

F-16C BLOCK 25/42 USAF



F-16C Block 25/42 USAF

The F-16 Fighting Falcon is a single-engine multirole fighter aircraft originally developed by General Dynamics for the United States Air Force (USAF). Designed as an air superiority day fighter, it evolved into a successful all-weather multirole aircraft. Over 4,600 aircraft have been built since production was approved in 1976. Although no longer being purchased by the U.S. Air Force, improved versions are being built for export customers. In 1993, General Dynamics sold its aircraft manufacturing business to the Lockheed Corporation, which in turn became part of Lockheed Martin after a 1995 merger with Martin Marietta.

The Block 25 F-16C first flew in June 1984 and entered USAF service in September. The aircraft version is fitted with the Westinghouse AN/APG-68 radar and has improved precision night-attack capability. Block 25 introduced a very substantial improvement in cockpit avionics, including improved fire-control and stores management computers, an Up-Front Controls (UFC) integrated data control panel, data-transfer equipment, multifunction displays, radar altimeter, and many other changes.

Block 25s were first delivered with the Pratt & Whitney F100-PW-200 engine and later upgraded to the Pratt & Whitney F100-PW-220E. This Variant was largely involved on the CAS (Close Air Support) missions during the Operation Desert Storm in 1991. With 209 Block 25 C-models and 35 D-models delivered, today the USAF's Air National Guard and Air Education and Training Command are the only remaining users of this variant. One F-16C, nicknamed the "Lethal Lady", had flown over 7,000 hours by April 2008.

CAUTION

- *Read carefully and fully understand the instructions before commencing assembly.
- *Keep out of reach of children. Children must not be allowed to put any parts in their mouths, or pull plastic bag over their heads.
- *When using adhesives and paints, please make sure not to use them in closed room or near the fire.
- *When assembling this kit, tools including knives are used. Extra care should be taken to avoid injury.

WARNING: CONTAIN SMALL PARTS NOT FOR CHILDREN UNDER 14 YEARS OF AGE.



Drill



Remove



2 Set



Bend



Optional



Decal



Super Glue



Fill Hole



No Cement



Be Careful

TOOLS RECOMMENDED

Cement

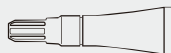

Side Cutter



Modeling Knife



Tweezers

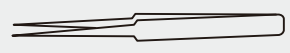

1/48 SCALE AIRCRAFT SERIES NO.K48102

AFTERMARKET SERVICES CARD

When requesting replacement parts, please take or send this form to your local dealer so that the parts required can be correctly identified. Please note that specifications and availability are subject to change without notice. Or visit <http://www.kineticmodel.com> for latest information. For more information, please contact services@kineticmodel.com

Part Code	K48102	Qty	Item	Part Code	Qty	Item
00-180-001	1/48 MODERN US TARGETING POD	1	A	00-180-007	1	G
00-180-002	1/48 F-16 LOWER FUESLAGE	1	B	00-180-010	2	K
00-180-003	1/48 F-16A/C UPPER FUESLAGE	1	C	01-100-001	1	Decal
00-180-004	1/48 F-16 MAIN PARTS	1	D	01-180-48102	1	Decal
00-180-005	1/48 NSI INTAKE and LANDING GEAR	1	E	03-180-48102	1	MANUAL
00-180-006	1/48 F-16 FUEL TANKS, SEATS	2	F			

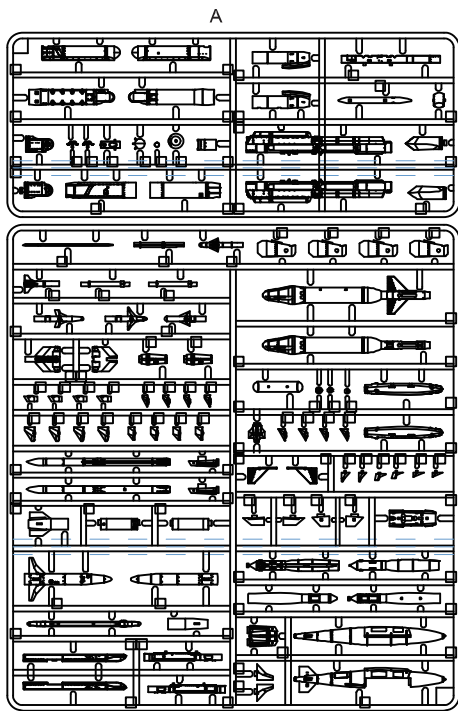

A

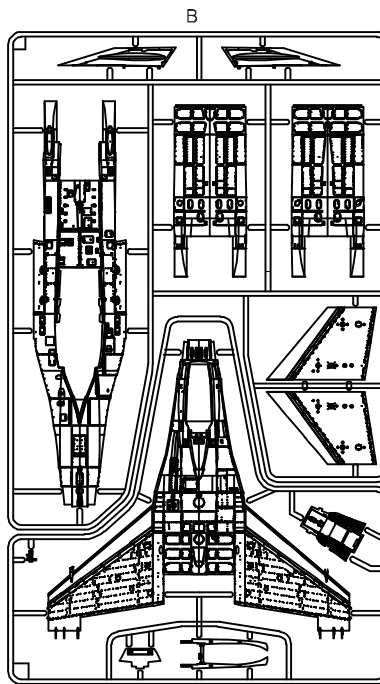

B

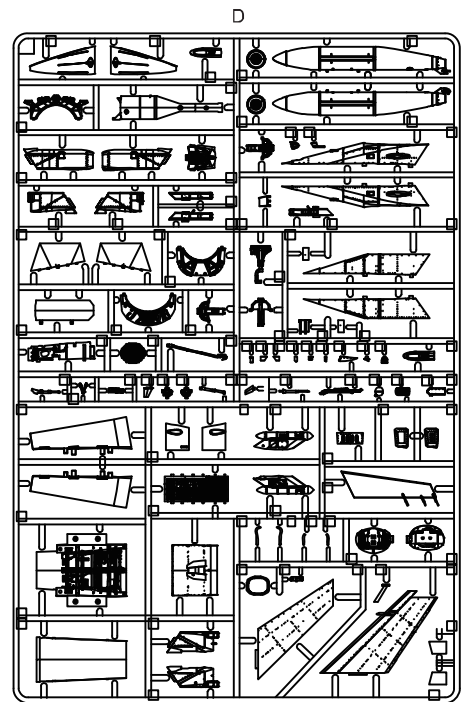

D

Kx2

C

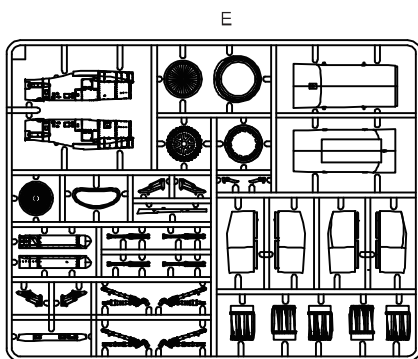

E

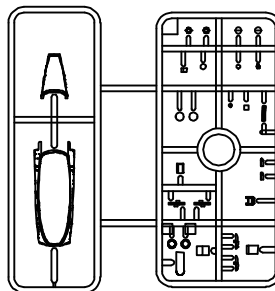

G

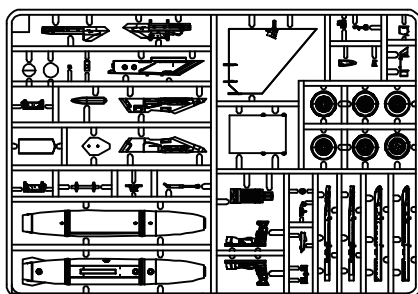

Fx2



COLOR	AMMO MIG	VALLEJO MODEL COLOR	GSI CREOS MR. COLOR	TAMIYA ENAMEL/ACRYLIC	HUMBROL ENAMEL
GUN METAL	A.MIG-045	70.863	78	X-10	53
MATT BALCK	A.MIG-046	71.057	33	XF-1	33
SATIN WHITE	A.MIG-047	70.842	1	X-2	22
YELLOW	A.MIG-048	71.002	4	XF-3	69
BLUE	A.MIG-086	71.089	323/5	X-4	14
CRYSTAL RED	A.MIG-093	70.934	47	X-27	220
CRYSTAL BLUE	A.MIG-098	70.938	50	X-23	-
BURNT IRON	A.MIG-187	71.073	61	XF-4	-
STEEL	A.MIG-191	70.864	28	-	27003
SILVER	A.MIG-195	71.063	8	X-11	11
GOLD	A.MIG-198	71.066	9	X-12	16
GHOST GRAY FS 36375	A.MIG-203	70.990	308	-	-
GUNSHIP GRAY	A.MIG-204	71.047	305	XF-77	125
FS36320	A.MIG-208	71.120	307	-	128
FS336270	A.MIG-211	71.275	306	-	126
DARK OILVE DRAB	A.MIG-237	71.016	12	XF-62	-
SATIN BLACK	A.MIG-032	70.861	2	X-18	21
CLEAR YELLOW	-	70.937	48	X-24	-
FS 36495	A.MIG-209	71.276	338	-	-

For Color Profile, please go to www.kineticmodel.com for download
(type the kit# and go for manual/painting guide)

1

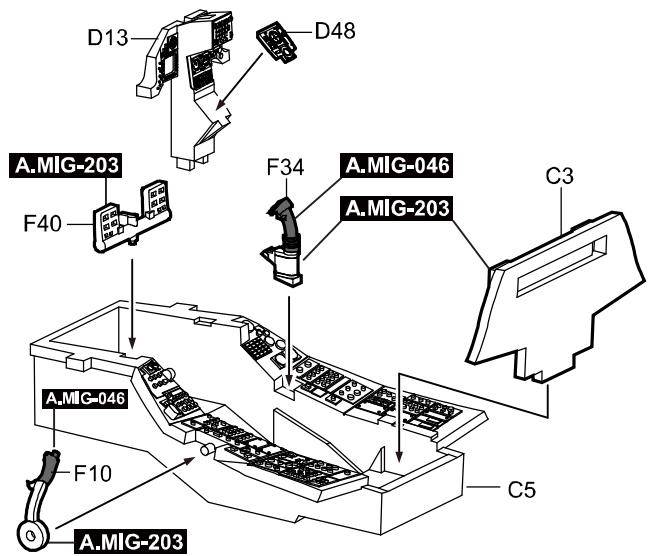
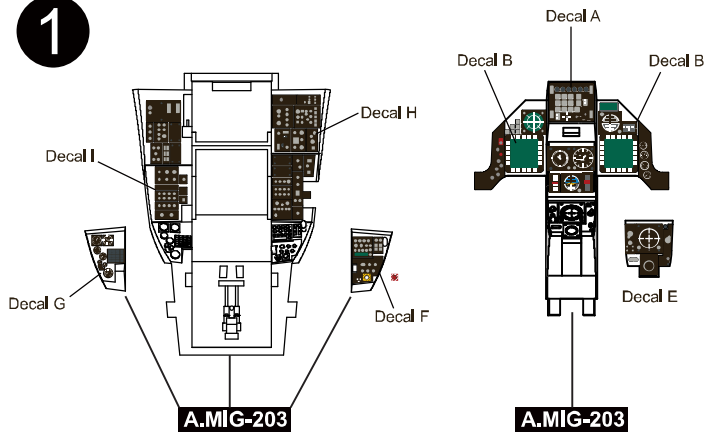

2

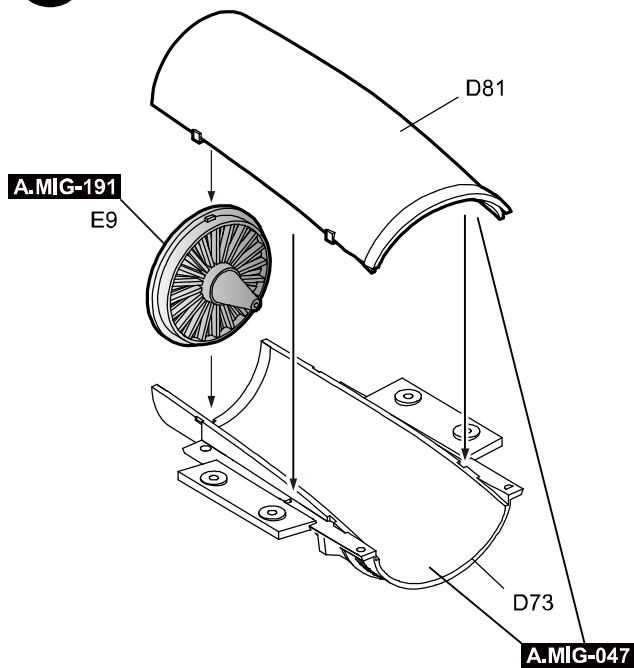

3

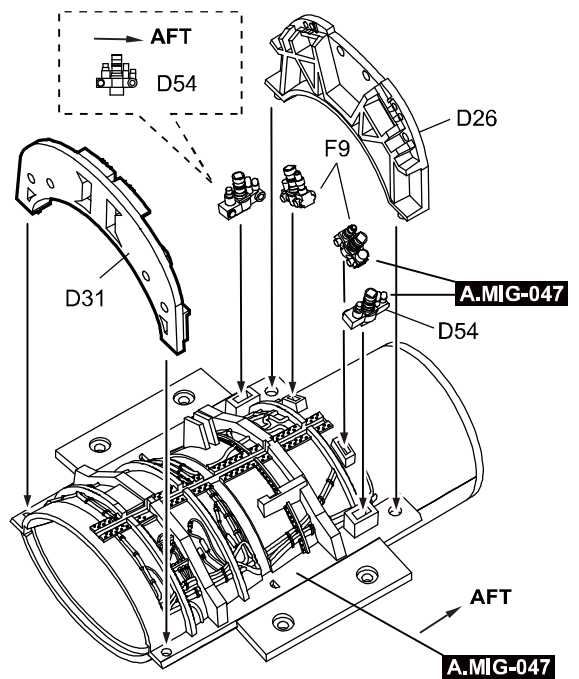

4

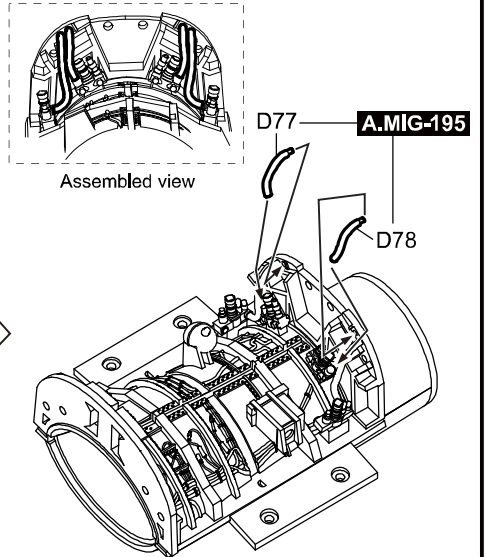
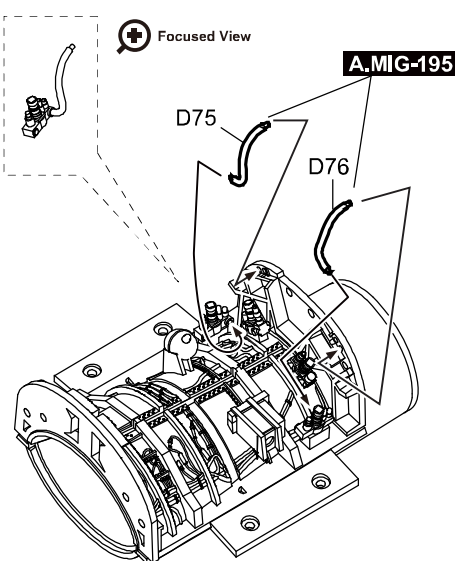
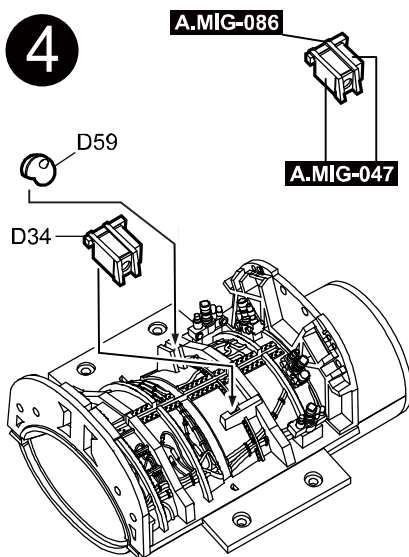

5

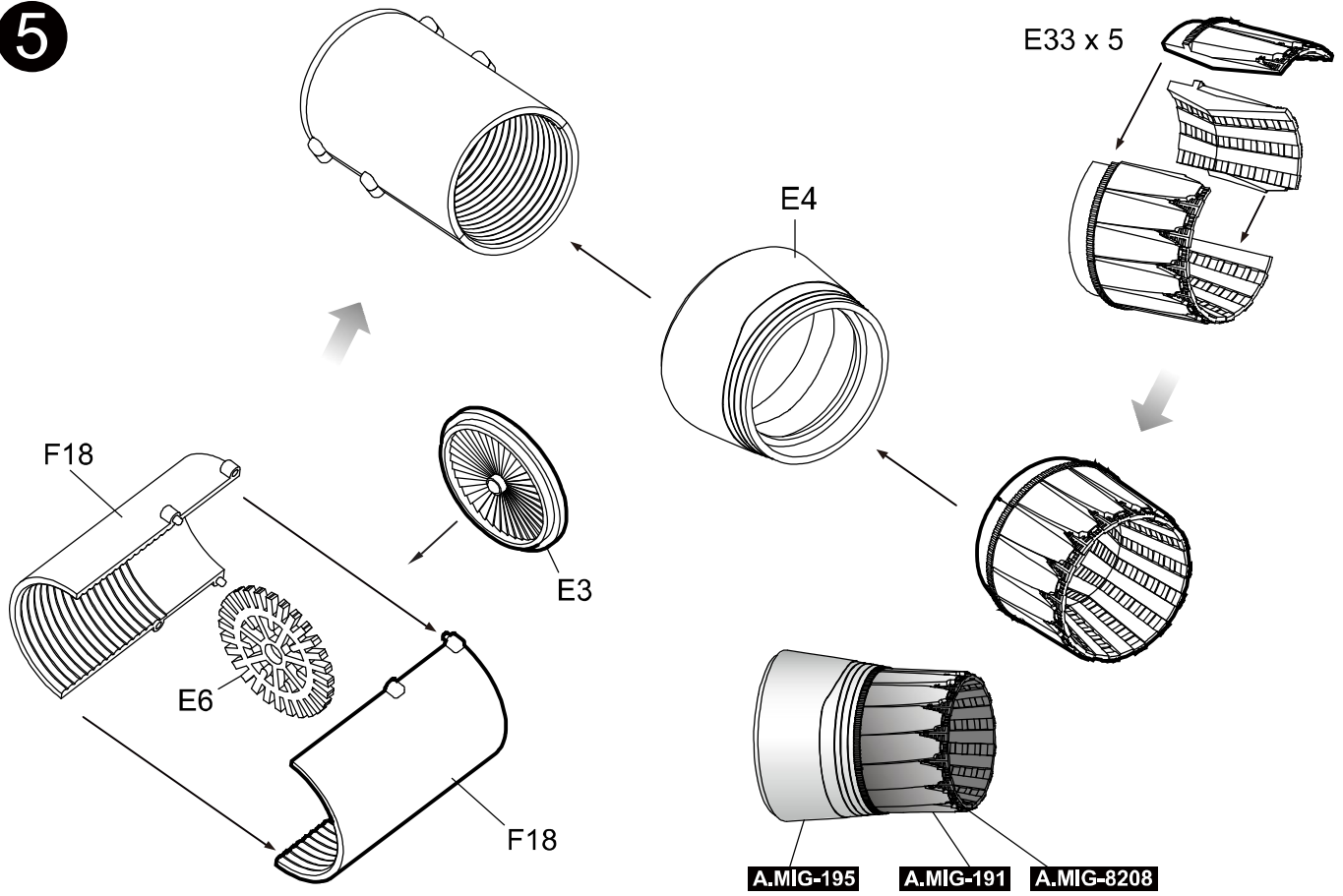

6

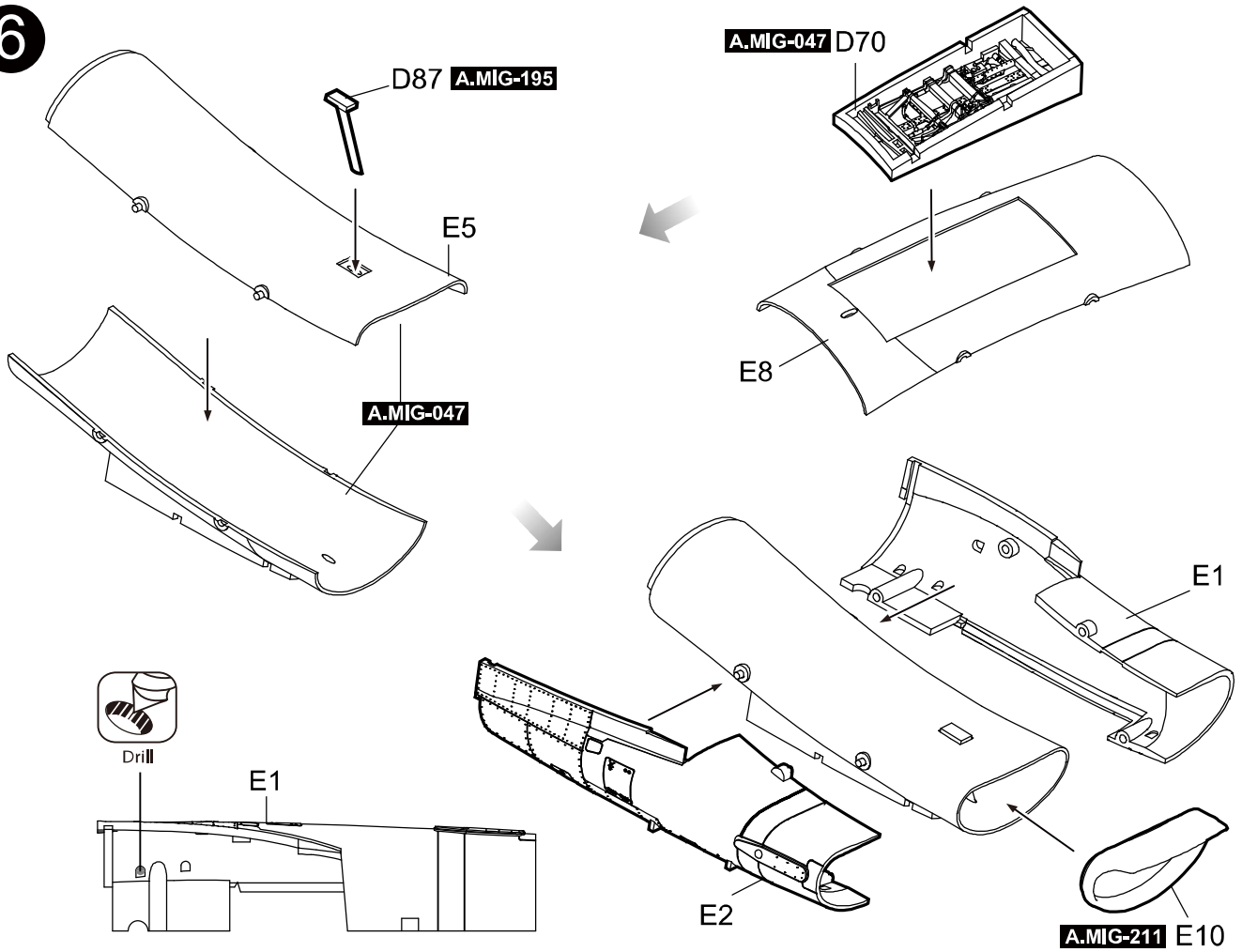

7

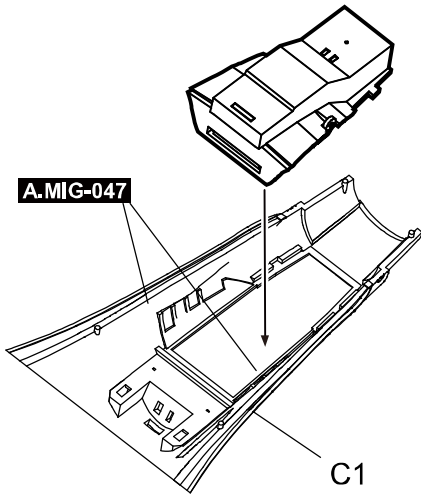

8

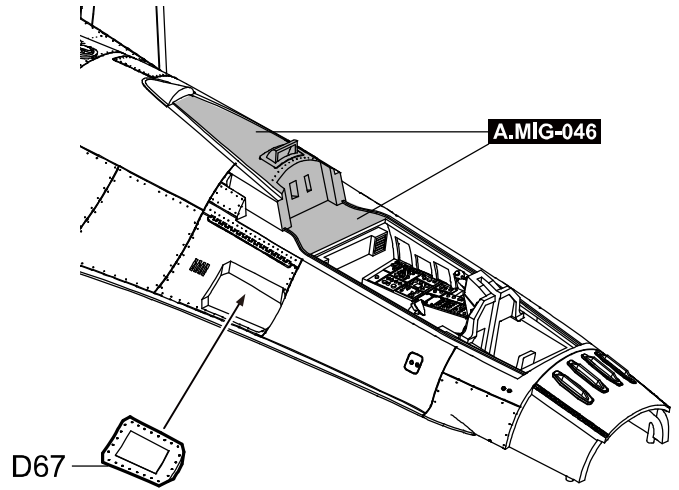

9

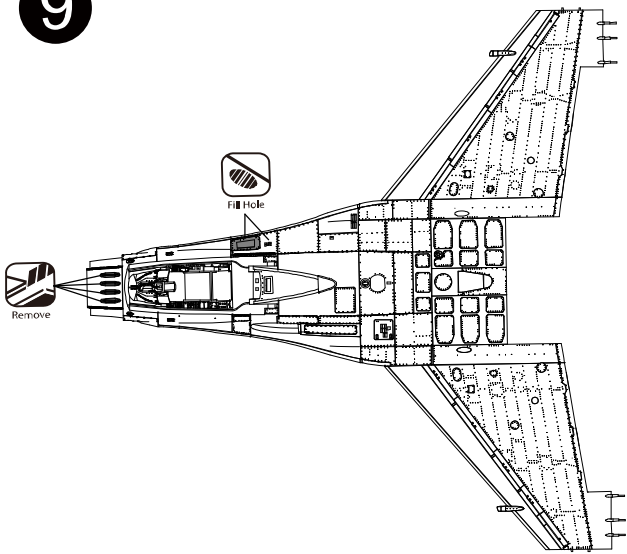

+ Focused View

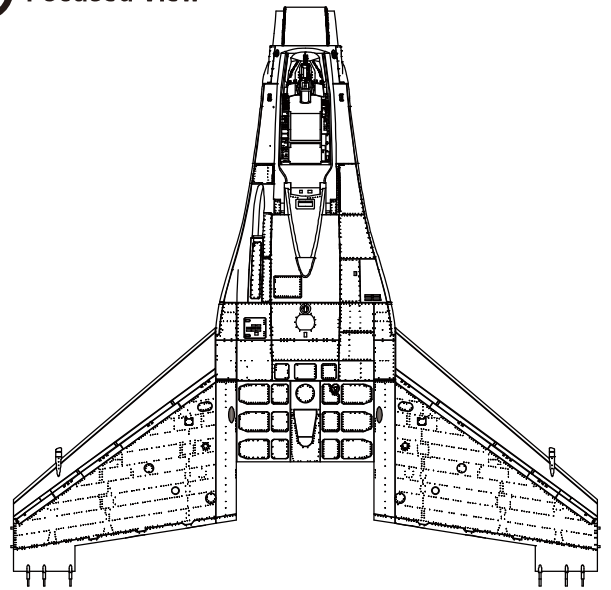

10

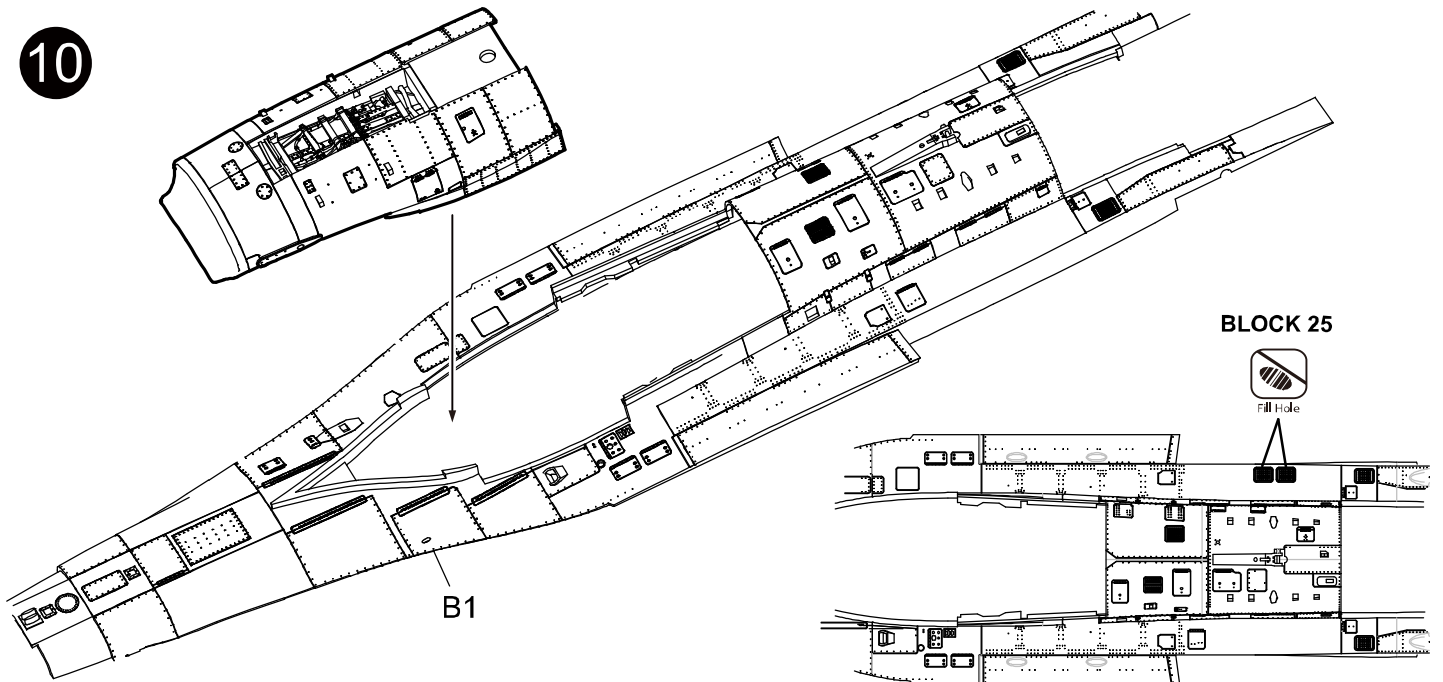

11

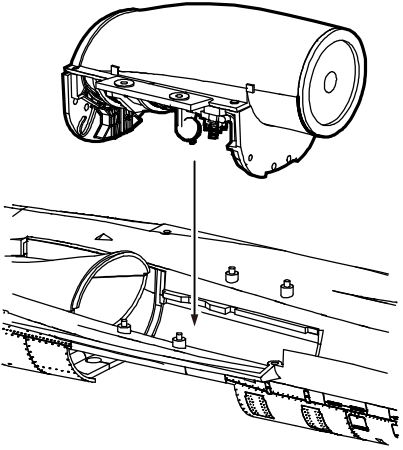

12

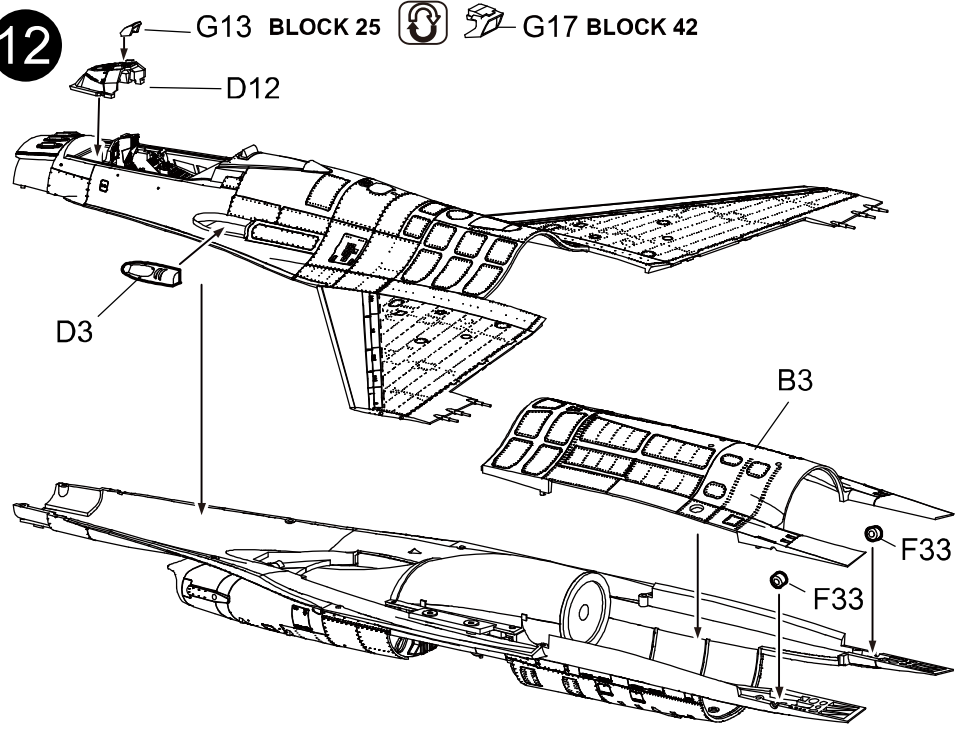

13

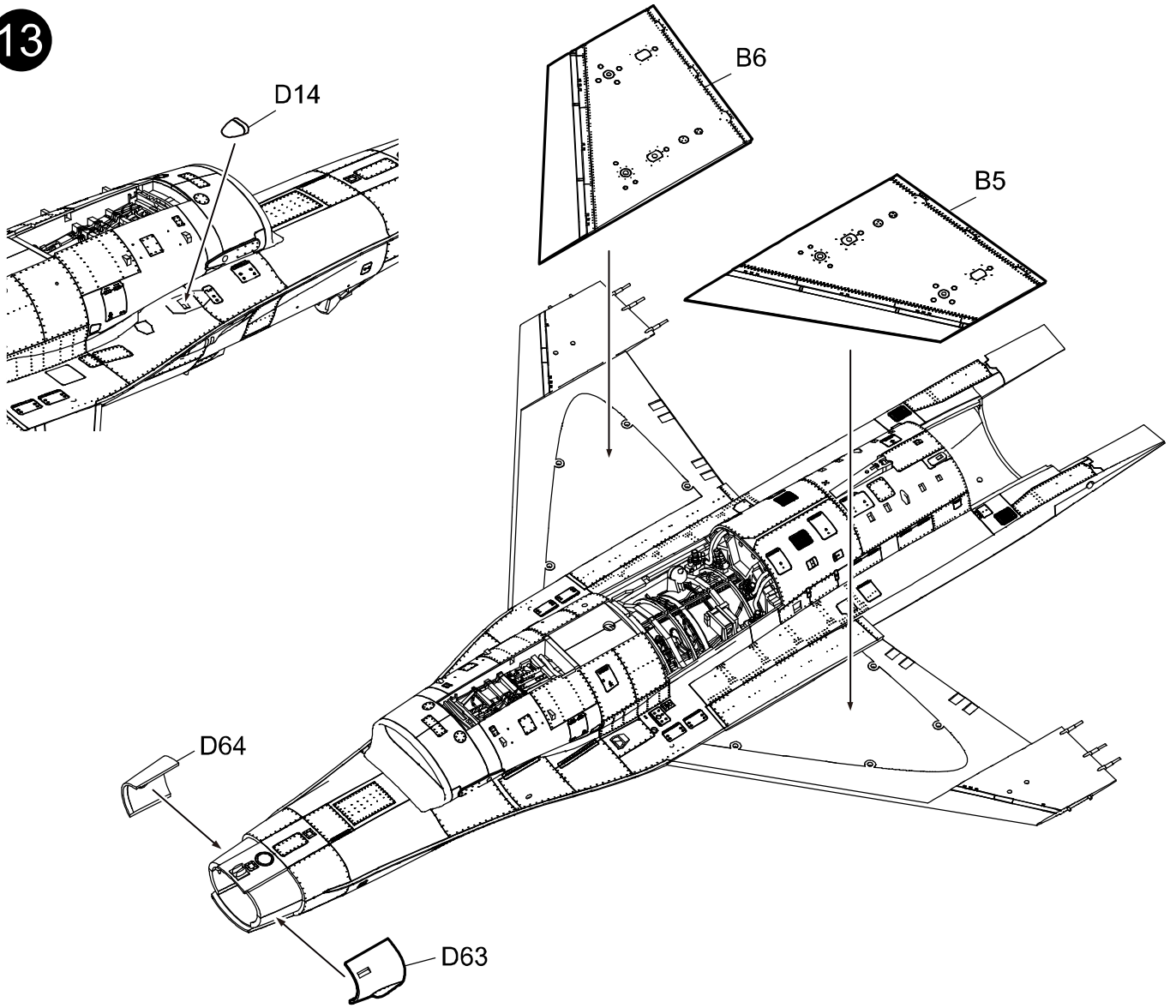

14

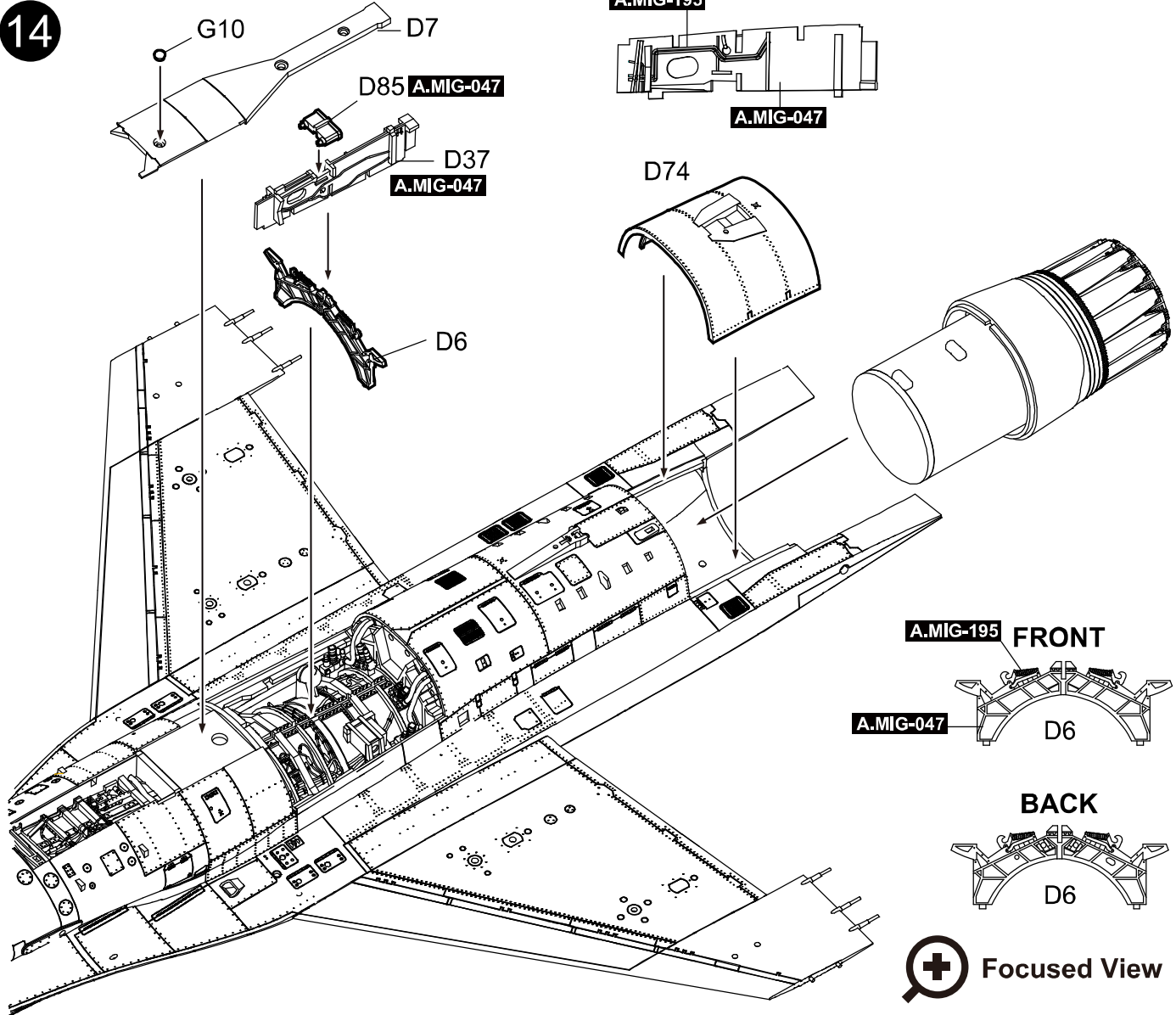

15

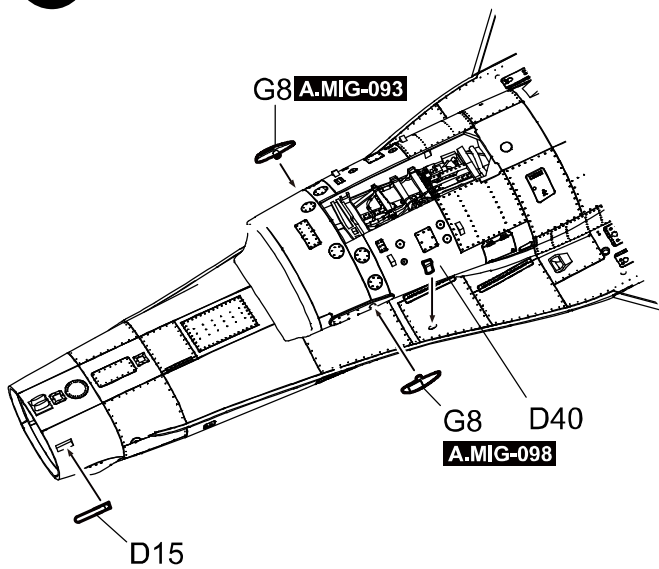

16

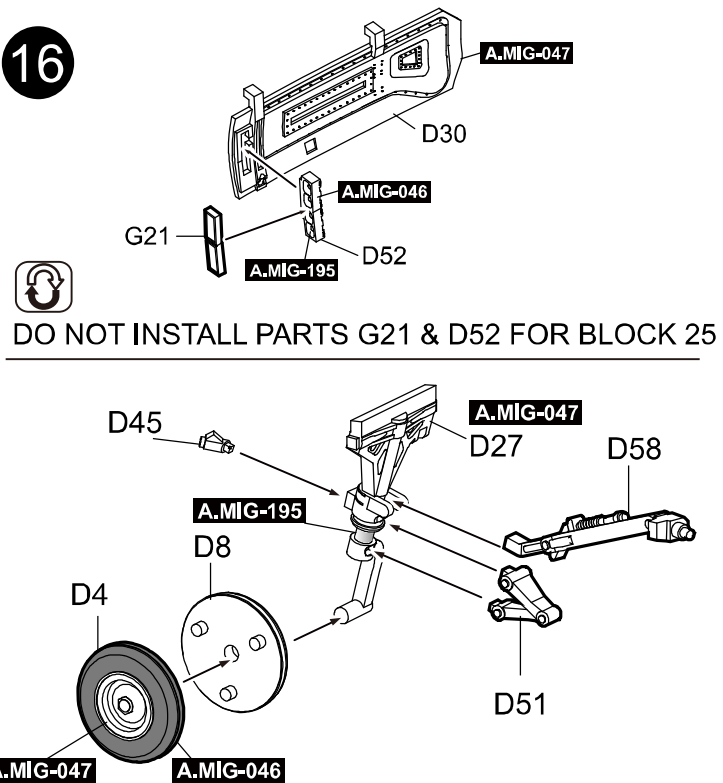

17

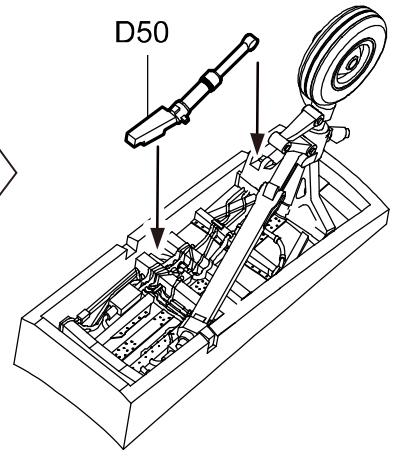
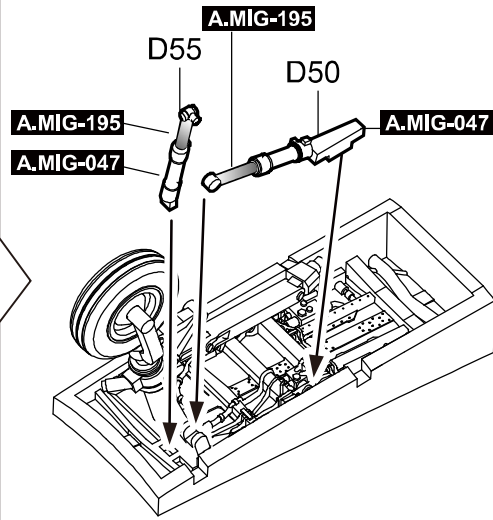
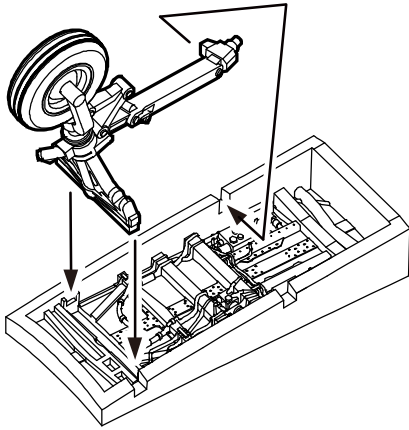

18

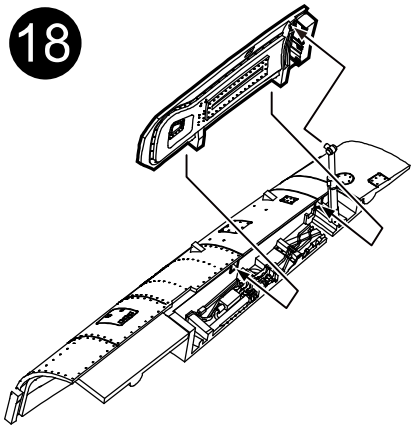

+ Focused View

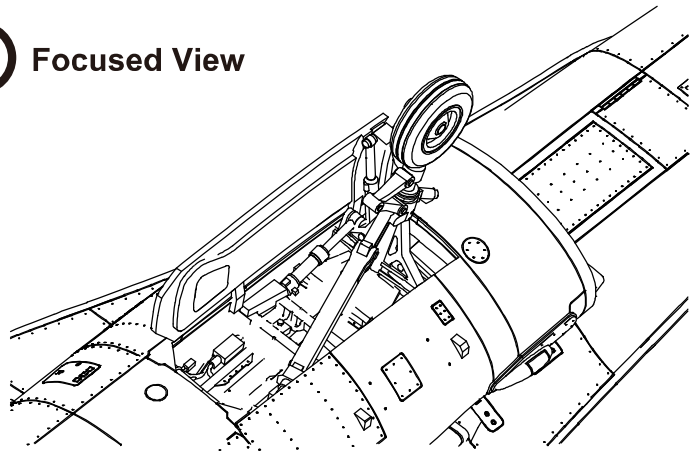

19

BLOCK 25

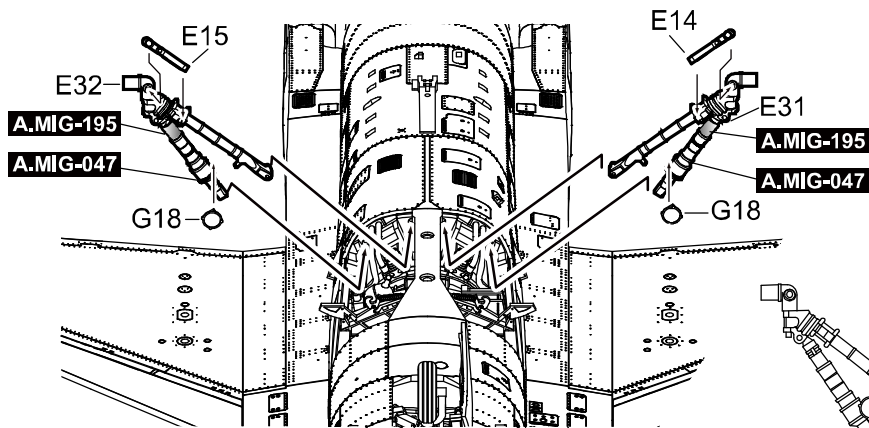

+ Focused View

BLOCK 42

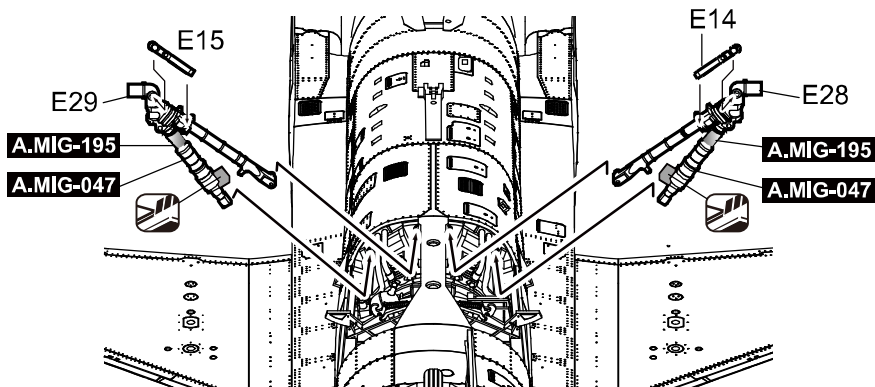

20

BLOCK 42 E20(E21)
BLOCK 25 E19(E18) A.MIG-047

AFT

E19(E18)

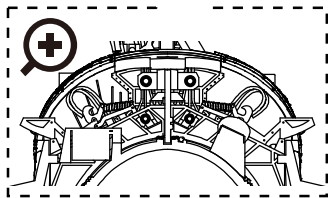
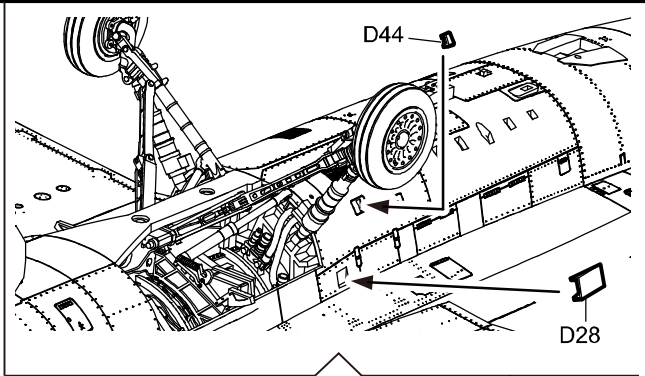

A.MIG-195

A.MIG-047

F31(F31)

A.MIG-046

A.MIG-047

BLOCK 42 Block 25

F19

F20

F26

F27

2

2

21

D35

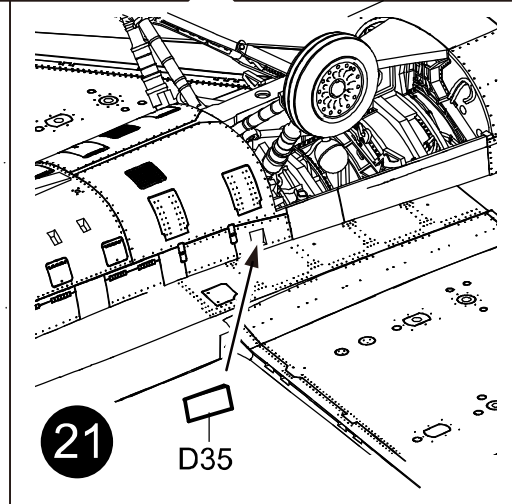

BLOCK 25

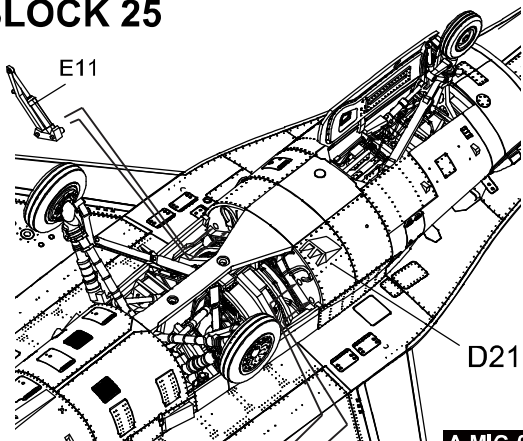

E22

A.MIG-047

E23

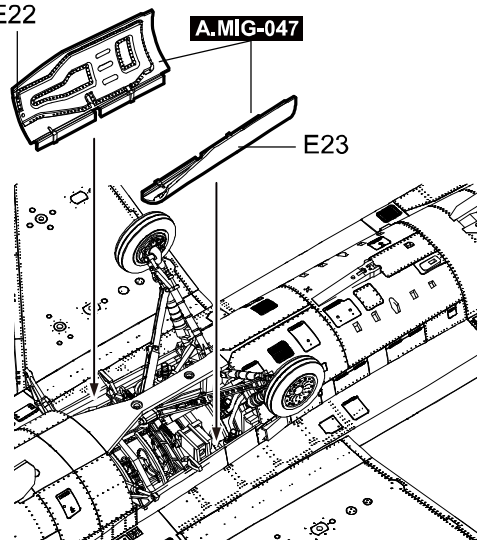

22

BLOCK 42

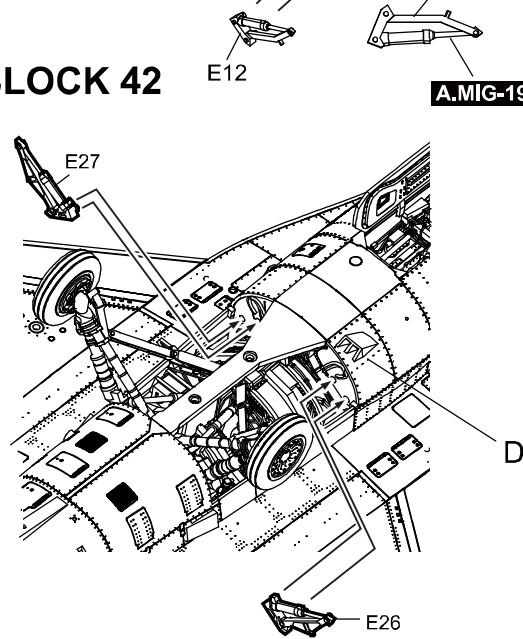

E24

A.MIG-047

E25

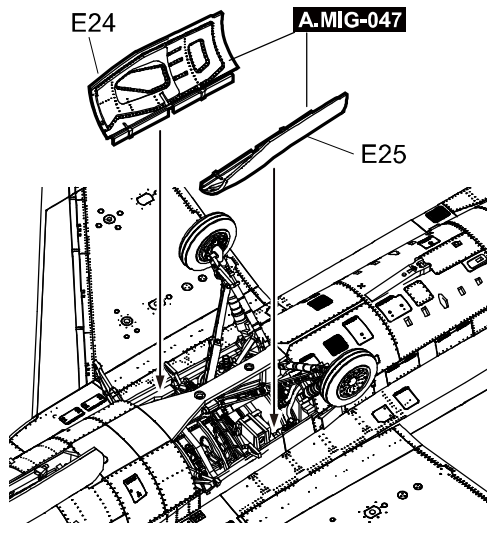

23

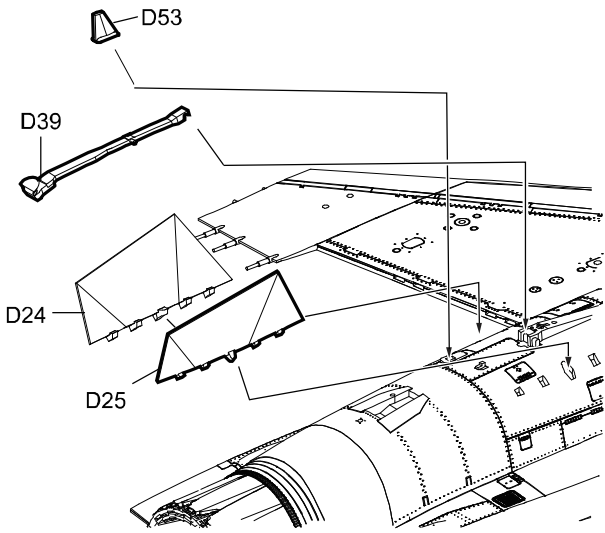

Cut for closed canopy option.

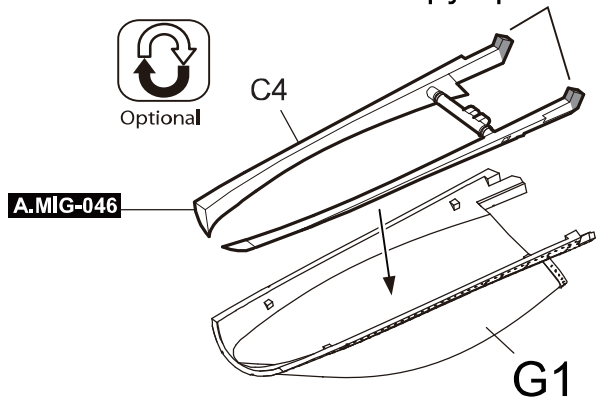

24

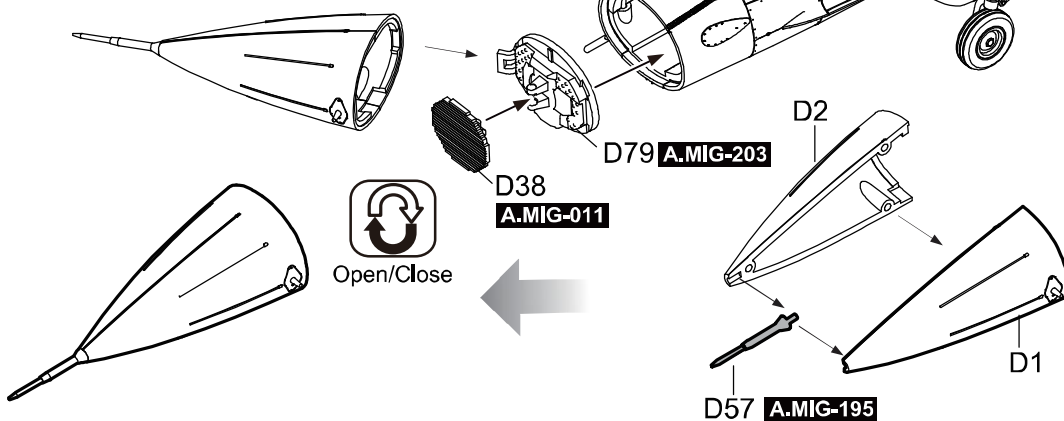
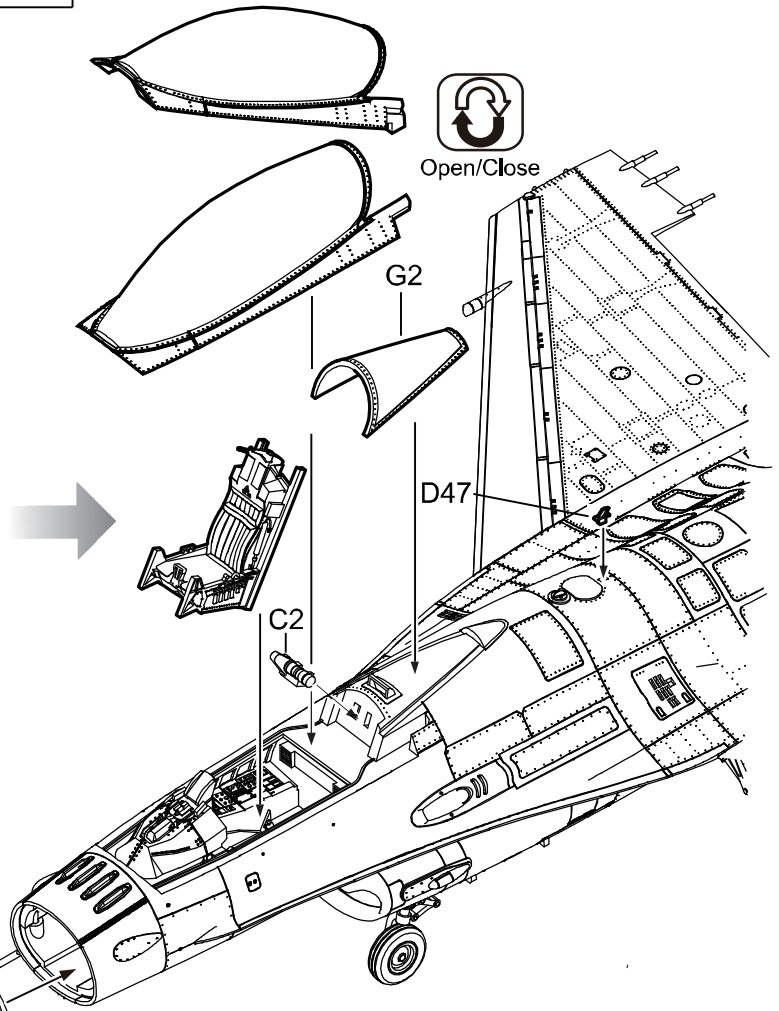
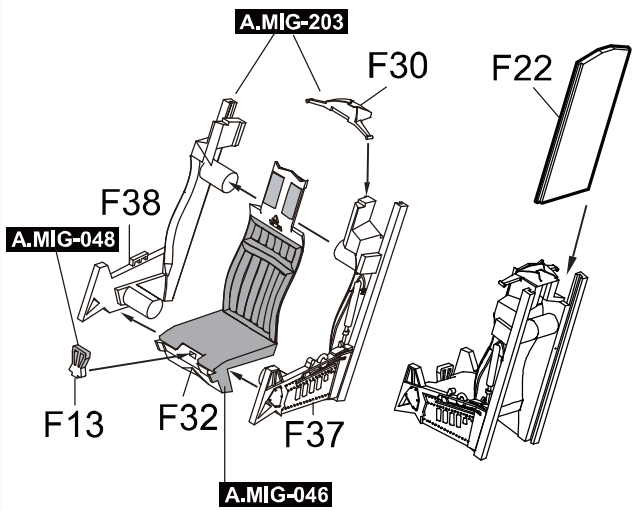

25

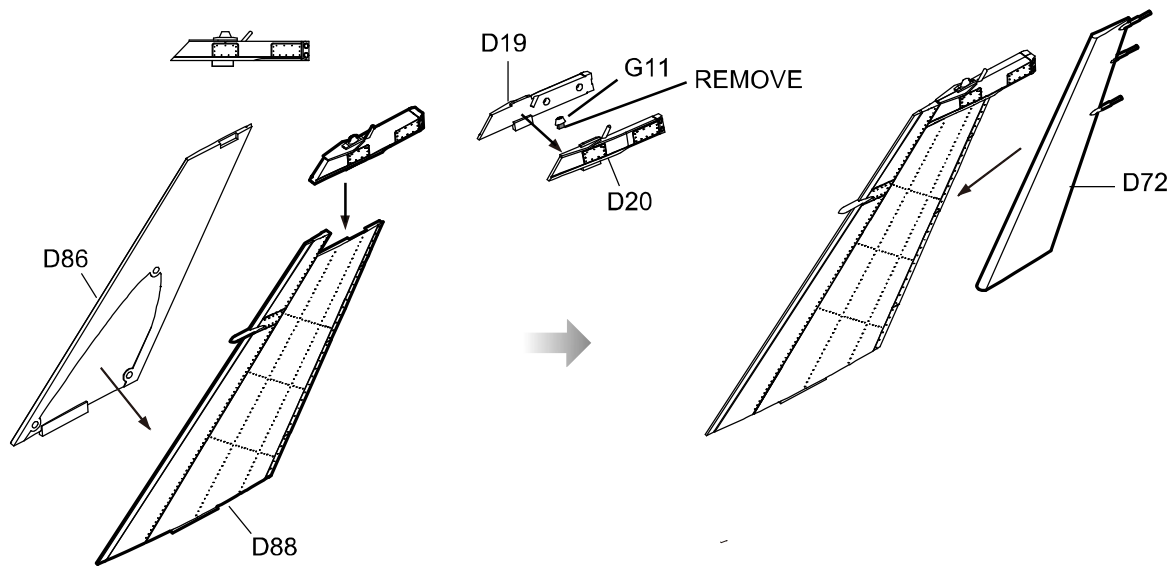

26

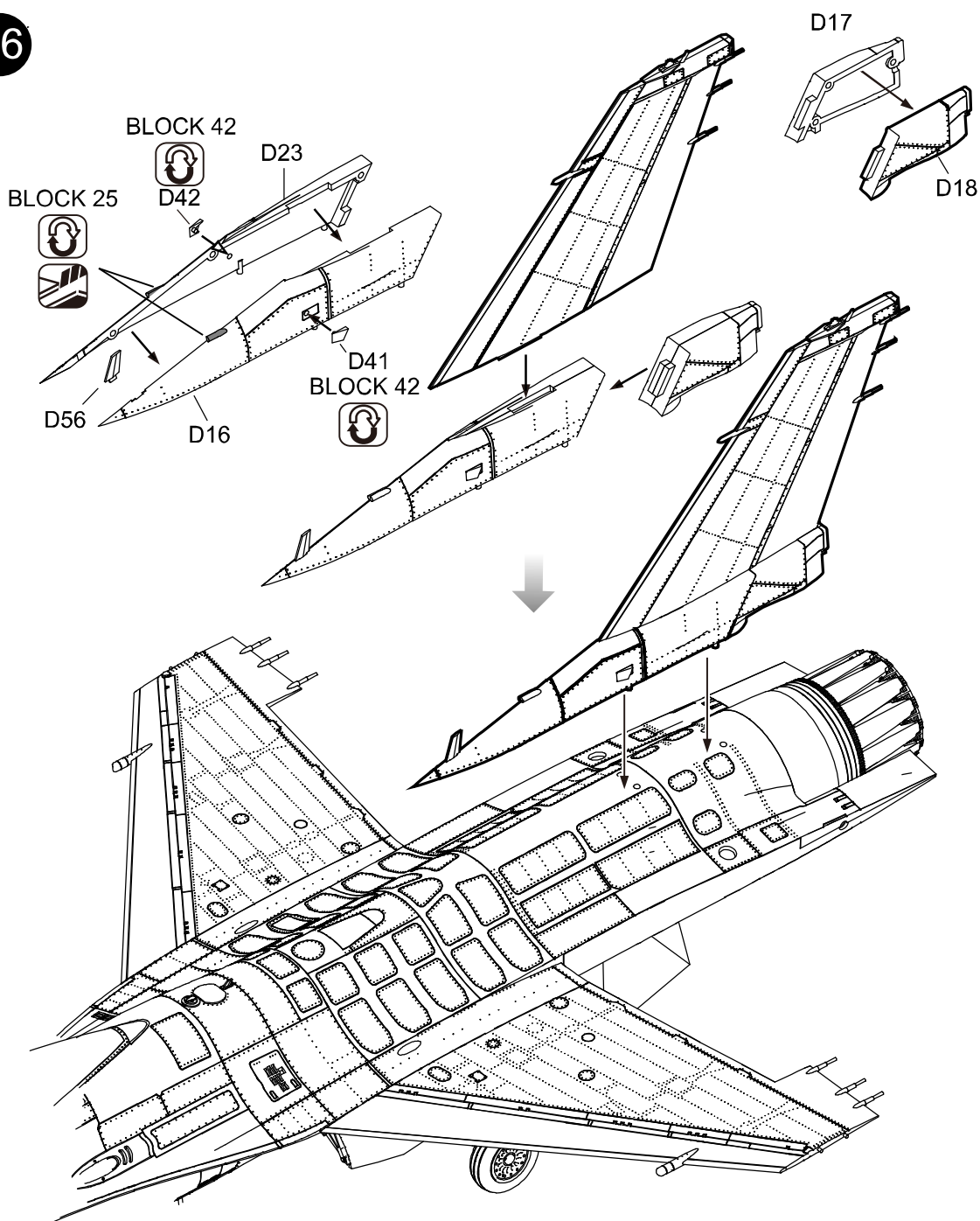

27

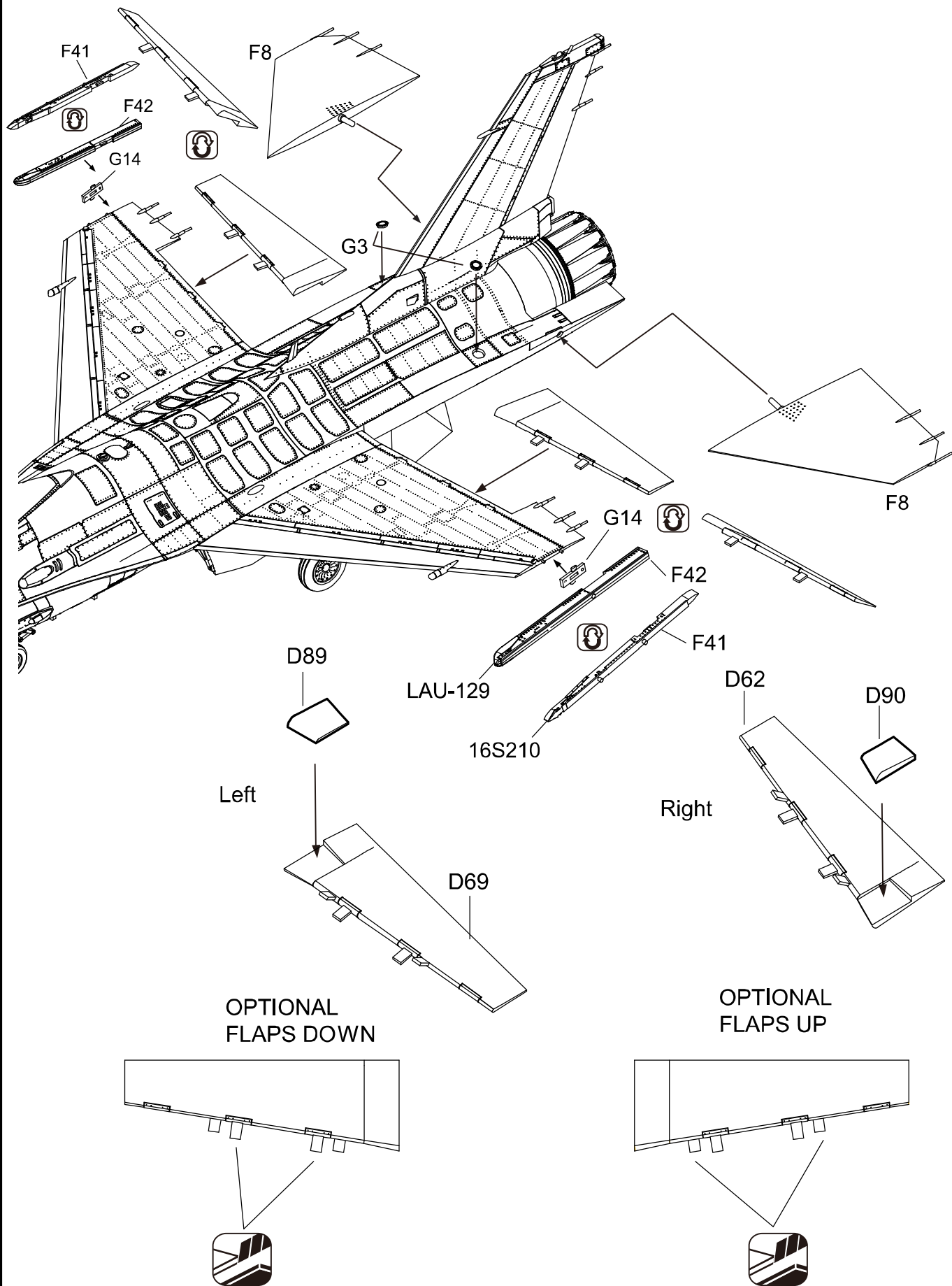

TER

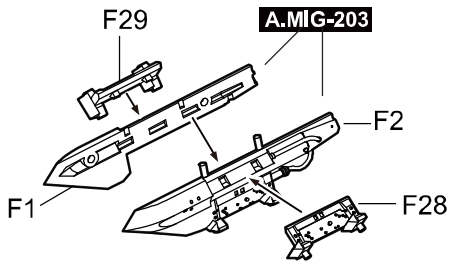

MIDDLEPYLON A.MIG-203

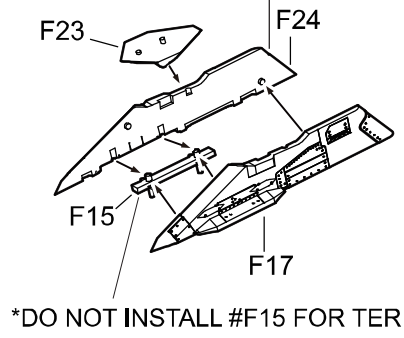

WING TANK PYLON

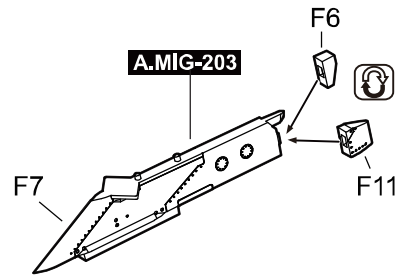

CENTENLINEPYLON

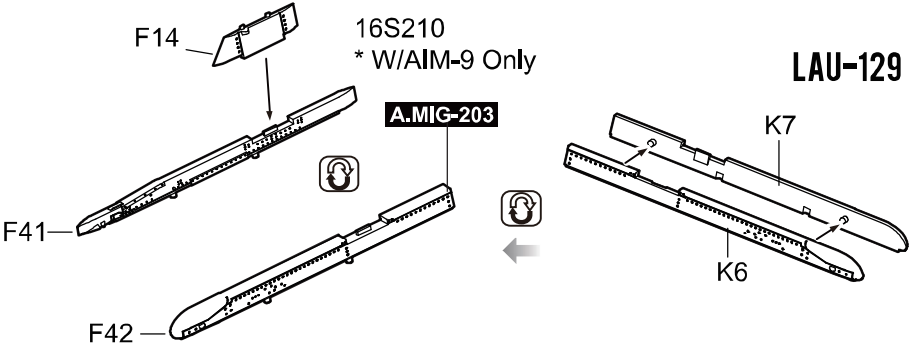
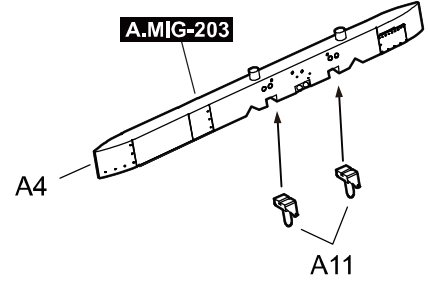

AAQ-13

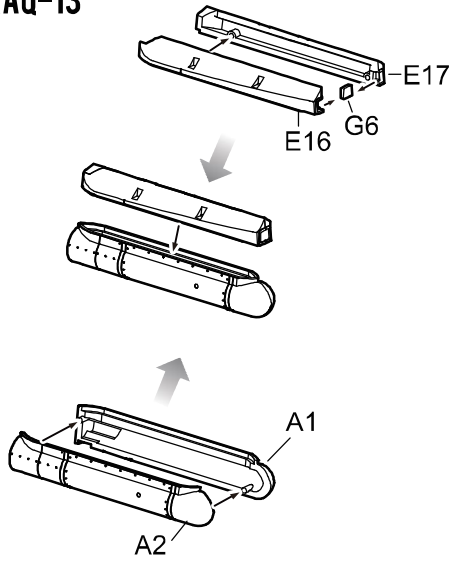

AAQ-14

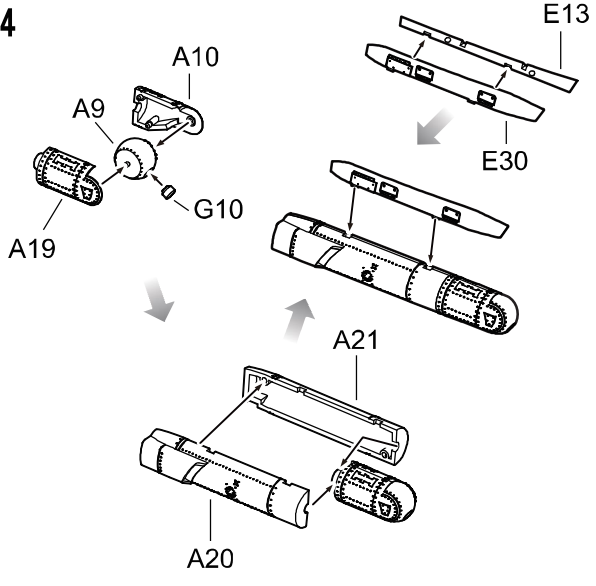

AIM-9M

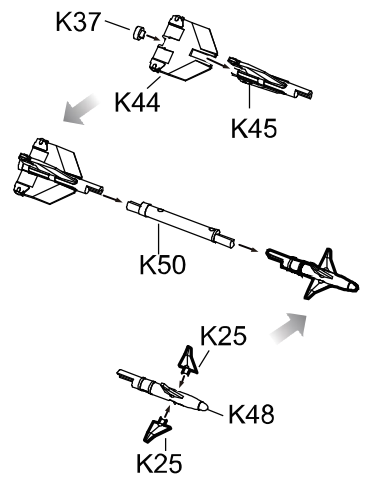

AGM-88

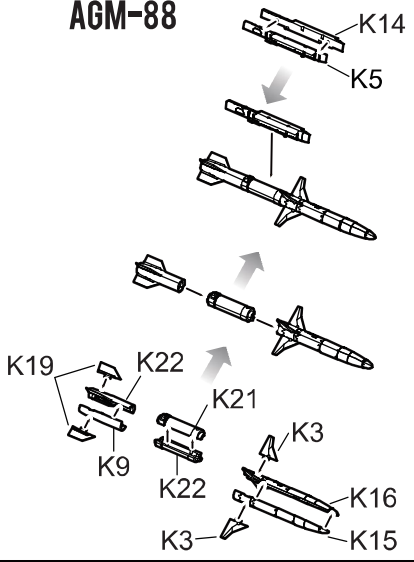

SNIPER XR

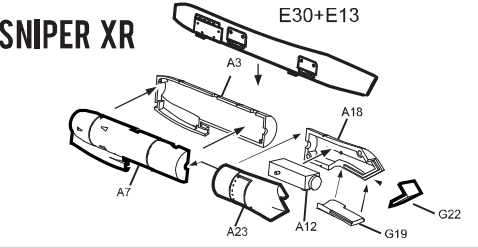

AAQ-28

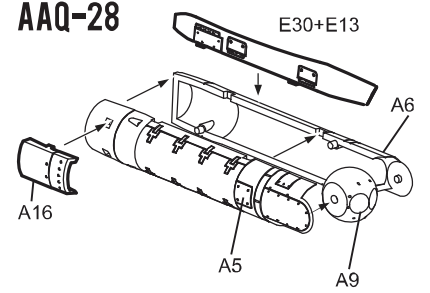

AIM-9X

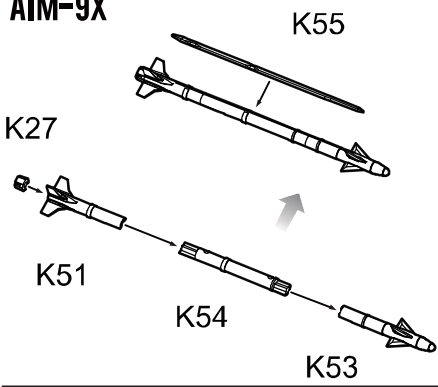

ALQ-184

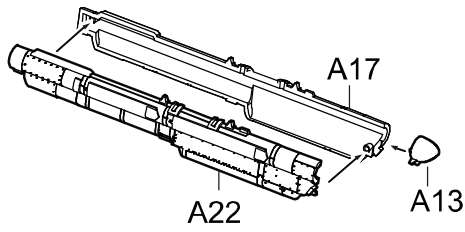

GBU-31

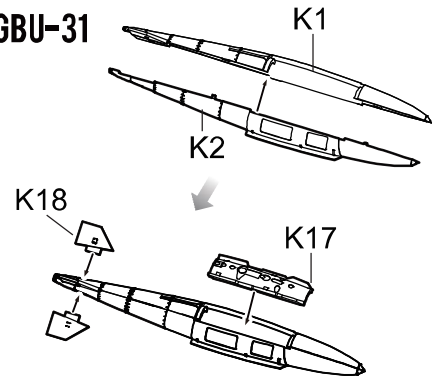

AIM-120

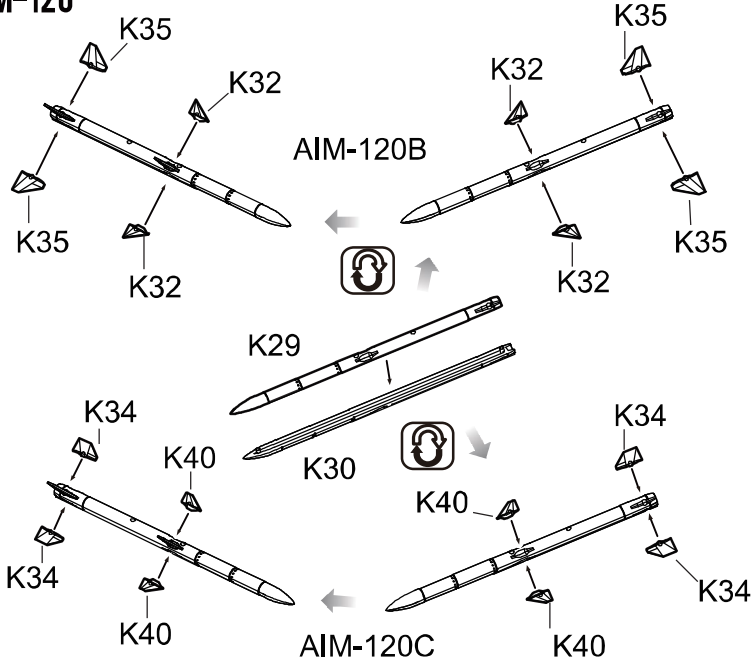

370 GALLON WING TANK

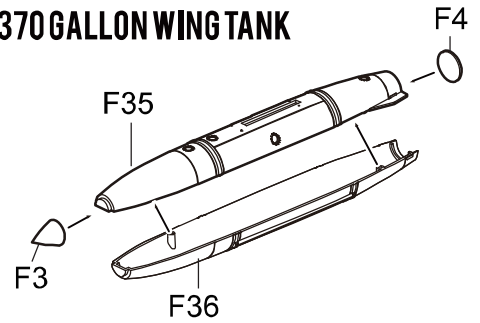

300 GALLON CENTENLINE TANK

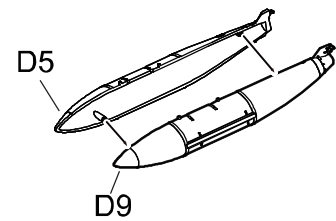

GBU-12-49

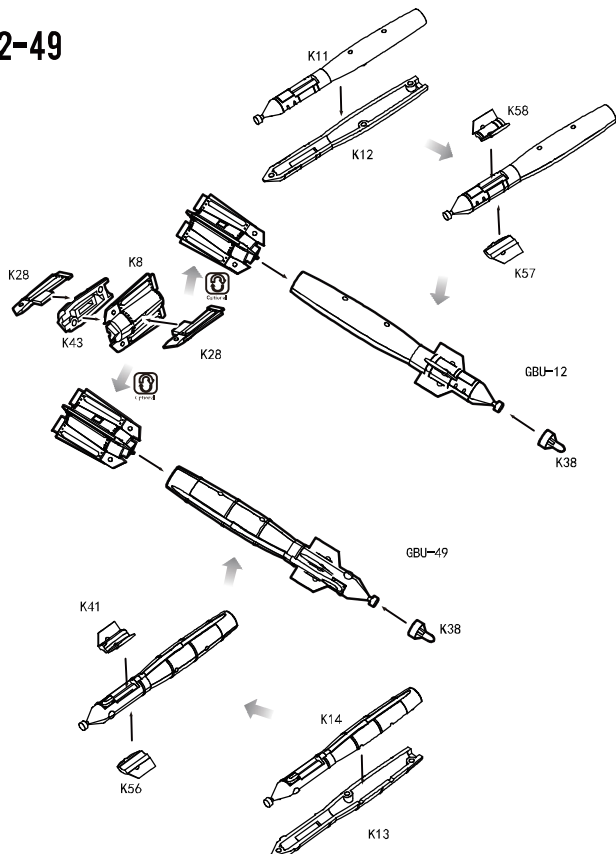

GBU-24

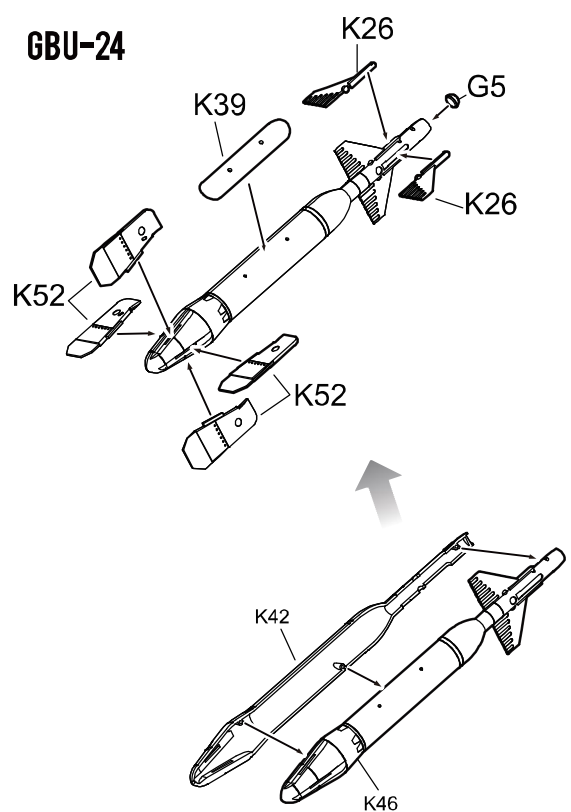

AN/ASQ-213 HARM TARGETING SYSTEM POD

HARDPOINT LOCATION

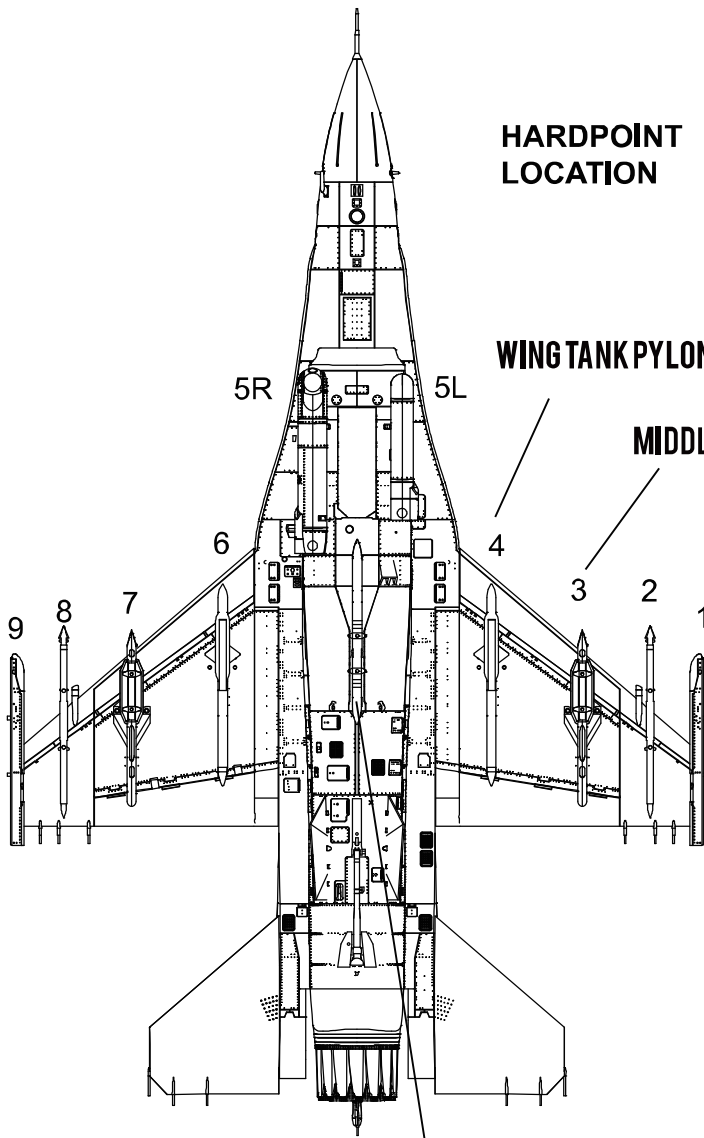

WING TANK PYLON

MIDDLE PYLON

CENTRELINE PYLON 5

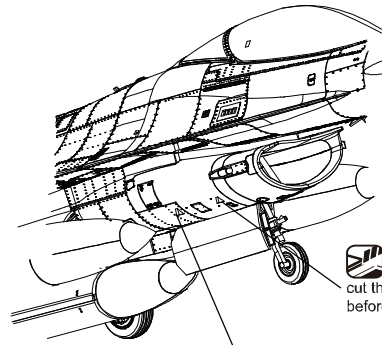

cut this locating pin before installing AN/ASQ-213

Trim the pin to fit the AN/ASQ-213

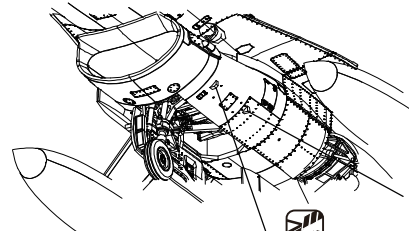

Trim the pin to fit the AN/ASQ-213

cut this locating pin before installing AN/ASQ-213

If you choose to install AGM-88 (HARMS), you need to install AN/AQL-213 either on hardpoint 5R/5L



Portside

D71 (5L)

A.MIG-047 **A.MIG-203**

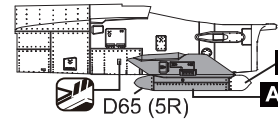

Starboard

A.MIG-047

A.MIG-203

D65 (5R)

WEAPON LOADING ILLUSTRATION

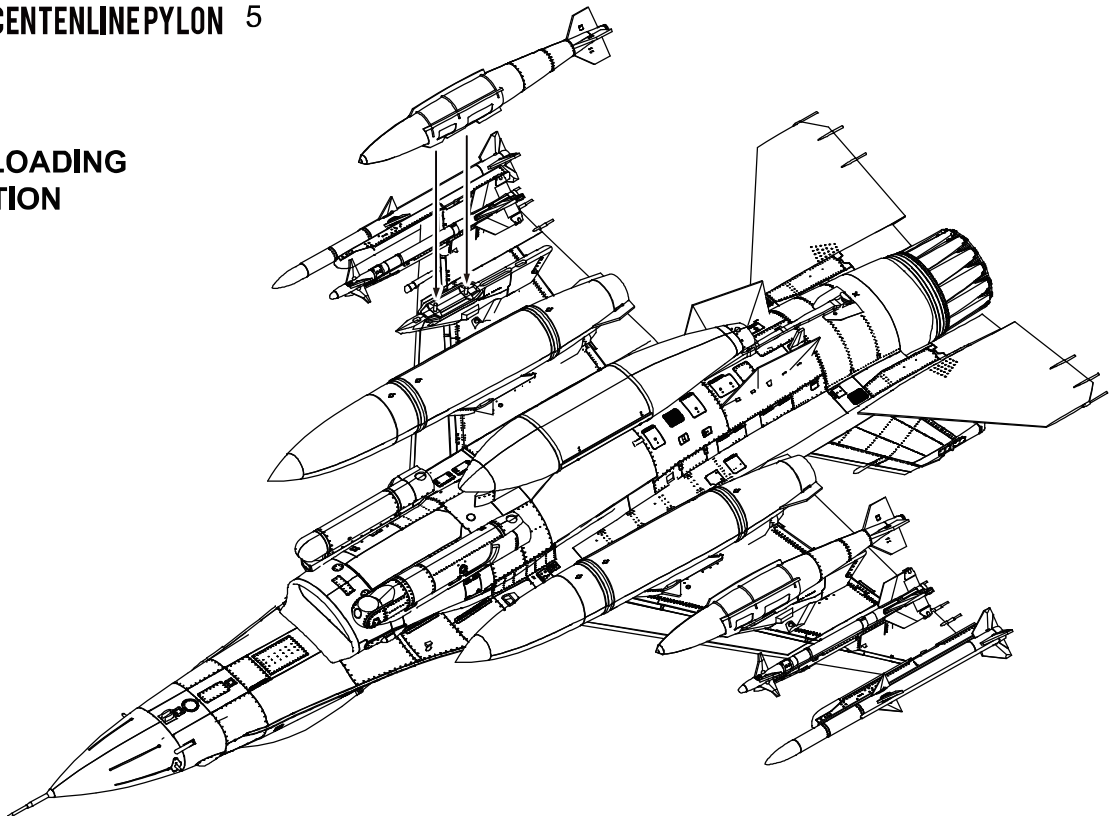

EXTERNAL STORES

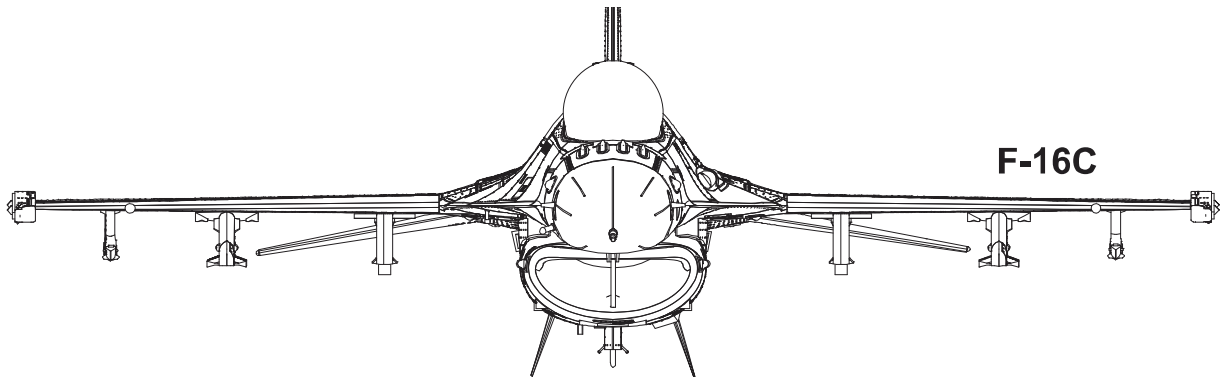

Station No. Weapons	9	8	7	6	5R	5	5L	4	3	2	1
16S210 (W/AIM-9M only)	●	●	●						●	●	●
LAU-129	●	●	●						●	●	●
AIM-9M	●	●	●						●	●	●
AIM-9X (W/LAU-129 only)	●	●								●	●
AIM-120B (W/LAU-129 only)	●	●	●						●	●	●
AIM-120C (W/LAU-129 only)	●	●	●						●	●	●
GBU-12/49			●						●		
GBU-12/49 (W/TER)			● ●						● ●		
GBU-31			●						●		
GBU-38			●						●		
GBU-38 (W/TER)			● ●						● ●		
GBU-24			●						●		
AGM-88			●						●		
370gal. Fuel tank				●				●			
300gal. Fuel tank						●					
AN/AAQ-13							●				
AN/AAQ-14					●						
SNIPER XR					●						
AN/ASQ-213 (W/AGM-88 installed)					●		●				
ALQ-184						●					

F-16C Block 25
147th Fighter Wing Texas ANG
2007

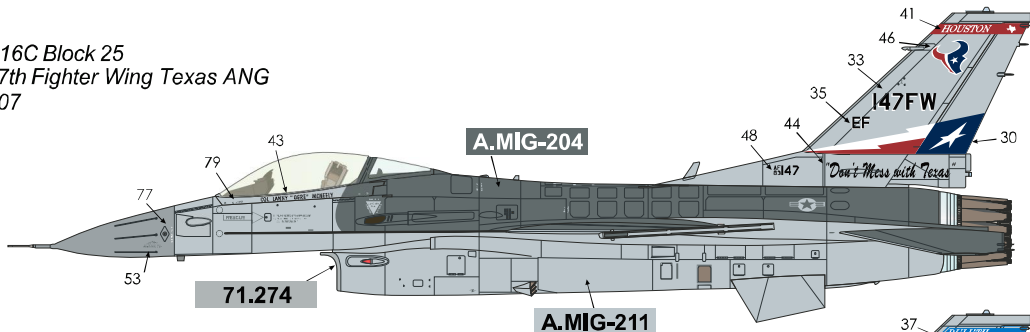

F-16C Block 25
148th Fighter Wing Minnesota ANG
2008

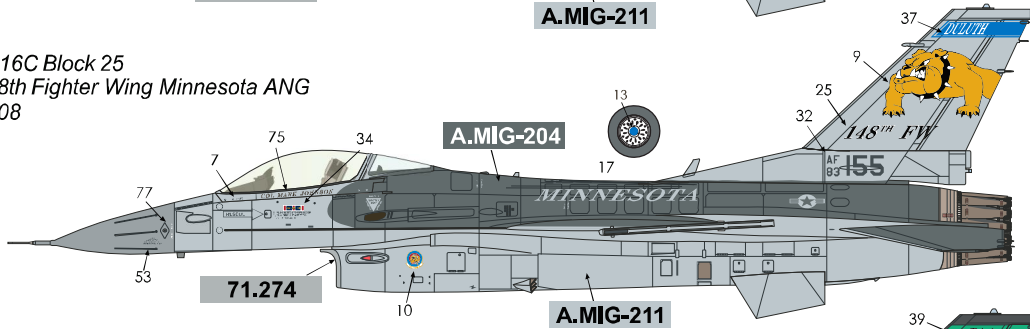

F-16C Block 42
112th Fighter Wing Ohio ANG
2020

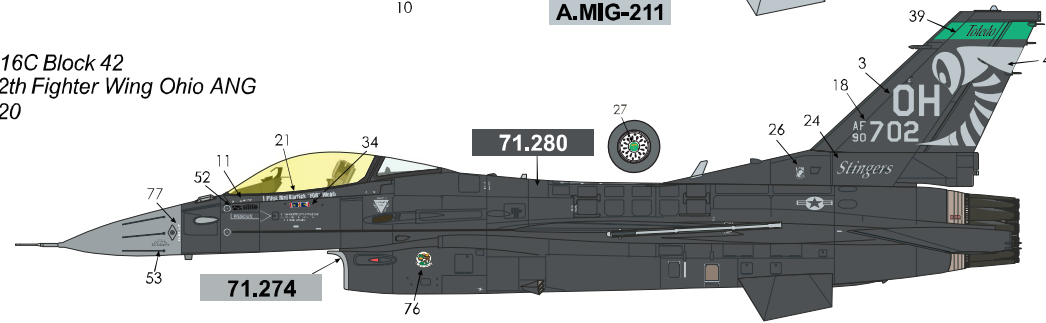

- Fs36118 **A.MIG-204**
- Fs36270 **A.MIG-211**
- Fs36251 **71.274**
- Fs36170 **71.280**

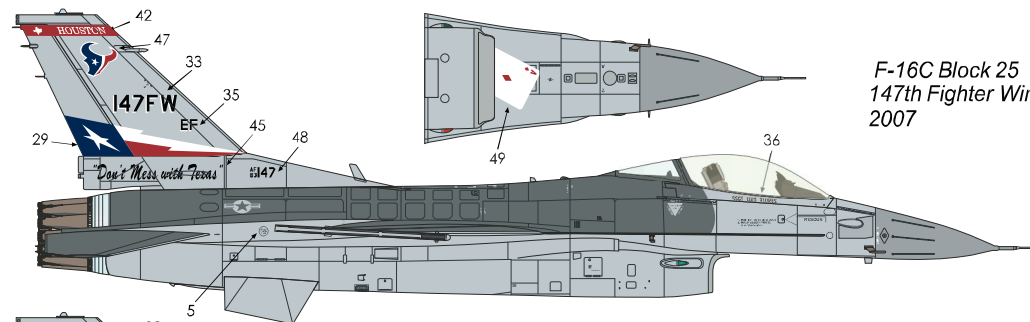

F-16C Block 25
147th Fighter Wing Texas ANG
2007

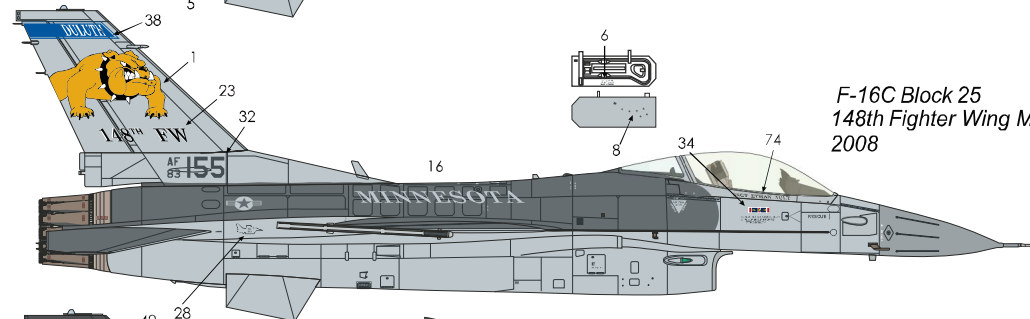

F-16C Block 25
148th Fighter Wing Minnesota ANG
2008

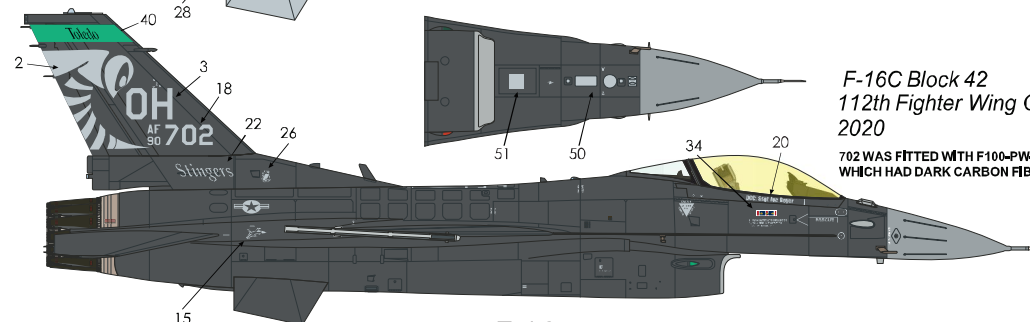

F-16C Block 42
112th Fighter Wing Ohio ANG
2020

702 WAS FITTED WITH F100-PW-229 ENGINES
WHICH HAD DARK CARBON FIBER PETALS

MISSILE RAILS AND DROP TANKS

CAN BE FS36375 **A.MIG-203** OR FS36270 **A.MIG-211**

THIS SHEET WAS MADE POSSIBLE BY THE GENEROUS CONTRIBUTION OF BULLSEYE DECALS AND COMBINED ARTWORK WITH FIGHTERTOWN DECALS

