

1/48 KA-6D Tanker Intruder INTERIOR 3D* DECAL

(for conversion from HobbyBoss kit)

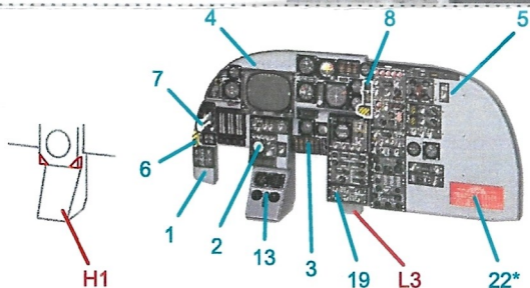

black - kit's parts
red - kit's parts which
you've to remove the
relief from
blue - decals

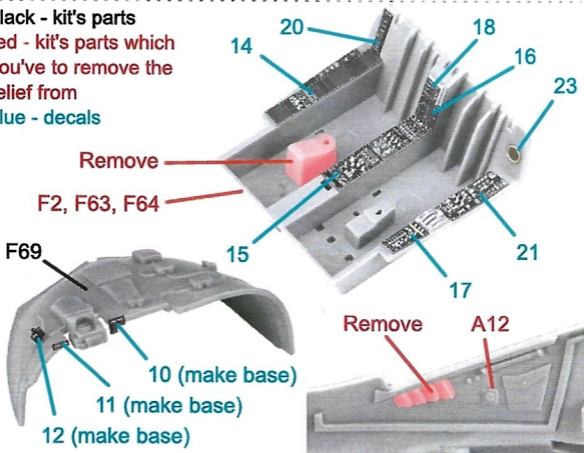

* optional, refer to your sources

If your basis for conversion is A-6E or A-6E TRAM kit,
then use part L3 as is.

In the case of A-6A kit use part H1 and make two
small corners as shown.

A (pilot) or B (B/N)

