

MENG

GERMAN

德國Panzerhaubitze 2000自行榴彈炮 內含50件零件

Panzerhaubitze 2000

SELF-PROPELLED HOWITZER w/ADD-ON ARMOR



1/35
SCALE



1

REAR WHEEL ASSEMBLY
 1. ATTACH REAR WHEEL TO REAR AXLE

REAR WHEEL ASSEMBLY
 1. ATTACH REAR WHEEL TO REAR AXLE

STEP 1
 ATTACH REAR WHEEL TO REAR AXLE



STEP 2
 ATTACH REAR WHEEL TO REAR AXLE



STEP 3
 ATTACH REAR WHEEL TO REAR AXLE



REAR WHEEL ASSEMBLY
 1. ATTACH REAR WHEEL TO REAR AXLE

2

REAR WHEEL ASSEMBLY
 1. ATTACH REAR WHEEL TO REAR AXLE

STEP 1
 ATTACH REAR WHEEL TO REAR AXLE



REAR WHEEL ASSEMBLY
 1. ATTACH REAR WHEEL TO REAR AXLE

3

REAR WHEEL ASSEMBLY
 1. ATTACH REAR WHEEL TO REAR AXLE



STEP 1
 ATTACH REAR WHEEL TO REAR AXLE

4

4000
STRUKTUR
 Struktur zusammenbauen
 (siehe auch Seite 1)

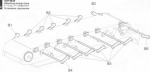
**5**

4000
STRUKTUR
 Struktur zusammenbauen
 (siehe auch Seite 1)

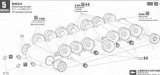
**6**

4000
STRUKTUR
 Struktur zusammenbauen
 (siehe auch Seite 1)

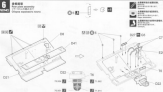

7

BEWEISST
BEWEISST
BEWEISST

**8**

BEWEISST
BEWEISST
BEWEISST

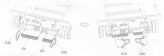
**9**

BEWEISST
BEWEISST
BEWEISST

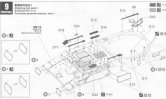

10

Сборка
Сборка двигателя
Сборка двигателя (продолжение)

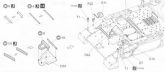
**11**

Сборка
Сборка двигателя
Сборка двигателя (продолжение)

**12**

Сборка
Сборка двигателя
Сборка двигателя (продолжение)



13**BRACKET
INSTALLATION**

1. Remove the top cover and the bottom cover.

**A****B****WARNING**

CAUTION
Do not touch the sharp edges of the covers.

STEP 1**STEP 2****STEP 3****STEP 4****14****BRACKET
INSTALLATION**

1. Remove the top cover and the bottom cover.



WARNING
Do not touch the sharp edges of the covers.

15

15. 将履带张紧器
安装在履带张紧器
座上。



16

16. 将履带张紧器
安装在履带张紧器
座上。



17. 将履带张紧器
安装在履带张紧器
座上。



17

17.01
 17.01.01
 17.01.02

17.01
 17.01.01
 17.01.02

17.01
 17.01.01
 17.01.02

**17.01****17.01****18**

18.01
 18.01.01
 18.01.02



19

将前盖盖到前壳上，并拧紧前盖上的所有螺钉。

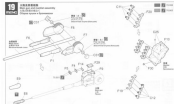

20

将前壳盖到前盖板上，并拧紧前壳上的所有螺钉。

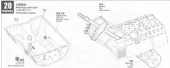

21

将前壳盖到前壳板上，并拧紧前壳上的所有螺钉。

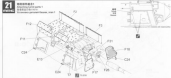

22

REAR PANEL:
 Attach back panel to
 front panel.
 (See page 10 for
 front panel assembly.)



23

REAR PANEL:
 Attach back panel to
 front panel.
 (See page 10 for
 front panel assembly.)

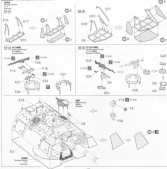

24

1066935
1066936
1066937
1066938
1066939
1066940
1066941
1066942
1066943
1066944
1066945
1066946
1066947
1066948
1066949
1066950
1066951
1066952
1066953
1066954
1066955
1066956
1066957
1066958
1066959
1066960
1066961
1066962
1066963
1066964
1066965
1066966
1066967
1066968
1066969
1066970
1066971
1066972
1066973
1066974
1066975
1066976
1066977
1066978
1066979
1066980
1066981
1066982
1066983
1066984
1066985
1066986
1066987
1066988
1066989
1066990
1066991
1066992
1066993
1066994
1066995
1066996
1066997
1066998
1066999



25

1066989
1066990
1066991
1066992
1066993
1066994
1066995
1066996
1066997
1066998
1066999



01 Photo 01



02 Photo 02



03 Photo



04 Photo



05 Photo



06 Photo



07 Photo



08 Photo



09 Photo



10 Photo



11 Photo



12 Photo



13 Photo



14 Photo



15 Photo



16 Photo



17 Photo



18 Photo



19 Photo



20 Photo



21 Photo



22 Photo



23 Photo



3.1. ТЕХНИЧЕСКОЕ ОПИСАНИЕ ТЕХНИЧЕСКИХ СРЕДСТВ ОБОРОНЫ

3.1.1. Техническое описание танка Leopard 2 (Германия, Франция, Италия, Великобритания, США)

3.1.1.1. Техническое описание танка Leopard 2 (Германия, Франция, Италия, Великобритания, США)

3.1.1.1.1. Техническое описание танка Leopard 2 (Германия, Франция, Италия, Великобритания, США)

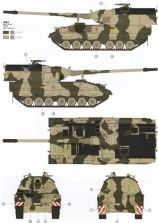

3.2. МАНЕВРЕН ТАНК ТИПА Т-72С3 (СН)

1990-1992, 1993, 1994, 1995, 1996, 1997, 1998, 1999, 2000, 2001, 2002, 2003, 2004, 2005, 2006, 2007, 2008, 2009, 2010, 2011, 2012, 2013, 2014, 2015, 2016, 2017, 2018, 2019, 2020, 2021, 2022, 2023, 2024, 2025

1990-1992, 1993, 1994, 1995, 1996, 1997, 1998, 1999, 2000, 2001, 2002, 2003, 2004, 2005, 2006, 2007, 2008, 2009, 2010, 2011, 2012, 2013, 2014, 2015, 2016, 2017, 2018, 2019, 2020, 2021, 2022, 2023, 2024, 2025



3.3. МАНЕВРЕН ТАНК ТИПА Т-72С3 (СН)

1990-1992, 1993, 1994, 1995, 1996, 1997, 1998, 1999, 2000, 2001, 2002, 2003, 2004, 2005, 2006, 2007, 2008, 2009, 2010, 2011, 2012, 2013, 2014, 2015, 2016, 2017, 2018, 2019, 2020, 2021, 2022, 2023, 2024, 2025

1990-1992, 1993, 1994, 1995, 1996, 1997, 1998, 1999, 2000, 2001, 2002, 2003, 2004, 2005, 2006, 2007, 2008, 2009, 2010, 2011, 2012, 2013, 2014, 2015, 2016, 2017, 2018, 2019, 2020, 2021, 2022, 2023, 2024, 2025

1990-1992, 1993, 1994, 1995, 1996, 1997, 1998, 1999, 2000, 2001, 2002, 2003, 2004, 2005, 2006, 2007, 2008, 2009, 2010, 2011, 2012, 2013, 2014, 2015, 2016, 2017, 2018, 2019, 2020, 2021, 2022, 2023, 2024, 2025





K) M1 Abrams (M1 Abrams) (M1 Abrams)

Top View: [https://www.ford.com/asset-library-agencies/404](#)

Front View: [https://www.ford.com/asset-library-agencies/404](#)

Rear View: [https://www.ford.com/asset-library-agencies/404](#)





Свойства
Color properties
of the
T-72 tank armor



0000	General Day	0.400000	Generalized night	0.0000	0000
0000	Front view	000000	Generalized sunset	0.0000	0000
0000	Track clamp	000000	Generalized atmosphere	0.0000	0000
0000	Track end	000000	Track component	0.0000	0000
000	Gun	0.000000	Gunport	0.0000	0000
000	Track	0.0000	Trackport	0.0000	0000
000	Wheel	0.0000	Wheel	0.0000	0000
0000	Gun	0.000000	Generalized	0.0000	0000
0000	Track	0.0000	Gun	0.0000	0000
000	Gun	0.0000	General	0.0000	0000
0000	Gunlight gun	0.00000000	General	0.0000	0000
0000	General Day	0.40000000	General	0.0000	0000
000	General	0.4000000000	General	0.0000	0000
000	Gun	0.0000	General	0.0000	0000
0000	Generalized	0.00000000	Generalized night	0.0000	0000
0000	Generalized	0.00000000	General night	0.0000	0000