

# mpc

AN MPC PRODUCT OF **Fundimensions**

DIVISION OF GENERAL MILLS FUN GROUP, INC.,  
MOUNT CLEMENS, MICHIGAN 48043

ASSEMBLY NUMBERS **2**

PART NUMBERS **20**

CLEAR PARTS **1**

DO NOT CEMENT 

CEMENT 

## PLEASE READ THIS FIRST

Before you begin, read the instructions very carefully. Study the illustrations and become familiar with the pieces before you start assembly of your model. Following the procedures given, test fit all parts before cementing, this way you will become acquainted with the location of parts when it comes time to use cement.

The highest quality styrene goes into the making of each MPC model. Only paint and cement made for styrene should be used. Before test fitting parts, trim off excess "flash". To join parts, use cement sparingly. Apply cement to very small parts with a toothpick. For removing parts from the "runners" it is best to use your modelers knife, do not attempt to twist them off.

It is best to paint the very small parts while they are still on the runners. For realism use flat colors and use them carefully. You should have no trouble assembling your kit if the instructions are followed properly.

© FUNDIMENSIONS Div. of General Mills Fun Group, Inc. 1976

# C130 HERCULES

0552



## HISTORY

The R.A.F.'s Hercules is one of the latest versions (C-130 K) of the famous American C-130 transport now in use throughout the world. The first Hercules prototype flew in August 1954 and delivery of production aircraft to the U.S.A.F. began in 1956. Since this time there has been continual development and versions have been produced with more powerful engines and increased range. Special variants are in use for aerial survey, satellite recovery, search and rescue, flight refuelling and even as the AC-130 Gunship for combat in Vietnam. In all some thousand C-130s have been produced and they currently equip over a dozen Air Forces. In R.A.F. service the Hercules has replaced the Hastings and Beverley as the standard medium range tactical transport and 66 have been delivered and are serving with five squadrons of Air Support Command. The Hercules is capable of carrying out a wide range of transport missions from long range trooping flights with 92 troops to the air dropping of 64 paratroops. The capacious fuselage can carry twenty tons of freight and can accept a wide variety of military vehicles and equipment. With a take-off and landing run of under 300 yards the C-130 can operate from the most primitive air strips and has even flown on and off the U.S. carrier 'Forrestal'. Powered by four 4,910-s.h.p. Allison turboprop engines, the Hercules, C.Mk.1 has a maximum speed of 385 m.p.h. and normal cruising speed of 340 m.p.h. Range with maximum payload is 2,430 miles but with maximum fuel and reduced load this is extended to 4,780 miles. Wing span is 132 ft. 7 ins. and length 99 ft. 6 ins.

**1** Paint all three crew figures as shown (use flat colors).

Helmet \_\_\_\_\_ WHITE  
Face \_\_\_\_\_ FLESH  
Suit \_\_\_\_\_ DARK BLUE  
Boots \_\_\_\_\_ BLACK  
Goggles \_\_\_\_\_ GREEN  
Hands \_\_\_\_\_ FLESH



# 2

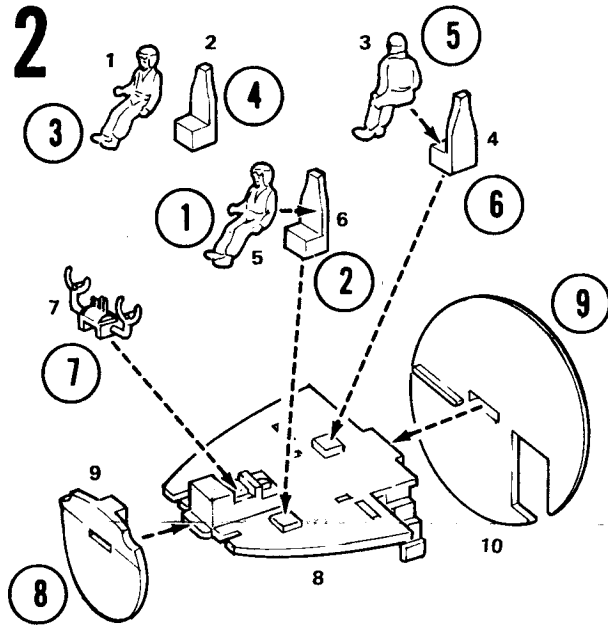

# 3

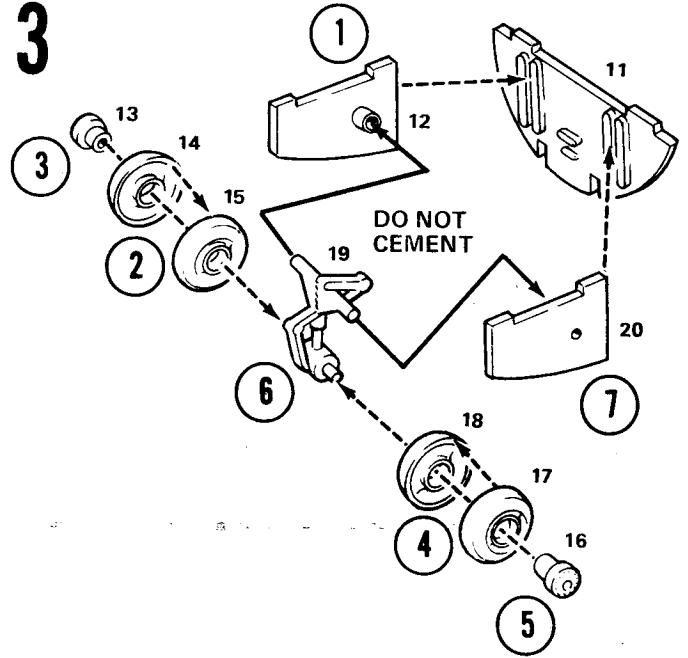

# 4

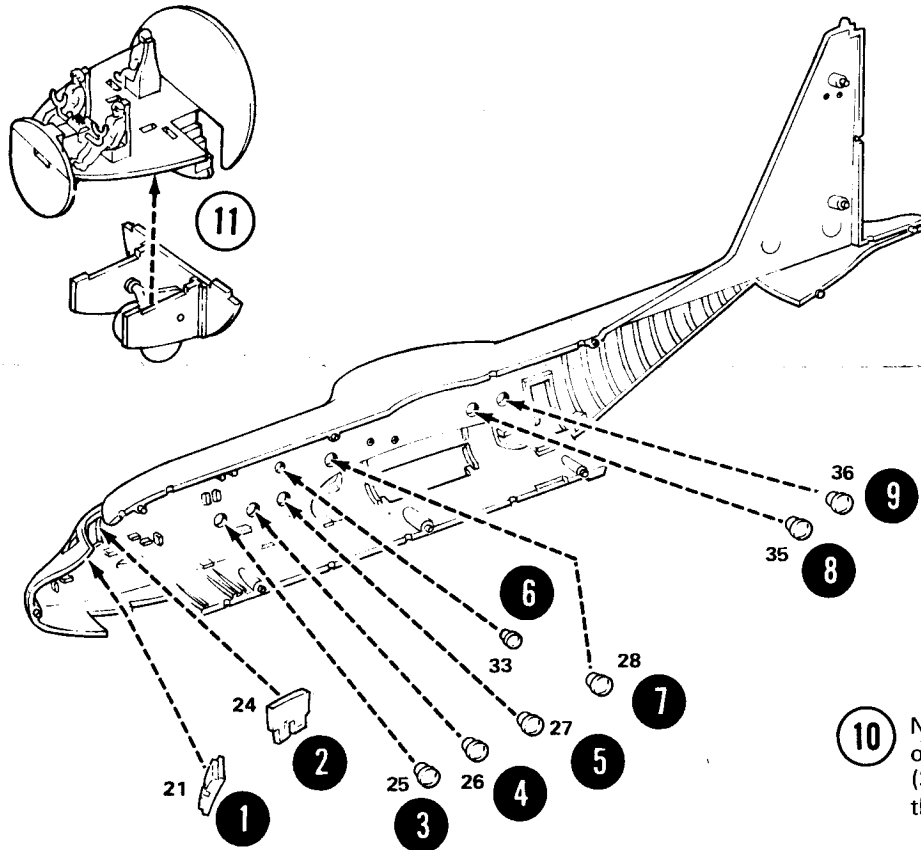

**10** NOTE: Repeat 1 thru 9 for other side using clear parts (33 & 34 are smaller than the rest).

# 5

14

Cement fuselage halves together trapping the cockpit floor board, cargo doors, and rudder.  
NOTE: The cargo doors and rudder should move freely.

NOTE: Open flashed holes. Repeat for other side.

DO NOT CEMENT

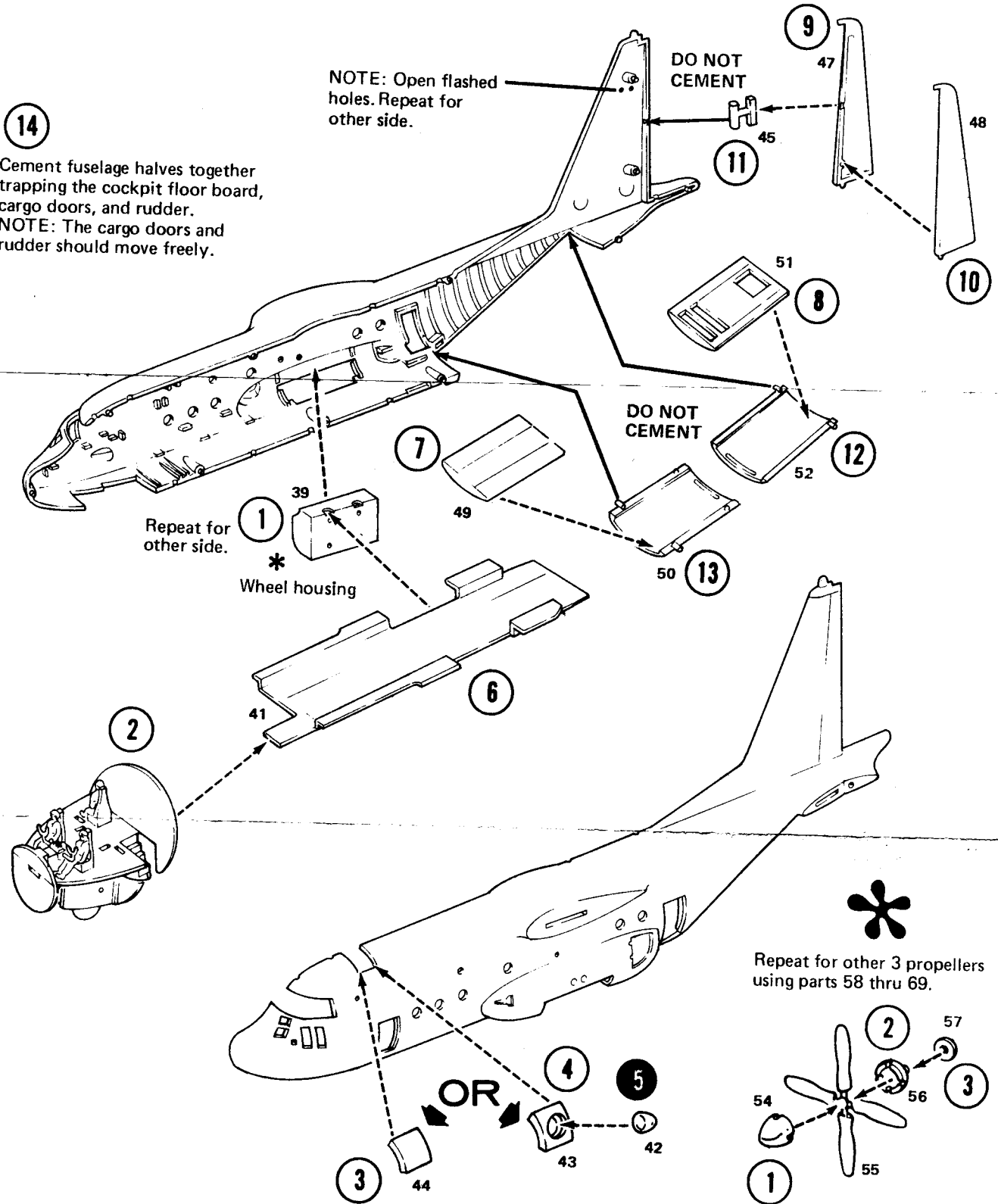

# 6

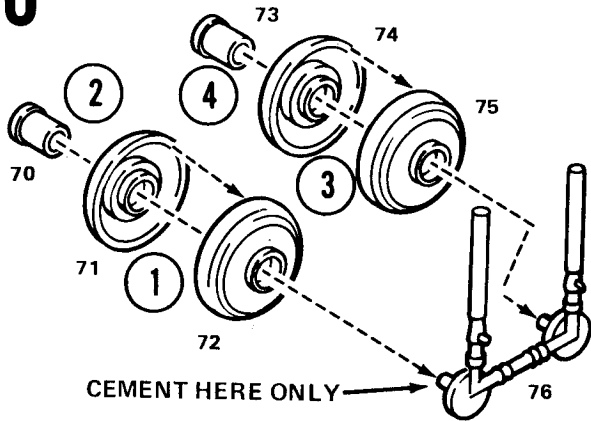

Locate hubs through assembled wheels (DO NOT CEMENT) to pins on landing gear.

# 7

NOTE: Cement square end of hinge only.

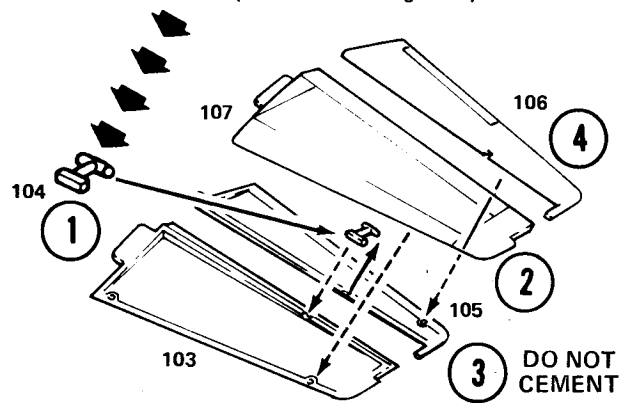

5 Repeat same procedure with other wing assembly.

# 8

NOTE: Undercarriage should be cemented in either raised or lowered position as desired. Parts 84 & 87, 88 & 91 are to be used when landing gear is in the raised position.

# 1

Holes for raised and lowered position are inside wheel housing\* (already installed in fuselage). Holes deepest in the housing are for the raised position, and holes closest to the opening are for the lowered position.

NOTE: If cargo doors are open and loading ramp is used, see detail for assembly (shown right side up.)

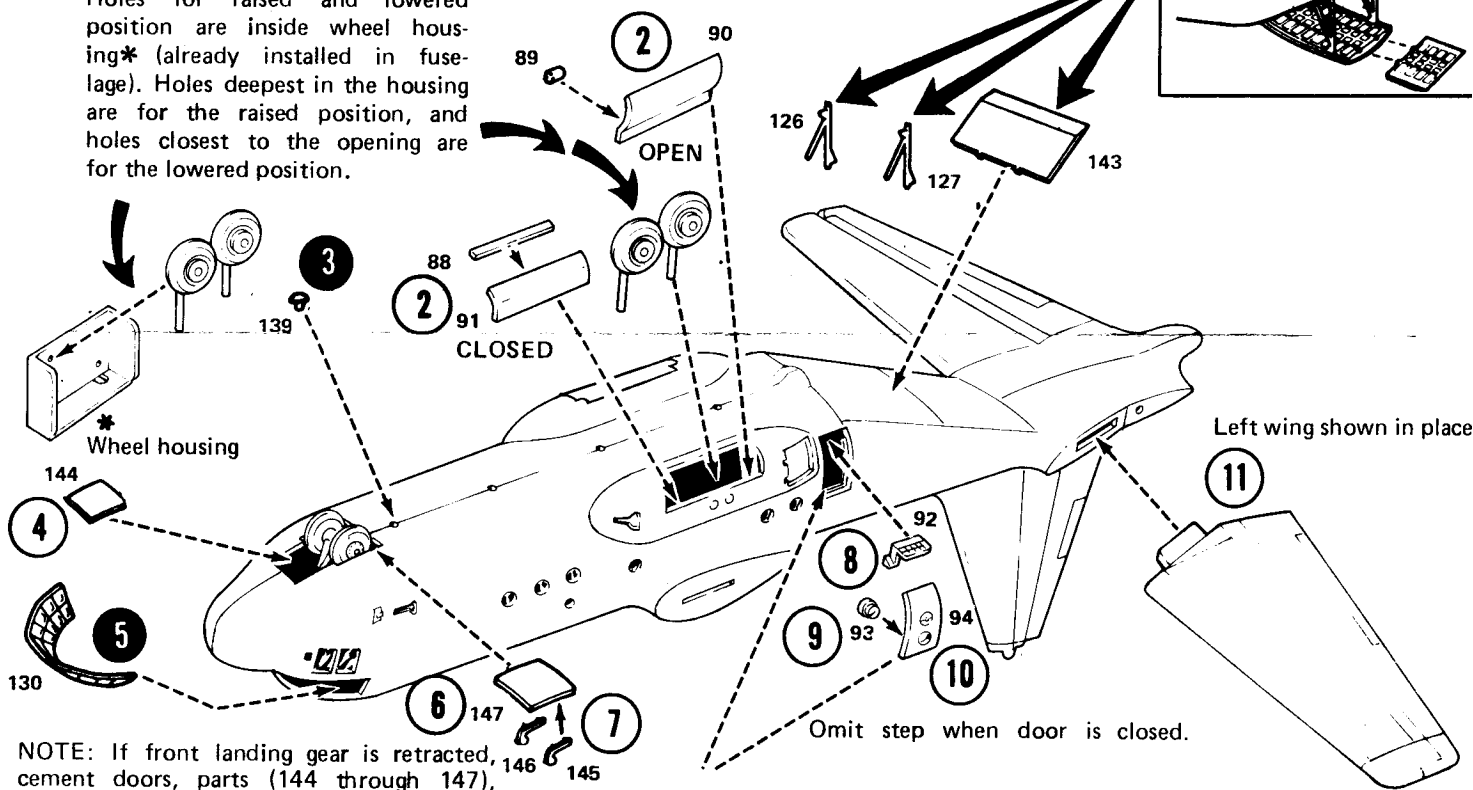

NOTE: If front landing gear is retracted, cement doors, parts (144 through 147), in the closed position.

9

B

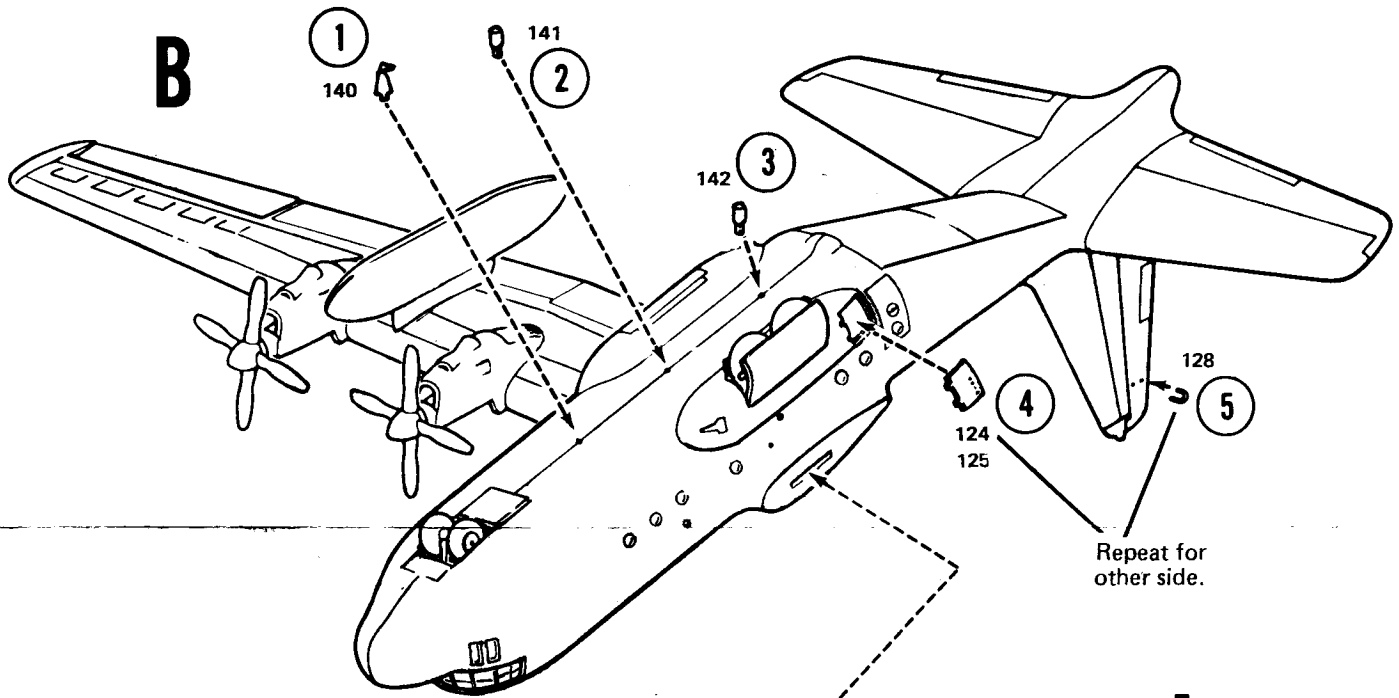

C

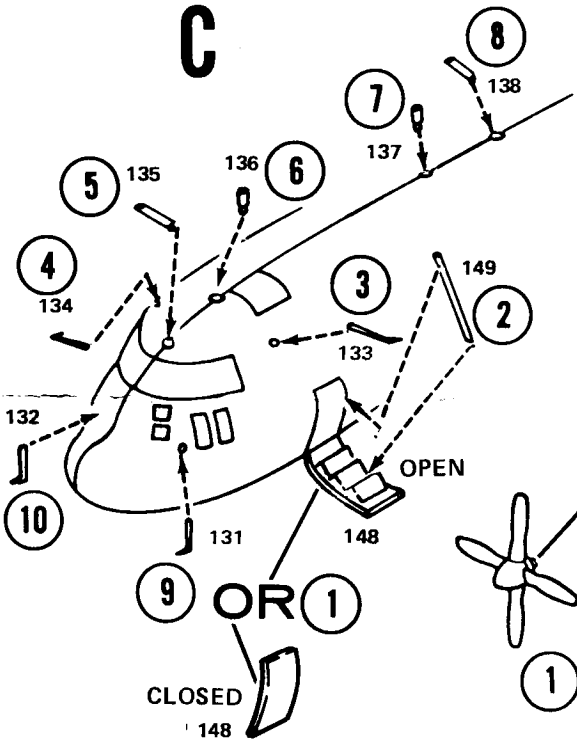

A

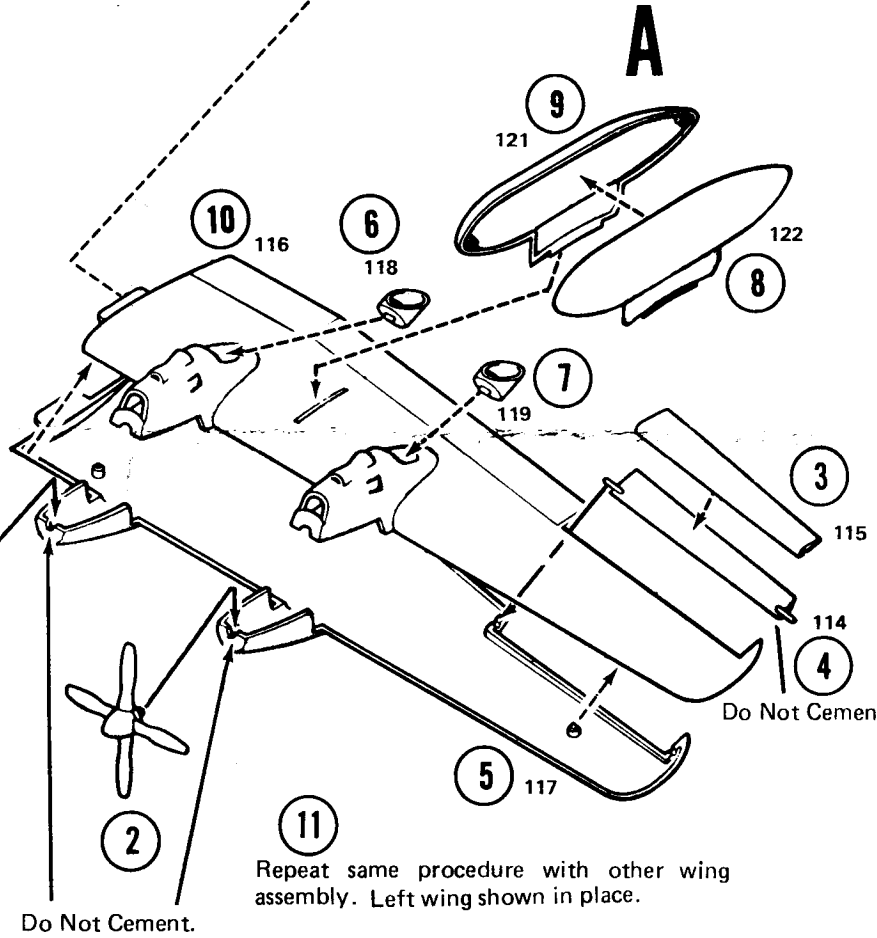

# DECAL PLACEMENT & COLOR SCHEME

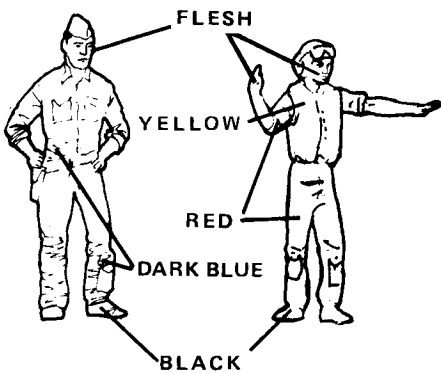
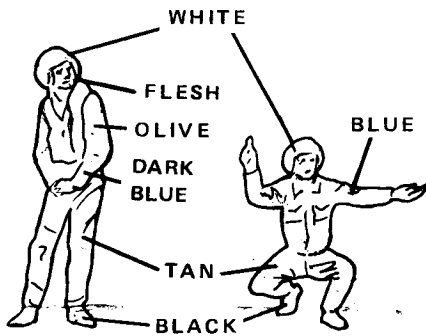
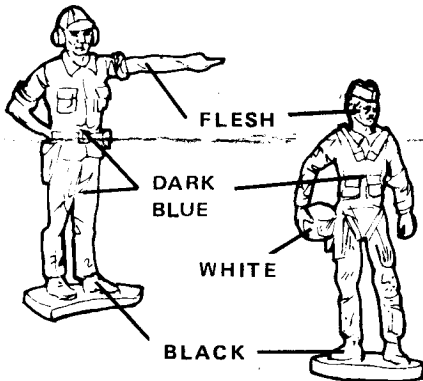
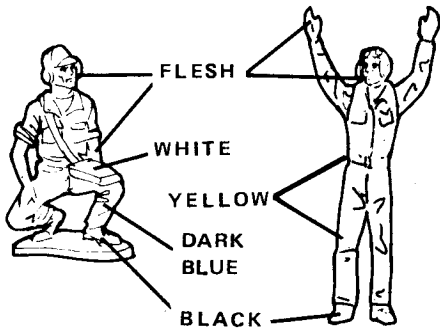

HC-130 PLAN VIEW  
TYPICAL MARKINGS

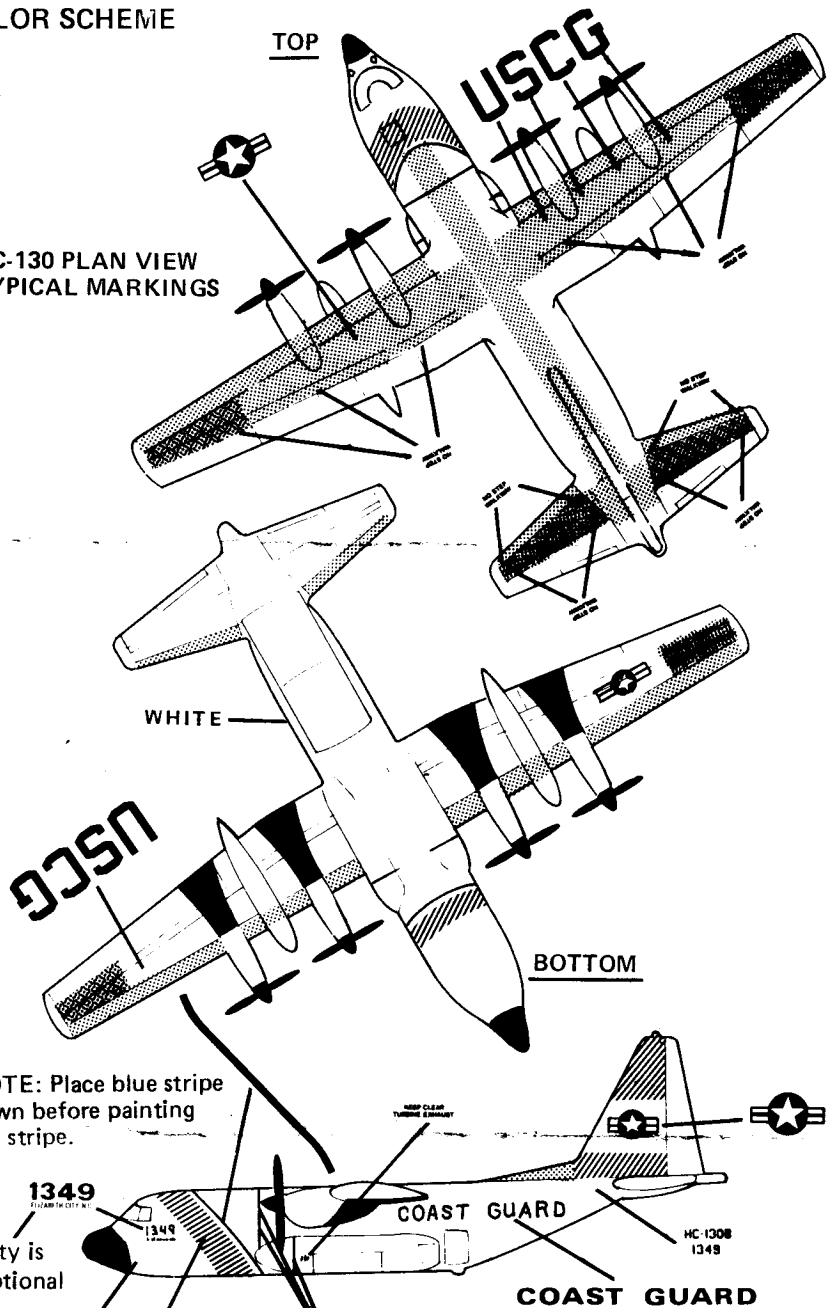

NOTE: Place warning decal over stripe

