



# Canberra PR.9 landing flaps

eduard

72 502

1/72 scale detail set for AIRFIX kit • sada detailů pro model 1/72 AIRFIX

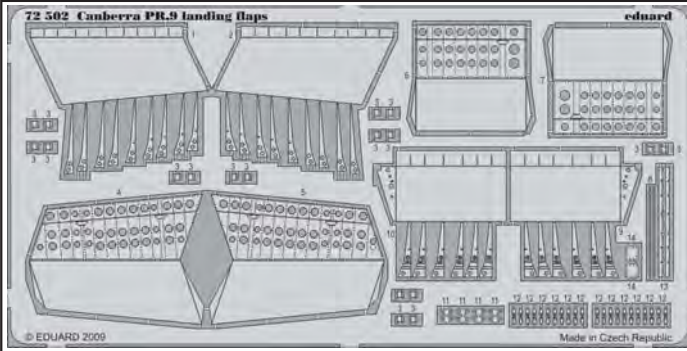

- APPLY EXPRESS MASK AND PAINT BEFORE GLUING  
POUŽIT EXPRESS MASK NABARVIT PŘED SLEPENÍM
- SYMMETRICAL ASSEMBLY  
SYMETRICKÁ MONTÁŽ
- REMOVE  
ODSTRANIT
- GRIND  
OBROUSIT
- DRILL HOLE  
VRTAT OTVOR
- BEND  
OHNOUT
- OPTION  
VOLBA
- REPLACE  
NAHRADIT

■ ORIGINAL KIT PARTS  
PŮVODNÍ DÍLY STAVEBNICE
 ■ PHOTO-ETCHED PARTS  
LEPTANÉ DÍLY
 ■ PARTS TO BE REMOVED  
DÍLY K ODSTRANĚNÍ
 ■ FILL  
TMELIT

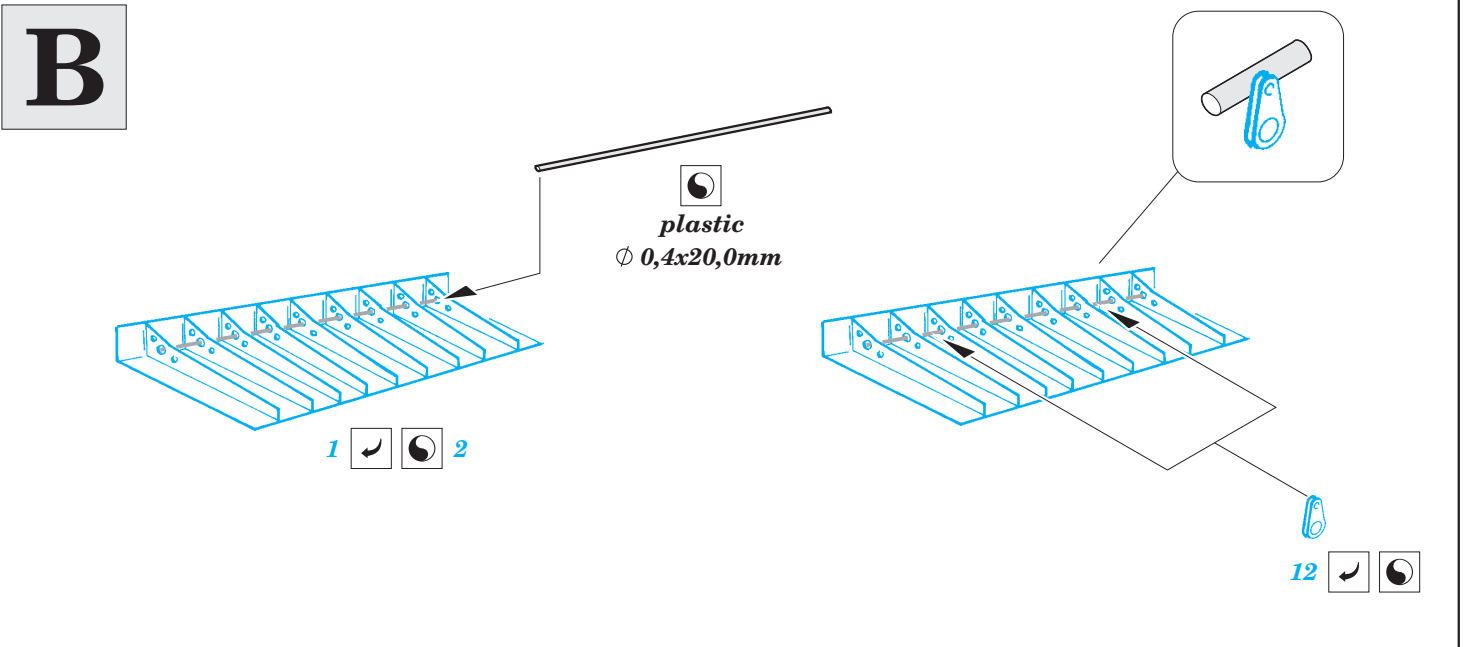
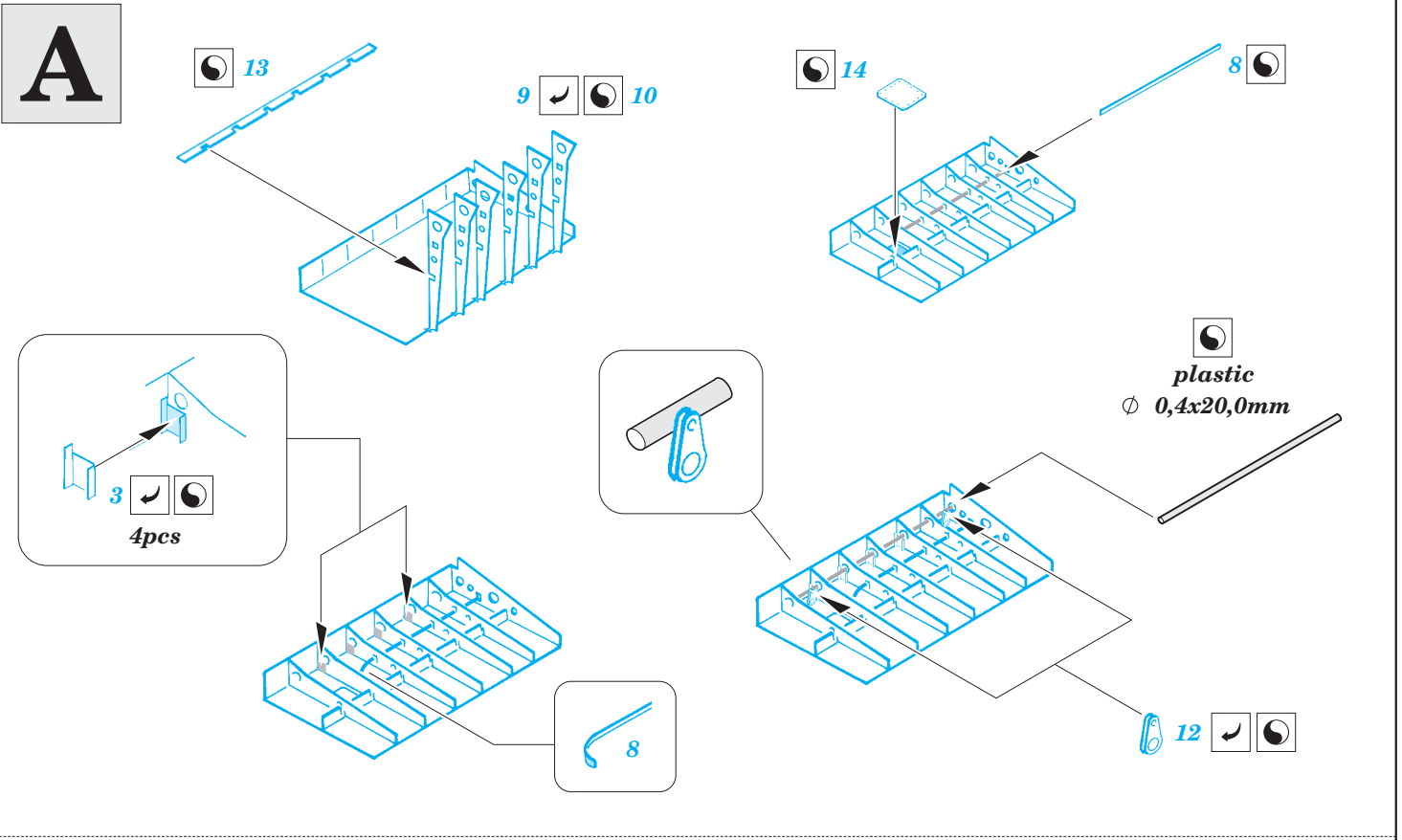

4I ☐ 2I

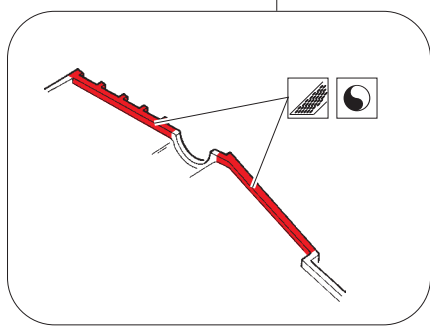
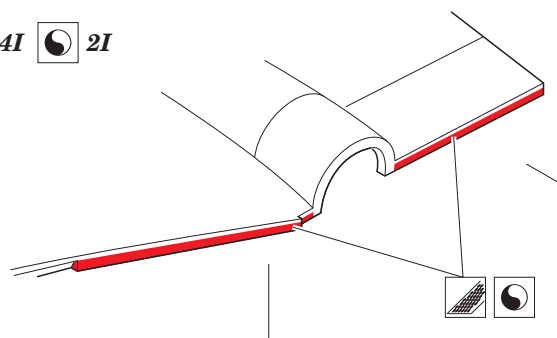

4I ☐ 2I

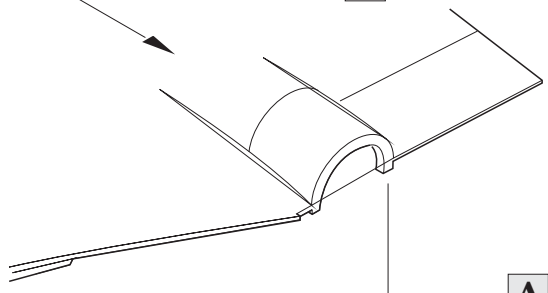

A ☐

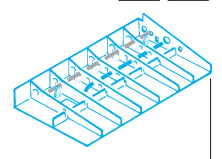

B ☐

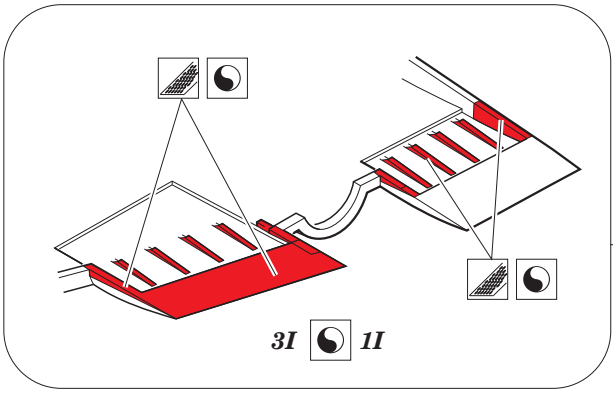
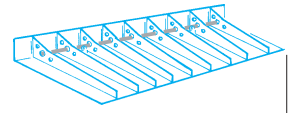

3I ☐ 1I



3I ☐ 1I

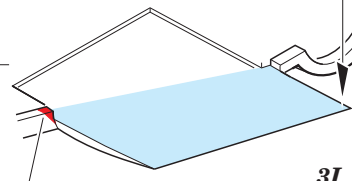

13 ☐ 14

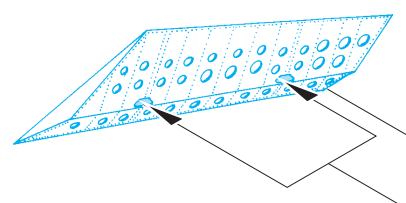

1I ☐

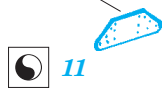

6 ☐ 7

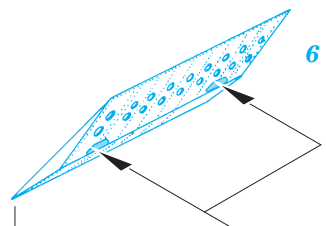

1I ☐

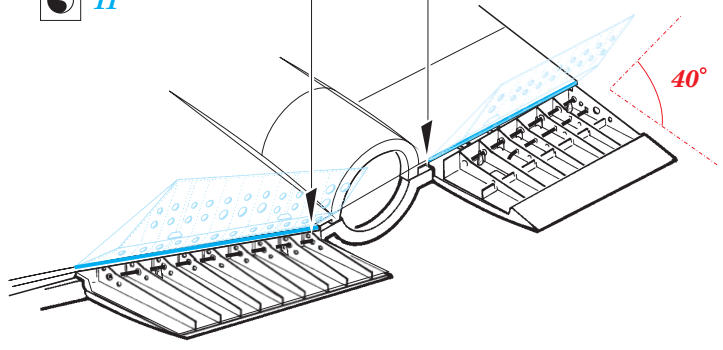

40°