

# Heavy Armoured Car with 7,5 cm gun Sd.Kfz. 234/3

Ciężki samochód pancerny

1/35 scale update fit to Italeri

**ABER**

**35 077**

WWW.ABER.NET.PL

Made in Poland © 2004

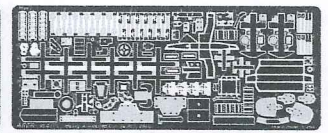
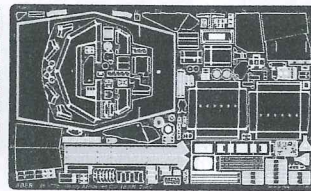
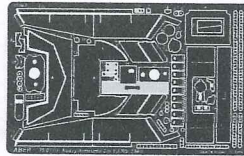

We advise that better method to join metal to metal is soldering. Use ABER soldering solution AF20 (doradzamy łączenie części metalowych za pomocą lutowni. Zastosuj nasz topnik AF20)

**WARNING**

Any unauthorized copying, producing and reproducing of ABER company products, or any part thereof, is strictly prohibited and any such action establishes liability for a civil action and may give rise to criminal prosecution.

**OSTRZEŻENIE**

Jakiegokolwiek kopiowanie, produkowanie i reprodukcja wyrobów firmy ABER bez zezwolenia, w całości lub części jest surowo zabronione. Powyższe działania powodują powstanie odpowiedzialności cywilnej oraz mogą spowodować wszczęcie postępowania karnego.

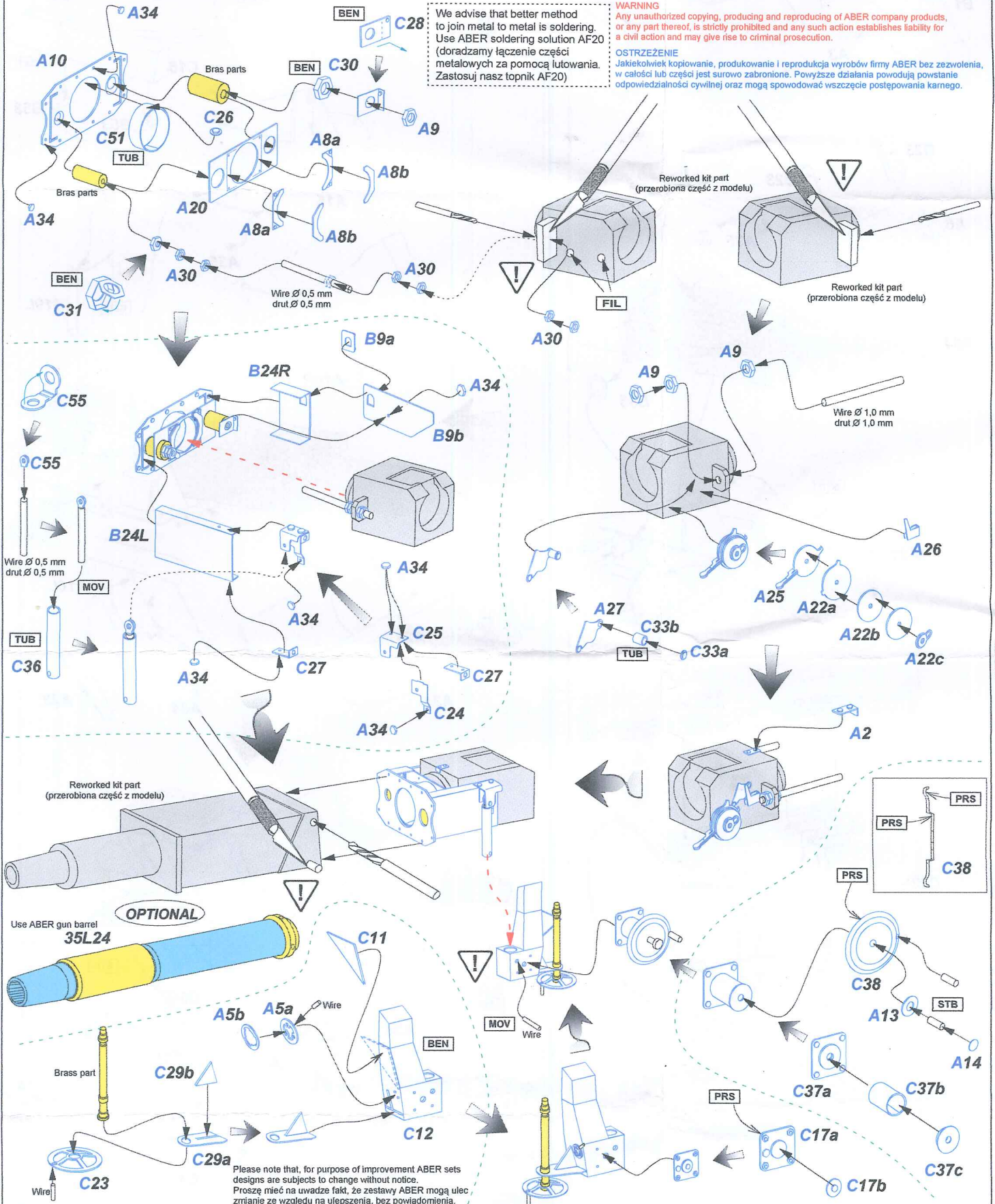

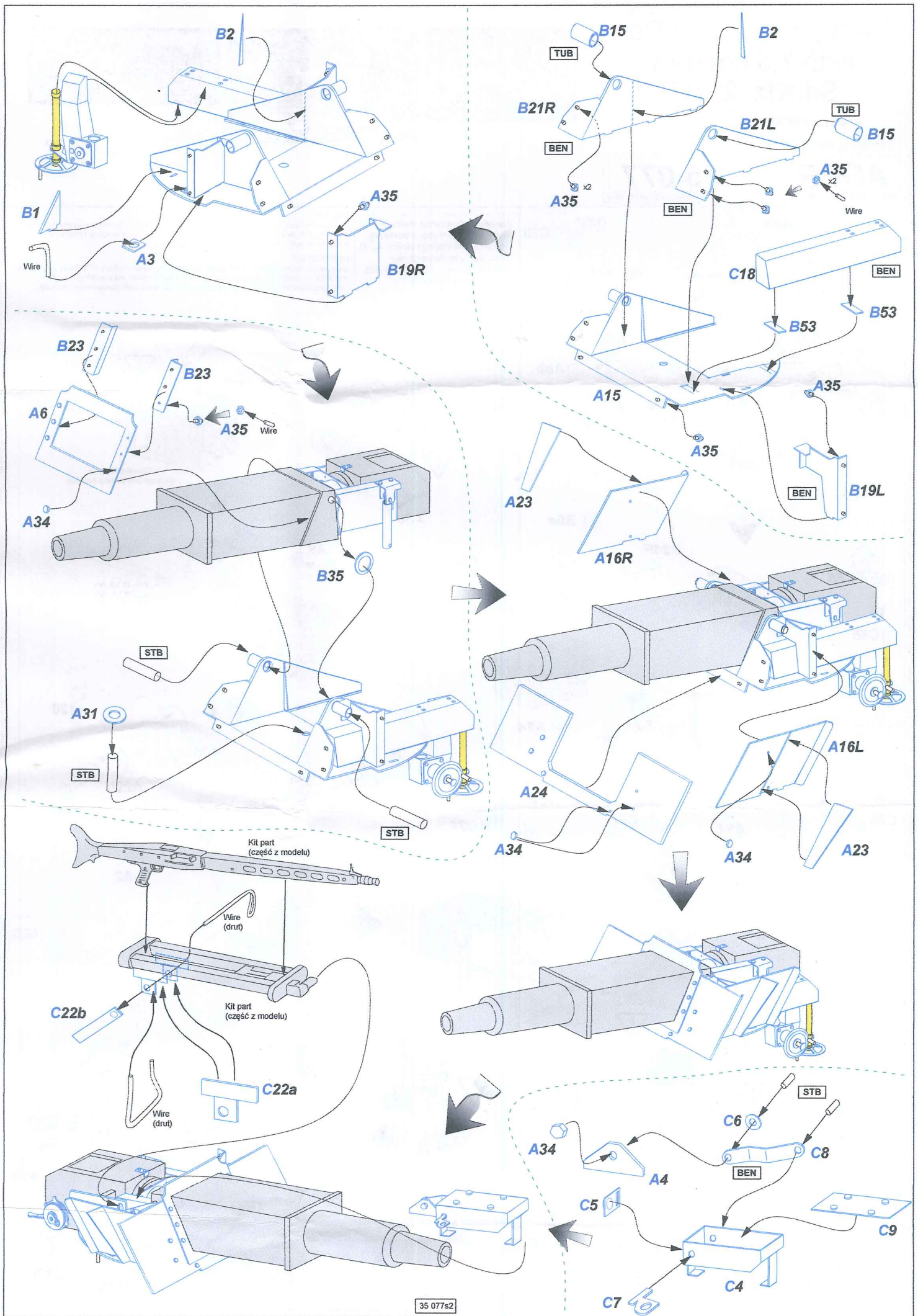

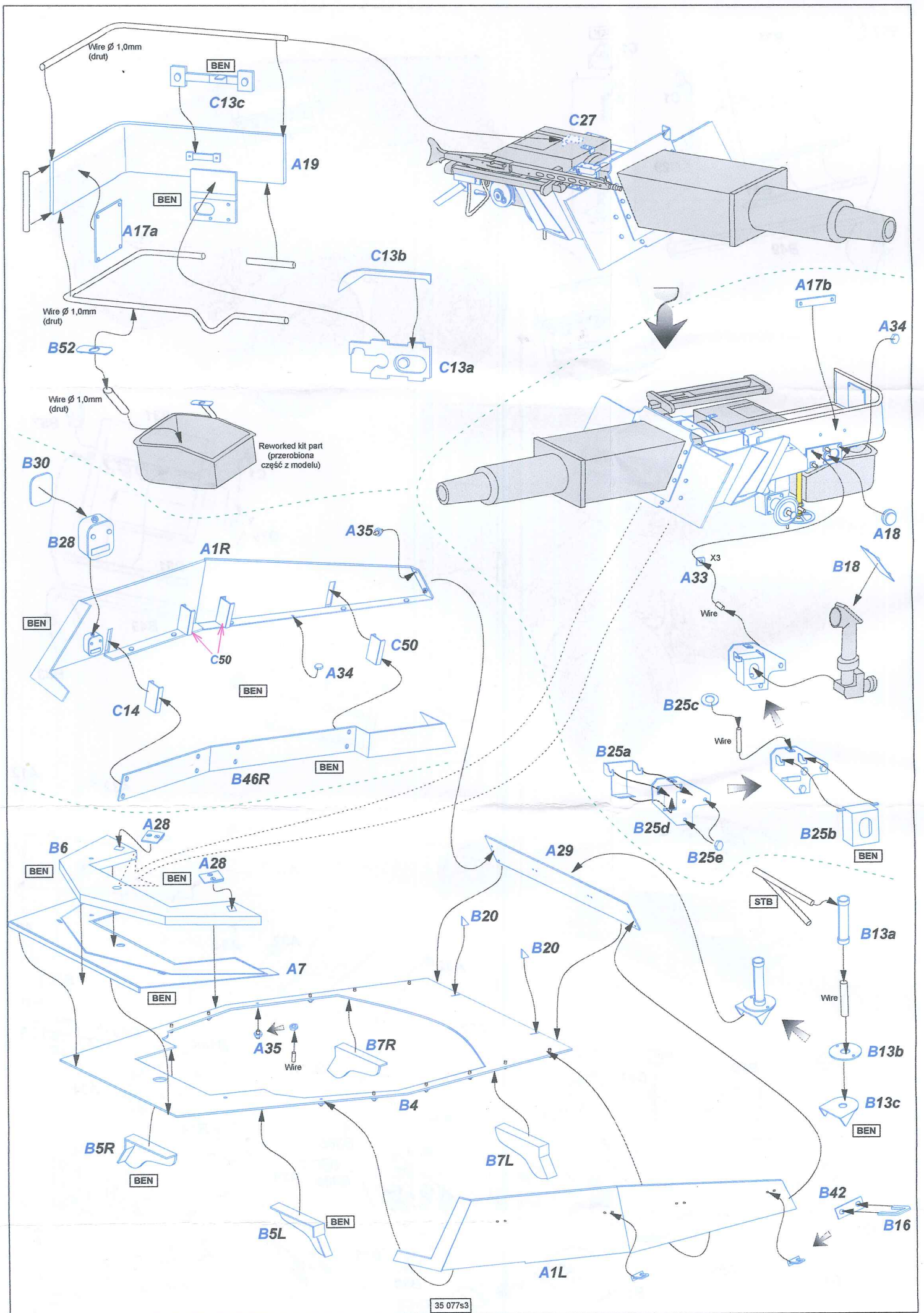

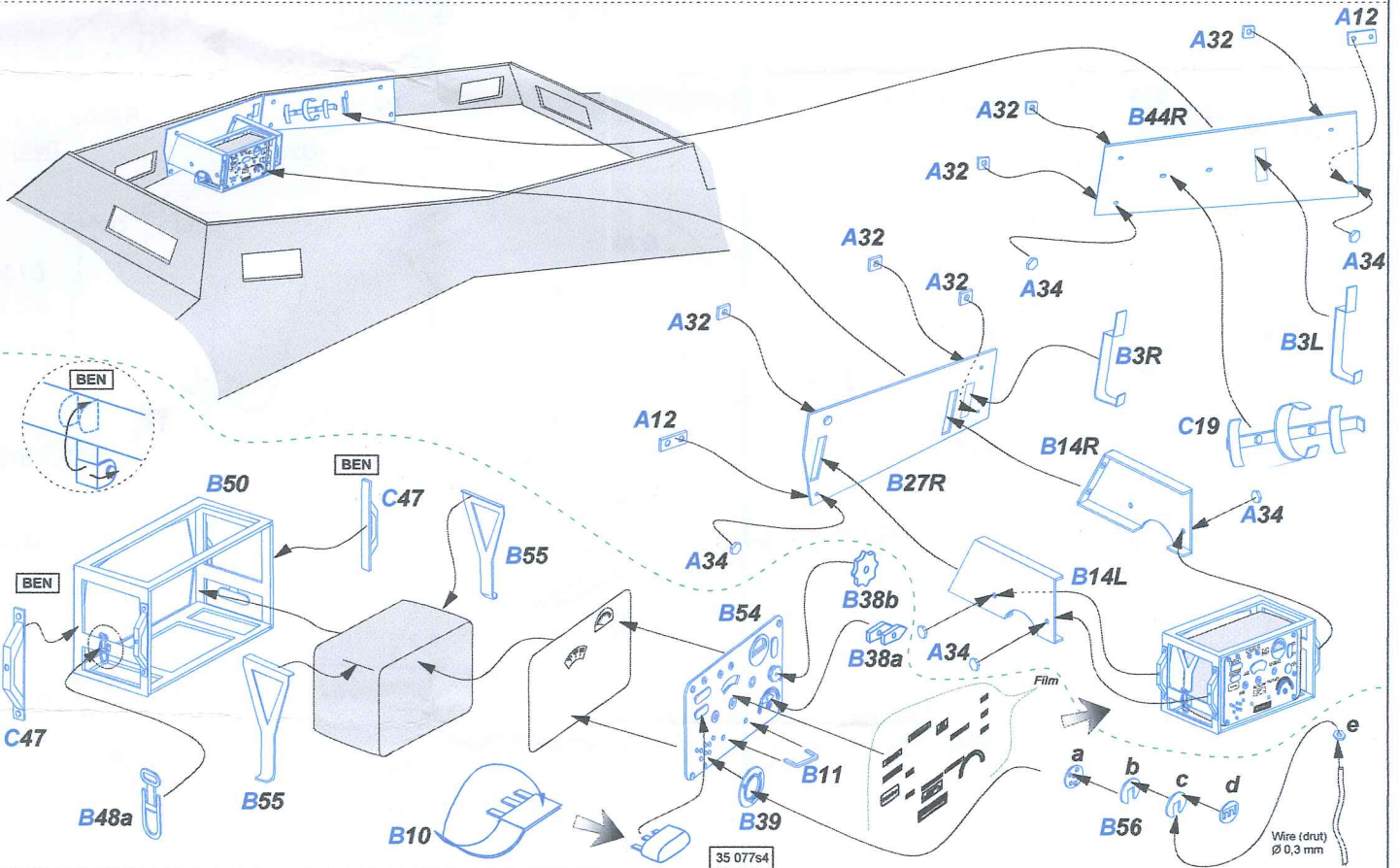
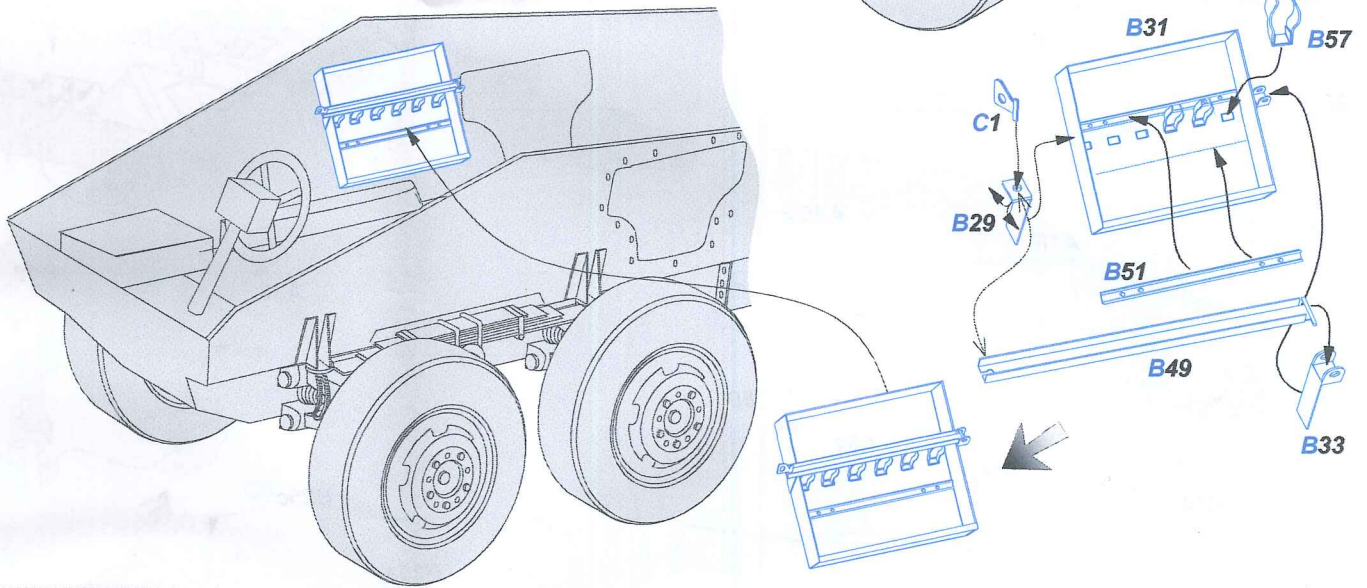
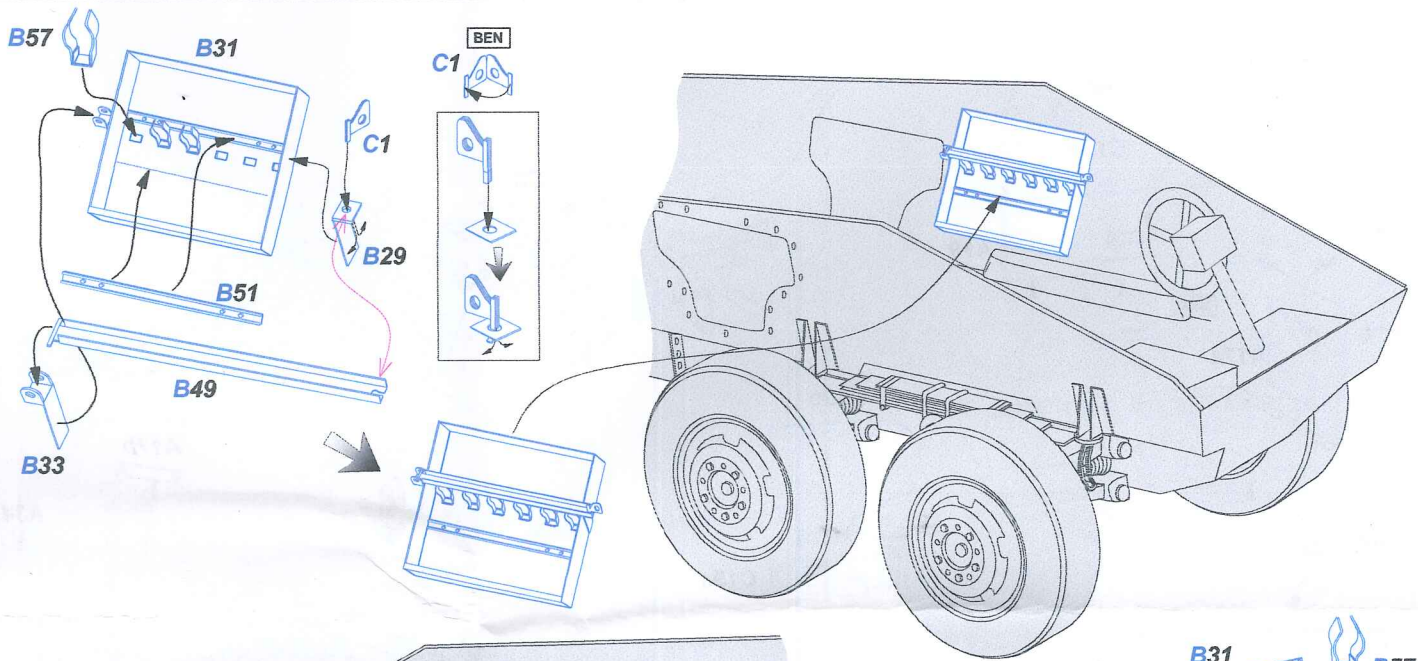

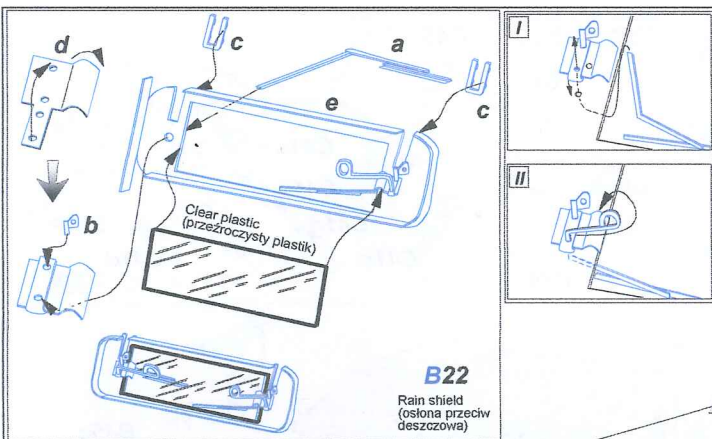

**B22**  
Rain shield  
(osłona przeciw deszczowa)

Separately sold (oddzielnie w sprzedaży):

- 35 A30 Side bin doors for Sd.Kfz.234 (Dźwiczki do bocznych schowków)
- 35 A77 Engine upper deck for Heavy Armoured Car Sd.Kfz. 234 (Górne pokrywy przedziału silnikowego do ciężkiego samochodu pancernego)
- 35 L-24 German 75 mm K 51 L/24 Barrel for Sd.Kfz. 234 (Lufta)
- R-20 German with indicators for Sd.Kfz. 234 (Skrajnia obrysu)

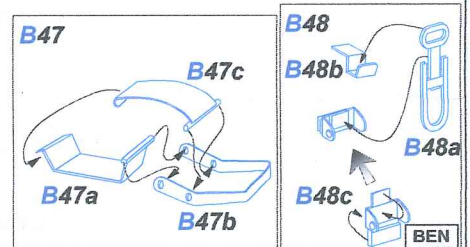
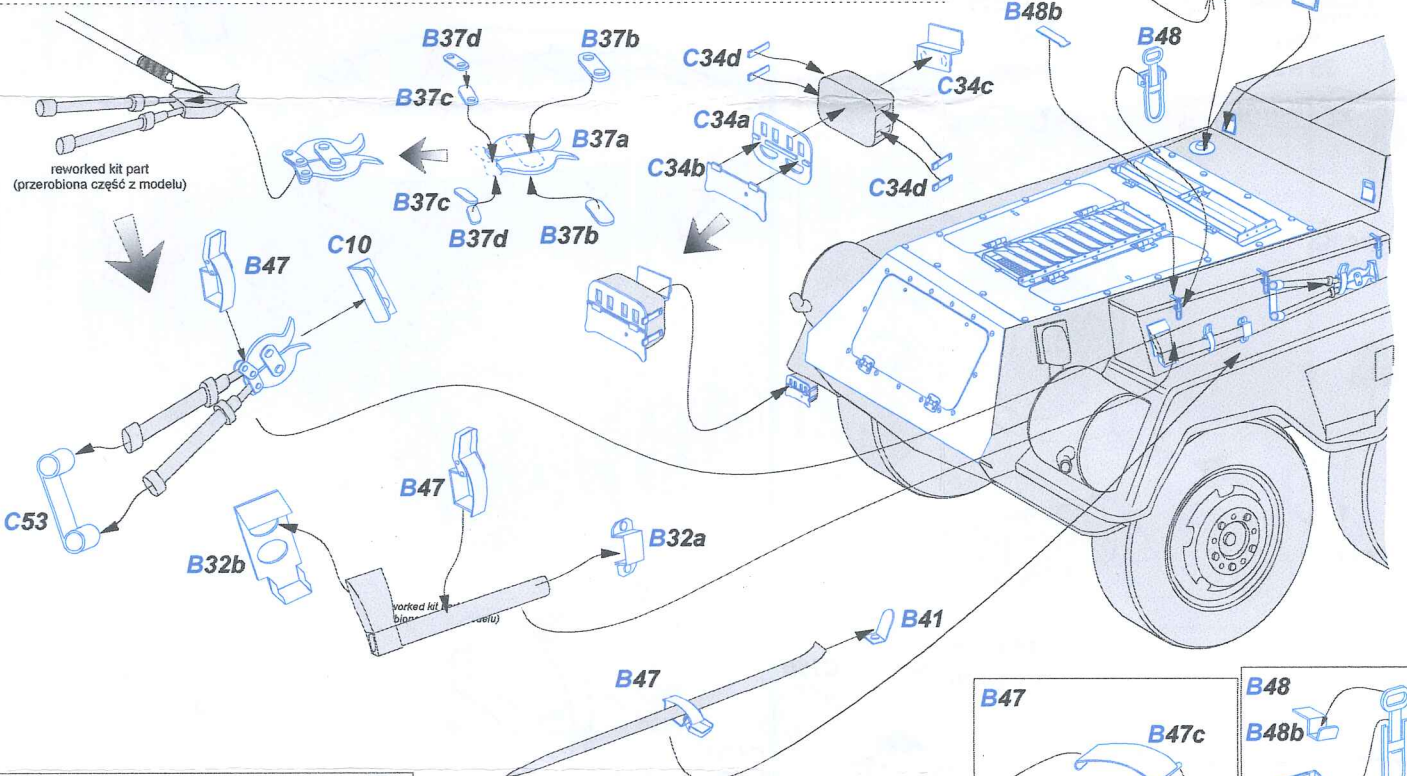
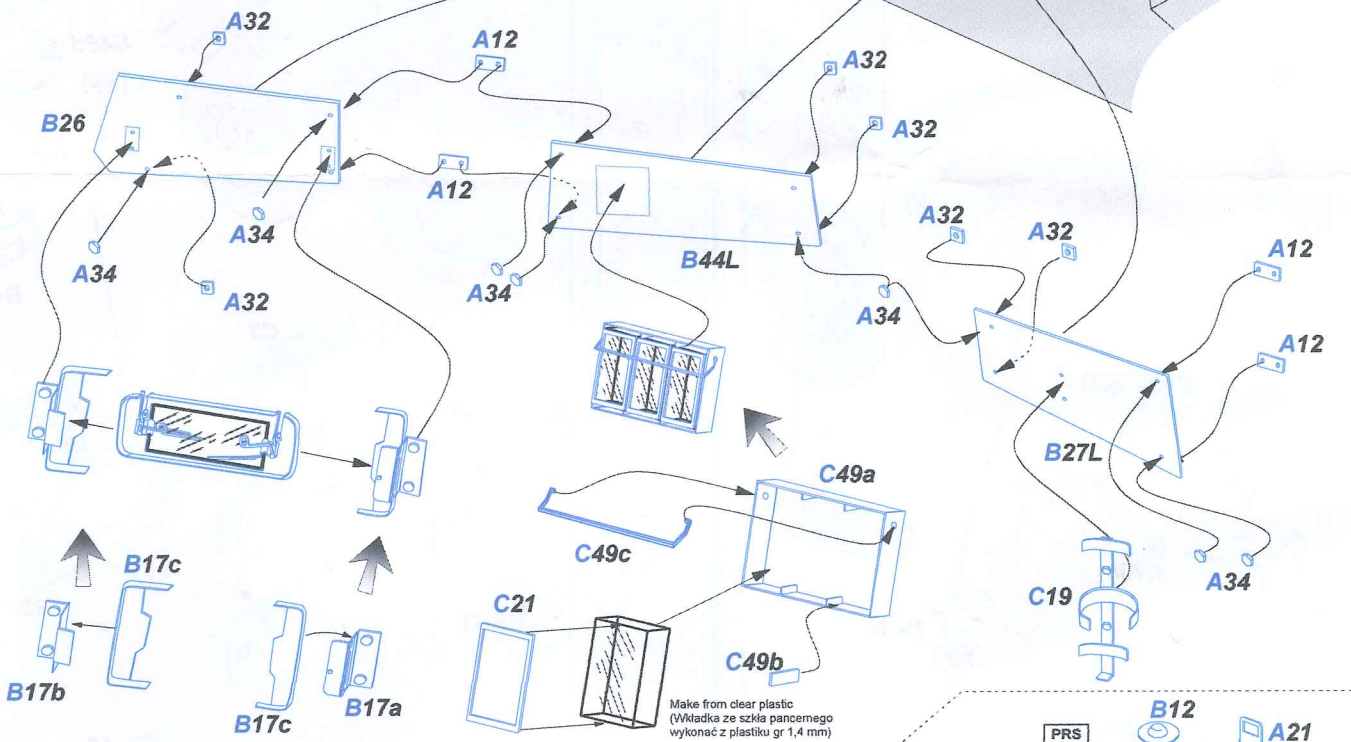
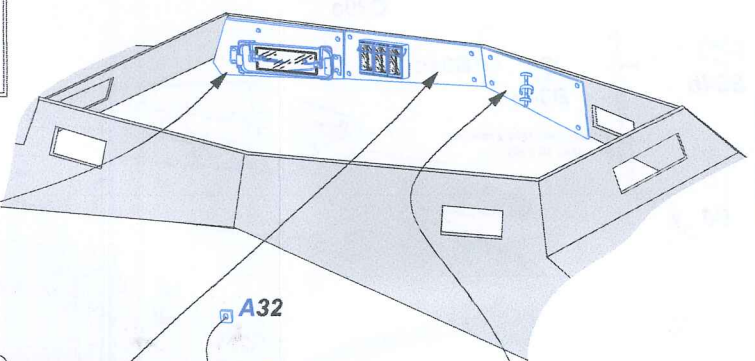

**Bibliography:**  
 1. "Schwerer Panzerspahwagen (Sd.Kfz.234)", MOS No 24, Darlinton Productions Inc., Darlinton 1998  
 2. "German 8-wheeled armored car(2), Ground Power No 074, Delta Publishing, Tokyo 2000  
 3. "Sd.Kfz.234", Photosniper No 20, Kagero, Lublin 2004  
 4. "Sd.Kfz.234", Armor Photogallery No 4, Progres Publishing House, Warszawa 2003

