

1/48 SCALE PLASTIC KIT

ProfiPACK
edition

#8103



ATTENTION * UPOZORNĚNÍ * ACHTUNG * ATTENTION * 注意



Carefully read instruction sheet before assembling. When you use glue or paint, do not use near open flame and use in well ventilated room. Keep out of reach of small children. Children must not be allowed to suck any part, or pull vinyl bag over the head.



Před započítím stavby si pečlivě prostudujte stavební návod. Při používání barev a lepidel pracujte v dobře větrané místnosti. Lepidla ani barvy nepoužívejte v blízkosti otevřeného ohně. Model není určen malým dětem, mohlo by dojít k požití drobných dílů.

INSTRUCTION SIGNS * INSTR. SYMBOL * INSTRUKTION SINNBILDEN * SYMBOLES * 記号の説明



OPTIONAL
VOLBA



BEND
OHNOUT



OPEN HOLE
VYVRTAT OTVOR



SYMMETRICAL ASSEMBLY
SYMETRICKÁ MONTÁŽ



REMOVE
ODŘÍZNOUT



REVERSE SIDE
OTOČIT



APPLY EDUARD MASK
AND PAINT
POUŽÍT EDUARD MASK
NABARVIT

PLASTIC PARTS

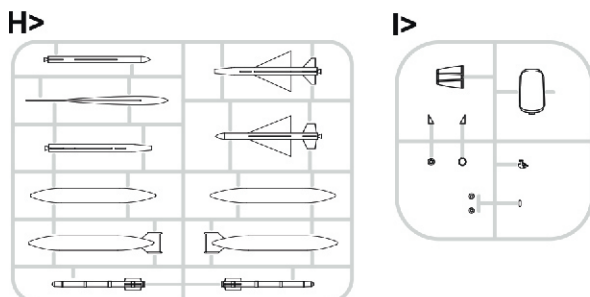
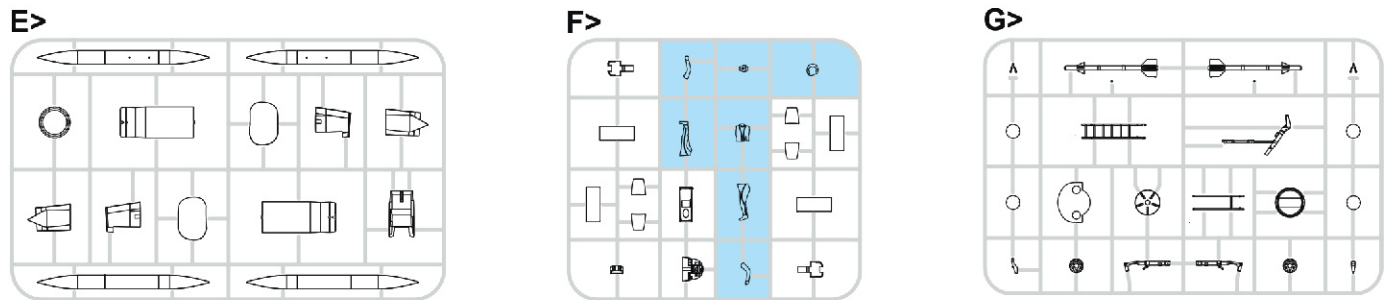
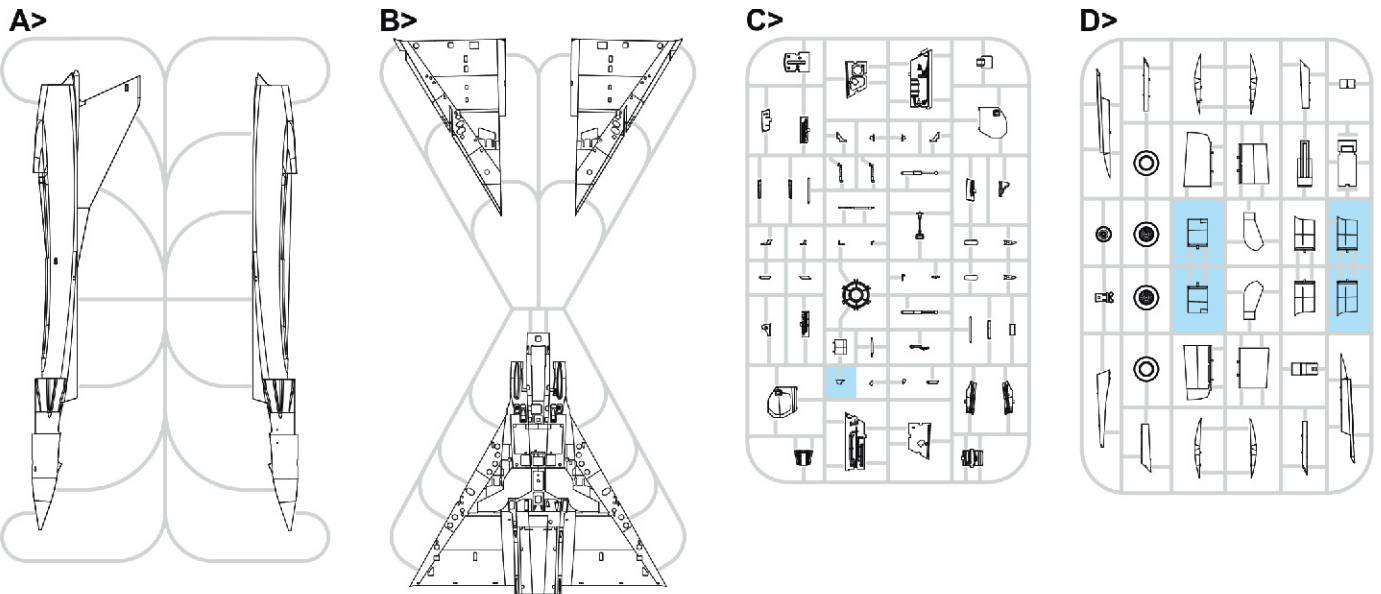
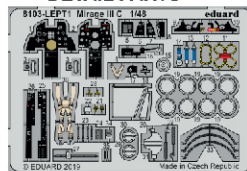
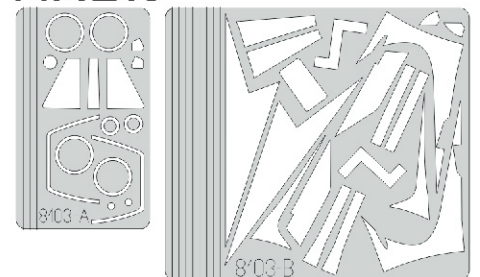
PE - PHOTO ETCHED
DETAIL PARTSeduard
MASK

-Parts not for use. -Teile werden nicht verwendet. -Pièces à ne pas utiliser. -Tyto díly nepoužívejte při stavbě. - 使用しない部品

COLOURS

BARVY

FARBEN

PEINTURE

色

GSI Creos (GUNZE)		MISSION MODELS	
AQUEOUS	Mr.COLOR	PAINTS	
H1	C1	MMP-001	WHITE
H2	C2	MMP-047	BLACK
H4	C4	MMP-007	YELLOW
H8	C8		SILVER
H11	C62	MMP-001	FLAT WHITE
H12	C33	MMP-047	FLAT BLACK
H24	C58		ORANGE YELLOW
H27	C44		TAN
H51	C11	MMP-063	LIGHT GULL GRAY
H52	C12	MMP-091	OLIVE DRAB
H58	C351	MMP-059	INTERIOR GREEN
H67	C115	MMP-057	LIGHT BLUE
H72	C22	MMP-078	DARK EARTH
H77	C137	MMP-040	TIRE BLACK
H79	C39		SANDY YELLOW
H90	C47		CLEAR RED

GSI Creos (GUNZE)		MISSION MODELS	
AQUEOUS	Mr.COLOR	PAINTS	
H93	C50		CLEAR BLUE
H94	C138		CLEAR GREEN
H310	C310	MMP-060	BROWN
H312	C312		GREEN
H313	C313		YELLOW
H314	C314		BLUE
H323	C323		LIGHT BLUE
H330	C361	MMP-077	DARK GREEN
H337	C337		GRAYISH BLUE
	C352		YELLOW CHROMATE
Mr.METAL COLOR		METALLICS	
	MC213	MMM-006	STEEL
	MC214	MMM-001	DARK IRON
	MC218	MMM-003	ALUMINIUM
Mr.COLOR SUPER METALLIC		METALLICS	
	SM01	MMC-001	SUPER CHROME

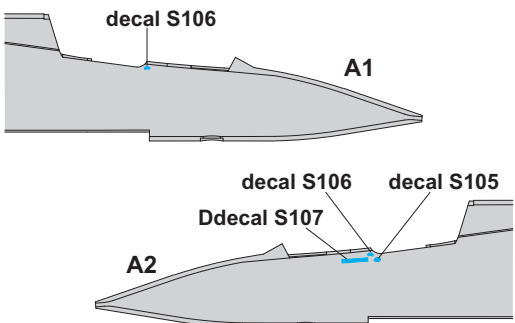
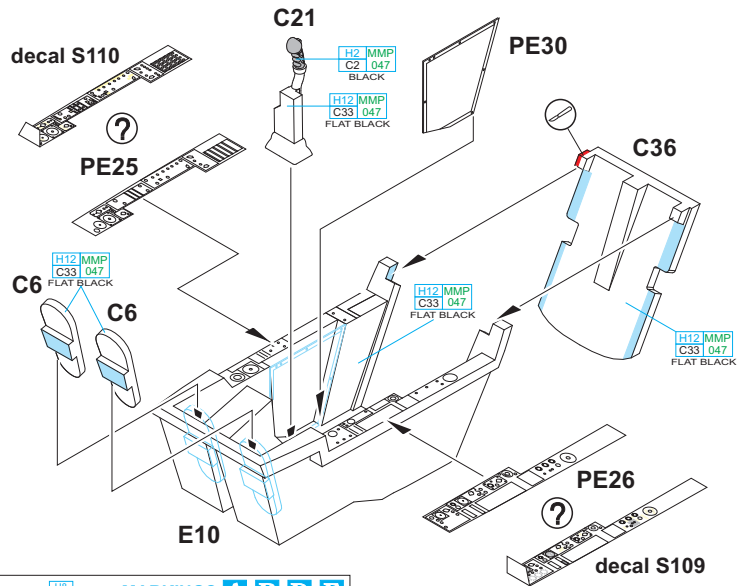
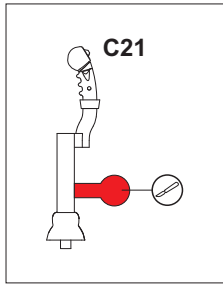
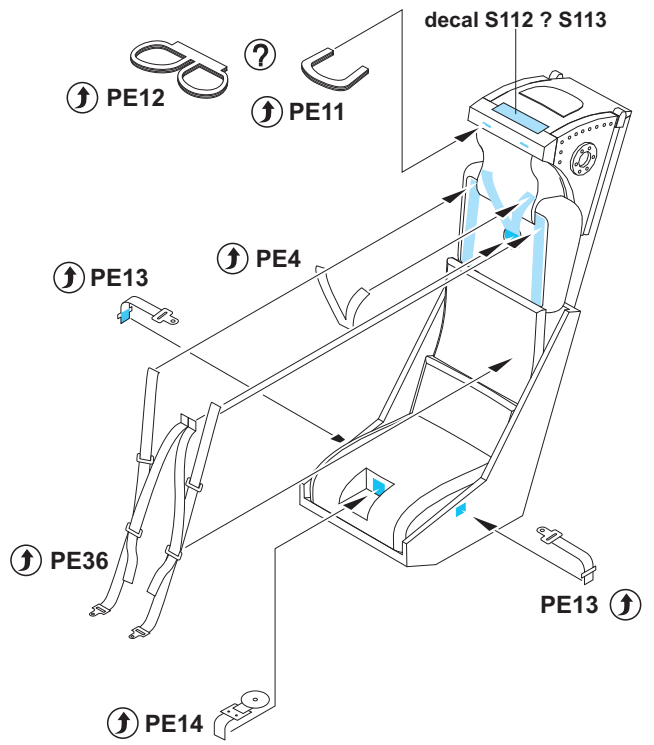
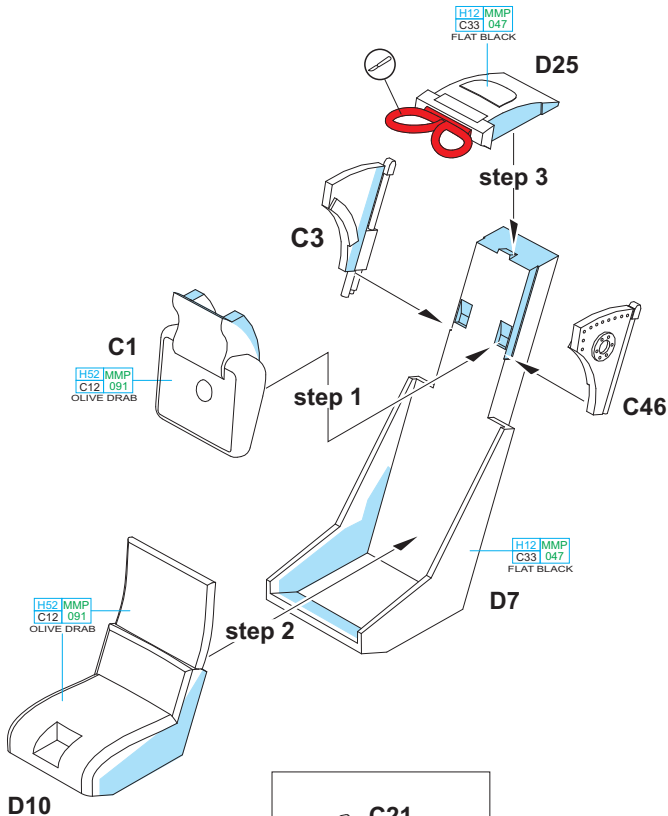

1 =

H20	SILVER
C8	SILVER
H11	MMP C82 001 FLAT WHITE
H12	MMP C33 047 FLAT BLACK

- MARKINGS **A, B, D, E**
- MARKING **C**

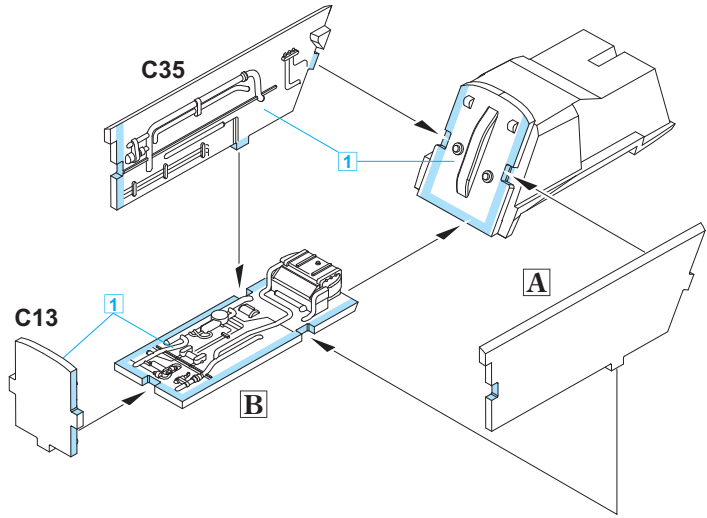
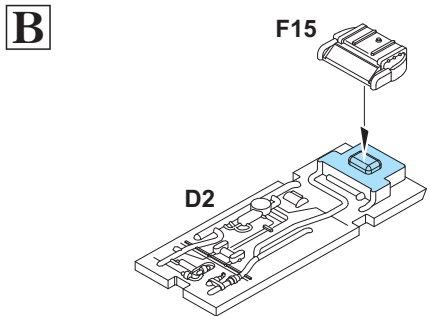
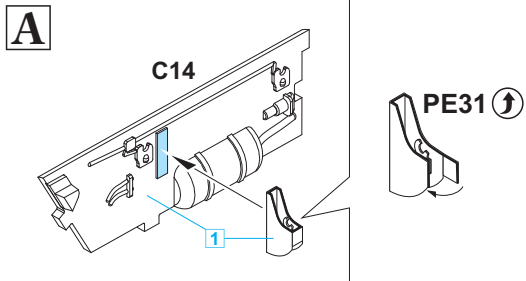

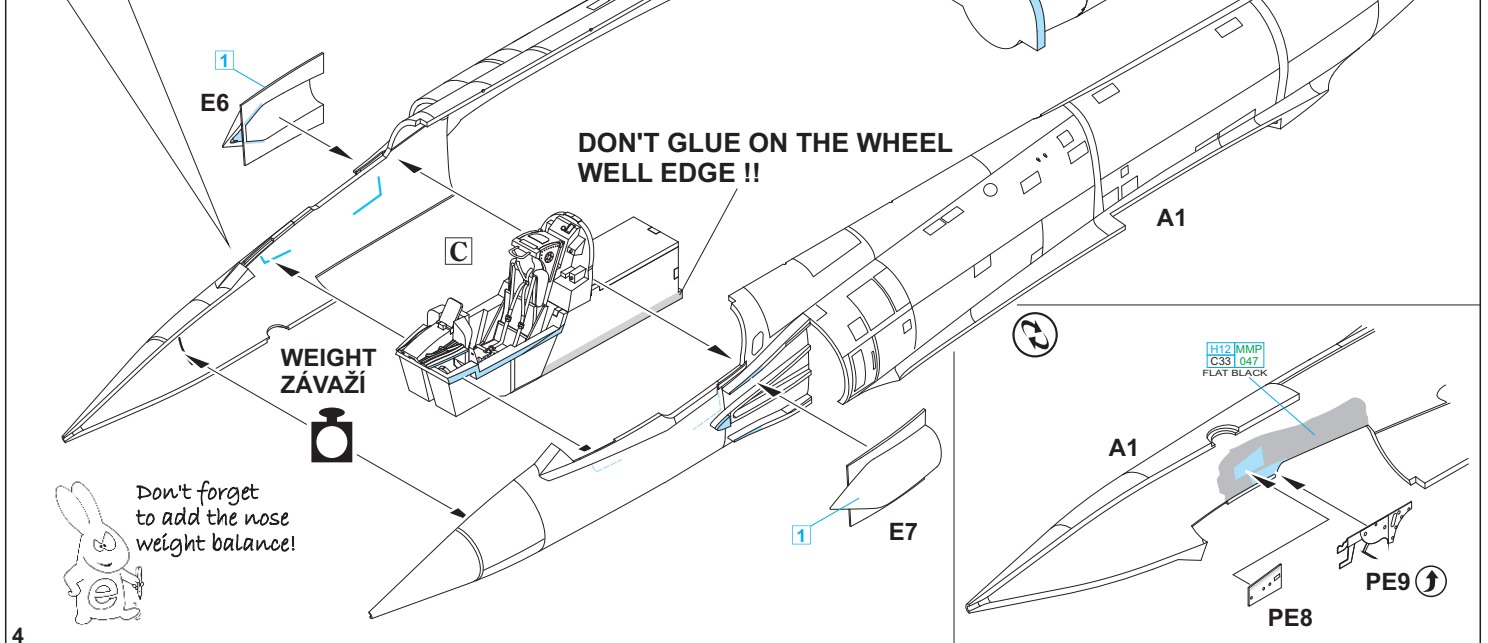
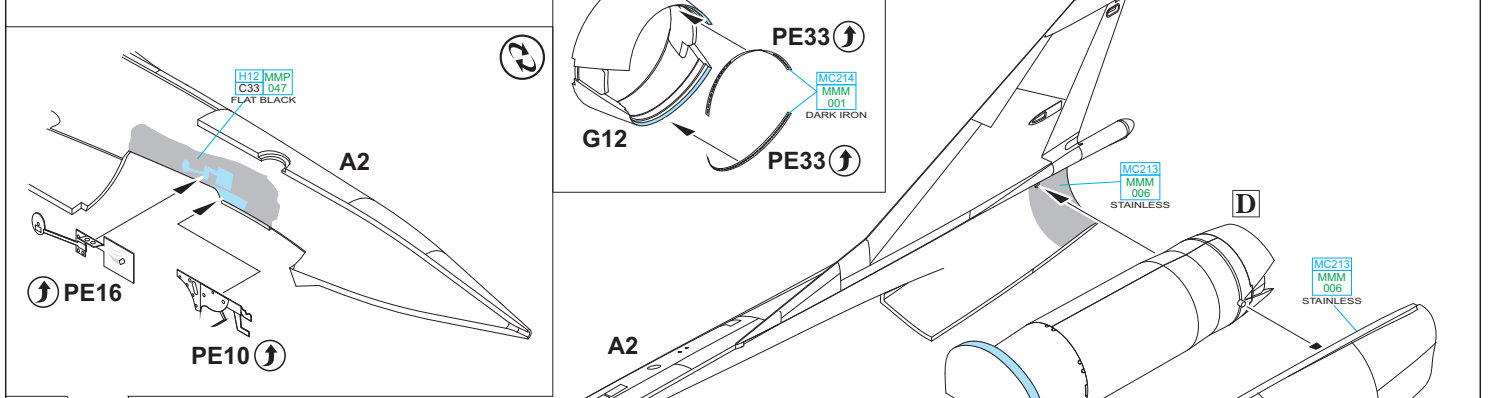
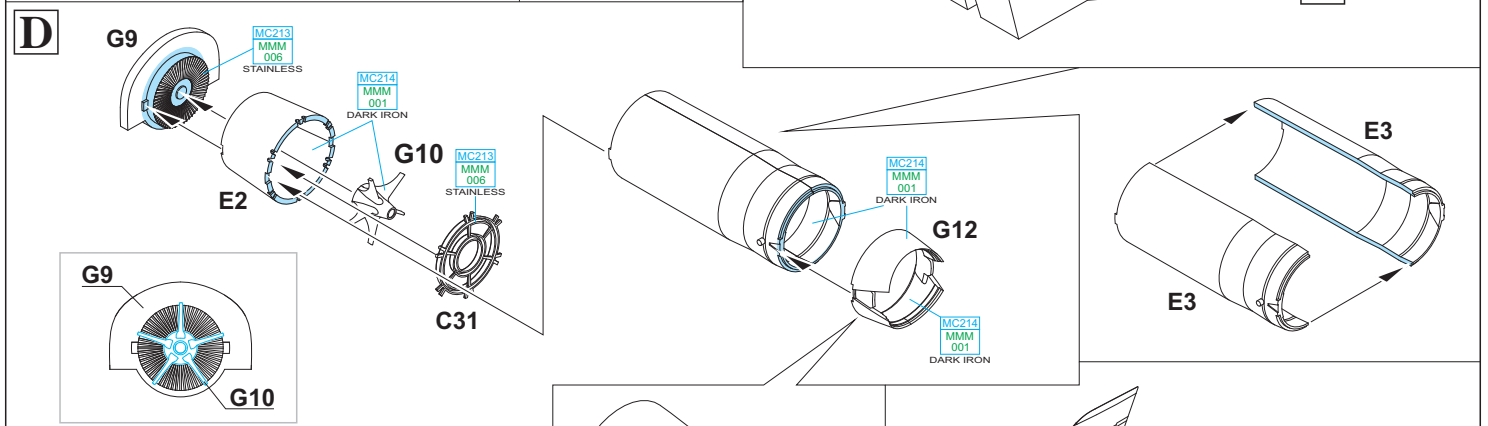
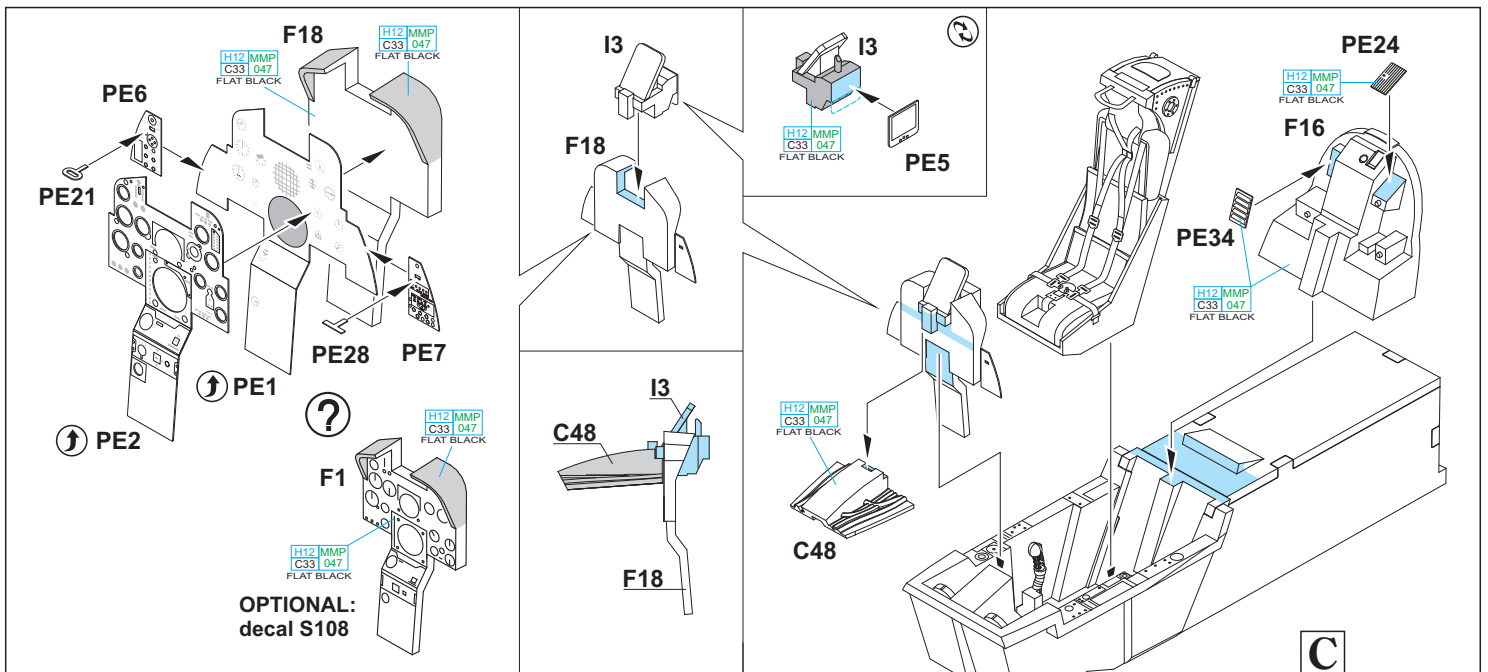

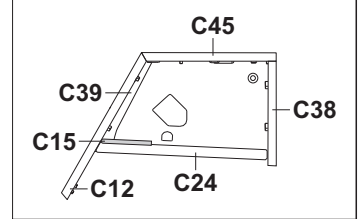
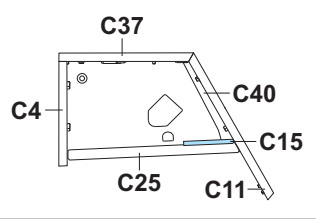
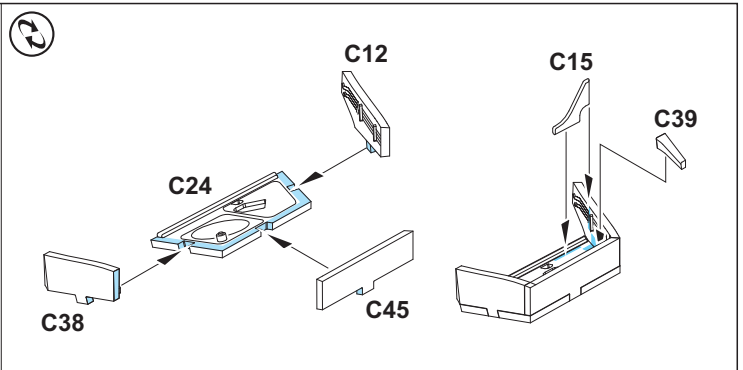
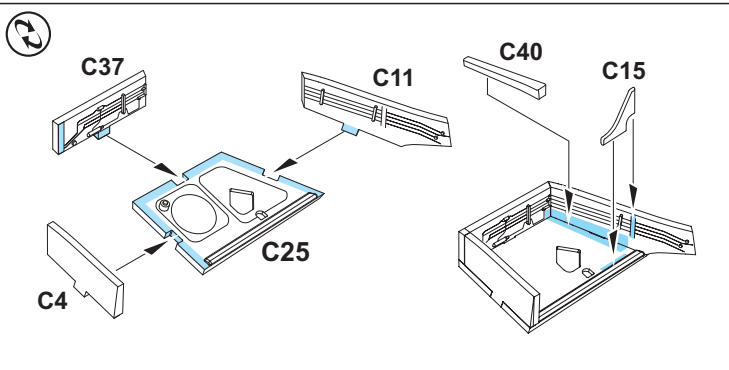

FOR EXTERNAL FUEL TANKS
RACKS D6 OR D11
SEE PAGE 13

FOR MATRA 530
RACK D26
SEE PAGE 13

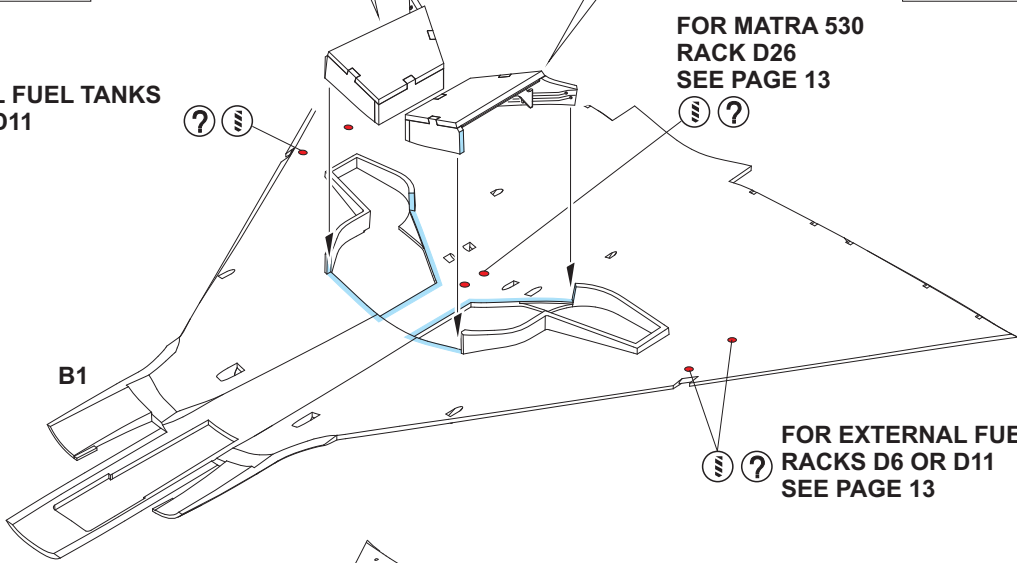

FOR EXTERNAL FUEL TANKS
RACKS D6 OR D11
SEE PAGE 13

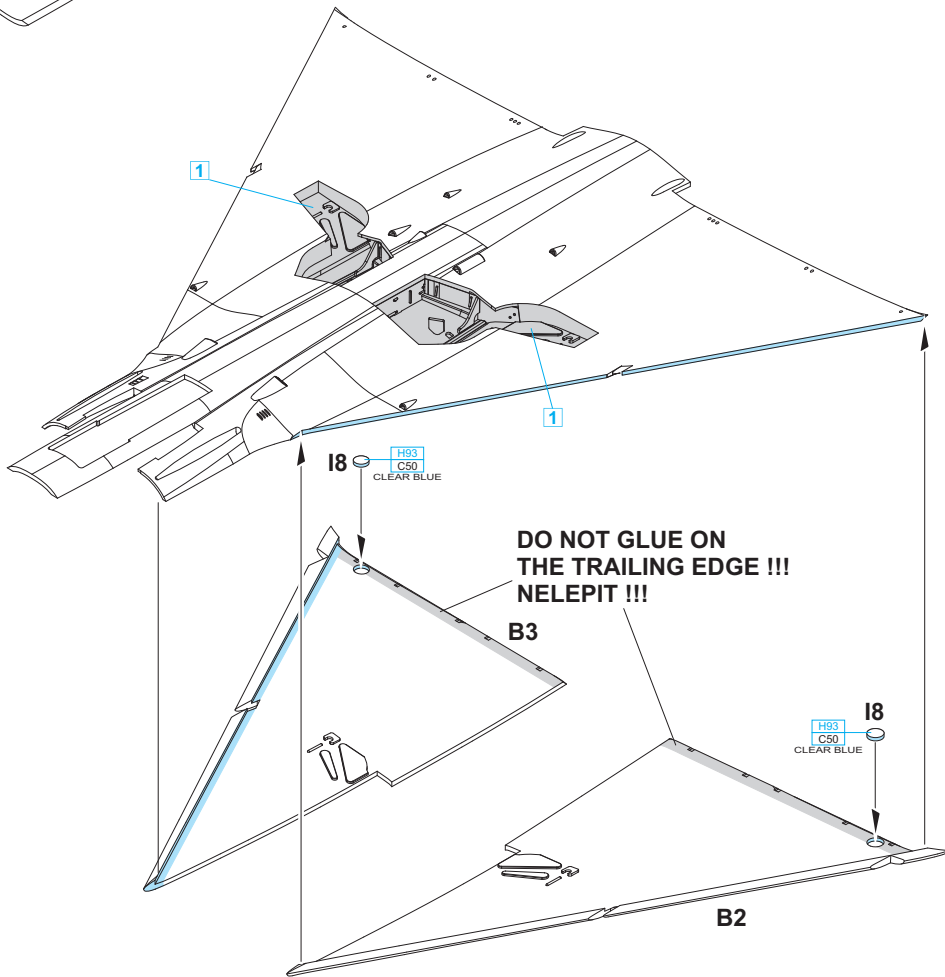

DO NOT GLUE ON
THE TRAILING EDGE !!!
NELEPIT !!!

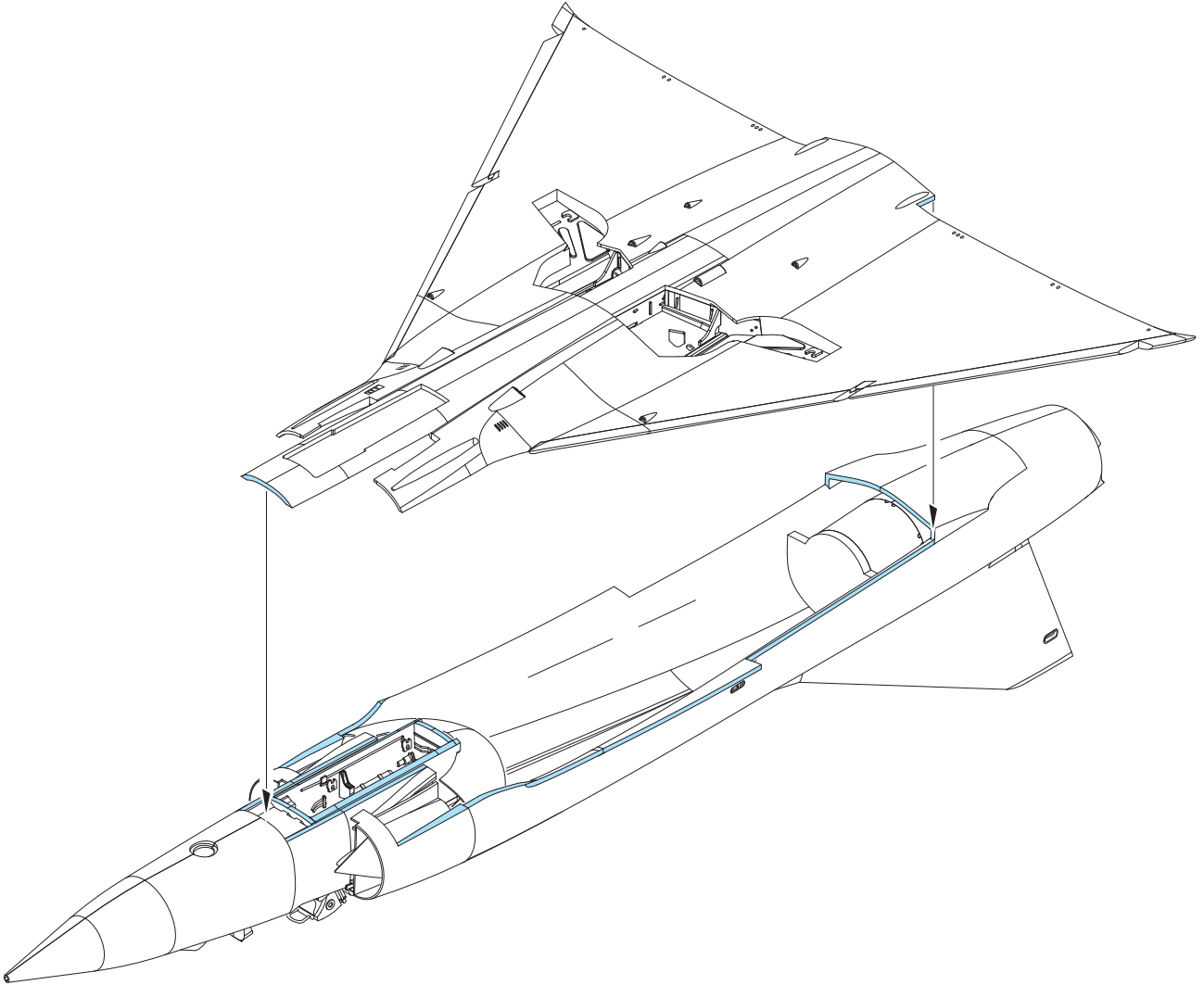
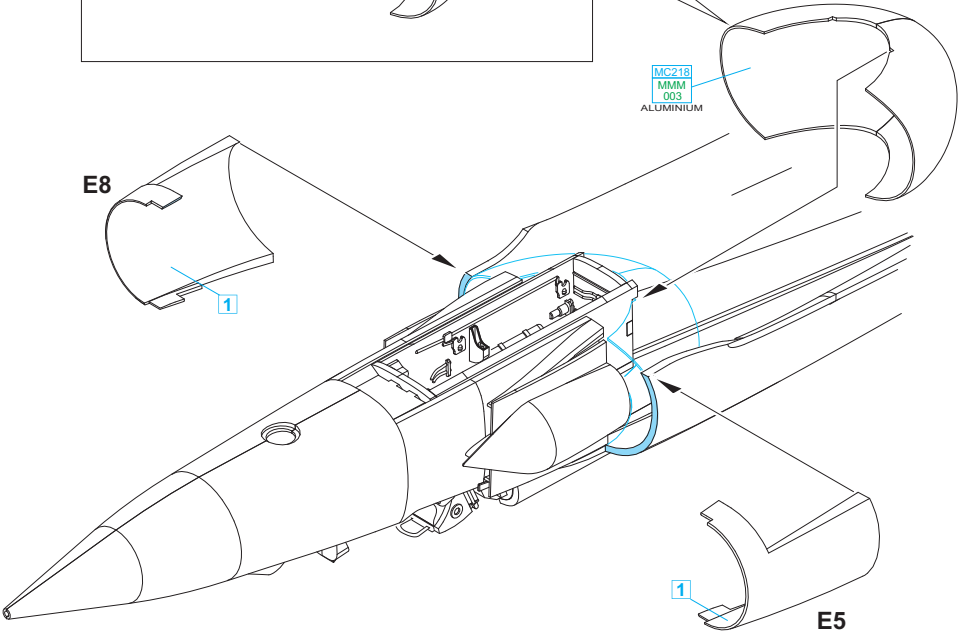
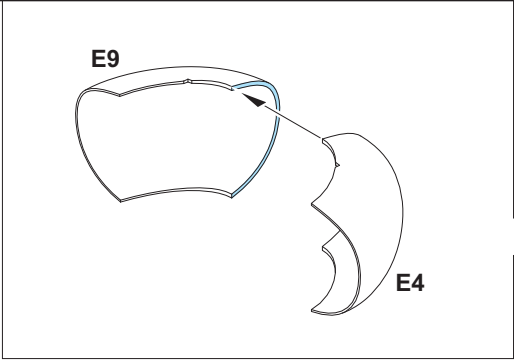

USE D5 FOR AIM-9D SIDEWINDER PART G2
OR MATRA 550 MAGIC TRAINER
SEE PAGE 13

USE D5 FOR AIM-9D SIDEWINDER PART G2
OR MATRA 550 MAGIC TRAINER
SEE PAGE 13

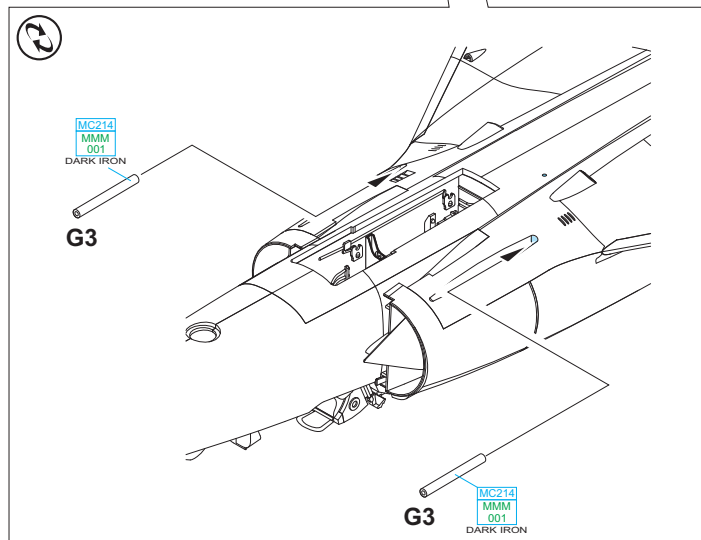
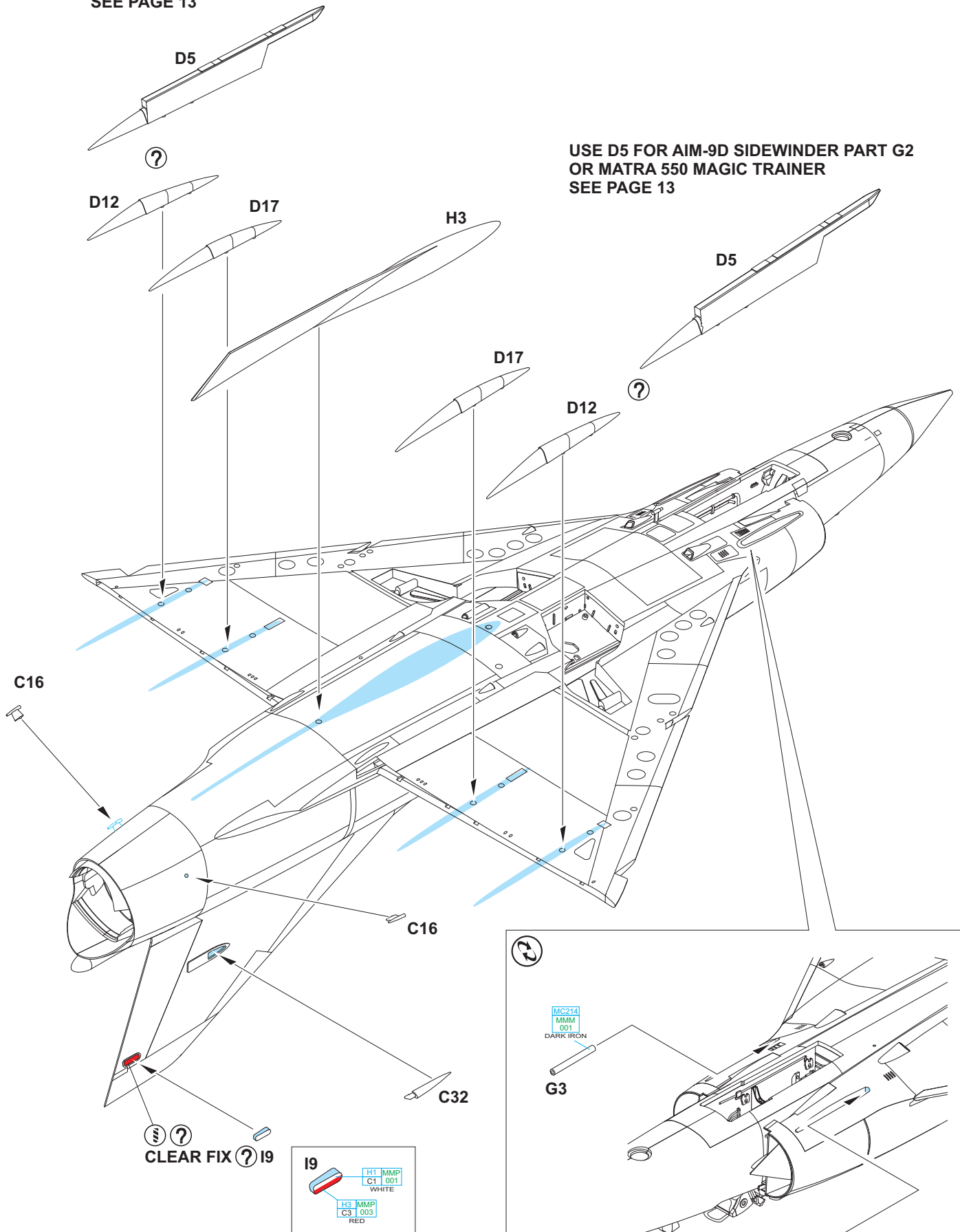

CLEAR FIX ? I9

I9	H1	MMM	WHITE
	C1	001	
I9	H3	MMM	RED
	C3	003	

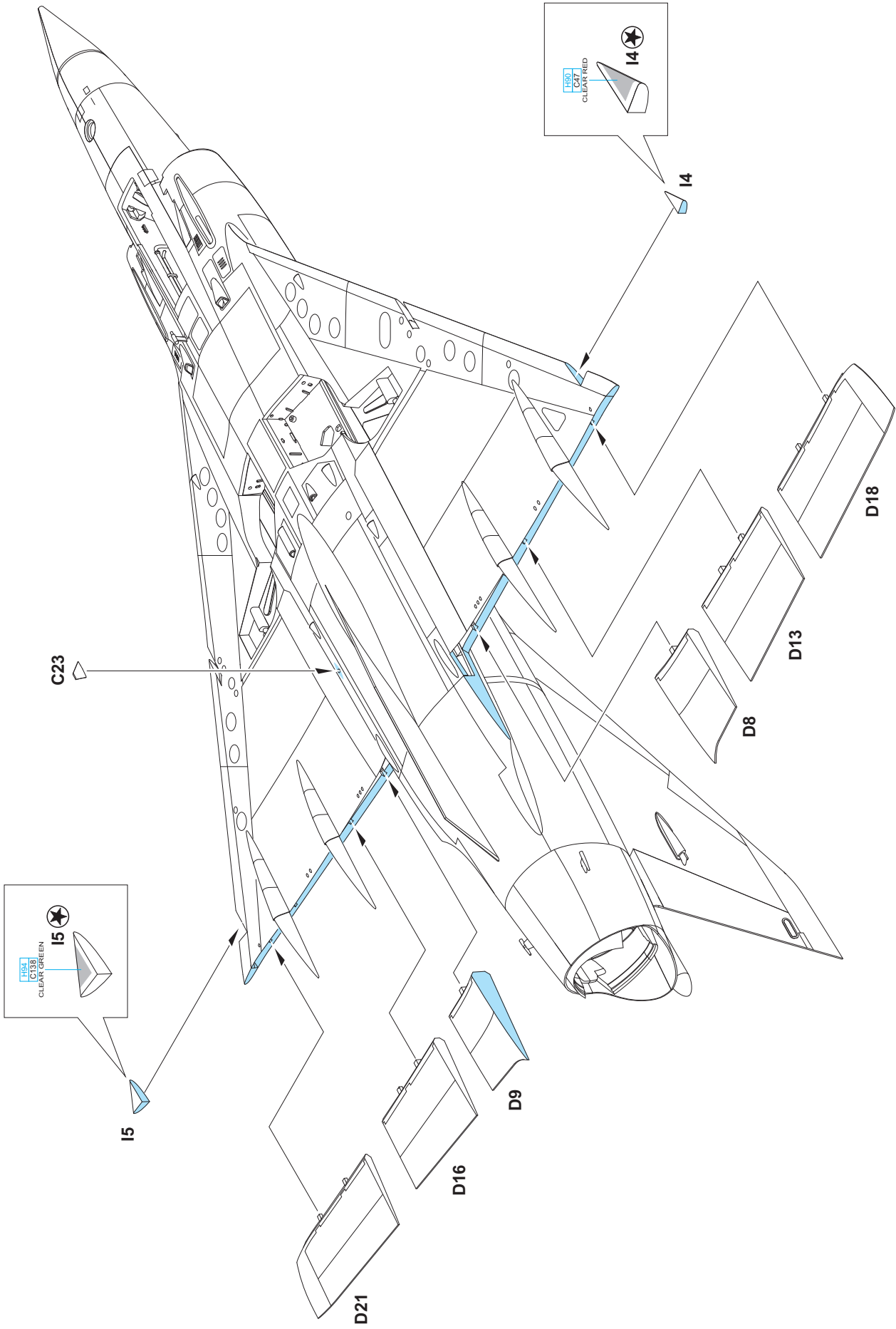

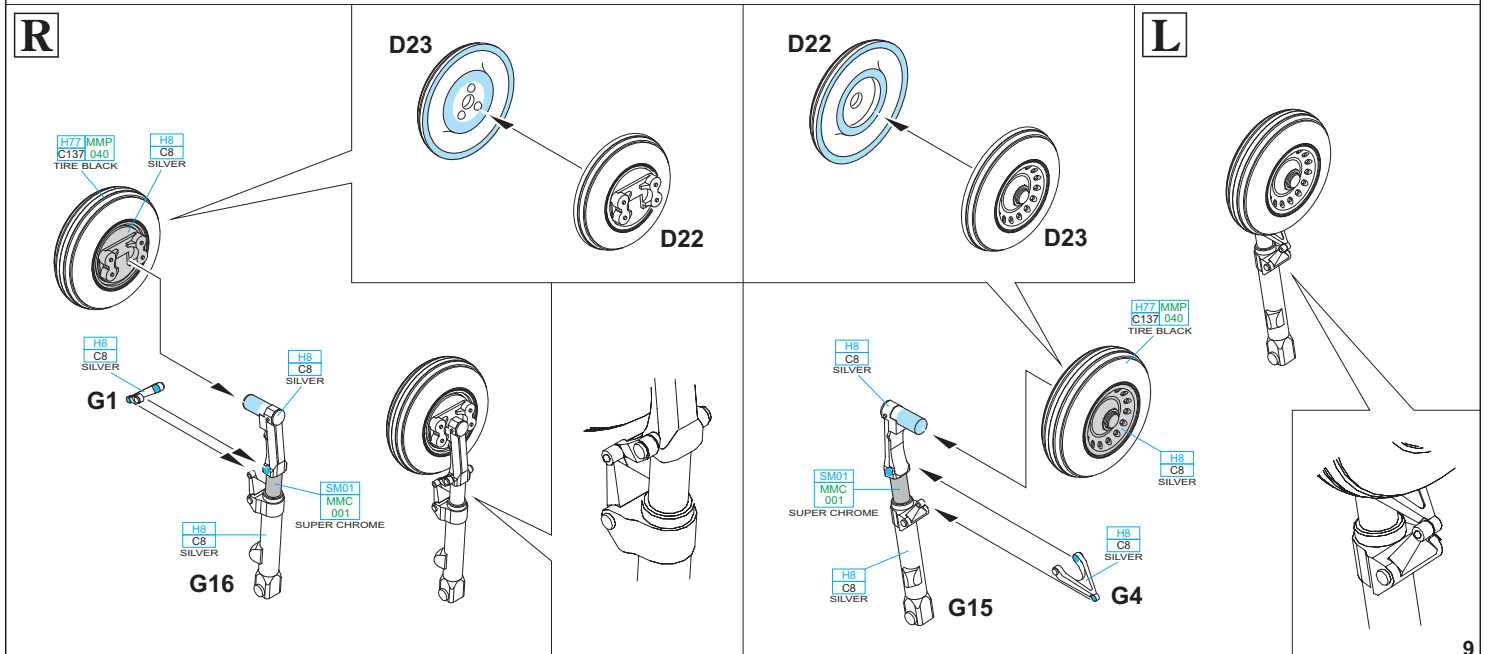
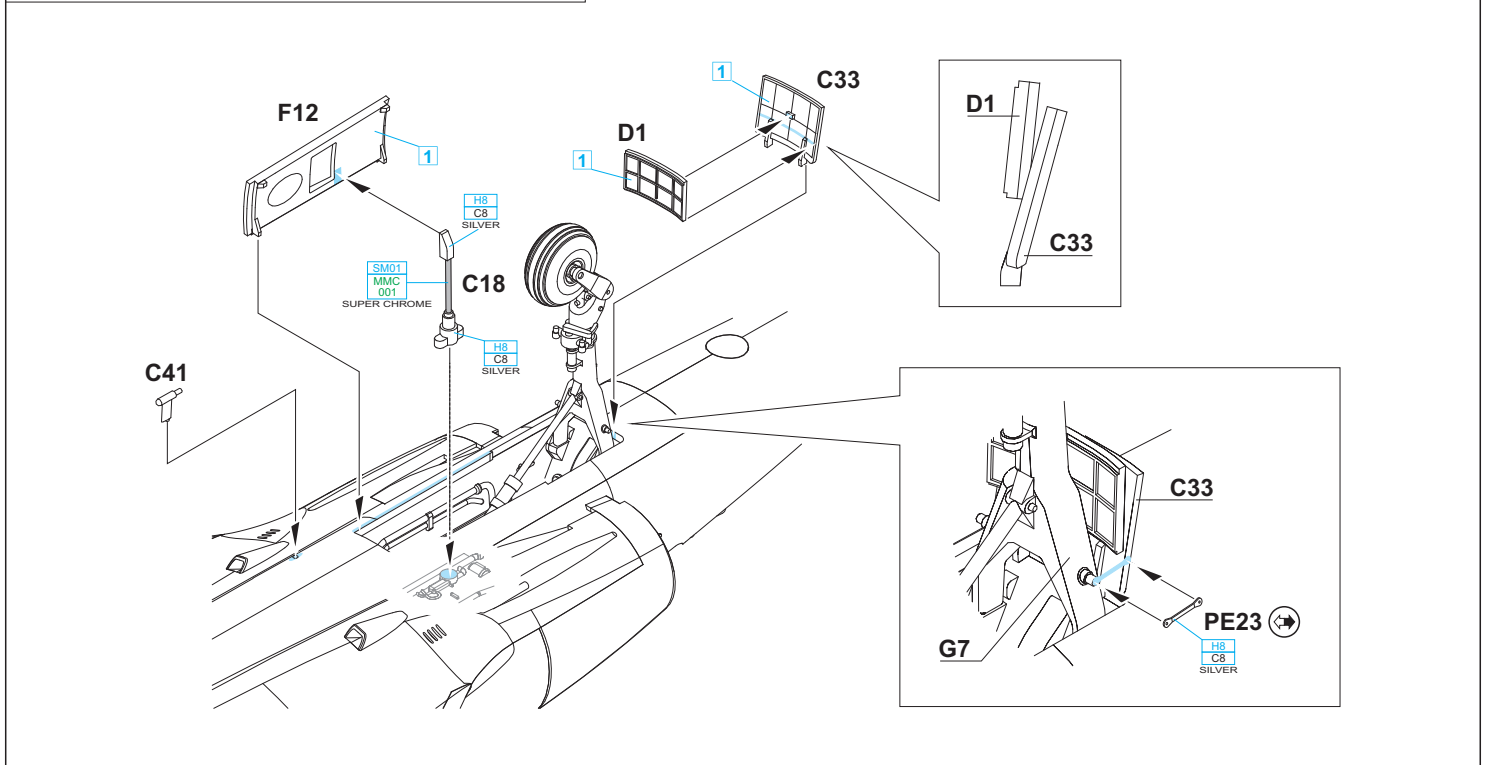
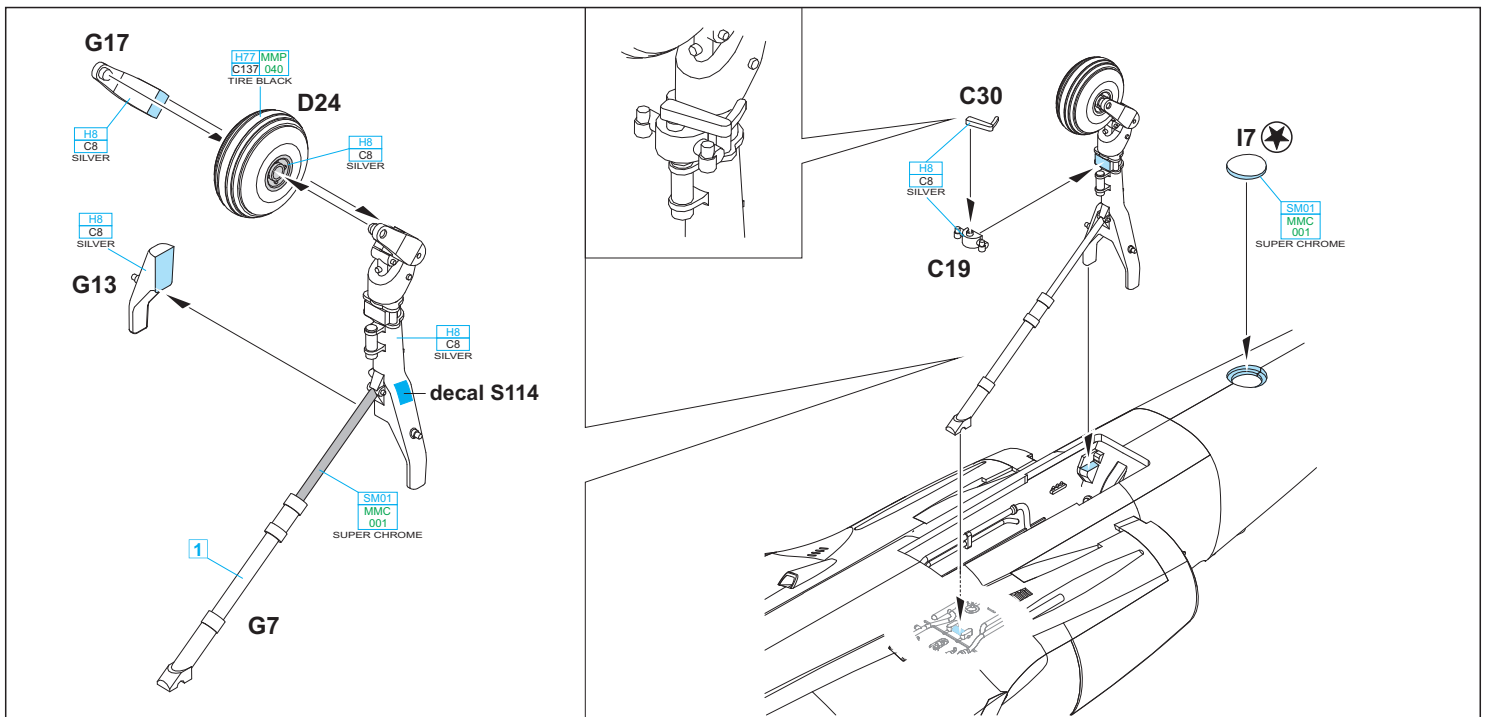

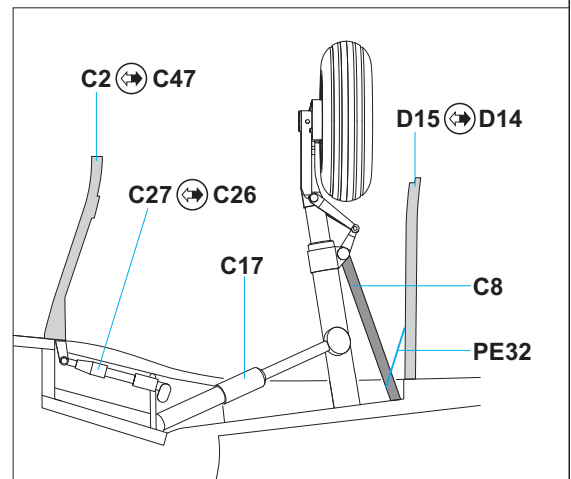
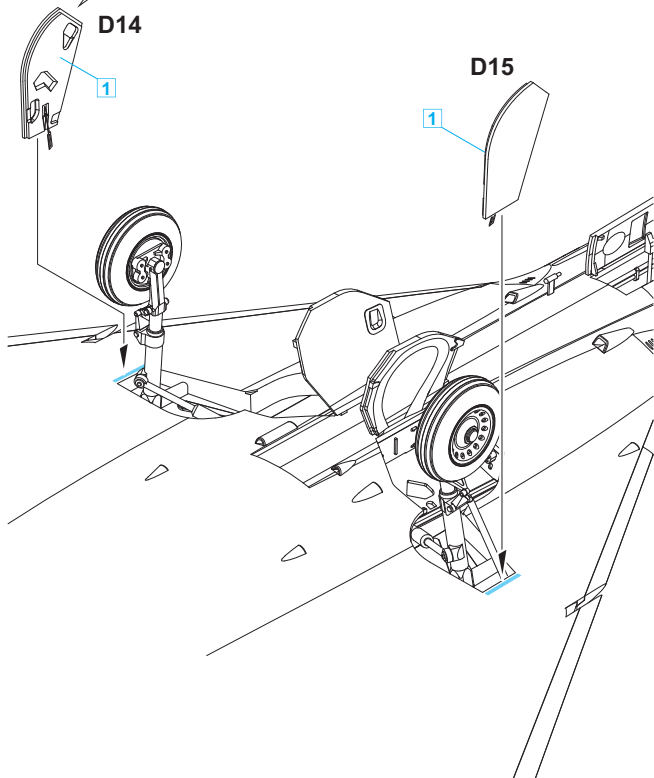
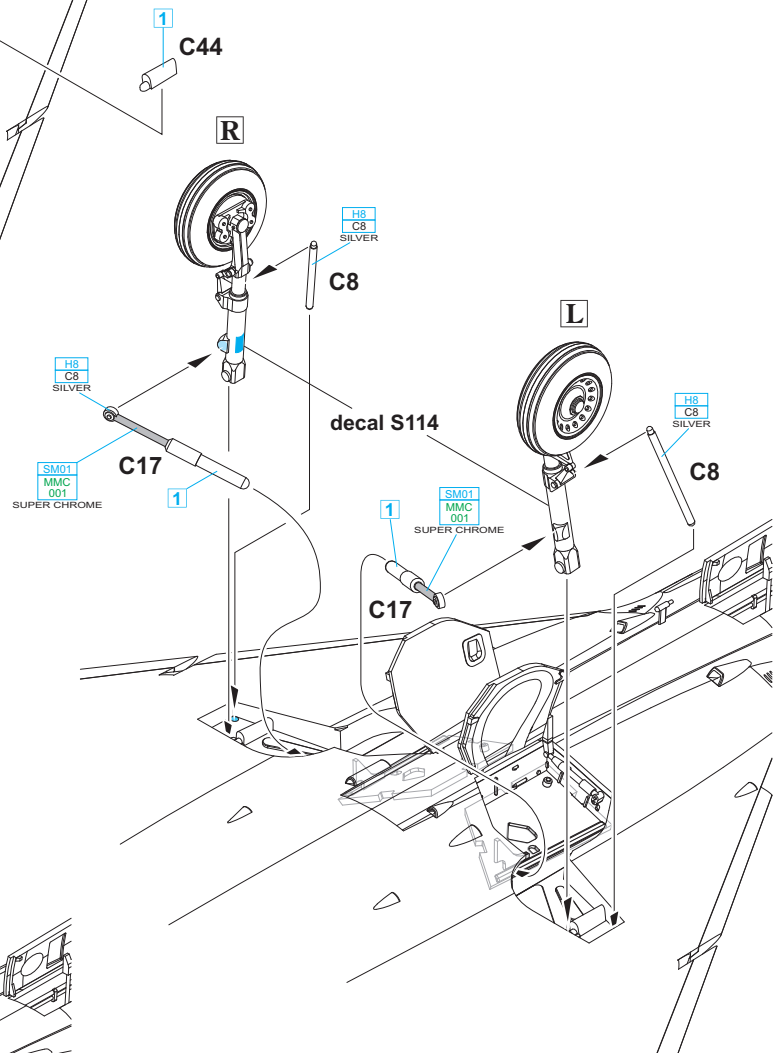
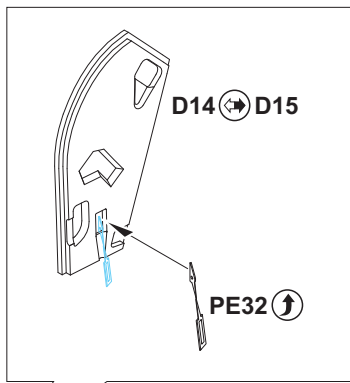
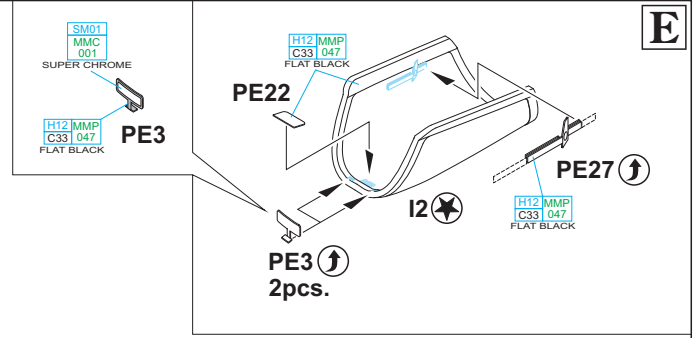
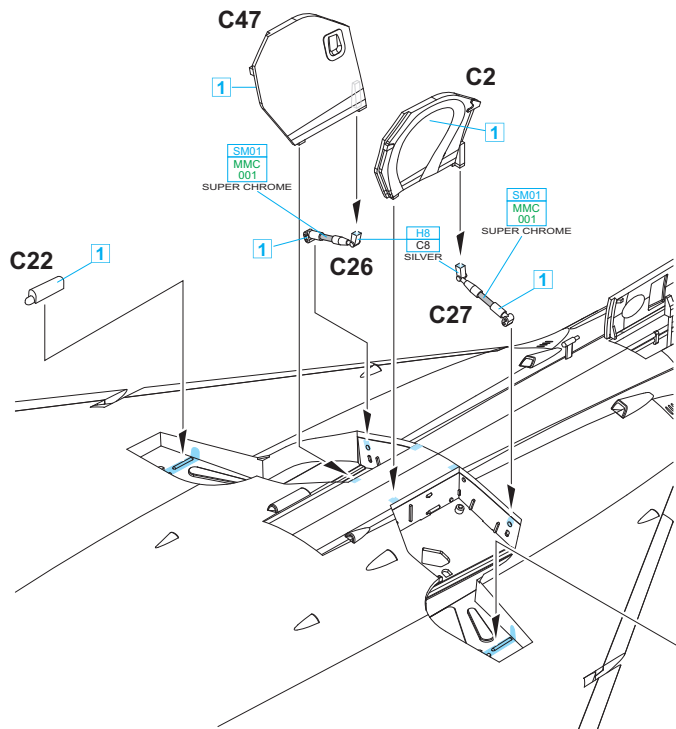

C23 - MARKINGS **A; B; D** ONLY

C42 - MARKINGS **A; D** ONLY

PE20 - MARKING **C** ONLY

CLOSED **E**

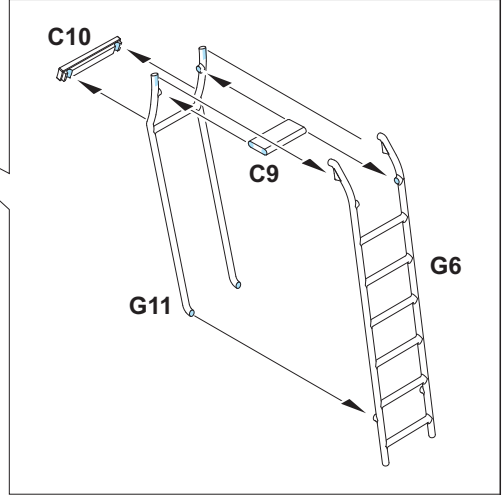
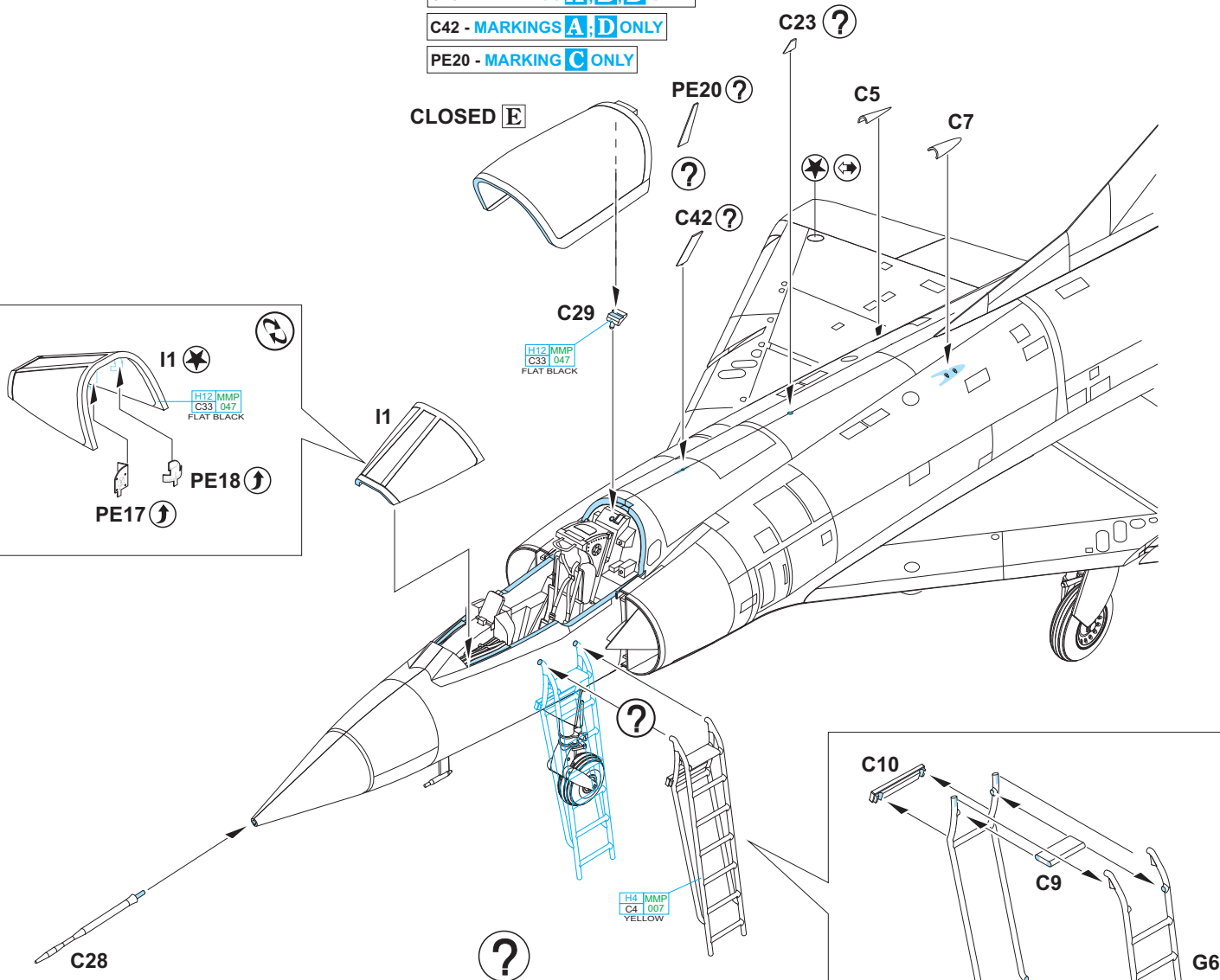

OPEN **E**

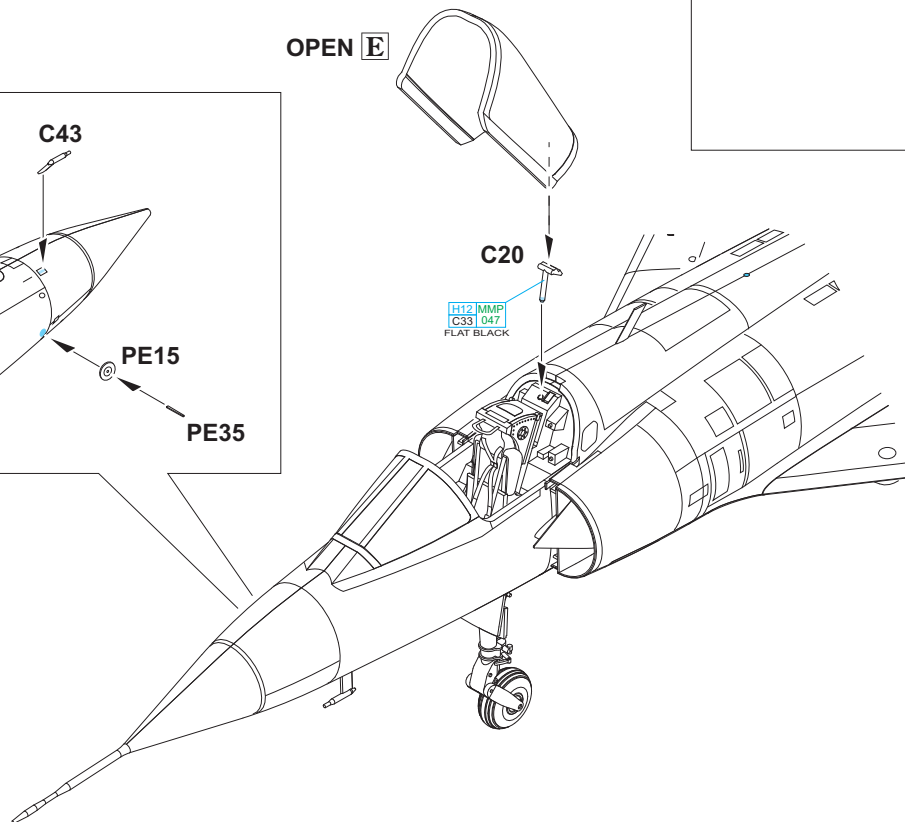
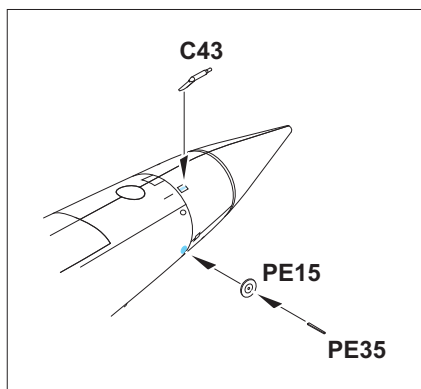

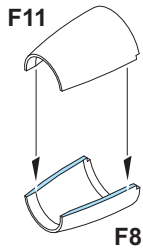

F ROCKET LAUNCHER
JL 100R
2 pcs.

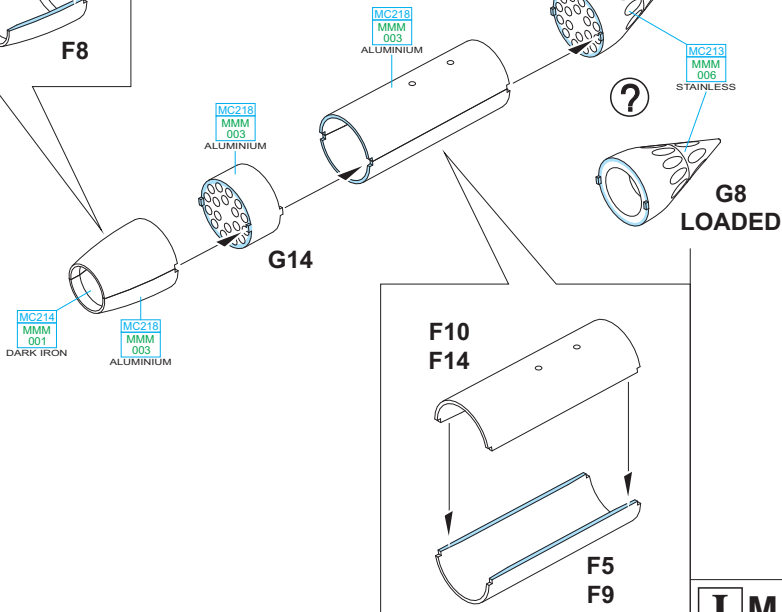

G MATRA 530C,K

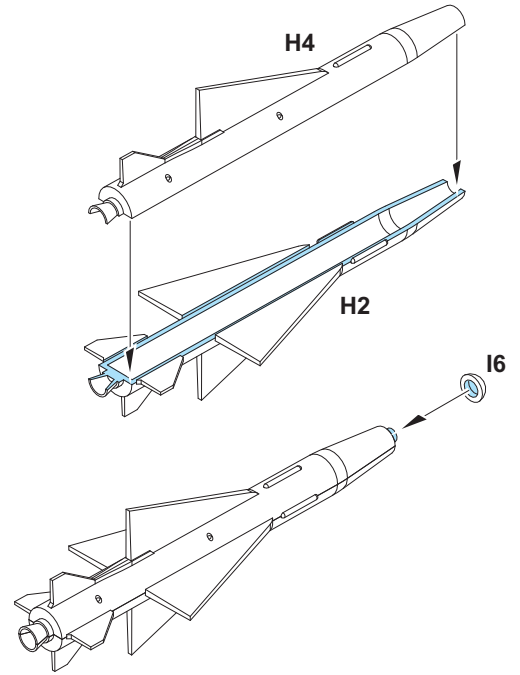

H MATRA 550 MAGIC TRAINER
2 pcs.

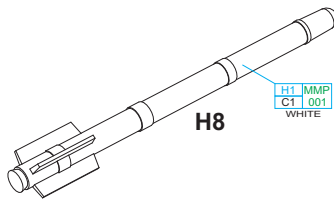

I MATRA 530E, M

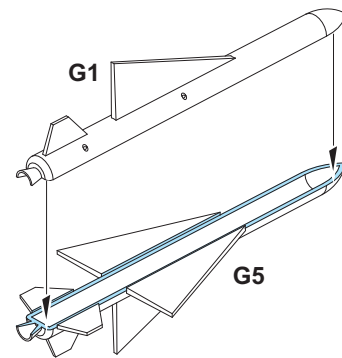

J AIM-9D SIDEWINDER
2 pcs.

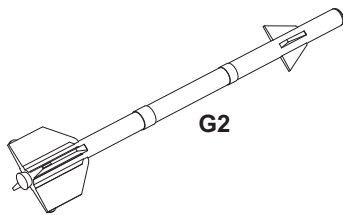

L EXTERNAL FUEL TANK- 500I
2 pcs.

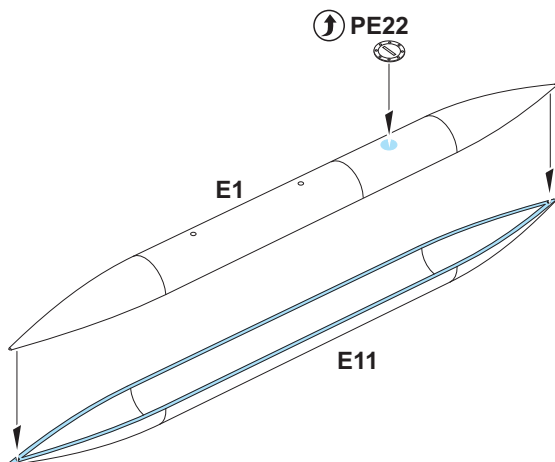

K EXTERNAL FUEL TANK- 625I
2 pcs.

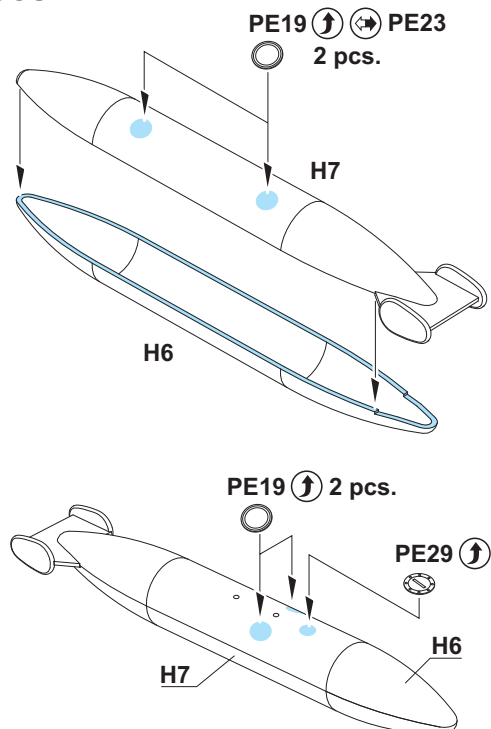

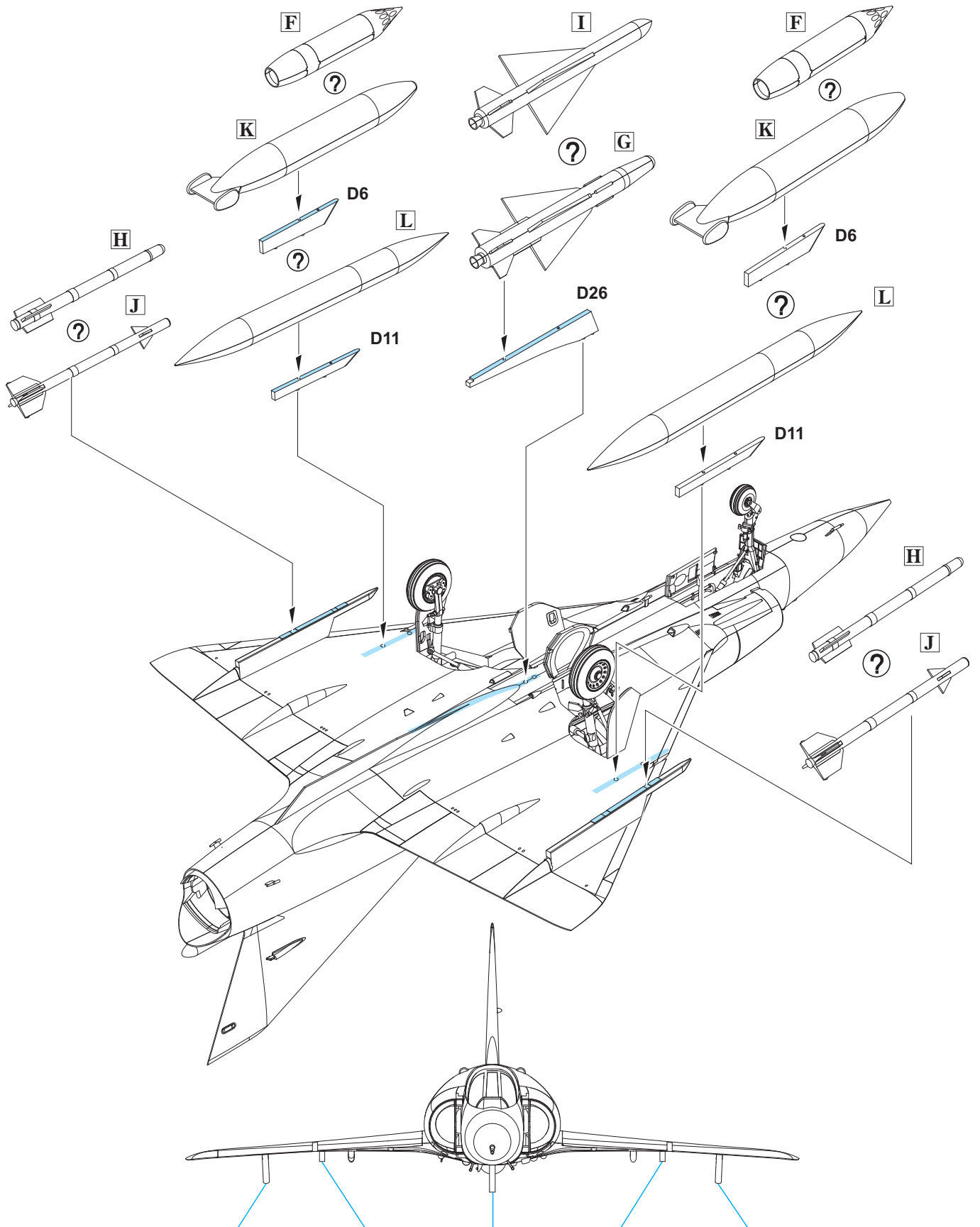

MATRA 530C, K					
MATRA 530E, M					
FUEL TANK 500I					
FUEL TANK 625I					
ROCKET LAUNCHER JL 100R					
AIM-9D SIDEWINDER					
MATRA 550 MAGIC TRAINER					

F

ROCKET LAUNCHER JL 100R

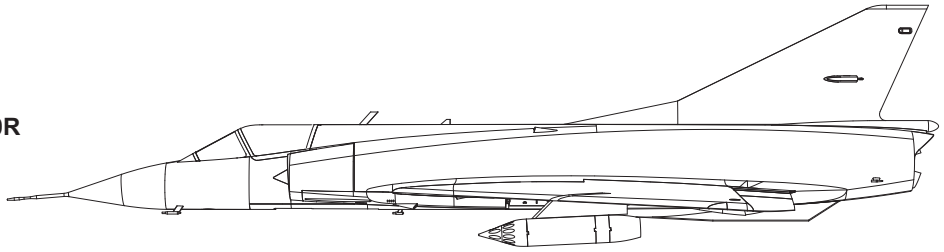

G

MATRA 530C, K

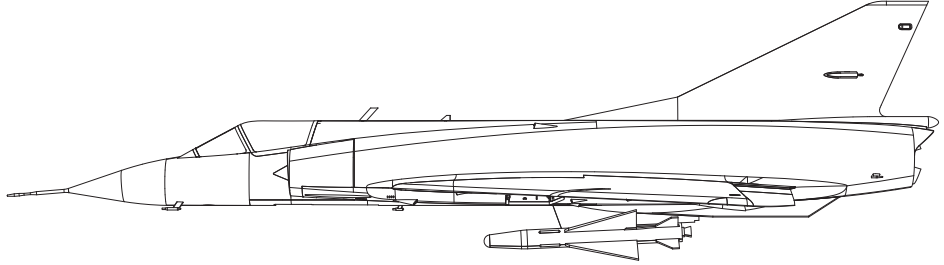

H

MATRA 550 MAGIC TRAINER

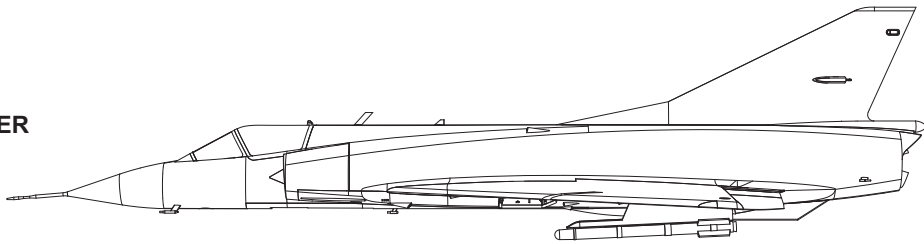

I

MATRA 530E, M

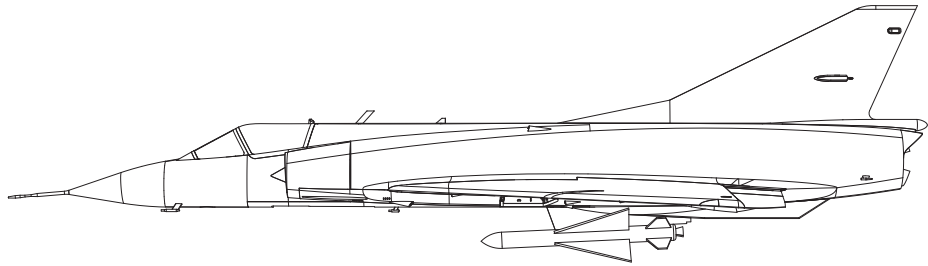

J

AIM-9D SIDEWINDER

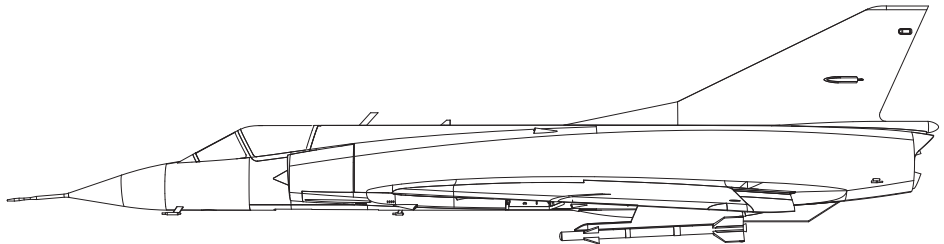

K

EXTERNAL FUEL TANK- 625I

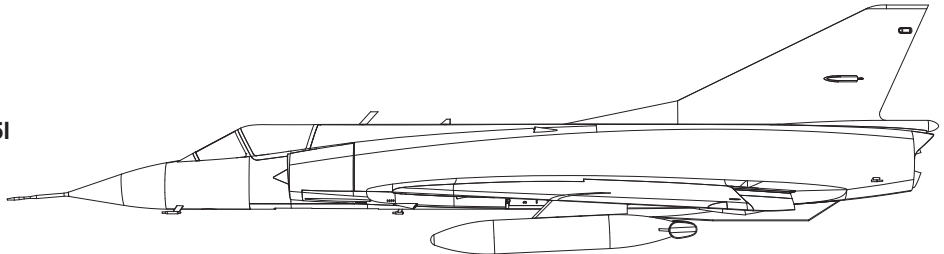

L

EXTERNAL FUEL TANK- 500I

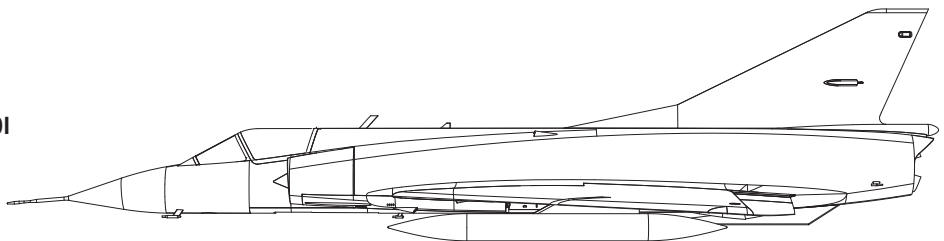

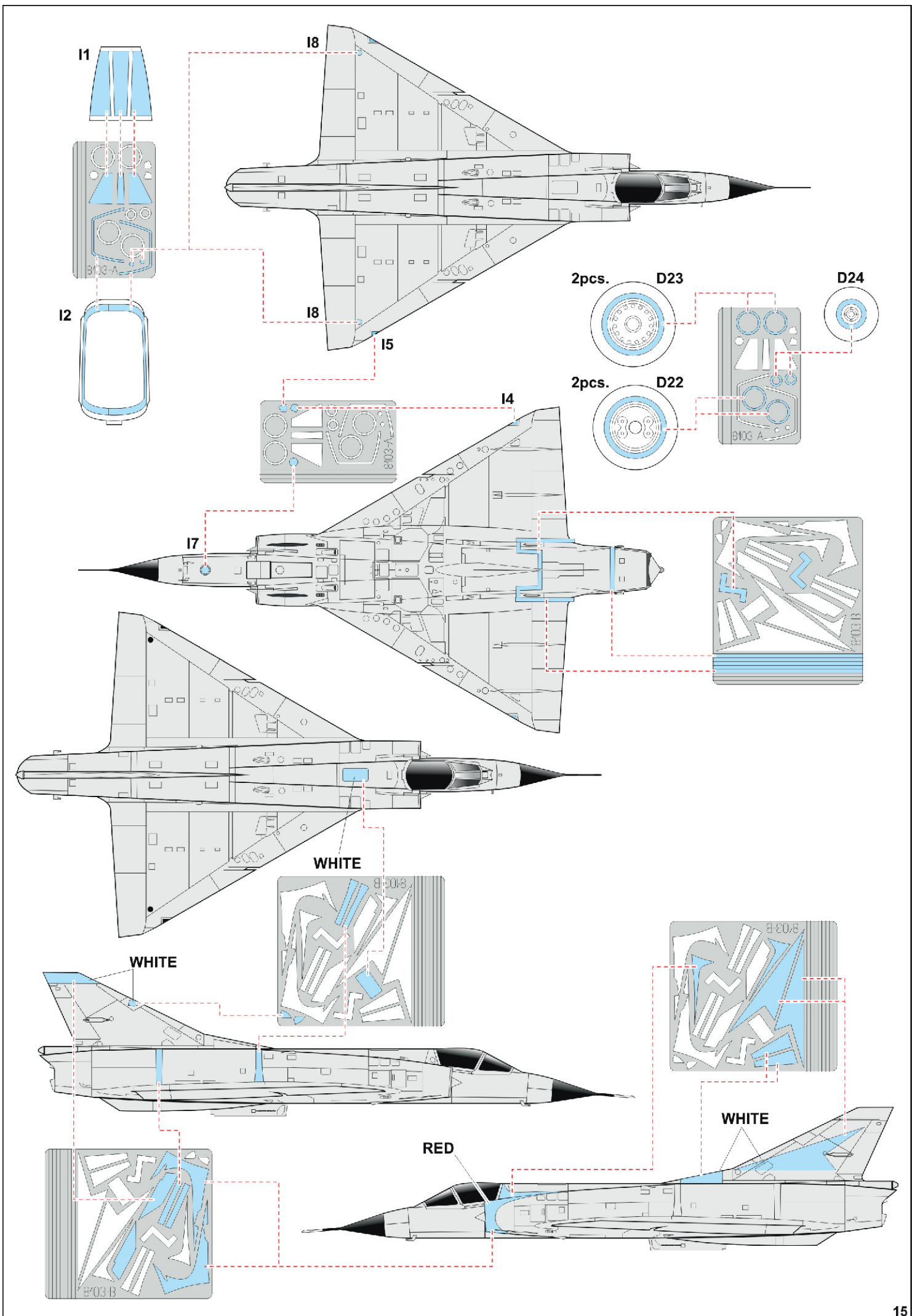

C Mirage IIIC, No. 259 (ex 59), Tayeset 101, Hatzor Air Base, Israel, 1971

One of two most successful Israeli Mirages IIIC, credited with 13 kills, changed appearance over the time. Here it's depicted as it appeared in July 1971, sporting 11 kills so far. The remaining 2 kills were scored in 1973. In 1971 Mirage IIIC nr.259 flew in the standard Israeli Air Force camouflage, under surfaces were in light blue, upper and side surfaces were painted in green, brown and sand colors. The aircraft carries Tayeset 101 tail marking.

ČESKOU VERZI TEXTU NALEZNETE NA
www.eduard.cz
POD KATALOGOVÝM ČÍSLEM 8103

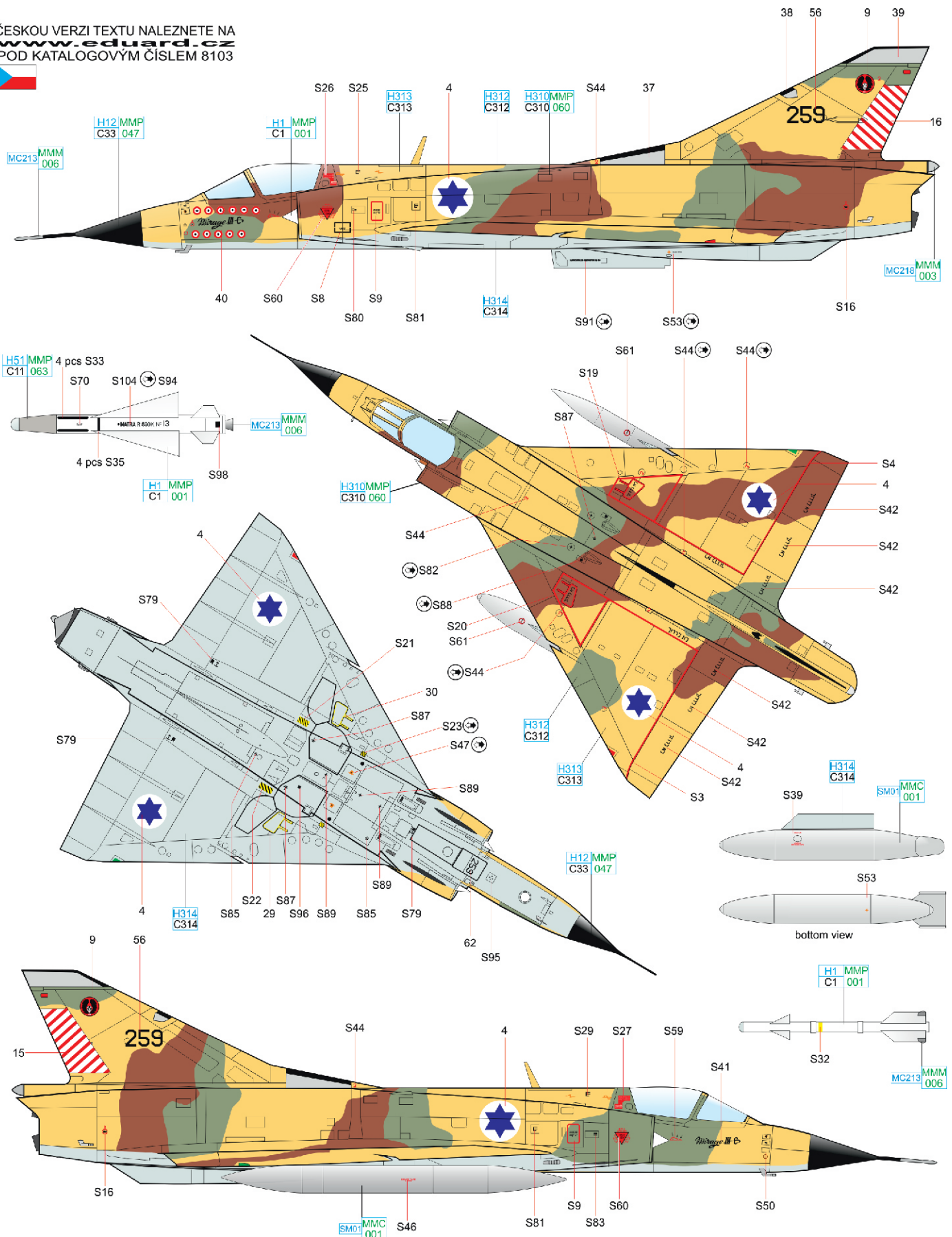

BLACK	H12 MMP C33 047	WHITE	H1 MMP C1 001	GRAY	H51 MMP C11 063
SUPER CHROME	SM01 MMC 001	STEEL	MC213 MMM 006	ALUMINIUM	MC218 MMM 003
		BLUE	H314 C314	YELLOW	H313 C313
				GREEN	H312 C312
				BROWN	H310MMP C310 060

E Mirage IIICZ, No. 800, No. 2 Squadron SAAF, Waterkloof Air Base, Republic of South Africa, 1982

No. 2 squadron of the South African Air Force, unit with the rich history and with which SAAF airmen never missed any combat mission, was equipped with Mirage IIICZ aircraft in 1963. It operated them until 1990 when they were replaced by home-designed Atlas Cheetah, based on the Mirage III concept though.

ČESKOU VERZÍ TEXTU NALEZNETE NA
www.eduard.cz
 POD KATALOGOVÝM ČÍSLEM 8103

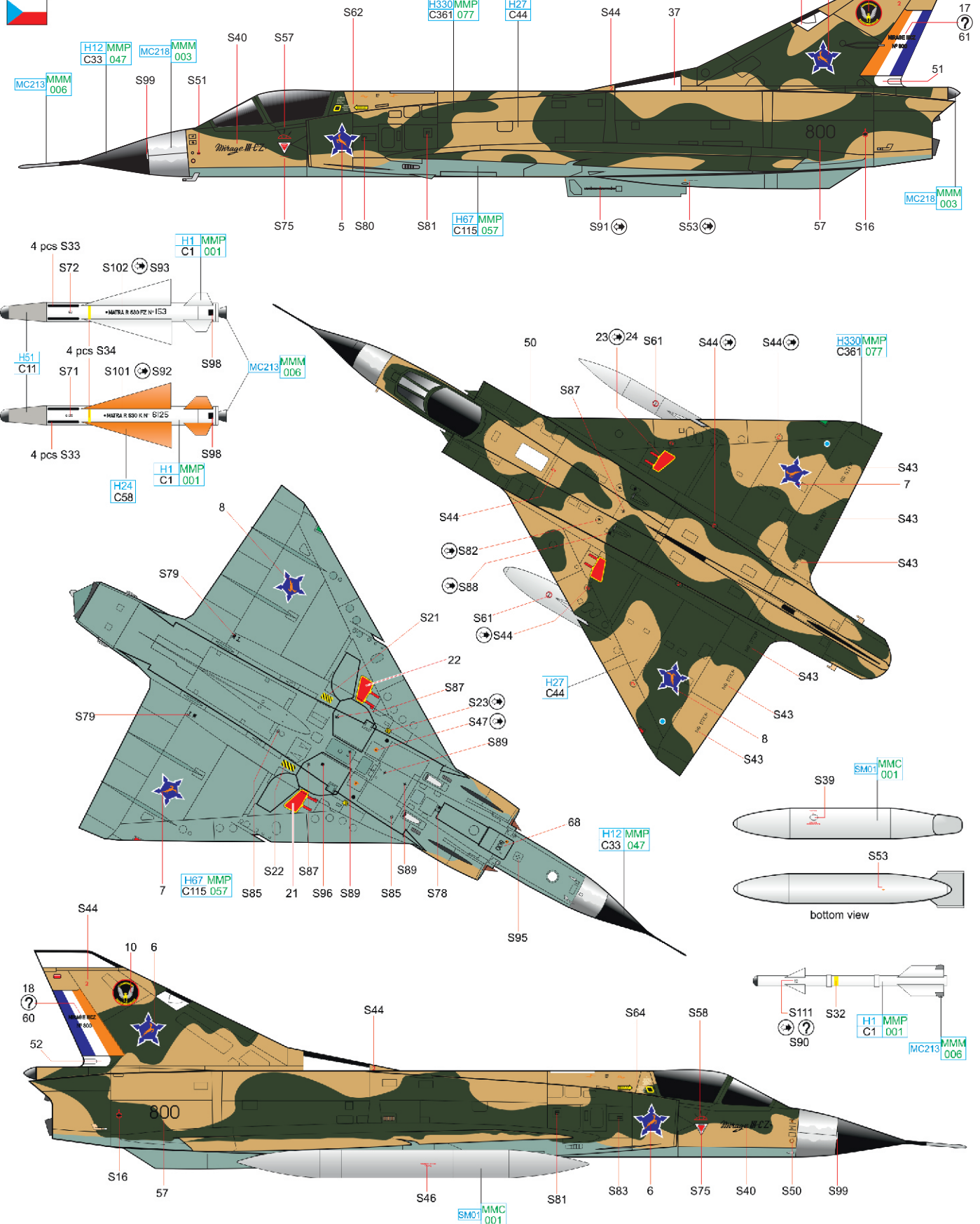

DARK GREEN	H330 MMP C361 077	TAN	H27 C44	ORANGE	H24 C58	GRAY	H51 C11
SUPER CHROME	SM01 MMC 001	STEEL	MC213 MMM 006	ALUMINIUM	MC218 MMM 003	LIGHT BLUE	H67 MMP C115 057
						BLACK	H12 MMP C33 047
						WHITE	H1 MMP C1 001