

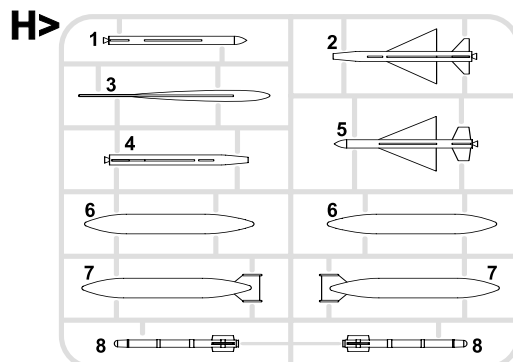

PP - PLASTIC PARTS

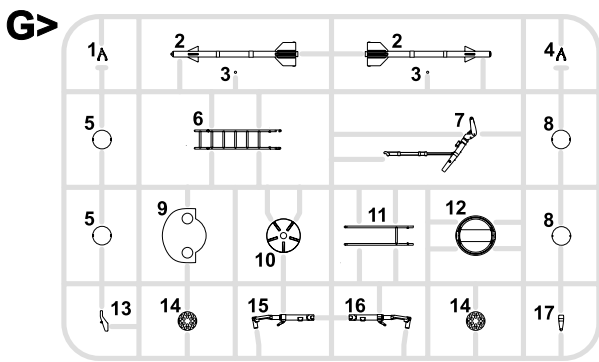

PE - PHOTO ETCHED PARTS

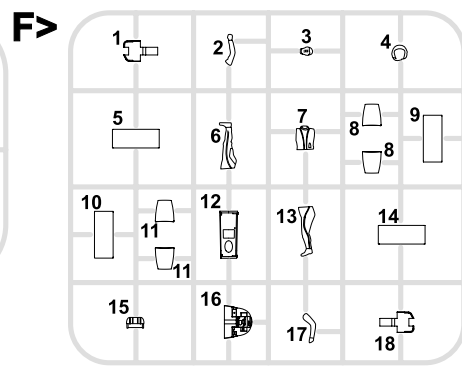
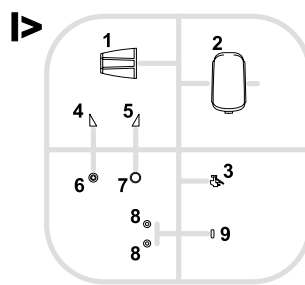
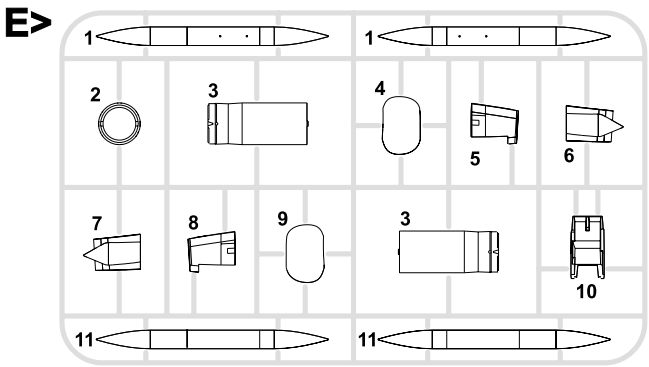
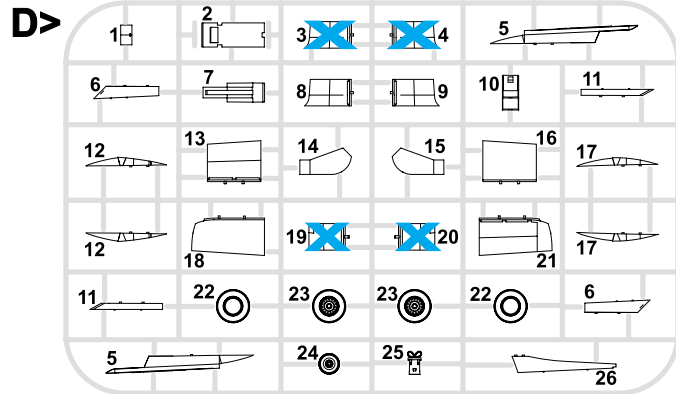
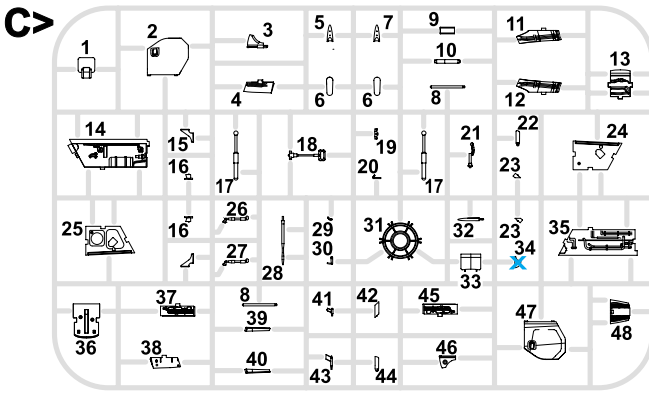
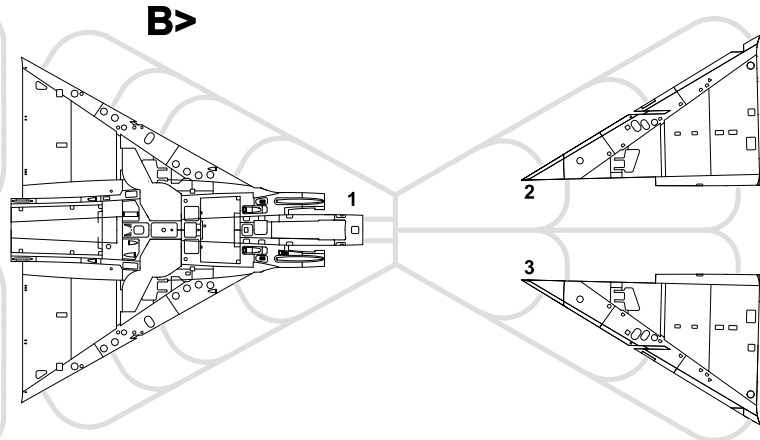
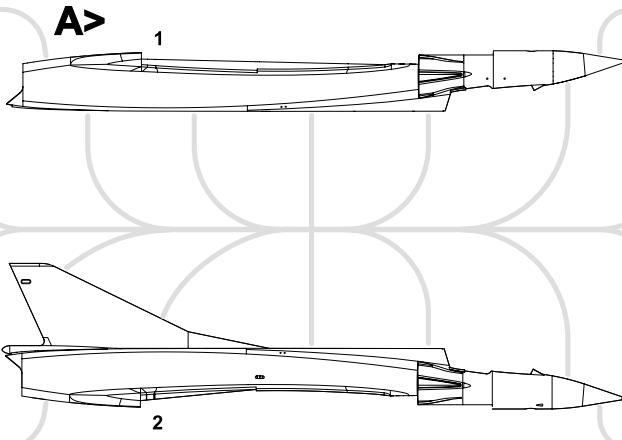
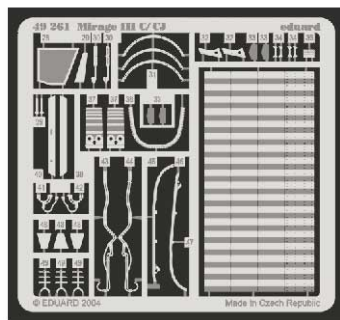
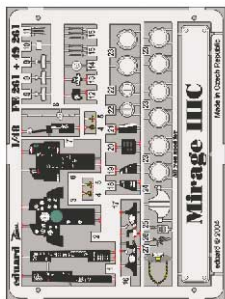
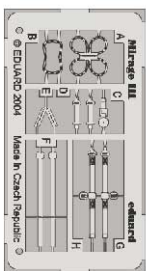

WEIGHT  
ZÁVAŽÍ

FILM

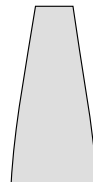

**eduard**  
**Express Mask**

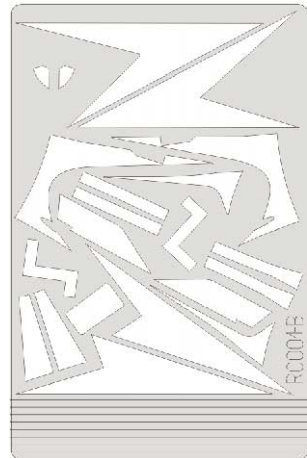
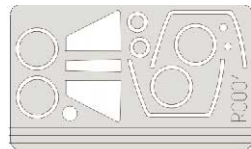

# I

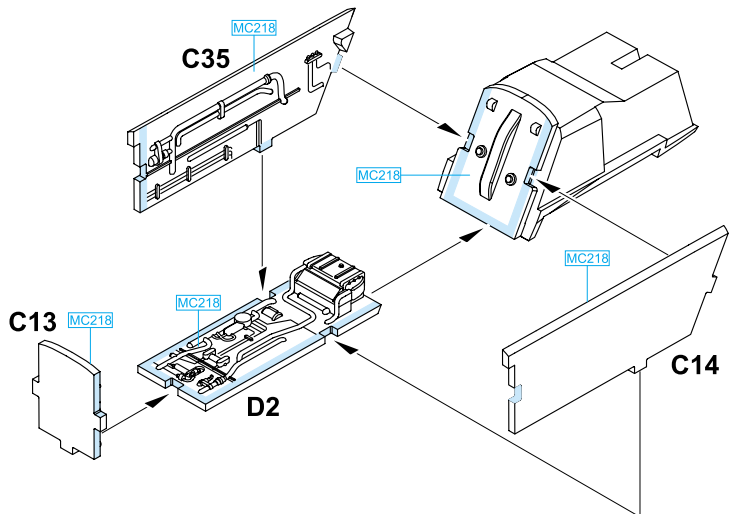
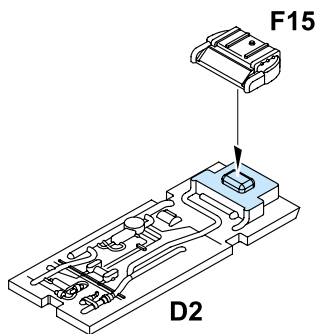
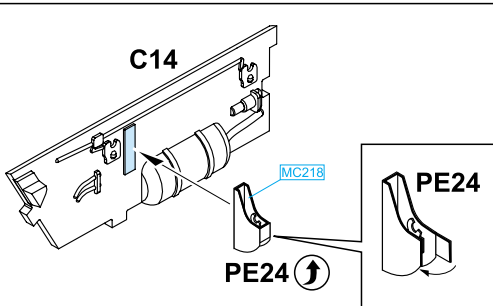
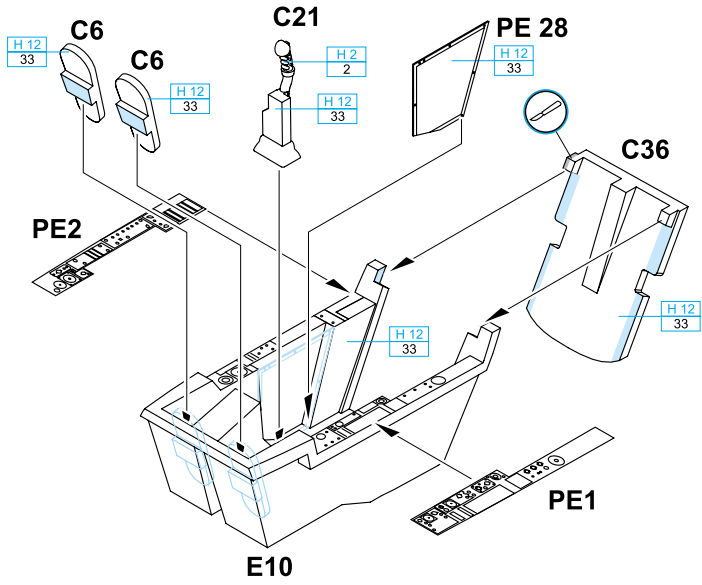
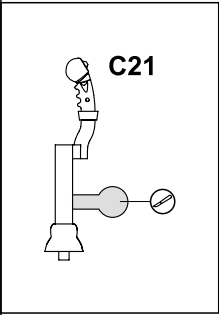
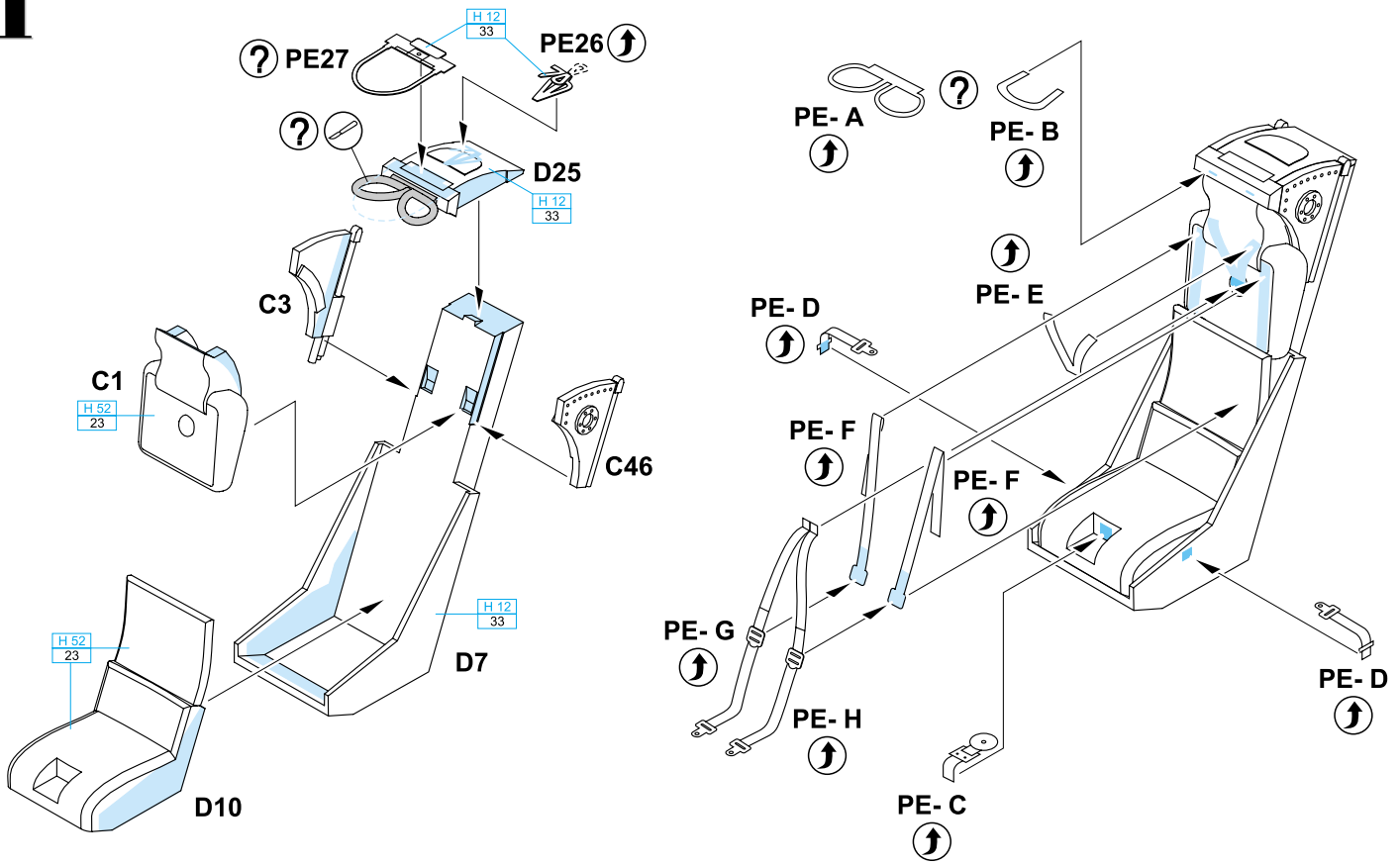

**REVERSE VIEW  
OPAČNÝ POHLED**

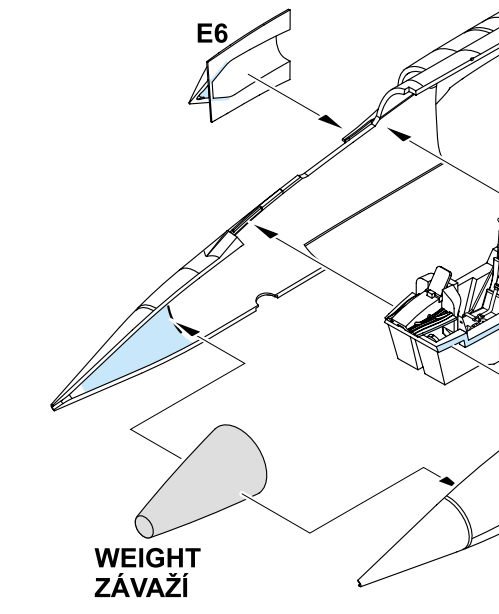
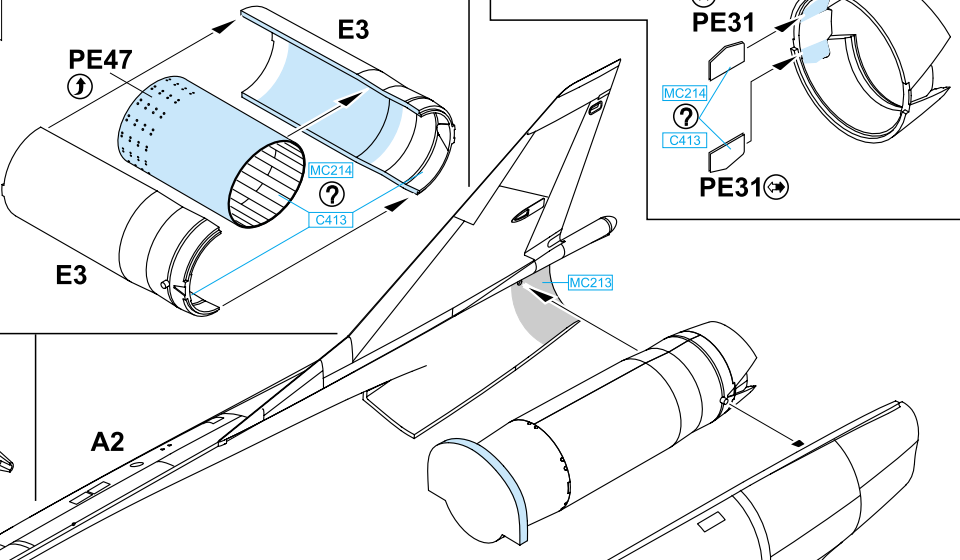
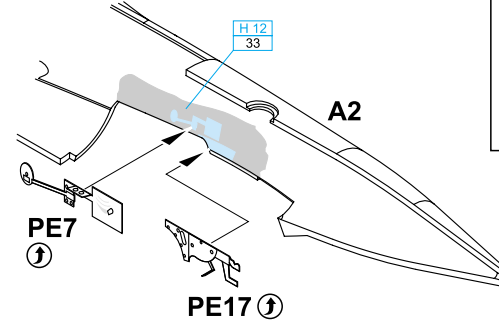
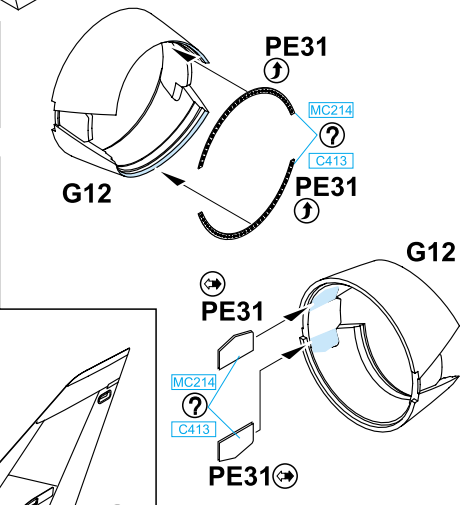
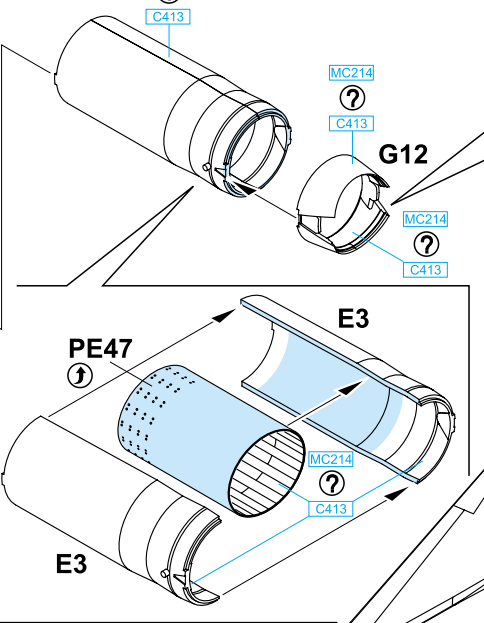
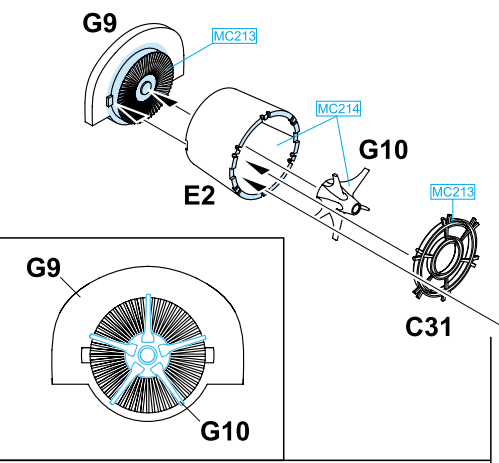
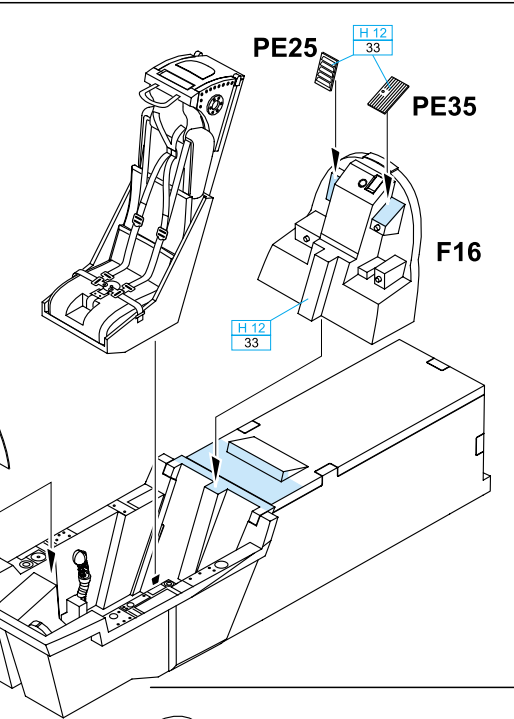
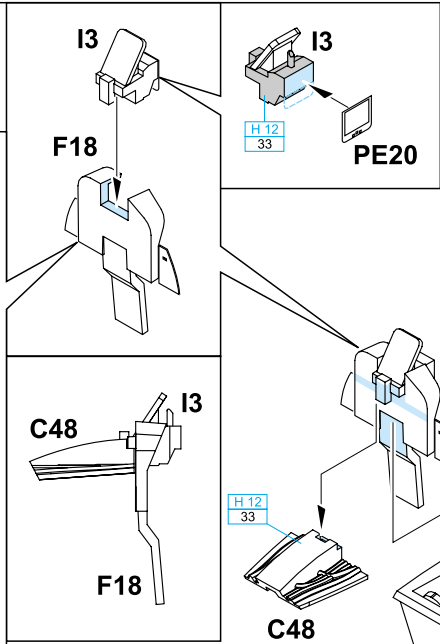
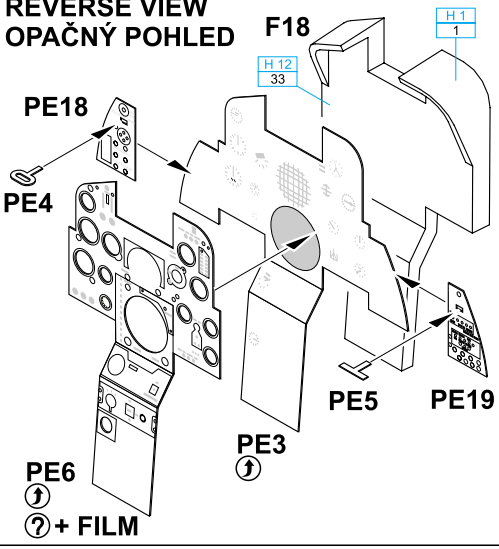

**DON'T GLUE ON THE WITHEEL  
WELL EDGE !!  
NELEPIT NA HRANU  
PODV. ŠACHTY !!**

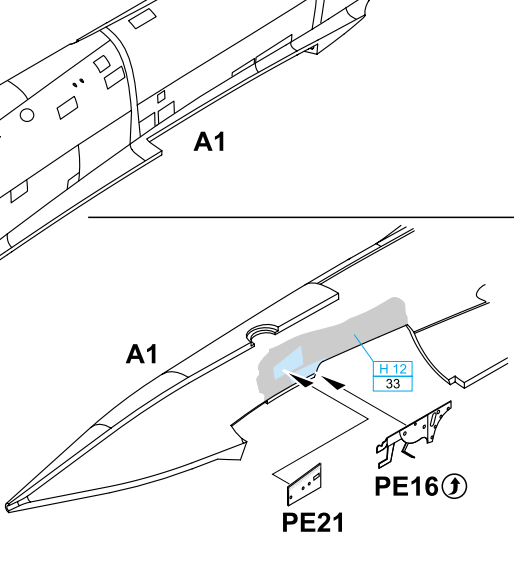

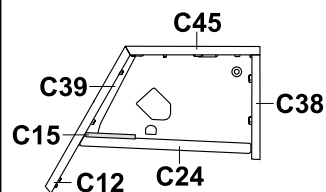
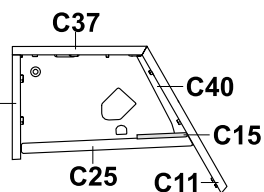
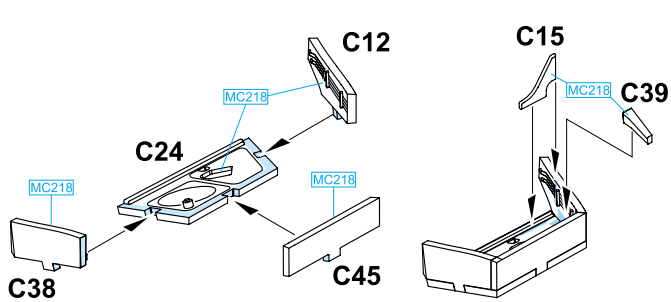
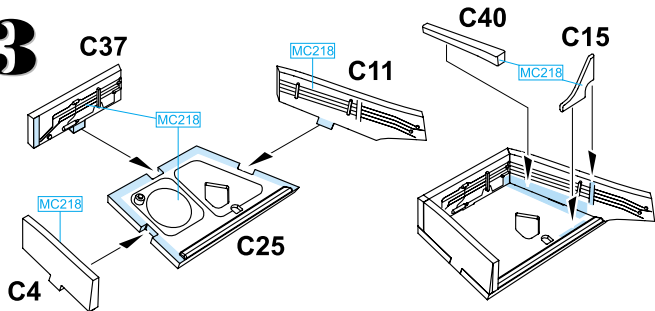
**3**

IF EXTERNAL FUEL TANKS RACKS D6 OR D11 ARE USED. SEE PAGE 11  
 POKUD JE POUŽIT ZÁVĚSNÍK PŘÍDAVNÉ NÁDRŽE D6 NEBO D11. VIZ. STR.11

IF MATRA 530 RACK D26 IS USED. SEE PAGE 11  
 POKUD MÁ BÝT POUŽIT ZÁVĚSNÍK D26 PRO MATRU 530. VIZ. STR.11

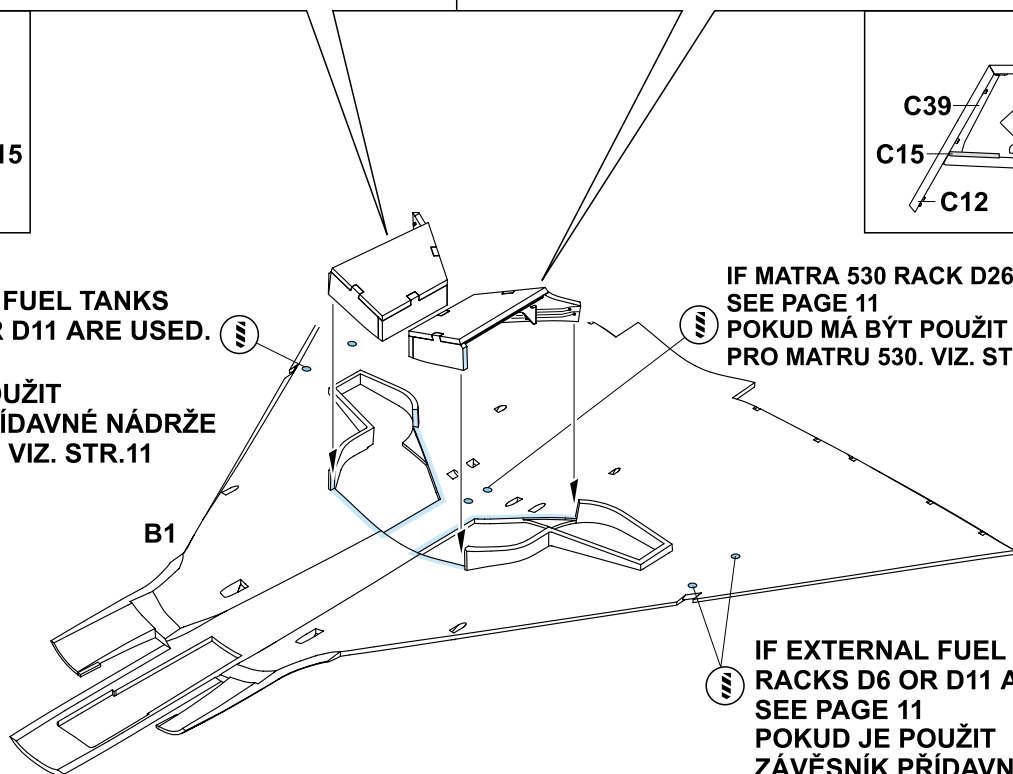

IF EXTERNAL FUEL TANKS RACKS D6 OR D11 ARE USED. SEE PAGE 11  
 POKUD JE POUŽIT ZÁVĚSNÍK PŘÍDAVNÉ NÁDRŽE D6 NEBO D11. VIZ. STR.11

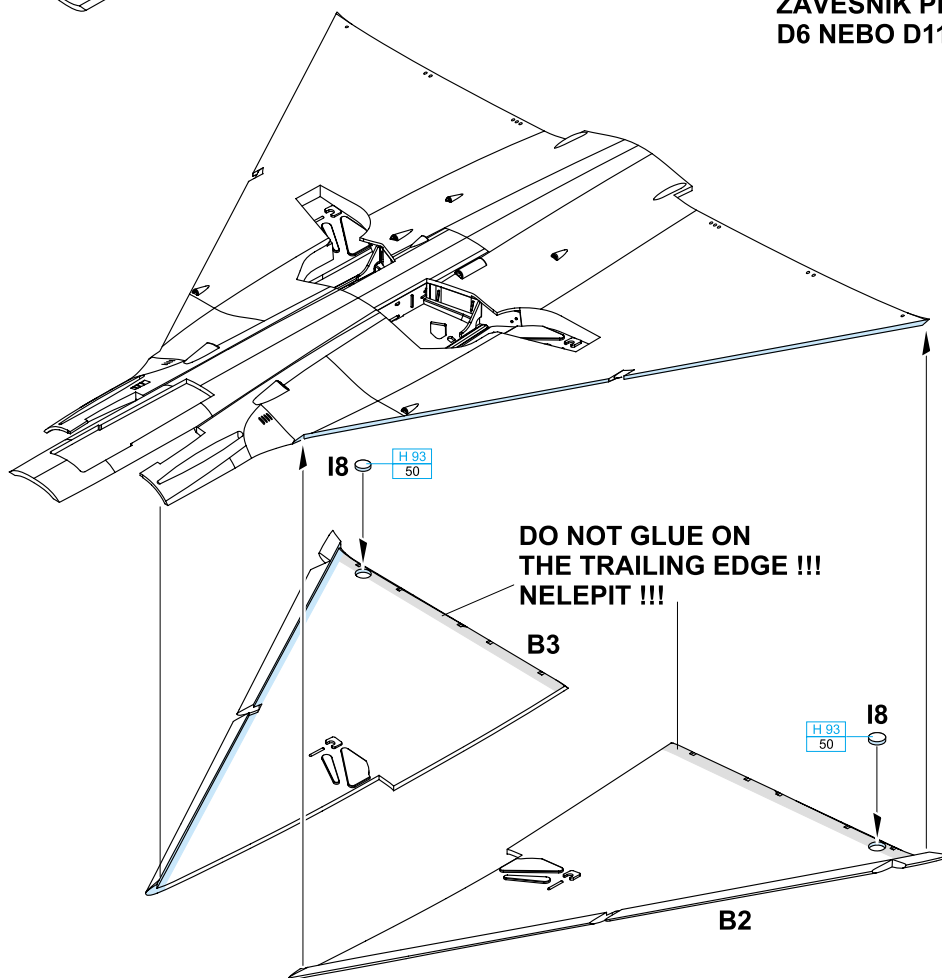

**DO NOT GLUE ON THE TRAILING EDGE !!!  
 NELEPIT !!!**

I8  
 H 93  
 50

# 4

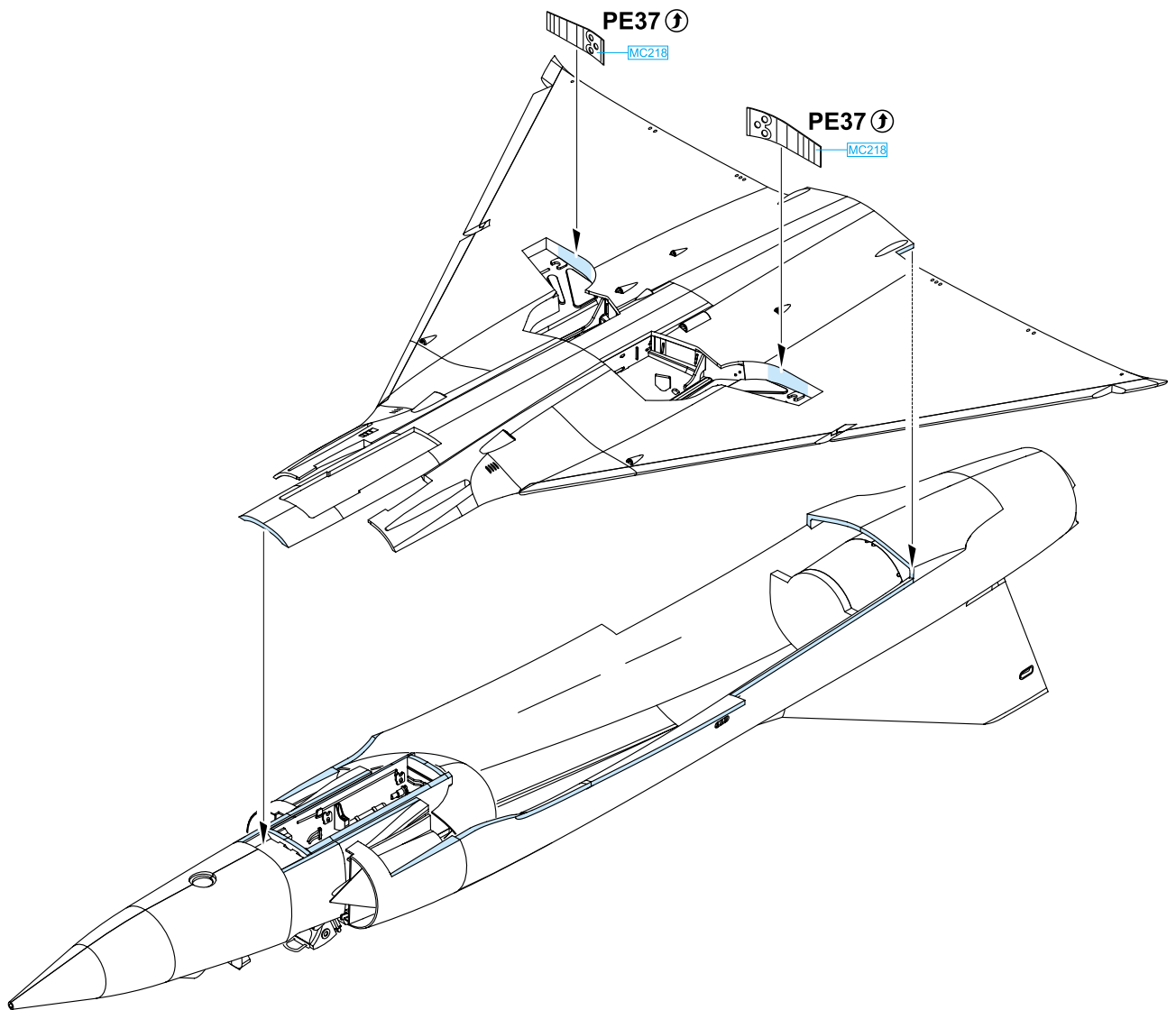
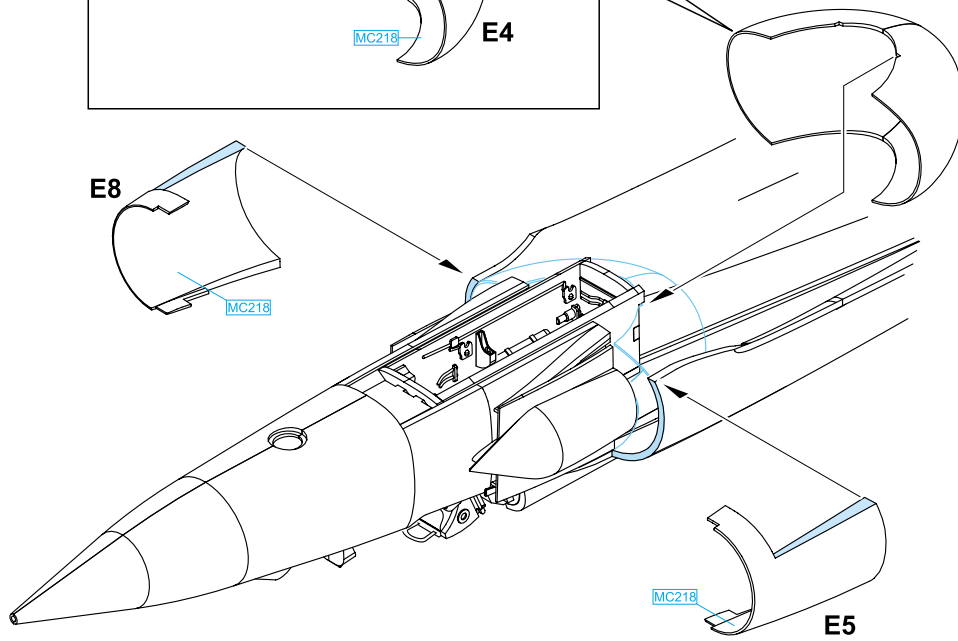
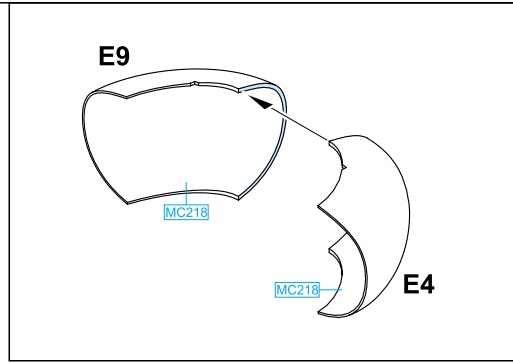

USE D5 IF AIM-9D SIDEWINDER PART G2  
OR MATRA ATM-9D WILL BE USED.  
SEE PAGE 11

D5- POKUD JE POUŽIT AIM-9D SIDEWINDER  
NEBO MATRA ATM-9D.  
VIZ. STR. 11

USE D5 IF AIM-9D SIDEWINDER PART G2  
OR MATRA ATM-9D WILL BE USED.  
SEE PAGE 11

D5- POKUD JE POUŽIT AIM-9D SIDEWINDER  
NEBO MATRA ATM-9D.  
VIZ. STR. 11

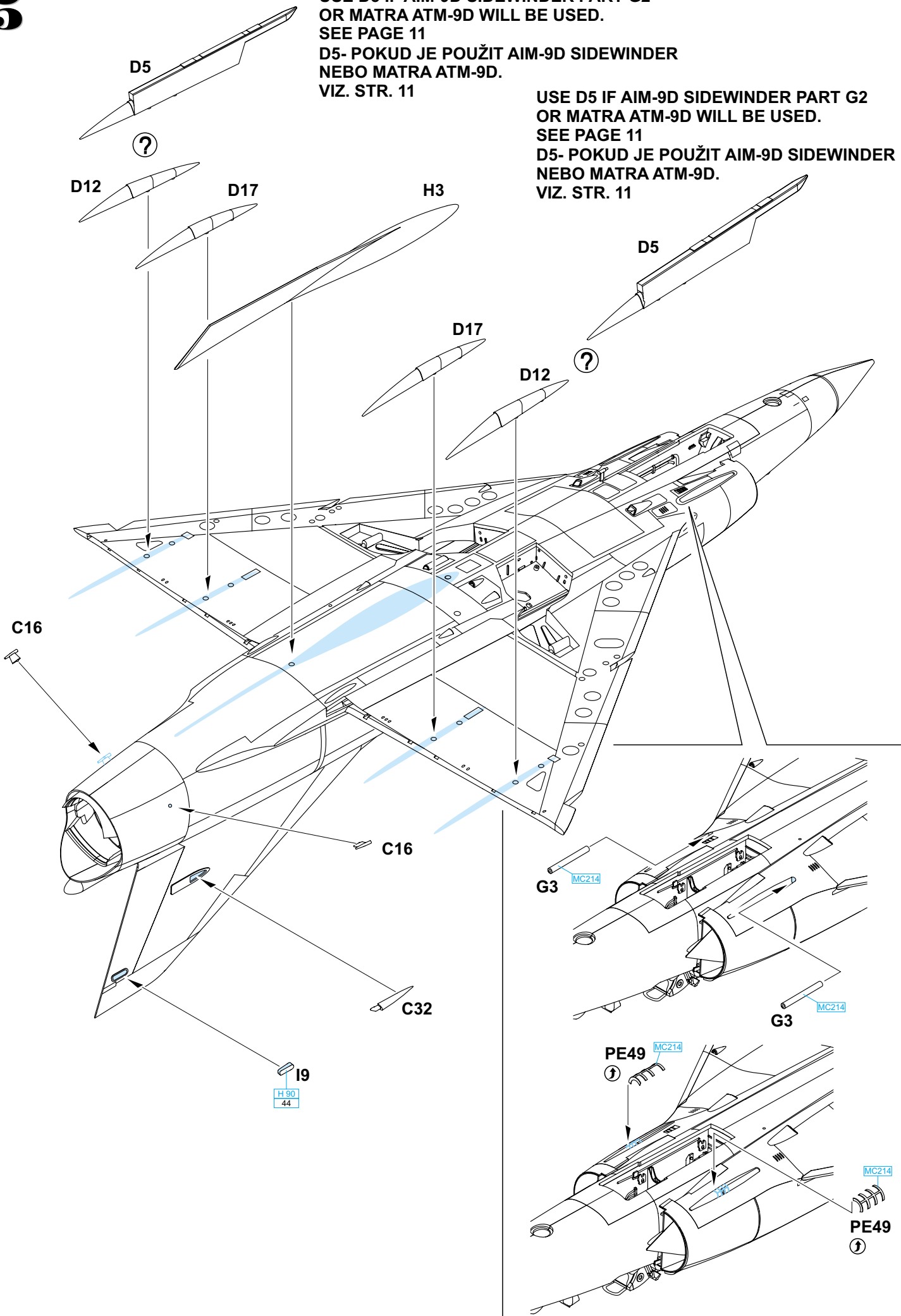

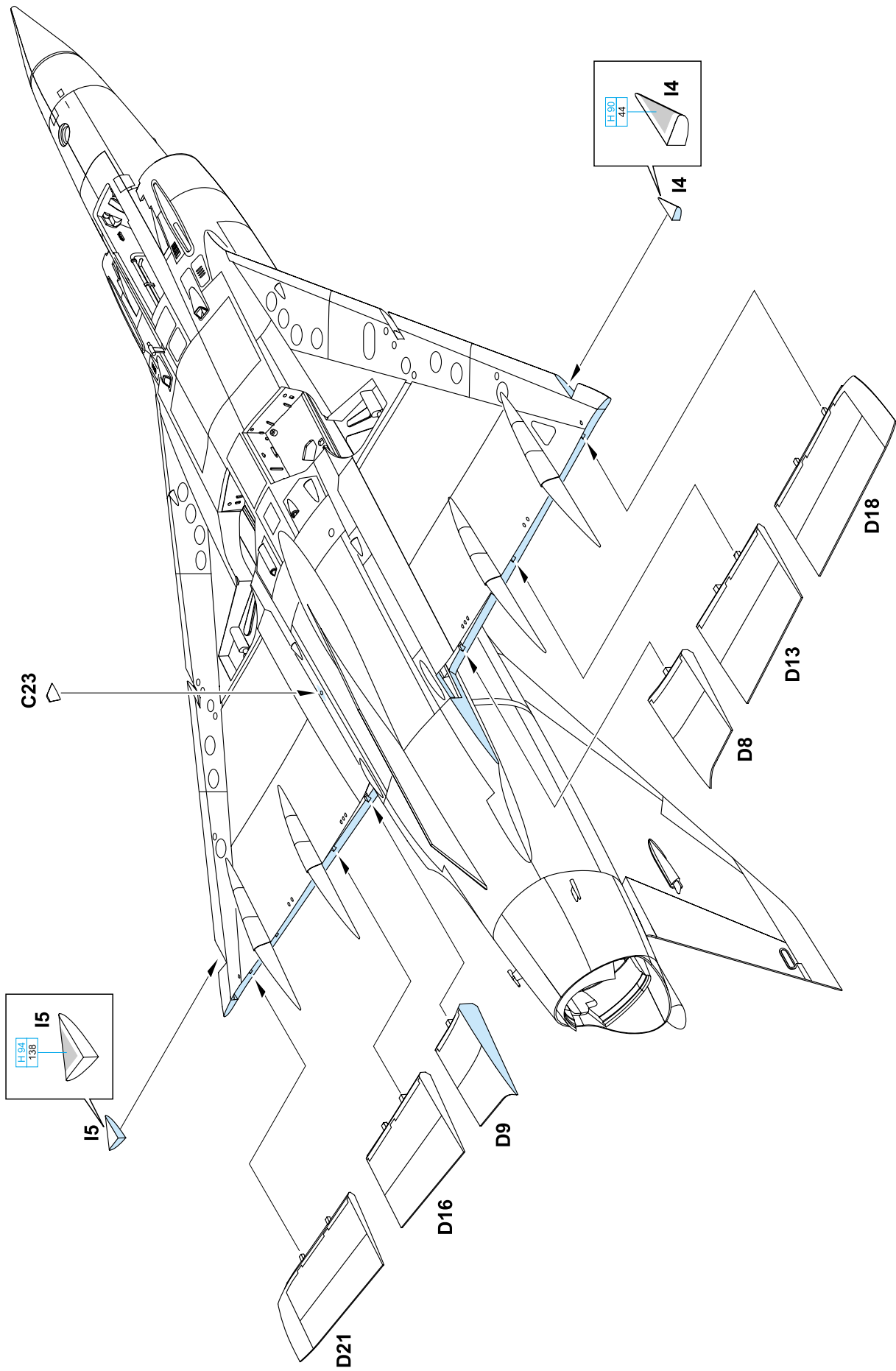

7

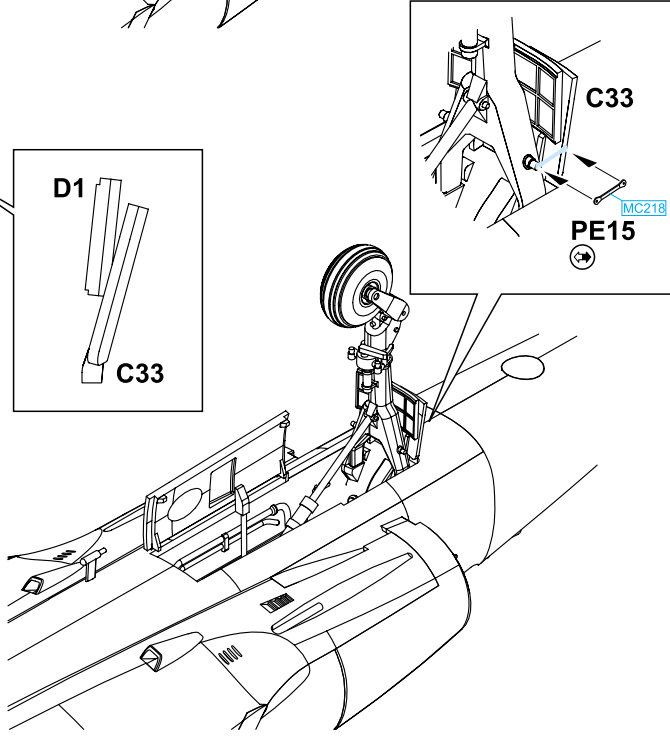
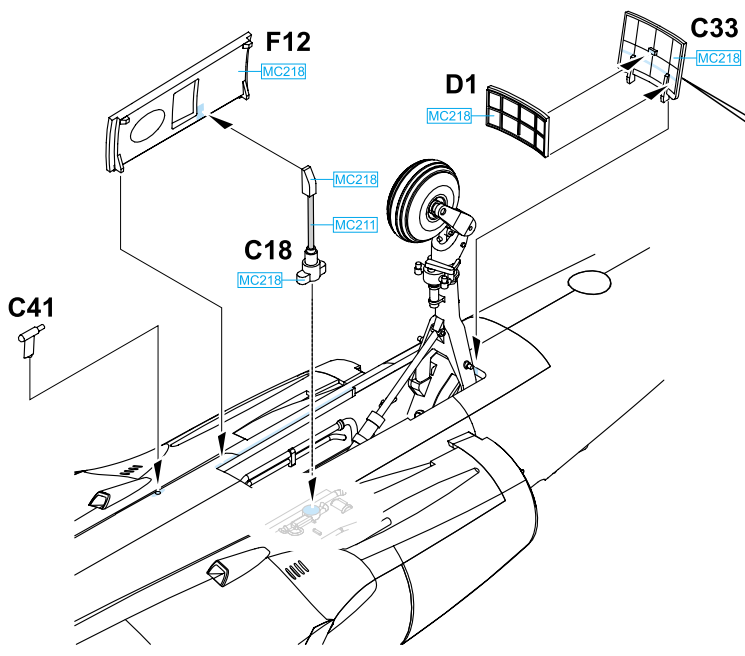
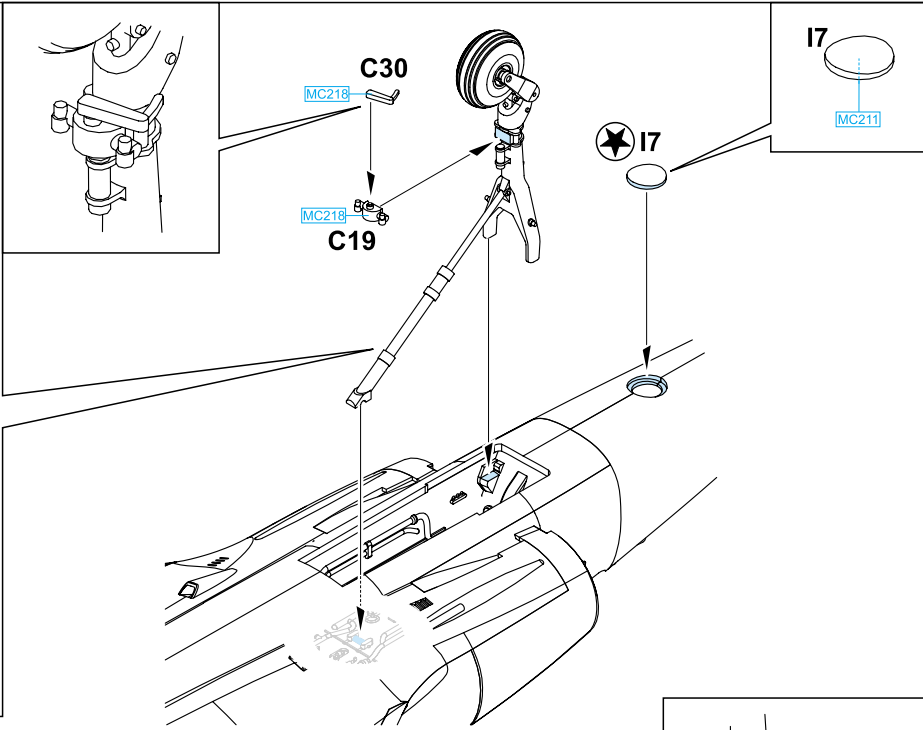
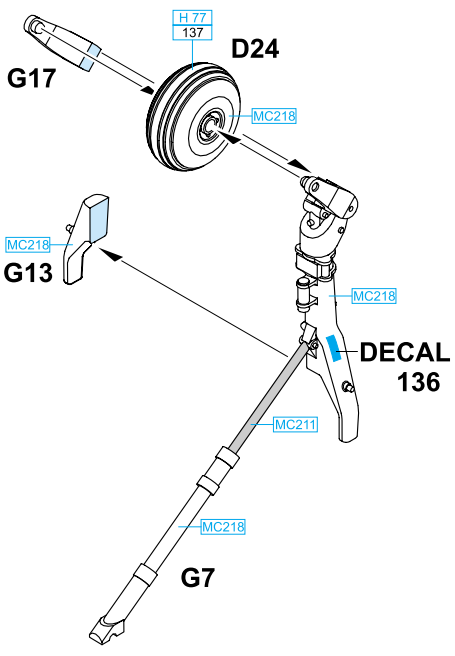

L

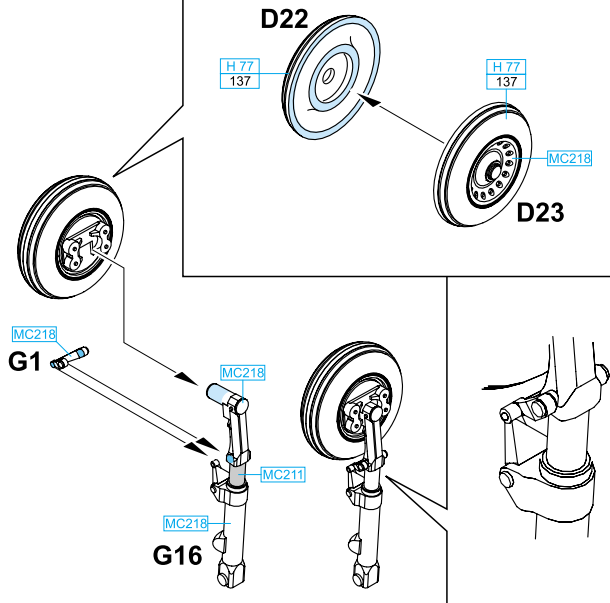

R

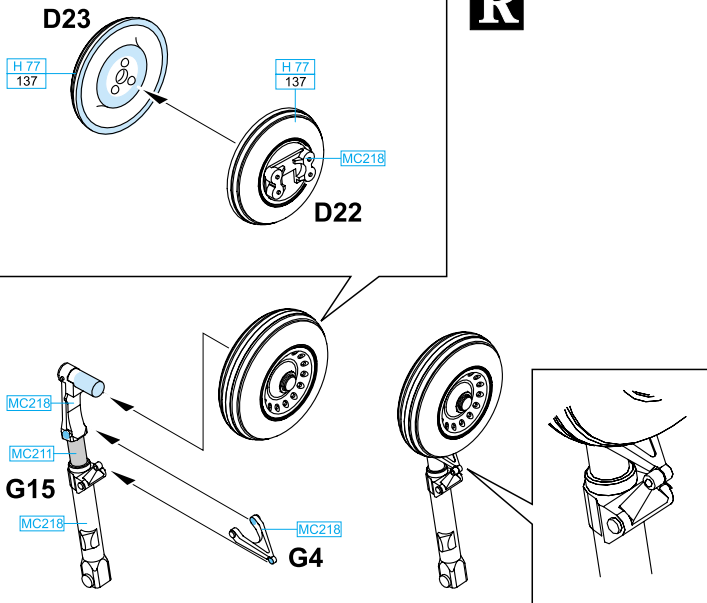



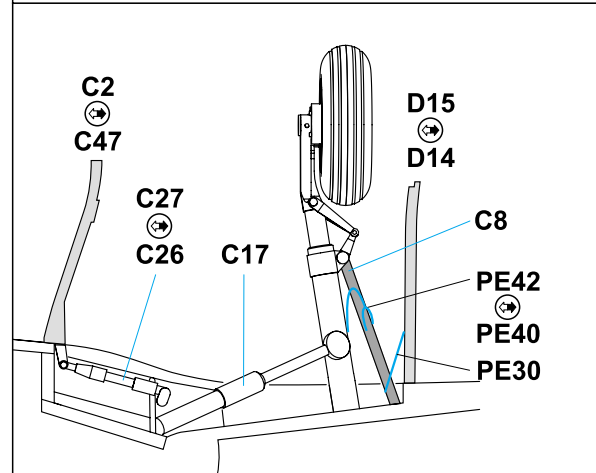
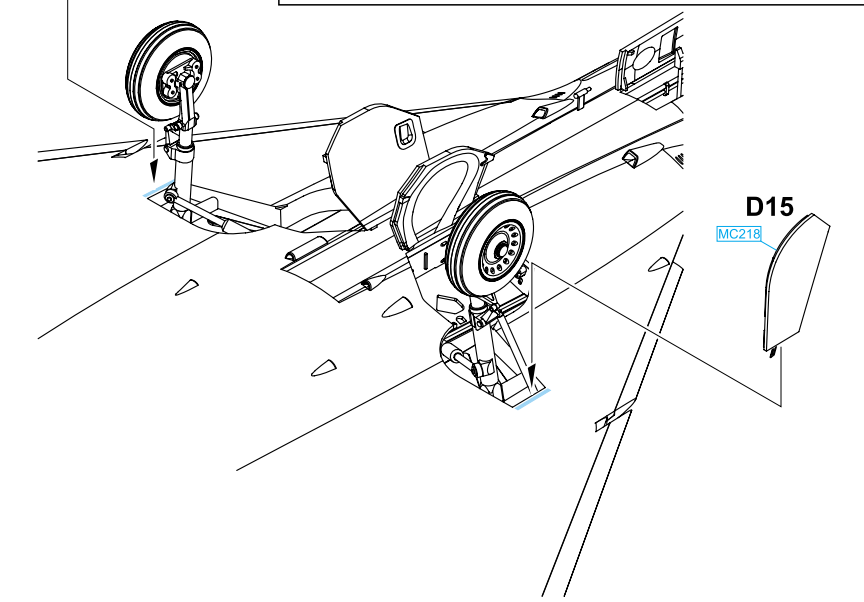
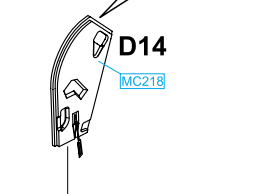
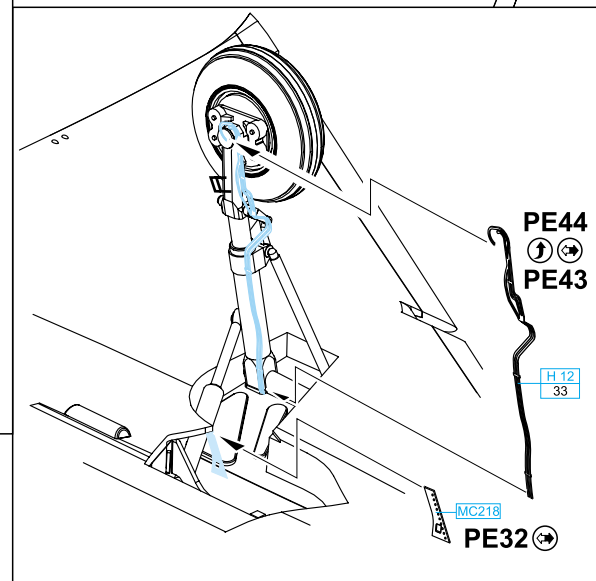
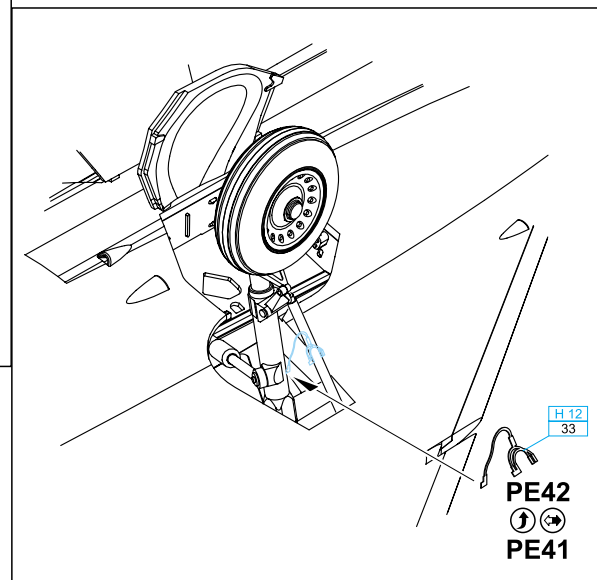
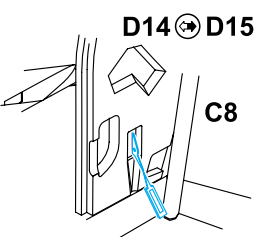
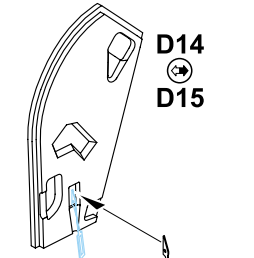
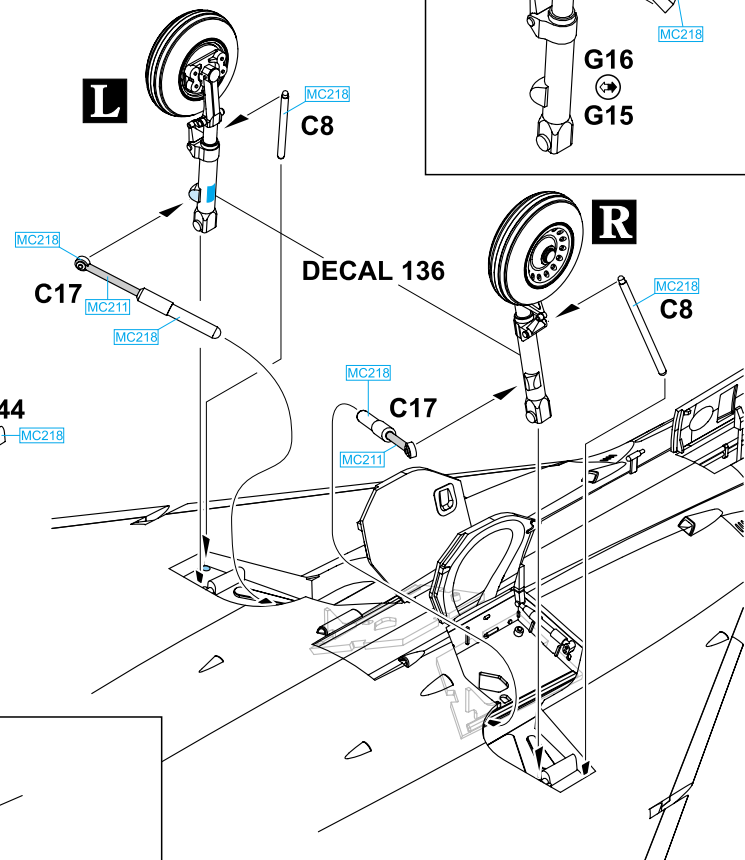
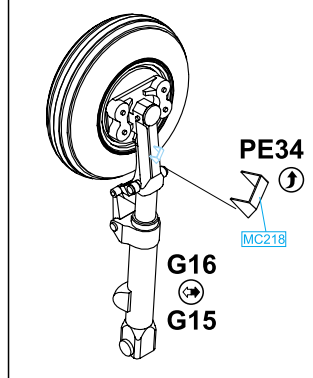
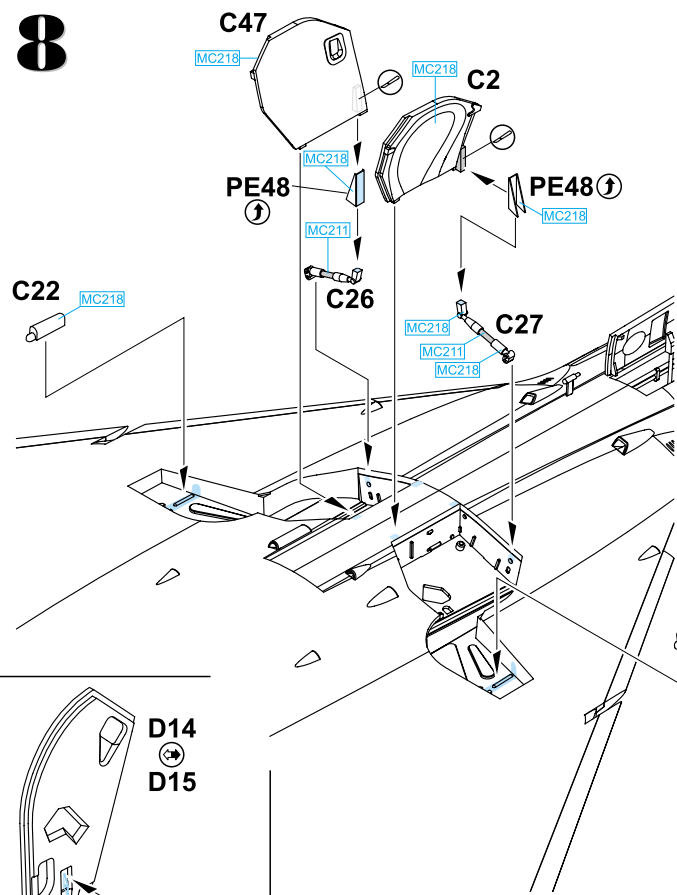



## ROCKET JL 100R 2 pcs.

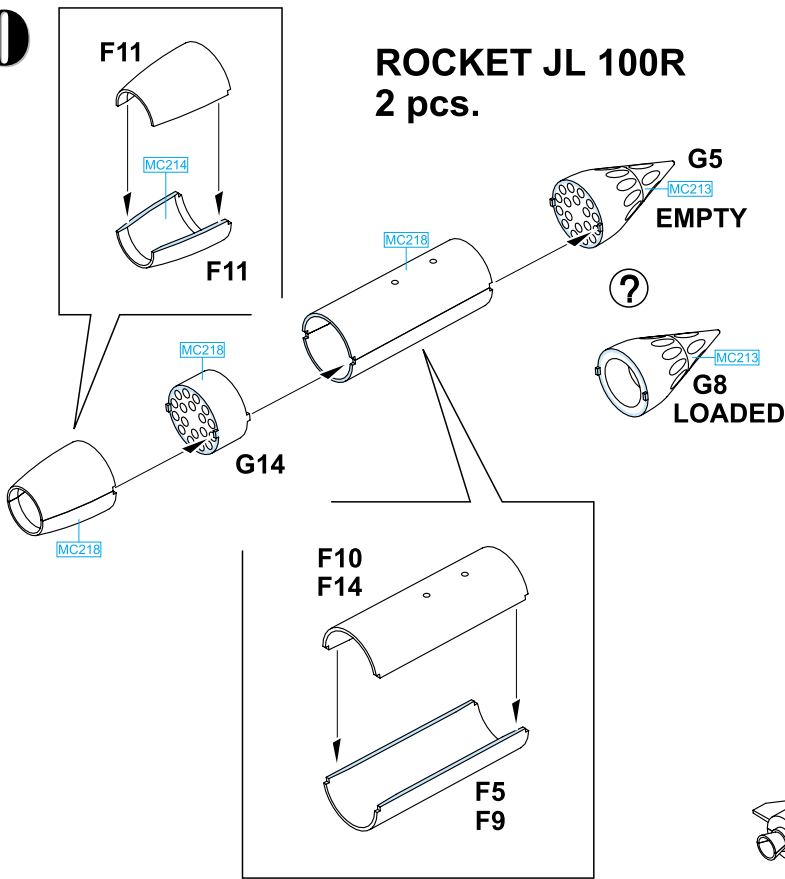

## MATRA 530C,K

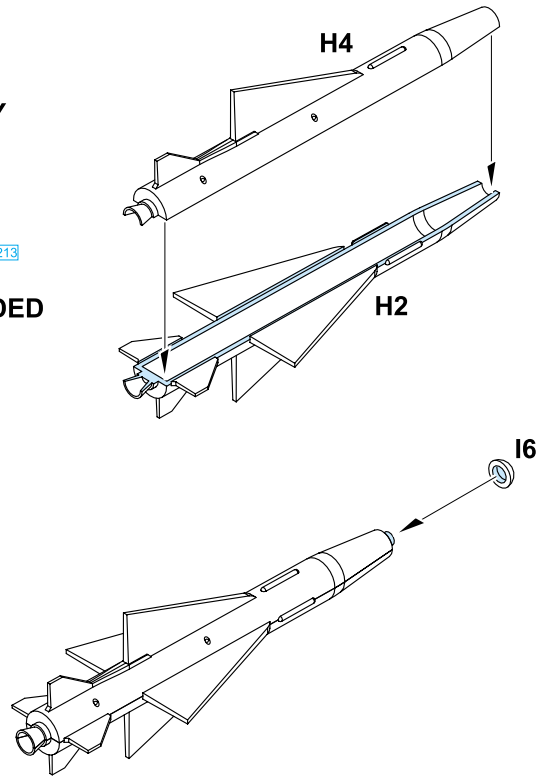

## MATRA ATM-9D 2 pcs.

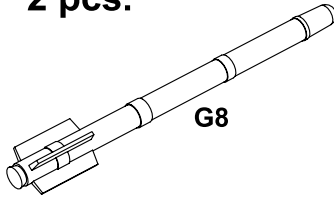

## MATRA 530E, M

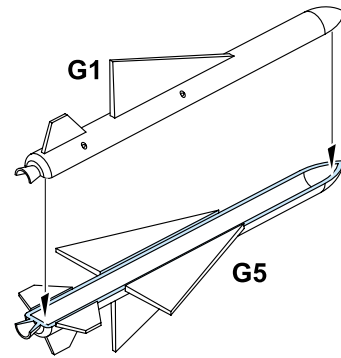

## AIM-9D SIDEWINDER 2 pcs.

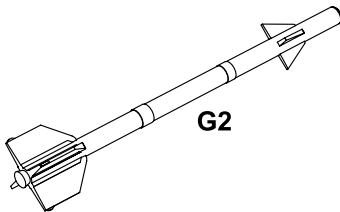

## EXTERNAL FUEL TANK- 625I 2 pcs.

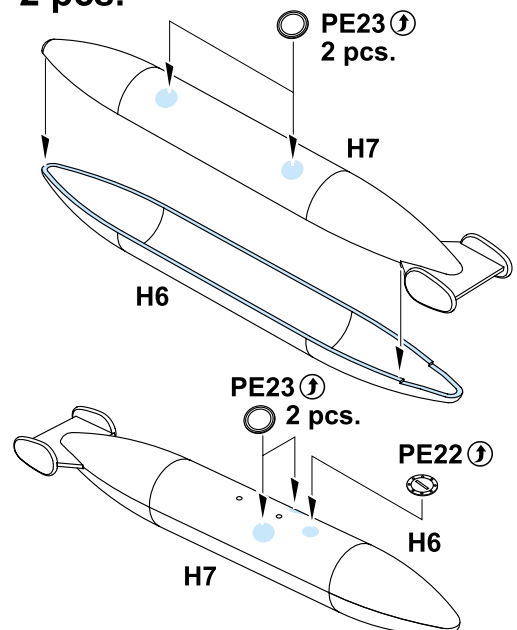

## EXTERNAL FUEL TANK- 500I 2 pcs.

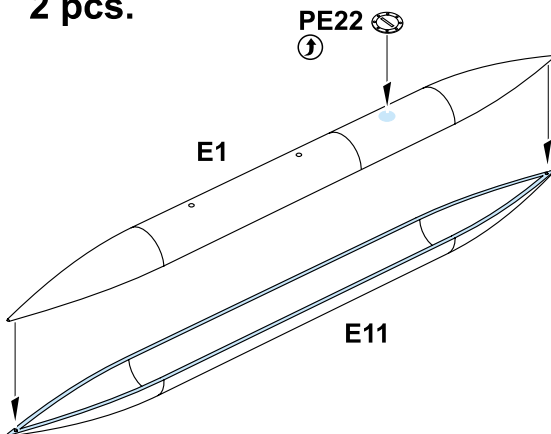

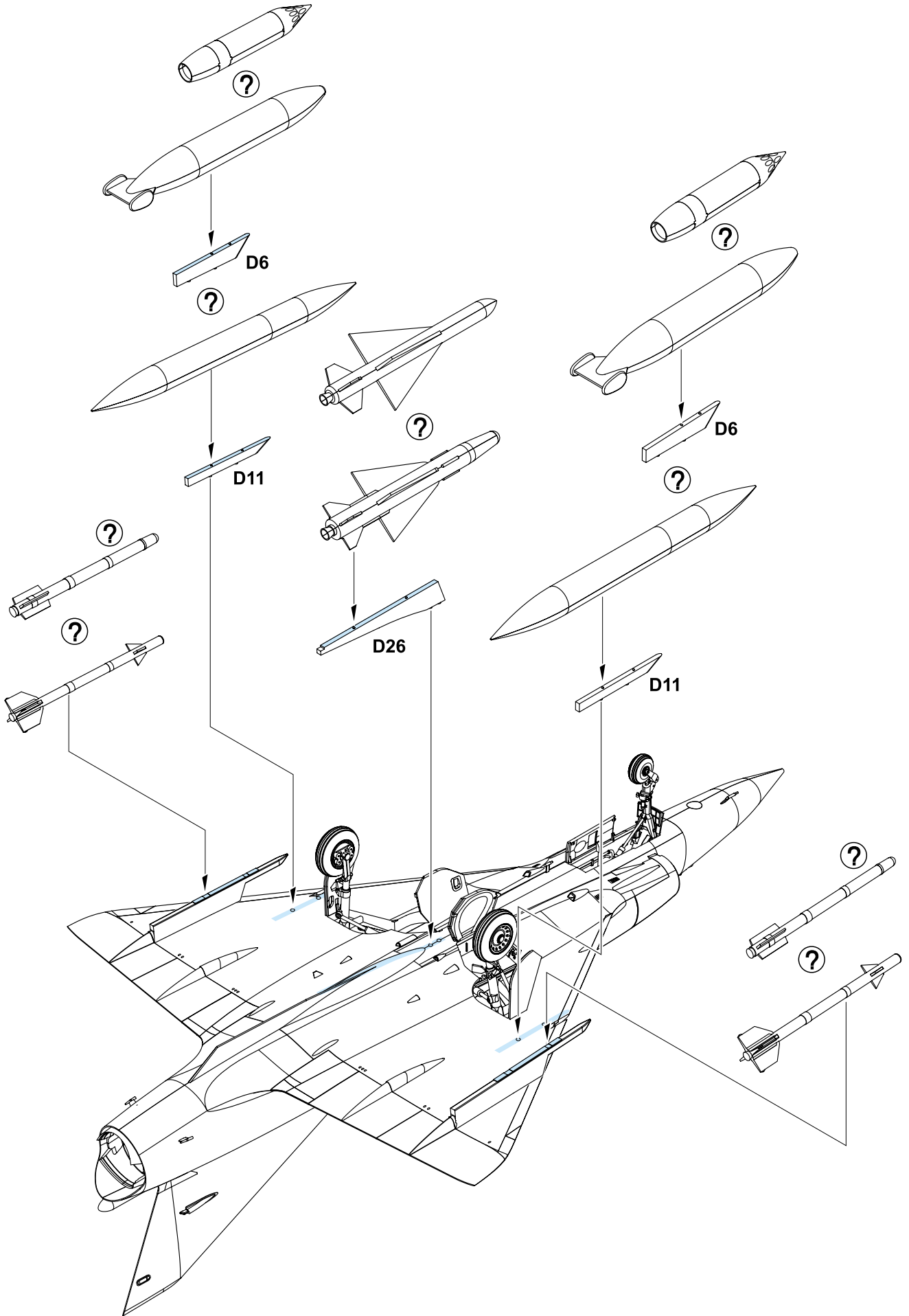

**MATRA 530C, K**

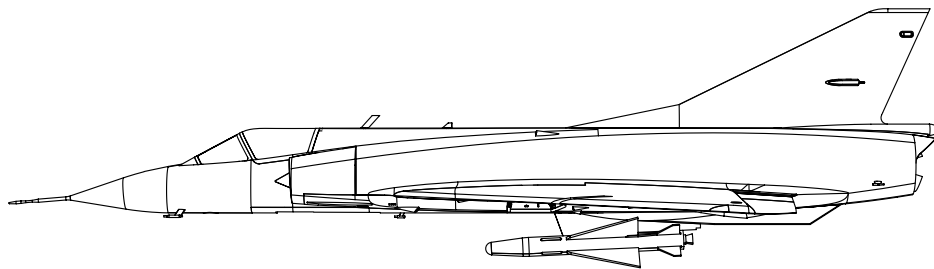

**AIM-9D SIDEWINDER**

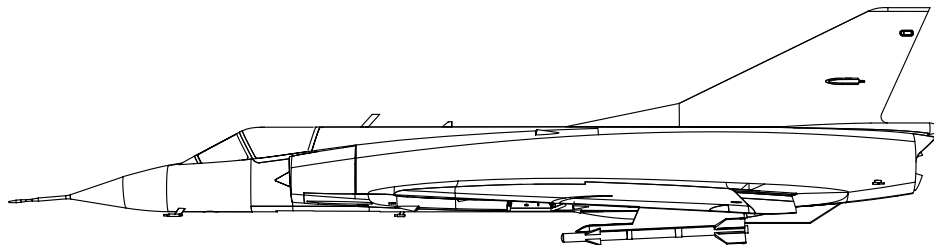

**EXTERNAL FUEL TANK- 500I**

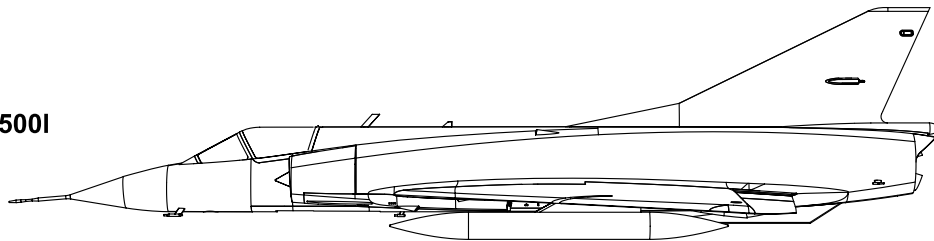

**EXTERNAL FUEL TANK- 625I**

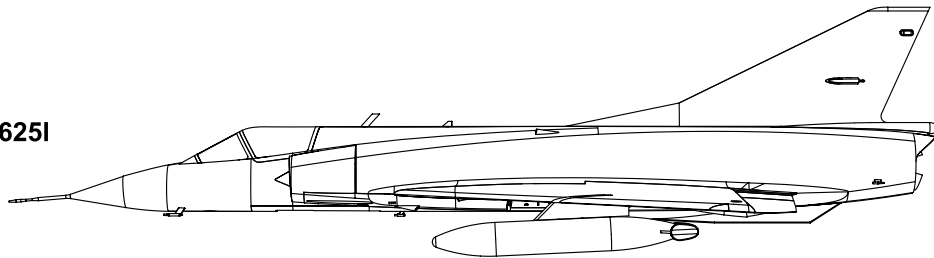

**ROCKET JL 100R**

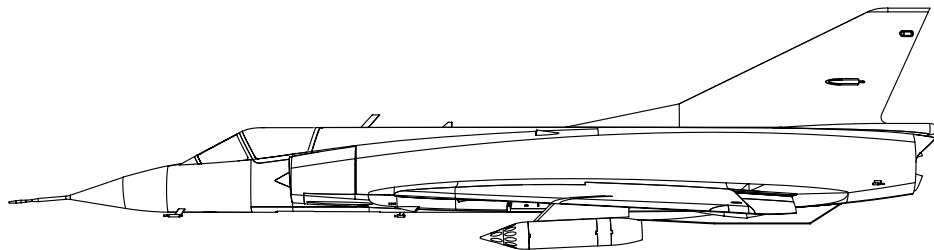

**MATRA ATM-9D**

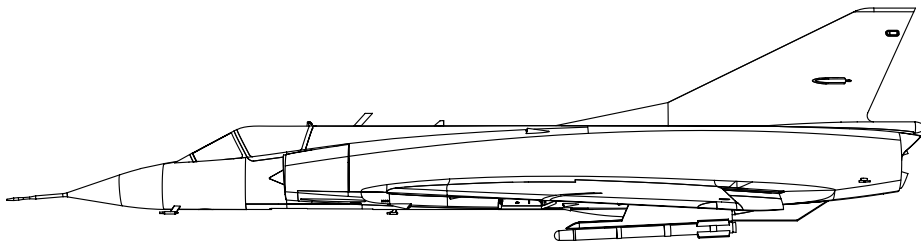

**MATRA 530E, M**

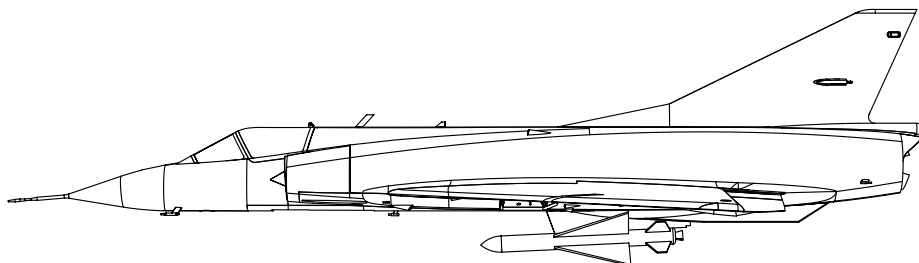

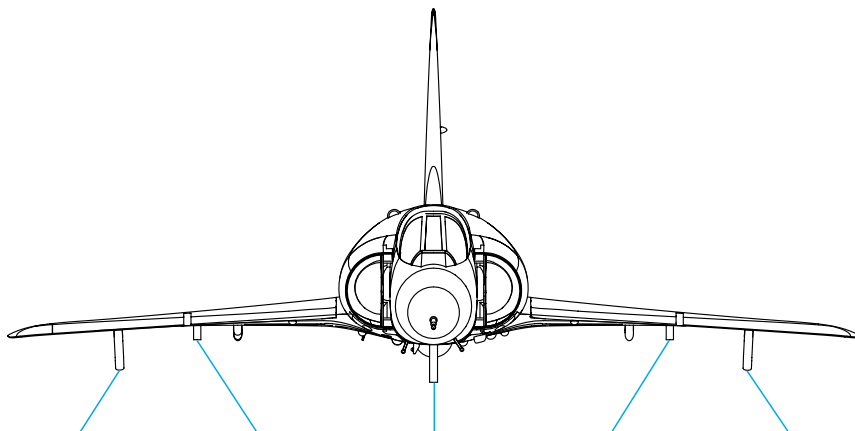

<b>MATRA 530C, K</b>					
<b>MATRA 530E, M</b>					
<b>FUEL TANK 500I</b>					
<b>FUEL TANK 625I</b>					
<b>ROCKET JL 100R</b>					
<b>AIM-9D SIDEWINDER</b>					
<b>MATRA ATM-9D</b>					

## COLOURS



## BARVY



## FARBEN



## PEINTURE



GUNZE		APPROXIMATE COLOR MATCH					
AQUEOUS	Mr.COLOR			TAMIYA	HUMBROL	REVELL	TESTORS
<a href="#">H 1</a>	<a href="#">1</a>	WHITE / WEIß / BLANC / BÍLÁ		X 2	22	4	1745
<a href="#">H 2</a>	<a href="#">2</a>	BLACK / SCHWARZ / NOIR / ČERNÁ		X 1	21	7	1747
<a href="#">H 3</a>	<a href="#">3</a>	RED / ROT / ROUGE / ČERVENÁ		X 7	19	31	1503
<a href="#">H 4</a>	<a href="#">4</a>	YELLOW / GELB / JUANE / ŽLUTÁ		X 8	69	12	1514
<a href="#">H 5</a>	<a href="#">5</a>	BLUE / BLAU / BLEU / MODRÁ		X 3	15	54	
<a href="#">H 11</a>	<a href="#">62</a>	WHITE / WEIß / BLANC / BÍLÁ		XF 2	34	5	1768
<a href="#">H 12</a>	<a href="#">33</a>	BLACK / SCHWARZ / NOIR / ČERNÁ		XF 1	33	8	1749
<a href="#">H 24</a>	<a href="#">58</a>	ORANGE / ORANGE / ORANGE / ORANŽOVÁ			169		
<a href="#">H 26</a>	<a href="#">66</a>	GREEN / GRÜN / VERT / ZELENÁ			2	61	1524
<a href="#">H 44</a>	<a href="#">51</a>	FLESH / HAUTFARBE / CHAIR MATT / BARVA PLETI		XF 15	61	35	1516
<a href="#">H 45</a>	<a href="#">323</a>	LIGHT BLUE / HELL BLAU / BLEU AVION / SVĚTLE MODRÁ		XF 15	47	50	1508
<a href="#">H 47</a>	<a href="#">41</a>	RED- BROWN / TARN- ROTBRAUN / BRUN- ROUGE / ČERVENOHNĚDÁ		XF 64	160	383	
<a href="#">H 51</a>	<a href="#">11</a>	GREY / GRAU / GRIS / ŠEDÁ					1729
<a href="#">H 52</a>	<a href="#">12</a>	OLIVE DRAB / OLIV GRÜN / OLIVE / OLIVOVÁ			155		1711
<a href="#">H 58</a>	<a href="#">27</a>	ZINC- CHROMATE / INNEN GRÜN / ŽLUTOZELENÁ			151		1715
<a href="#">H 67</a>	<a href="#">115</a>	LIGHT BLUE / HELL BLAU / BLEU AVION / SVĚTLE MODRÁ	FS 35622	XF 21	65	55	2078
<a href="#">H 72</a>	<a href="#">22</a>	BROWN / BRAUN / BRUN / HNĚDÁ		XF 52	29	87	
<a href="#">H 73</a>	<a href="#">22</a>	DARK GREEN / DUNKEL GRÜN / VERT FONCÉ / TMAVĚ ZELENÁ	FS 30219	XF 26	30		2027
<a href="#">H 77</a>	<a href="#">137</a>	TIRE BLACK / REIFEN SCHWARZ / PNEU NOIR / BARVA PNEUMATIK		X 1	182	8	2040
<a href="#">H 79</a>	<a href="#">39</a>	SAND / SAND / SABLE / PÍSKOVÁ		XF 59	93	16	
<a href="#">H 81</a>	<a href="#">55</a>	KHAKI / KHAKI / KAKI / KHAKI			26	380	2099
<a href="#">H 90</a>	<a href="#">44</a>	CLEAR RED / ROT REIN / ROUGE / ČERVENÁ		X 27	1321	731	
<a href="#">H 93</a>	<a href="#">50</a>	CLEAR BLUE / BLAU REIN / BLEU / MODRÁ		X 23	1320	752	
<a href="#">H 94</a>	<a href="#">138</a>	CLEAR GREEN / GRÜN / REIN / VERT / ZELENÁ		X 25	1325		
<a href="#">H 95</a>	<a href="#">101</a>	SMOKE GRAY / RAUCH GRAU / GRIS / ŠEDÁ		X 19	1324		
<a href="#">H 312</a>	<a href="#">312</a>	GREEN / GRÜN / VERT / ZELENÁ	FS 34227		120		1716
<a href="#">H 318</a>	<a href="#">318</a>	CHROMATE YELLOW / RADOME / RADOME / CHROMOVĚ ŽLUTÁ			148		1709
<a href="#">H 331</a>	<a href="#">331</a>	DARK SEA GRAY / SEEGRAU / GRIS MER / ŠEDÁ			164		
<a href="#">H 337</a>	<a href="#">337</a>	BLUE GRAY / GRAU BLAU / BLEU- GRIS / ŠEDOMODRÁ			145		1721
<a href="#">H 338</a>	<a href="#">338</a>	LIGHT GRAY / HELL GRAU / GRIS METAL / SVĚTLE ŠEDÁ		XF 14	147		1732
Mr.METAL COLOR							
<a href="#">MC 211</a>		CHROM SILVER / CHROMSILBER / CRÓMÉ / CHROM		X 11	11	90	1290
<a href="#">MC 213</a>		STEEL / STAHL / ACIER / OCEL		XF 16	53 + 56	91	1780
<a href="#">MC 214</a>		GUN METAL / STAHLBLAU / GRIS METAL / DĚLOVINA		X 10	53		1795
<a href="#">MC 218</a>		ALUMINIUM / ALUMINIUM / ALUMINIUM / HLINÍK		XF 56	56	99	1781

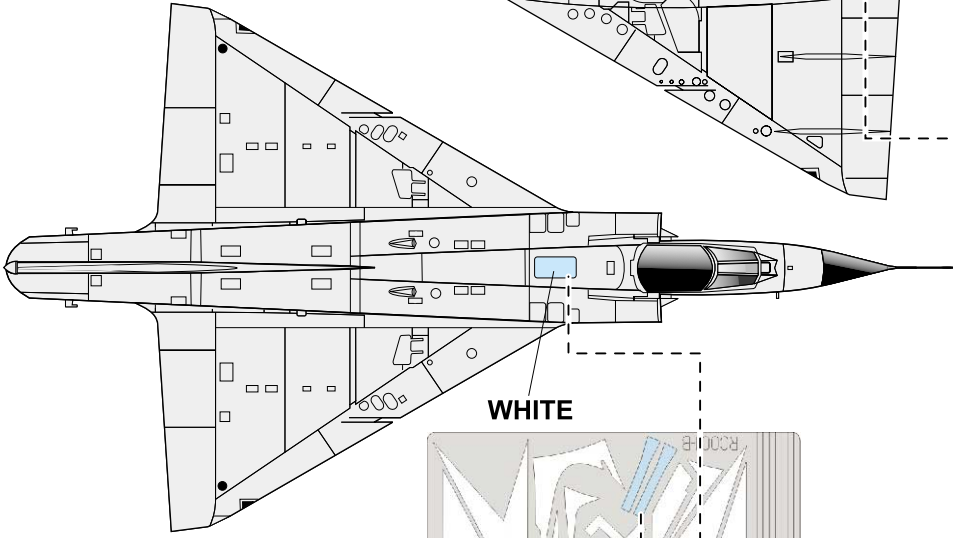
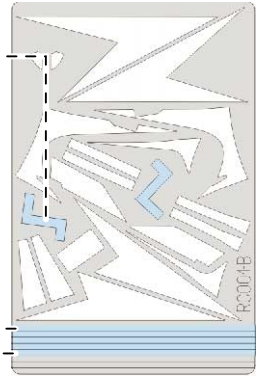
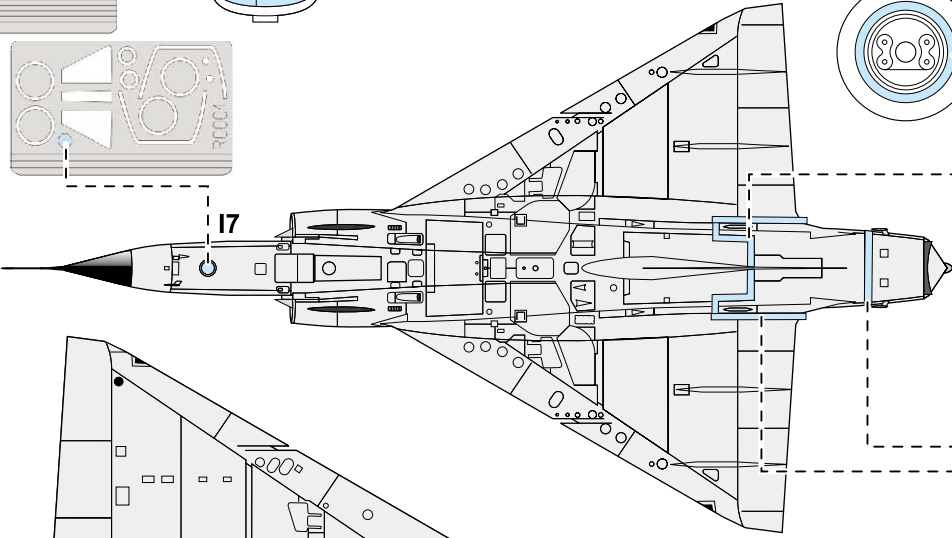
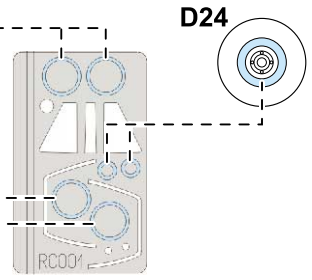
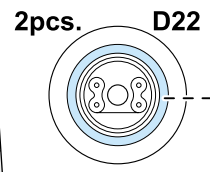
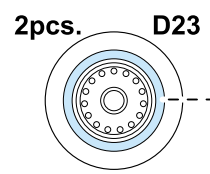
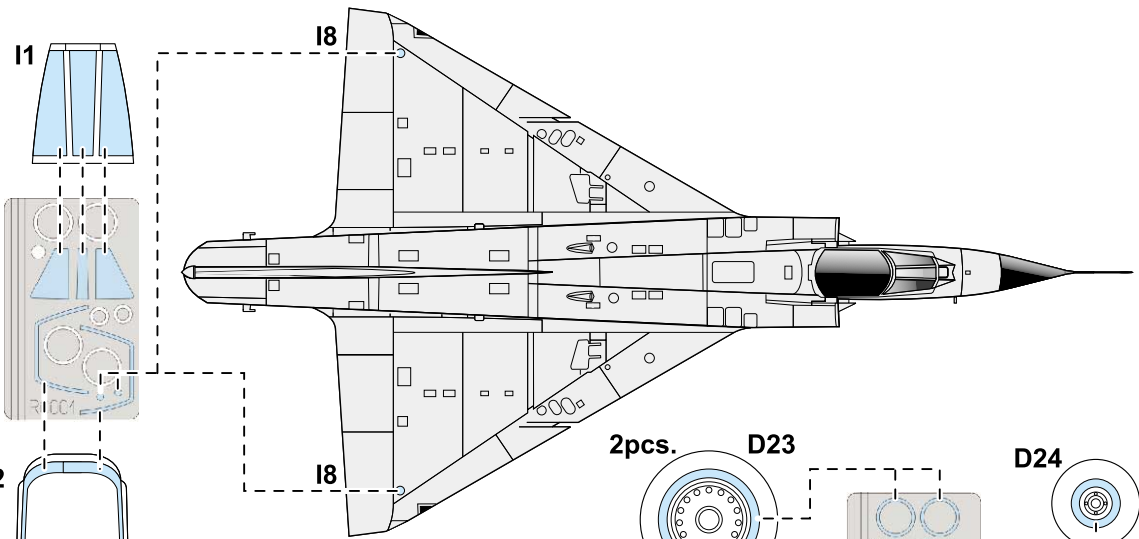
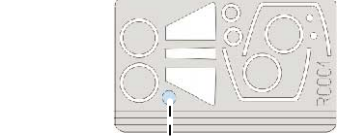
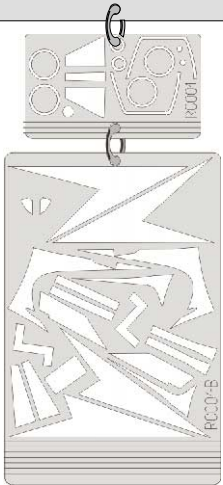

**8102 - MARKING B**

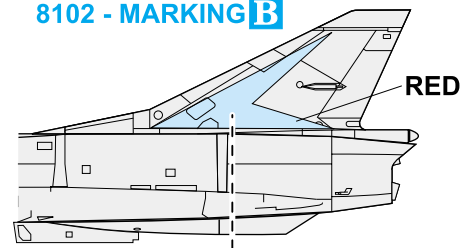

**RED**

**WHITE**

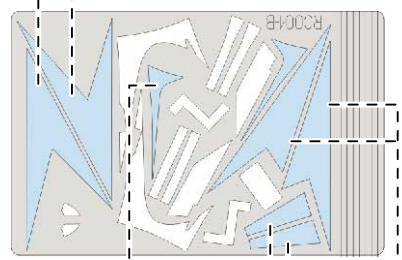
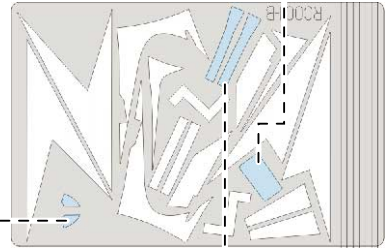

**8100 - MARKING A**

**WHITE**

**A**

**RED**

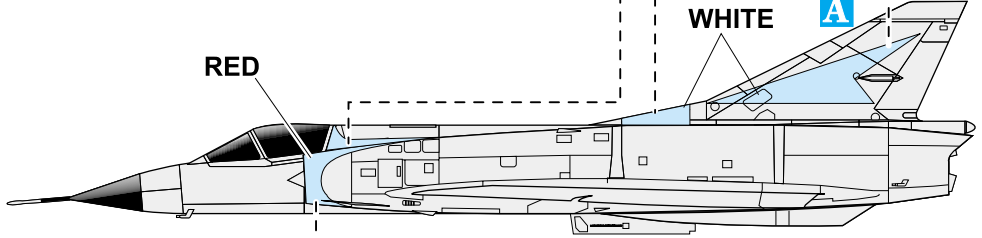
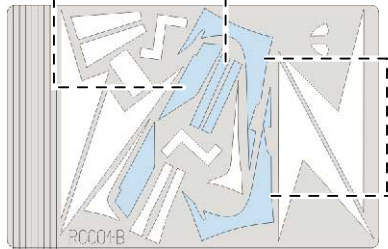
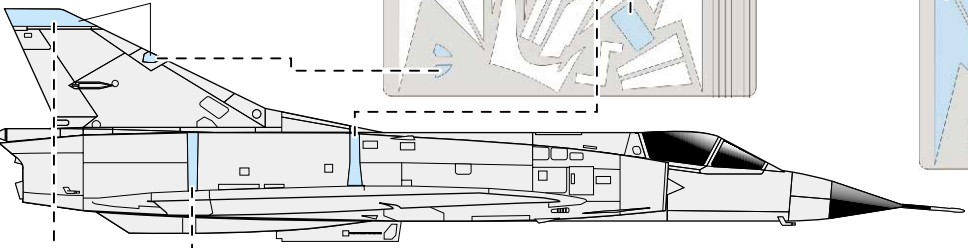

A MIRAGE III C, No.92, EC 02/ 010, Seine, Armée de l' Air, BA 120 Cazaux, April 1976

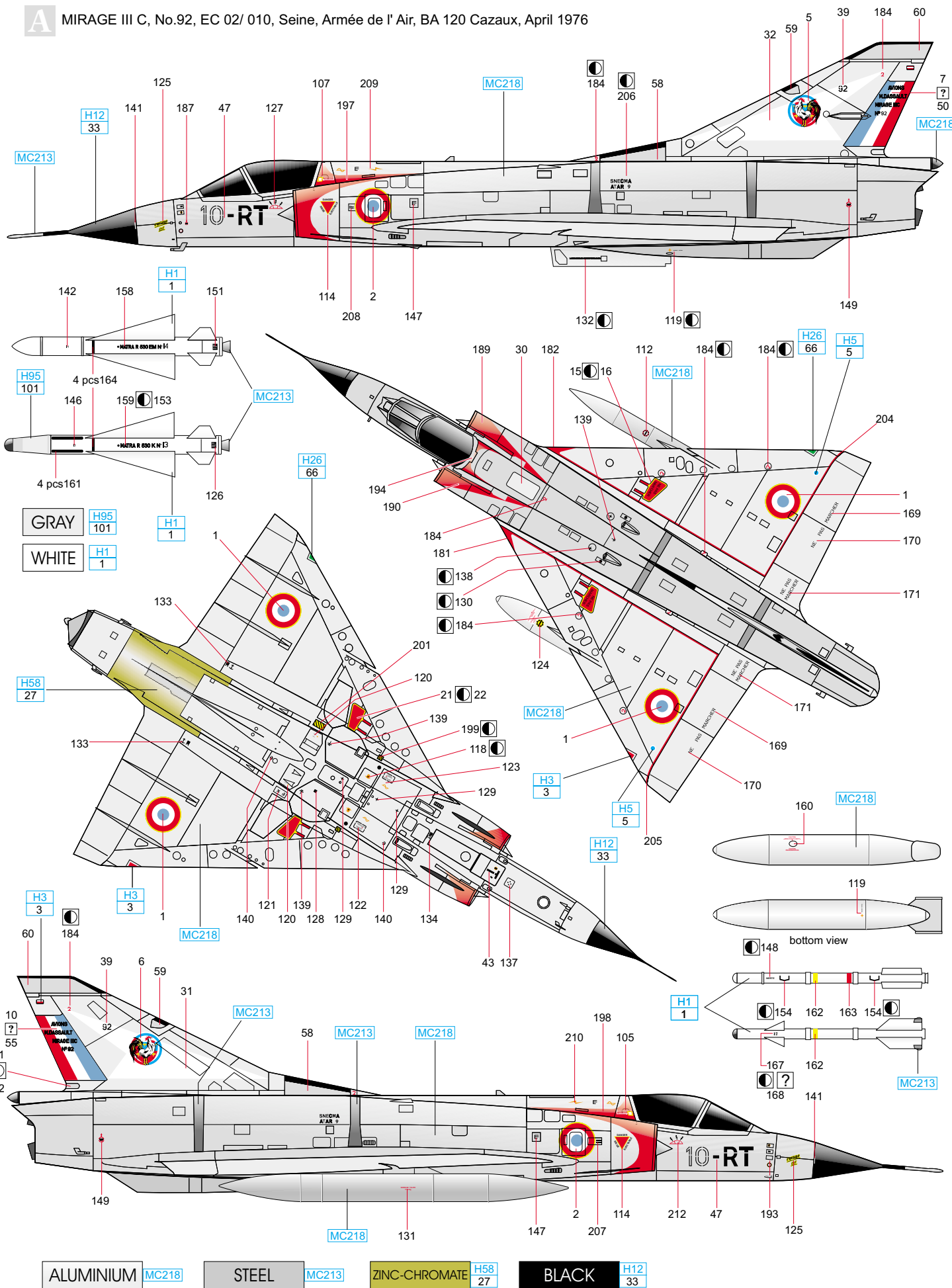

ALUMINIUM MC218 STEEL MC213 ZINC-CHROMATE H58 27 BLACK H12 33



**B** MIRAGE III C, No.50, EC 02/013 Alpes, Armée de l'Air, BA132 Colmar, 1963

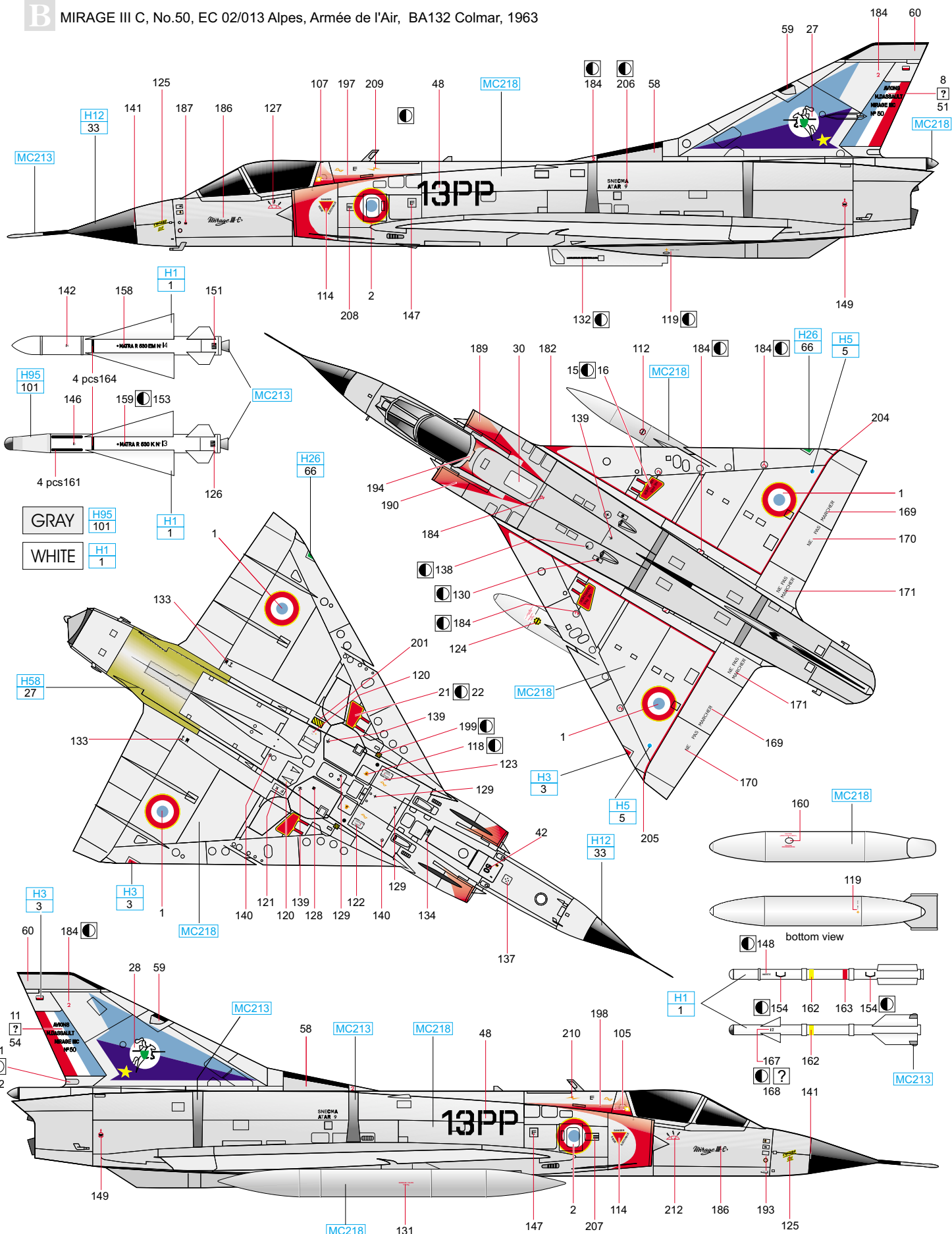

GRAY H95 101  
 WHITE H1 1

H3 3

H1 1

ALUMINIUM MC218 STEEL MC213 ZINC-CHROMATE H58 27 BLACK H12 33

\* MARKING & PAINTING \*      \* MARKIERUNGEN UND BEMALUNG \*  
 DECORATION ET PEINTURE      8100      OZNAČENÍ A ZBARVENÍ

**C** MIRAGE III C, No.31, EC 02/ 010, Seine, Armée de l' Air, BA 120 Creil, May 1978

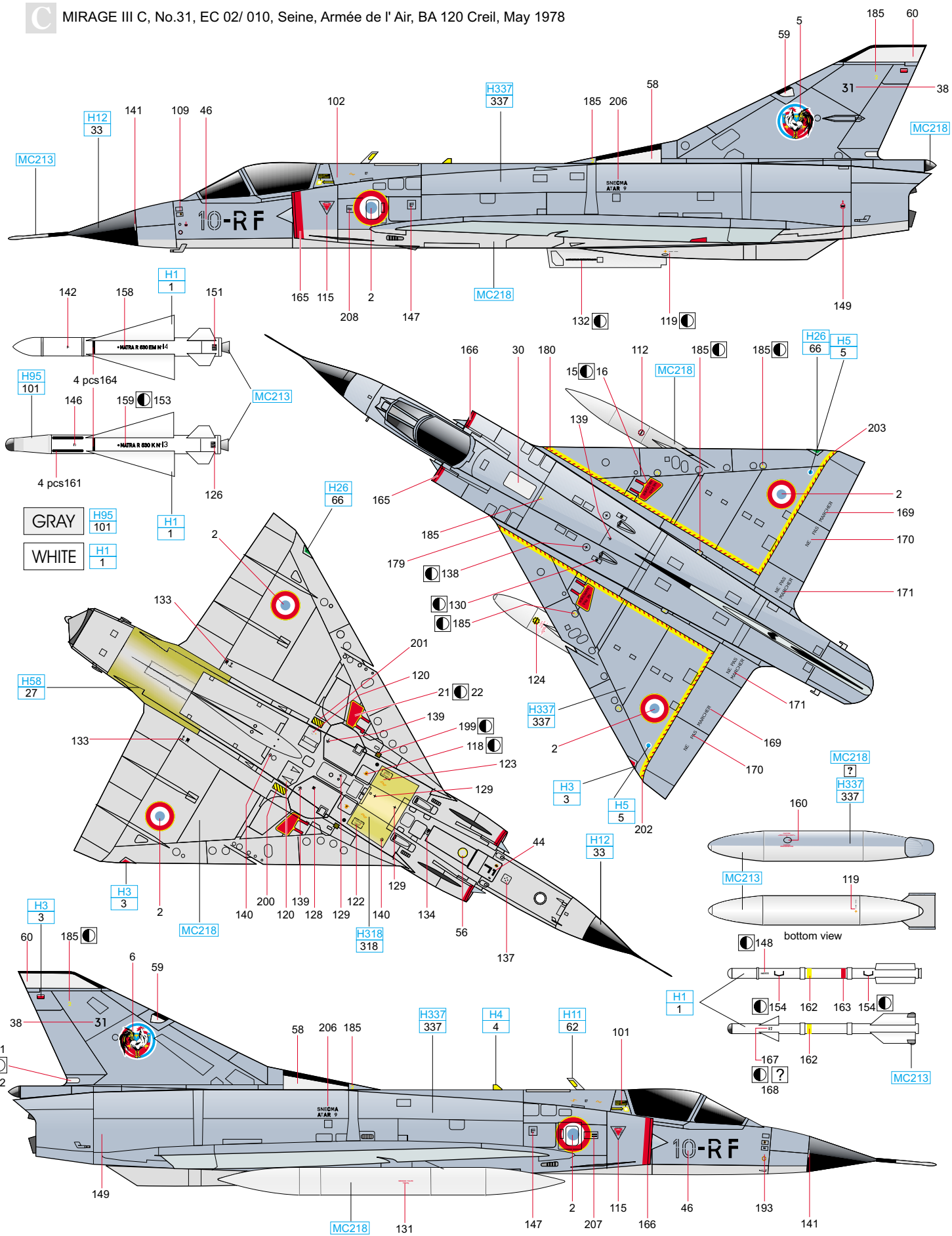

- BLACK      H12 33
- ALUMINIUM      MC218
- ALUMINIUM MATT      MC213
- ZINC-CHROMATE      H58 27
- CHROMATE YELLOW      H318 318
- BLUE GRAY      H337 337

**D** MIRAGE III C No.87, EC 03/010 Vexin, Détachement Air 188, Armée de l'Air, Djibouti, Oktober 1984

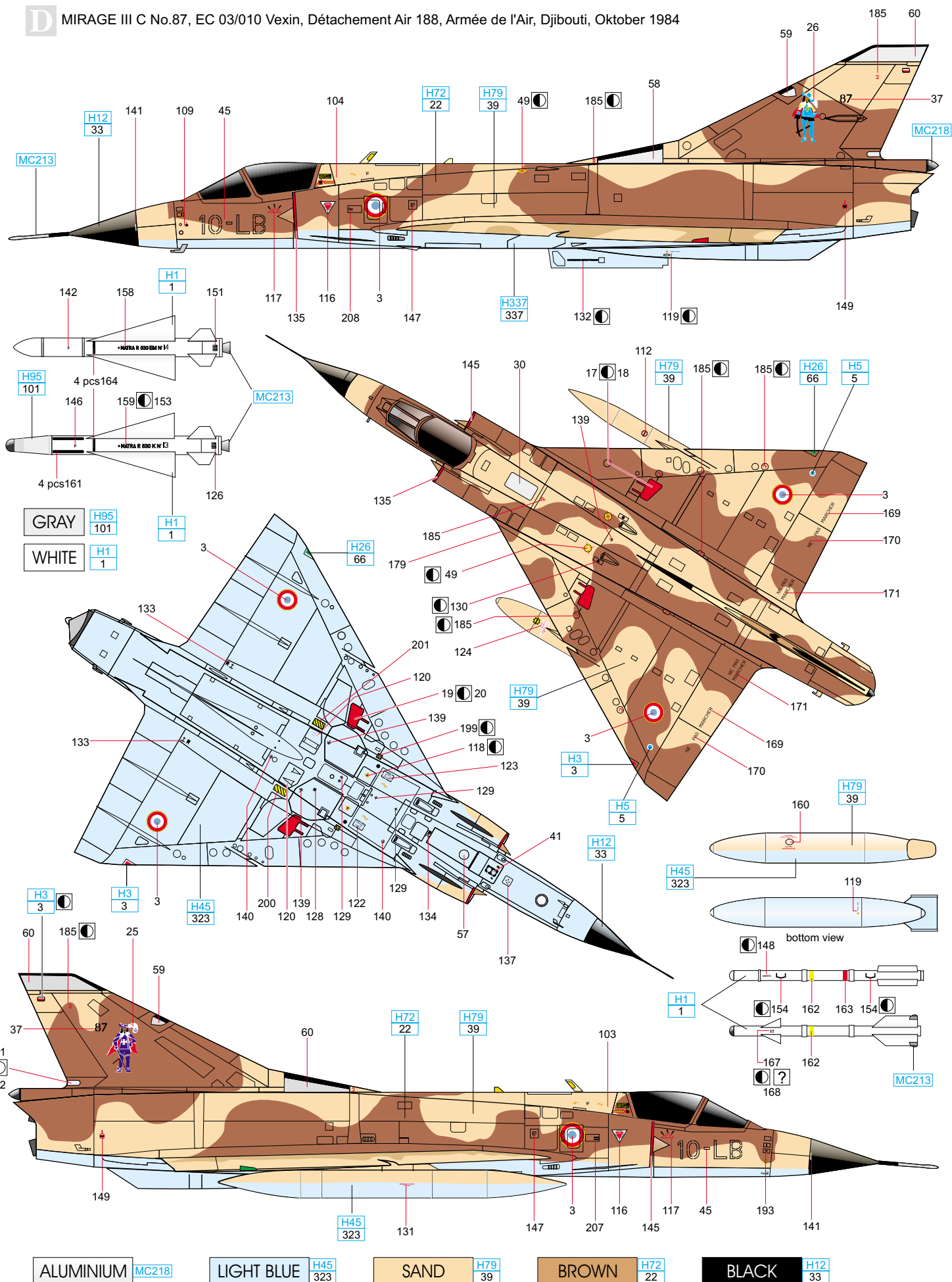

ALUMINIUM MC218

LIGHT BLUE H45 323

SAND H79 39

BROWN H72 22

BLACK H12 33



\* MARKING & PAINTING \* MARKIERUNGEN UND BEMALUNG \*  
 DECORATION ET PEINTURE 8101 OZNAČENÍ A ZBARVENÍ

A MIRAGE III C No.28, EC 01/002, SPA 3 - Cigognes, Armée de l'Air, Base Aérienne 102 Dijon, February 1964

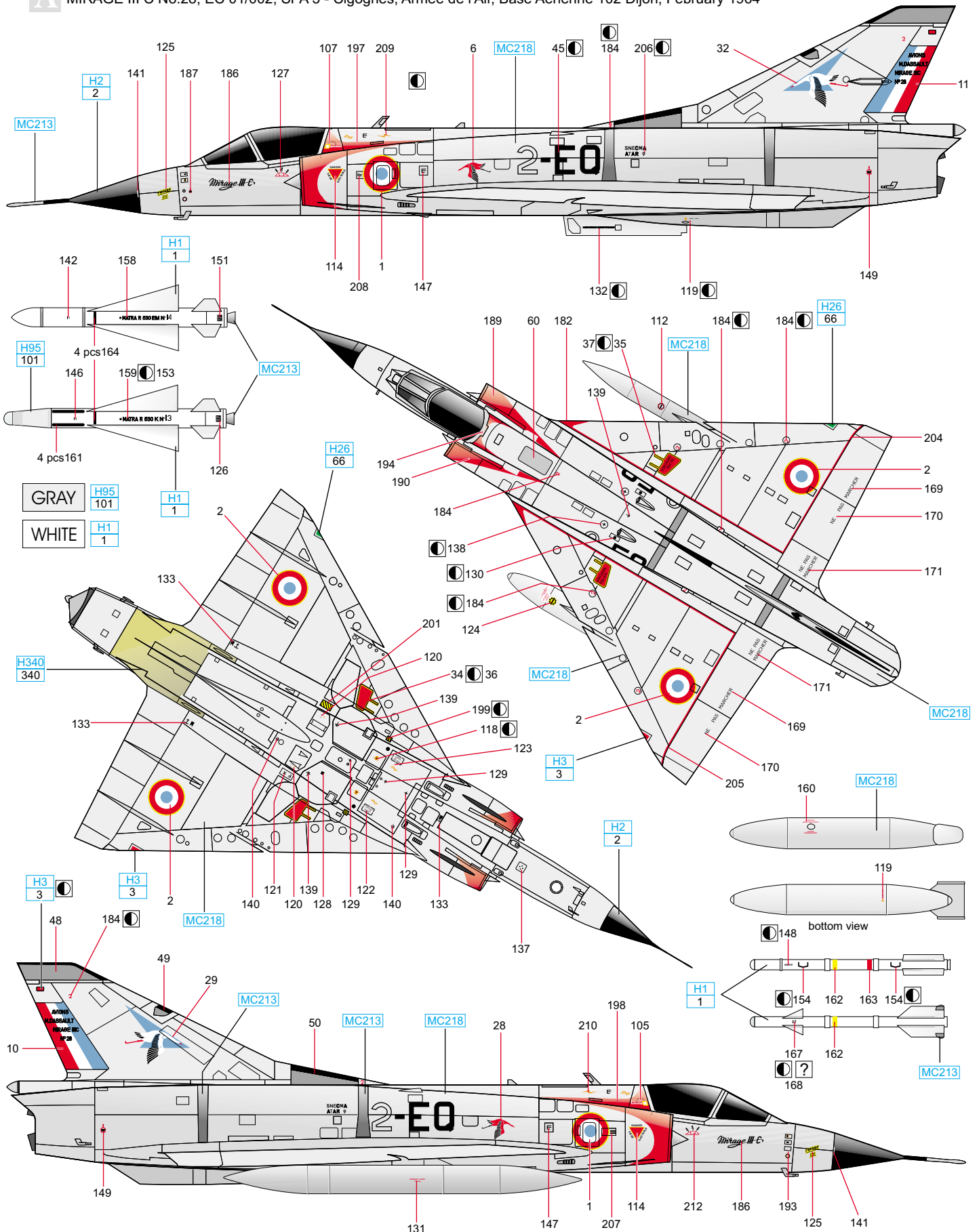

GRAY H95 101  
 WHITE H1 1

ALUMINIUM MC218 STEEL MC218 ZINC-CHROMATE H340 340 BLACK H2 2



\* MARKING & PAINTING \* MARKIERUNGEN UND BEMALUNG \*  
 DECORATION ET PEINTURE 8101 OZNAČENÍ A ZBARVENÍ

C MIRAGE III C No.67, EC 03/010 Vexin, Détachement Air 188, Armée de l'Air, Djibouti, July 1981

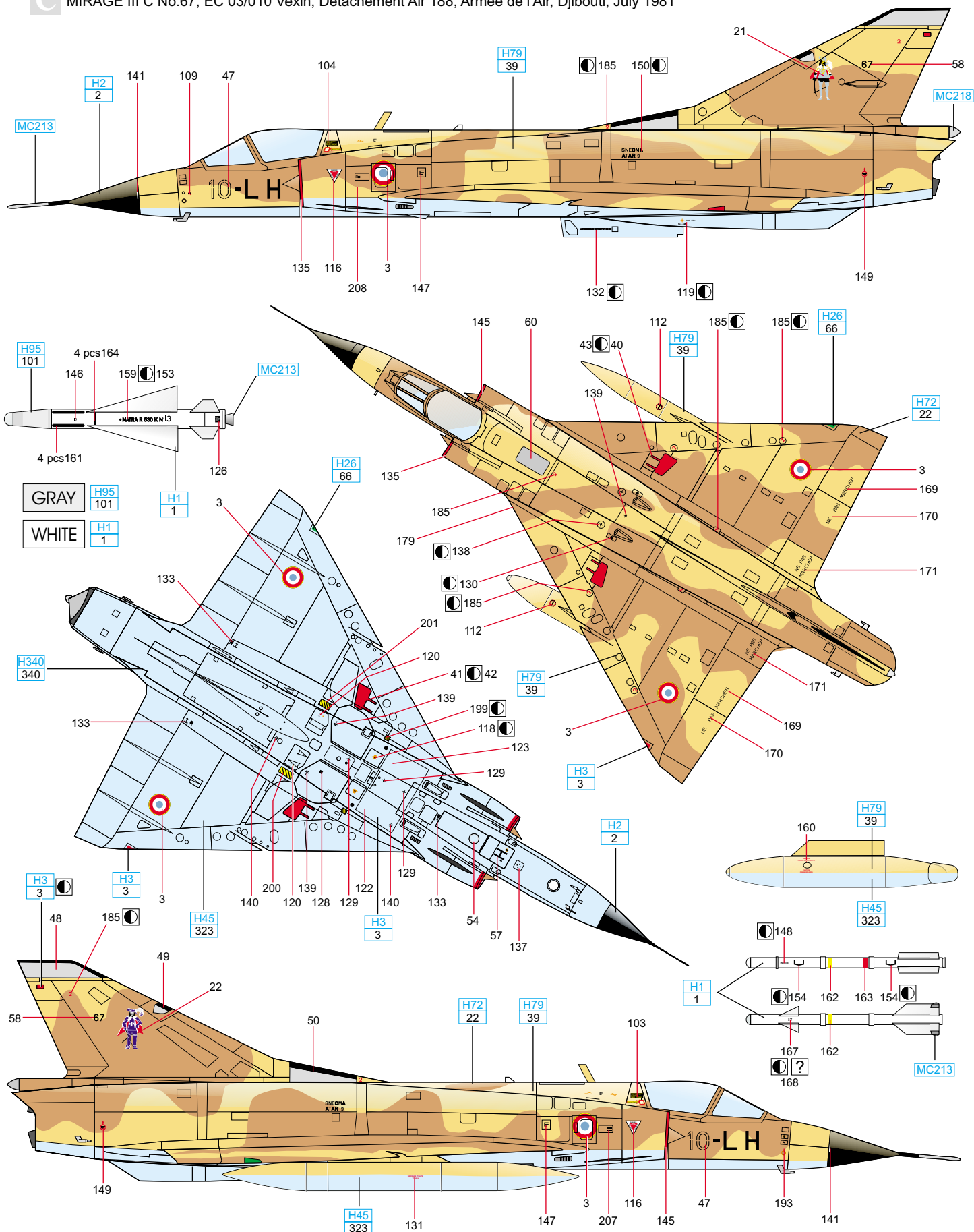

ALUMINIUM MC218    BLACK H2 2    SAND H79 39    BROWN H72 22    LIGHT BLUE H45 323

\* MARKING & PAINTING \* MARKIERUNGEN UND BEMALUNG \*  
 DECORATION ET PEINTURE 8101 OZNAČENÍ A ZBARVENÍ

**D** MIRAGE III CZ, 814/O, No.2 Squadron SAAF, Waterkloof Air Base 1971

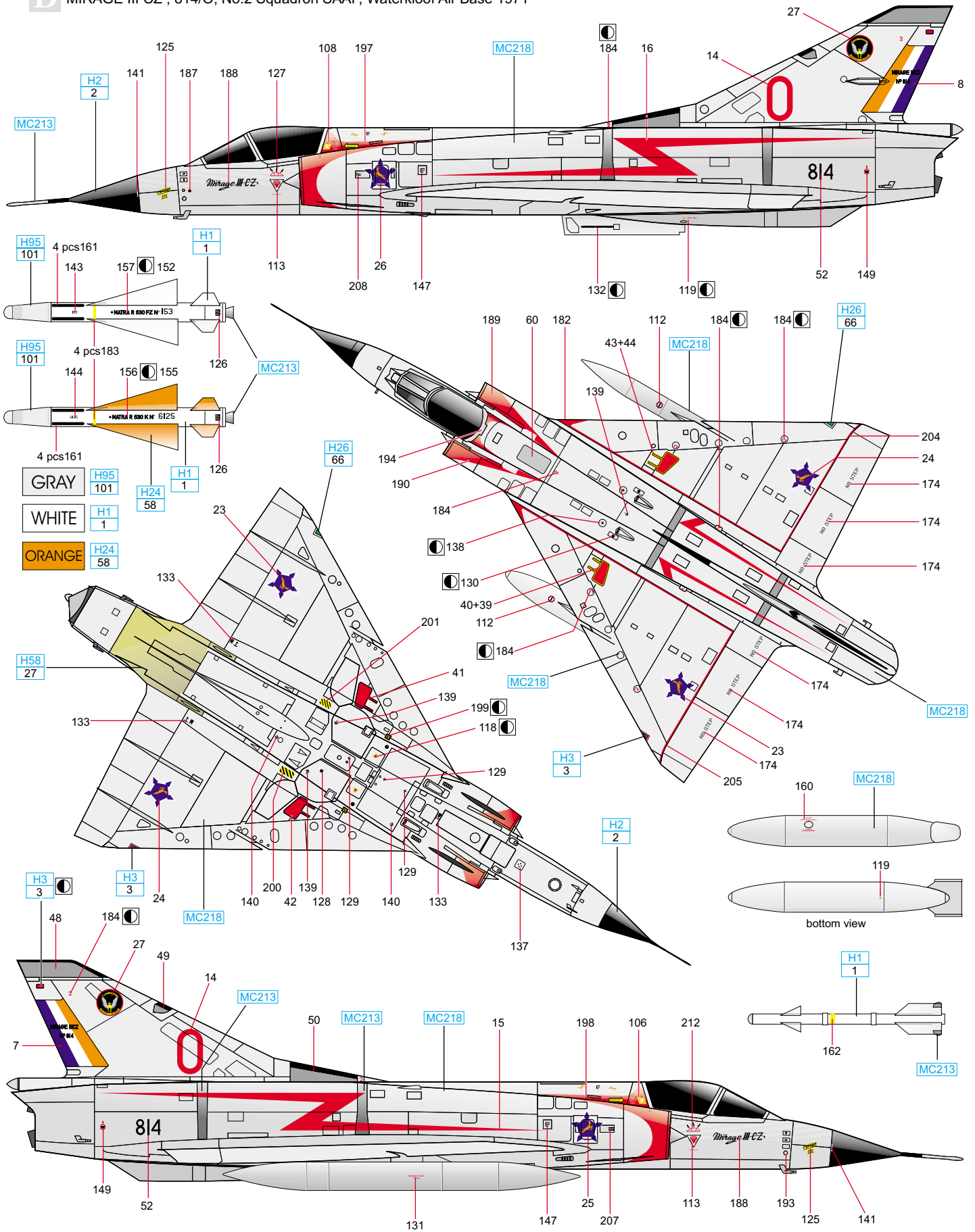

- H95 101 4 pcs 161
- H1 1 143 157 152
- H95 101 4 pcs 183
- H1 1 144 156 155
- 4 pcs 161
- GRAY H95 101
- WHITE H1 1
- ORANGE H24 58

- H58 27
- H3 3
- H3 3
- H3 3

- H3 3
- H3 3

- H1 1

ALUMINIUM MC218 STEEL MC213 ZINC-CHROMATE H58 27 BLACK H2 2



\* MARKING & PAINTING \* MARKIERUNGEN UND BEMALUNG \*  
 DECORATION ET PEINTURE 8101 OZNAČENÍ A ZBARVENÍ \*

**E** MIRAGE III CJ , No.59 , 101st Tayaset, Chel Ha' Avir, Six Day War, 1968

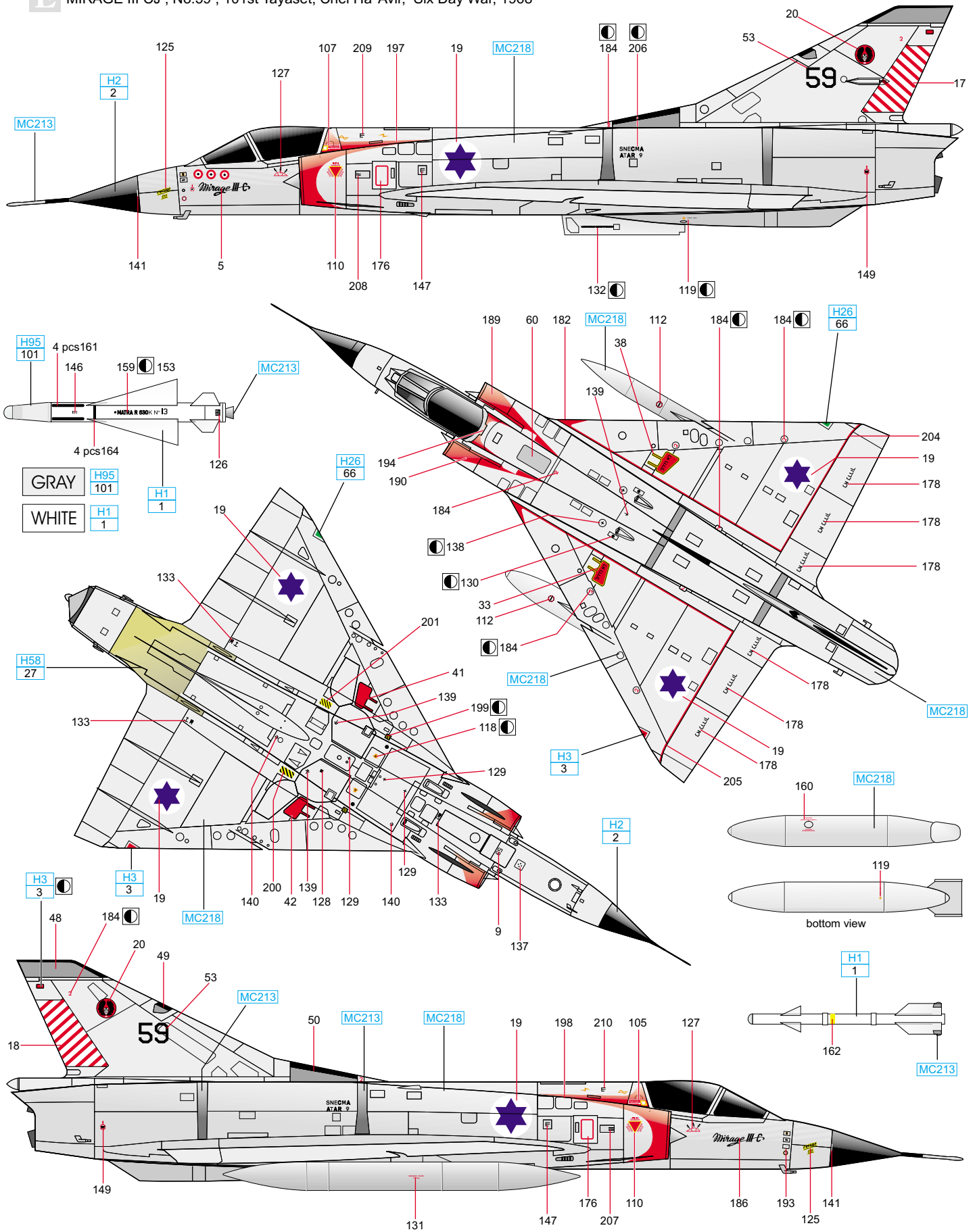

- H95 101 4 pcs 161
- 146
- 159
- 153
- 4 pcs 164
- GRAY H95 101
- WHITE H1 1
- H1 1

- H58 27
- H3 3
- H3 3
- H3 3

- H3 3
- H3 3
- H3 3

- H1 1

- ALUMINIUM MC218
- STEEL MC218
- ZINC-CHROMATE H58 27
- BLACK H2 2

\* MARKING & PAINTING \* MARKIERUNGEN UND BEMALUNG \*  
 DECORATION ET PEINTURE 8101 OZNAČENÍ A ZBARVENÍ \*

**F** MIRAGE III CJ , No.259 (renumbered ex 59) , 101st Tayaset, Chel Ha' Avir, operation Branch, Summer 1970

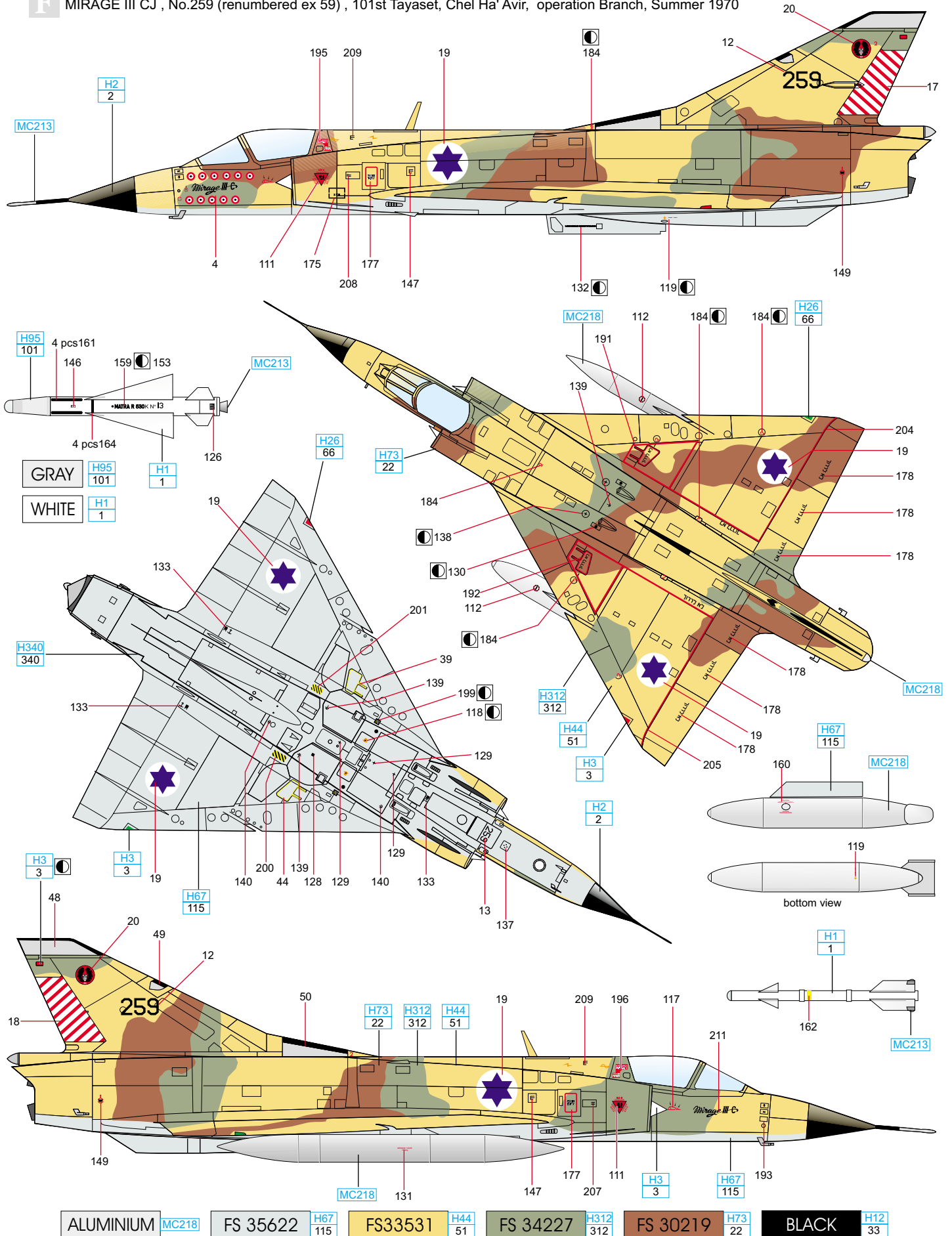

- ALUMINIUM MC218
- FS 35622 H67 115
- FS33531 H44 51
- FS 34227 H312 312
- FS 30219 H73 22
- BLACK H12 33

A MIRAGE III CJ, No.159 (renumbered ex 59), 101st Tayaset, Chel Ha' Avir, Yom Kippur War, 1973

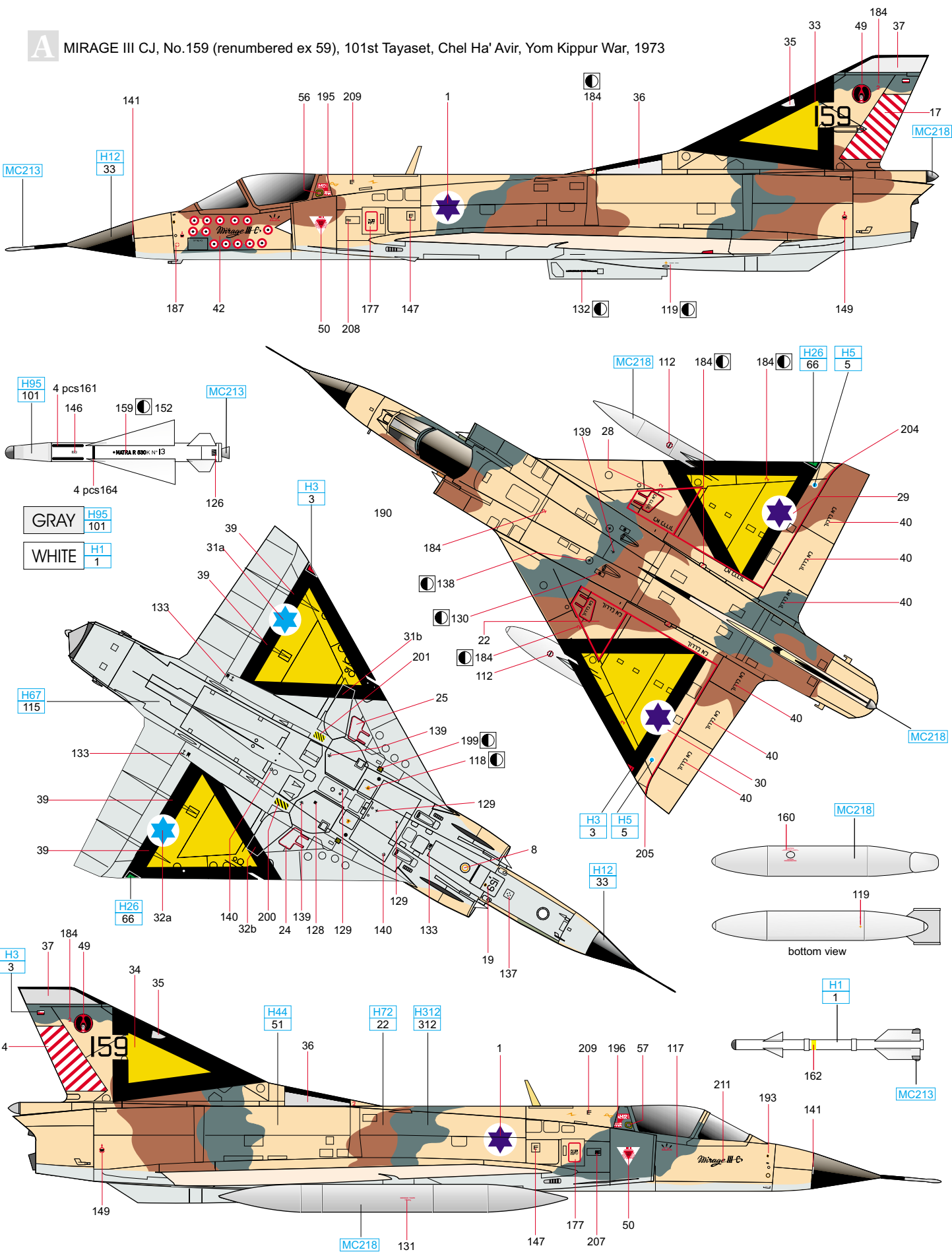

GRAY H95 101  
 WHITE H1 1

ALUMINIUM MC218 FS 35622 H67 115 FS33531 H44 51 FS 34227 H312 312 FS 30219 H73 22 BLACK H12 33





**D** MIRAGE III CJ, No. 745, 117st Tayaset, Chel Ha' Avir, 1967

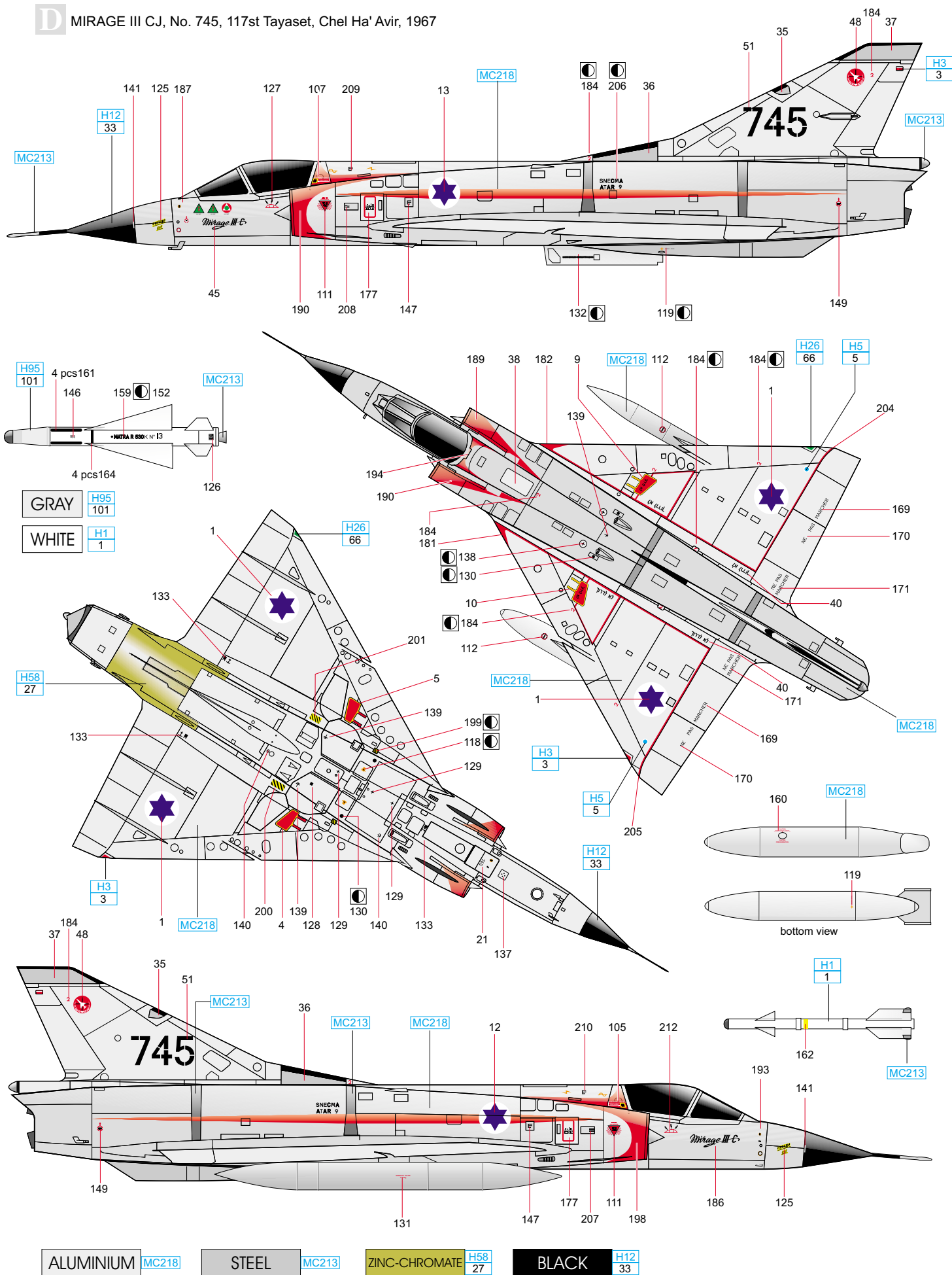

- ALUMINIUM MC218
- STEEL MC213
- ZINC-CHROMATE H58 27
- BLACK H12 33

