

'49 MERCURY

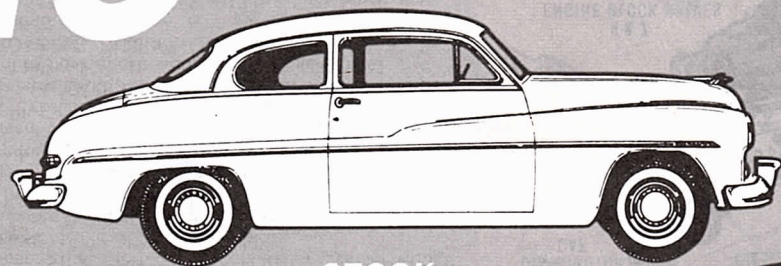

STOCK

1/25TH
SCALE
MODEL



3 in 1



Trophy
SERIES

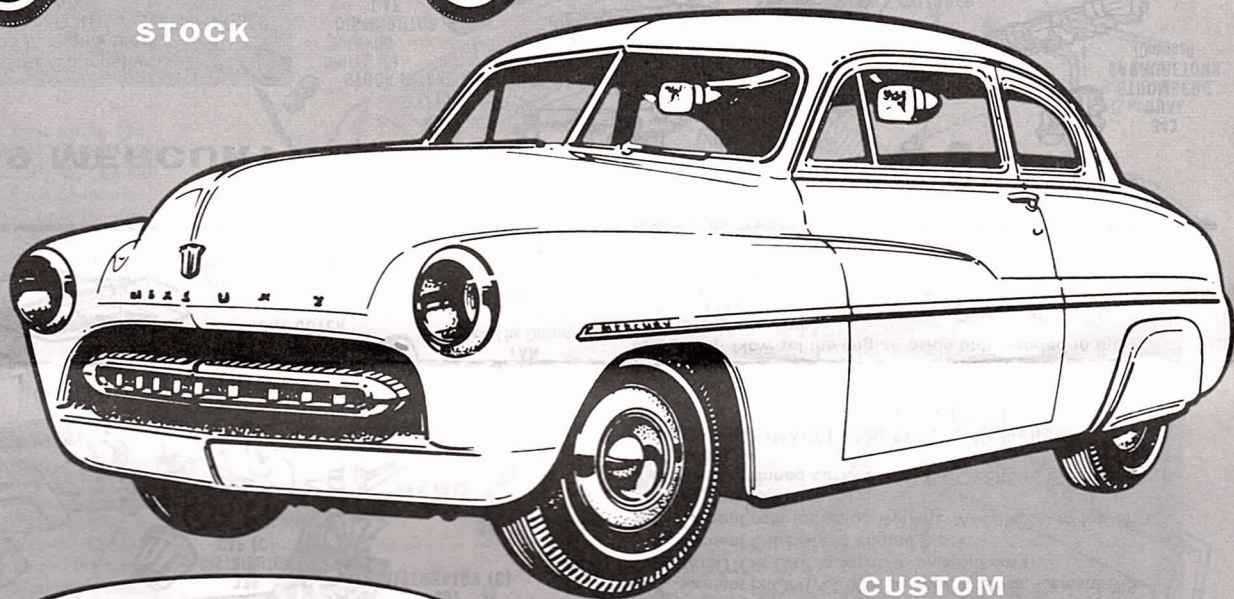

CUSTOM

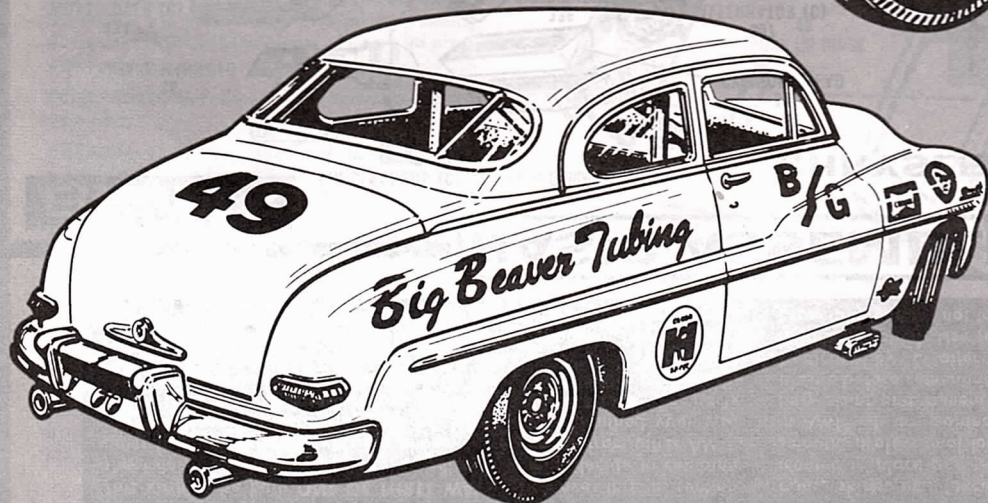

COMPETITION

*a
m
t*

®

READ THIS BEFORE YOU BEGIN

This kit may be built **ONE OF THREE WAYS**. Look over this instruction sheet carefully before you begin building. You may decide to combine parts from the different versions shown, or use parts from other AMT® kits for a really personalized model. After you've planned your car, follow the assembly instructions **WITHOUT CEMENTING** the parts together. This will familiarize you with the fit and location of parts.

For the neatest job, the various sub-assemblies and components should be painted before any chrome parts are attached. For example: in building the *custom* version, all non-chrome parts such as scoops,

panels, skirts, etc. (except the clear window assembly) should be cemented in place and the body should then be painted as a unit for a smooth, professional-looking finish.

AMT® kits are molded from the finest high-impact styrene plastic. Use only paint and cement made for styrene plastic. Trim off any excess plastic before cementing parts together. When attaching **CHROME** parts (indicated by "C" after part names), scrape plating away where cement is to be applied. Use *just enough* cement to join plastic parts, and be especially careful not to smear cement on exposed surfaces.

BASIC ASSEMBLIES

ENGINES

CHRYSLER RAM INDUCTION V-8

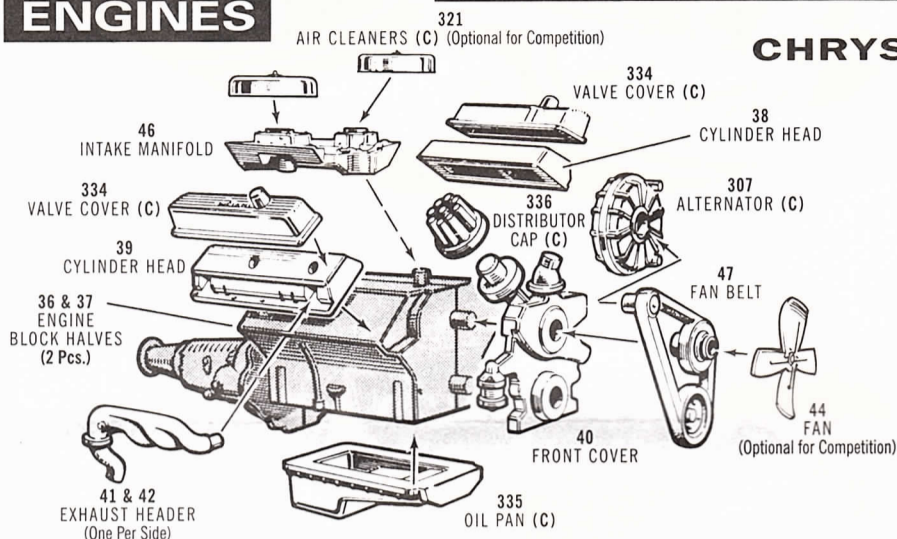

1. Cement ENGINE BLOCK HALVES together.
2. Cement CYLINDER HEADS to engine block.
3. Cement FRONT COVER to engine block. Cement DISTRIBUTOR CAP to location on front cover.
4. Cement OIL PAN to engine block.
5. Cement ram-induction INTAKE MANIFOLD to top of engine block.
6. Cement finned custom VALVE COVERS to cylinder heads.
7. Cement EXHAUST HEADERS to cylinder heads.
8. Cement ALTERNATOR and FAN to FAN BELT, then cement this assembly to front cover.
9. Cement AIR CLEANERS to carburetors (on intake manifold). Now set the engine aside until needed in the chassis assembly.

STOCK 1949 MERCURY V-8

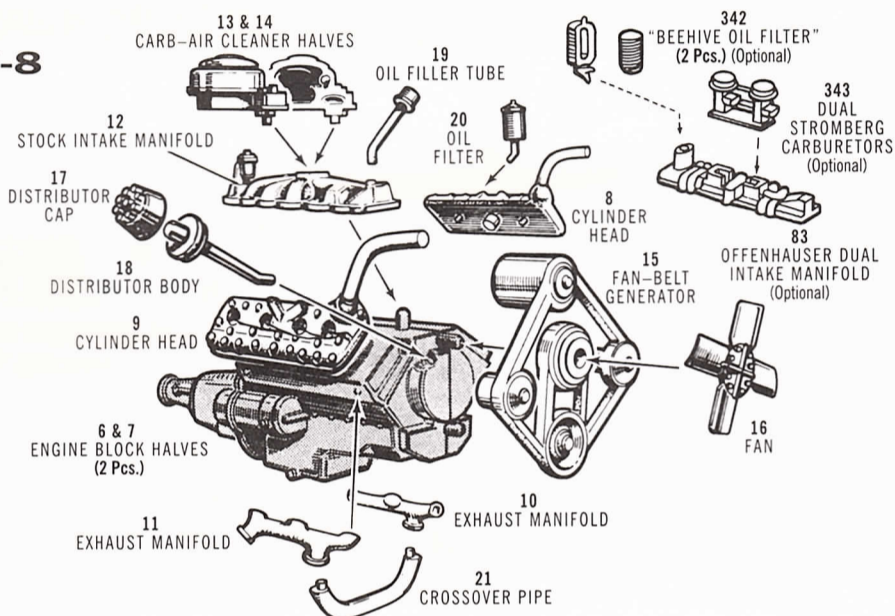

1. Cement ENGINE BLOCK HALVES together.
2. Cement CYLINDER HEADS to engine block.
3. Cement STOCK INTAKE MANIFOLD or OFFENHAUSER INTAKE MANIFOLD to engine block.
4. Assemble DISTRIBUTOR and cement into locating hole on front end of engine block.
5. Cement OIL FILLER TUBE into its location in stock intake manifold. (Optional)
6. Cement OIL FILTER into cylinder head OR cement BEEHIVE OIL FILTER into Offenhauser intake manifold.
7. Assemble CARBURETOR-AIR CLEANER halves and cement to stock intake manifold OR cement DUAL STROMBERG CARBURETORS into Offenhauser intake manifold.
8. Cement EXHAUST MANIFOLDS to engine block, then cement CROSSOVER PIPE to manifolds.
9. Cement FAN BELT-GENERATOR to front of engine, then cement FAN to pulley. Now set the engine aside until needed in the chassis assembly.

INTERIOR

STOCK-1. Cement PEDALS to locating Tab. **2.** Cement INSTRUMENT PANEL into position. **3.** Cement STEERING COLUMN into instrument panel. **4.** Cement STEERING WHEEL to column. **5.** Assemble FRONT SEAT and cement to floor of interior.

COMPETITION-1. Cement PEDALS to locating Tab. **2.** Cement SHIFT LEVER to transmission tunnel. **3.** Cement auxiliary INSTRUMENT CLUSTER to INSTRUMENT PANEL. Apply instrument DECALS to cluster. **4.** Cement instrument panel to interior. **5.** Cement STEERING COLUMN to instrument panel, then cement STEERING WHEEL to column. **6.** Assemble FRONT SEAT and cement to floor of interior. **7.** Assemble ROLL BAR and cement to floor of interior (see detail).

CUSTOM-1. Cement PEDALS to locating tab. **2.** Cement SHIFT LEVER, PHONE, TAPE RECORDER (or TV) to custom CONSOLE. **3.** Cement console to driveshaft tunnel on floor of interior. **4.** Cement custom BUCKET SEATS onto locating posts. **5.** Cement INSTRUMENT PANEL to interior. **6.** Cement STEERING COLUMN to instrument panel, then cement CUSTOM STEERING WHEEL to column. **7.** Cement SPEAKER GRILLE to SPEAKER HOUSING and install on package shelf.

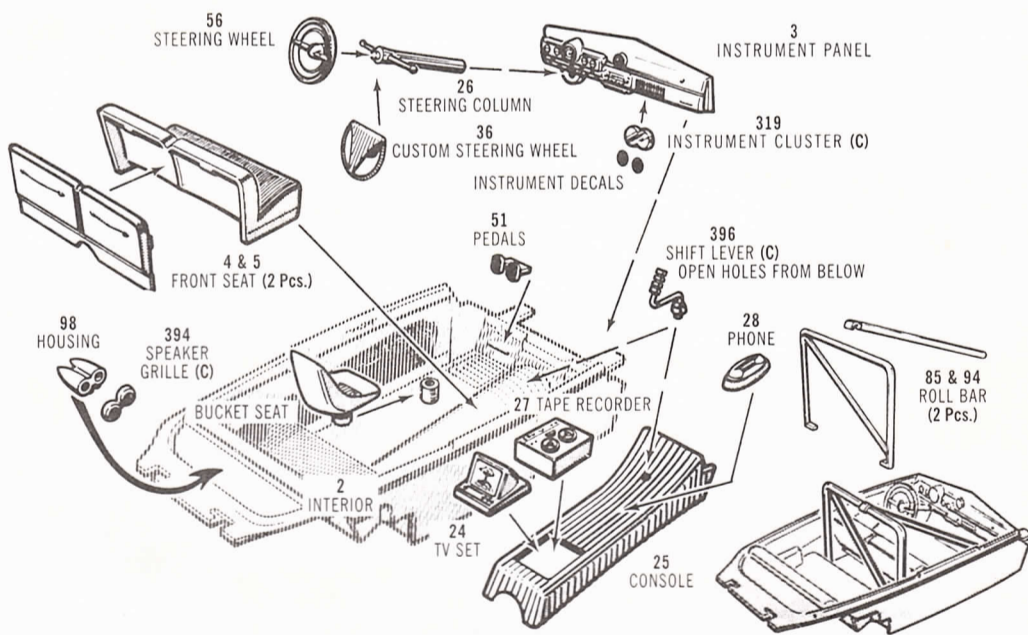

BODY

STOCK-1. Carefully cement WINDOW into BODY. **2.** Cement MIRROR to window where shown. **3.** Place tabs of TRUNK LID HINGE in locating recesses as shown, and cement ASSEMBLED INTERIOR into body. Interior retains hinge but allows it to move freely for trunk operation. **4.** Cement TRUNK LID to hinge, aligning lid pins with hinge bar holes.

COMPETITION-Follow STOCK assembly procedure above.

CUSTOM-1. With a sharp tool, open locating hole(s) for AERIAL (may be either single or dual). Do not install aerial yet. **2.** Many custom '49 Mercs have one-piece rear windows, as used in the '50. You can simulate this by trimming out the two rear window divider bars. **3.** Carefully cement WINDOW into body. **4.** Assemble "floating" HEADRESTS and cement this unit between locating tabs in roof. **5.** Place tabs of TRUCK LID HINGE in locating recesses as shown, and cement ASSEMBLED INTERIOR into body. Interior retains hinge but allows it to move freely for trunk operation. **6.** Now cement AERIAL into locating hole(s) from underside of body. Trim off the unused pin(s).

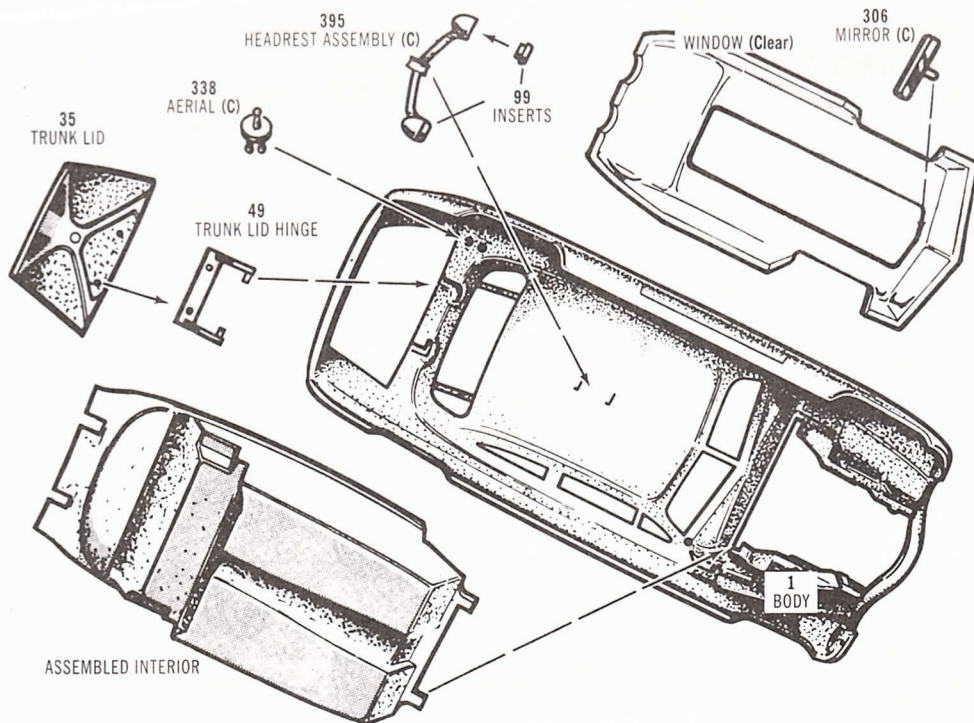

WHEELS

- Carefully apply a light coating of cement to face of INNER WHEEL HALF (Shaded Area).
- Press inner wheel half into TIRE.
- Place BRAKE DRUM inside inner wheel half. Be sure cement does not touch brake drum, or wheel will not rotate freely.
- STOCK:** Press STOCK WHEEL COVER into tire until it contacts inner wheel half.
COMPETITION: Press OPEN WHEEL HALF into tire until it contacts inner wheel half.
CUSTOM: Press OPEN WHEEL HALF into tire until it contacts inner wheel half. Cement CUSTOM WHEEL COVER into open wheel half.

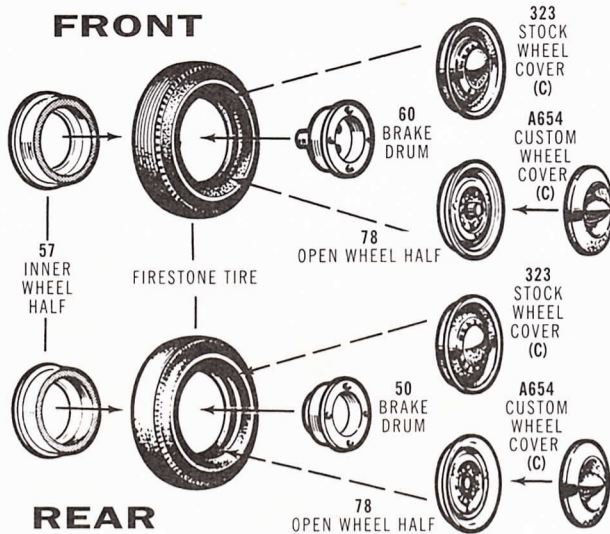

GOODYEAR TIRE OPTIONS

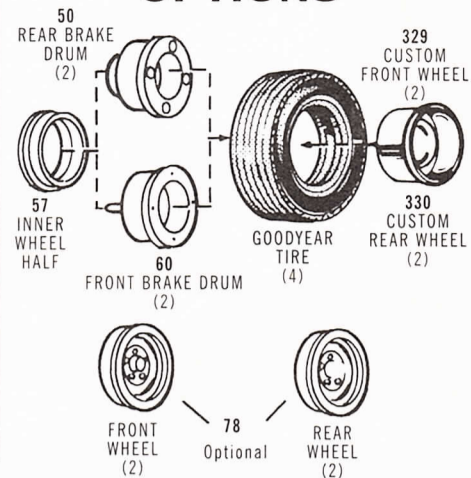

CHASSIS ASSEMBLIES

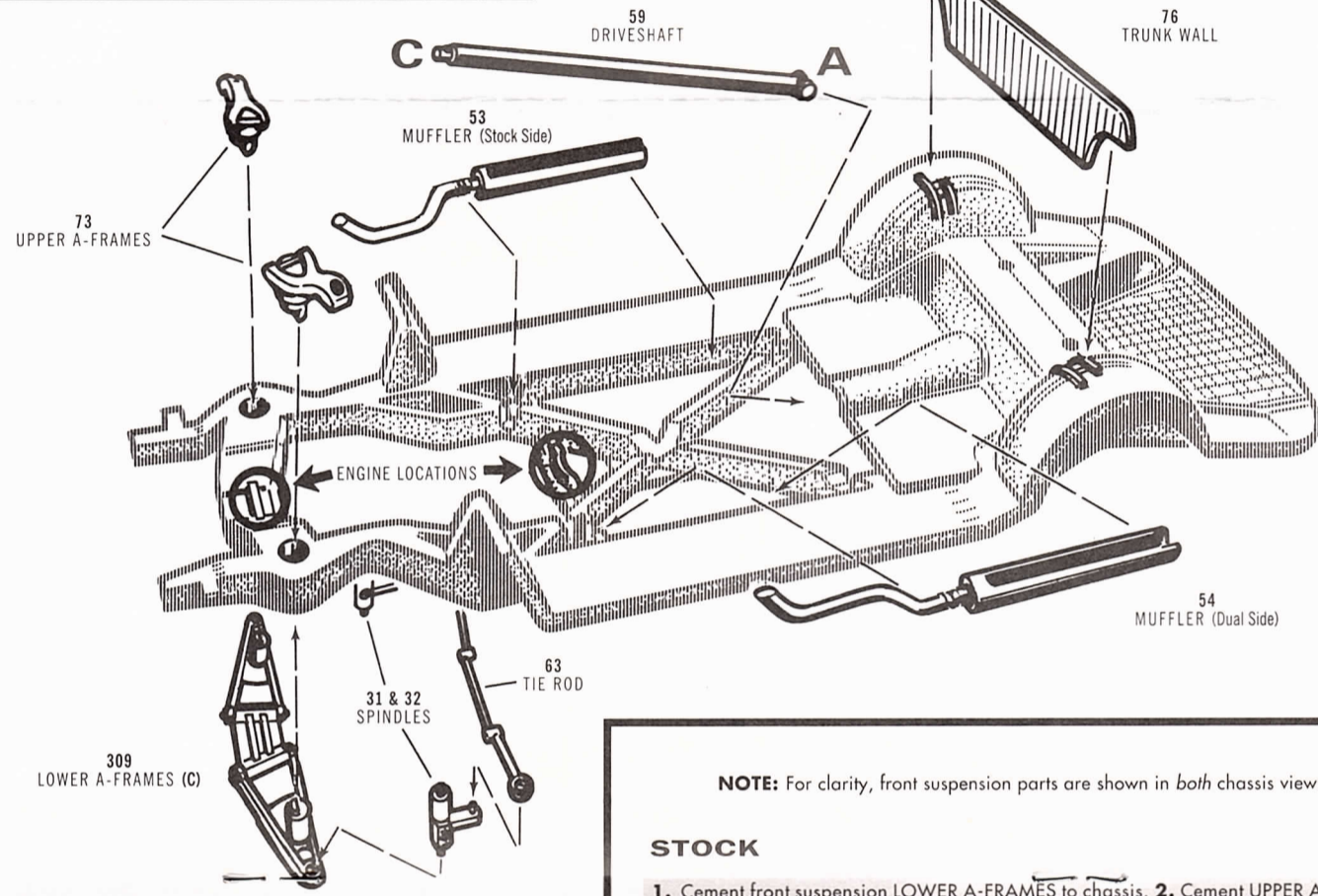

NOTE: For clarity, front suspension parts are shown in both chassis views.

STOCK

- Cement front suspension LOWER A-FRAMES to chassis.
- Cement UPPER A-FRAMES to chassis and at the same time insert SPINDLES between upper and lower A-Frames (Refer to detail at left). Do not apply cement to spindles.
- Snap TIE ROD onto pins on spindle arms.
- Cement SPLASH PANS to front and rear of frame.
- Cement GAS TANK to chassis as shown below.
- Cement stock side MUFFLER and TAILPIPE to chassis.
- Assemble REAR AXLE halves and cement unit to frame.
- Cement SHOCK ABSORBERS to rear axle and chassis as shown.
- Cement TRUNK WALL to chassis.
- Install DRIVESHAFT (Cement u-joint "A" to differential housing "B" on rear axle assembly).
- Install stock engine (cement transmission to driveshaft end "C", then locate engine on frame where circled). Align exhaust manifold with muffler headpipe.
- Cement assembled front and rear WHEELS in place. Check wheels for free rotation.

COMPETITION

Follow STOCK assembly above with these additions: STEP 6—Install dual side MUFFLER and TAILPIPE. STEP 11—Install Chrysler instead of stock engine, and align exhaust headers with muffler headpipes.

CUSTOM

Follow STOCK assembly above with these additions and changes: STEP 4—DO NOT install splash pans. STEP 6—Install dual side MUFFLER and TAILPIPE. STEP 9—Pleated side of TRUNK WALL (shown) faces to rear of car. STEP 11—Install Chrysler instead of stock engine, and align exhaust headers with muffler headpipes.

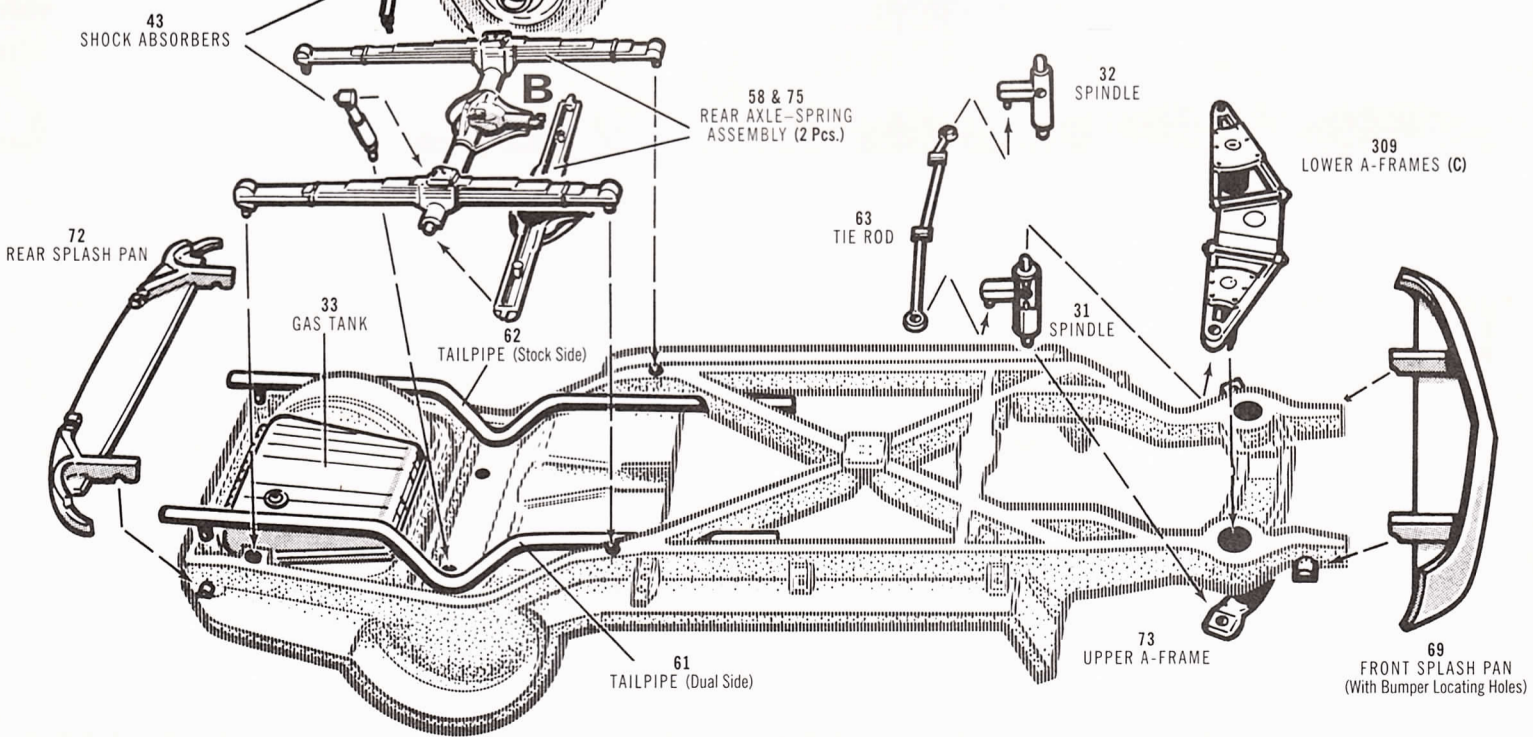
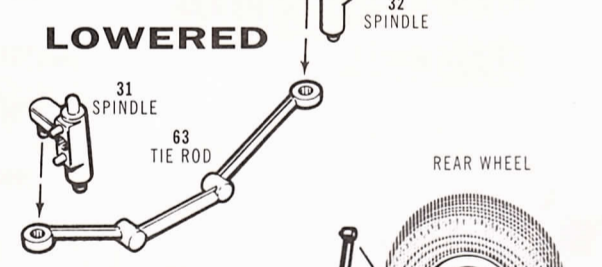
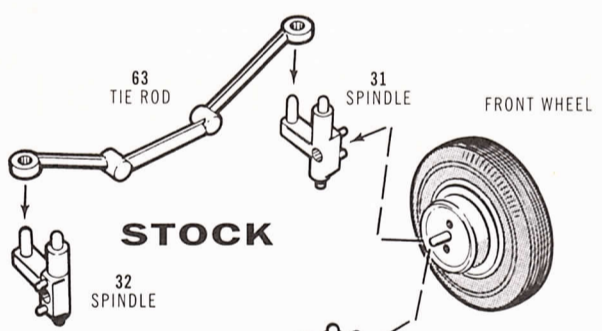

FINAL STOCK — COMPETITION ASSEMBLY

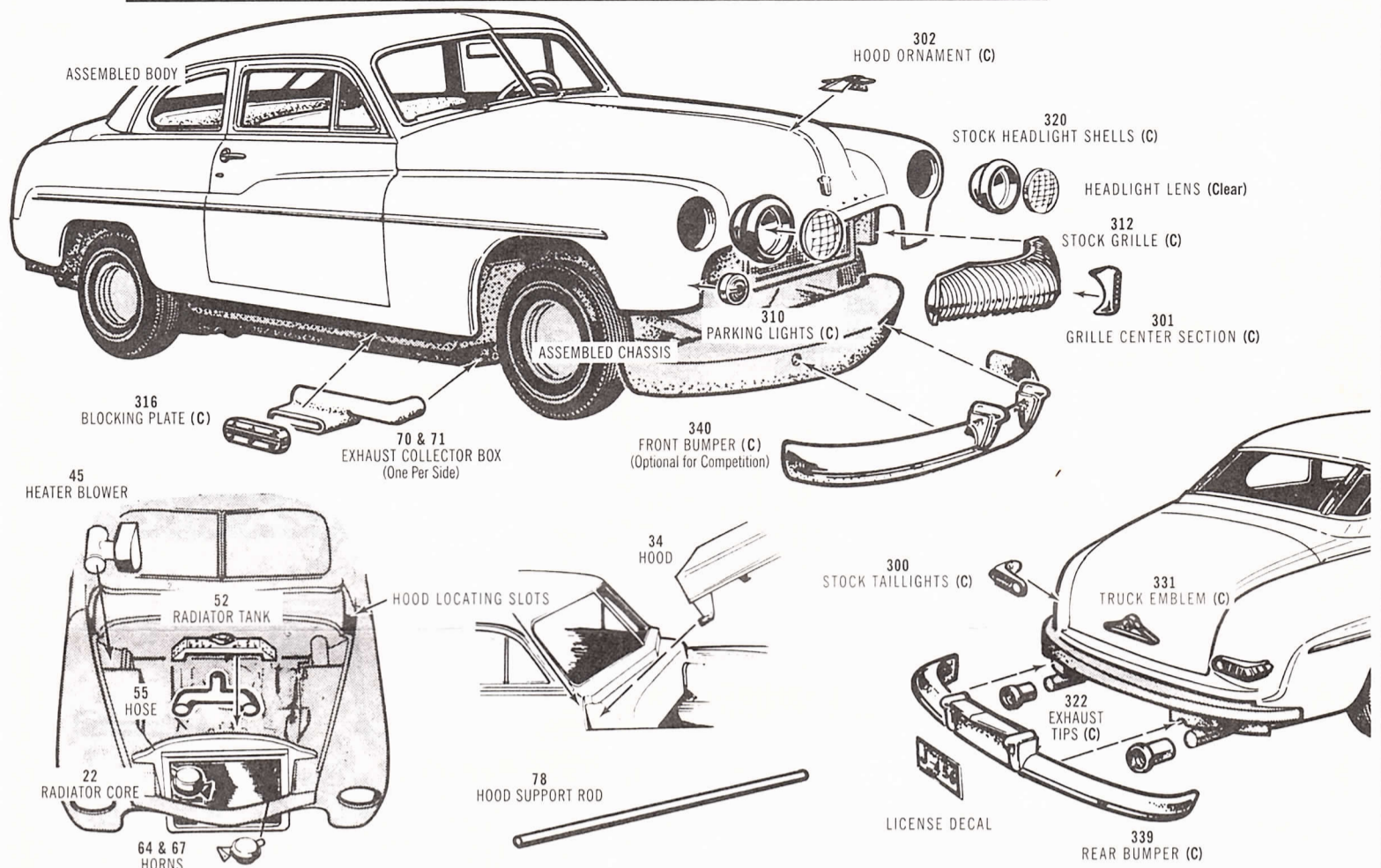

STOCK

1. Cement ASSEMBLED BODY to ASSEMBLED CHASSIS. 2. Cement Engine compartment components in position: HEATER BLOWER, RADIATOR CORE, RADIATOR TANK, and HORNS. 3. Install HOOD as shown in detail above. 4. Cement ORNAMENT to hood as shown. 5. Cement STOCK GRILLE in position, followed by CENTER SECTION. 6. Cement FRONT BUMPER to pan as shown. 7. Cement STOCK HEADLIGHT SHELLS into fender openings. Carefully cement LENSES into headlight shells. 8. Cement PARKING LIGHTS below headlights. 9. Cement REAR BUMPER to pan as shown. Apply LICENSE DECAL to bumper where shown. 10. Cement STOCK TAILLIGHTS to body where shown. Cement TRUNK EMBLEM to trunk lid where shown.

COMPETITION

1. Cement ASSEMBLED BODY to ASSEMBLED CHASSIS. 2. Cement Engine compartment components in position: RADIATOR CORE, RADIATOR HOSE (Cement between engine and radiator), and RADIATOR TANK. 3. Install HOOD as shown in detail above. 4. Cement FRONT BUMPER to pan as shown. 5. Cement STOCK HEADLIGHT SHELLS into fender openings. Carefully cement LENSES into headlight shells. 6. Cement PARKING LIGHTS below headlights. 7. Cement exhaust COLLECTOR BOXES to frame (Angled pipe attaches where frame rail angles inward). Cement BLOCKING PLATES to collector box outlets. 8. Cement REAR BUMPER to pan as shown. 9. Cement EXHAUST TIPS to tailpipes. 10. Cement STOCK TAILLIGHTS to body as shown. Apply competition DECALS following directions on decal sheet. Instruction sheet cover drawing shows a typical decal arrangement.

FINAL CUSTOM ASSEMBLY

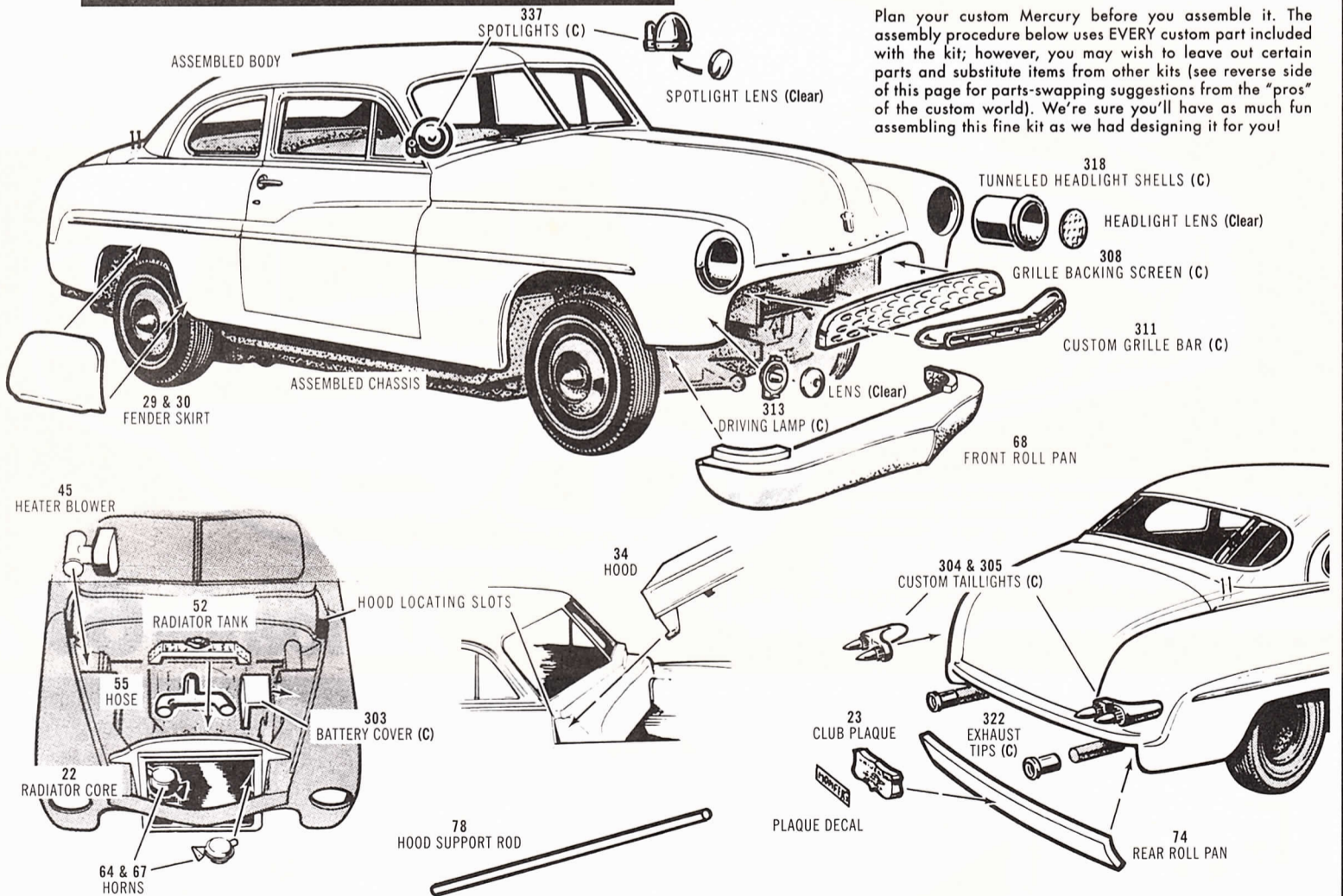

Plan your custom Mercury before you assemble it. The assembly procedure below uses EVERY custom part included with the kit; however, you may wish to leave out certain parts and substitute items from other kits (see reverse side of this page for parts-swapping suggestions from the "pros" of the custom world). We're sure you'll have as much fun assembling this fine kit as we had designing it for you!

1. Cement ASSEMBLED BODY to ASSEMBLED CHASSIS. 2. Cement front and rear ROLL PANS to body as shown. 3. Cement engine compartment components in position as shown: HEATER BLOWER, RADIATOR CORE, RADIATOR HOSE (cement between engine and radiator), RADIATOR TANK, BATTERY COVER, and HORNS. 4. Install HOOD as shown in detail above. 5. Cement FENDER SKIRTS to body where shown. 6. Cement TUNNELED HEADLIGHT SHELLS into fender openings. Carefully cement LENSES into tunneled headlight shells. 7. GRILLE BACKING SCREEN and CUSTOM GRILLE BAR may be installed individually or in combination. When using both units, open up the two holes in the backing screen. These holes

locate the grille bar. 8. OPTIONAL GRILLE: The STOCK GRILLE (Pictured on stock assembly page), makes an extremely clean installation minus its center section. 9. Cement Lucas "Flamethrower" DRIVING LAMPS to fenders below tunneled headlights. Carefully cement LENSES into driving lamps. 10. Cement "Caddy"-type CUSTOM TAILLIGHTS to body as shown. 11. Cement CLUB PLAQUE to rear roll pan. **Note:** "Modifiers" decal may be applied to smooth side of plaque if desired. 12. Cement EXHAUST TIPS to tailpipes. 13. Carefully cement LENSES into SPOTLIGHTS and cement spotlights into location. 14. Apply customizing DECALS of your choice, following directions on decal sheet. See reverse side of this page for custom display accessories to make your Merc a show-winner.

DISPLAY ACCESSORIES

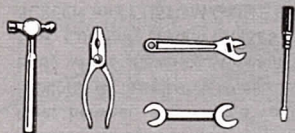

324
TOOL SET (C)
(5 Pcs.)



312 & 398
PISTONS—CONNECTING RODS (C)

399
CRANKSHAFT (C)



BUMPER
JACK (C)

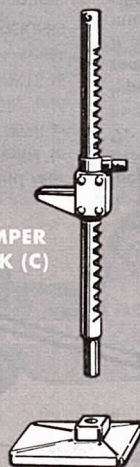

JACK HANDLE
—LUG WRENCH (C)



JACK BASE (C)



ENGINE DISPLAY STAND

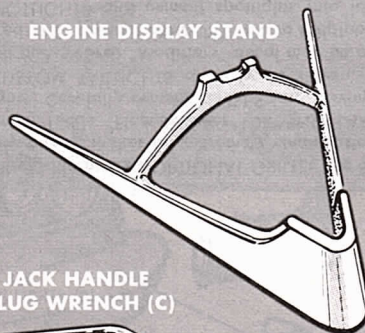

397
TROPHY (C)

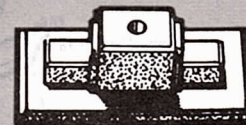

97
TROPHY BASE

'49 MERCURY

...by the AMT® customizing team

AMT's® customizing consultants, top authorities in the restyling field, have selected typical components from other Trophy Series Kits to show you the '49 as it *might* appear. Parts-swapping is a major area of the customizing scene—one you can easily duplicate in miniature. See your Hobby Shop for the *complete* Trophy Series lineup—every kit a modeler's masterpiece!

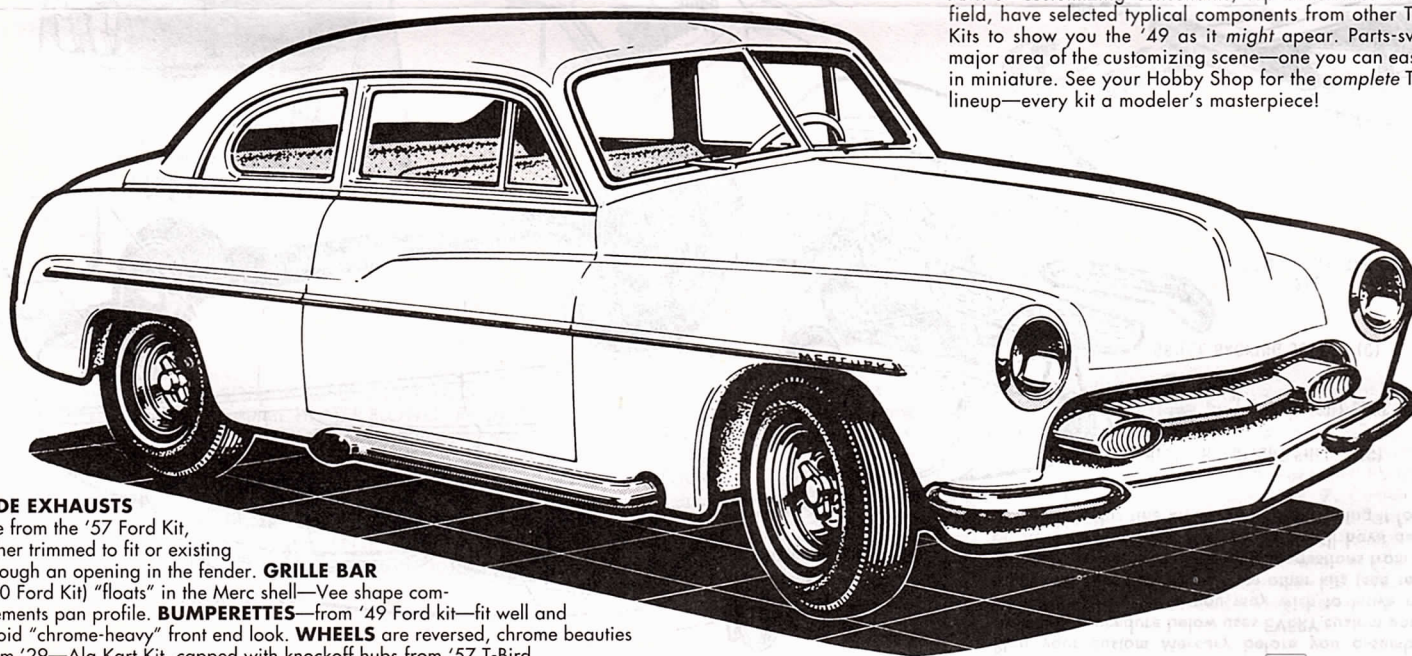

SIDE EXHAUSTS

are from the '57 Ford Kit, either trimmed to fit or existing through an opening in the fender. **GRILLE BAR** ('50 Ford Kit) "floats" in the Merc shell—Vee shape complements pan profile. **BUMPERETTES**—from '49 Ford kit—fit well and avoid "chrome-heavy" front end look. **WHEELS** are reversed, chrome beauties from '29—Ala Kart Kit, capped with knockoff hubs from '57 T-Bird.



GOODYEAR

Firestone

'49 MERCURY CUSTOMIZING KIT

3 in 1

CLUB COUPE

BUILD 1 OF 3 WAYS

STOCK CUSTOM
COMPETITION

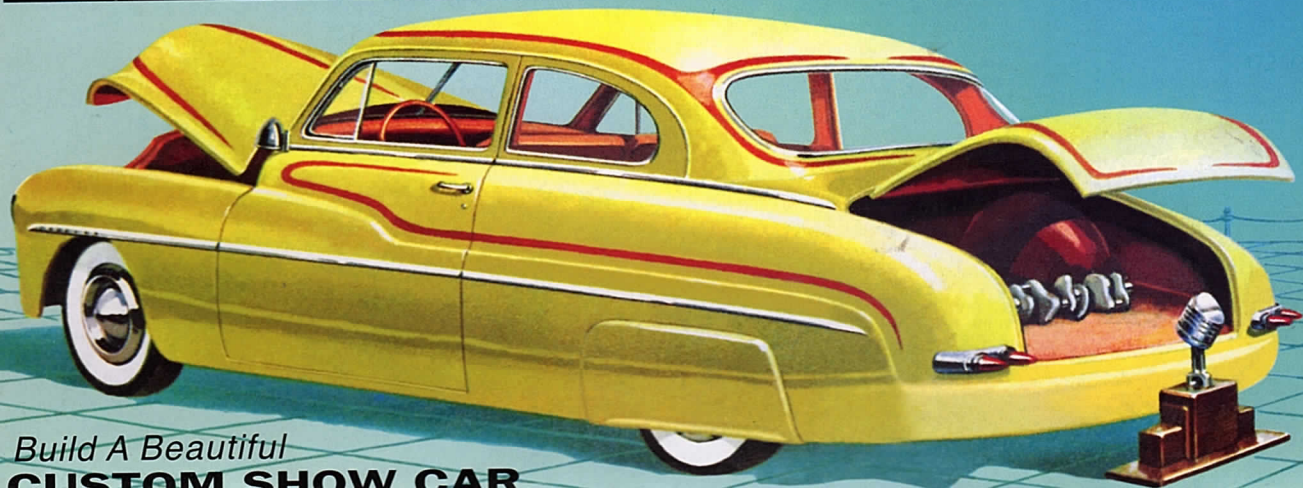

Build A Beautiful
CUSTOM SHOW CAR

BONUS FEATURE

**KIT INCLUDES
ALL NEW FIRESTONE
DELUXE CHAMPION
TIRES WITH FACTORY
PAD-PRINTED WIDE
WHITEWALLS**

Only from the...
KATS at AMT!



SPECIAL REISSUE

**ORIGINAL PARTS
HAVE BEEN RESTORED**

- ★ Custom Wheel Covers
- ★ Mod Futuristic Headrest
- ★ Wild Show Rod Shifter
- ★ Piston Trophy Topper
- ★ Display Crankshaft

EXTRA OPTIONS

- ★ 'Beehive' Oil Filter
- ★ Offenhauser Manifold
- ★ Dual Stromberg Carbs
- ★ Reverse Wheels + Caps
- ★ Wide Street Rod Tires

Authentic, Highly Detailed
STOCK PARTS

Show Accessories Plus
CUSTOM PARTS

Chrysler Ram Induction Engine
COMPETITION PARTS

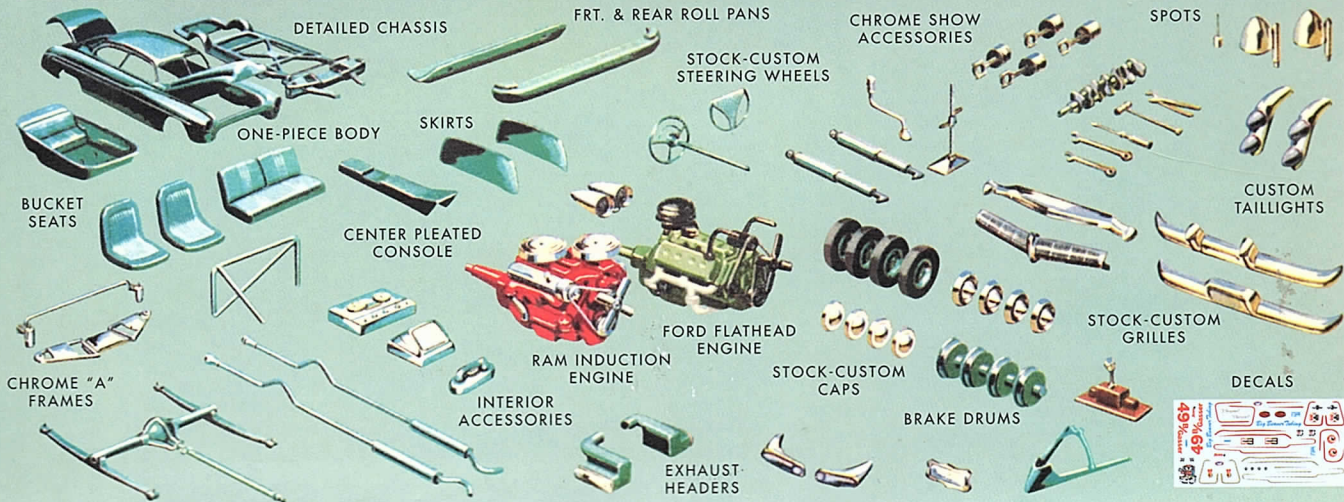

AMT® BY ROUND 2 - SEE BOX BOTTOM FOR MORE INFORMATION

DESIGNED IN THE U.S.A.

official model makers to the industry



1/25 SCALE PLASTIC MODEL KIT

KIT MAQUETTE EN PLASTIQUE
À L'ÉCHELLE 1/25

KIT DE MODELISMO DE
PLÁSTICO ESCALA 1/25



CARACTÉRISTIQUES • MERKMALE • CARACTERÍSTICAS • CARATTERISTICHE

FRA Maquette authentique d'une échelle de 1/25 avec une carrosserie et un intérieur entièrement détaillés. Matériau en plastique blanc moulé sur le carton de carton. Contenu des pièces chromées, des pneus en vinyle et des accessoires transférables à l'eau. Niveau de difficulté 2 - Peinture et colle requises. (See instructions) Les pièces moulées aux étiquettes de l'emballage sont disponibles sous une réserve d'articles de base.

ITA Modellauto Modell im Maßstab 1/25 mit voll detaillierter Karosserie und Innenverkleidung. Material aus Teil der Bodenwanne injiziert. Lediglich Chromteile, Pneumatik und in Wasser abbläsbares Alufolienkleber. Schwierigkeitsgrad 2 - Lack und Kleber erforderlich. (Nicht enthalten.) Zu den Fotos auf der Verpackung passende Fotos erhalten Sie bei Ihrem Händler für Bastbedarf.

DEU Modellauto Modell im Maßstab 1/25 mit voll detaillierter Karosserie und Innenverkleidung. Material aus Teil der Bodenwanne injiziert. Lediglich Chromteile, Pneumatik und in Wasser abbläsbares Alufolienkleber. Schwierigkeitsgrad 2 - Lack und Kleber erforderlich. (Nicht enthalten.) Zu den Fotos auf der Verpackung passende Fotos erhalten Sie bei Ihrem Händler für Bastbedarf.

ESP Modelo a escala 1/25 con carrocería e interior totalmente detallados. Detalles del motor grabados como parte de la bandeja del chasis. Incluye piezas cromadas, bandas de vinilo y calcomanías que se despegan con agua. Nivel de habilidad 2 - Se necesita pintura y pegamento. (No se incluye). Consejo pintura para lograr un aspecto como las fotos del paquete en su comercio de pasadísimo.

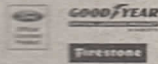

Ford Motor Company Trademarks and Trade Dress used under license to Round 2, LLC. www.FordMotorCompany.com Goodyear (and wing foot design) and Eagle are trademarks of The Goodyear Tire & Rubber Company, Akron, Ohio USA used under license by Round 2, LLC. Firestone and F-Shell Logo are registered trademarks of BPS Brands, LLC and are used with permission. Other names and trademarks are the property of their respective owners. AMT and design and ROUND 2 and design are trademarks of Round 2, LLC. ©2012 Round 2, LLC, South Bend, IN 46628 USA. Product and packaging designed in the USA. Made in China. All rights reserved.

WARNING: CHOKING HAZARD - Small parts.
Not for children under 3 yrs.

AVERTISSEMENT : DANGER DE SUFFOCATION - Petites pièces.
Ne convient pas pour les enfants de moins de 3 ans.

ADVERTENCIA: PELIGRO DE ASFIXIA - Contiene piezas pequeñas.
No apto para niños menores de 3 años.

KIT NO. AM7654/12
1843 Mercury

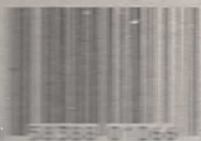

58388-01266-7
1106281241



Round 2, LLC
4073 Meghan Beeler Court
South Bend, IN 46628



International Hobbycraft (UK) Ltd.
21 St. Thomas Street
Bristol BS1 6JS England

Manufacturing Location: Singapore, Guangdong Province, China
Shanghai, China
Shanghai, China
Shanghai, China

round2models.com

PARTS OVERVIEW / PRÉSENTATION DES PIÈCES / VISTA GENERAL DE LAS PIEZAS

PARTS MOLDED IN WHITE UNLESS OTHERWISE INDICATED / LES PIÈCES SONT MOULÉES EN BLANC SAUF INDICATION CONTRAIRE
PIEZAS MODELADAS EN BLANCO A MENOS QUE SE INDIQUE LO CONTRARIO

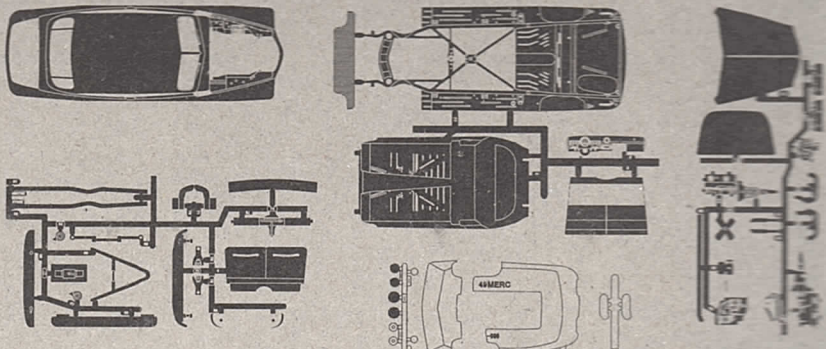

CLEAR / INCOLORE / TRANSPARENTE

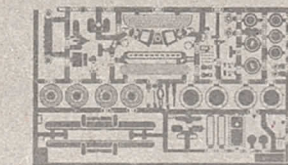
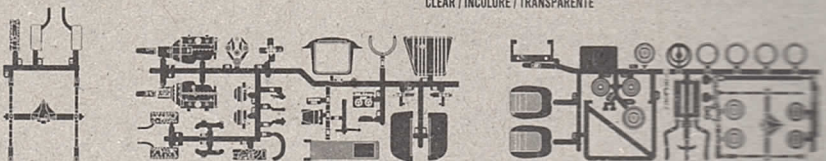

CHROME PLATED PARTS / PIÈCES CHROMÉES / CROMADO DE PIEZAS

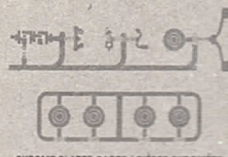

CHROME PLATED PARTS / PIÈCES CHROMÉES
CROMADO DE PIEZAS

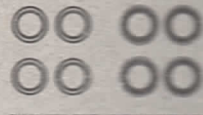

BLACK VINYL TIRES / PNEUS EN VINYLE NOIR
LANTAS NEGRO / BOMBAS



WATER RELEASE SCALE / ÉCHÉLONNEMENT DES PIÈCES
CROMADO DE PIEZAS

