



 SPUTNIK 3DLABS

IL-10 1/144

IL-10 (NATO reporting name: "Beast") is a Soviet all-metal attack aircraft of the final period of World War II, designed by the OKB Ilyushin in 1944, based on the IL-1 fighter project.

Produced in USSR (4,965 aircrafts) and under license in Czechoslovakia (1,200 Avia B-33s with full cannon armament).

It was used from April 1945 in Europe, in August 1945 against the Kwantung Army, and in the Korean War.

Operators: USSR, N.Korea, China, Czechoslovakia, Bulgaria, Poland, Hungary, Romania, Yemen, Indonesia.

Specifications

Length:	11.12 m
Wingspan:	13.4 m
Maximum speed:	550 km/h
Service ceiling:	7 250 m
Range:	1500 km
Powerplant:	Mikulin AM-42 (2000 hp)

Armament

- 2 x 23 mm VYa cannons
- 2 x 7.62 mm ShKAS machine guns
- 4 RS-82/RS-132 unguided rockets
- Up to 600 kg of bombs

Supports removal and assembly

- Use sharp cutters and scalpel to remove supports.
- Start removal from the outer areas and move towards the center.
- 'ABS-like' UV-resin is quite flexible.
- On the detail board, first remove the protective barrier and then you can separate the parts starting with the smallest ones.
- It is recommended to use large punch for rough trimming of vacu canopy and small punch (on supports) for finishing trimming.
- Each decal element must be cut to its outline.
- Detailed manual with painting options is available as PDF-file here:
<https://sputnik3dlabs.com/144013.pdf>

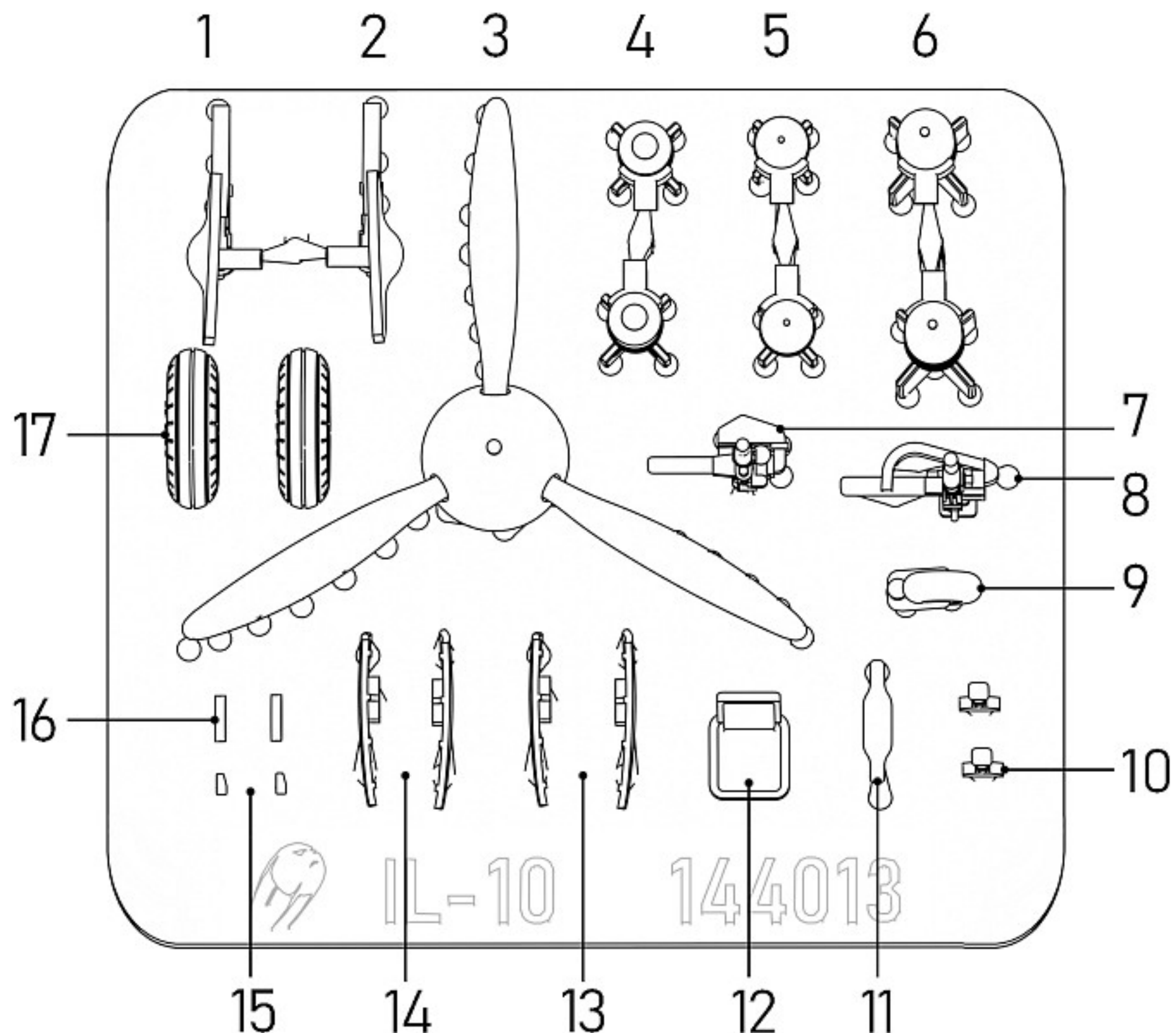

Assembly

1

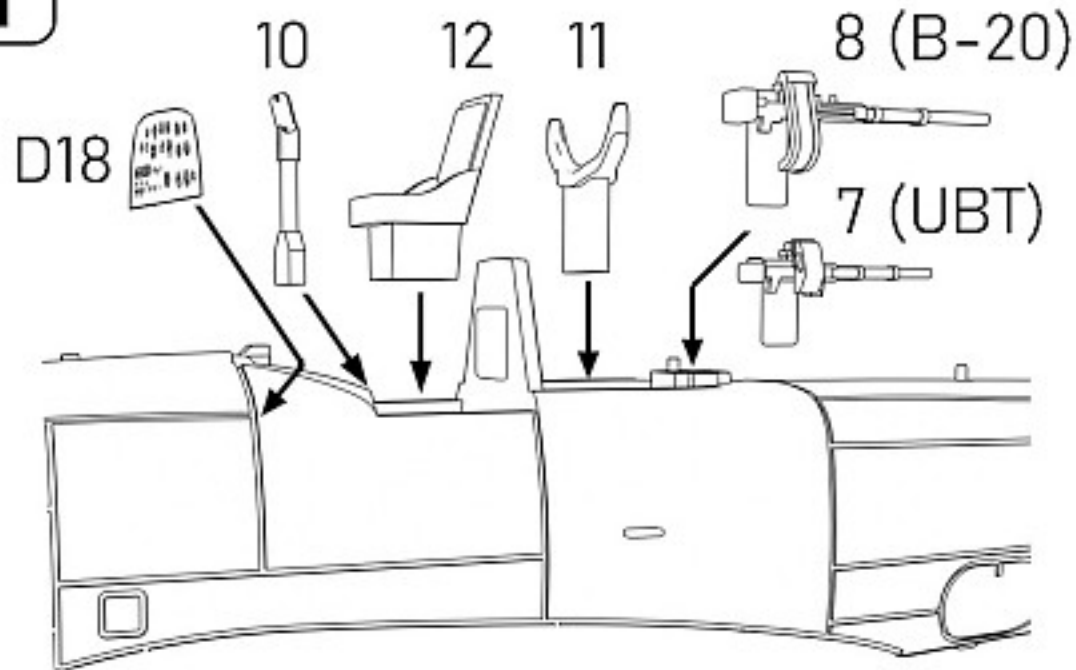

2

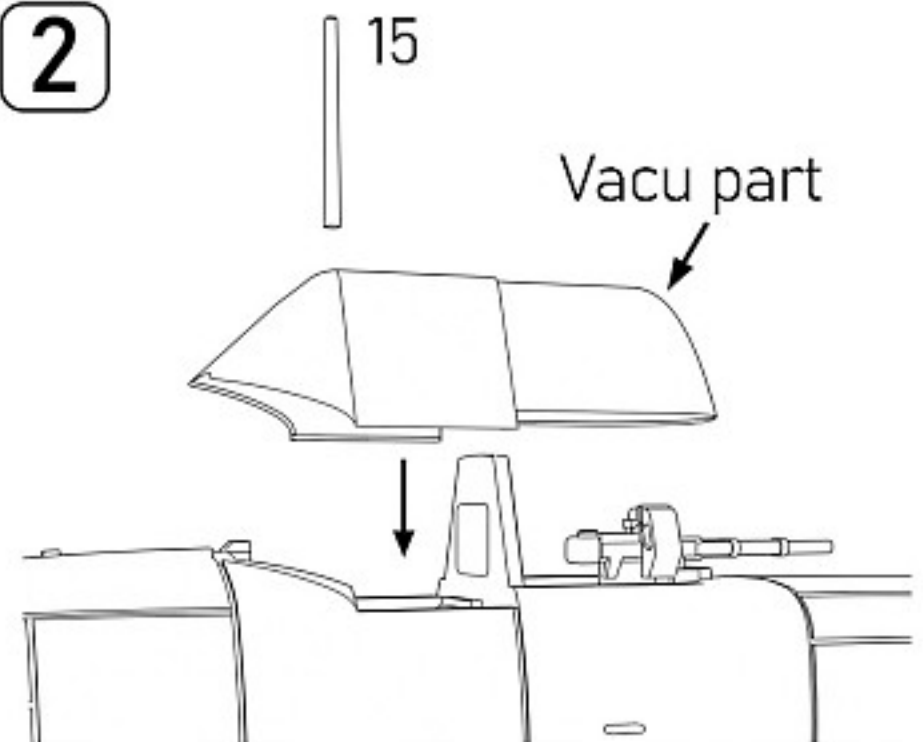

3

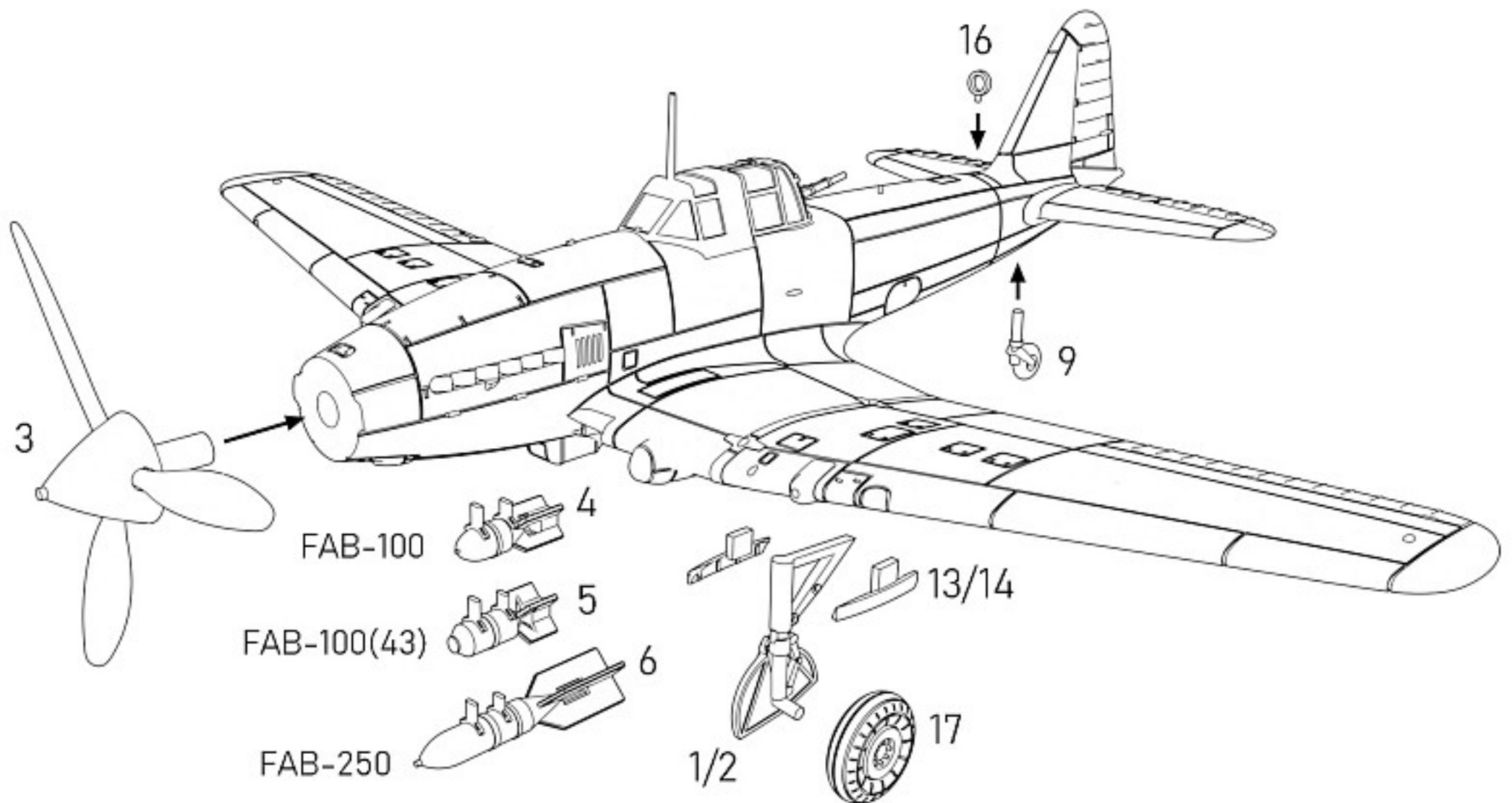

4

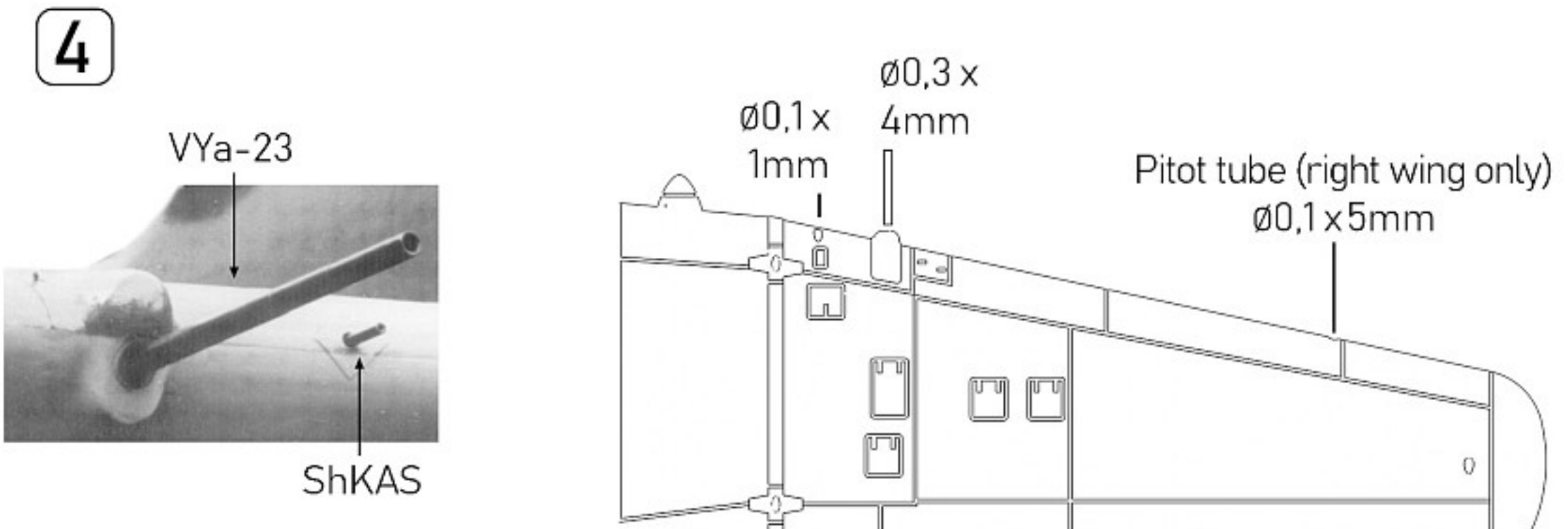

Marking options



IL-10 'Blue 33',
unknown unit,
spring of 1945



IL-10 of 15 GvShAP, Mjr.
Aleksenko V.A., twice HSS
July 1945



IL-10 Mjr.-General
Shundrikov V.P., comm. of
2nd GvShAD, East Germany,
1952



IL-10 of 175 SHaP, the ins-
cription was transferred
from IL-2, Latvia
summer of 1945



IL-10 'White 36' of
167 GvShAP, Georgia,
1949



IL-10 'White 39',
N.Korean Air Force
Kimpo Air Base,
summer of 1950