



Kit No. CB-35043

Sd.Kfz.6/2 (BN9b) 3.7cm FlaK36 auf Fahrgestell Zugkraftwagen 5t (Early/Late Production)

BRONCO 1/35 SCALE

Bronco Models Sd.Kfz.6/2 (BN9b) 3.7厘米 36型防空炮半履带车(前/后期型)

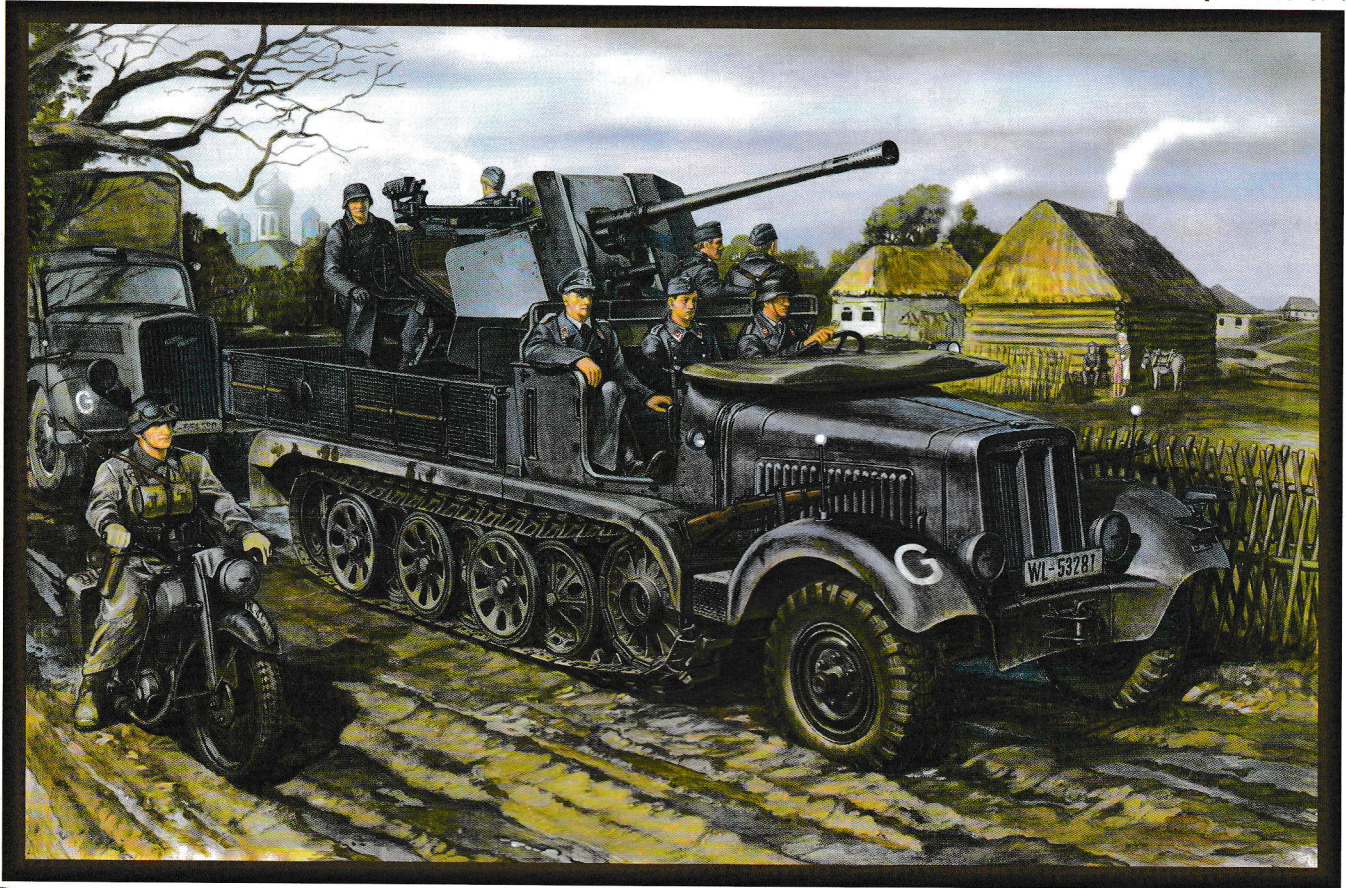

The Sonderkraftfahrzeug 6 (SdKfz.6) was one of a series of prime movers built for the German army during the late 1930's. Built originally to tow artillery, they were used for a wide variety of roles. The Sdkfz.6 weighed 9 tonnes and had a 5 tonne capacity, it was the usual towing vehicle for the 10.5cm leFH 18 howitzer. Later in the war some had anti-aircraft guns mounted in the rear cargo bed, such as the 3.7cm FlaK.36. This conversion was designated the 3.7cm FlaK.36 auf Selbstfahrlaffette SdKfz.6/2, and a total of 339 were built 1941-43. All were sent to Luftwaffe mobile anti-aircraft units where they replaced the SdKfz.7/2. In service they were used to protect armoured columns.

Short story by Phil Greenwood

Das Sonderkraftfahrzeug 6 (SdKfz.6) war eine von vielen in den 1930ern gebauten Zugmaschinen der Wehrmacht. Das 9 Tonnen schwere Fahrzeug konnte 5 Tonnen tragen. Ursprünglich zum Ziehen der Geschütze (z.B. 10,5cm leFH 18) gedacht, wurden diese Halbketten auch anderweitig eingesetzt. Im Verlauf des Krieges montierte man u.a. die 3,7cm FlaK 36 auf die Ladefläche. So entstand zwischen 1941-43 das SdKfz.6/2 mit 339 gebauten Fahrzeugen. Bei den Flugabwehreinheiten der Luftwaffe ersetzten sie das SdKfz.7/2 zum Schutze der gepanzerten Kolonnen.

TRANSLATION © Michael Knoblich ACADEMY EUROPE

Sd.Kfz.6 5t 是德国军队在 1930 代后期所发展一系列半履带车的其中一款；主要用作拖曳火炮或作为各式各样的用途使用。Sdkfz.6 重约 9 吨，装载能力有 5 吨，其通常任务是用来拖曳 10.5cm leFH 18 榴弹炮。在战争后期有部份这种车辆在后方载货平台装上 3.7cm FlaK.36 高射炮，这款式被称为 3.7cm FlaK.36 auf Selbstfahrlaffette SdKfz.6/2，从 1941-43 年间总共生产了 339 台。所有这种车辆均被分发往空军属下各流动防空单位替换 SdKfz.7/2。在作战行动中它们通常被安排作为在装甲部队中执行防空任务。

ILLUSTRATION 图示说明:

CORRECT METHOD FOR APPLYING DECALS : HINWEISE ZUM ANBRINGEN DER DECALS 正确使用水贴纸的方法:

1. Clean model parts surface with wet cloth. Entsprechende Stellen am Modell feucht reinigen.
将需要贴水贴之部位表面擦干净。
2. Cut out the decal parts and dip them in cold water for 15 ~20 seconds. Decal ausschneiden und für 15-20 Sek. ins Wasser legen.
将所需之贴纸剪下泡在清水里约15至20秒。
3. Place it on correct position of the model kit. Decal an der richtigen Stelle auflegen.
将湿透之贴纸取出置放于正确之位置旁。
4. Slide off the decal from the base paper on to the model kit surface with a cotton stick. Decal mit Wattestäbchen festhalten und Papier darunter wegziehen.
用棉花棒轻推贴纸表面使其从底纸滑出至模型表面之正确位置。
5. When decal get dry then complete. Decal mit Papiertuch andrücken und trocknen.
待其自然干透后即完成。

ICON INSTRUCTION: 图标说明:



Open Hole
Loch bohren
钻孔



Remove
Abtrennen
切除



x2 2 Sets needed
Vorgang wiederholen
同样的制作二组



Bend
Biegen
曲折



Optional
Auswahl
可以选择采用



Apply Decal
Decal anbringen
贴水贴纸



Instant Glue For Metal
Sekundenkleber verwenden
瞬间接着剂,金属用



Fill Hole
Verspachteln
把孔填平



Do not cement
Nicht kleben
不用粘合

COLOR SUGGESTION: FARBTABELLE: 涂装指引:

Color 涂料表	MR. Hobby	Hobby Color	Humbrol	Tamiya
Steel Stahl 黑铁色	H-18	C-28	53	/
Wood brown Holzbraun 木棕色	H-37	C-43	/	/
Silver Silber 银色	H-8	J-8	11	X-11
Flat white Matt Weiss 消光白	H-11	C-62	34	XF-2
Red Rot 红色	H-3	C-3	19	X-7
Rust Rust 铁锈色	H-334	/	113	/
Tyre black Reifenschwarz 轮胎黑	H-77	C-137	85	/
Semi-gloss black Schwarz Seidenmatt 半光黑色	/	C-82	/	/
German gray Deutsches Grau 德国灰	H-32	C-40	92	XF-63
White Weiss 白色	H-1	C-1	/	X-2
Flat black Mattschwarz 消光黑	H-12	C-33	33	XF-1
Copper 铜色	H-10	C-10	12	XF-6
Field gray Feldgrau 原野灰	H-48	C-52	/	XF-65
Red brown Rotbraun 红棕色	H-47	C-41	61	XF-64
Dark green Dunkelgrün 暗绿色	H-36	C-17	30	XF-61
Dark yellow 暗黄色	H-78	C-39	83	XF-60

READ BEFORE ASSEMBLING: VOR ZUSAMMENBAU LESEN: 组装必读:

- Carefully Study instruction before assembling. Anleitung studieren und verständlich machen. 组装前请阅读清楚制作指引。
- Keep plastic model glue and tools away from children. Kleber, Farben, Werkzeuge und Plastiktüten von Kindern fernhalten. 胶水,油漆及工具勿让小孩接触。
- Do not use cement or paint near open flame or sparks. Kleber/Farbe nicht in Nähe von offenen Flammen. 胶水及油漆勿接触火种。
- Do not work in closed room. Nur in ausreichend belüfteten Räumen arbeiten. 勿在密封地方制作模型。

PARTS LIST 零件展示表:

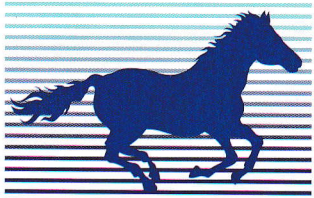

BRONCO

Bronco Models

Copyright © 2011

Made in China

中国制造

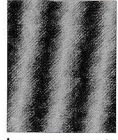

No use parts
不要部件

Ⓐ₁ × 2

Ⓐ₂ × 1

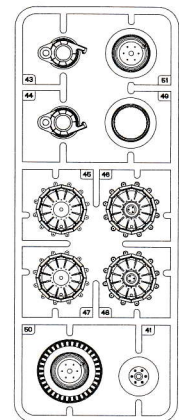
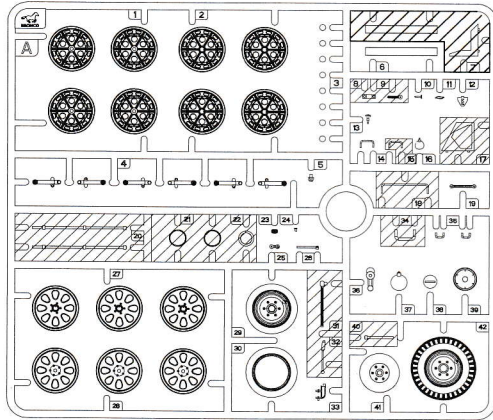

Ⓑ × 1

Ⓑ_b × 1

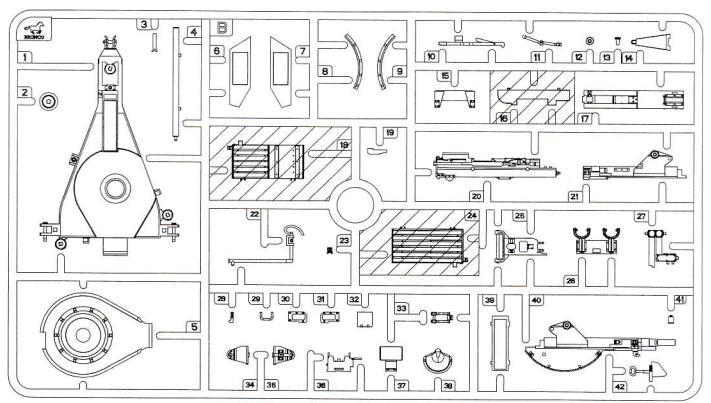
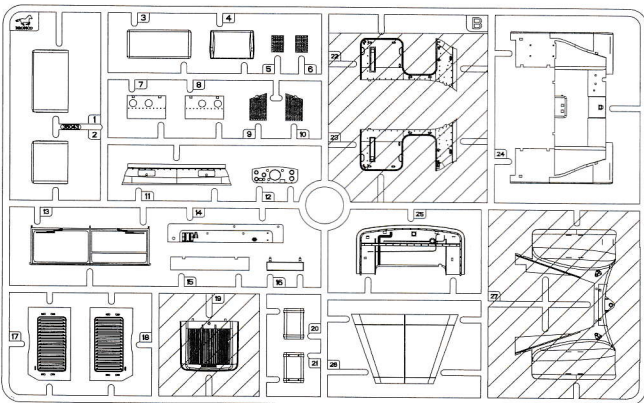

Ⓒ × 1

Ⓒ_b × 1

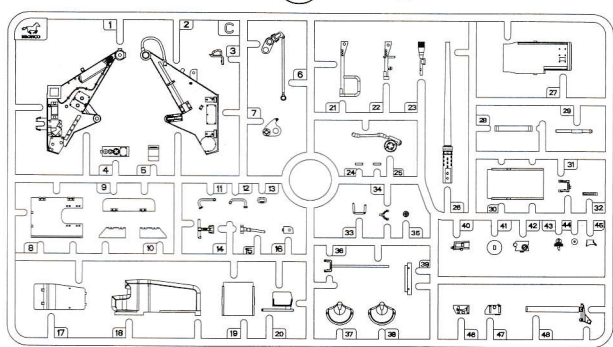
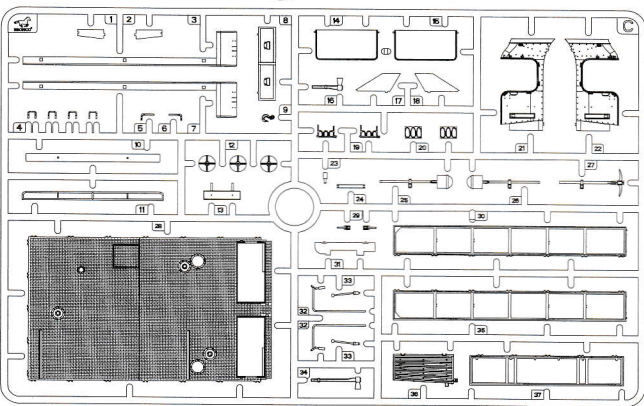

Ⓓ × 1

Ⓓ_b × 3

Ⓔ × 1

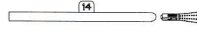
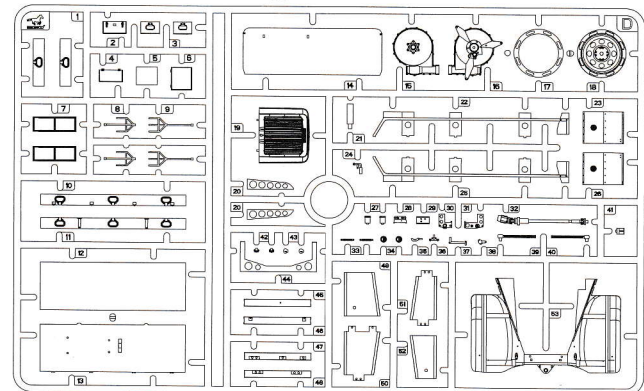

Ⓓ_b × 2

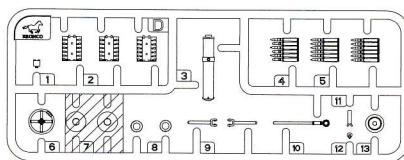
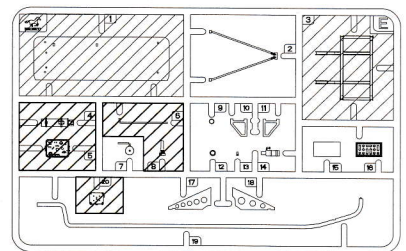

String
细绳

PARTS LIST 零件展示表:

Ⓔ × 1

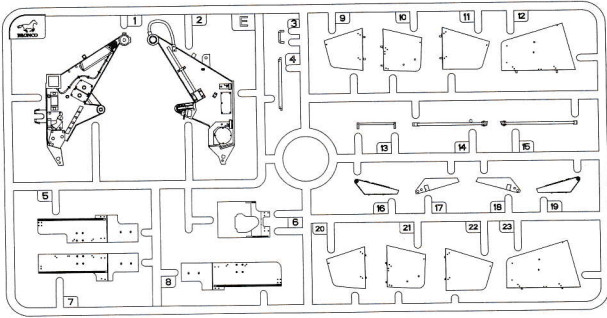

Ⓕ × 1

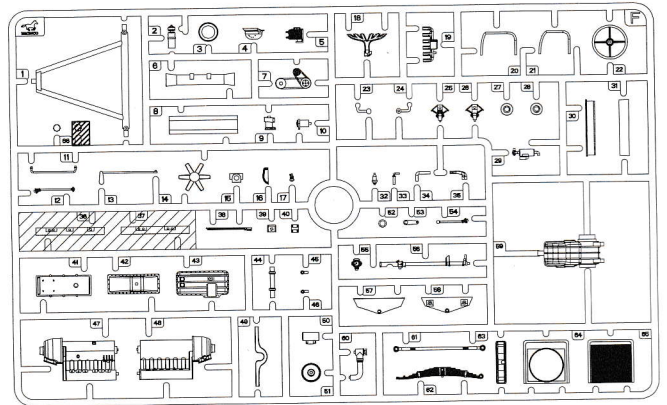

Ⓖa × 1

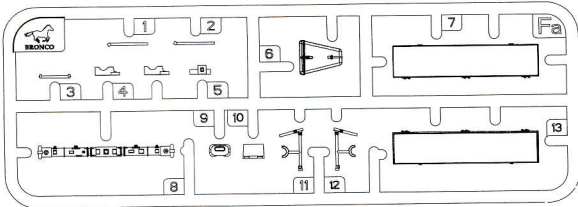

Ⓖ × 4

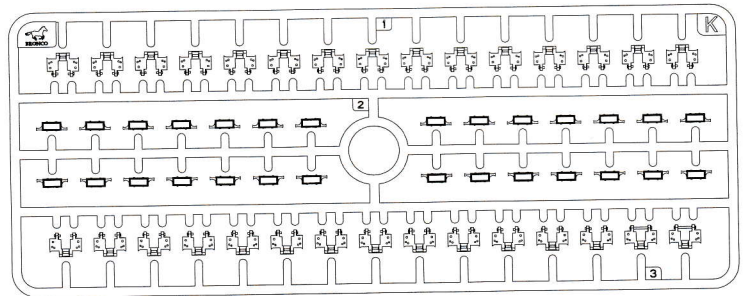

Ⓖb × 1

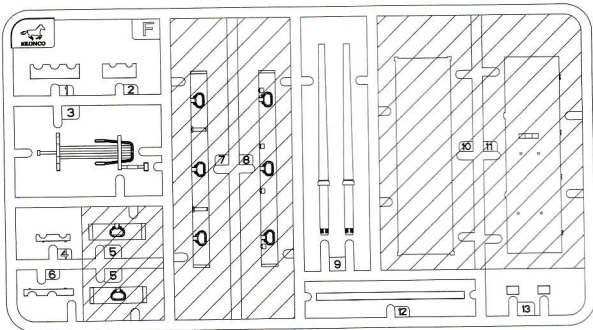

Ⓖ × 6

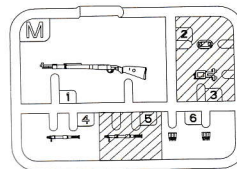

Ⓖ × 1

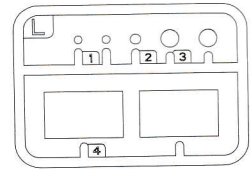

Ⓖ × 16

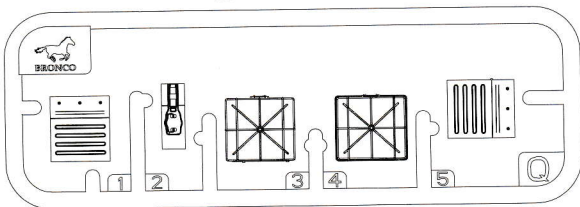

Ⓖ × 1

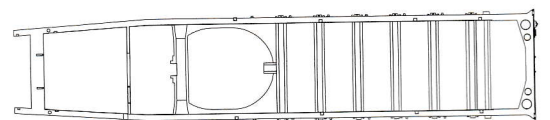

Ⓖ × 3



DECAL × 1

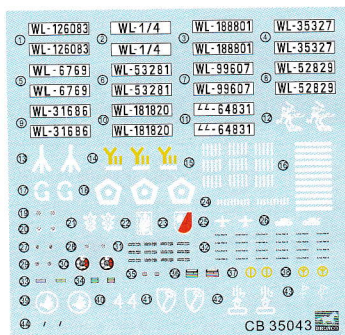

Ⓖ × 1

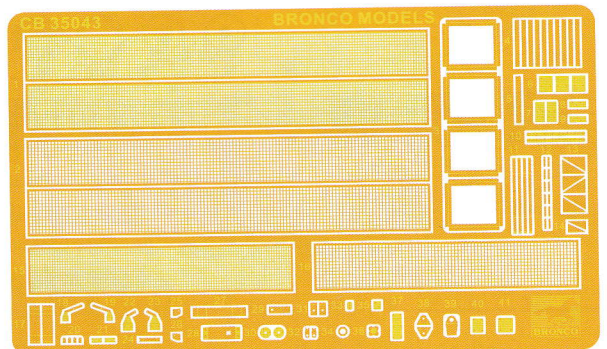

Ⓖ × 1



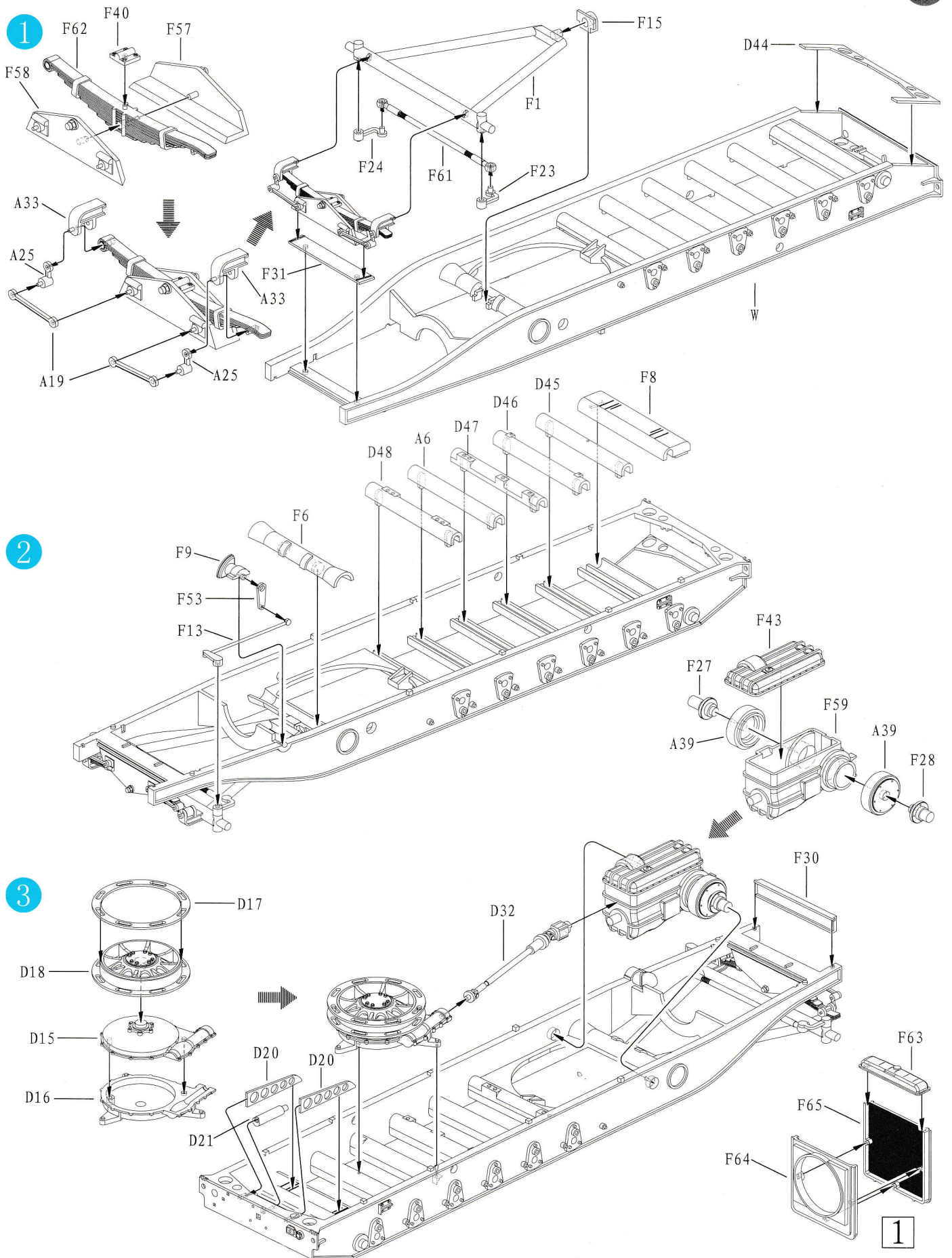
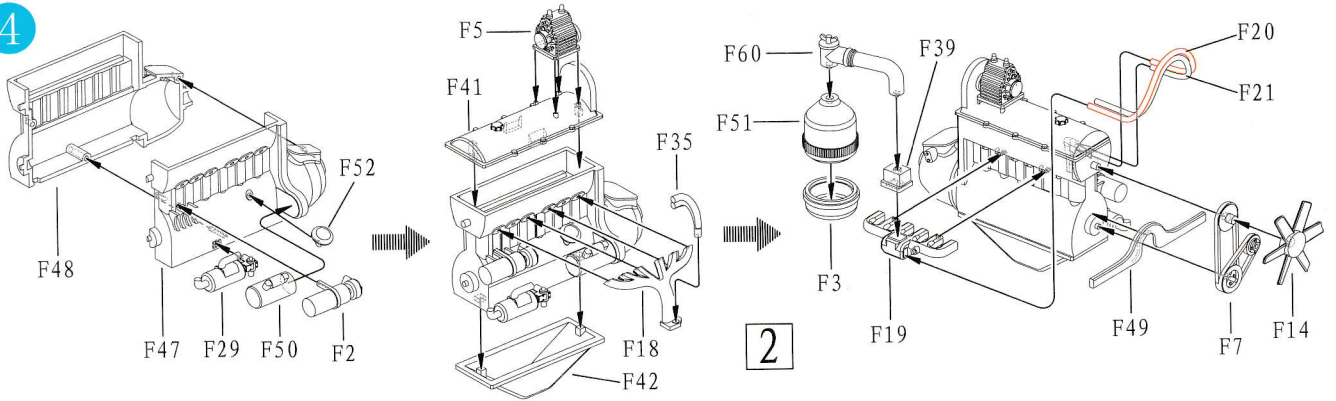
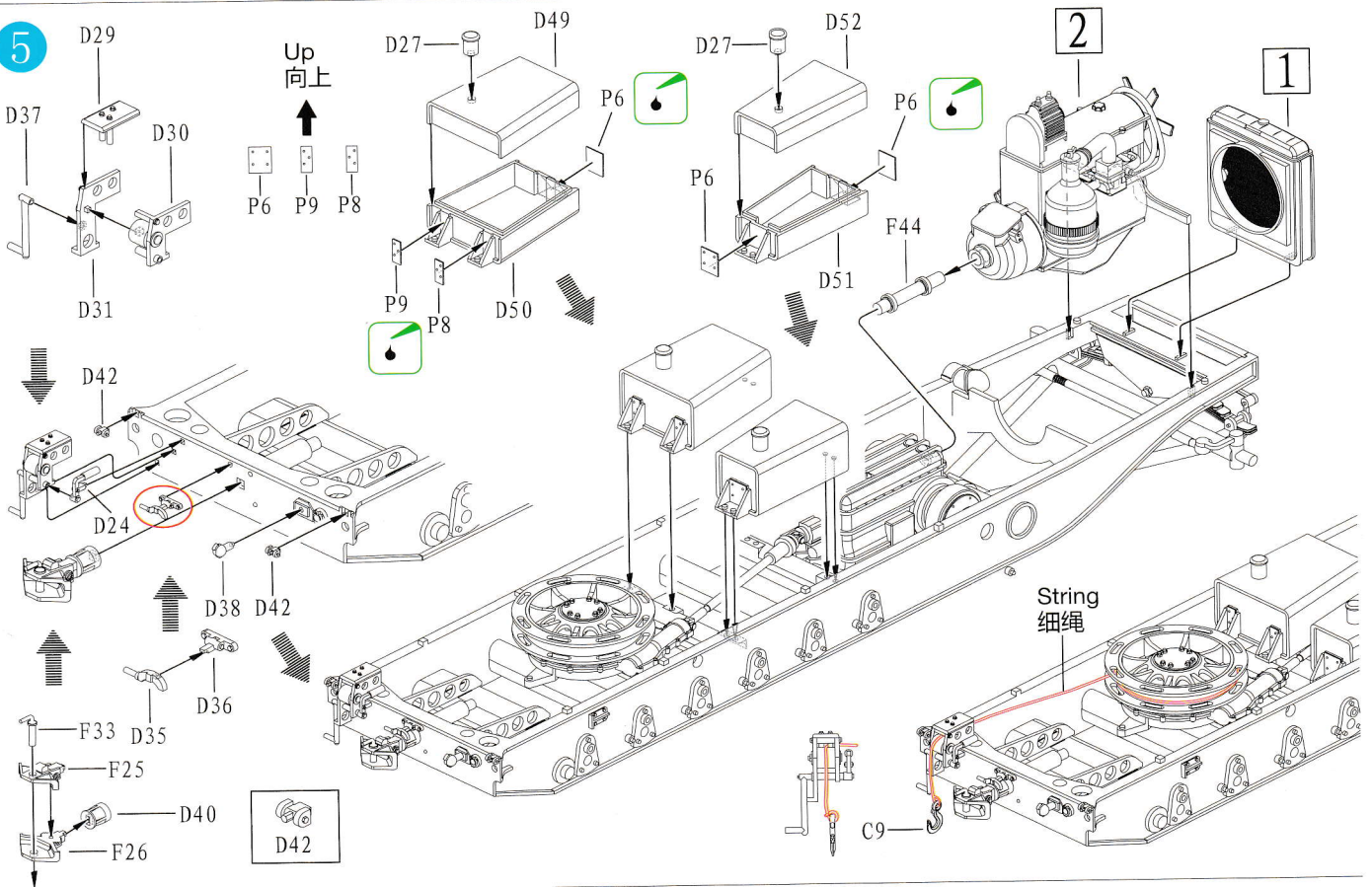

ILLUSTRATION 图示说明:

4



5



6

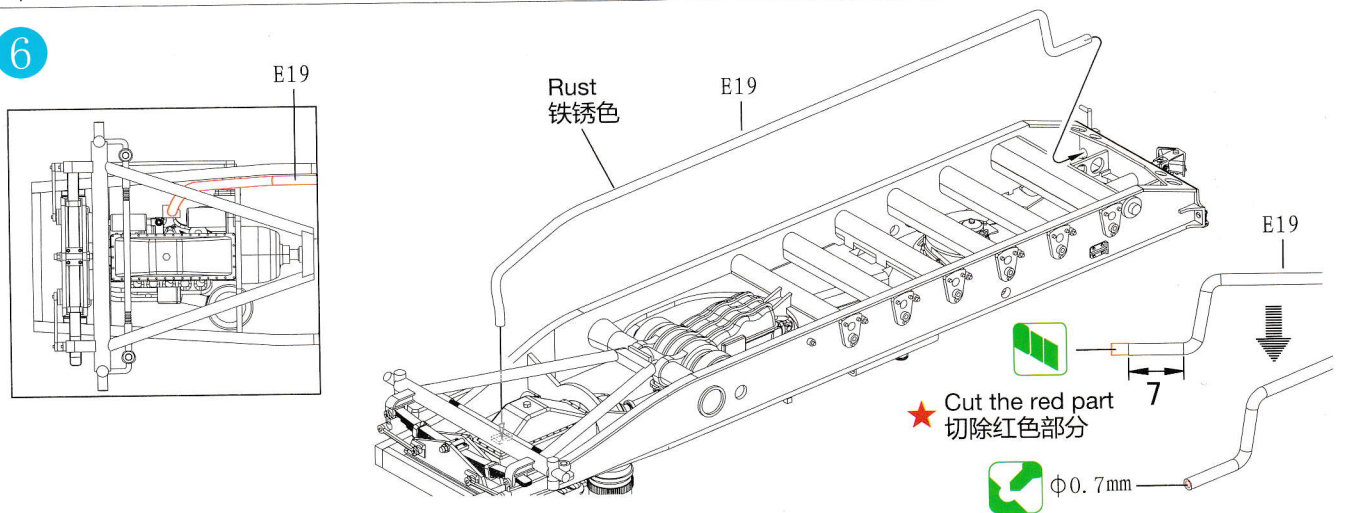

7

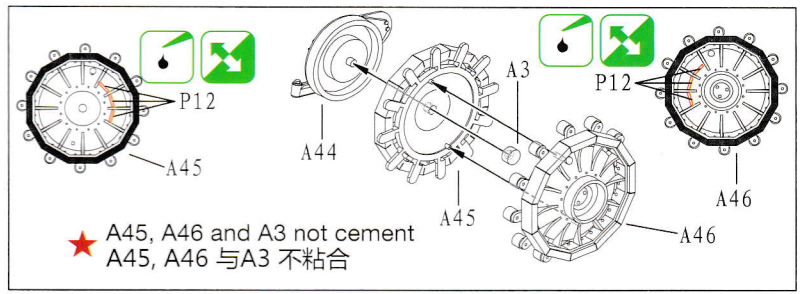
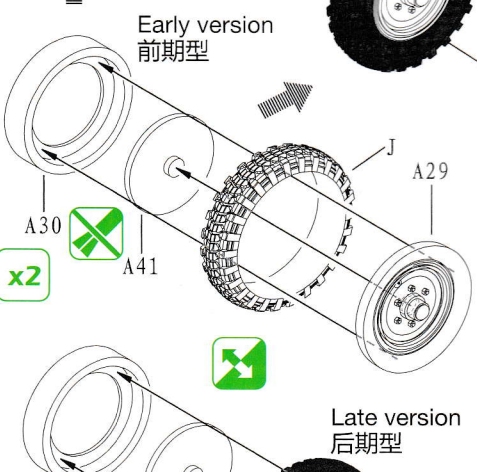
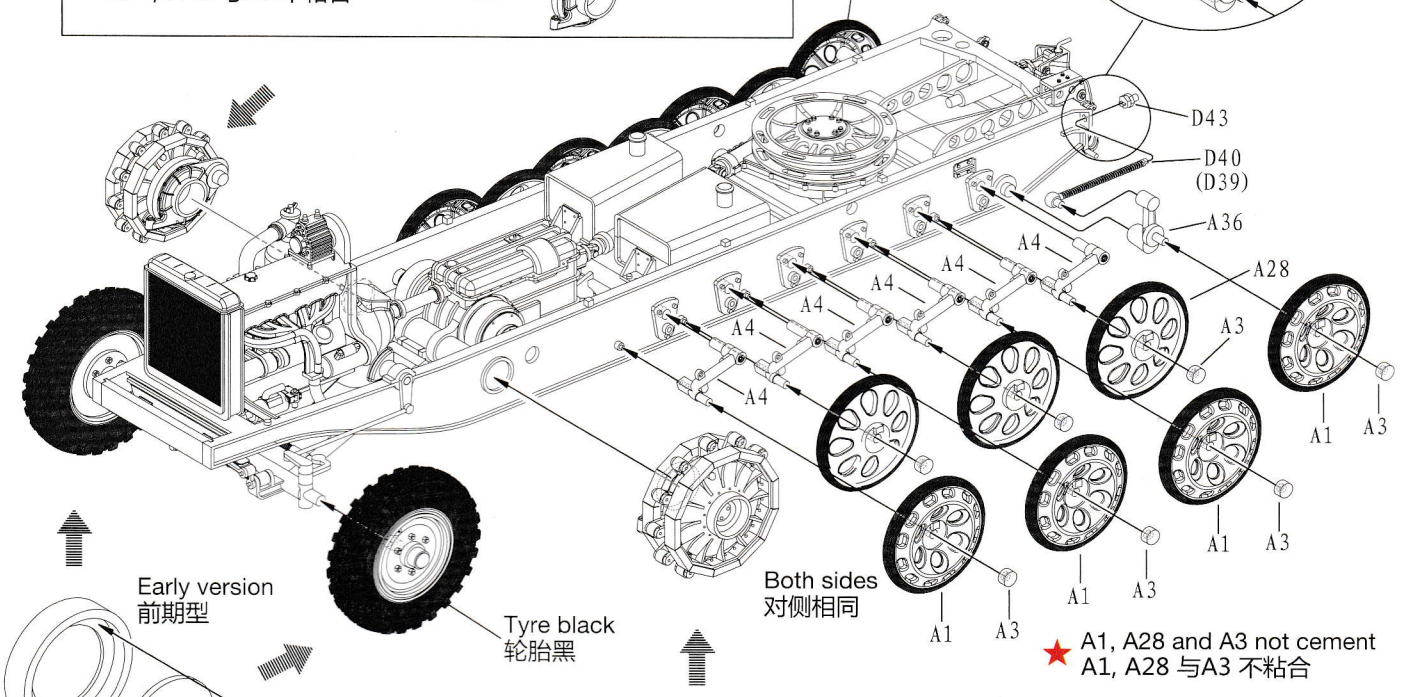
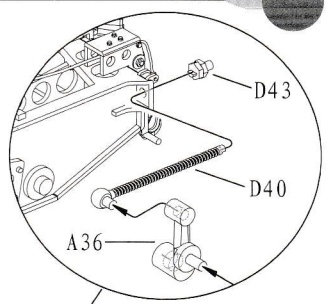
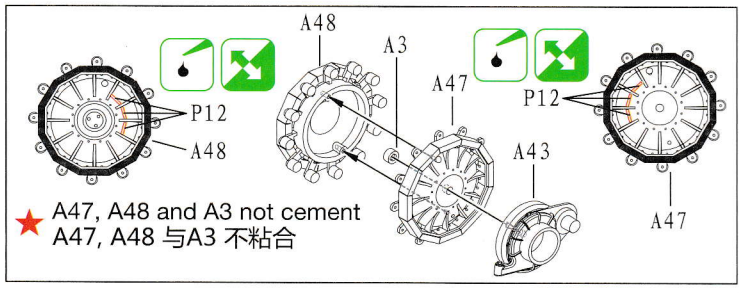

8

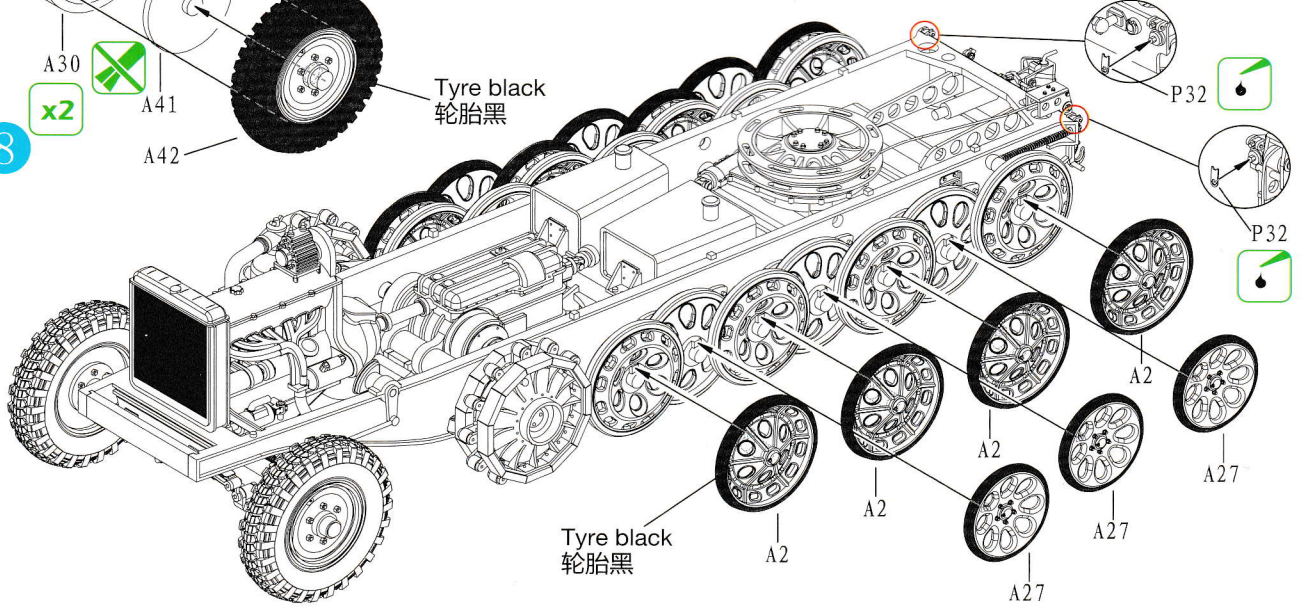
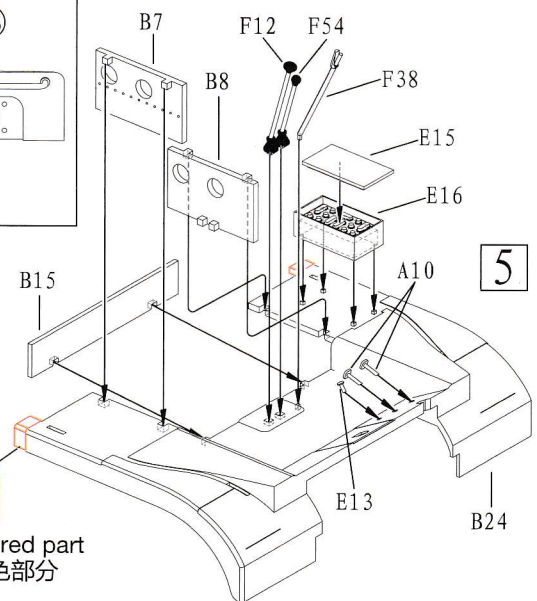
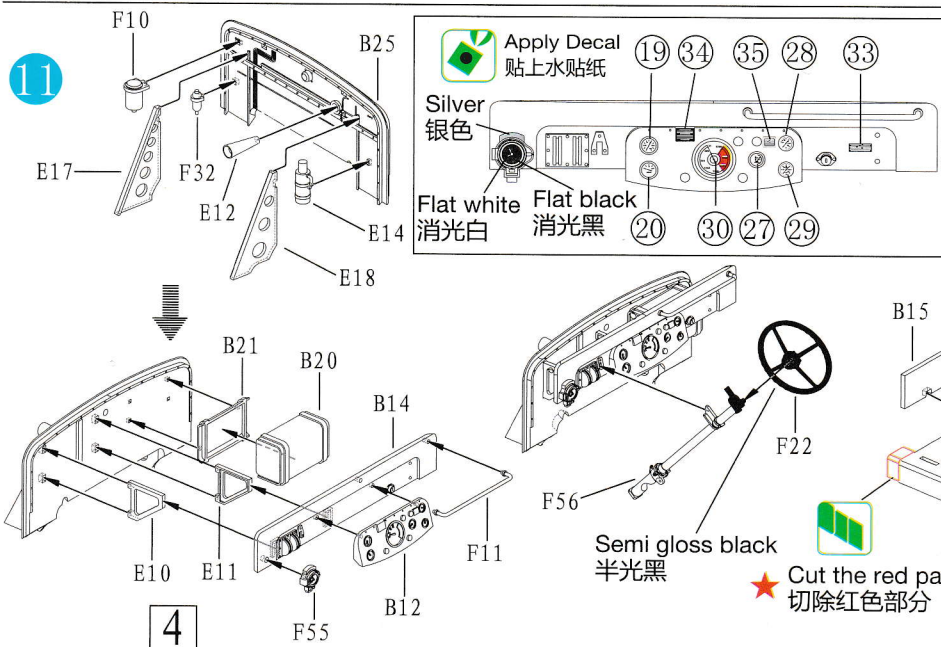
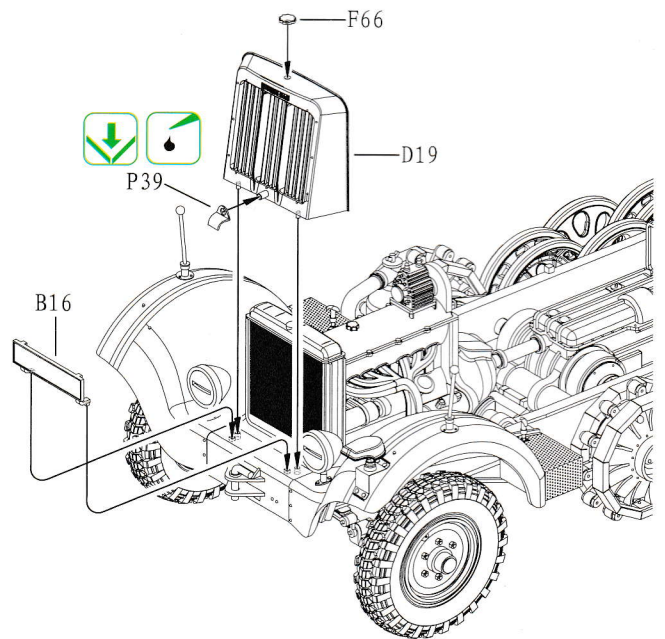
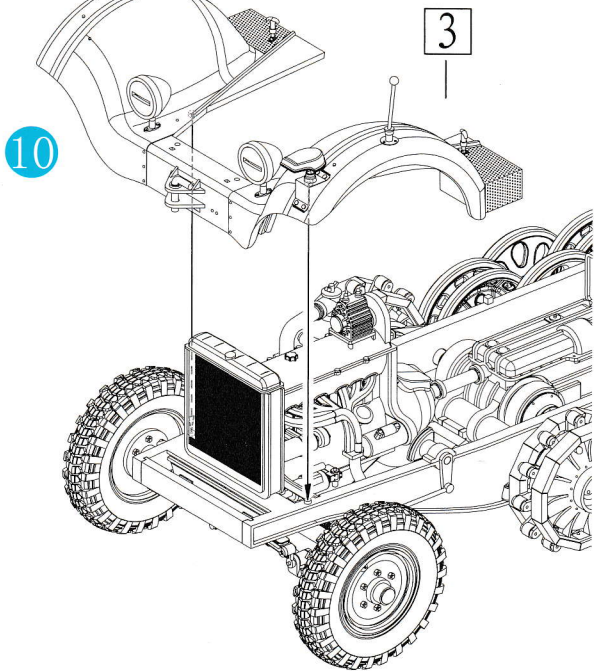
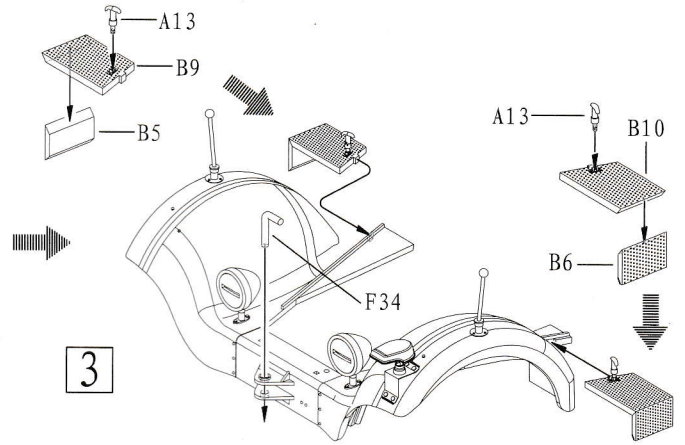
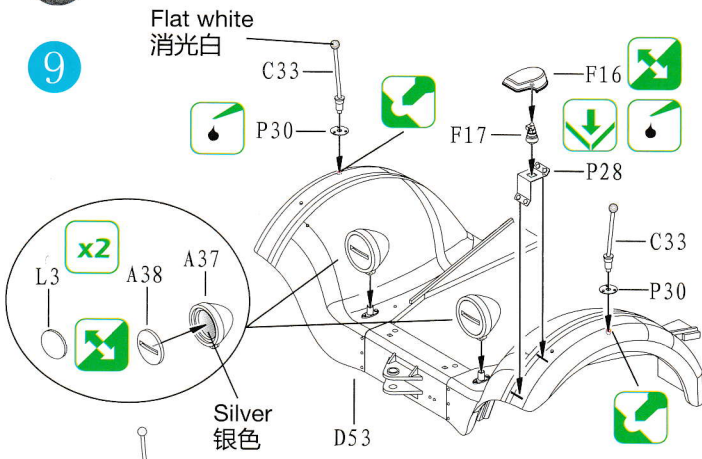

ILLUSTRATION 图示说明:



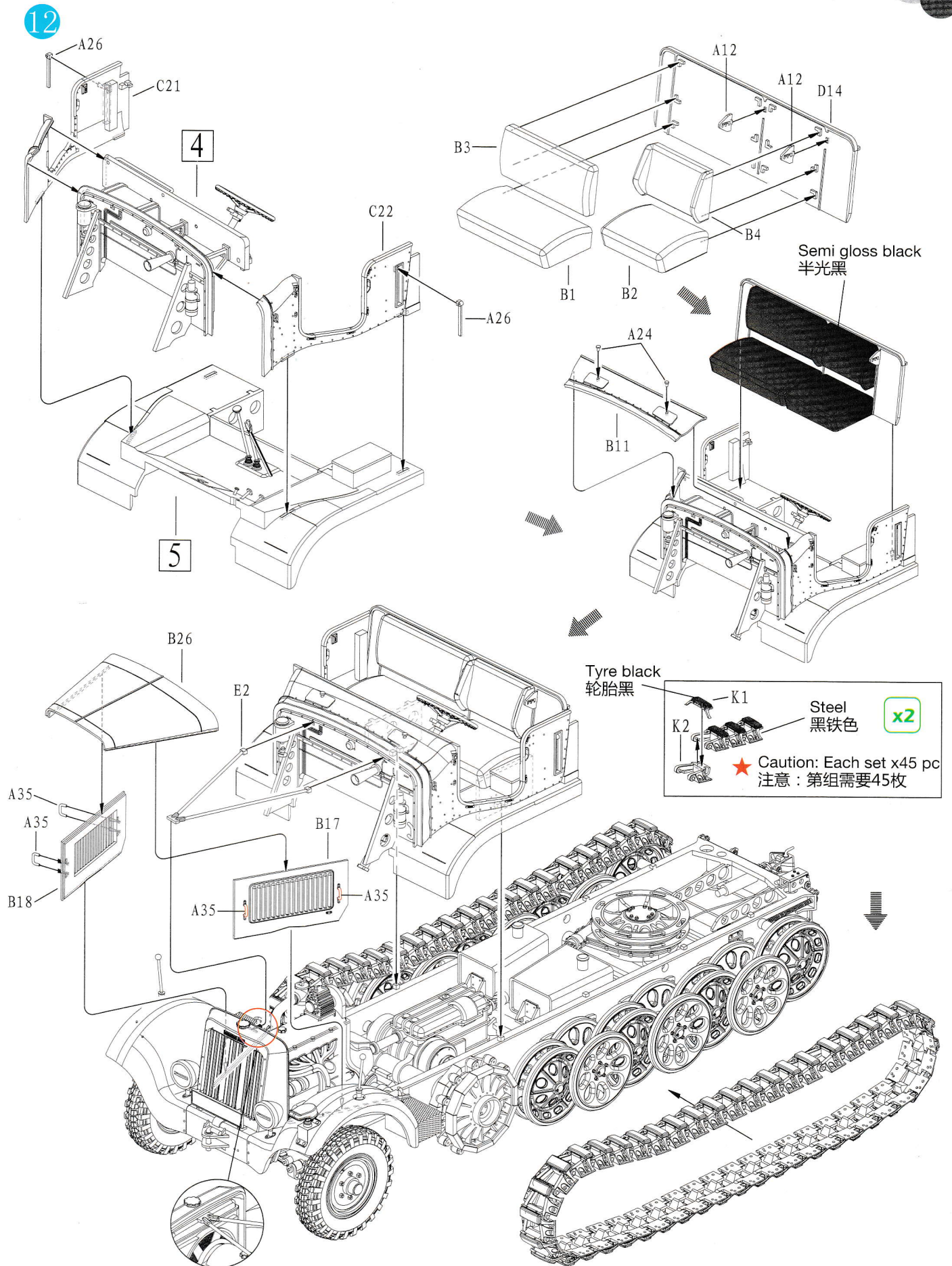
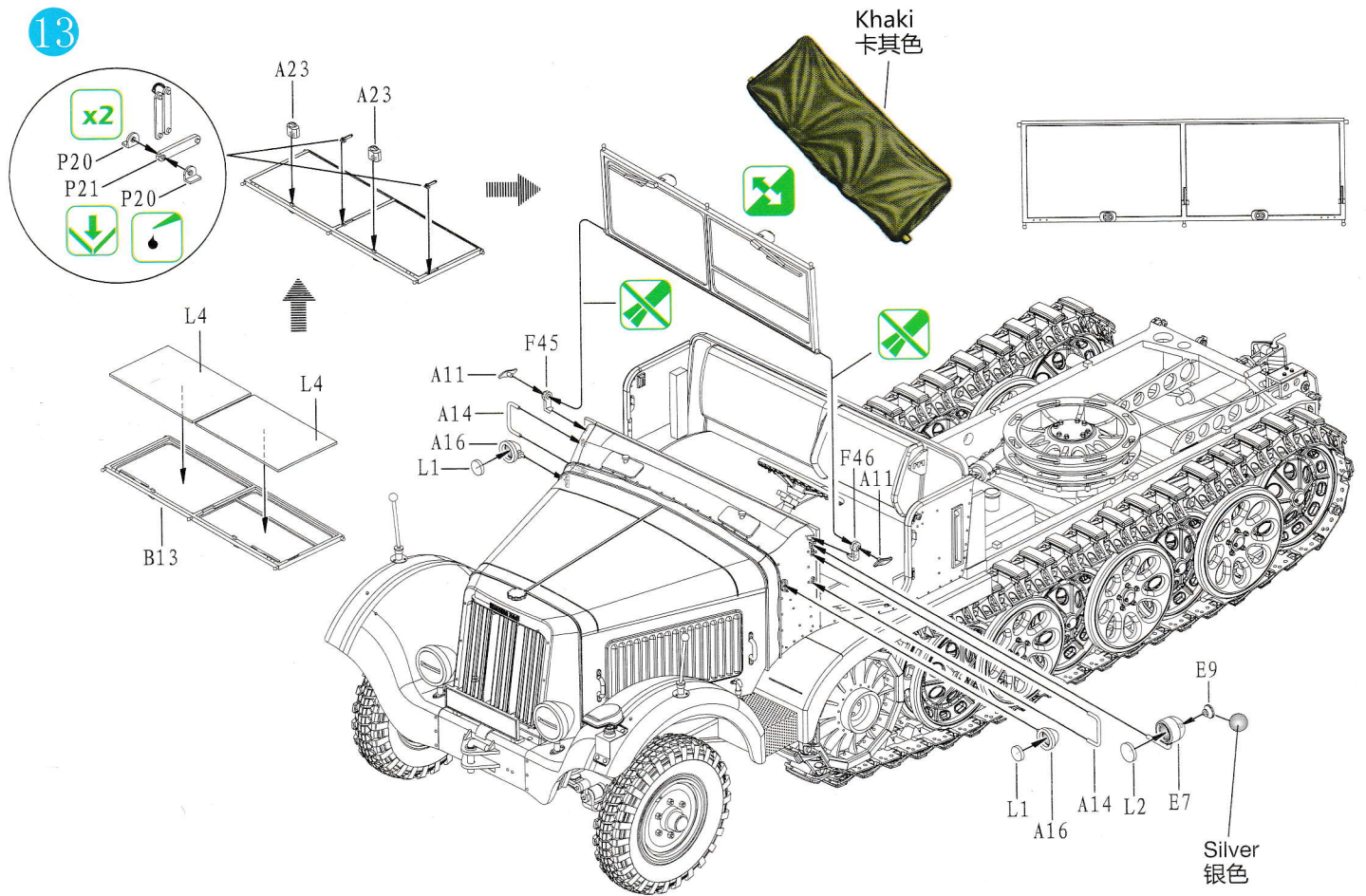
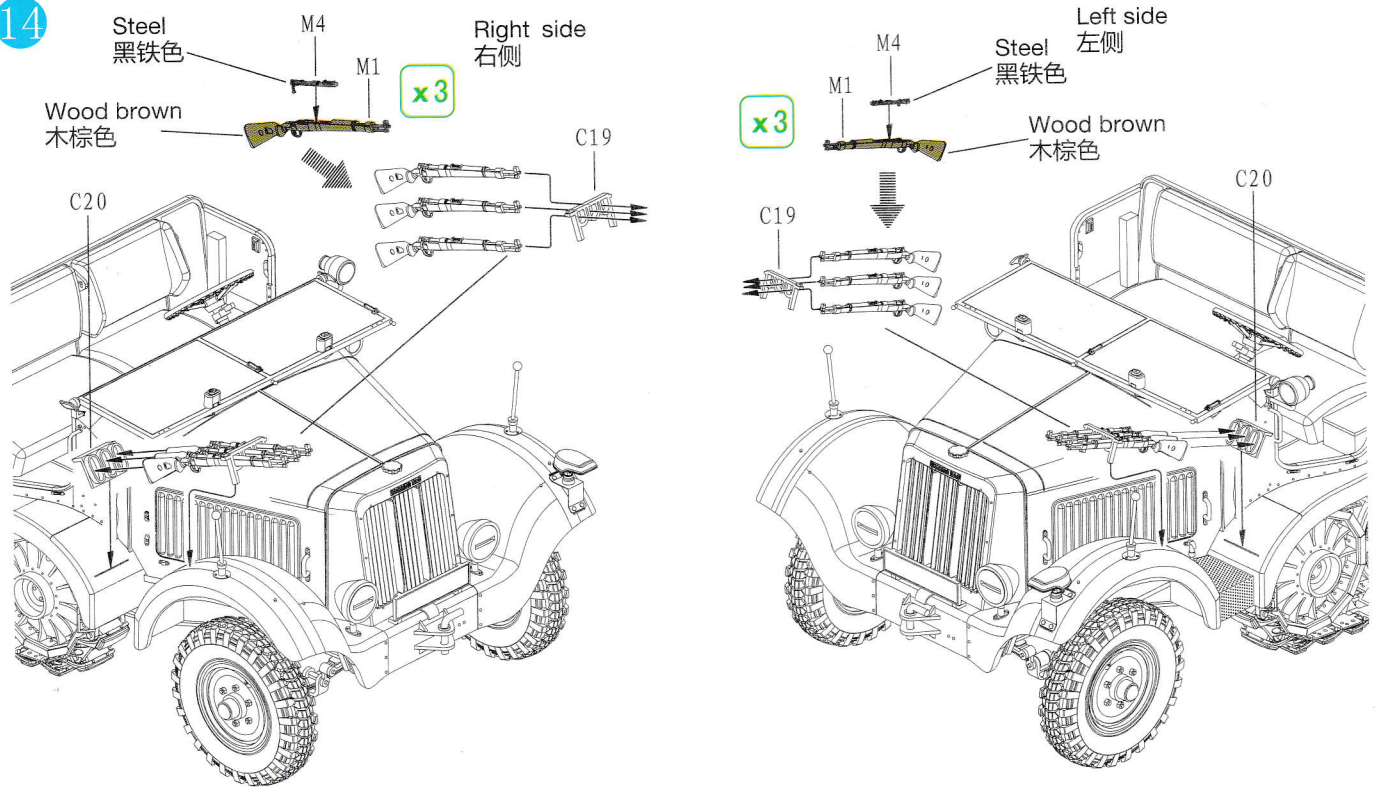

ILLUSTRATION 图示说明:

13



14



15

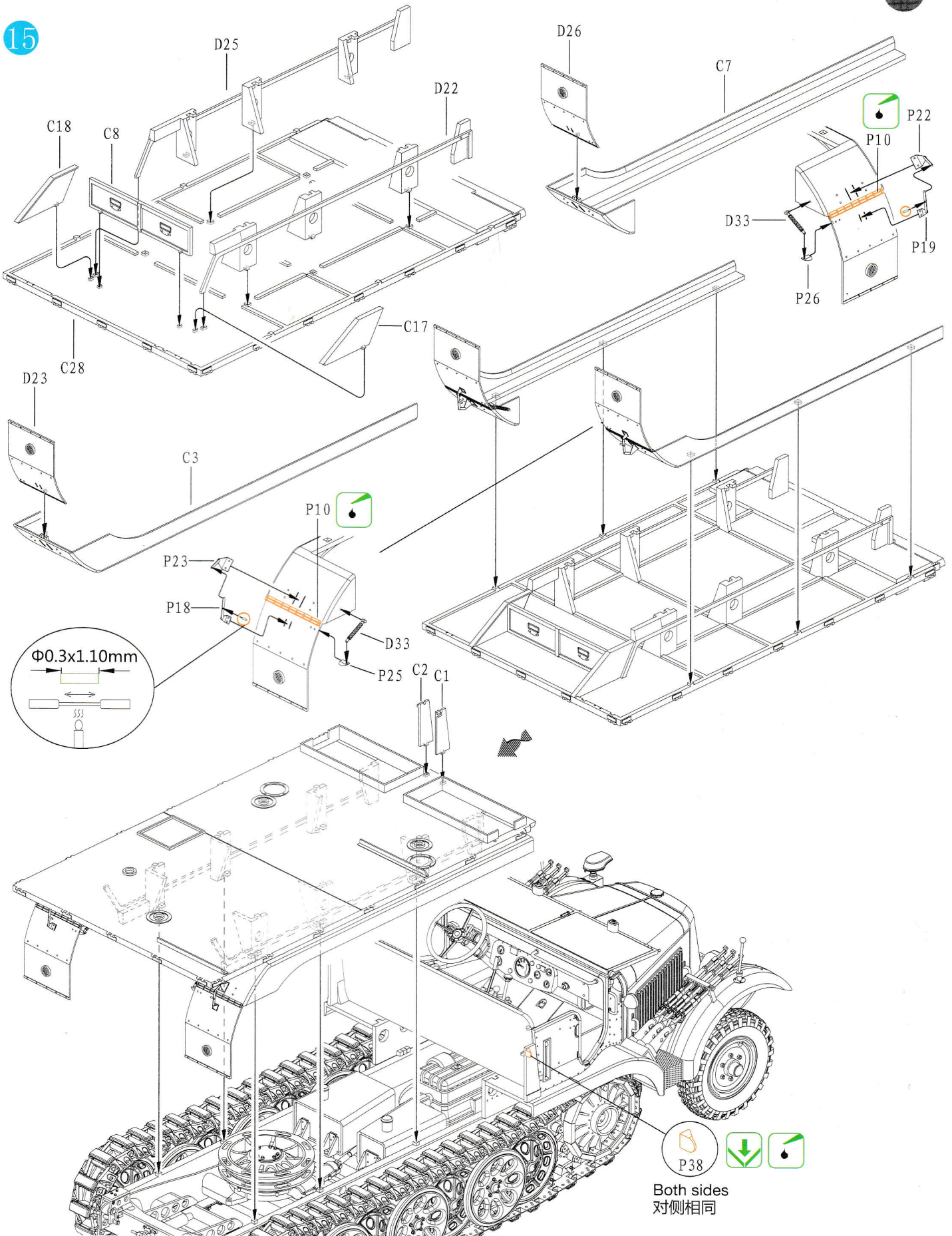
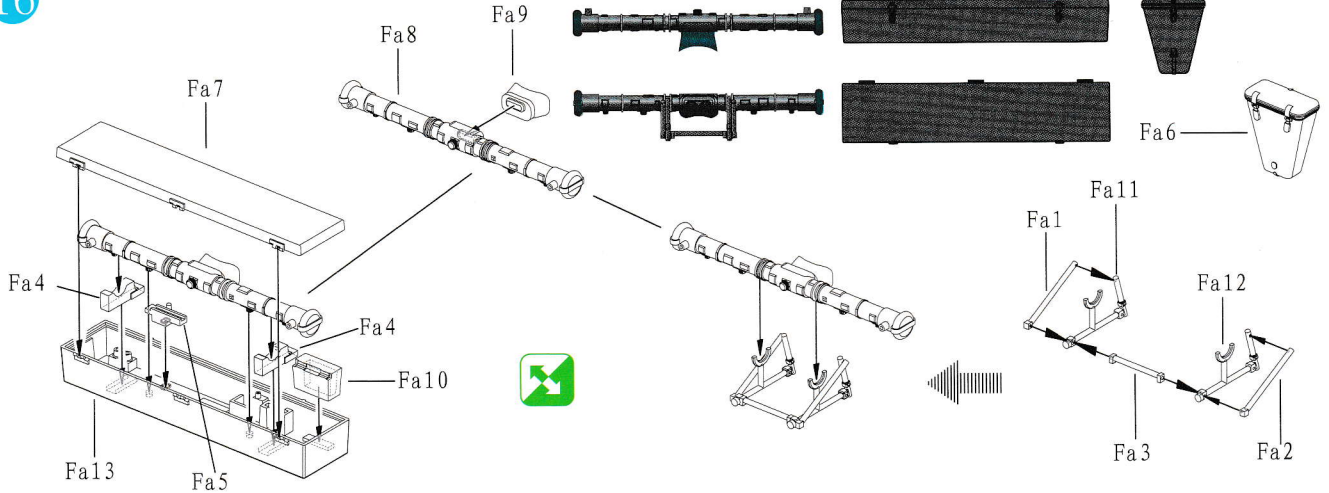

ILLUSTRATION 图示说明:

16

★ Assembly for German R36 Range Finder & Container
德军R36测距仪及储存箱的组装方法



17

★ Caution: The parts of F1&F2 is for the spare gun barrels on standby condition
注意: F1及F2零件是供后备炮管在作战时处于随时换装状态

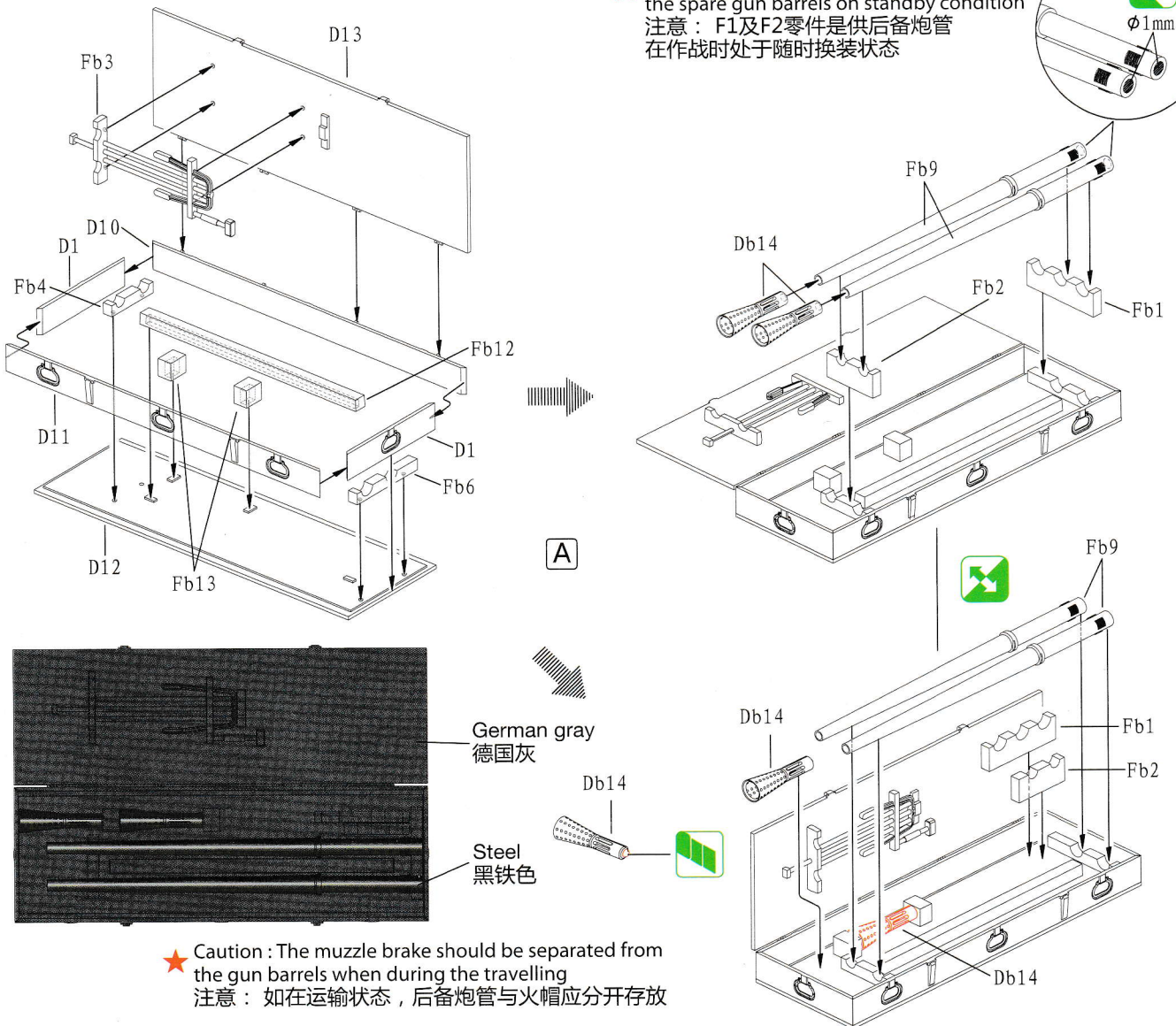

★ Caution: The muzzle brake should be separated from the gun barrels when during the travelling
注意: 如在运输状态, 后备炮管与火帽应分开存放

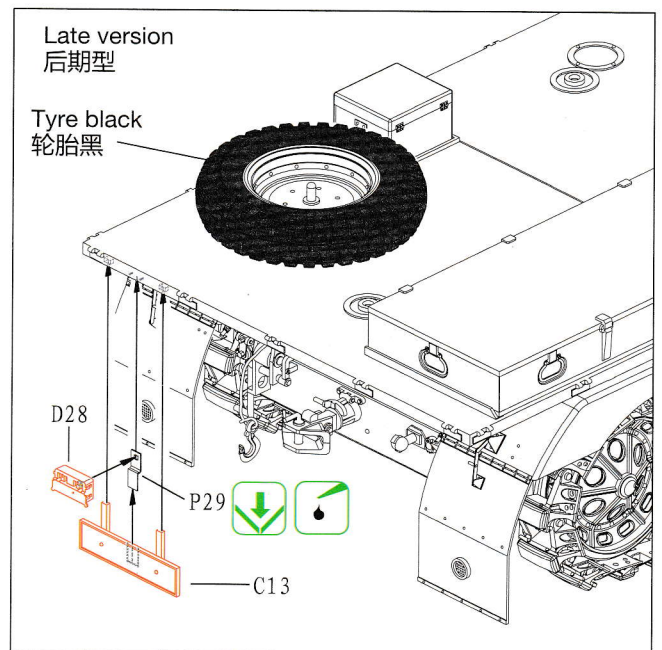
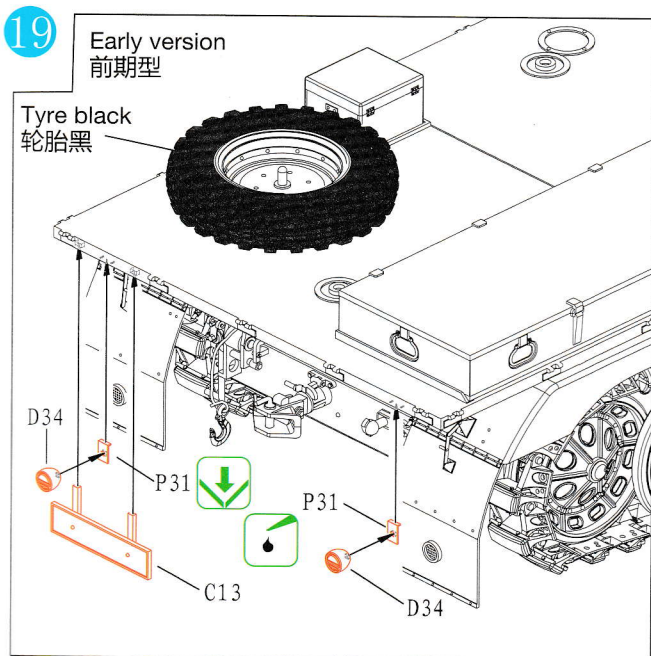
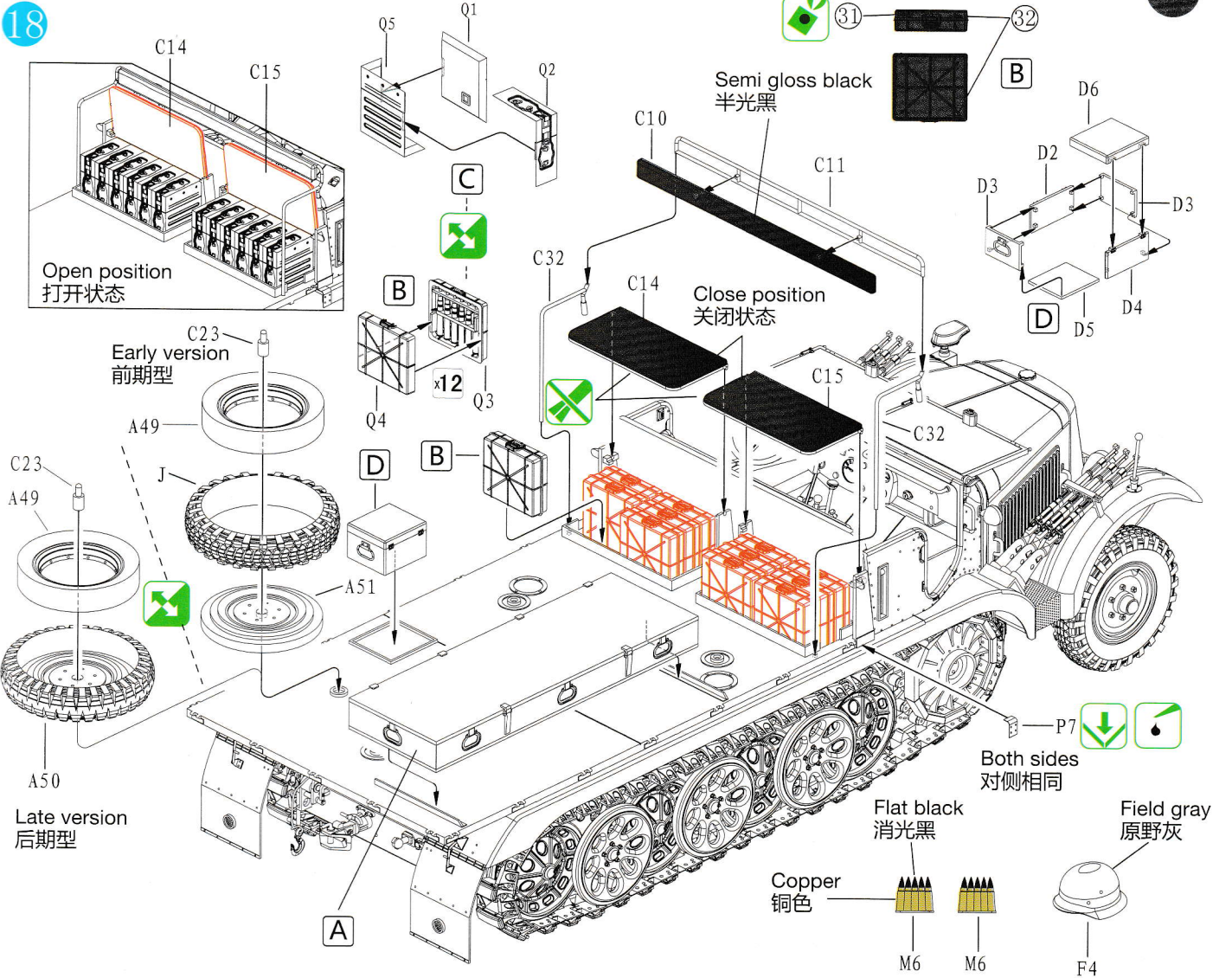
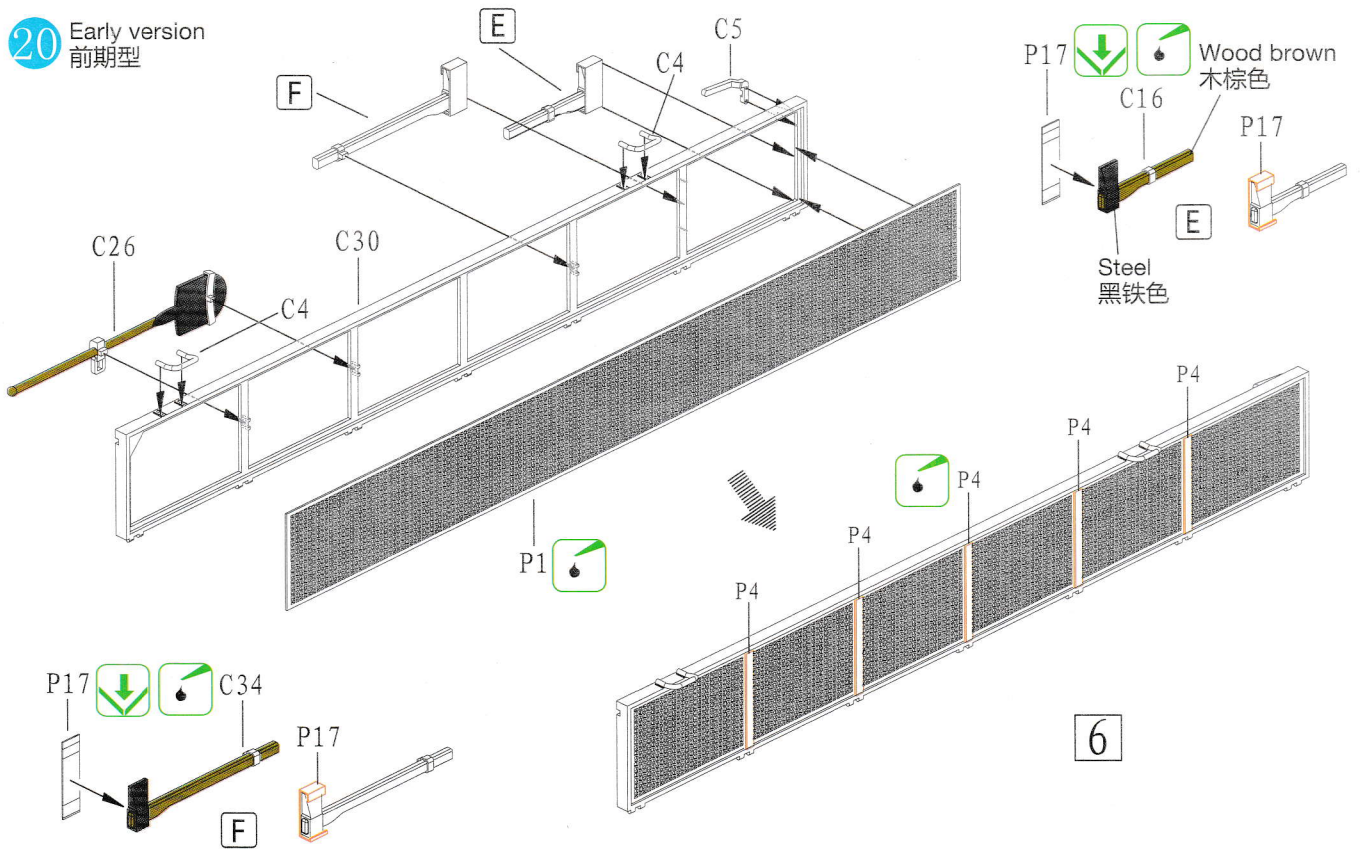
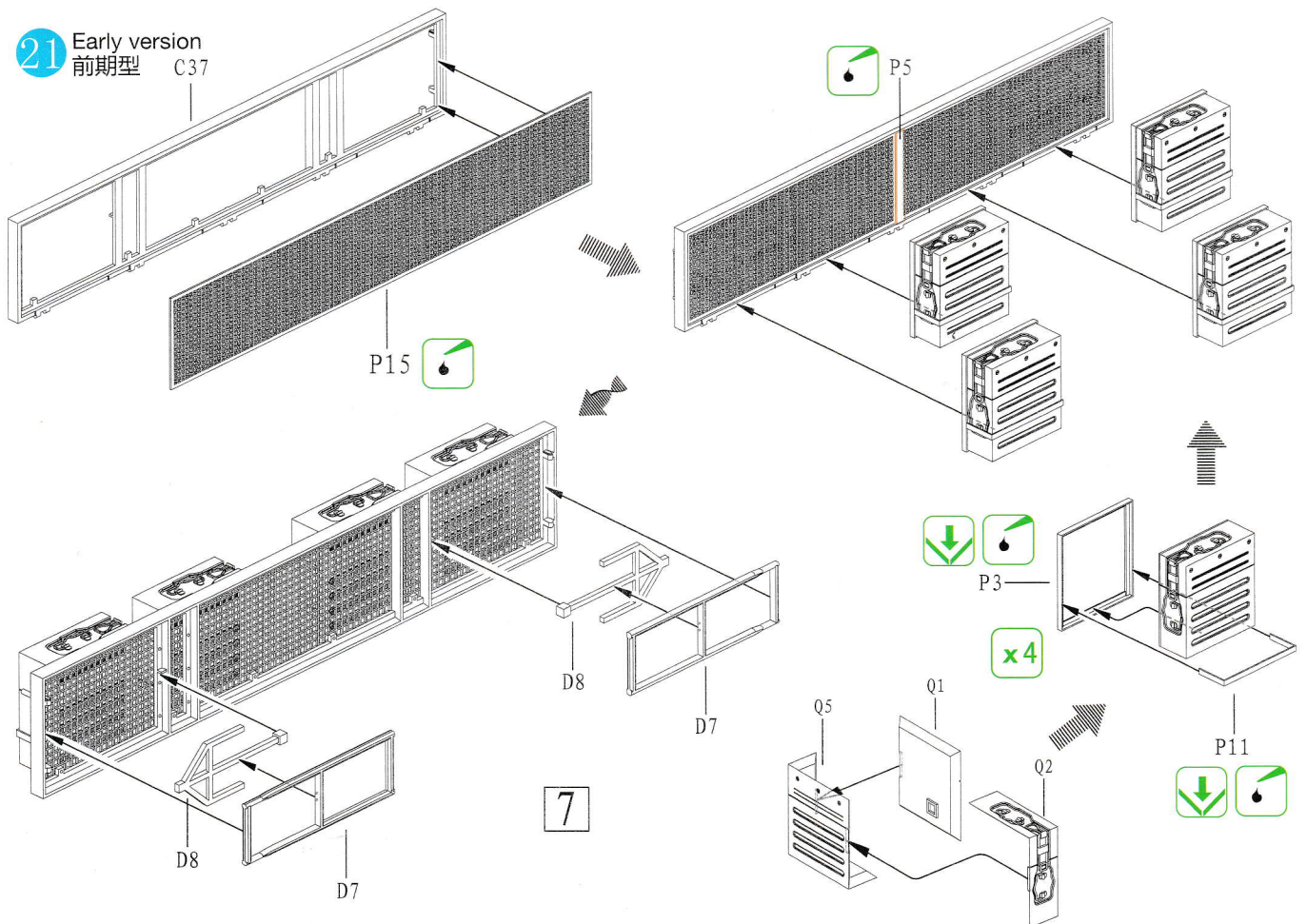

ILLUSTRATION 图示说明:

20 Early version
前期型



21 Early version
前期型



22 Early version
前期型

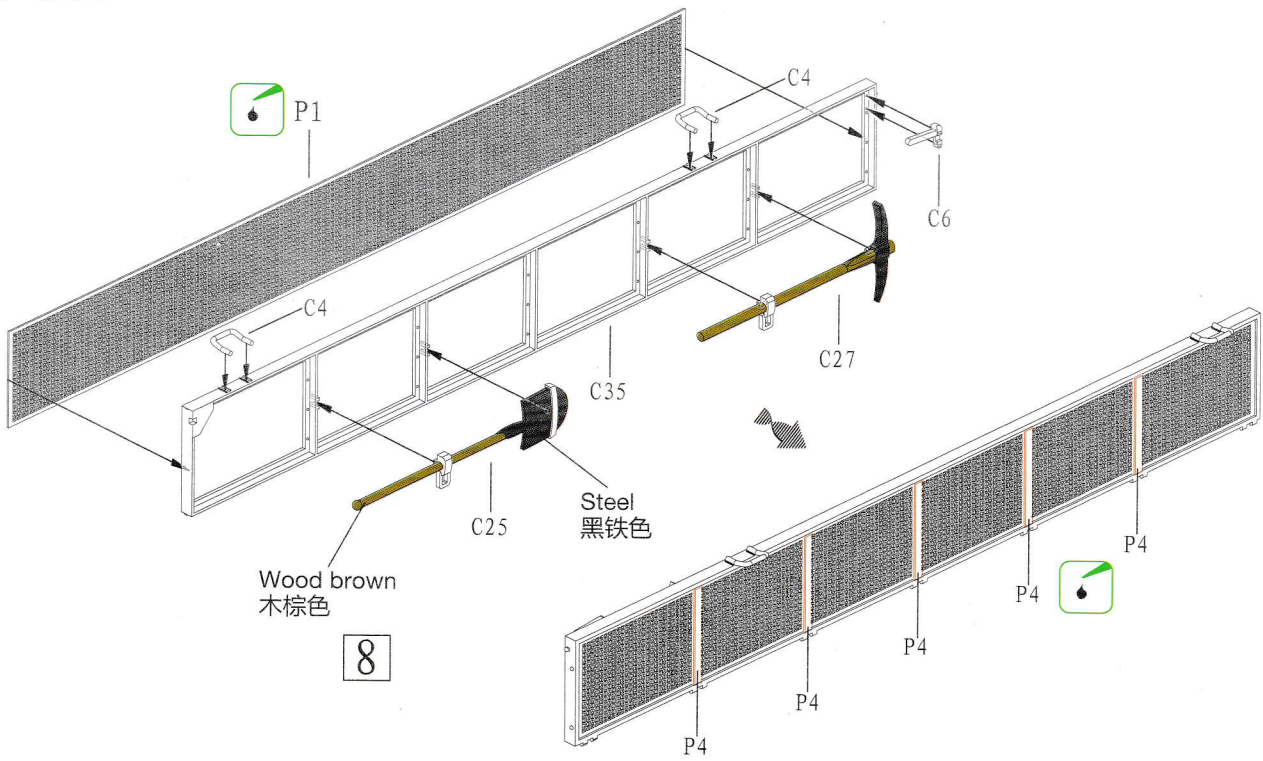

23 Early version in travel position
前期型运输状态

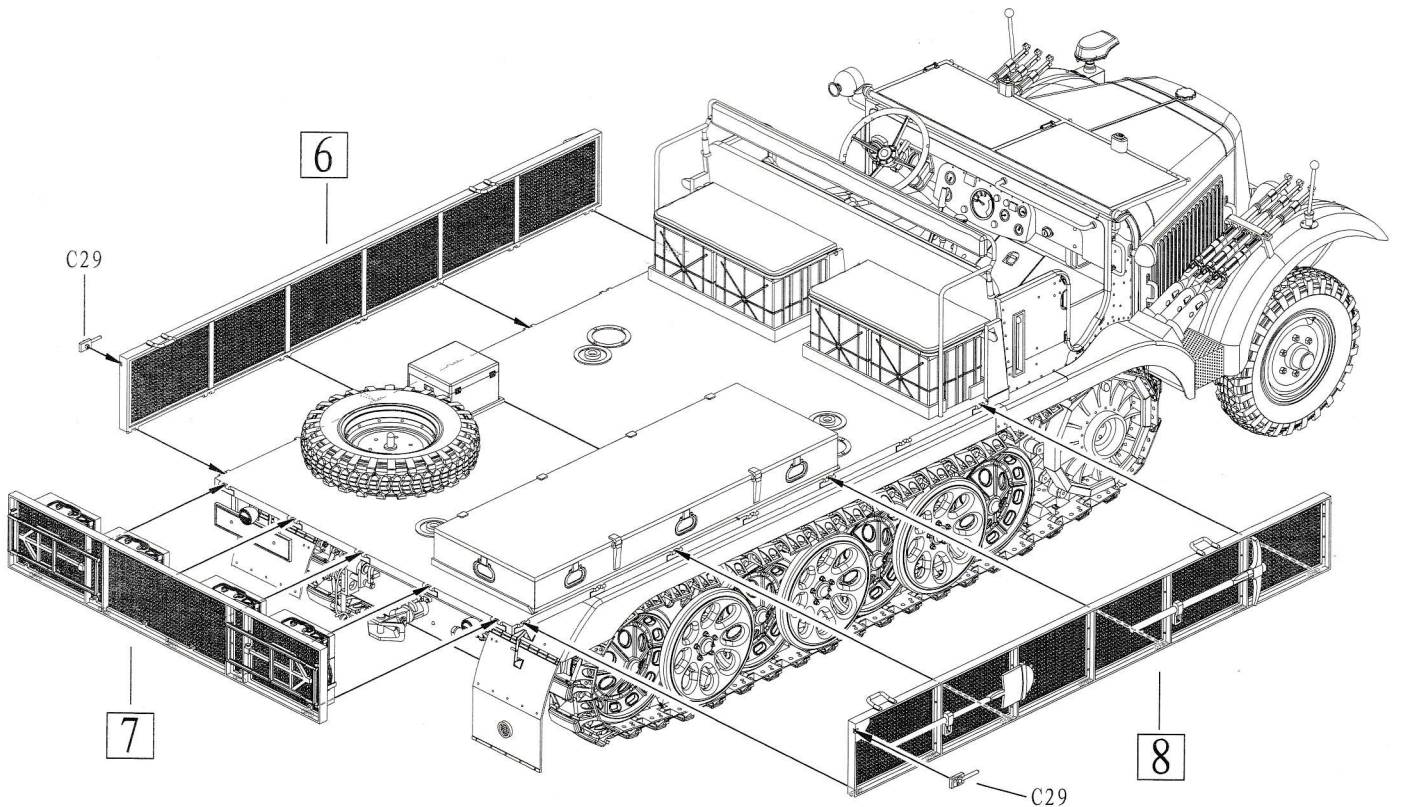
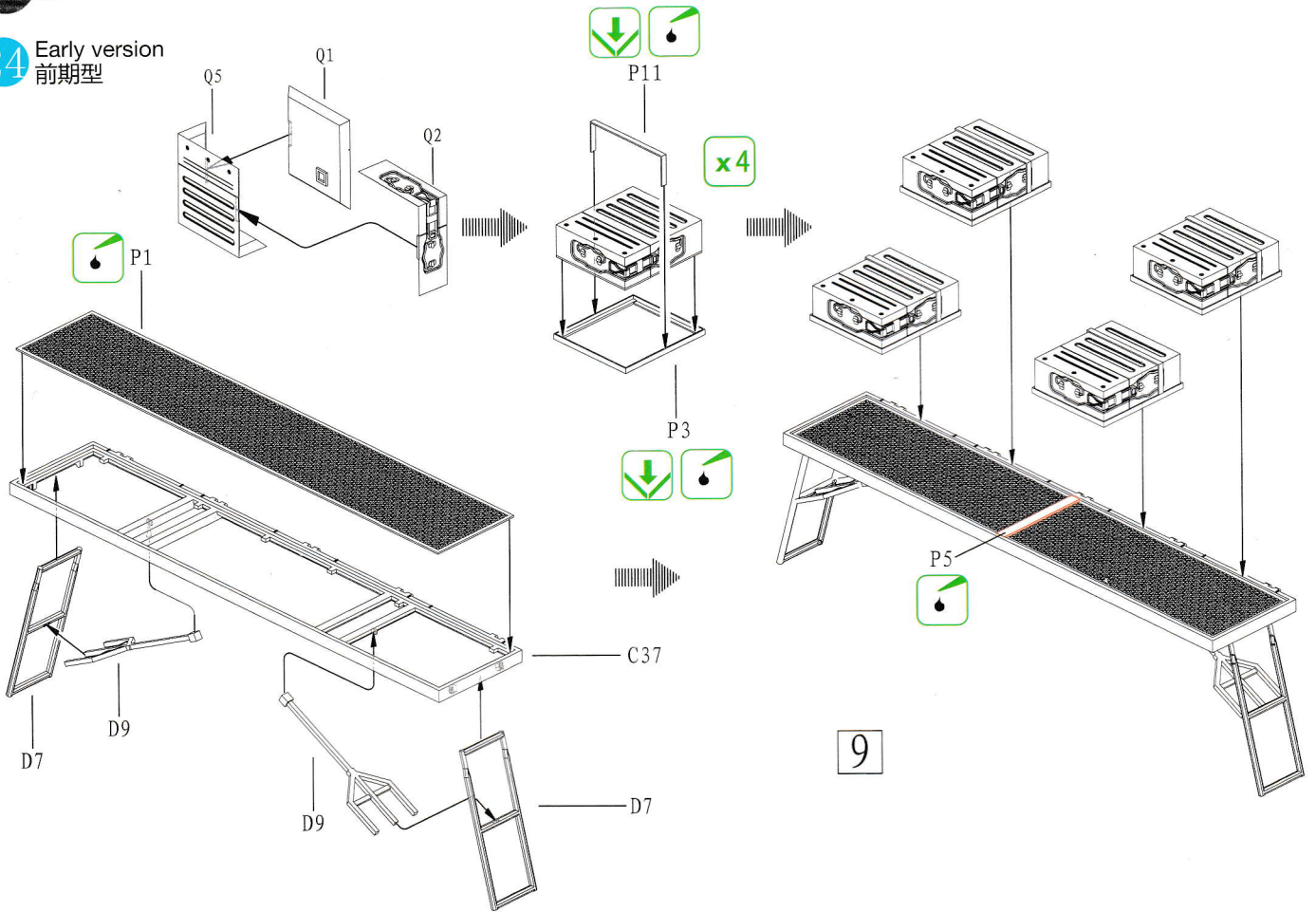
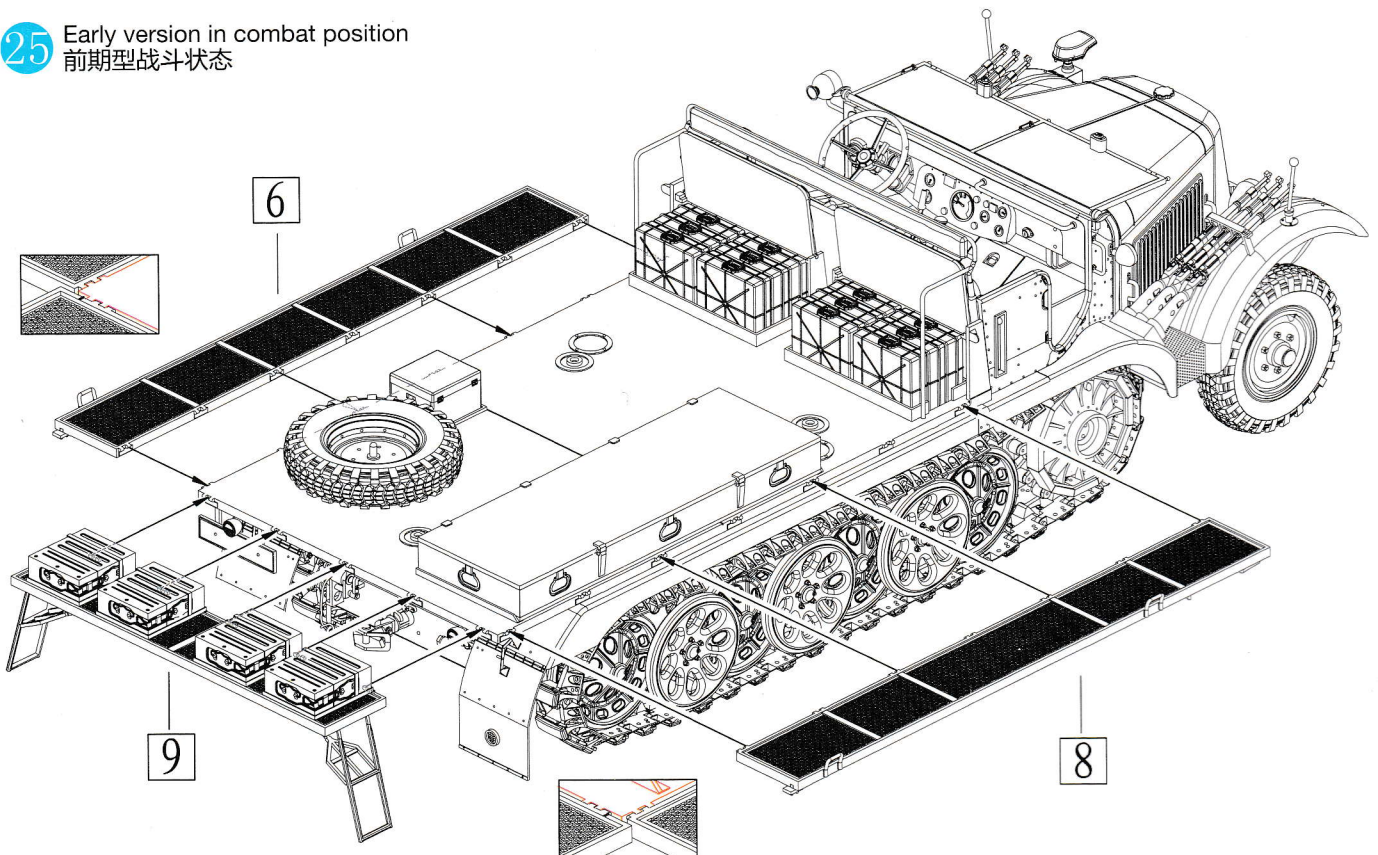

ILLUSTRATION 图示说明:

24 Early version 前期型



25 Early version in combat position 前期型战斗状态



26 Late version
后期型

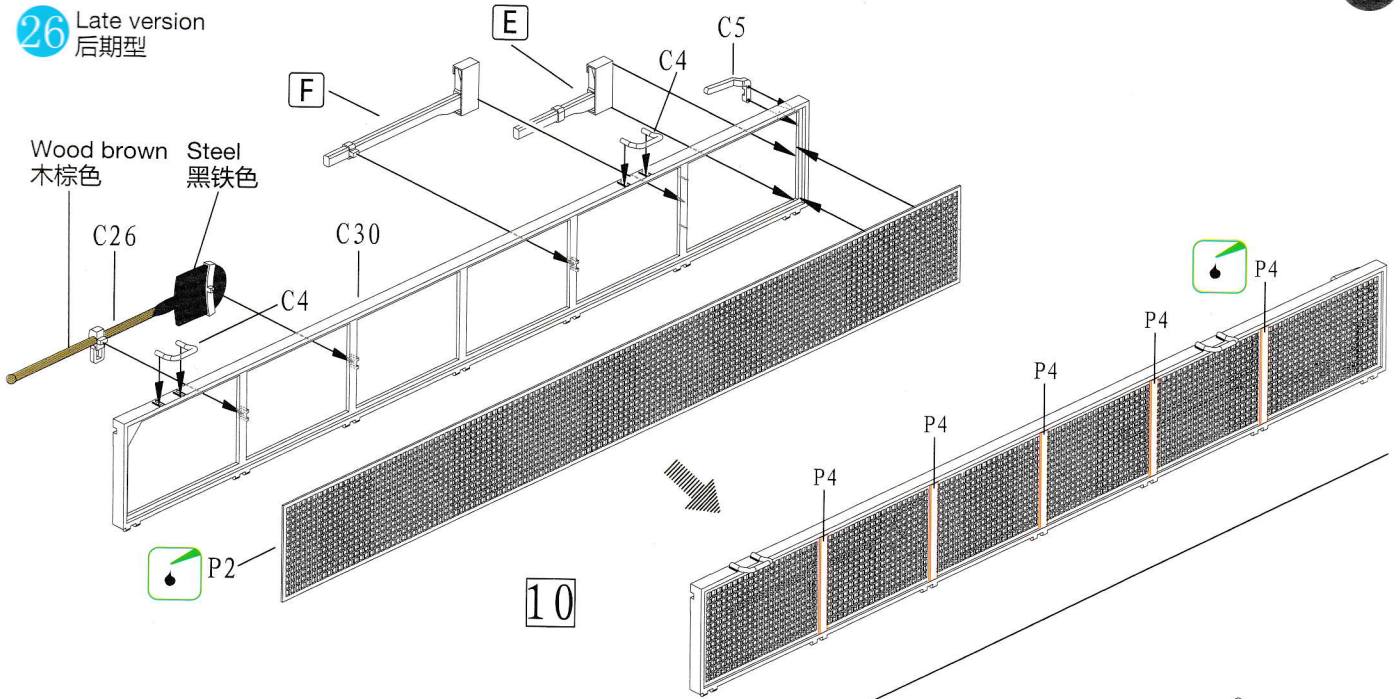

27 Late version
后期型

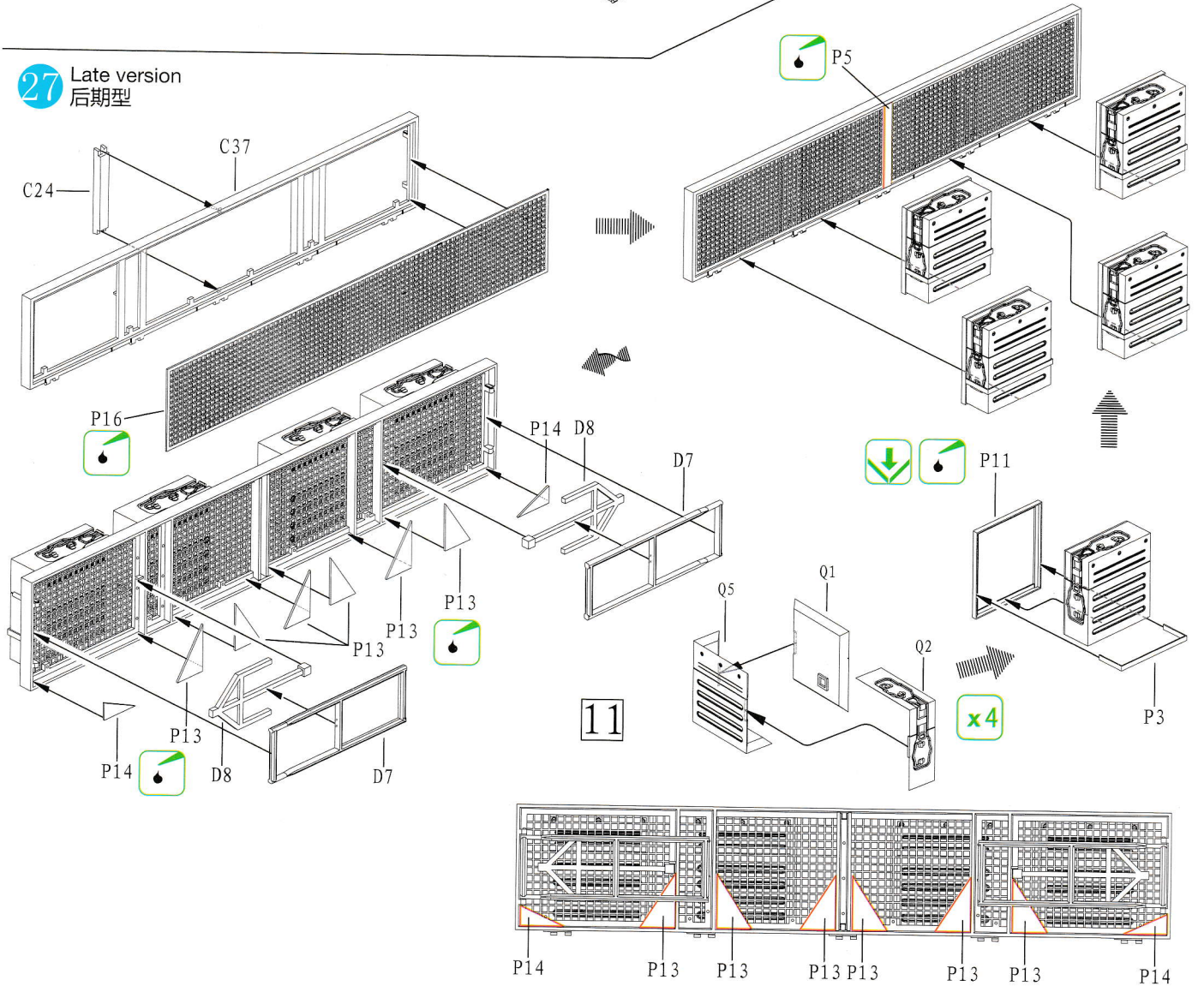
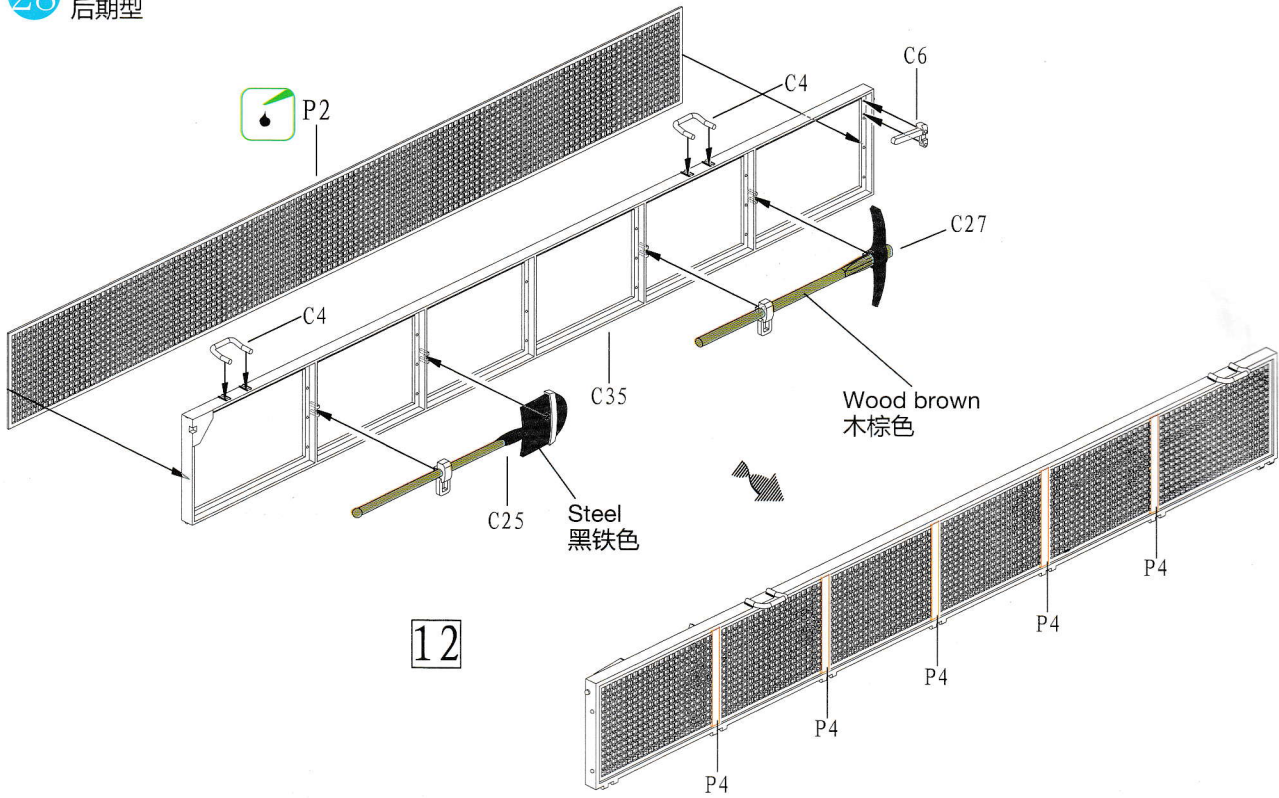
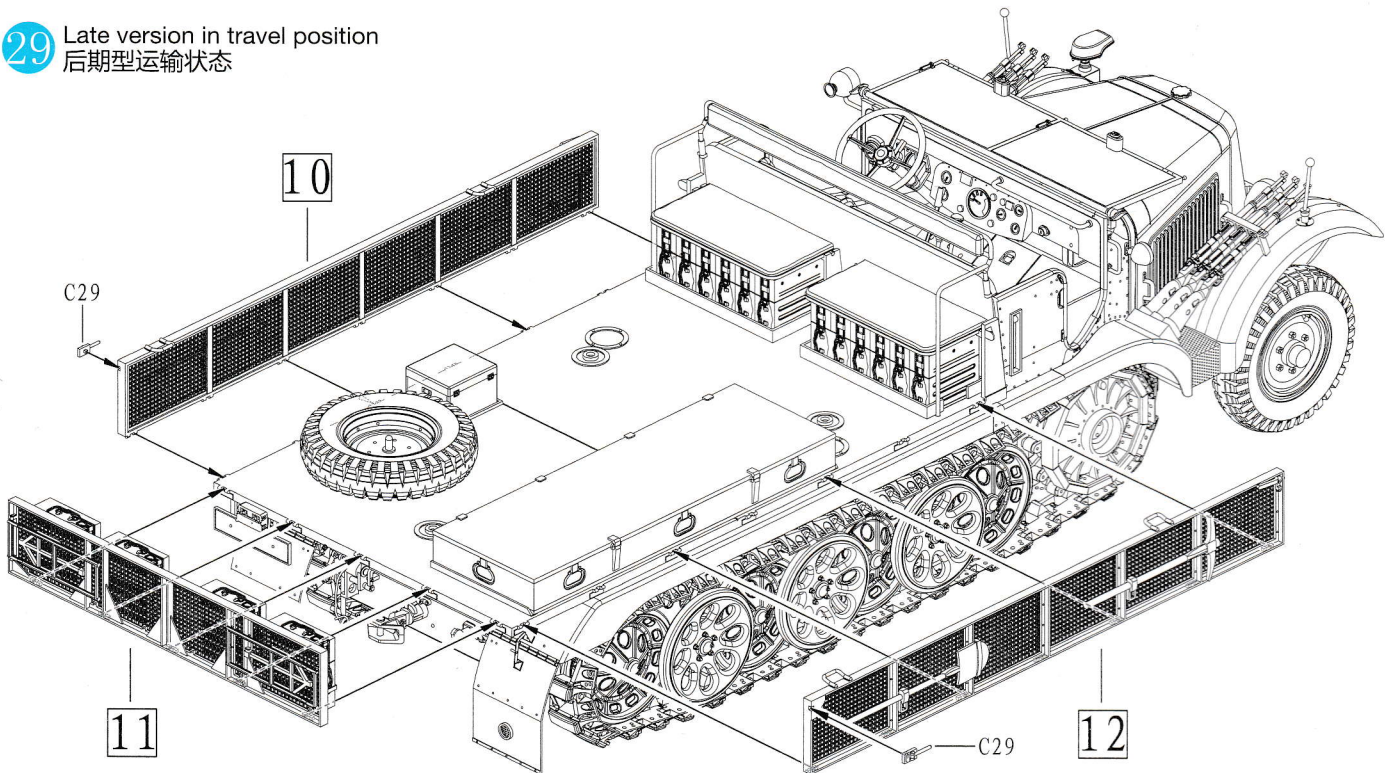

ILLUSTRATION 图示说明:

28 Late version
后期型



29 Late version in travel position
后期型运输状态



30 Late version
后期型

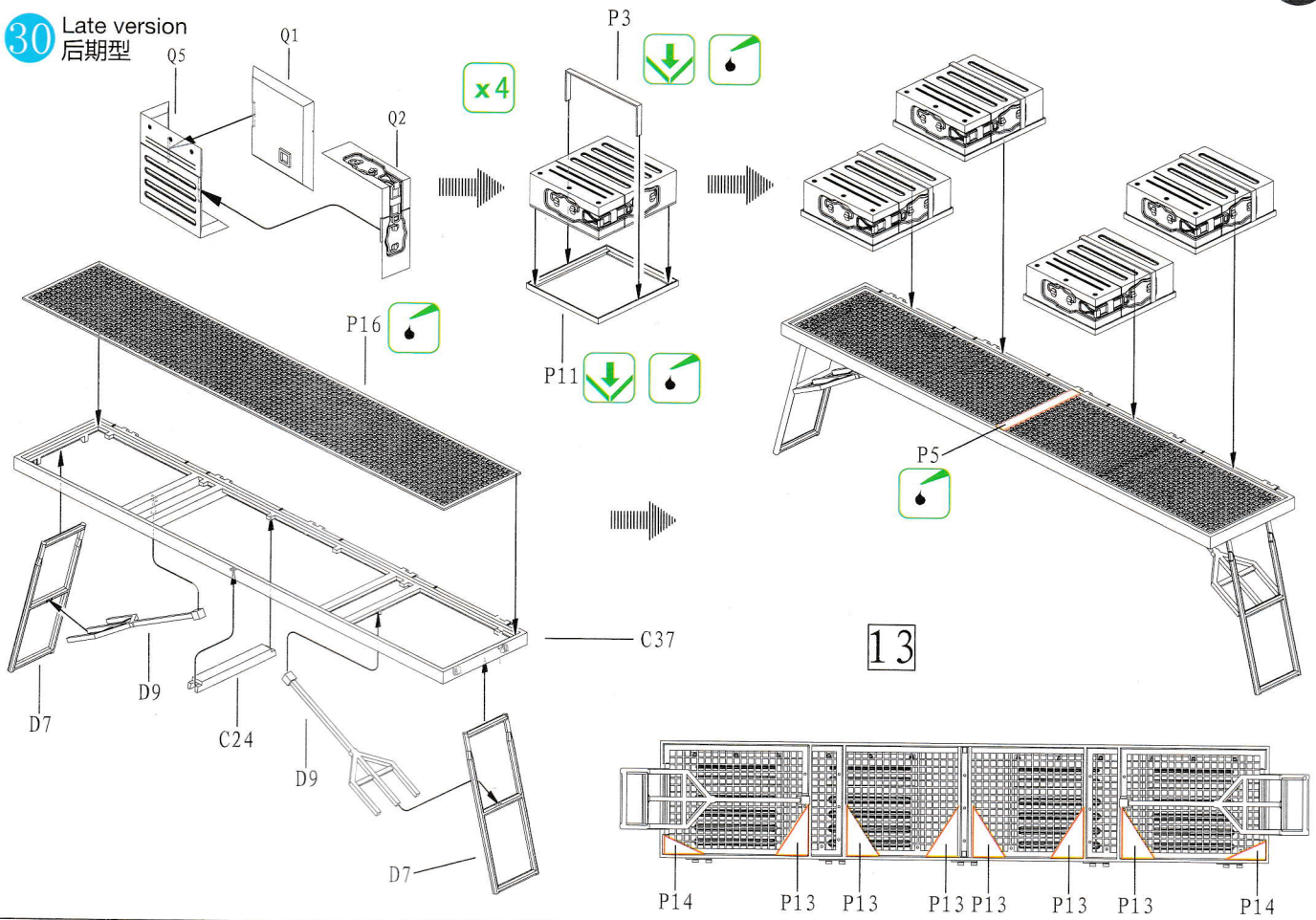

31 Late version in combat position
后期型战斗状态

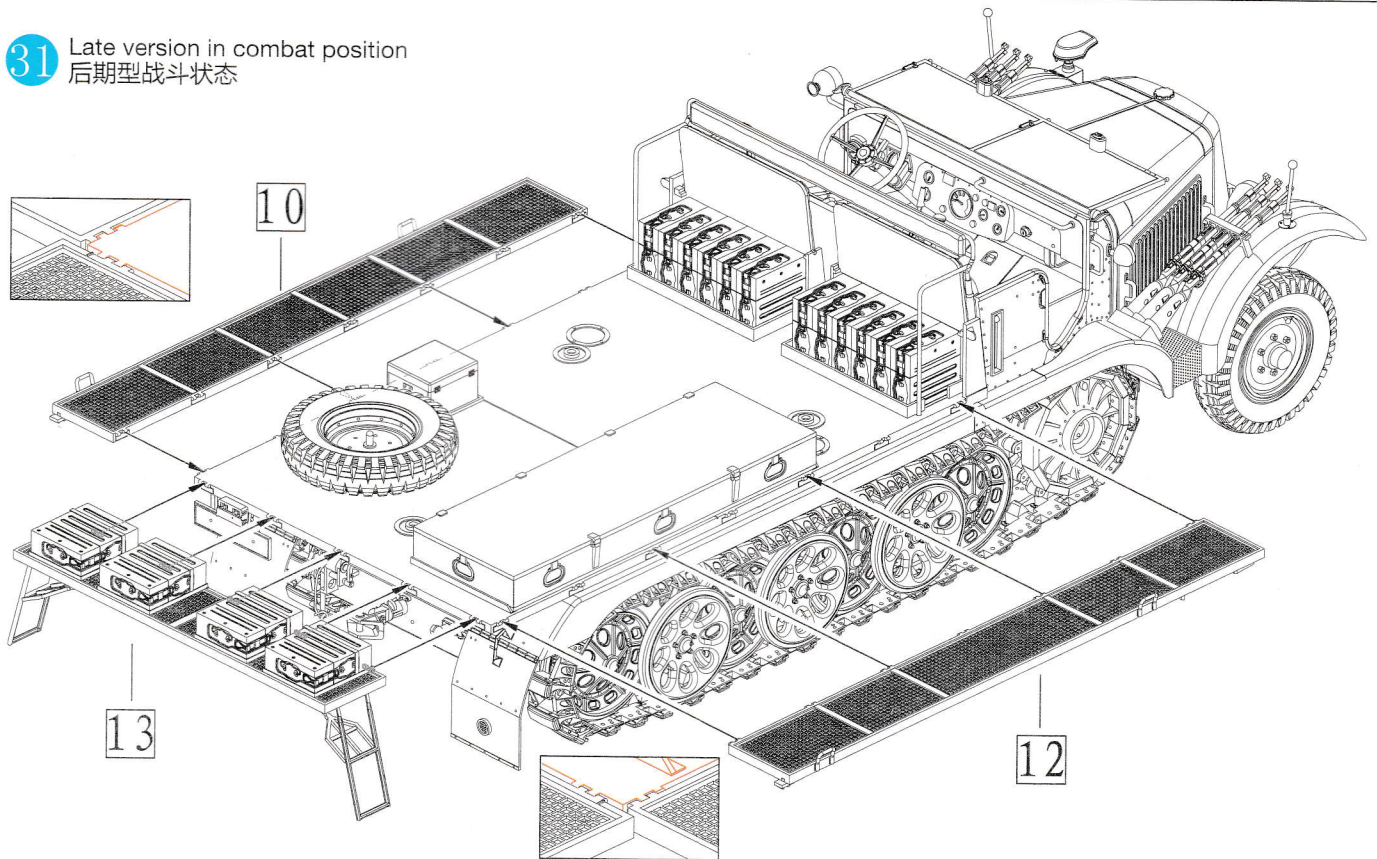

32

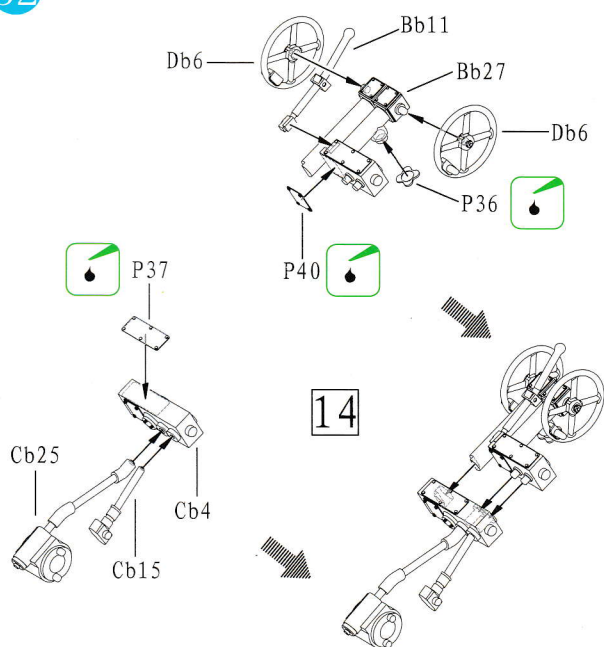

15

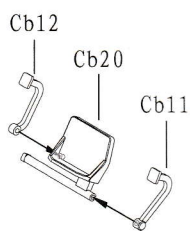

Flat black
消光黑

16

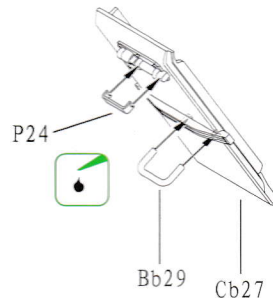
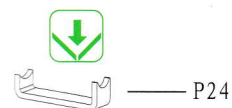
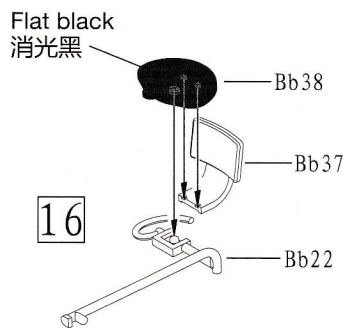

17

33

Late version
后期型

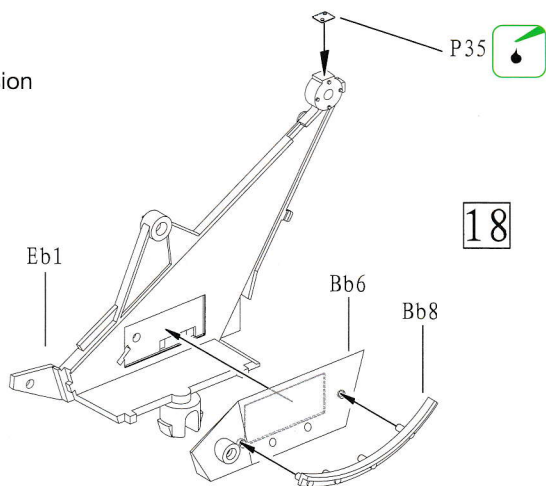

Early version
前期型

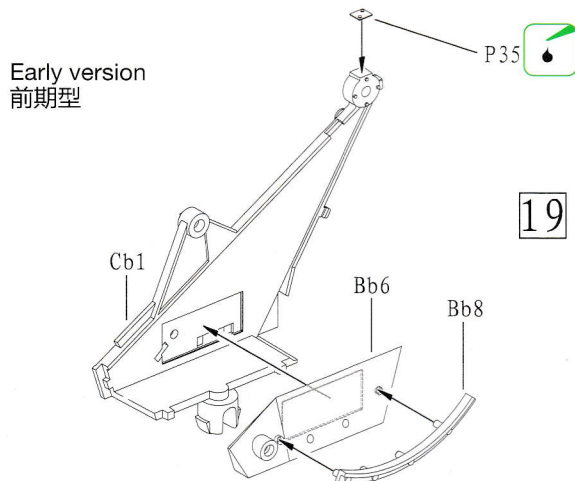

Late version
后期型

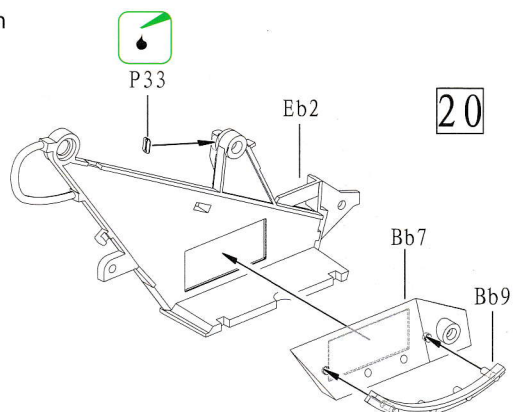

Early version
前期型

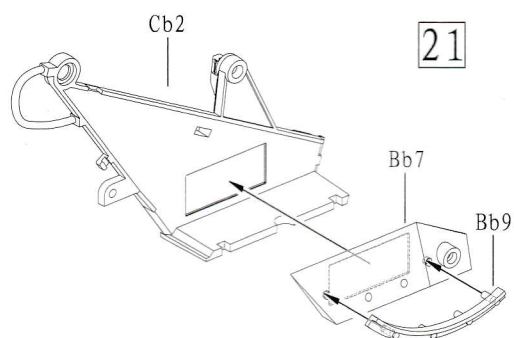

34

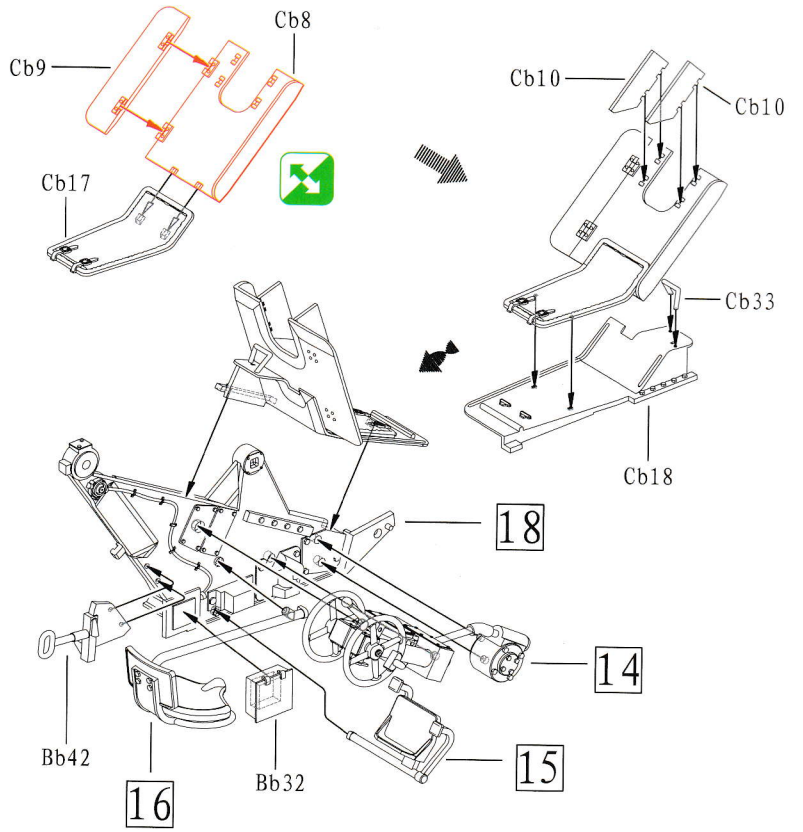
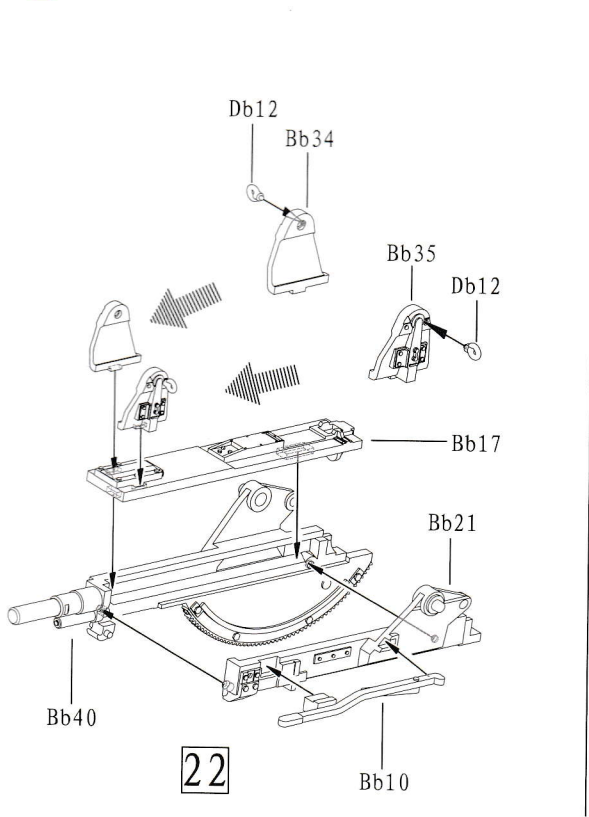

35

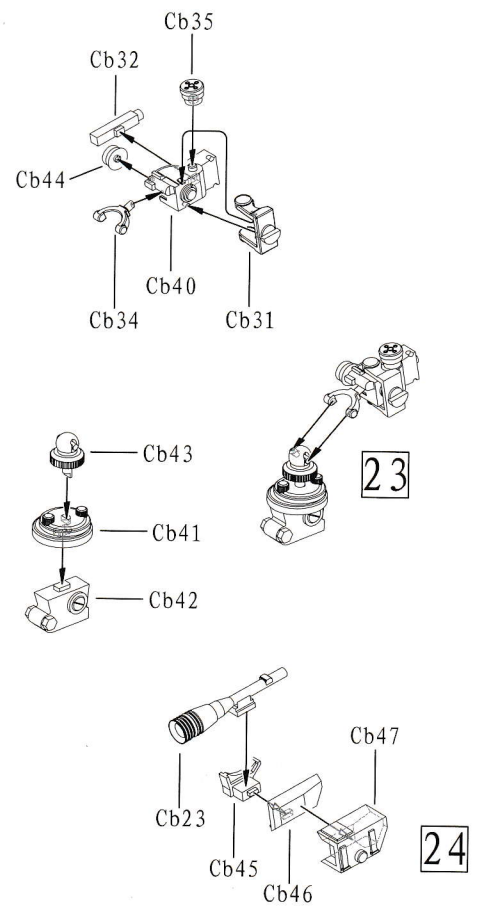
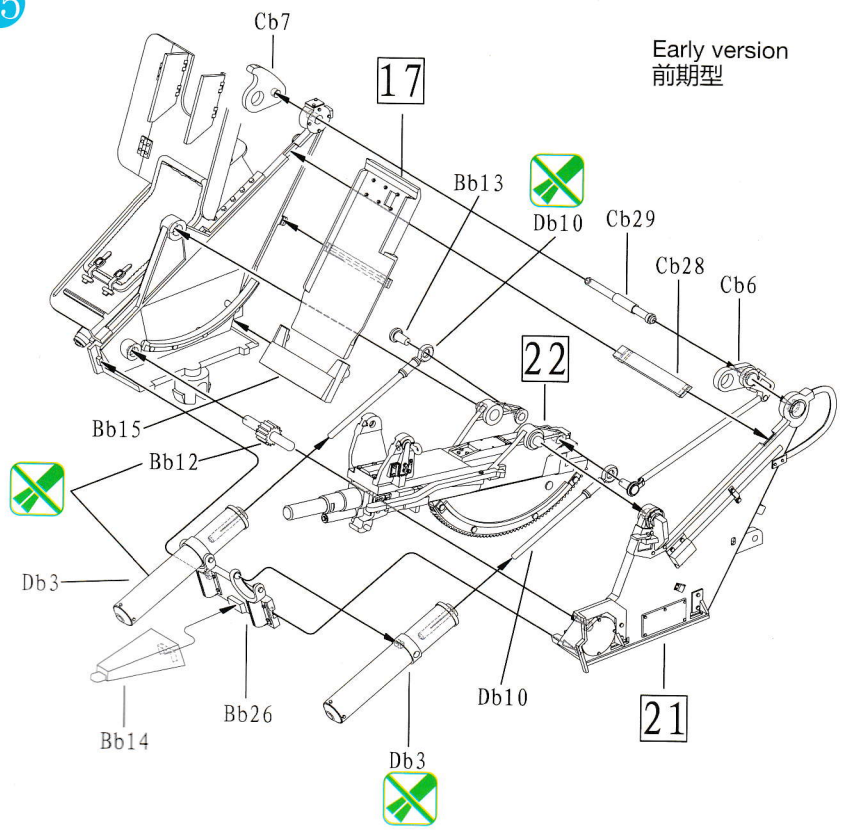
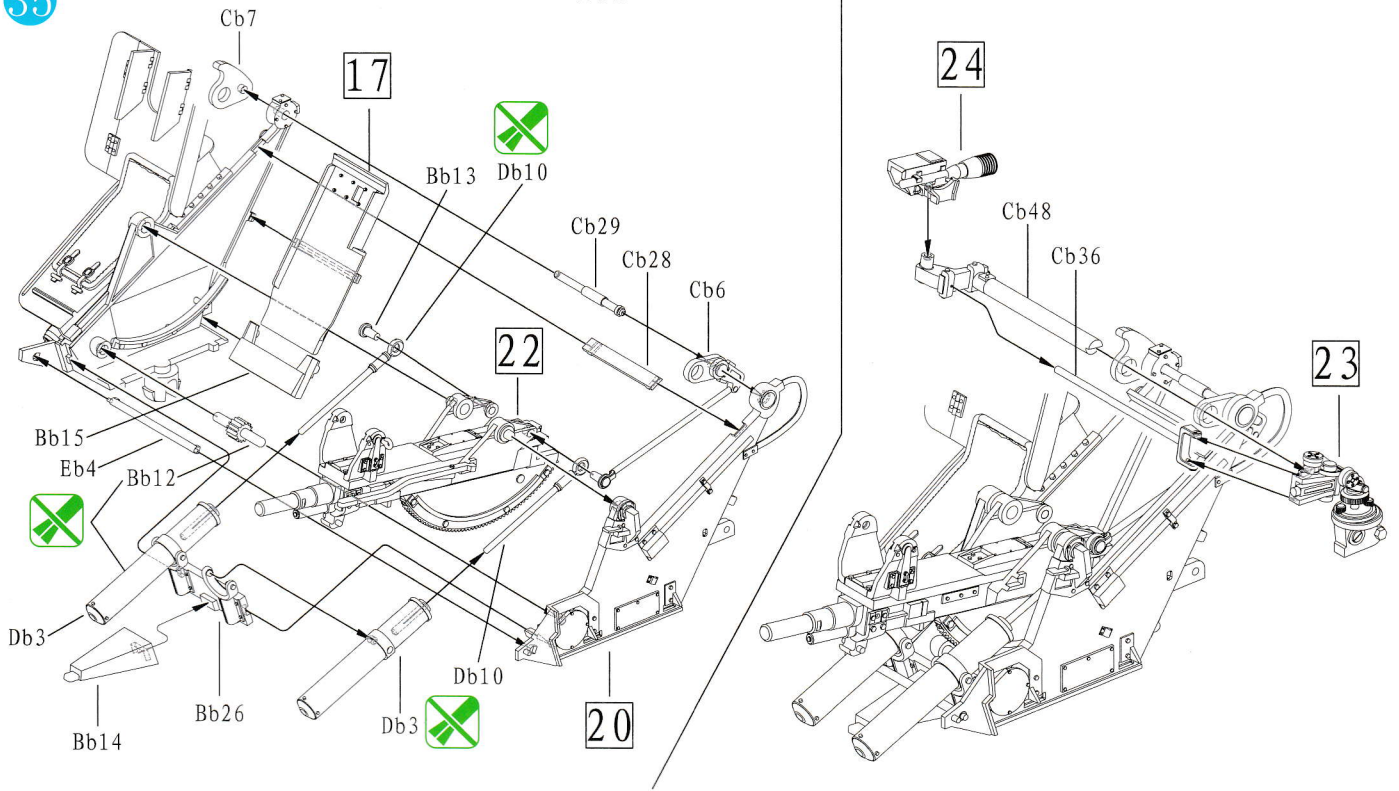

ILLUSTRATION 图示说明:

35

Late version
后期型



36

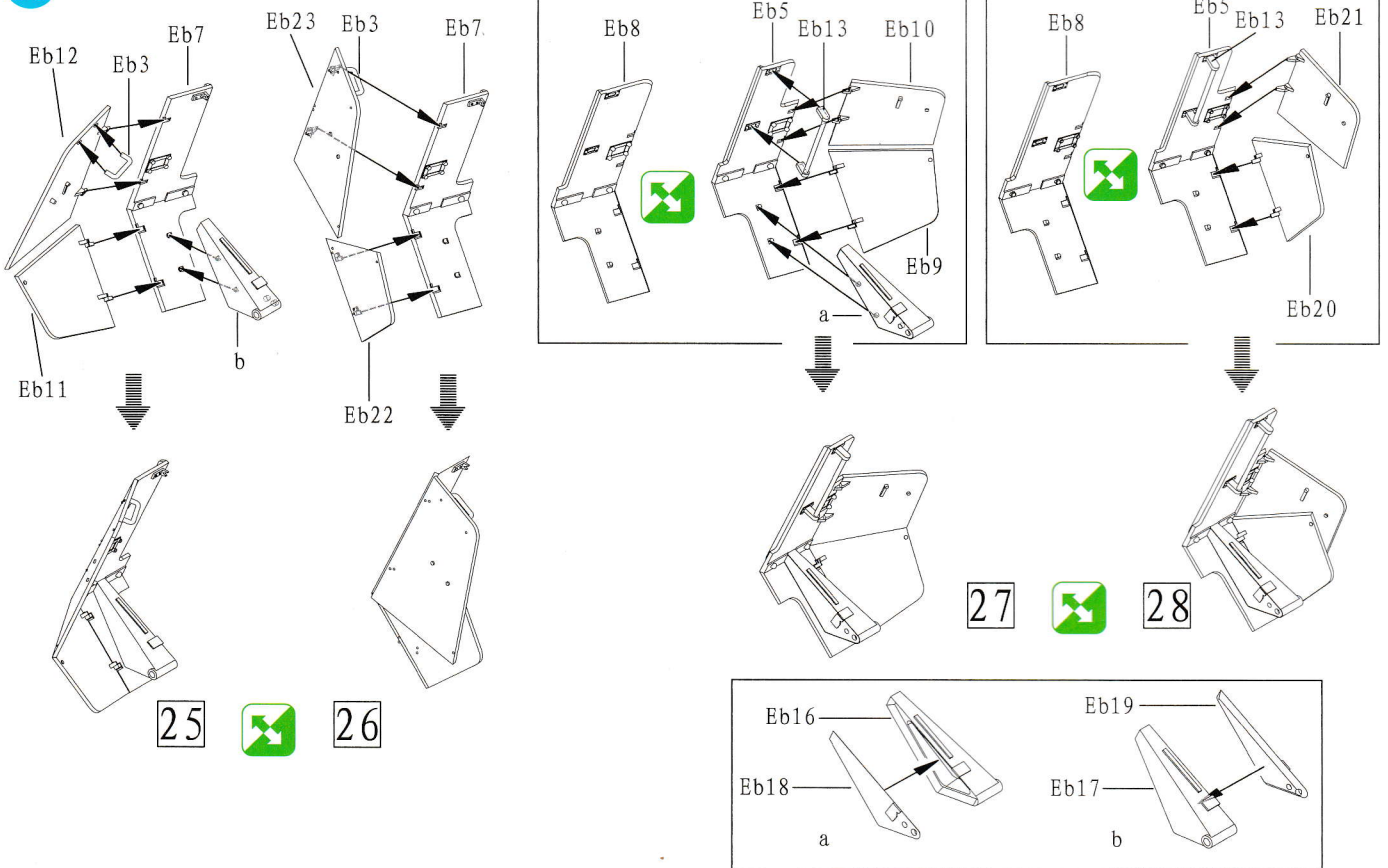

37

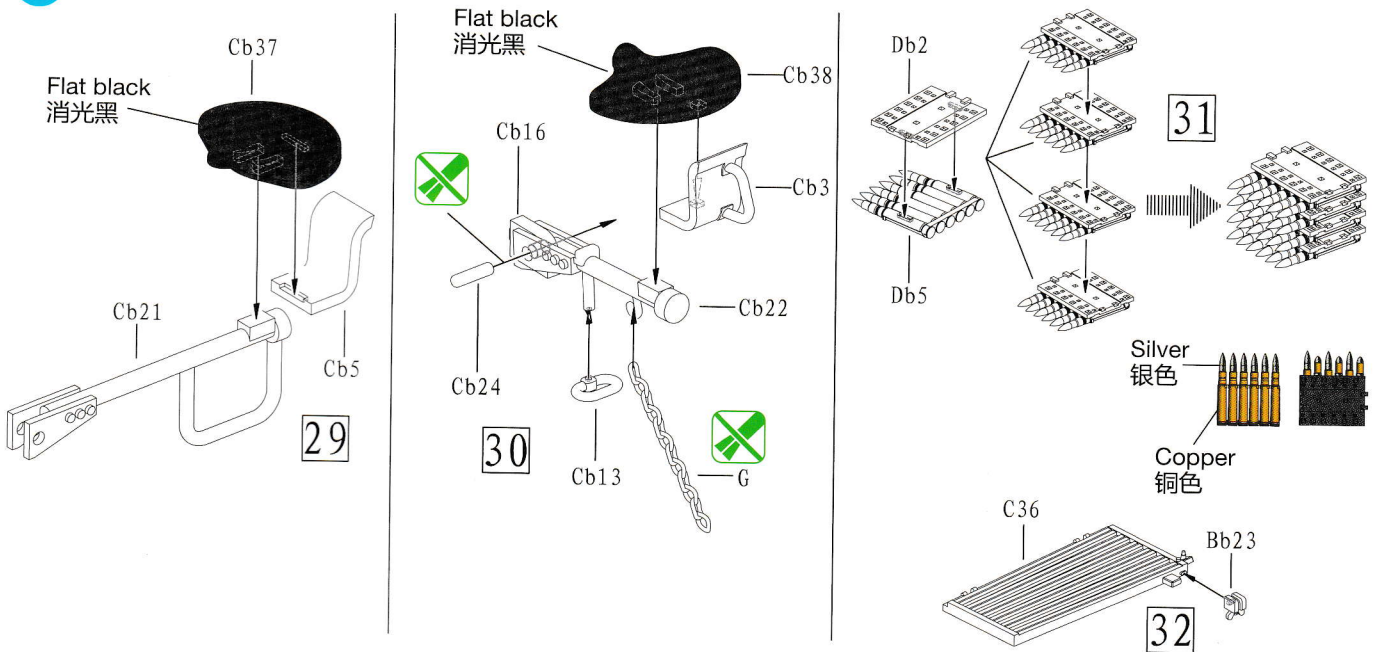

38

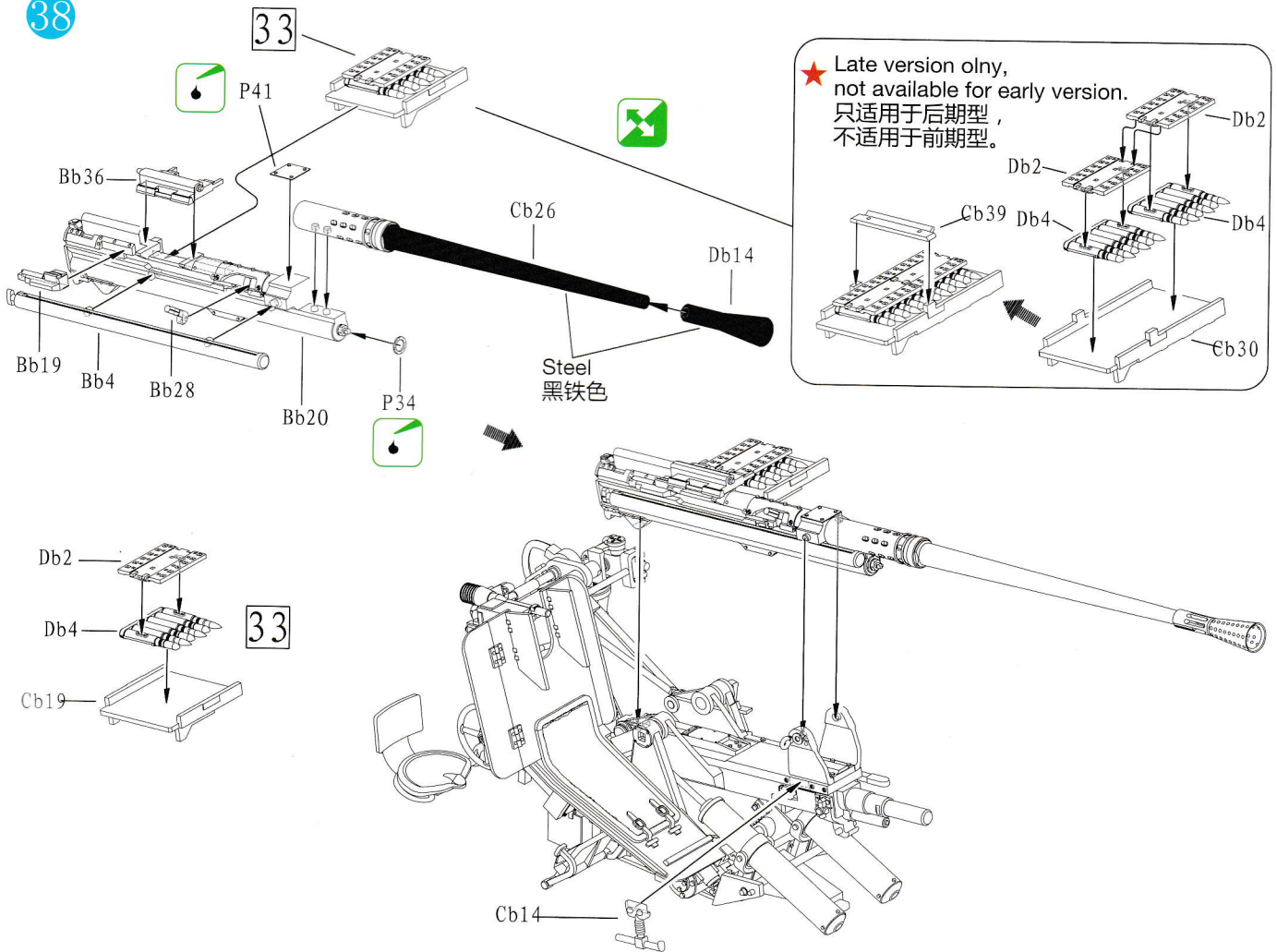
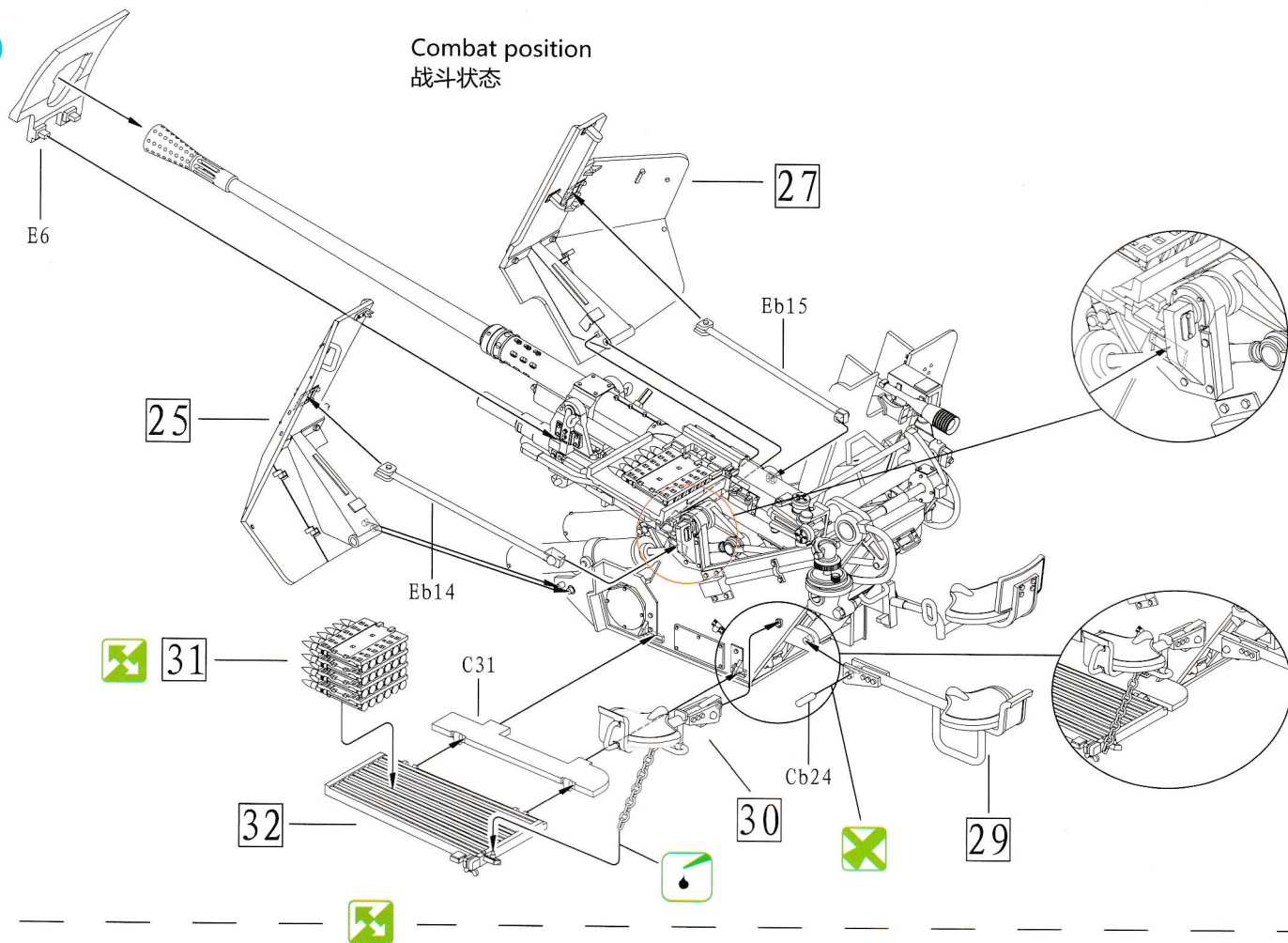

ILLUSTRATION 图示说明:

39

Combat position
战斗状态



Travelling position
运输状态

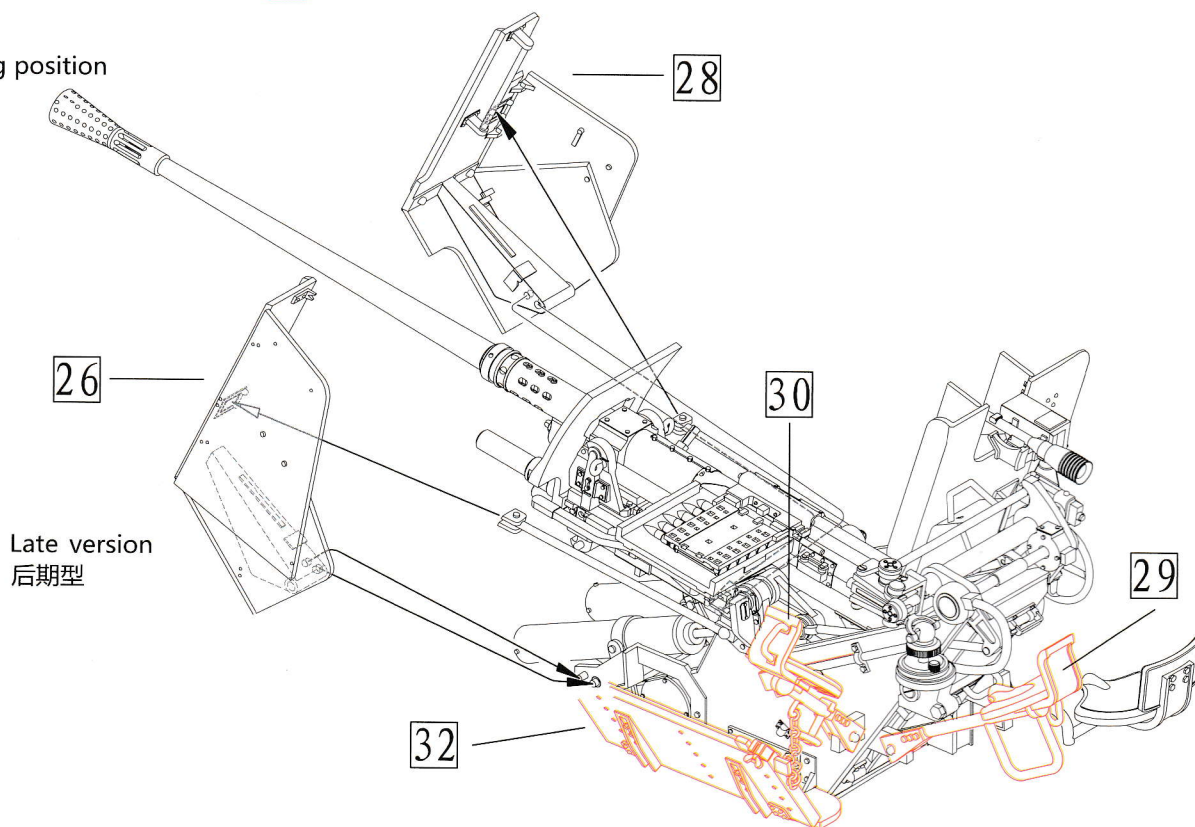

Late version
后期型

40 Travelling position
运输状态

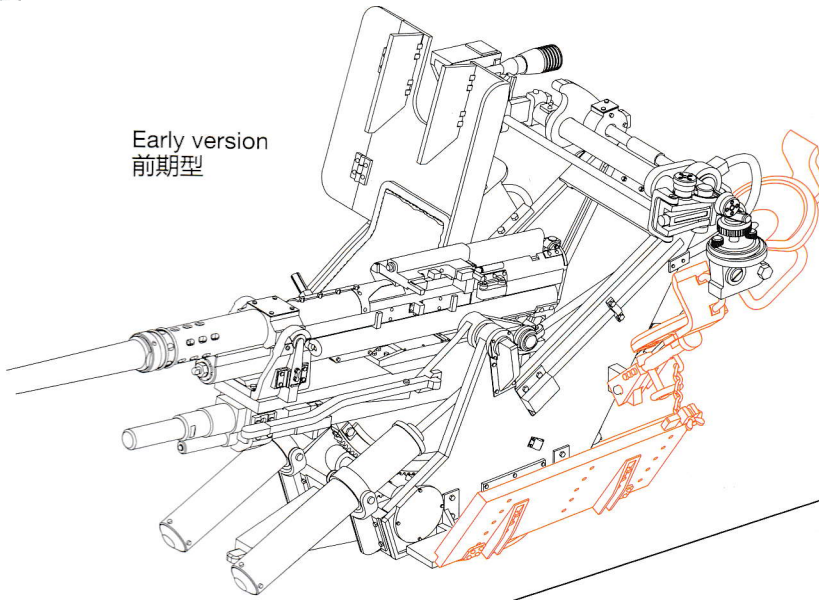

41

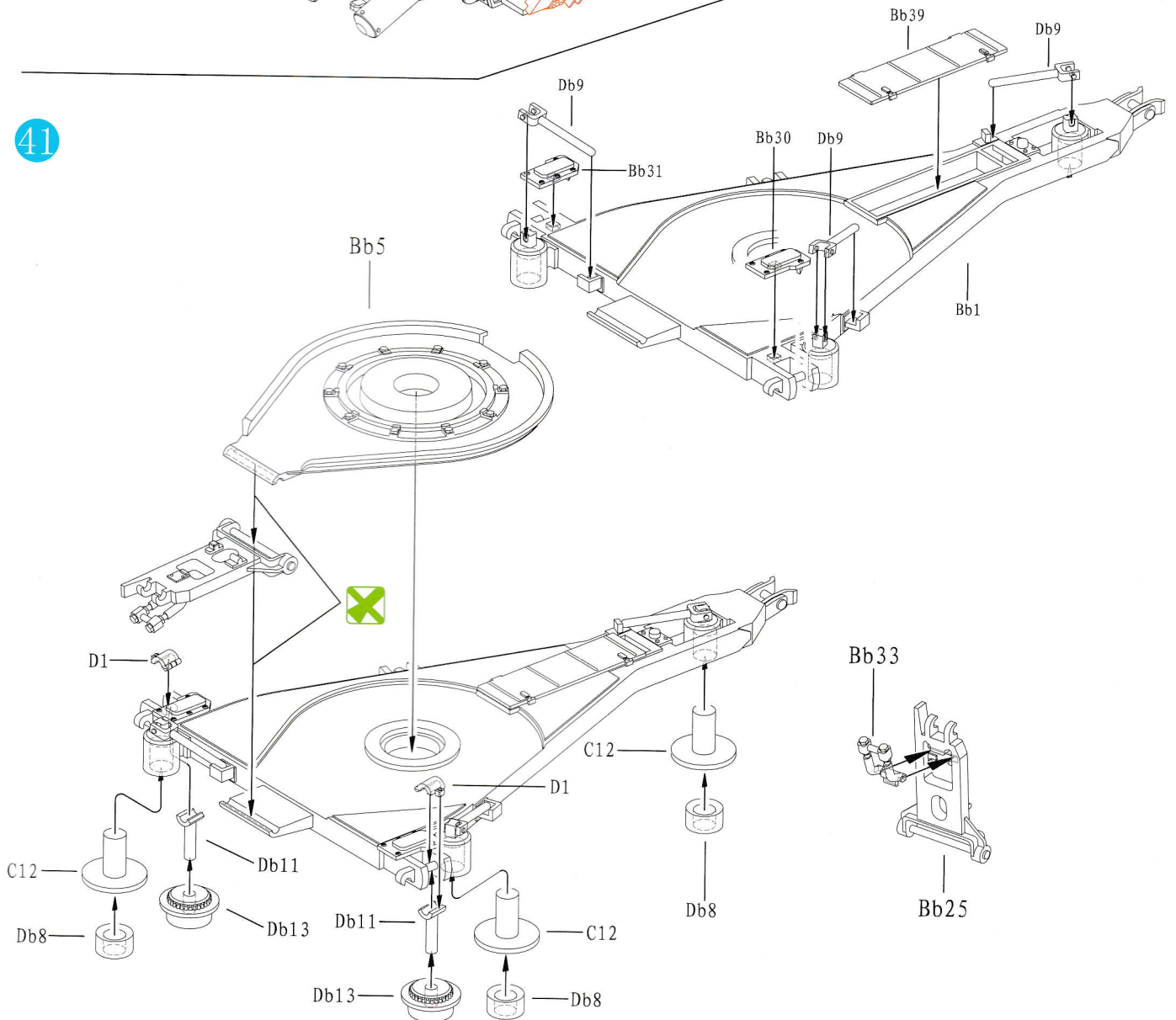

42 Combat position
战斗状态

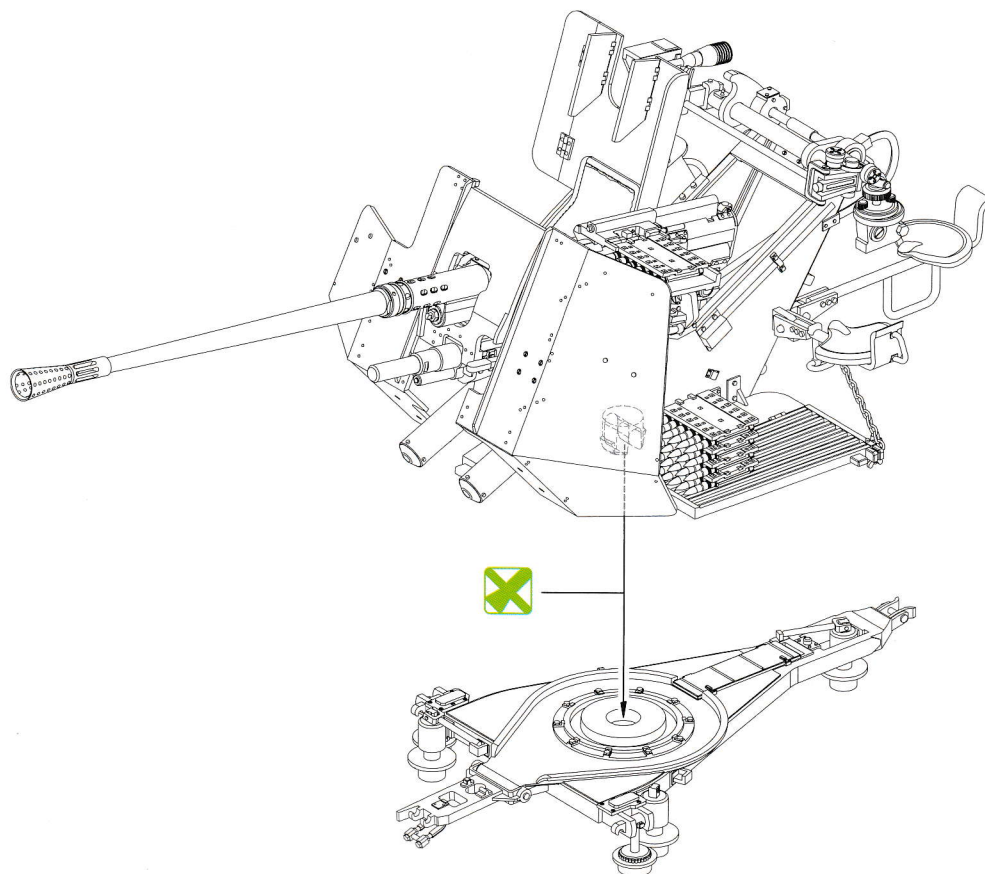
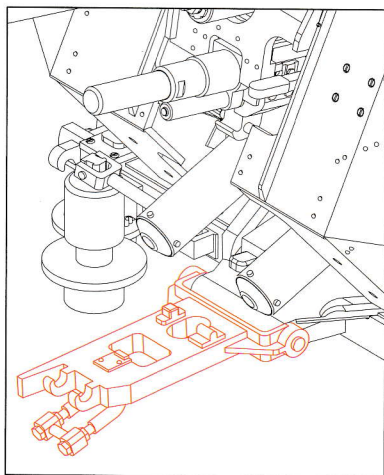

Travelling position
运输状态

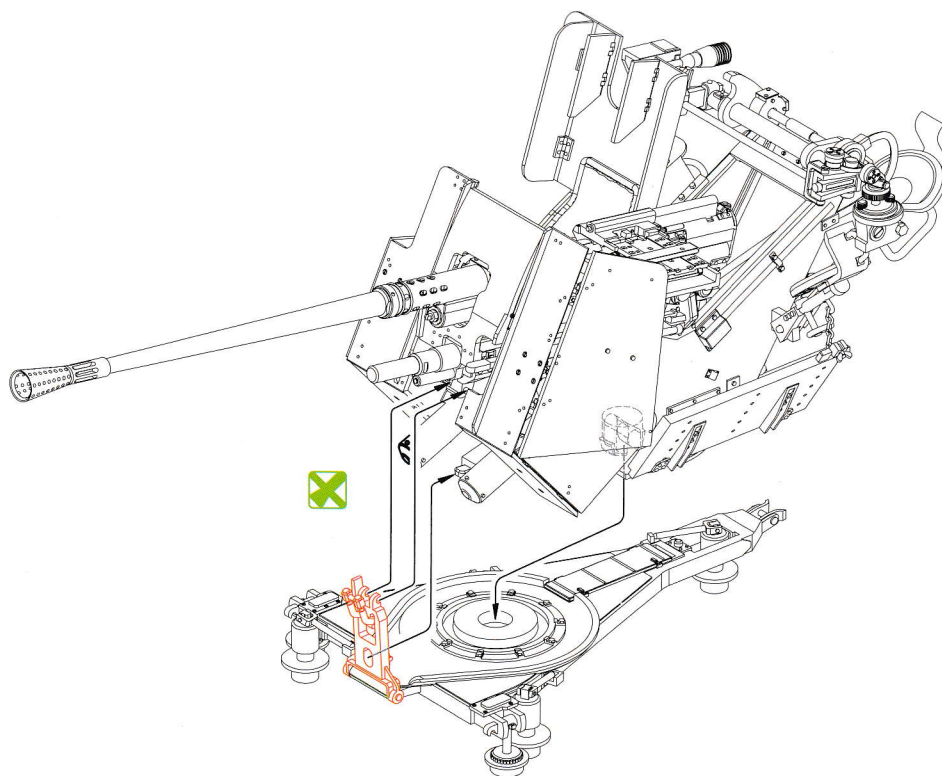
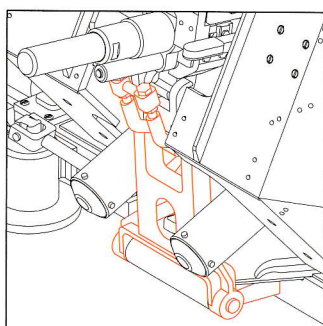

43 Travelling position
运输状态

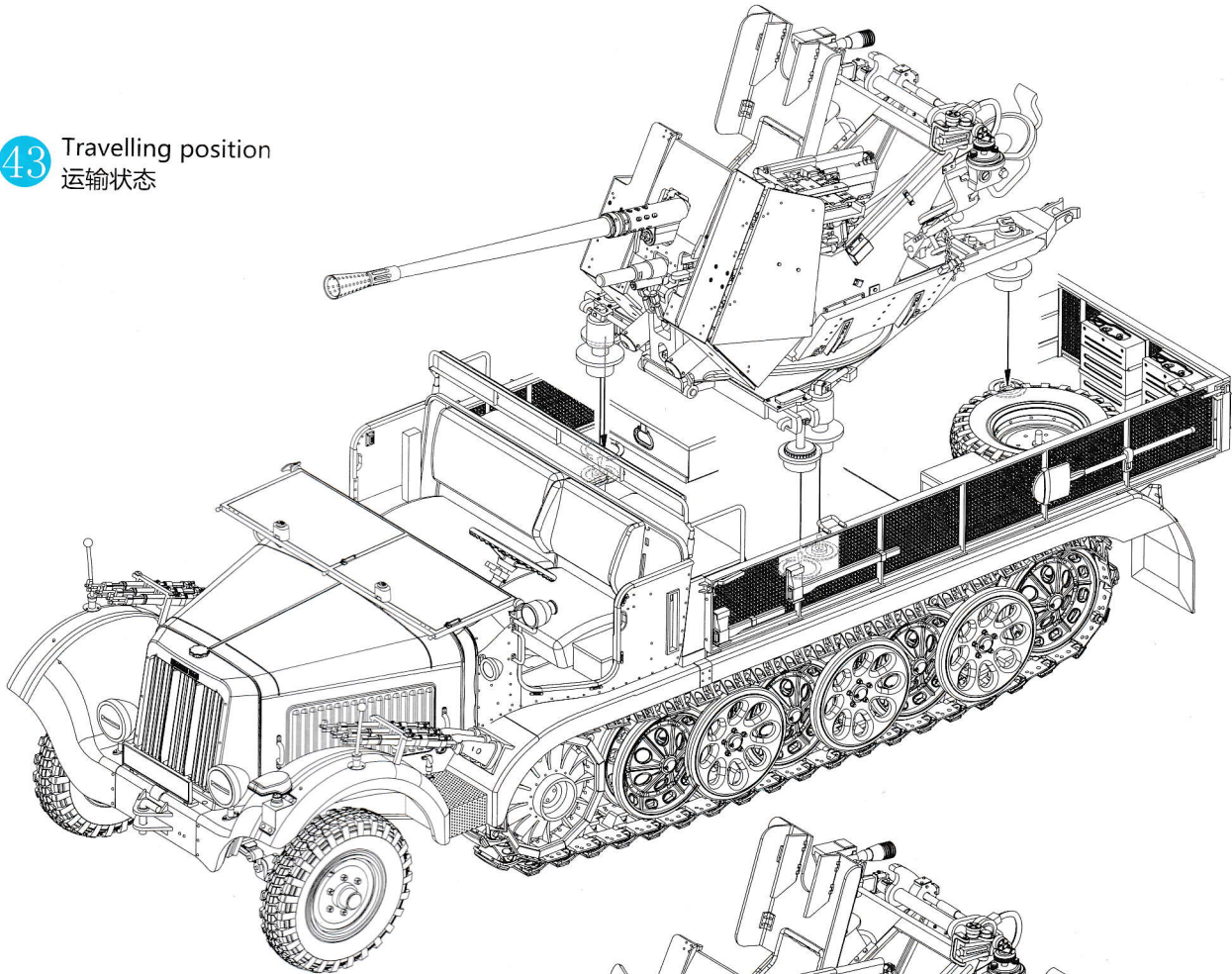

44 Combat position
战斗状态

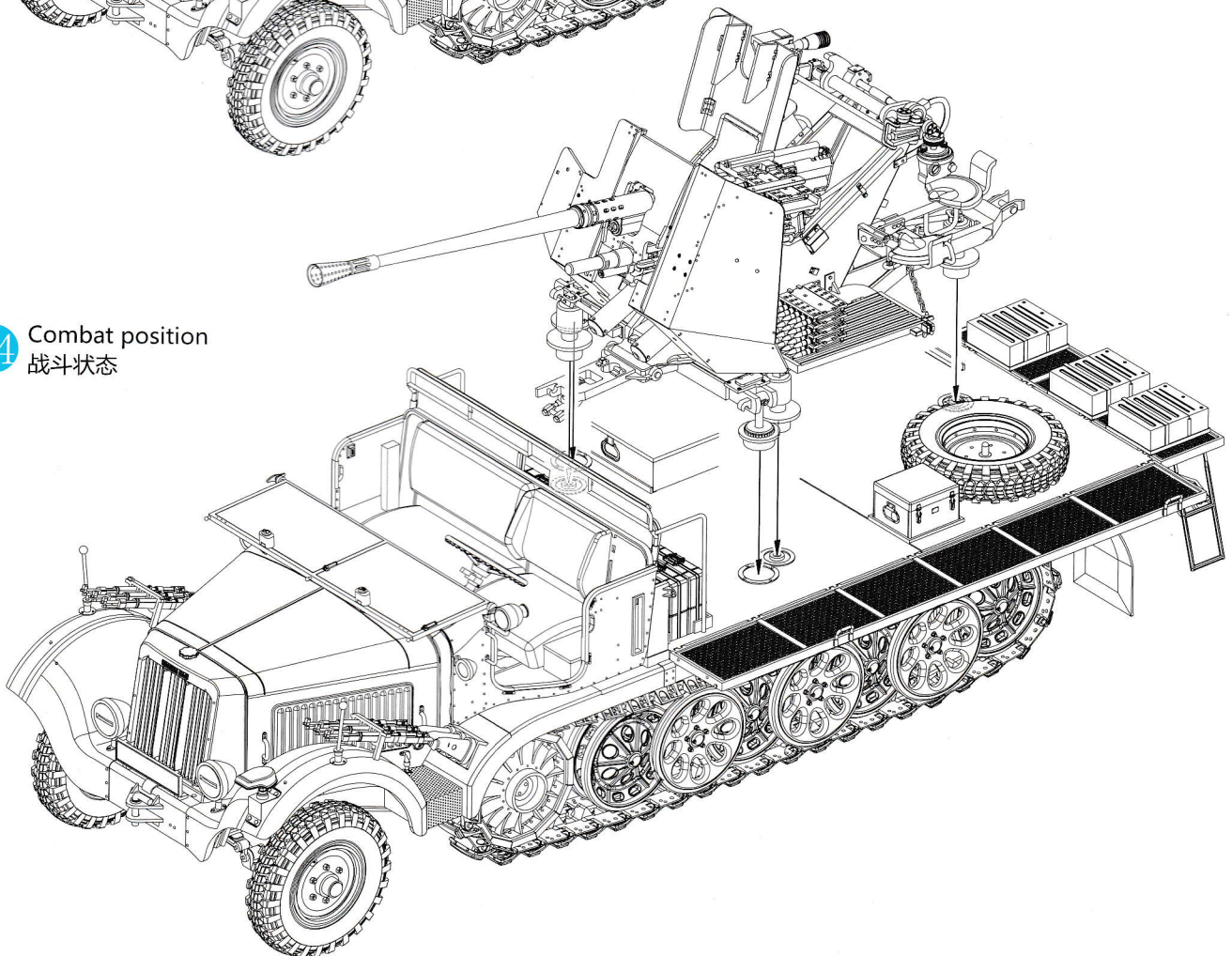

DECAL & COLOUR GUIDE 水贴及涂色指示:

Unit unknown.
部队不明

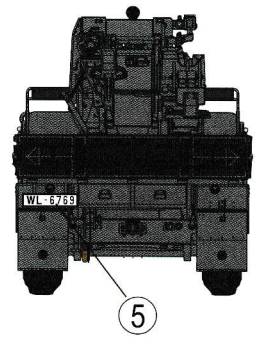
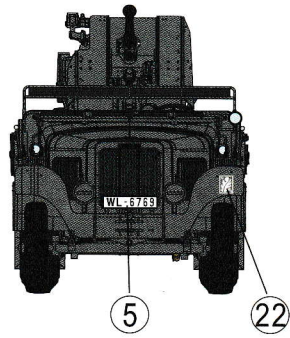
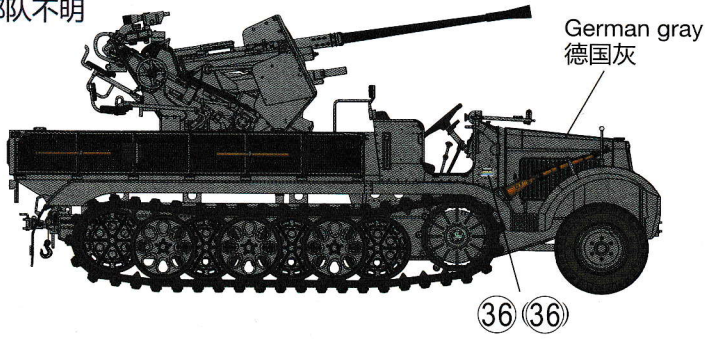

Unit unknown.
部队不明

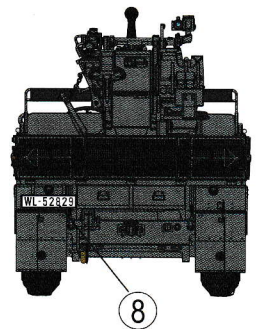
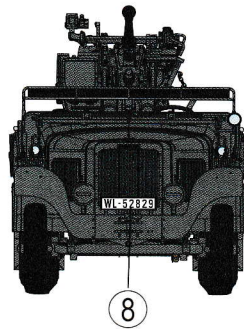
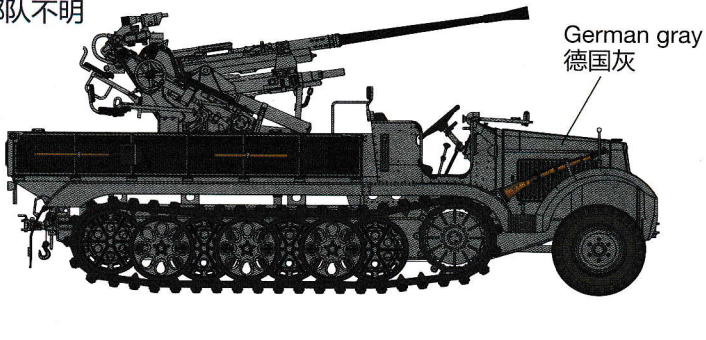

Unit unknown.
部队不明

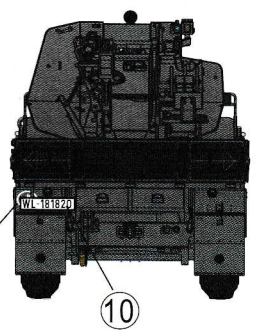
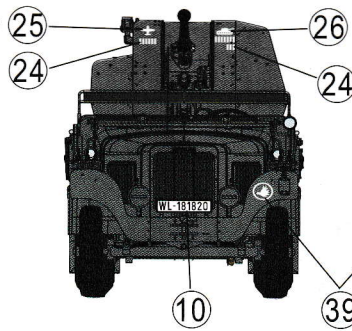
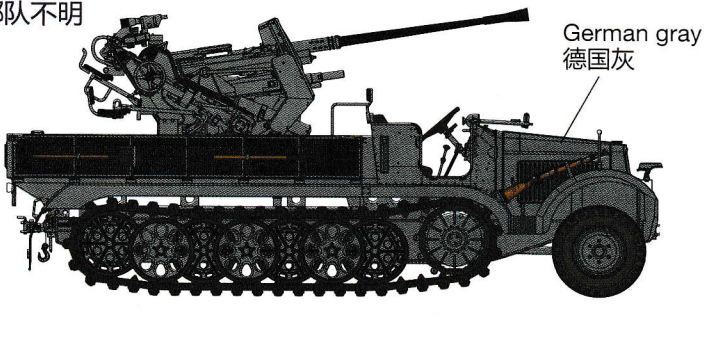

Unit unknown.
部队不明

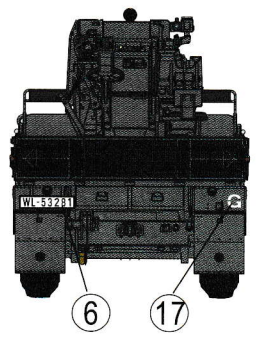
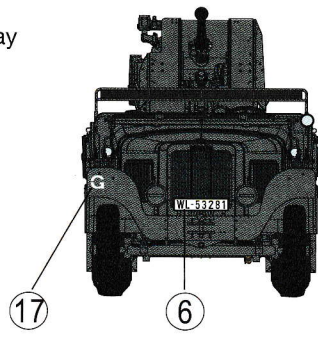
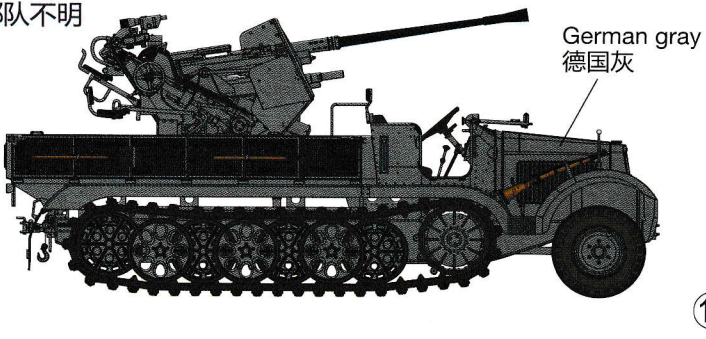

Unit unknown.
部队不明

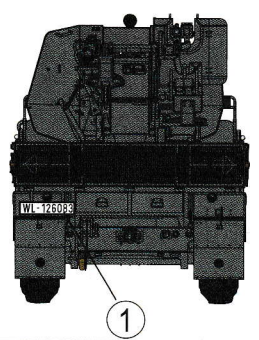
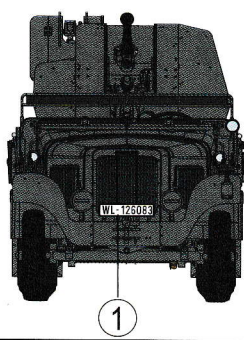
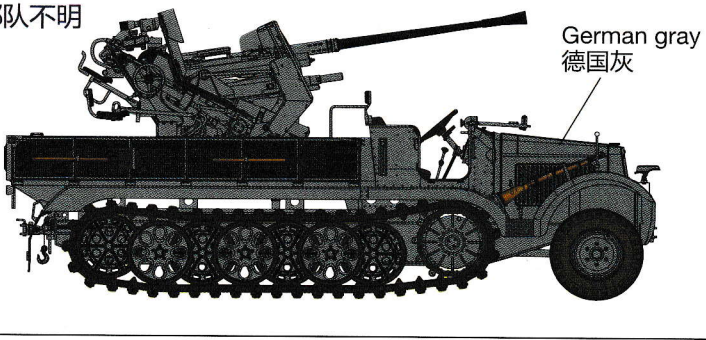

11th Pz.Div. Balken campaign, April 1941.
1941年在巴尔干半岛作战之第11装甲师属下车辆

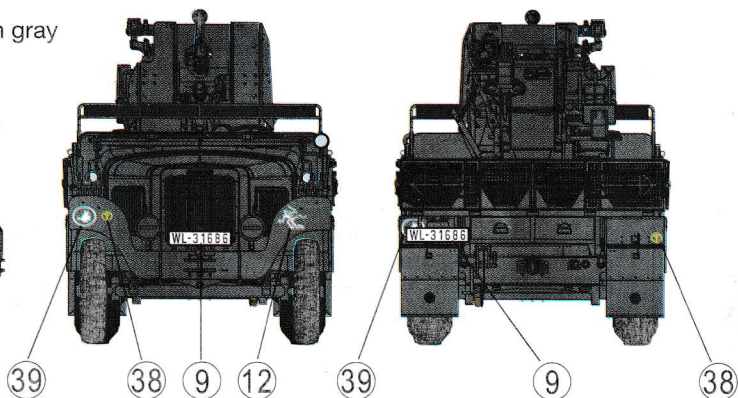
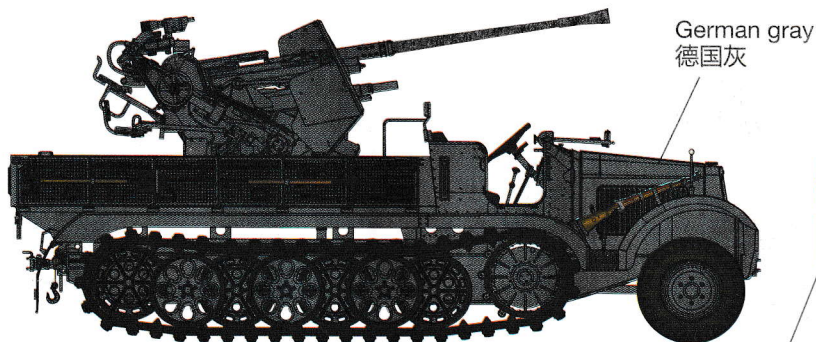

Unit unknown.
部队不明

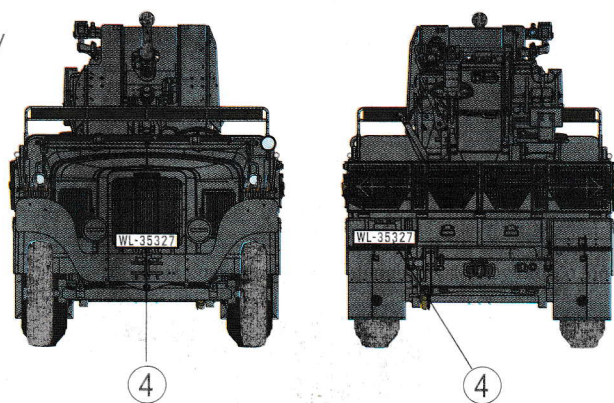
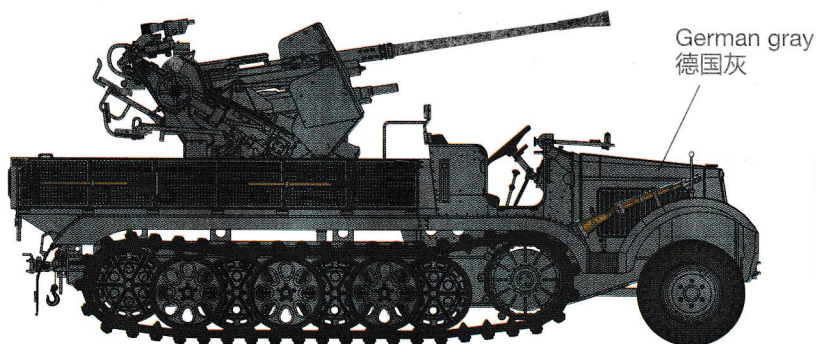

Unit unknown.
部队不明

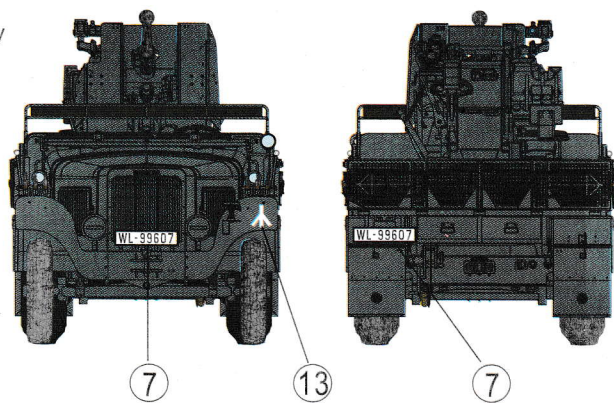
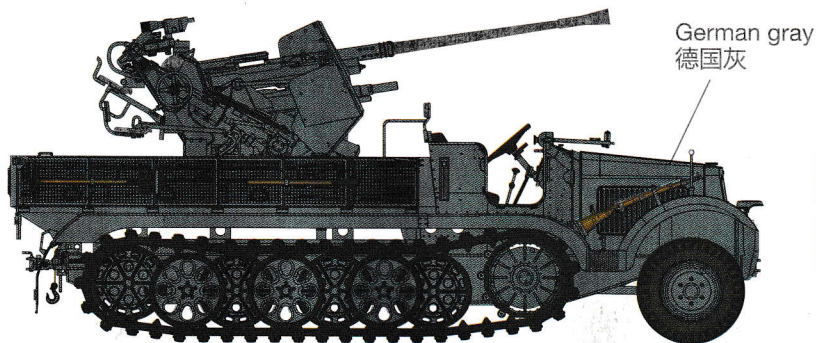

Unit unknown.
部队不明

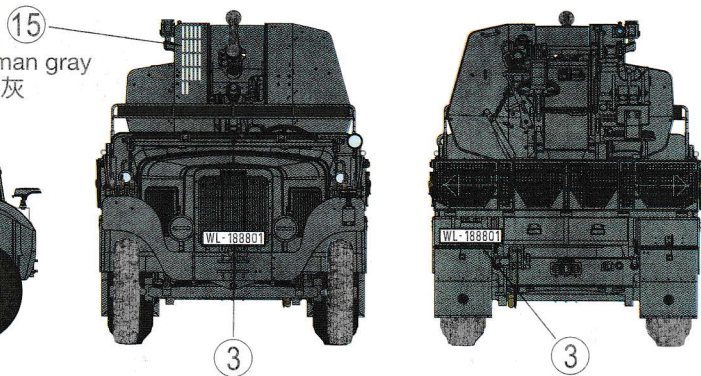
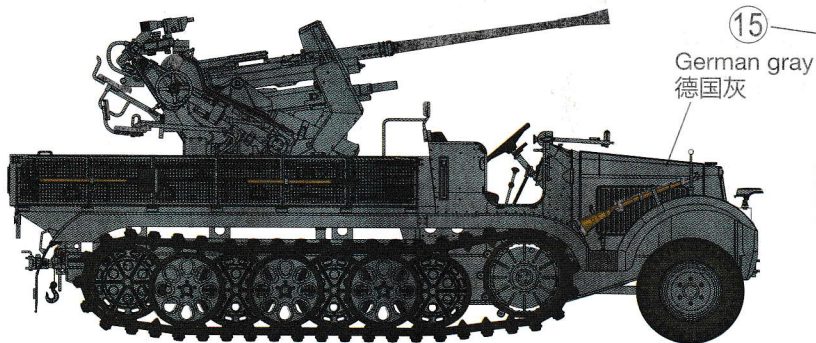

Unit unknown.
部队不明

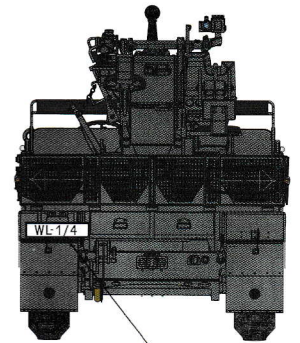
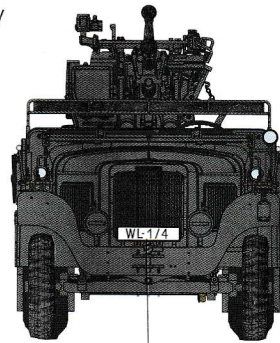
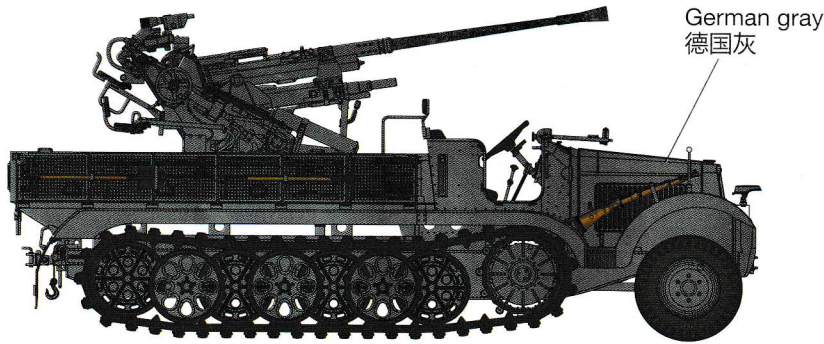

3.7cm Flak 36 auf Fgst mZgkw 5t-Sd.kfz.6/2 from the 290.Flak Abteilung (Luftwaffe) 4th panzer Division, Eastern Front, Summer 1944.
1944年在东部战线作战之第4装甲师属下车辆

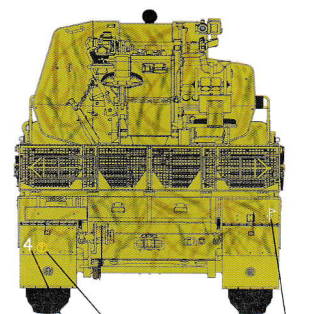
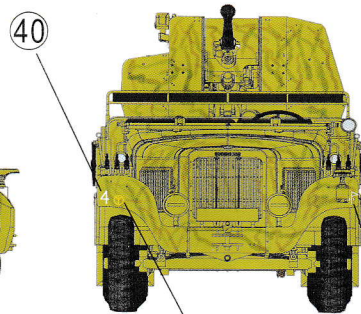
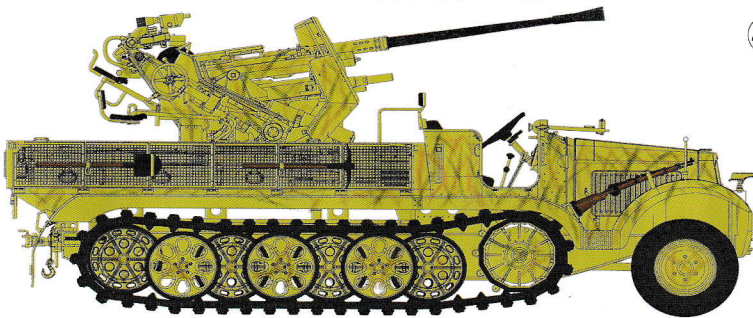

Camouflage Scheme: Dark Yellow / Dark Green / Red Brown
迷彩颜色: 深黄色 / 深绿色 / 红棕色

LAH in eastern front 1941-1942.
在1941-1942年间东部战线作战之党卫军部队属下车辆

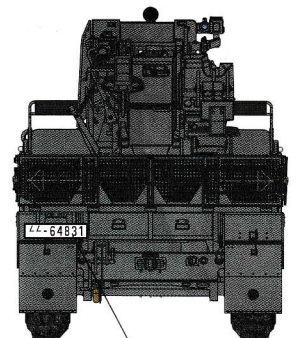
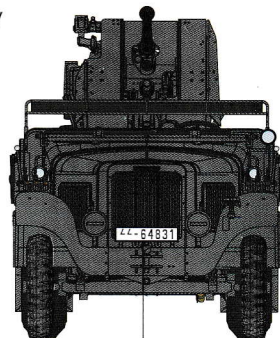
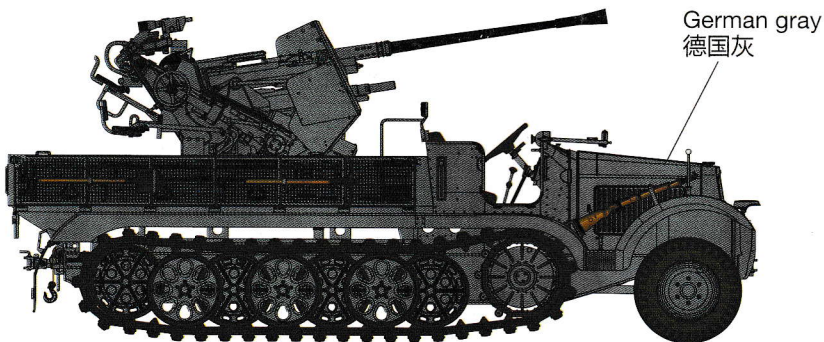

★ Caution: This kit not include the Sd.Ah.52 37mm Flak 36/37 Ammunition Carriage Trailer, please purchase the Bronco product CB35079 if require.
注意: 本套件不包含德军Sd.Ah.52型37mm Flak 36/37弹药运载拖车, 如有需要请购买BRONCO CB35079产品。

