

eduard
MASK

CX 128

F-15E Strike Eagle 1/72

The die-cut mask for accurate canopy frame painting of the Academy
scale 1/72 KIT

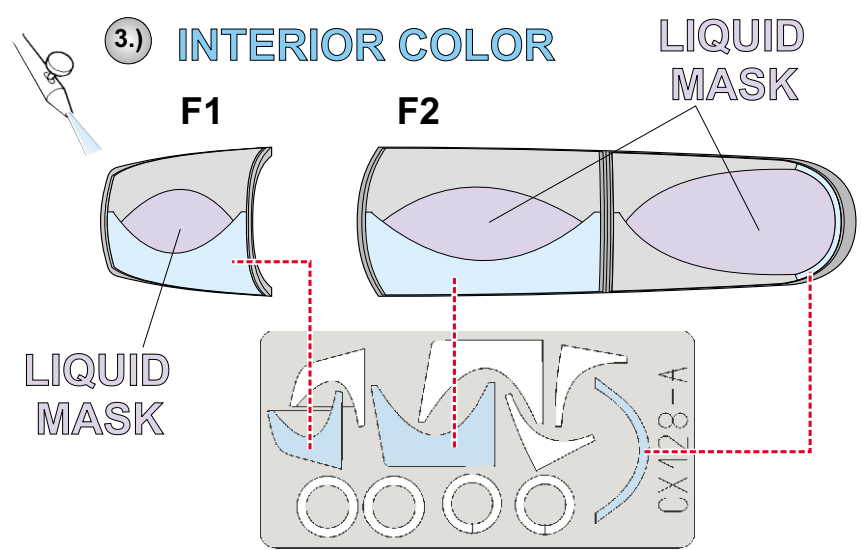
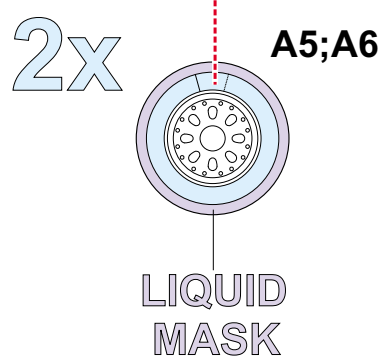
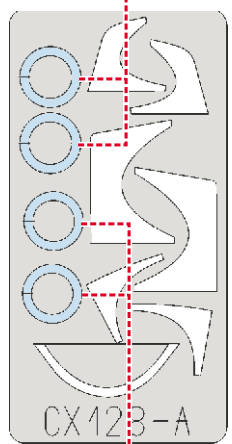
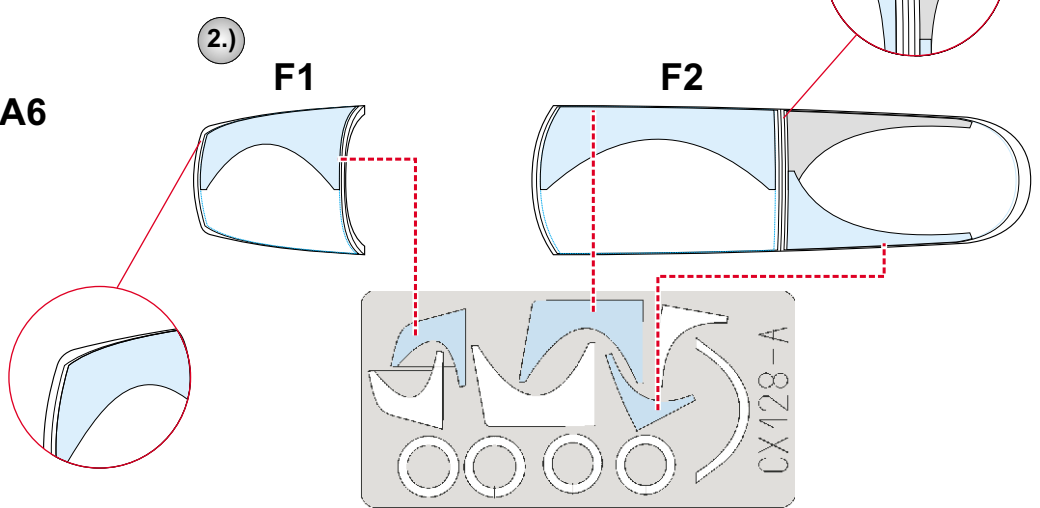
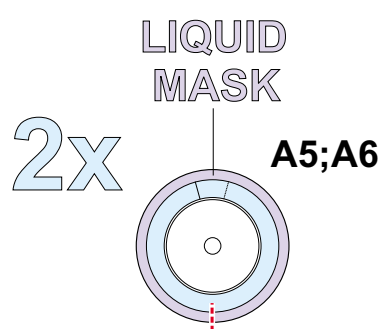
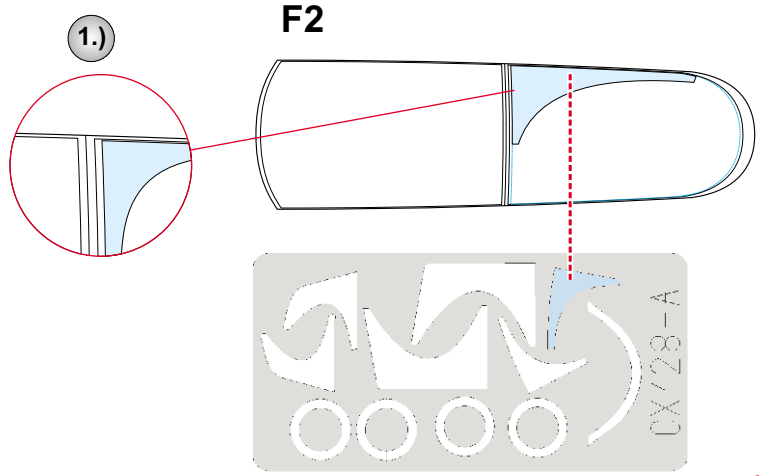
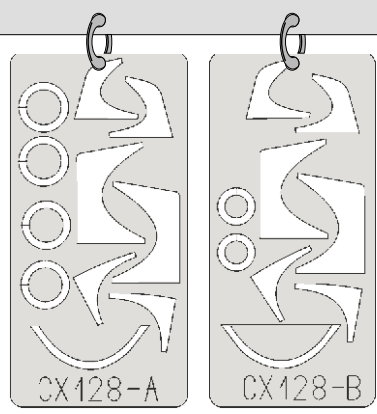

RUBBER
COLOR

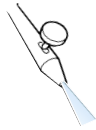

4.)

F1

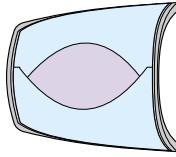

F2

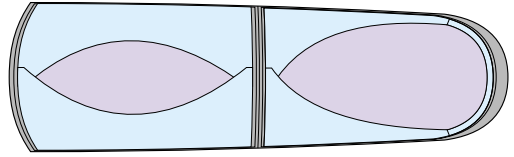

5.)

REMOVE MASK

6.)

F2

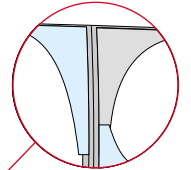
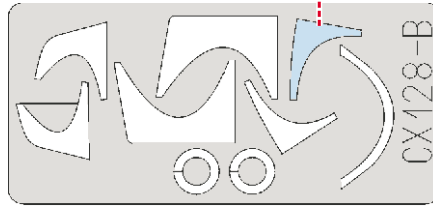
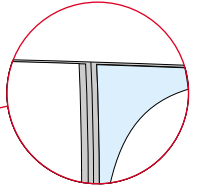
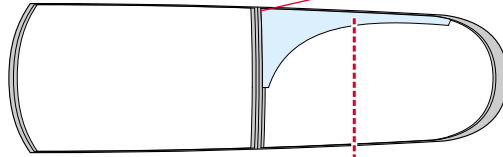

LIQUID
MASK

A16

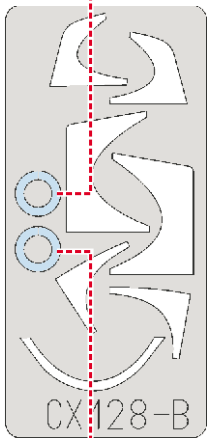
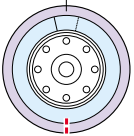

7.)

F1

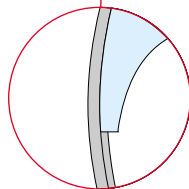
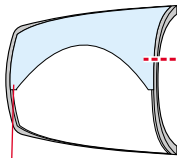

F2

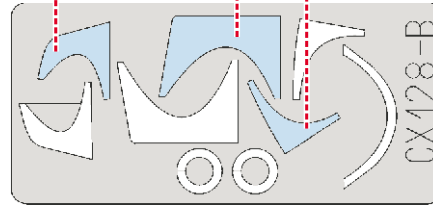
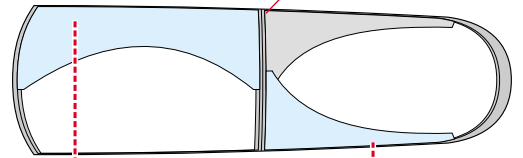

A16

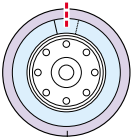

LIQUID
MASK

8.)

CAMOUFLAGE COLOR

LIQUID
MASK

F1

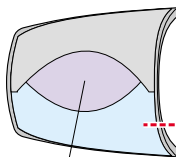

LIQUID
MASK

F2

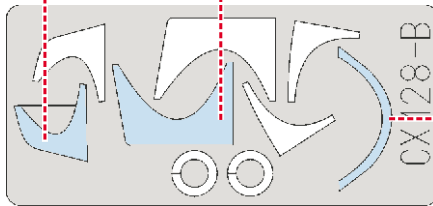
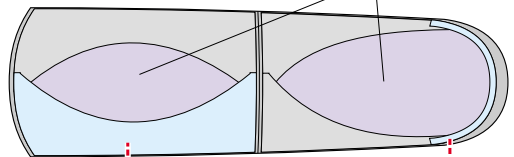

REFERENCES: Squadron/Signal Publ.: Aircraft # 24 - F-15 Eagle
Windrow & Greene Wings #1 - F-15 Strike Eagle