



Bronco Models

Kit No. CB-35038

# 7.62cm FK36(r) auf PzJgr Selbstfahrlafette Zugkraftwagen 5t 'Diana' (Sd.Kfz.6/3) 1/35 SCALE

德军7.62cm FK36(r)“黛安娜”(Sd.Kfz.6/3)5吨半履带反坦克自走炮车

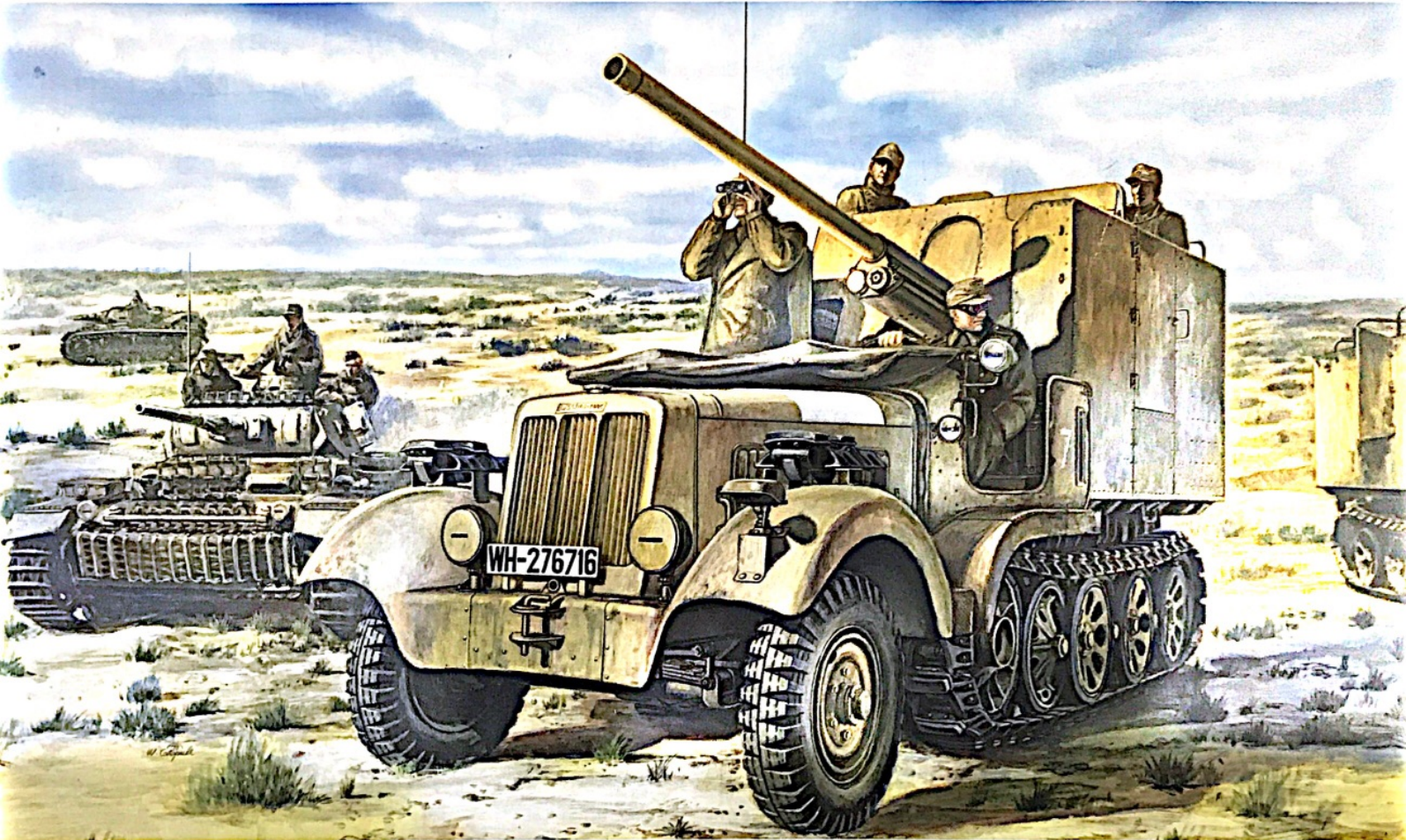

The development of the Sd.Kfz.6 was started by Büssing-NAG in 1934, it was one of a series of Half-Track vehicles for the German Army. These were primarily intended as prime movers for artillery pieces. The later Types BN 9 used the Maybach HL 54 TUKRM engine rated at 115HP. Top speed was 50kph and a crew of 7 could be carried. A total of 3,500 of these vehicles were produced. Several SdKfz 6 chassis were fitted with the Russian M1936 7.62cm anti-tank gun, examples of which were captured in Russia. The gun was mounted on the rear bed with the gun facing forward. The vehicle was designated the 7.62cm Pak.36(r) auf 5t Zugkraftwagen and named "Diana". Protection for the crew was provided by an armoured box with side access doors. Nine vehicles are thought to have been converted and issued to PzJager Abteilung 605, serving with the Deutsches Afrika Korps in North Africa.

Short story by Phil Greenwood

Die Entwicklung des Sd.Kfz.6 begann 1934 bei Büssing NAG. Sie war eine von vielen Serien von Halbkettenfahrzeugen der Wehrmacht. Obwohl eigentlich als Zugmaschine für Artilleriegeschütze gedacht, wurden einige mit erbeuteten sowjetischen M1936 7,62cm PaK bestückt. Die Waffe war auf dem hinteren Teil angebracht und zeigte nach vorne. Ein kastenförmiger Aufbau mit seitlichen Türen gab der Bedienmannschaft Schutz. Offiziell bezeichnet als „7,62cm Pak (r) auf 5t Zugkraftwagen“, war in der Truppe aber eher der Begriff DIANA gebräuchlich. Spätere Baulose (BN9) waren mit dem Maybach HL 54 TUKRM bestückt, dieser 115 PS Motor erlaubte eine Höchstgeschwindigkeit von 50km/h auf der Strasse. Von den insgesamt 3500 produzierten Fahrzeugen dienten neun als DIANA bei der Panzerjäger Abteilung 605 des Deutschen Afrika Korps in Nordafrika.

© Translation Michael Knoblich ACADEMY EUROPE

Sd.Kfz.6 5t半履带牵引车是由Bussing-NAG厂于1934年开始研发。后来由BN9型开始改用迈巴赫NL38 TUK100发动机。最高时速达每小时五十公里及可载乘员7名。总共有3,500辆被生产出来。Sd.Kfz.6 5t半履带牵引车分别被发展作为运兵型(Sd.Kfz.6)和炮兵型(Sd.Kfz.6/1)及装载Flak 36三十七毫米高射炮型(Sd.Kfz.6/2)。总数有九辆BN9b底盘的这种半履带牵引车被德国非洲军团在车体上改装上大片装甲板及配有俄罗斯制七点六厘米反坦克炮作为自走反坦克炮在北非使用,这款德军改装的反坦克自走炮被英军称之为“黛安娜”(Diana)。根据数据显示Sd.Kfz.6半履带牵引车都被广泛使用到二战所有战线上。

# ILLUSTRATION 图示说明:

## CORRECT METHOD FOR APPLYING DECALS : HINWEISE ZUM ANBRINGEN DER DECALS 正确贴水贴纸的方法:

1. Clean model parts surface with wet cloth. Entsprechende Stellen am Modell feucht reinigen.  
将需要贴上水贴之部位表面擦干净。
2. Cut out the decal parts and dip them in cold water for 15 ~20 seconds. Decal ausschneiden und für 15-20 Sek. ins Wasser legen.  
将所需之贴纸剪下泡在清水里约15至20秒。
3. Place it on correct position of the model kit. Decal an der richtigen Stelle auflegen.  
将湿透之贴纸取出置放于正确之位置旁。
4. Slide off the decal from the base paper on to the model kit surface with a cotton stick. Decal mit Wattestäbchen festhalten und Papier darunter wegziehen.  
用棉花棒轻推贴纸表面使其从底纸滑出至模型表面之正确位置。
5. When decal get dry then complete. Decal mit Papiertuch andrücken und trocknen.  
待其自然干透后即完成。

## ICON INSTRUCTION: 图标说明:



Open Hole  
Loch bohren  
钻孔



Remove  
Abtrennen  
切除



2 Sets needed  
Vorgang wiederholen  
同样的制作二组



Bend  
Biegen  
曲折



Optional  
Auswahl  
可以选择采用



Apply Decal  
Decal anbringen  
贴上水贴纸



Instant Glue For Metal  
Sekundenkleber verwenden  
瞬间接着剂,金属用



Fill Hole  
Verspachteln  
把孔填平



Do not cement  
Nicht kleben  
不用粘合

## COLOR SUGGESTION: FARBTABELLE: 涂装指引:

Color	涂料表	MR. Hobby	Hobby Color	Humbrol	Tamiya
Steel	Stahl 黑铁色	H-18	C-28	53	/
Red brown	Rotbraun 红棕色	H-47	C-41	160	XF-64
Silver	Silber 银色	H-8	J-8	11	X-11
Flat white	Matt Weiss 消光白	H-11	C-62	34	XF-2
Dark sand	Dunk Sand 深沙色	/	/	/	/
Tyre black	Reifenschwarz 轮胎黑	H-77	C-137	85	/
White	Weiss 白色	H-1	C-1	/	X-2
Semi-gloss black	Schwarz Seidenmatt 半光黑色	/	C-82	/	/
Wood brown	Holzbraun 木棕色	H-37	C-43	/	/
Rust	Rust 铁锈色	H-334	/	113	/
Flat black	Mattschwarz 消光黑	H-12	C-33	33	XF-1
Copper	铜色	H-10	C-10	12	XF-6
Red	Rot 红色	H-3	C-3	19	X-7
Khaki	Kaki 卡其色	H-81	C-55	26	XF-49
Field gray	Feldgrau 原野灰	H-48	C-52	/	XF-65

## BEFORE ASSEMBLING: VOR ZUSAMMENBAU LESEN: 组装必读:

Carefully Study instruction before assembling. Anleitung studieren und verständlich machen. 组装前请阅读清楚制作指引。

- ⚠ Keep plastic model glue and tools away from children. Kleber, Farben, Werkzeuge und Plastiktüten von Kindern fernhalten. 胶水,油漆及工具勿让小孩接触。
- ⚠ Do not use cement or paint near open flame or sparks. Kleber/Farbe nicht in Nähe von offenen Flammen. 胶水及油漆勿接触火种。
- ⚠ Do not work in closed room. Nur in ausreichend belüfteten Räumen arbeiten. 勿在密封地方制作模型。

# PARTS LIST 零件展示表:

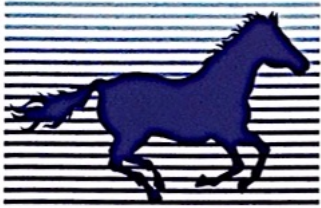

**BRONCO**

Bronco Models

Copyright © 2010

Made in China

中国制造



No use parts  
不要部件

Ⓐ × 2

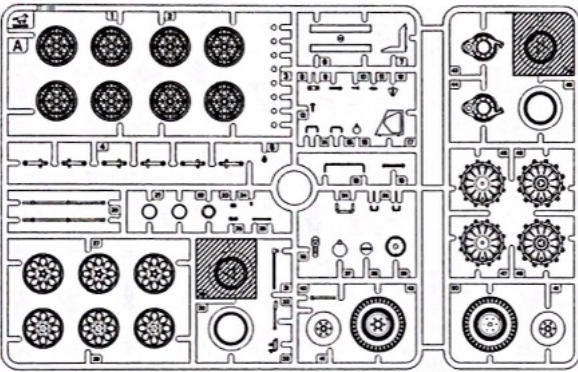

Ⓑ × 1

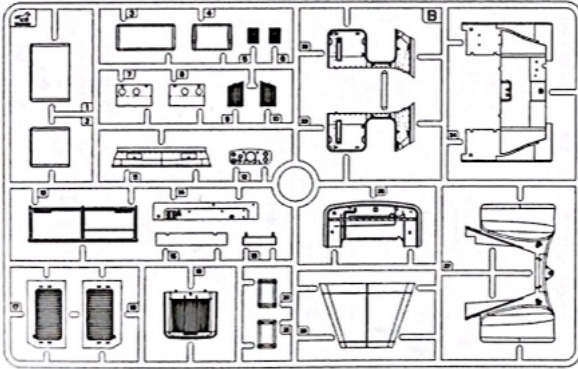

Ⓒ × 1

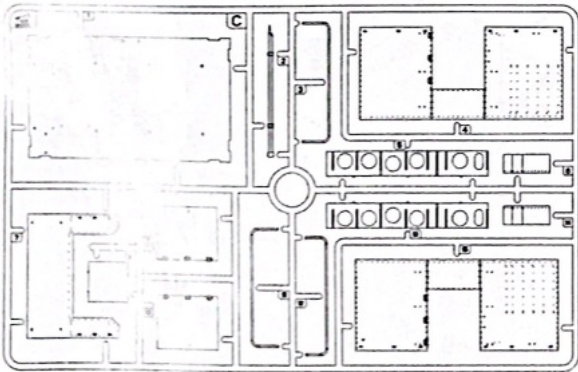

⒱ × 1



CB-35038

Ⓓ × 1

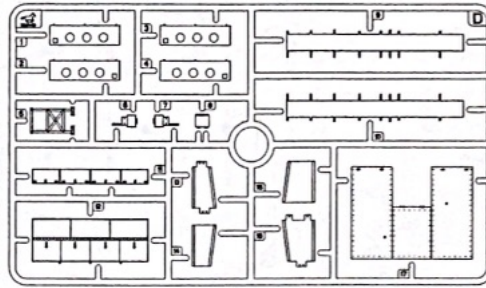

Ⓔ × 1

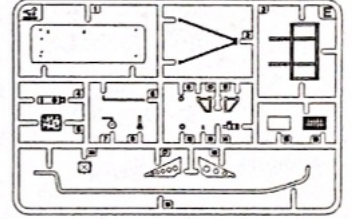

Ⓕ × 2

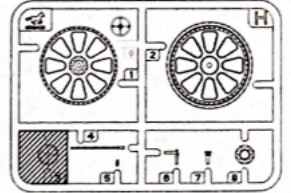

Ⓕ × 1

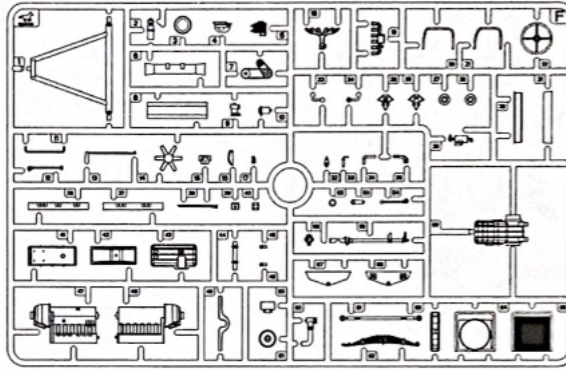

Ⓖ × 1

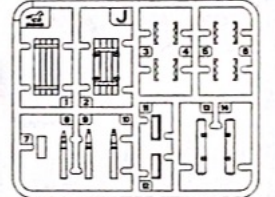

Ⓖ × 1

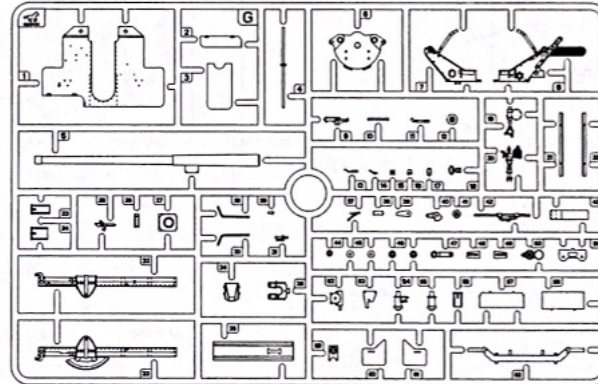

Ⓖ × 1

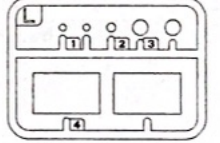

Ⓖ × 1

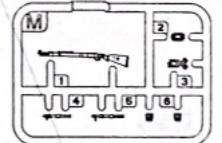

Ⓖ × 4

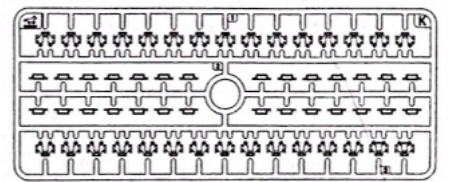

× 1

Ⓖ × 1

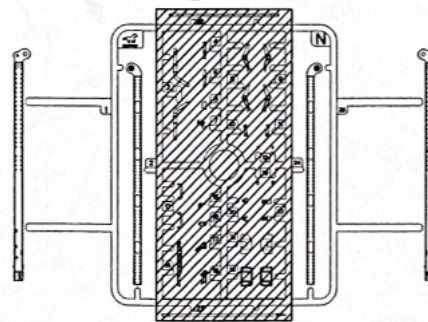

DECAL × 1



Ⓖ × 1

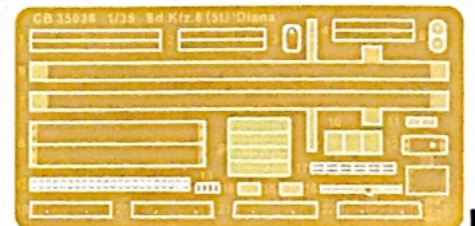

# ILLUSTRATION 图示说明:

1

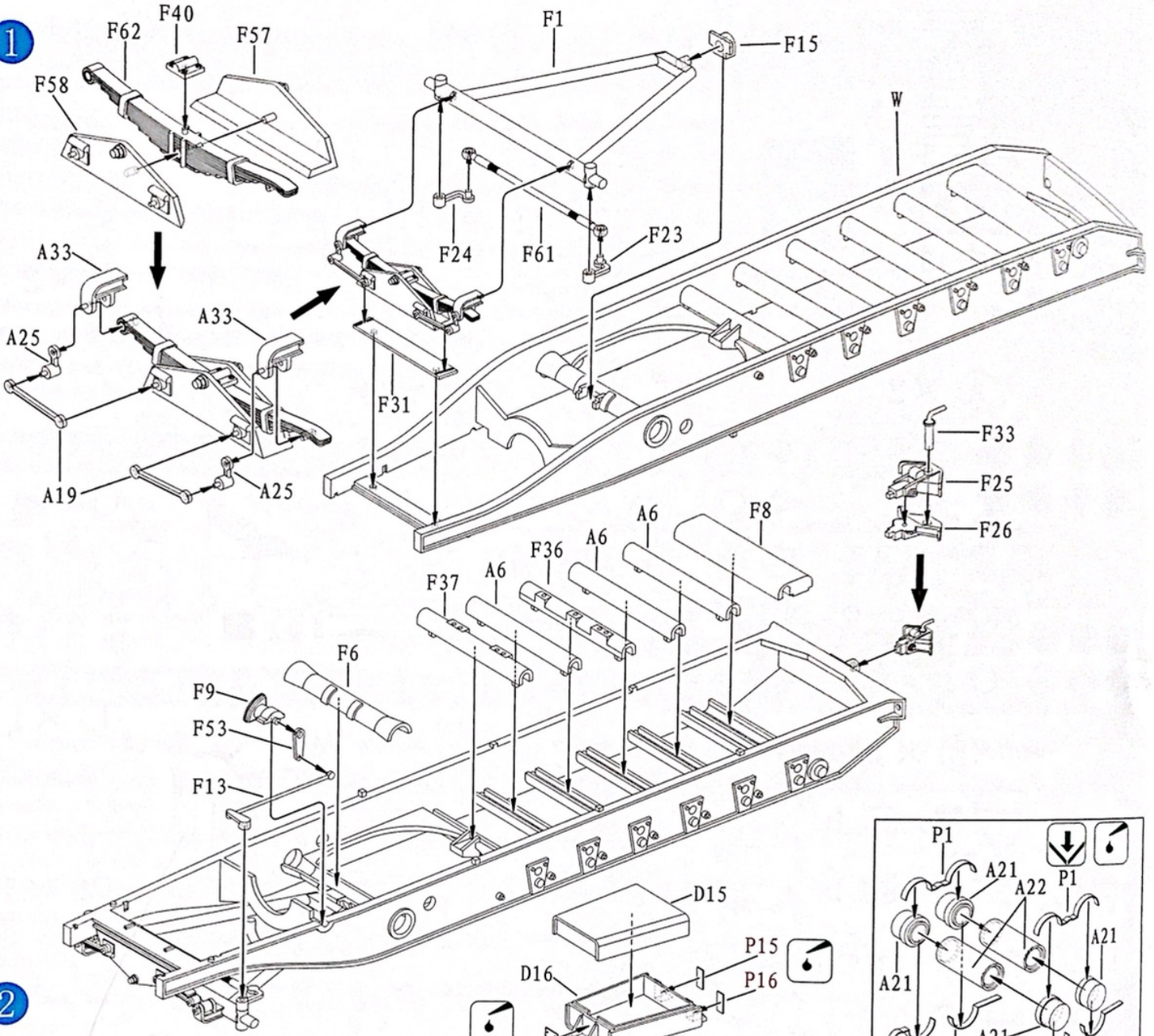

2

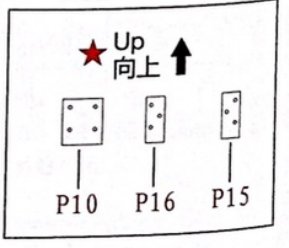
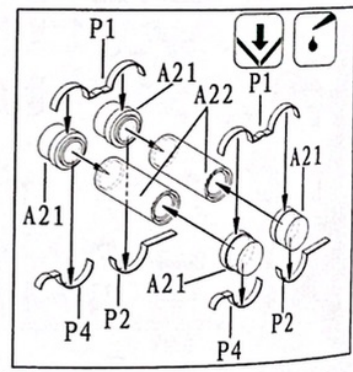
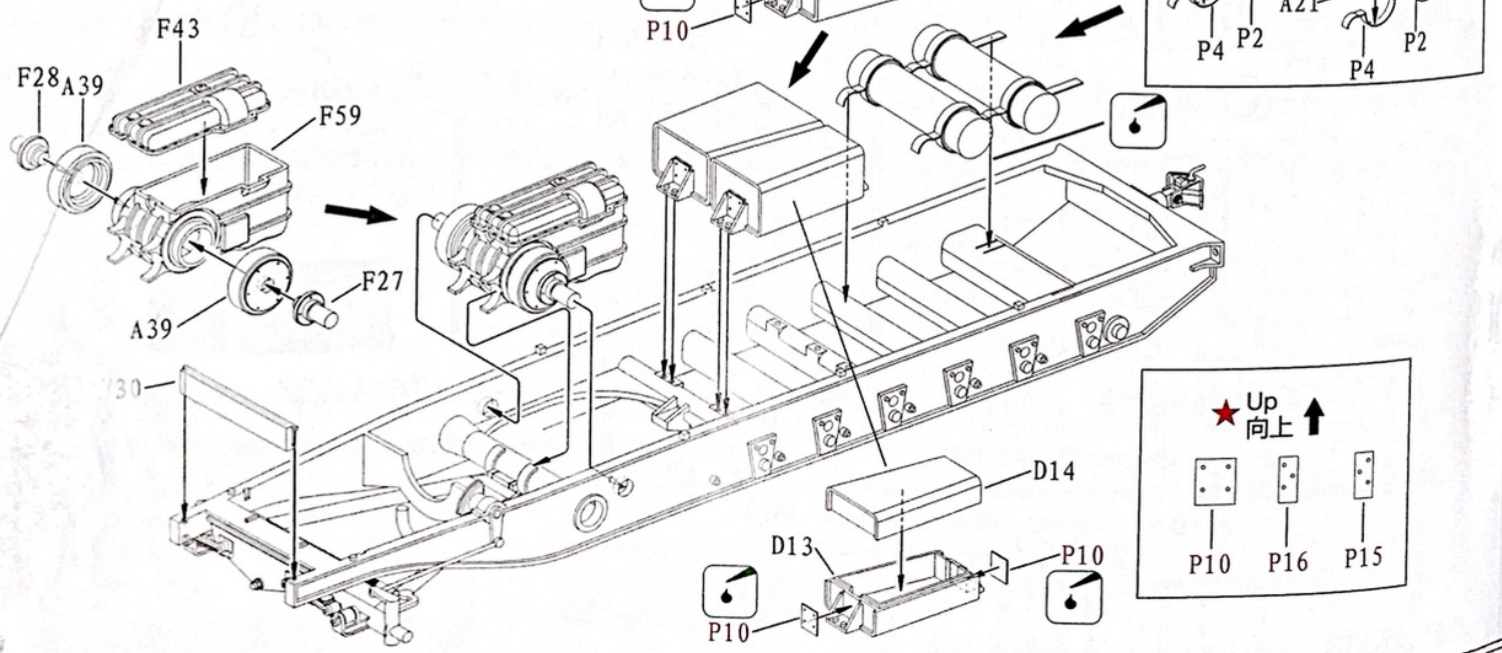
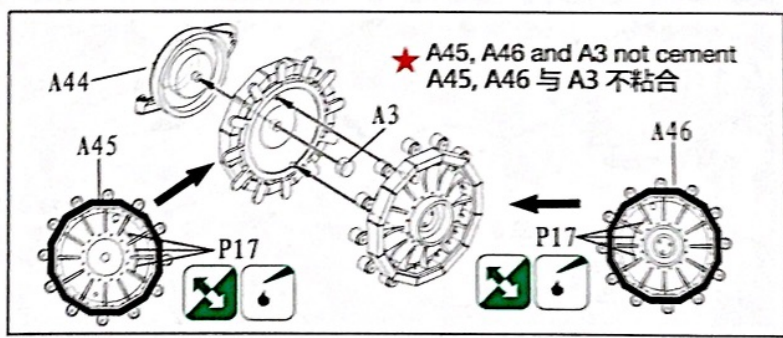
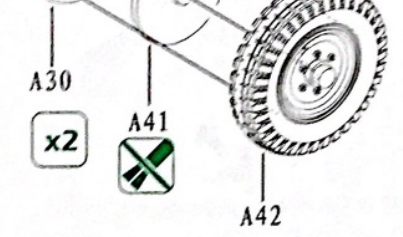
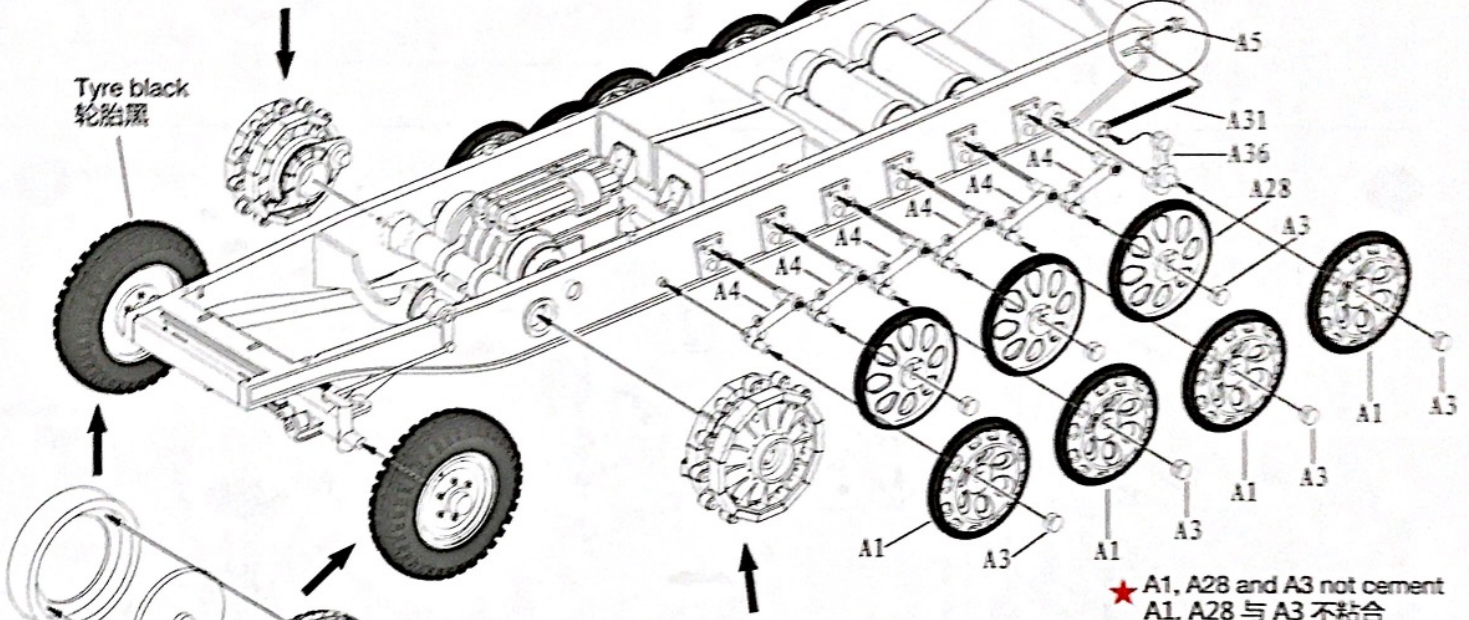
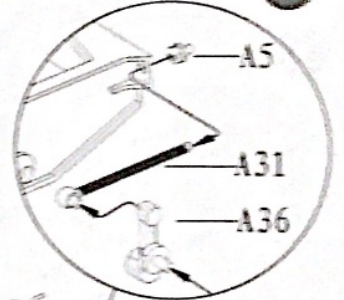
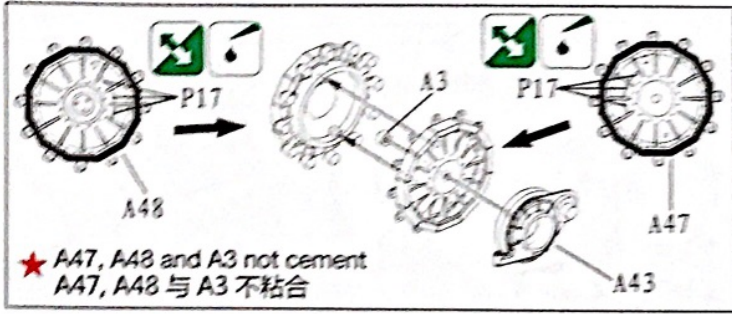
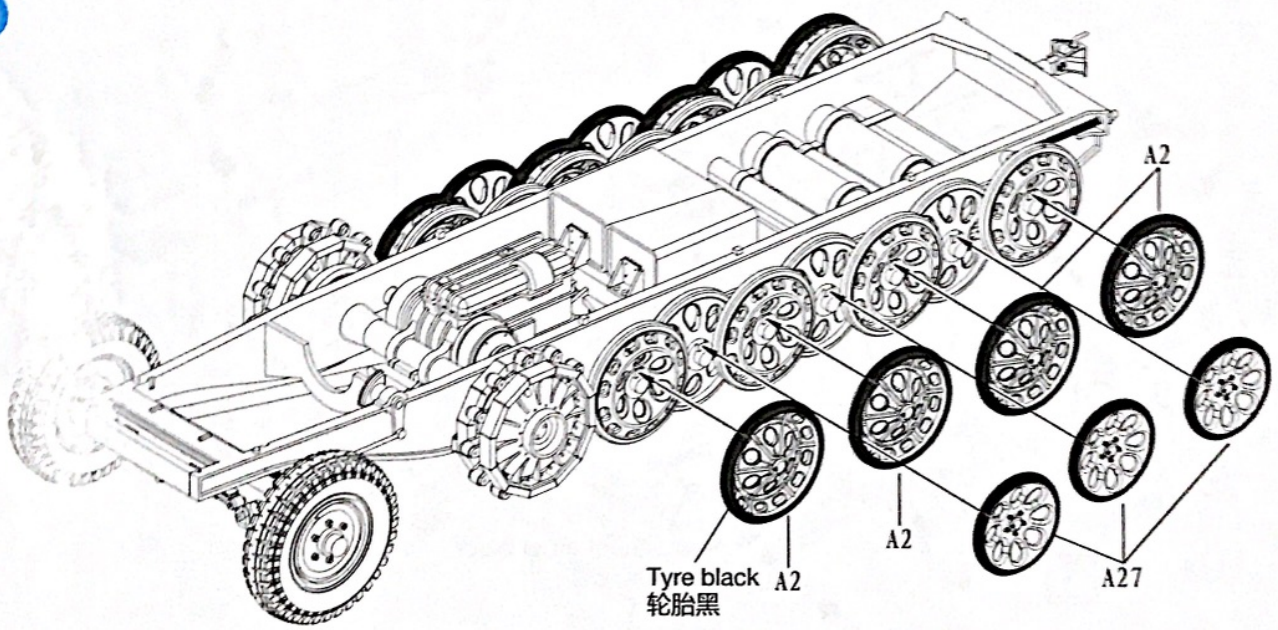

ILLUSTRATION 图示说明:

3



4



# ILLUSTRATION 图示说明:

5

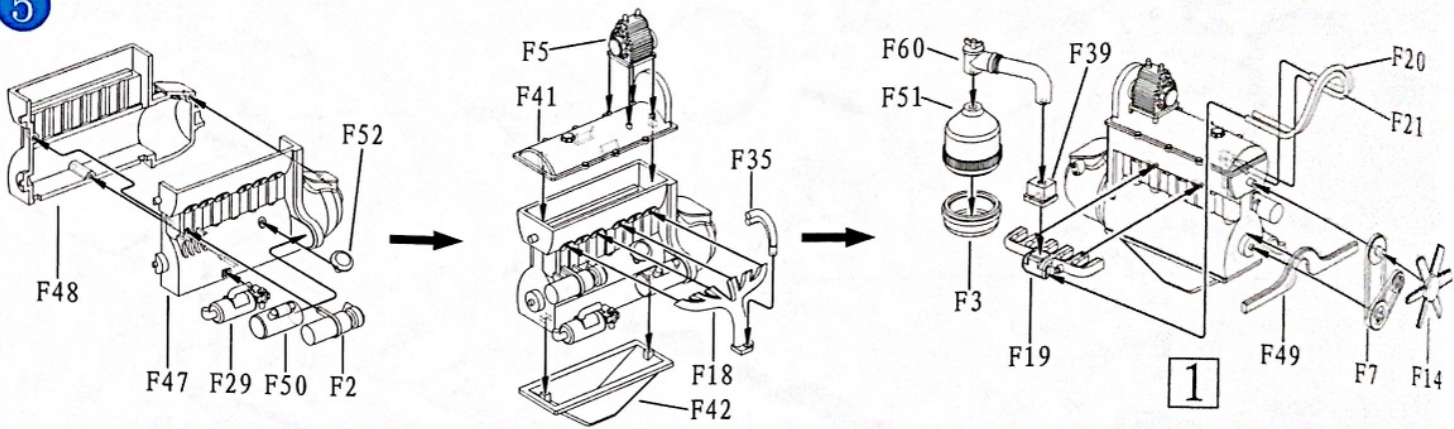

6

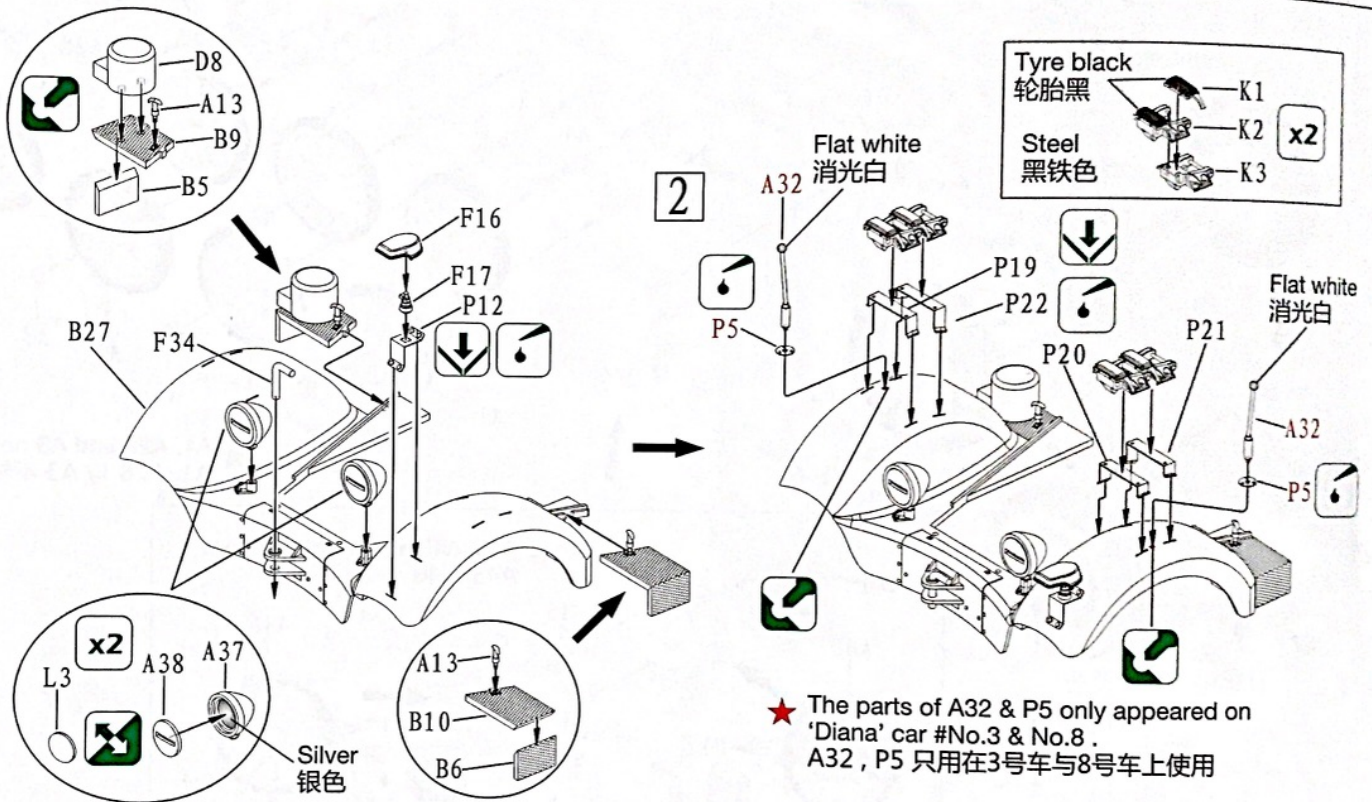

7

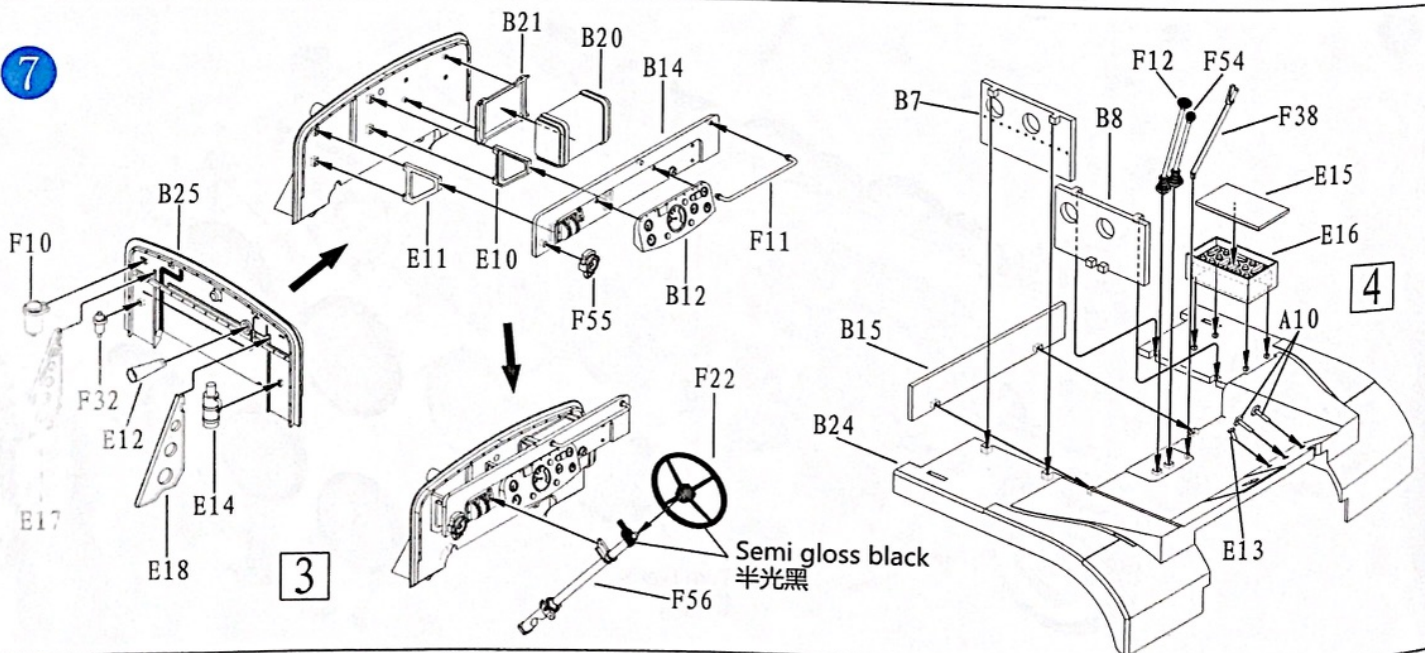

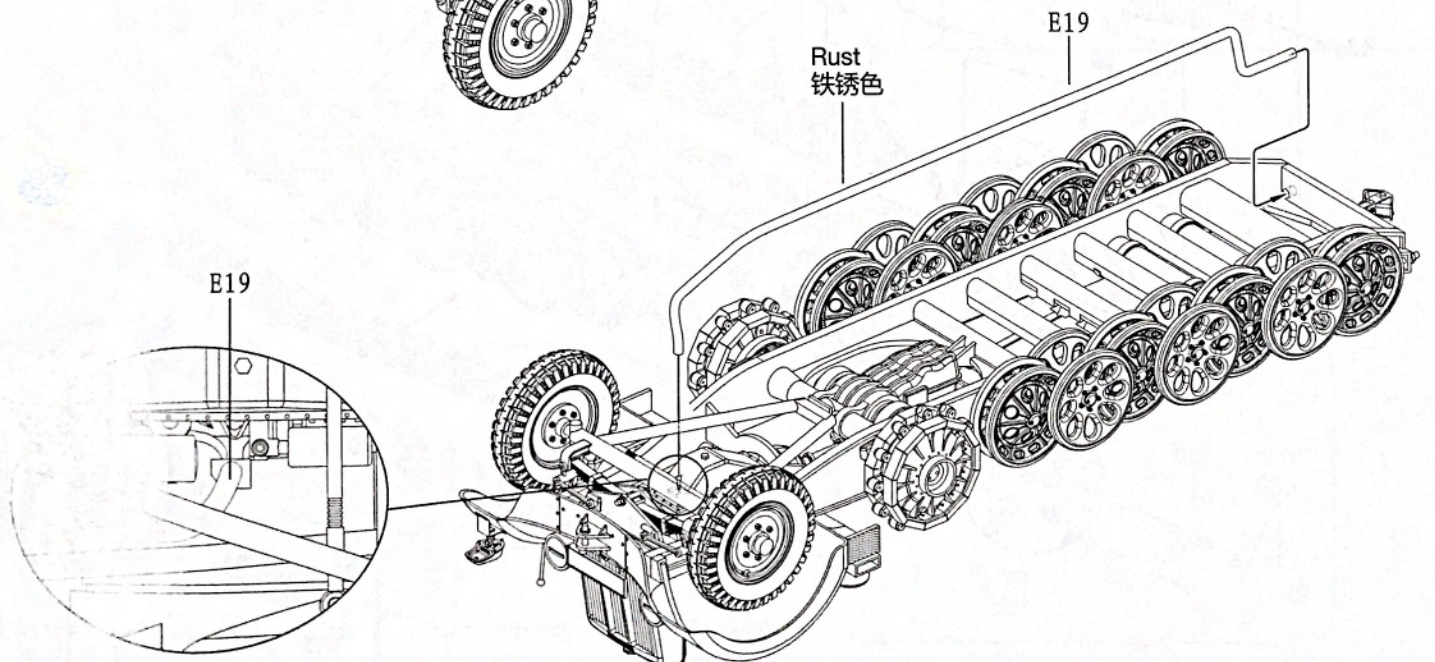
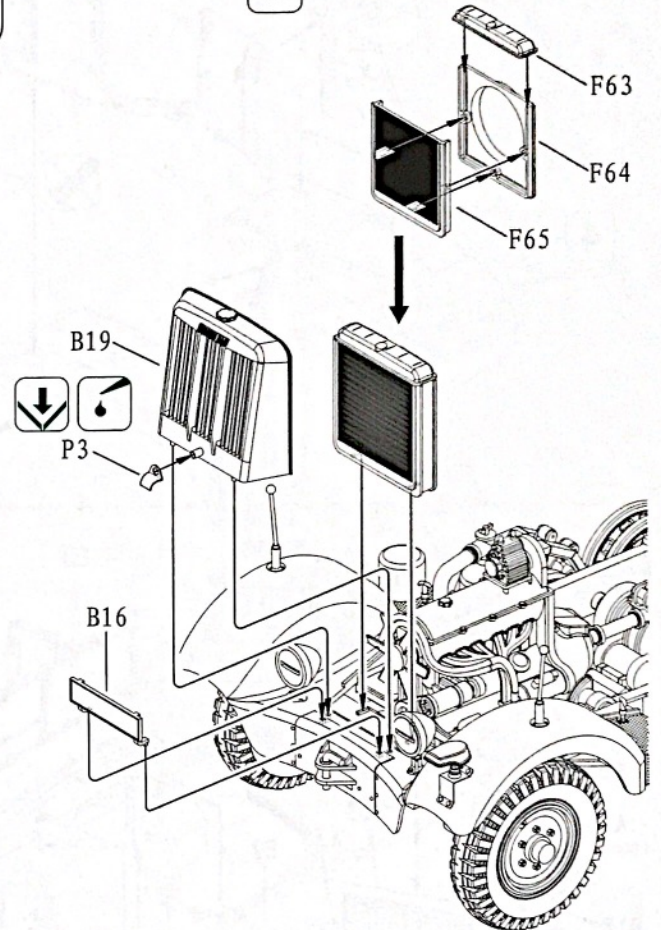
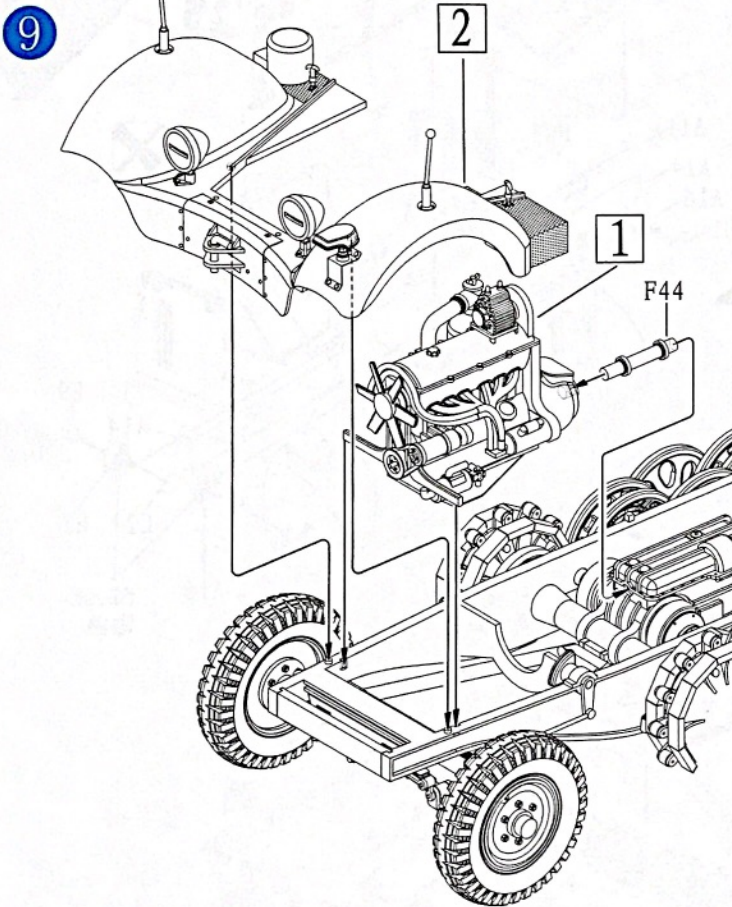
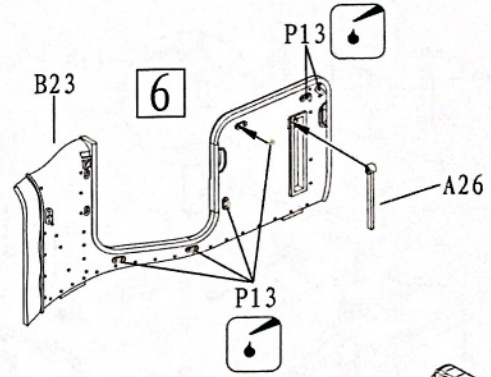
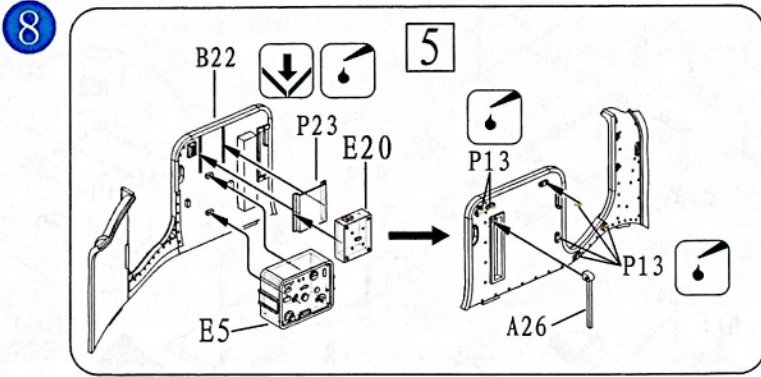

# ILLUSTRATION 图示说明:

11

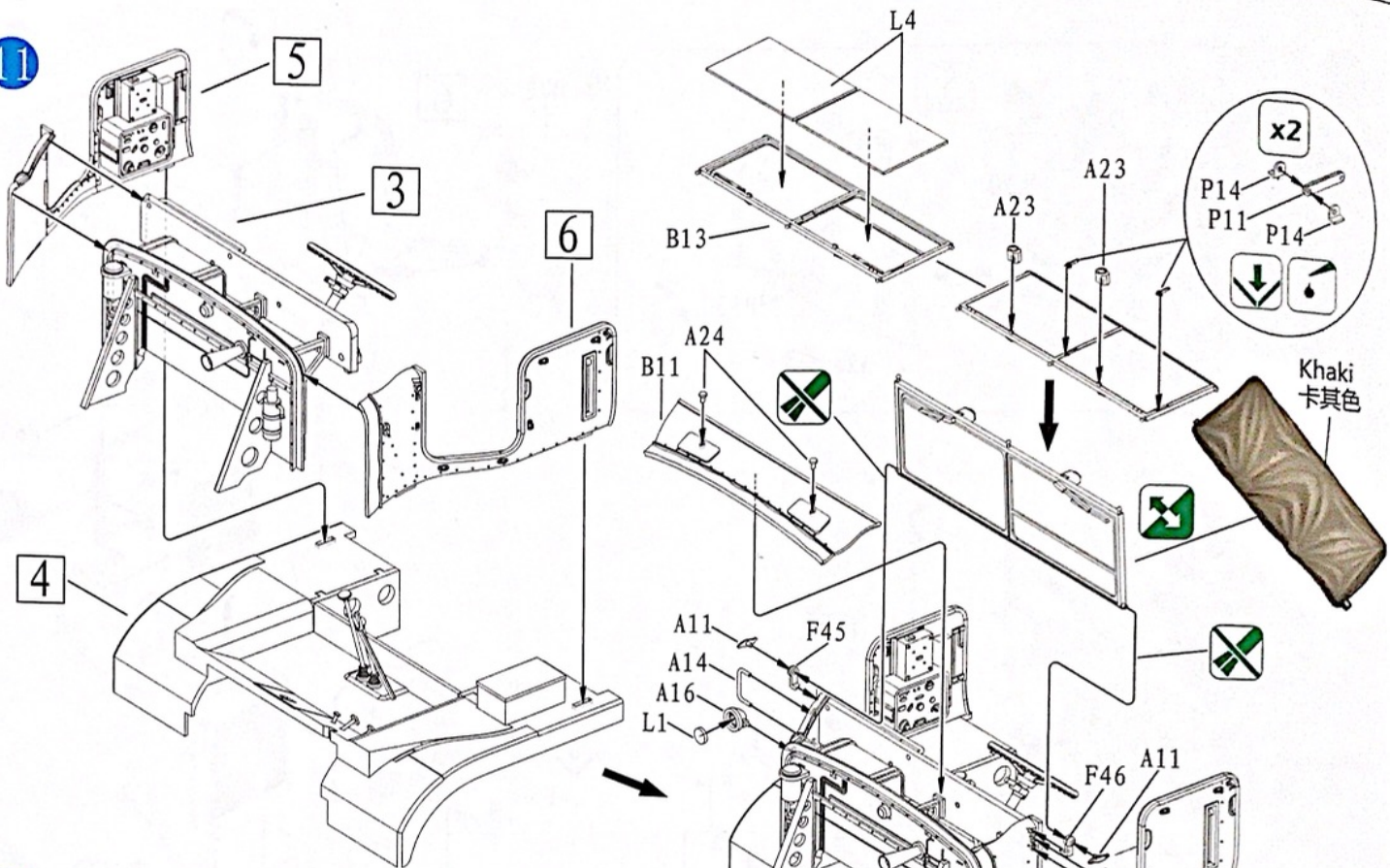

12

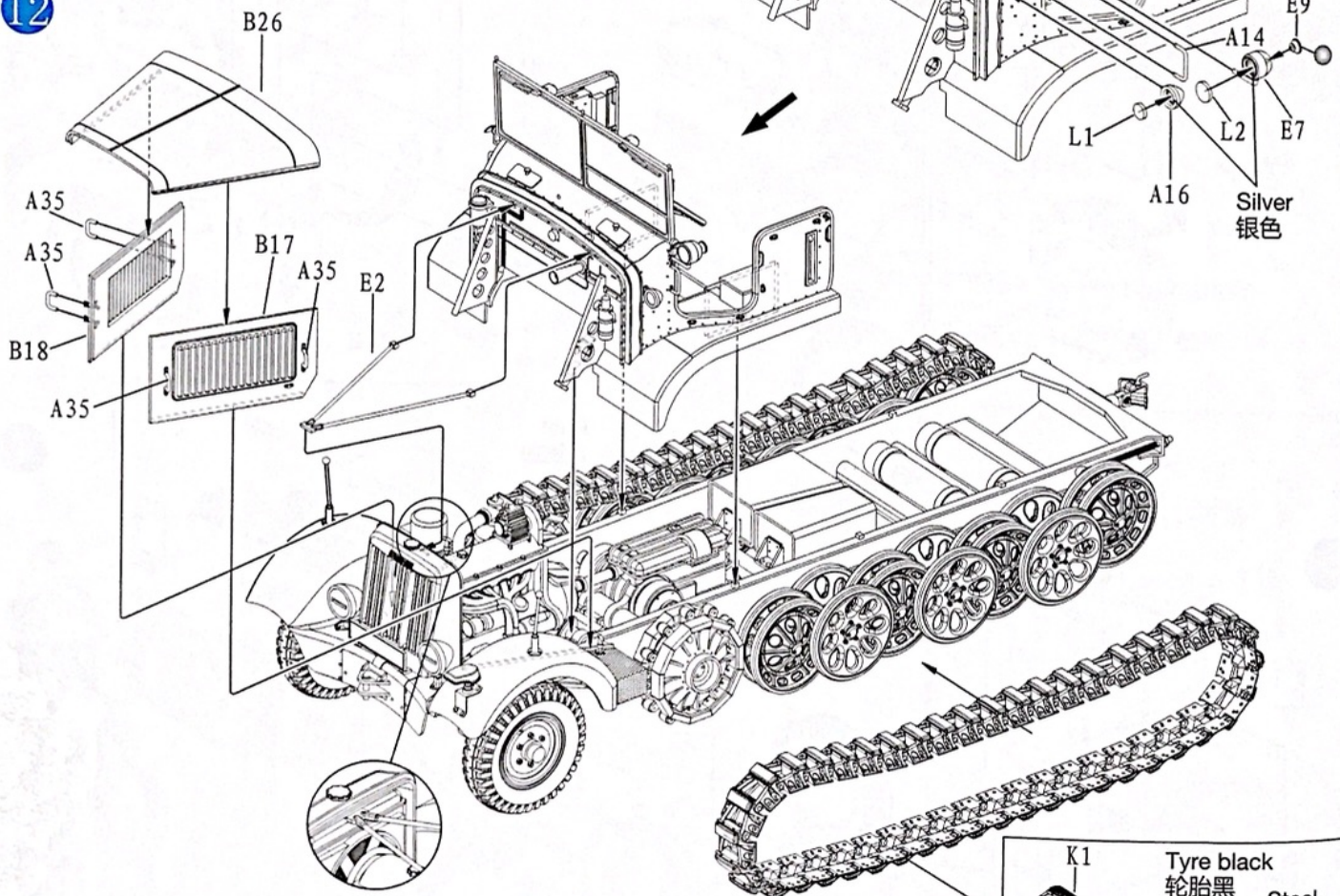

K1 Tyre black 轮胎黑  
 K2 Steel 黑铁色  
 x2  
 ★ Caution: each set x45 pc  
 注意: 每组需要45枚



13

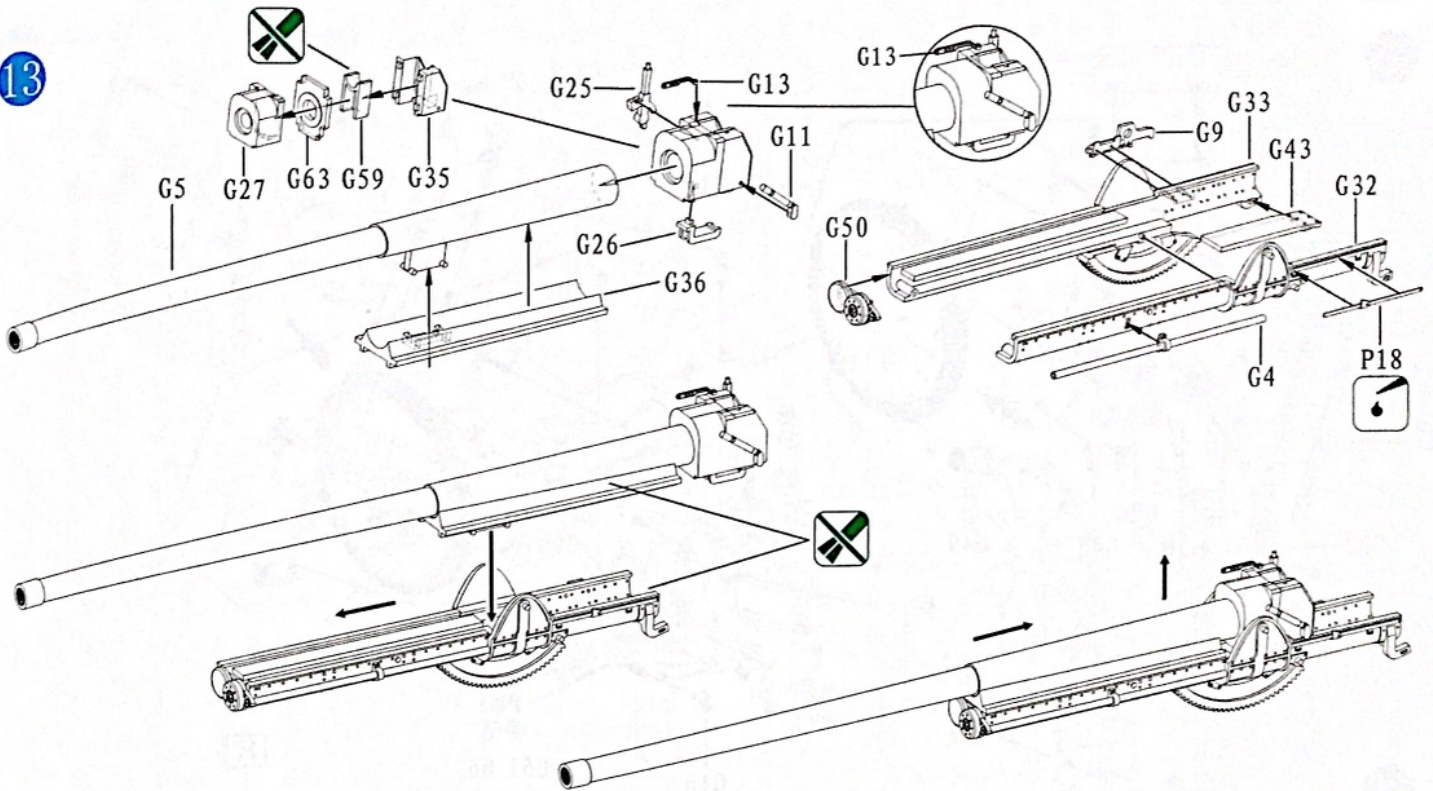

14

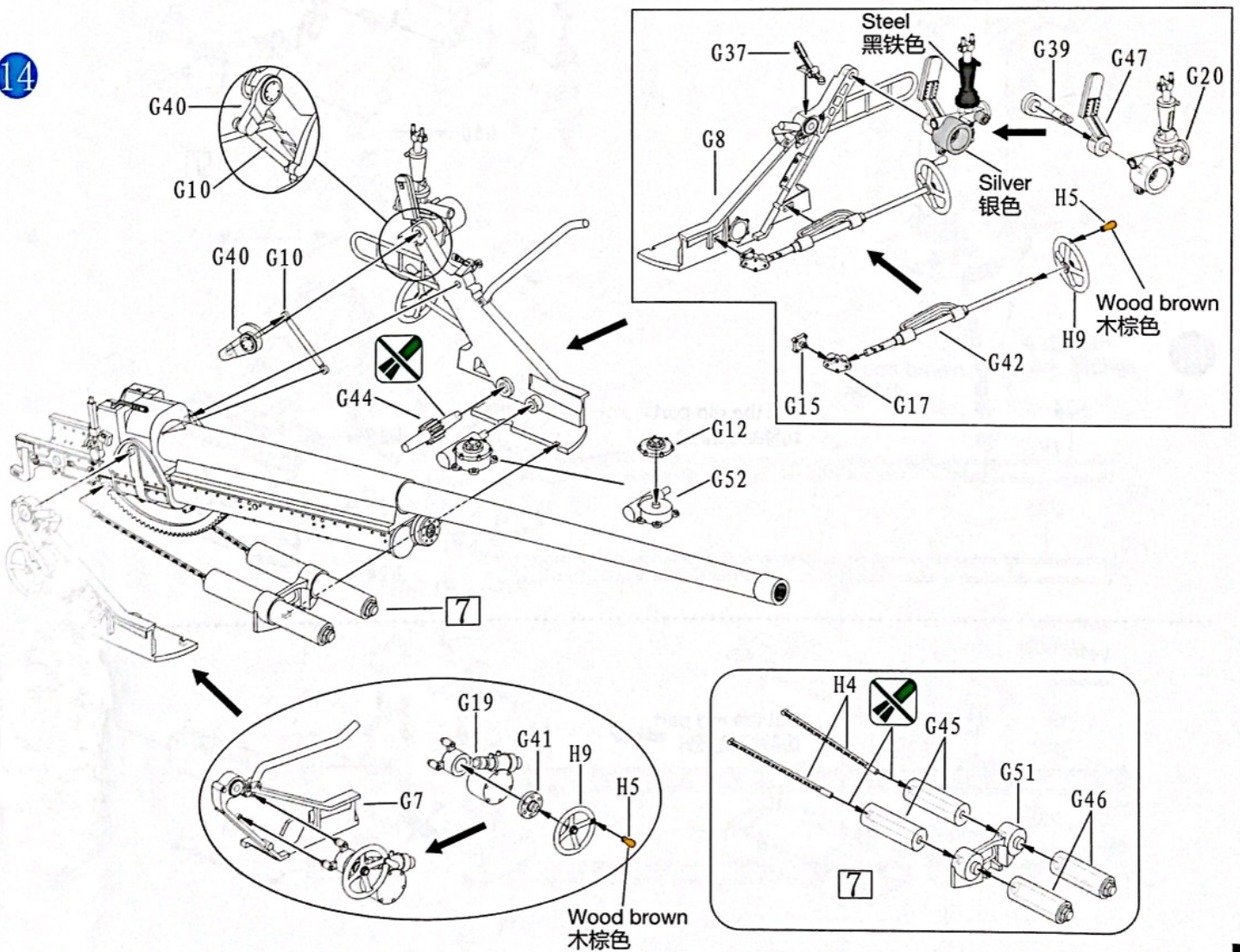

# ILLUSTRATION 图示说明:

15

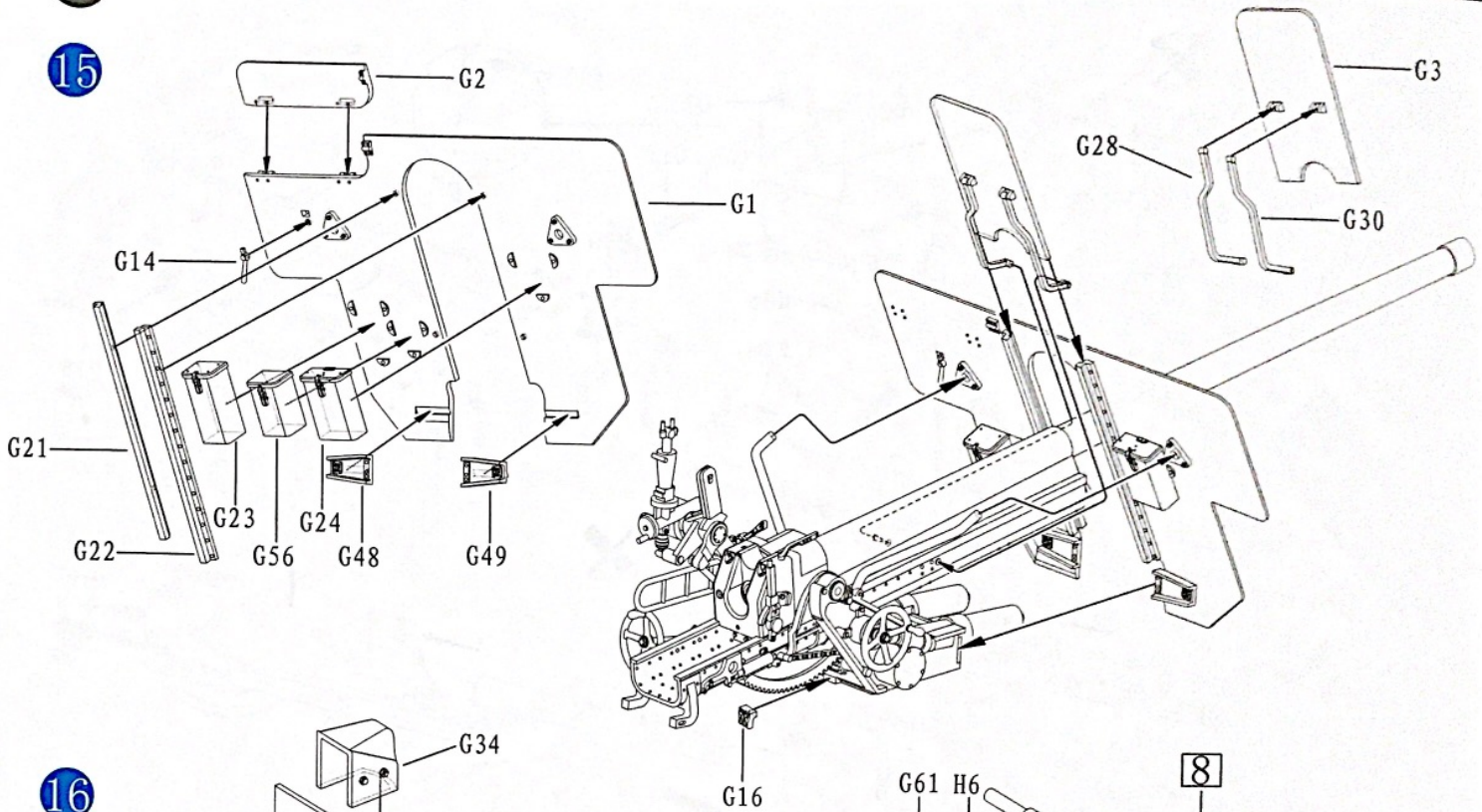

16

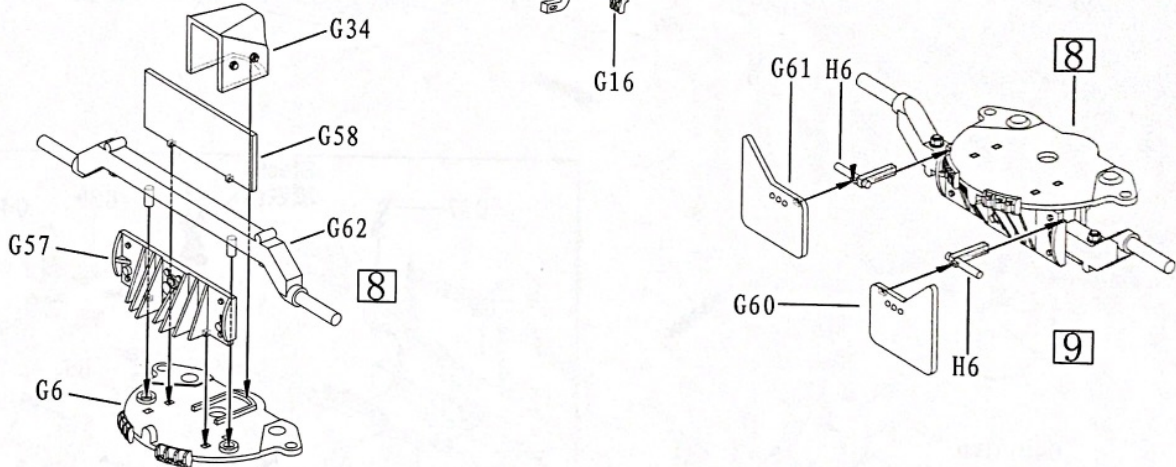

17

Right  
右侧

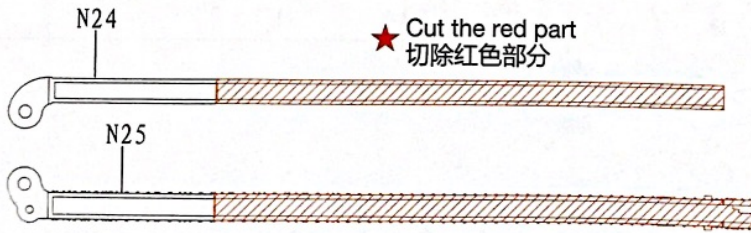

★ Cut the red part  
切除红色部分

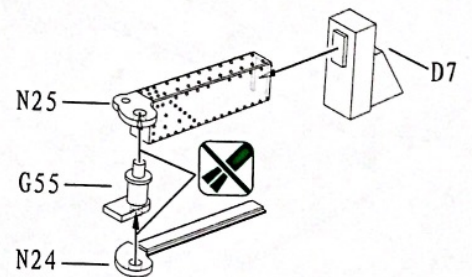

Left  
左侧

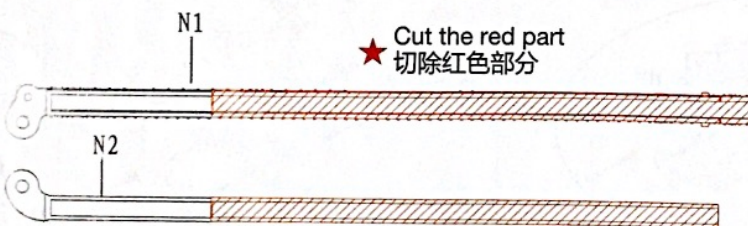

★ Cut the red part  
切除红色部分

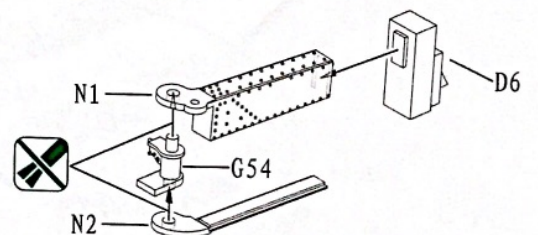

18

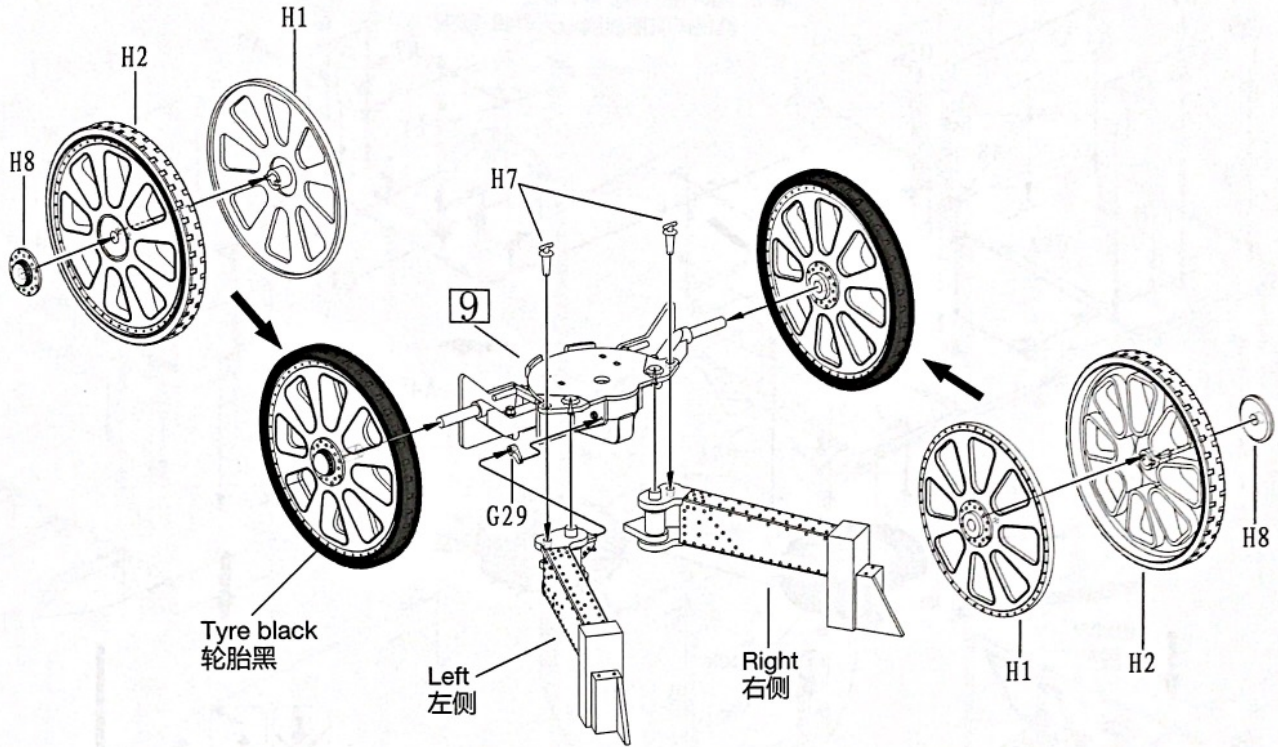

19

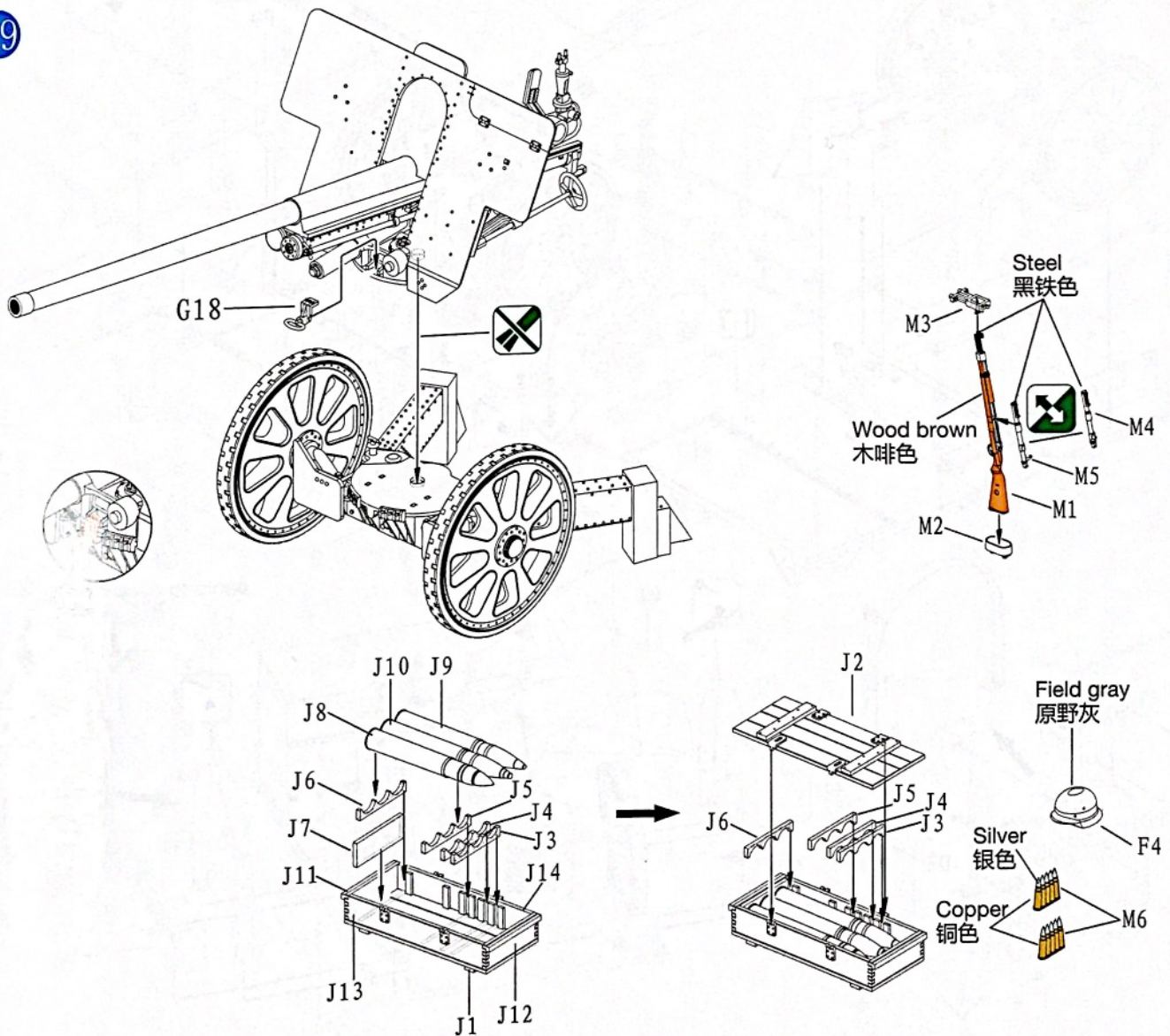

# ILLUSTRATION 图示说明:

20

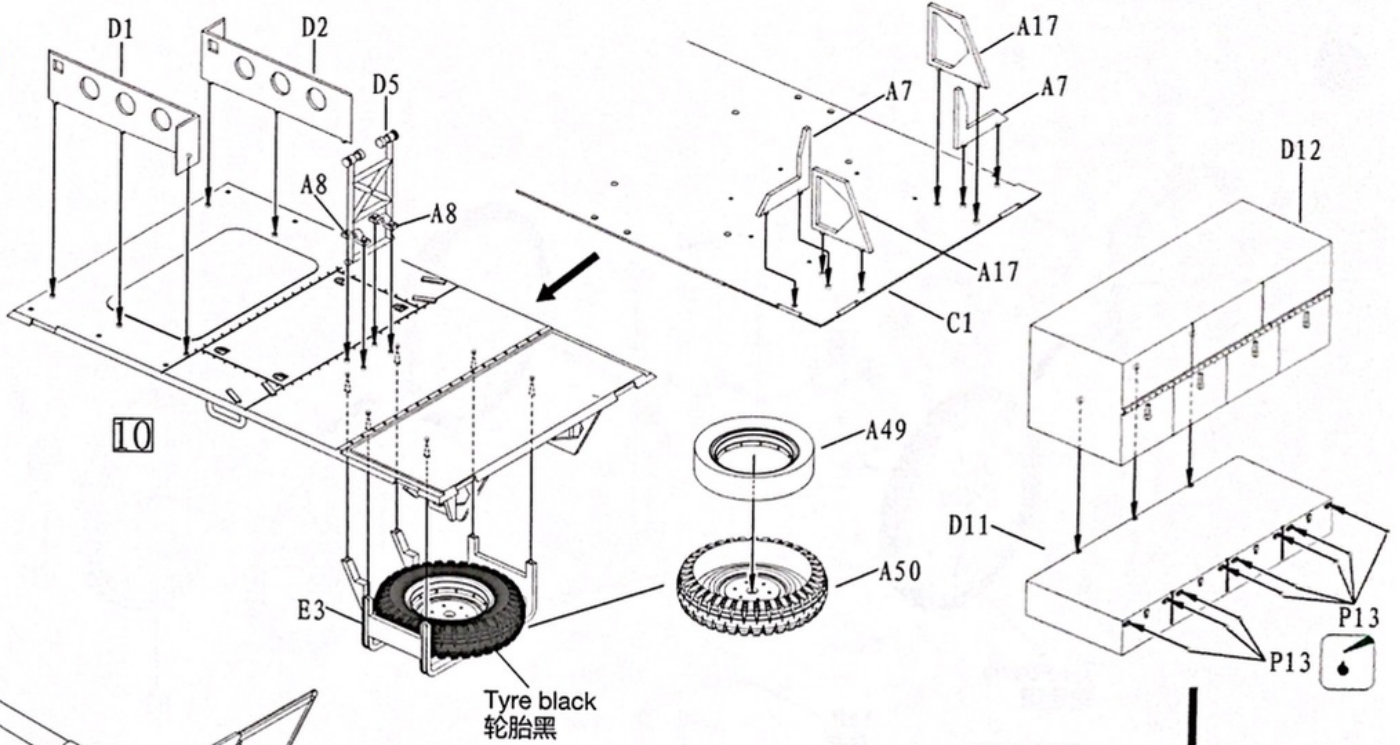

Tyre black  
轮胎黑

21

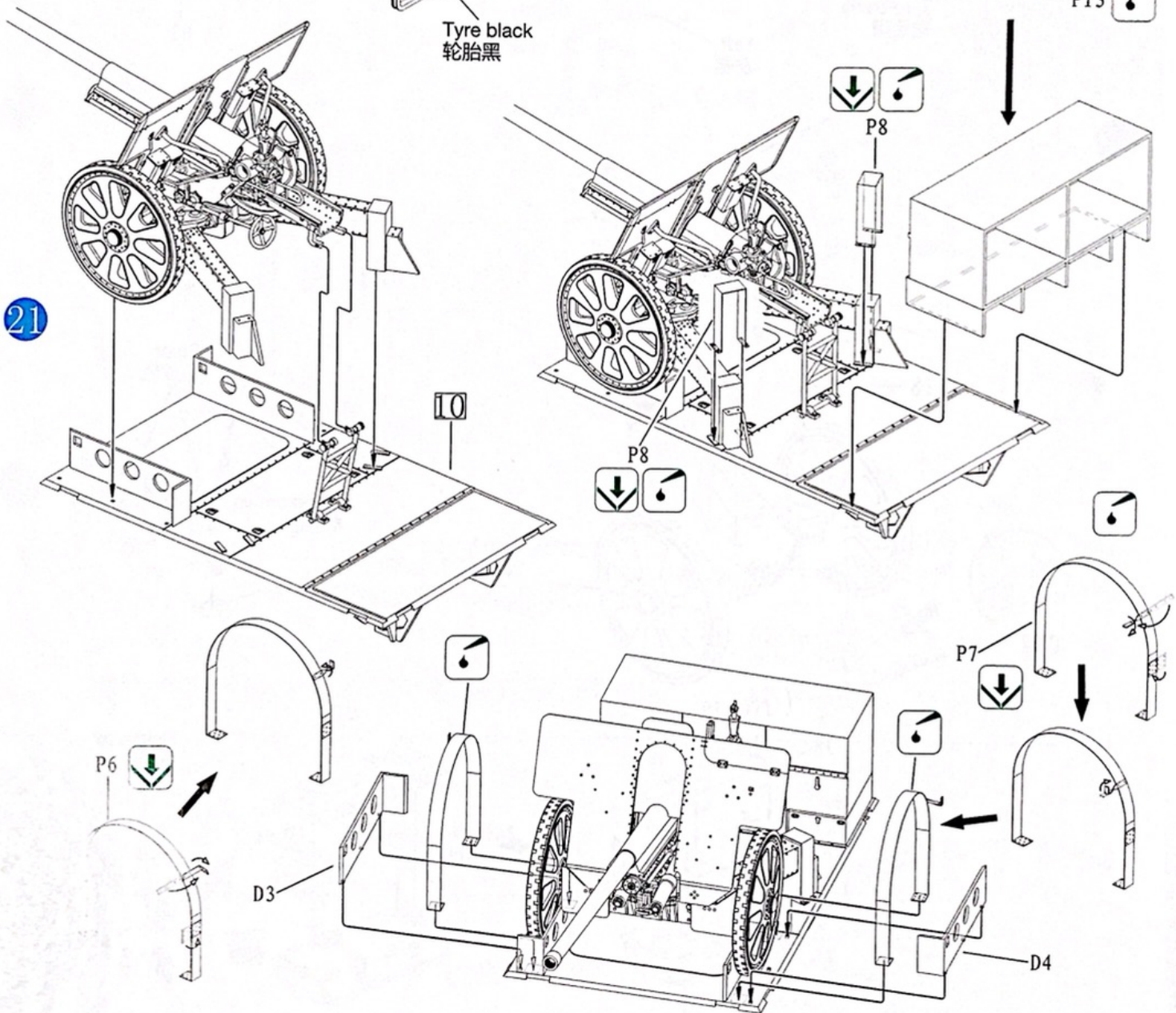

22

★ Caution: make the antenna from plastic frame channel with the heat of fire  
 注明: 制作天线用流道加热拉丝

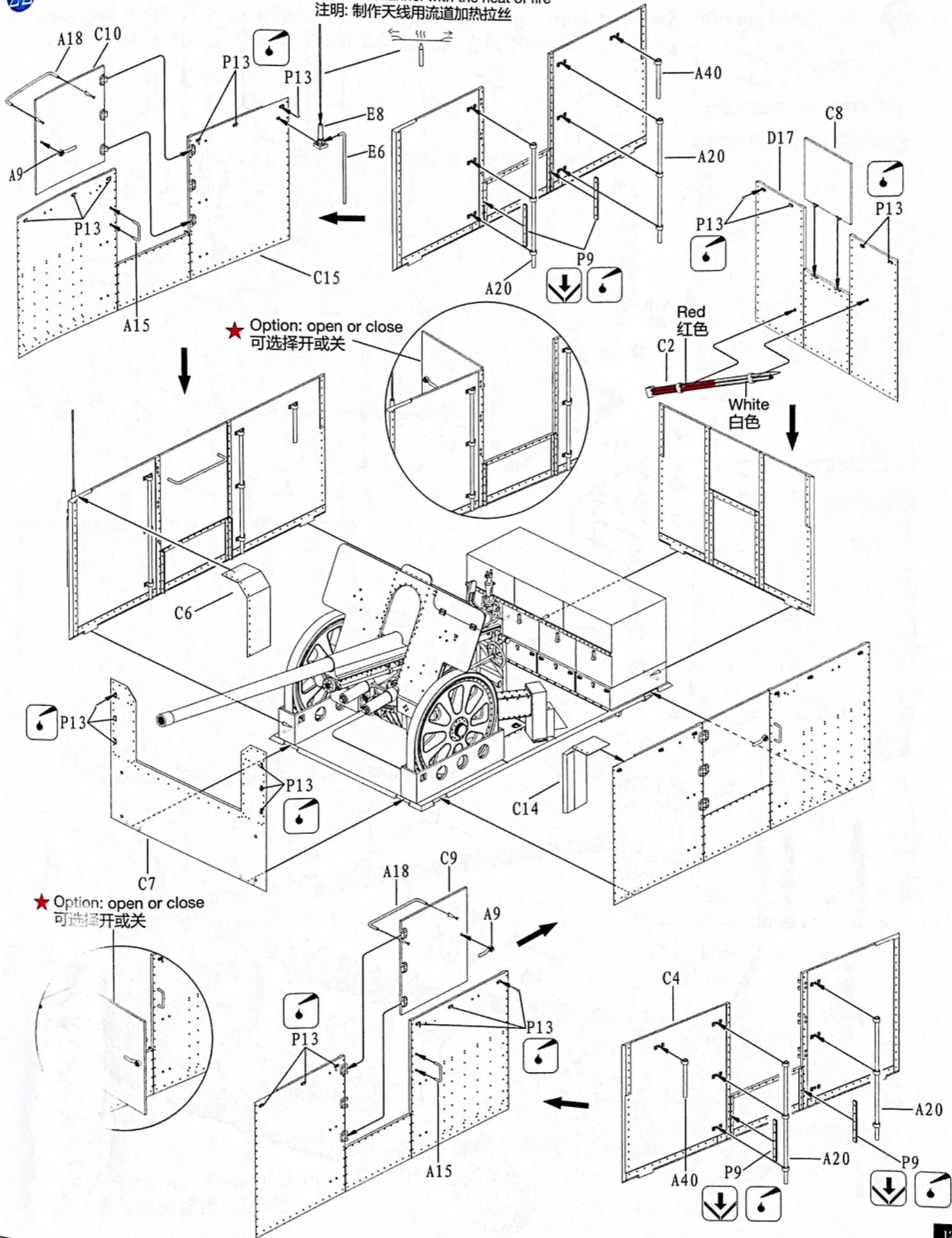

# ILLUSTRATION 图示说明:

23

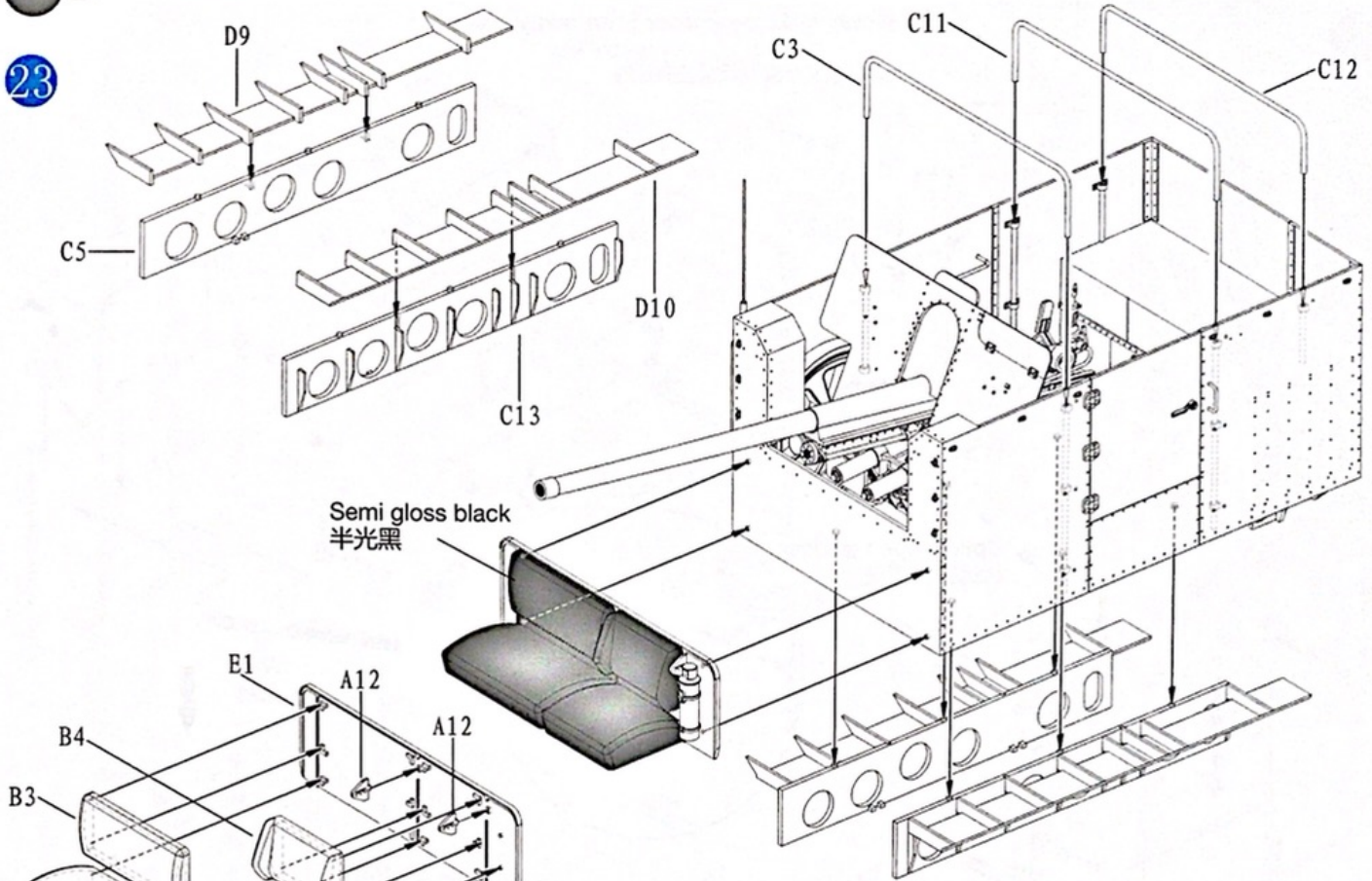

24

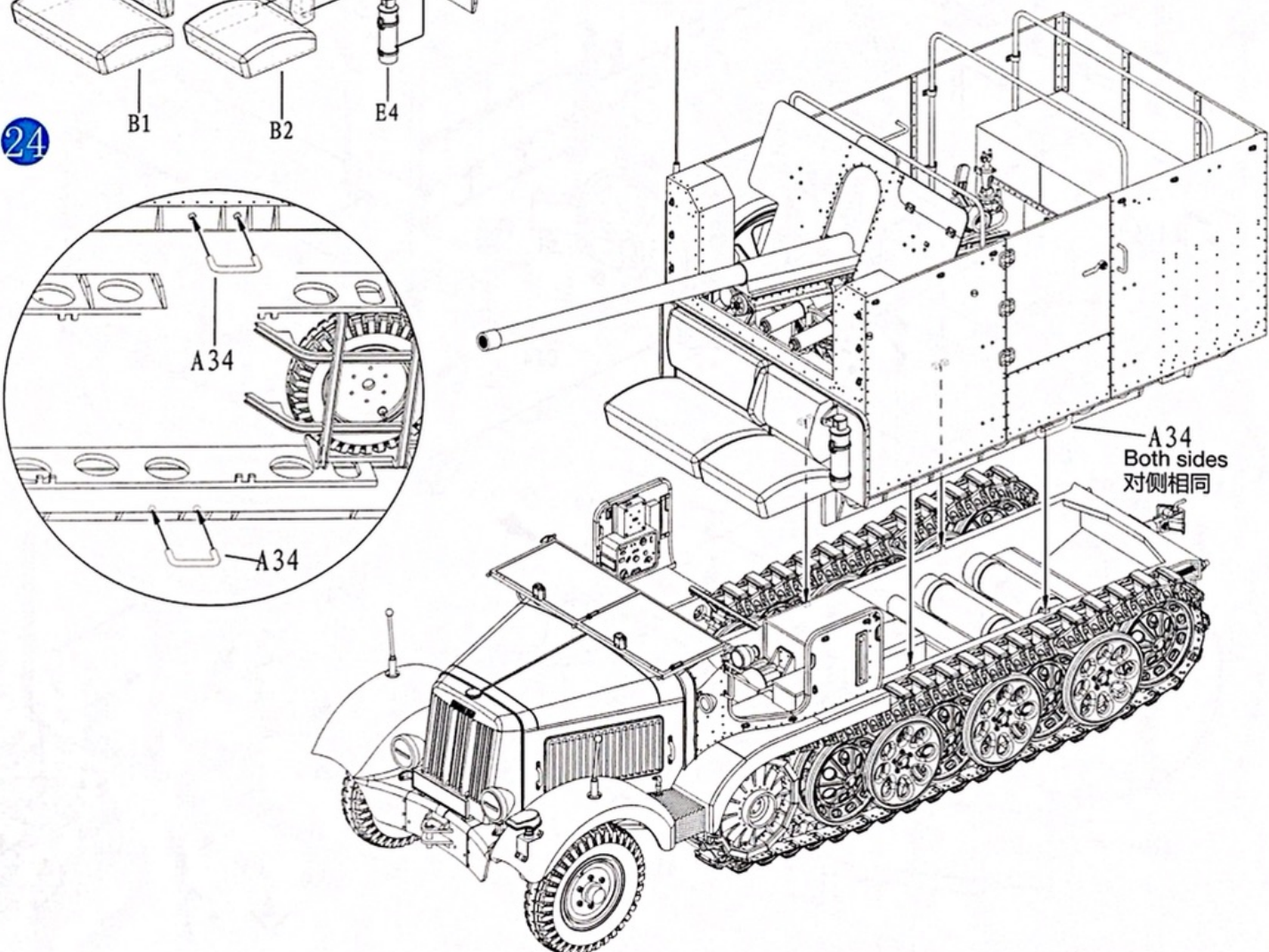

# DECAL & COLOUR GUIDE 水贴及涂色指示:

Option 1:  
 5t 'Diana' No.8 SP AT Gun, 605<sup>th</sup> PanzerJäger Abteilung, Libya, N. Africa, Spring, 1942.  
 1942年初, 在北非利比亚作战之605战车驱逐大队之属下8号车。

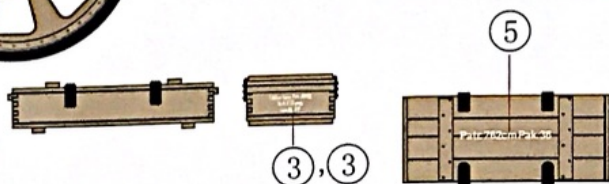
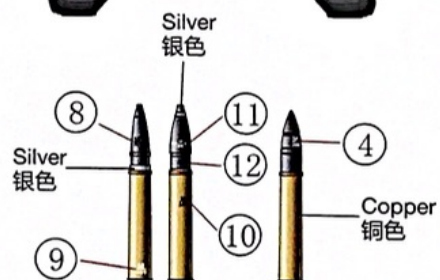
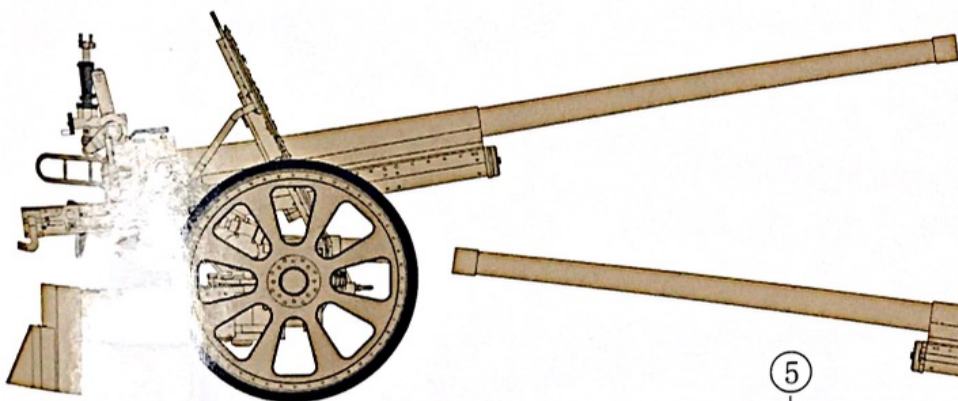
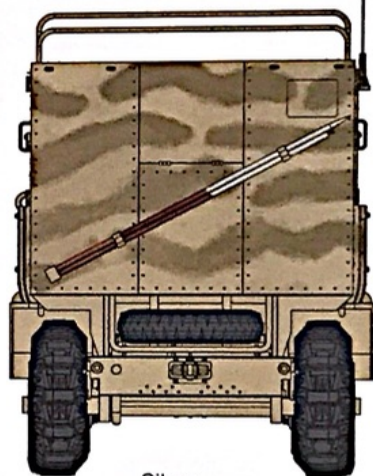
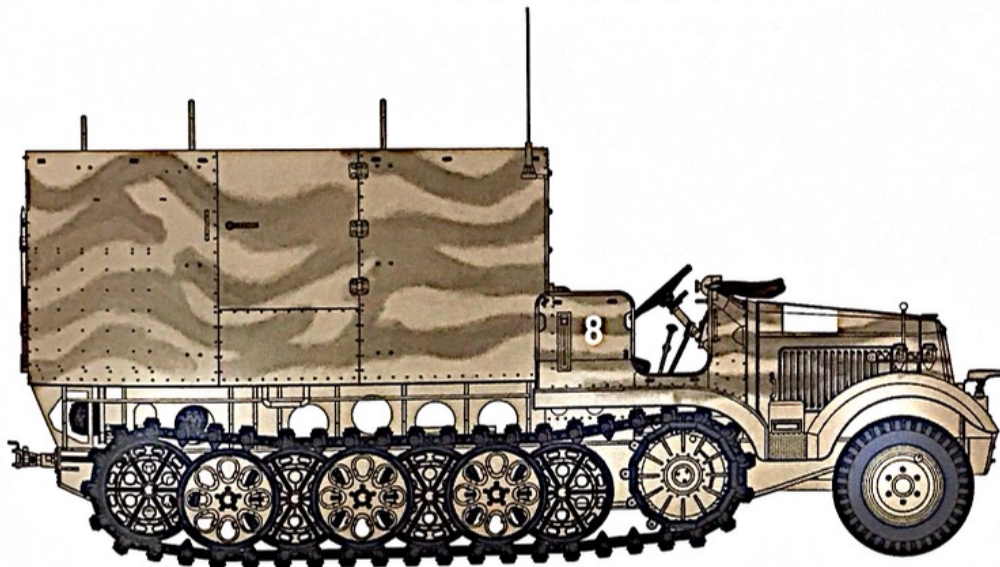
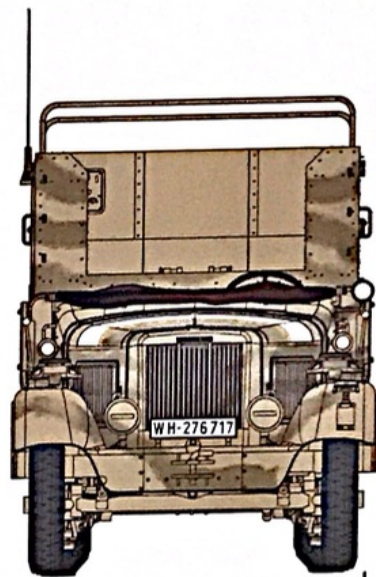
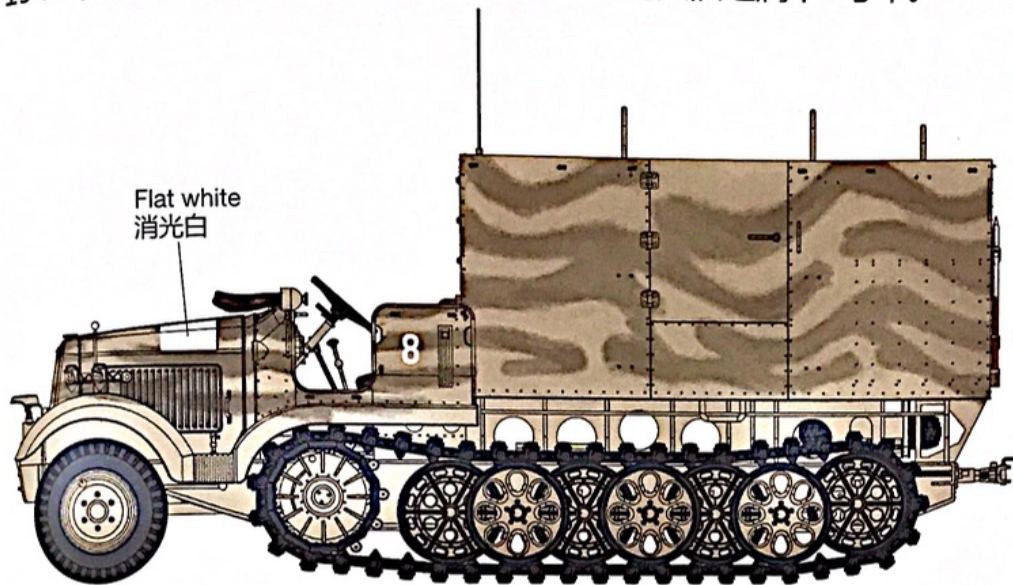

Camouflage Scheme : Overall Dark Yellow / Red Brown  
 迷彩颜色 : 整车涂暗黄色/红棕色

# DECAL & COLOUR GUIDE 水贴及涂色指示:

Option 2:

5t 'Diana' No.7 SP AT Gun, 605<sup>th</sup> PanzerJäger Abteilung, Libya, N. Africa, Spring, 1942.  
 1942年初，在北非利比亚作战之605战车驱逐大队之属下7号车。

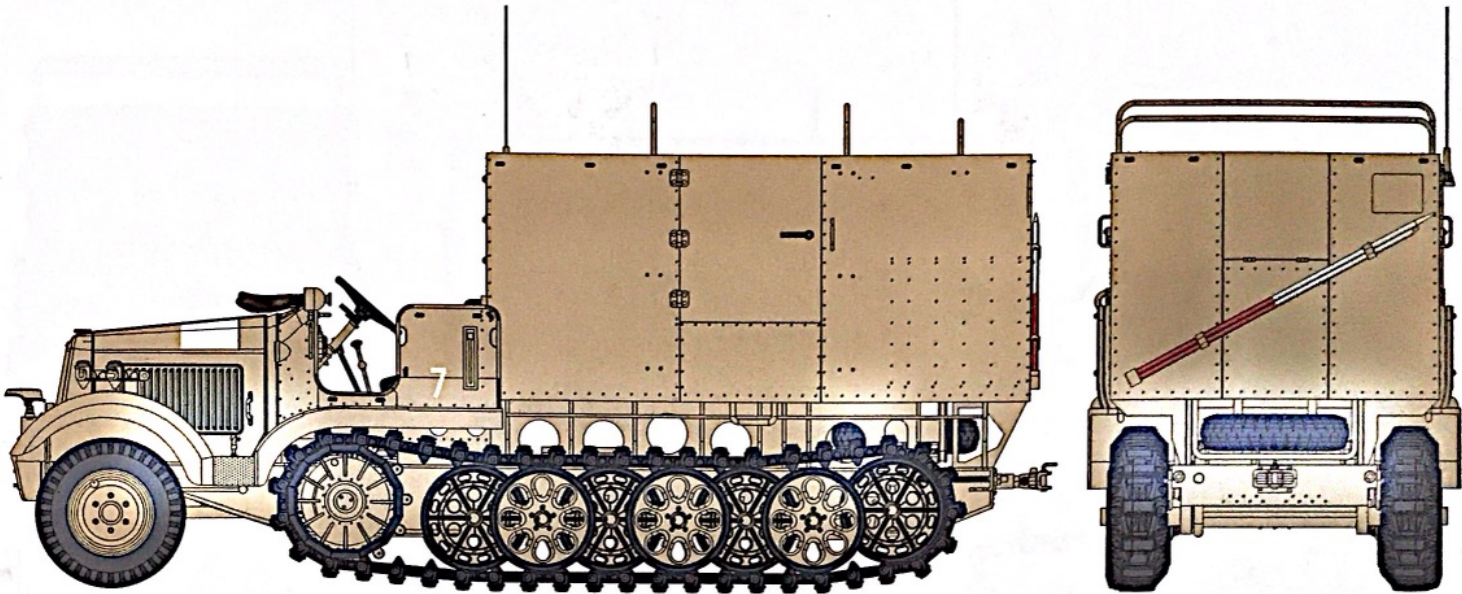

★ This marking just appeared on this car after captured by British / Commonwealth force.  
 此标志仅出现在此车遭英联邦军虏获后.

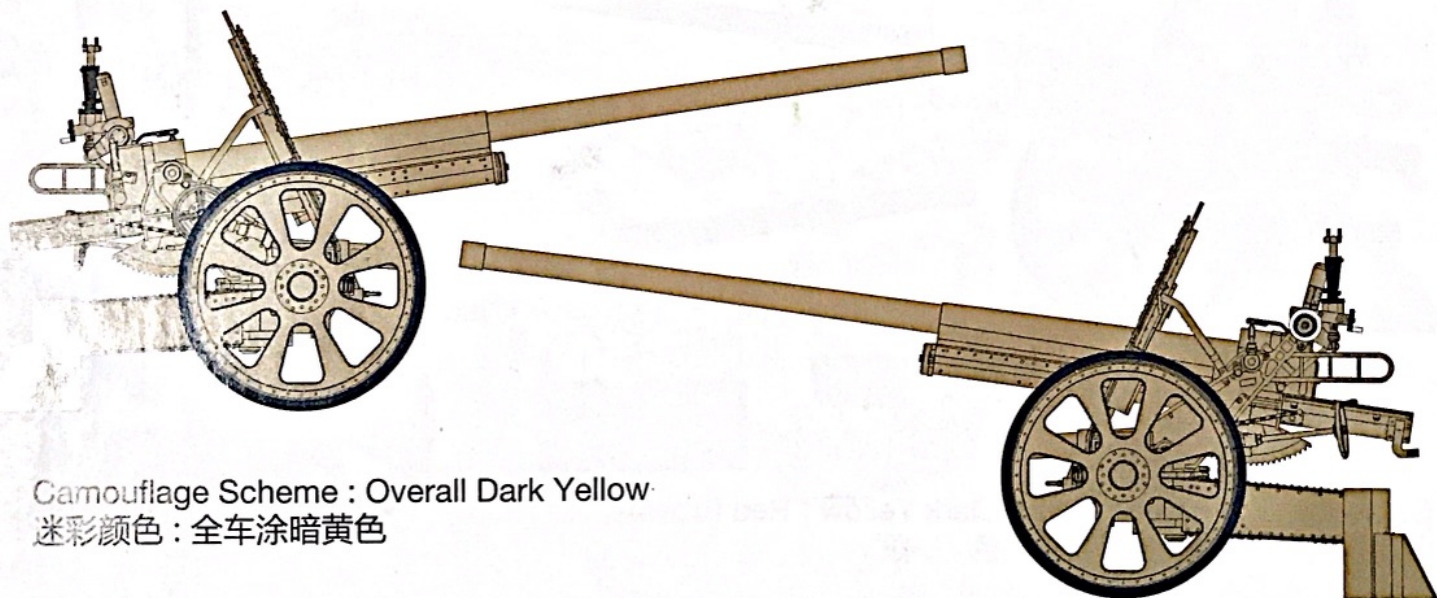
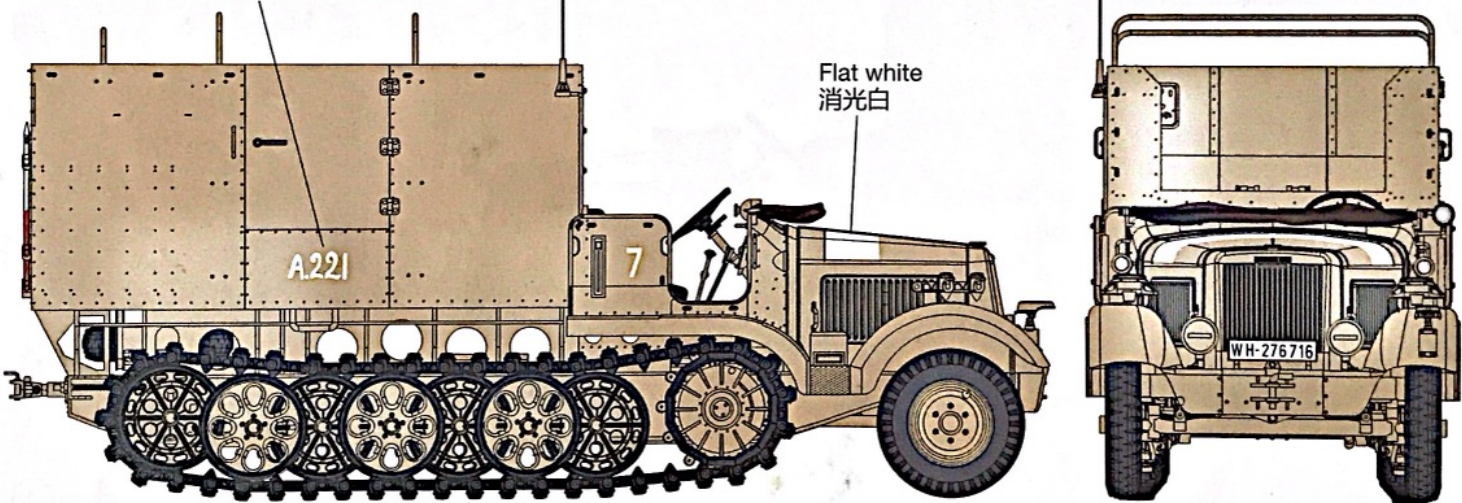

Camouflage Scheme : Overall Dark Yellow  
 迷彩颜色：全车涂暗黄色