

# Pz.Kpfw.IV Ausf. H KRUPP-GRUSONWERK MID PROD. AUG-SEP 1943

35330



## GENERAL INSTRUCTION

- ❑ HIGHLY DETAILED MODEL
- ❑ DRIVER COMPARTMENT INTERIOR ACCURATELY REPRESENTED
- ❑ FULLY DETAILED FIGHTING COMPARTMENT INTERIOR
- ❑ HIGHLY DETAILED INTERIOR OF TURRET
- ❑ ALL HATCHES CAN BE POSED OPEN & CLOSED
- ❑ FULL AMMUNITION INCLUDED
- ❑ ENGINE INCLUDED
- ❑ WORKABLE TRACKS INCLUDED
- ❑ CLEAR PLASTIC PARTS INCLUDED
- ❑ PHOTO-ETCHED PARTS INCLUDED
- ❑ DECAL SHEET FOR 4 OPTIONS

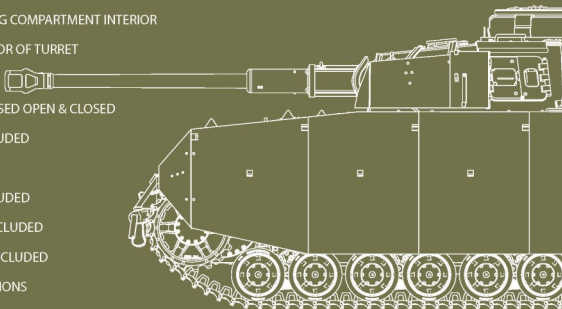

# Pz.Kpfw.IV Ausf. H KRUPP-GRUSONWERK MID PROD. AUG-SEP 1943



SCALE  
**1:35**

PAINTING GUIDE **1** Undefined Unit. Eastern Front. Autumn 1943

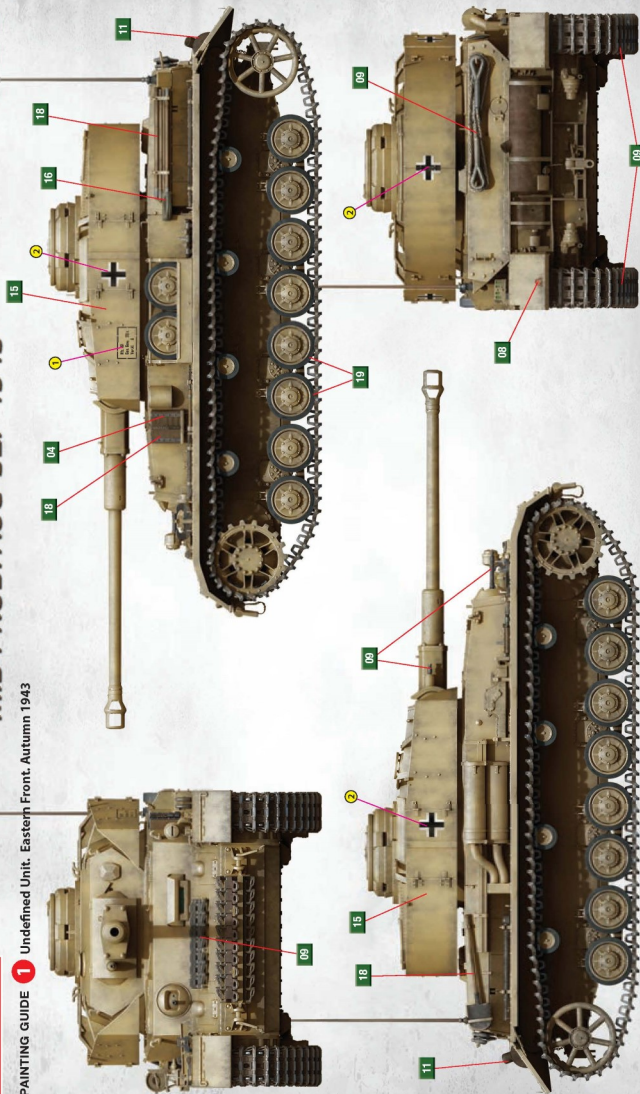

# Pz.Kpfw.IV Ausf. H Krupp-Grusonwerk MID PROD. AUG-SEP 1943

SCALE  
**1:35**



PAINTING GUIDE **2** 21. Pz.Rgt. 20. Panzer-Division, Eastern Front. Autumn 1943

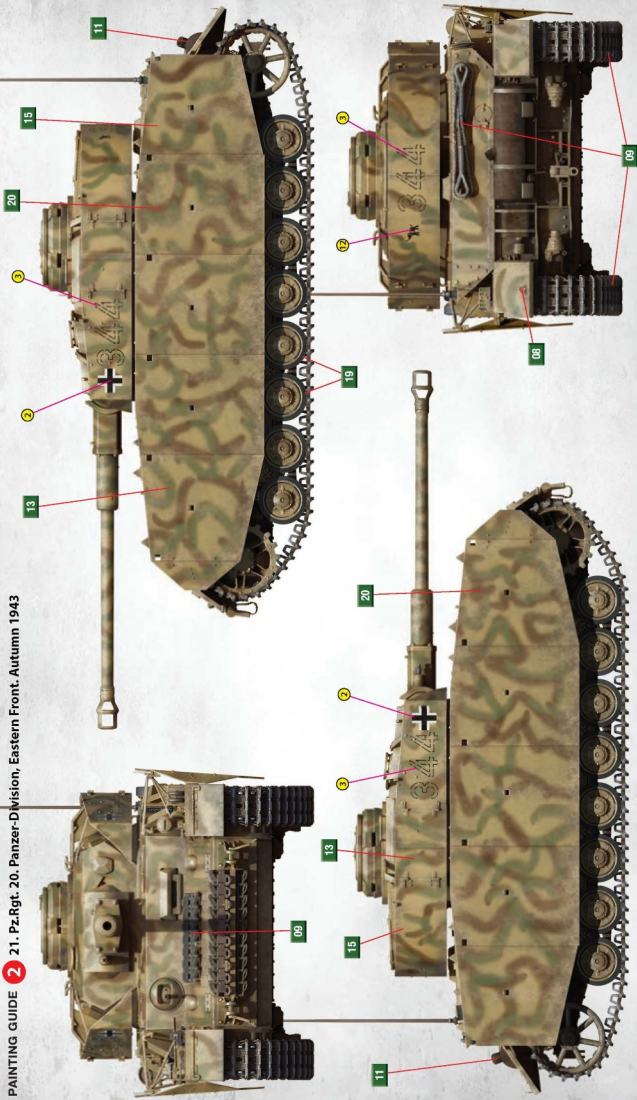

**ATTENTION**  
Ne pas utiliser de colle ou de peinture a proximite d'une flamme nue, et a derriere la piece de temps en temps.  
Pour retirer les pieces hors du cadran, utiliser des ciseaux speciaux pour marquer le plastique en enche avec un cutter ou un rasoir.  
Vor die feinde dieser kolonne pour la signification des symboles.  
Après l'assemblage peut rester des pieces inutilisées.

**ZUR BEACHTUNG!**  
Kleber und Farbe nicht nahe von offenem Feuer verwenden und das Fenster von Zeit zu Zeit zur Belüftung öffnen.  
Zum Abschneiden der Teile vom Werkstück eine Modellerschere verwenden und die überstehenden Plastikteile mit einem Messer oder einer Feile beseitigen.  
Die Bedeutung der Symbole finden Sie unten in dieser Spalte.  
Nach dem Zusammenbau des Modells, können einzelne Teile übrig bleiben.

**УВАГА**  
При використанні клею та фарб всі роботи проводити подаль від джерел вогню у приміщенні, що добре провітрюється.  
Деталі відокремлювати від лінійки ножем або іншим ручним інструментом. Зачистити обріви інше з'яву за допомогою наждака та надчиного паперу. Букування металу виконувати з'ярою і санкою. Для зручності побудови кожна деталь позначена номером.  
Після складання можуть залишитися використані деталі.

**ATTENZIONE**  
Non usare colla e vernice vicino a fiamme esposte. e aprire le finestre di tanto in tanto per cambiare l'aria. Quando si staccano parti del cassetto, usare forbici da modellismo e eliminare la plastica in eccesso con un coltello o una lima. Vedere in fondo a questa colonna per il signifi. Dopo l'assemblaggio possono rimanere parti inutilizzate.

**ВНИМАНИЕ**  
При использовании клея и красок все работы производить в проветриваемом помещении вдали от источников огня.  
Детали отделять от линейки ножом или другим режущим инструментом. Зачистить обривы и места среза при помощи наждака и наждачной бумаги. Буфование металла выполнять з'ярою и санкою. Сборку моделей производить согласно схеме сборки.  
Для удобства сборки каждая деталь обозначена номером.  
После сборки набора могут остаться неиспользованные детали.

**CAUTION**  
When you use glue or paint, do not use near open flame, and use in well ventilated room. When you take parts off the runner frame, use modeling scissors or cutter.  
See the bottom of this column for the meaning of symbols.  
Extra details can remain after assembling of the kit.

## PARTS

### Ai x4

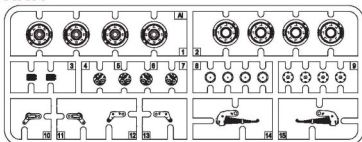

### COLOR CHART

Nº	Color	Vallajo	Mr. Color	AK RC	Mission Models	AMMO MIG	Tamiya	Color name
01	71.119	C-322	RC-003	MMP-082	A.MIG-0017	XF-02	Cremecross	
02	71.271	C-041	RC-067	MMP-015	A.MIG-0014	XF-64	German Rotbraun	
03	71.057	C-033	RC-001	MMP-047	A.MIG-0046	XF-01	Black	
04	71.072	C-028	AK-476	MMM-002	A.MIG-0191	XF-56	Steel	
05	71.056	C-040	RC-057	MMP-014	A.MIG-0008	XF-63	Dunkelgelb	
06	71.067	C-219	AK-460	MMM-009	A.MIG-0197	XF-12	Brass	
07	71.062	C-090	RC-020	MMM-008	A.MIG-0194	XF-16	Aluminium	
08	71.003	C-003	RC-006	MMP-003	A.MIG-0049	XF-07	Red	
09	71.073	C-078	RC-015	MMM-001	A.MIG-0045	XF-04	Gun Metal	
10	71.041	C-310	RC-035	MMP-033	A.MIG-0076	XF-10	Brown	
11	71.069	C-131	AK-709	MMP-001	A.MIG-0041	XF-10	Rust	
12	71.089	C-005	RC-036	MMP-065	A.MIG-0086	XF-17	Blue	
13	71.007	C-038	RC-023	MMP-025	A.MIG-0081	XF-42	Olive Green	
14	71.276	C-060	RC-299	MMP-072	A.MIG-0075	XF-55	Light Grey	
15	71.025	C-039	RC-062	MMP-011	A.MIG-0010	XF-60	Dunkelgelb	
16	71.016	C-012	RC-024	MMP-020	A.MIG-0071	XF-49	Khaki	
17	71.001	C-062	RC-004	MMP-001	A.MIG-0050	XF-02	White	
18	70.976	C-043	RC-030	MMP-076	A.MIG-0037	XF-79	Wood	
19	71.251	C-137	RC-022	MMP-040	A.MIG-0033	XF-85	Tire Black	
20	71.041	C-147	RC-068	MMP-012	A.MIG-0015	XF-10	Schokbraun	

### Decal

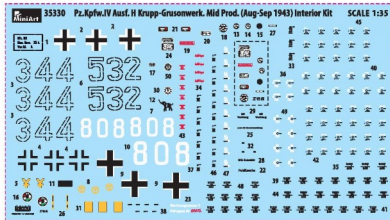

### Cd

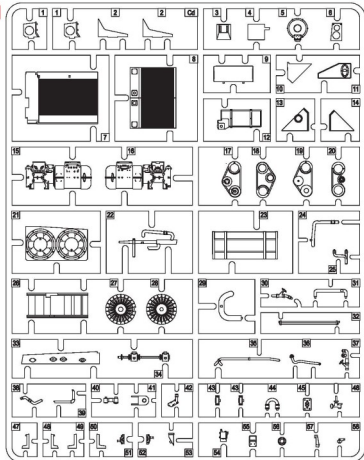

### Ke

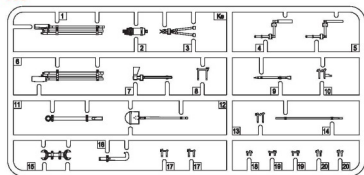

### PEb parts

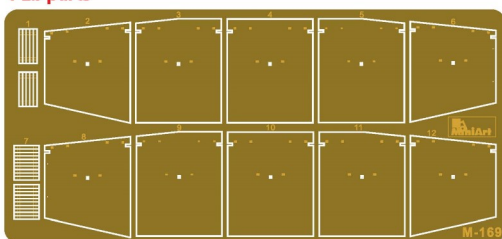

### PEa parts

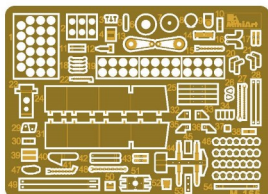



MAKÉ DVA  
2 TEILE FERTIGEN  
EFFICACE 2 PIÈCES  
FARE DUE PEZZI  
TWO PC  
DOR 2 BT  
ПОДГОТОВЬ ДВА ЧАСТА  
КЫЛЫСТЬ ДВАВ



DO NOT CEMENT  
NICHT KLEBEN  
NE PAS COLLER  
NON INCOLLARE  
ELEMMA  
LIMMAJU  
НЕ НОСЧОЛОВАТЬ КЛЕЯ  
НЕ КЛЕЙТИ



OPTIONAL  
NACH BELIEBEN  
FACILITATIVO  
FACILITATIVO  
VALIKOVALIKOVANEN  
VALIKAN  
BAYKAPITAY  
BAYKAPITI



OPEN HOLE  
ÖFFNEN  
FARE UN TROU  
FORO APERTO  
AKNA VEKA  
ÖPPNA HALET  
QESHITË DITREPËTE  
SPROBITI OTVER



REMOVE  
ENTFERNEN  
RETIEN  
SEPARARE  
ROSTI  
ALAGSNA  
OTKRYTË  
BYPYRATI



BEND  
BITS BIEGEN  
PLIER LES, VOUS PLIAT  
PIEGARE  
PLATA  
BOKKA  
BYKPYTË  
BYKPYTUM



SCRATCH-BUILD  
AM MISTEN ZU MACHEN  
FAIRE LE PLUS  
RENCHITË  
THE FINE  
DOR DIO SIALU  
QESHITË SHAKAPË  
SPROBITI SHAKOPY

## PARTS

### Ba x2

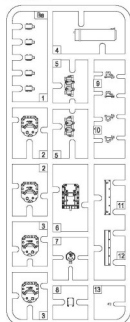

### Bf x2



### Bex x2

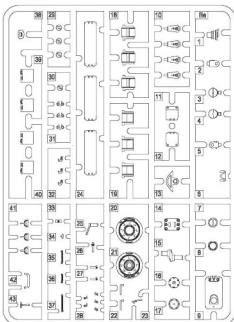

### Bc x2

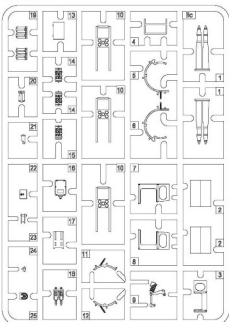

### Da

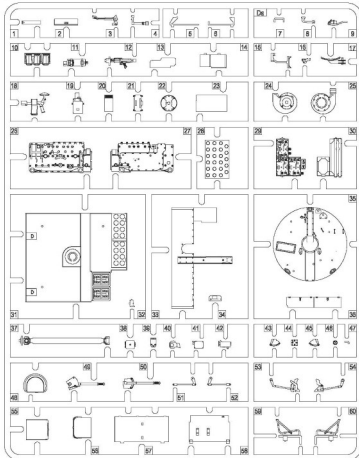

### Db

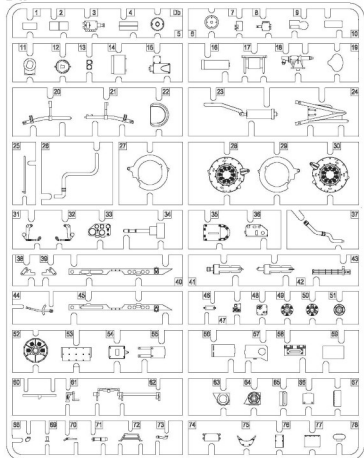

### La

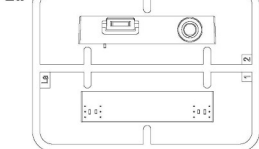

### Lg

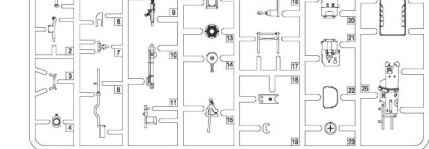

Fa

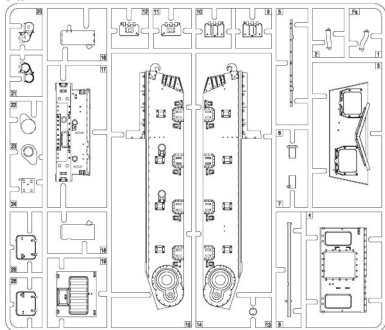

Fb

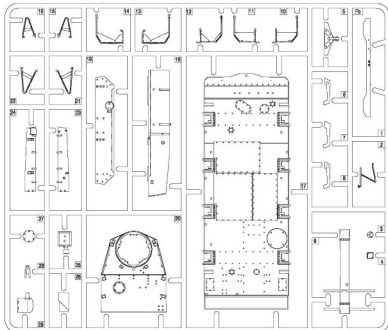

Ha

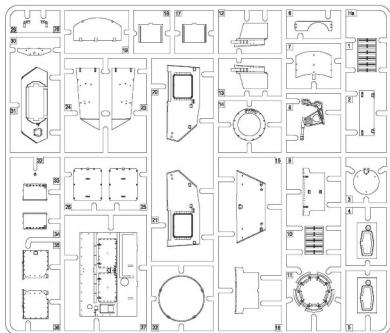

Hb

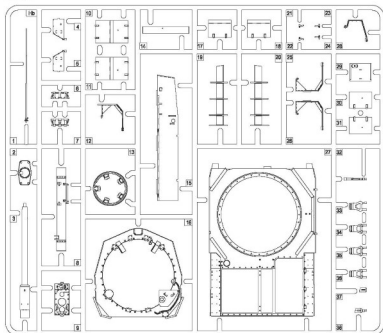

Ad x4

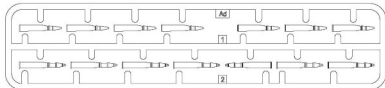

Ae x2

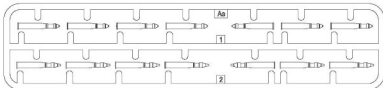

Je

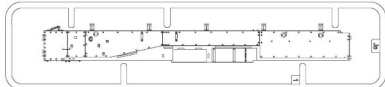

Kc (Clear parts)

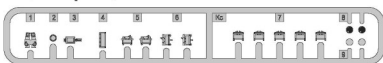

Ea

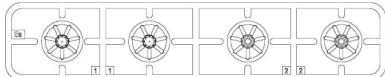

Jc

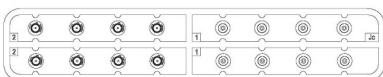

Ed

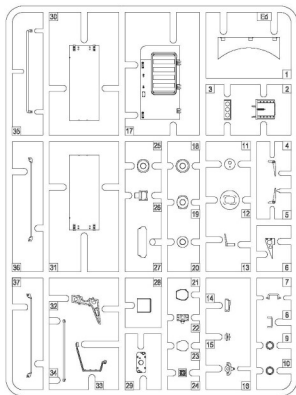

Jf

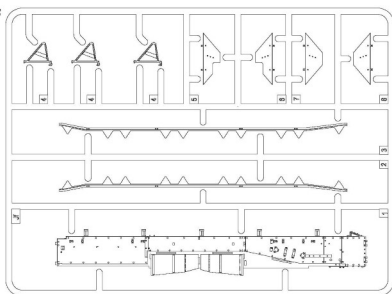

Ec

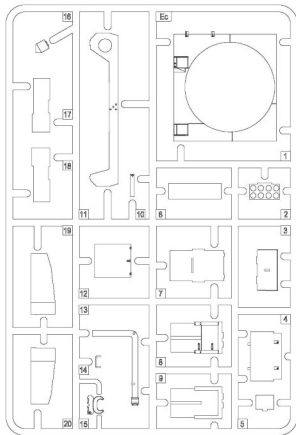

Ca

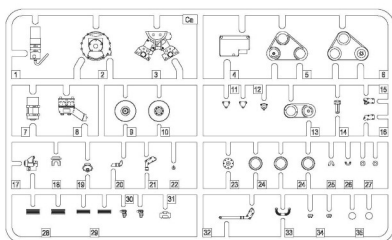

Cb

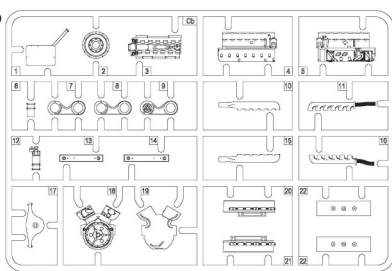

Jd

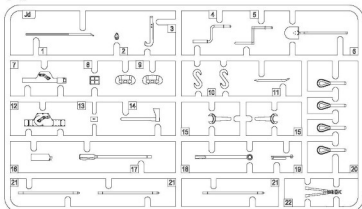

Tracks x22

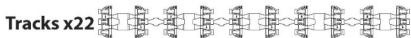

Af x4

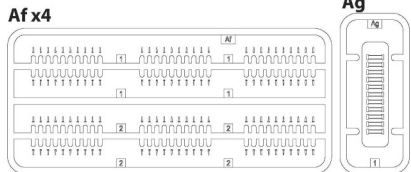

Ag

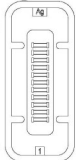

1

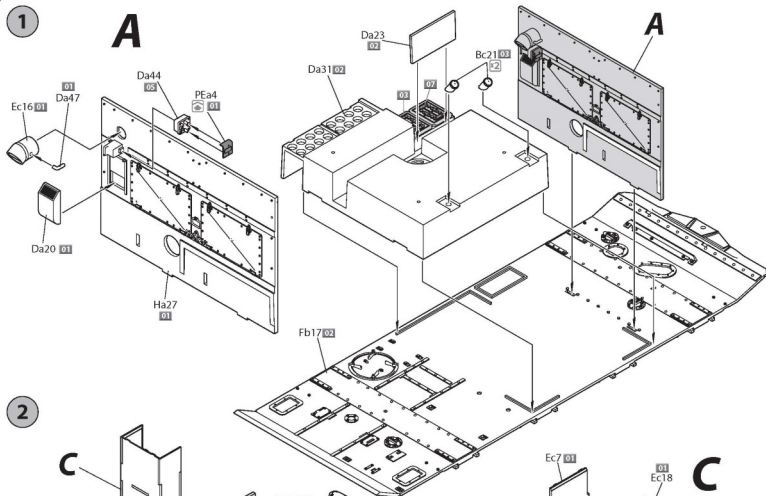

2

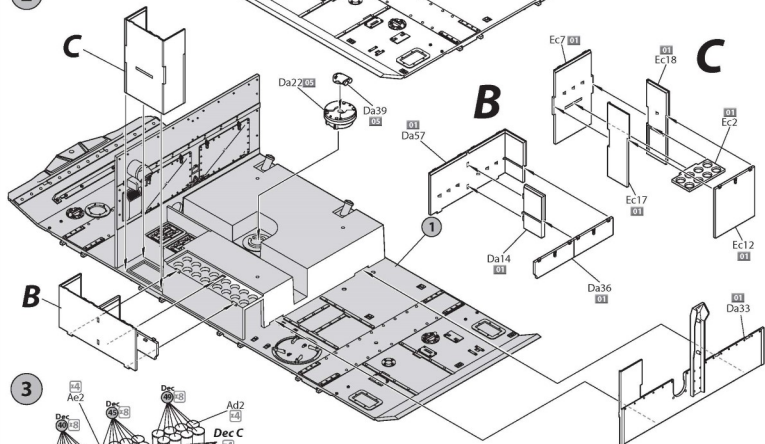

3

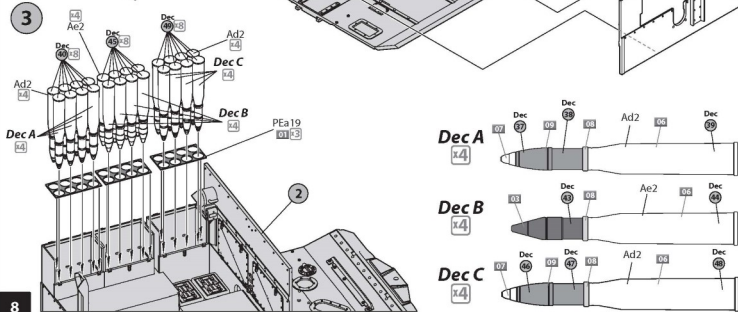



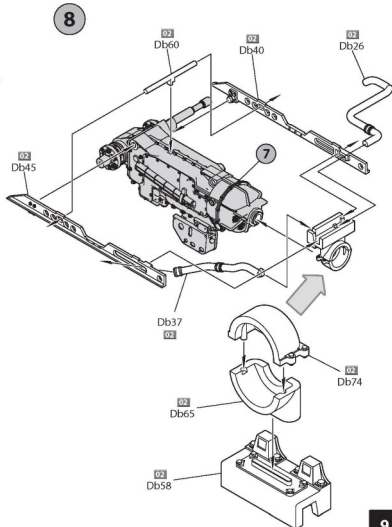
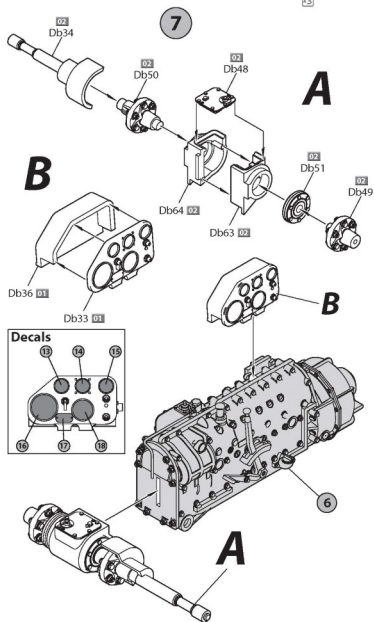
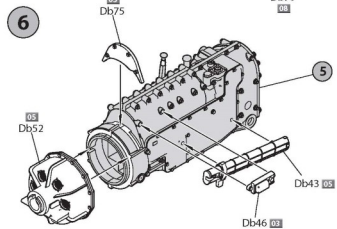
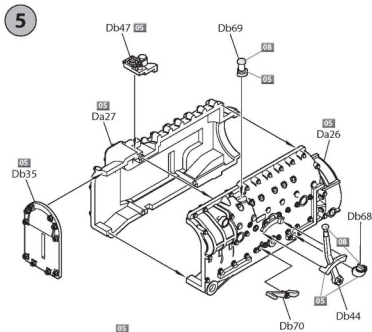
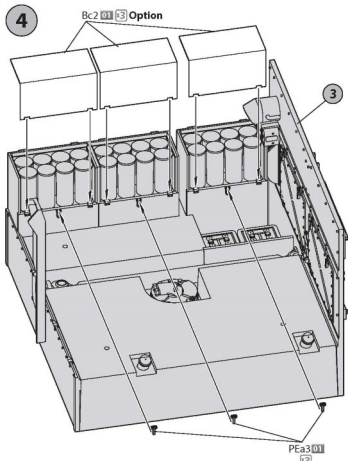

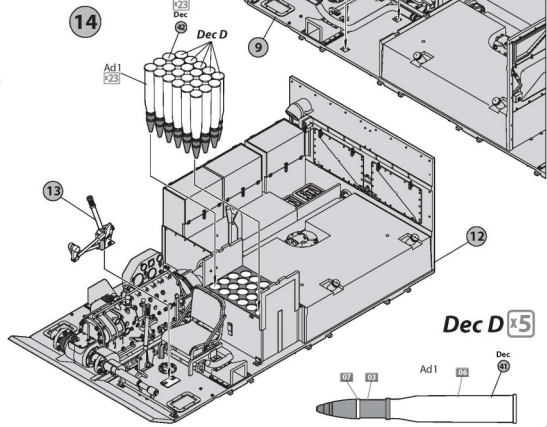
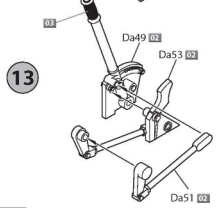
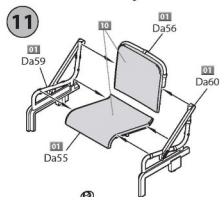
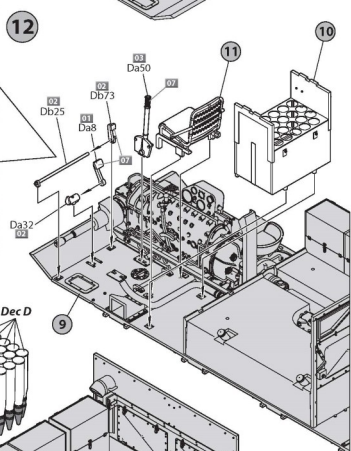
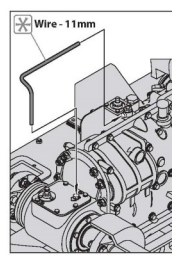
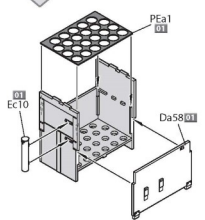
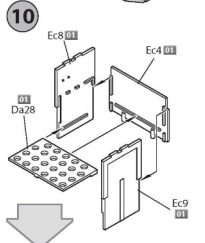
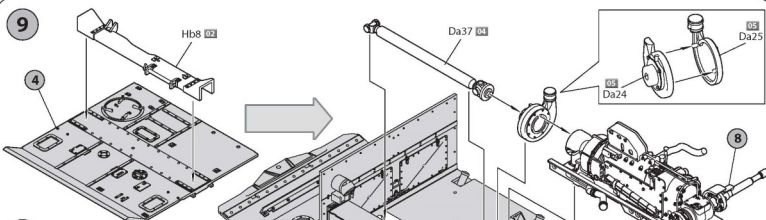

**Dec D x5**

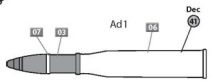

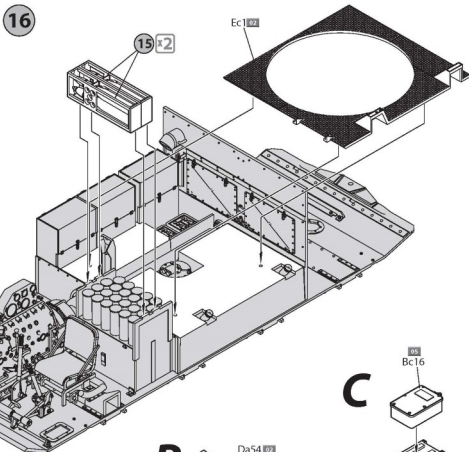
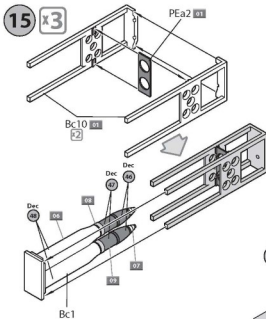

**15** Option See step 124

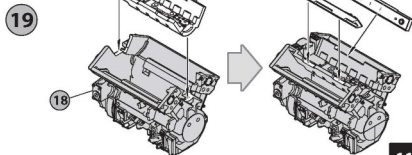
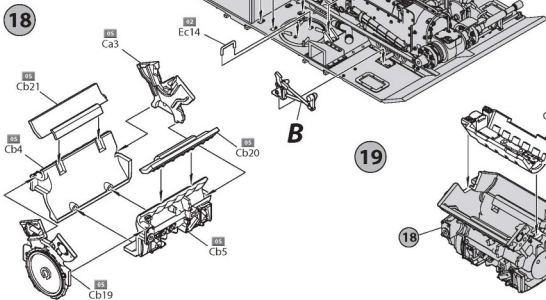
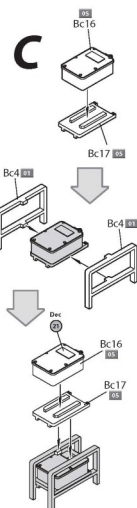
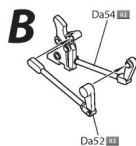
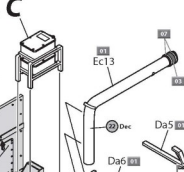

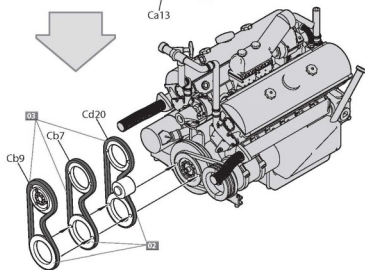
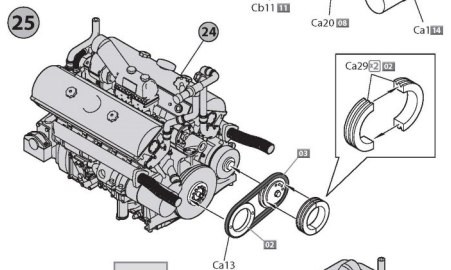
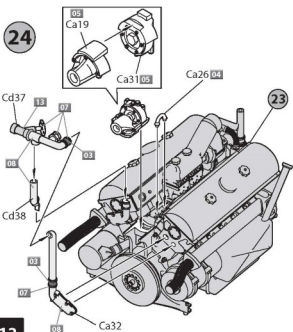
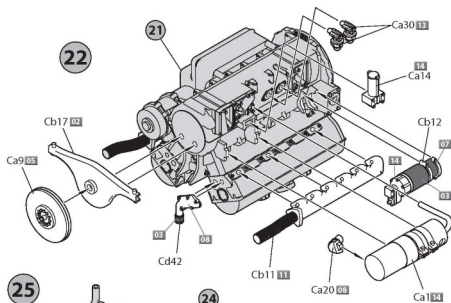
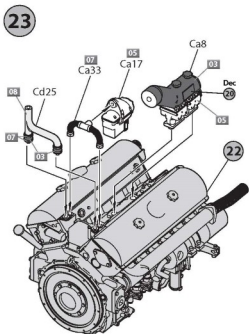
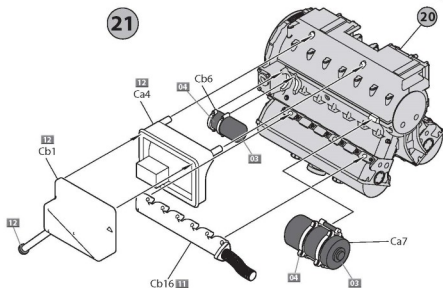
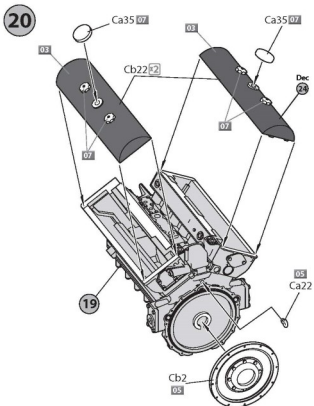

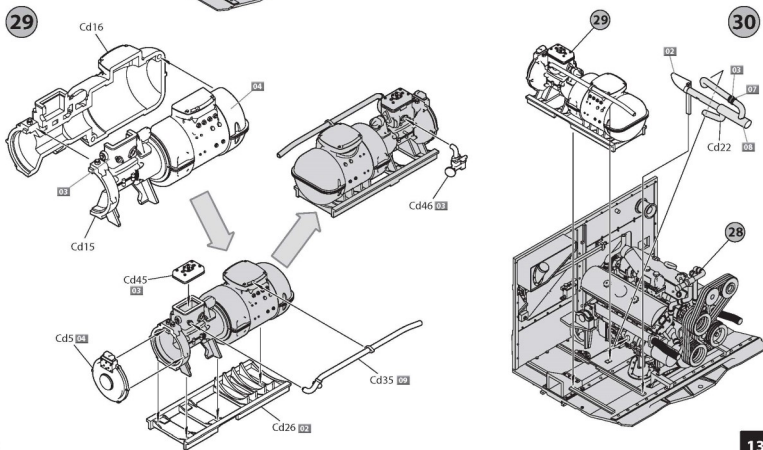
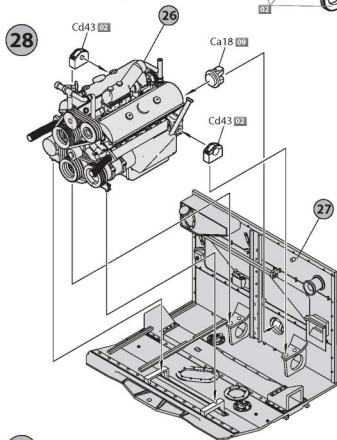
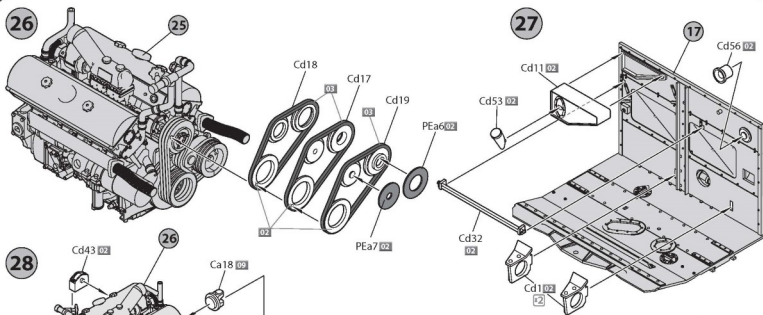

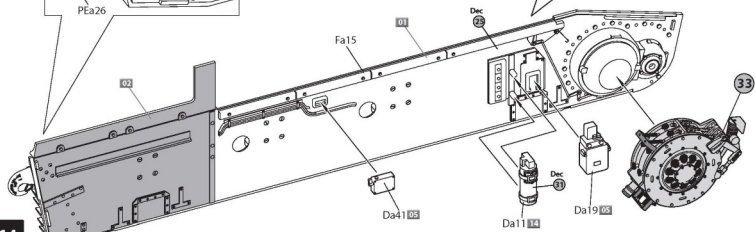
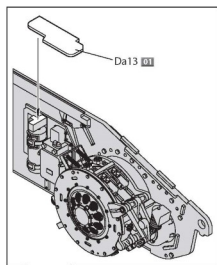
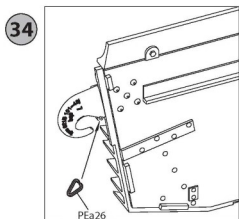
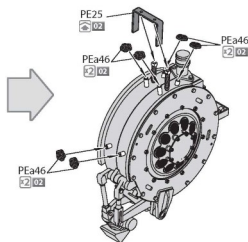
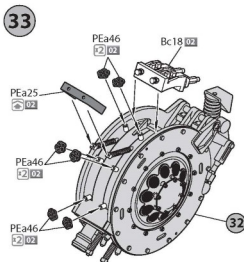
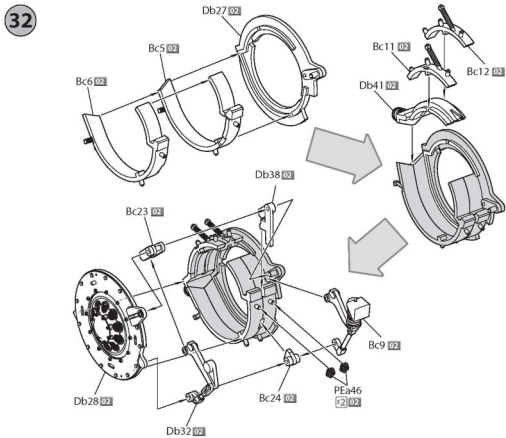
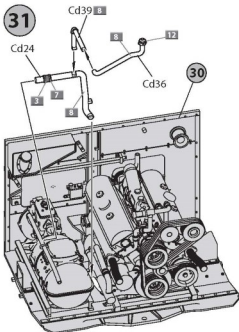

35

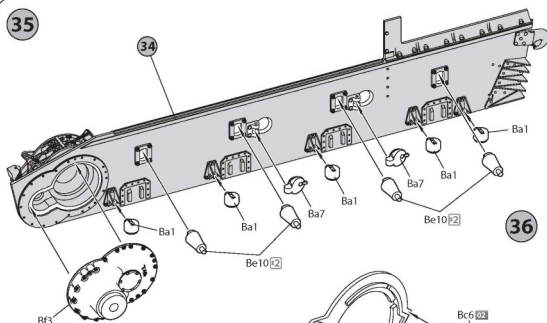

36

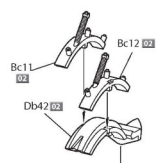

37

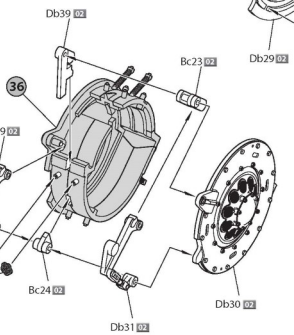
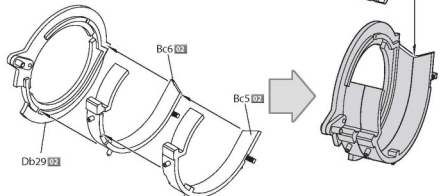

38

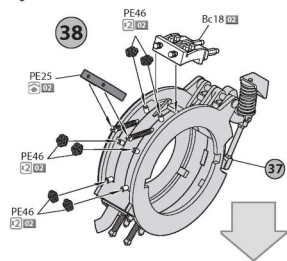

39

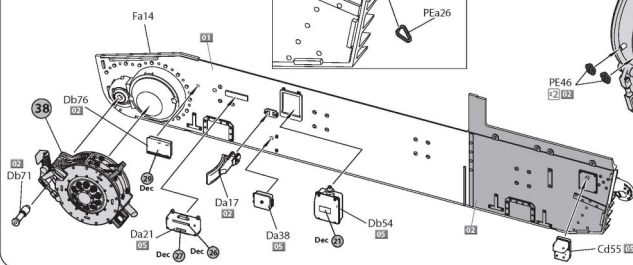
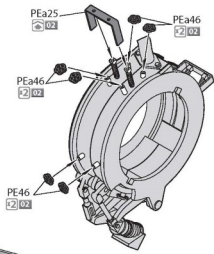
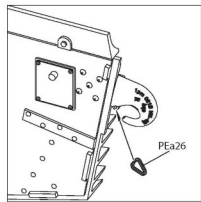

40

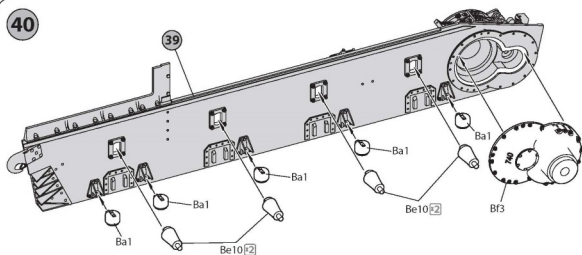

41

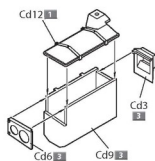

42

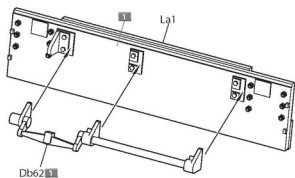

43

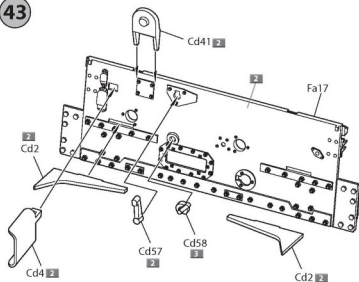

44

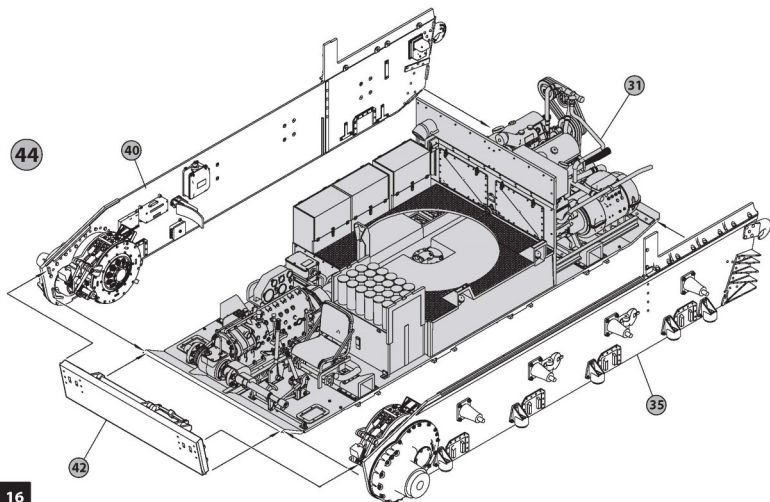



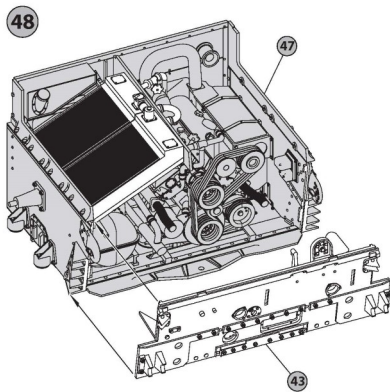
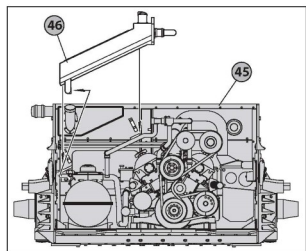
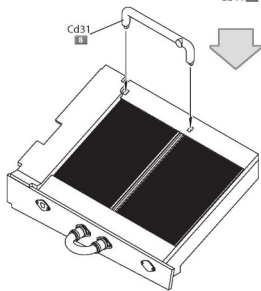
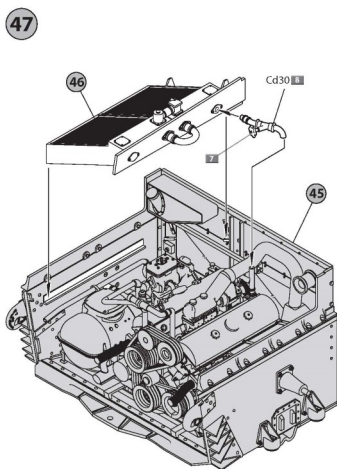
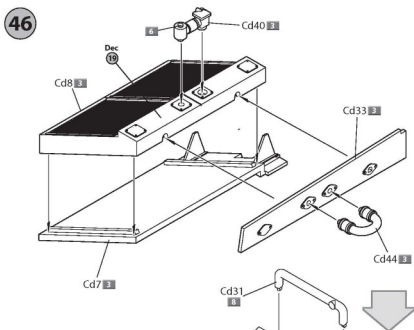
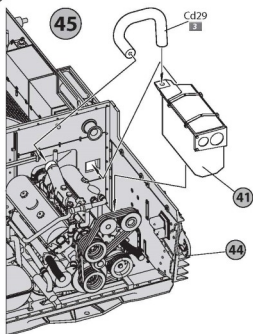

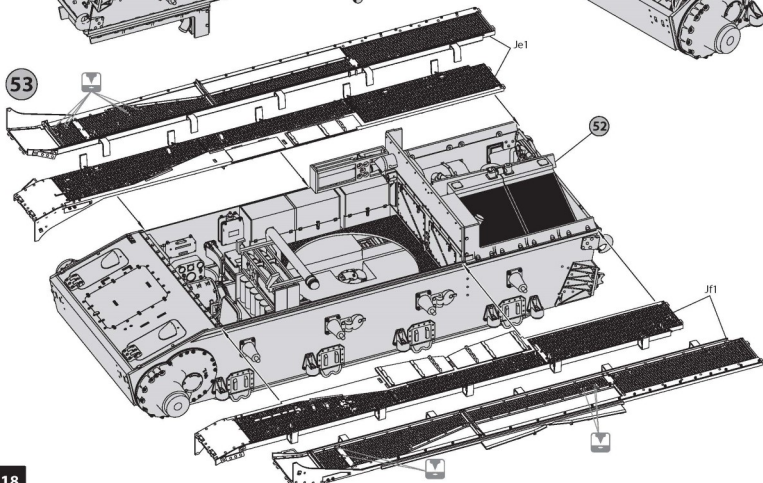
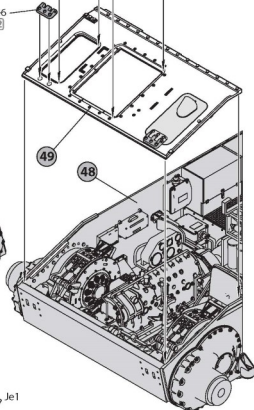
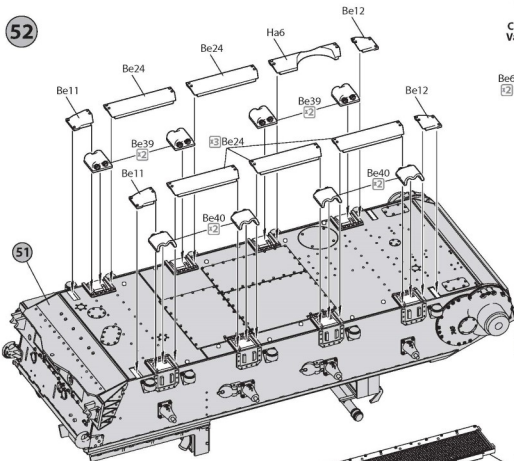
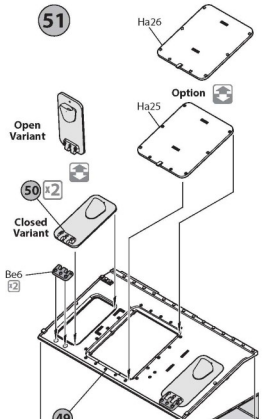
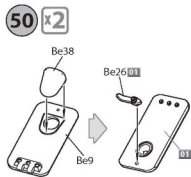
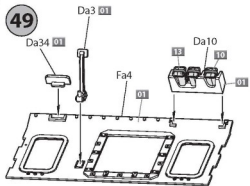

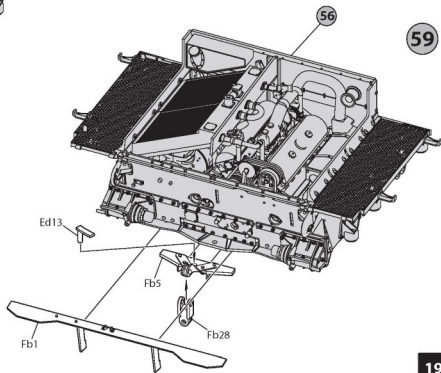
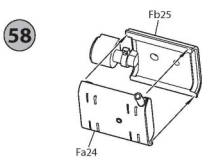
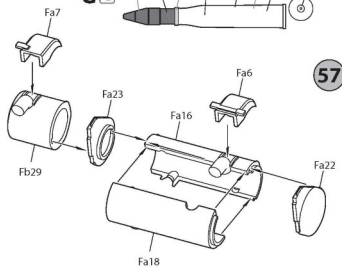
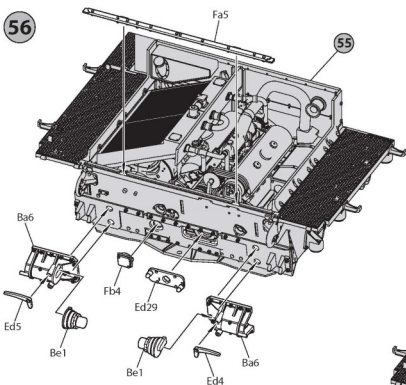
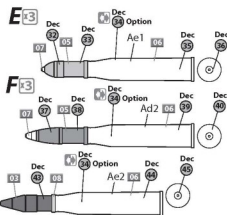
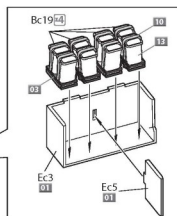
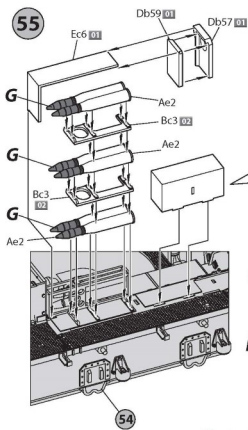
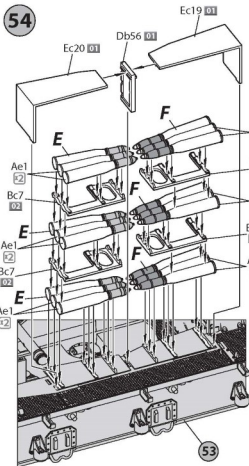

60

A

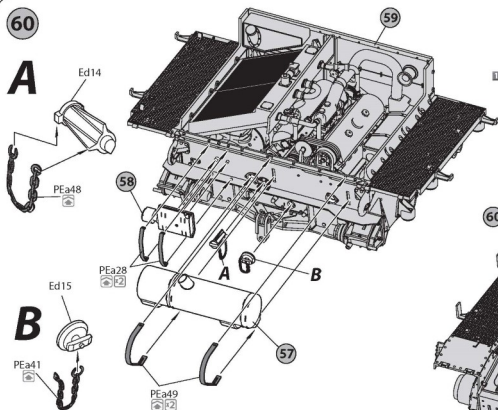

61

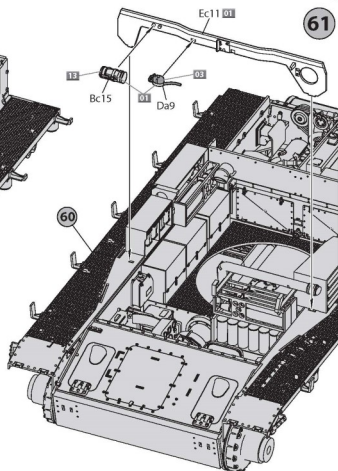

62

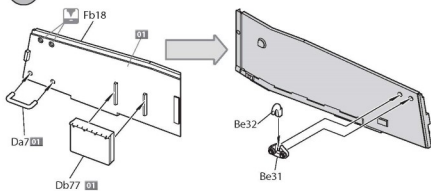

63

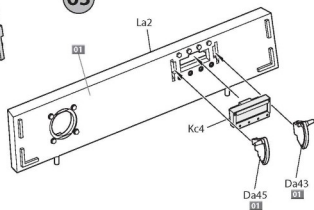

64

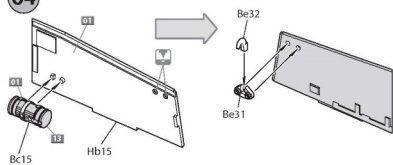

65

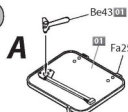

B

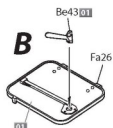

66

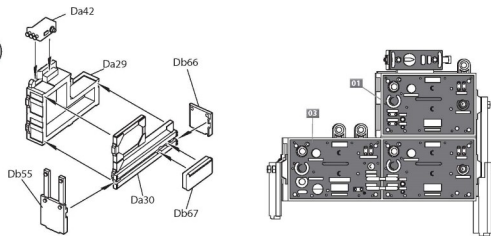

67

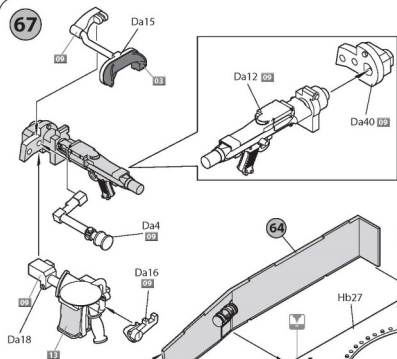

68

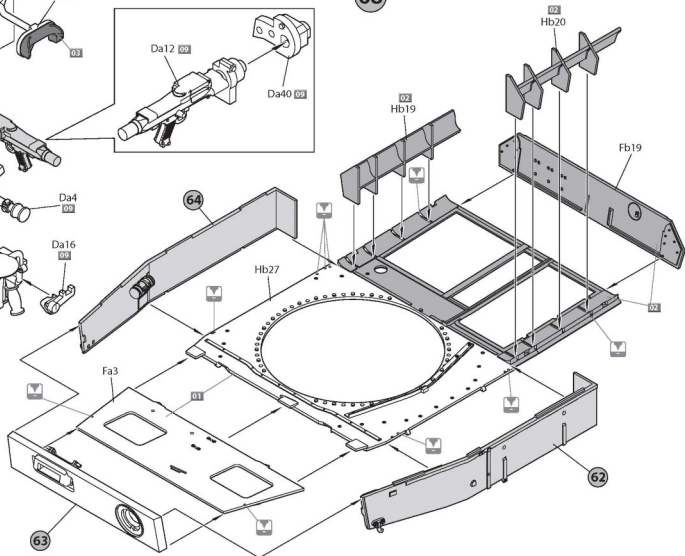

69

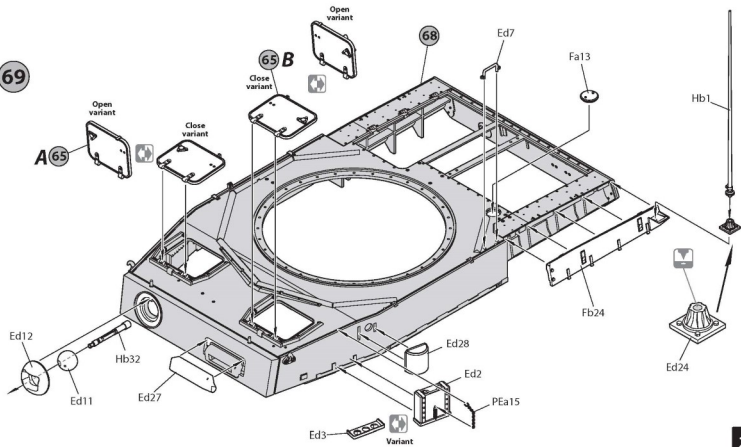

70

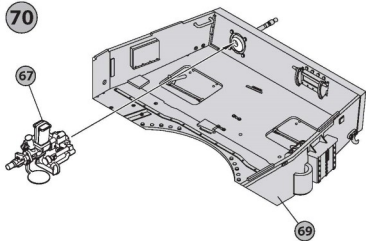

71

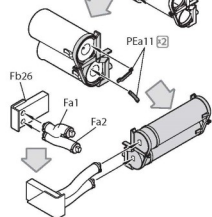
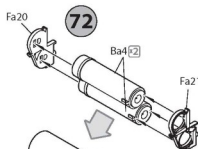
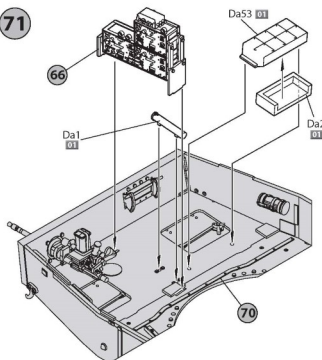

74

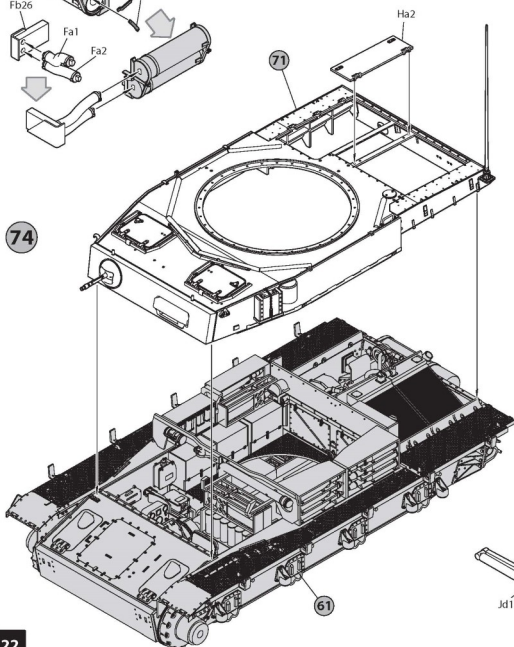

73 x2

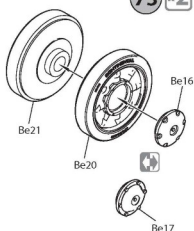

75

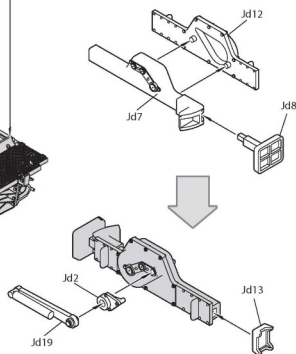

76

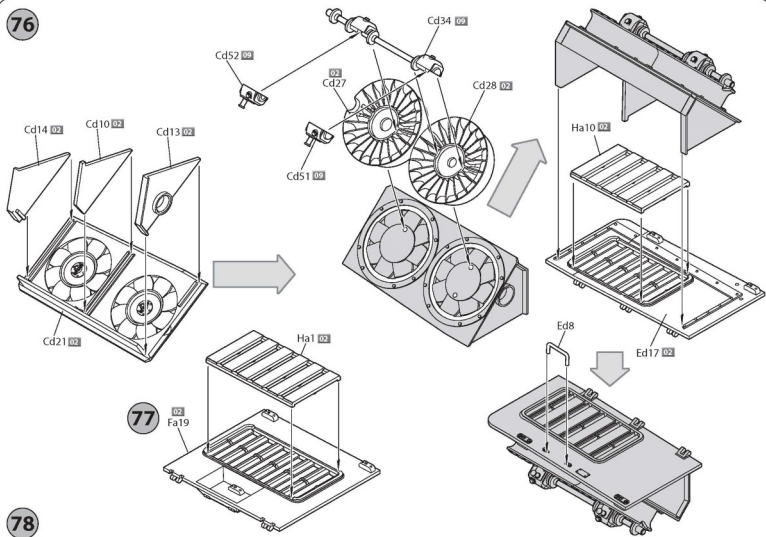

77

78

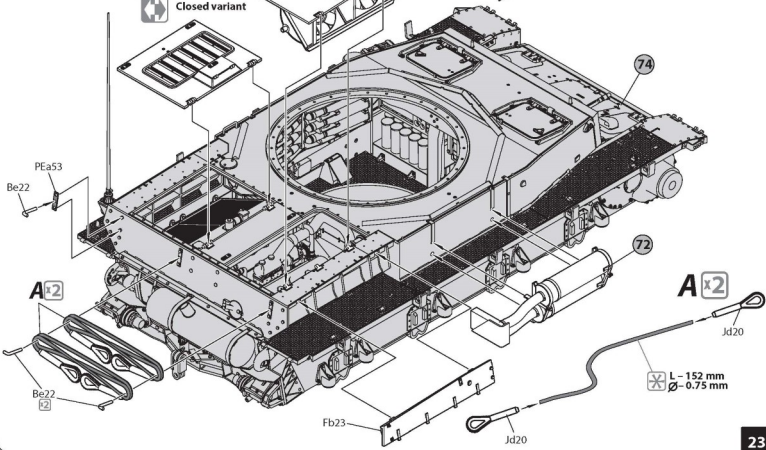
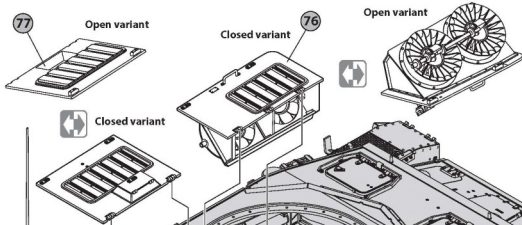

79

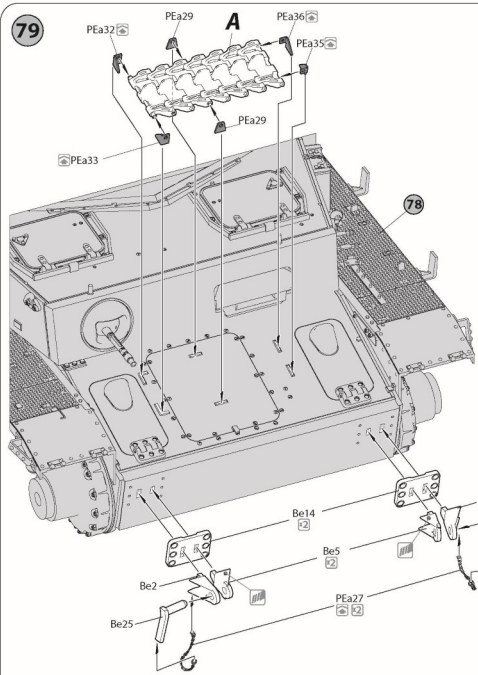

A

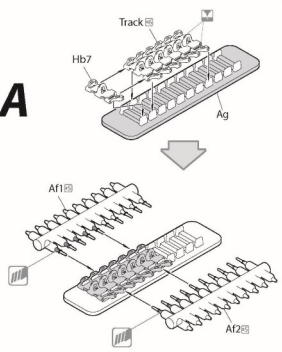

80

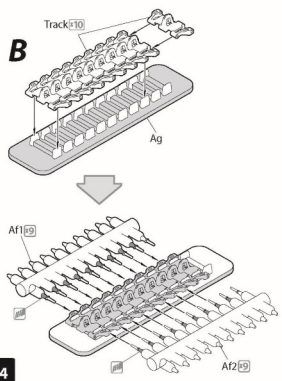

C

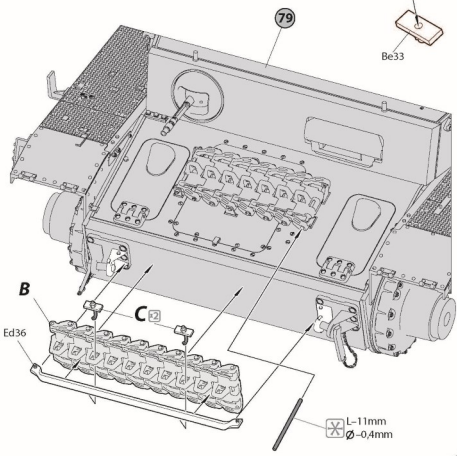
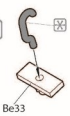

L-11mm  
Ø-0.4mm



81

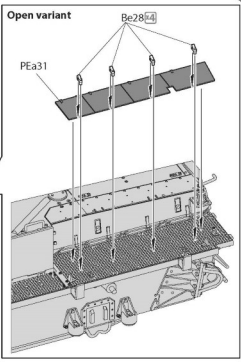
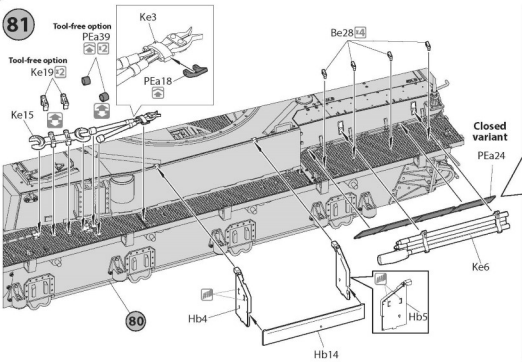

82

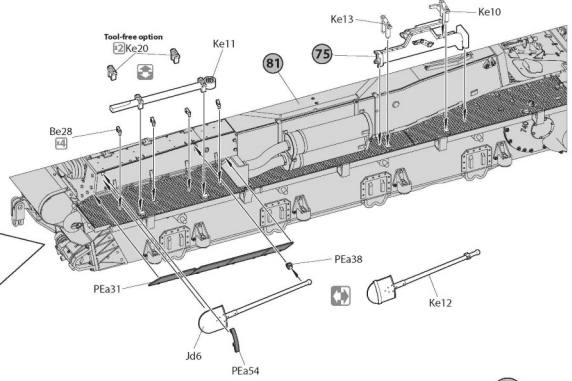
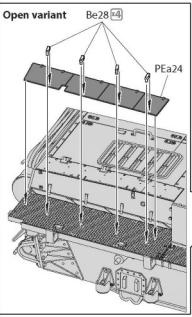

83

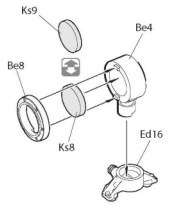
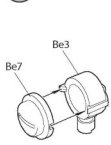

84

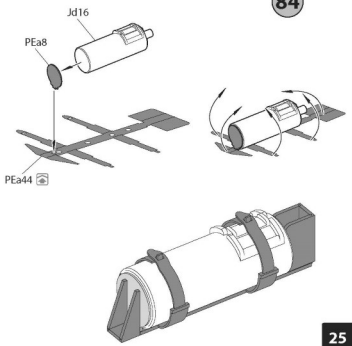

85

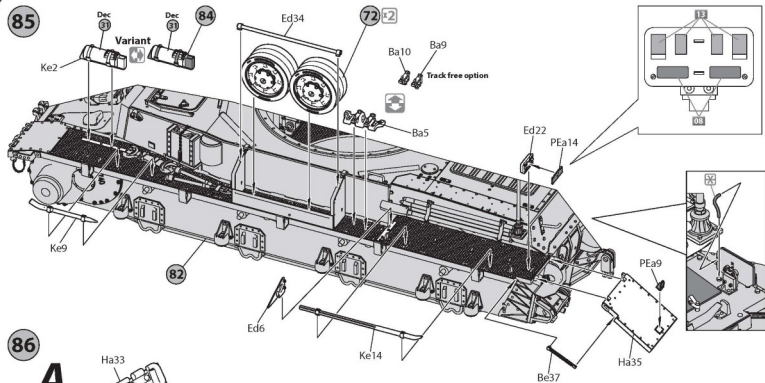

86

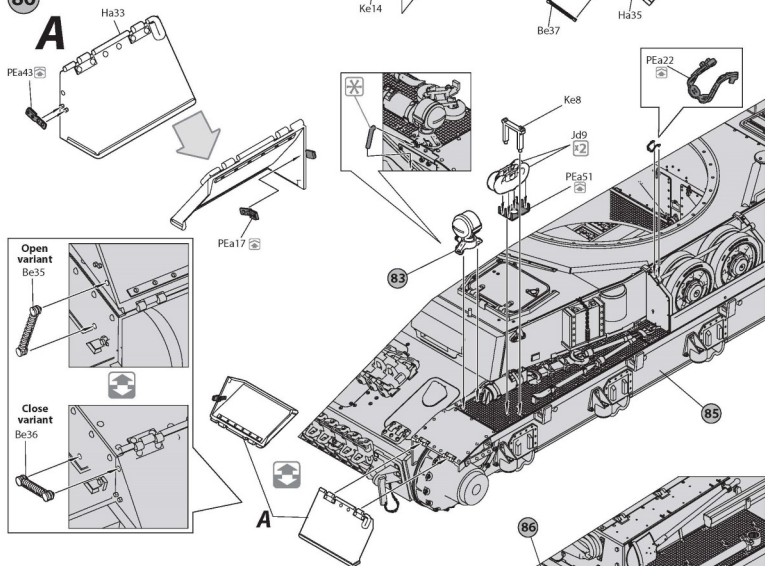

87 x16

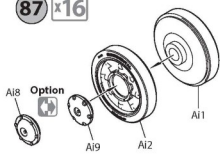

88

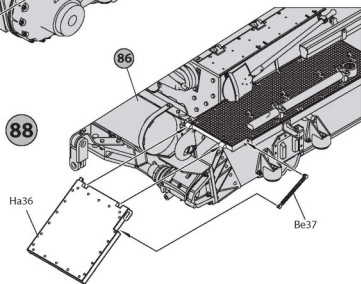

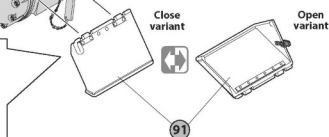
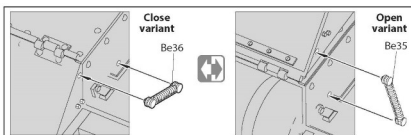
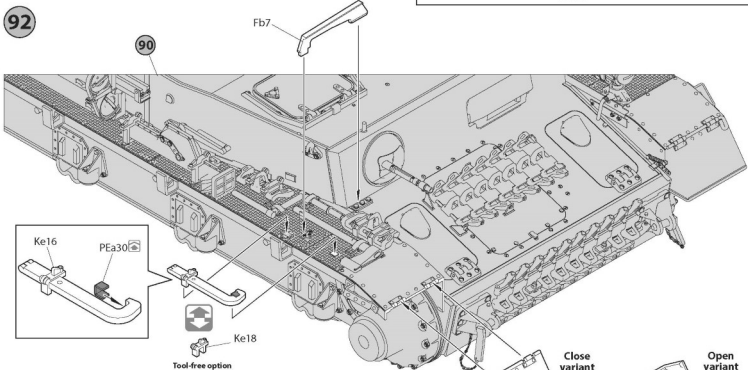
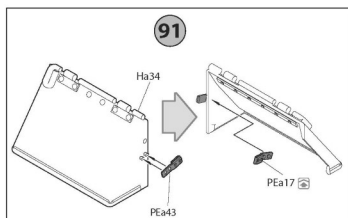
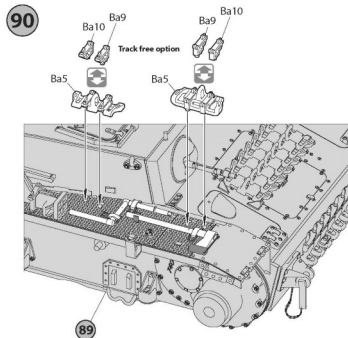
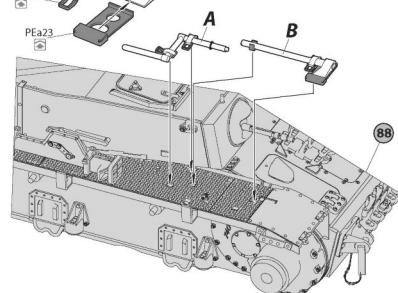
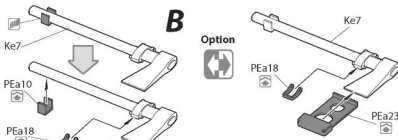
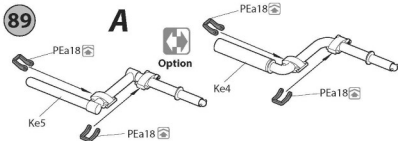

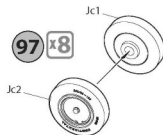
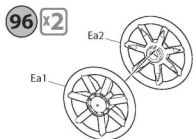
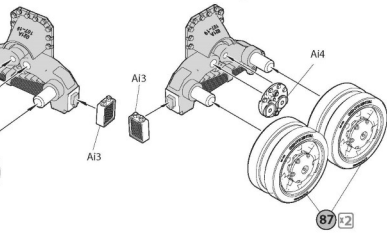
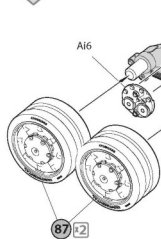
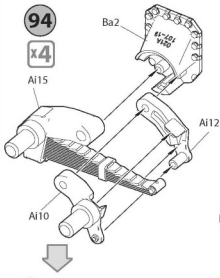
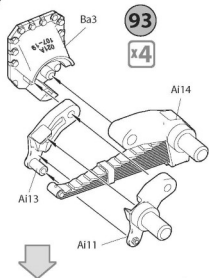

**98** x2

Repeat on the reverse side

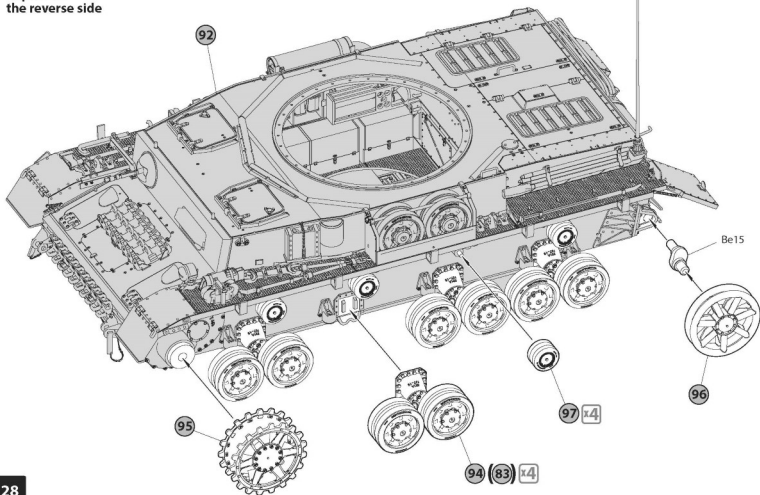

**x2** Each track links contains 101 tracks

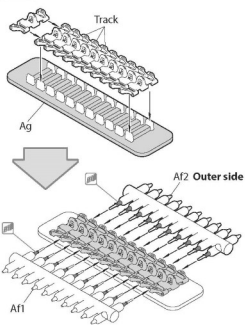

**99**

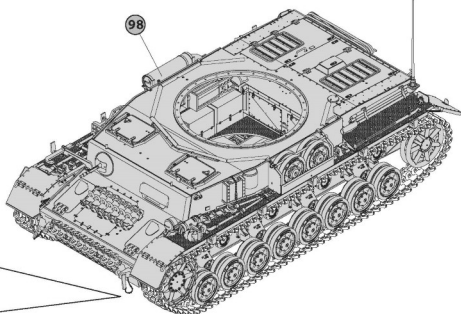

**100**

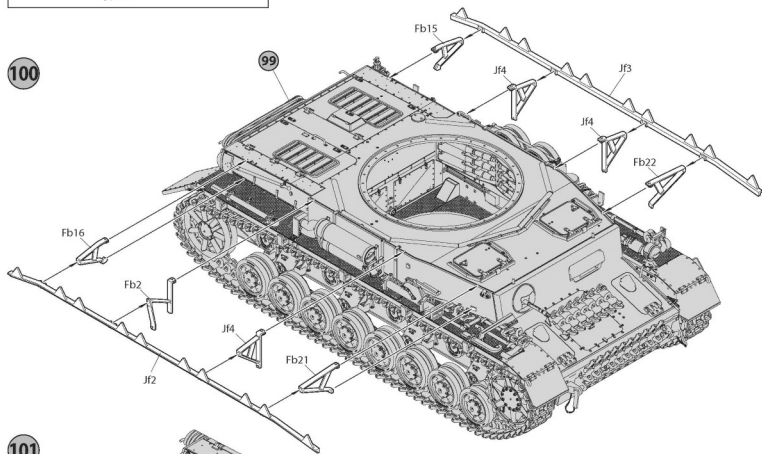

**101**

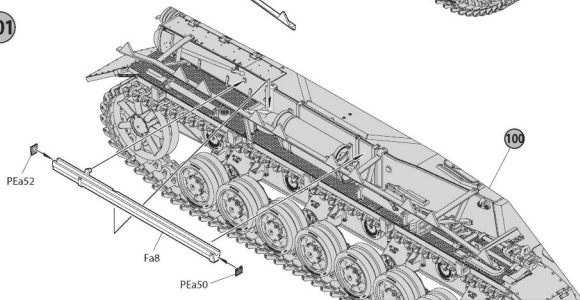

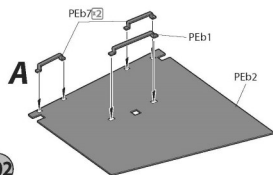

102

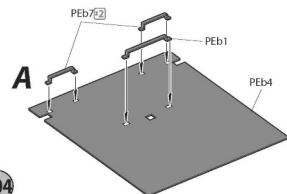
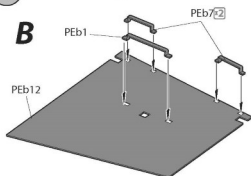

104

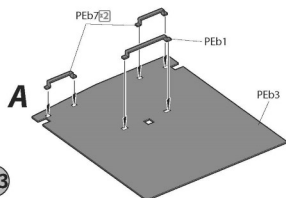
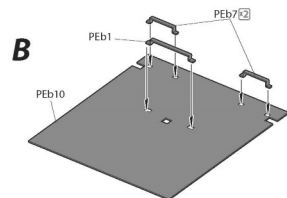

103

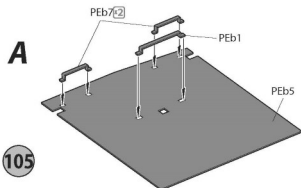
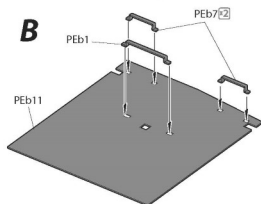

105

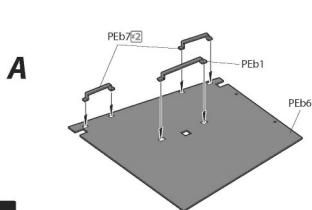
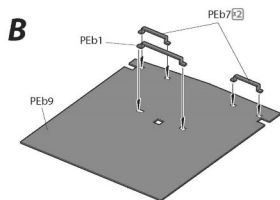

106

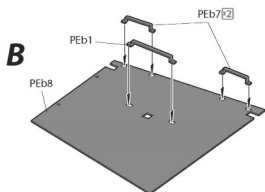

107

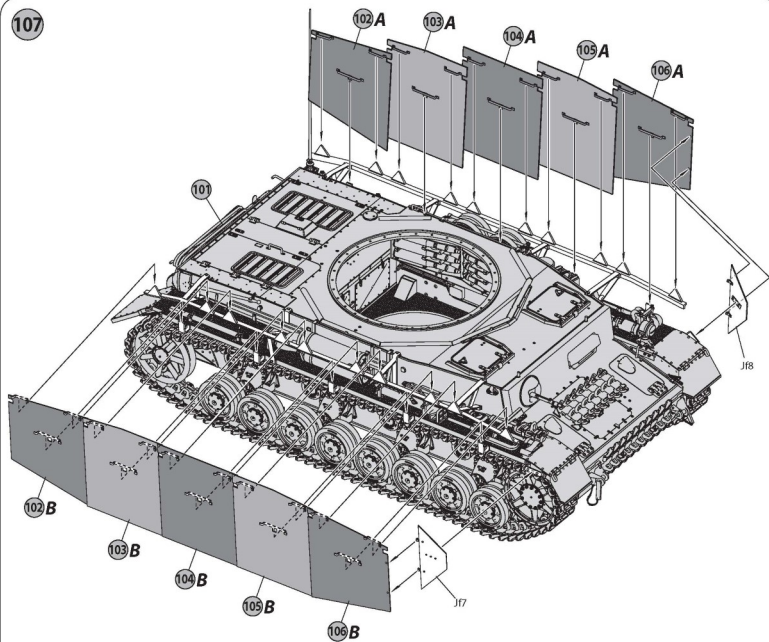

108

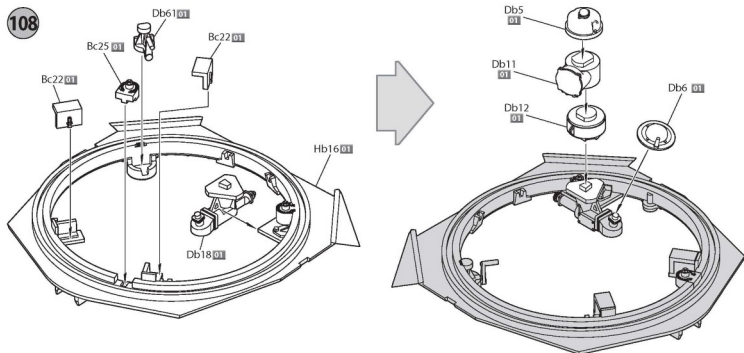

109

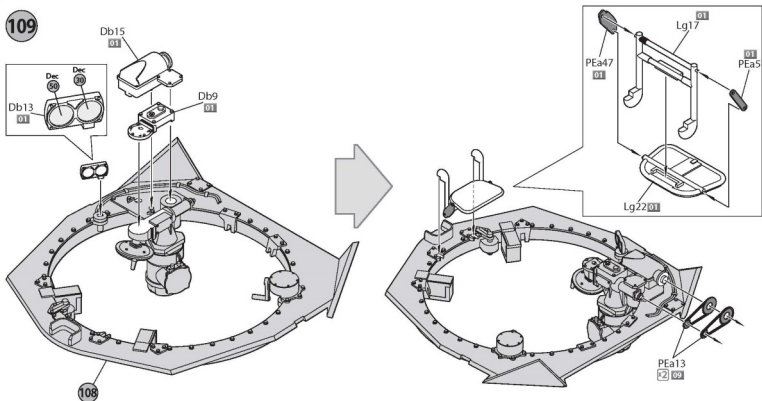

110

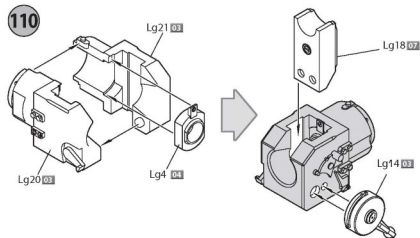

111

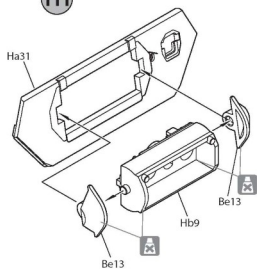

112

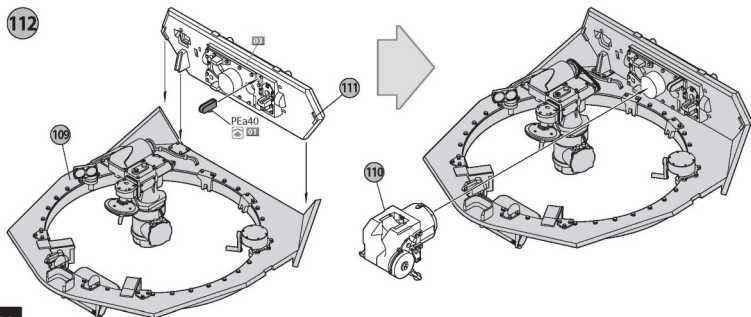



113

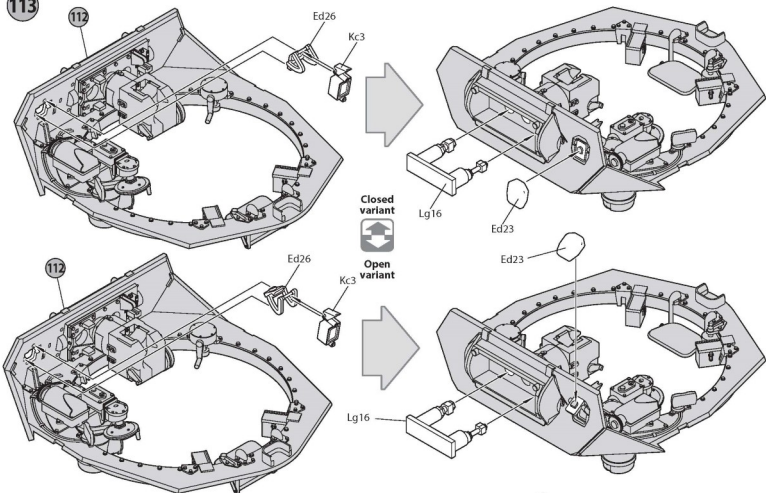

114

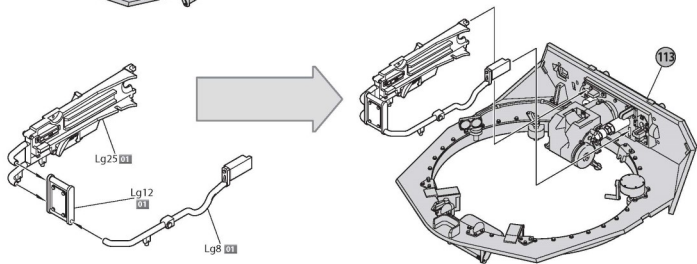

115

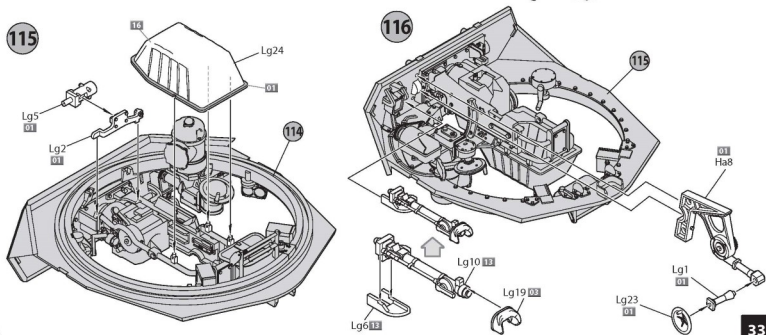

117

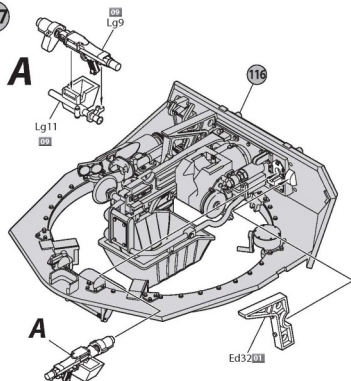

118

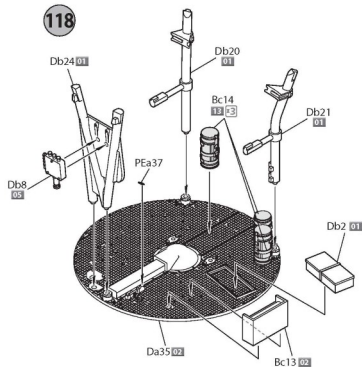

119

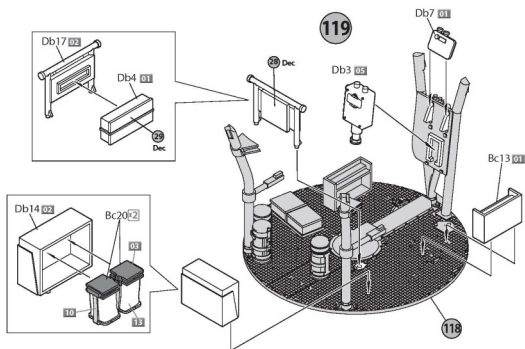

120

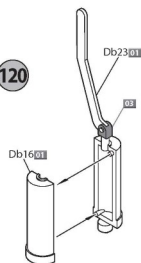

121

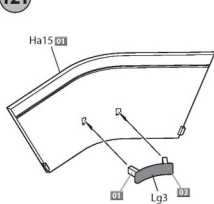

122

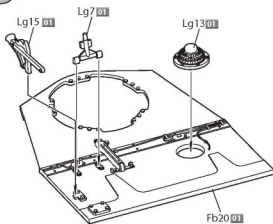

123

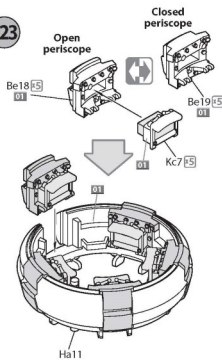

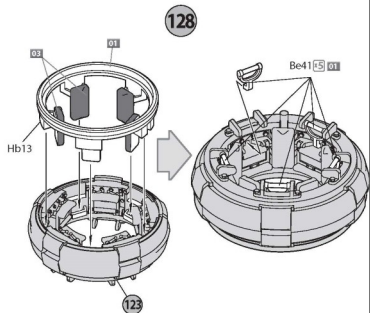
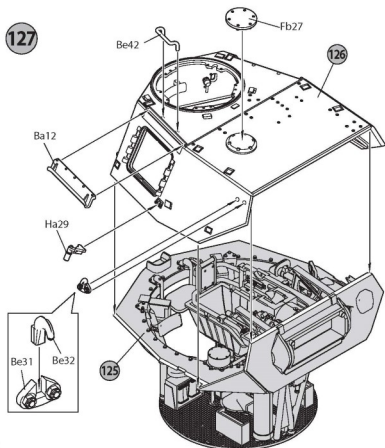
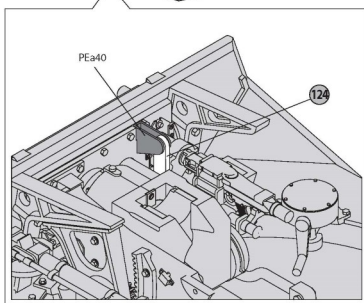
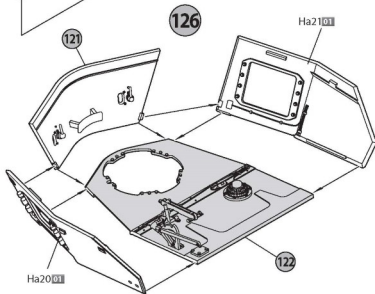
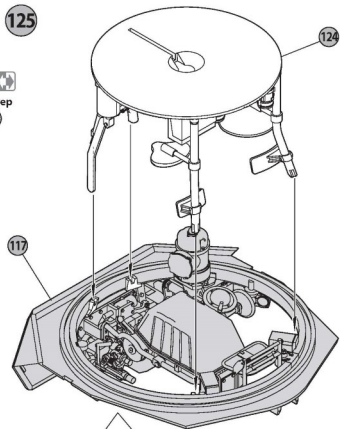
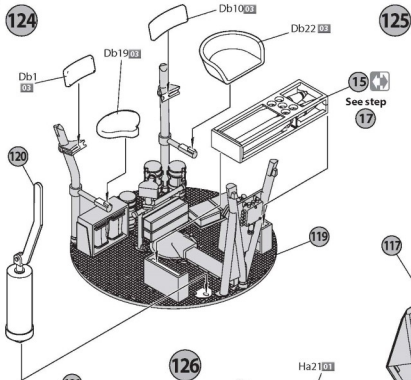



137

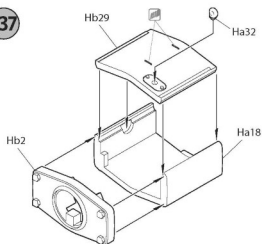

138

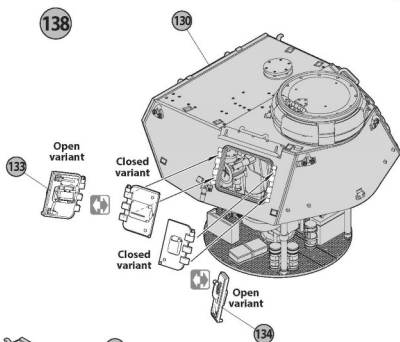

139

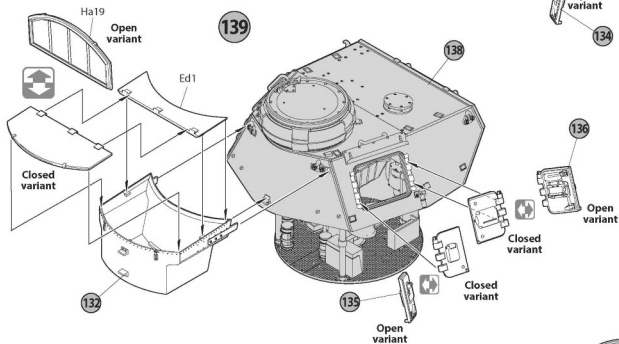

140

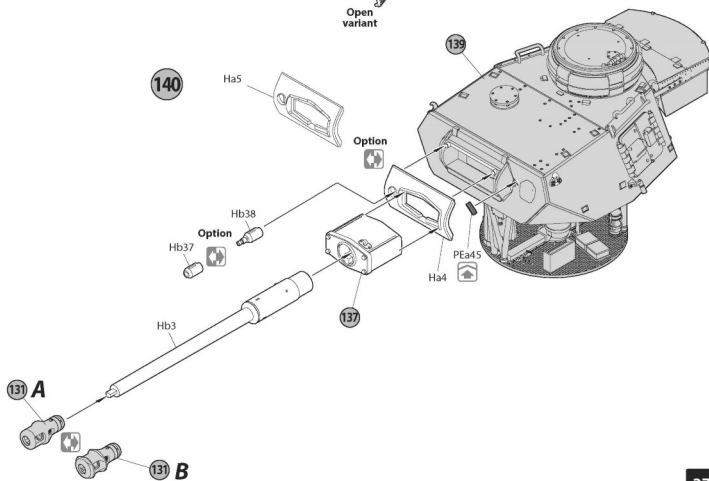

141

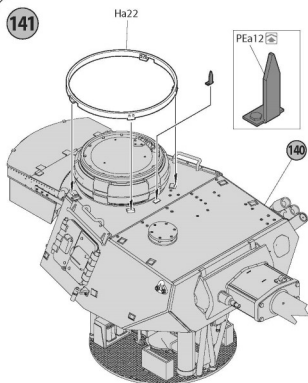

142

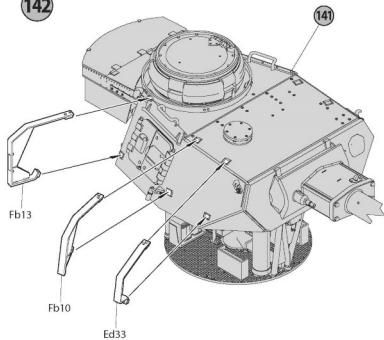

143

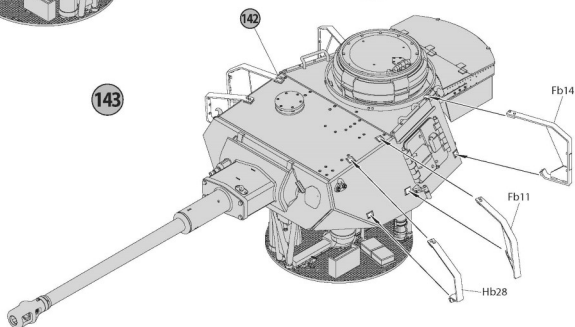

144

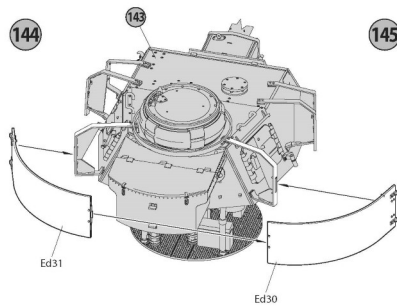

145

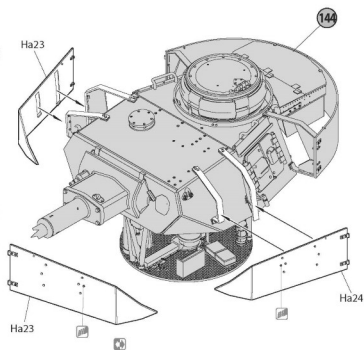

146

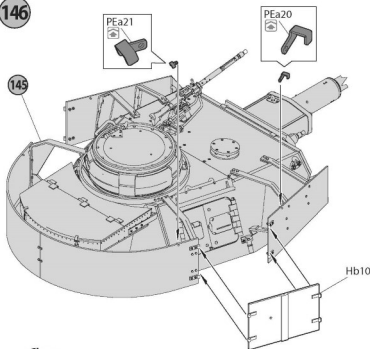

145

Hb10

Close  
variantOpen  
variant

147

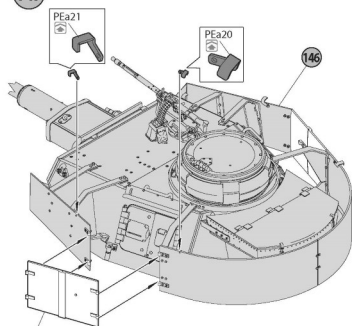

146

Hb11

Close  
variantOpen  
variant

145

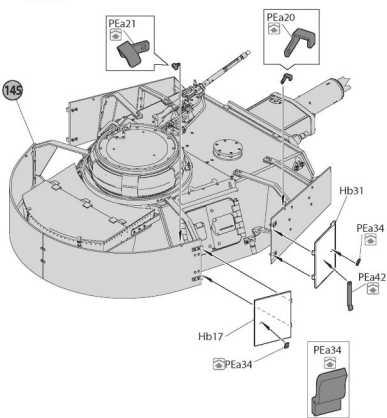

Hb31

PEa34

PEa42

Hb17

PEa34



PEa34

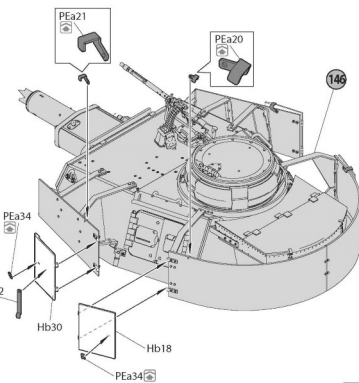

146

PEa34

PEa42

Hb30

Hb18

PEa34

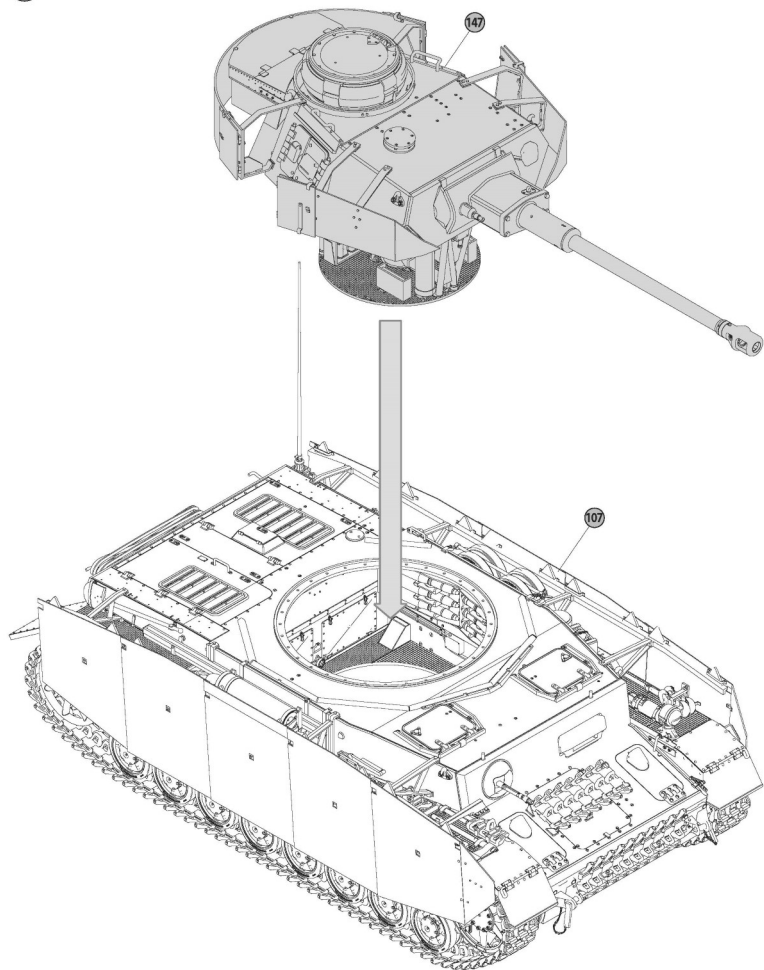



# Pz.Kpfw.IV Ausf. H Krupp-Grusonwerk MID PROD. AUG-SEP 1943

SCALE  
**1:35**

PAINTING GUIDE **3** 16. Panzer-Division, Eastern Front. Winter 1943-1944

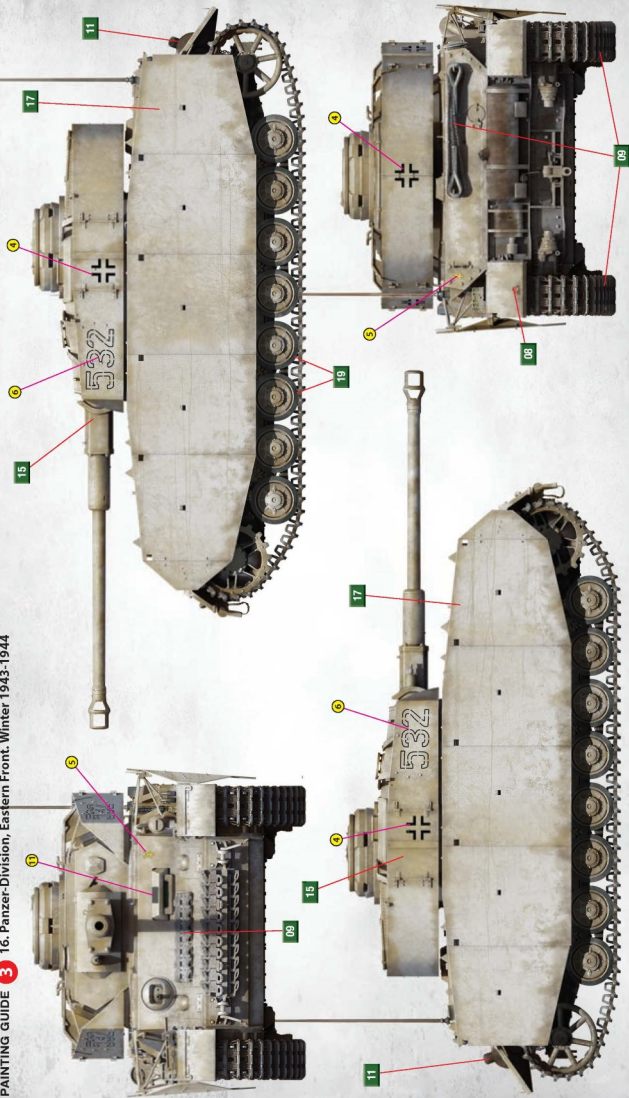

# Pz.Kpfw.IV Ausf. H KRUPP-GRUSONWERK MID PROD. AUG-SEP 1943

SCALE  
**1:35**



PAINTING GUIDE **4**  
8. company 2. Battalion 29. Pz.Rgt. 12. Panzer division.  
Bialystok, Poland, July 1944

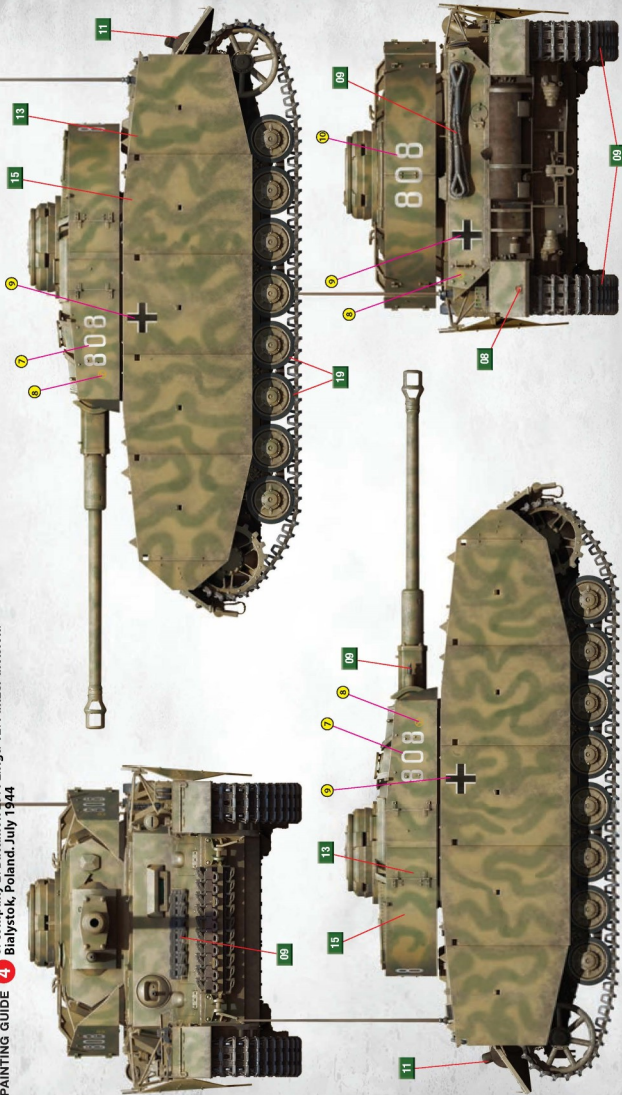

# RELATED ITEMS

## Pz.Kpfw.IV Ausf. J Nibelungenwerk

Late Prod. (Jan - Feb 1945)



THIS IS NOT A TOY  
UNASSEMBLED PLASTIC MODEL KIT  
KIT CONTAINS MODEL OF MEDIUM TANK  
RE PARTS ARE INCLUDING  
WHEELS AND TRACKS  
8 DECAL SHEETS

**MiniArt**

WW II MILITARY MINIATURES SERIES

35342

1:35

**INTERIOR KIT**  
INCLUDES 600+ COMPONENTS

WW II MILITARY MINIATURES SERIES

## GERMAN PANZERGRENADIERS

UNASSEMBLED PLASTIC MODEL KIT BOX CONTAINS MODELS OF FOUR FIGURES



*F. Ramirez 2012*

SCALE  
1:35

35248

**MiniArt**

SPECIAL EDITION

SCALE 1:35

## GERMAN TANK CREW FRANCE 1944

WW II MILITARY MINIATURES SERIES



**MiniArt**

35252

# RELATED ITEMS

## Pz.Beob.Wg.IV Ausf. J

LATE/LAST PROD. WITH CREW

2 IN 1

UNPAINTED PLASTIC MODEL KIT  
FOR CONSTRUCTING MODEL OF TANK & 5 FIGURES  
FOR DISPLAY PURPOSES  
THIS IS NOT A TOY

1:35

MiniArt



680TH20

35344

WW II MILITARY MINIATURES SERIES

SPECIAL EDITION

SCALE 1:35

35319

### GERMAN TANK REPAIR CREW

UNPAINTED PLASTIC MODEL KIT  
FOR THE 40 CONSTRUCTING FIGURES OF  
FIVE FIGURES, TOOLS



MiniArt



WW II MILITARY MINIATURES SERIES

SPECIAL EDITION

SCALE 1:35

### GERMAN TANK CREW NORMANDY 1944

WW II MILITARY MINIATURES SERIES



35275

MiniArt

SPECIAL EDITION

SCALE 1:35

35295

### GERMAN TANK CREW AT WORK

FOR THE 40 CONSTRUCTING FIGURES OF  
FIVE FIGURES, TOOLS



MiniArt



WW II MILITARY MINIATURES SERIES