

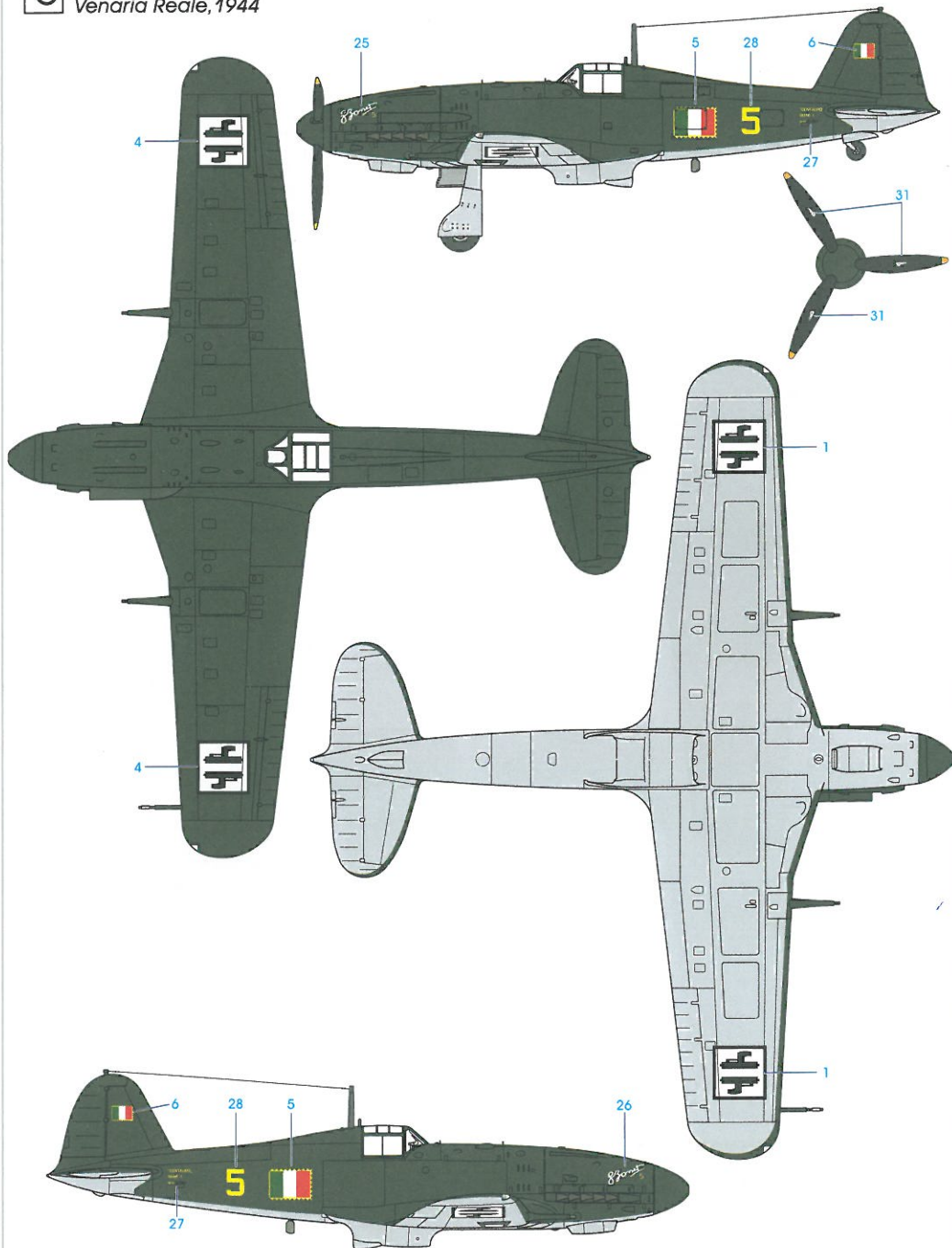

Fiat G.55 Serie 1, 2nd Gruppo, 2 Squadriglia
Venaria Reale, 1944



12

C317/H317

1

GRIGIO MIMETICO
Light Grey
FS -6440

C18/H65

2

VERDE OLIVA SCURO.2
Olive Green
FS -4052

Note: C4/H4 = Mr. Color/GSI Creos Aqueous Hobby Color



1/72 Scale

SW 72104



Fiat G.55 Centauro

Fiat G.55 Centauro

As early as 1939, Italian aircraft factories began designing monoplane fighters using inline as opposed to radial engines. Fiat experimented with the G.50 powered by an Italian built Daimler-Benz 601, then used a newly designed G.55 powered by a licence built 605 engine. The prototype flew in April 1942. It had good performance and flight characteristics at all altitudes. The original series were armed with a 20mm MG 151/20 cannon fitted in the forward fuselage and firing between the engine cylinder heads, and through the propeller arc. It also had 4 x 12.7mm Breda machine-guns; 2 in the upper cowl, and 2 in the lower cowl, all firing through the propeller arc. Problems servicing the lower guns meant replacing them with a 20mm MG 151/20 cannon in each wing. Later aircraft armament varied with both cannon plus machine-guns. A hard-point on each wing could carry a bomb up to 160kg (350 lb) or a 100 litre (26 u.s gal) drop-tank.

A problem with a left-hand yaw tendency under take-off power was partially resolved with a slightly off-set vertical stabiliser.

The Fiat G.55 proved to be an excellent interceptor and no easy target for the Spitfire, Mustang, Thunderbolt, and Lightnings over Northern Italy in 1944. Its good performance and handling at high altitude also made it the best option to use against allied bombers.

The G.55 was used by Aeronautica Nazionale Repubblicana (ANR) and Regia Aeronautica. In its short service life, it flew mainly under Repubblica Sociale Italiana insignia. Less than 300 were produced.

VISION SWORD s.r.o.

Těšínská 288
739 34 Šenov
CZECH REPUBLIC

www.swordmodels.cz

email: swordmodels@gmail.com

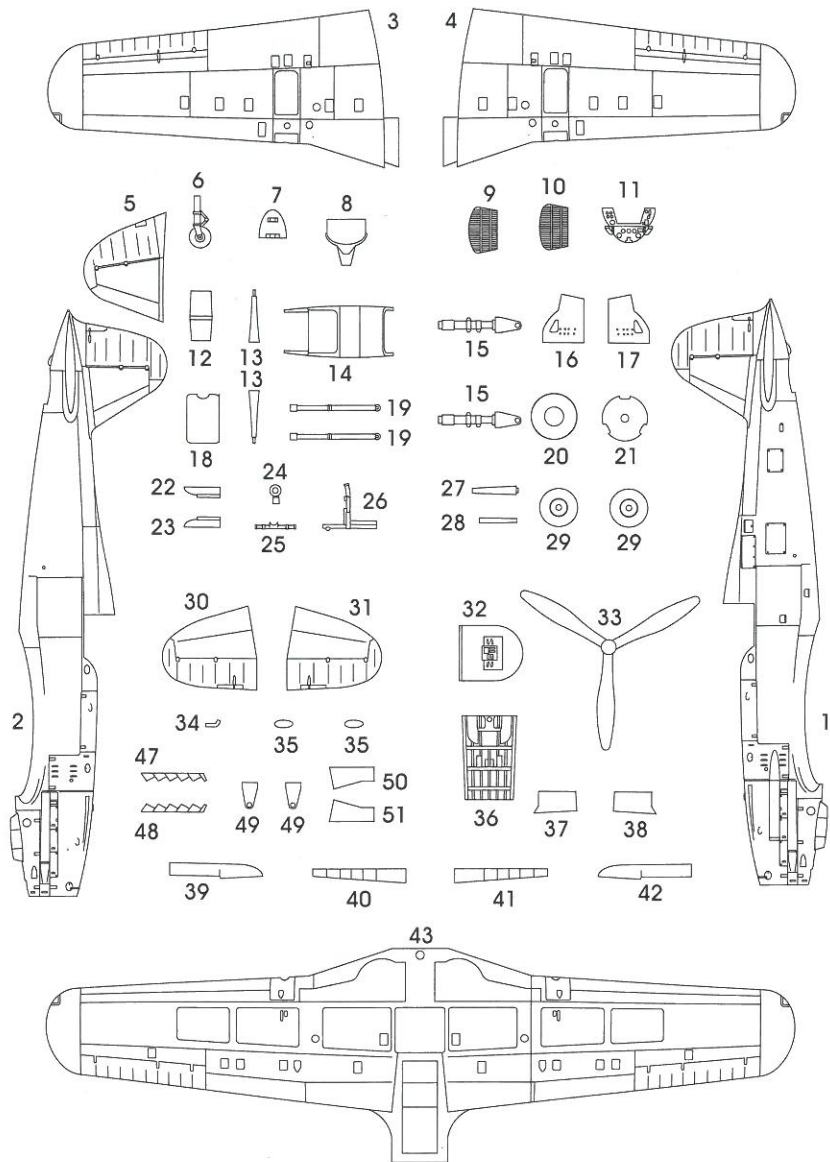

čiré díly/ clear parts



2

PUR díl/ PUR part
POUŽIT KYANOAKRYLÁTOVÉ LEPIDLO
INSTANT CYANOACRYLATE GLUE



46

barvy/ colours

A	C33/H12 • Black	E	C61/H76 • Burnt Iron Steel
B	C137/H77 • Tire Black	F	C28/H18 • Steel
C	C312/H312 • Light Green	G	MC211 • Chrom Silver
D	C8/H8 • Aluminium	H	C29/H17 • Brown Leather

Note: • = Mr. Color/GSI Creos Aqueous Hobby Color

1

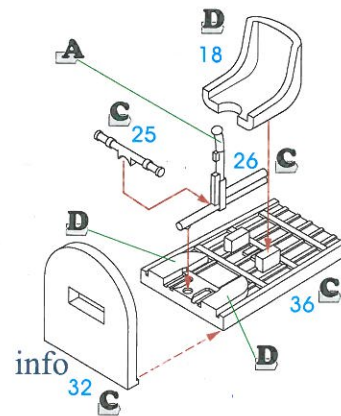

2

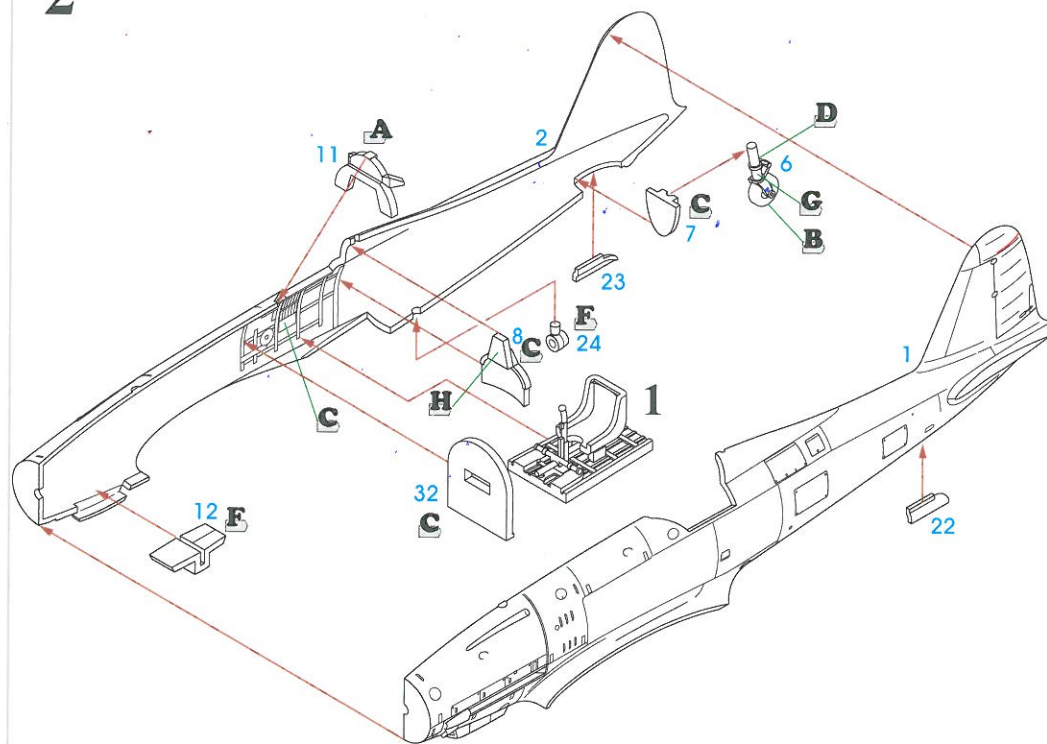

3

3

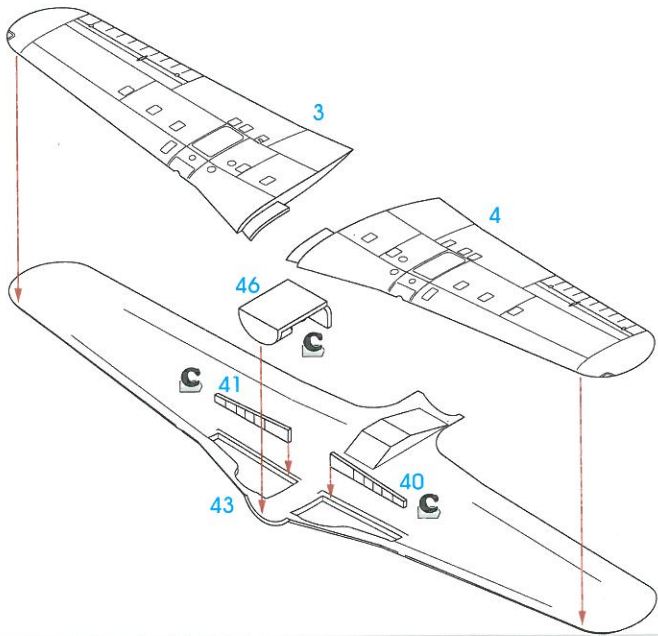

4



5

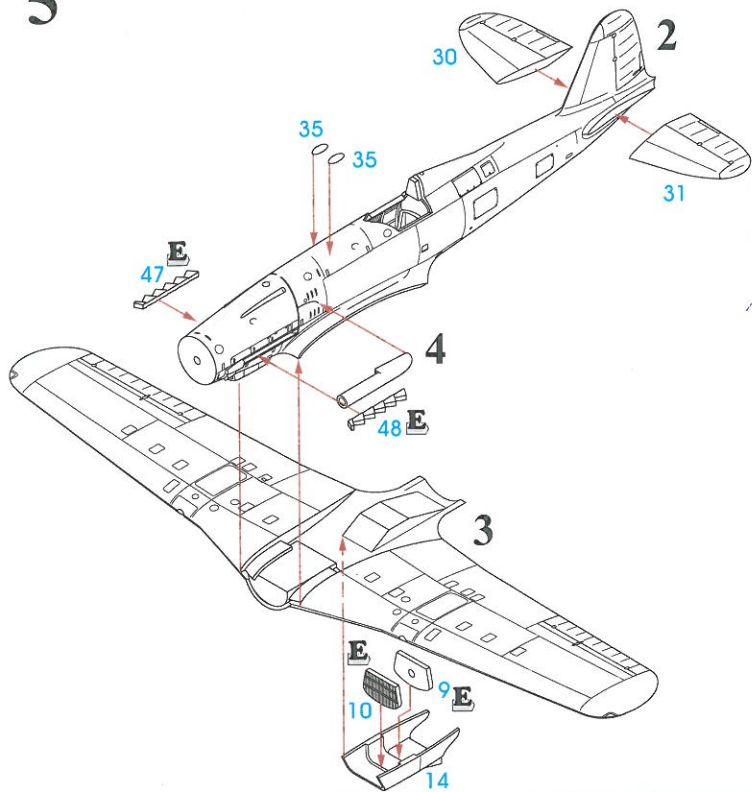

6

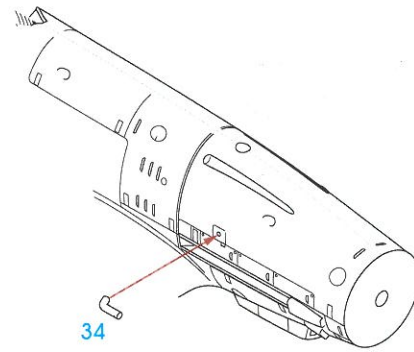

7 for cam. D, E, G
MOŽNOST VOĽBY
OPTIONAL

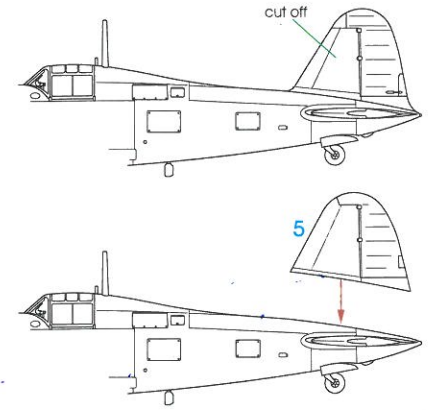

8

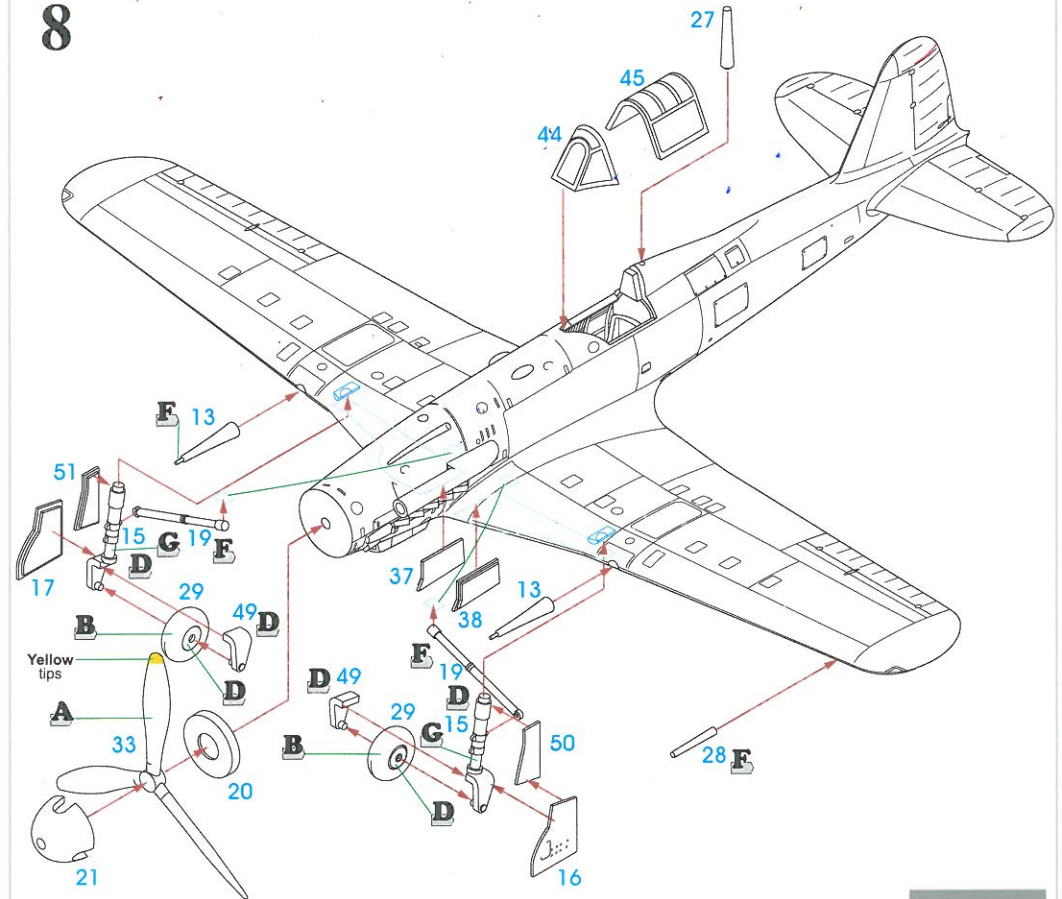

4

5

A Fiat G.55 Serie 1, 2nd Gruppo, 1a Squadriglia
Cascina Vaga, May 1944

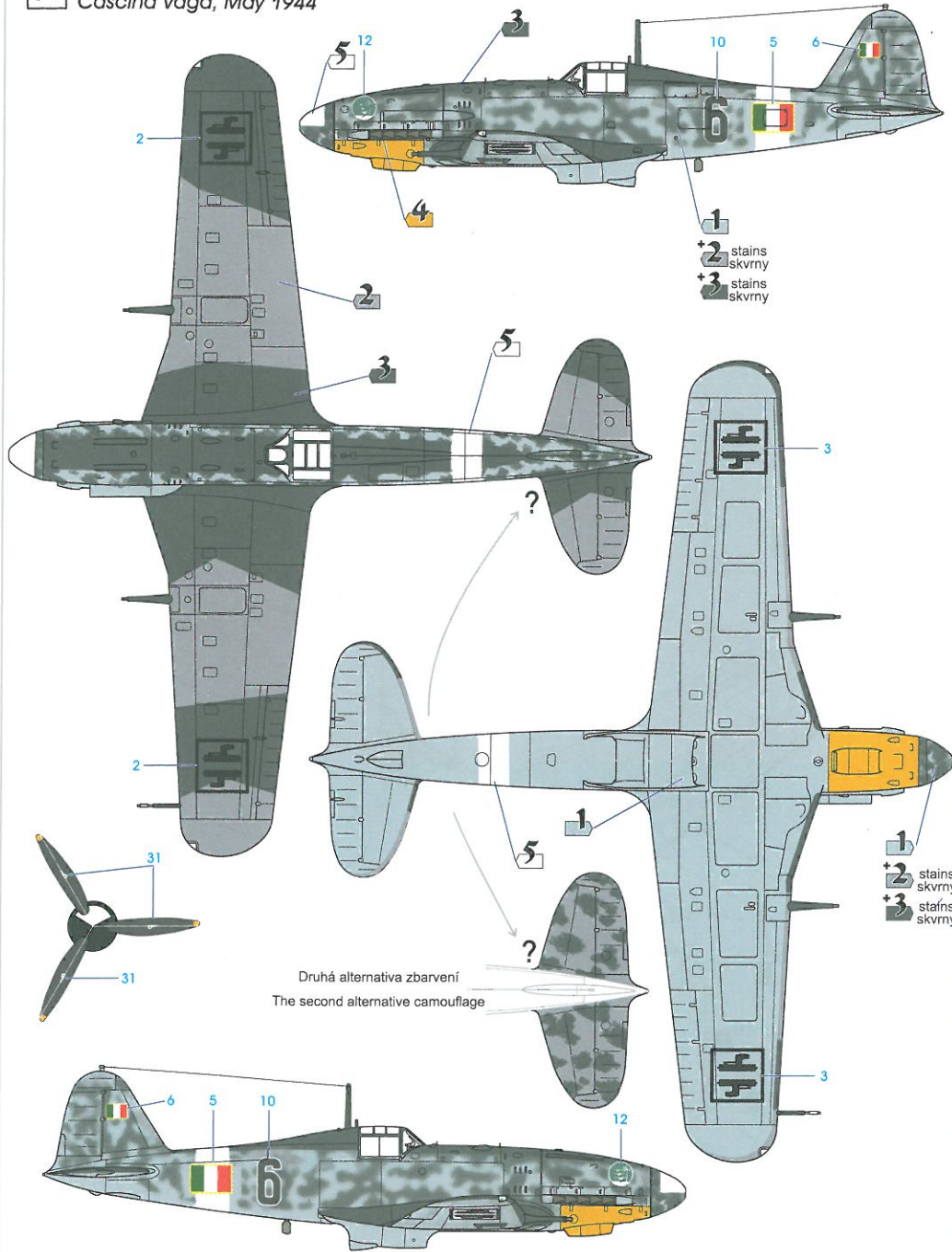

6

C117/H417

1 RLM 76 Lichtblau
Light Blue
FS -6473

C37/H69

2 RLM 75 Grauviolett
Grey Violet
FS -6132

C36/H68

3 RLM 74 Graugrün
Dark Grey-Green
FS -6081

C113/H413

4 RLM 04 Gelb
Yellow
FS -3538

C62/H11

5 RLM 21 Weiss
White
FS -7886

Note: C4/H4 = Mr. Color/GSI Creos Aqueous Hobby Color

B Fiat G.55 Serie 1, 2nd Gruppo, 1a Squadriglia, ten. Drago
Cascina Vaga, May 1944

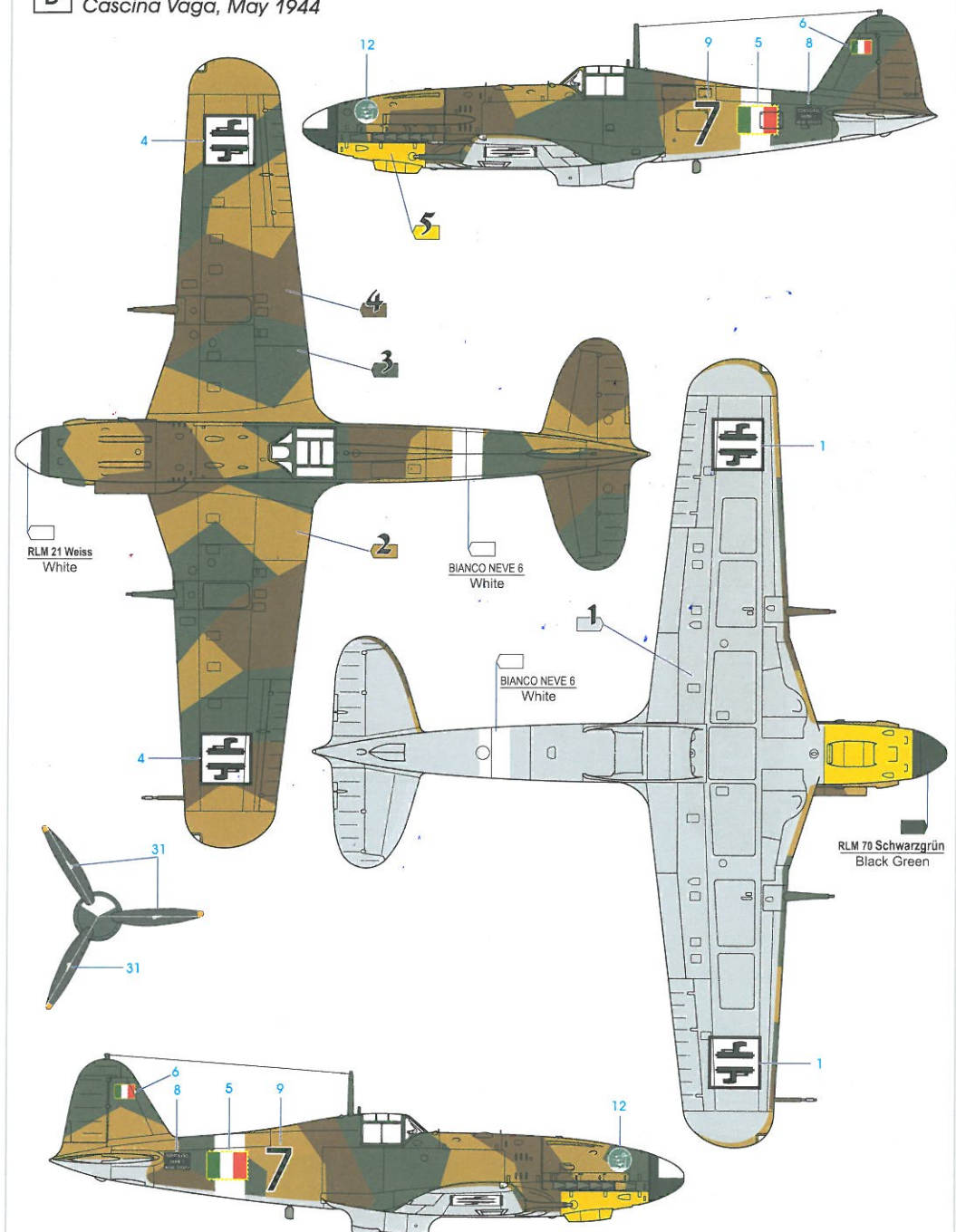

7

C317/H317

1 GRIGIO MIMETICO
Light Grey
FS -6440

C39/H79

2 GIALLO MIMETICO 3
Sand
FS -3434

C302/H302

3 VERDE MIMETICO 1
Dark Green
FS -4092
(FS -4096)

C43/H37

4 MARRONE MIMETICO 2
Dark Brown
FS -0076

C4/H4

5 GIALLO CROMO 7
Yellow
FS -3655

Note: C4/H4 = Mr. Color/GSI Creos Aqueous Hobby Color

C Fiat G.55 Serie 1, 1st Gruppo, 3rd Squadriglia
July 1944

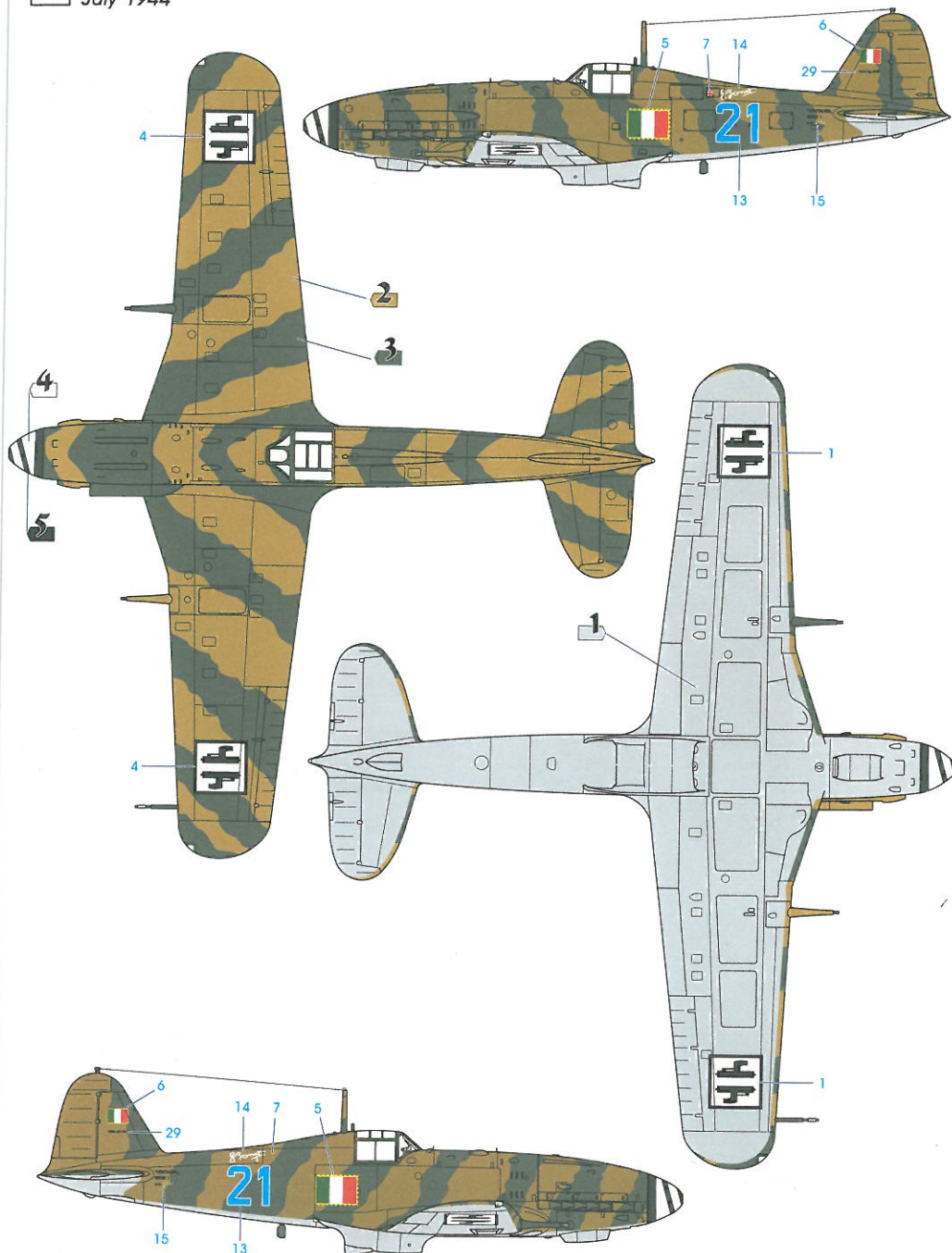

C317/H317

1 GRIGIO MIMETICO
Light Grey
FS-6440

C39/H79

2 GIALLO MIMETICO 3
Sand
FS-3434

C18/H65

3 VERDE OLIVA SCURO 2
Olive Green
FS-4052

C62/H11

4 BIANCO NEVE 6
White
FS-7925

C33/H12

5 GIALLO CROMO 7
Yellow
FS-3655

Note: C4/H4 = Mr. Color/GSI Creos Aqueous Hobby Color

8

D Fiat G.55 Serie 1, 2nd Gruppo, 1a Squadriglia
Cascina Vaga, May 1944

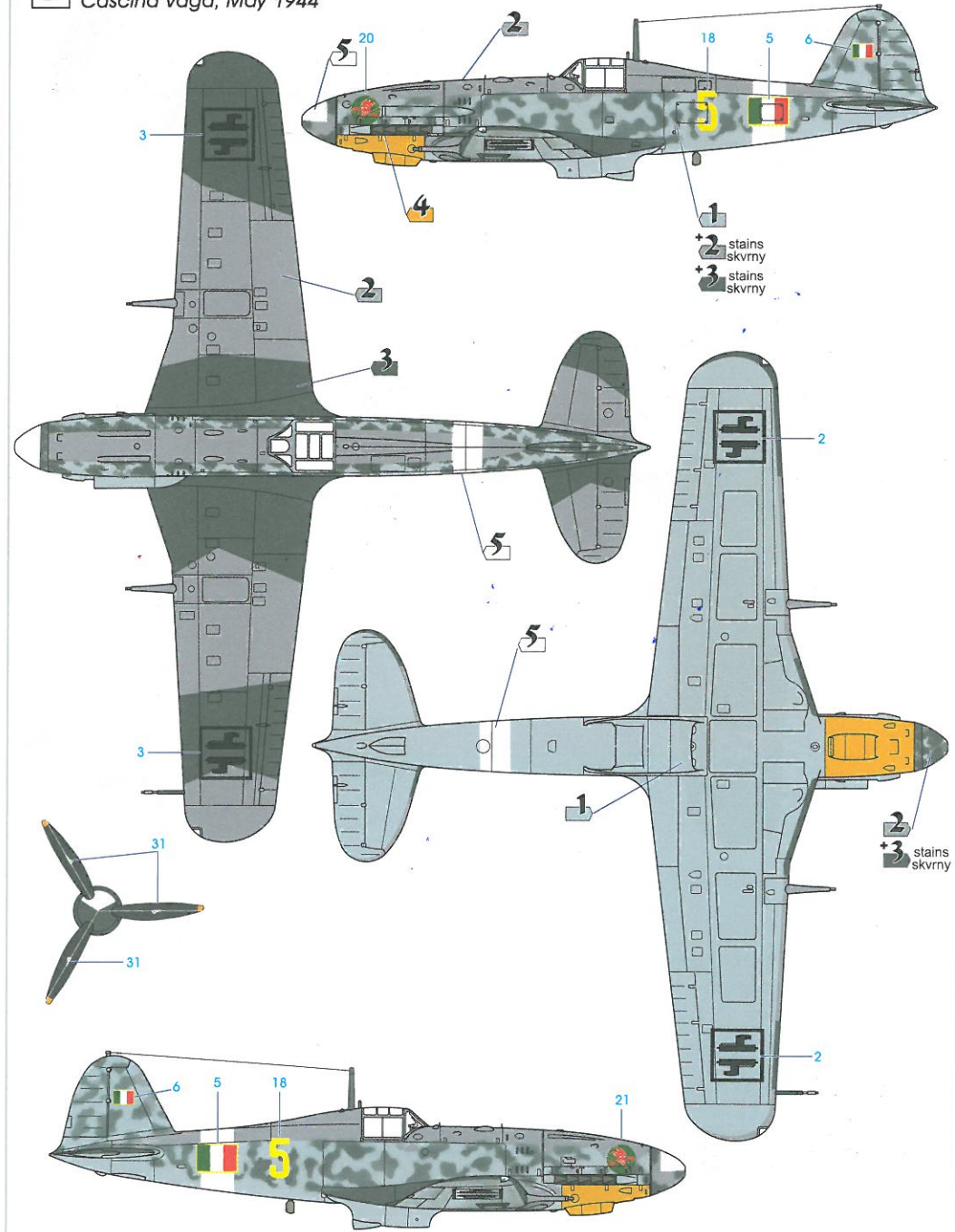

C117/H417

1 RLM 76 Lichtblau
Light Blue
FS-6473

C37/H69

2 RLM 75 Grauviolett
Grey Violet
FS-6132

C36/H68

3 RLM 74 Graugrün
Dark Grey-Green
FS-6081

C113/H413

4 RLM 04 Gelb
Yellow
FS-3538

C62/H11

5 RLM 21 Weiss
White
FS-7886

Note: C4/H4 = Mr. Color/GSI Creos Aqueous Hobby Color

9

E Fiat G.55 Serie 1, 2nd Gruppo, 2 Squadriglia
Bresso, April 1944

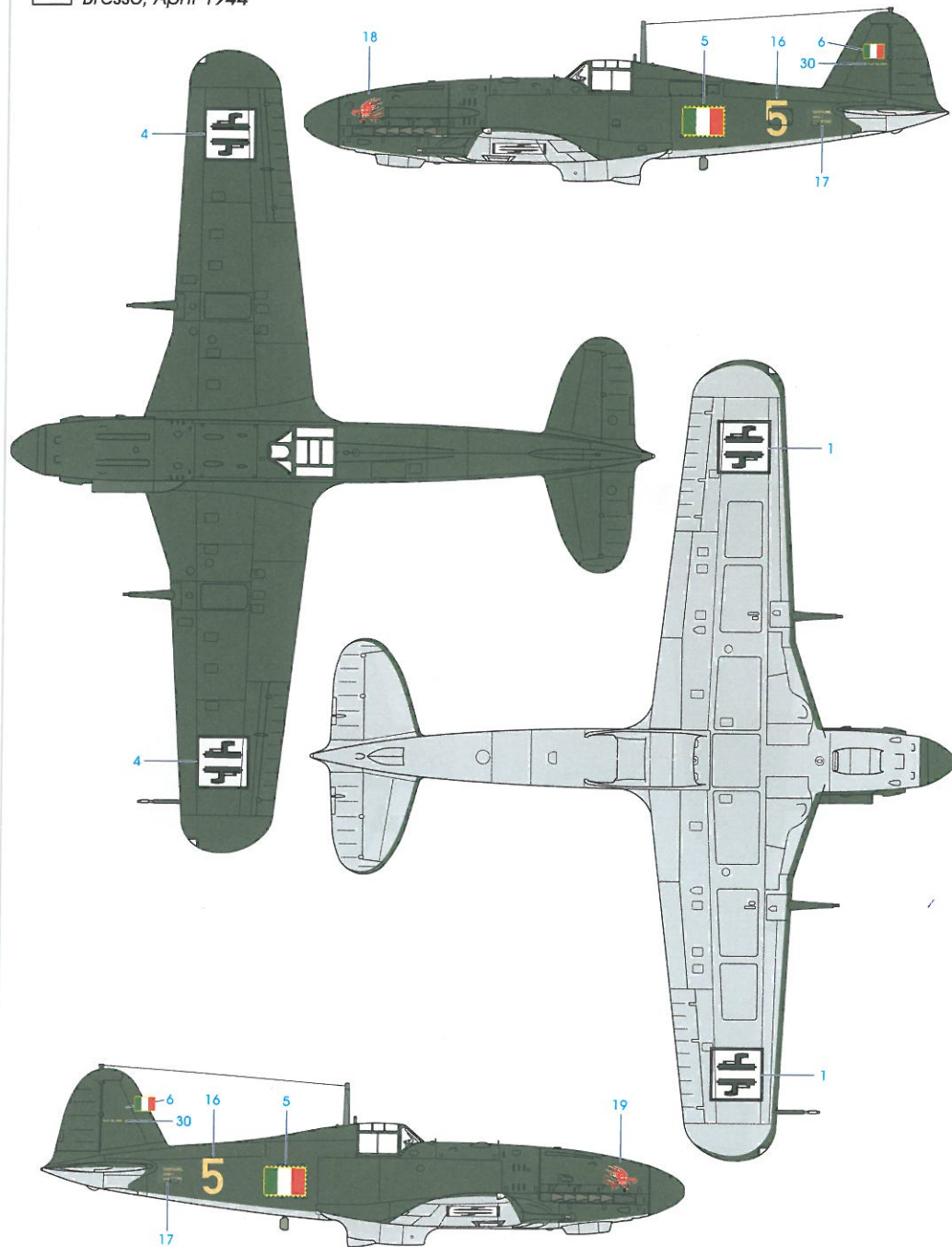

10

C317/H317

1 GRIGIO MIMETICO
Light Grey
FS -6440

C18/H65

2 VERDE OLIVA SCURO 2
Olive Green
FS -4052

Note: C4/H4 = Mr. Color/GSI Creos Aqueous Hobby Color

F Fiat G.55 Serie 1, 2nd Gruppo, 2 Squadriglia
Cascina Vaga, May 1944

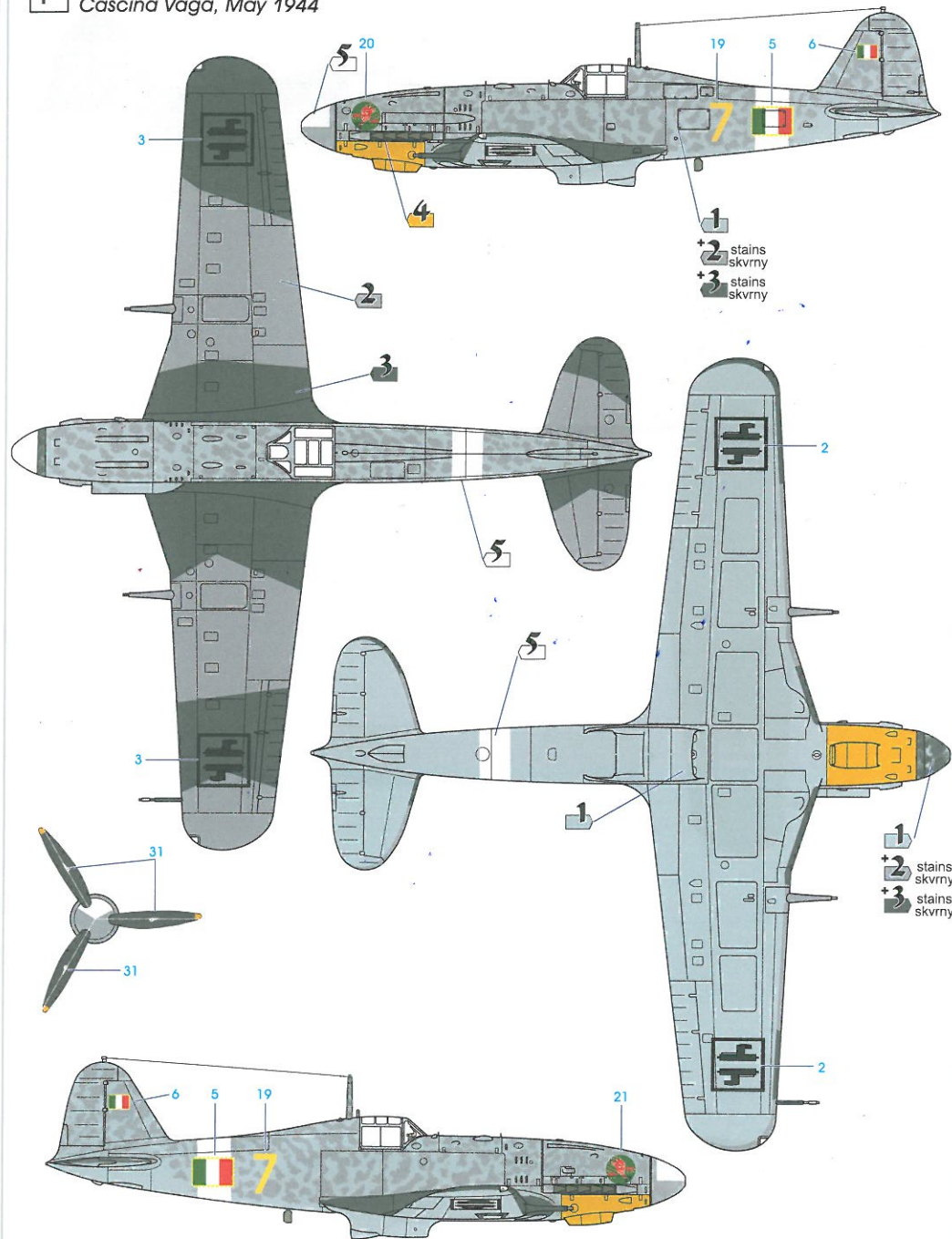

C117/H417

1 RLM 76 Lichtblau
Light Blue
FS -6473

C37/H69

2 RLM 75 Grauviolett
Grey Violet
FS -6132

C36/H68

3 RLM 74 Graugrün
Dark Grey-Green
FS -6081

C113/H413

4 RLM 04 Gelb
Yellow
FS -3538

C62/H11

5 RLM 21 Weiss
White
FS -7886

Note: C4/H4 = Mr. Color/GSI Creos Aqueous Hobby Color

11