

DEVASTATOR TBD-1

In 1934 the U.S. Navy Bureau of Aeronautics requested designs for a new torpedo plane. The Douglas TBD-1 met all the requirements for replacing the planes in use at that time and was accepted.

In 1937 the TBD-1 Devastators went into Navy service as the first all metal, low wing aircraft with hydraulically powered folding wings. At that time it was the most modern and efficient aircraft of its type. It could perform steep reversals at low air speeds and with perfection, execute the high speed dives used during the early part of the torpedo run.

The TBD-1 carried a crew of three - a pilot, torpedo officer or bombardier, and rear gunner / radio operator. They sat in tandem under a continuous transparent canopy which had sliding sections over each cockpit. For torpedo missions in World War II, only a crew of two was used.

The U.S.S. Saratoga, (CV-3) in November 1937, received the first Douglas TBD-1 Devastators. TBD's also served on the U.S.S. Lexington, Yorktown, Enterprise, Wasp and Ranger.

Devastators saw action in the Pacific on February 1, 1942. In the Battle of the Coral Sea, the TBD's had their greatest success by aiding in the sinking of one carrier and seriously damaging another. On May 8, 1942 during the Battle of Midway, the Douglas TBD's saw their last major action.

This accurately detailed model was designed from authentic drawings and photographs. Technical information was supplied by McDonnell Douglas and the U.S. Navy.

READ THIS BEFORE YOU BEGIN

- * Study the assembly drawings.
- * Each plastic part is identified by a number.
- * In the assembly drawings, some parts will be marked by a star (★) to indicate chrome plated plastic.
- * For better paint and decal adhesion, wash the plastic parts in a mild detergent solution. Rinse and let air dry.
- * Check the fit of each piece before cementing in place.
- * Use only cement for polystyrene plastic.
- * Scrape plating and paint from areas to be cemented.
- * Allow paint to dry thoroughly before handling parts.
- * Any unused parts may be discarded.

DECAL APPLICATION INSTRUCTIONS

1. Cut desired decal from sheet.
2. Dip decal in water for a few seconds.
3. Place wet decal on paper towel.
4. Wait until decal is movable on paper backing.
5. Place decal in position on model, face up on a slide backing away.
6. Press out air bubbles with a soft damp cloth.
7. Milkiness that may appear is for better decal adhesion and will dry clear. Wipe away any excess adhesive.
8. Do not touch decal until fully dry.
9. Allow the decals 48 hours to dry before applying clear coat.

LIRE CE QUI SUIT AVANT DE COMMENCER

- * Etudier les schémas de montage.
- * Chaque pièce en plastique est identifiée par un numéro.
- * Sur les schémas de montage, certaines pièces sont marquées d'une étoile (★) pour indiquer qu'elles sont en plastique chromé.
- * Pour une meilleure prise de la peinture et des autocollants, laver les pièces en plastique avec une solution détergente peu concentrée. Les rincer et les laisser sécher à l'air.
- * Vérifier que chaque pièce s'ajuste bien avant de la coller en place.
- * N'utiliser que de la colle pour polystyrène.
- * Gratter les parties à coller pour enlever le chrome et la peinture.
- * Laisser la peinture bien sécher avant de manipuler les pièces.
- * Toute pièce inutilisée peut être jetée.

DIRECTIVES D'APPLICATION DES AUTOCOLLANTS

1. Découper l'autocollant désiré de la feuille.
2. Tremper l'autocollant dans de l'eau pendant quelques secondes.
3. Placer l'autocollant mouillé sur une serviette en papier.
4. Attendez que l'autocollant puisse être déplacé sur son support en papier.
5. Mettre l'autocollant en position sur le modèle face sur le dessus et faire glisser le support pour l'enlever.
6. Appuyer avec un chiffon doux humide pour éliminer les bulles d'air.
7. La substance laiteuse qui peut apparaître est destinée à améliorer l'adhésion de l'autocollant et devient incolore au séchage. Essuyer pour enlever tout excédent d'adhésif.
8. Ne pas toucher l'autocollant tant qu'il n'est pas bien sec.
9. Laisser l'autocollant sécher pendant 48 heures avant d'appliquer une couche transparente.

This paint guide is provided to complete this kit as shown on the box.

Ce guide de peinture est fourni pour reproduire le modèle réduit qui apparaît sur la boîte.

A	Flat Black	<i>Noir mat</i>
B	Lemon Yellow FS 13655	<i>Jaune clair</i>
C	Orange Yellow FS 13538	<i>Jaune orange</i>
D	Aluminum	<i>Aluminium</i>
E	Blue Gray FS 35189	<i>Blue gris</i>
F	Light Gray FS 36440	<i>Gris clair</i>
G	True Blue FS 15102	<i>Blue</i>
H	Insignia Red FS 11136	<i>Rouge emblème</i>



*** CEMENT TOGETHER**
 * A COLLER



*** DO NOT CEMENT**
 * NE PAS COLLER



*** REPEAT SEVERAL TIMES**
 * A REPETER PLUSIEURS FOIS



*** DECAL**
 * DECAL COMANIE



*** OPTIONAL PARTS**
 * PIECES EN OPTION



*** REMOVE AND THROW AWAY**
 * A RETIRER ET JETER

If you have any questions or comments, call our hotline at: (800) 833-3570 or, please write to:

Revell-Monogram Consumer Service Department, 8601 Waukegan Road, Morton Grove, Illinois 60053
Be sure to include the plan number (85757500200), part number, description, your return address and phone number.

Visit our website: www.revell-monogram.com

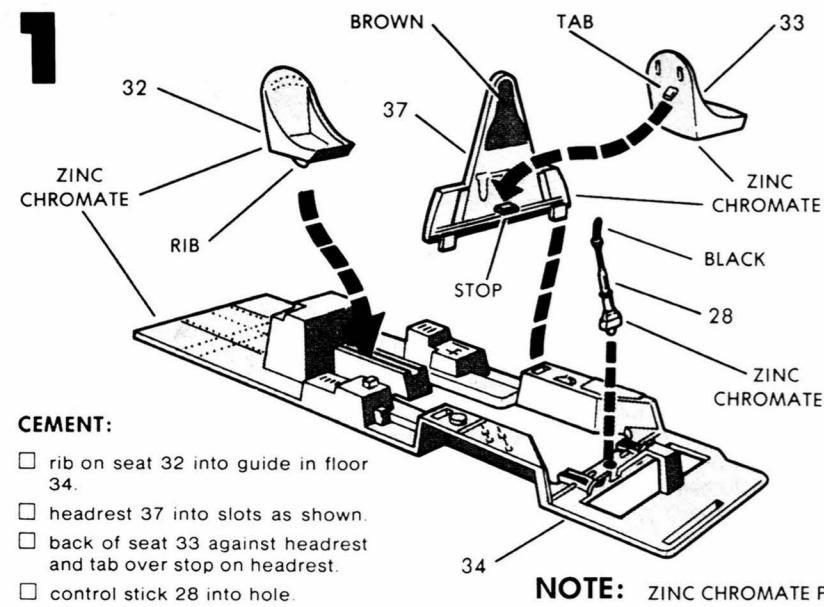

- CEMENT:**
- rib on seat 32 into guide in floor 34.
 - headrest 37 into slots as shown.
 - back of seat 33 against headrest and tab over stop on headrest.
 - control stick 28 into hole.

NOTE: ZINC CHROMATE PAINTING NOTES, IN ALL ASSEMBLY STEPS, PERTAIN TO VT-6 AND VT-8. VT-2 AIRCRAFT WERE FINISHED IN A SILVER.

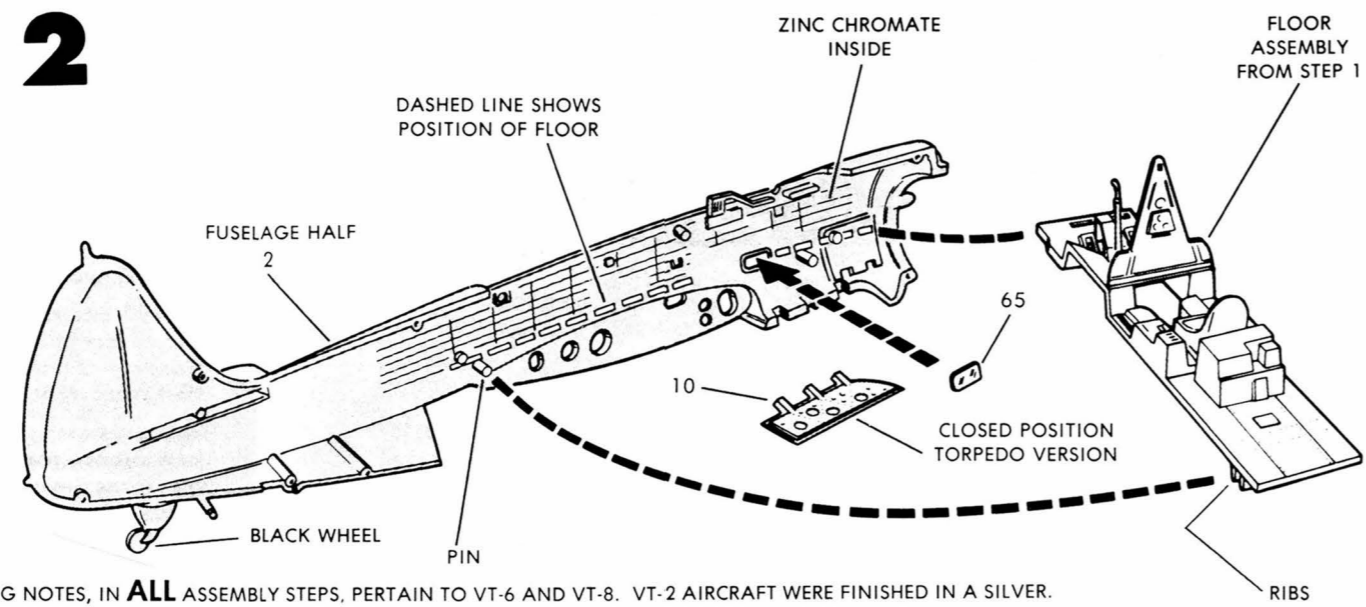

- TORPEDO VERSION**
- Cement door 10 into closed position—flush with bottom of fuselage 2.
- BOMBER VERSION**
- Door 10 is not required at this time.
- CONTINUE—**
- by carefully cementing smaller side of clear window 65 into fuselage half 2 as shown.
 - Cement assembled floor into fuselage half. Dashed lines on ILLUSTRATION indicate position. TWO RIBS fit over pin as shown.

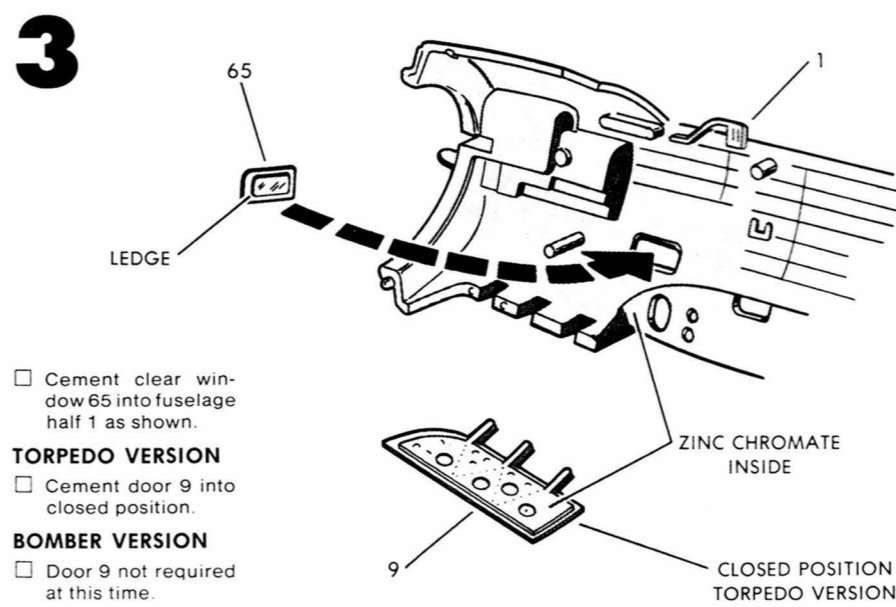

- Cement clear window 65 into fuselage half 1 as shown.
- TORPEDO VERSION**
- Cement door 9 into closed position.
- BOMBER VERSION**
- Door 9 not required at this time.

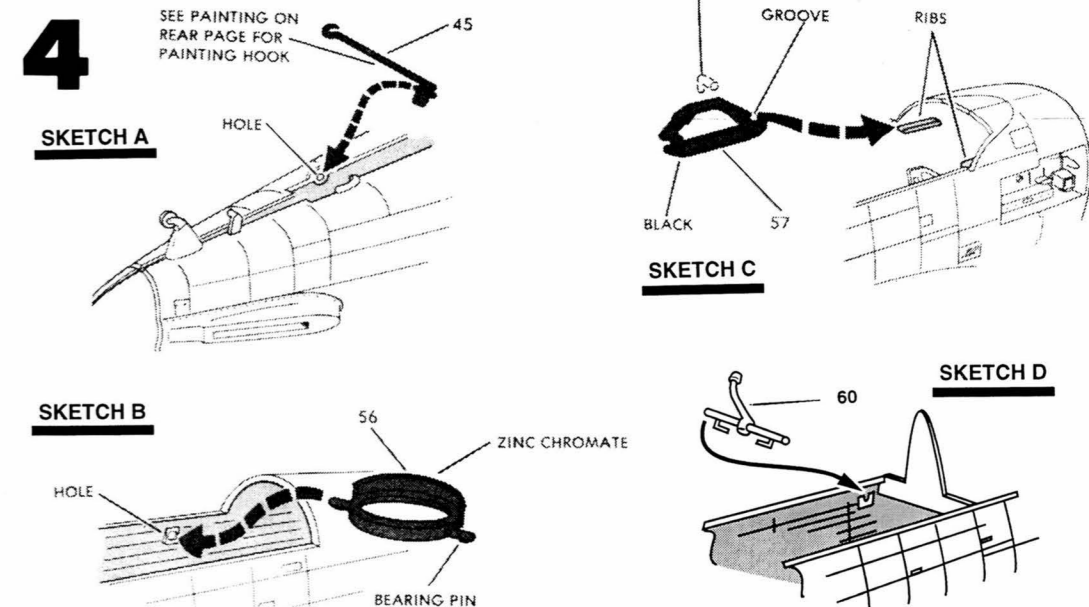

- Cement fuselage halves together. DO NOT APPLY any cement into the open area for the hook (SEE SKETCH A).
- While cement is wet-slightly spread fuselage apart and slip (DO NOT CEMENT) hook 45 and gun ring 56 into holes as shown in SKETCH A and B.
- Press fuselage together again and hold until cement sets.
- Cement instrument panel into fuselage as shown in SKETCH C. Grooves fit over ribs on sides of fuselage.
- Cement control stick 60 into fuselage as shown in SKETCH D.
- Cement cockpit top 14 into fuselage as shown in SKETCH E.

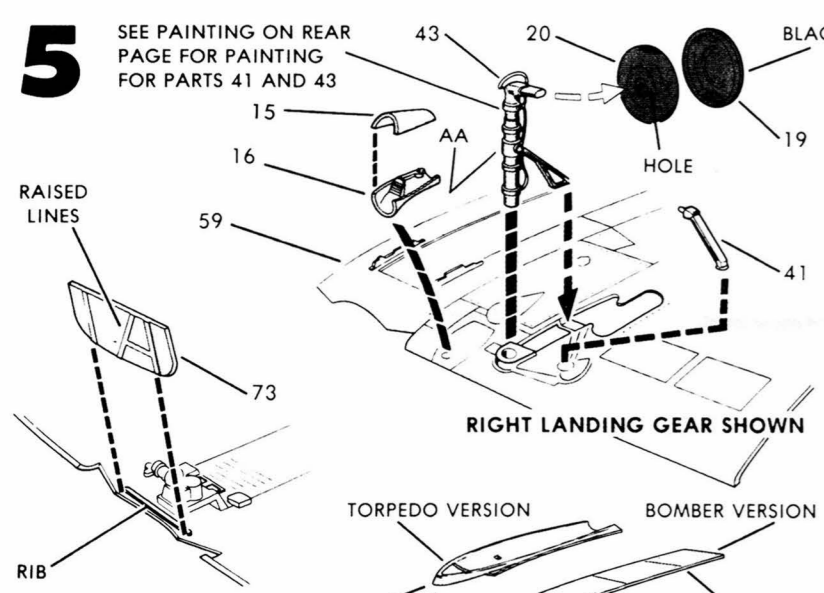

- Apply Decal AA to strut as shown.
- Cement strut 43 into wing bottom 59.
- Cement brace 41 into wing and hole in strut.
- Next, cement wheel halves 19 and 20 together.
- Hold wheel with SMALL HOLE as shown and cement onto strut. Tubing on strut fits into small hole.
- Repeat for strut 42, brace 41 and wheels 19 and 20.
- Cement scoop halves 15 and 16 together.
- Cement scoop onto wing as shown.

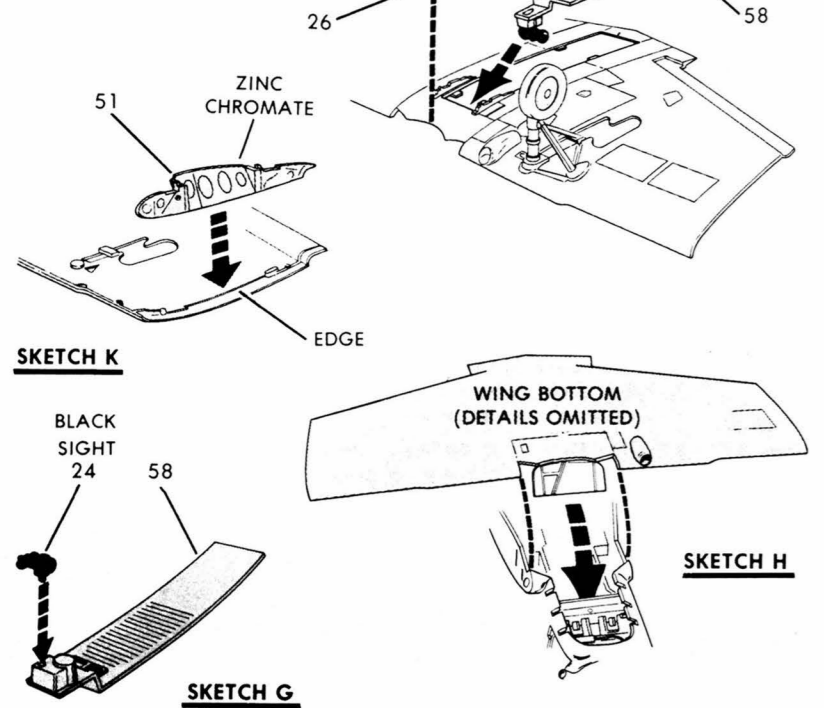

- Cement rib 35 against edge on wing tip half 8.
- Cement pitot tube 12 into hole.
- Cement wing tip half 5 into place.
- Repeat for rib 36 and wing tip halves 6 and 7.

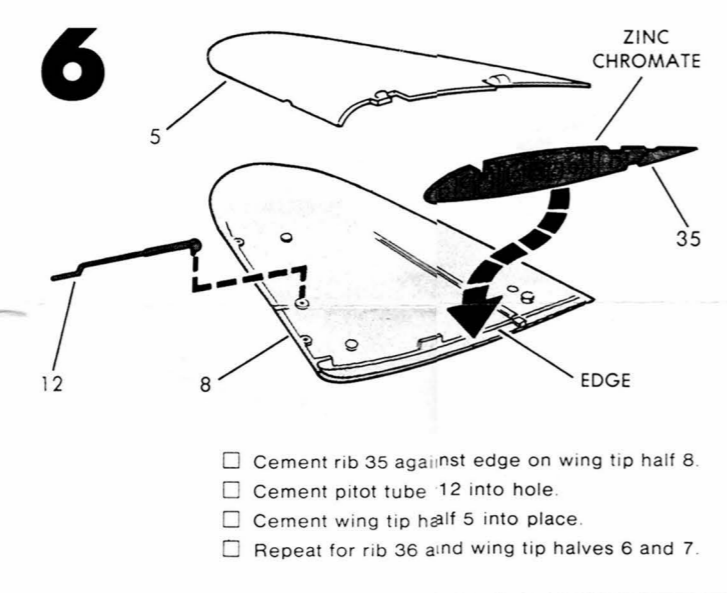

- Place (do not cement) hinge pins on wing tip into notches on large wing top 3 as shown.

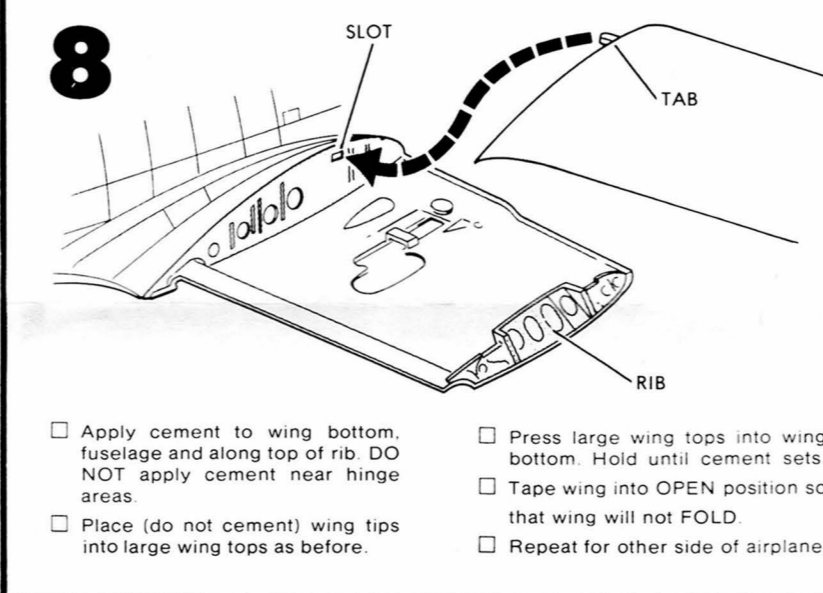

- Apply cement to wing bottom, fuselage and along top of rib. DO NOT apply cement near hinge areas.
- Place (do not cement) wing tips into large wing tops as before.
- Press large wing tips into wing bottom. Hold until cement sets.
- Tape wing into OPEN position so that wing will not FOLD.
- Repeat for other side of airplane.

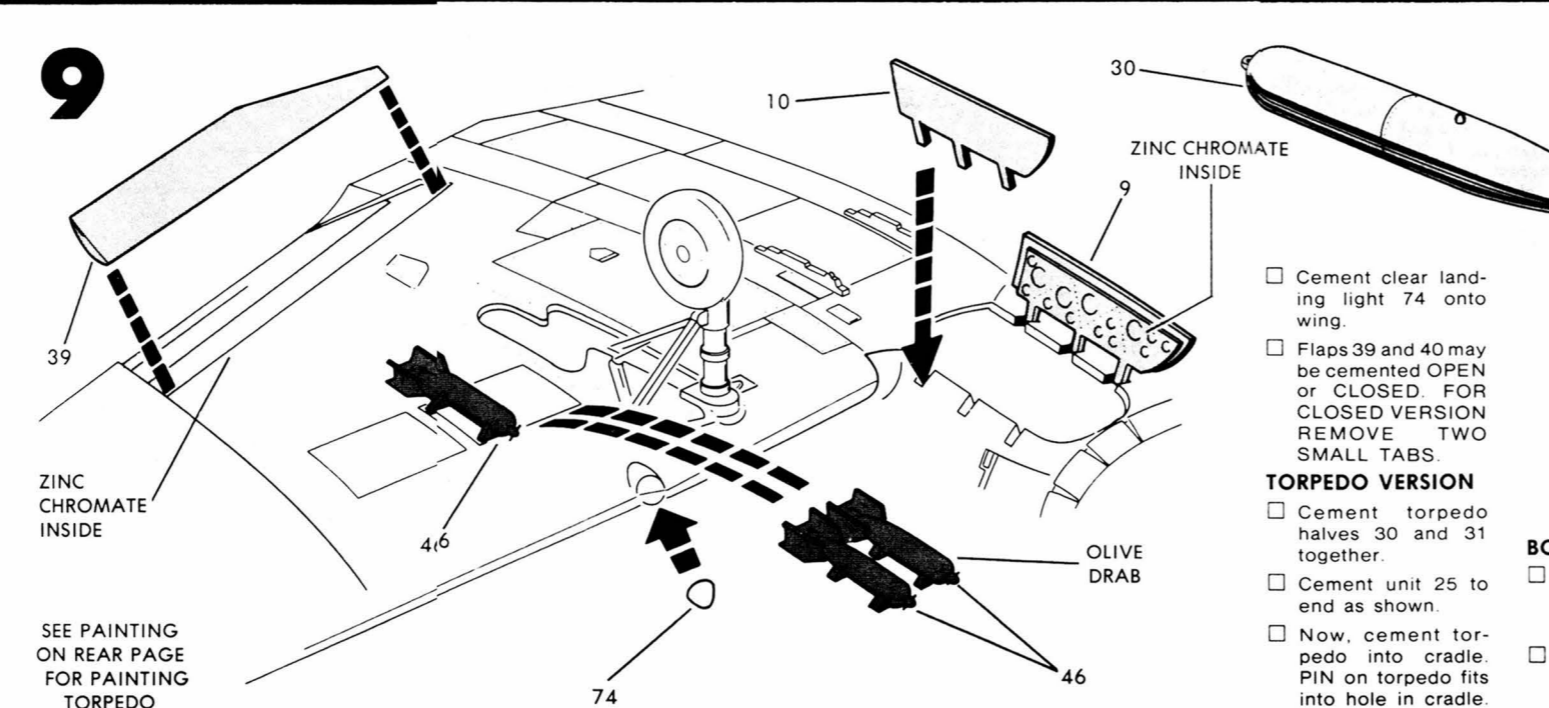

- Cement clear landing light 74 onto wing.
- Flaps 39 and 40 may be cemented OPEN or CLOSED. FOR CLOSED VERSION REMOVE TWO SMALL TABS.
- Cement torpedo halves 30 and 31 together.
- Cement unit 25 to end as shown.
- Now, cement torpedo into cradle. PIN on torpedo fits into hole in cradle.

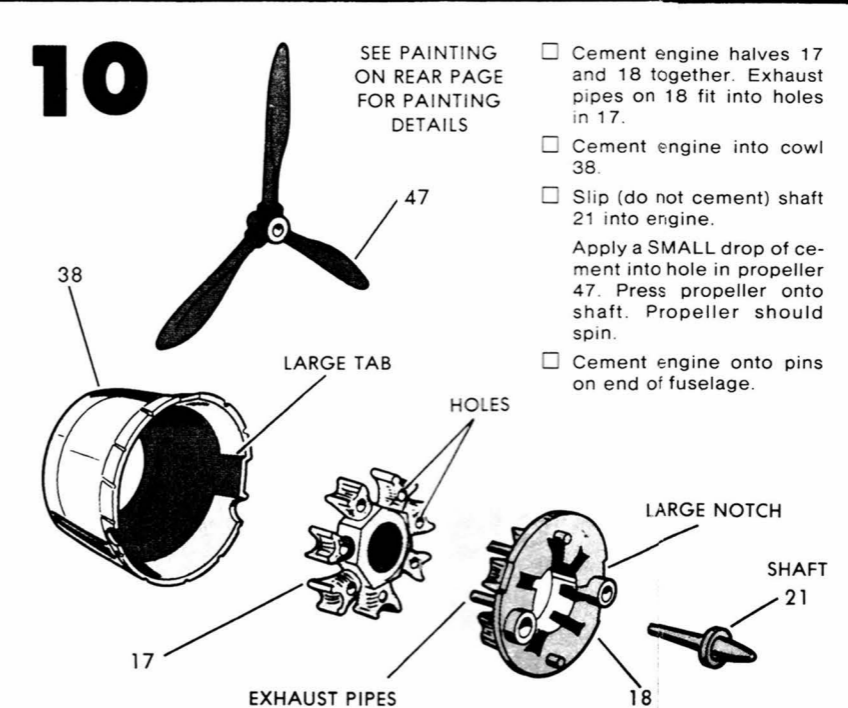

- Cement engine halves 17 and 18 together. Exhaust pipes on 18 fit into holes in 17.
- Cement engine into cowl 38.
- Slip (do not cement) shaft 21 into engine.
- Apply a SMALL drop of cement into hole in propeller 47. Press propeller onto shaft. Propeller should spin.
- Cement engine onto pins on end of fuselage.

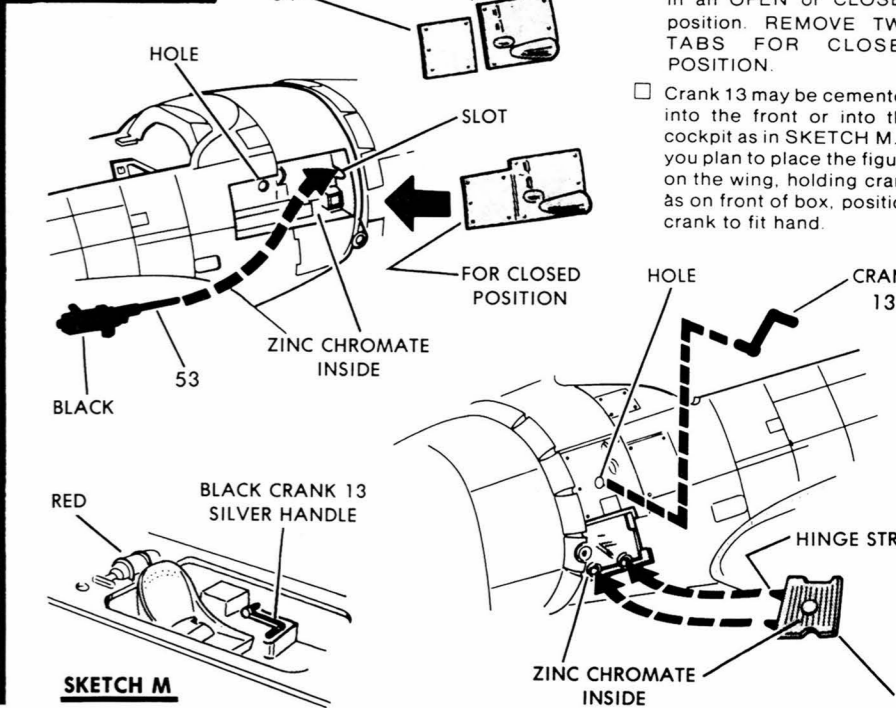

- Cement gun 53 into place.
- Door 54 may be cemented in a closed position or cut as shown and placed on the display surface.
- Door 11 may be cemented in an OPEN or CLOSED position. REMOVE TWO TABS FOR CLOSED POSITION.
- Crank 13 may be cemented into the front or into the cockpit as in SKETCH M. If you plan to place the figure on the wing, holding crank as on front of box, position crank to fit hand.

12

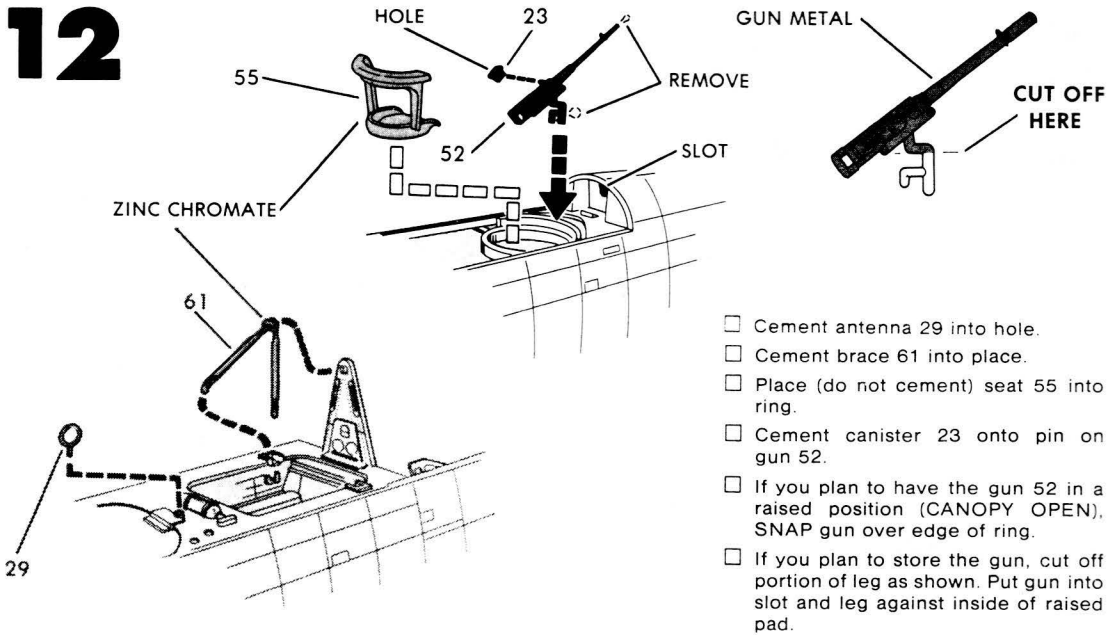

- Cement antenna 29 into hole.
- Cement brace 61 into place.
- Place (do not cement) seat 55 into ring.
- Cement canister 23 onto pin on gun 52.
- If you plan to have the gun 52 in a raised position (CANOPY OPEN), SNAP gun over edge of ring.
- If you plan to store the gun, cut off portion of leg as shown. Put gun into slot and leg against inside of raised pad.

13

BEFORE cementing the clear canopies into position, paint the raised lines. Refer to PAINTING directions.

- Carefully cement front canopy 66 into place.
- Cement sight 22 into holes in canopy.
- Cement antenna 27 into place.

FOR CLOSED CANOPY

- Carefully cement clear pieces 70, 71 and 72 into place.

FOR OPEN CANOPY

- Carefully cement clear pieces 67 and 68 into holes as shown in SKETCH R.
- Cement piece 70 into place.
- Cement piece 72 over piece 70 as shown. ALSO see box photo.

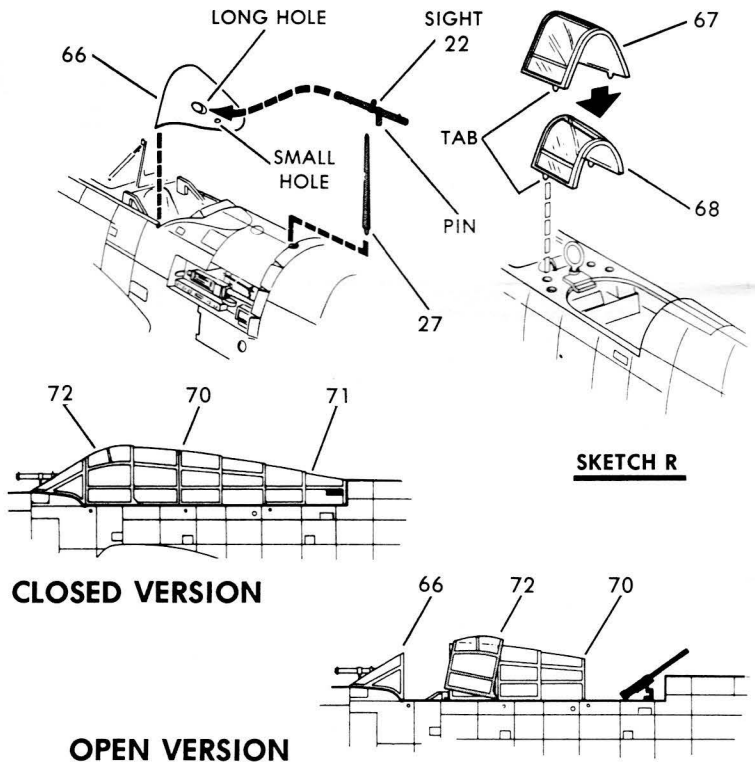

14

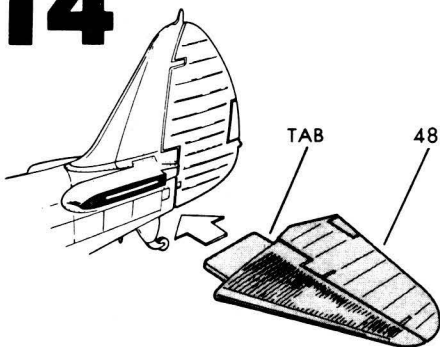

- Cement stabilizers 48 and 49 into fuselage.

15

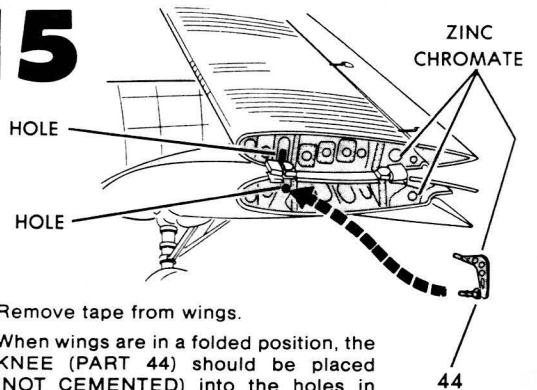

- Remove tape from wings.
- When wings are in a folded position, the KNEE (PART 44) should be placed (NOT CEMENTED) into the holes in ribs. REMOVE knees BEFORE attempting to open the wings.

TBD-1 DEVASTATOR, BUNO 0200
VT-2, USS LEXINGTON, 1939
SQUADRON COMMANDER'S AIRCRAFT

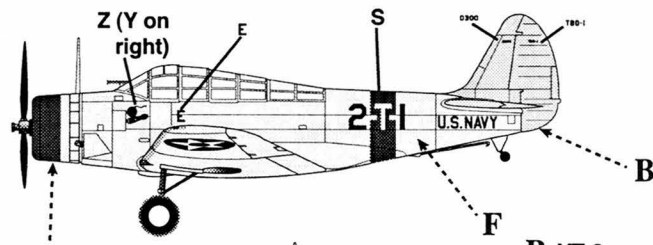

TBD-1 DEVASTATOR, BUNO 0324
VT-6, USS ENTERPRISE, 1939
1ST SECTION, 3RD AIRCRAFT

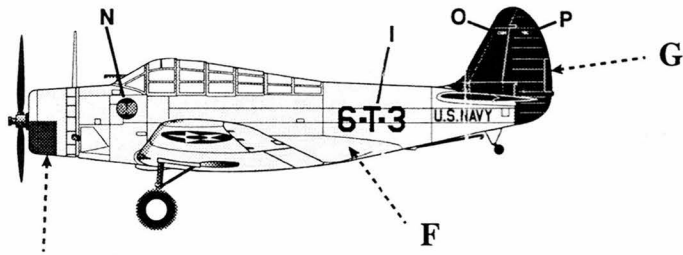

TBD-1 DEVASTATOR, BUNO 0338
VT-8, USS HORNET, 1941
3RD SECTION, 2ND AIRCRAFT

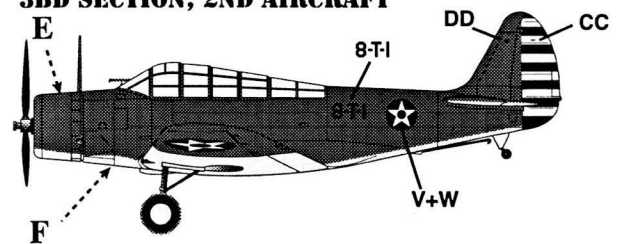

TBD-1 DEVASTATOR, BUNO 0308
VT-6, USS ENTERPRISE, 1942

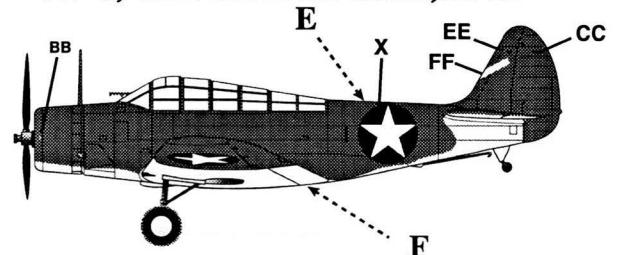

VT-2/VT-6
1939 TOP VIEW

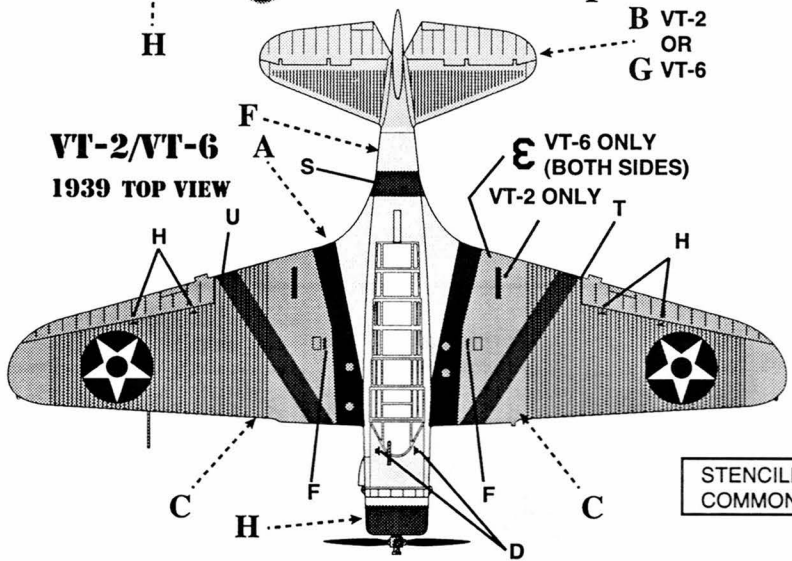

VT-2/VT-6
1939 BOTTOM VIEW

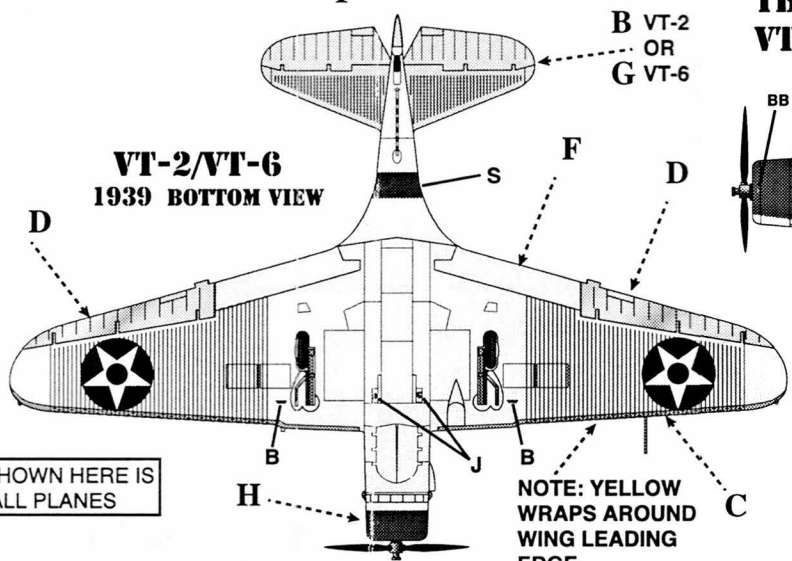

STENCILING SHOWN HERE IS COMMON TO ALL PLANES

VT-8/VT-6
TOP VIEW

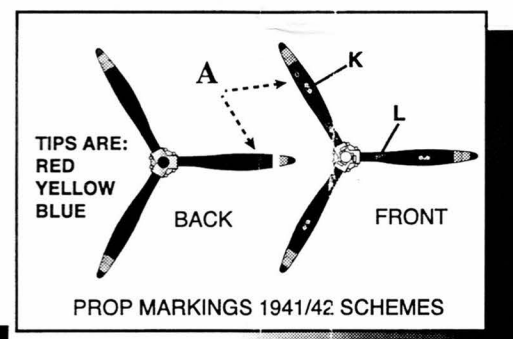
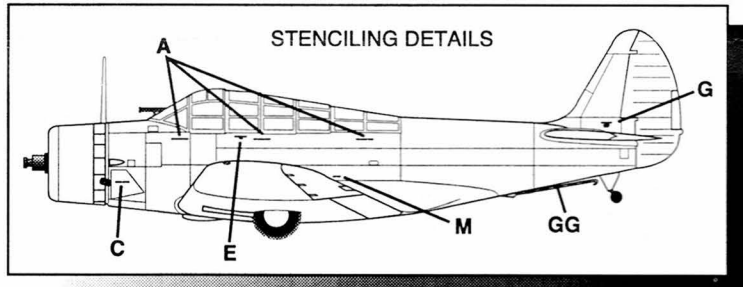
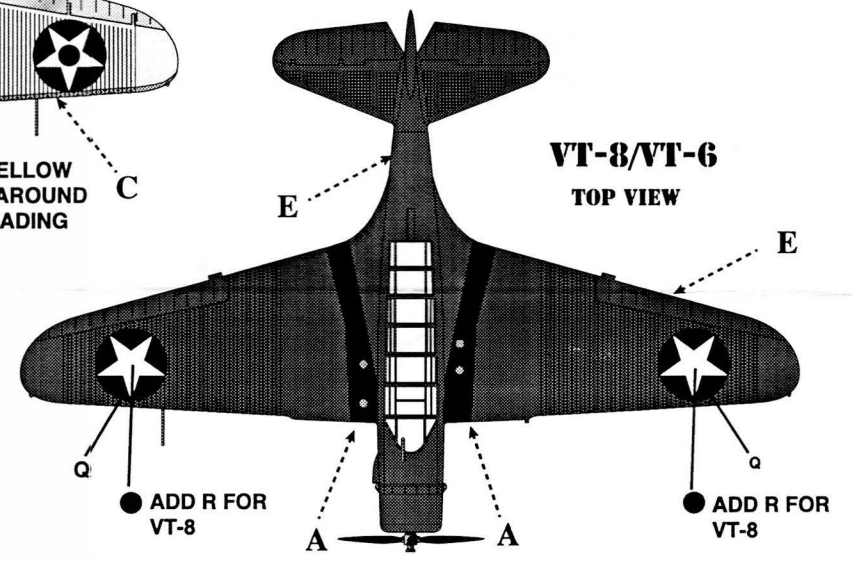

- A** ■ FLAT BLACK
- B** ■ LEMON YELLOW FS 13655
- C** ■ ORANGE YELLOW FS 13538
- D** ■ ALUMINUM PAINT
- E** ■ BLUE GRAY FS 35189
- F** ■ LIGHT GRAY FS 36440
- G** ■ TRUE BLUE FS 15102
- H** ■ INSIGNIA RED FS 11136

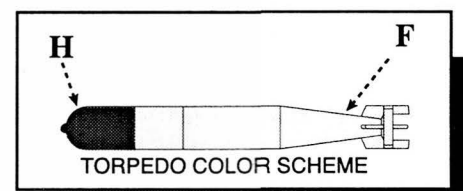
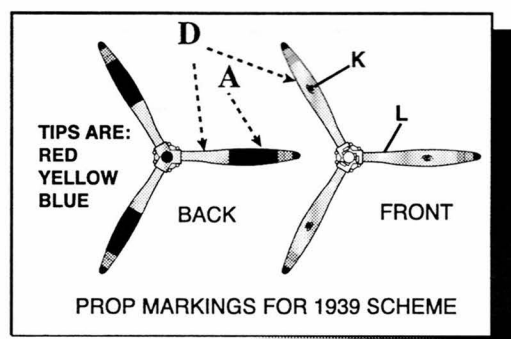

VT-8
BOTTOM VIEW

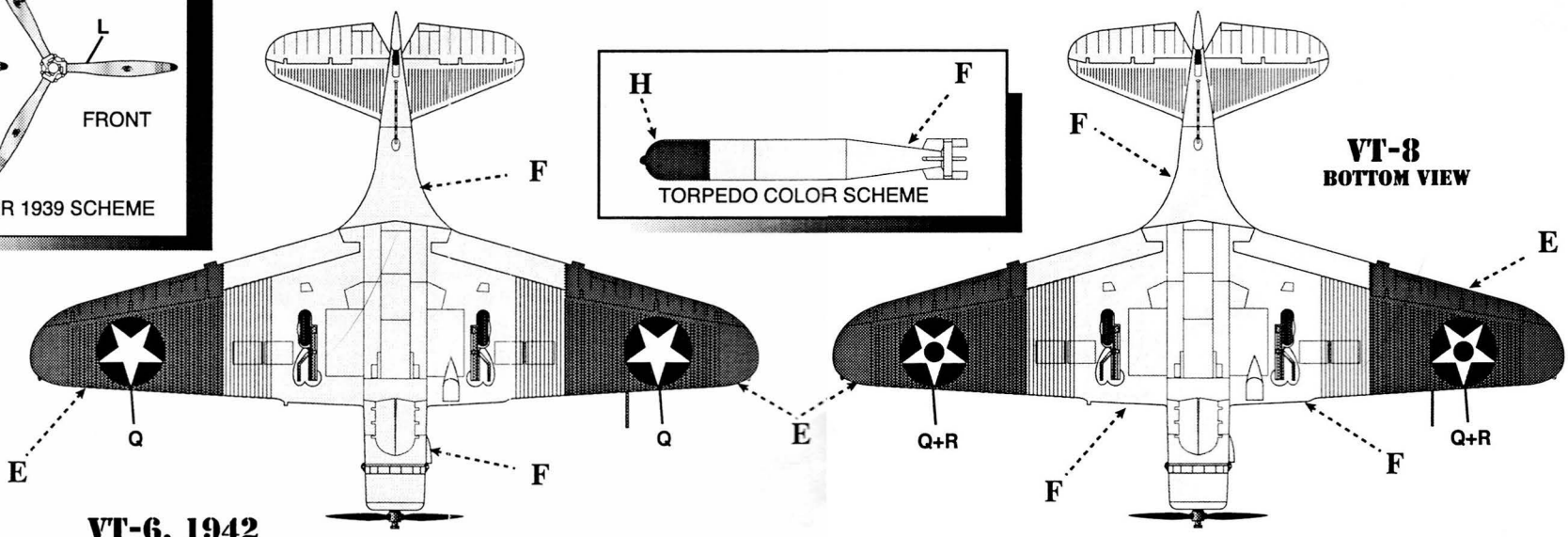

VT-6, 1942
BOTTOM VIEW