



M41A3 LIGHT TANK

"WALKER BULLDOG"



美國M41A3"華克猛犬"輕戰車

M41A3 "Walker Bulldog" Light Tank

During the last days of WWII, the US Army were equipped with M24 light tank armed with a 75mm gun, primarily operated for reconnaissance missions. Despite the war had almost come to an end, a newer light tank was still under development, with the Russian T34/85 as its potential opponent. In 1949, a prototype designated the T-41 gained satisfactory result in trails. After further development, prototypes T-41E1 and T-41E2 were formally designated as M41 and M41A1 respectively in 1951, nicknamed "Little Bulldog". Besides the difference on turret welding, the latter also has a newer gun stabilizing system. The M41 was later amended to the "Walker Bulldog" in honour of Lt. Gen. Walton H. Walker, who had been killed in a car accident during the Korean War.

The main armament of the M41, the M32 gun, was the first cannon with an evacuator, which was capable of preventing poisonous gas leaking into personnel cabin. Additionally, its T-muzzle break was able to conduct gas to both sides, in order to provide clear view for further firing. Although it only had a caliber of 76.2mm, the M32 was even more powerful than its 90mm contemporary.

The Continental AOS-895-3 gasoline engine of M41/M41A1 suffered from limited mileage, later developed M41A2 and M41A3 thus adopted newer AOS1-895-5 engine. An engine-driven component for the turret was also added, resulting in the exhaust pipe to extrude from the right chassis, which had become its most distinguishing characteristic in appearance. Additionally, the gun of the M41A3 had 65 riflings, where as the previous versions only had 57. Together with modifications on the interior, the M41A3 became the most produced version among the M41 series, and was serving the Army of the Republic of Vietnam in large quantity during the Vietnam War.

The M41 can be deployed with transportation aircraft. In addition to its service in the US Army, the M41 is still in service with many countries after continuous improvement and service life extending modifications.

M41A3輕戰車 ウォーカーブルドッグ

第2次大戦末期、米陸軍は75mm砲を搭載したM24軽戦車を偵察を主任務として配備していました。戦いはほとんど終わりに近づいていましたが、ソビエトのT34/85に対抗できる軽戦車の開発は継続され、1949年に試作が完了したT-41が満足いく結果を残したため、引き続きT-41E1とT-41E2が試作されました。これが1951年制式採用され、「リトルブルドッグ」と呼ばれたM41とM41A1となったのです。砲塔の溶接の違いに加え、後者には新しい射撃安定装置が搭載されていました。後にM41は、朝鮮戦争中に交通事故で殉職したW. H. ウォーカー中將の栄誉を称え、「ウォーカーブルドッグ」と改称されました。

M41の主武装は、初めて排気装置を装備したM32 76.2mm砲で、これにより乗員室内への有毒な燃焼ガスの流入を防ぐ事ができました。さらにT型のマズルブレーキは発射煙を左右に排出する事により、射撃後の視界を良好に保つ事ができ、次の照準を容易にしました。口径こそ76.2mmでしたが、同時代の90mm砲より強力なものでした。

M41とM41A1に搭載されたコンチネンタルAOS-895-3ガソリンエンジンは、航続距離不足に苦しめられたため、後に製造されたM41A2とA3には、新型のAOS1-895-5エンジンが搭載されることとなりました。砲塔旋回用の駆動ユニットが取り付けられたため、右側シャーシから排気管が飛び出す結果となり、これが外観上もっとも特徴的なものとなっています。さらに砲身も57ライフレングより65ライフレングへと延長されました。車内の改良と合わせ、M41A3はM41シリーズ中もっとも多く生産された型となりました。ベトナム戦争中は、南ベトナム陸軍にも多数が供与され、全期間を通し使用されていました。

M41は、輸送機での展開が可能でした。今なお、米陸軍だけではなく、さまざまな改良や耐用年数を延ばす改造を加えられながら、多くの国で使用されています。

M41A3華克猛犬輕戰車

二次大戰末期美國輕戰車的主要規格為擁有75mm砲的M24輕戰車,在戰場上主要擔任偵察的任務,雖然戰爭已近尾聲,但以蘇聯T34/85為假想對手的新一代輕戰車的計劃仍在進行中,1949年編號T-41的原型車測試成功,並據此進行下一步的改良,T-41E1與T-41E2兩種原型車於1951年授與制式編號,分別為M41及M41A1,並被暱稱為"小牛頭犬"(little bulldog)兩者間除了砲塔焊接方式不同外,M41A1更擁有較新的砲身穩定系統,其後為紀念韓戰期間因車禍事故身亡的華克中將(Lieutenant General Walton H. Walker.),遂更名為"華克猛犬"(Walker bulldog).

M41輕戰車使用的M32型主砲為美國戰車中率先採用了排煙器(evacuator)的設計,能夠有效防止有毒瓦斯進入車身,而T字型的砲口制退器(muzzle brake)更能將砲口的瓦斯迅速往左右散開,避免妨礙次發彈的射擊。雖其口徑僅為76.2mm但威力尤勝當時90mm口徑火砲。

由於M41及M41A1使用的大陸(Continental)AOS-895-3汽油引擎續航力不足,隨後生產的M41A2與M41A3採用新型發動機AOSI-895-5,砲塔同時修改為由引擎驅動,因此,車身右側延伸出的副排氣管成為外觀上最大的特徵,而M41A3的主砲膛線由57條增加為65條,加上部分內裝的更改,成為M41戰車中產量最高的一型,曾於越戰時大量裝備南越陸軍。

M41輕戰車可藉由運輸機進行布署,除了在美軍中服役外,不斷的改良及延壽計劃,使得M41今日仍然在許多的國家繼續的服役當中。

Illustration:圖示說明



Method For Applying Decals:

1. Clean Model Surface With Wet Cloth.
2. Cut Out Of Decal Sheet And Dip Them In Water For 15 Seconds.
3. Place it on proper position on model.
4. Slide off base paper leaving decals On Model With Wet Finger Tip.
5. Move Decals To Exact Position, Push Out Excess Water Under Decal With Soft Cotton Cloth.
6. When Decals Get Dry Then Complete.

水貼紙使用說明:

1. 將模型表面擦乾淨
2. 將貼紙剪下泡入清水中約15秒
3. 將泡濕之貼紙取出置於欲貼處旁
4. 用指尖輕推貼紙表面使其滑出底紙
5. 將貼紙調整至適當位置並輕擦拭水份
6. 待其自然乾燥後即完成

Color list: 塗料表

Color	Brand	GSI Creos (Gunze Sangyo)			Humbrol	Revell	Life Color
		Hobby Color	Mr. Color	Mr. Color Spray			
Olive drab(2)	橄欖綠	H-78	C-38	J-38	66	46	UA106
Khaki green	卡其綠	H-80	C-54				
Steel	黑鐵	H-18	C-28	J-28	53	91	LC76
Tire black	輪胎黑	H-77	C-137		85	302	
Bright blue	寶藍	H-15	C-65	J-65	14	51	LC60
Red brown	紅褐	H-47	C-41	J-41	160	383	
Khaki	卡其	H-81	C-55		159		
Olive green	橄欖綠		C-120		86	361	UA002
Field green	野戰綠	H-340	C-340		161		

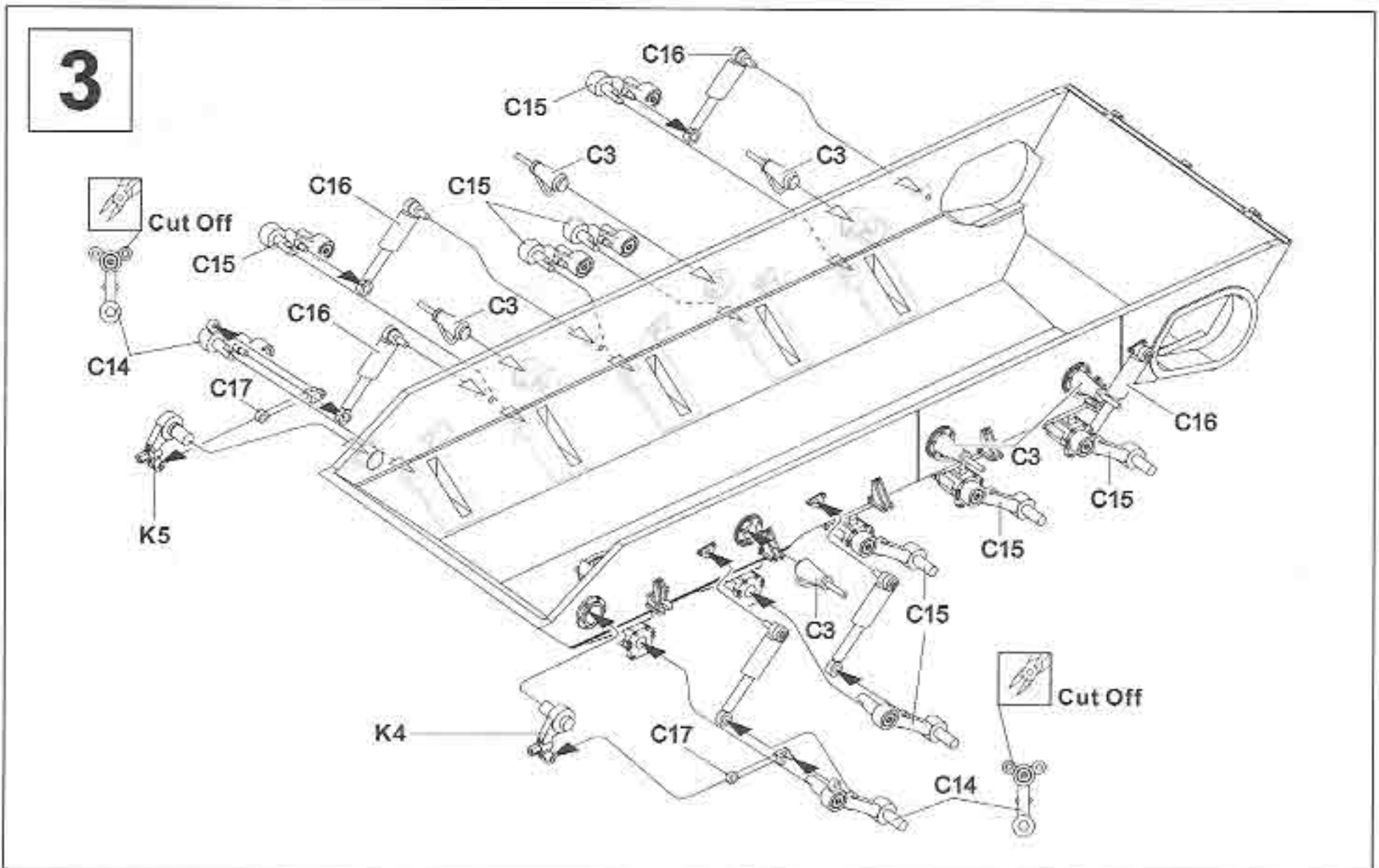
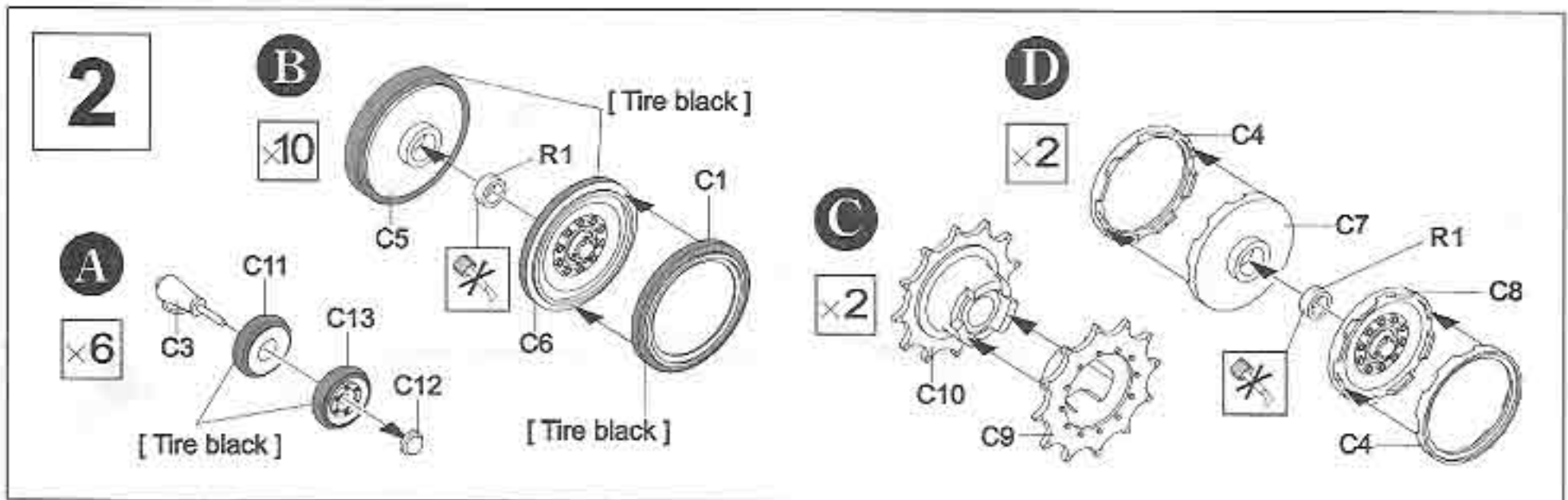
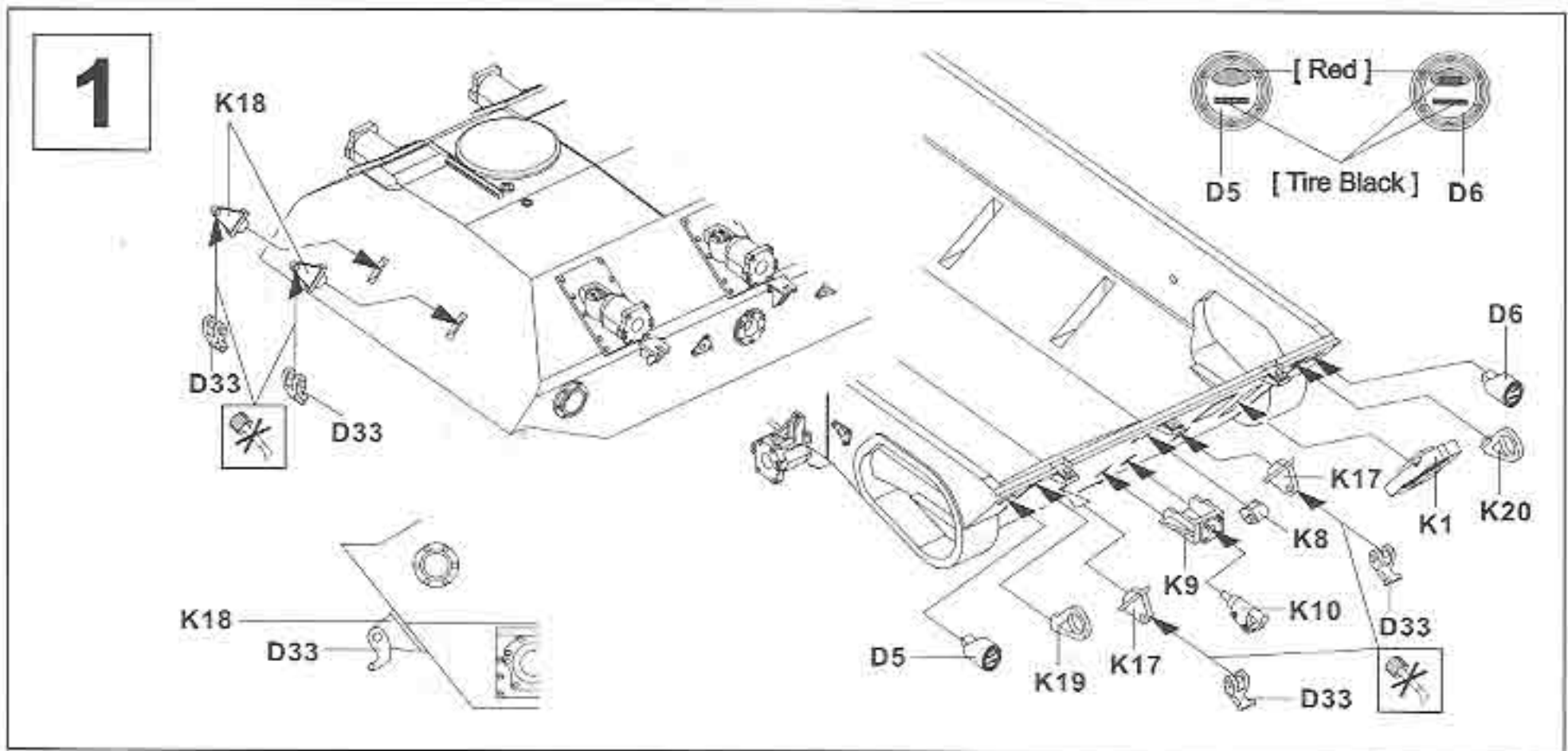

4

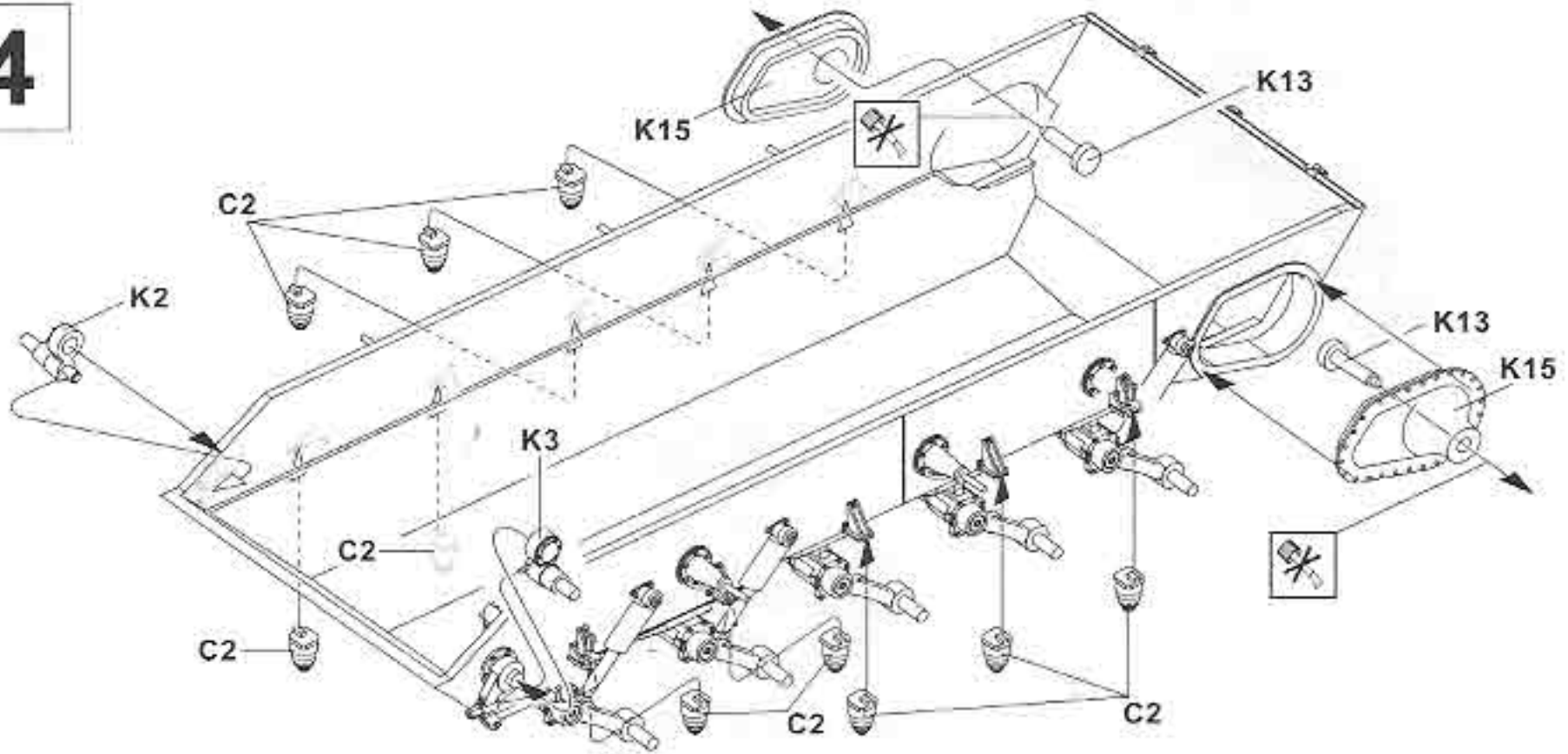

5

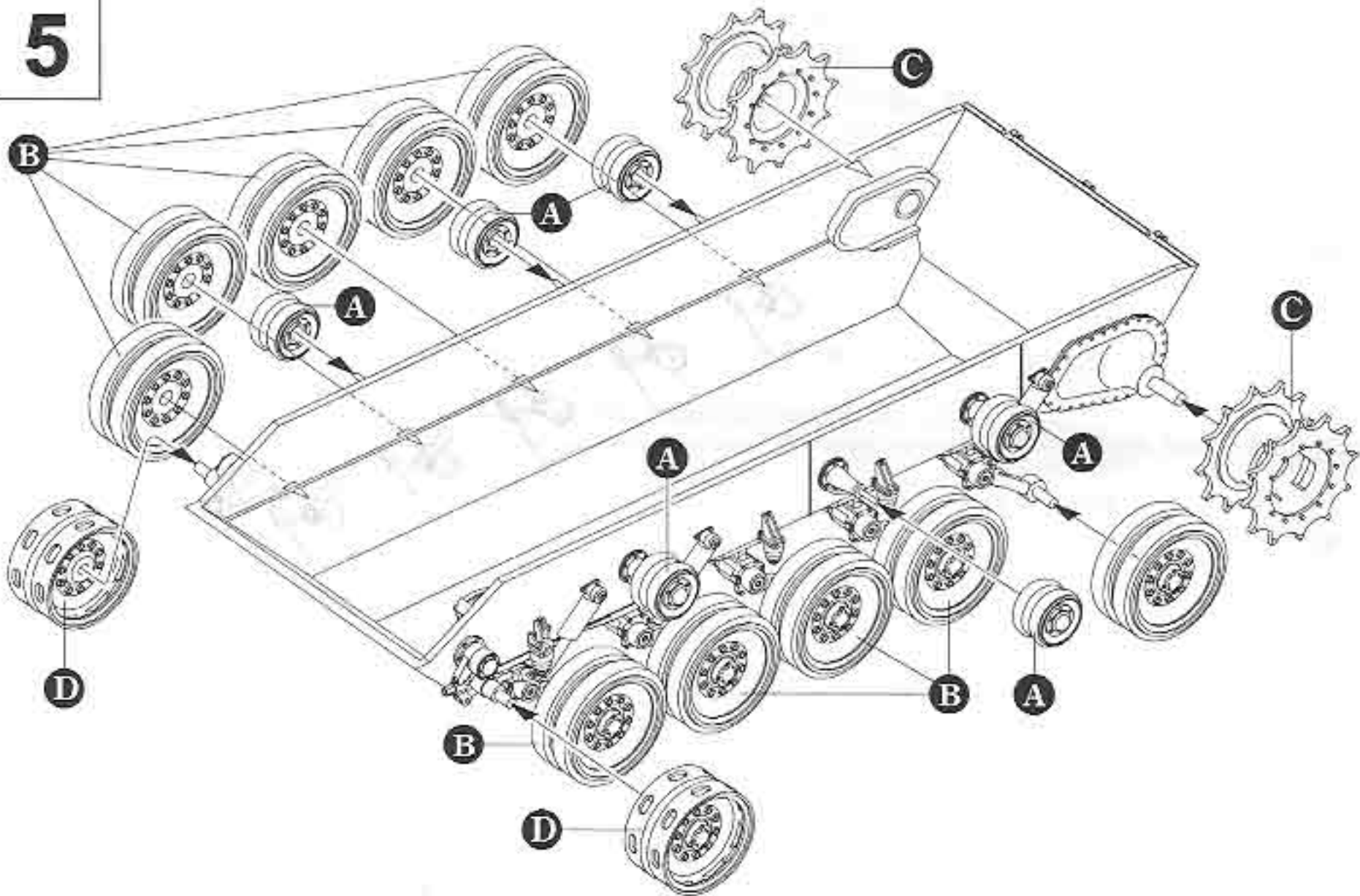

6

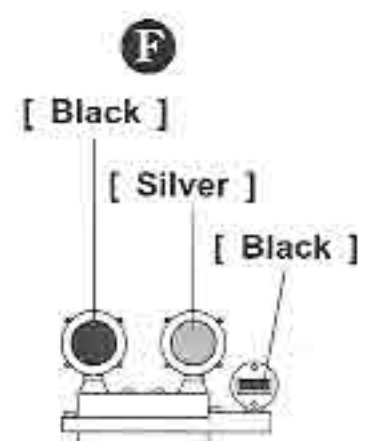
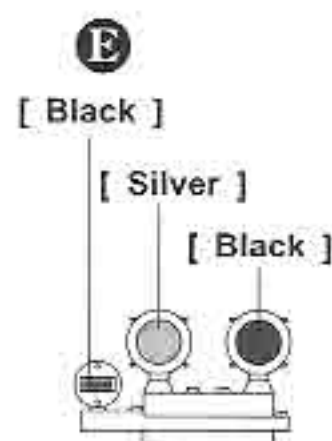
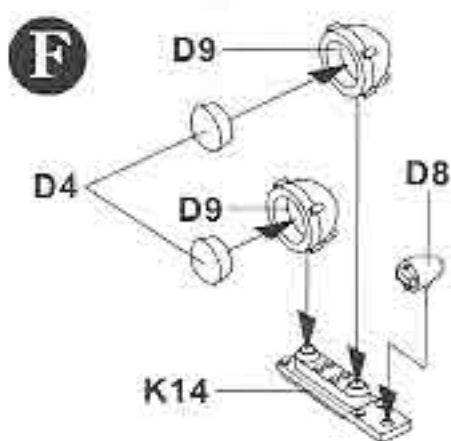
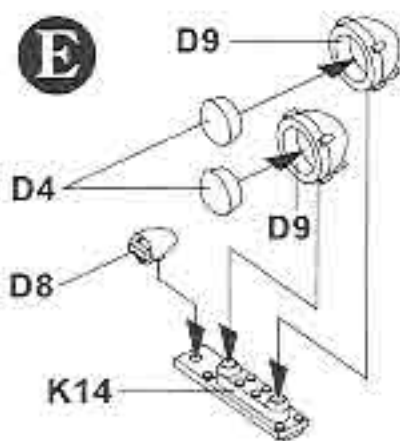

7

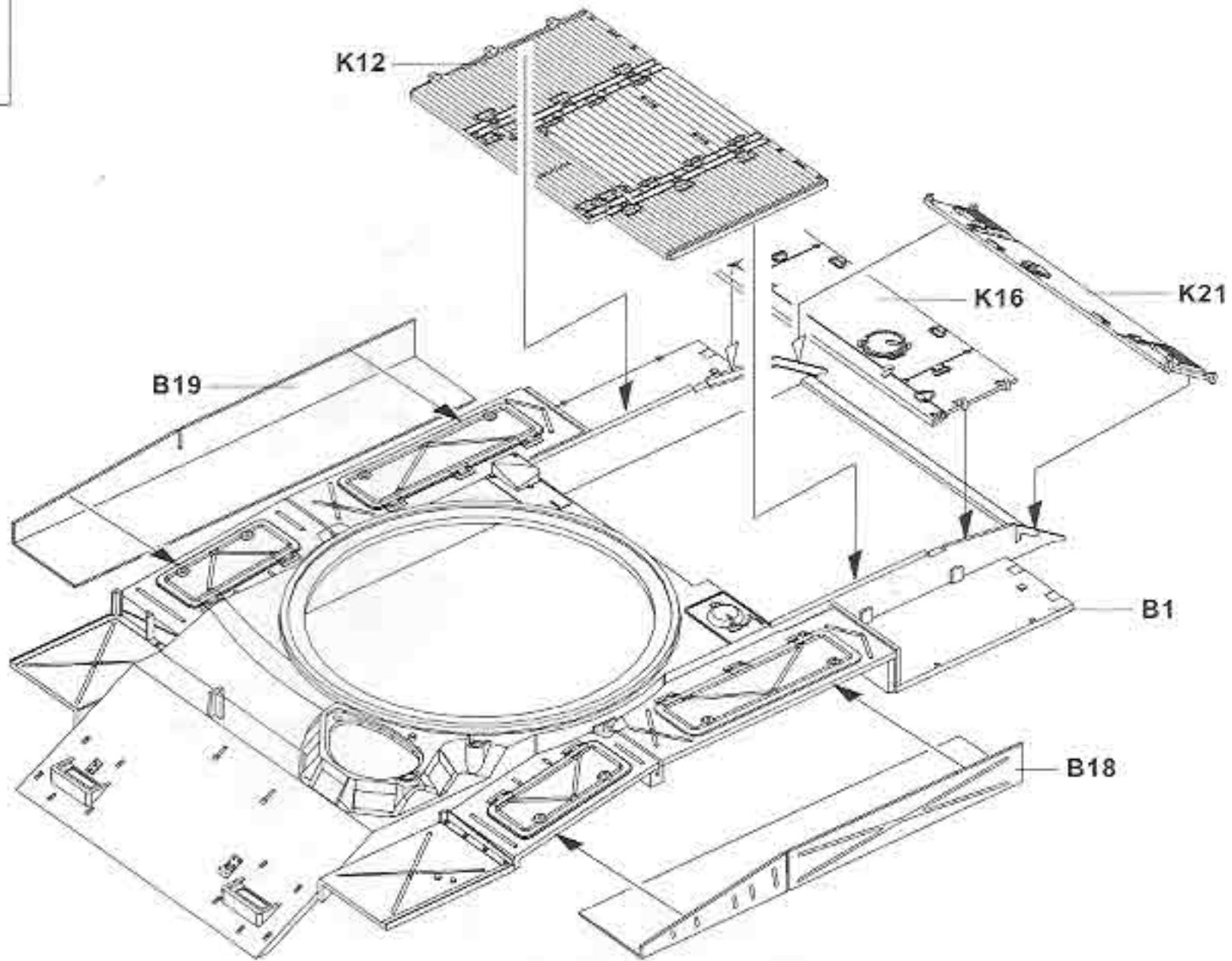

8

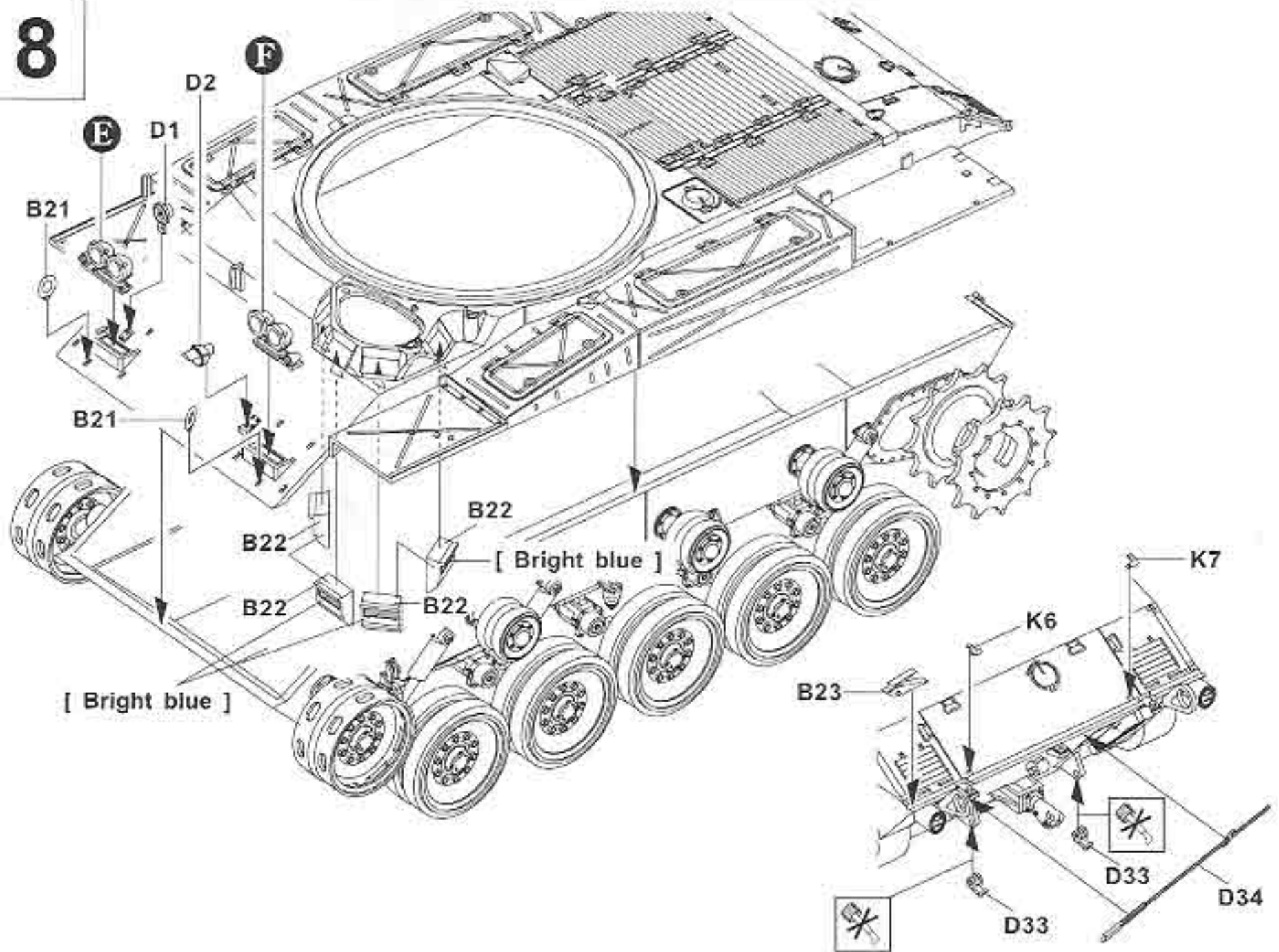

9

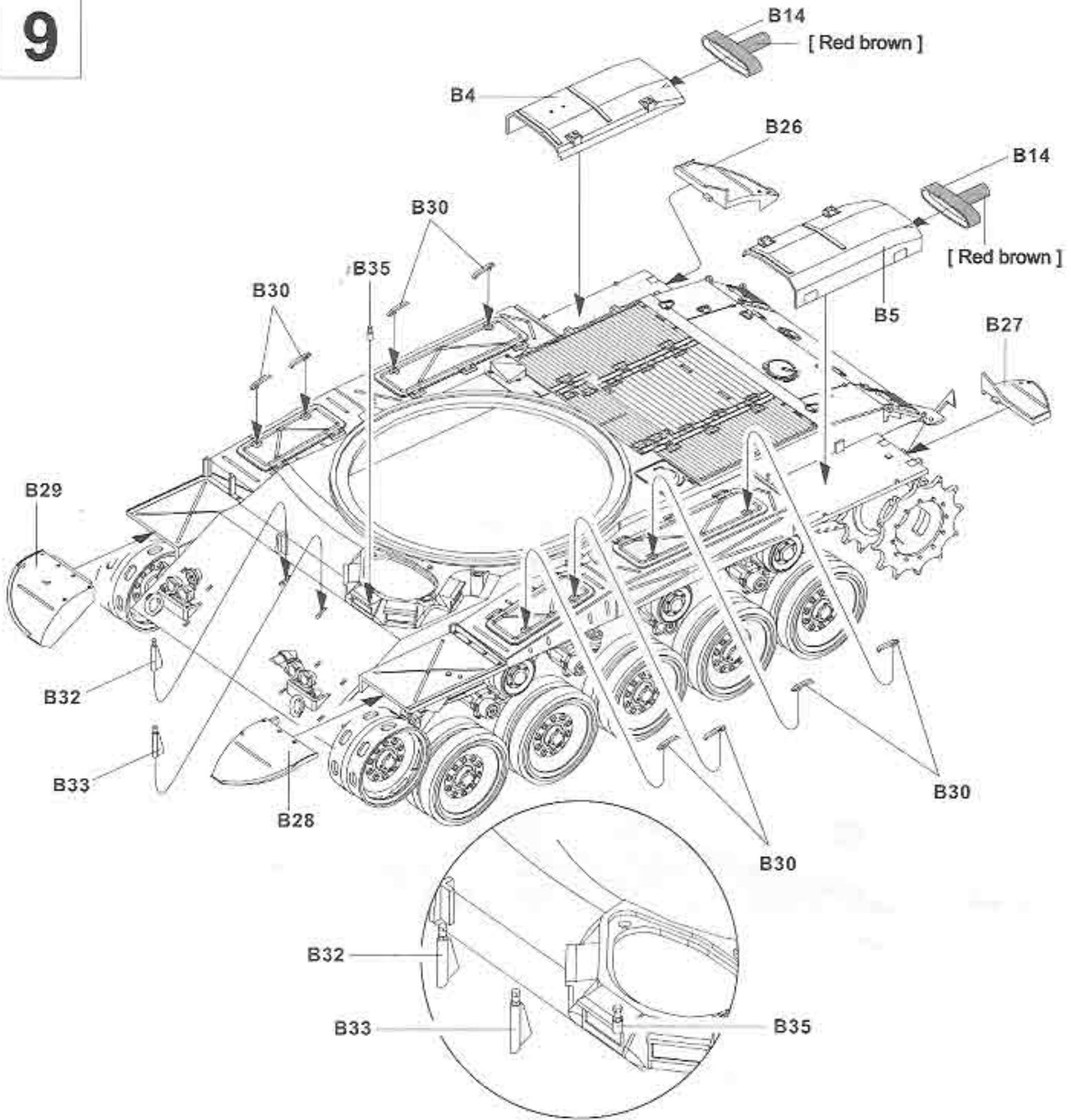

10

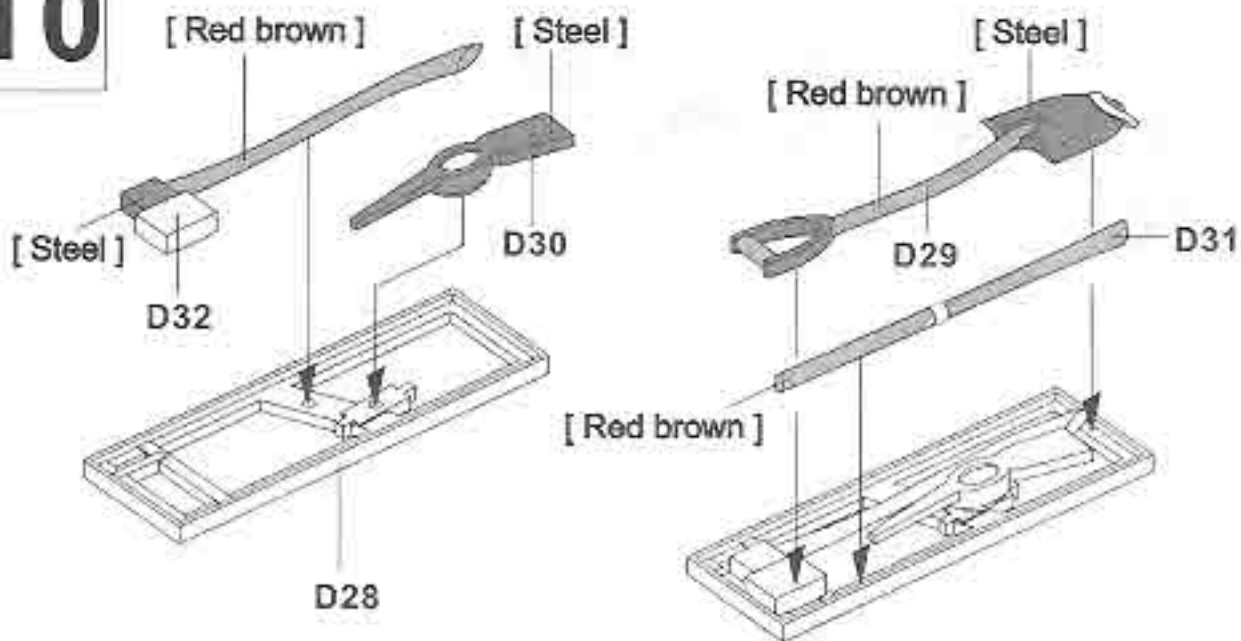

G

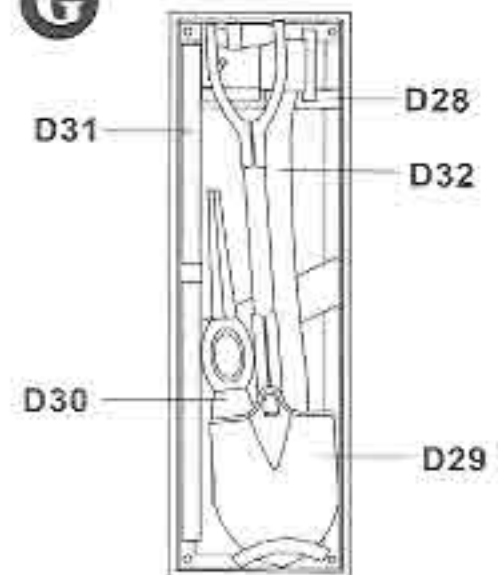

11

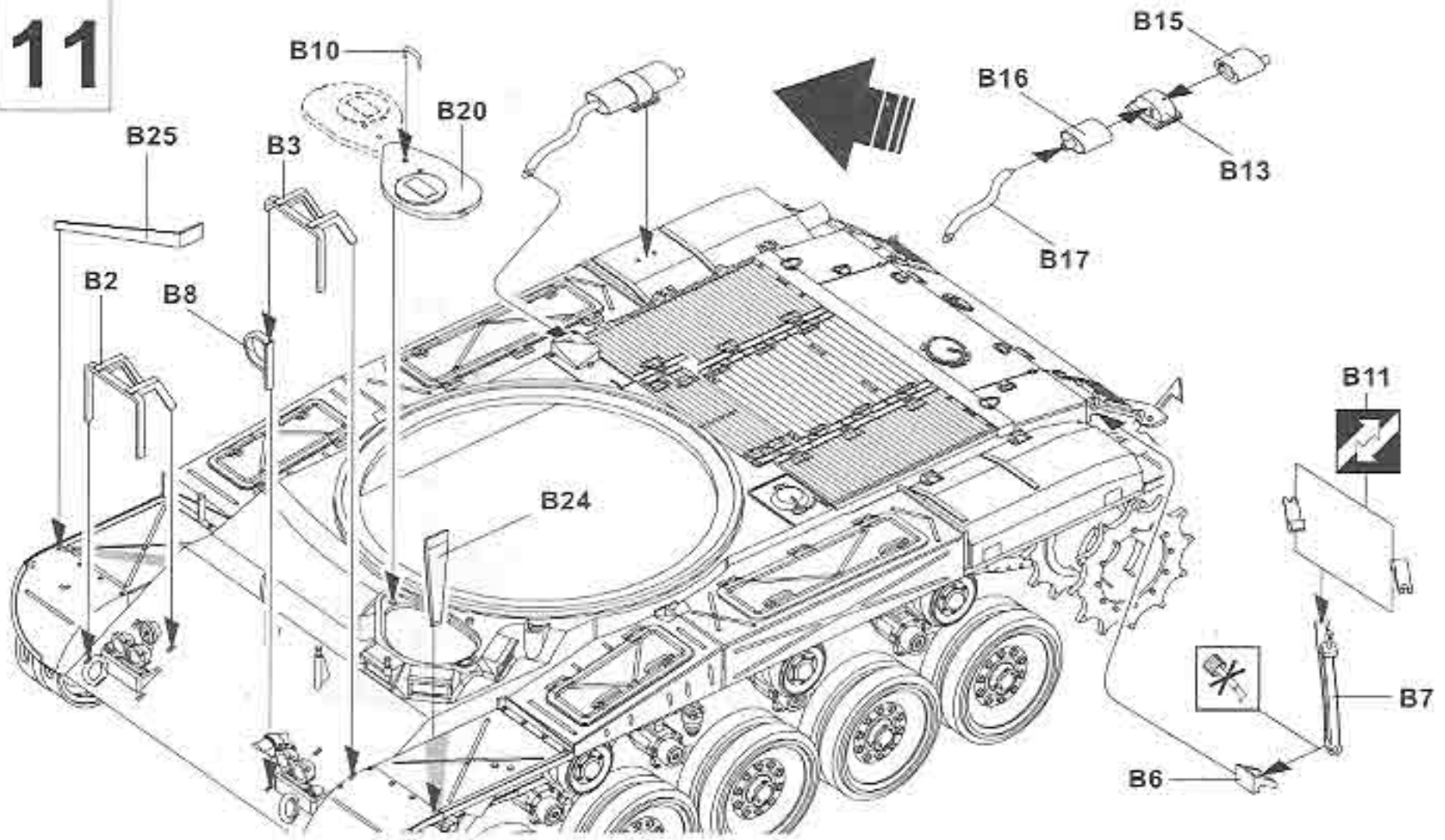

12

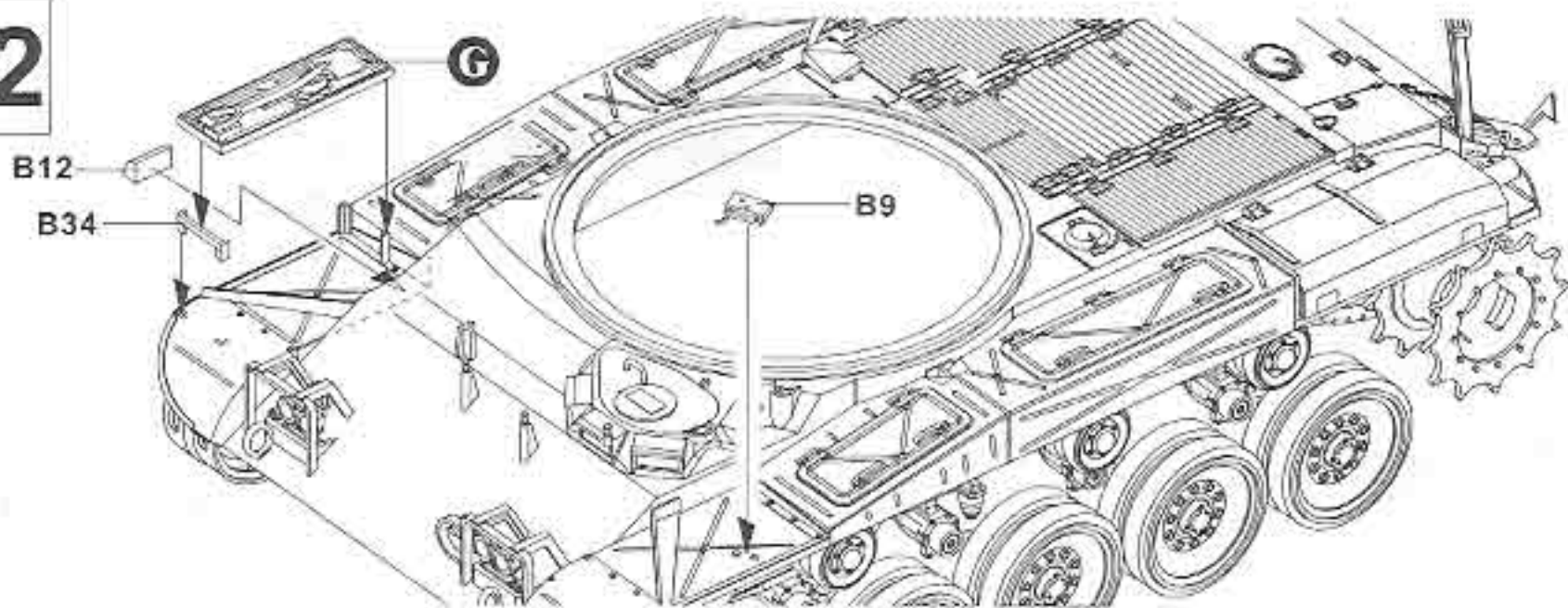

13

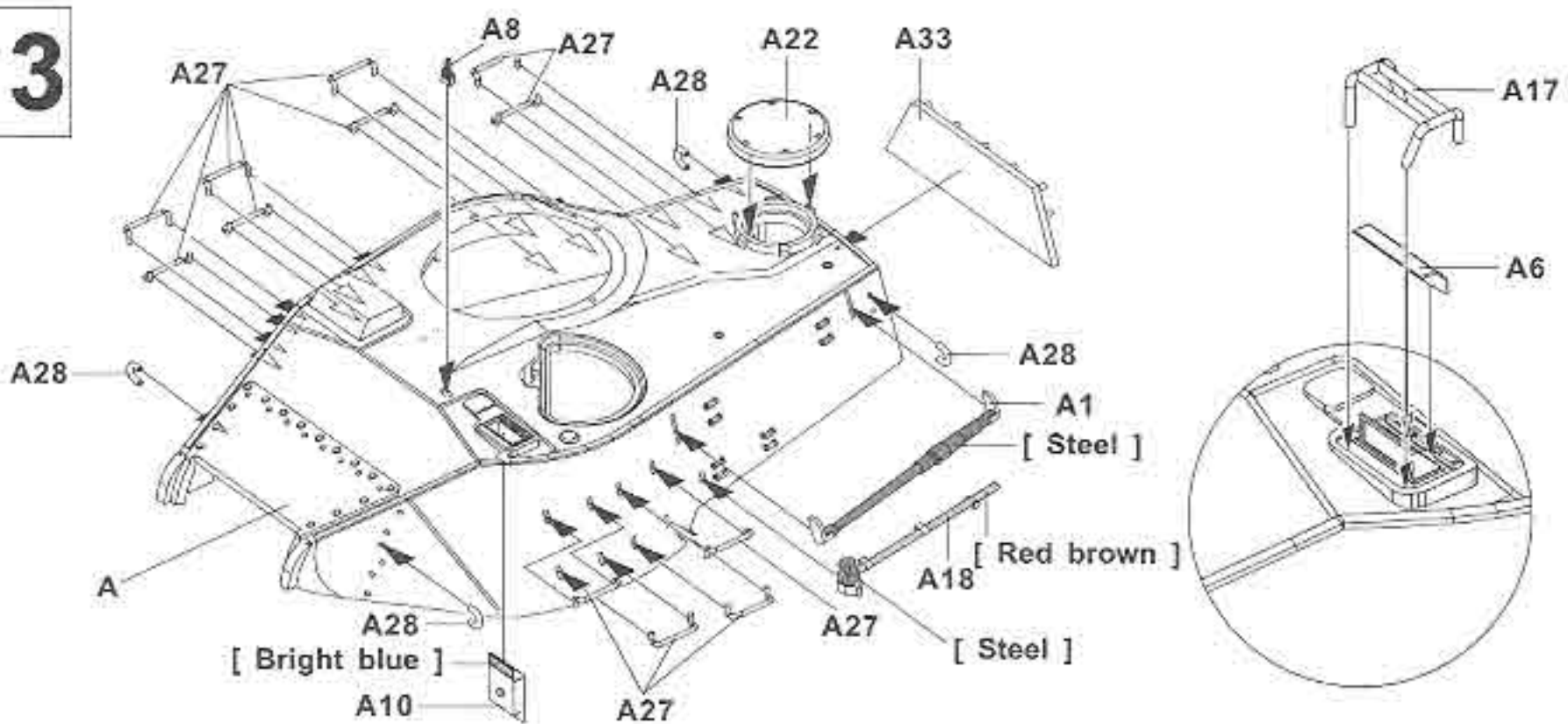

14

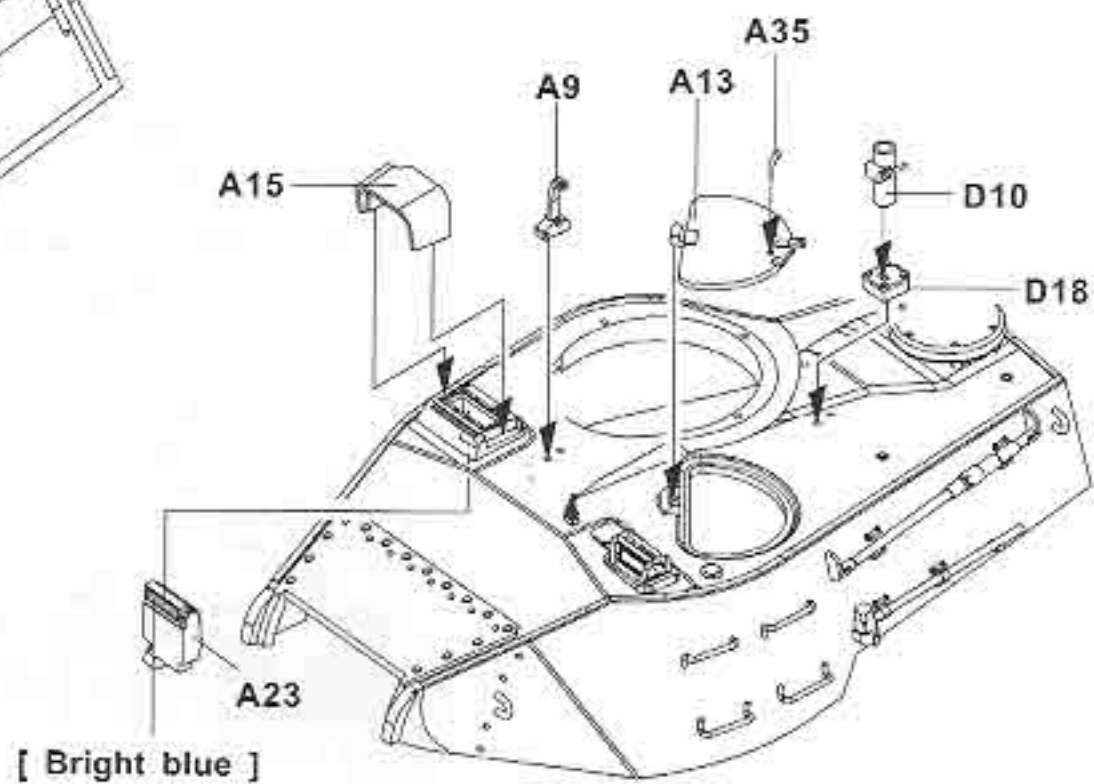
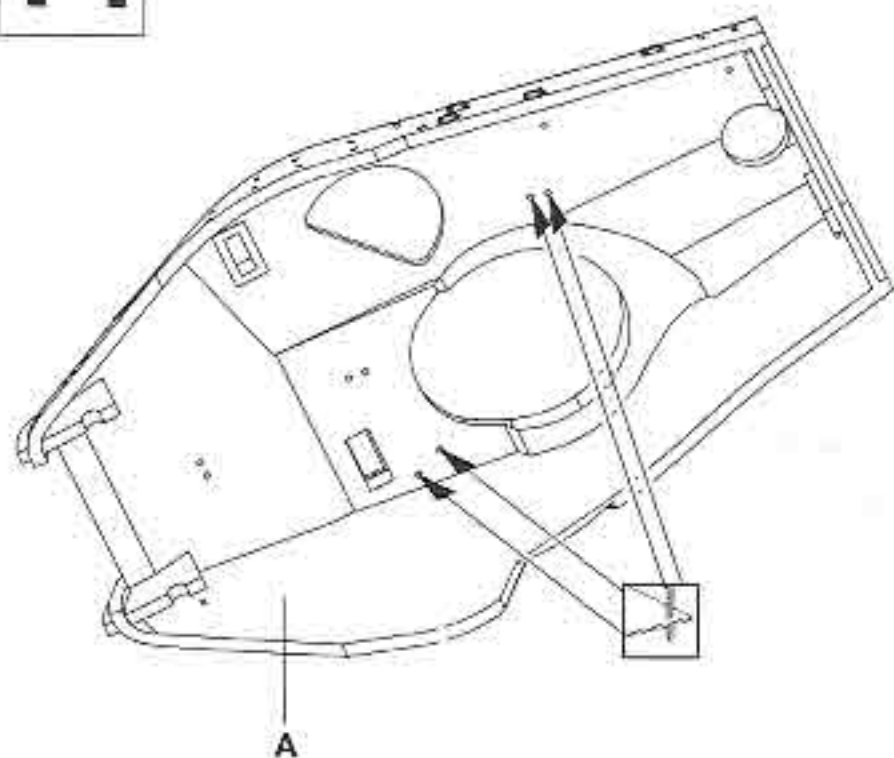

15

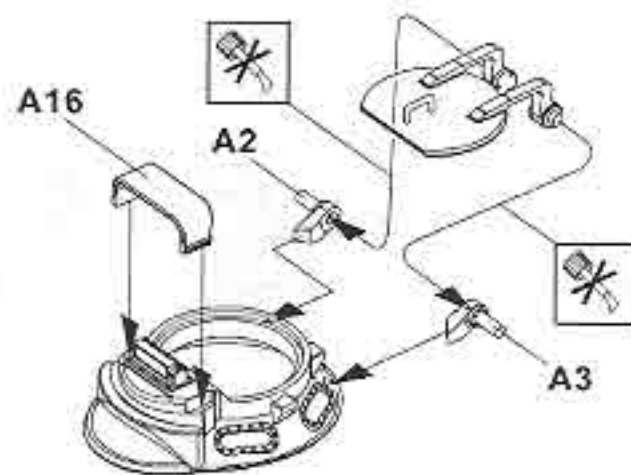
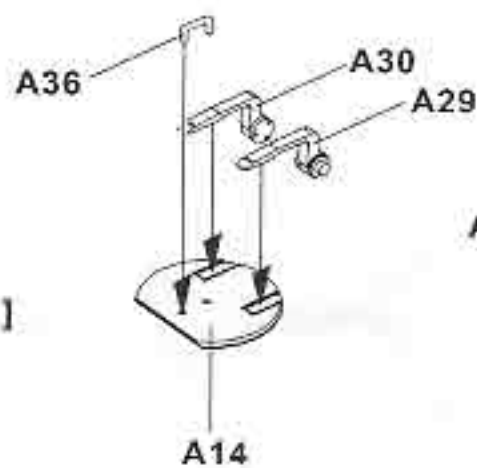
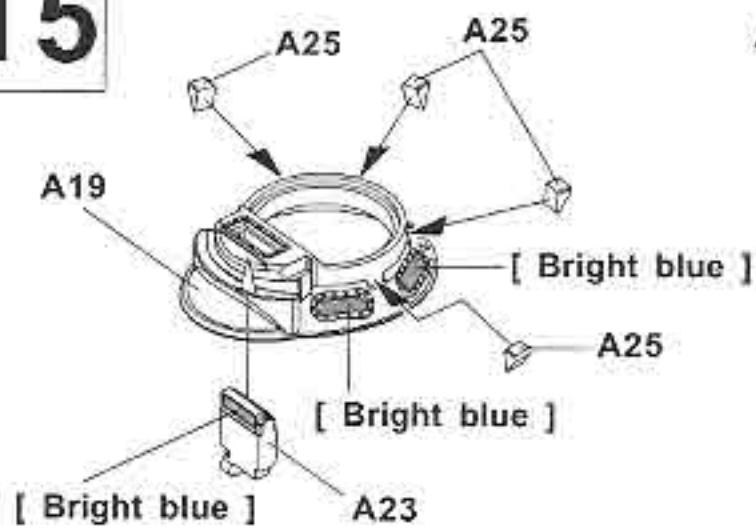

16

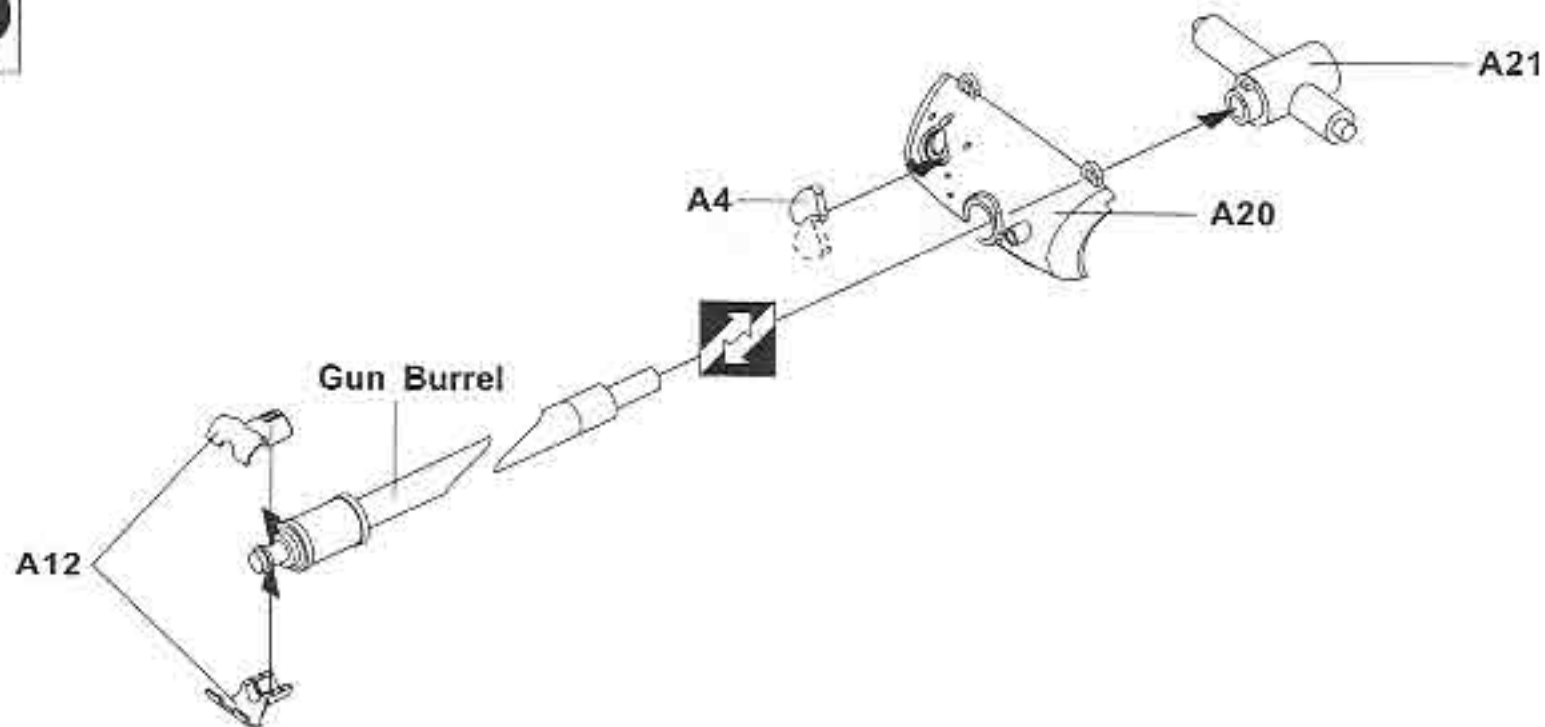

17

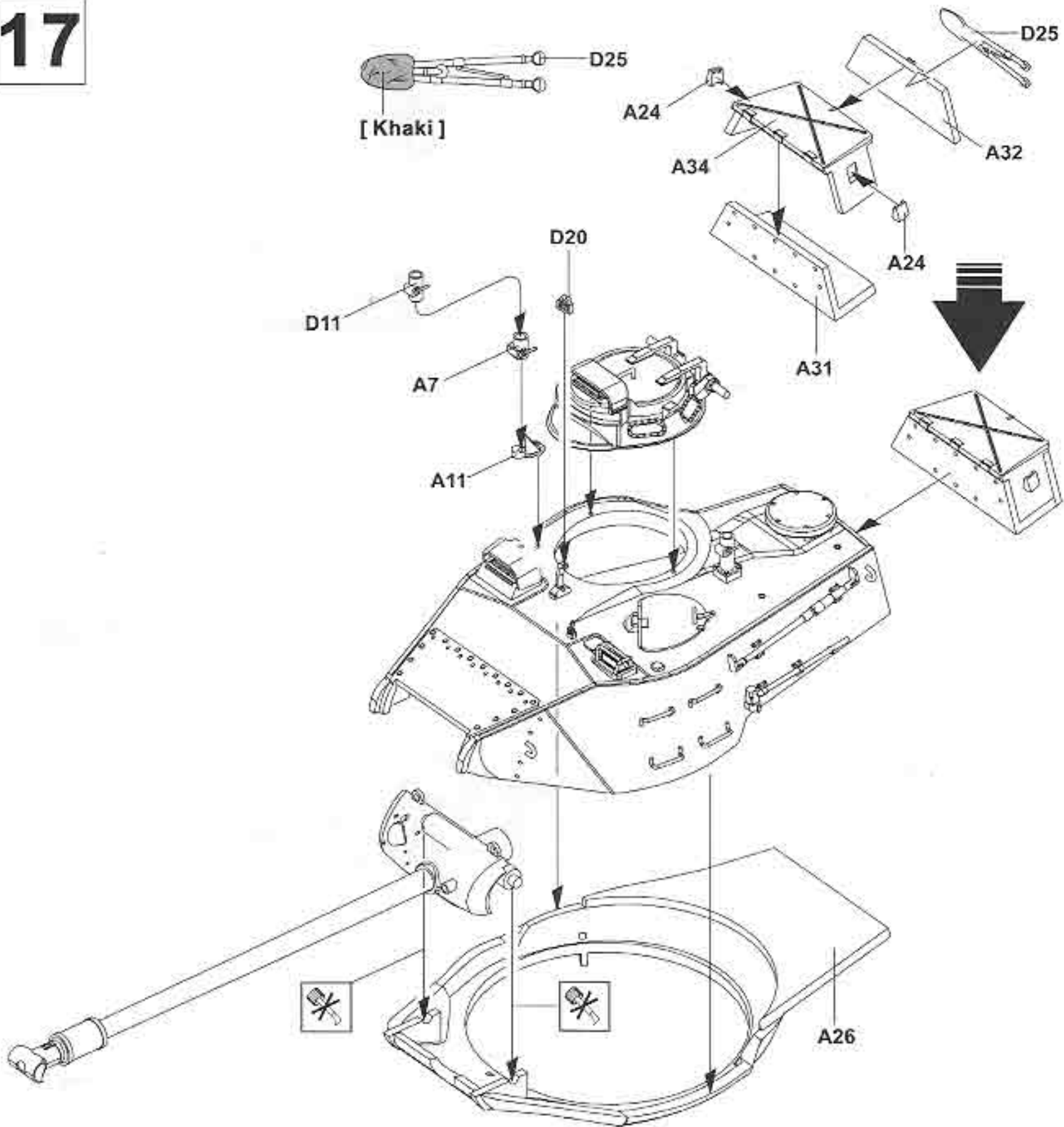

18

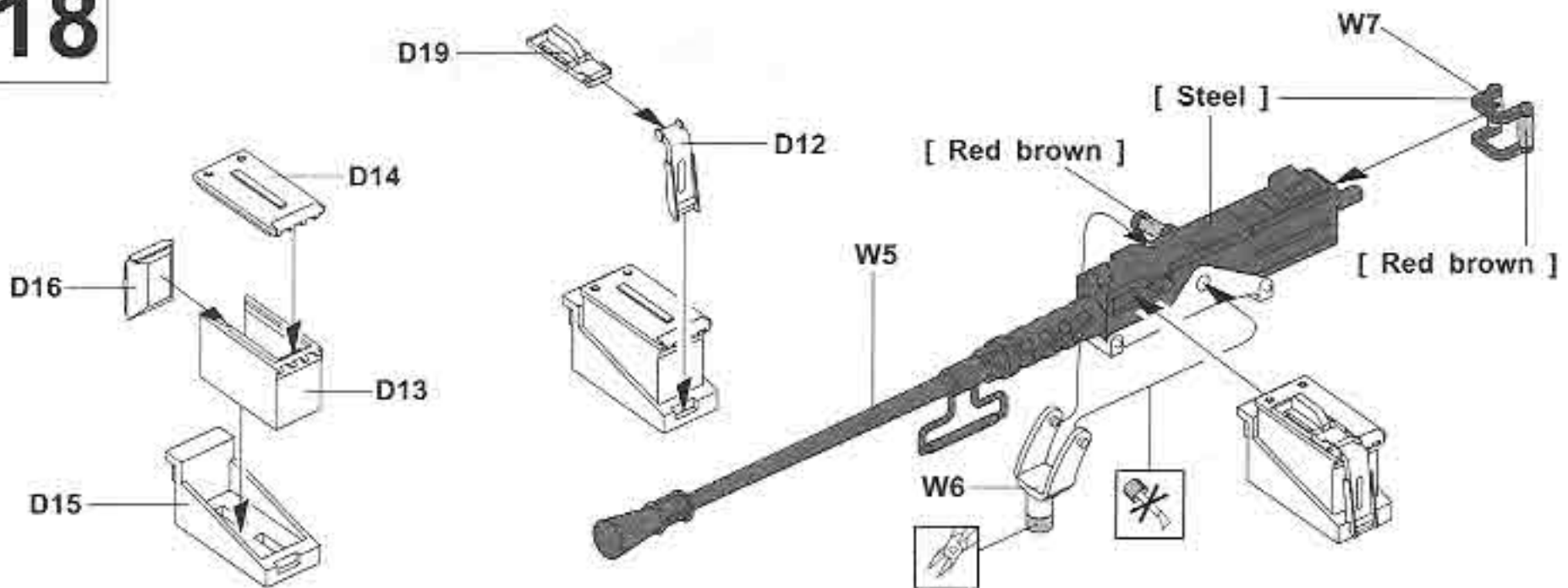

19

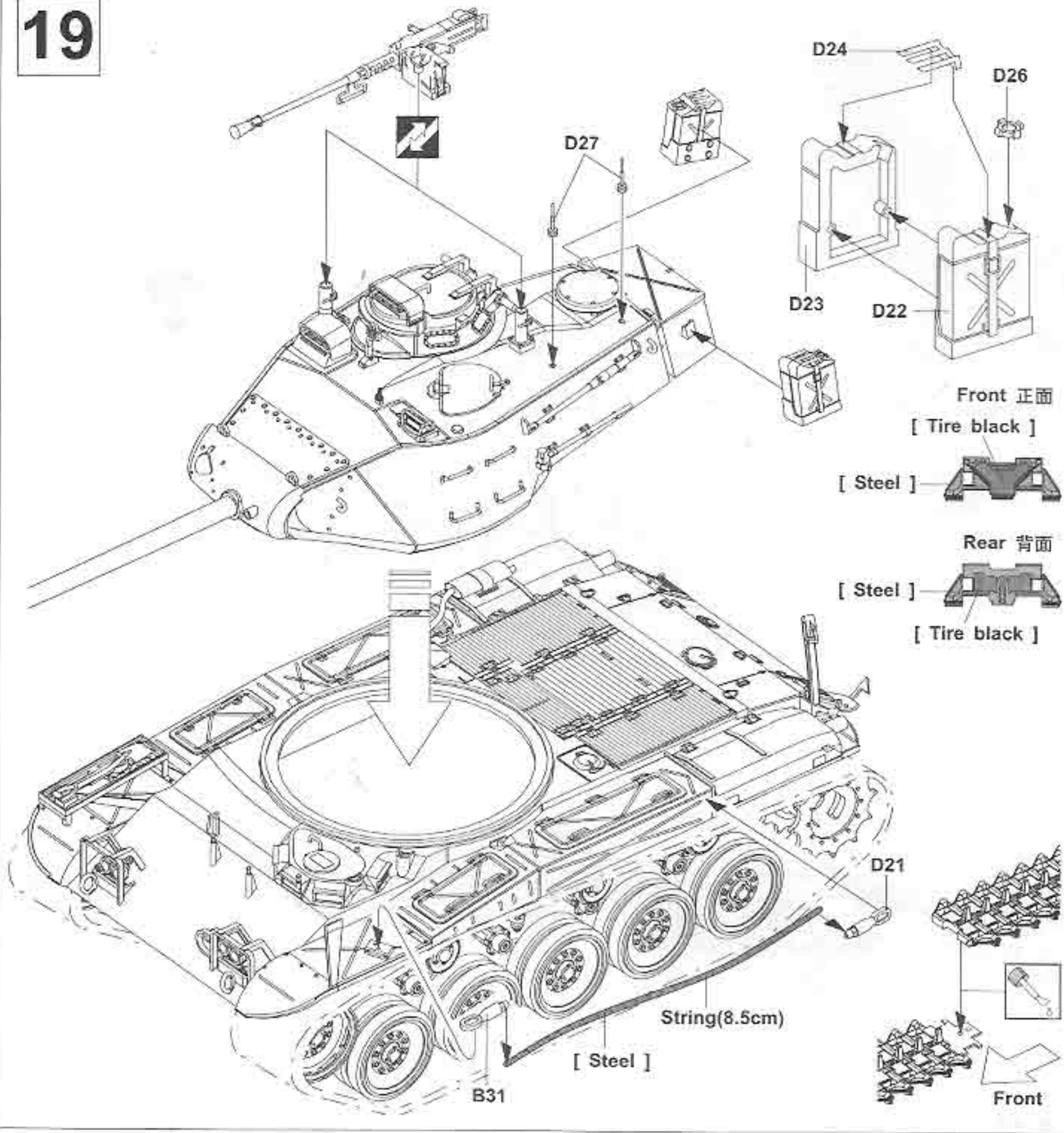

A U.S. Army 1st Armored Regt, West German, 1956

美國陸軍第一裝騎旅, 1956年西德

 Body Color: Olive drab(2)

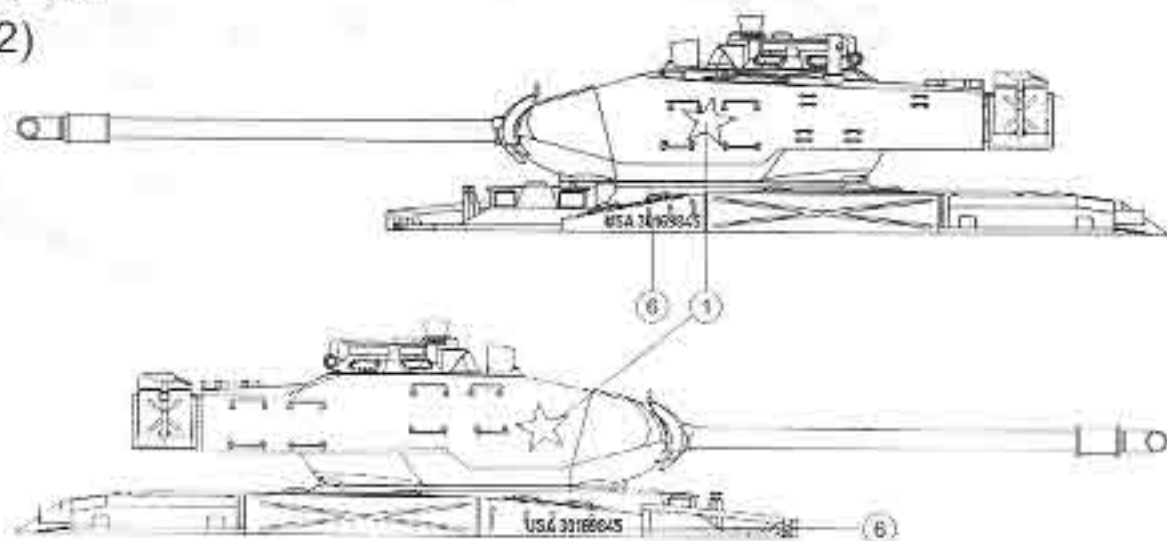
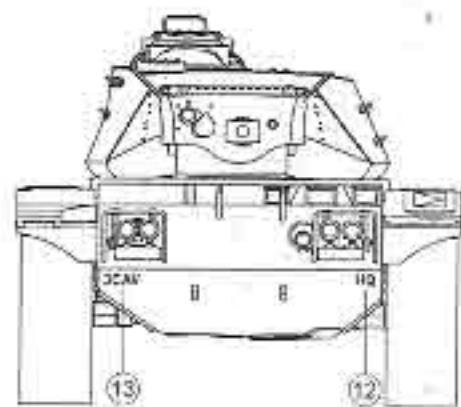

B U.S. Army 4th Cavalry, 25th Infantry Division, Thailand 1962

美國陸軍第25步兵師, 1962年泰國

 Body Color:Olive drab(2)



C South Vietnamese Army, 1972

越南共和國陸軍

 Body Color:Khaki green

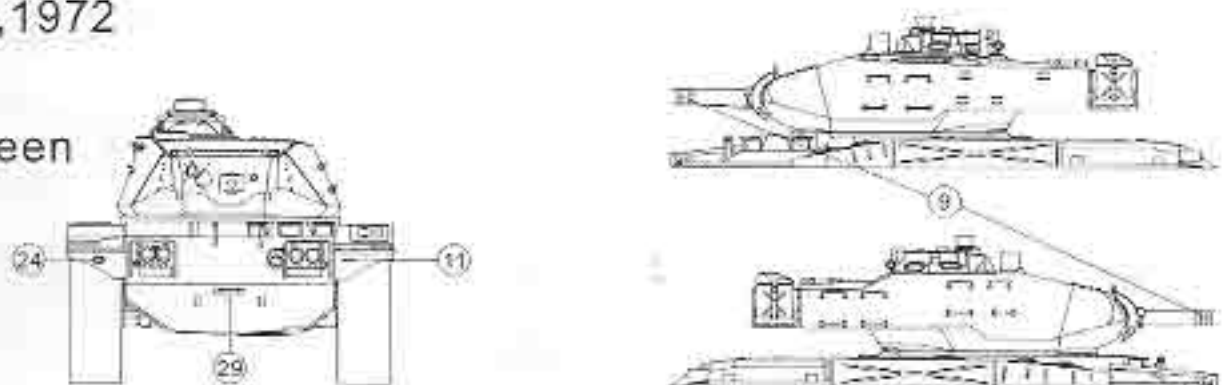

D South Vietnamese Army

越南共和國陸軍

 Body Color:Khaki green

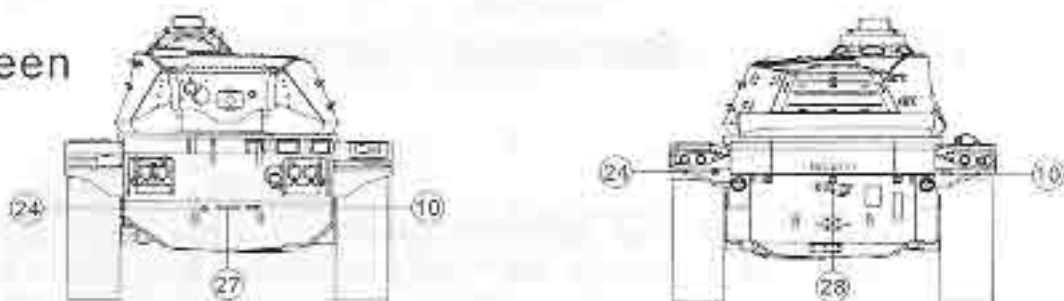

E R.O.C. Marine Corps

中華民國海軍陸戰隊

 Body Color:Field green

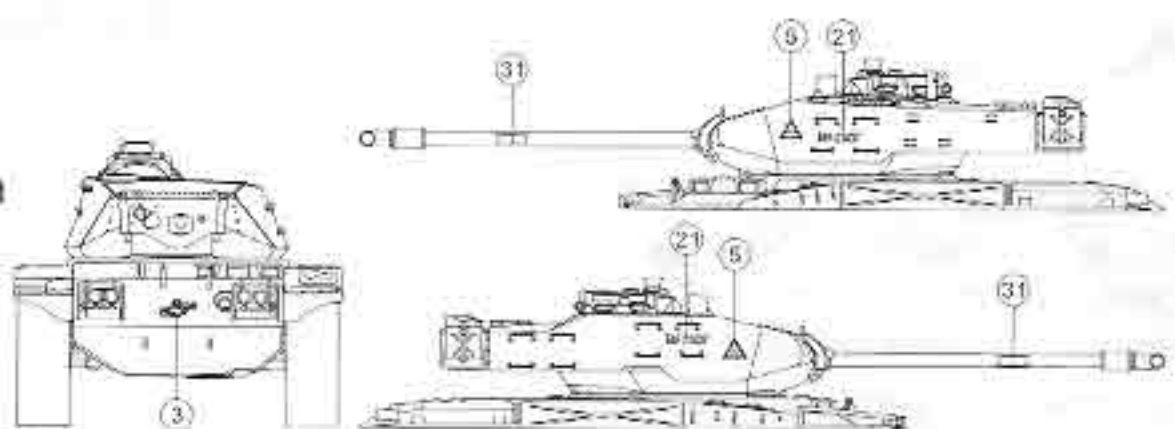

F R.O.C. Marine Corps

中華民國海軍陸戰隊

 Body Color:Field green

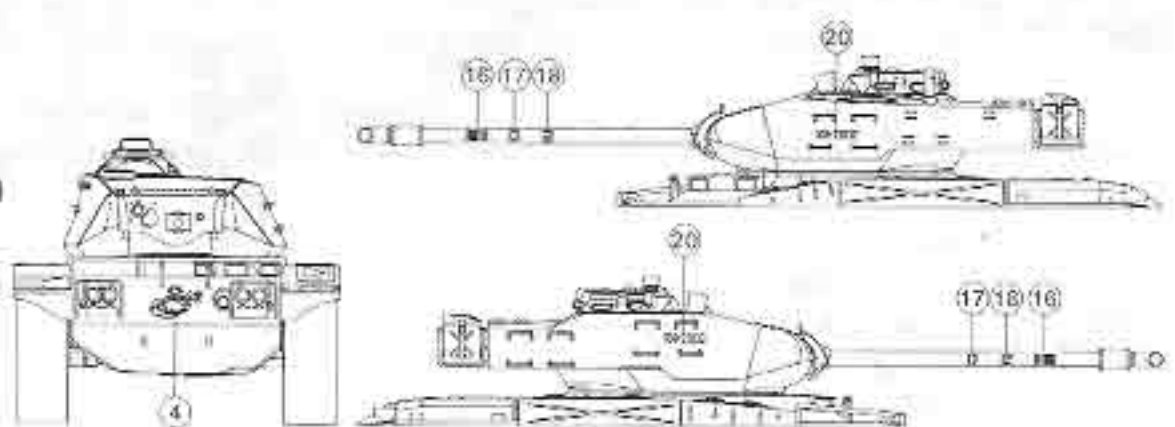

G R.O.C. Marine Corps

中華民國陸軍裝甲兵學校

 Body Color:Olive green

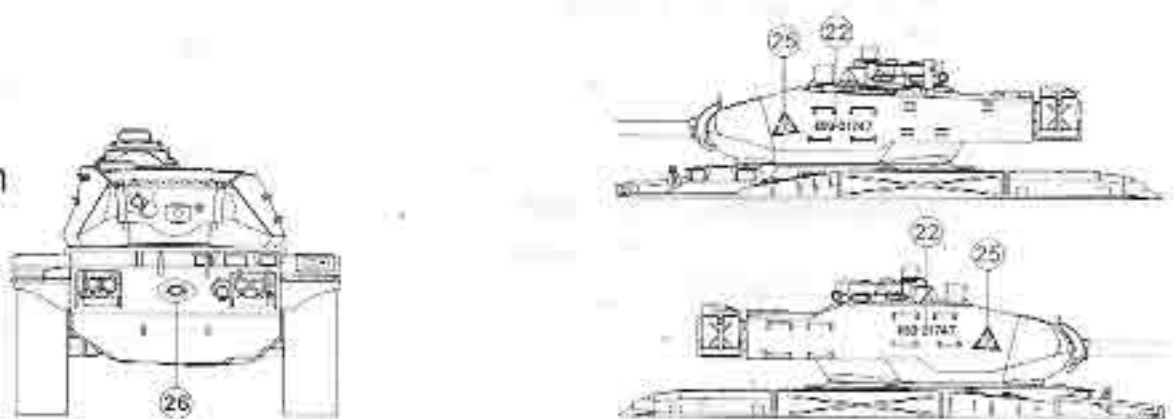

PARTS LIST 零件表

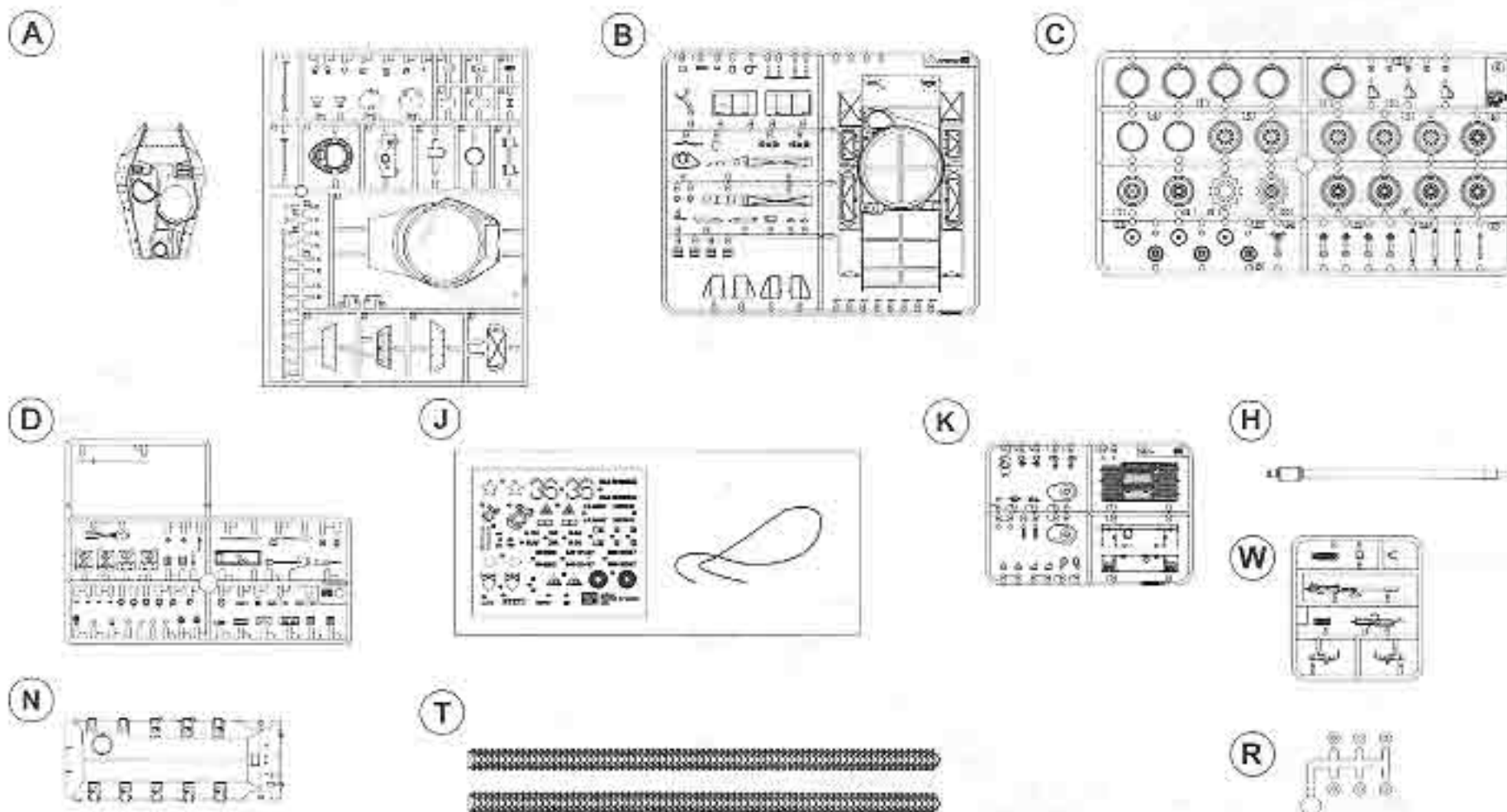

Parts:

(A) ——— 1	(D) ——— 1	(H) ——— 1	(R) ——— 2
(B) ——— 1	(J) ——— 1	() ——— 1	(T) ——— 1
(C) ——— 2	(K) ——— 1	(N) ——— 1	(W) ——— 1



Instructions:

If for some reason, you are not fully satisfied or have questions concerning our product; Please use the form provide, and send it to our nearest representative or mail it directly to our office.

We will deal with that A.S.A.P.

 AF 35041 Parts Replacement Form	
<input type="checkbox"/> A parts <input type="checkbox"/> B parts <input type="checkbox"/> C parts <input type="checkbox"/> D parts <input type="checkbox"/> E parts <input type="checkbox"/> F parts <input type="checkbox"/> G parts	<input type="checkbox"/> H parts <input type="checkbox"/> I parts <input type="checkbox"/> M parts
Reason for replacement:	<input type="checkbox"/> Missing <input type="checkbox"/> broken
Signature: _____	

限台灣地區使用 For Taiwanese use only!

總代理：戰鷹企業 客服部收 本公司將盡速為您處理
 請將本表與該部品相同金額之郵政匯票一同寄至

 AF 35041 零件補充申請表	申請人 姓 地 電 名 址 話 : : :
<input type="checkbox"/> A部品零件 ——— NT\$150 <input type="checkbox"/> B部品零件 ——— NT\$140 <input type="checkbox"/> C部品零件 ——— NT\$180 <input type="checkbox"/> D部品零件 ——— NT\$ 80 <input type="checkbox"/> H部品零件 ——— NT\$ 30 <input type="checkbox"/> J部品零件 ——— NT\$160 <input type="checkbox"/> K部品零件 ——— NT\$ 60 <input type="checkbox"/> N部品零件 ——— NT\$ 80 <input type="checkbox"/> R部品零件 ——— NT\$ 30 <input type="checkbox"/> T部品零件 ——— NT\$160 <input type="checkbox"/> W部品零件 ——— NT\$ 60	
(請填 總計 NT\$ _____)	
零件補充原因: (請於 <input type="checkbox"/> 打) . 原包裝即 <input type="checkbox"/> 遺失或 <input type="checkbox"/> 毀損 . 製作途中 <input type="checkbox"/> 遺失或 <input type="checkbox"/> 毀損 . <input type="checkbox"/> 補充多餘零件 . 其他原因 _____	