

**11671****Plastic Model Kit Skill Level 2 1/48 Scale****MINICRAFT  
MODEL KITS***Legends in the making™*

Beechcraft, T-34 Mentor, emblem, logo and body designs are the trademarks and trademarks of the Beechcraft Corporation and are used under license by Minicraft Models (US) LLC

- Finely Detailed (Over 90 Parts)
- Landing Gear Up or Down
- Includes Clear Display Stand
- Premium Cartograf Decals

**ALL  
NEW TOOLING!**

# T-34A Mentor®

**During the post-war years the US military recognized a need for a cost effective “higher performance” aircraft capable of good speed and maneuverability with gentle flight characteristics for training new pilots. Funding was scarce so the U.S. military turned to Beechcraft Aviation to modify their successful Bonanza into a tandem seat military trainer. A new aircraft based on the Beechcraft Bonanza was created using a tandem fuselage and sliding canopy. The Mentor was a very successful design that was used by the United States Air Force, the United States Navy and many US allied air force units. The T-34 A/B series ceased production in 1959, all are now retired from US military service, but many examples of this successful design can still be seen in flight today in private ownership. This new 1/48 scale Minicraft kit boasts all new tooling and includes detailed cockpit and sliding canopy, position-able landing gear and high quality decals printed by Cartograf with 2 marking options.**

## Painting and finishing Minicraft model kits

Techniques for painting and finishing your model vary depending on the preferences of each model builder. Commonly most painting is recommended before assembly. Small details are best painted before assembly. Details like car and airplane interiors **MUST** be painted before assembly. Modelers may choose to paint the model kit using model paint with a paintbrush, an aerosol spray can or an airbrush. Large areas of the model like a model car a body or model airplane wings and fuselage are best painted before assembly or as a partially assembled sub-assembly. Use of an aerosol can or airbrush is recommended. Models can be painted after assembly but clear parts and some details will need to be masked to keep clear parts clear and preserve pre-painted details.

## Decal Application:

Your Minicraft model includes high-quality waterslide decals. These decals adhere best to a glossy surface. Use a sharp scissors or knife to cut individual decals from the carrier sheet. Do not cut into the clear film surrounding the individual decals. It is recommended that you apply one decal at a time. Place the decal section in warm water, when first inserted in the water your decal will curl, after approximately ten seconds the decal will uncurl. Remove from water and lay on a paper towel. After approximately 10 - 20 seconds the decal will slide freely from the backing paper. Use a small brush to help slide the decal from the backing paper and into position on the model. Carefully blot excess water from the decal, using care not to move the decal or tear it. If you choose to use a setting solution, apply a thin coat over the decal following the manufacturer's instruction. Allow the decal to dry overnight. Wash any adhesive residue off the model with a small wet towel.

**Minicraft Models (US) LLC 2136 12th St. Rockford, IL. 61104 Printed in China  
www.minicraftmodels.com**

### SPRUE A

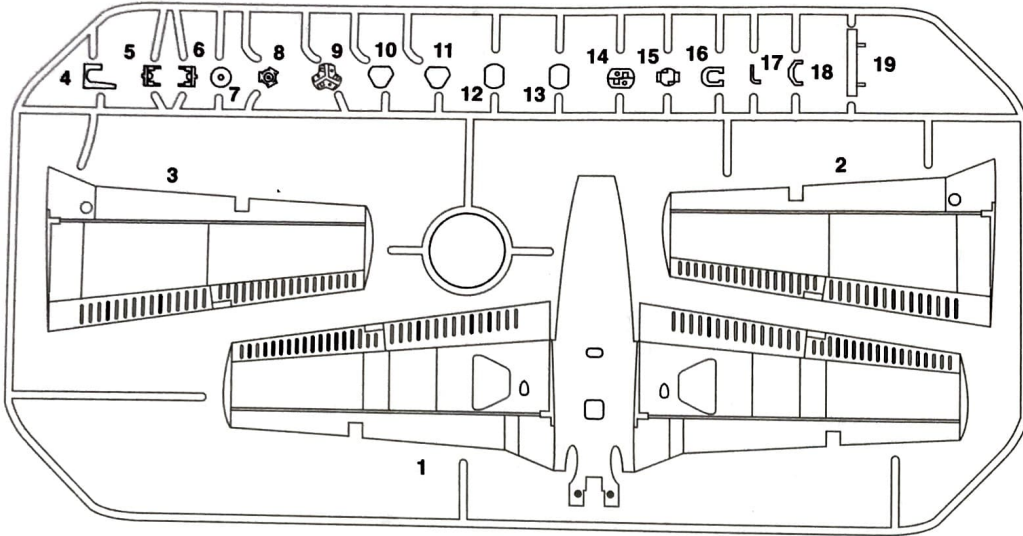

### SPRUE D

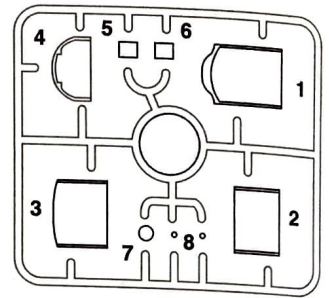

### SPRUE C

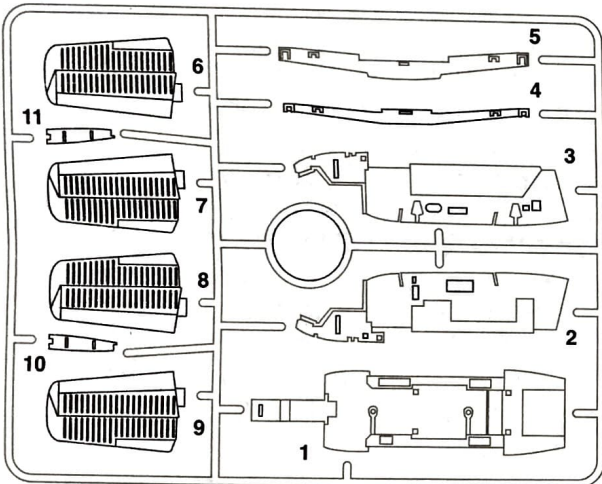

### SPRUE E

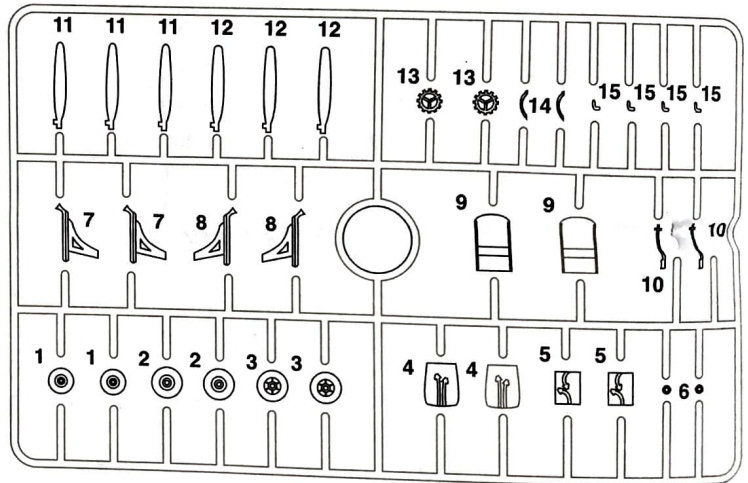

### SPRUE B

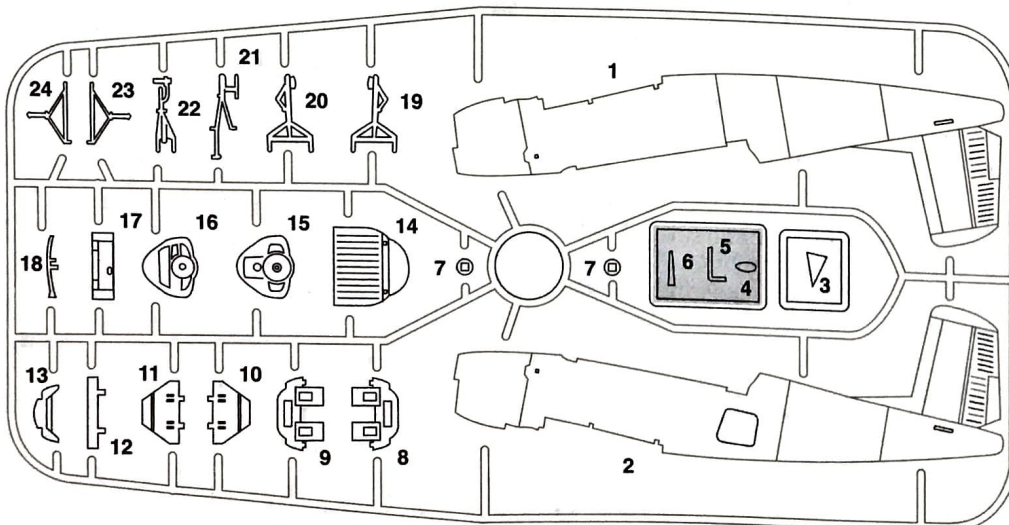

Parts shown in Gray  
not for use

## BEFORE BEGINNING ASSEMBLY

Your Minicraft T-34A Mentor model kit has delicate parts by design for accuracy in this scale.

All parts should be carefully cut from the parts sprue with a sharp hobby knife.

A sprue cutter may damage smaller parts. It is also advised to dry-fit parts before cementing.

Various optional parts are provided; please check references if necessary for the particular aircraft you are modeling.

Please review all assembly steps to become familiar with the parts before beginning assembly.

### IN-FLIGHT DISPLAY

If you intend to build your T-34 in-flight using the Clear Display Stand, refer to page 15 for direction. If so, nose weight not needed.



Cement



DO NOT Cement



Cut away



Optional parts



2x Multiple assemblies



Drill hole

## 1 COCKPIT



All Parts

Main parts INTERIOR GREEN  
or FLAT MEDIUM GRAY

Control consoles BLACK  
with SILVER/WHITE details

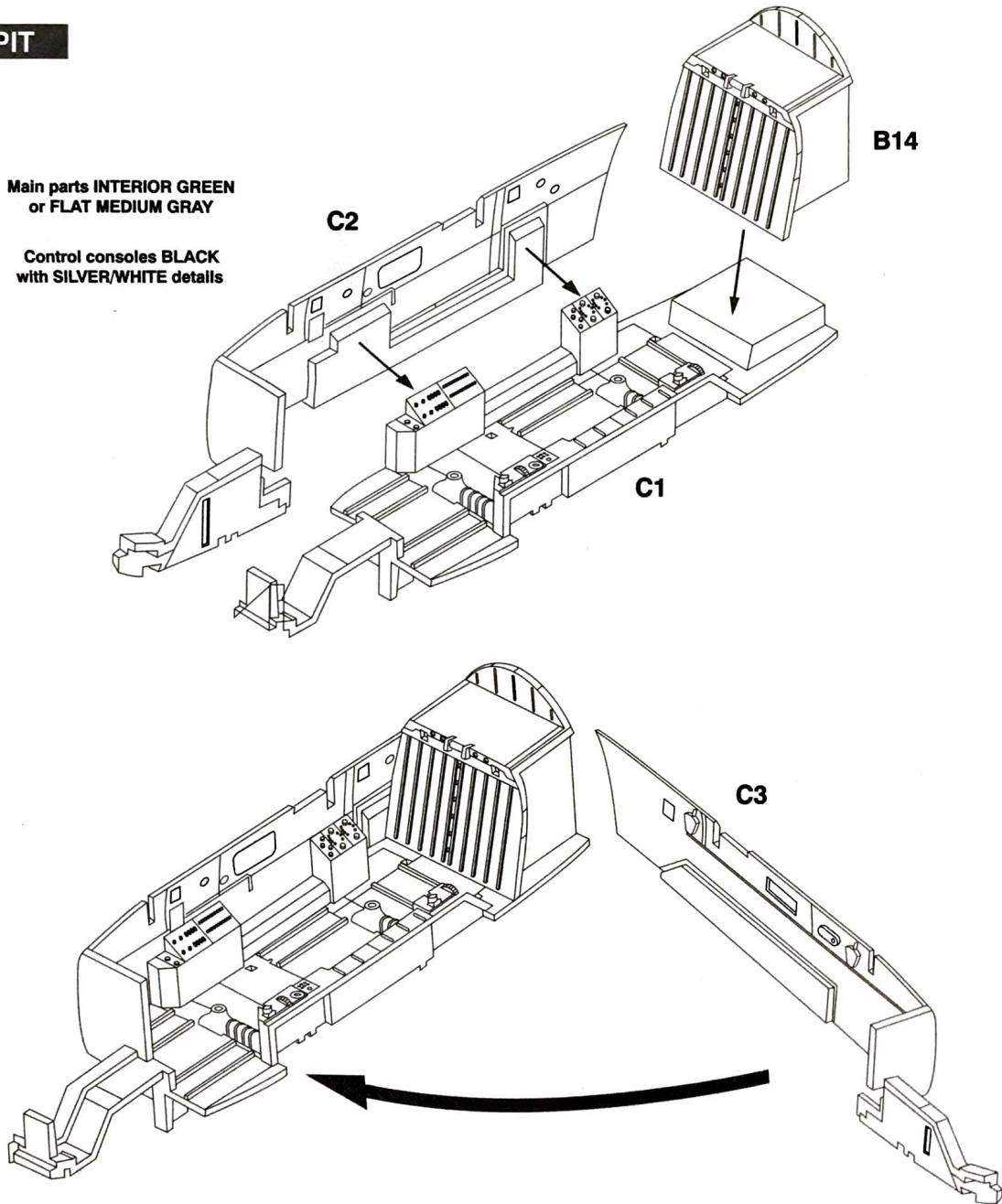

## 2 INSTRUMENT PANELS

  
All Parts

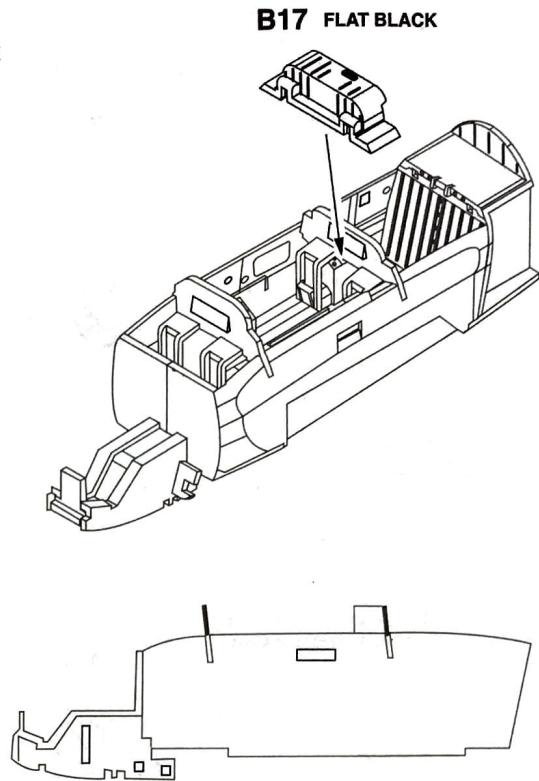
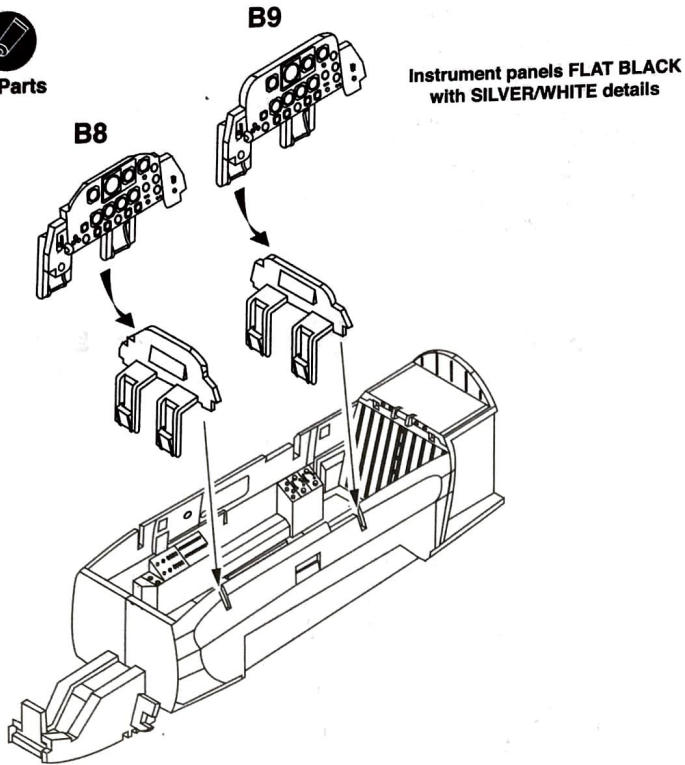

Note parts alignment

## 3 SEATS

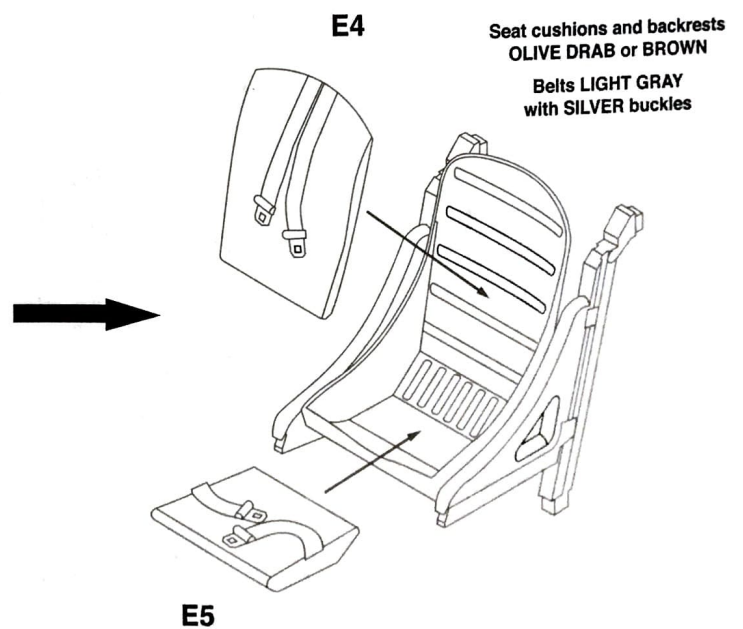
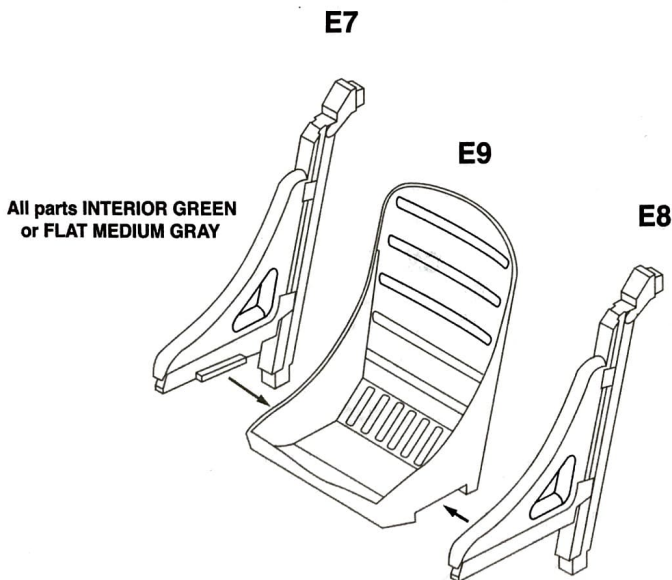

## 4 CONTROL STICKS / SEATS



All Parts

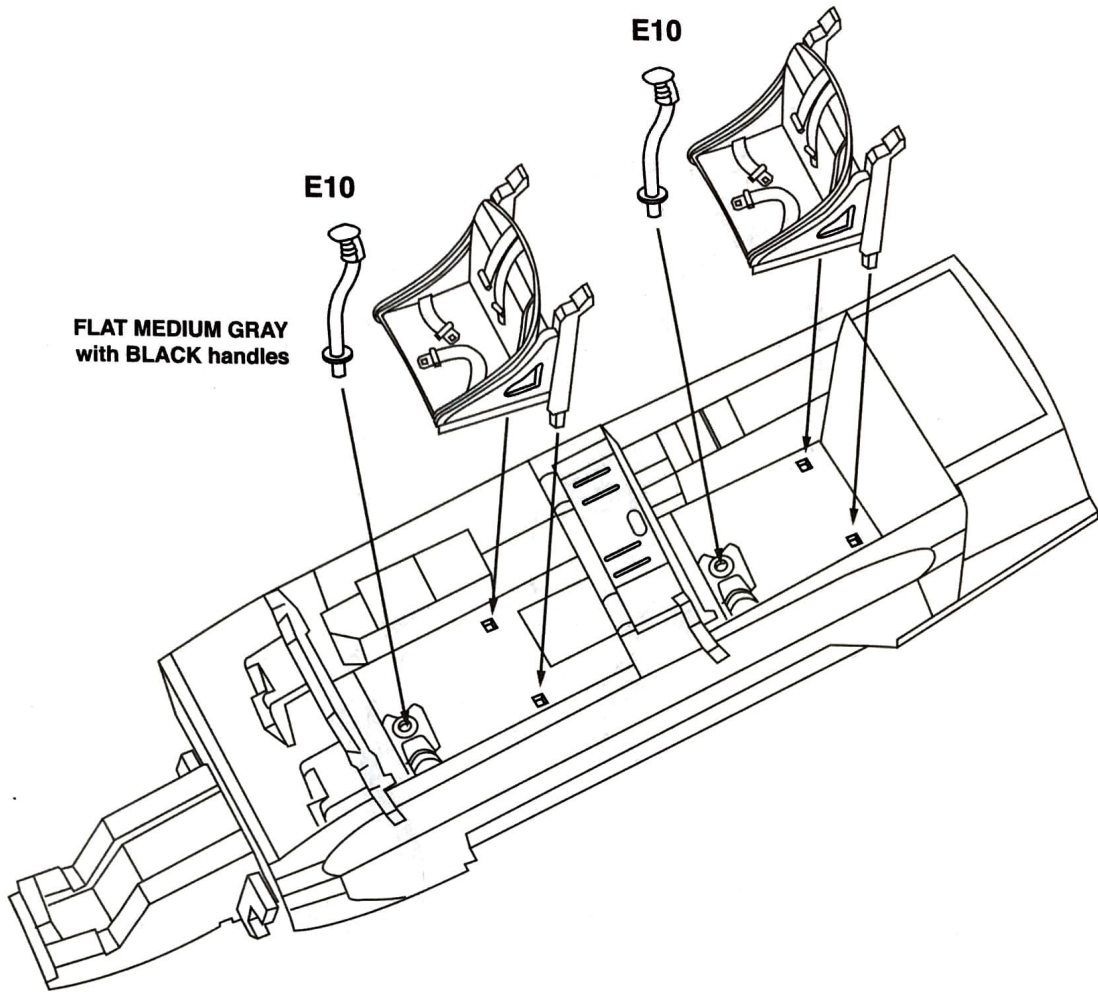

## 5 TRIM WHEELS



All Parts

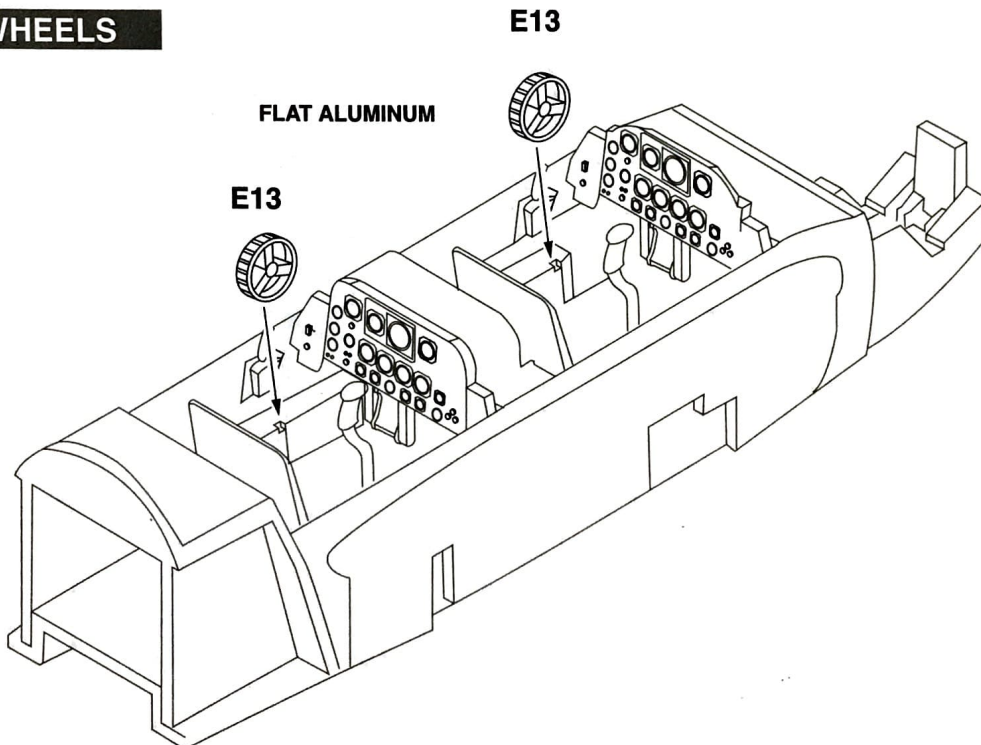

**6 FUSELAGE ASSEMBLY 1**



All Parts

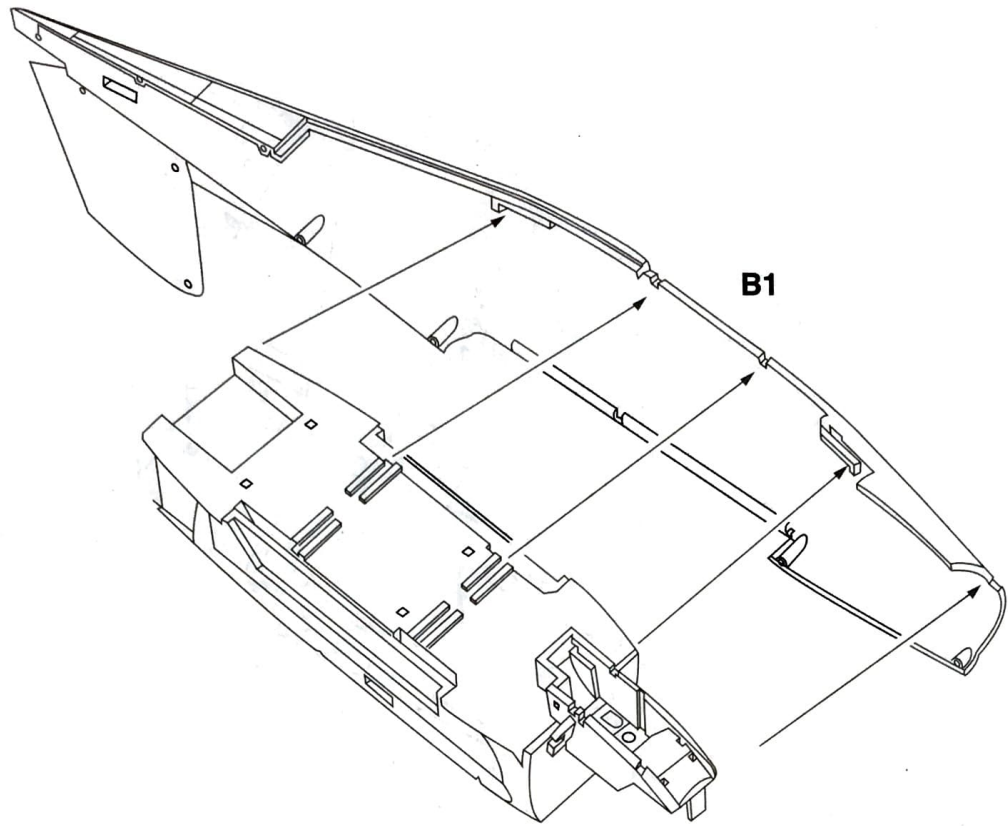

**7 FUSELAGE ASSEMBLY 2**



All Parts

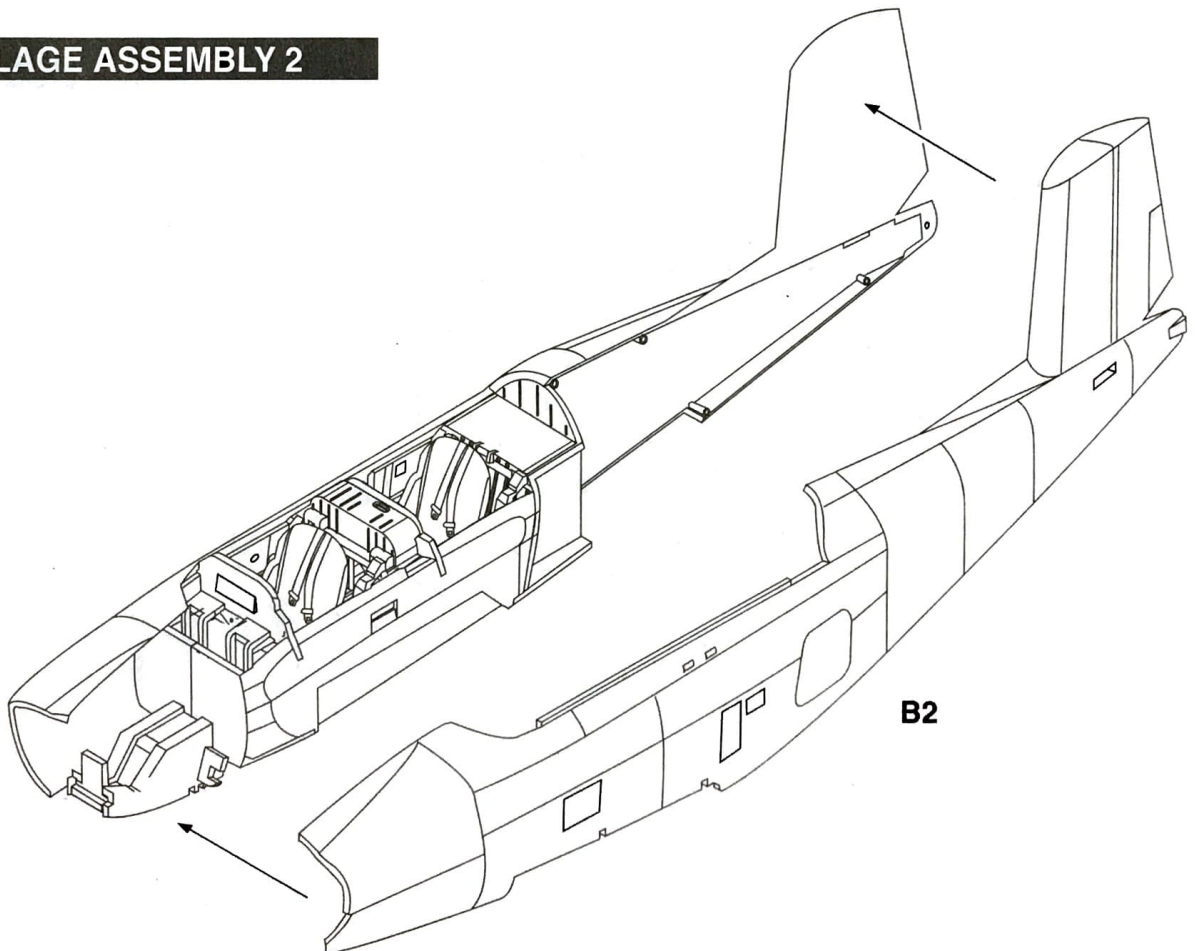

# 8 FUSELAGE ASSEMBLY 3



All Parts

**NOTE**  
Add nose weight  
1 Oz. / 28 g  
before installing part B16

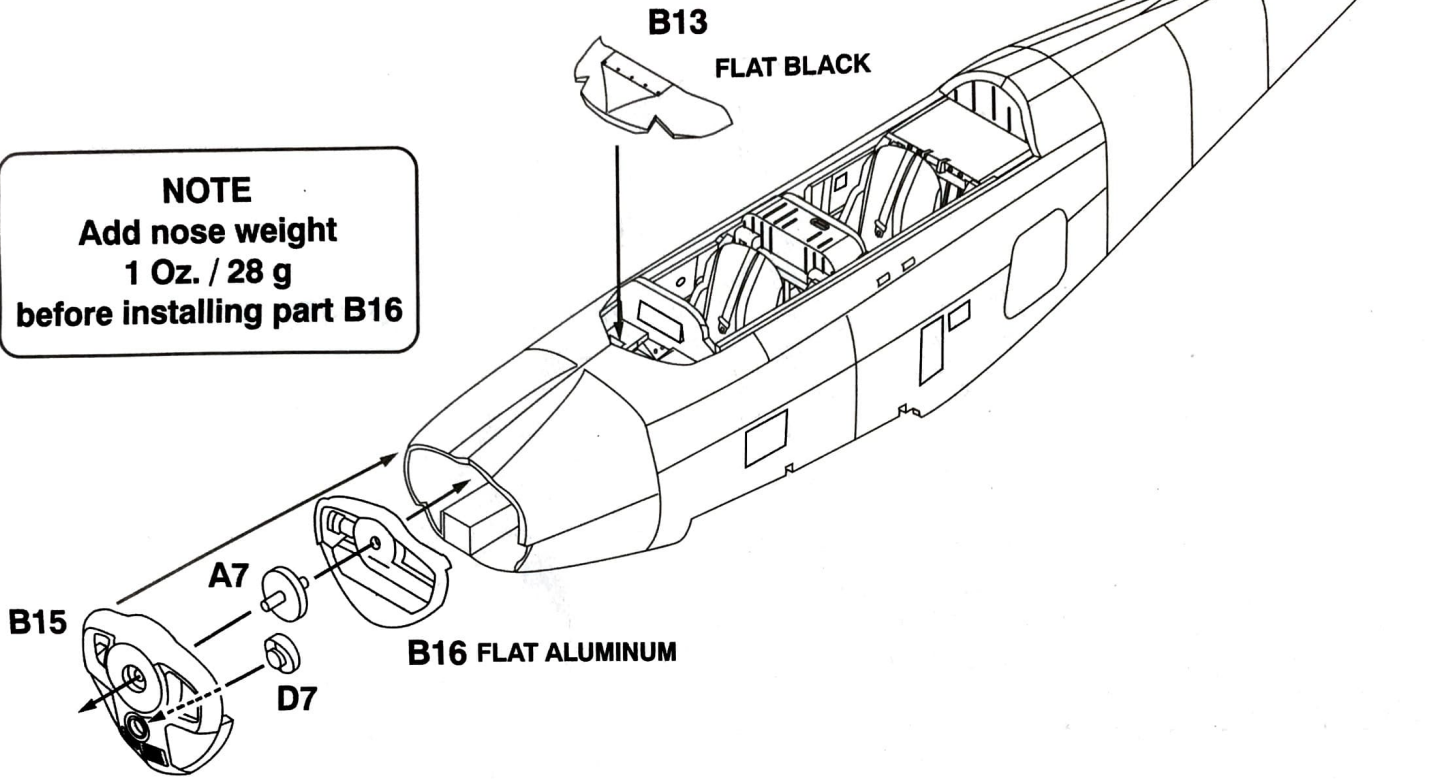

# 9 TAIL FILLET



All Parts

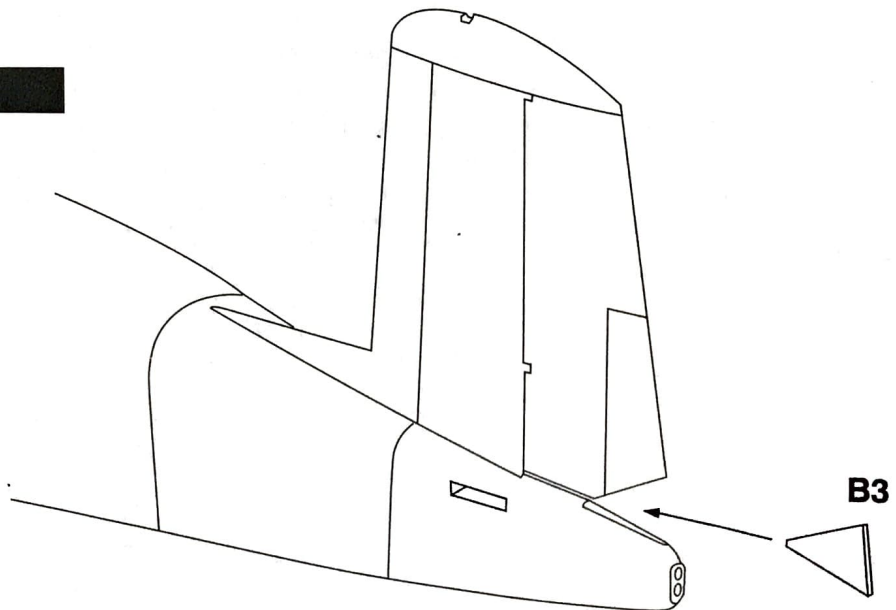

# 10 WING SPAR



All Parts

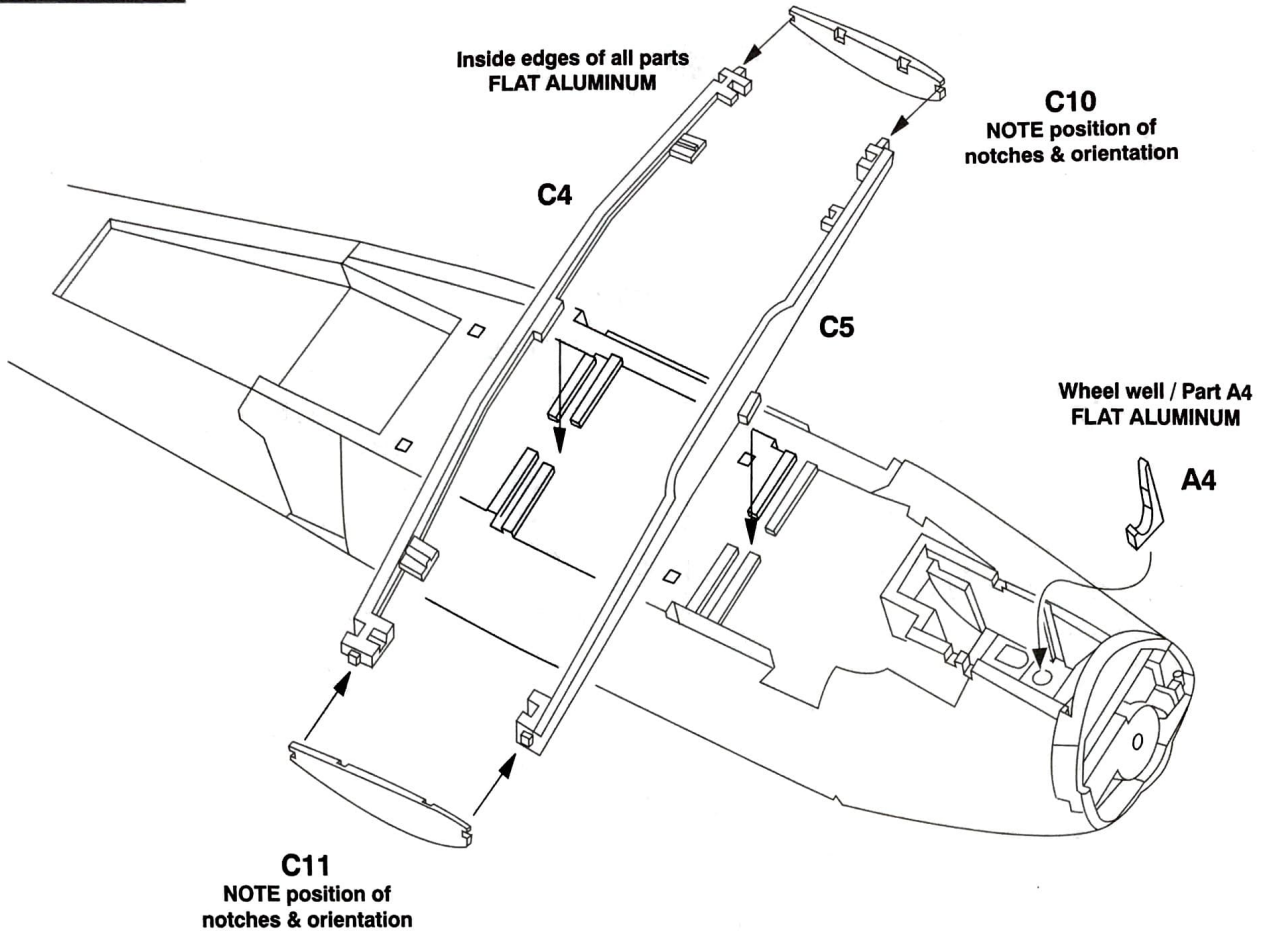

# 11 MAIN ASSEMBLY



All Parts

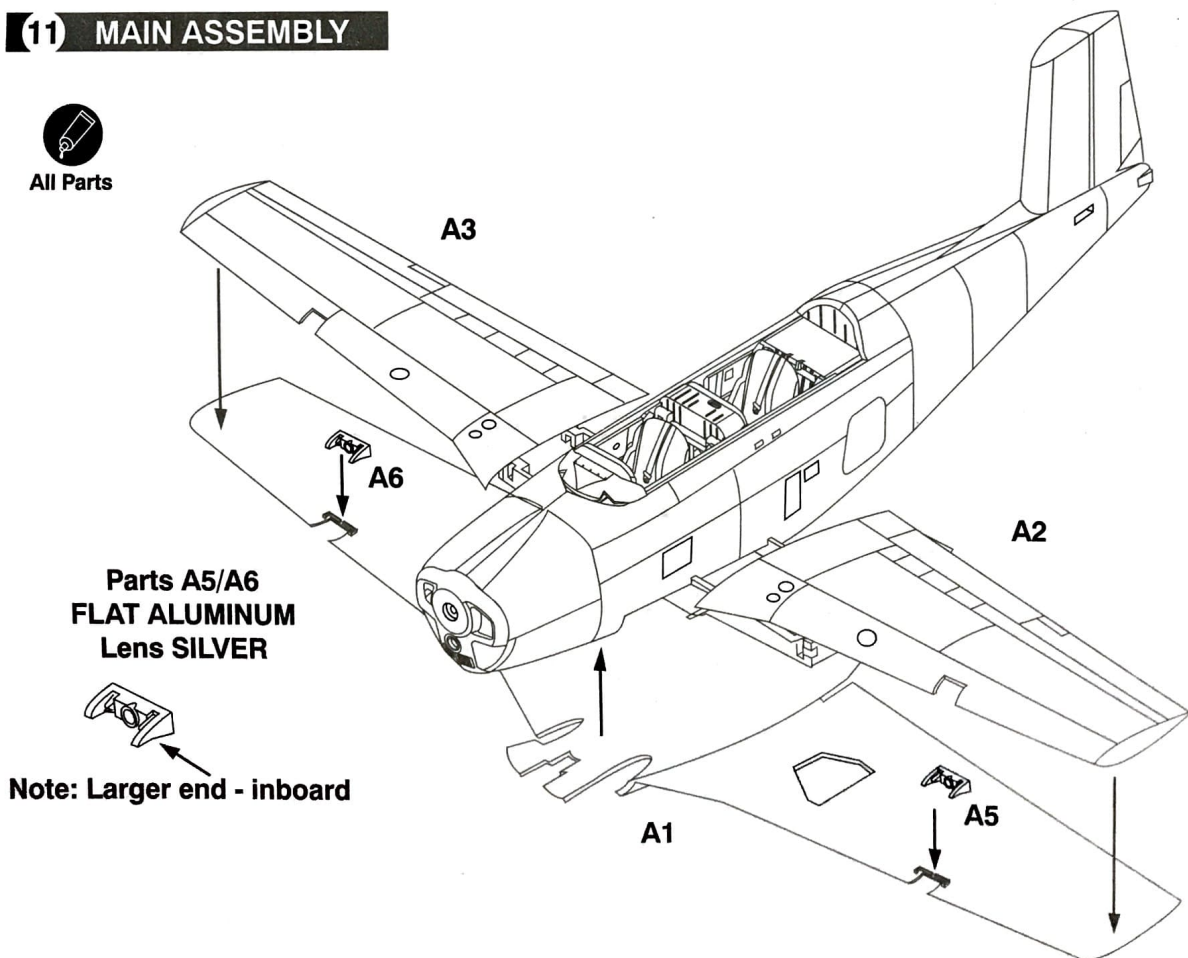



## 12 STABILIZERS



All Parts

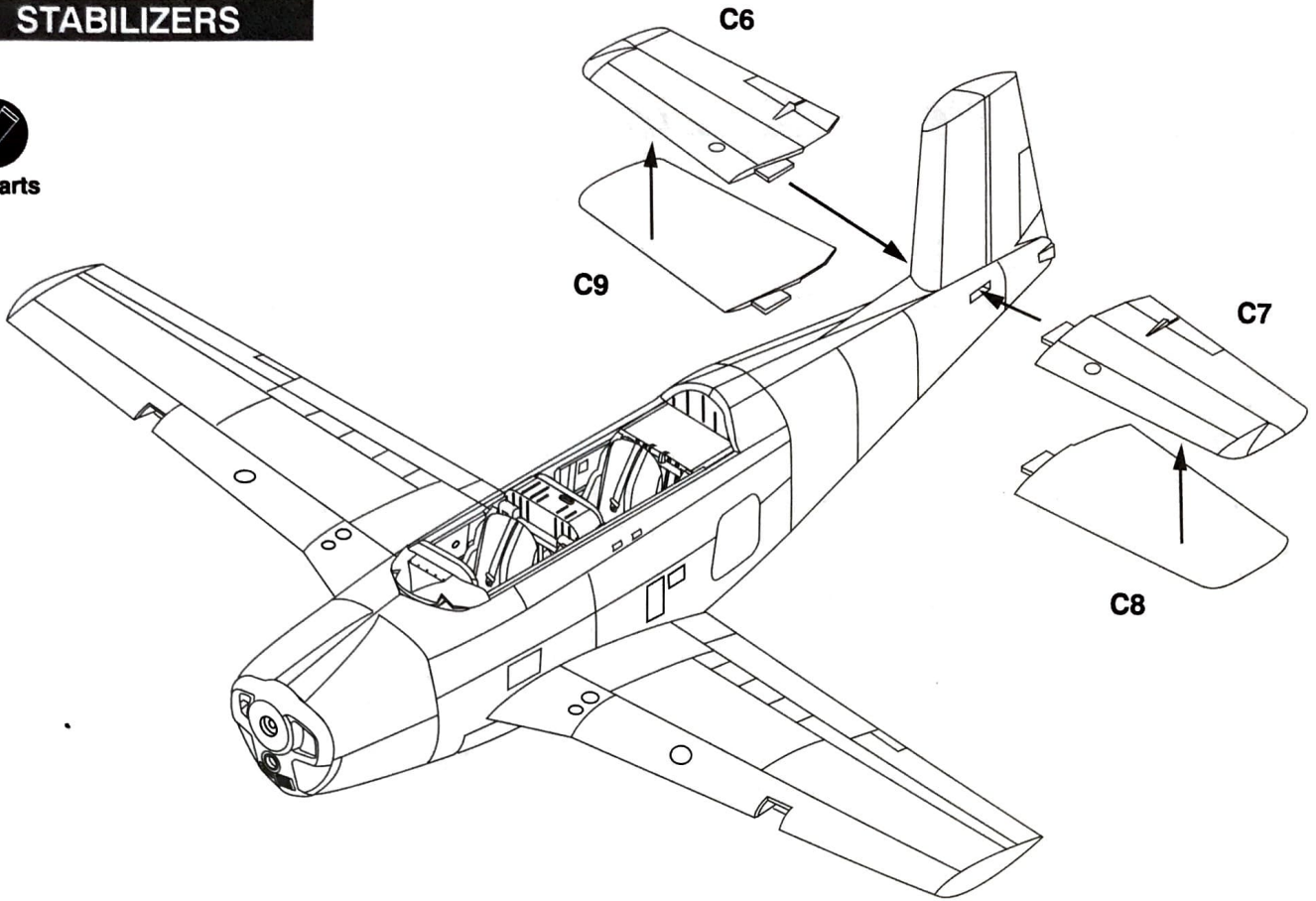

## 13 EXHAUSTS



All Parts

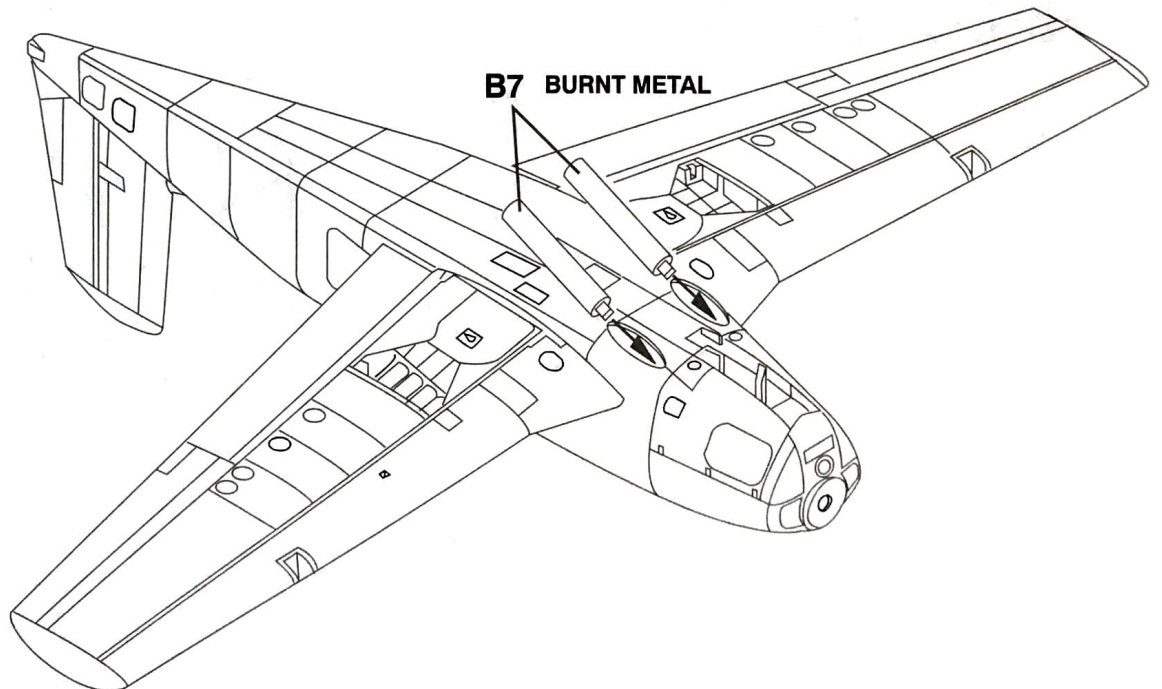

# 14 CANOPIES / WING LANDING LIGHTS

  
All Parts

Parts E15  
FLAT ALUMINUM

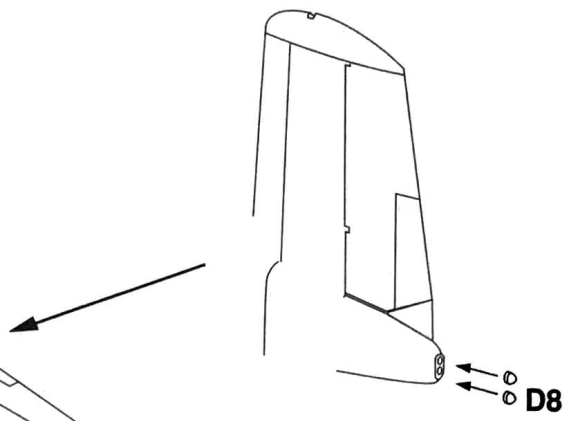
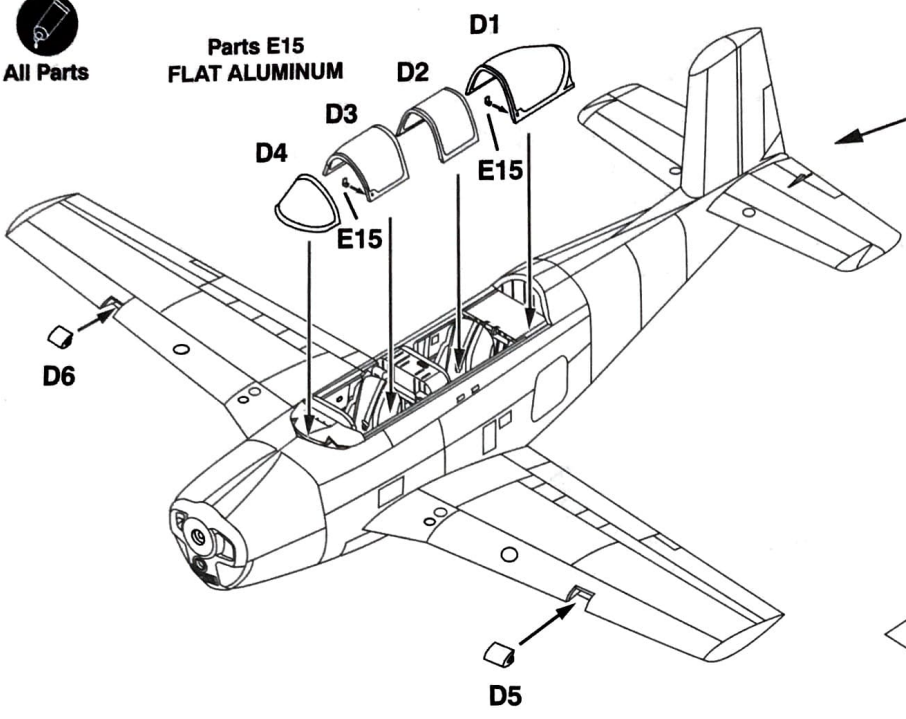

Canopy parts shown in place

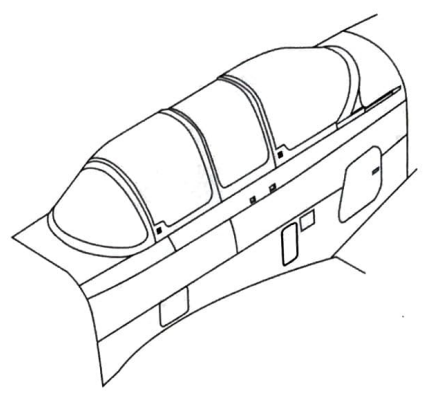

# 15 FUSELAGE DETAILS

  
All Parts

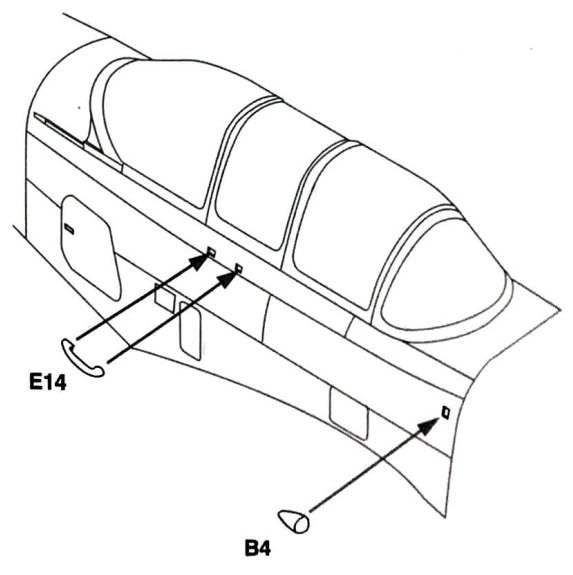
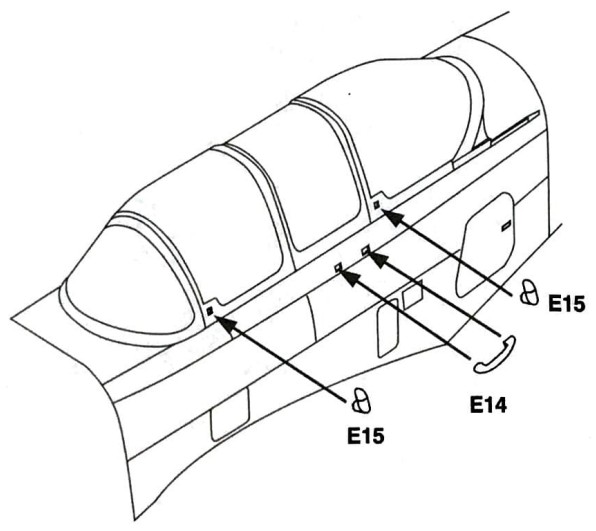

## 16 MAIN LANDING GEAR



Your model may be assembled with **EXTENDED** or **RETRACTED** landing gear.  
Please review the following steps for reference as you complete assembly.



All Parts

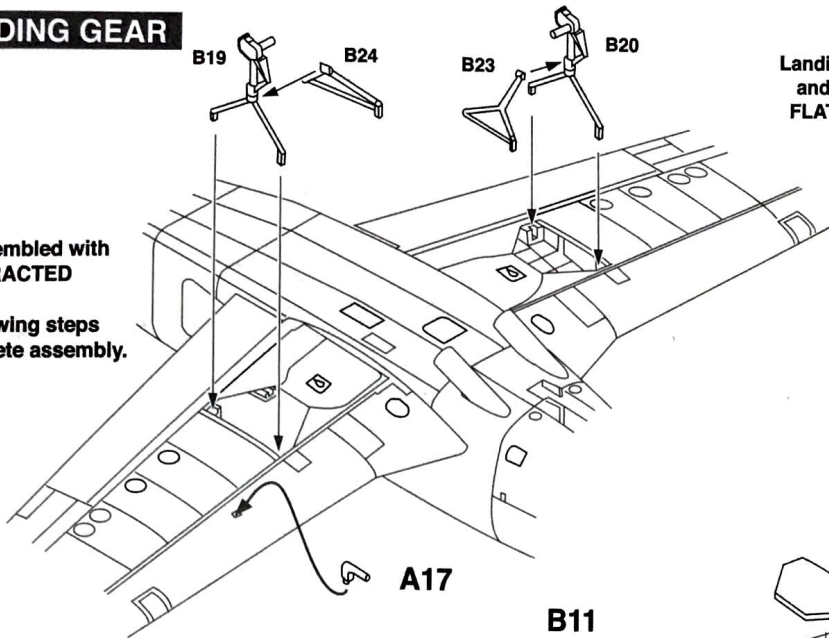

For closed mainwheel doors (retracted landing gear) remove tabs on parts B10 / B11.

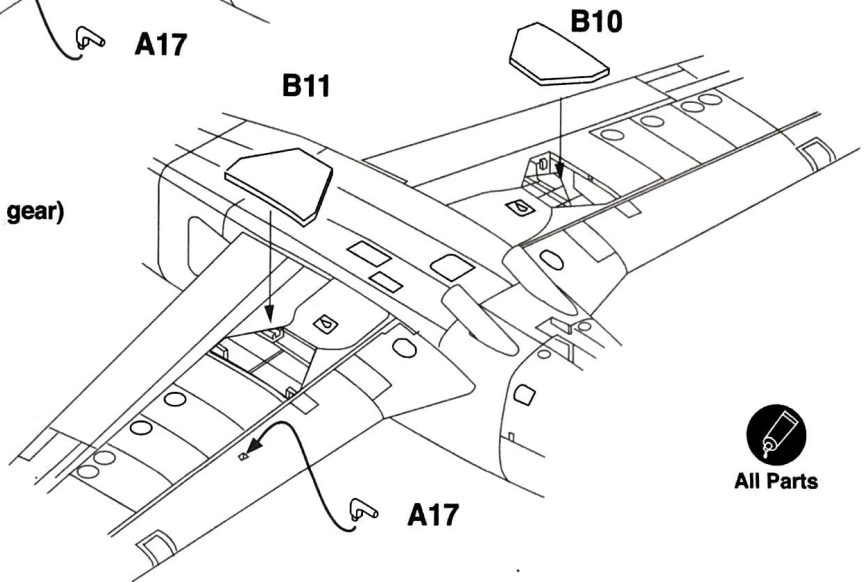
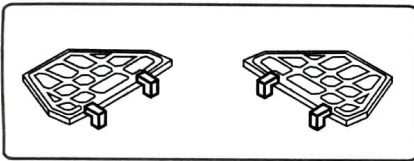

All Parts

## 17 MAINWHEELS



All Parts

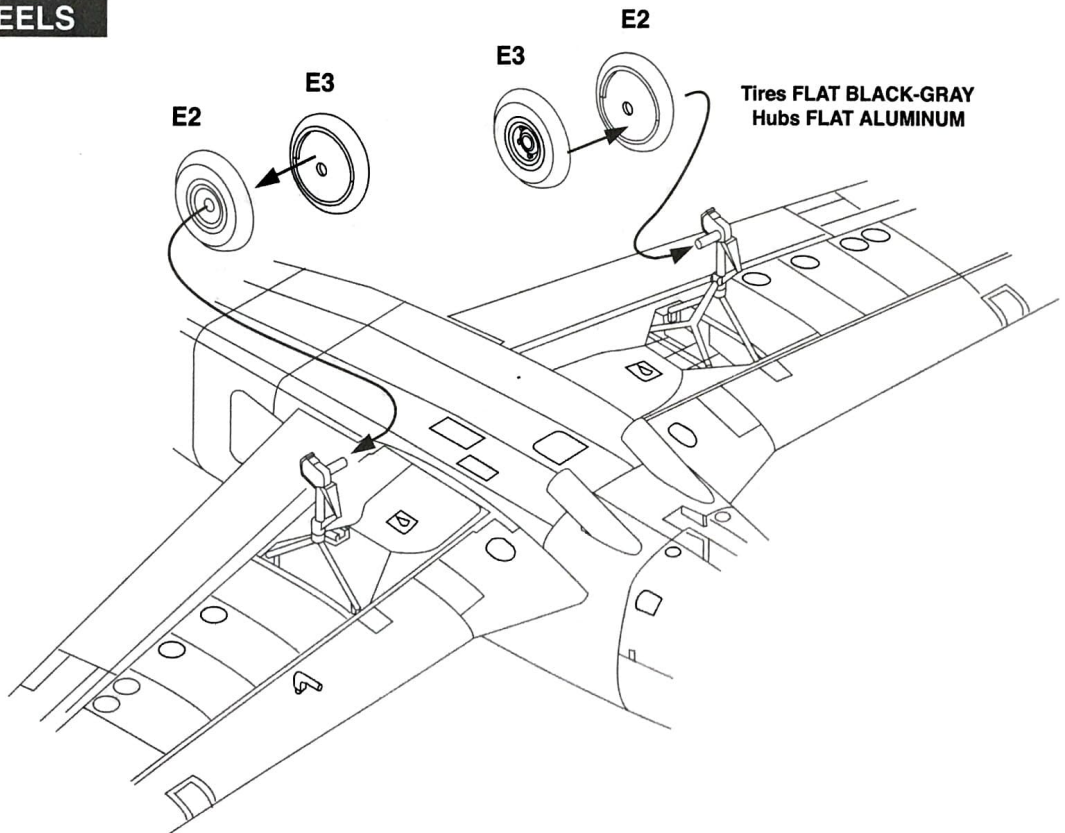

## 18 MAINWHEEL DOORS / PITOT



All Parts

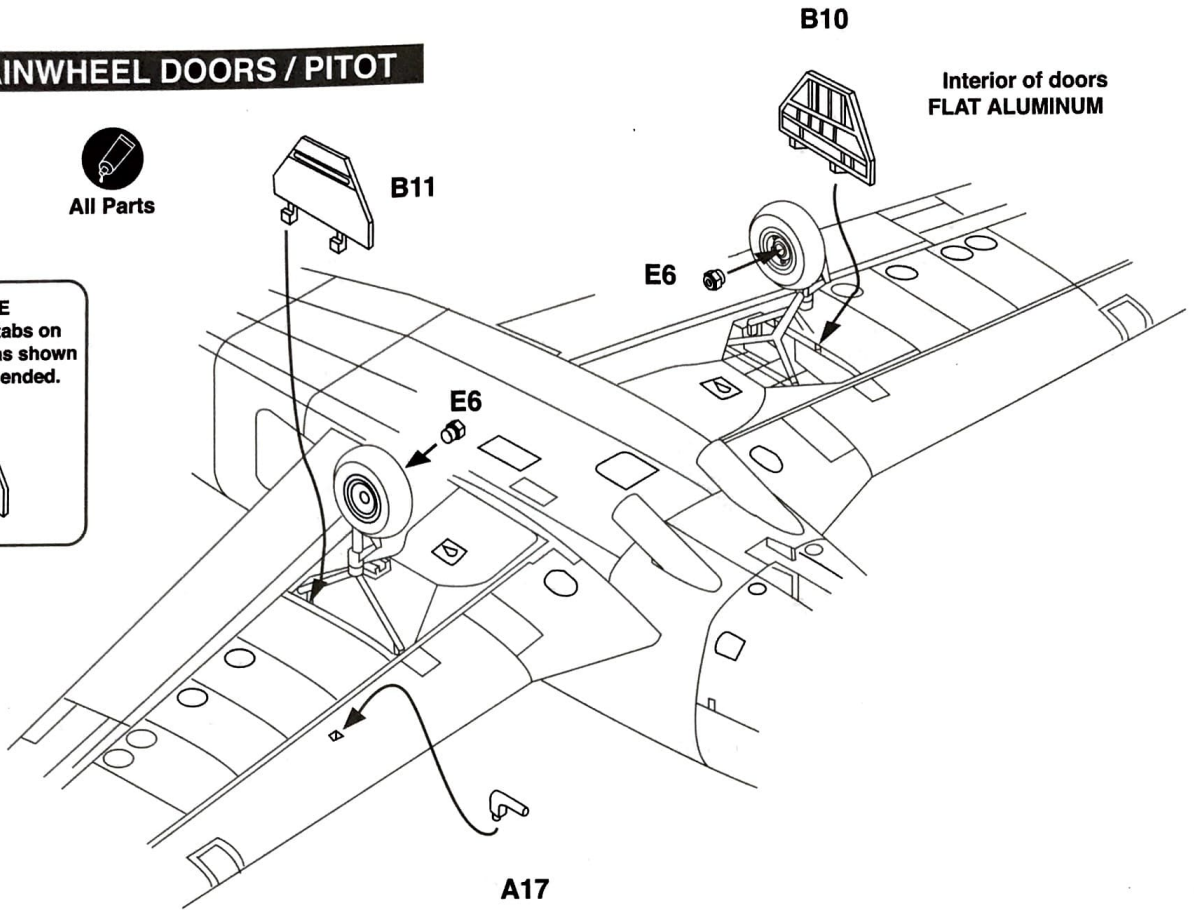

B10

Interior of doors  
FLAT ALUMINUM

B11

E6

E6

A17

## 19 NOSEGEAR STRUT



All Parts

**NOTE - Option**  
Refer to Step 21. Nosegear doors may be installed before assembling the nosegear struts.

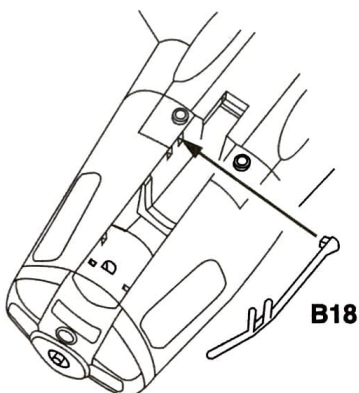

B18

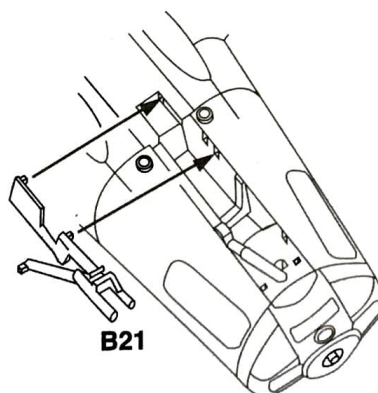

B21

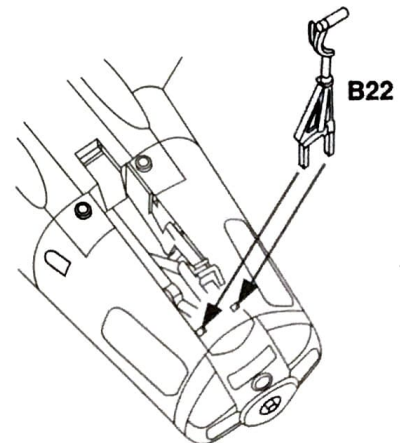

B22

Landing gear struts  
and wheel well  
FLAT ALUMINUM

## 20 NOSEWHEEL



All Parts

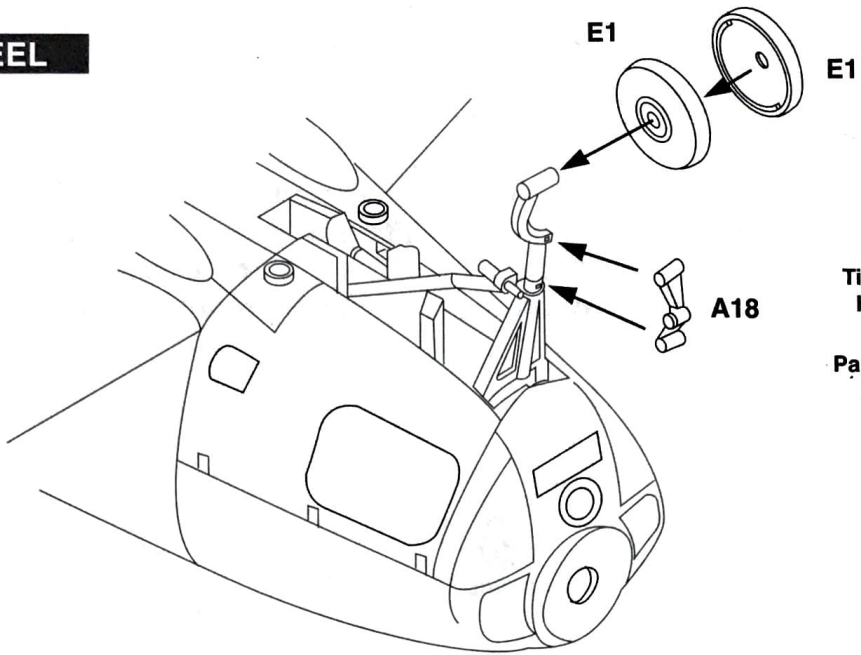

Tire FLAT BLACK-GRAY  
Hub FLAT ALUMINUM

Part A18 FLAT ALUMINUM

## 21 NOSEGEAR DOORS



All Parts

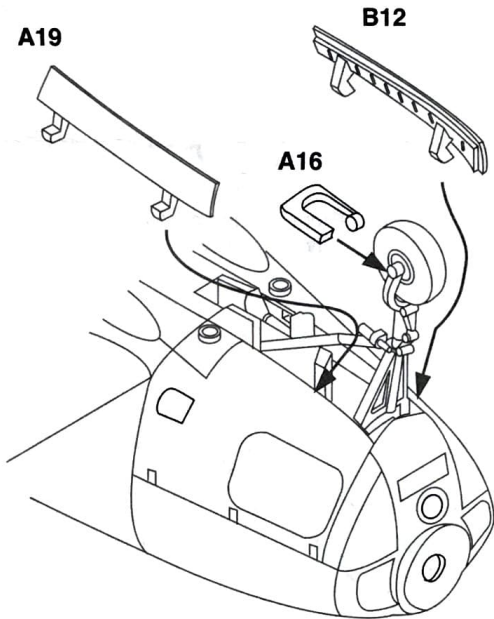

For closed nosewheel doors (retracted landing gear)  
remove tabs on parts B12/A19.

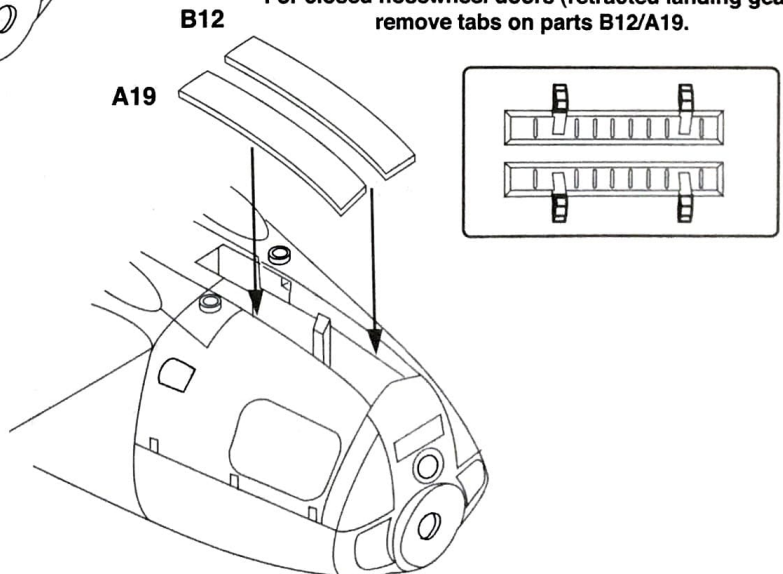

## 22 PROPELLER

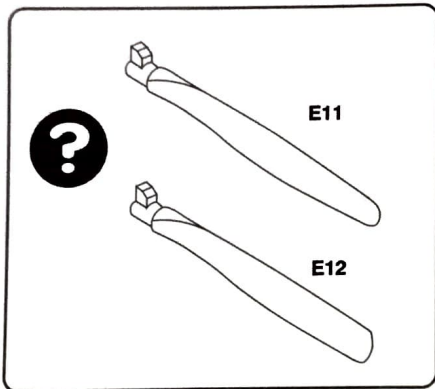

Minicraft has included parts for both 2 and 3 blade propellers. When originally introduced, Beechcraft manufactured the T-34 with 2 blade propellers. After the T-34 was sold to allied Air Forces and to private individuals, many aircraft were modified to use 3 blade props and different types of prop hub/spinner types. The option of using 2 or 3 blade propellers and 2 types of propeller hubs are provided in this kit.

**NOTE**  
T-34A aircraft were generally fitted with propeller blades of the style of parts E12. Parts E11 are provided as an option.

Propeller blades  
FLAT BLACK-GRAY with YELLOW tips  
Refer to color guide.

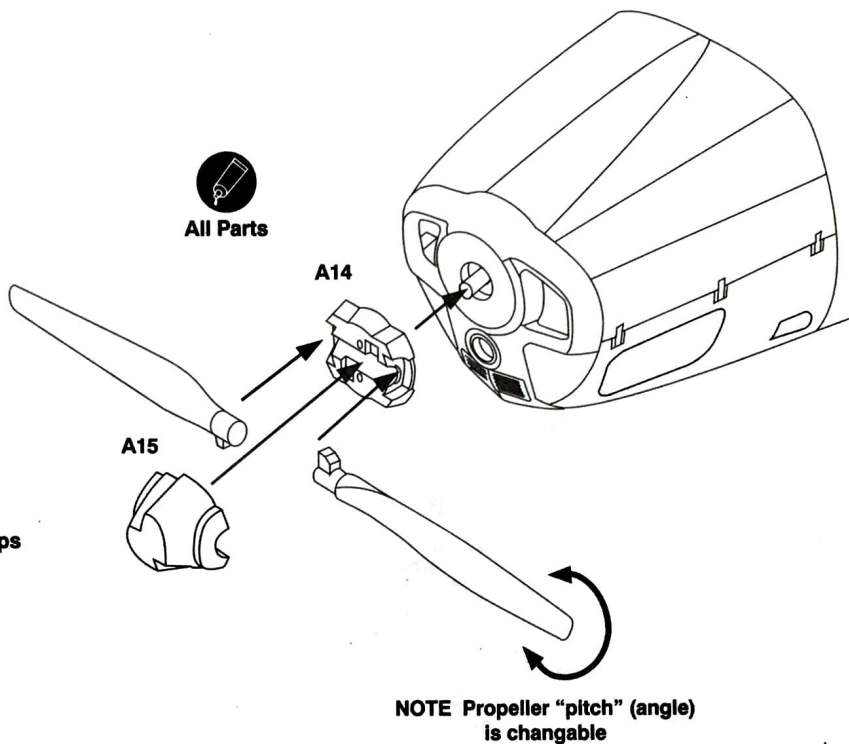

## 23 PROPELLER SPINNER

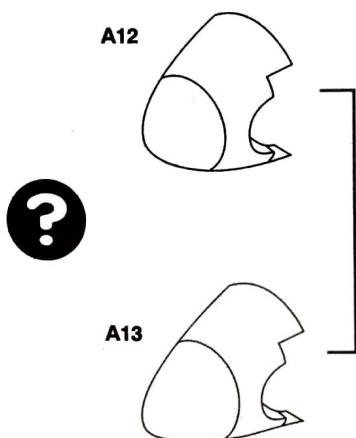

**NOTE**  
T-34A aircraft were generally fitted with a propeller spinner of the style of part A12. Part A13 is provided as an option.

# Display Stand

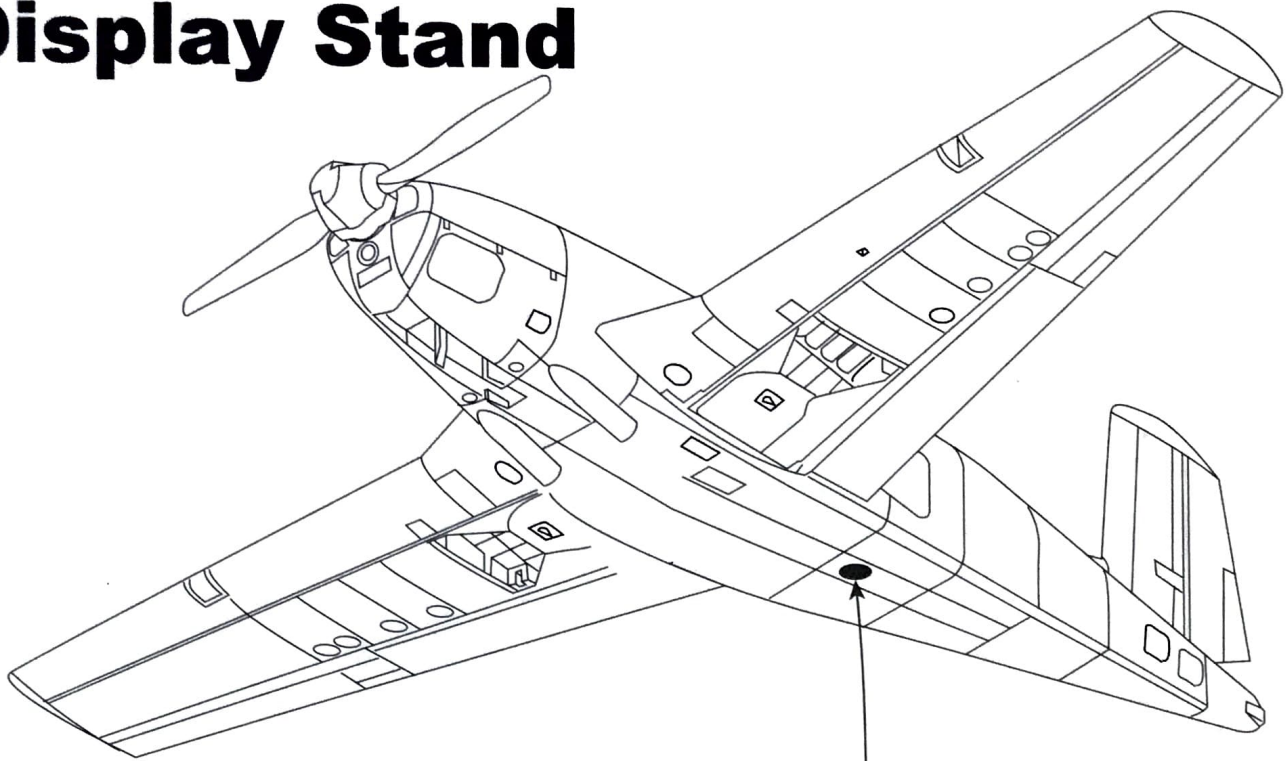

Drill hole

Glue post into hole drilled  
in model  
(5/32" / 5mm)

Part 3 snaps to Part 4  
(do not glue)

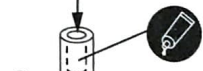
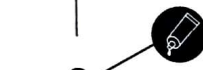
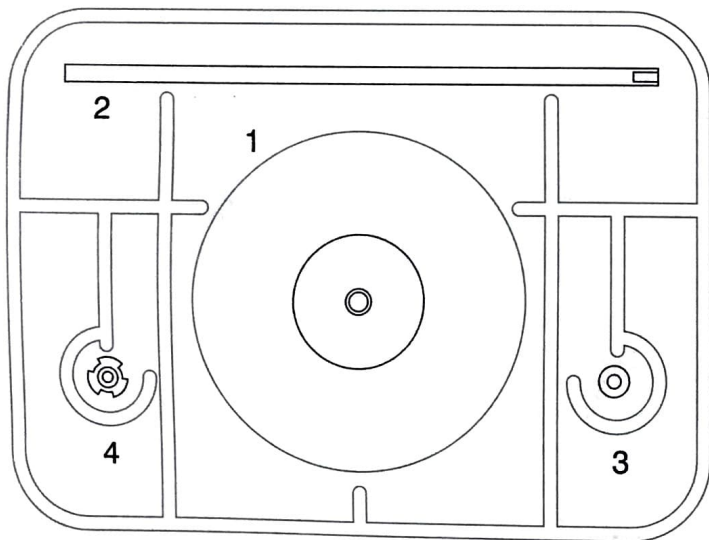

If preferred, shorten  
vertical support  
from base (solid) end

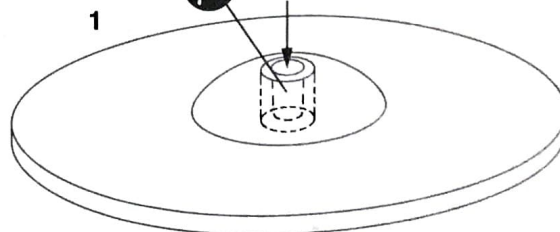

# USAF, YT-34A, 1950

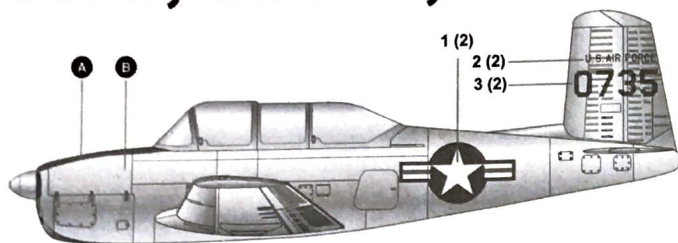

# Japan, T-34A, 1957

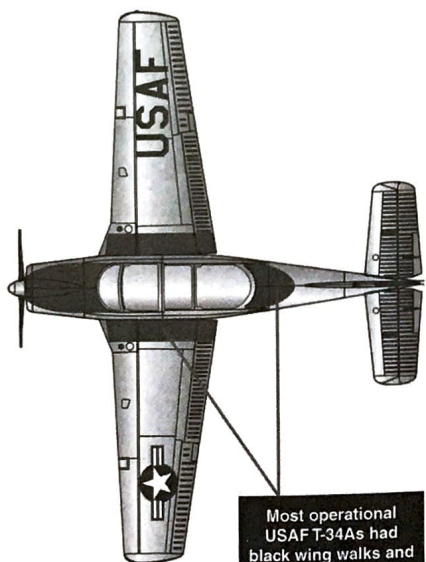
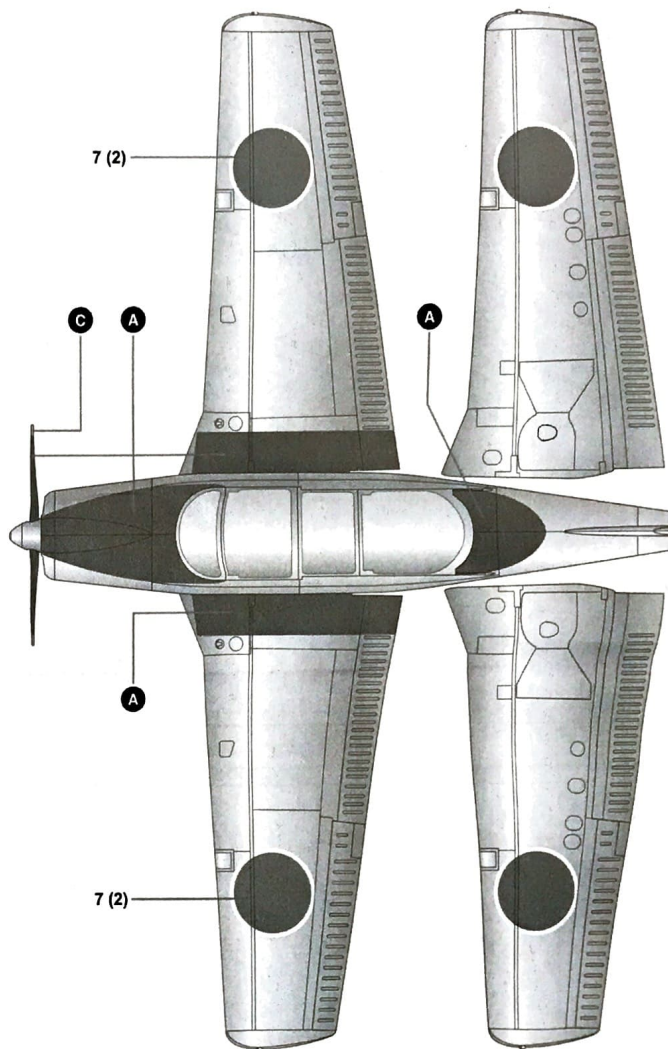
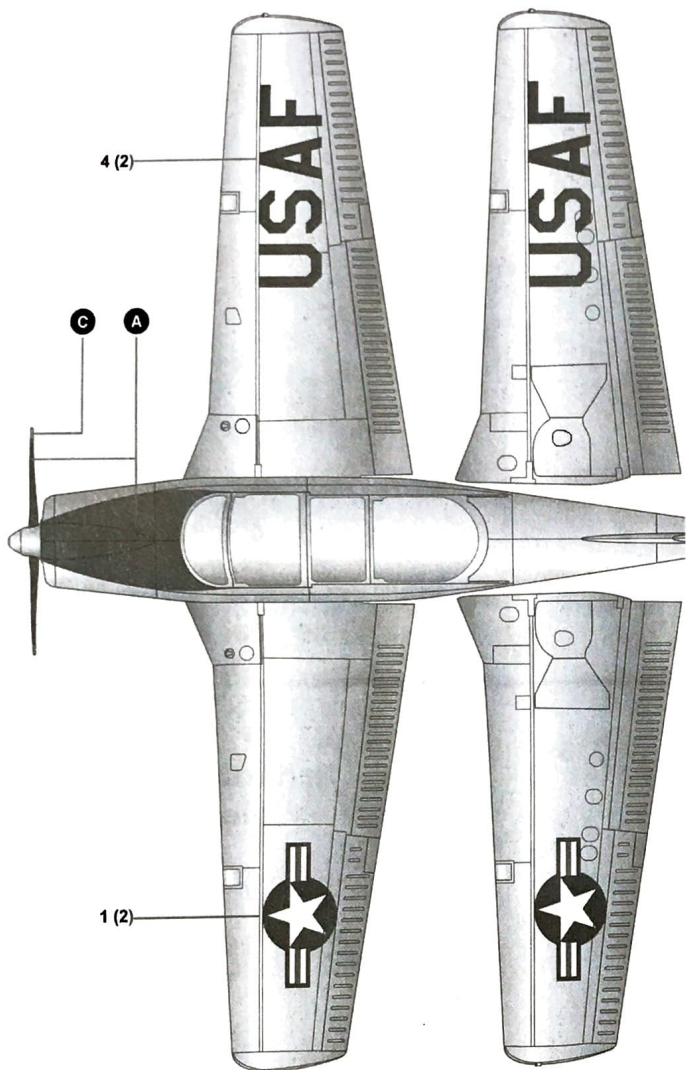
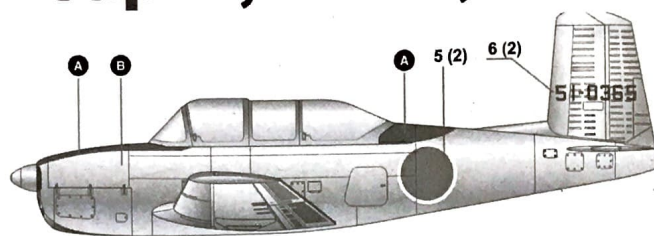

Most operational USAF T-34As had black wing walks and rear anti-glare panel.

## PAINTS

- A Black  
(ModelMaster 1749, Acryl 4768)
- B Aluminum  
(ModelMaster 1781, Acryl 4677)
- C Insignia Yellow  
(ModelMaster 1708, Acryl 4721)





1

U.S. AIR FORCE  
U.S. AIR FORCE

2

0735 0735

3



1



USAF

4



6

51-0365 51-0365

1-48 T-34A • 11671  
©2018 Minicraft Models (US) LLC

USAF



5

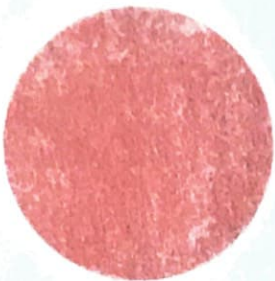

7

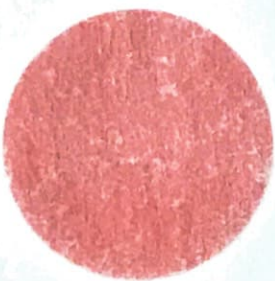

7

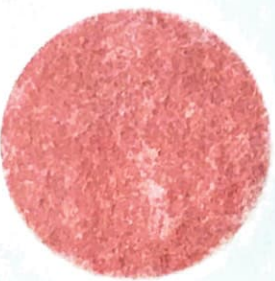

7

