



F-101B VOODOO

KIT 4456

1/72 SCALE

1/72 ECHELLE

ESCALA 1/72

REVELL, INC. Des Plaines, IL Copyright © 1992 All rights reserved. Made in U.S.A. 4456 R 4200

The sleek McDonnell-Douglas F-101 survived initial questions concerning its operational mission to become one of the finest fighter-interceptor aircraft ever built. Although conceived as a long-range fighter escort, it became readily apparent that the new breed of strategic bombers had little need for escort aircraft. However, the threat of a strategic nuclear attack created a demand for an all-weather fighter-interceptor, and the very versatile F-101B proved to be perfectly suited for this mission.

Developed specifically to combat the threat of manned bombers, the two-place "Voodoo" compiled an impressive service record that spanned more than 25 years. Powered by the after-burner-equipped J-57 turbojet engines, it could achieve speeds over 1,200 miles per hour.

Armament consisted of two externally mounted "Genie" nuclear-tipped missiles, and two Hughes "Falcon" rocket-powered missiles that were mounted on a rotating launcher positioned on the underside of the fuselage. Two external fuel tanks were fitted to improve range.

In spite of the fact that the F-101B never attacked an enemy aggressor, it performed its intended role most admirably. During its operational life, the "Voodoo" served with active duty U.S. Air Force squadrons and Air National Guard units assigned to the Air Defense Command. While in service with "The Guard", this sleek fighter compiled an impressive service record in simulated operational exercises such as the challenging "William Tell" meets.

If you have any problems building this model, call our modeling tips hotline at: **(800) 833-3570**

READ THIS BEFORE YOU BEGIN

- Study the assembly drawings.
- Each plastic part is identified by a number.
- Check the fit of each piece before cementing in place.
- Do not use too much cement to join parts.
- Use only cement for polystyrene plastic.
- Model may be painted to match photos on box.
- Allow paint to dry thoroughly before handling parts.
- Scrape paint from areas to be cemented.
- For better paint and decal adhesion, wash the plastic parts in a mild detergent solution. Rinse and let air dry.

LISEZ CE QUI SUIT AVANT DE COMMENCER

LE MONTAGE

- Etudiez les schémas d'assemblage.
- Chaque pièce plastique porte un numéro d'identification.
- Contrôlez que chaque pièce soit bien conforme avant de la coller à sa place.
- N'utilisez pas trop de colle pour réunir les pièces.
- Utilisez uniquement une colle spéciale pour polystyrène.
- Le modèle peut être peint conformément aux photos sur la boîte.

- Laissez sécher la peinture complètement, avant de manipuler les pièces.
- Grattez la peinture sur les surfaces devant être collées.
- Pour assurer la meilleure adhésion possible de la peinture et des décalcomanies, lavez les pièces de plastique avec une légère solution savonneuse. Rincer et laisser sécher à l'air.

LEA ESTO ANTES DE EMPEZAR

- Estudie los dibujos de ensamblaje.
- Cada pieza de plástico se identifica por un número.
- Verifique que cada pieza encaje bien antes de pegar en posición.
- No use demasiado pegamento para unir las piezas.
- Use únicamente pegamento para plástico de poliestirena.
- El modelo puede pintarse de acuerdo con las fotografías de la caja.
- Permita que se seque la pintura completamente antes de tocar las piezas.
- Raspe la pintura de las superficies que serán pegadas.
- Para una mejor fijación de la pintura y de las calcomanías, lávase las piezas plásticas en una solución de detergente suave. Enjuáguese y déjese secar al aire.



DECAL (DIP IN WATER)
DECALCOMANIE (A PLONGER DANS L'EAU)
DECALCOMANIA (MOJE CON AGUA)

Revell, Incorporated has put forth every effort to create and manufacture the finest model kit available. If a part may be missing, please write to:

Revell, Incorporated
Consumer Service Department
395 North Third Avenue
Des Plaines, Illinois 60016



ALTERNATIVE ASSEMBLY
ENSEMBLAGE ALTERNATIVE
ENSAMBLE ALTERNATIVO

Be sure to include the kit number, part number, description, and your return address.



REMOVE AND THROW AWAY
À RETIRER ET JETER
QUITE Y TIRER



REPEAT SEVERAL TIMES
À RÉPÉTER PLUSIEURS FOIS
REPITA VARIAS VECES



OPTIONAL PARTS
PIÈCES EN OPTION
PIEZAS OPCIONALES

A	SATIN BLACK	NOIR MAT	NEGRO MATE
B	FLAT RED	ROUGE TERNE	ROJO APAGADO
C	METALLIC	METALLIC	METALICO
D	FLAT BLACK	NOIR TERNE	NEGRO APAGADO
E	OLIVE DRAB	VERT OLIVE	ACEITUNADO
F	DARK GRAY	GRIS FONCE	GRIS OSCURO
G	ALUMINUM	ALUMINIUM	ALUMINIO
H	ZINC CHROMATE	CHROMATE DE ZINC	CROMATO DE CINC
J	SATIN WHITE	BLANC	BLANCO
K	GUN METAL	METALLIC	METALICO

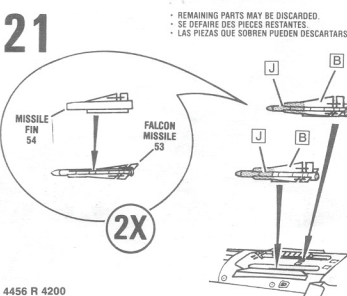
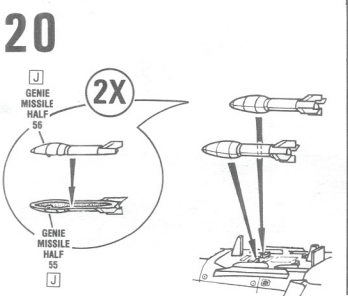
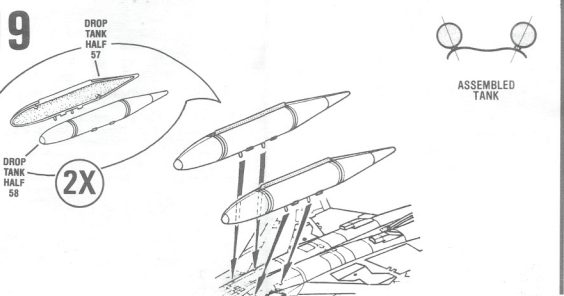
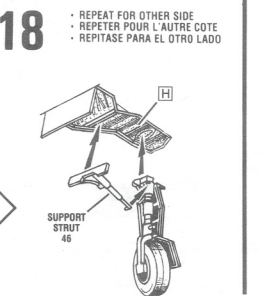
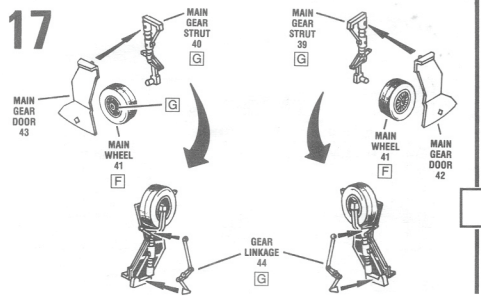
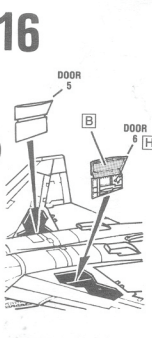
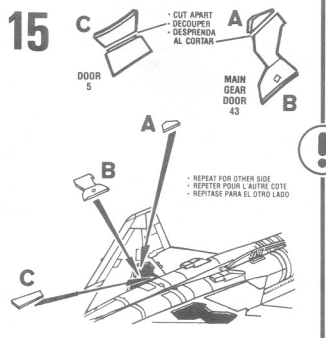
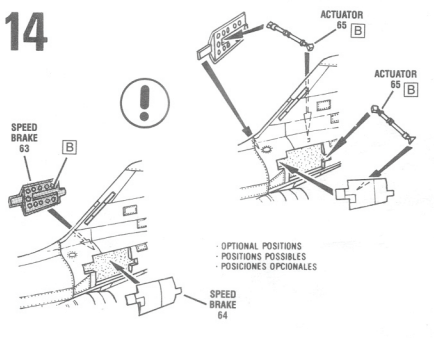
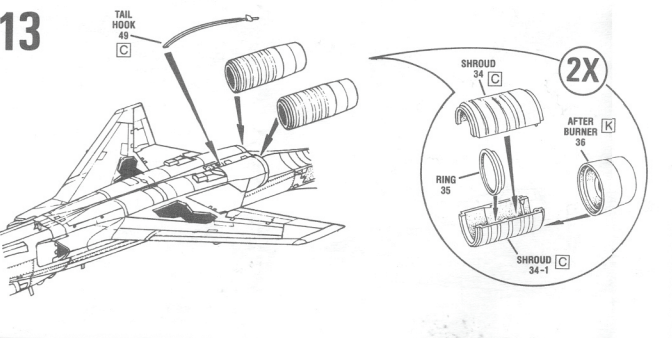
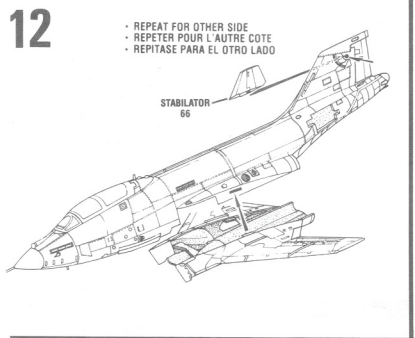
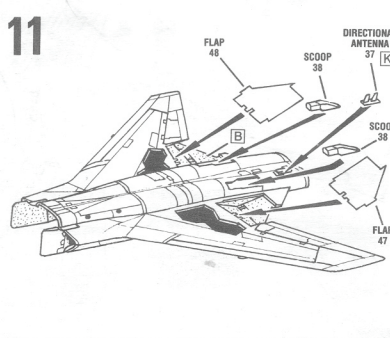
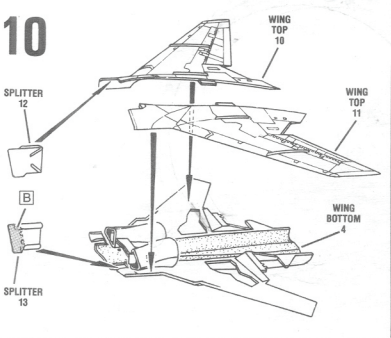
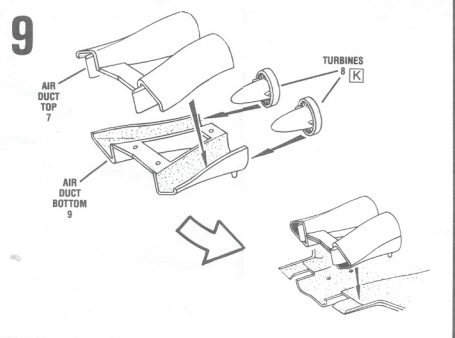
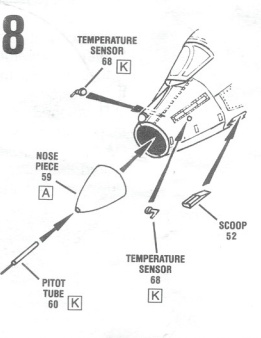
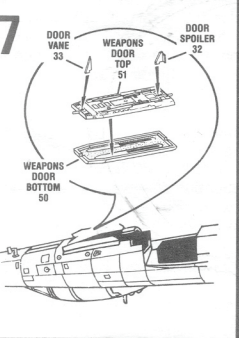
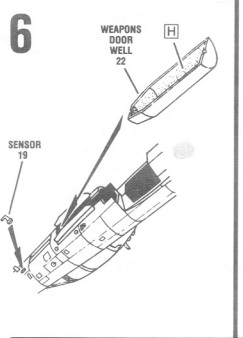
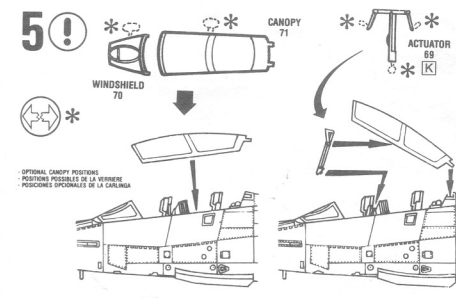
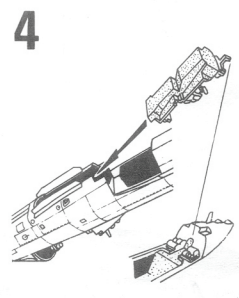
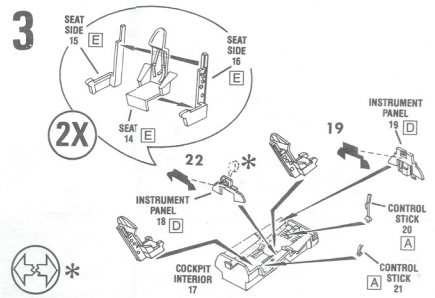
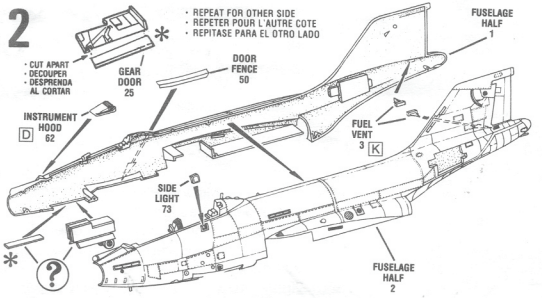
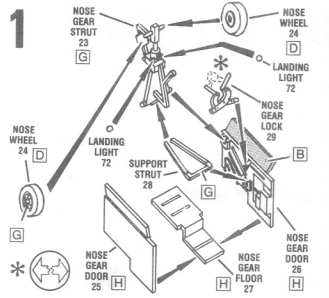

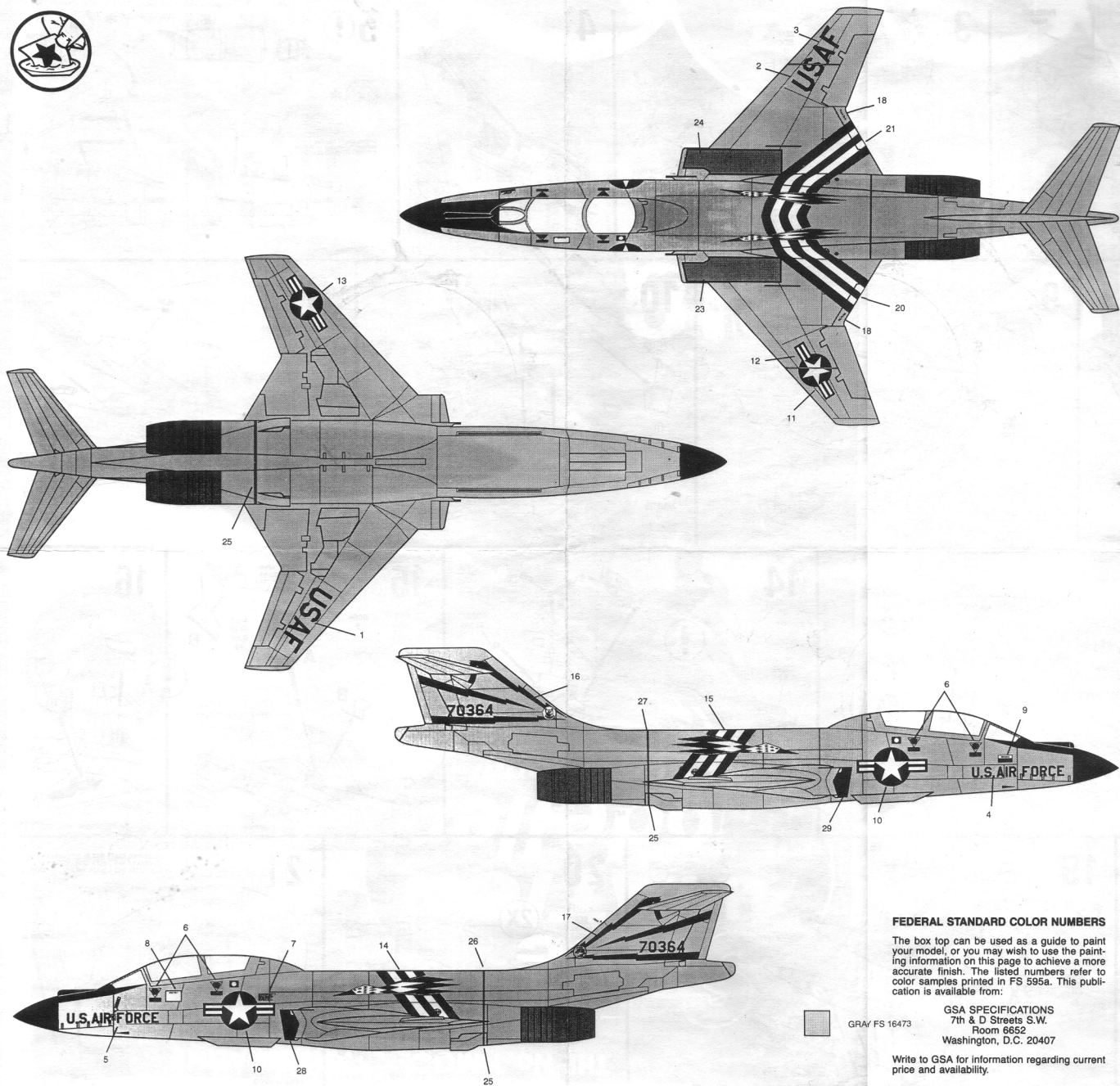

FEDERAL STANDARD COLOR NUMBERS

The box top can be used as a guide to paint your model, or you may wish to use the painting information on this page to achieve a more accurate finish. The listed numbers refer to color samples printed in FS 595a. This publication is available from:

GSA SPECIFICATIONS
7th & D Streets S.W.
Room 6652
Washington, D.C. 20407

Write to GSA for information regarding current price and availability.