

WWII GERMANY LANDCRUISER P1000 RATTE



搜模閣

UA72088

1:72
SCALE

modelcollect

WWII GERMANY LANDCRUISER P.1000 RATTE



ITEM NO:UA72088

The Landkreuzer P. 1000 "Ratte" (English: Land Cruiser P. 1000 "Rat") was a design for a super-heavy tank for use by Nazi Germany during World War II, proposed by Krupp director Edward Grotte in June 1942, who had already named it "Landkreuzer". Submitted designs and drawings of the tank went under the names OKH Auftrag Nr. 30404 and E-30404/1, which were presented in December 1942. The tank was planned to be 1000 metric tonnes, being far heavier than the Panzer VIII "Maus", the heaviest tank ever built (weighing 188 tonnes). The project gained the approval of Adolf Hitler, who had expressed interest in the development of the tank, but was canceled by Minister of Armaments Albert Speer in early 1943.

The Ratte is known for its enormous size: it would have weighed 1,000 tonnes, five times the weight of the Panzer VIII Maus. The divided weight of the Ratte included 300 tonnes of armament (the total weight of the guns themselves was 100 tonnes, so turret armour would have weighed 200 tonnes), 200 tonnes of armour and frame and 100 tonnes of track and automotive components, while remaining weight would be distributed to miscellaneous features. It was planned to be 35 m long (37 metres when including naval guns), 11 m high and 16 m wide. To compensate for its immense weight, the Ratte would have been equipped with three 1.2 m (3 ft 11 in) wide and 21 m (69 ft) long treads on each side with a total tread width of 7.2 m (23 ft 7 in). This would help stability and weight distribution, but the vehicle's sheer mass would have destroyed roads and rendered bridge crossings next to impossible. It was expected that its height, and its ground clearance of 2 m (6.6 ft), would have allowed it to ford most rivers with relative ease, thus eliminating the need for bridge crossings.

Planned propulsion was by two MAN V12Z32/44 24-cylinder marine diesel engines of 6,300 kW (8,400 hp) each (as used in U-boats) or eight Daimler-Benz MB 501 20-cylinder marine diesel engines of 1,500 kW (2,000 hp) each (as used in E-boats) to achieve the 12,000 kW (16,000 hp) needed to move this tank. The engines were to be provided with snorkels, also like those used by German submarines. The snorkels were designed to provide a way for oxygen to reach the engine, even during amphibious operations passing through deep water.

The Ratte's primary weapon would have been a dual 280 mm SK C/28 gun turret. This was the same turret that was used on the German capital ship Gneisenau but modified by removing one of the guns and its associated loading mechanism. Removing the third gun allowed extra accommodation of ammunition, and reduced the total weight of the tank by 50 tonnes. The guns used for the Ratte would have fired ammunition developed for other naval guns. It also included armour-piercing rounds with 8.1 kg (18 lb) of explosive filler, and high-explosive rounds with 17.1 kg (38 lb) of explosive filler.

Further armament was to consist of a 128 mm anti-tank gun of the type used in the Jagdtiger or Maus, two 15 mm Mauser MG 151/15 autocannons, and eight 20 mm Flak 38 anti-aircraft guns, probably with at least four of them as a Flakvierling quad mount. The 128 mm anti-tank gun's precise location on the Ratte is a point of contention among historians, most believing that it would have been mounted within the primary turret, with some others thinking a smaller secondary turret at the rear of the Ratte more logical. Some concept drawings exist to suggest a flexible mount on the glacis plate. The tank was to be provided with a vehicle bay that could hold two BMW R12 motorcycles for scouting, and several smaller storage rooms, a compact infirmary area, and a self-contained lavatory system.

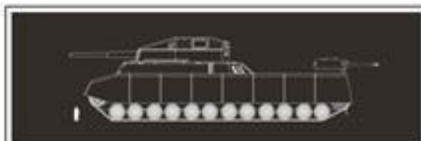

Type	Project super-heavy tank
Place of origin	Nazi Germany
Production history	
Designer	Krupp
Specifications	
Weight	1,000 tonnes (1,100 short tons; 980 long tons), estimated
Length	35m hull 37m guns forwards
Width	16m
Height	11m
Crew	20+, possibly as many as 41
Armor	150–360 mm (5.9–14.2 in)
Main	2 × 280 mm 54.5 SK C/34
Engine	8 × Daimler-Benz MB501 20-cylinder marine diesel engines, or 2 × MAN V12Z32/44 24-cylinder marine diesel engines 12,000 to 13,000 kW (16,000 to 17,000 hp)
Ground clearance	2 m (79 in)
Operational range	~190 kilometres (120 mi)
Speed	~25 miles/hour

●READ BEFORE ASSEMBLY

1. When you use glue or paint, do not near flame, and use in a well-ventilated room.
2. Take extra care in handling photo etch parts in order to avoid injury
3. When you take parts off the runner frame, use modeling scissors and trim excess plastic with a cutter or a file.
4. Glue and paint are not included.
5. This product is only suitable for experienced more than 14 years old.

●装配之前仔细阅读:

1. 勿於近火处使用胶水或油漆, 并 打开窗户保持空气流通。
2. 取蚀刻片时应特别注意安全, 防止利边划伤手指。
3. 从胶架中取出部件时, 应用模型专用剪, 并用界刀或小锉除去多余的胶料。
4. 请使用塑料胶水和油漆, 模型内不含。
5. 本产品不适合14岁以下没有经验的模型爱好者。

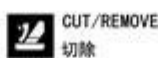
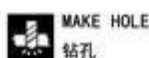

DECAL APPLICATION

1. Cut off decal from sheet.
2. Dip the decal in tepid water 40° C for about 10 sec. and place on a clean cloth.
3. Hold the backing sheet edge and slide decal onto the model.
4. Move decal into position by wetting decal with finger.
5. Press decal gently down with a soft cloth until excess water and air bubbles are gone.

水贴纸的使用:

1. 从水贴纸上剪下印花。
2. 将印花放入温水中浸10秒, 然后放在干净布上。
3. 拿着印花纸将印花移到模型上。
4. 手指蘸水将印花移到适当的位置。
5. 用软布轻压印花直至不干, 汽泡消失。

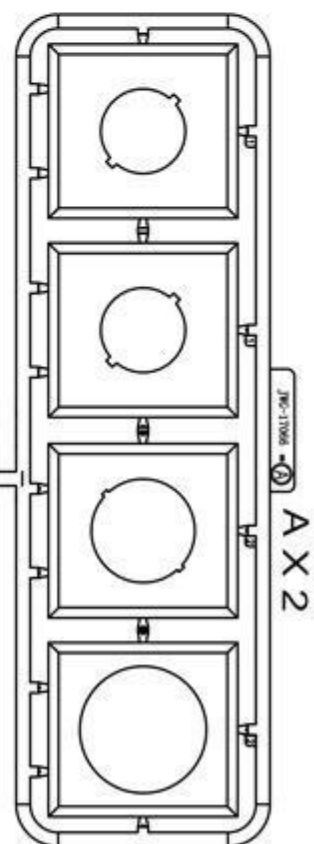
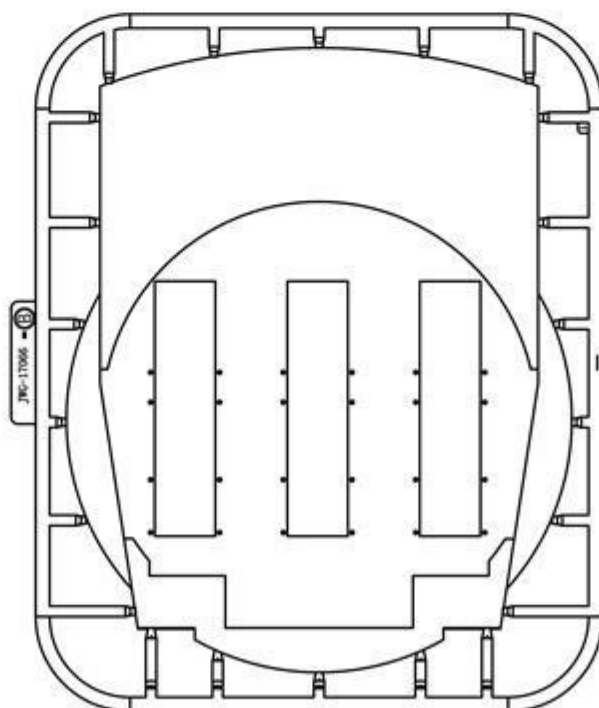
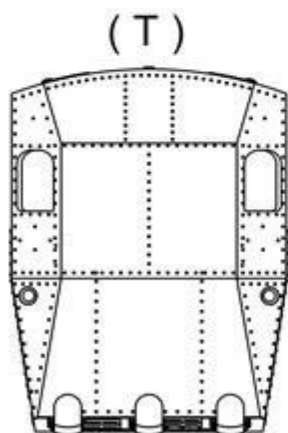
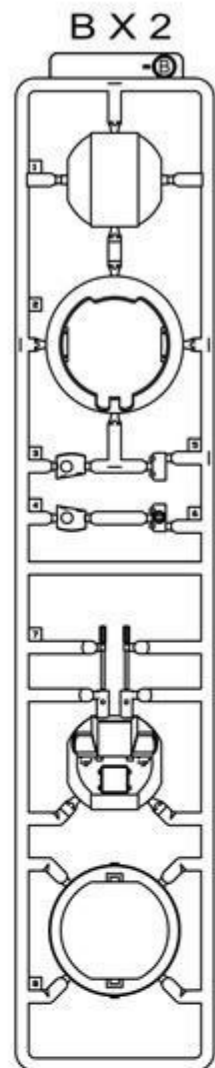
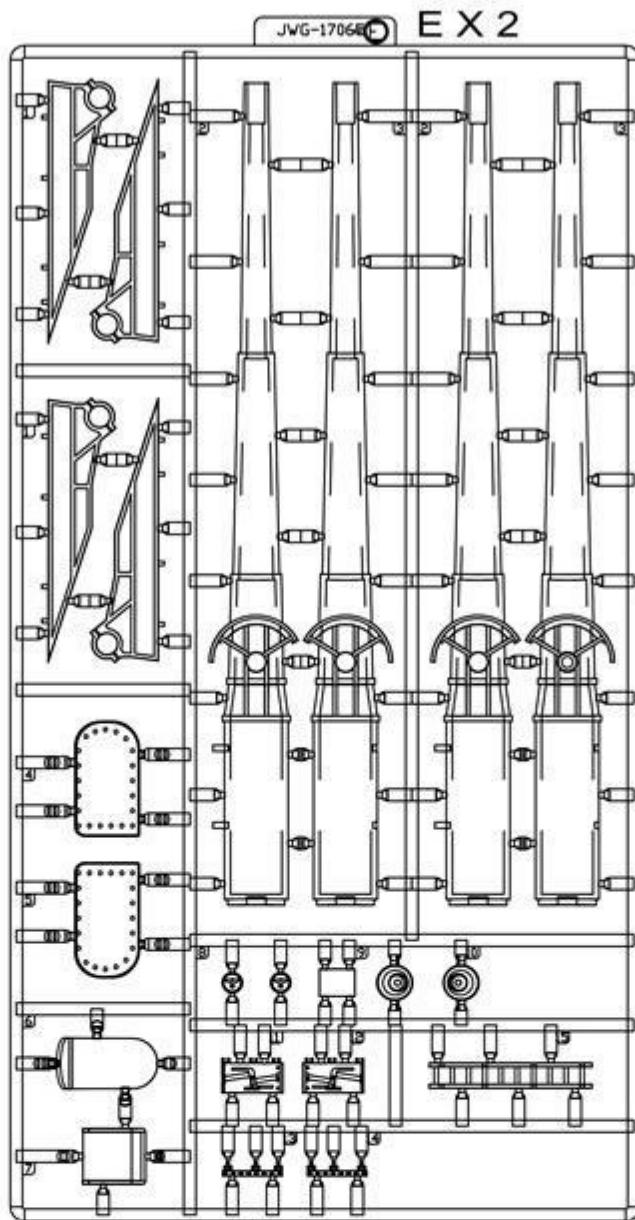
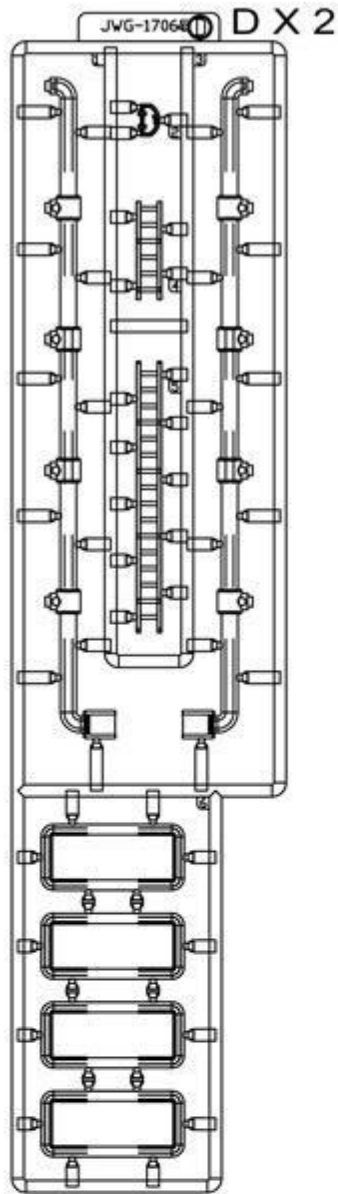

PE-72030 X 2

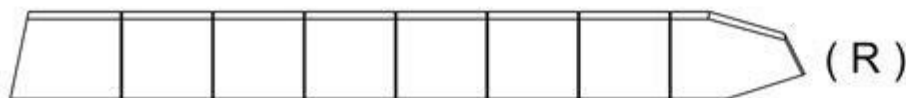
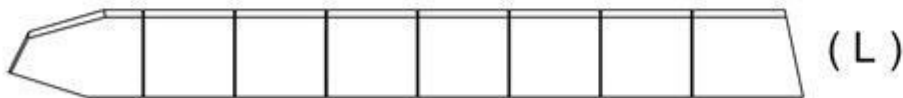
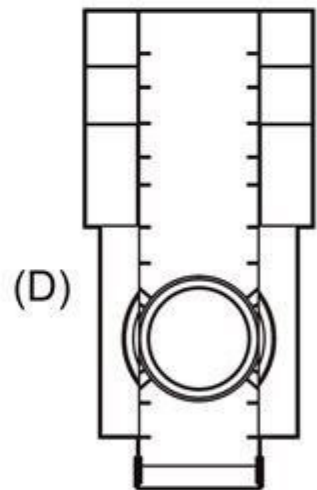
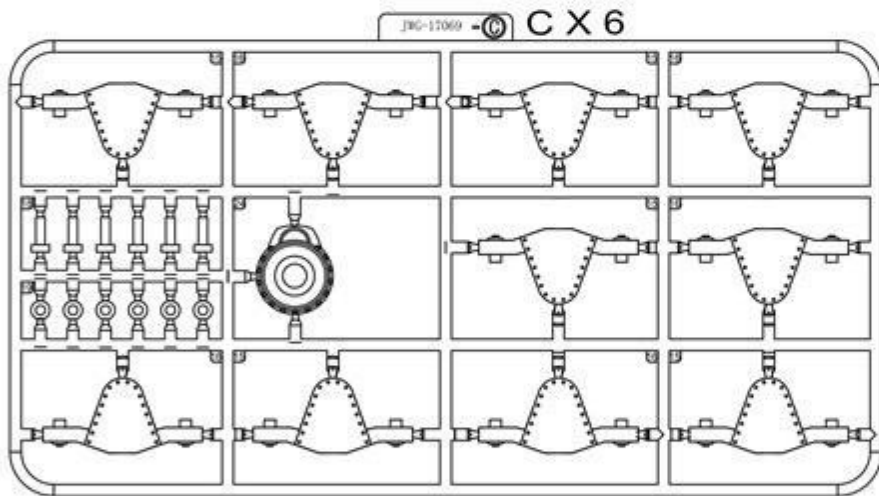
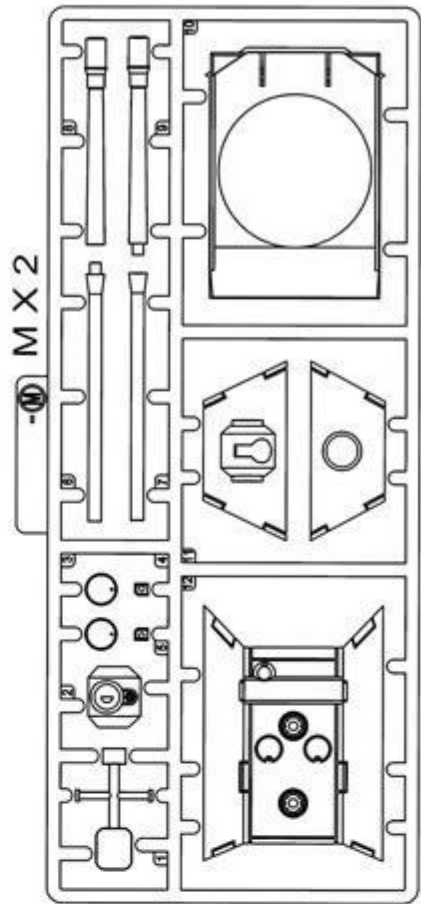
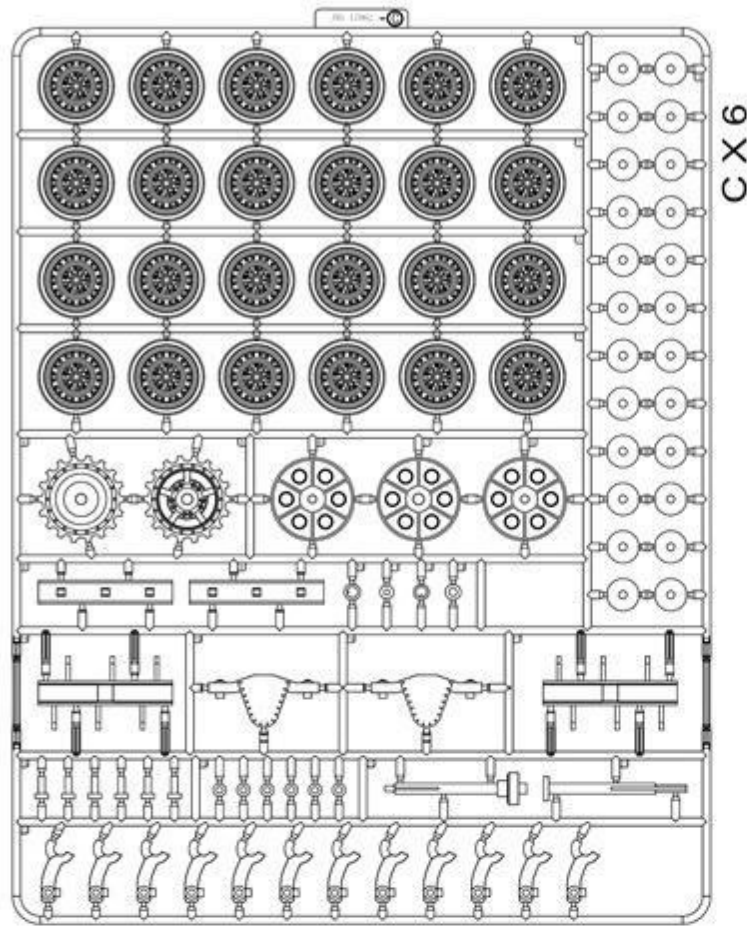

(H) X 72

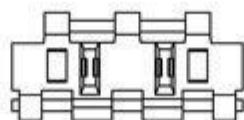

(L) X 1068

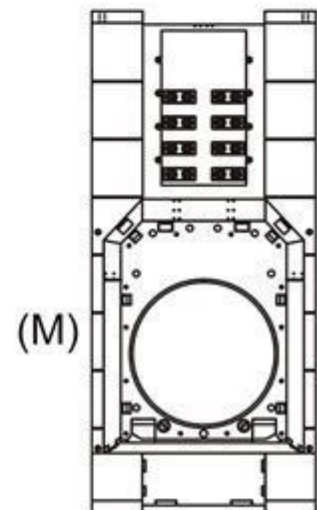

1

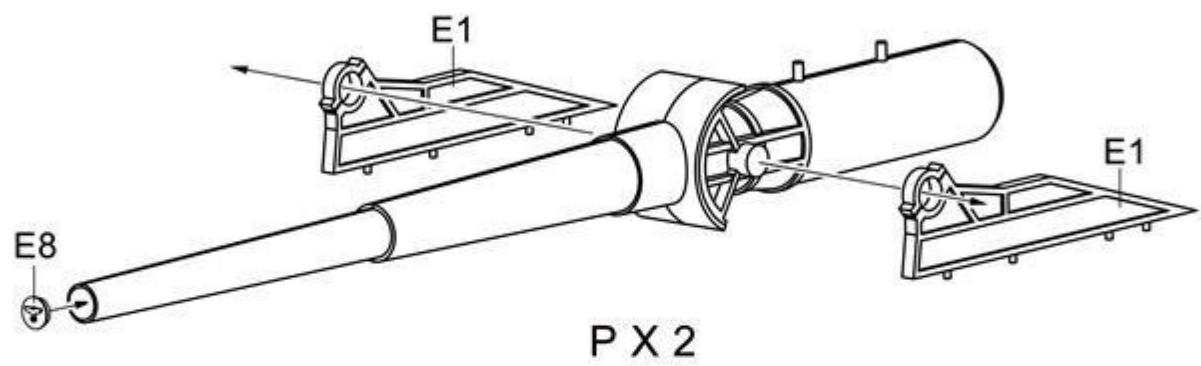
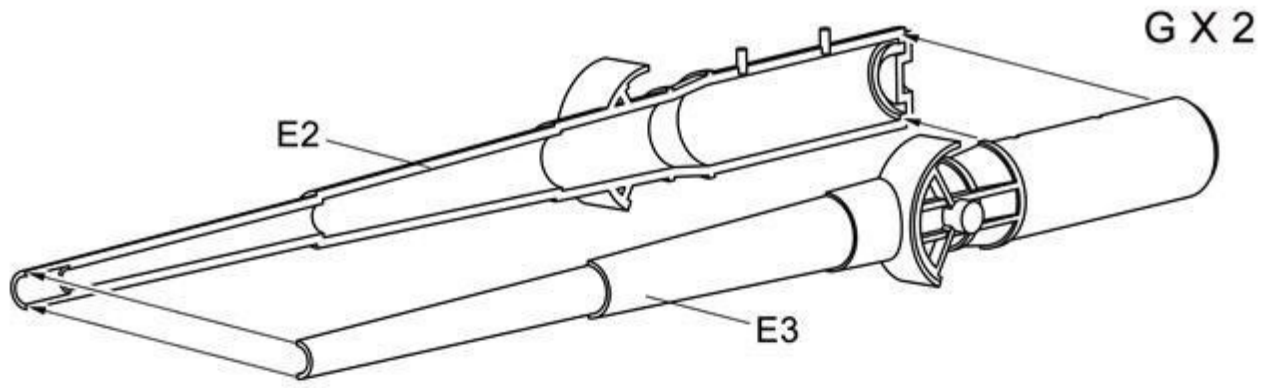

2

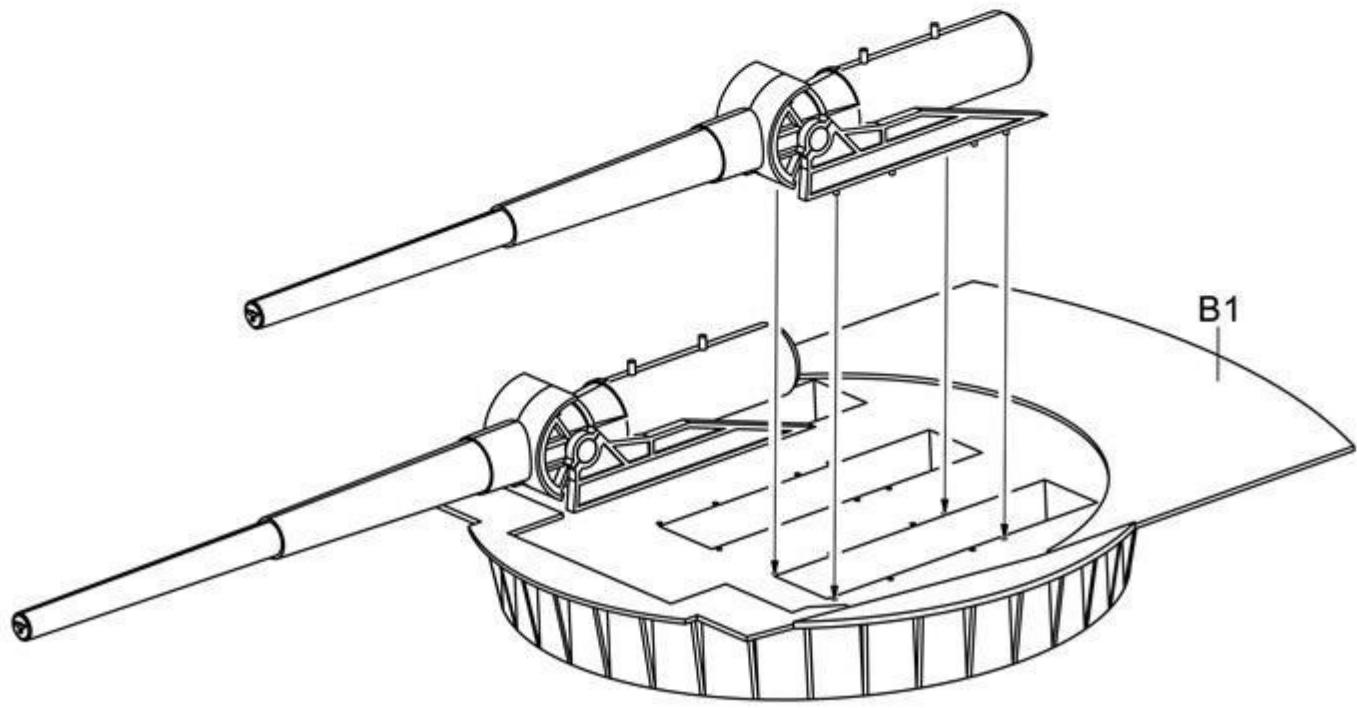

3

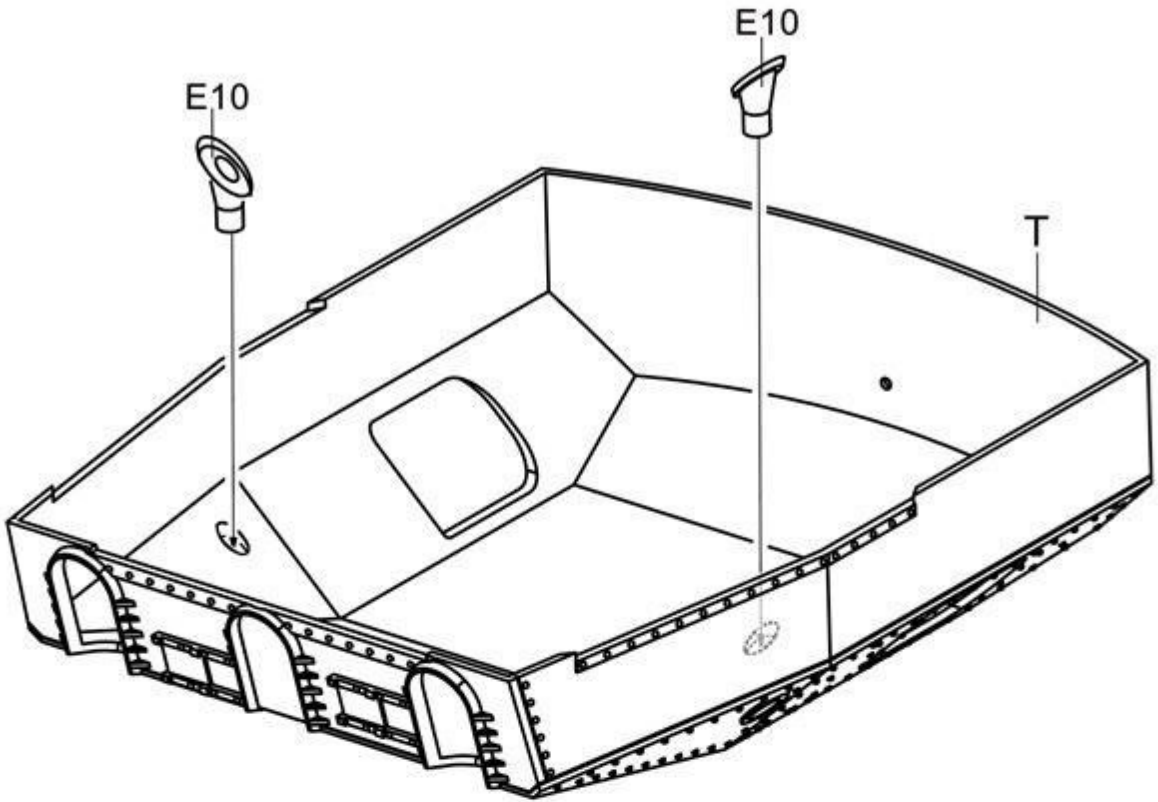

4

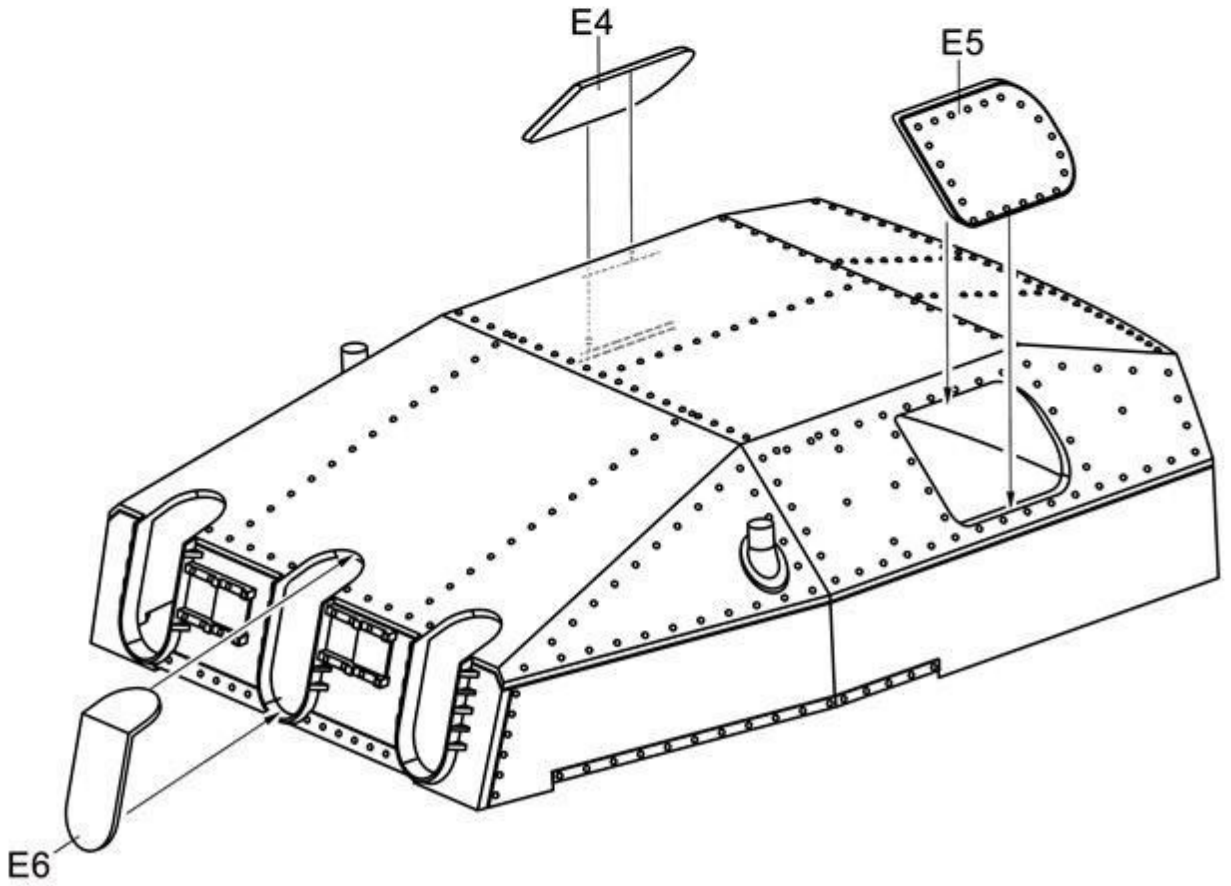

5

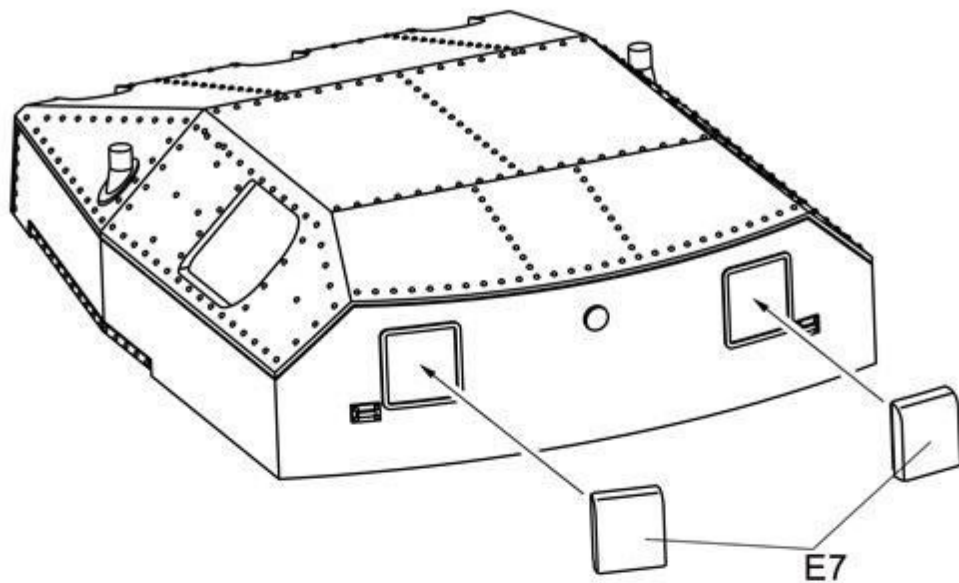

6

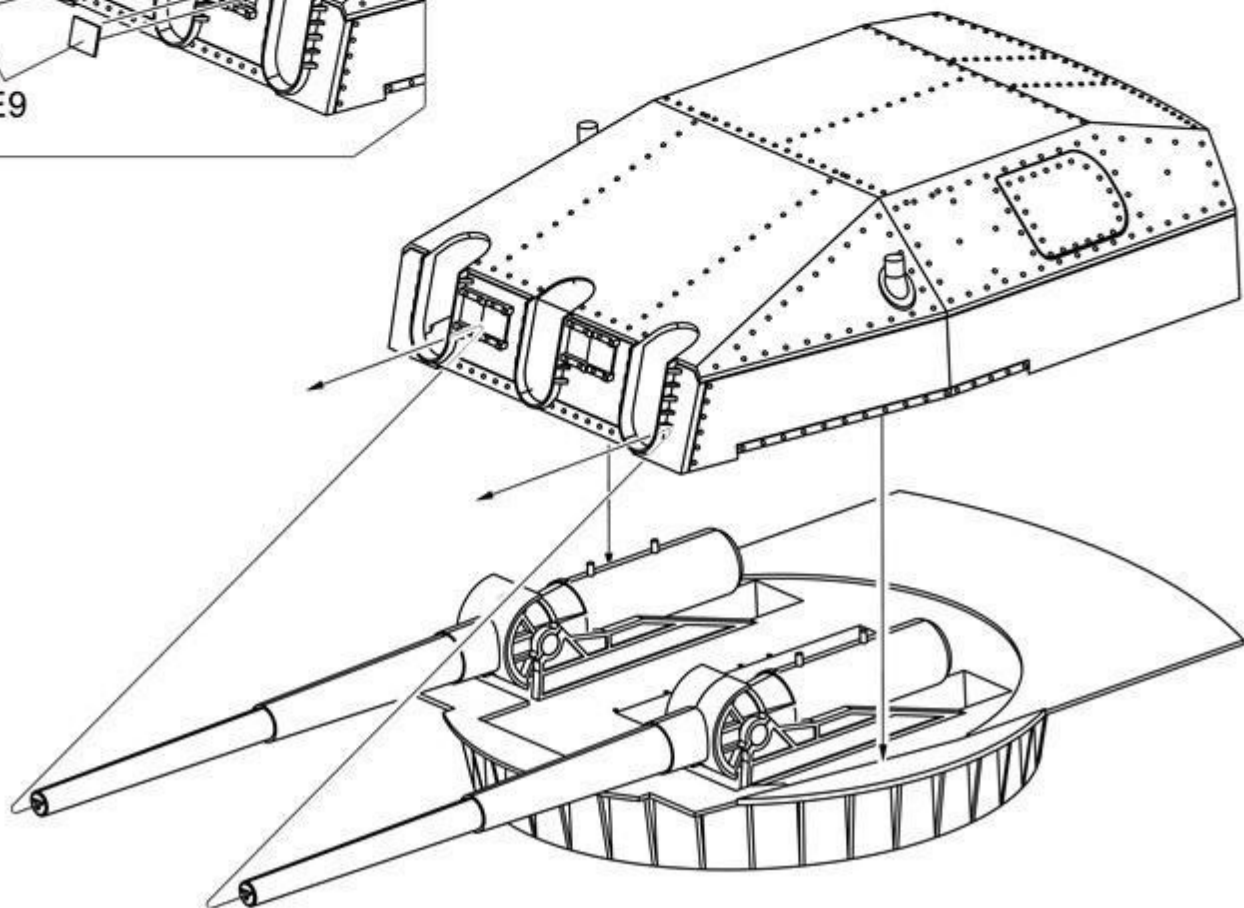
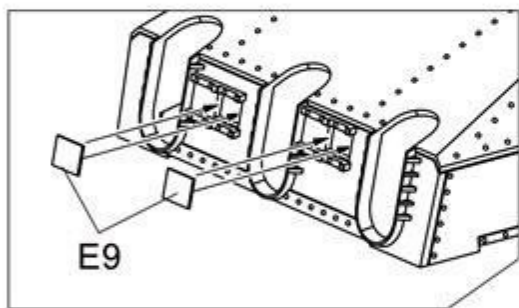

7

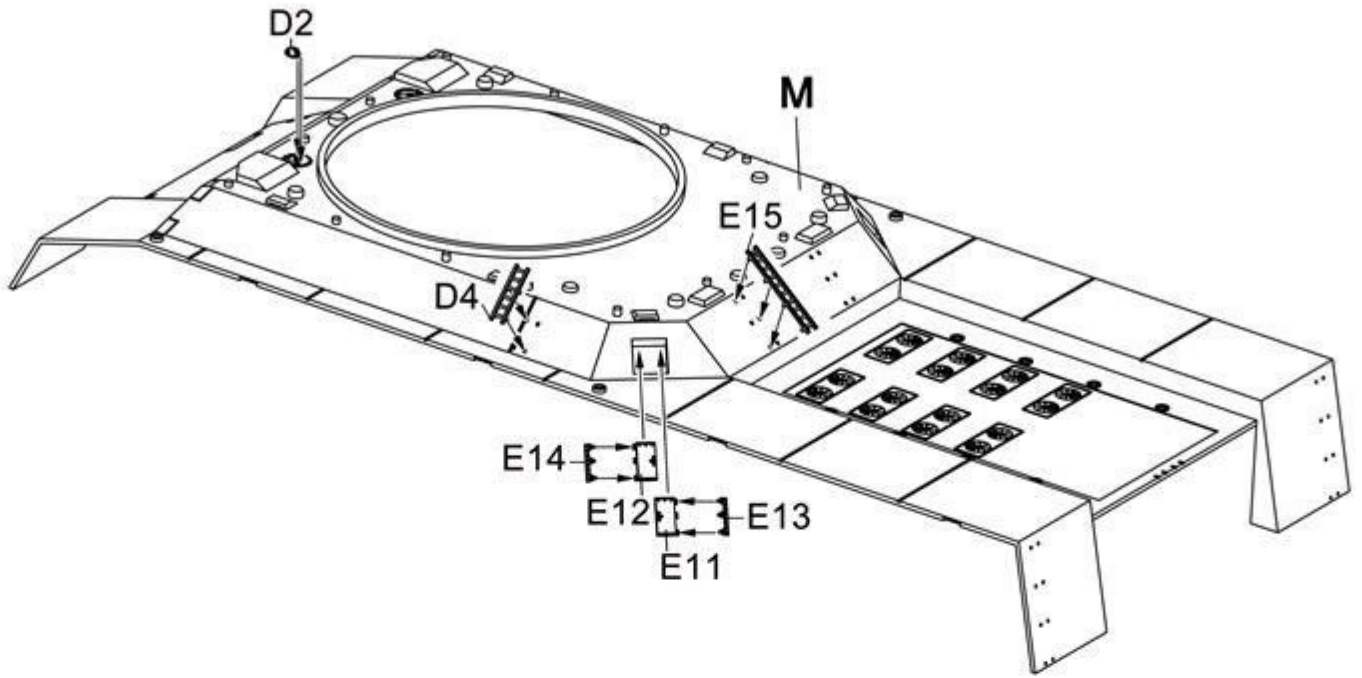

8

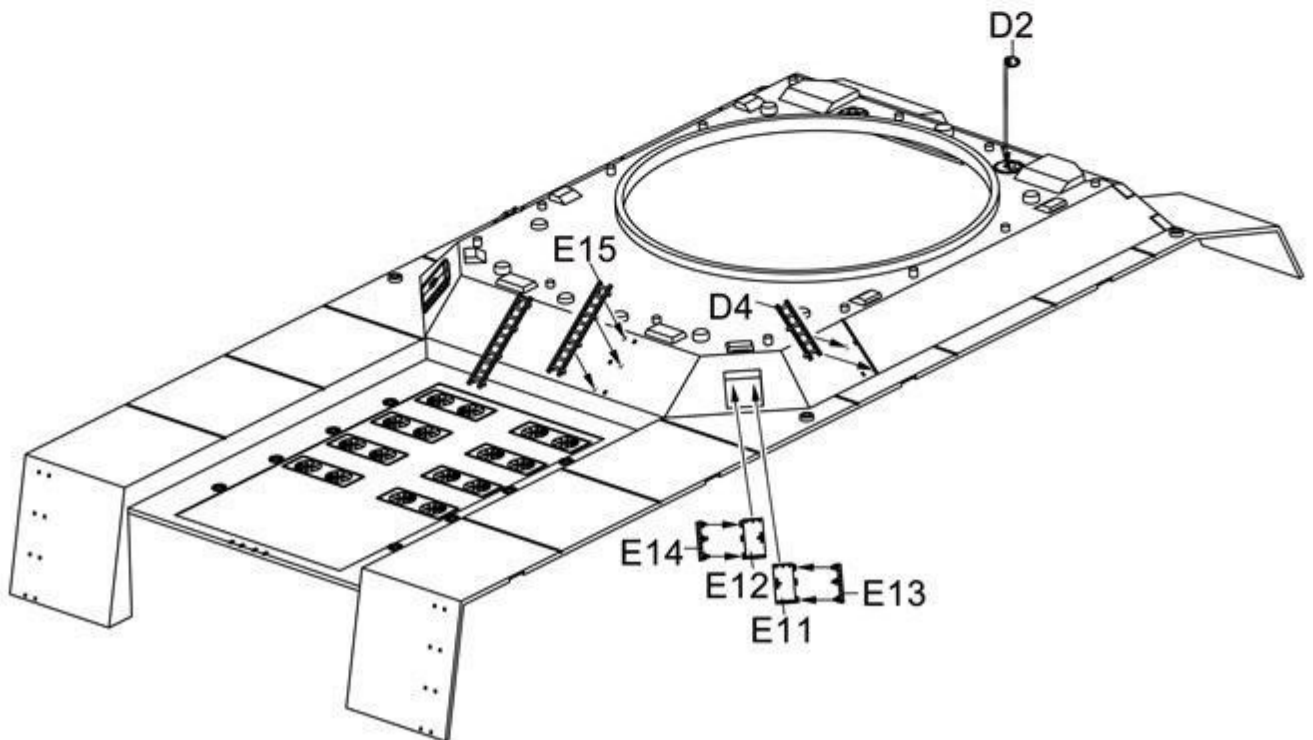

9

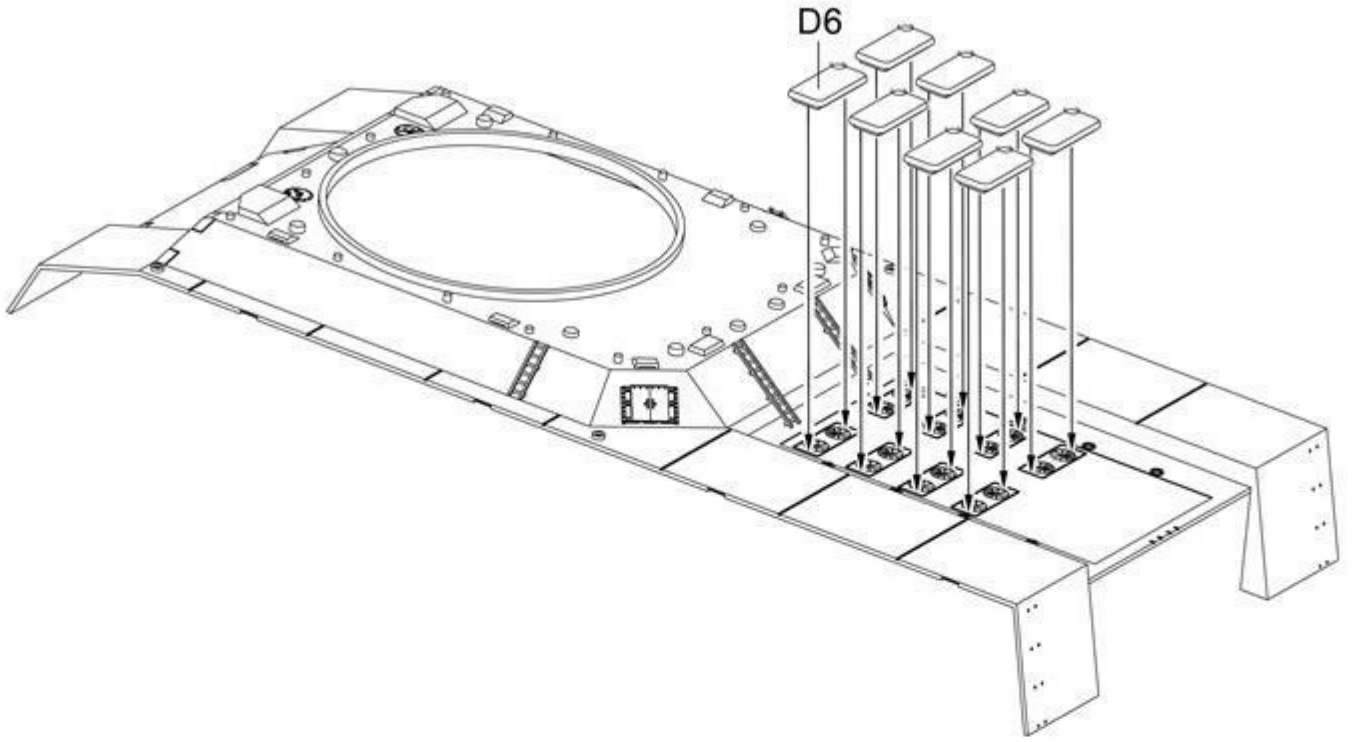

10

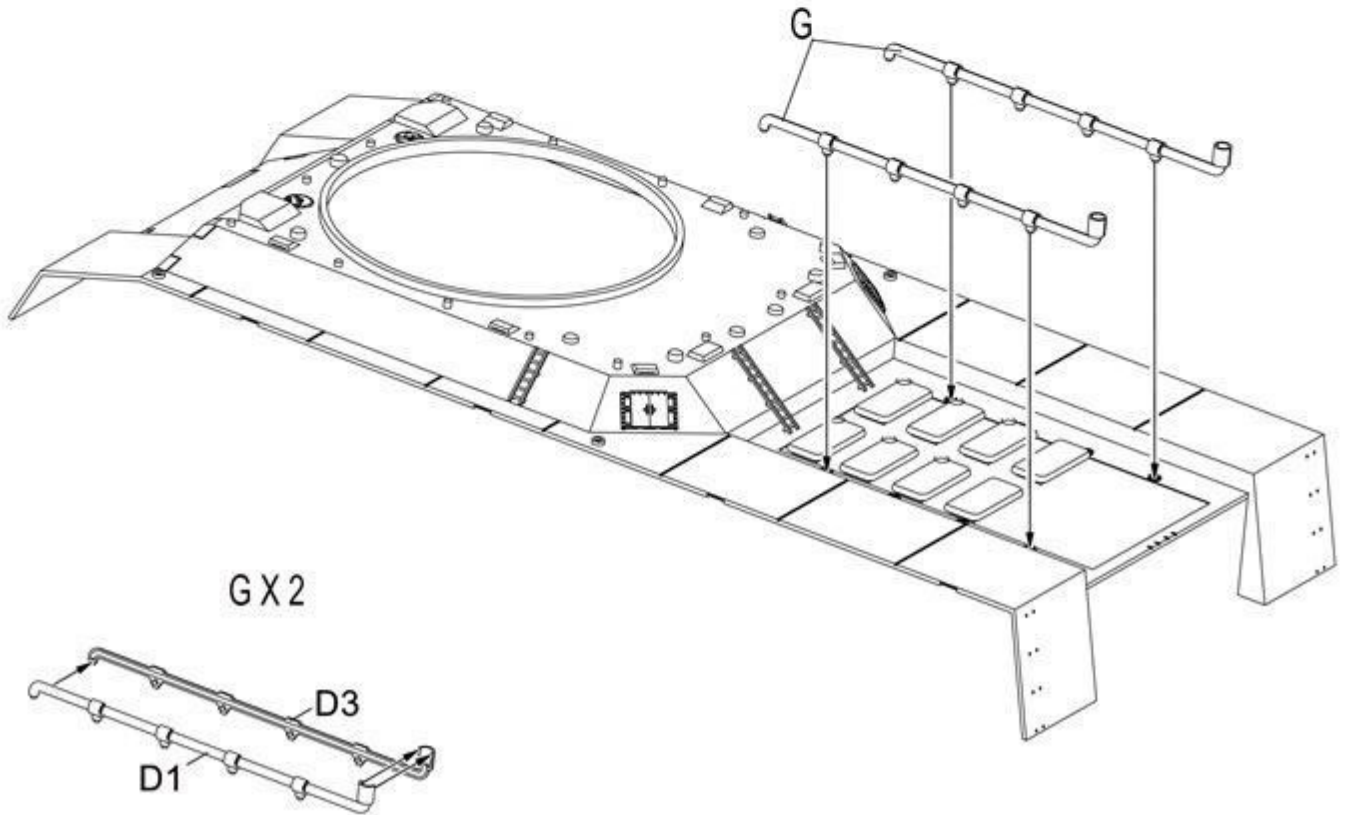

11

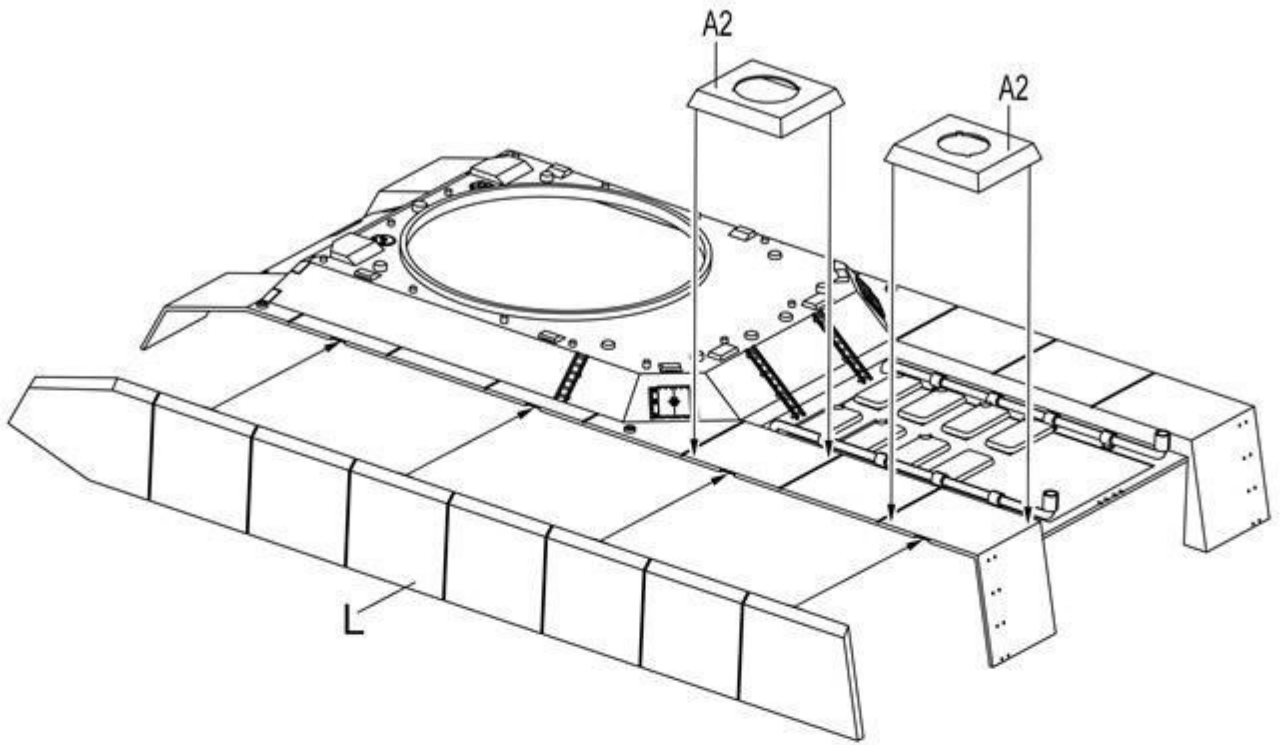

12

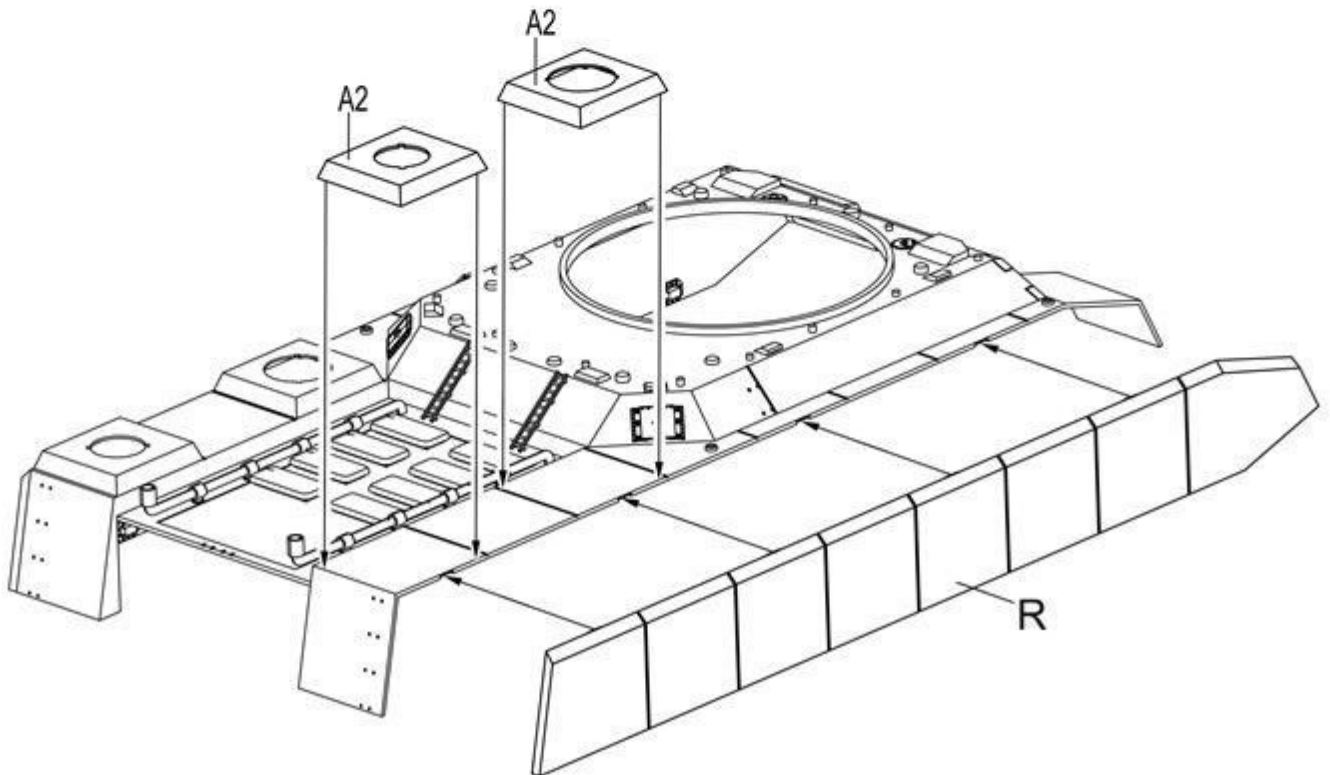

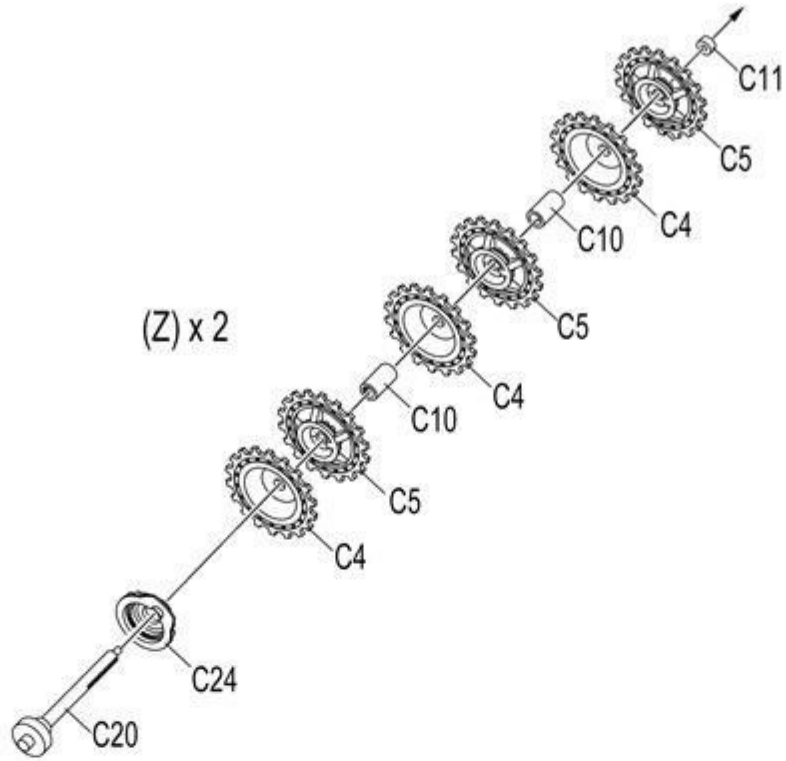

(A) X 12

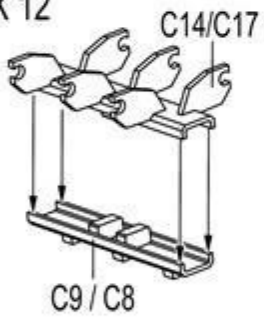

(B) X 36

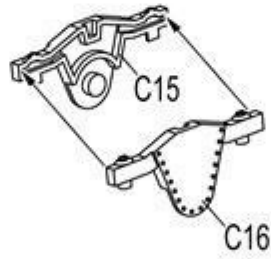

(C) X 36

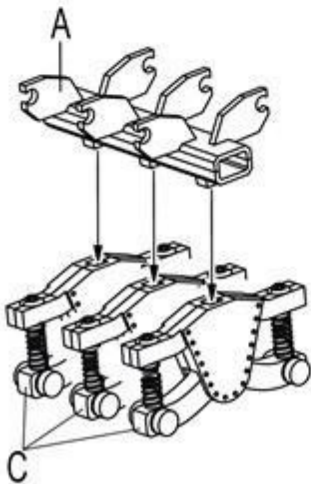
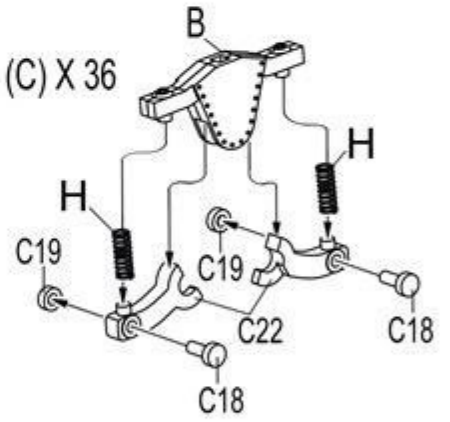

(L) x 12

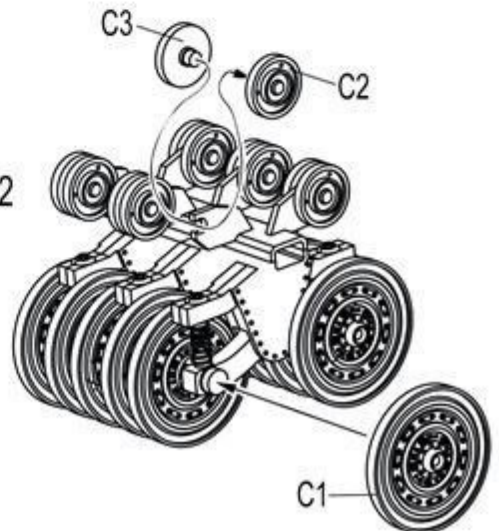

15

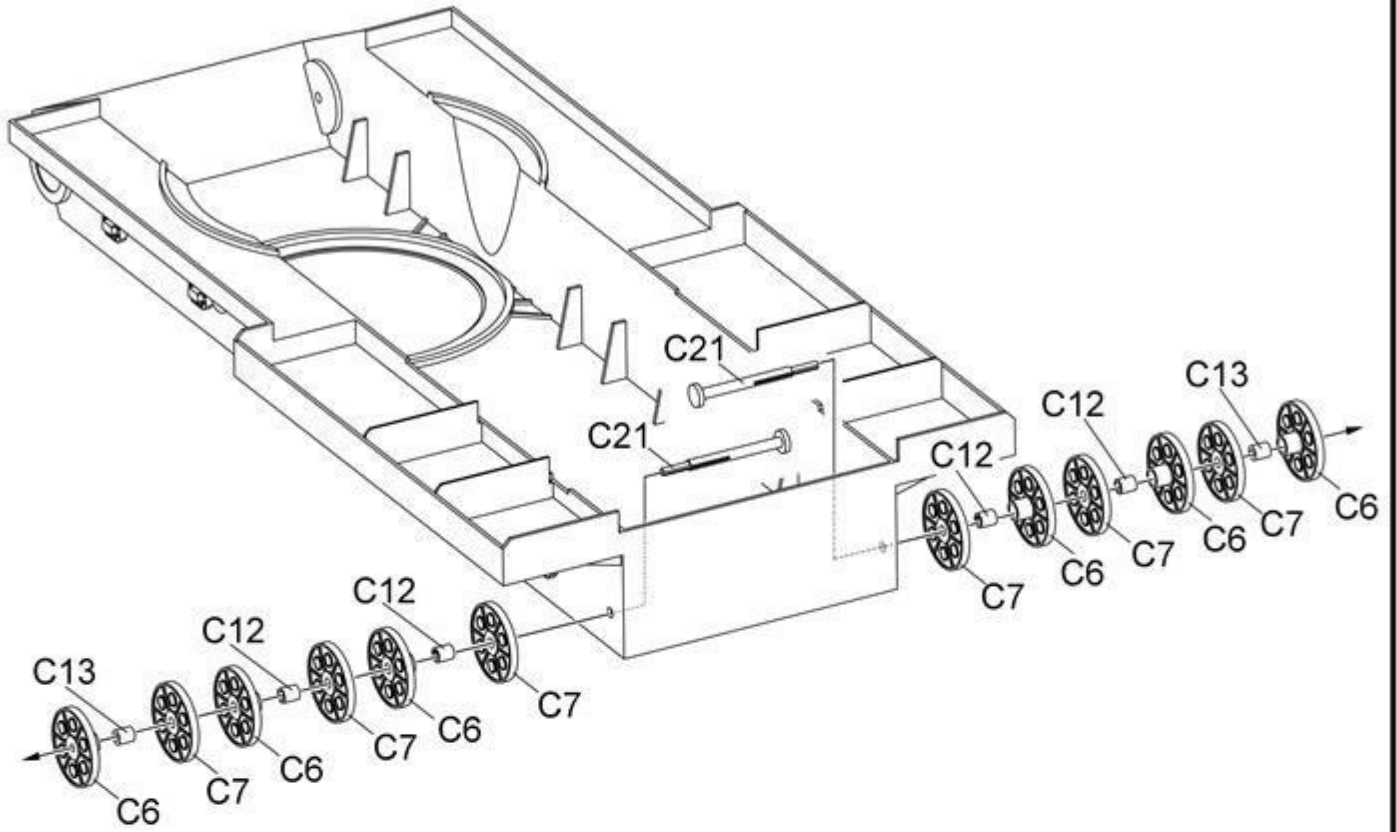

16

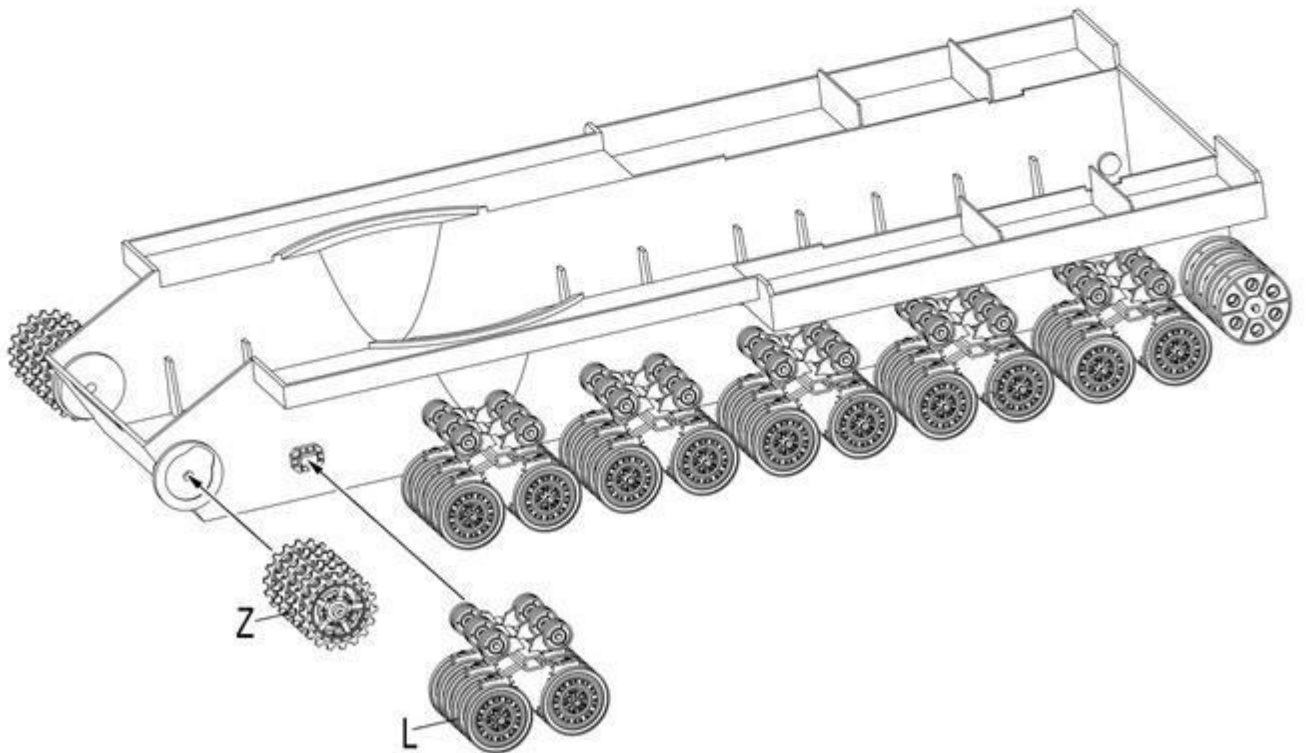

17

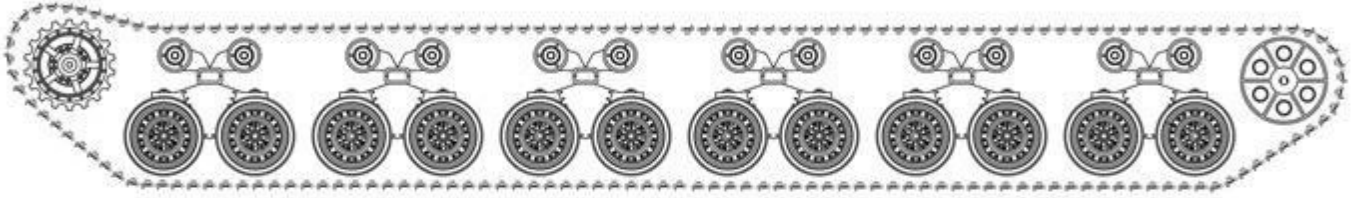
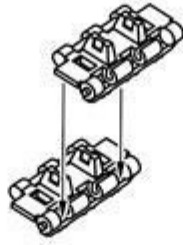

18

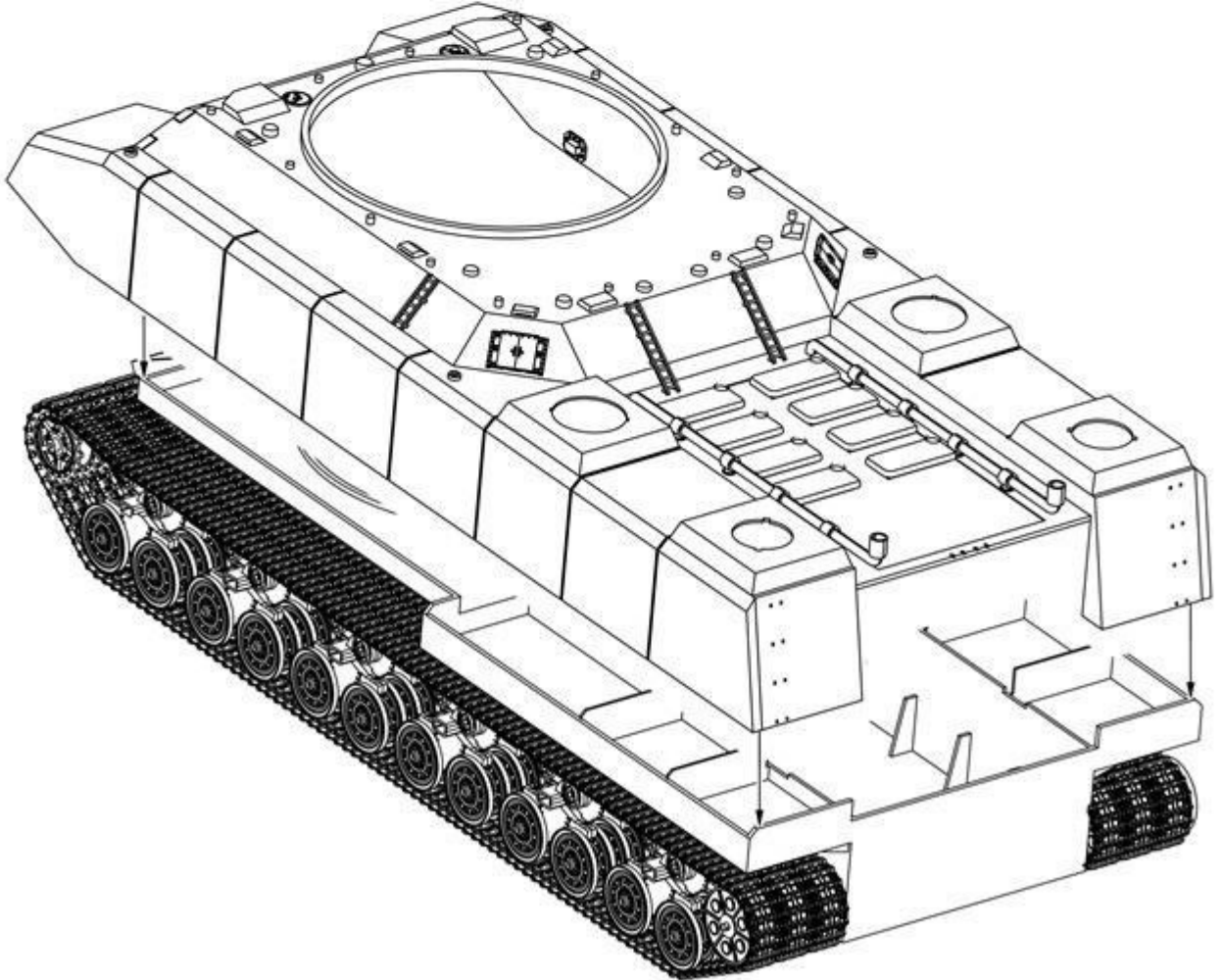

19

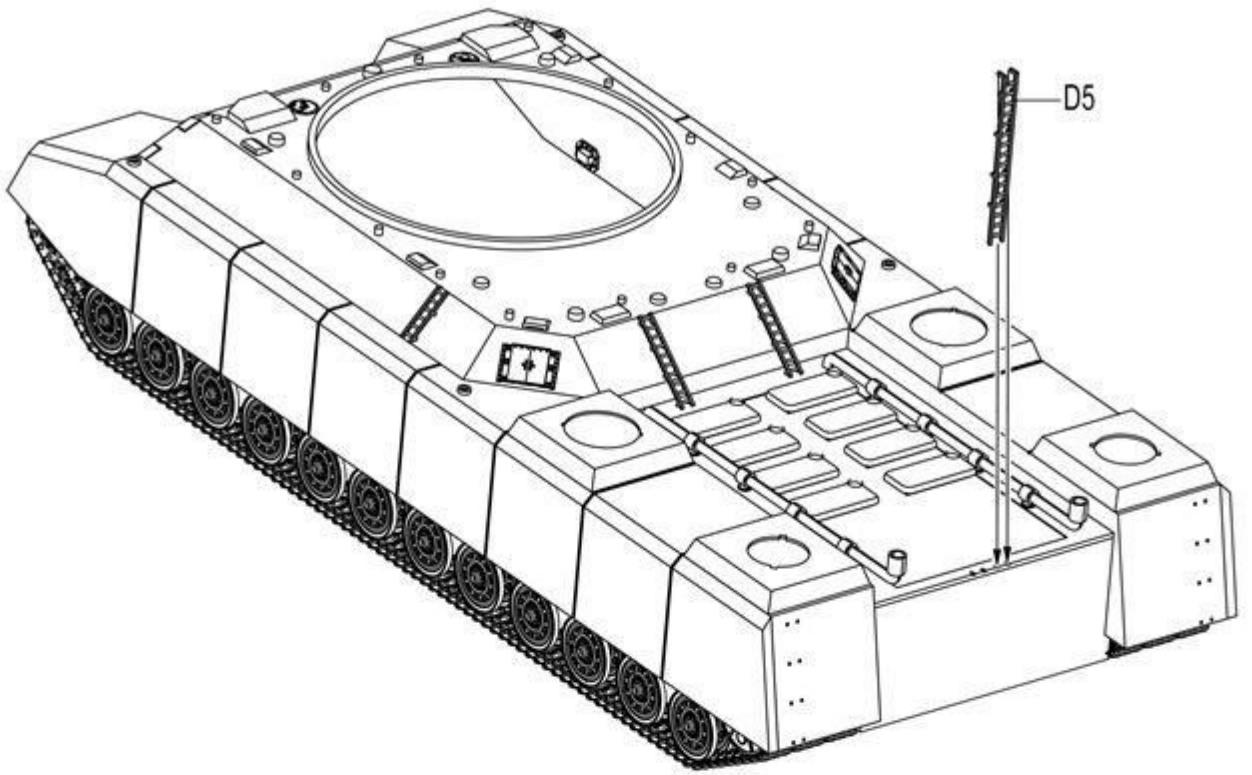

20

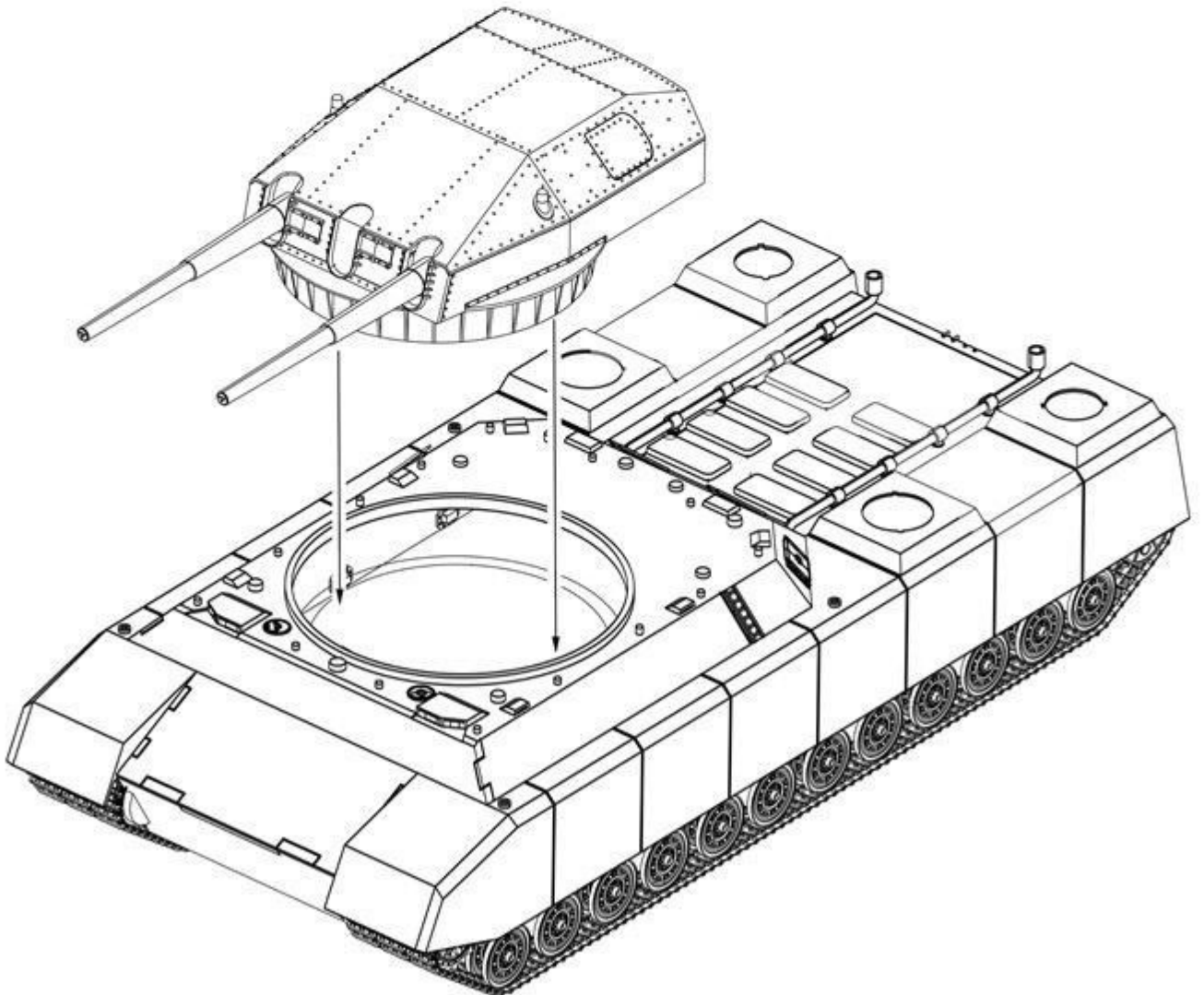

21

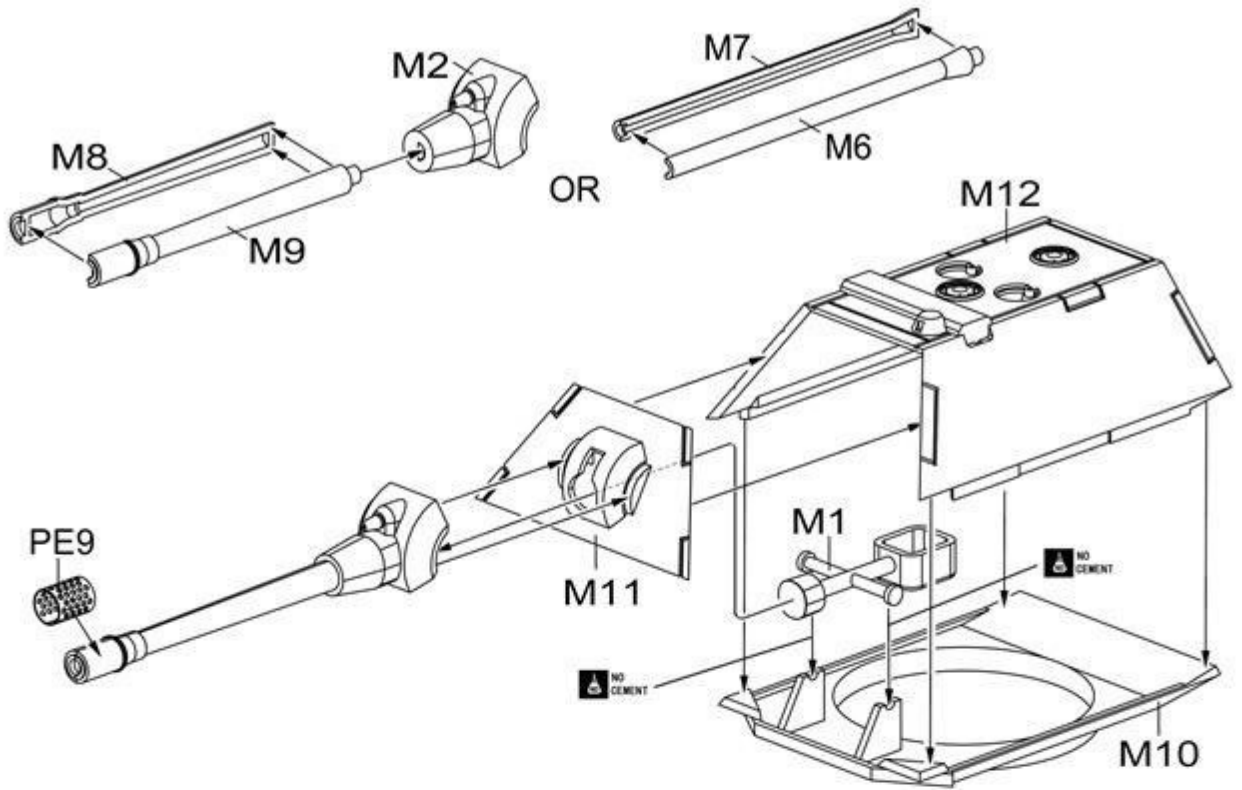

22

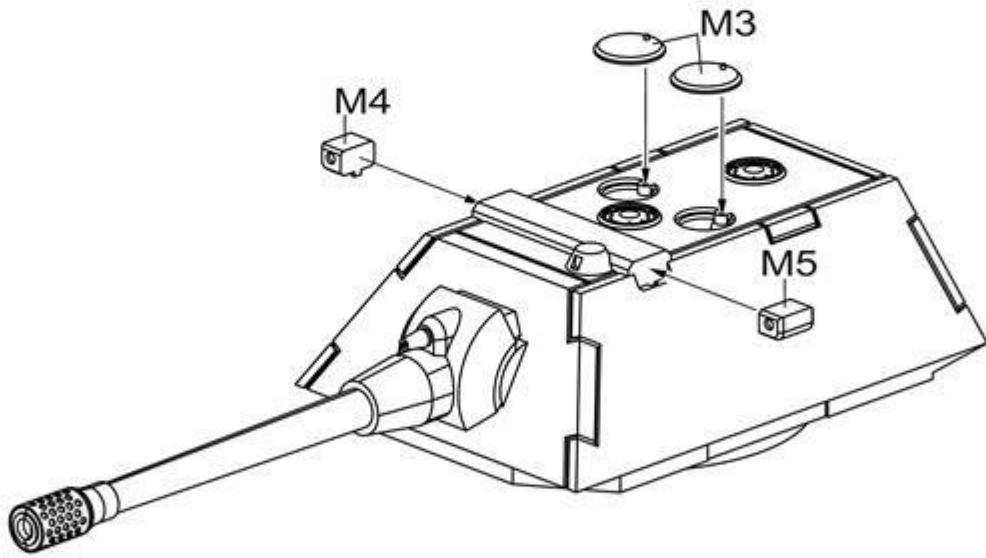

23

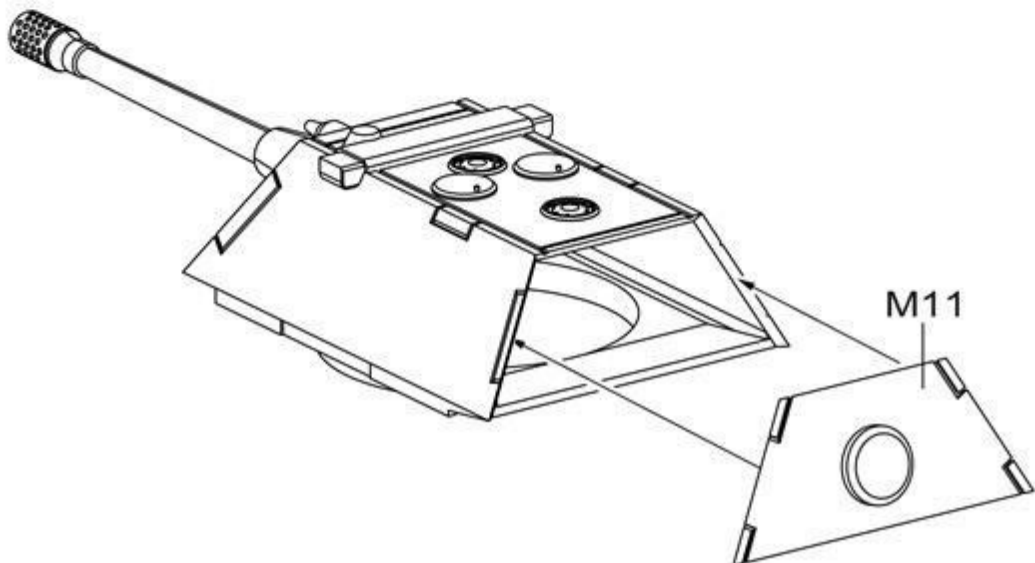

24

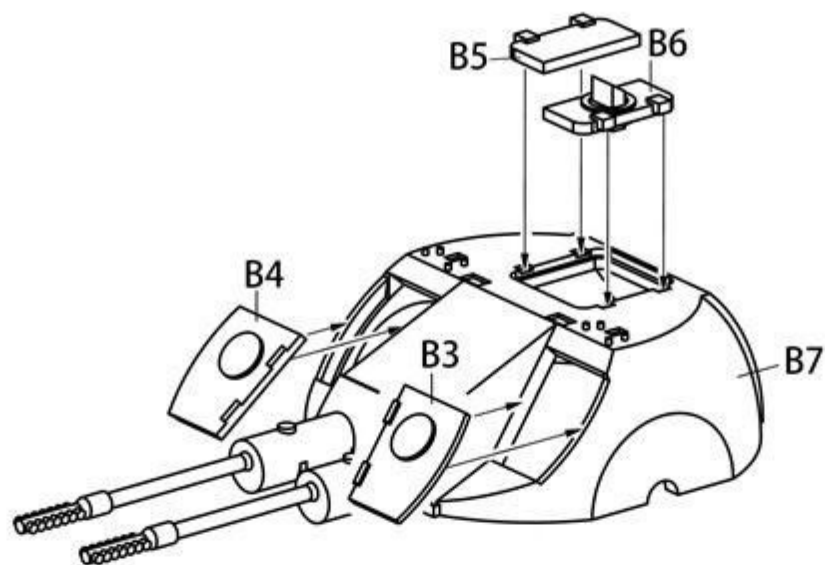

25

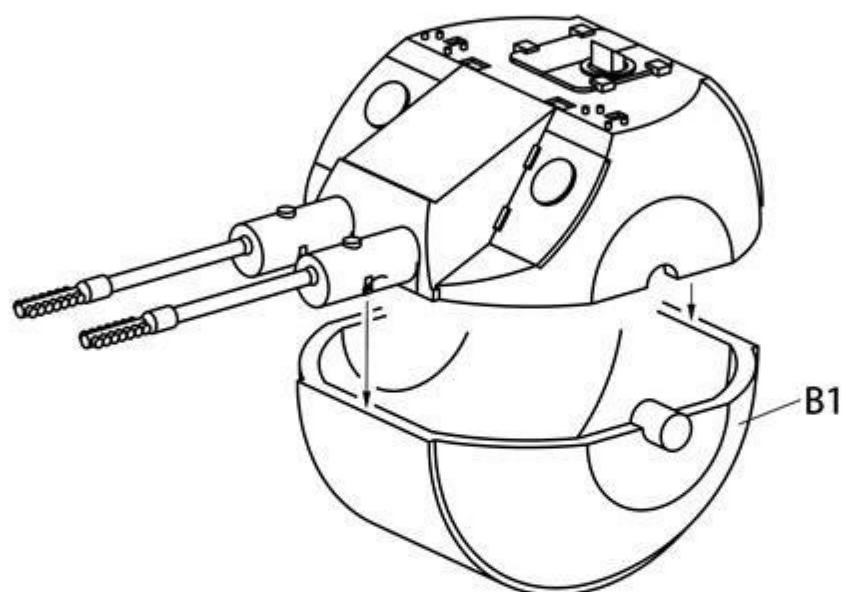

26

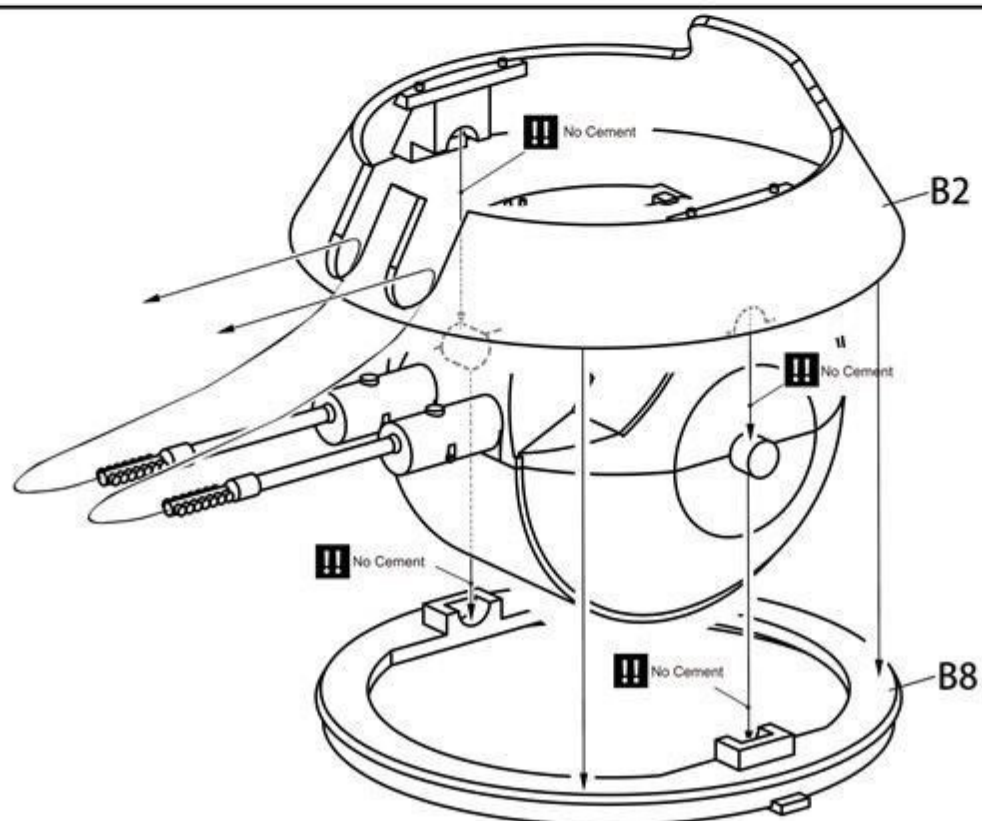

27

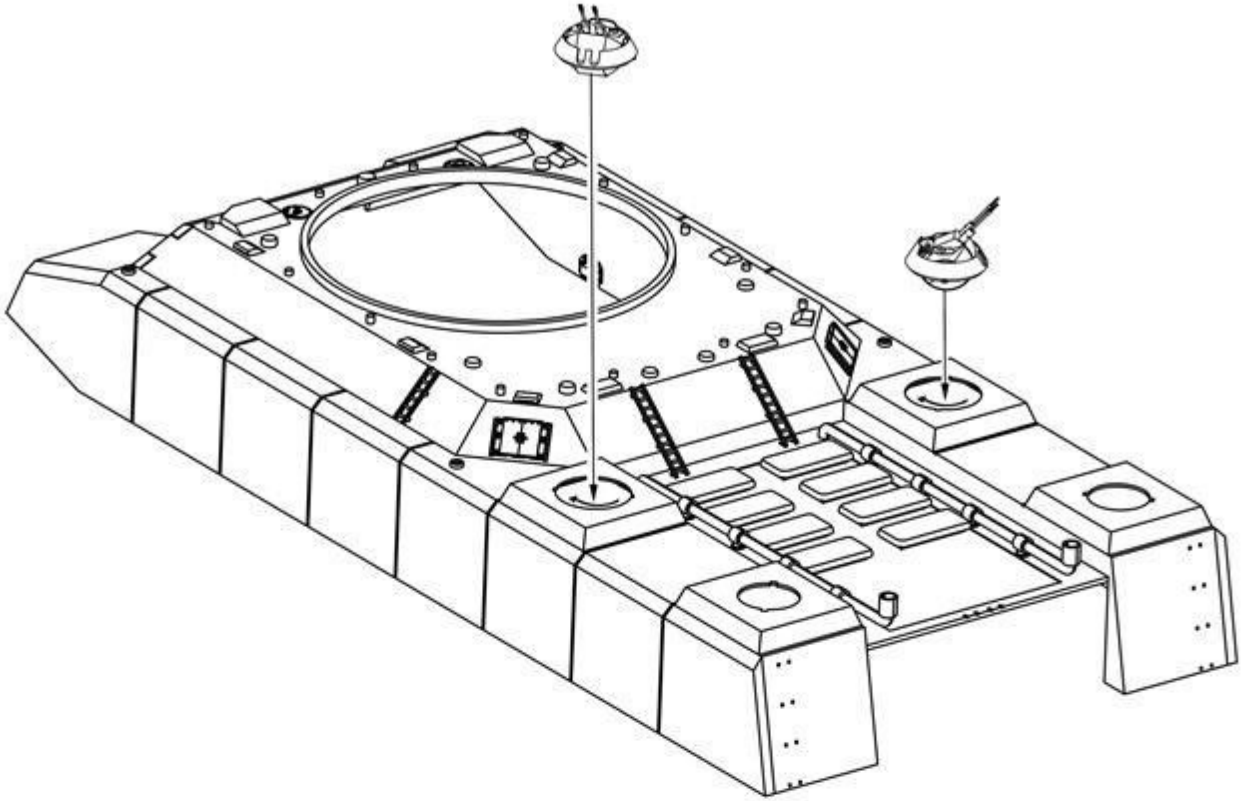

28

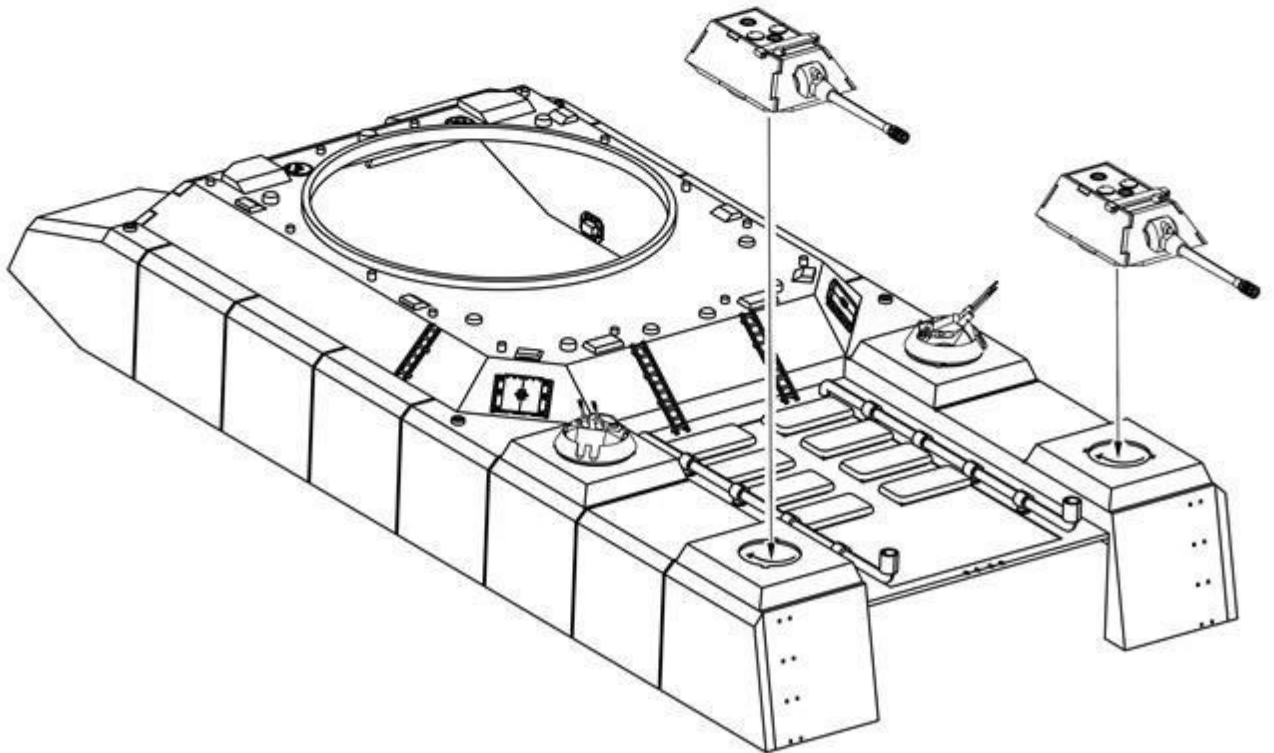

WWII GERMANY LANDCRUISER P.1000 RATTE

modelcollect

A.MIG 033 Rubber & Tires	A.MIG 097 Crystal Orange	A.MIG 003 RAL 6011 RESEDAGRÜN	A.MIG 011 RAL 7028 DUNKELBLAU S 44 DG 1	A.MIG 047 Satin White	A.MIG 911 GREY SHINE
A.MIG 014 RAL 8012 ROTBRAUN	A.MIG 042 OLD RUST				

