

# WWII US M31 tank recovery vehicle

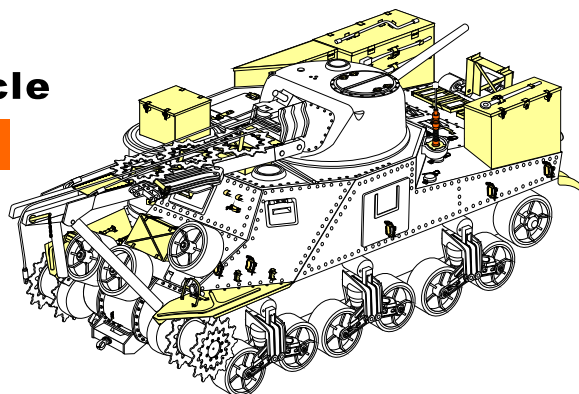





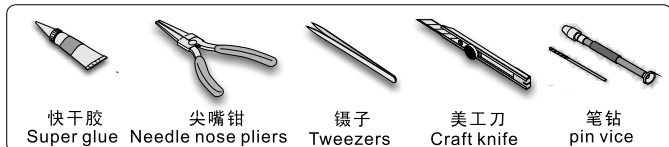

## 二战美军M31坦克回收车改造件

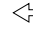
[For TAKOM 2088]



■ 推荐使用工具 RECOMMENDED TOOLS



-   
 安装  
install
-   
 折叠  
bend
- A1**  
 改造件零件编号  
PE/resin part number
- B12**  
 原零件编号  
kit part number
- C22**  
 被替换的原零件编号  
replaced kit part number
-   
 另一侧相同制作  
repeat on opposite side
-   
 切除  
remove
-   
 打磨  
grind off
-   
 弧度卷曲  
radial bending
- x2**  
 制作若干组  
multiple assembly
-   
 选择安装  
alternative
-   
 钻孔  
drill
-   
 用胶棒制作  
make from plastic rod

  
 用尖端在凹槽处冲压  
use penpoint to press on the dent

蚀刻片零件内朝面向上  
Put the part upside down  
 用笔尖在凹槽处刺  
Use penpoint to press on the dent

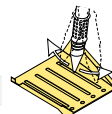
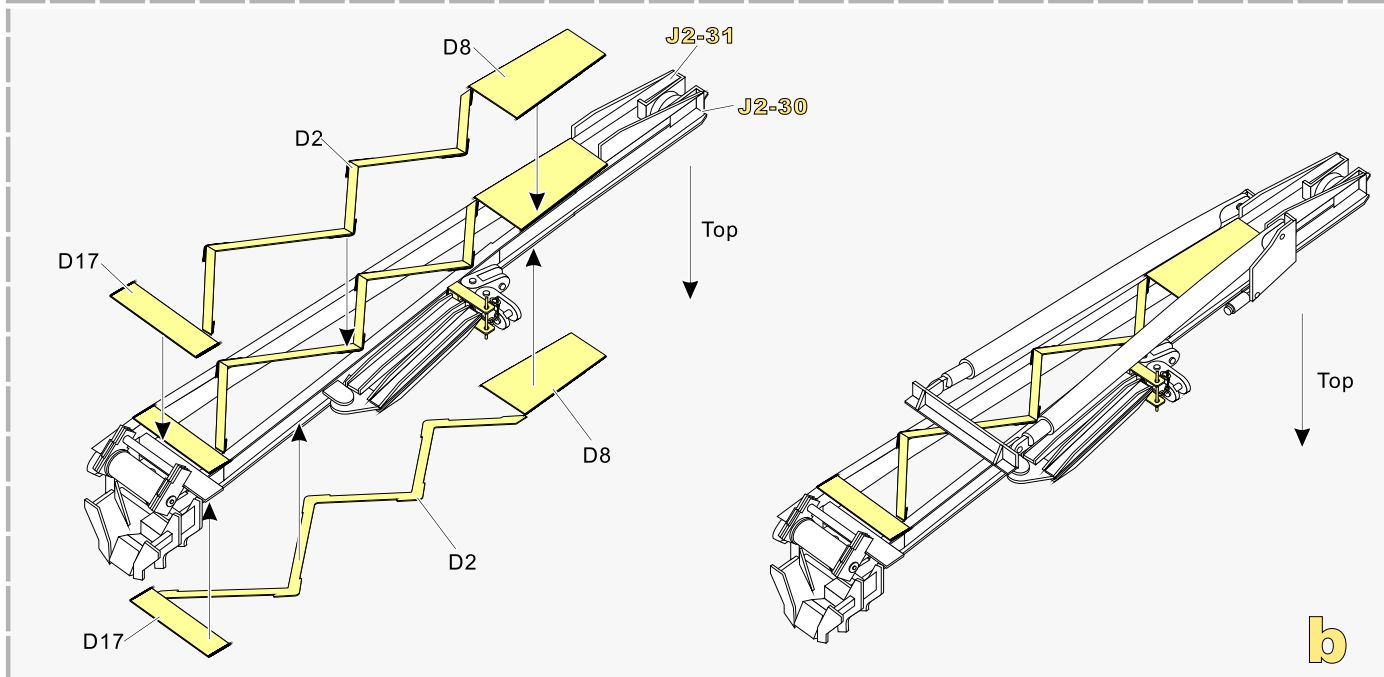
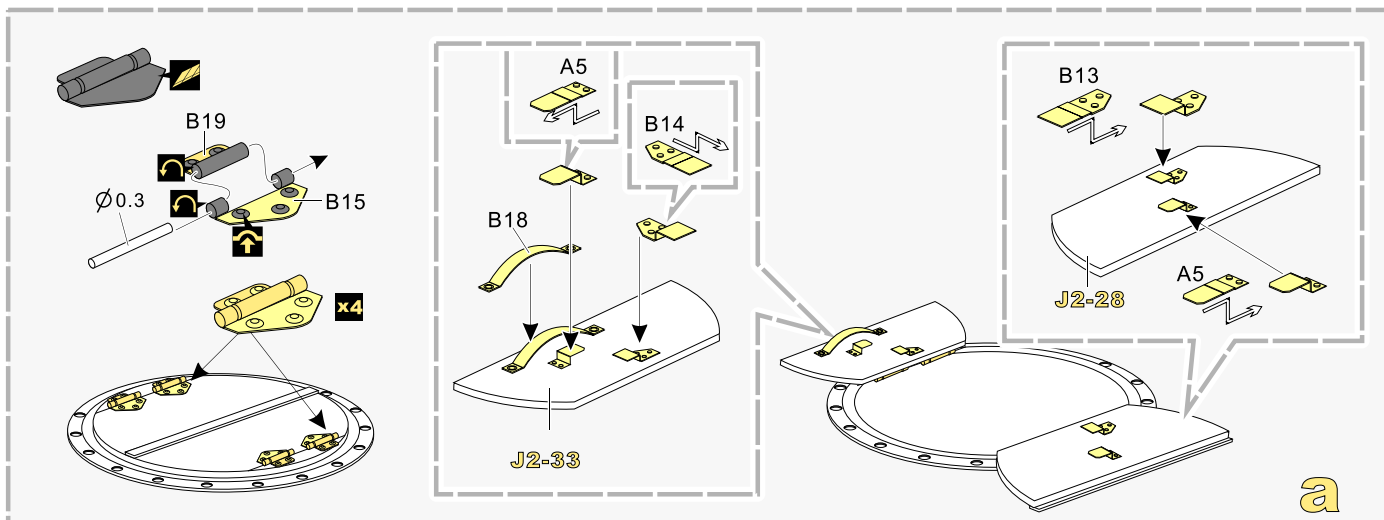
1/35 MILITARY MINIATURE VEHICLE UPGRADE SERIES PE35931

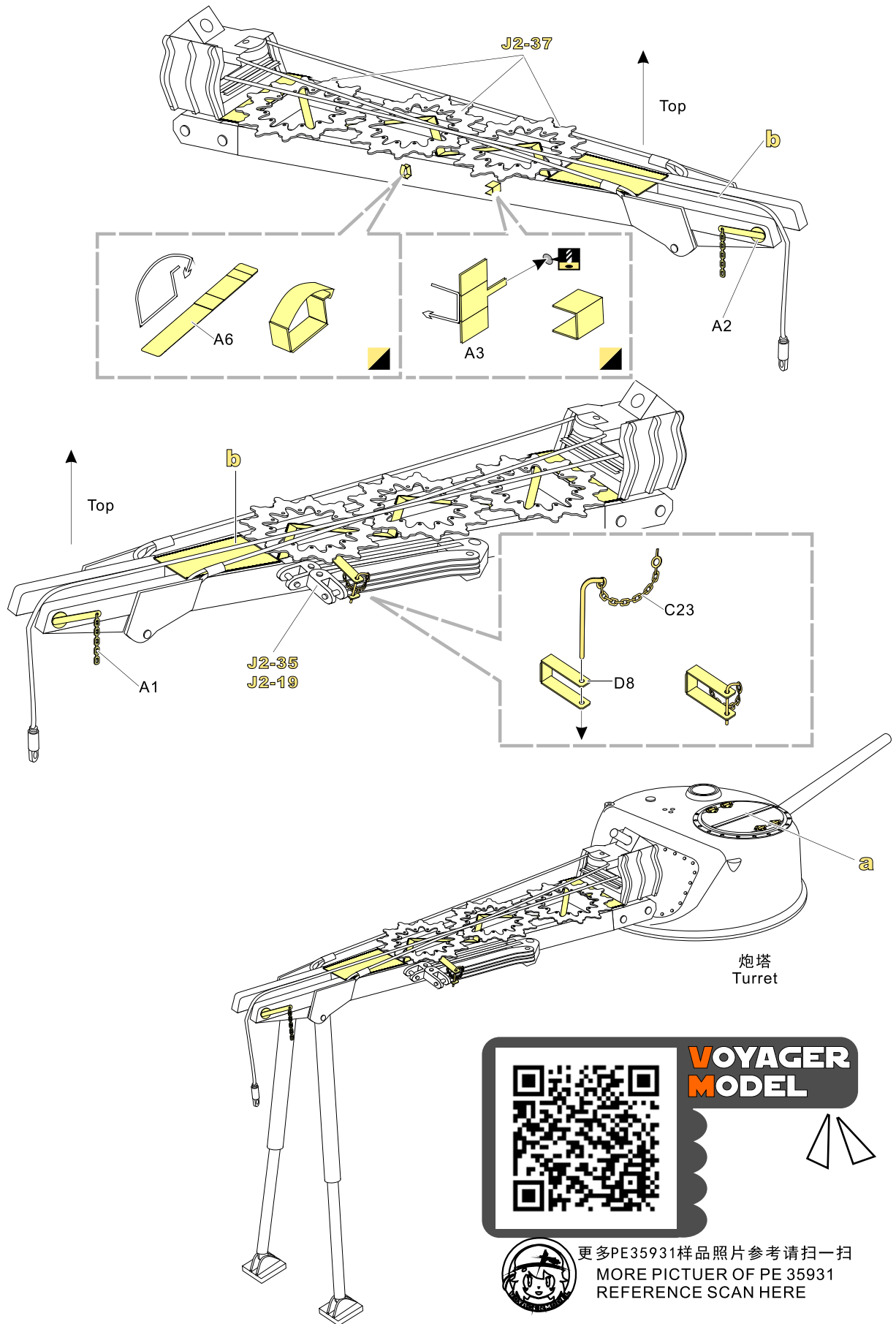

1/35 MILITARY MINIATURE VEHICLE UPGRADE SERIES PE35931

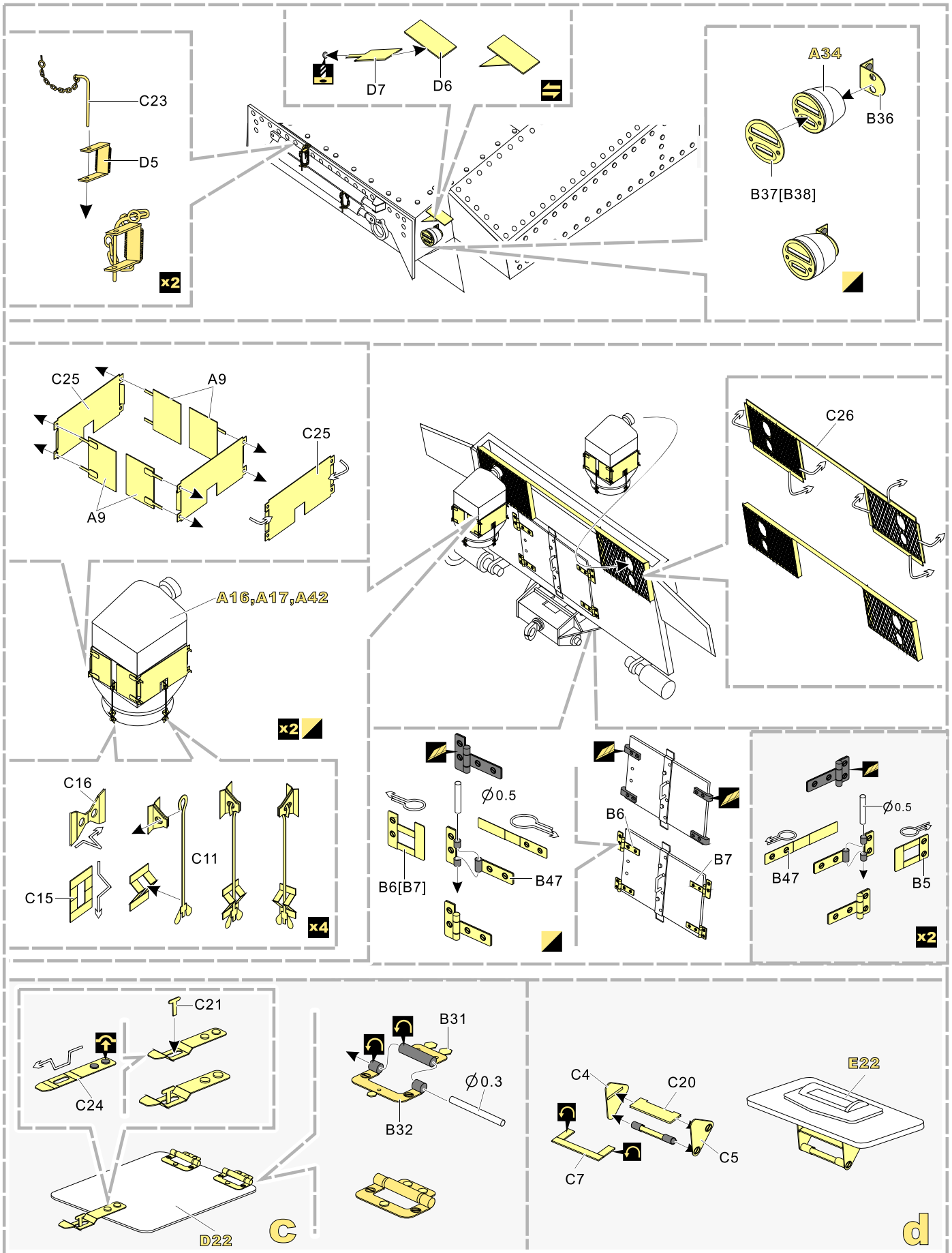

1/35 MILITARY MINIATURE VEHICLE UPGRADE SERIES PE35931

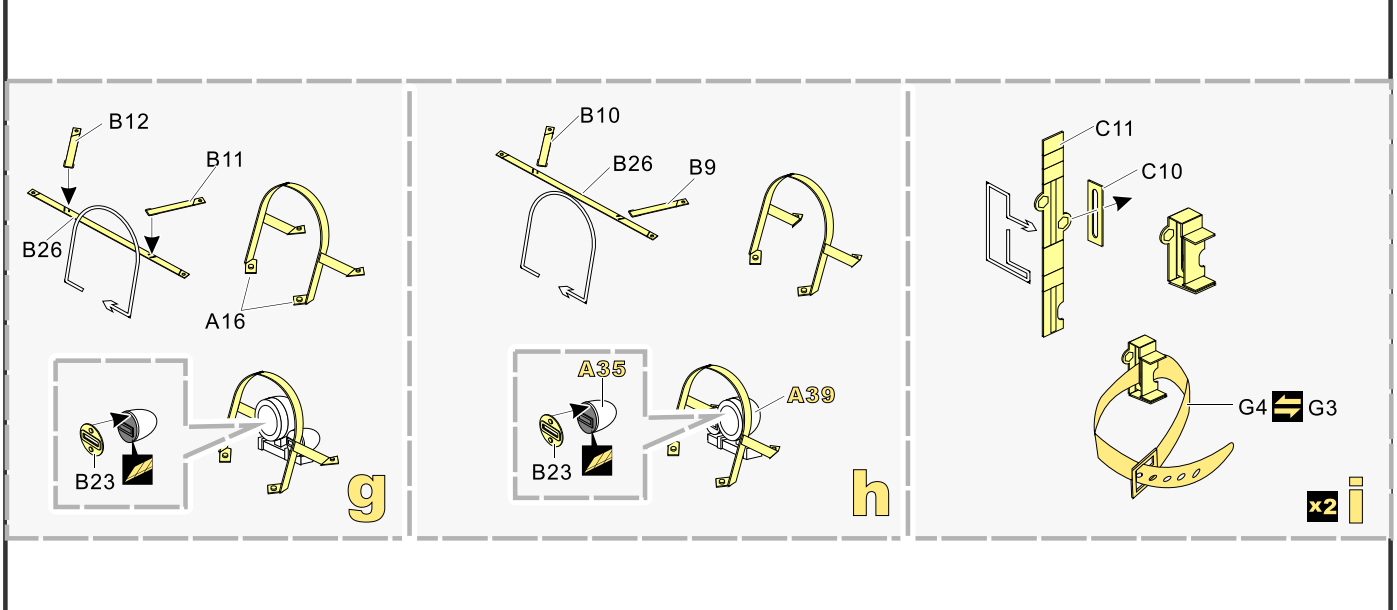
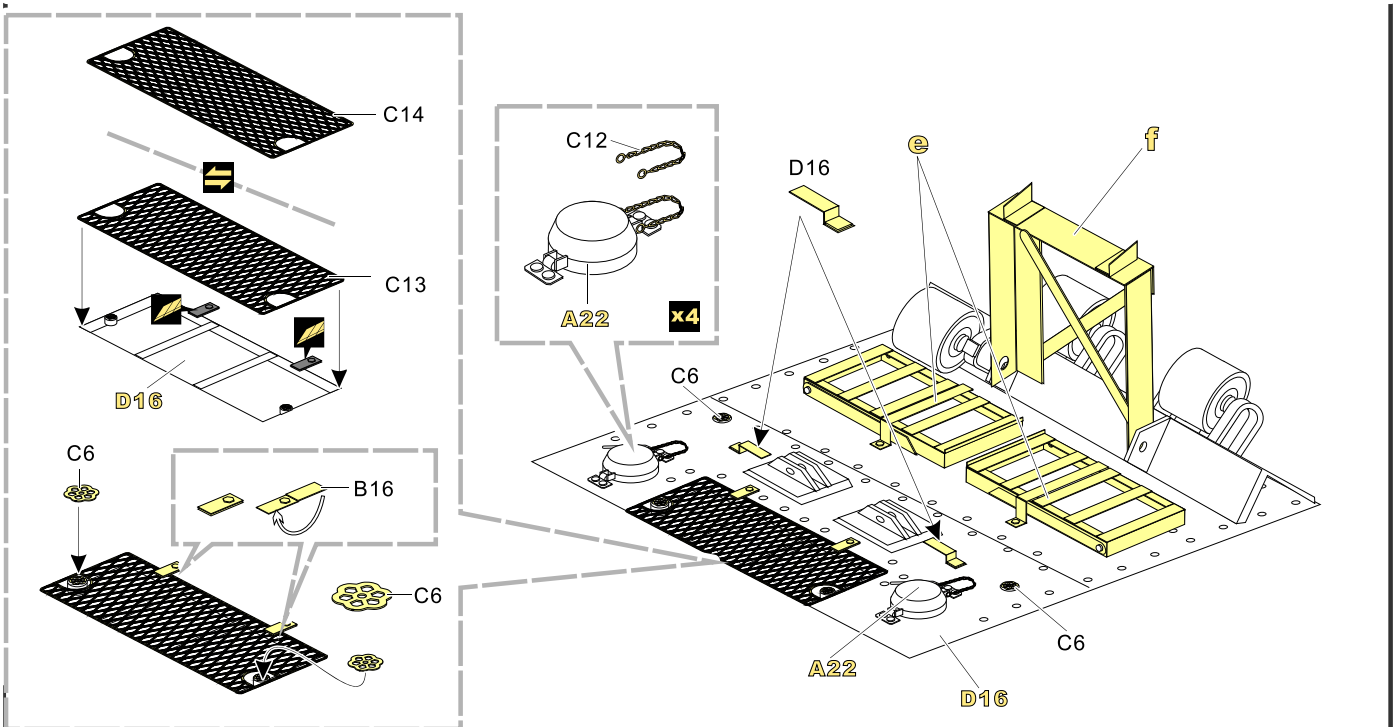
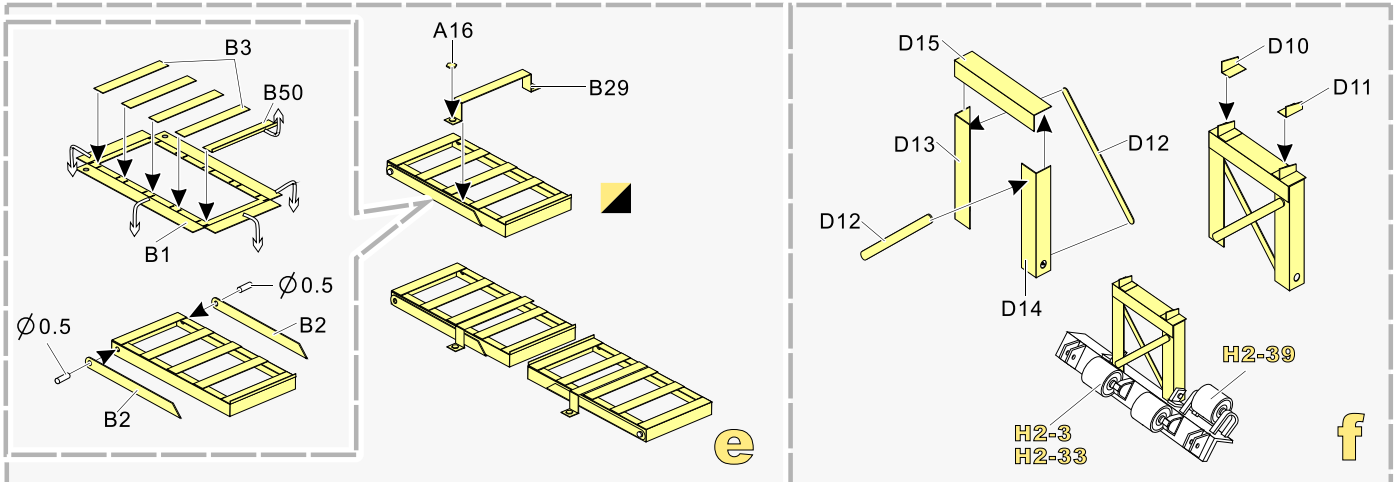

1/35 MILITARY MINIATURE VEHICLE UPGRADE SERIES PE35931

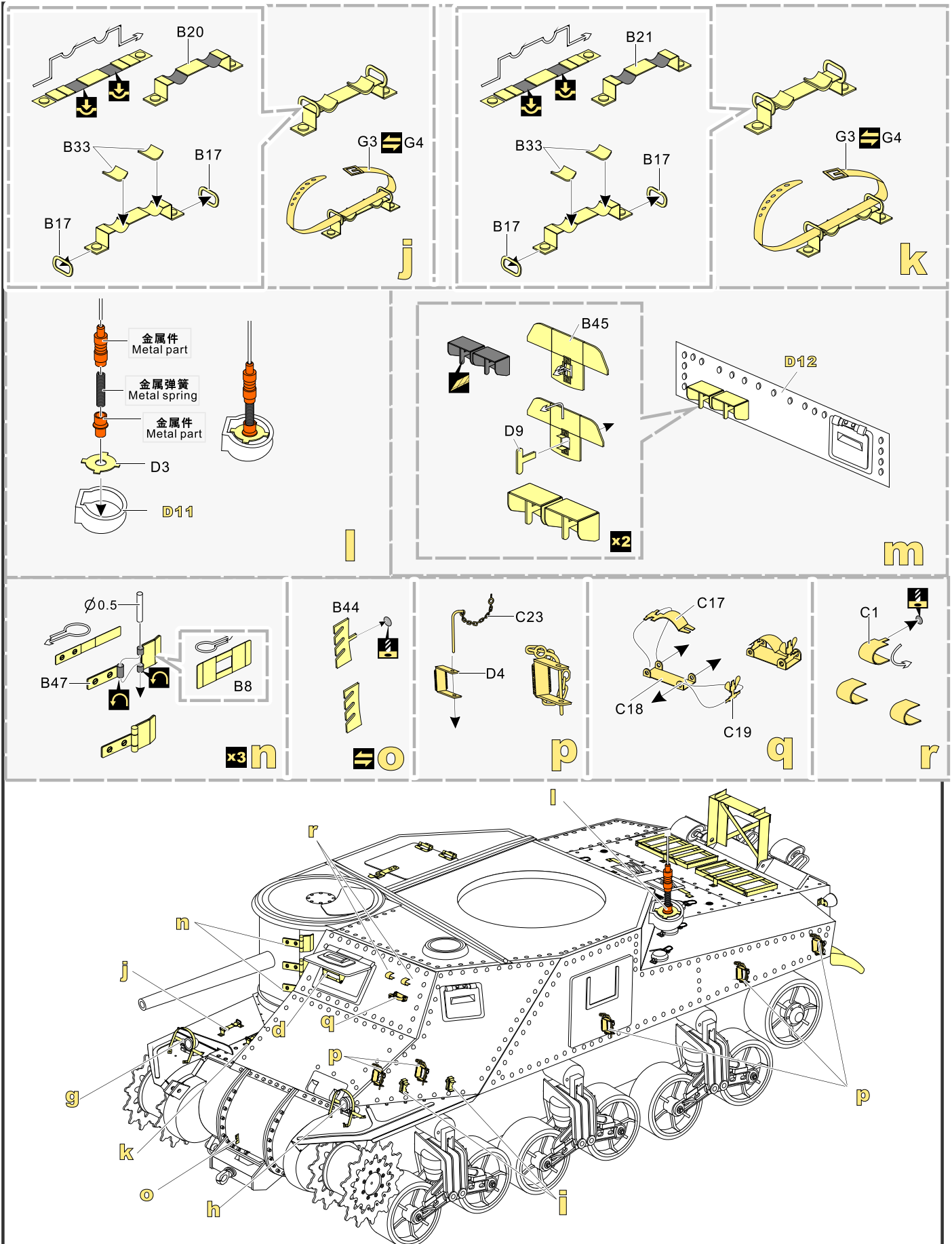

1/35 MILITARY MINIATURE VEHICLE UPGRADE SERIES PE35931

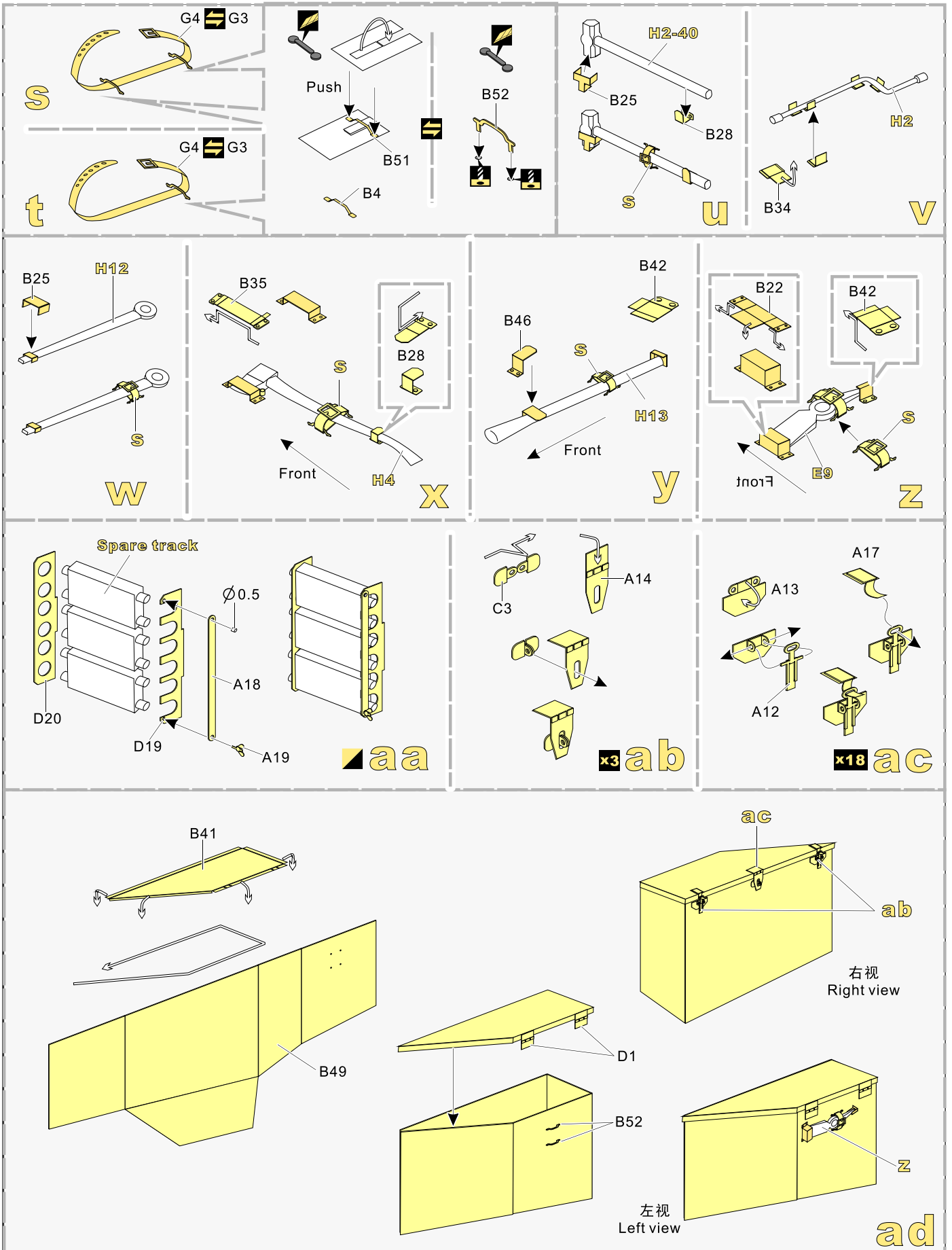

1/35 MILITARY MINIATURE VEHICLE UPGRADE SERIES PE35931

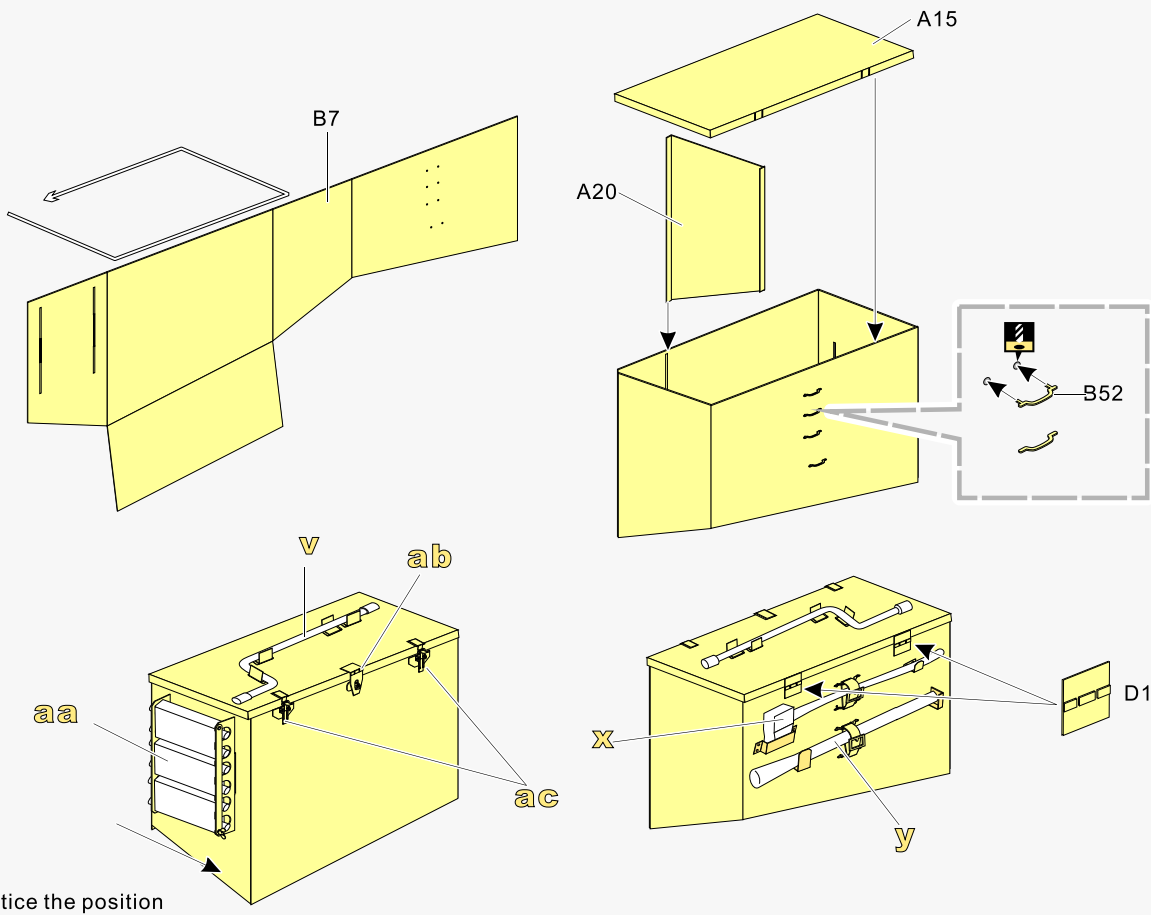
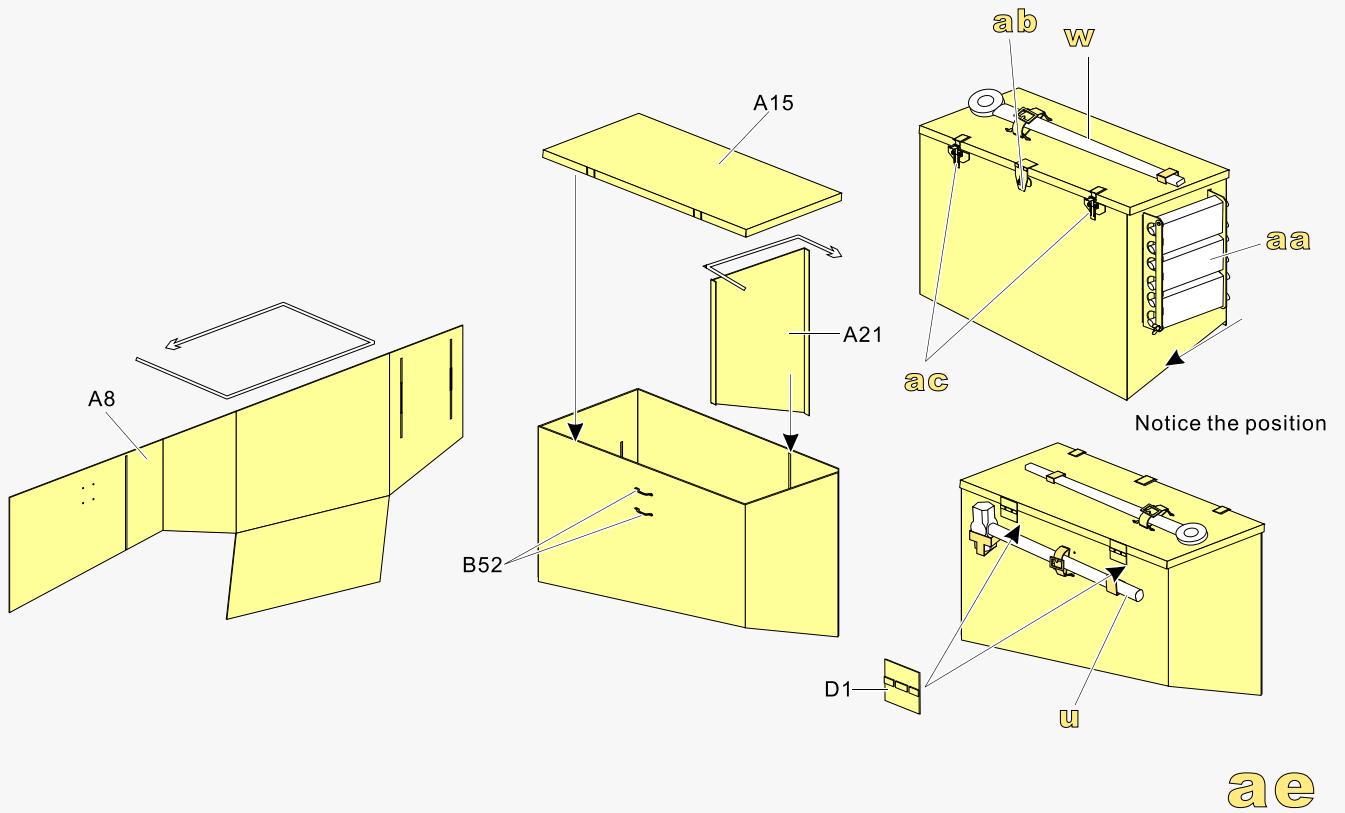

1/35 MILITARY MINIATURE VEHICLE UPGRADE SERIES PE35931

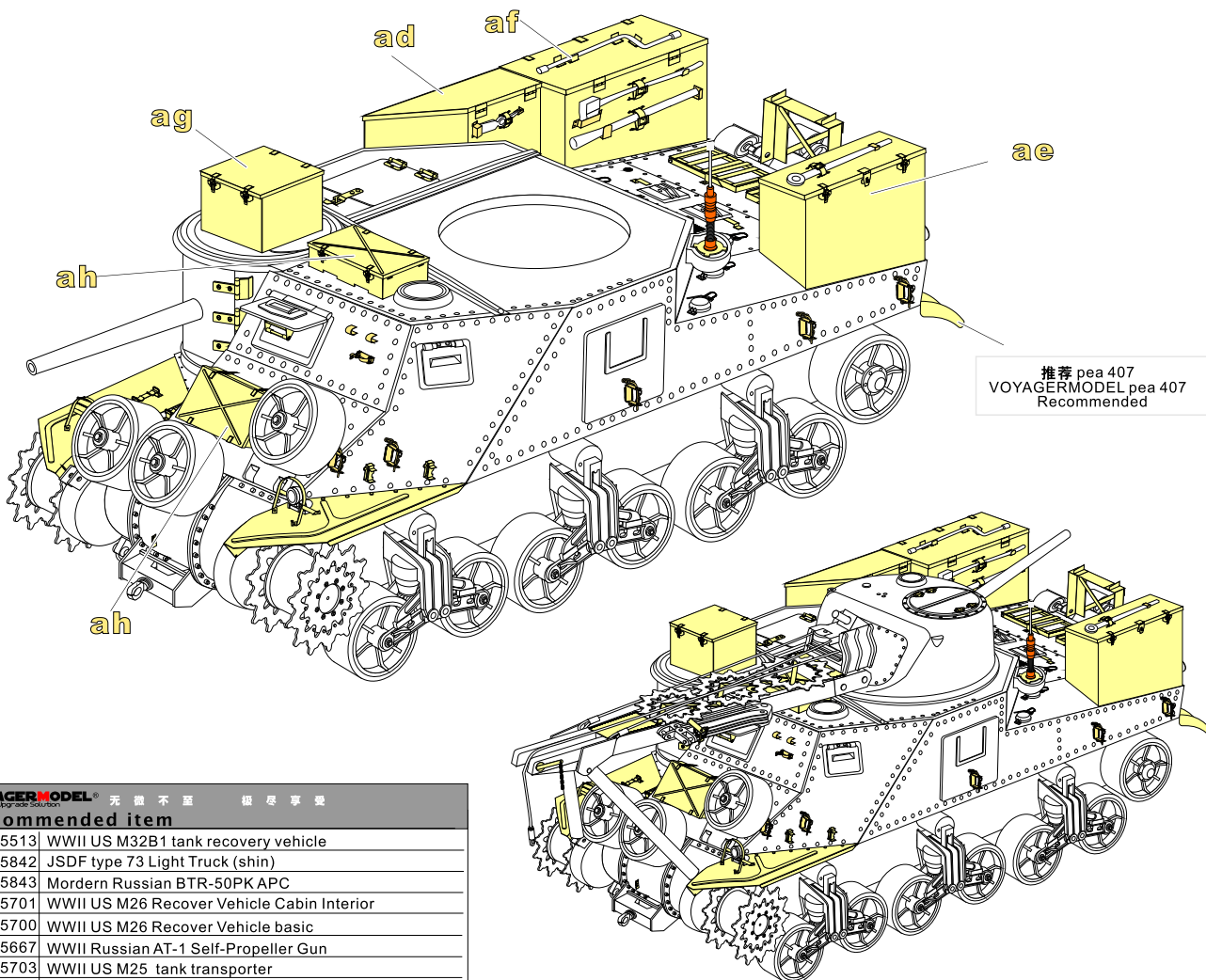
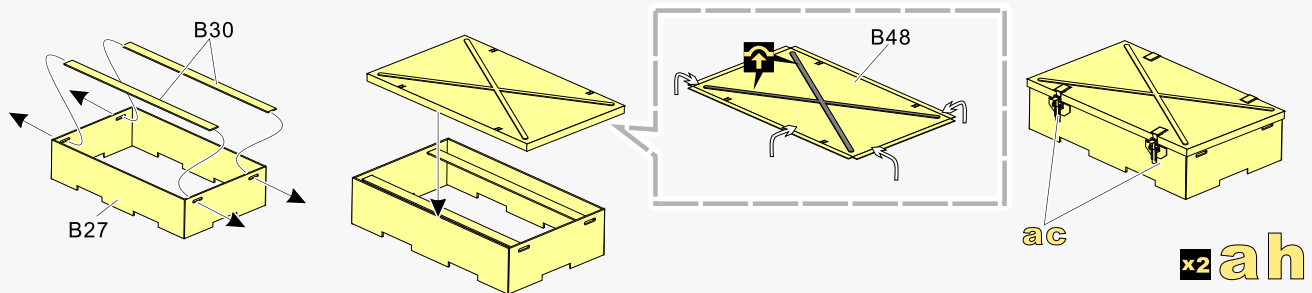
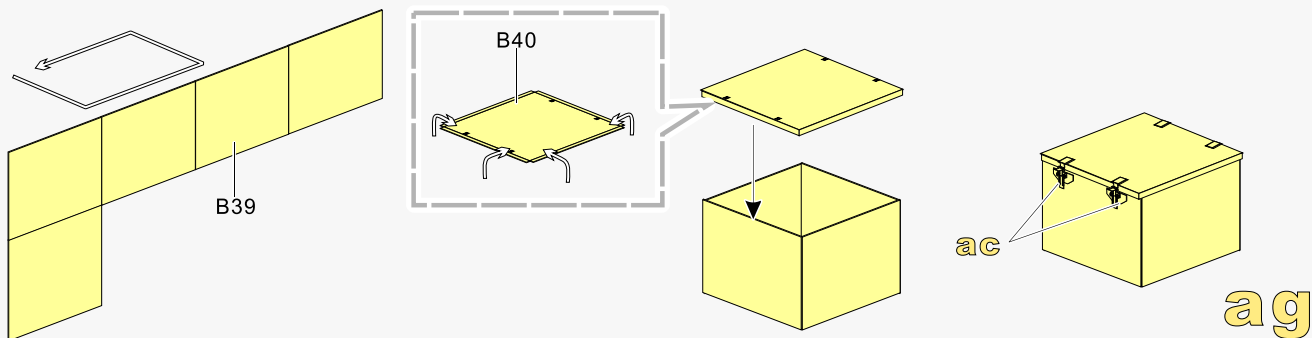

**VOYAGERMODEL®** 无微不至 精益求精

The Best Upgrade Solution

**Recommended item**

PE 35513	WWII US M32B1 tank recovery vehicle
PE 35842	JSDF type 73 Light Truck (shin)
PE 35843	Mordern Russian BTR-50PK APC
PE 35701	WWII US M26 Recover Vehicle Cabin Interior
PE 35700	WWII US M26 Recover Vehicle basic
PE 35667	WWII Russian AT-1 Self-Propeller Gun
PE 35703	WWII US M25 tank transporter
PE 35465	WWII U.S. GMC 2.5ton 6X6 Cargo Truck
PE 35751	WWII U.S.Army M36B1 GMC Tank Destroy Basic