

5 Ta183B-1 HUCKEBEIN
III./JG52 "RICHTHOFEN" 1945

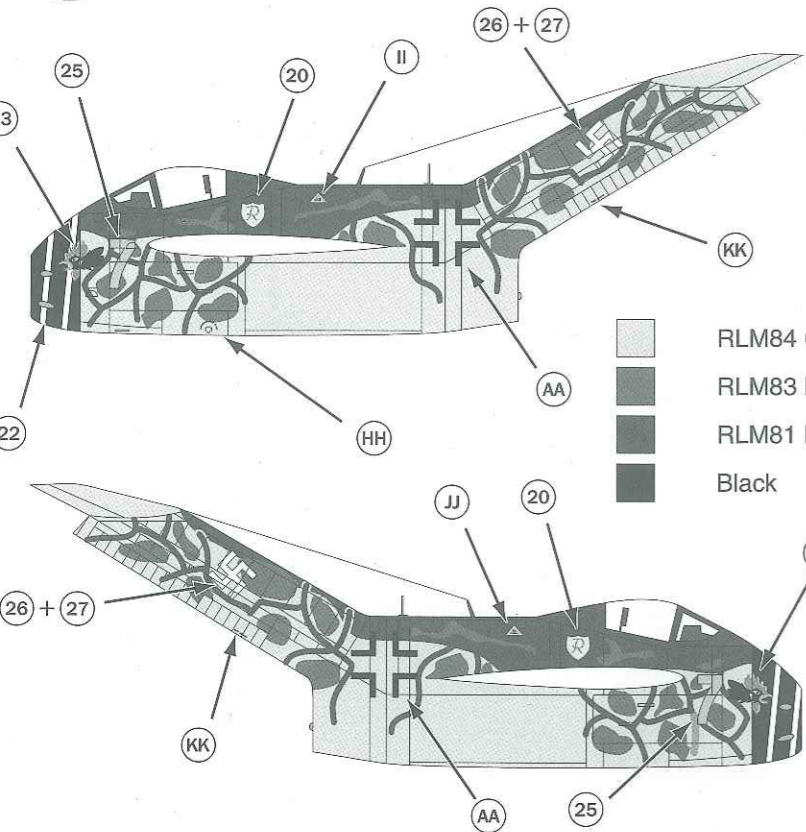

- RLM84 Gray Green
- RLM83 Dark Green
- RLM81 Brown Violet
- Black

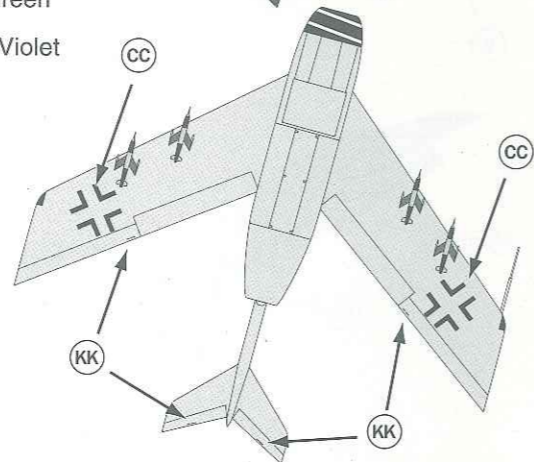
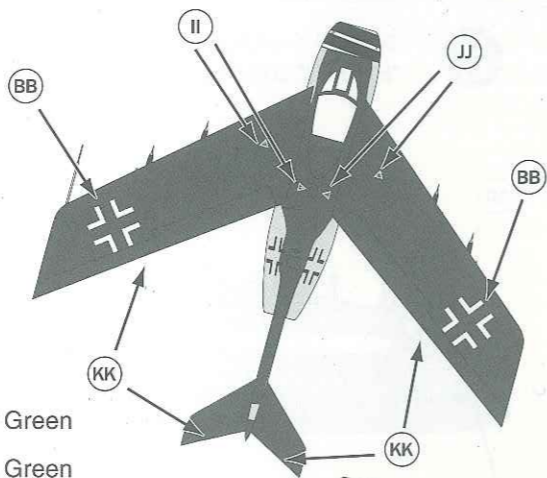

6 Ta183B-1 HUCKEBEIN
I./JG52 1945

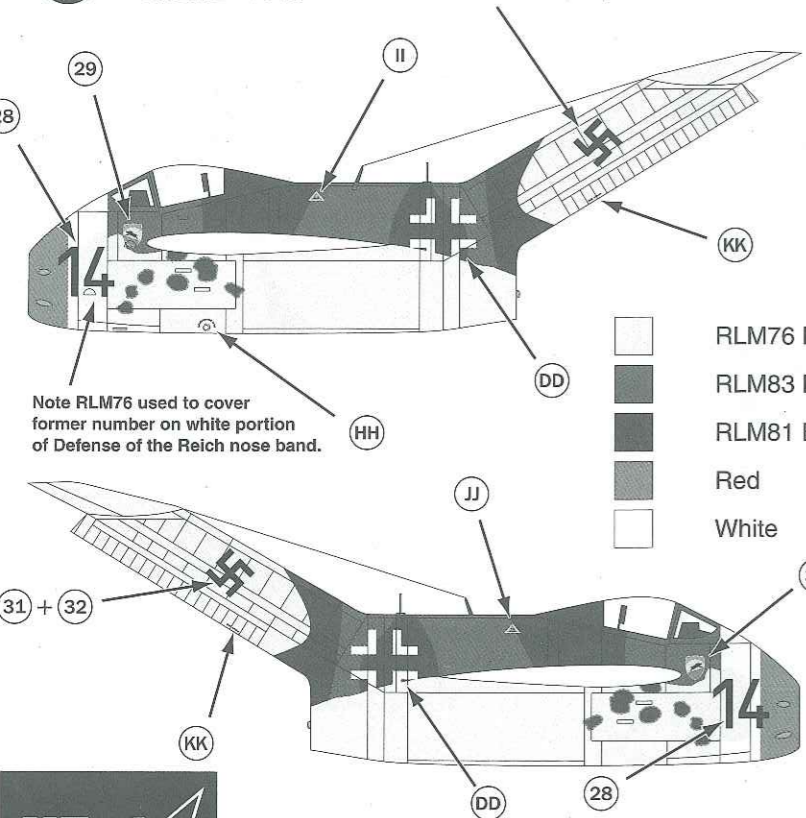

- RLM76 Light Blue
- RLM83 Dark Green
- RLM81 Brown Violet
- Red
- White

Note RLM76 used to cover former number on white portion of Defense of the Reich nose band.

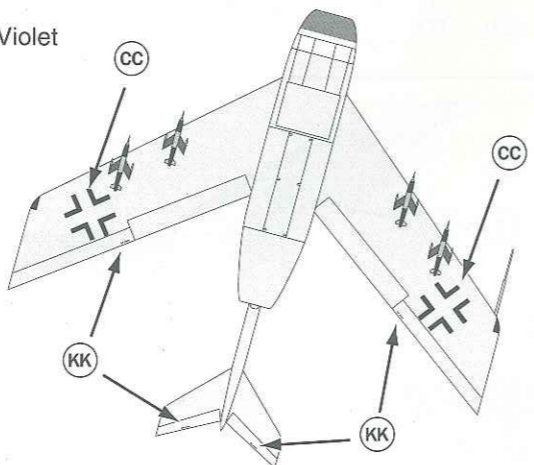
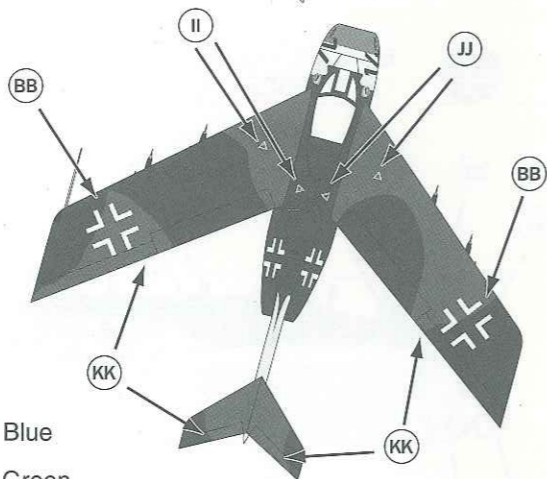

© 2001
All rights reserved.

No. 10



#484601

1/48th Scale

Focke Wulf Ta-183 "Huckebein"

Chosen to be the Luftwaffe's new fighter in the Emergency Fighter Competition of February, 1945. The single-engined, swept-wing Focke Wulf Ta-183 "Huckebein" was to be the answer to the overwhelming numerical superiority of the Allies. Sixteen Versuchs (experimental test series) aircraft were to be built. The Ta-183 V1-V3 were to be powered by the Jumo 004B turbojet, pending delivery of the He S 011 jet engine. The Ta-183 V4-V14 were to be constructed as O-series preproduction aircraft and V15-V16 as static test aircraft. Scheduled to fly in May or June, 1945, and enter full production by October, 1945. The project supposedly ended with the capture of the Focke Wulf facilities by British troops on April 8...Supposedly.

However, upon capturing Berlin, the Russians also captured a full set of plans for the Ta-183. These were taken back to the U.S.S.R. In March, 1946, the Mig Design Bureau began construction of what is believed to be six prototypes powered by the advanced Rolls Royce "Nene" turbojet engine, a gift they received from the British. Flight testing revealed that the original Ta-183 design needed either automatic leading edge slots or wing boundary layer fences to alleviate low-speed stalling. In the interest of simplicity and reduced maintenance, boundary layer fences were chosen

to overcome this problem. Also, the horizontal stabilizer was moved approximately one-third down from the top of the vertical tail as a compromise between high-speed and low-speed flying. The modified Ta-183 is reported to have first flown on December 30, 1947. In May, 1948, the heavily-modified design was ordered into production as the Mig-15.

Meanwhile, in the United States, North American Aviation was totally revamping their P-86 design based on captured Messerschmitt designs and wind tunnel data. The resultant changes yielded the classic F-86 Sabre. Thus the stage was set for swept-wing jet combat over the skies of Korea!

AMtech would like to express a very special "Thank you!" to Dan Johnson and his Luft '46 website. Dan is a true gentleman, and his assistance and encouragement in this project were critical to its success.

Dan's new book on the Ta-183, with the remarkable artwork of Daniele Sabatini, should be available in November, 2001. We highly recommend this book, as well as his earlier books on the Focke Wulf EF-128 and the Heinkel He-343. Please run, do not walk, to the Luft '46 website at www.luft46.com and check out the incredible information to be found there. And don't forget to order the books!

This paint guide is provided to complete this kit as shown throughout the instructions.

| | |
|--------------------|--------|
| Black Gray | RLM 66 |
| Black Green | RLM 70 |
| Gray Green | RLM 74 |
| Gray Violet | RLM 75 |
| Light Blue | RLM 76 |
| Brown Violet | RLM 81 |
| Dark Green | RLM 83 |
| "Not Official RLM" | RLM 84 |
| Gray | RLM 02 |
| Yellow | RLM 04 |
| Aluminum | |
| Leather | |
| Wood | |
| Flat Black | |
| Satin Black | |
| Satin White | |

Step 1 - Cockpit Assembly

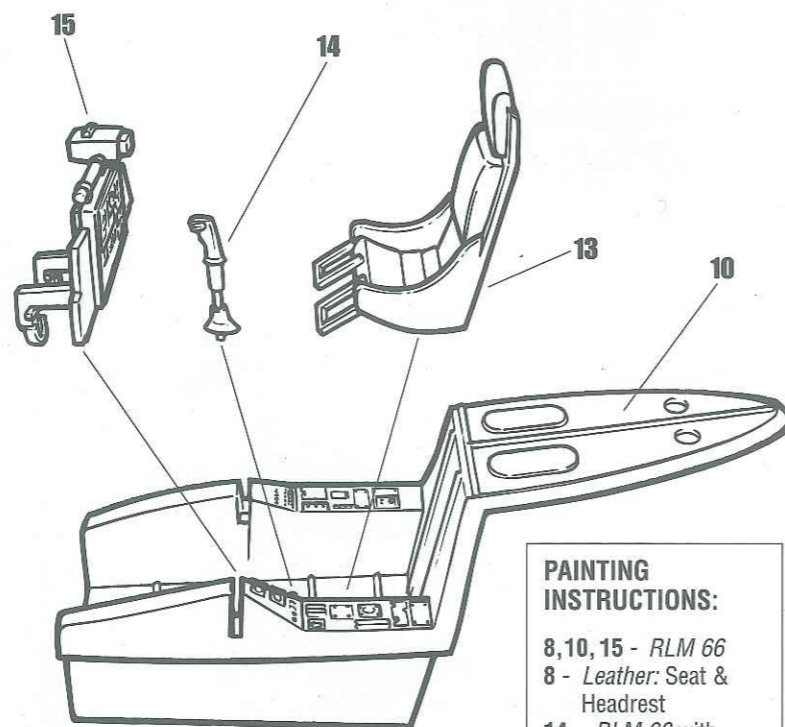

PAINTING INSTRUCTIONS:

8, 10, 15 - RLM 66
 8 - Leather: Seat & Headrest
 14 - RLM 66 with Black Handle

Step 3 - Installation of Cockpit, etc.

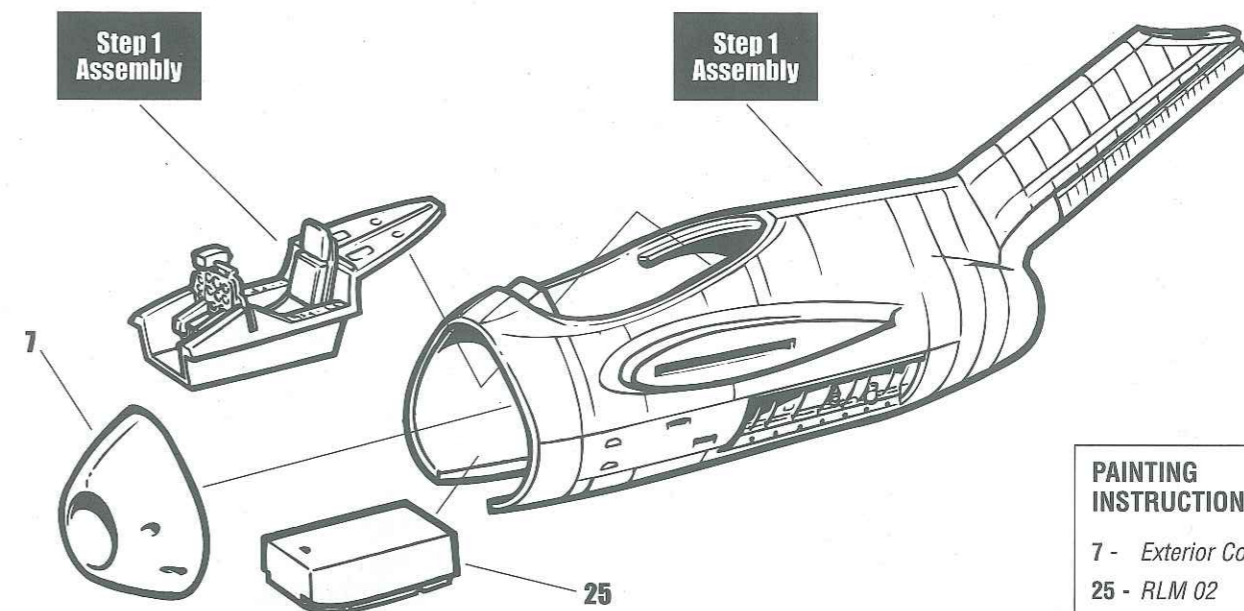

PAINTING INSTRUCTIONS:

7 - Exterior Color
 25 - RLM 02

Step 2 - Fuselage Assembly

PAINTING INSTRUCTIONS:

11, 12 - Jet Exhaust
 18, 19 - RLM 02
 1, 2, - RLM 66: Interior
 Exterior Color: Exterior
 8, 23 - Exterior Color

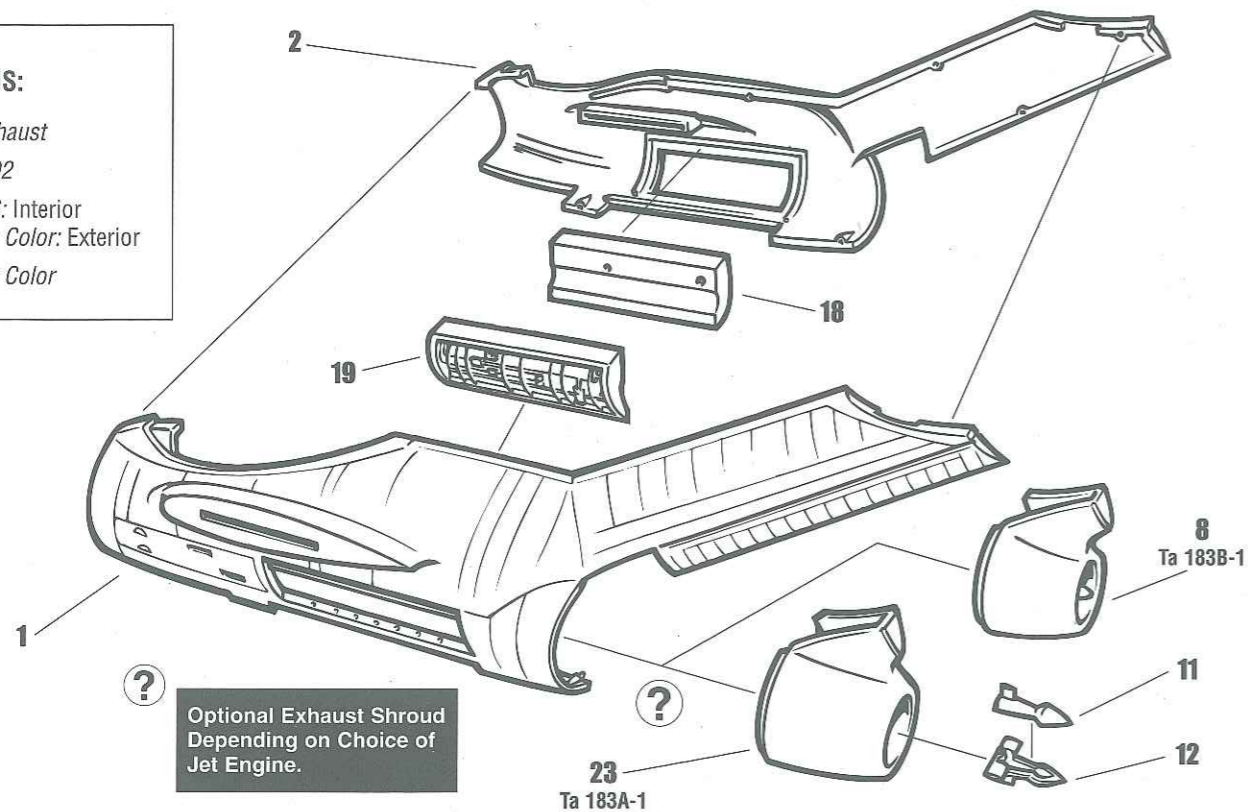

Optional Exhaust Shroud Depending on Choice of Jet Engine.

Step 4a - Lower Fuselage "Landing Gear Up"

* Trim hinge tabs if installing doors closed.

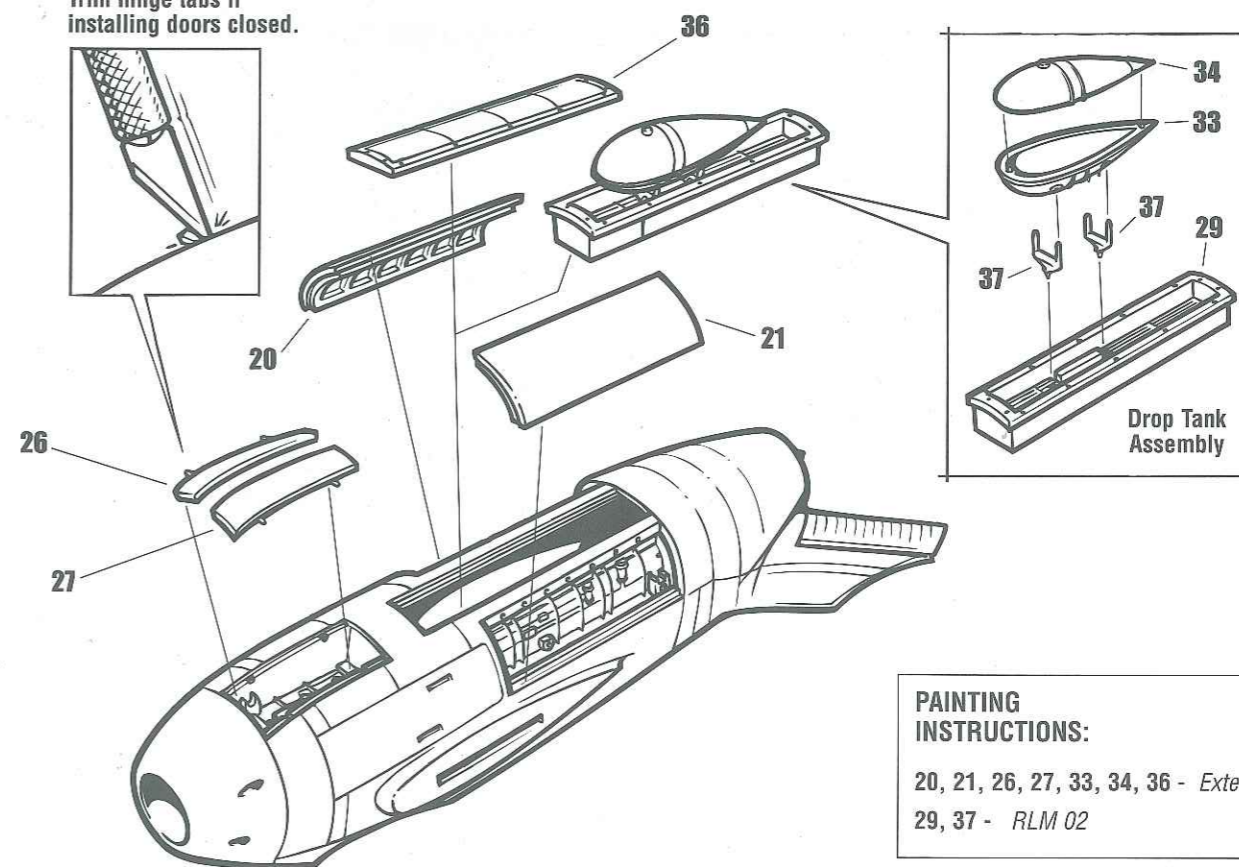

PAINTING INSTRUCTIONS:

20, 21, 26, 27, 33, 34, 36 - Exterior Color
 29, 37 - RLM 02

Step 4b - Lower Fuselage "Landing Gear Down"

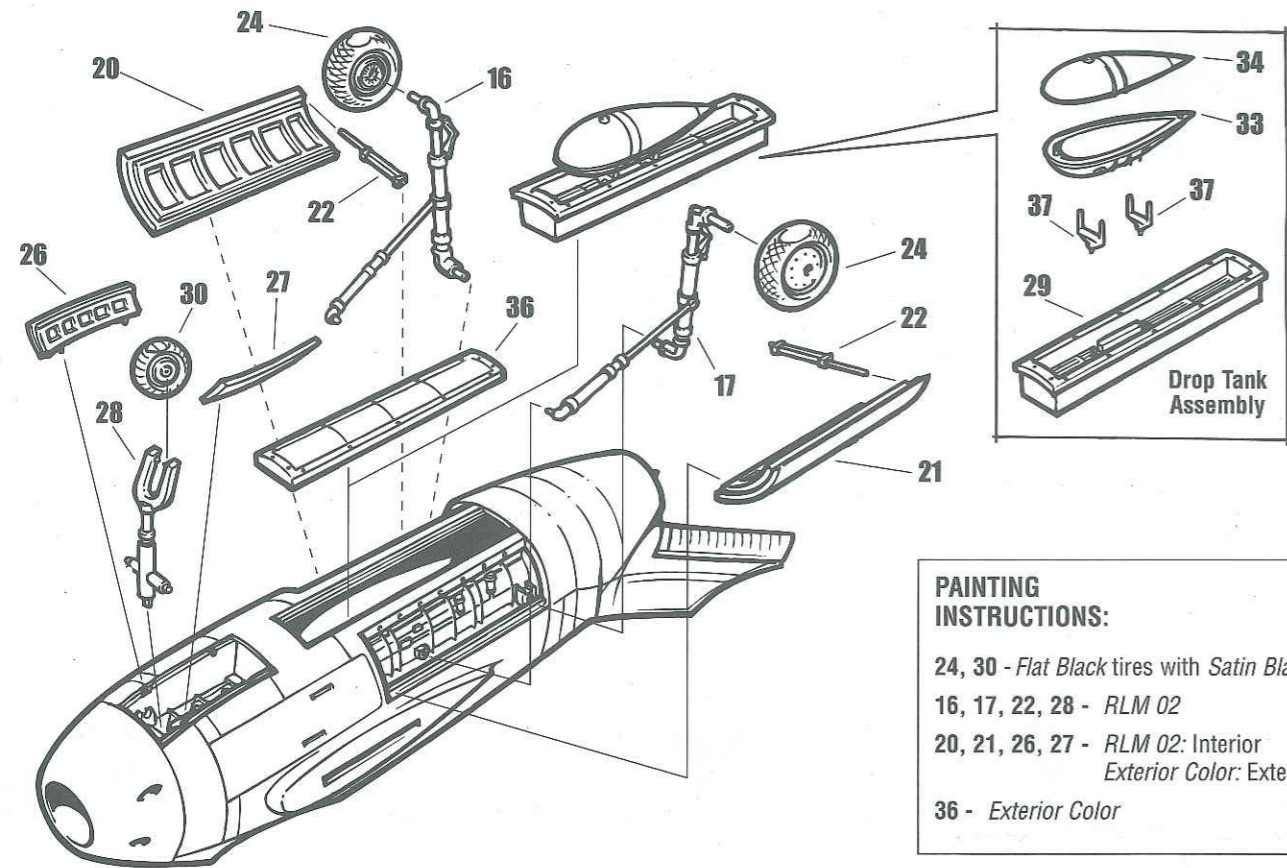

PAINTING INSTRUCTIONS:

24, 30 - Flat Black tires with Satin Black hubs
 16, 17, 22, 28 - RLM 02
 20, 21, 26, 27 - RLM 02: Interior
 Exterior Color: Exterior
 36 - Exterior Color

Step 6 - Underwing Stores

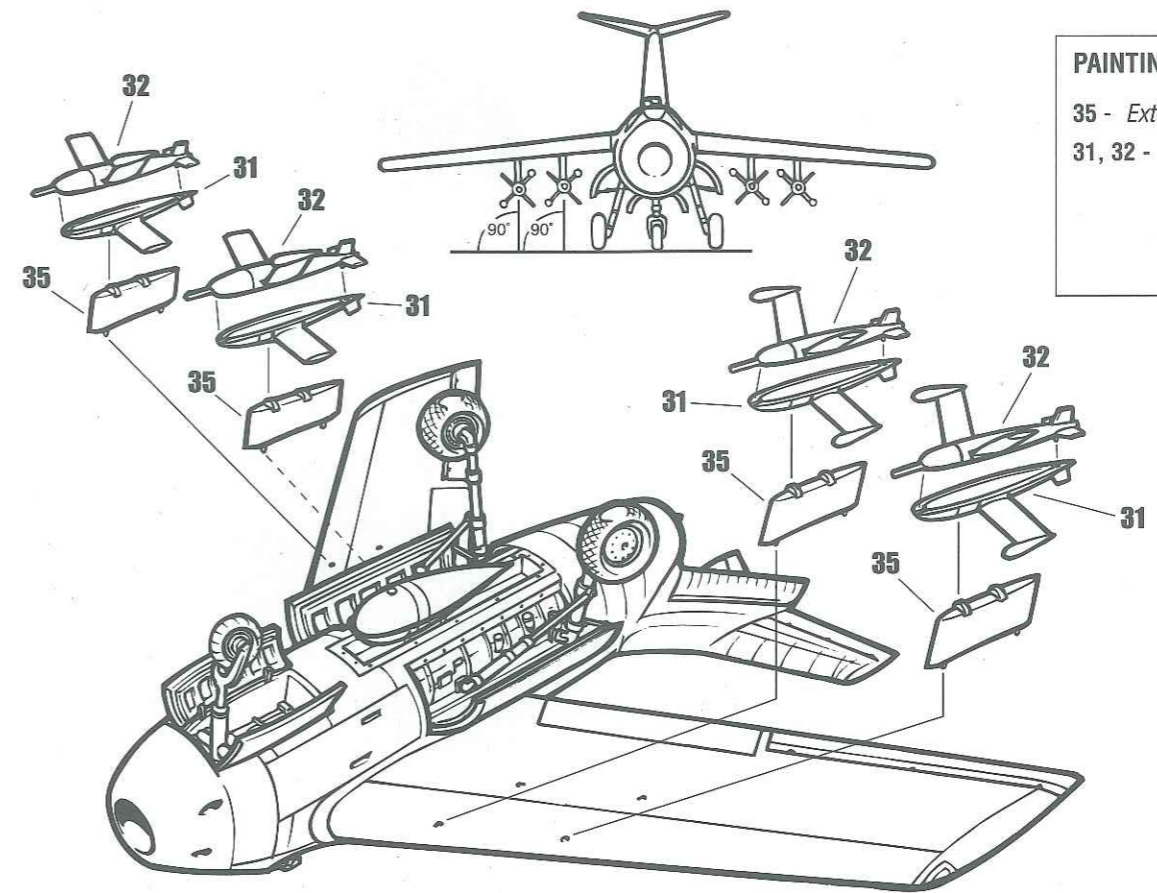

PAINTING INSTRUCTIONS:

35 - Exterior Color
 31, 32 - Aluminum: Body & Fins,
 Probe, Pod Tips
 RLM 76: Body (optional)
 Satin Black: Nose, Pods
 Wood: Wings

Step 5 - Wing Assembly

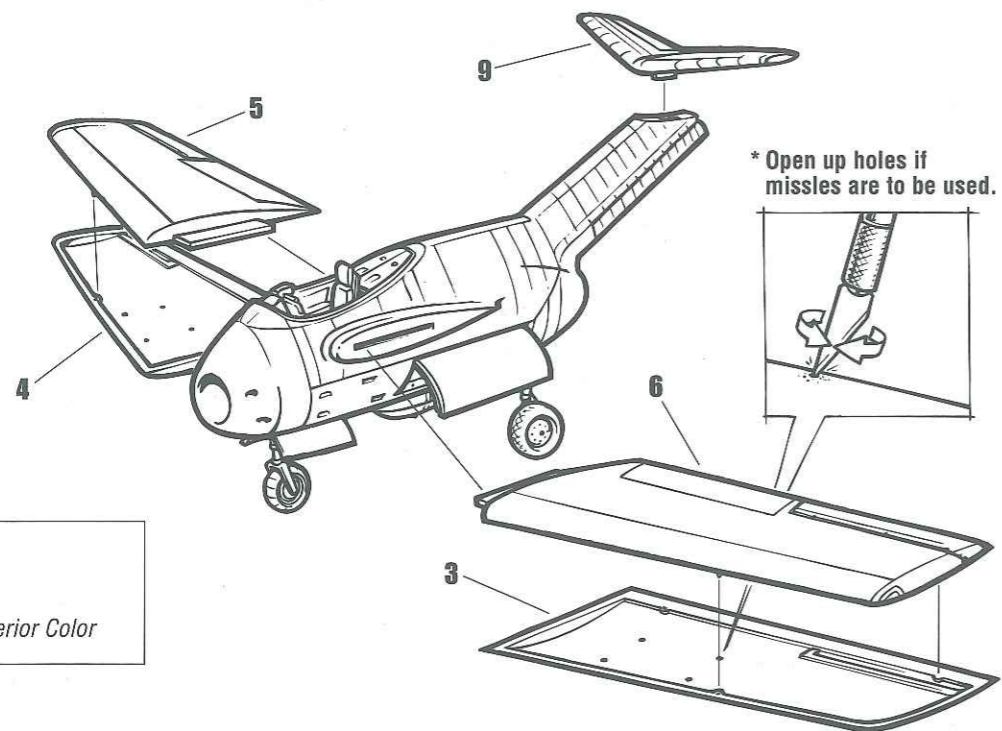

PAINTING INSTRUCTIONS:

3, 4, 5, 6, 9 - Exterior Color

Step 7 - Final Assembly

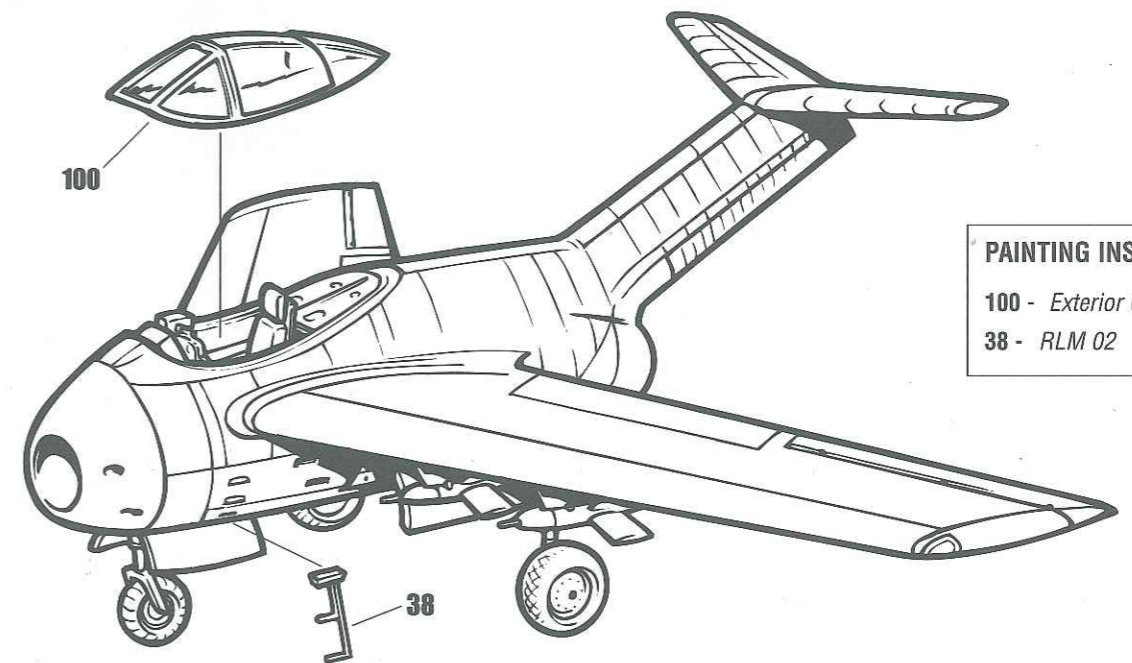

PAINTING INSTRUCTIONS:

100 - Exterior Color: Framework
 38 - RLM 02

1 Ta183A-1 HUCKEBEIN
III./JG54 1946

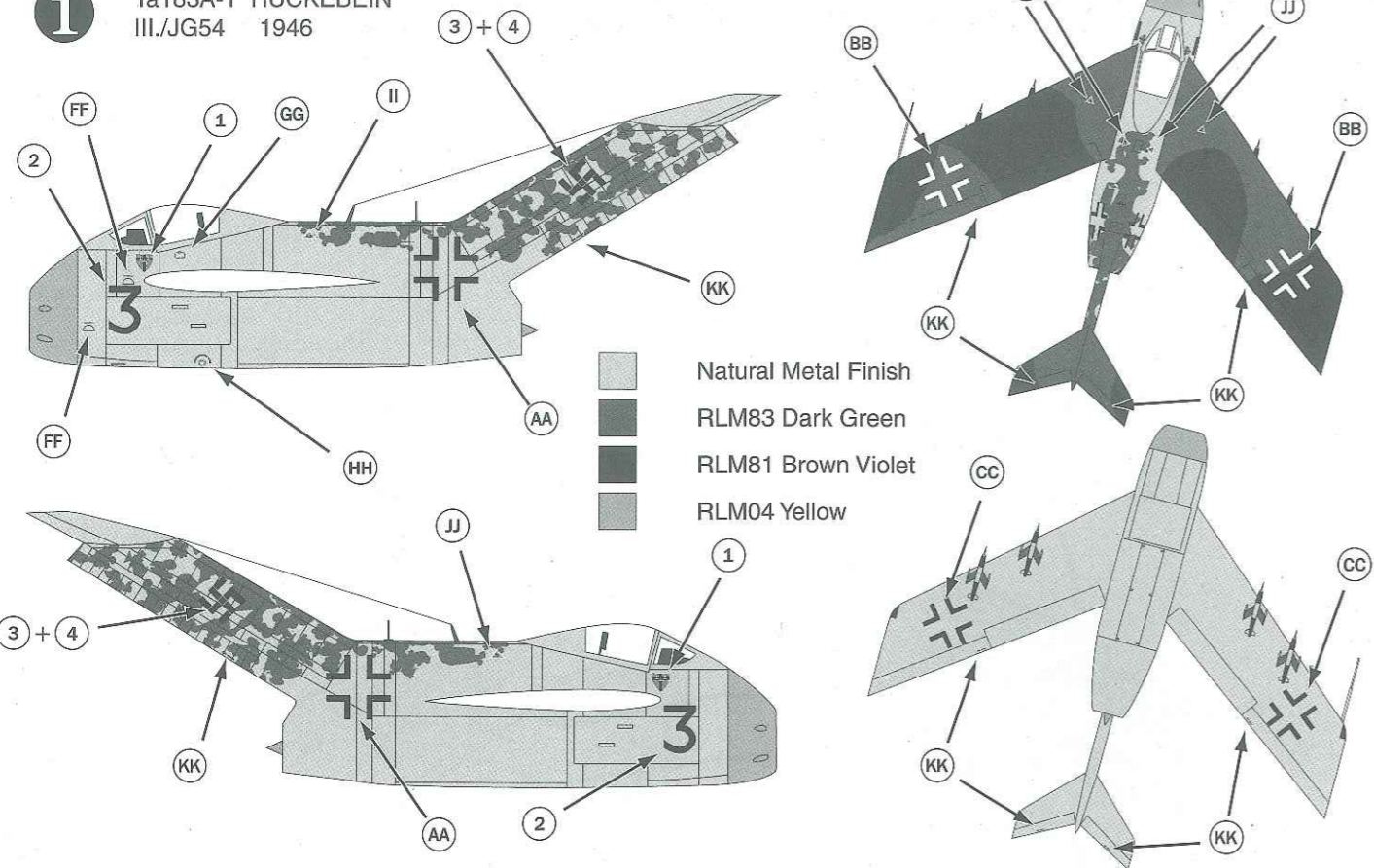

2 Ta183A-1 HUCKEBEIN
9./JG52 1945

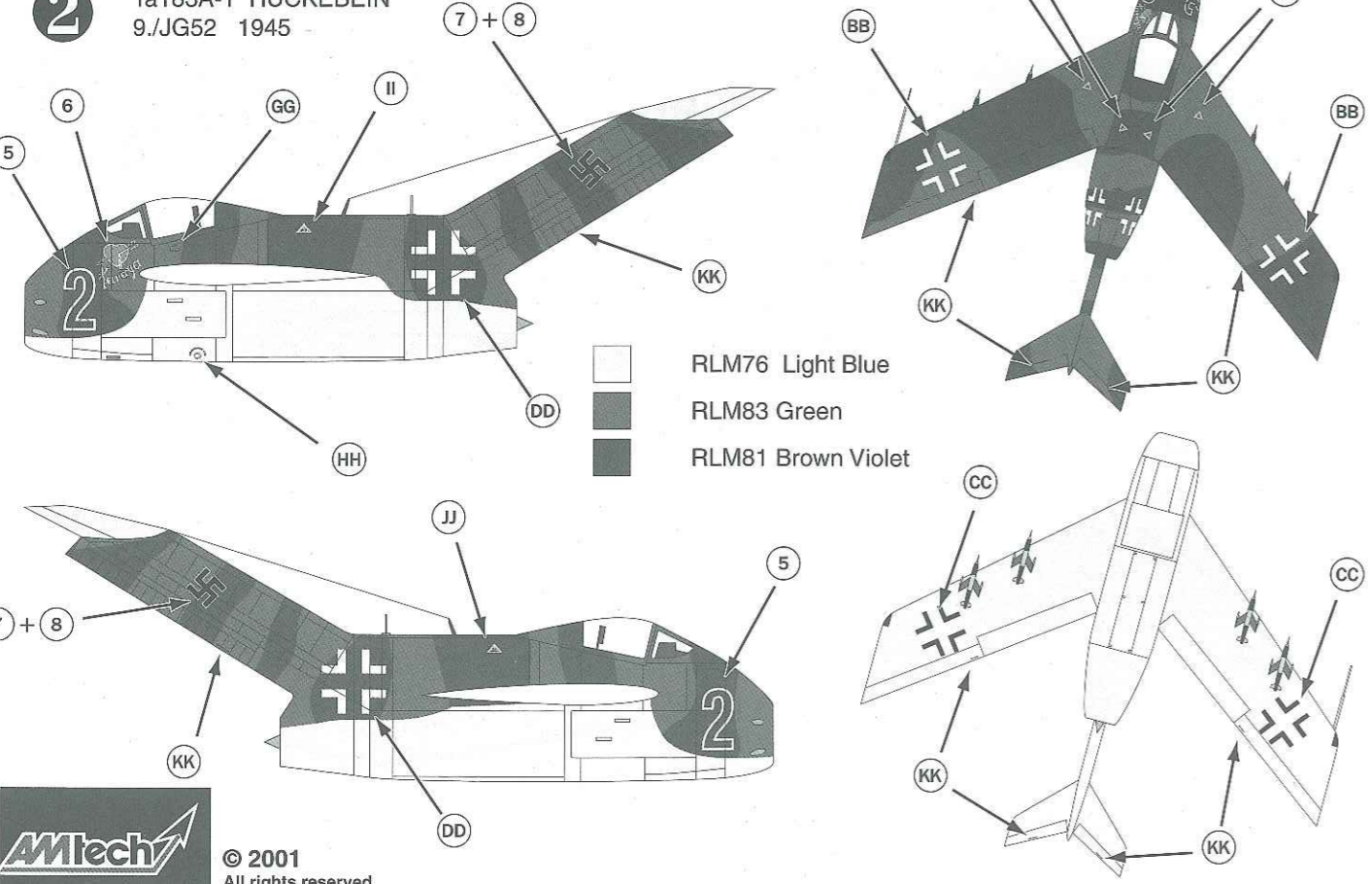

3 Ta183B-1 HUCKEBEIN
"RABEN" STAFFEL, 5./JG52 1945

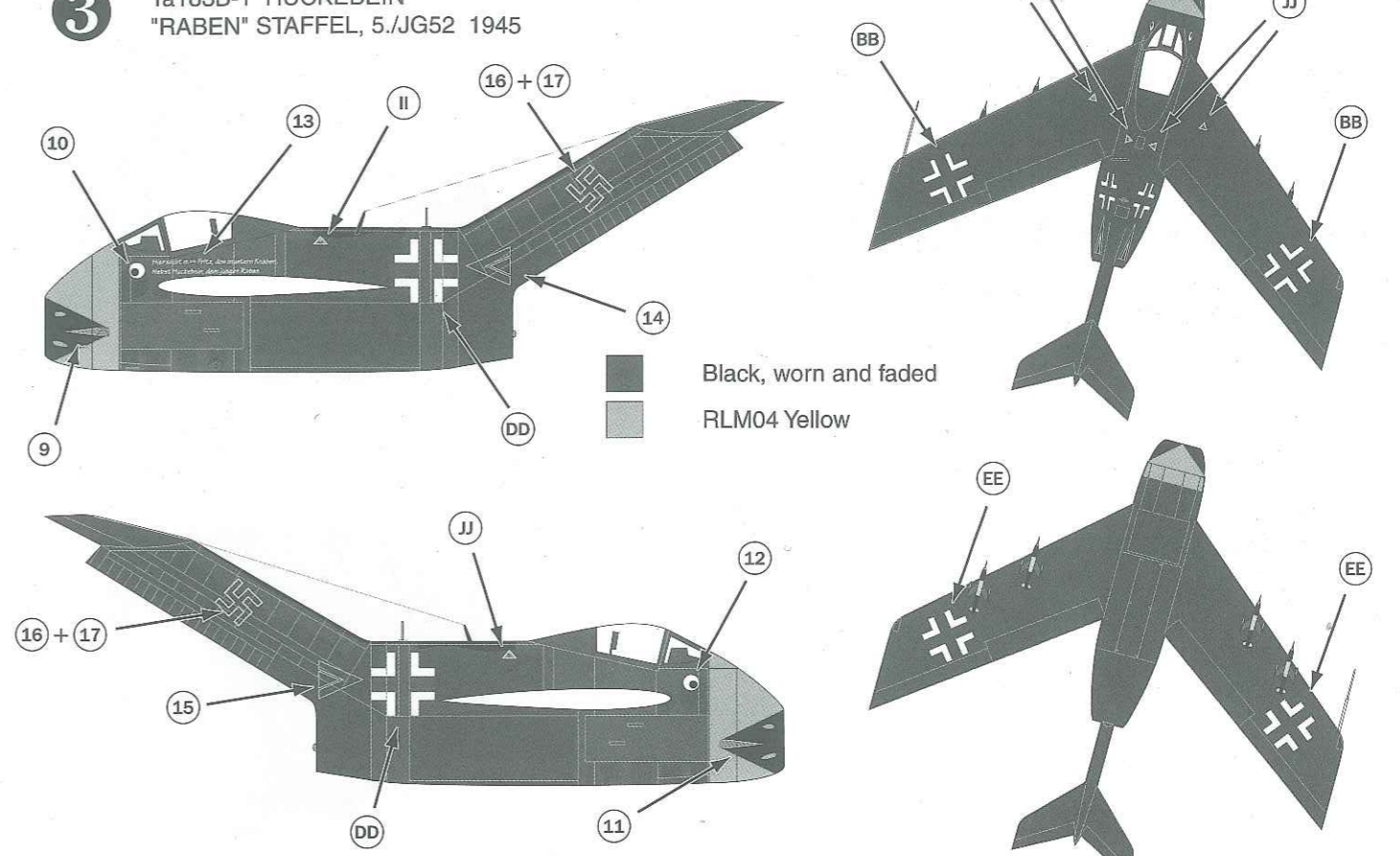

4 Ta183B-1 HUCKEBEIN
1./JG2 "RICHTHOFEN" 1945

