

## 15 cm sFH 13/1 (Sf) auf GW Lr.S. (f) - Sd.Kfz. 135/1

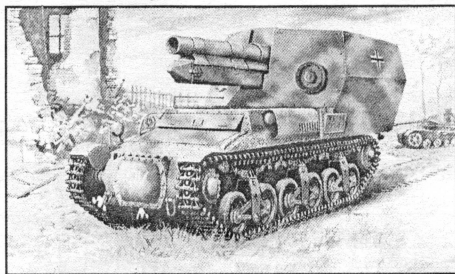

Lorraine L37L był lekkim opancerzonym transporterem przeznaczonym do przewozu amunicji i ludzi. W okresie od 1937 roku do maja 1940 roku wyprodukowano w zakładach SOCIETE LORRAINE 387 sztuk tego pojazdu. Przez komisję do spraw uzbrojenia niemieckiego WEHRMACHTU został zaakceptowany jako samobieżna laweta do zabudowy armat i haubic pod oznaczeniem Sd.Kfz. 135. W okresie lipiec – sierpień 1942 w zakładach Wa A Paris zabudowano na podwoziu L37 15 cm haubicę s.F.H. 13. Wykonano 64 sztuki z przeznaczeniem dla dwóch pułków artylerii samobieżnej stacjonujących we Francji.

**Dane techniczne:**

Uzbrojenie – haubica 15 cm s.F.H. 13 L/17, karabin maszynowy 7,92 mm  
Zaloga – 4 osoby, masa bojowa – 8500 kg.

Silnik – 6-cylindrowy DelaHaye 103 TT o poj. 3,5 dcm<sup>3</sup> i mocy 70 ps przy 2700 obr/min, skrzynia biegów o 6 przełożeniach, prędkość maksymalna 34 km/h, zasięg 135 km.

**MALOWANIE I OZNAKOWANIE****Nakładanie kalkomanii.**

1. Wyciąć wybrany znak z arkusza.
2. Zanurzyć w naczyniu z ciepłą wodą na czas ok. 10 sek.
3. Po wyjściu z wody począć az kalkomania całkowicie odmoknie (2-5min.) i daje się łatwo przesuwać po papierze.
4. Przenieść kalkomanie na model.
5. Wgnieść kalkomanie w fakturę modelu przy pomocy miękkiej szmatki, usuwając jednocześnie pęcherze powietrza i wodę znajdującą się pod kalkomanią.

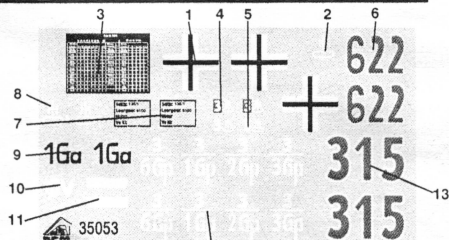
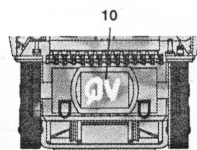
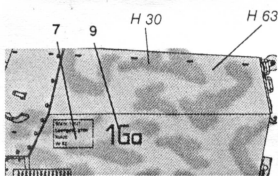
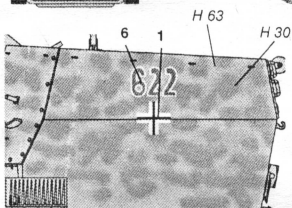
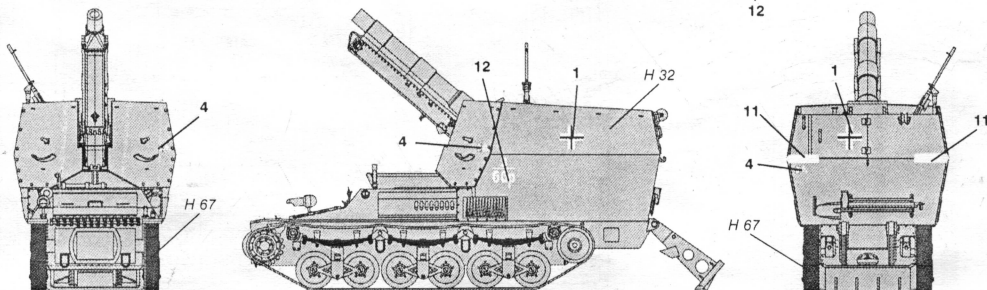
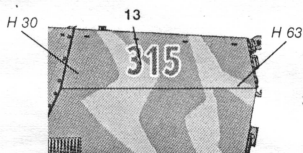
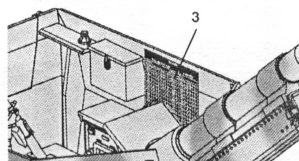
**1. Gepanzerte Artillerie-Regiment(Sfl.) – Francja 1942****1. Pz.Art.Rgt.155, 21 Panzer Division (neu) – Normandia, Francja 1944****2. Pz.Art.Rgt.125, 21 Panzer Division (neu) – Normandia, Francja 1944****Tablica przeliczników artyleryjskich****3. Pz.Art.Rgt.192, 21 Panzer Division (neu) – Normandia, Francja 1944**

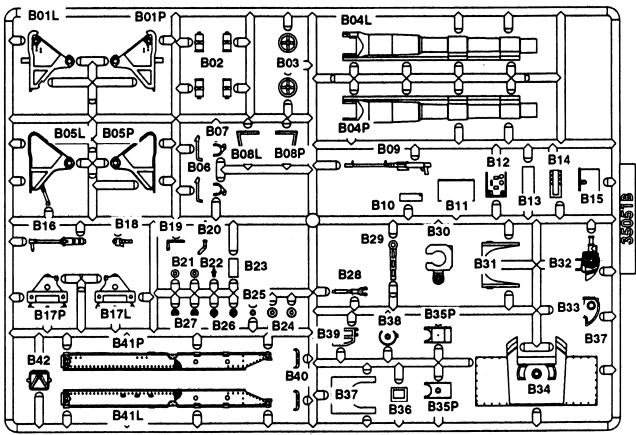
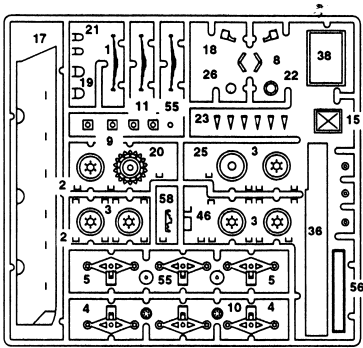

29

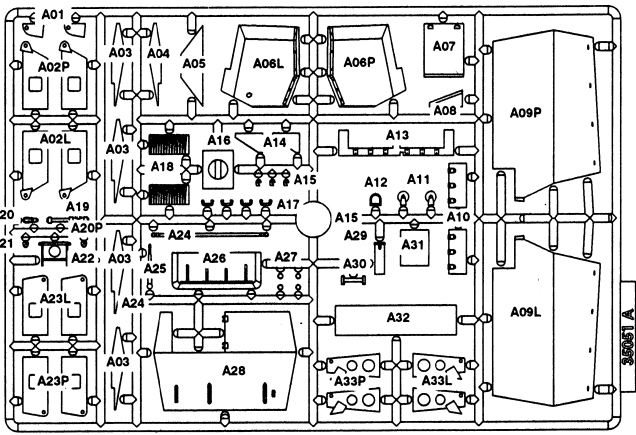
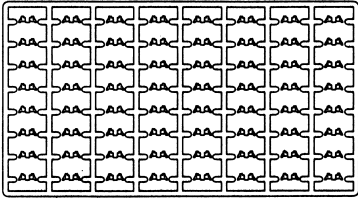

C

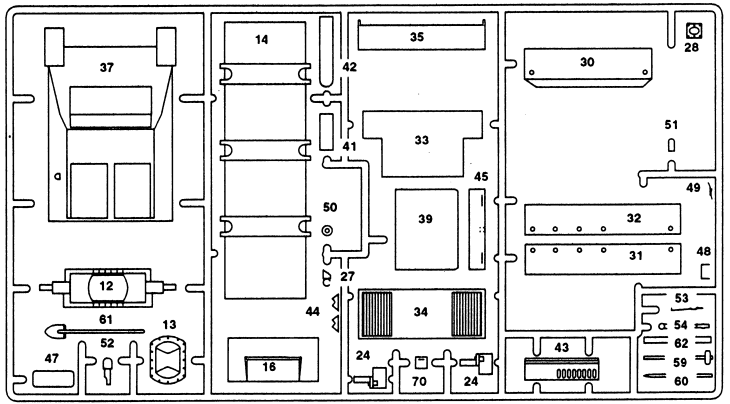
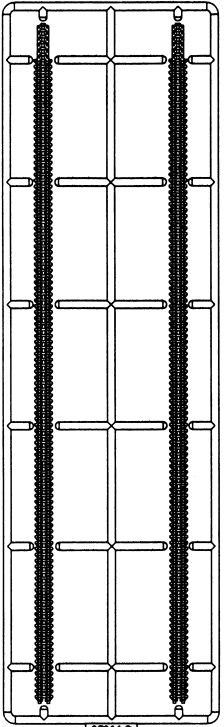

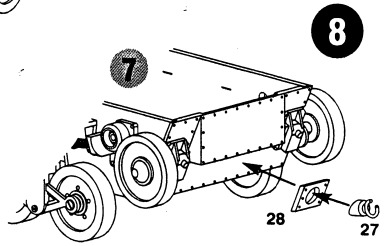
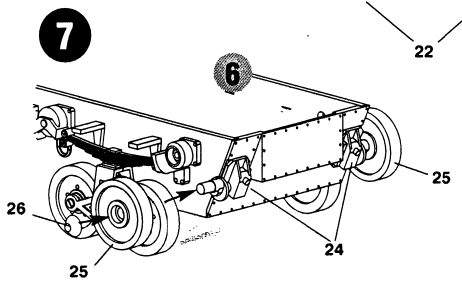
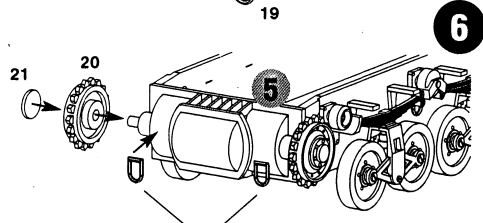
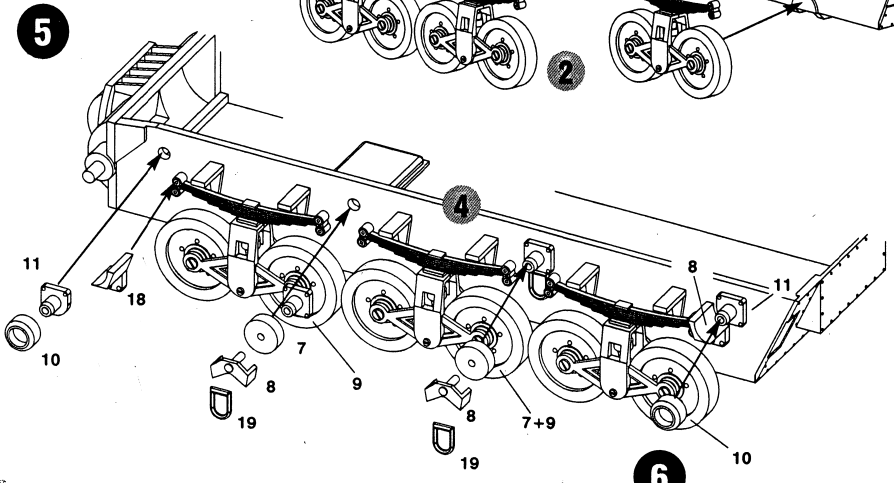
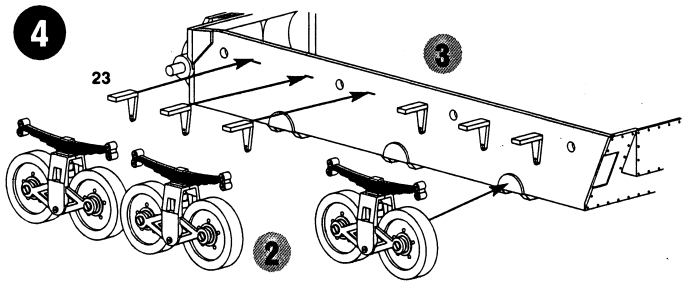
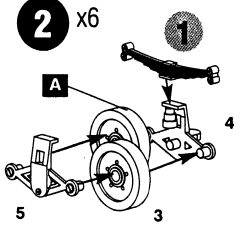
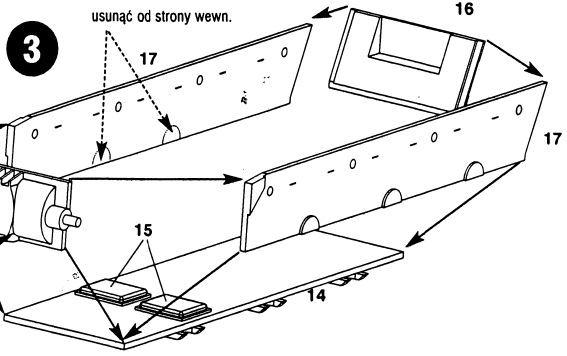
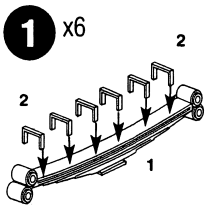

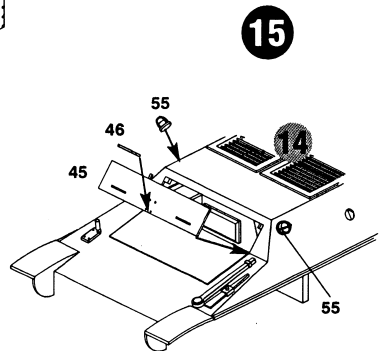
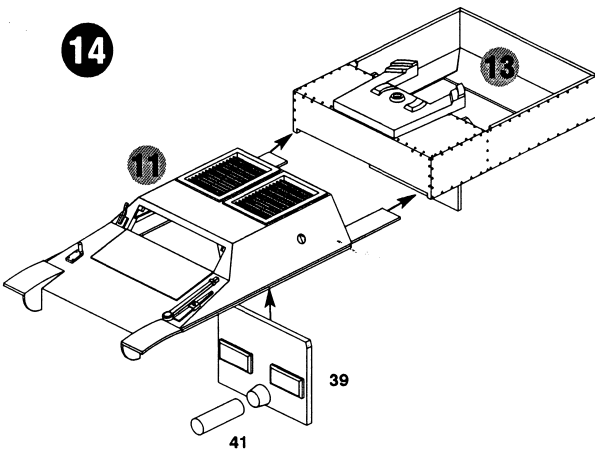
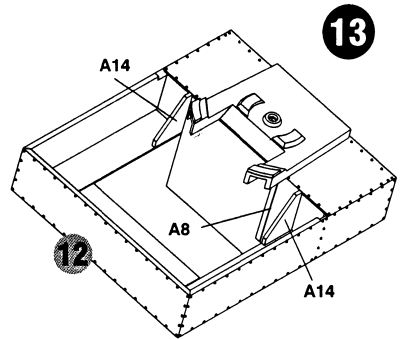
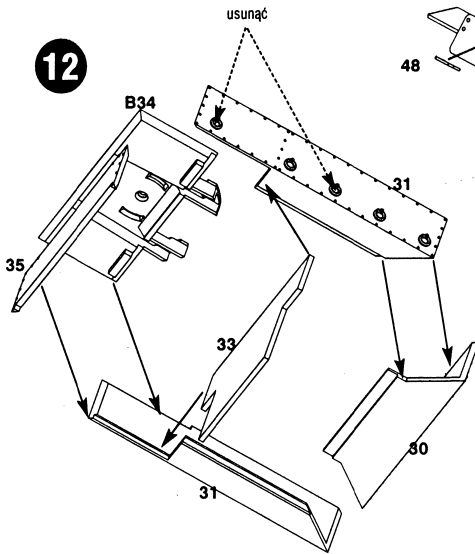
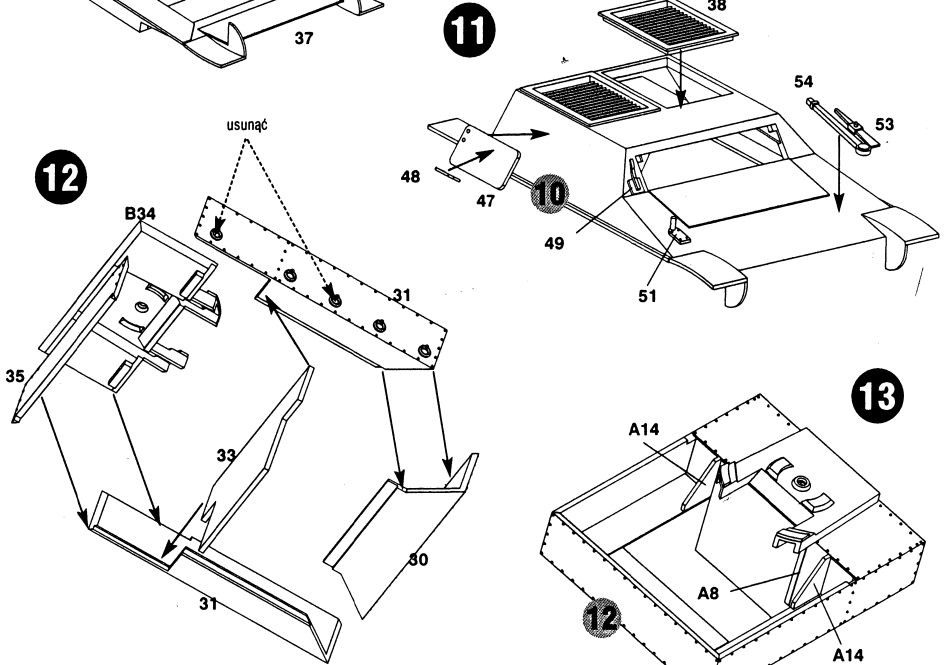
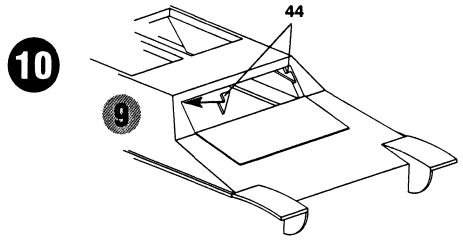
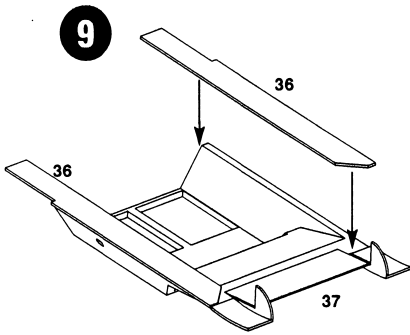

16

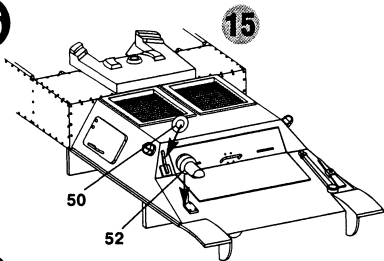

17

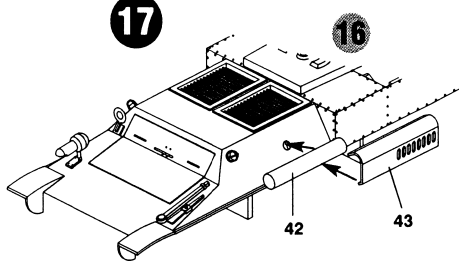

18

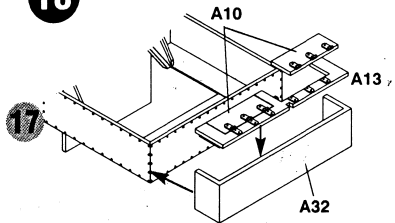

17

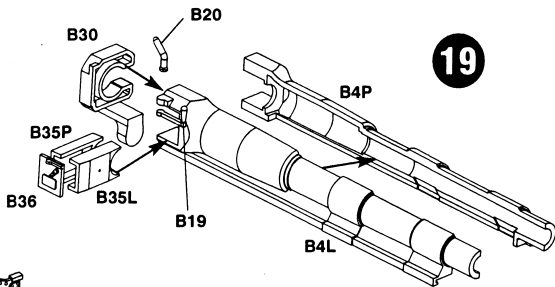

19

20

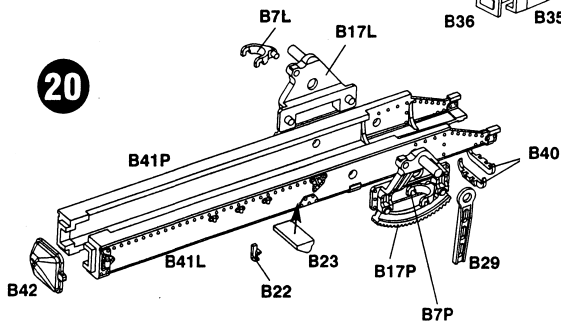

21

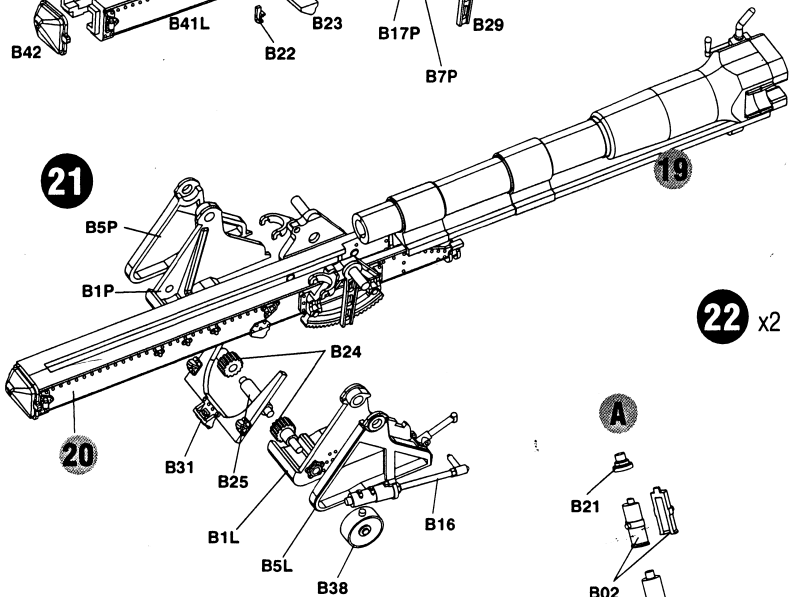

22 x2 ?

A

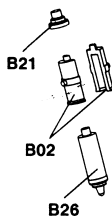

B

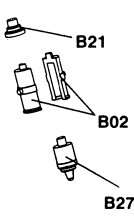

23

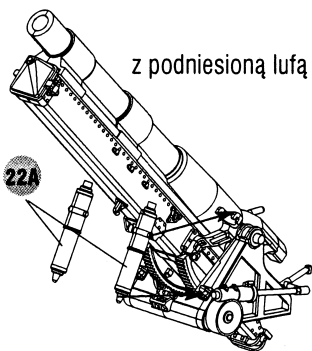

z opuszczoną lufą

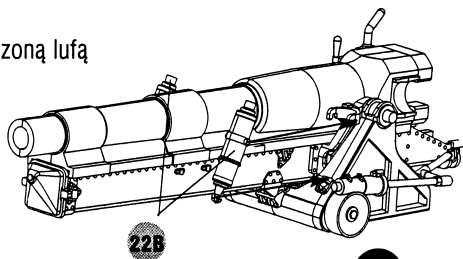

25

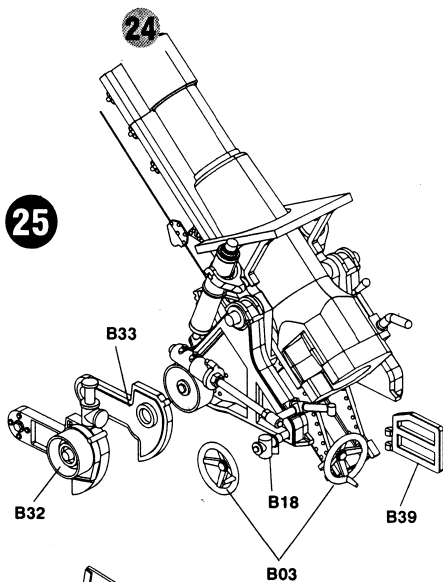

27

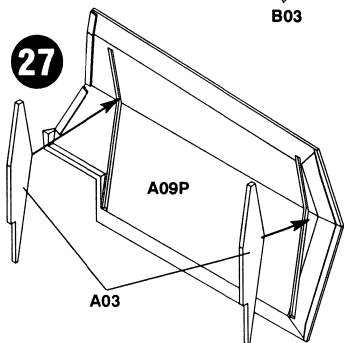

24

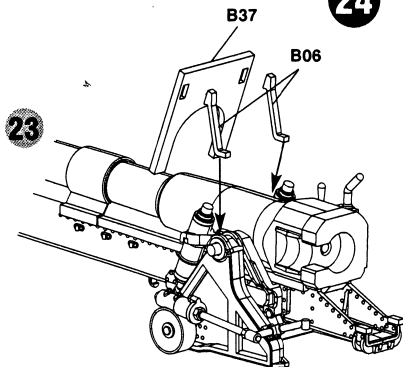

26

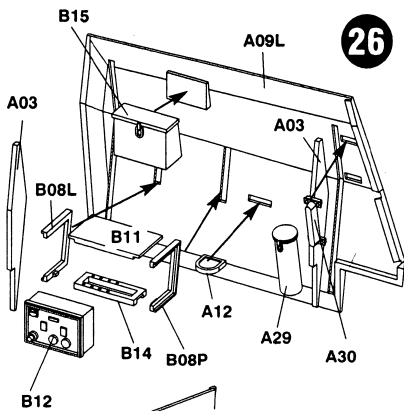

28

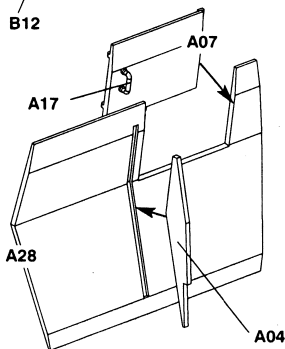

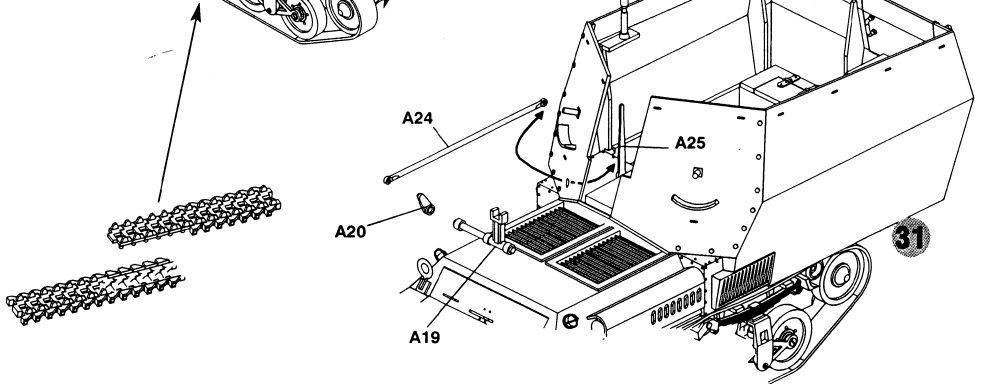
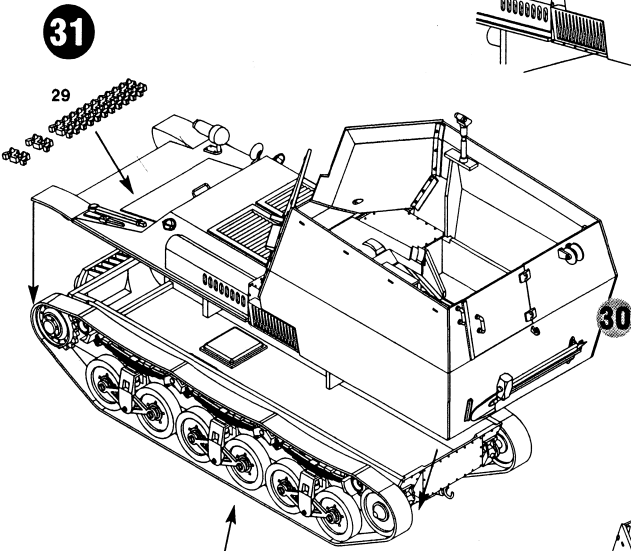
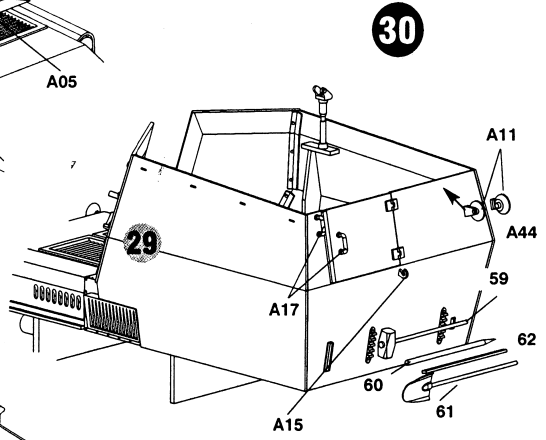
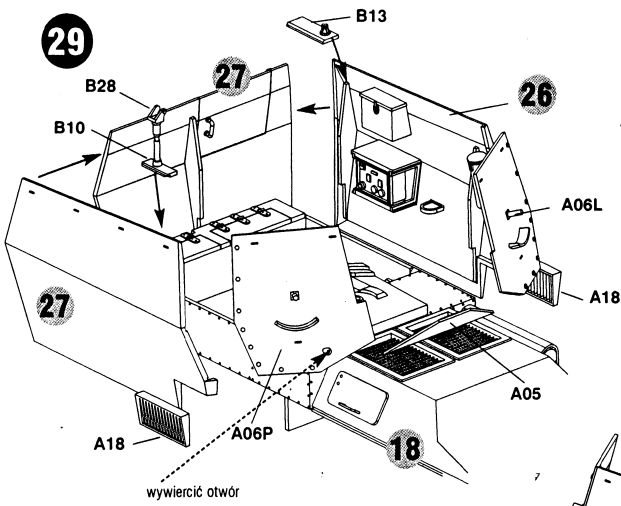

33

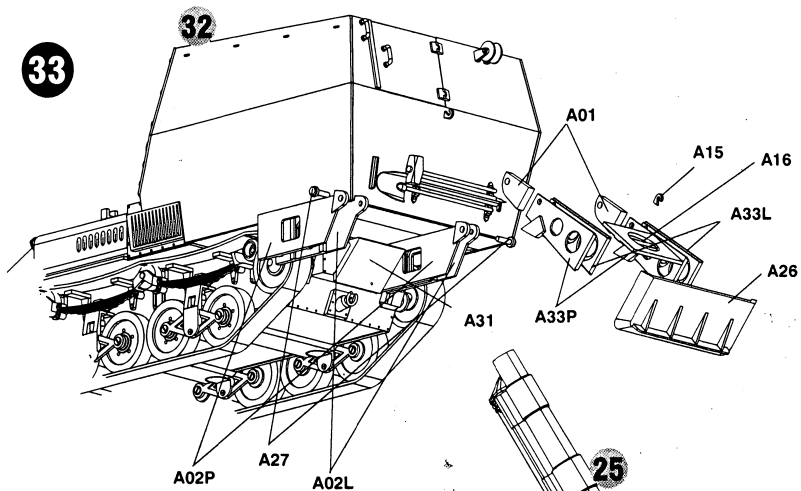

34

