

THE SCALE OF  
THIS MODEL IS  
1/63.5 ACTUAL SIZE  
OR  
1" = 5' 3"

**Revell**  
Authentic Kit

COPYRIGHT 1955 BY REVELL, INC., VENICE, CALIF.  
Pat. No. 2,551,340

H-136 PRINTED IN CANADA

*"IT'S REAL BECAUSE IT'S REVELL"*

## B-25 HISTORY

# B-25 MITCHELL BOMBER

"Best airplane in America for that particular job" were the words of Brigadier General James H. Doolittle, whose B-25 "Billy Mitchell" medium Bomber led a squadron of fifteen other B-25s on the first devastating U. S. raid on Tokyo from the "Shangri-la" Aircraft Carrier U.S.S. Hornet, April 18, 1942.

Active on war fronts throughout the world, B-25s were flown by all the Allies and were the only planes to serve in every combat zone of World War II. Their brilliant combat record paid homage to the late Air Force General William Mitchell for whom they were named.

Built at North American Aviation's Inglewood, California Plant, the twin-engined B-25 has semi-monocoque four-longeron fuselage structure of aluminum alloy covered with the same material. All-metal wings have sealed compartments at outer tips for flotation. Wing center sections have built-in fuel and oil tanks.

The Bomber was powered by two Wright "Cyclone" R-2600-13 twin-row radial

air-cooled engines with two-speed superchargers making available 1700 hp for takeoff. Each engine was fitted with an independent, bullet-proof, self-sealing fuel system consisting of two interconnected fore and aft compartments. Normal fuel capacity of 646 gallons can be augmented by 420 gallons carried in a dropable tank installed in the bomb-bay.

One machine-gun in the nose and two Bendix electrically operated turrets with .50 cal. machine-guns, one above and one below the fuselage amidships comprise the armament. The bomb-bay provides for internal bomb and torpedo storage beneath the center section.

Wingspan of 67 feet, 6-7/10 inches creates an overall wing area of 609.8 square feet. The B-25C is 52 feet, 10-13/16 inches long and is 15 feet, 9-3/16 inches high. The crew consisted of five airmen.

### FOR BEST RESULTS, READ THIS FIRST

1. Since this kit is molded of styrene plastic, use only Revell © Cement. Do not let cement touch your eyes, furniture or clothing.
2. Apply cement sparingly. Excess cement may run and damage the details on your model.
3. Carefully trim any excess plastic from parts before assembling. This will result in parts

fitting together perfectly, and also enable moving parts to move freely.

### THIS IS VERY IMPORTANT

4. All parts are numbered for easy identification, or the numbers are engraved on the bar next to the part. Carefully remove each part from its bar only when that part is to be used.
5. Start with No. 1 and cement it to No. 2, etc.

6. With Revell Paint Set Colors, paint all the parts where indicated and allow to dry before assembling. All colors are flagged as shown: **RED** <
7. Directions for applying decals are on the back of the Decal Sheet.
8. Carefully follow these numbered steps, for ease in building your model.

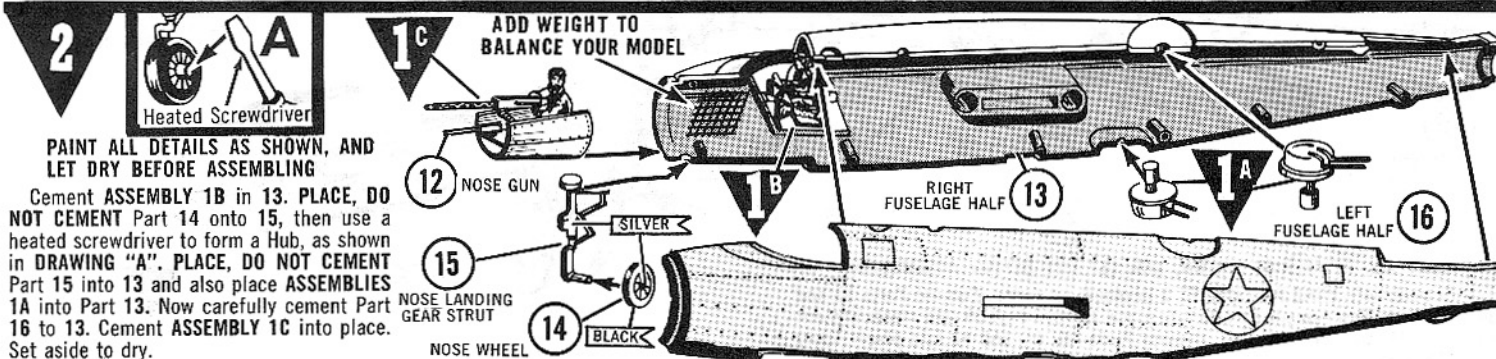
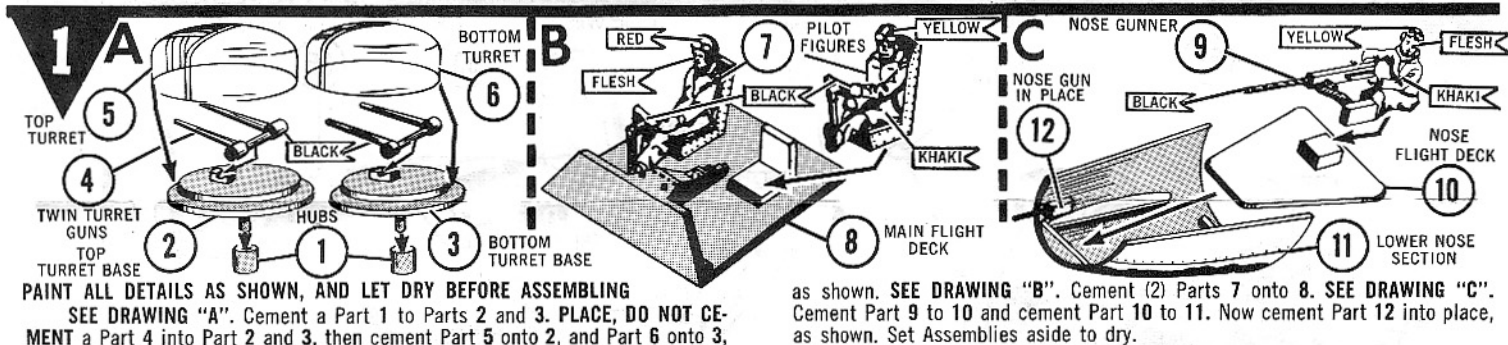





WING

15711



WING

LEFT



FUS.



THE FLYING

DRAGON



THE FLYING

DRAGON



FUS.

15711

RIGHT