

F-15C MSIP II

ACADEMY

HOBBY MODEL KITS

12221



1/48th Scale

Photo : Tim Lachenmaier



		GSI CREOS		LIFE COLOR	HUMBROL	TESTOR/MODEL MASTER		
		AQUAFLEX HOBBY COLOR	Mr. COLOR			ENAMEL	ACRYL	
1	FLAT BLACK	H<12>	33	LC02	33	1749	4768	무광 검정색
2	BRIGHT GREEN	H<26>	66	LC11	2	52715		브라이트 그린
3	YELLOW		329	UA140	154	1708	4721	유광 노랑색
4	BLACK	H<2>	2	LC52	21	1742	4695	유광 검정색
5	WHITE	H<1>	1	LC51	22	1745	4696	유광 흰색
6	SILVER	H<8>	8	LC74	11	1790	4678	은색
7	BURNT IRON	H<76>	61	LC74(60%) +LC02(40%)	56	1796	4676	흑철색
8	FLAT WHITE	H<11>	62	LC01	34	1768	4769	무광 흰색
9	METALLIC GRAY	H<28>	61	LC76	53	1795	4681	메탈릭 그레이
10	CLEAR RED	H<90>	47		1321		4630	클리어 레드
11	CLEAR BLUE	H<93>	50				4658	클리어 블루
12	DARK GULL GRAY/ FS 36231	H<317>	317	UA033	140		4755	다크 걸 그레이
13	LIGHT GHOST GRAY/ FS 36320	H<308>	308	UA062	127	1728	4762	라이트 고스트 그레이
14	KHAKI	H<81>	55	UA039	72	1792		카키색
15	KHAKI GREEN	H<80>	54					카키 그린
16	OLIVE GREEN		120	UA030	123	2081	4790	올리브 그린
17	LIGHT GRAY FS 36251		308(70%) +317(30%)	UA026(70%) +UA003(30%)				라이트 그레이
18	DARK GRAY FS 36176		307(80%) +305(20%)	UA027(80%) +UA022(20%)				다크 그레이
19	DARK GHOST GRAY/ FS 36320	307	307	UA027	128	1741	4761	다크 고스트 그레이

⚠ 보호자 분들은 반드시 읽어 주십시오.



**주의
WARNING!**

- 조립하기 전에 취급 설명서를 꼭히 읽어 내용을 충분히 이해한 상태에서 조립하여 주십시오.
- 부품을 자를 때는 해당번호를 확인한 뒤 니퍼 등으로 깨끗이 잘라 주십시오. 칼을 이용하여 부품을 다듬고 자를 경우 손을 다치지 않도록 세심한 주의를 기울여 주십시오.
- 작은 부품 따위를 절대로 입에 넣지 마십시오. 잘못하여 삼킬 경우 질식 등의 위험이 있습니다. ● 자칫 먹을 우려가 있으므로 3세 미만의 어린이에게는 절대로 주지 마십시오.
- 잘라낸 부품은 깨끗이 다듬어 조립하고 남은 쓰레기는 분리하여 잘 버려 주십시오. ● 기능상 부득이하게 튀어나온 부분이 있을 수 있습니다. 취급 시 충분한 주의를 기울여 주십시오.
- 제품 및 부품이 포장된 비닐봉지는 개봉 후 즉시 어린이의 손에 닿지 않는 곳에 잘 버려 주십시오. 머리에 뒤집어쓰거나 얼굴을 덮을 경우 질식의 위험이 있습니다.
- 색칠 및 접착을 위하여 모형용 도료 및 접착제 등을 사용할 때에는 창문을 열어 환기를 시키고 화기를 멀리하여 주십시오. 사용하고 남은 도료 및 접착제는 어린이의 손이 닿지 않는 곳에 잘 보관하여 주십시오.

- Before starting to assemble, read the instruction manual very carefully to understand well everything of the instructions.
- Before cutting a part off sprue, check the part number again and use proper tool such as nipper to cut it clearly. Take care not to be hurt in use of modelling knife to cut or trim parts.
- Never put small parts in the mouth to avoid any danger of suffocation by accidentally swallowed ones. ● Never let children less than 3 years old have it to avoid any danger of taking it.
- The product may have some protruding parts for functional reasons and take care of handling it always.
- After cutting a part off sprue, trim it clearly to assemble and the wastes should be properly sorted to dispose.
- Plastic bags packed with the product and parts should be disposed in a proper place immediately to keep out of children to avoid any danger of suffocation by pulling it over head or putting it over face.
- Before using modelling colors or cement, open windows to keep the room well ventilated and do not use near fire or flame. After using them, keep in a proper place out of children.

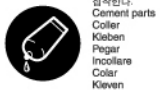

점착한다.
Cement parts
Colier
Kleben
Pegar
Incollare
Colar
Kleven



점착하지 않는다.
Do not cement
Ne pas coller
Nicht kleben
No pegar
Non incollare
Nao colar
Niet kleven



3
수반금 조립한다.
Repeat operation
Répéter l'opération
Vorgang wiederholen
Ripetir la operacion
Ripetere
Repilir a operação
Herhalen



전사지를 붙인다.
Decals
Décalomanies
Abziehbild



9
무게추를 넣는다.
Add weight
Lester
Gewicht



구멍이나 홈을 메워준다.
Use filler
Masiquer
Schließen



잘라낸다.
Cut away
Couper
Schneiden
Cortar
Tagliare
Cortar
Snijden



선택한다.
Optional parts
Choix
Auswahlmöglichkeit
Elección
Scelta
Opcao
Keuze



반대측도 조립한다.
Repeat for opposite side
Répétition de la page
Wiederholung für gegenüberliegende Seite



구멍을 뚫어준다.
Make hole
Faire un trou
Öffnen



주의한다.
Be careful
Faire attention
Hier Vorsicht



색칠 및 전사지 붙이기 번호
Painting scheme number
Numeros de la liste de peintures
Lackierschemanummer

1

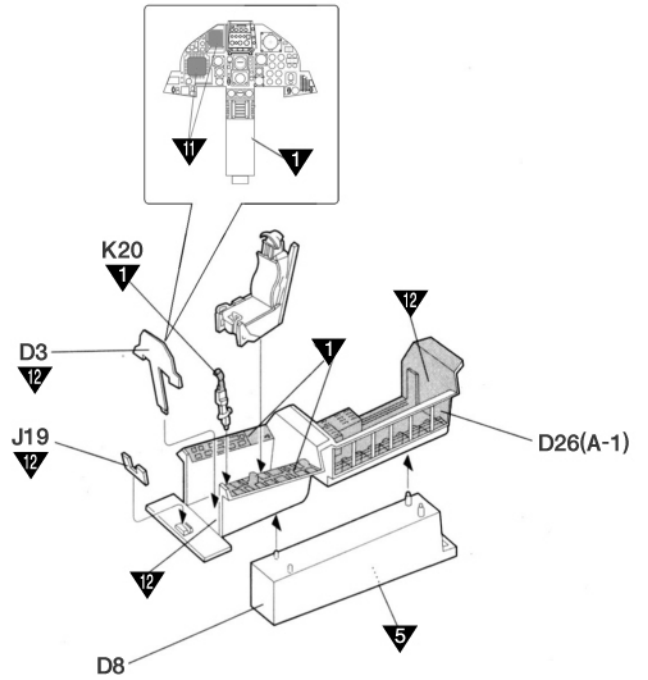
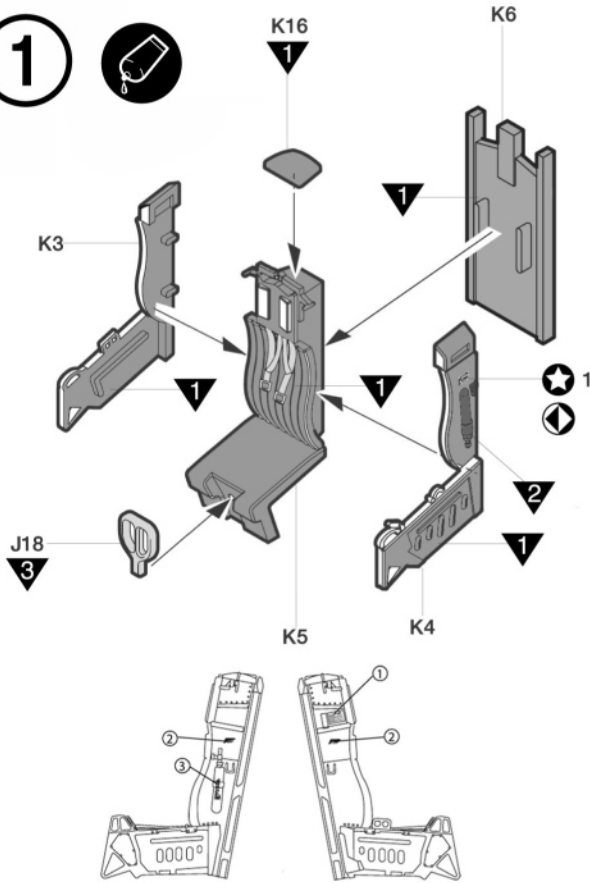

2

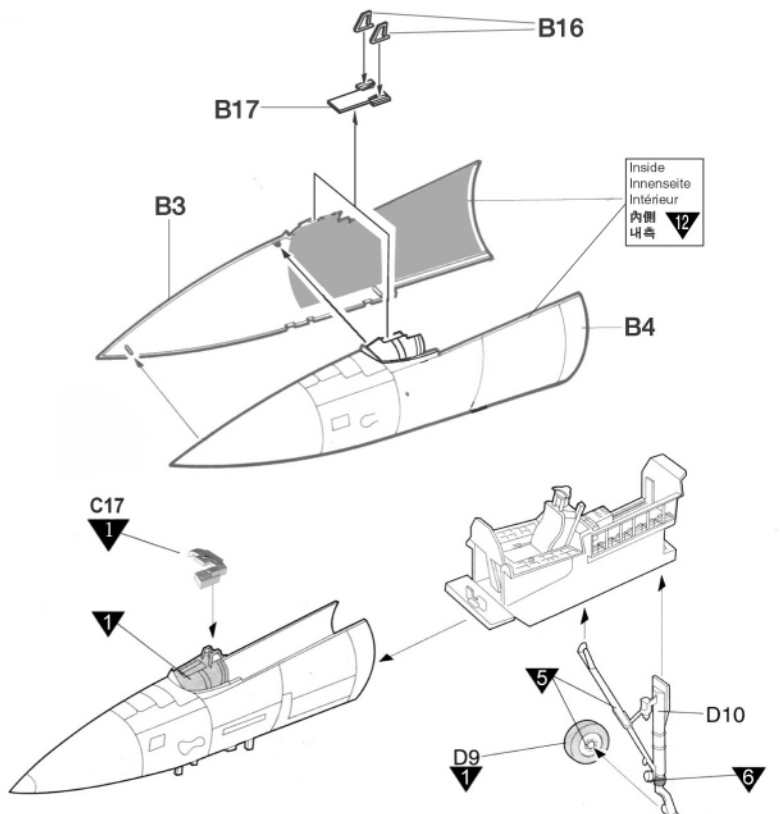
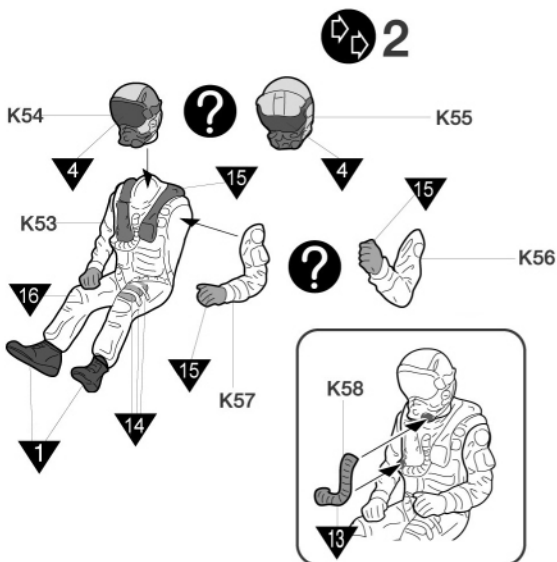

3



Inside
Innenseite
Intérieur
内側
내측

D12

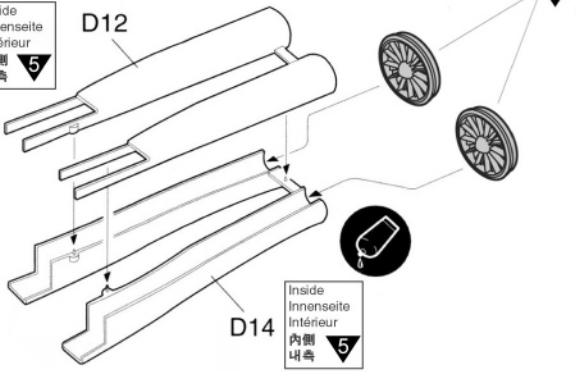

D14

Inside
Innenseite
Intérieur
内側
내측

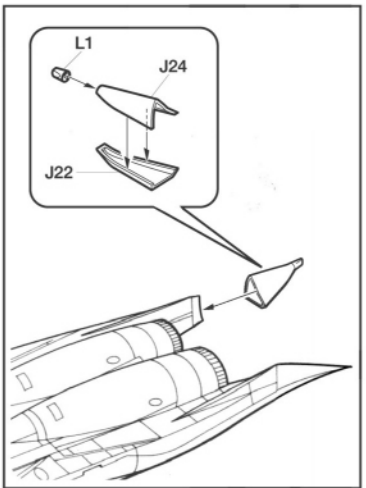
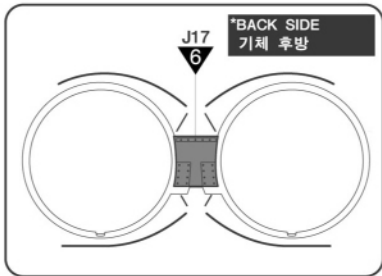

4



A2

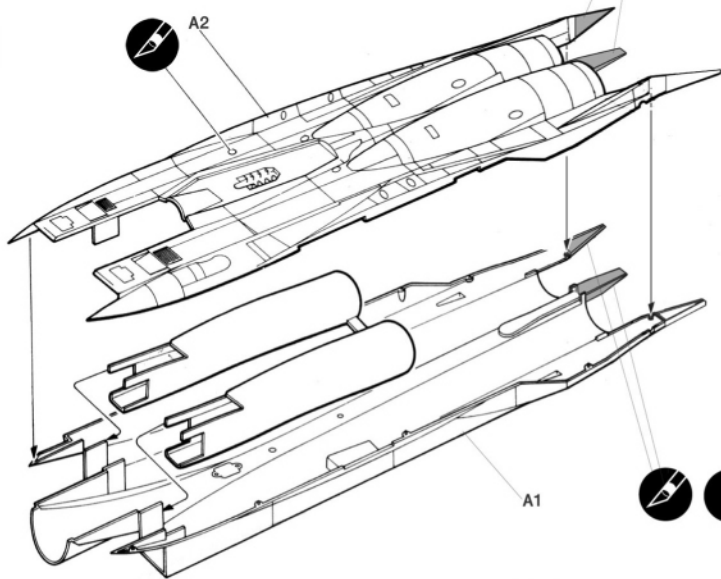

A1



5



7

K33

B18

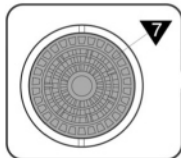

7

K33

B18

D23(A1)

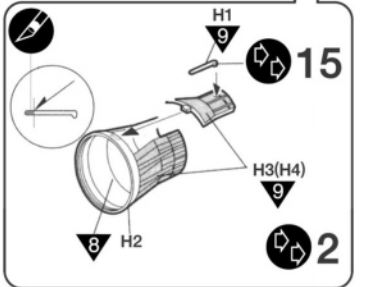
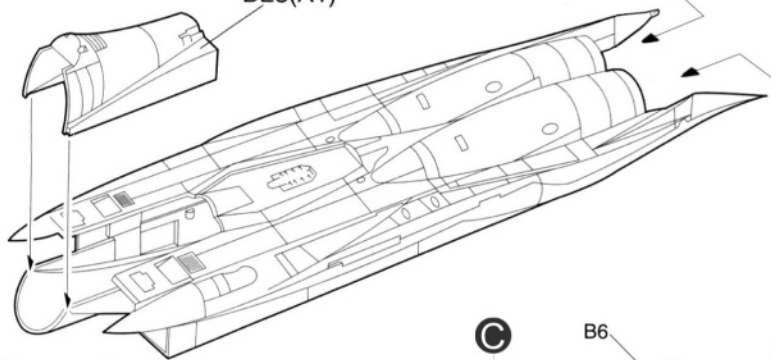

15

2

6



• Right/우

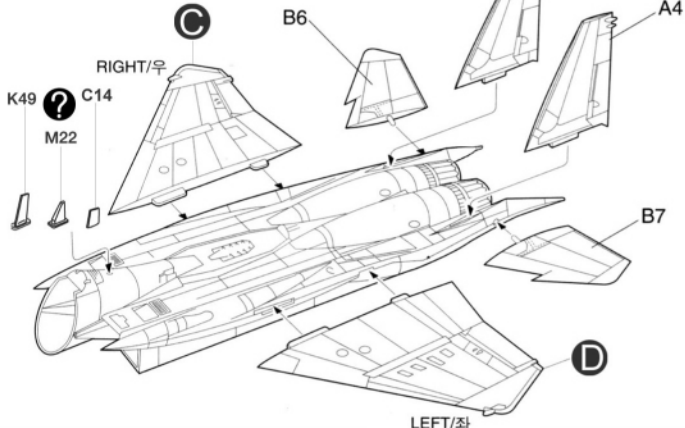
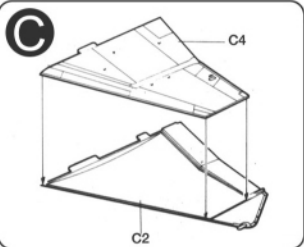

RIGHT/우

LEFT/좌

• Left/좌

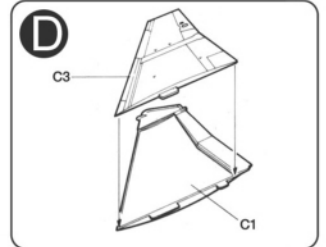

7



★ Select open or closed
개/폐 선택가능

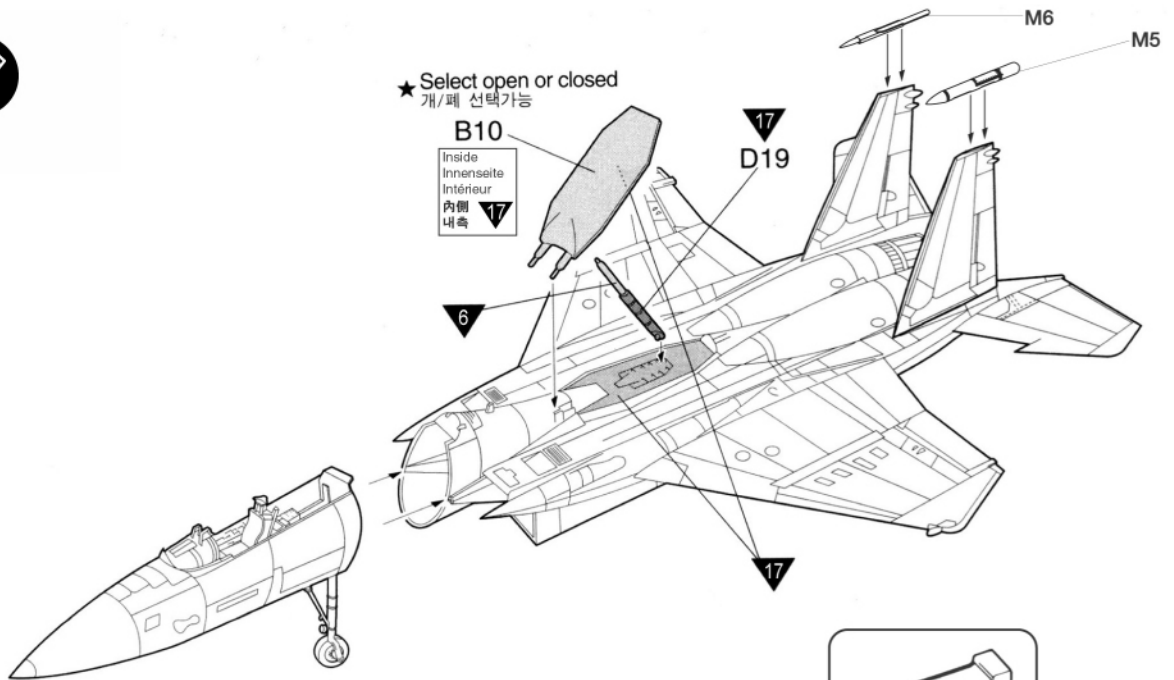

8

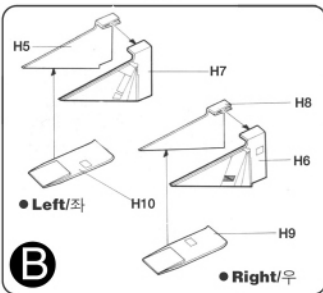
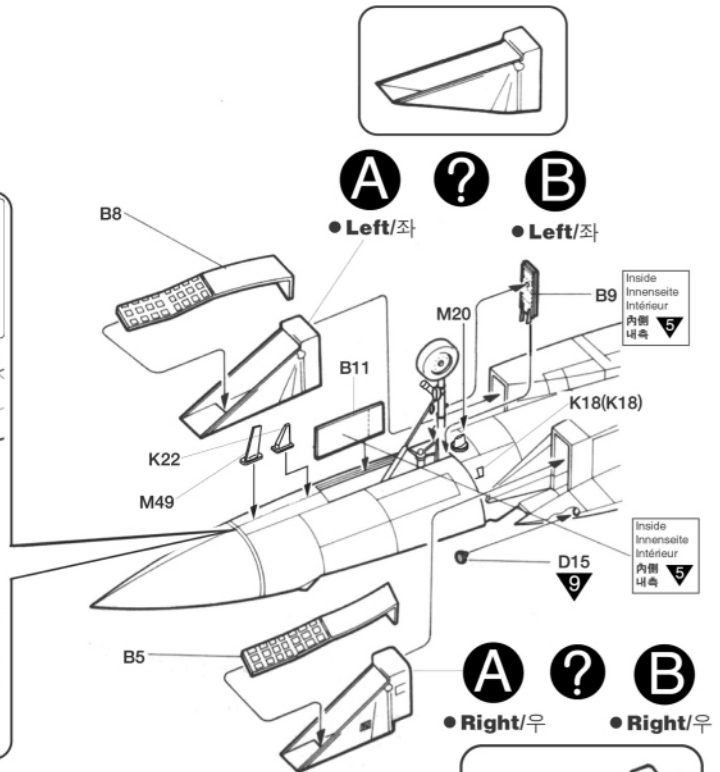
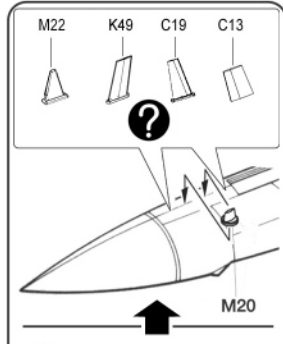
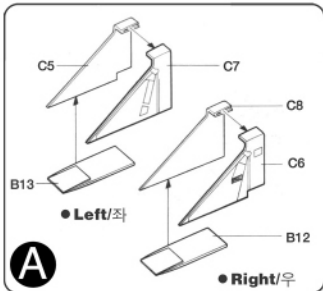

9

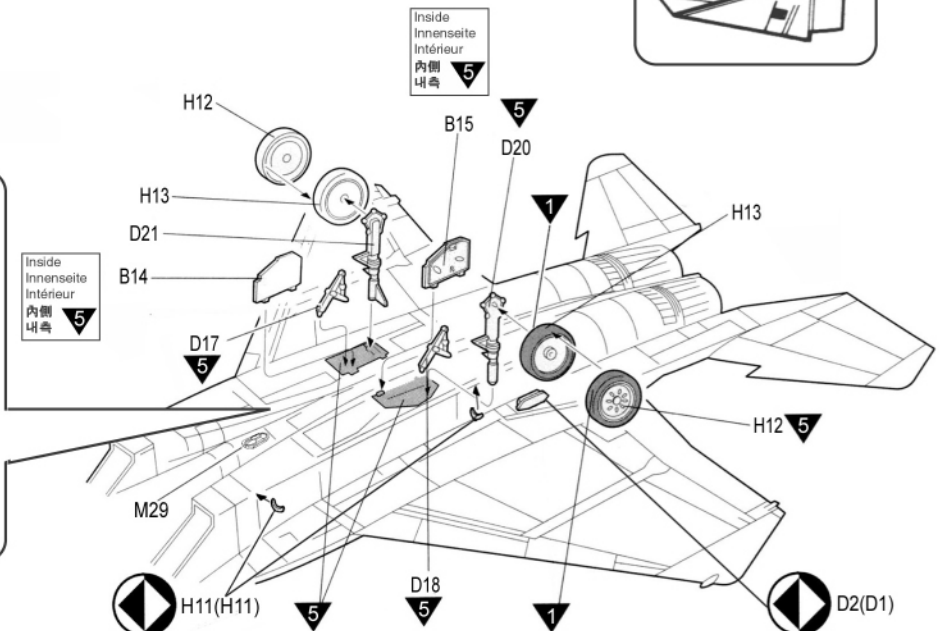
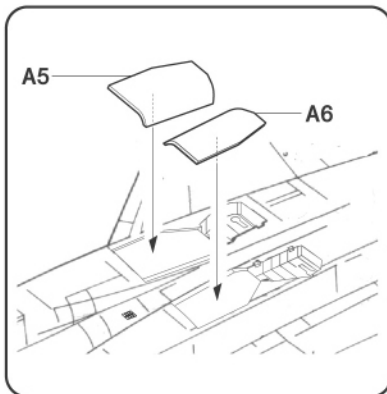

10



2

* () is opposite number.
()는 반대측 번호입니다.

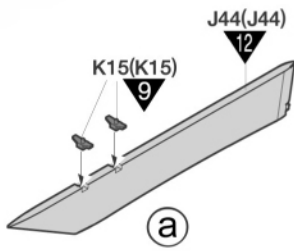

2

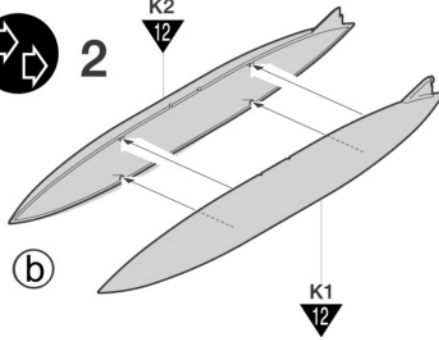

2

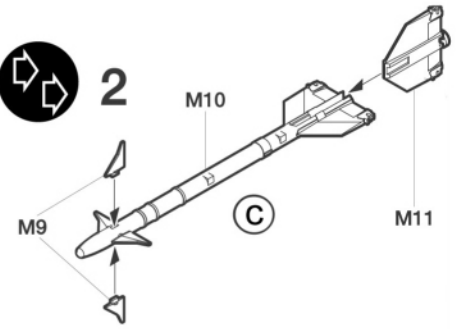

2

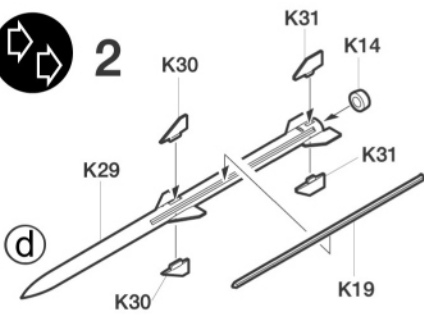

2

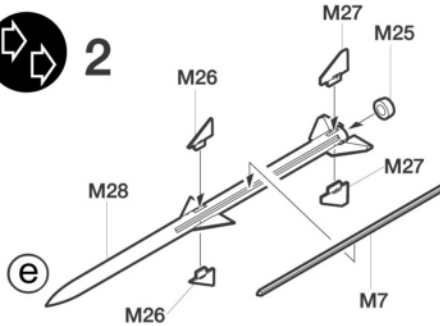

2

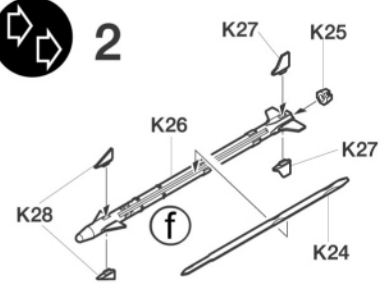

11

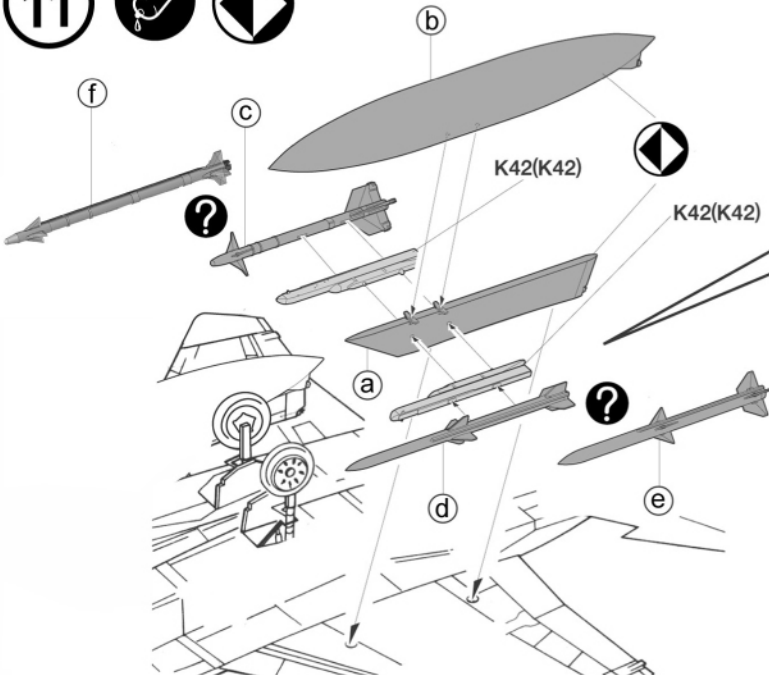

* () is opposite number.
()는 반대측 번호입니다.

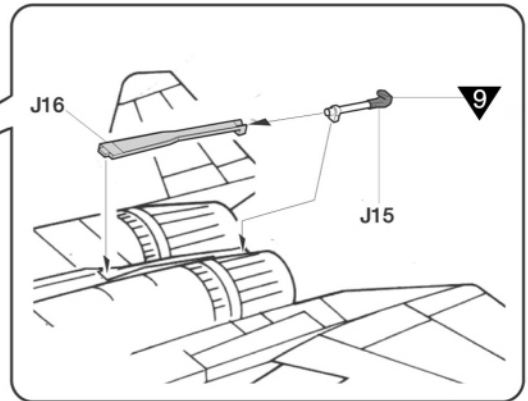

12

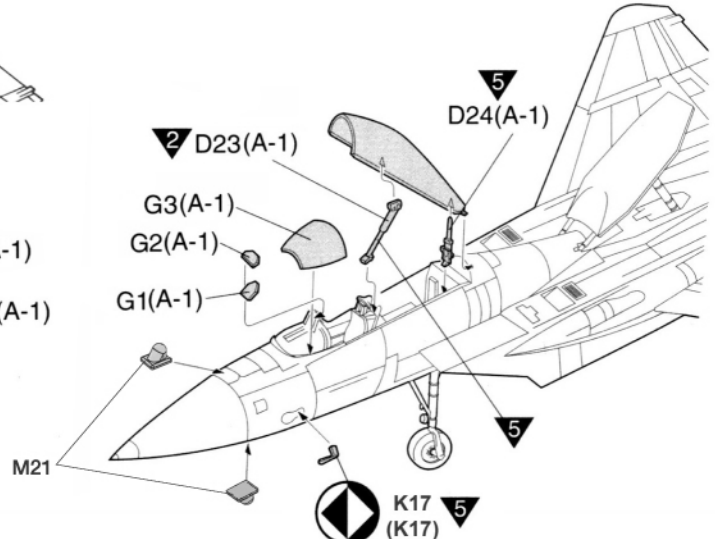
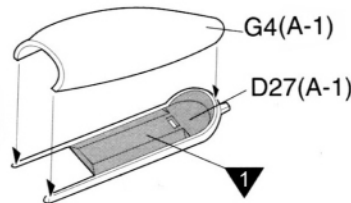
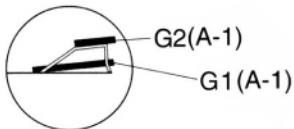

COMMON DATA
공통 기본 데이터

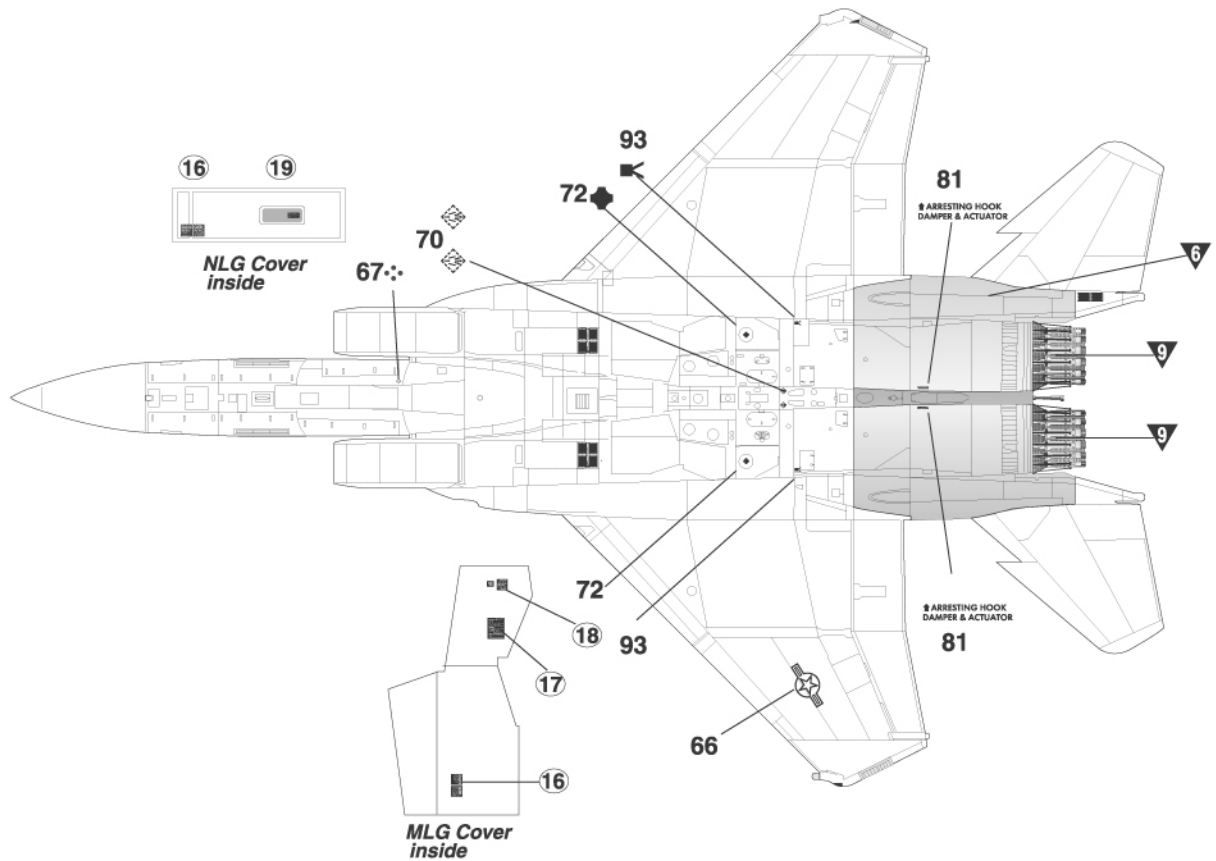
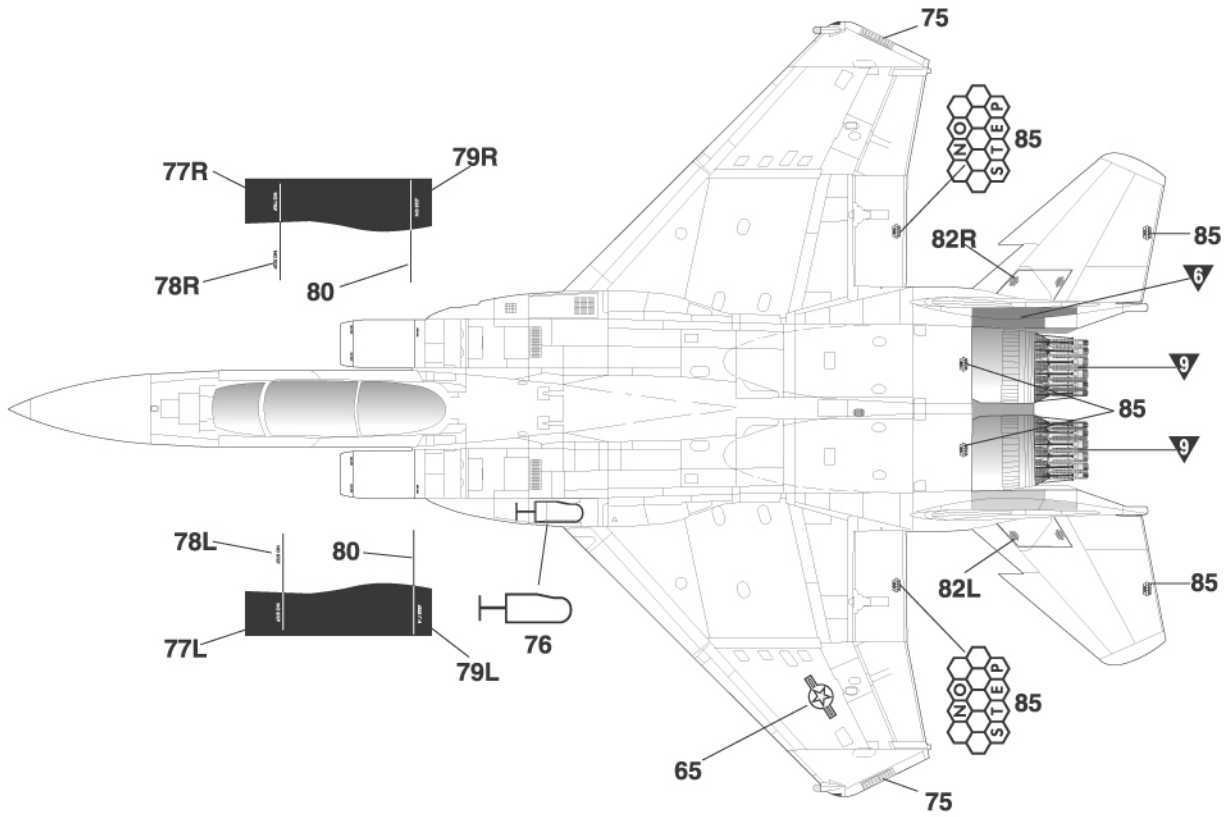

COMMON DATA
공통 기본 데이터

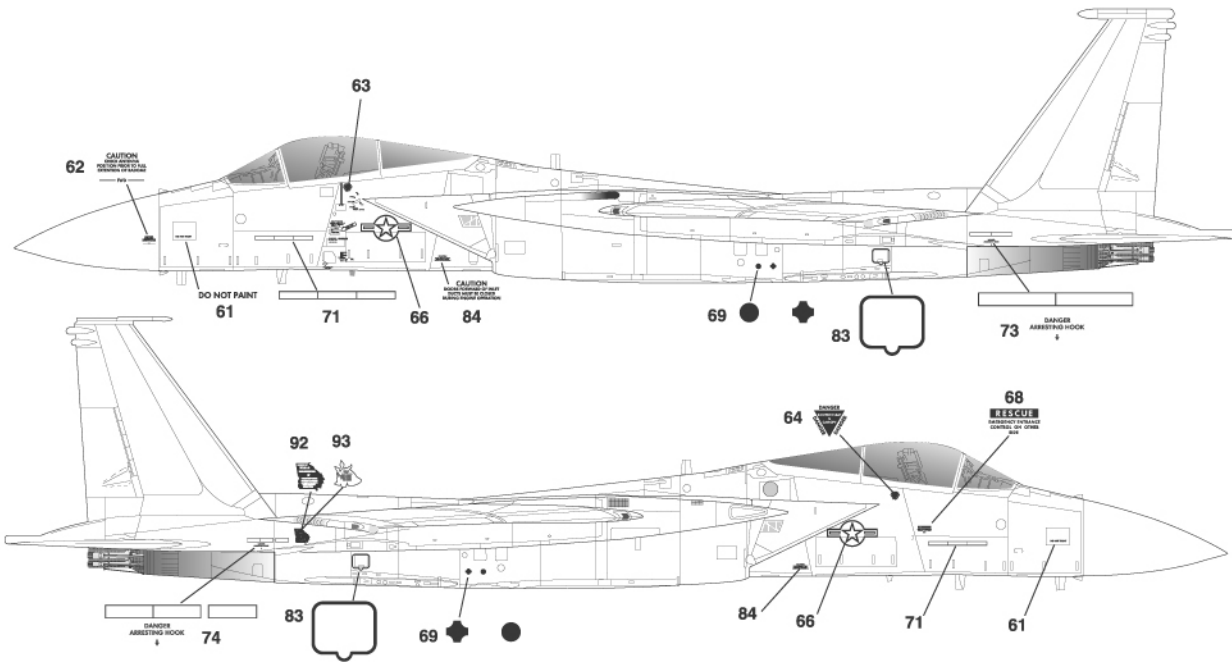

MLG

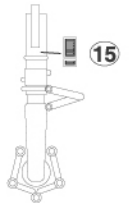

Wing Pylon



LAU-128



610 Gal External Fuel Tank

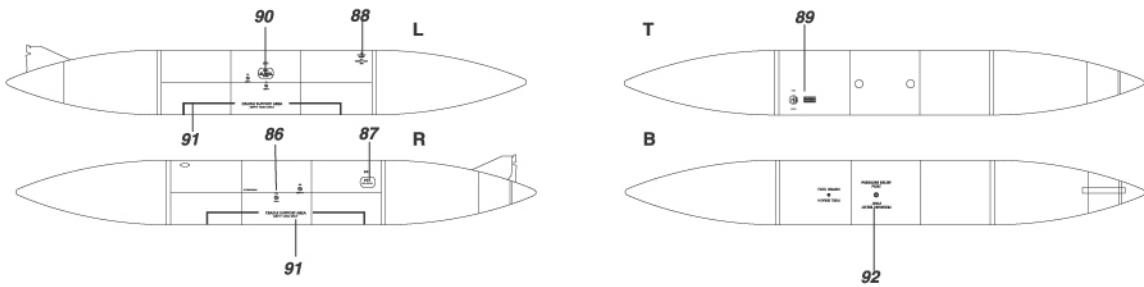

AIM-9X

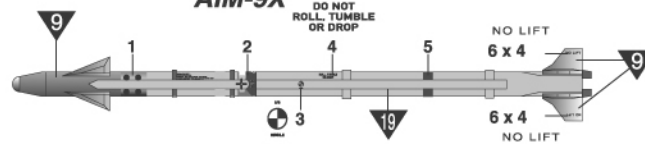

※ () is opposite number.
()는 반대쪽 번호입니다.

AIM-120B

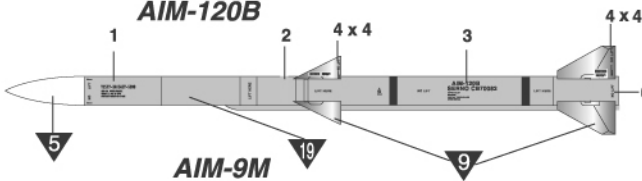

AIM-120C

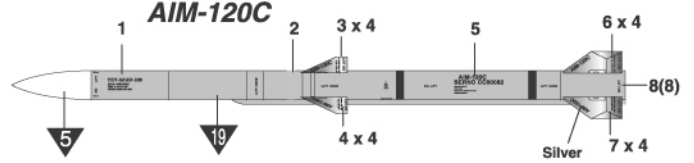

AIM-9M

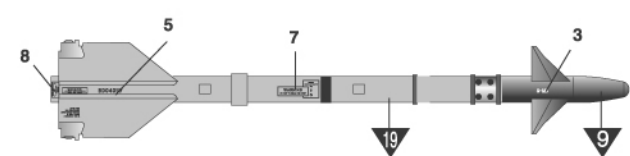
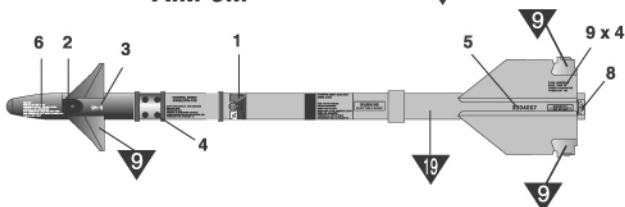

COMMON DATA
공통 기본 데이터

- 1 40014 - 132
- 2 2019 - 3
- 3 01018 - 133
- 4 5201 - 53
- 5 8488 - 43

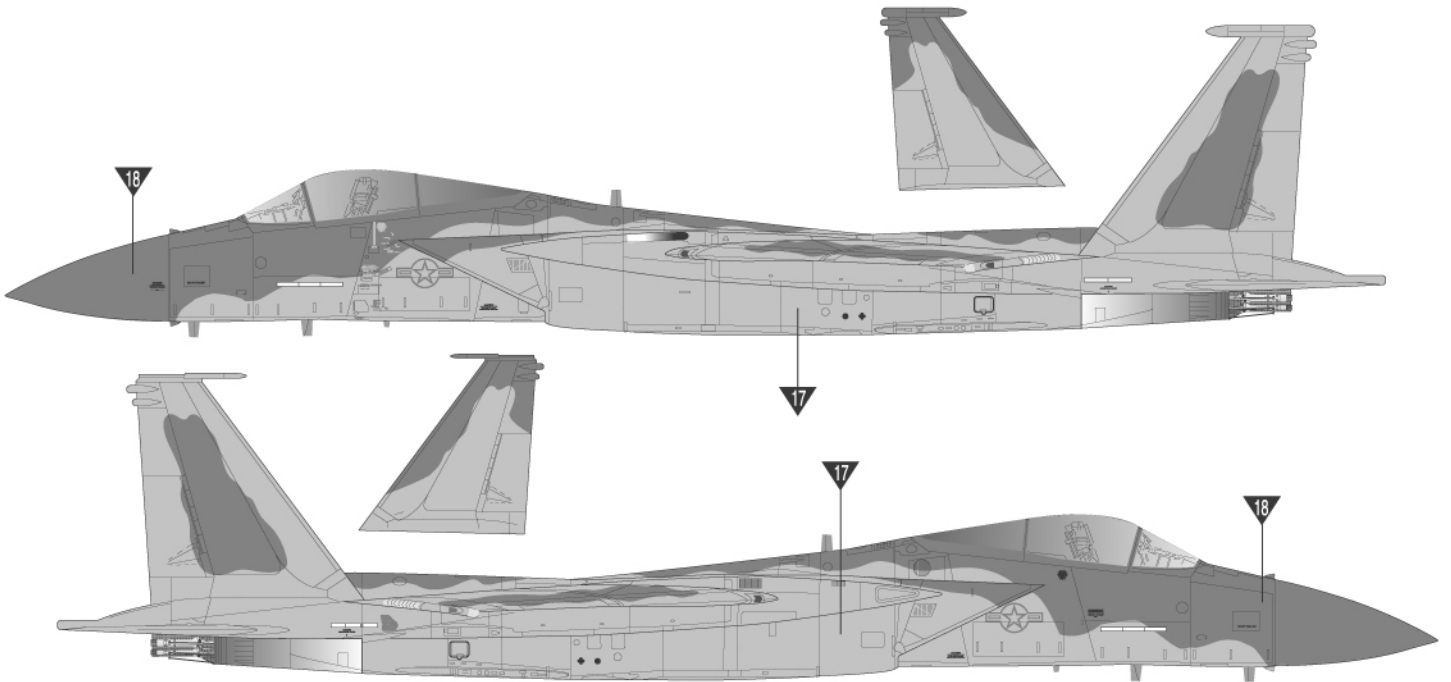
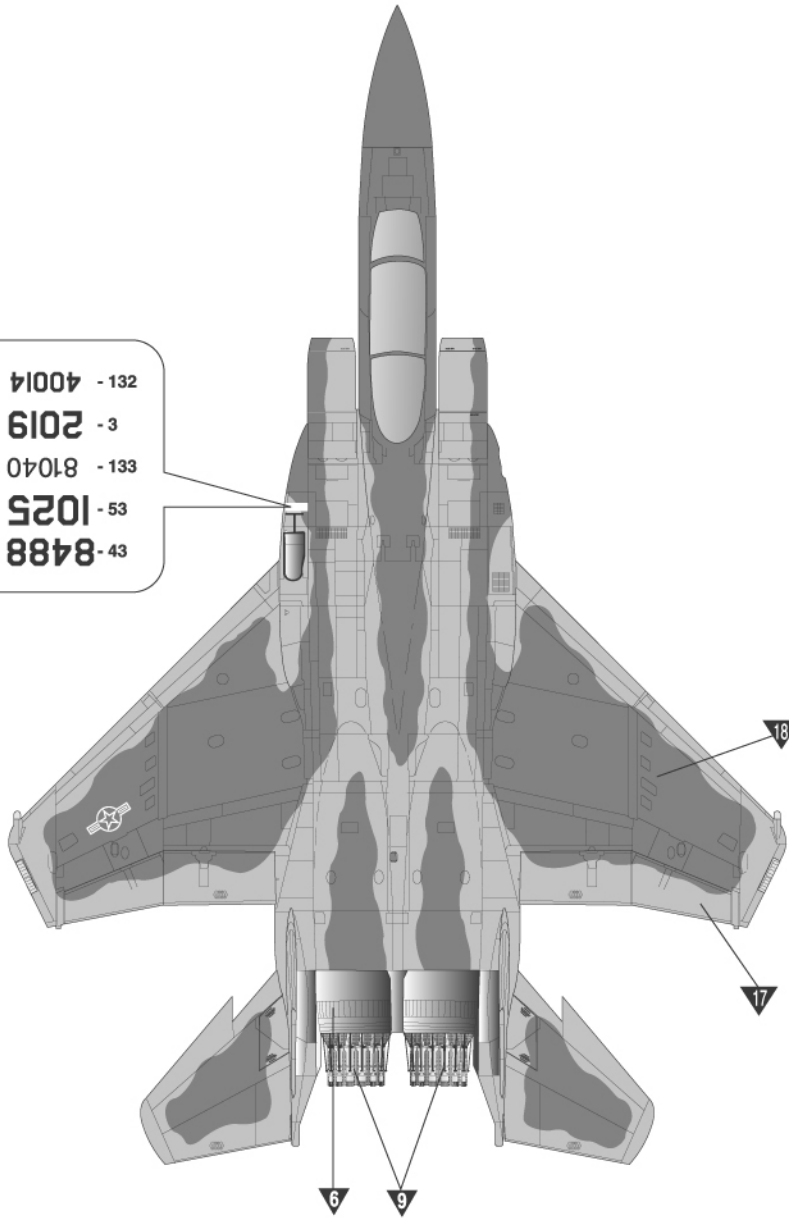

F-15C MSIP II.

The Multi-Stage Improvement Program (MSIP) is a joint program carried out by McDonnell Douglas(now Boeing) and the USAF. MSIP II is that portion of the program which handles the F-15C/D. The major part of MSIP II is to fit the APG-70 radar and the AIM-120 AMRAAM. The ECM equipment was improved, with ALR-56C RWR, ALQ-135B internal ECM system, and enhanced ALQ-128 being introduced.

The first MSIP II aircraft was F-15C 84-001, first flown on June 20, 1985. MSIP II was still underway at the time of the Desert Storm of 1991, and the AIM-120 was not yet ready for combat use. However, MSIP II F-15Cs were quickly despatched to the Gulf, and during the war they achieved an impressive kill ratio against Iraqi aircraft. After the Persian Gulf War, F-15C MSIP II operated in East Europe during Operation Allied Force, Afghanistan in Operation Enduring Freedom, Iraq in Operation Iraqi Freedom.

F-15 MSIP(Multi-Stage Improvement Program)는 미공군의 주력 제공전투기인 F-15의 수명연장과 임무능력향상을 위한 개량 계획으로 1982년 F-15A/B를 개량하는 MSIP I 계획과 뒤이어 F-15C/D를 개량하는 MSIP II로 나뉜다. MSIP I은 비경제적이란 이유로 취소되고 MSIP II만 승인되어 1983년 2월 8억 6천만달러의 예산이 책정됐다가 그해 12월 27억 4천만 달러로 증액되어 실시되었다. 1984년 12월 첫 번째 F-15C(84-0001)의 개량을 시작하여 85년 6월 20일 작업이 끝난 이후 현재까지 400여대의 기체가 개량에 개량을 거듭하고 있다.

주요 개량점은 APG-63 레이더를 개량형인 APG-63(V)1으로 교체하고 이에 따라 AIM-120 암람 공대공 미사일의 운용이 가능하게 되었다. 더불어 직접조준 방식의 신형 헬멧의 도입으로 AIM-9X 수퍼 사이드와인더 미사일의 운용까지 가능하다. 1999년에는 일부 기체가 기존의 기계식 레이더가 아닌 디지털 방식의 APG-63(V)2 AESA 레이더로 개량을 하여 알래스카 엘맨도르프 기지 소속의 제 12, 19비행대에 배치되었다. 디지털 레이더의 개량은 후에 모든 기체에 적용될 예정이다. F-15C MSIP II는 매우 성공적으로 1991년 걸프전쟁과 이후의 유고내전과 이라크 비행금지구역 초계, 2002년 미국의 아프카니스탄 침공과 2003년 제2차 이라크 전쟁까지 미공군에 절대적인 제공권을 안겨준 일등공신이었다. 라이벌 기체인 해군의 F-14 톰캣이 퇴역한 상황이고 최강 전투기인 F-22 랩터가 배치됐지만, 여전히 미공군의 주력으로 활동하고 있고 앞으로도 당분간 주력 전투기로 활약할 예정이다.

1 F-15C-37-MC Eagle 84-0014, 493rd FS, 48th FW, RAF Lakenheath, UK
F-15C-37-MC Eagle 84-0014, 제 1전투 항공단 제 493 전투비행대 영국 레이큰헤스 공군기지

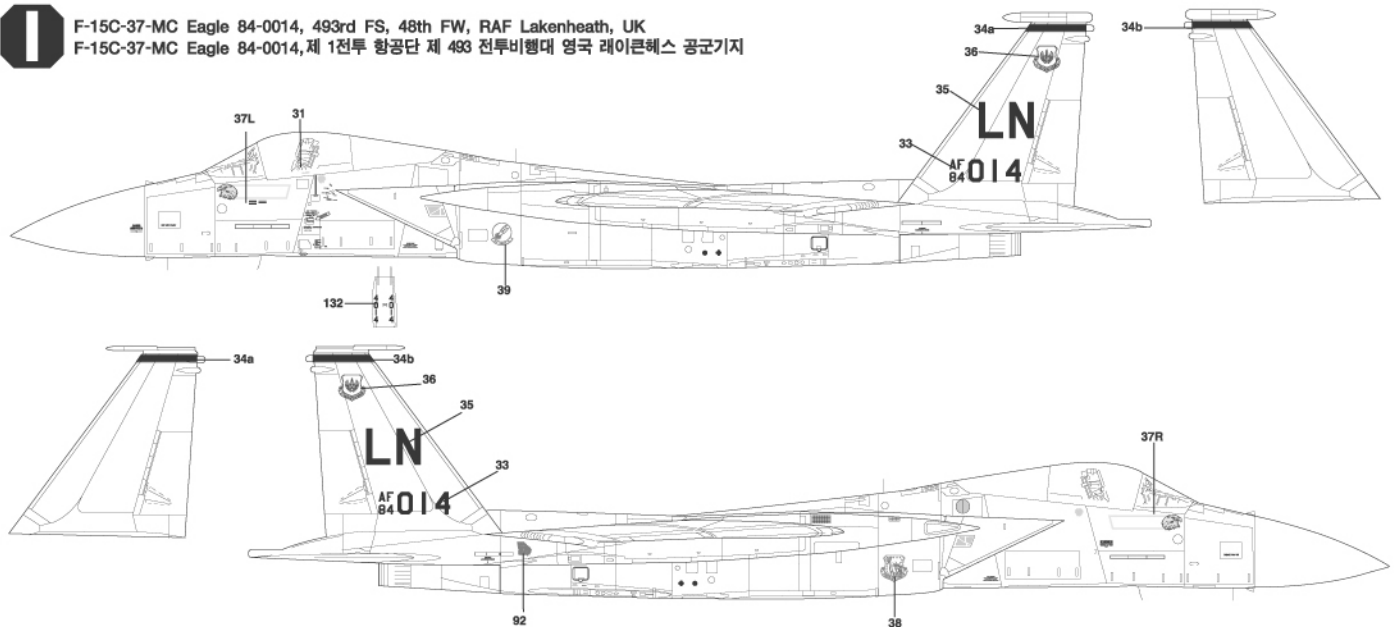

2 F-15C-33-MC Eagle 82-0019, 71st FS, 1th FW, Langley AFB, VA, USA
F-15C-33-MC Eagle 82-0019, 제 1전투 항공단 제 71 전투비행대 미국 버지니아주 랭글리 공군기지

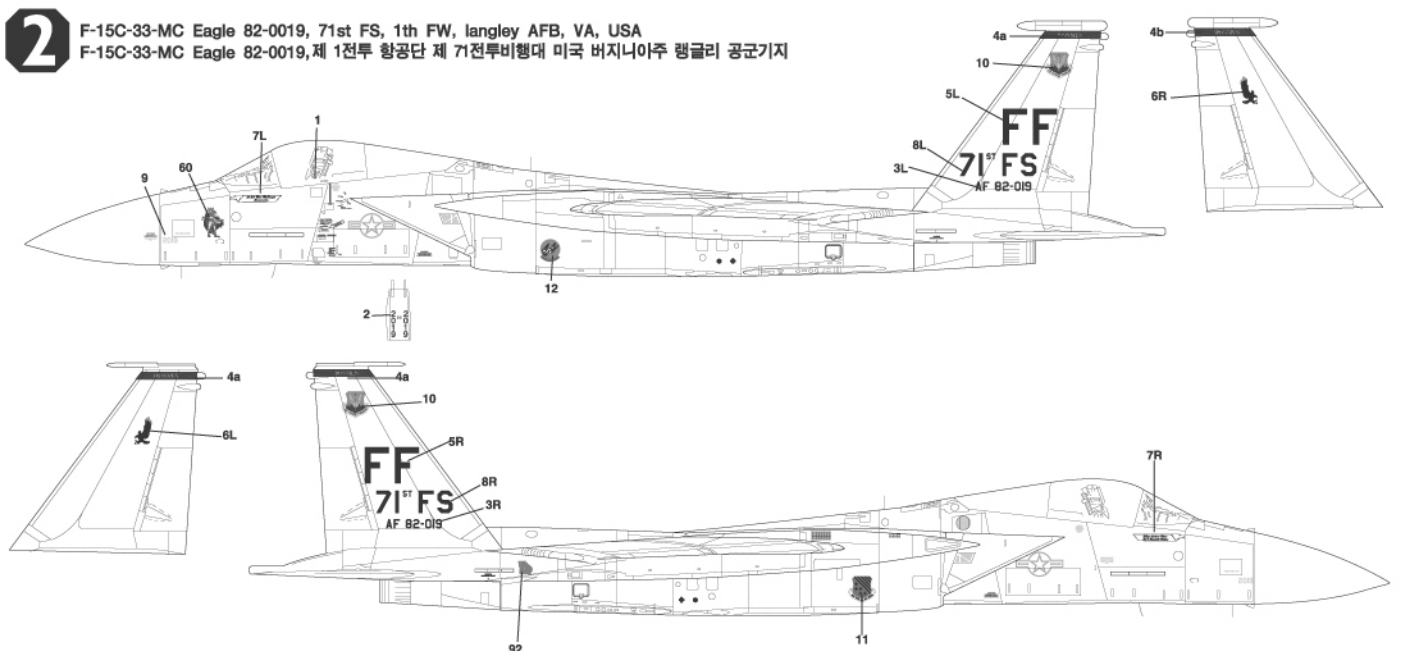

3 F-15C-31-MC Eagle 81-0040, 67th FS, 18th OG, Kanena AB, Okinawa, Japan
 F-15C-33-MC Eagle 81-0040, 제 18 항공작전단 제 67전투비행대 일본 오키나와 가레나 공군기지

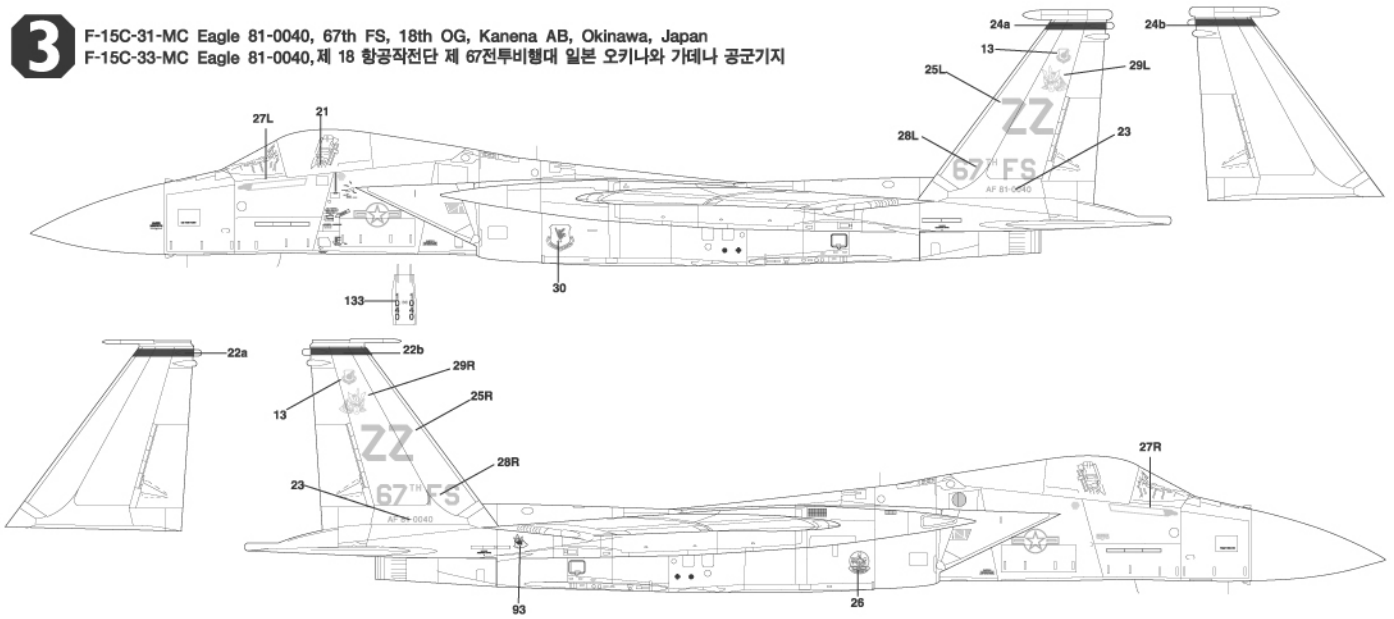

4 F-15C-30-MC Eagle 81-0025, 110th FS, 131st FW, Missouri ANG, Lambert IAP
 F-15C-30-MC Eagle 81-0025, 제 131전투항공단 제 110전투비행대 미조리 주 방위군

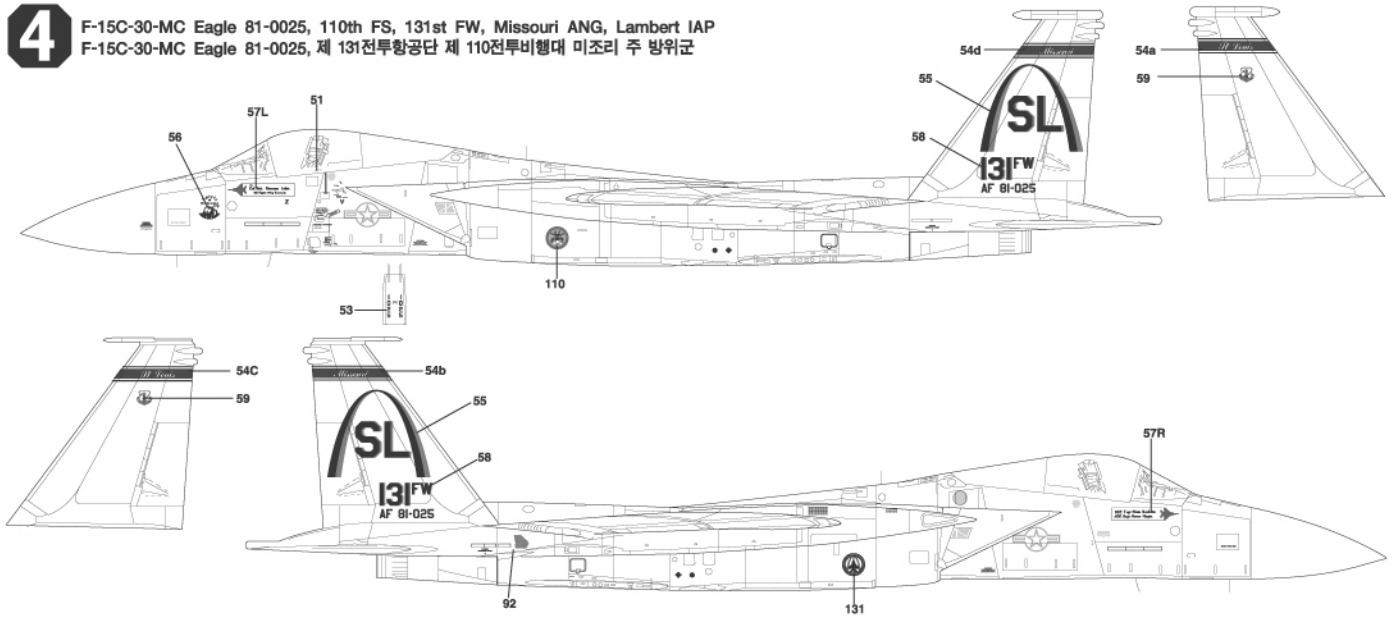

5 F-15C-21-MC Eagle 78-0488, 173rd FW, Oregon ANG, Kingsley Field
 F-15C-21-MC Eagle 78-0488, 제 173전투비행대 오레곤 주 방위군

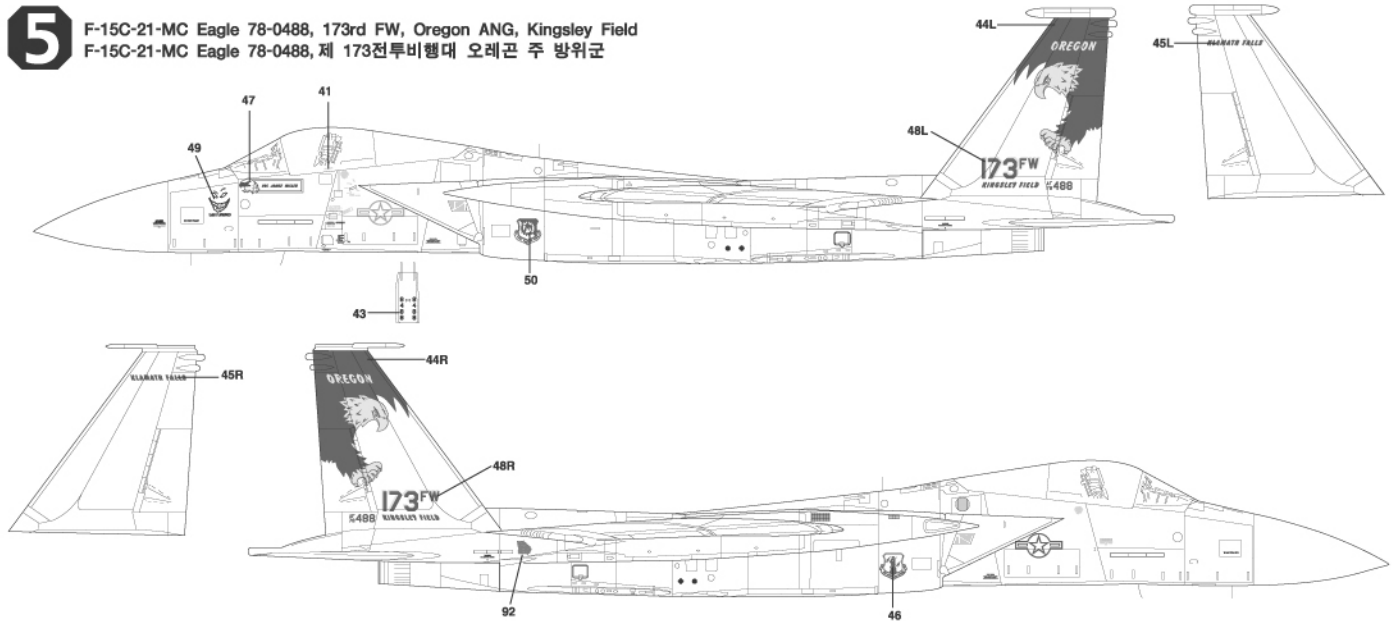

● Necessary tool for etching attachment
에칭 부착에 필요한 도구

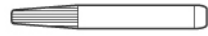

Instant glue(순간접착제)



Knife(커터칼)

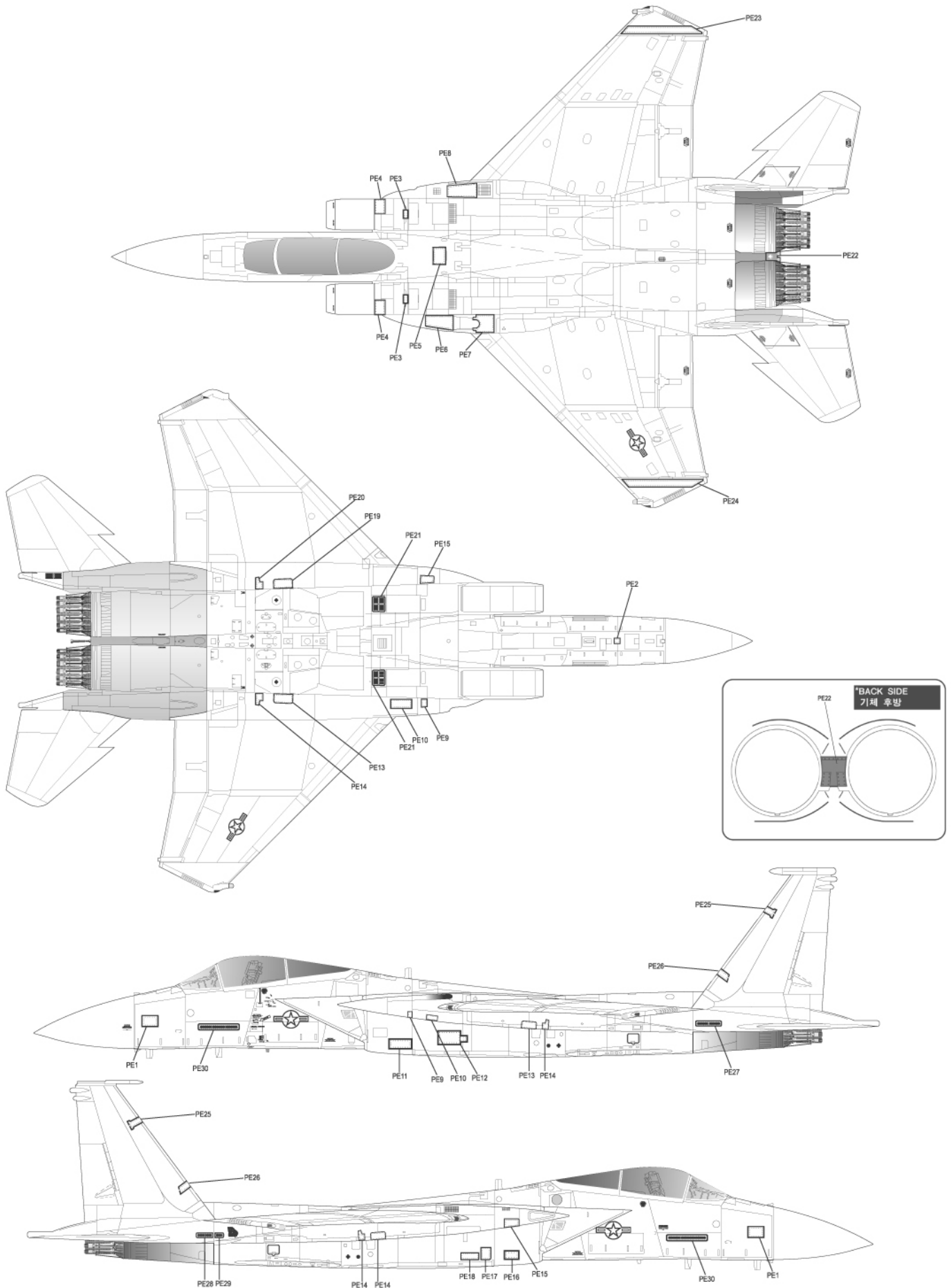

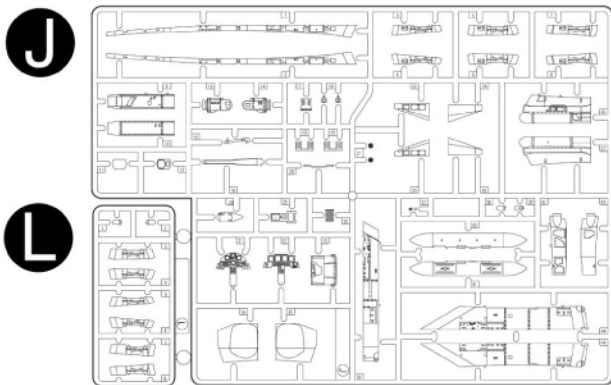
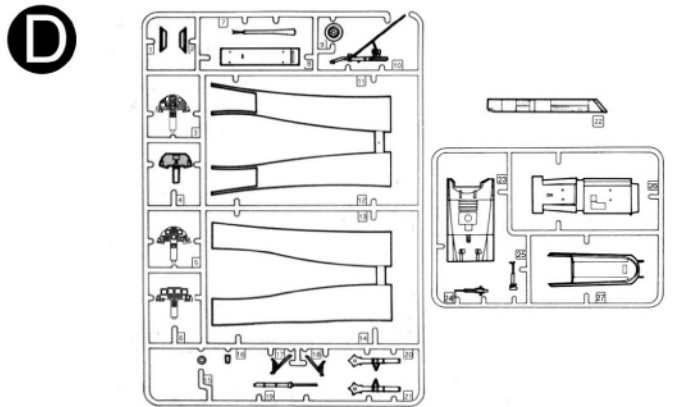
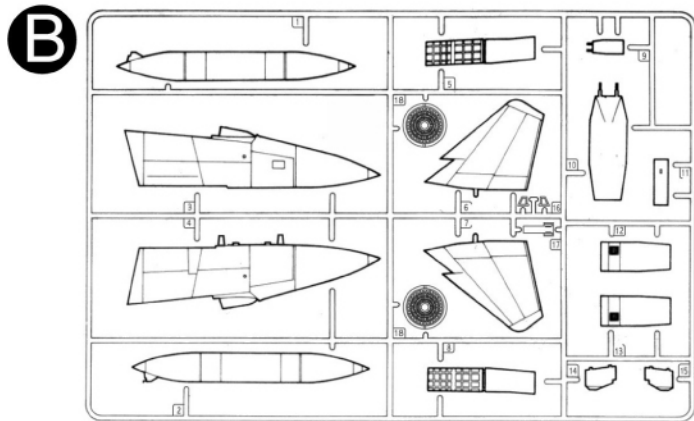
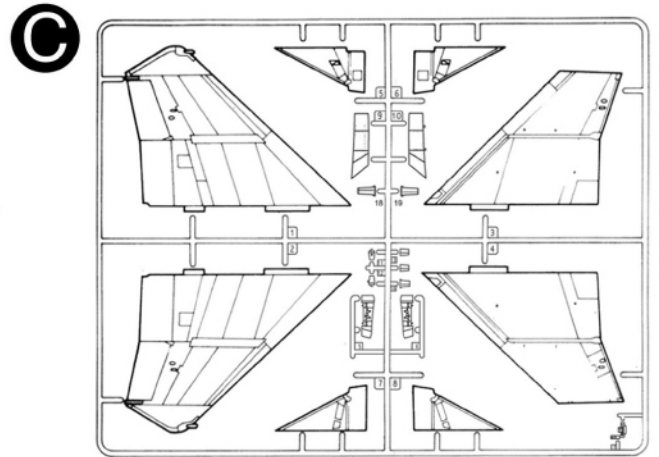
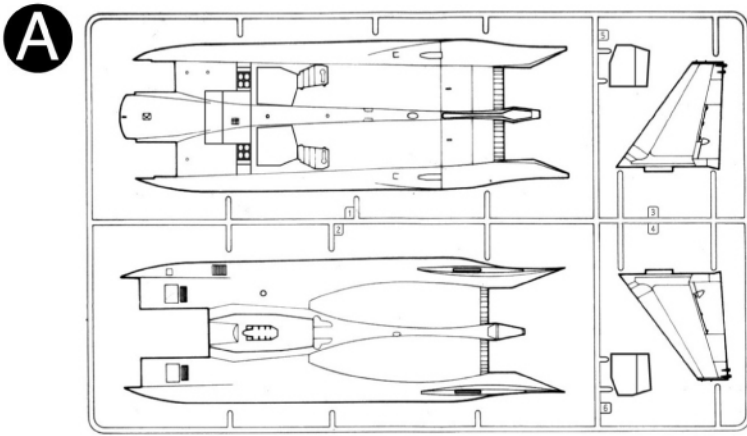

K
X2

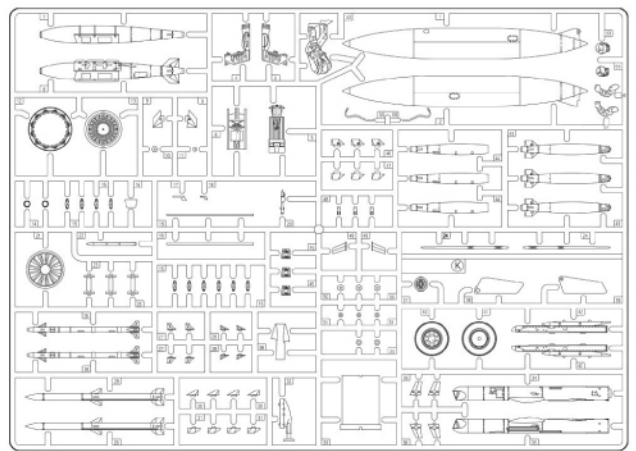

L

G



M

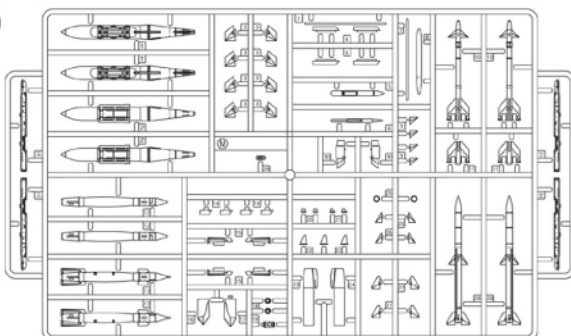

● Decal/전사지

H

● Photo etched/에칭

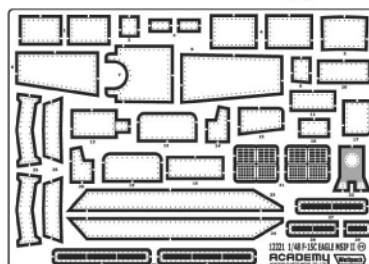
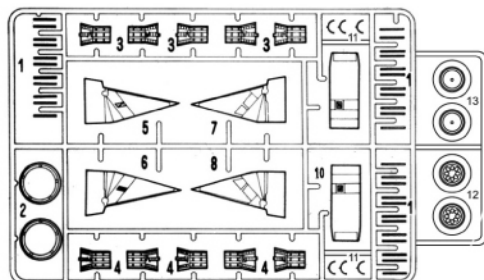

● Unused parts/불필요 부품

B1, B2, B18x2, B19, C9, C10, C12, C15, C16, D4, D5, D6, D7, D16, D22, J1, J2, J3, J4, J5, J6, J7, J8, J9, J10, J11, J12, J13, J14, J18x1, J19x1, J20, J21, J23, J25, J26, J27, J28, J29, J30, J31, J32, J33, J34, J35, J36, J37, J38, J39, J40, J41, J42, J43, L2, L3, L4, L5, L6, L7, L8, K3x1, K4x1, K5x1, K6x1, K7, K8, K9, K10, K11, K12, K13, K15x16, K16x1, K20x1, K22, K23, K32, K34, K35, K36, K37, K38, K39, K40, K41, K43, K44, K45, K46, K47, K48, K50, K51, K52, K53x1, K54x1, K55x1, K56x1, K57x1, M1, M2, M3, M4, M8, M12, M13, M14, M15, M16, M17, M18, M19, M23, M24, M30, M31

ACADEMY
HOBBY MODEL KITS

ACADEMY
ACADEMY PLASTIC MODEL CO., LTD.
521-1, Yonghyeon-dong, Uijeongbu-si, Gyeonggi-do, Korea
고객상담번호: 080-969-7000