



**VERLINDEN
PRODUCTIONS**

CE **MADE IN BELGIUM**
AGE 14 AND UP/ ET PLUS

MIG 29 "FULCRUM" Update Set

**1:48
766**

RESIN PARTS

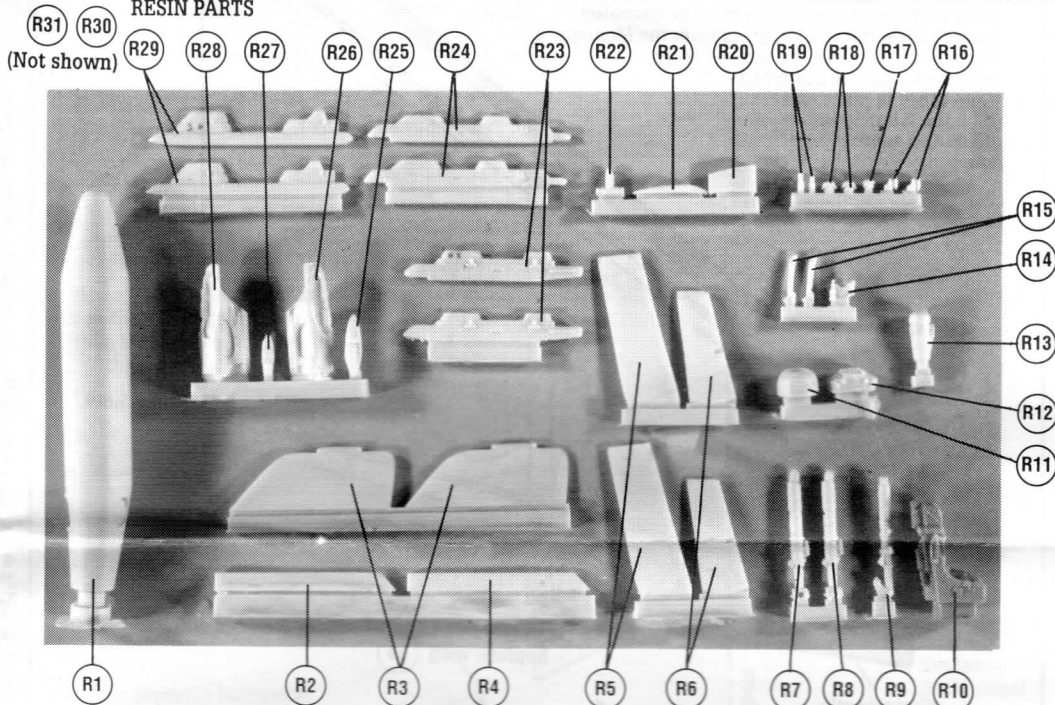
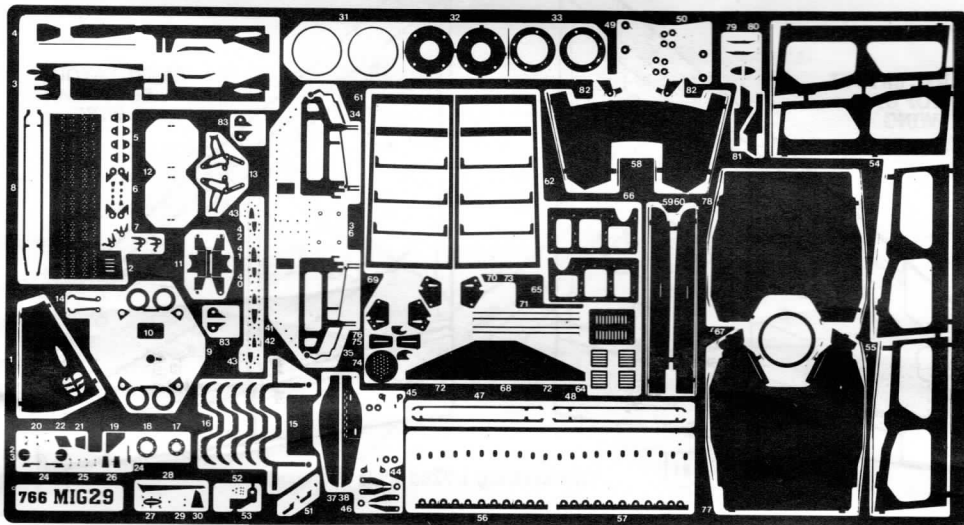

PHOTO-ETCHED PARTS



I

One of the major mistakes of the Monogram kit is the too large wingspan and oversize external fuel tank.

To correct the wingspan, two wingtips, flaps and ailerons are included and some sawing, sanding and rescribing of panels needs to be executed.

First remove the shaded areas from the Monogram wing as shown. File the trailing edge to receive flaps and ailerons.

Glue these in place, then glue the wingtip in place and sand smooth.

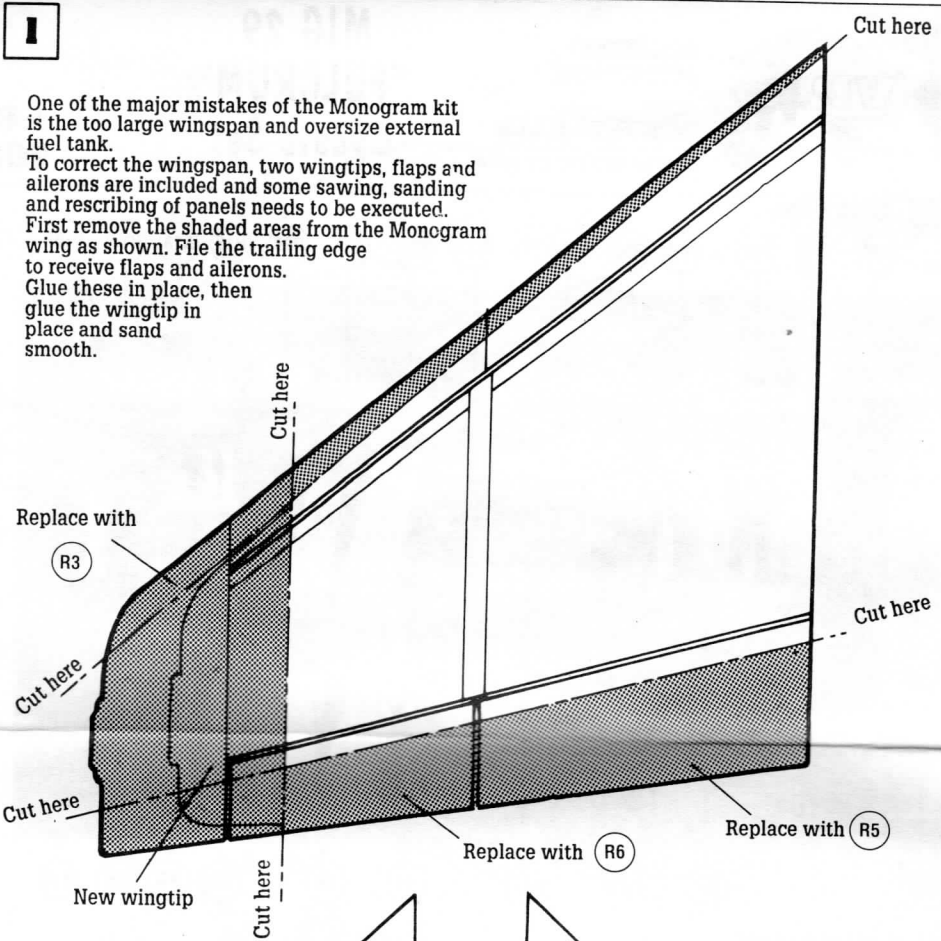

PANEL LAYOUT
TOP OF
WING

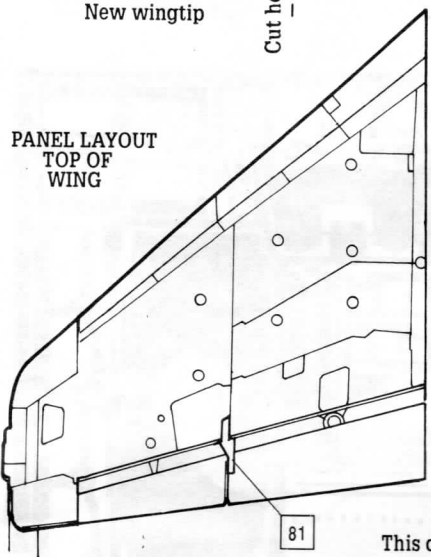

PANEL LAYOUT
BOTTOM OF
WING

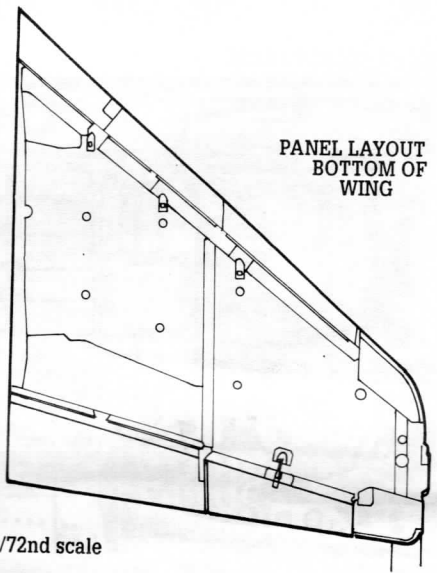

81

This drawing 1/72nd scale

2

Remove shaded area (1,5mm on left side wheel well (see NOTE)

Remove kit part

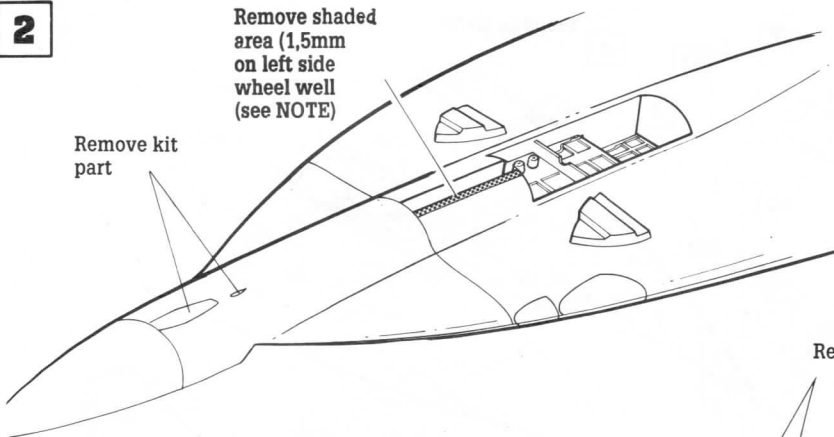

NOTE
Monogram's nose actuator is on the aircraft's centerline while the actual aircraft has the actuator on the right side of the nose gear strut.

Remove kit airbrake (lower half)

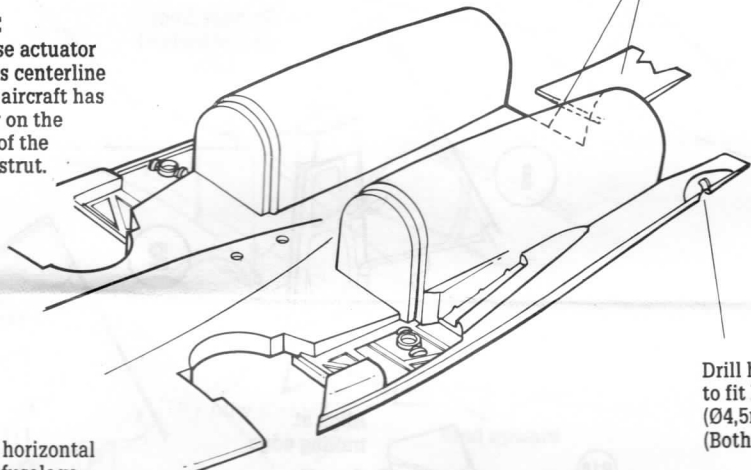

Drill hole to fit R18 (Ø4,5mm) (Both sides)

Separate horizontal tail from fuselage

Remove kit airbrake (upper half)

Separate horizontal tail from fuselage

Remove bulge

Remove bulge

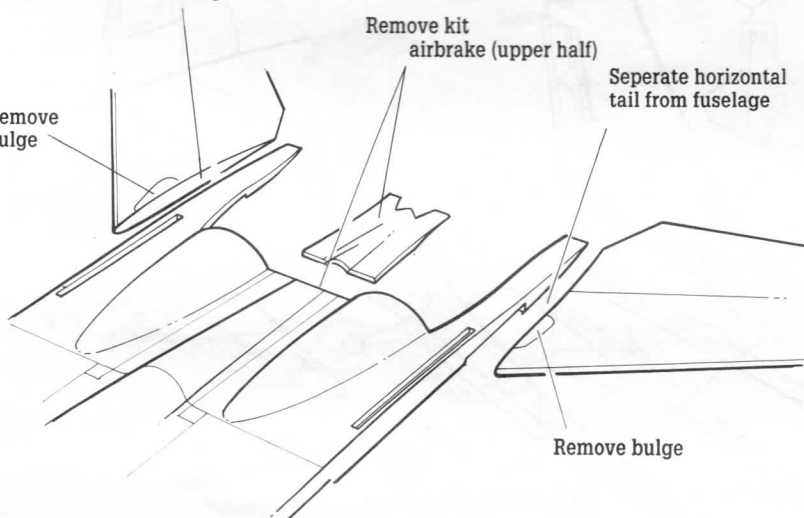

3

Shape as shown

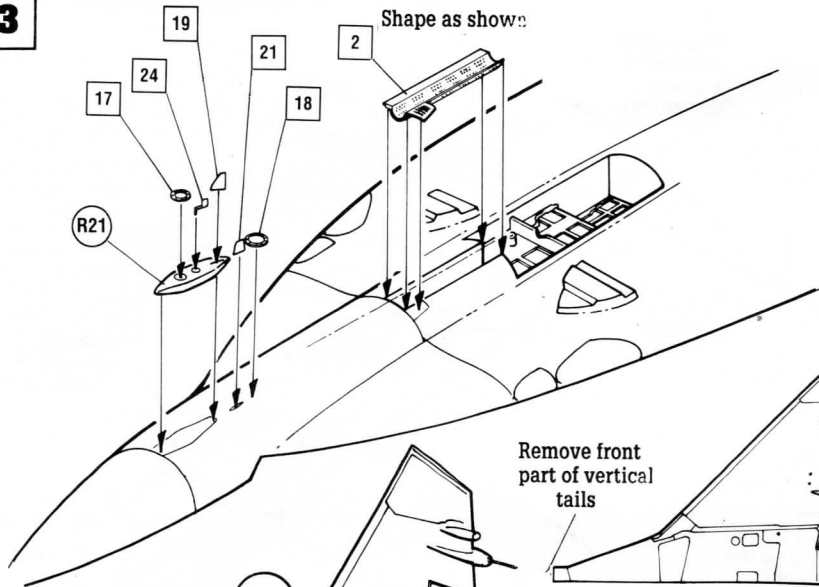

1

Remove front part of vertical tails

Align here

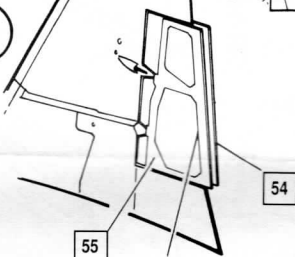

2

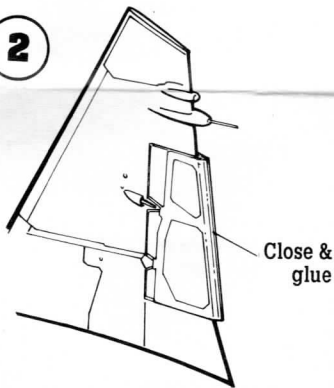

Align at trailing edge

Close & glue

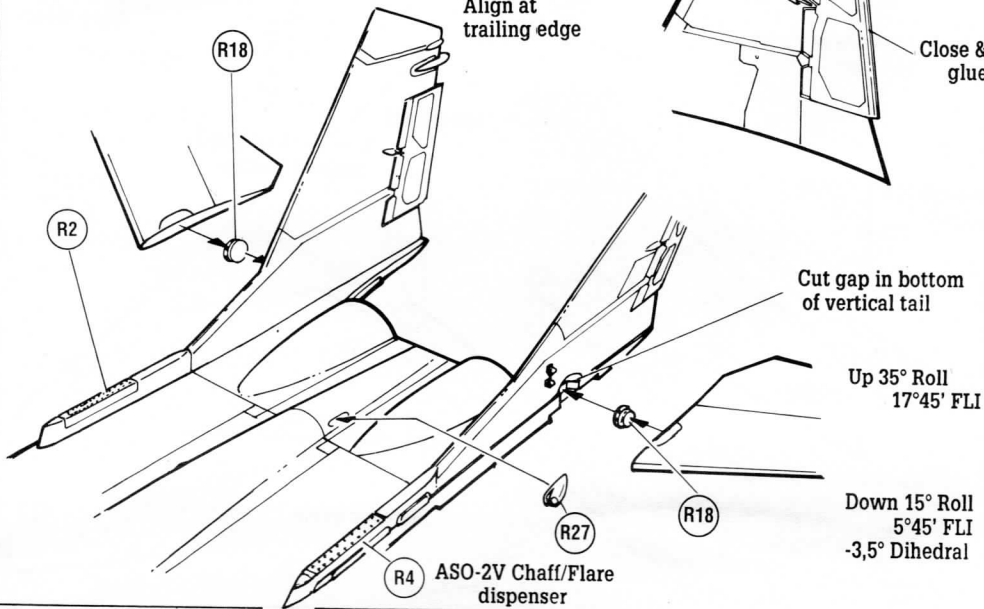

Cut gap in bottom of vertical tail

Up 35° Roll
17°45' FLI

Down 15° Roll
5°45' FLI
-3,5° Dihedral

R4 ASO-2V Chaff/Flare dispenser

4

Glue here

78

Glue here only

R13

R15

77

CAUTION
Shape parts 77 & 78
around R13 when Glued
in place on kit fuselage

79

Close &
Glue

Bend upward

Close &
Glue

57

58

76

75

30

29

17mm

**BOTTOM
FUSELAGE**

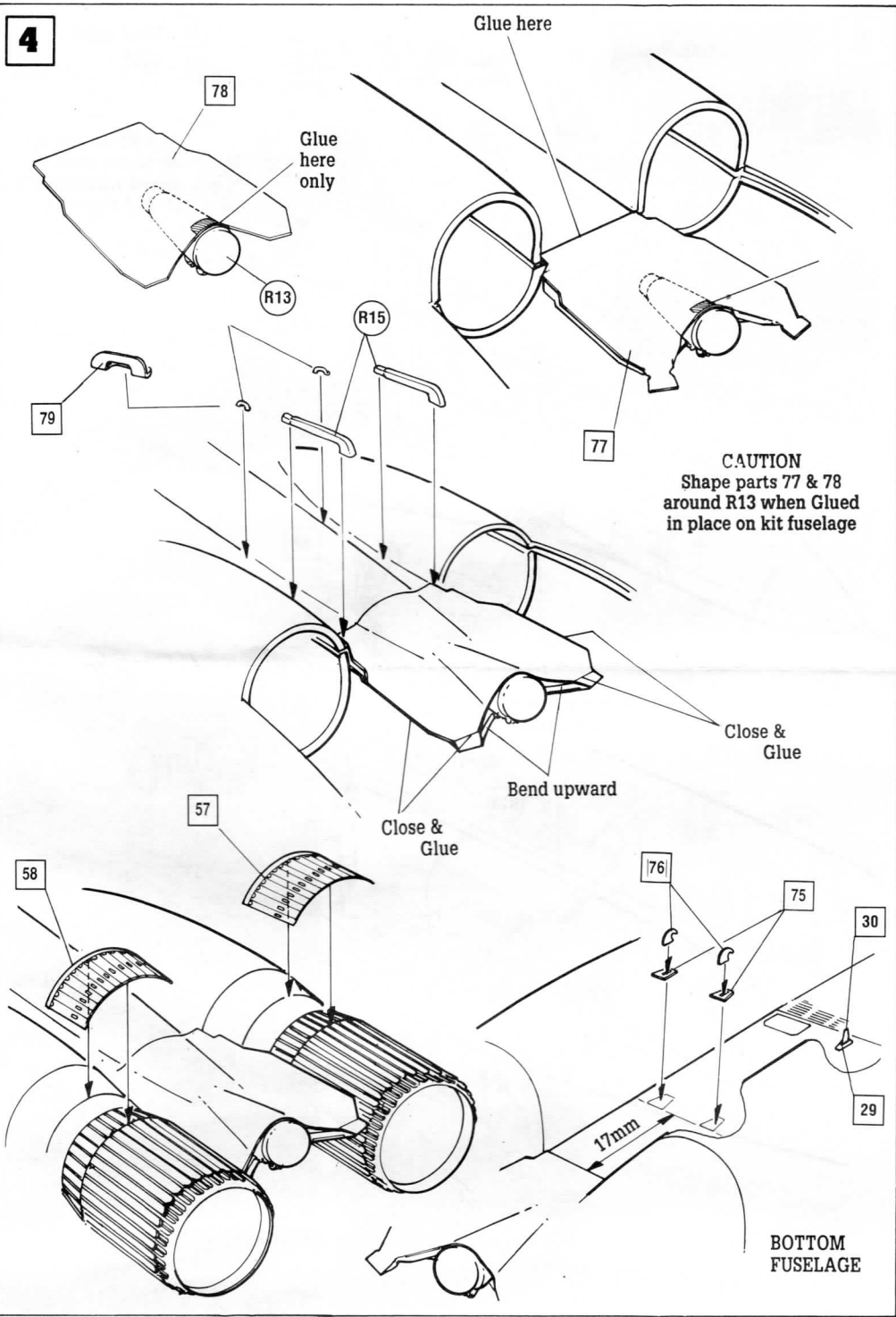

5

SEAT
Black with
grey webbing

Light Grey
Black buttons

61 (Right side)

62 65 (Right side)

66

61 & 62 are auxiliary
air intake panels,
closed when aircraft
is on the ground

R10

R12

R25

Remove
kit part

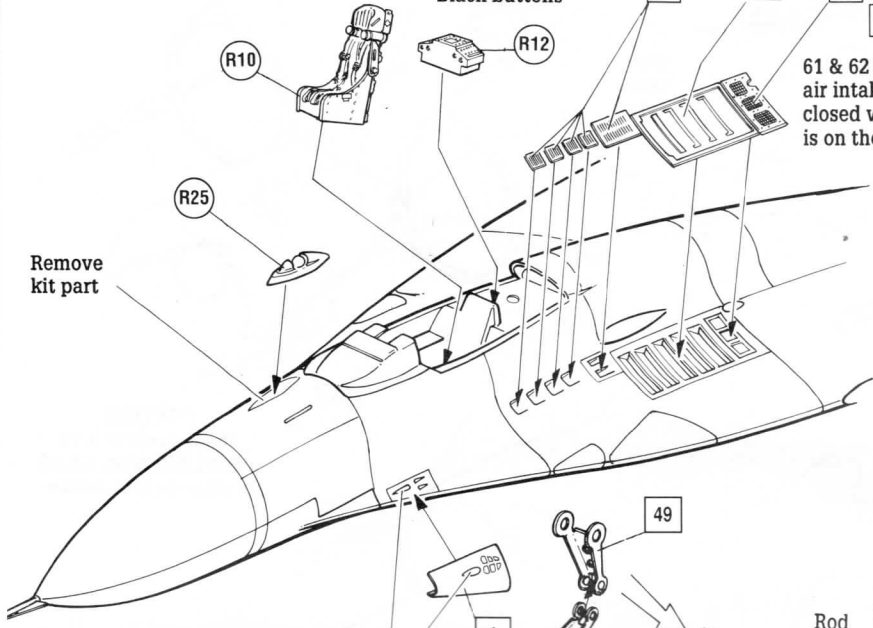

Align gun ports
Shape on kit

1

49

50

(Left) R8

R19

Rod Kit part

33

47

32

48

31



R30

Shape as shown

35

34 (Left)

38 (Left)

Curve
upward

R26

R28

(Left)

52

53 (Left)

Glue kit part 54 here

Copper wire

46

45

44 (Left)



6

5 7 Make 2 for right side
Make 2 for left side

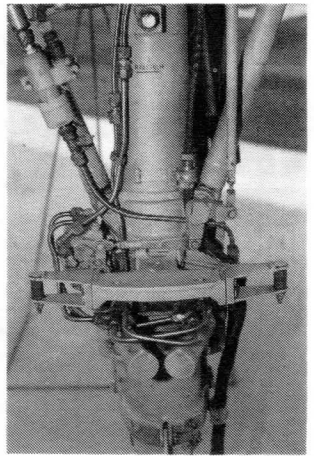
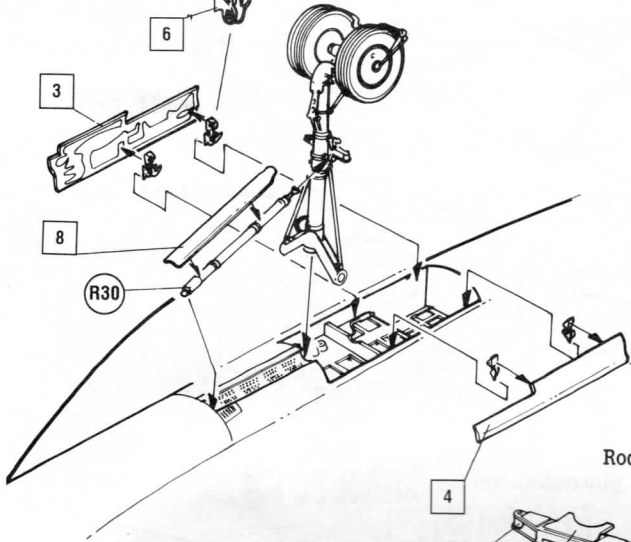

NOTE
Shape 3 and 4 to
curve of bottom
fuselage

