

MILITARY MINIATURES SERIES

# T-55A

EARLY MOD. 1965

37057



## GENERAL INSTRUCTION

- HIGHLY DETAILED MODEL
- WORKABLE TORSION BARS
- ALL HATCHES CAN BE POSED OPEN
- TOTAL DETAILS 898
- 727 PLASTIC PARTS
- 145 PHOTOETCHED PARTS
- 26 CLEAR PLASTIC PARTS
- DECAL SHEET FOR 9 VARIANTS



MiniART : 37057

Romanian Army, 90's.  
Румынская армия, 90-е годы.

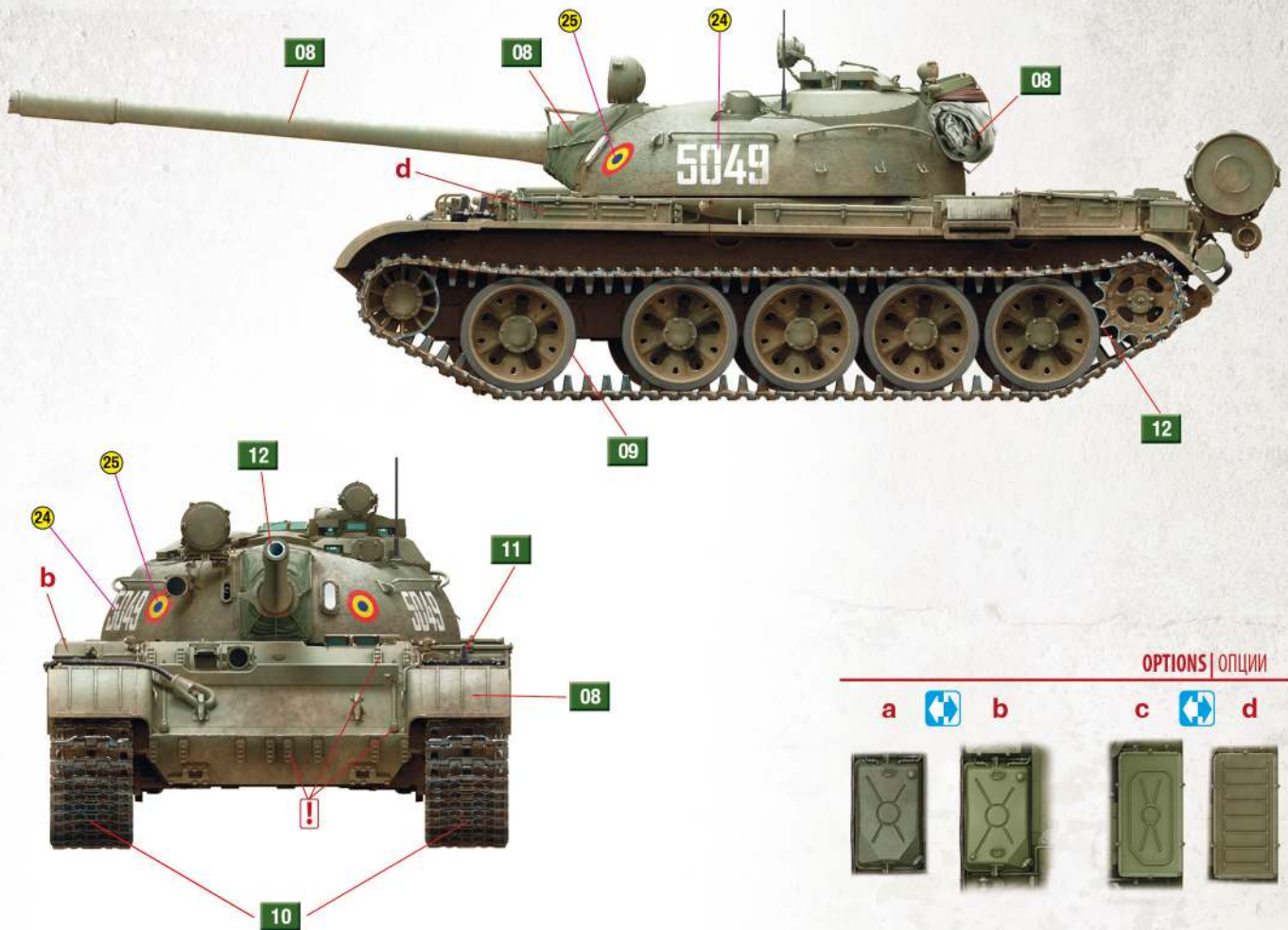

OPTIONS | ОПЦИИ

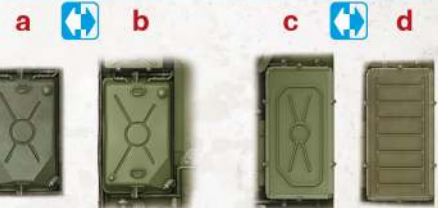

## Colors chart

## Таблица цветов

№	COLOR / ЦВЕТ	Vallejo	Humbrol	Mr. Color	TESTORS	AMMO MIG	Название цвета	Color name
01		017	150	136	4807	A.MIG-083	Русский зеленый XB518	Russian Green XB518
02		984	160	109	1540	A.MIG-020	Темно-коричневый	Dark Brown
03		934	1321	047	1529	A.MIG-093	Красный-полупрозрачный	Crystal Red
04		951	34	001	1768	A.MIG-024	Белый	White
05		886	225	127	1715	A.MIG-058	Светло-зеленый хаки	Light Green Khaki
06		818	100	131	1736	A.MIG-912	Красно-коричневый	Red Brown
07		913	84	043	1735	A.MIG-036	Дерево	Wood
08		920	125	128	1723	A.MIG-077	Серо-зеленый	Grey Green
09		830	111	037	1741	A.MIG-033	Серый	Grey
10		995	32	137	1750	A.MIG-035	Темно-серый	Dark Grey
11		950	33	002	1749	A.MIG-046	Черный	Black
12		864	11	SM04	1415	A.MIG-191	Сталь	Steel
13		863	53	028	1405	A.MIG-045	Вороненый металл	Gun Metal
14		801	54	SM02	1782	A.MIG-197	Латунь	Brass
15		010	153	003	1150	A.MIG-049	Красный	Red
16		971	79	115	4788	A.MIG-210	Серо-голубой	Grey Blue
17		062	56	218	1401	A.MIG-194	Алюминий	Aluminum
18		850	60	006	1764	A.MIG-023	Защитный зеленый	Protective Green
19		977	94	044	1742	A.MIG-021	Темно-желтый 7К	Dark Yellow 7k
20		890	86	038	1591	A.MIG-002	Оливково-зеленый	Olive Green

**ATTENTION**

Ne pas utiliser de colle ou de peinture à proximité d'une flamme nue, et aérer la pièce de temps en temps.  
 Pour retirer les pièces hors du cadre, utiliser des ciseaux spéciaux pour maquette le plastique en excès avec un cutter ou une lime.  
 Voir la fin de cette colonne pour la signification des symboles

**ZUR BEACHTUNG**

Kleber und Farbe nicht nahe von offenem Feuer verwenden und das Fenster von Zeit zu Zeit zur Belüftung öffnen.  
 Zum Abschneiden der Teile vom Verbundstück eine Modellerschere verwenden und die überstehenden Plastikteile mit einem Messer oder einer Feile beseitigen.  
 Die Bedeutung der Symbole finden Sie unten in dieser

**УВАГА**

Під час використання клею та фарби, всі роботи проводити у провітрюваному приміщенні по далі від джерела вогню.  
 Деталі відкремлювати від литників ножом або іншим ріжучим інструментом.  
 Зачистити облію і місця зрізу за допомогою надфіля та наждакового паперу.  
 Складання моделей проводити згідно схеми складання. Для зручності складання кожна деталь відзначена номером.

**ATTENZIONE**

Non usare colla e vernice vicino a fiamme esposte, e aprire le finestre di tanto in tanto per cambiare l'aria.  
 Quando si staccano parti del carrello, usare forbici da modellismo e eliminare la plastica in eccesso con un coltello o una lima.  
 Vedere in fondo a questa colonna per il signifi

**ВНИМАНИЕ**

При использовании клея и красок, все работы производить в проветриваемом помещении вдали от источников огня.  
 Детали отделять от литников ножом или другим режущим инструментом.  
 Зачистить облой и места среза при помощи надфиля и наждачной бумаги.  
 Сборку моделей производить согласно схемы сборки. Для удобства сборки каждая деталь обозначена номером.

**CAUTION**

When you use glue or paint, do not use near open flame, and use in well ventilated room.  
 When you take parts off from the runner frame, use a modeling scissors and trim excess plastic with a cutter or a file.  
 See the bottom of this column for the meaning of symbols.

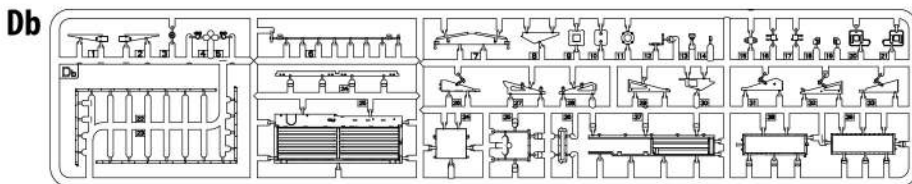
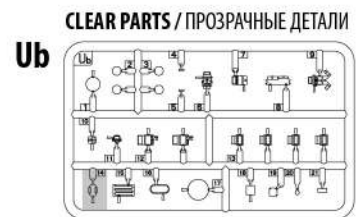
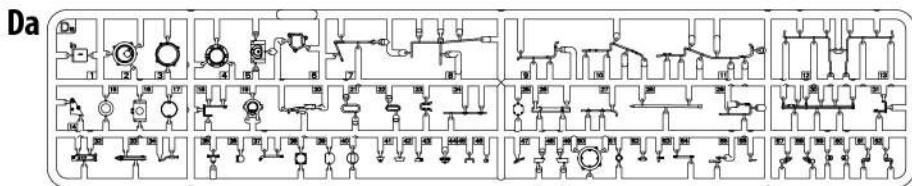
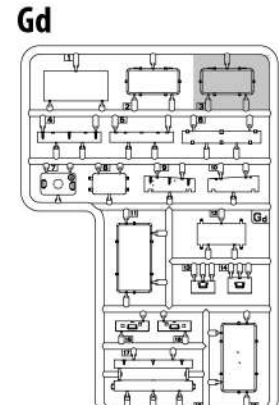
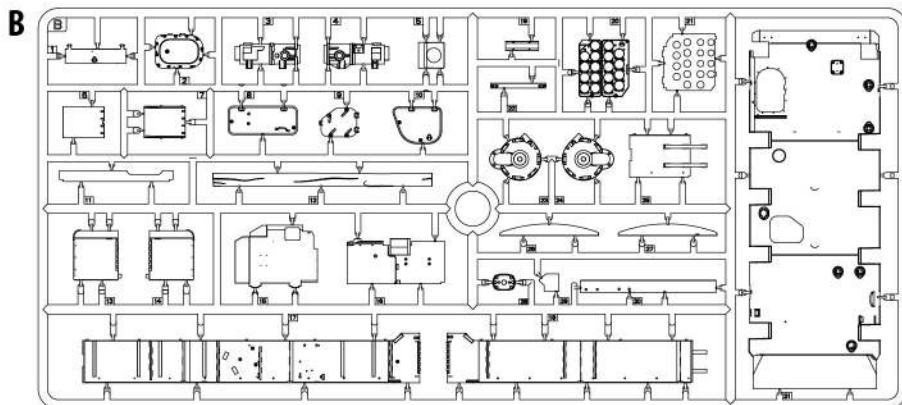
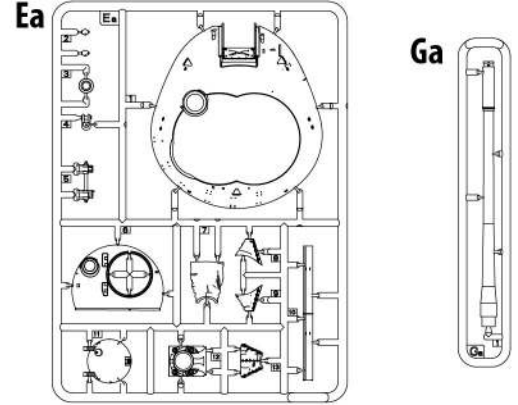
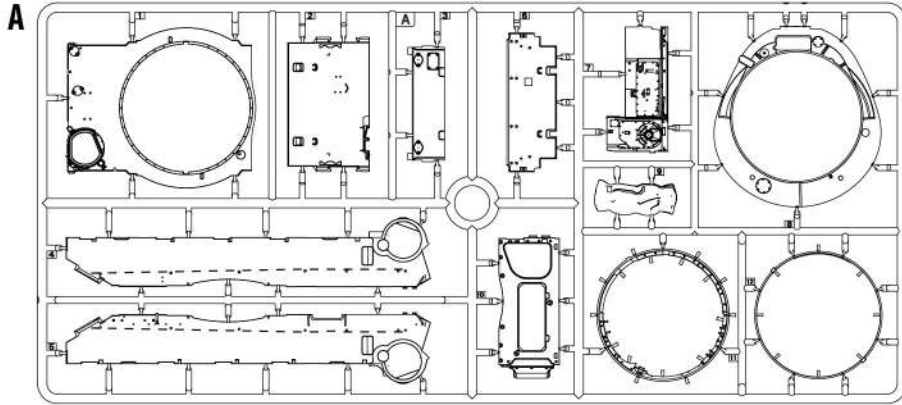
**PARTS/ДЕТАЛИ**

**Photo-etched parts**  
 Детали фототравления  
**PEa (M-48)**

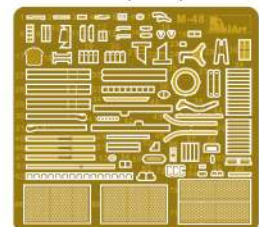

**Decals sheets | Деколи**



**x2**

MAKE 2PCS  
2 TEILE FERTIGEN  
EFFECTUER 2 PIECES  
FARE DUE PEZZI  
TEE 2 KPL  
GÖR 2 ST  
ПОВТОРИТЬ ДВА РАЗА  
КІЛЬКІСТЬ РАЗІВ



DO NOT CEMENT  
NICHT KLEBEN  
NE PAS COLLER  
NON INCOLLARE  
EILIMÄÄ  
LIMMAEJ  
НЕ ИСПОЛЬЗОВАТЬ КЛЕИ  
НЕ КЛЕЙТИ



OPTIONAL  
NACH BELIEBEN  
FACULTATIF  
FACOLTATIVO  
VALINNANVARAINEN  
VALBAR  
ВАРИАНТЫ  
ВАРІАНТИ



OPEN HOLE  
OFFNEN  
FAIRE UN TROU  
FORO APERTO  
AVAA REIKÄ  
OPPIA HALET  
СДЕЛАТЬ ОТВЕРСТИЕ  
ЗРОБИТИ ОТВІР



REMOVE  
ENTFERNEN  
RETIRER  
SEPARARE  
POISTA  
AVLAGSNA  
ОТРЕЗАТЬ  
ВІДРІЗАТИ



BEND  
BITTE BIEGEN  
PLIER S'IL VOUS PLAÎT  
PIEGARE  
TAIJA  
BOCKA  
ВЫГНУТЬ  
ВИГНУТИ



SCRATCHBUILD  
AM MEISTEN ZU MACHEN  
FAIRE LE PLUS  
RENDITI  
TEE ITSE  
GÖR DIG SJÄLV  
СДЕЛАТЬ САМОМУ  
ЗРОБИТИ САМОМУ

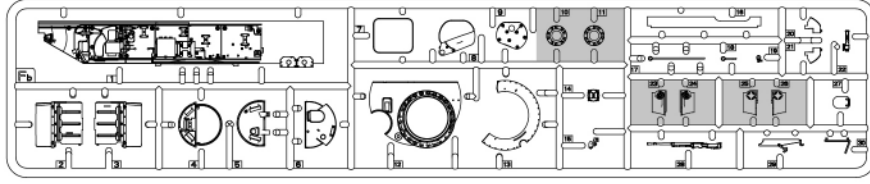
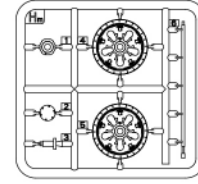
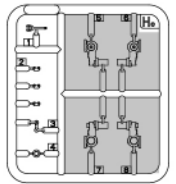
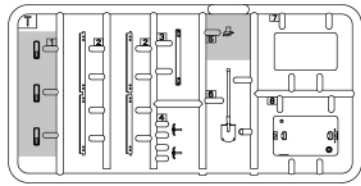
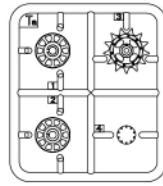
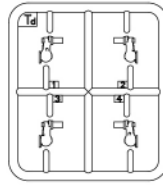
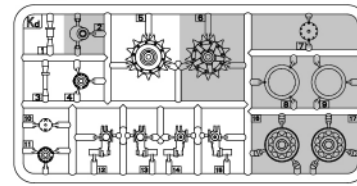
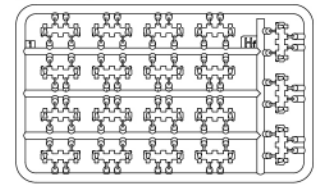
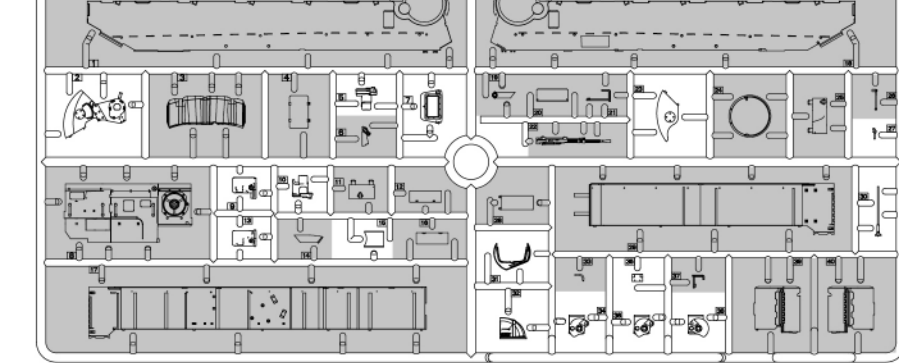
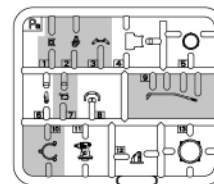
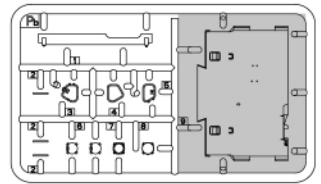
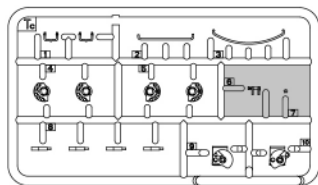
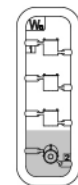
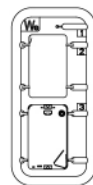
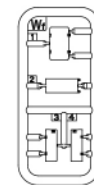
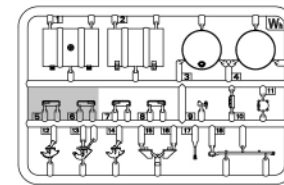
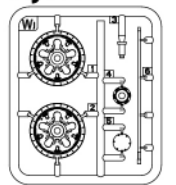
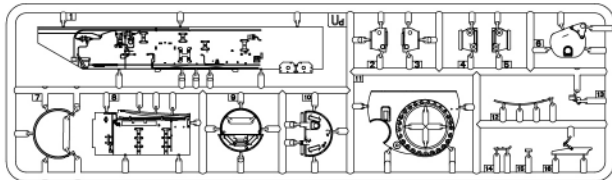
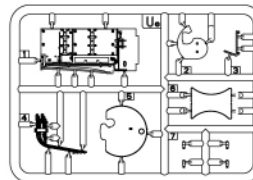
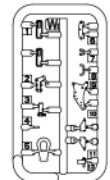

PARTS NOT FOR USE  
TEILE WERDEN NICHT VERWENDET  
NEST PAS UTILISÉ  
PARTI NON PER L'USO  
OSIA EI KÄYTTÄ  
INTE FÖR ANVÄNDNING  
НЕ ИСПОЛЬЗУЕТСЯ  
НЕ ВИКОРИСТОВУЄТЬСЯ

**PARTS/ДЕТАЛИ****Fb****Hd x4****Hm x8****Ho x4****Tx3****Ta x2****Td x3****Kd x2****Hf x10****S****Pa****Pb****Tcx3****Wa x2****We x3****Wf x2****Wh x2****Wj x2****Ud****Ue****Wk x2****Wi x4**

1

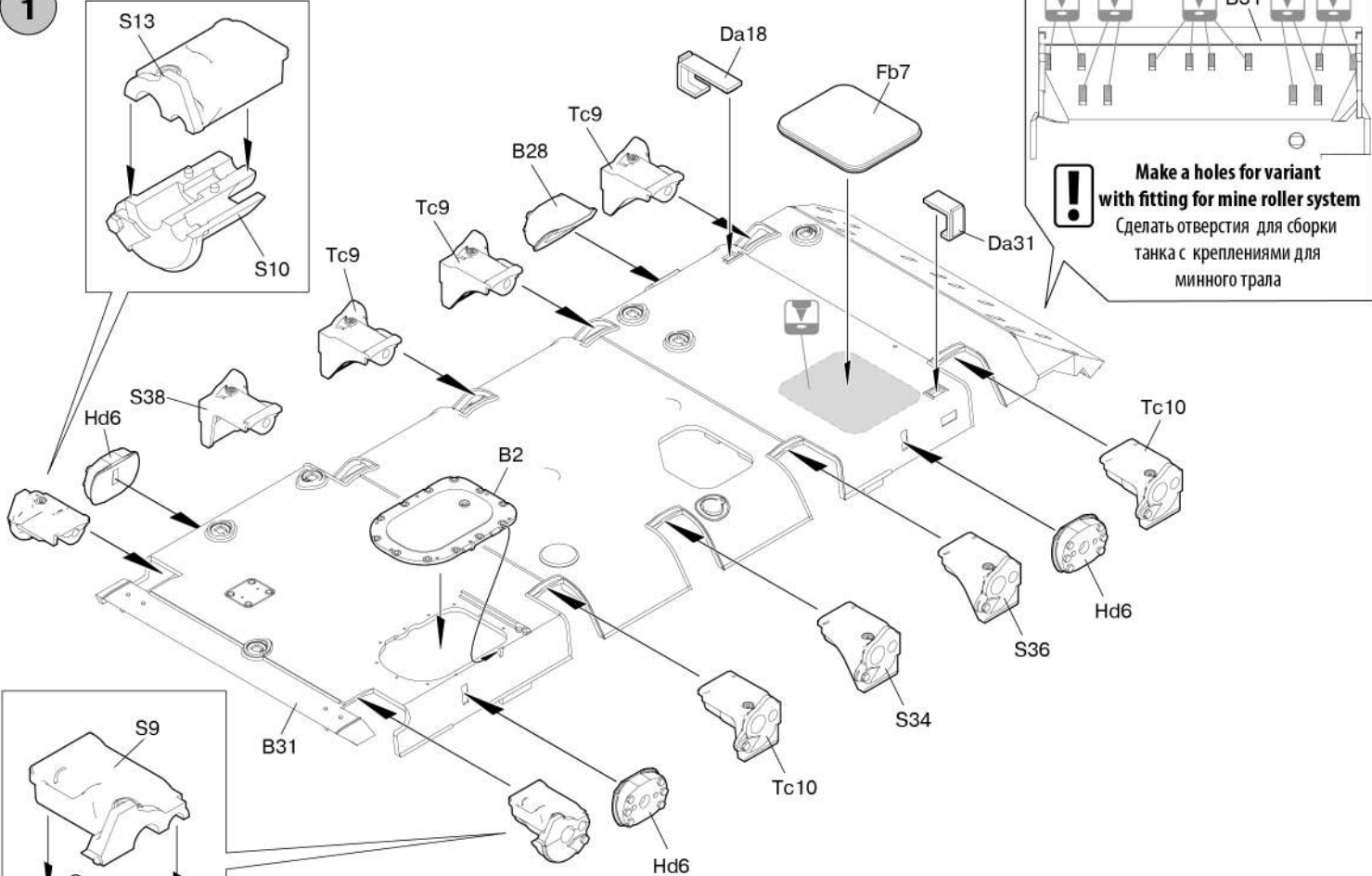

2

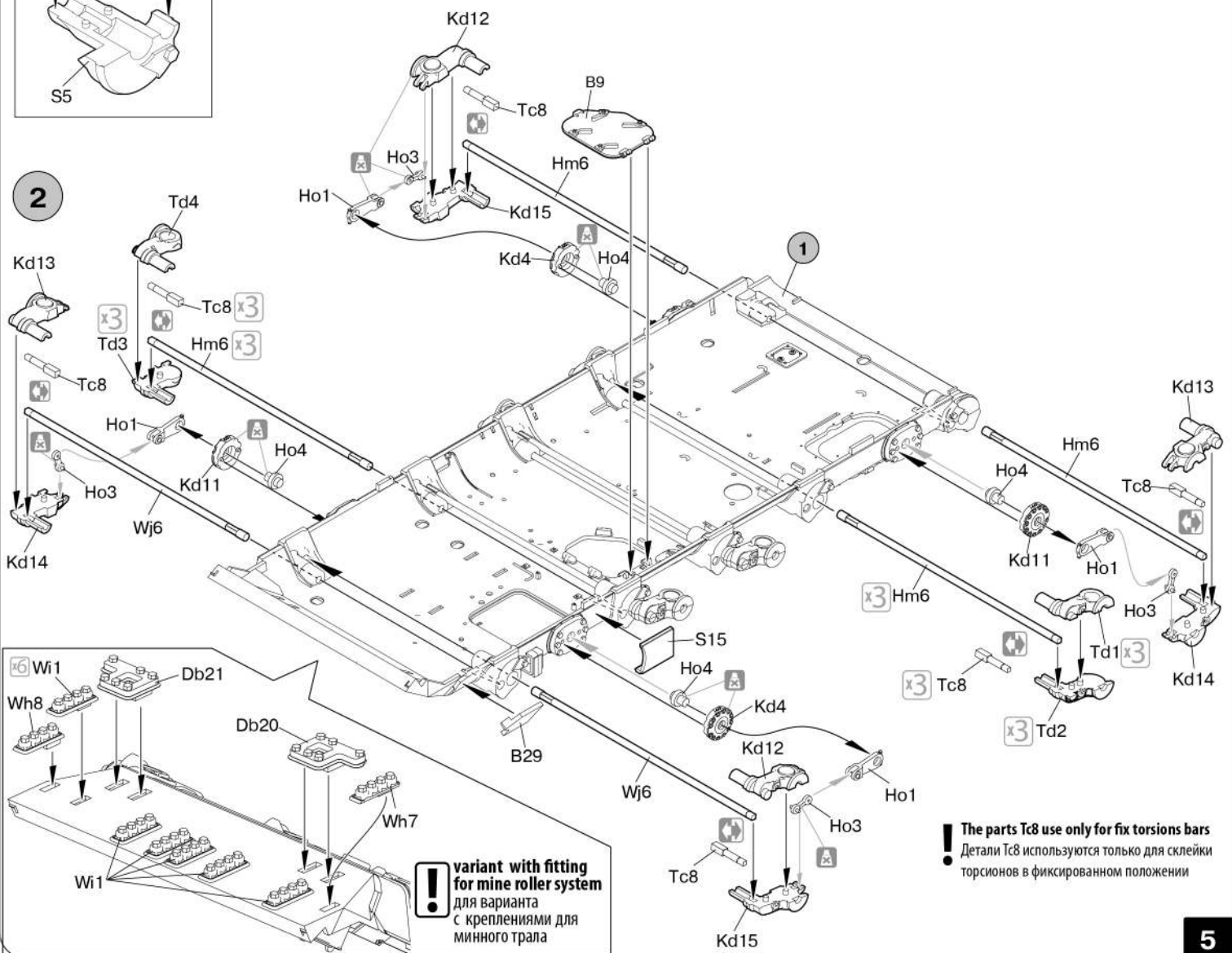

**variant with fitting for mine roller system**  
 для варианта с креплениями для минного траля

3

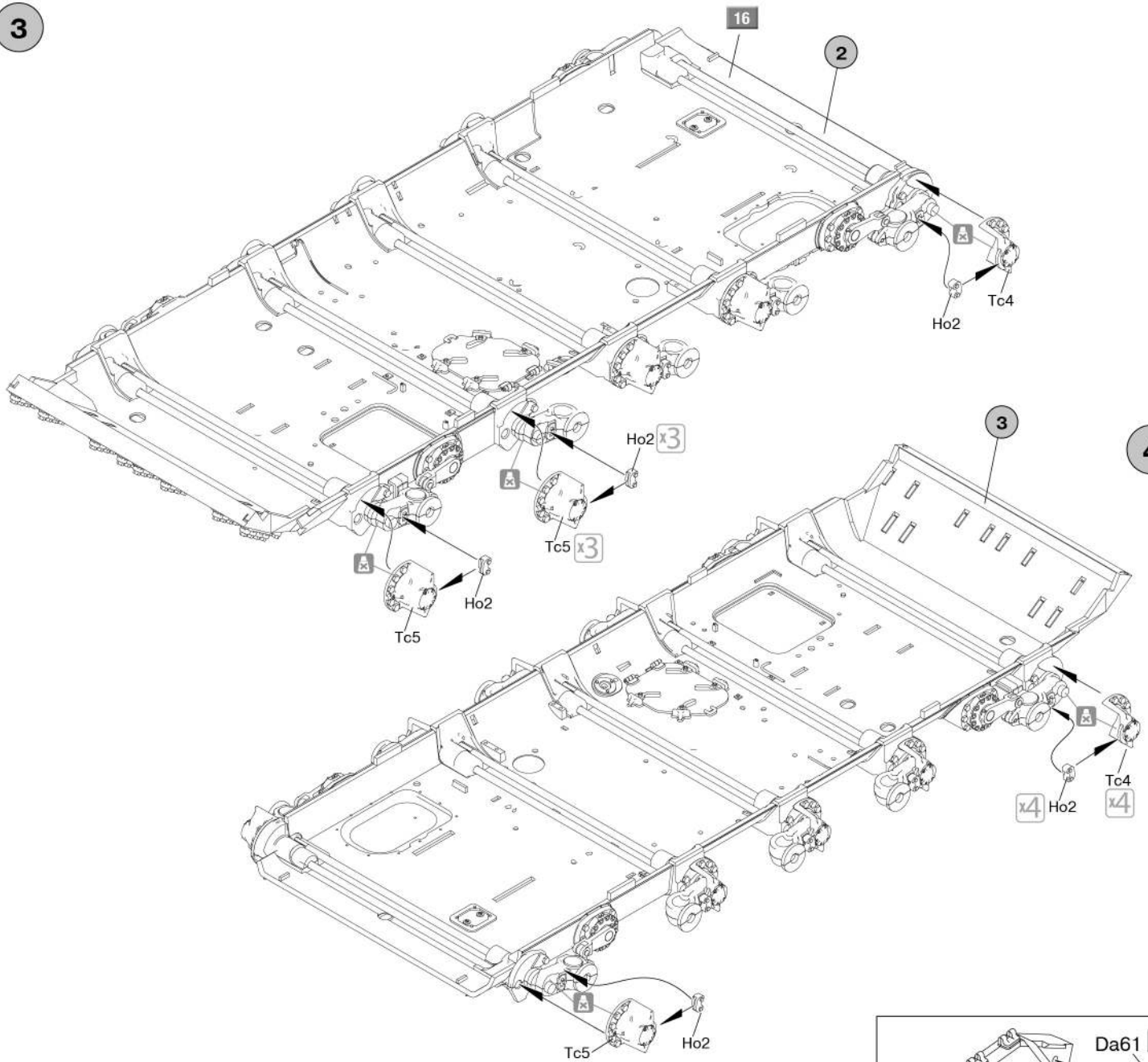

4

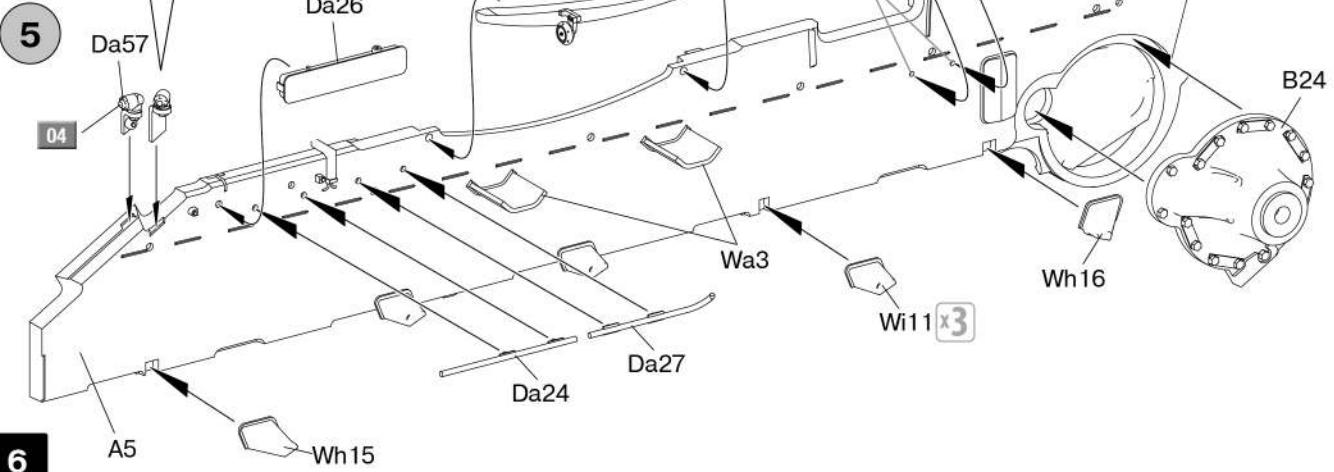
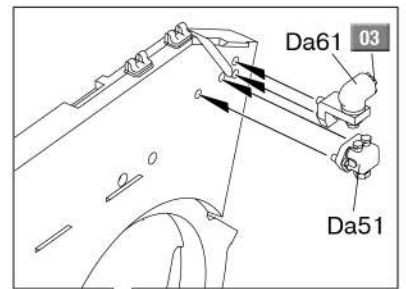
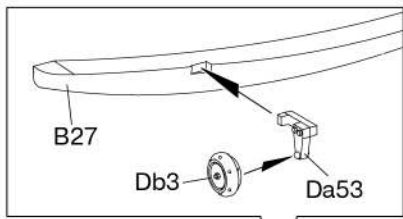
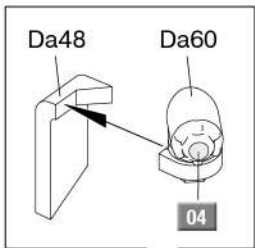

6

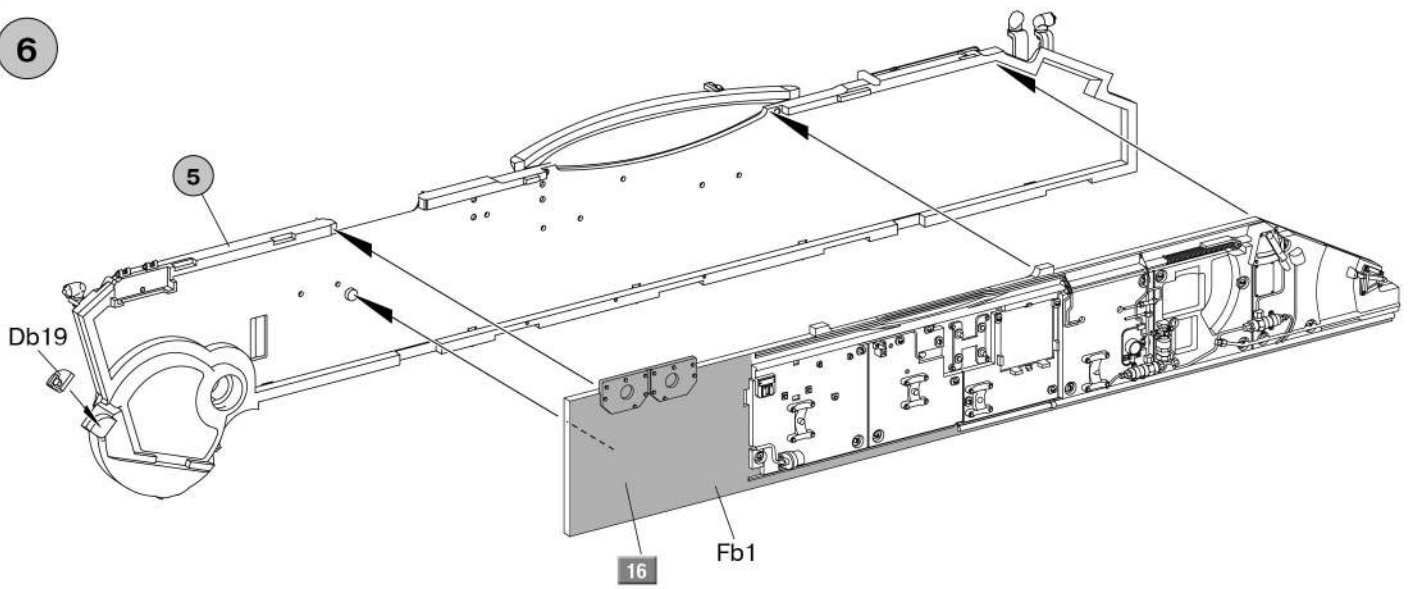

7

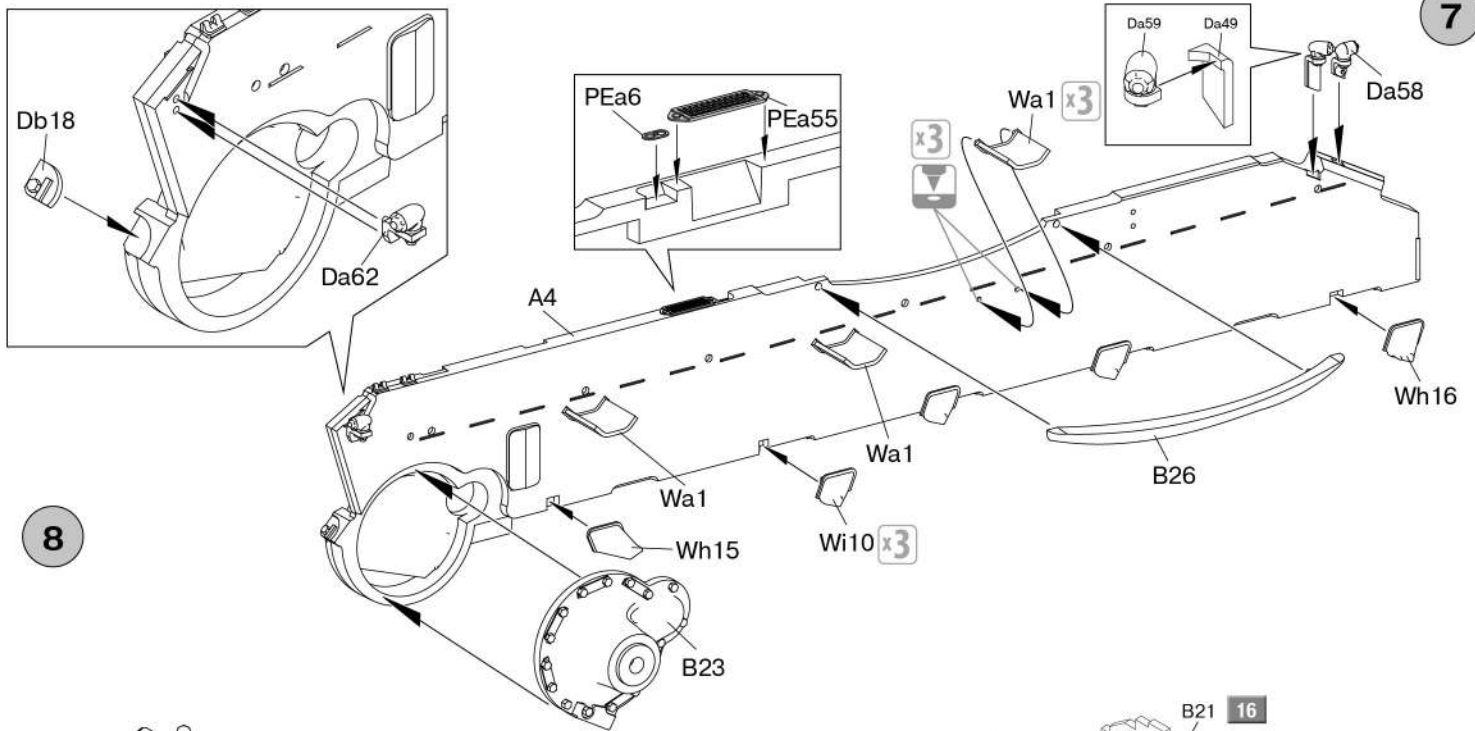

8

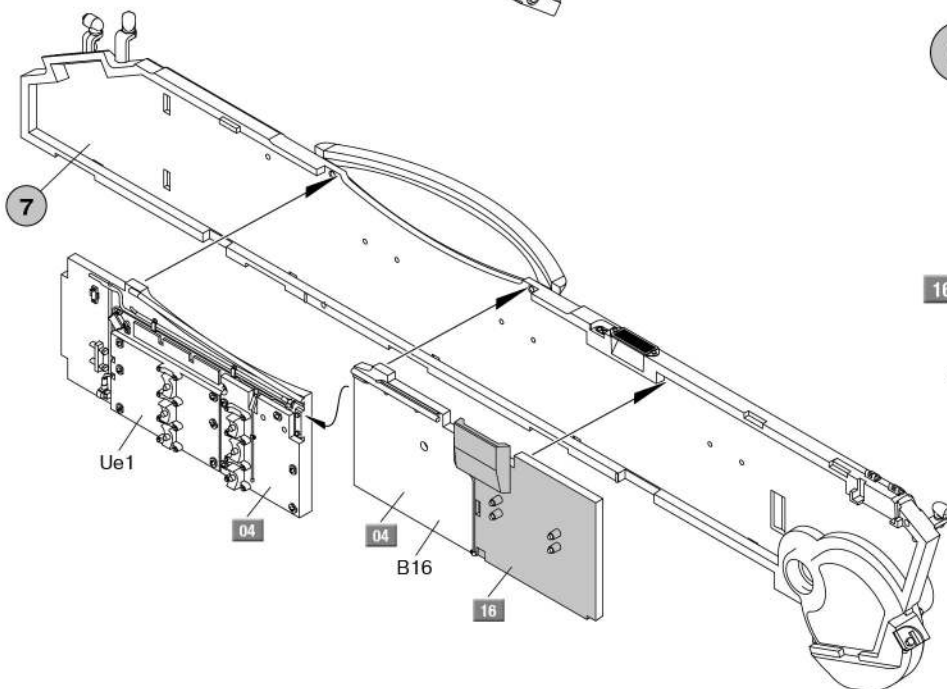

9

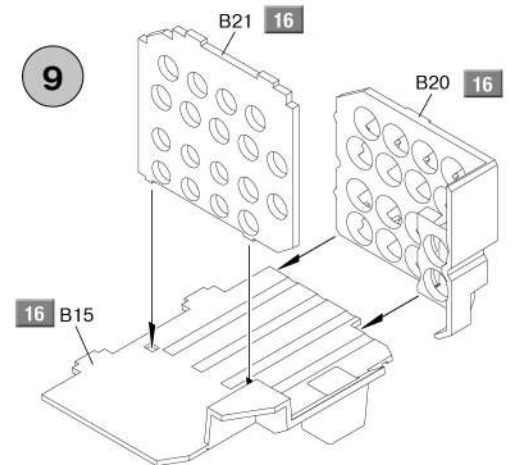

7

10

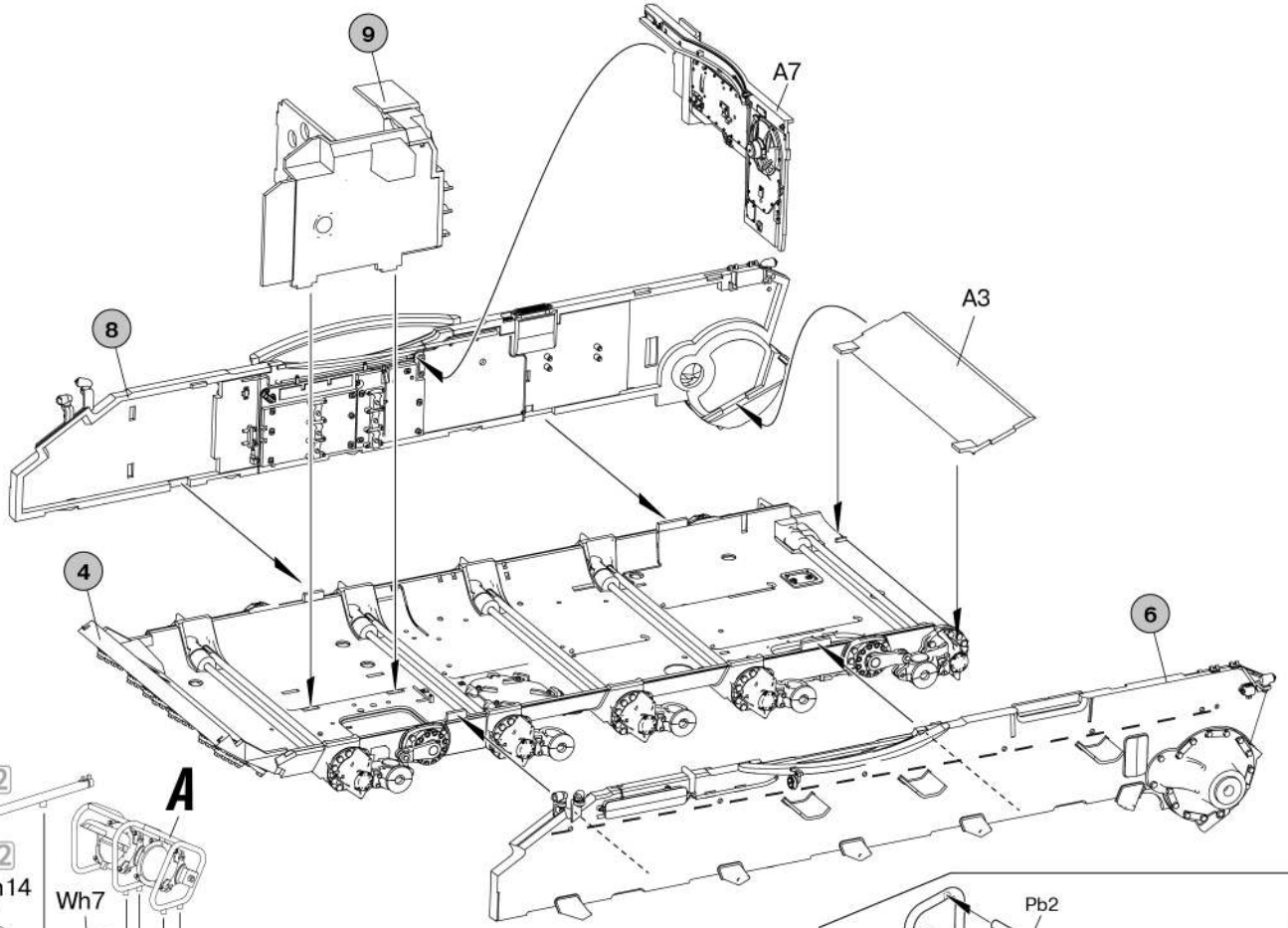

11

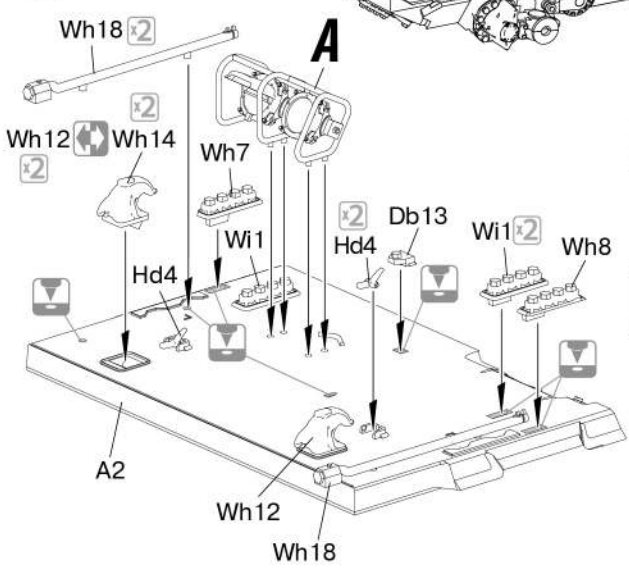

**!** The parts Wh18, Wh7, Wi1, Wh8, Db13 used for variant of tank with fitting for mine roller system  
 Детали Wh18, Wh7, Wi1, Wh8, Db13 используются для сборки варианта танка с креплениями для минного траля

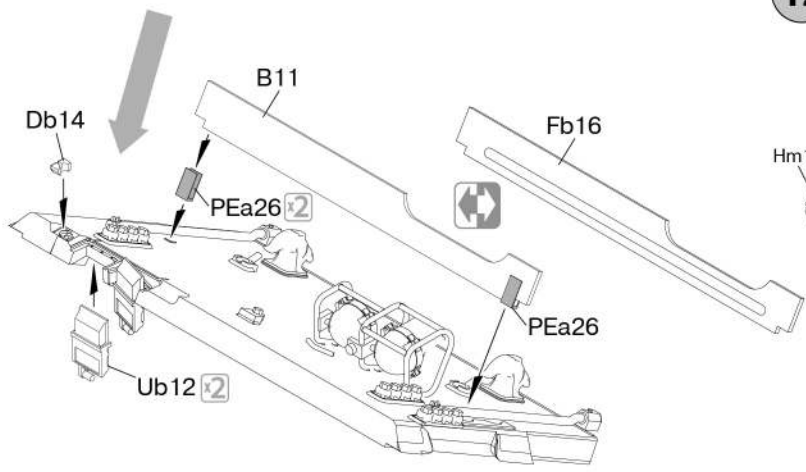
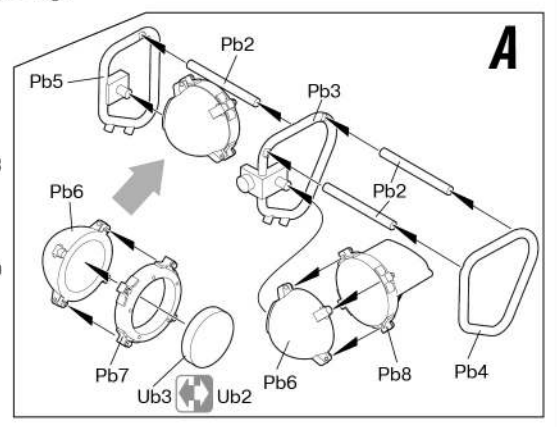

12 x8

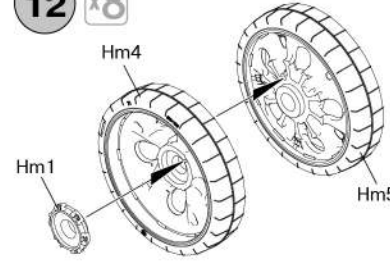

13 x2

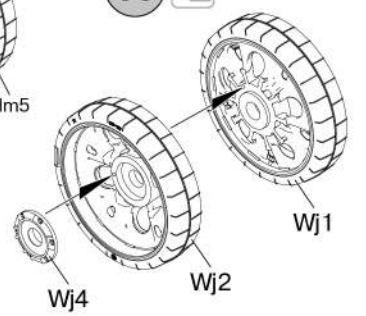

14 x2

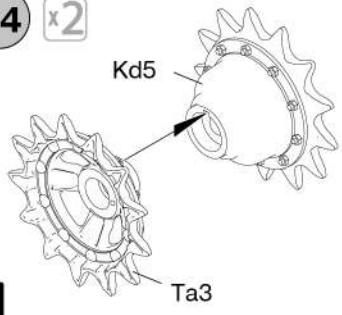

15 x2

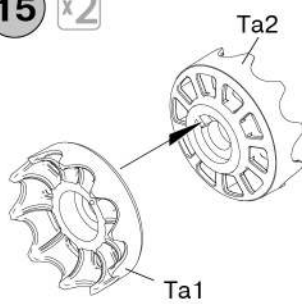

16

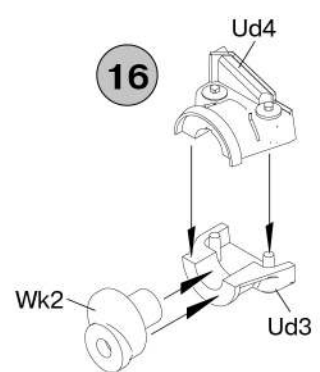

17

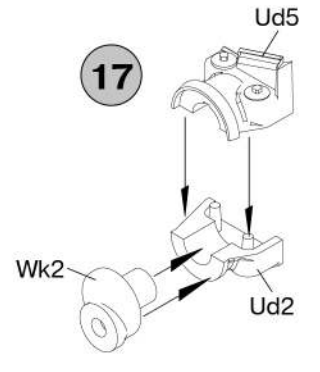



18

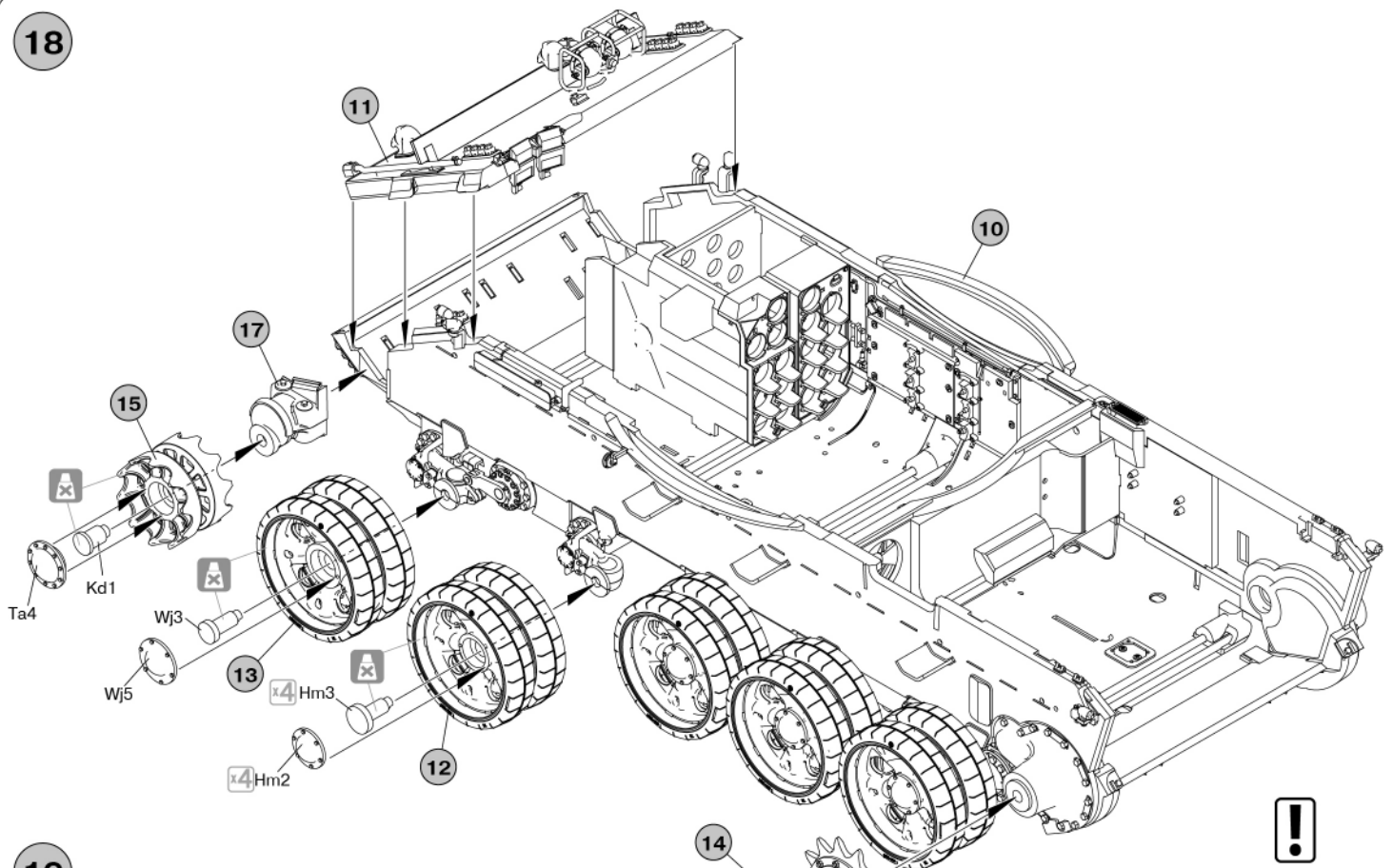

19

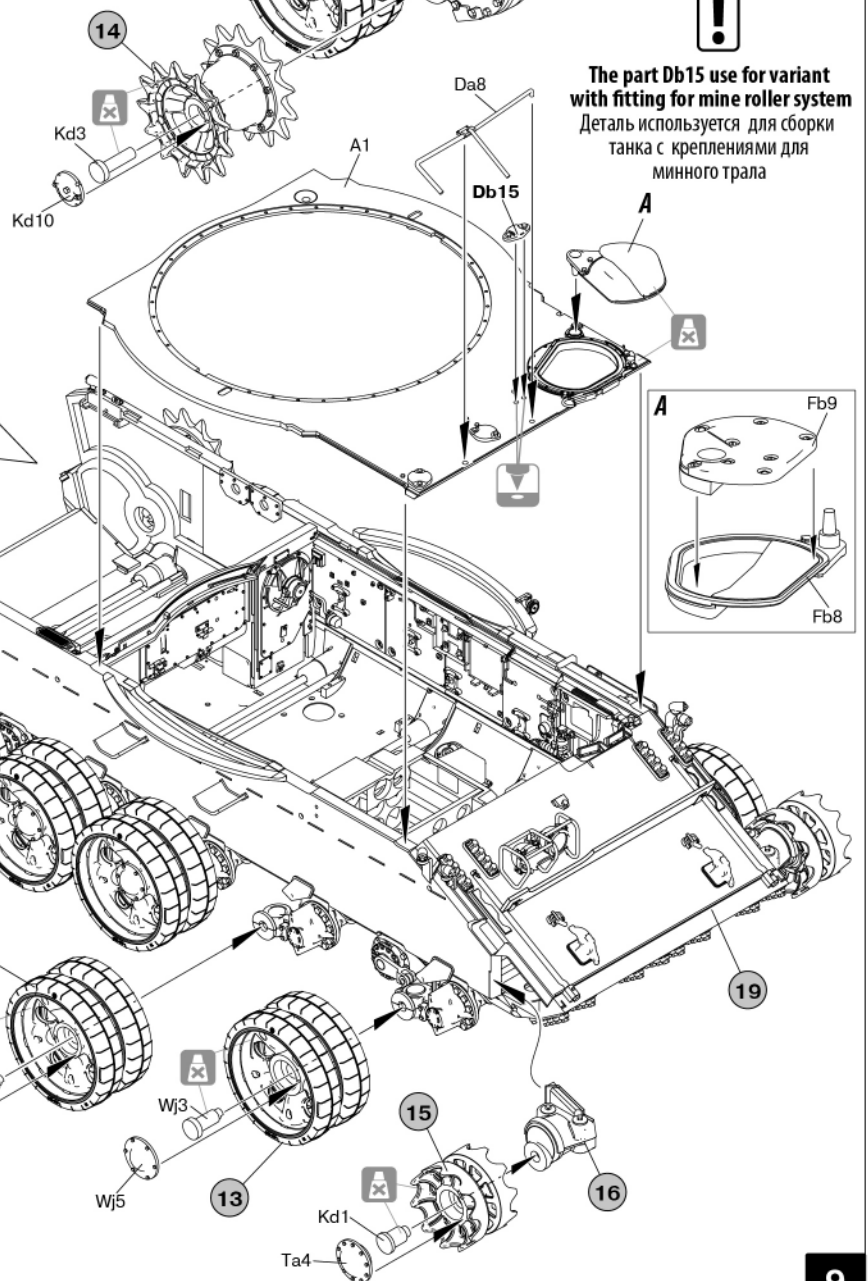
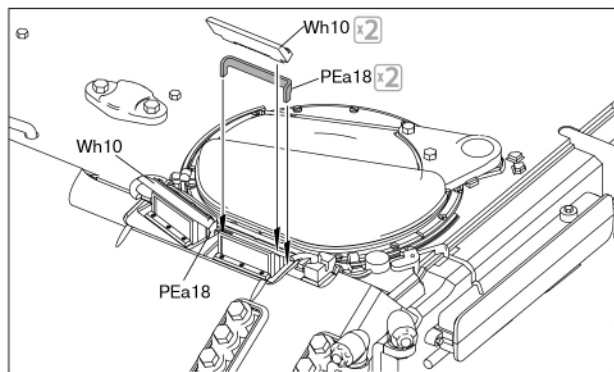

The part Db15 use for variant with fitting for mine roller system  
 Деталь используется для сборки танка с креплениями для минного траля

20



The part Db10 use for variant with fitting for mine roller system  
Деталь Db10 используется для сборки танка с креплениями для минного трапа

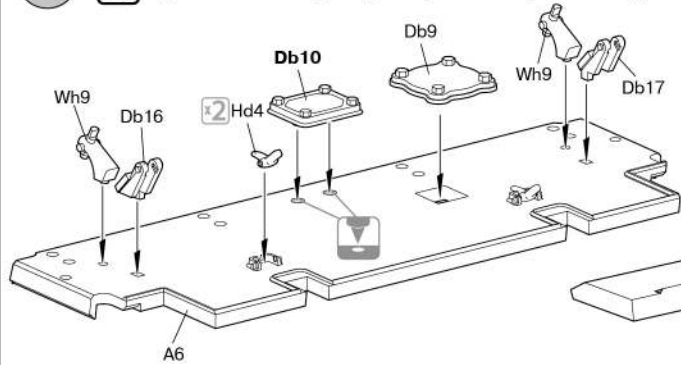

21

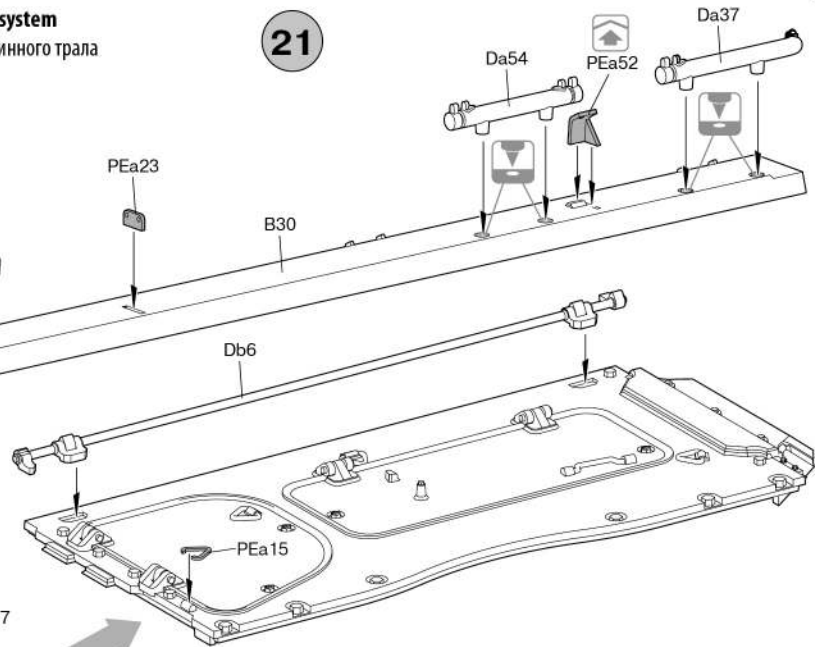

22

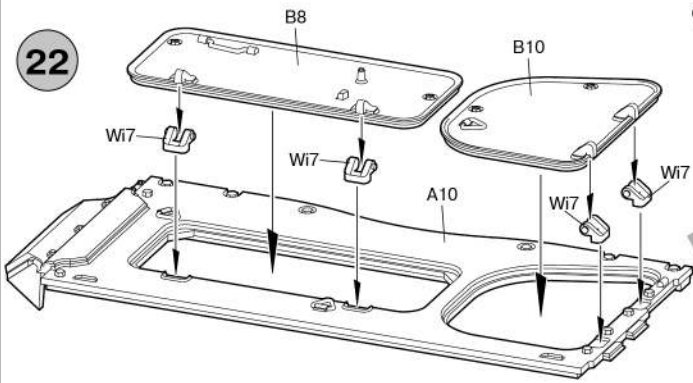

23

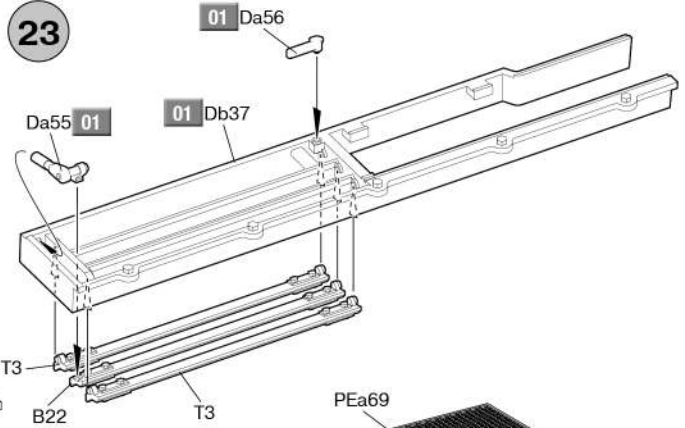

24

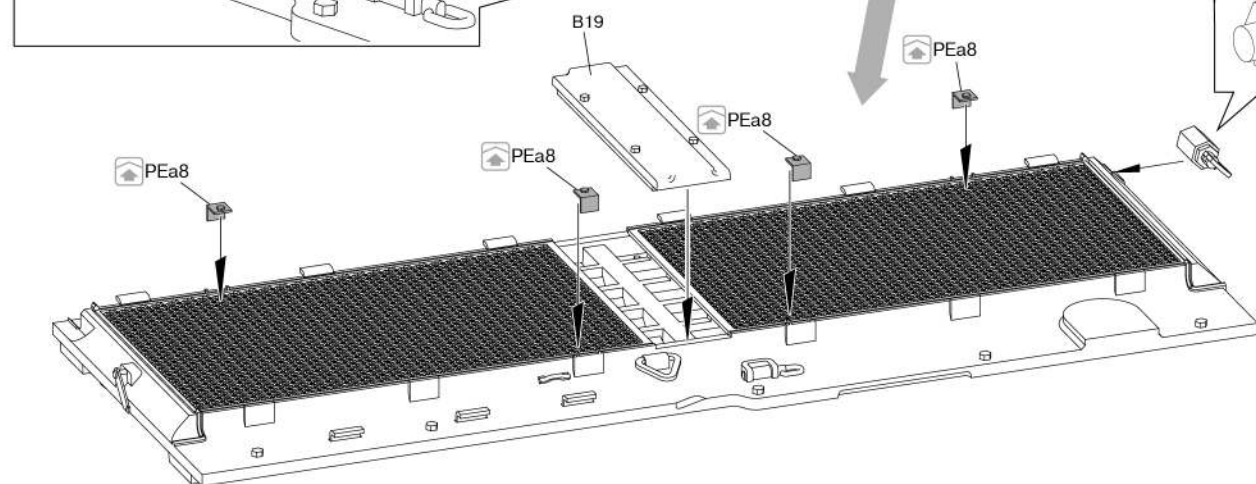
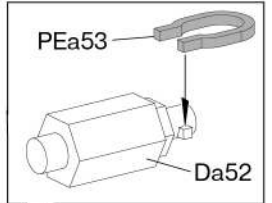
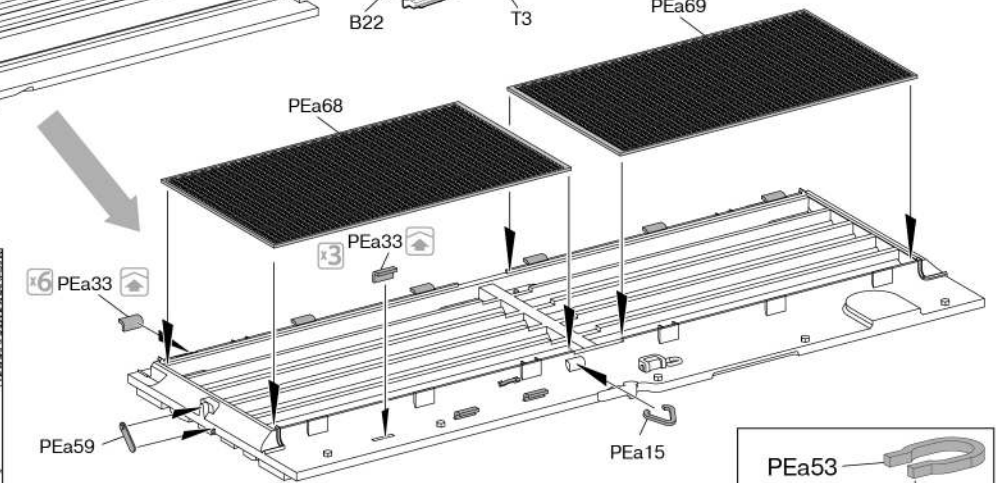
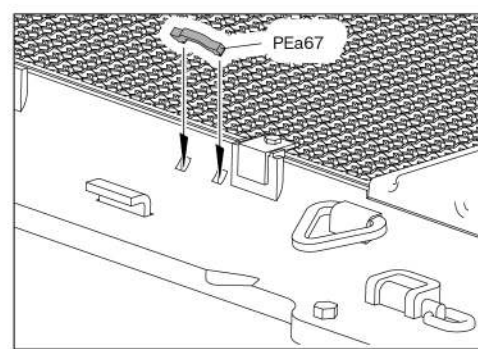
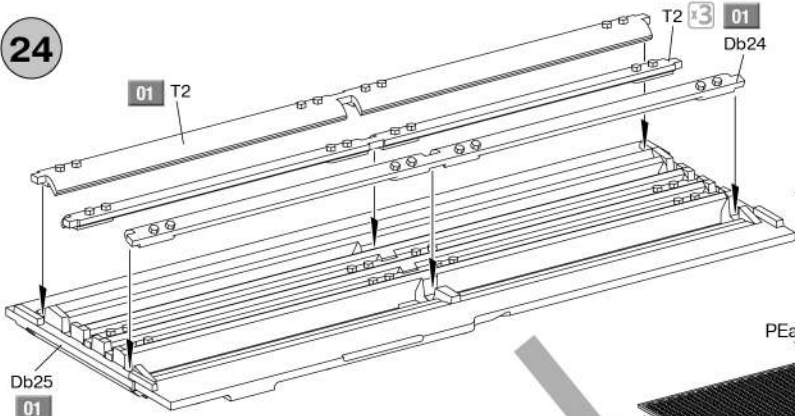

25

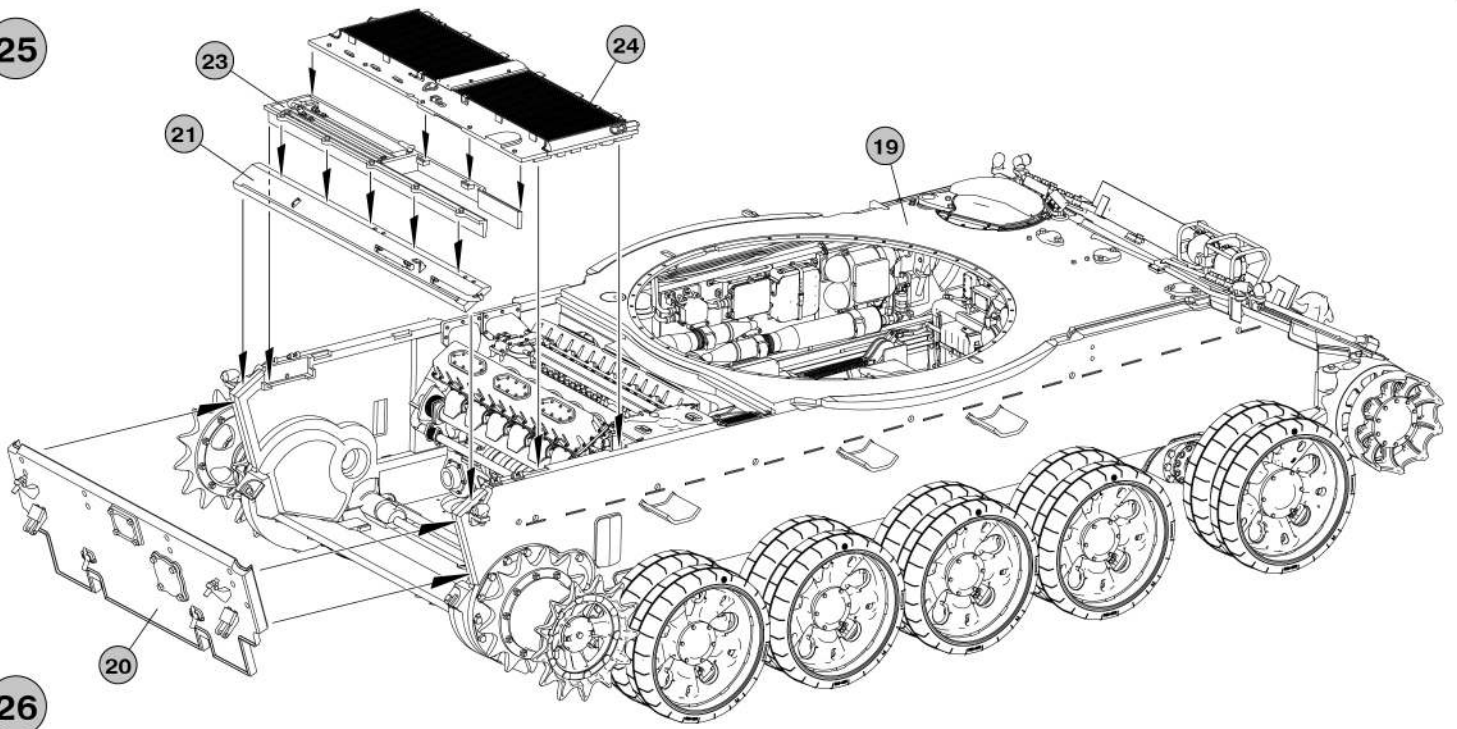

26

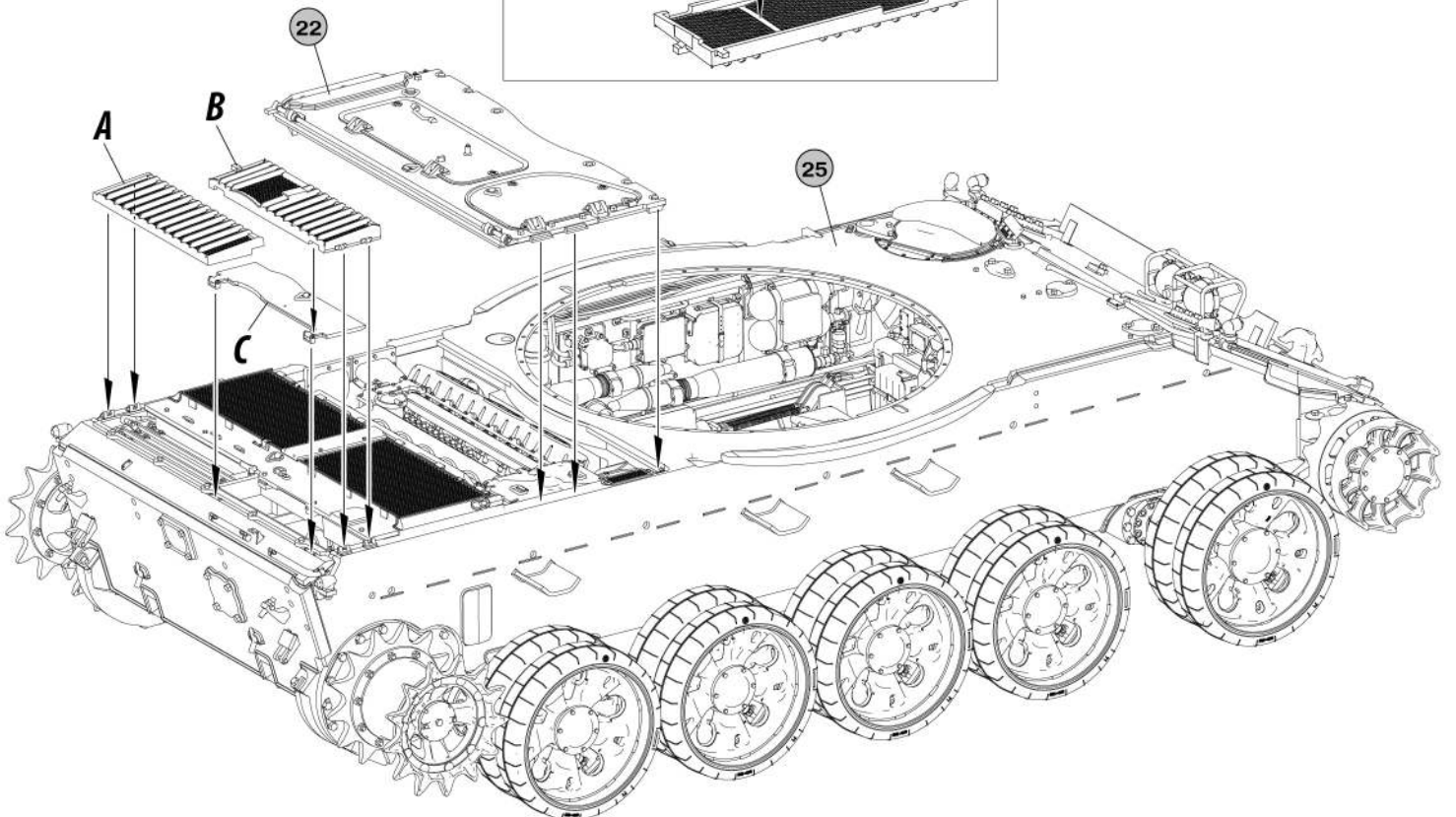
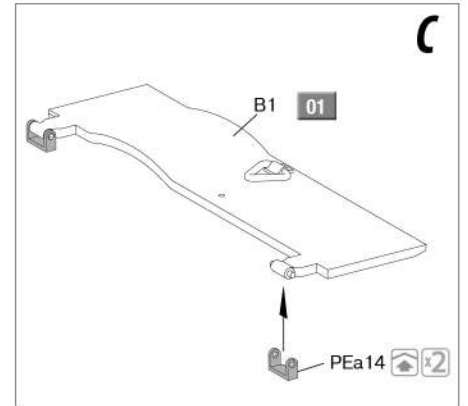
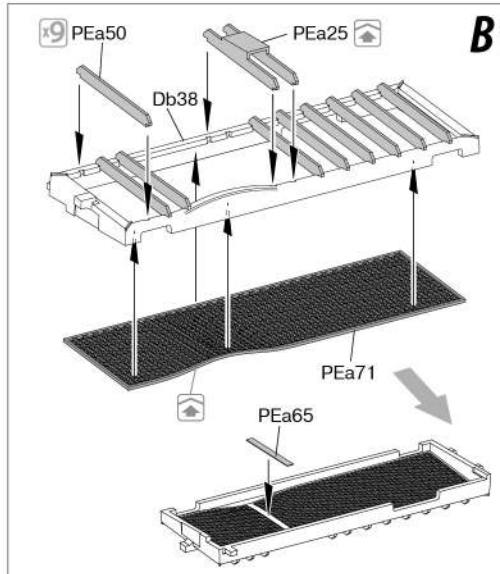
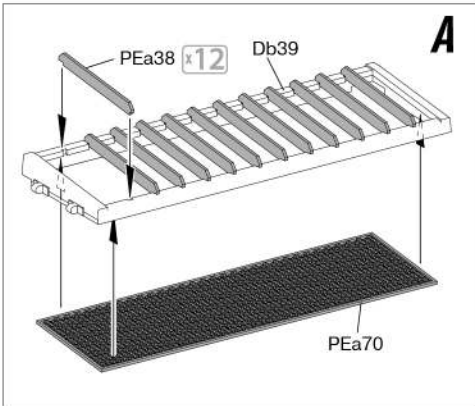

According to painting options  
Согласно вариантам окраски

27 x3

**b** Early type of fuel tanks  
Ранний тип топливных баков



**a** Late type of fuel tanks  
Поздний тип топливных баков

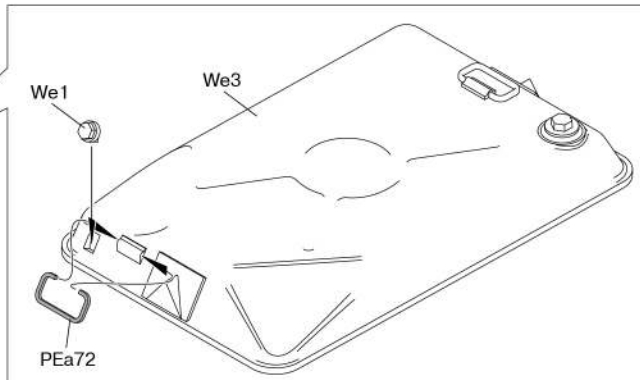
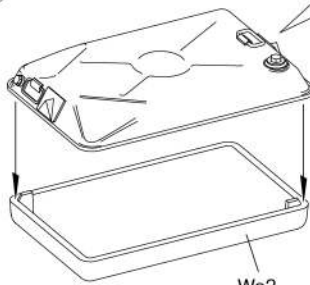
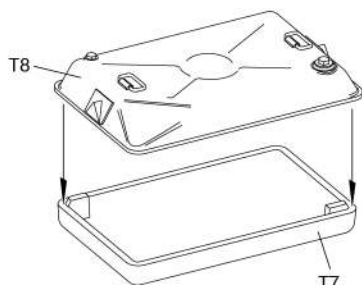

28

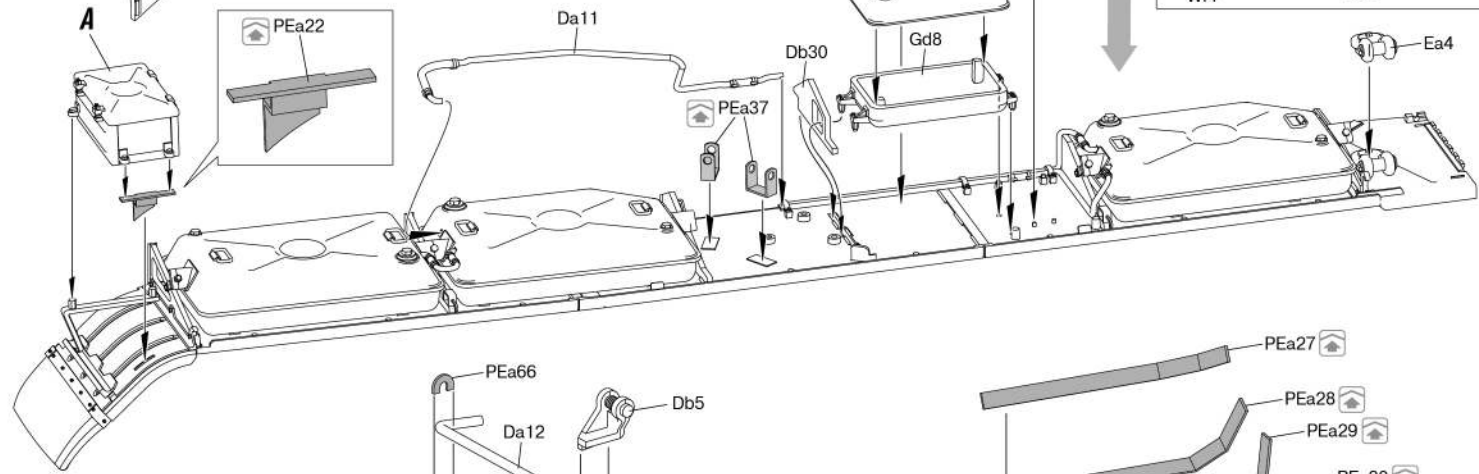
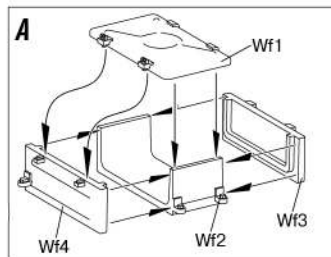
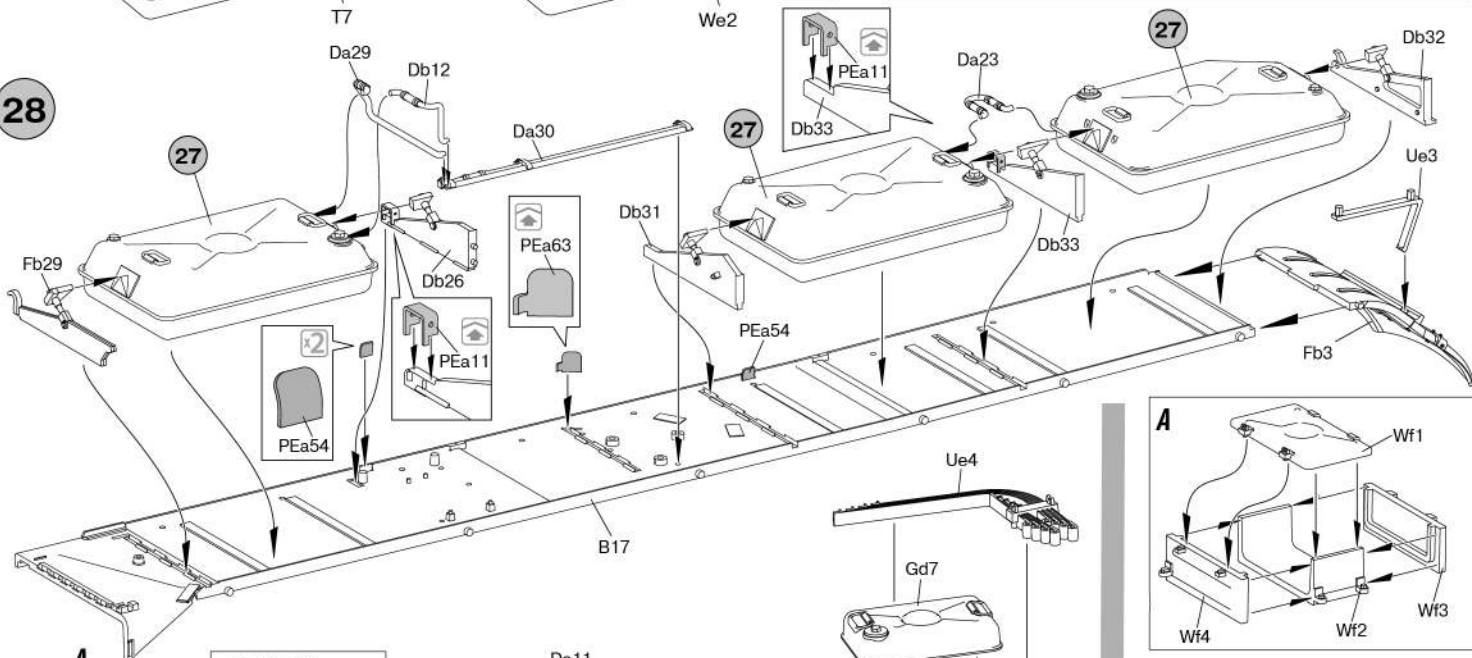

29

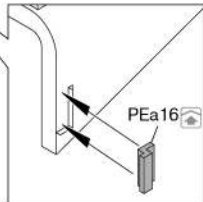
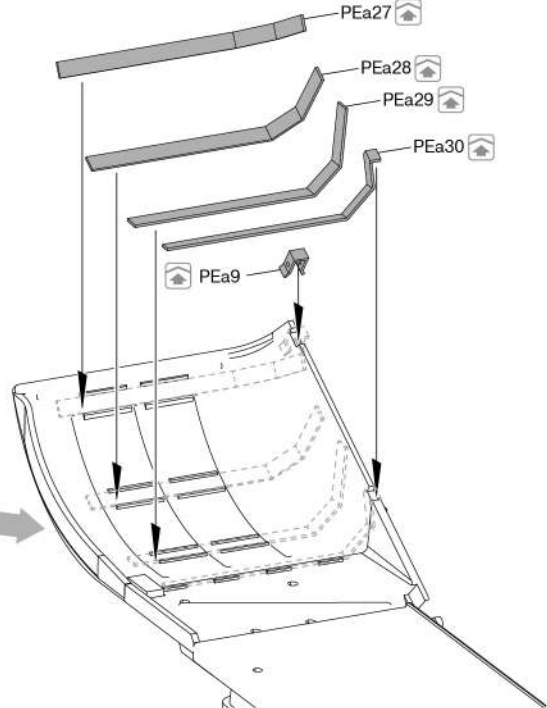
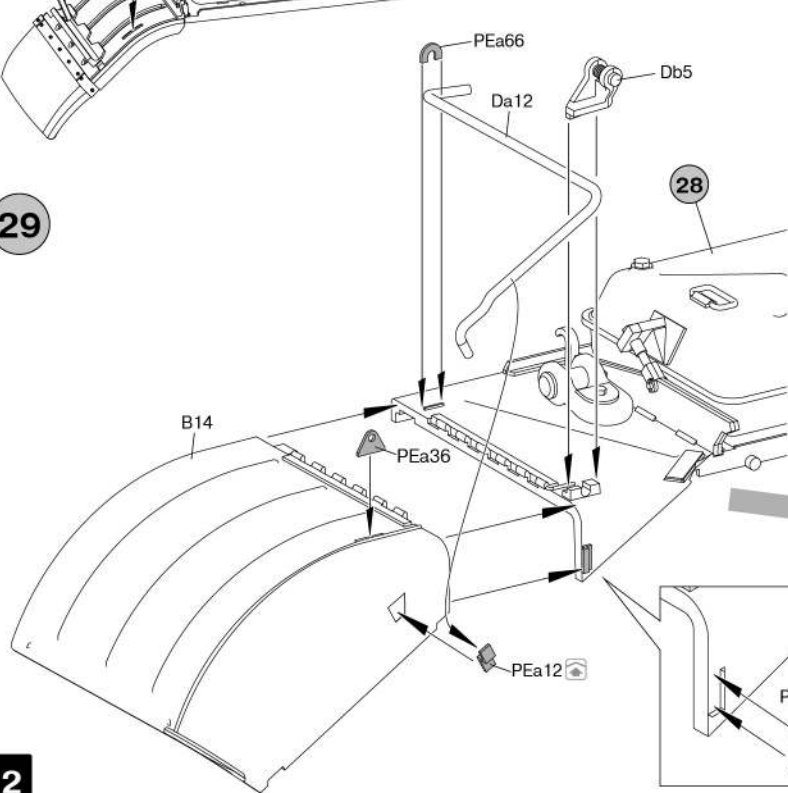

30

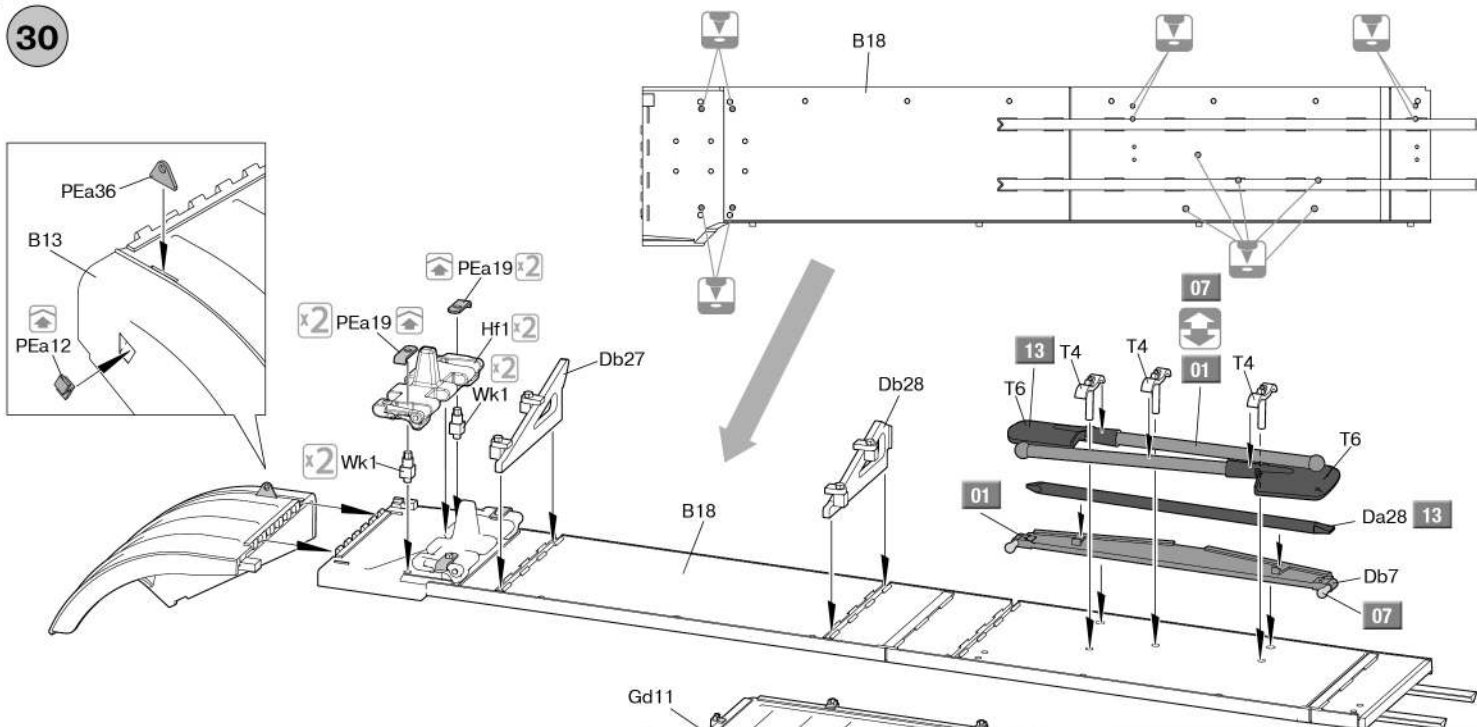

31

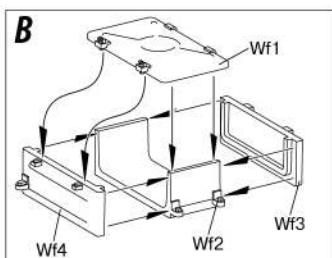
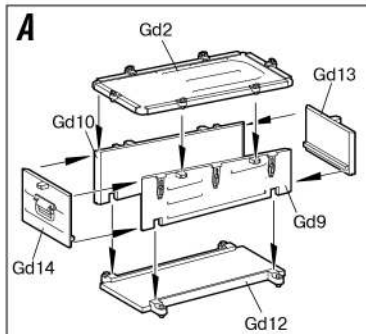
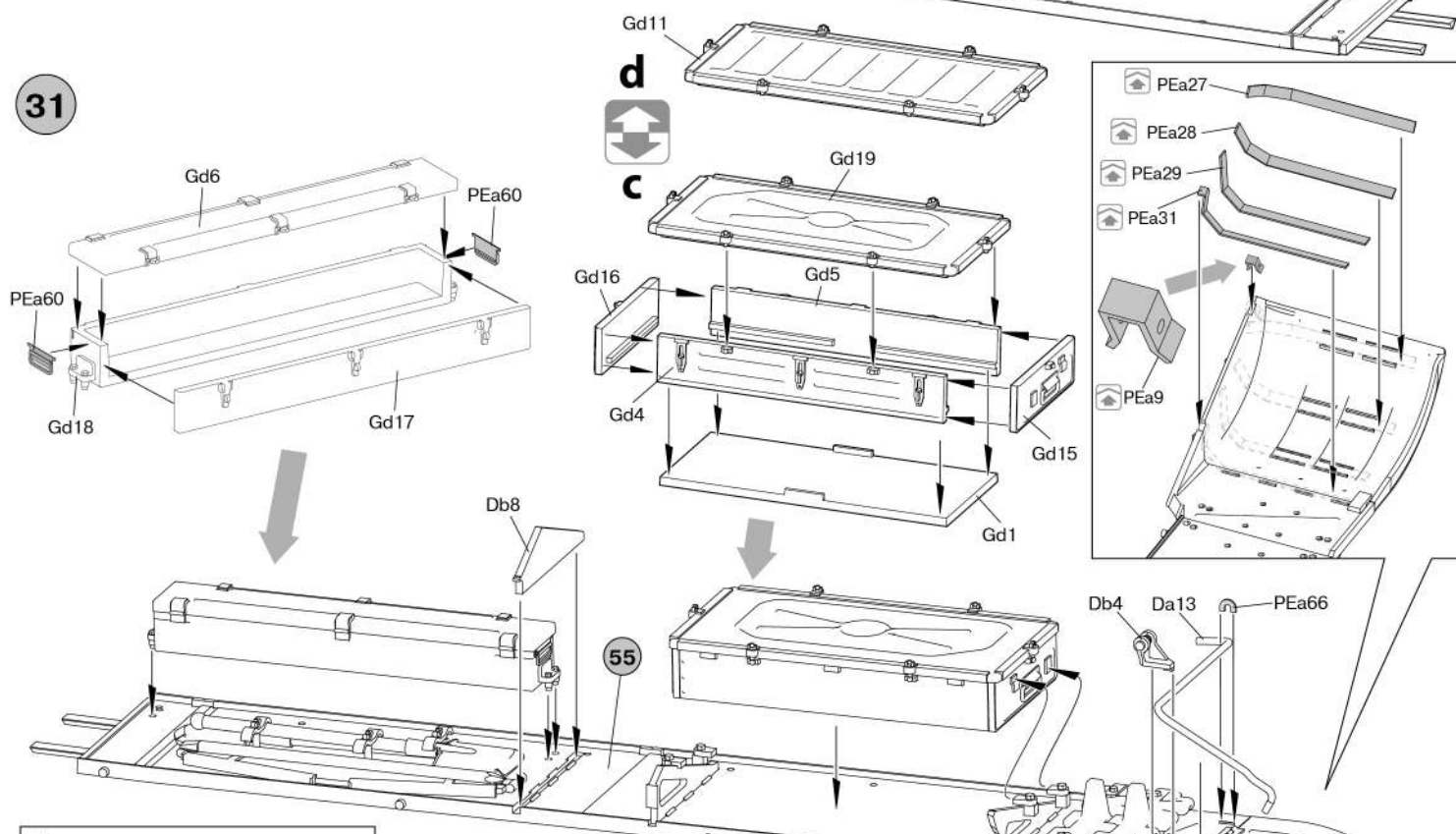

32

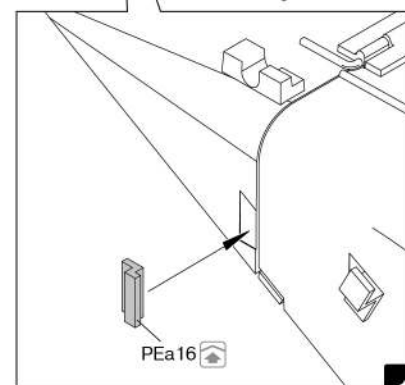
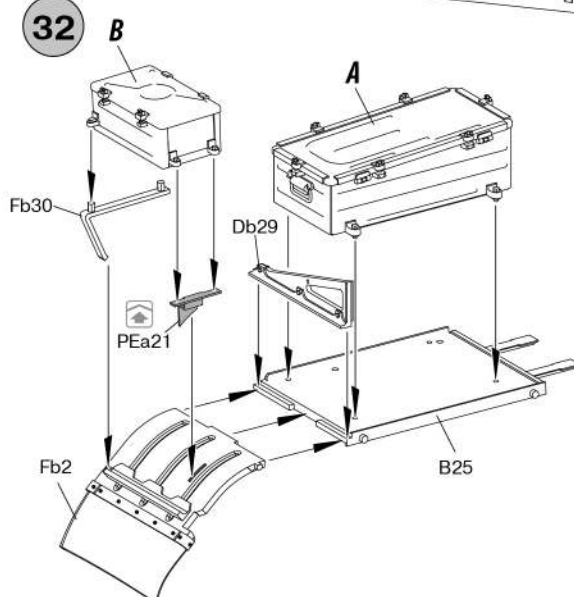

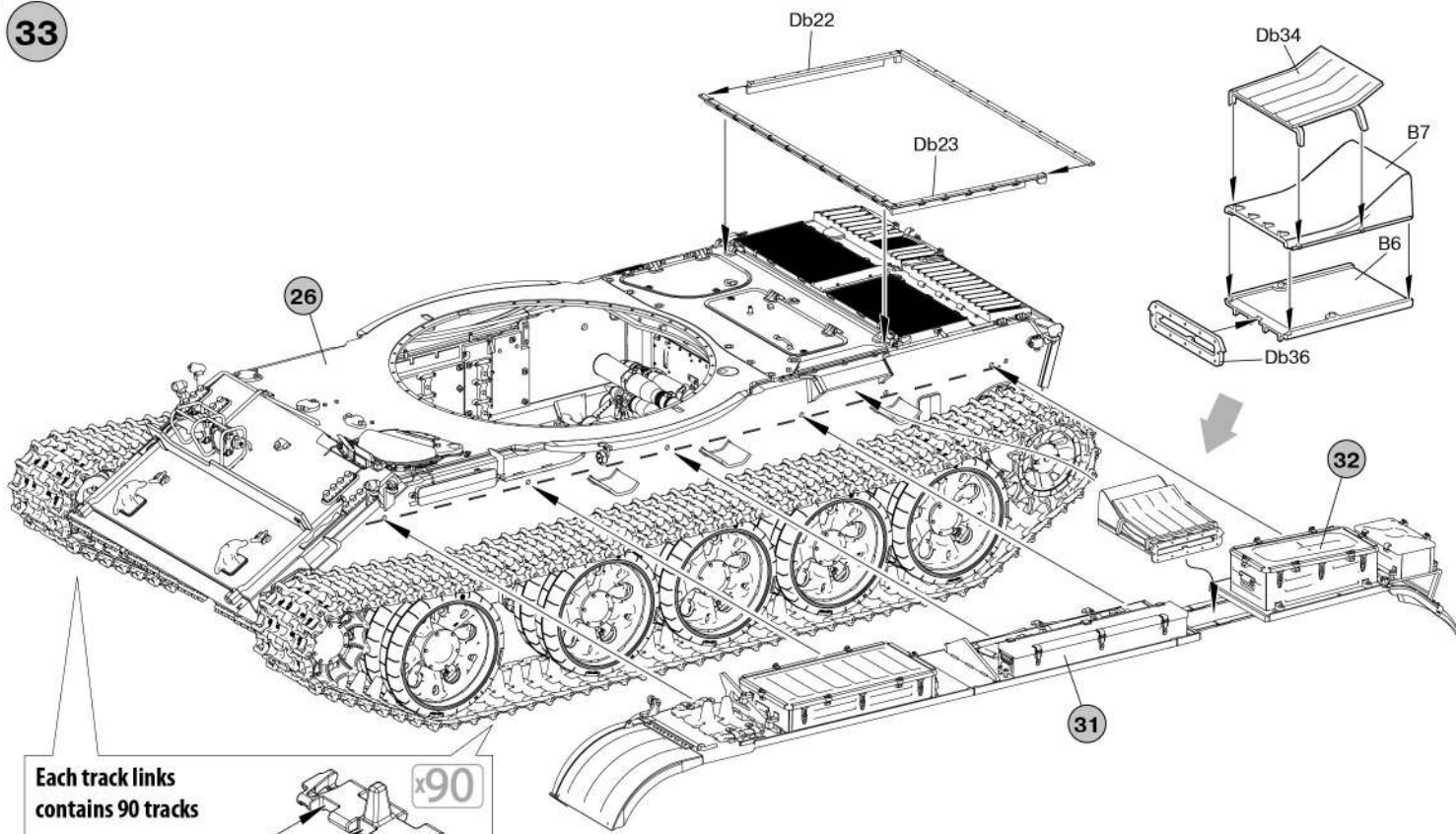

**Each track links contains 90 tracks**

каждая гусеничная лента состоит из 90 траков

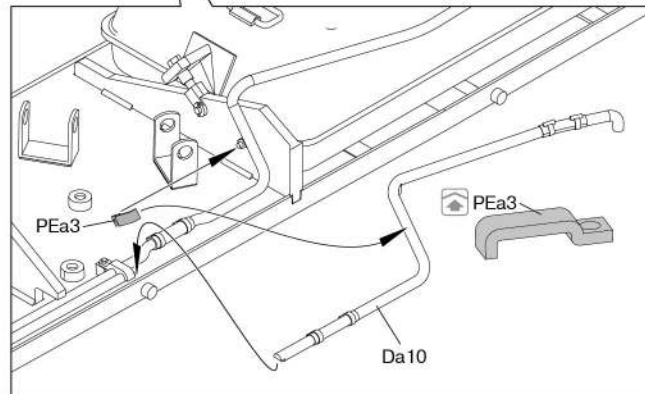
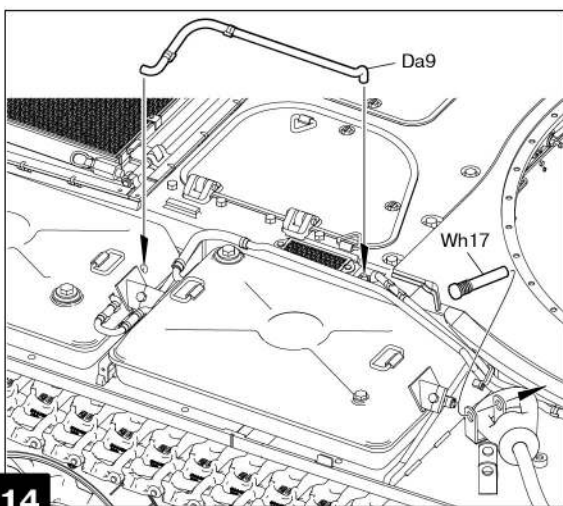
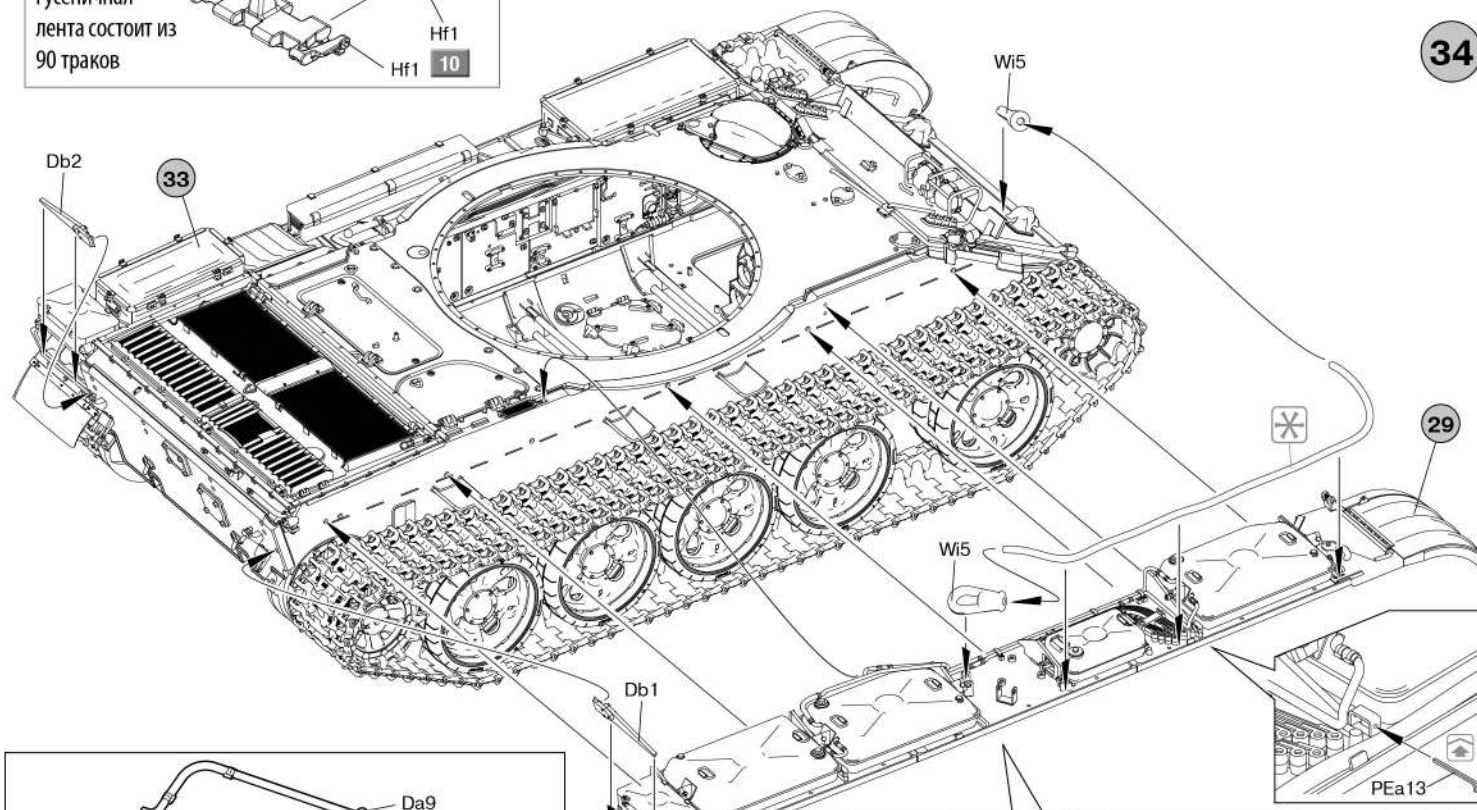
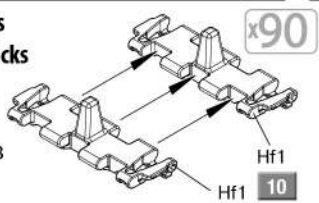

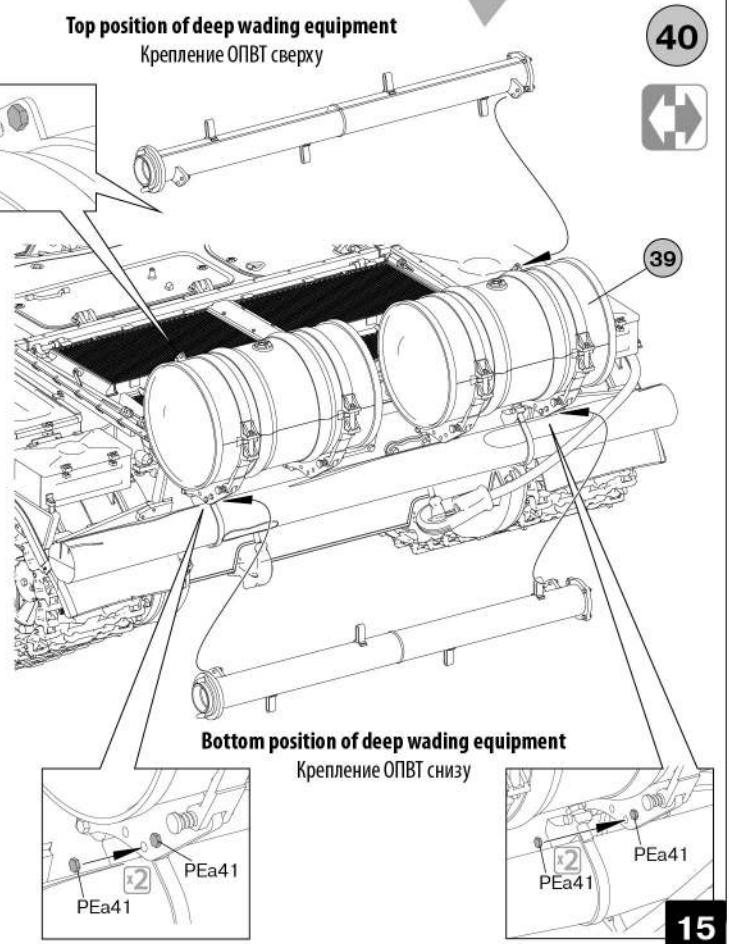
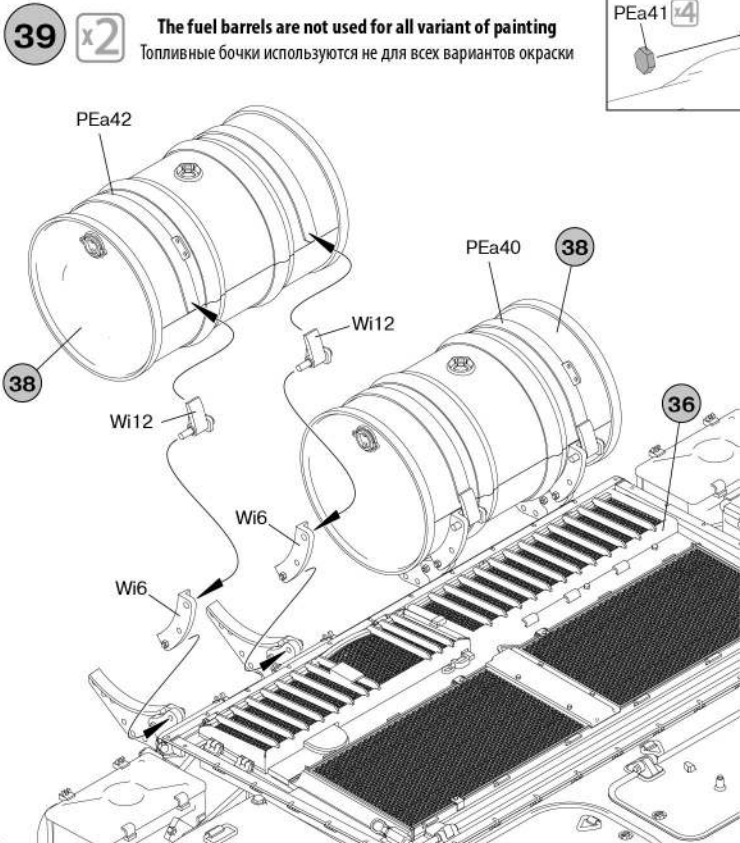
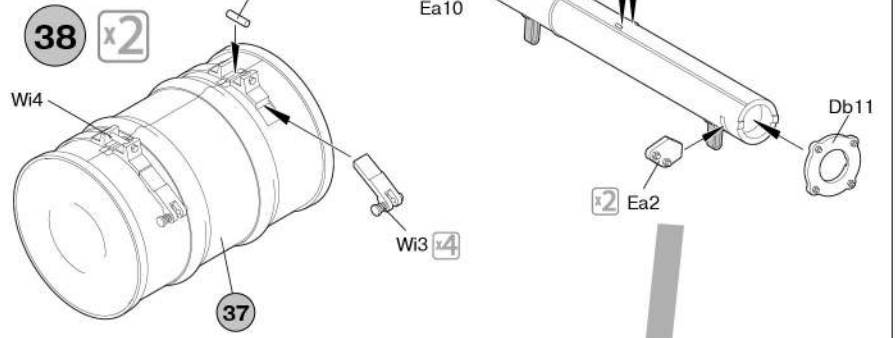
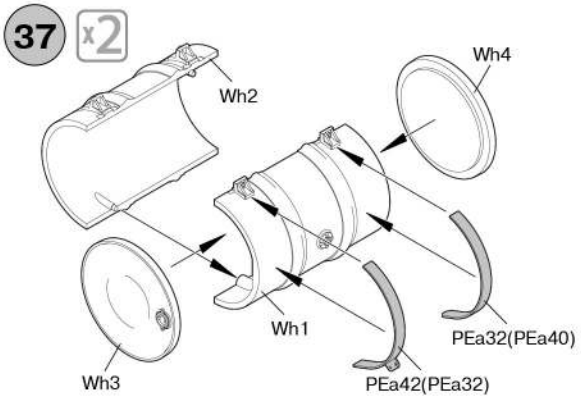
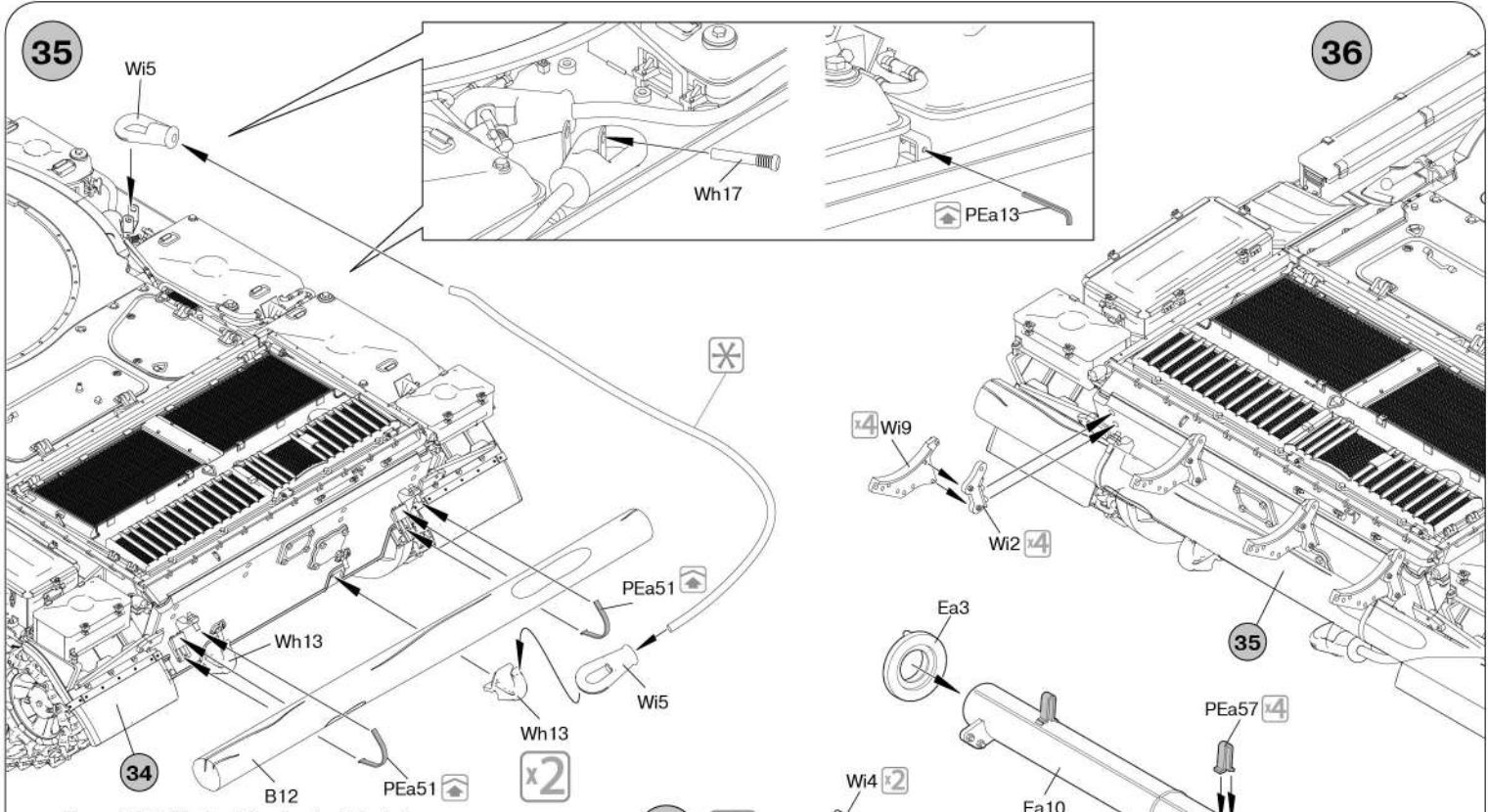

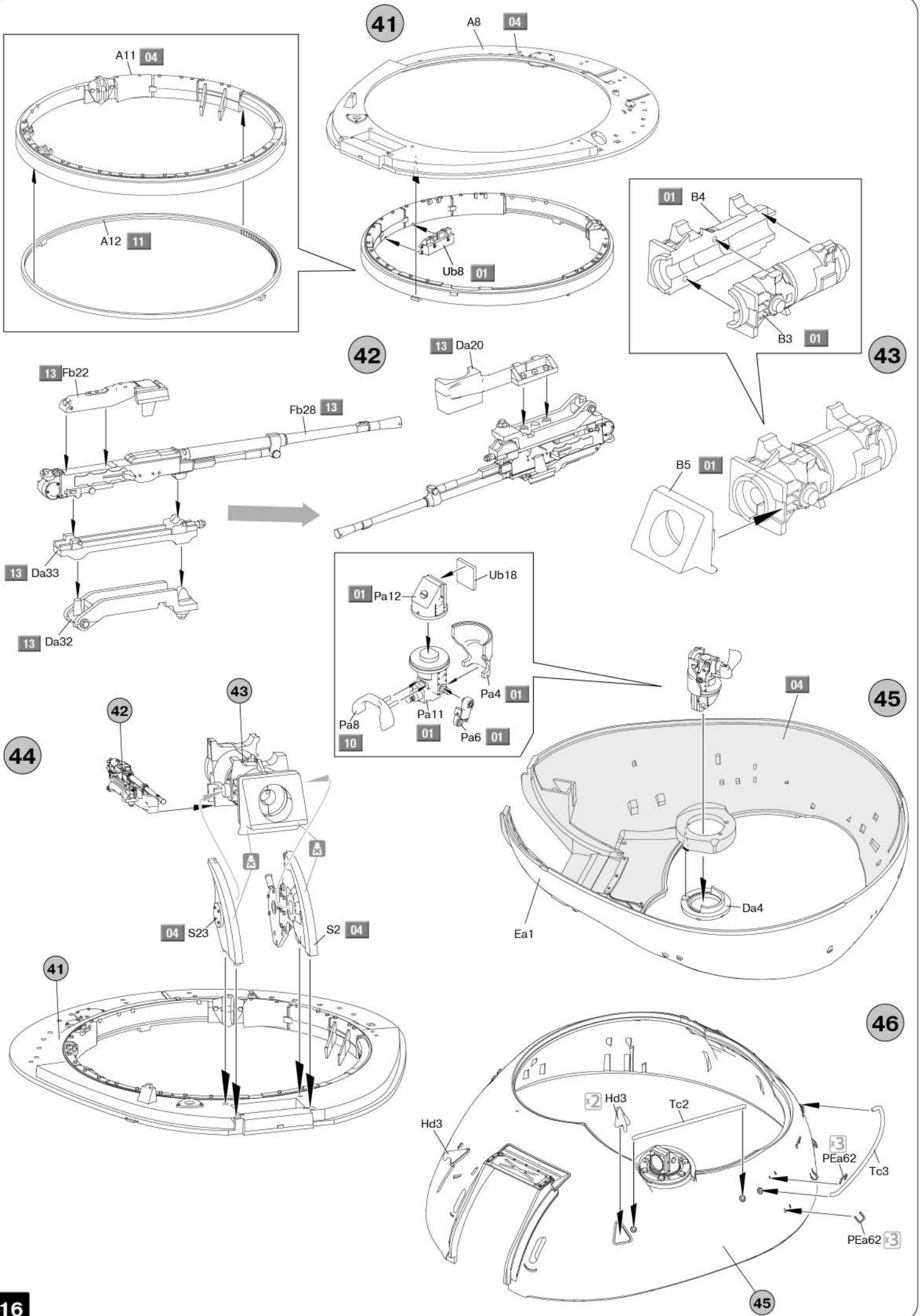



47

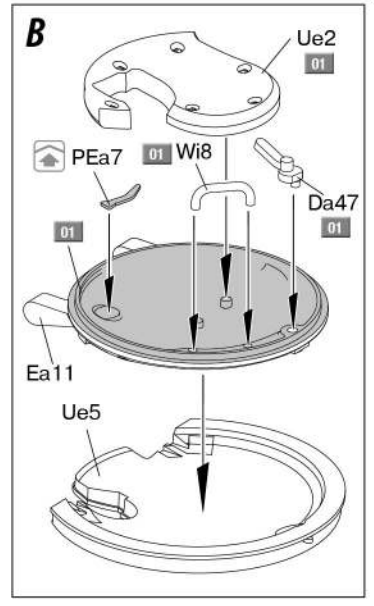
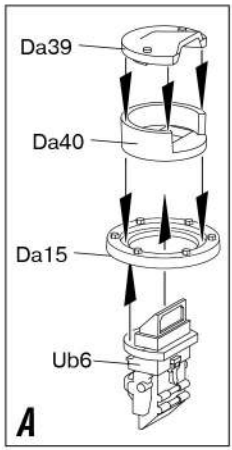
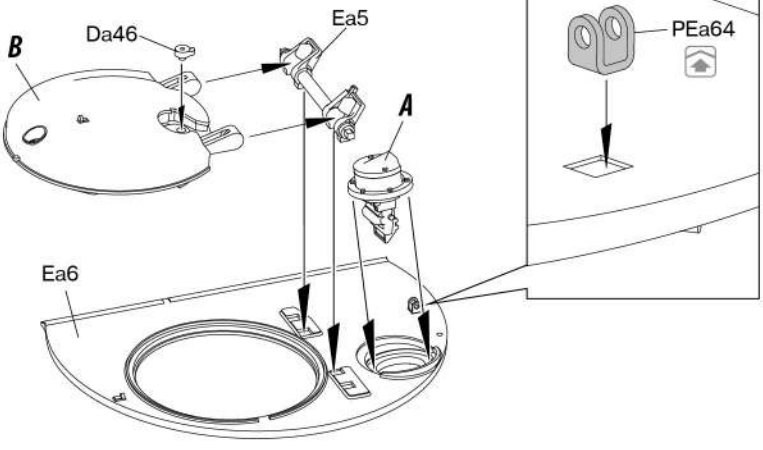

48

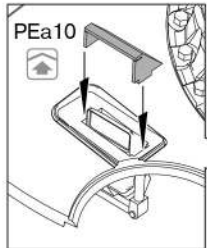
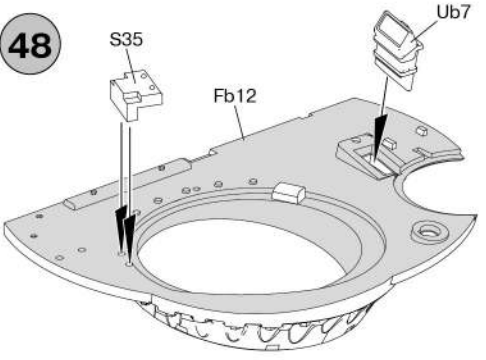

49

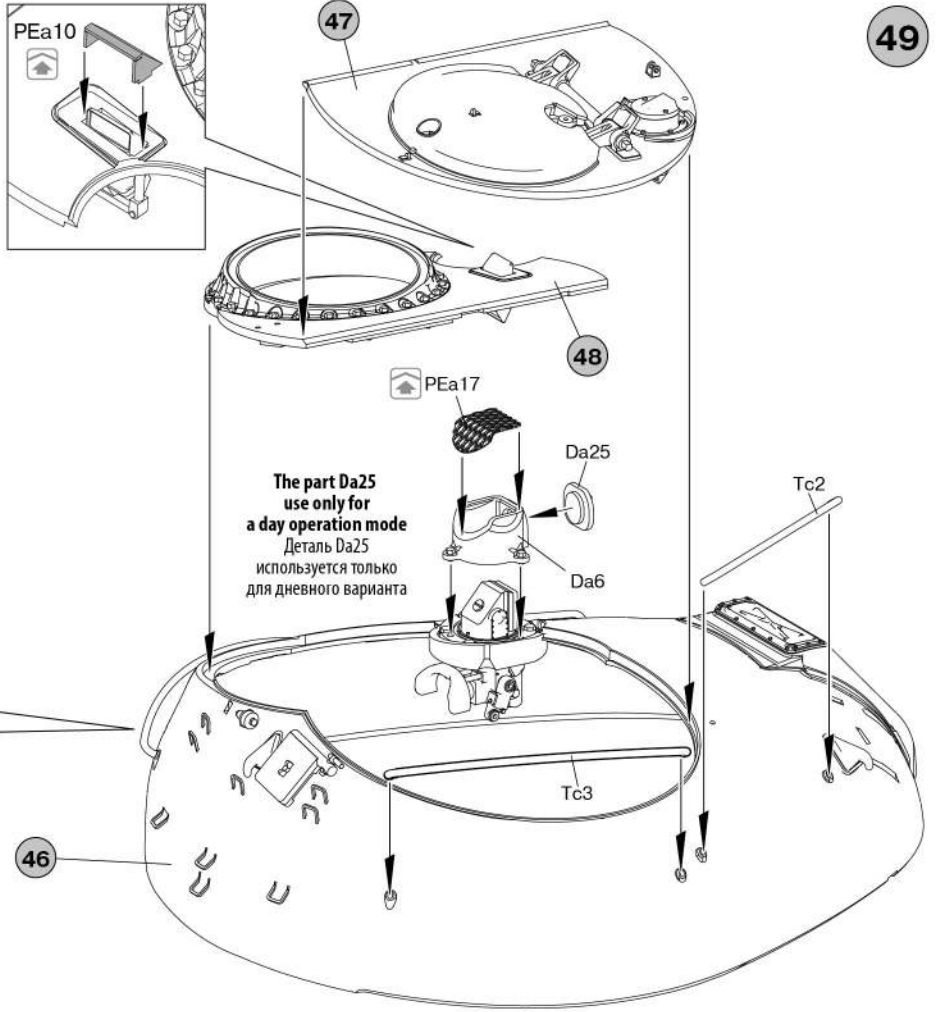
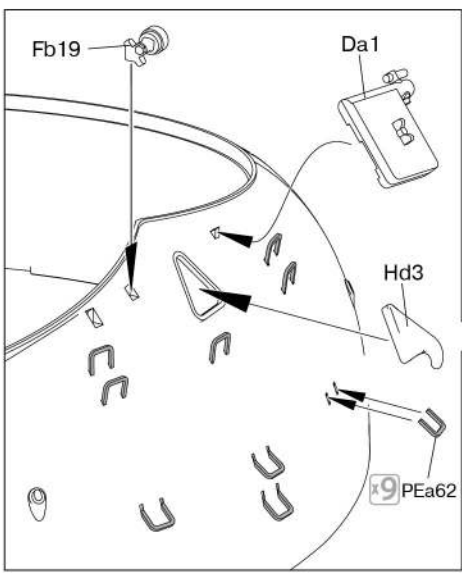

50

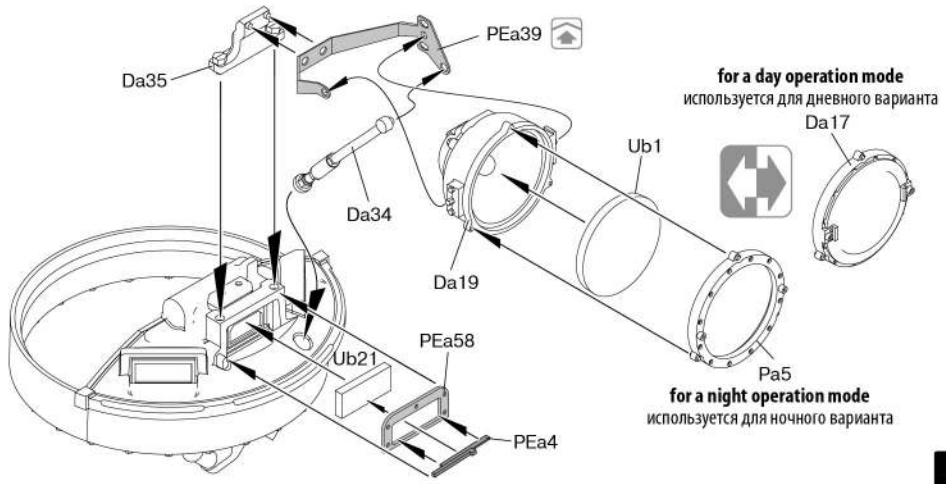
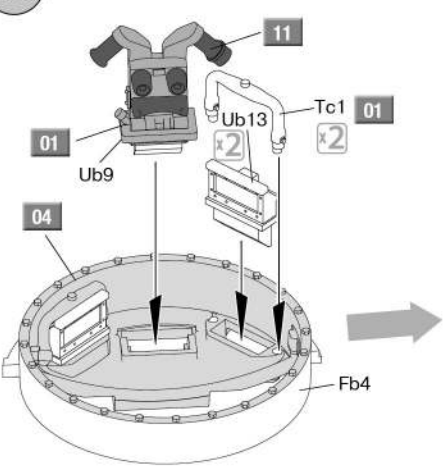

51

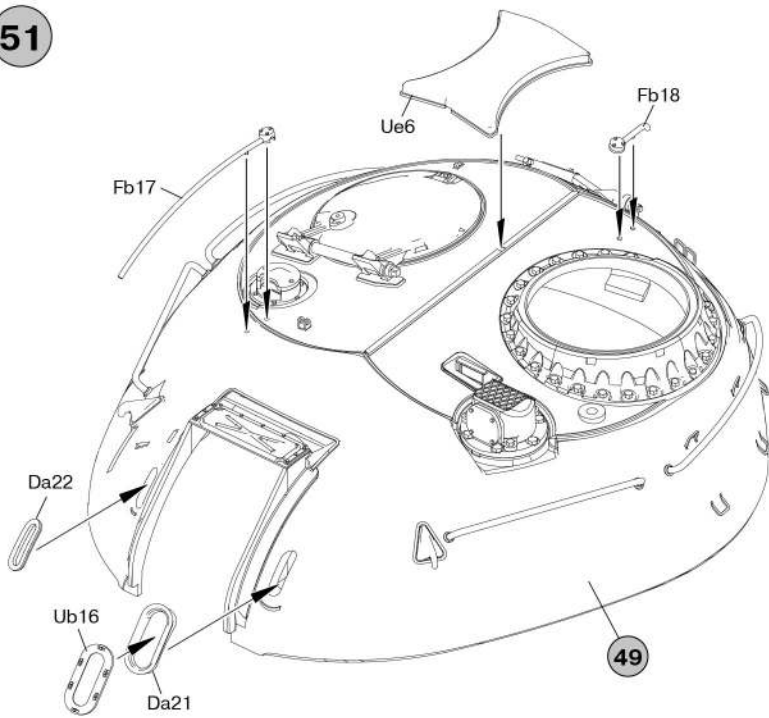

52

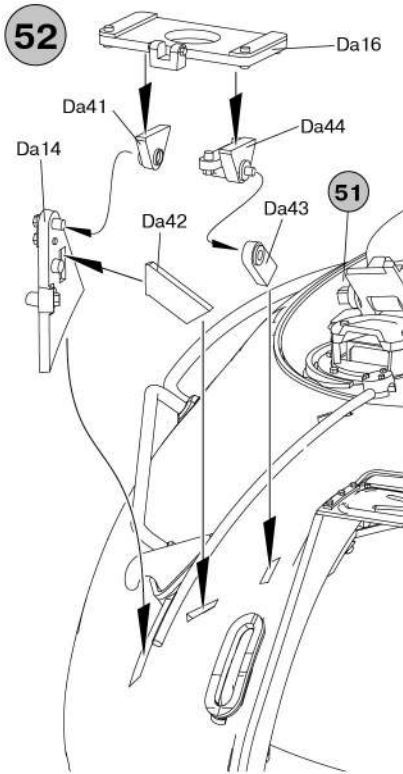

53

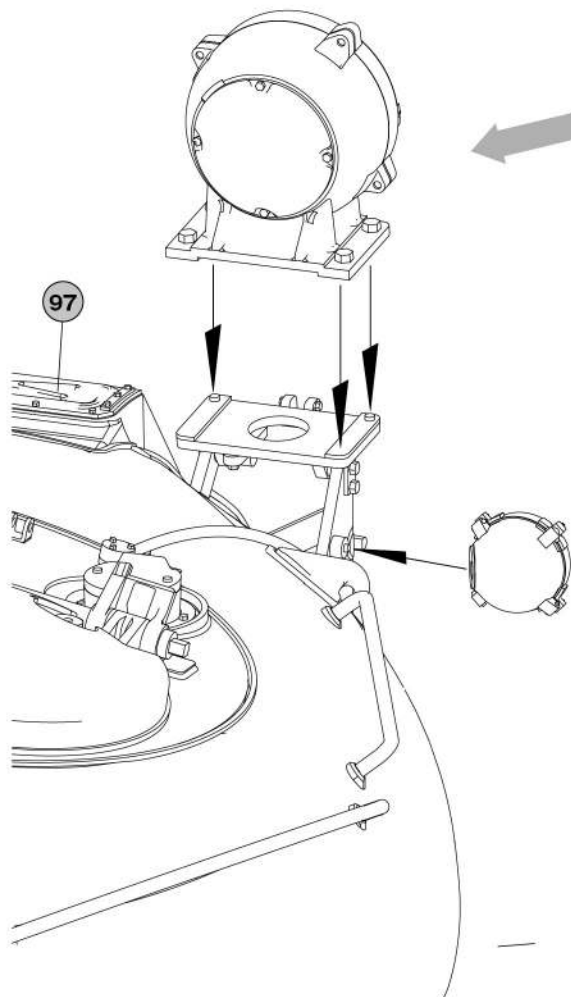

**for a day operation mode**  
используется для дневного варианта

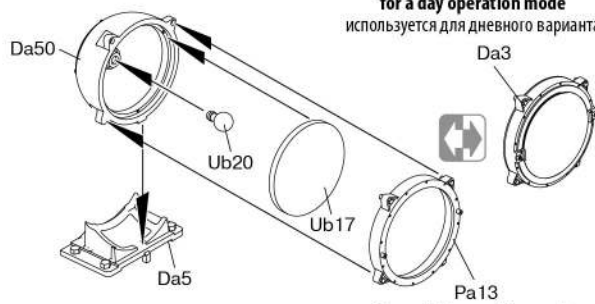

**for a night operation mode**  
используется для ночного варианта

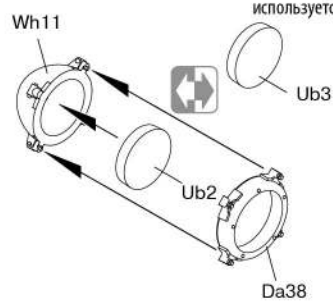

54

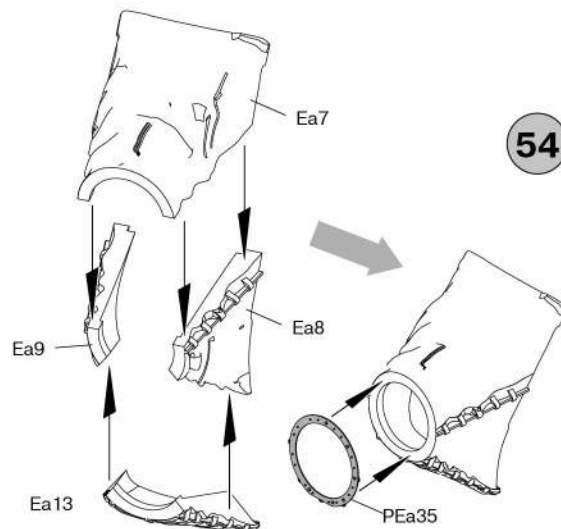

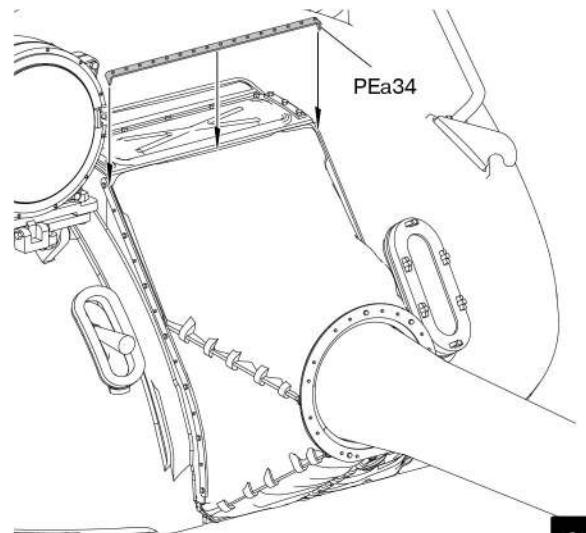
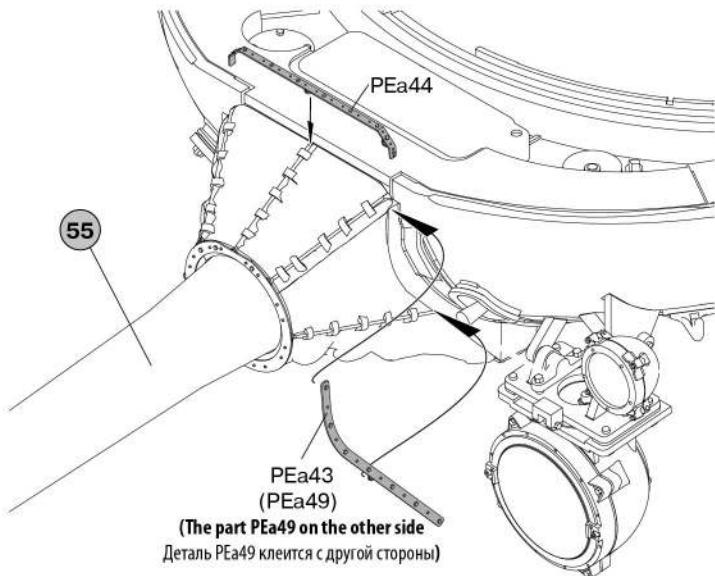
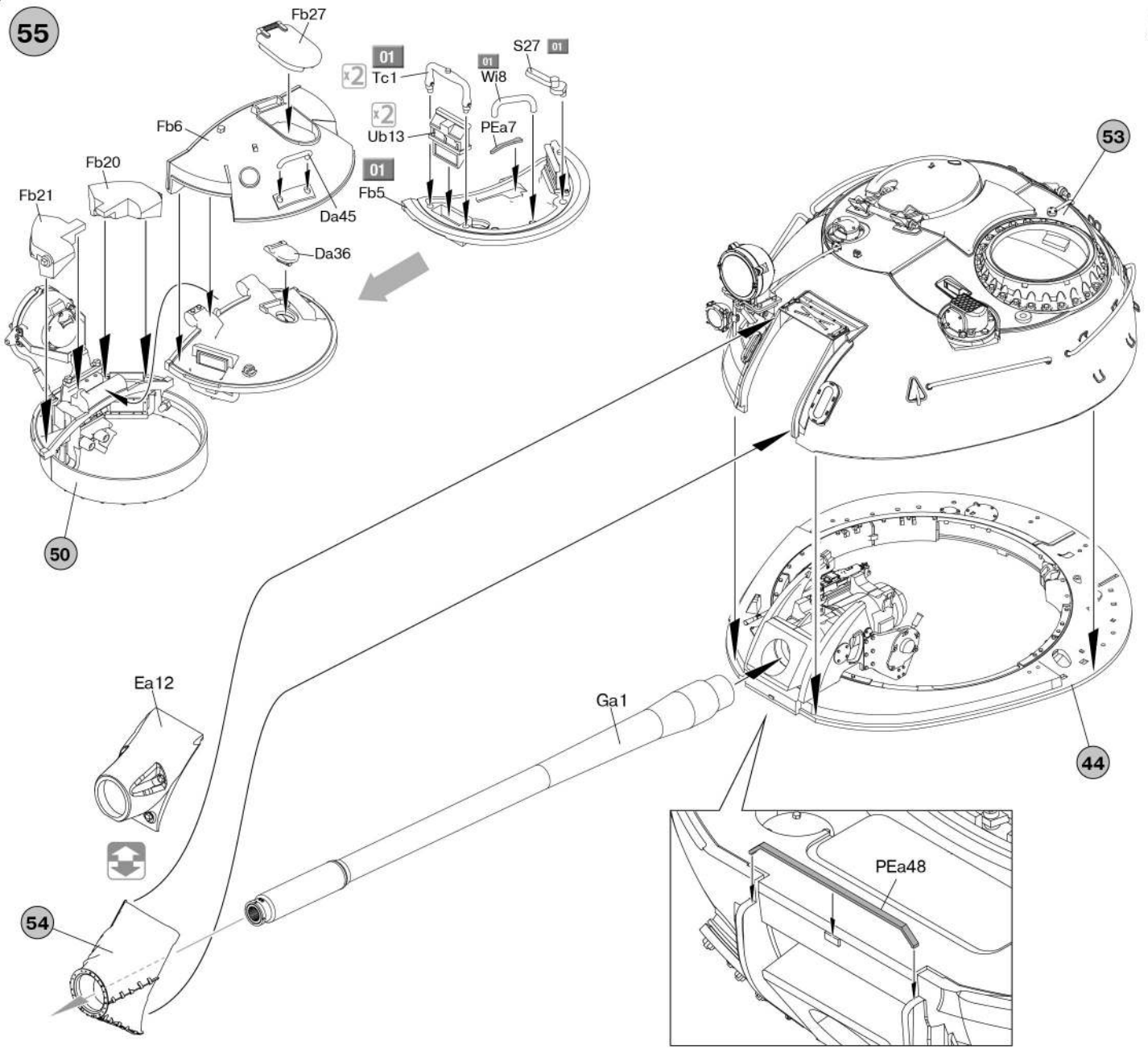

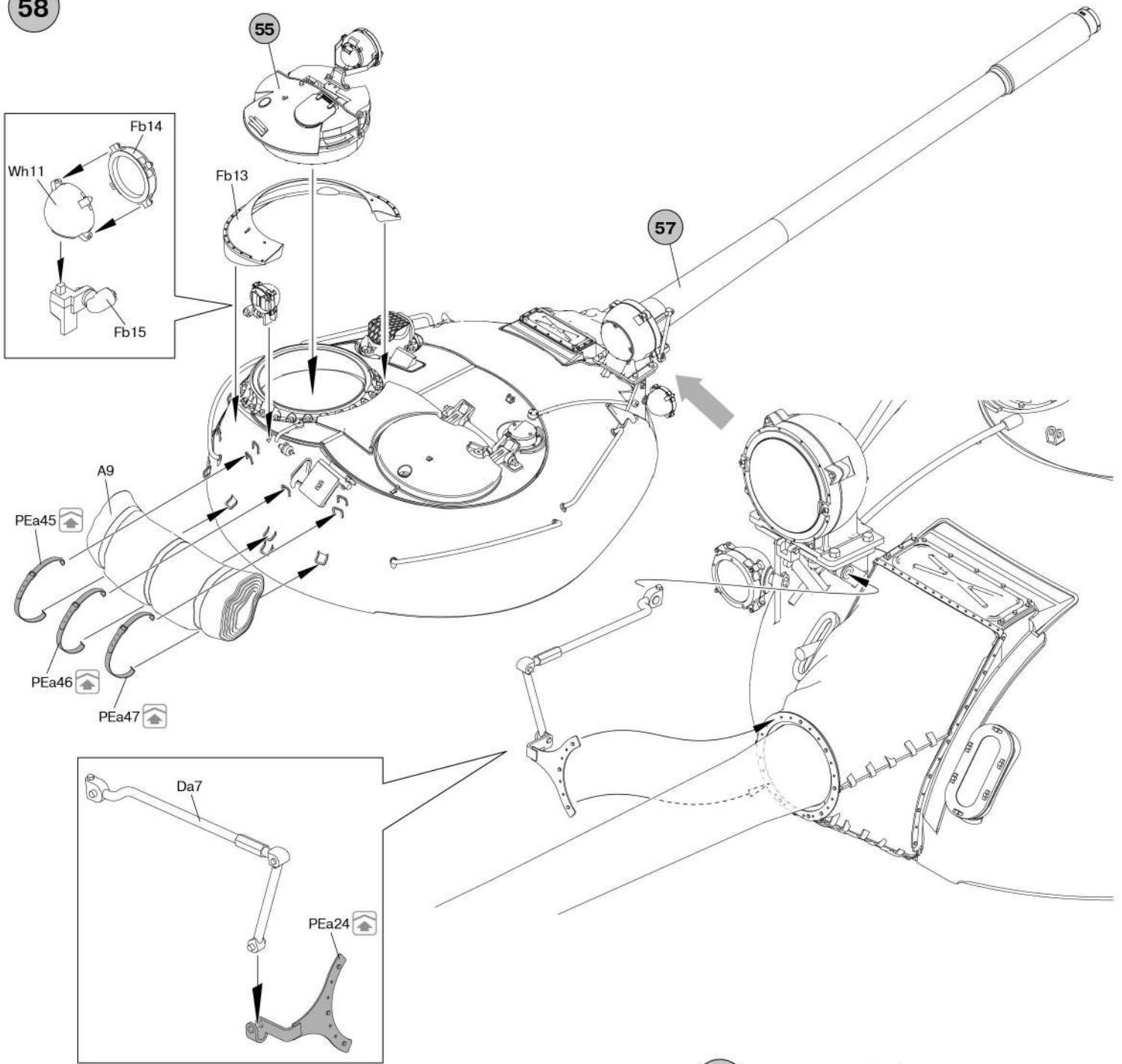

to select, see STEP 60  
 для выбора смотрите шаг 60

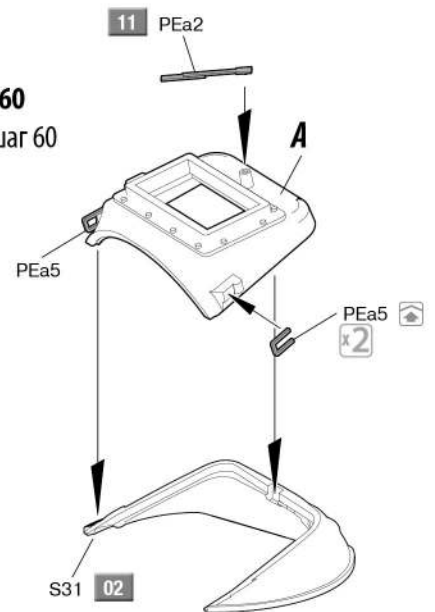
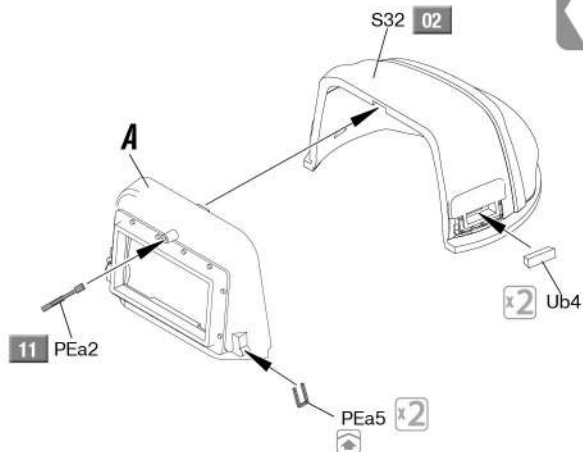
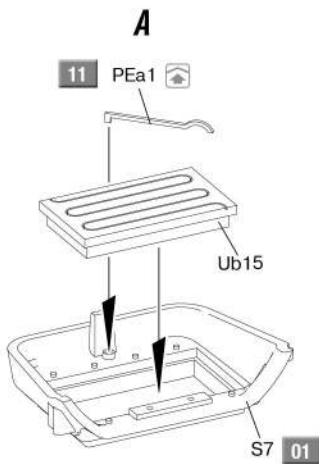

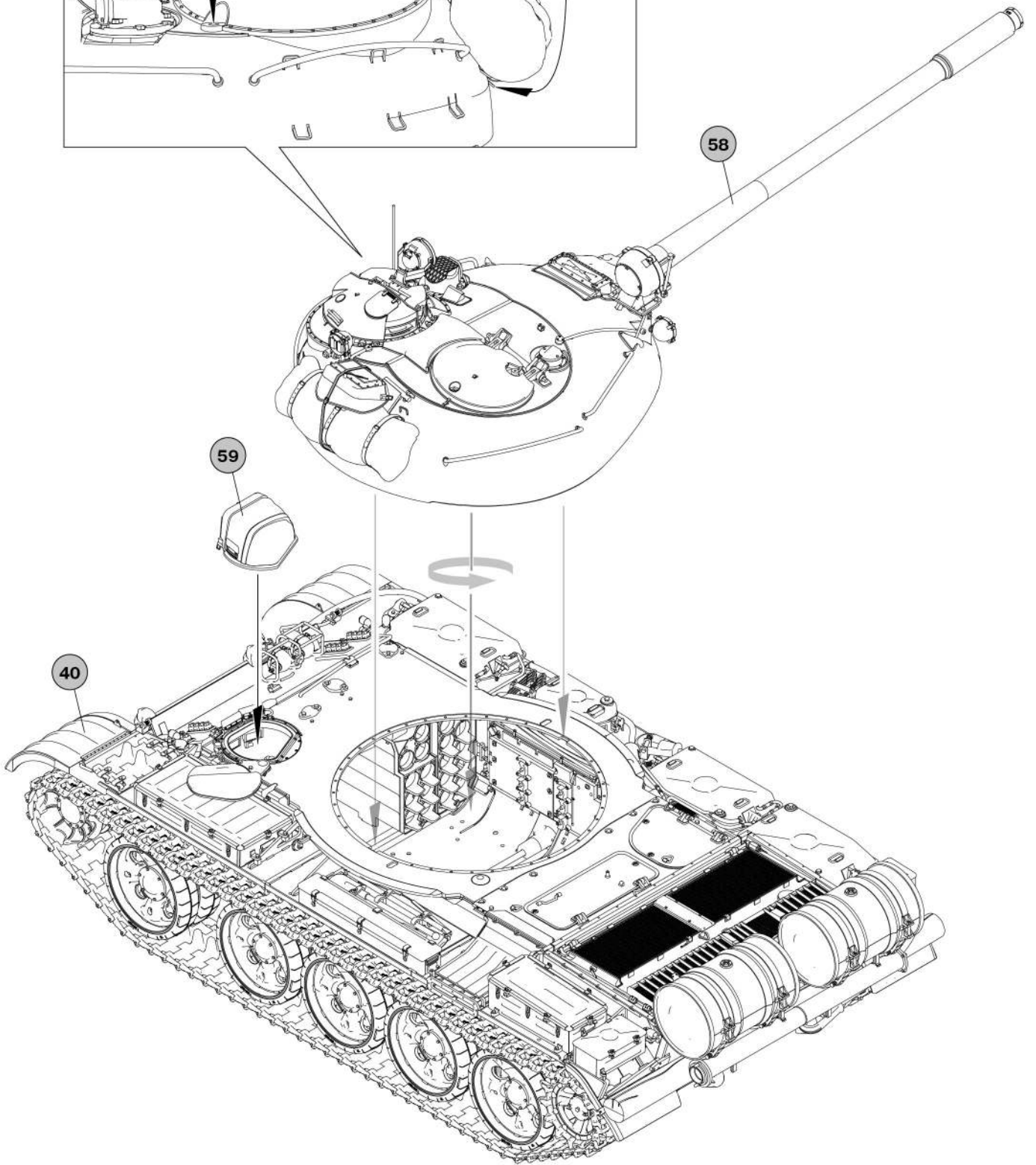
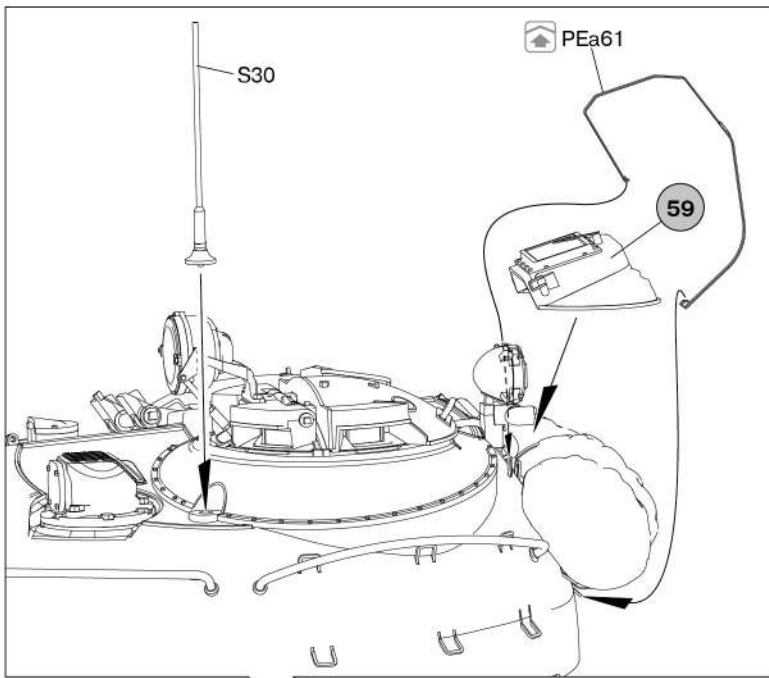

**55th Marine infantry Division, Pacific Fleet of the Soviet Navy, Ethiopia 1980.**  
 55-я дивизия морской пехоты Тихоокеанского флота ВМФ СССР, Эфиопия 1980 год.



**Yugoslav People's Army, 80's**  
 Югославская народная армия, 80-е годы.

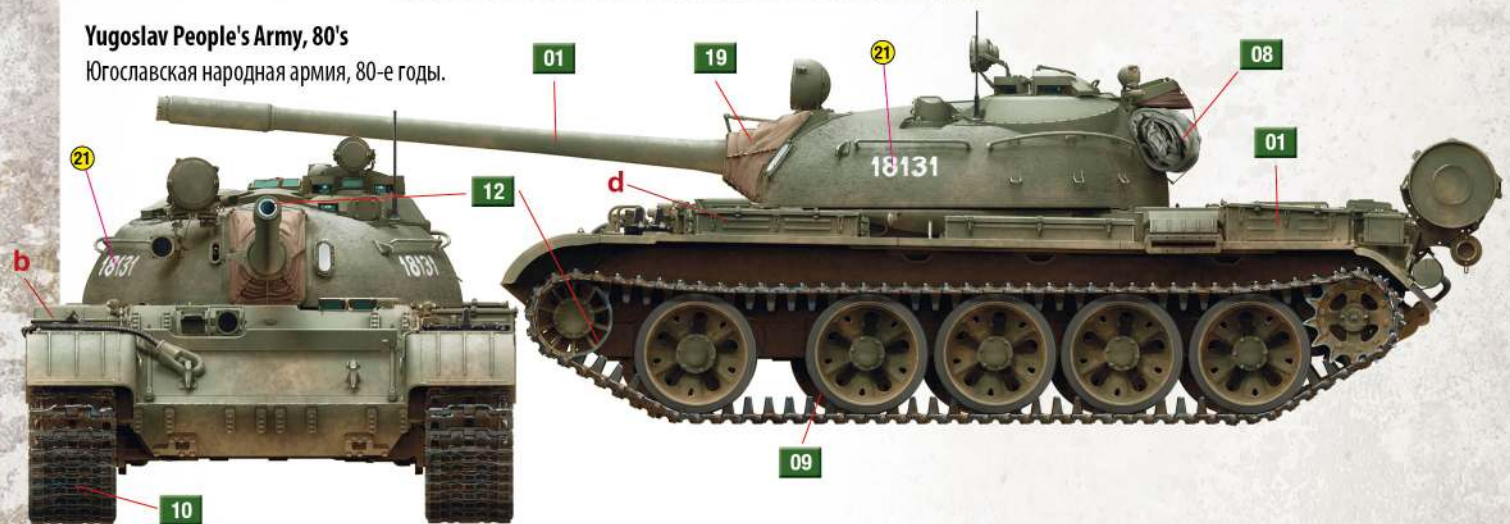

**Hungarian Army, 90's.**  
 Венгерская армия, 90-е годы.

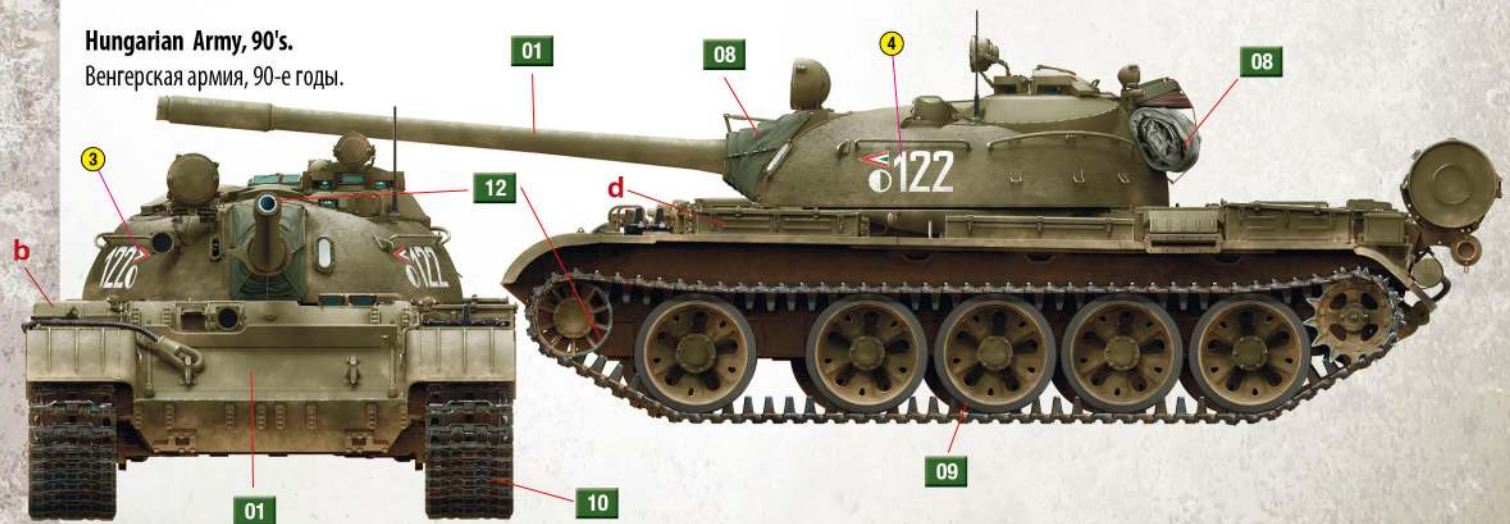

Soviet Army, 60-70s.  
Советская Армия, 60-70е годы.

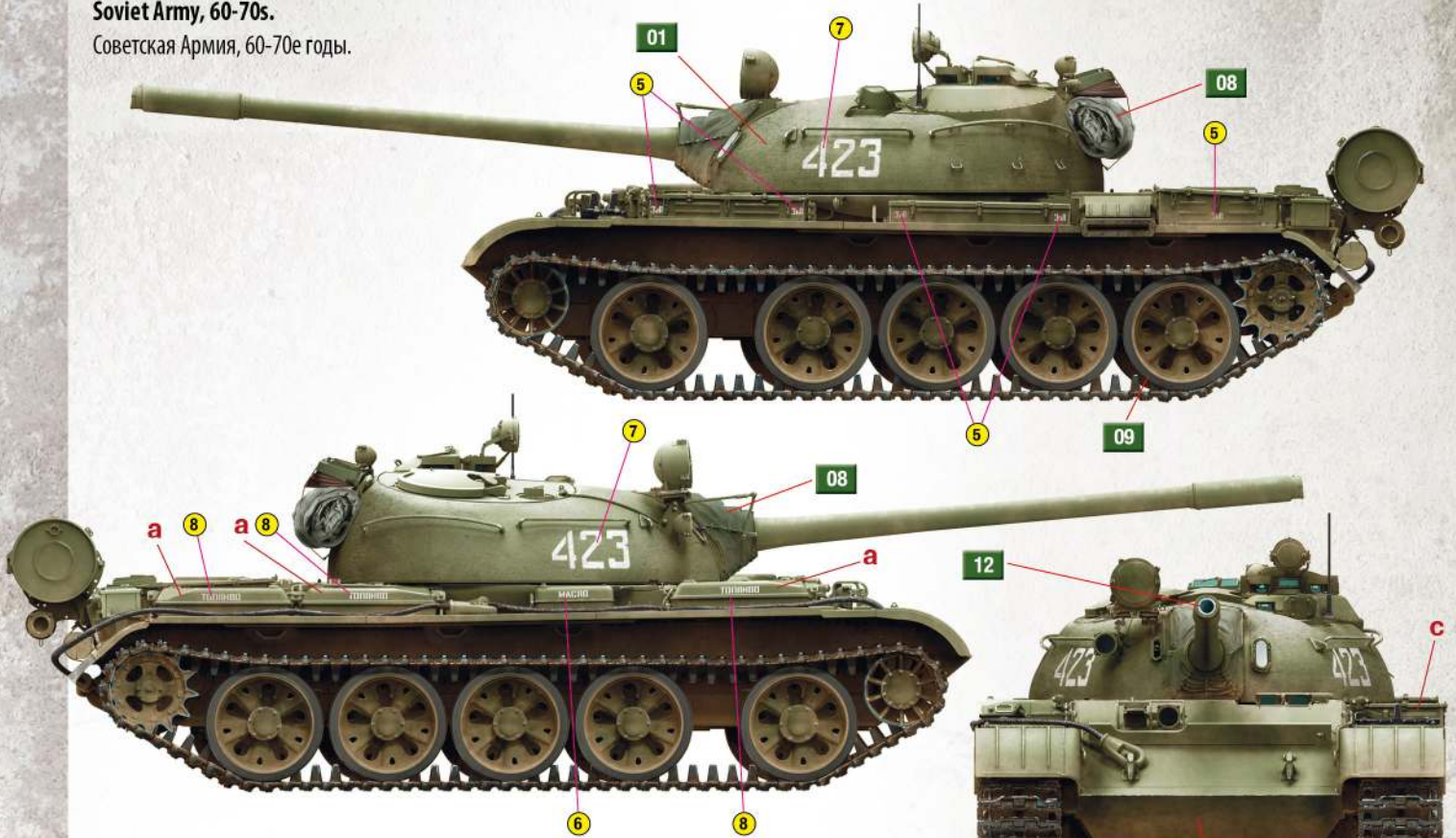

Hungarian People's Army. Operation "Danube".  
Prague, Czechoslovakia, August-September 1968.  
Венгерская Народная армия. Операция «Дунай».  
Прага, Чехословакия, август-сентябрь 1968 года.



Soviet military parade coloring, 60-70s.

Парадная окраска для Советской армии, 60-70е годы.



Somali Army, "Ogaden War", 1977.

Армия Сомали, «Война за Огаден», 1977 год.



Marine infantry of the Soviet Navy, 70s.

Морская пехота ВМФ СССР, 70-е годы.

