

G.W.H.[®]
LIMITED EDITION



ГАДАЦЬКИЙ АВІАПОЛК



Su-27UBM 
"FLANKER-C" IN DIGITAL CAMOUFLAGE
Su-27UBM "FLANKER-C" 乌克兰空军数码迷彩涂装限量版

ПС УКРАЇНИ
UKRAINIAN
AIR FORCE



1/48
SCALE **S4817**



B Part x 1

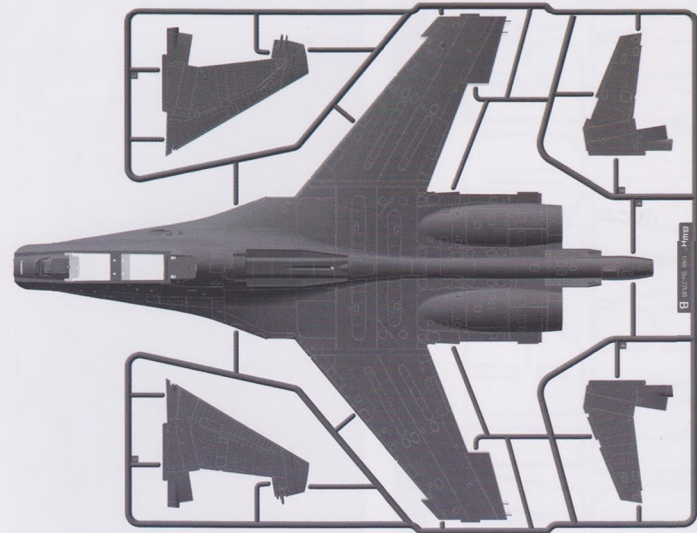

C Part x 1

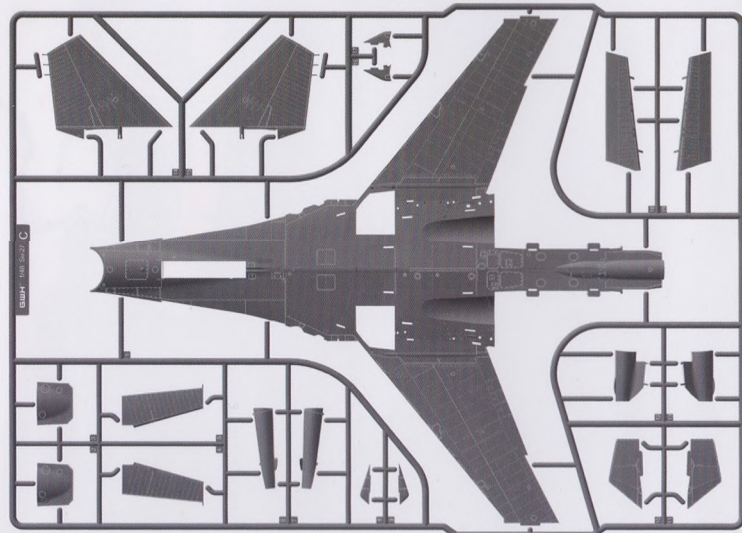

D-1 Part x 1



D-2 Part x 1



E Part x 1

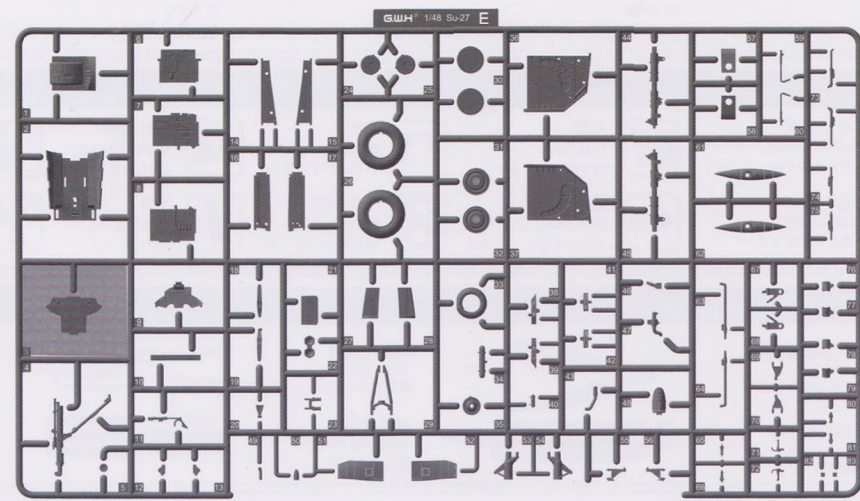

G Part x 1

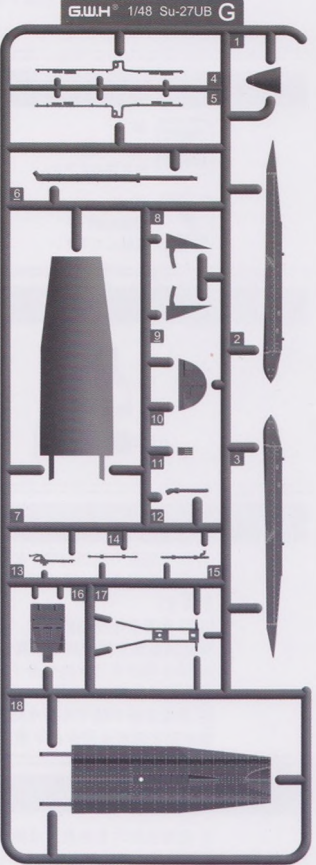

F Part x 1

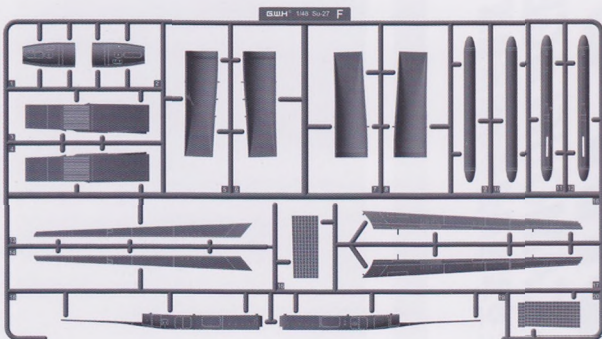

X Part x 1

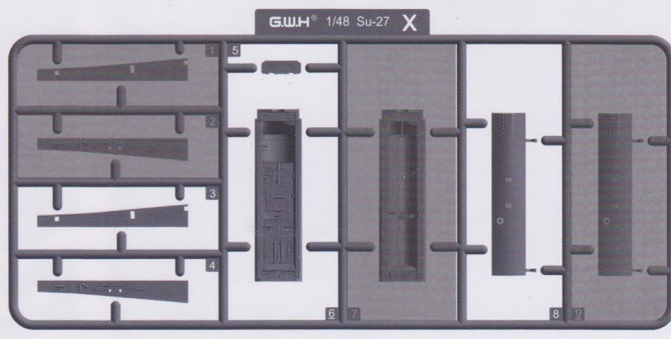

AKU-470 Part x 2

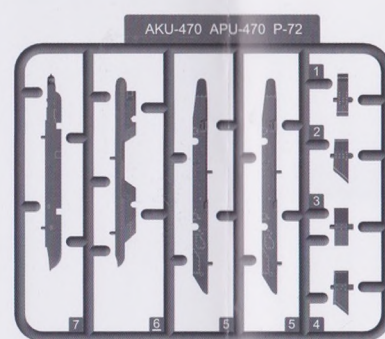

T Part x 2

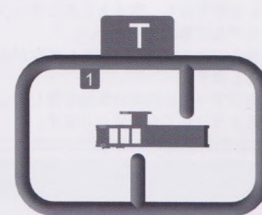

S Part x 2



R Part x 1



V1 Part x 1



W Part x 1



I Part x 2

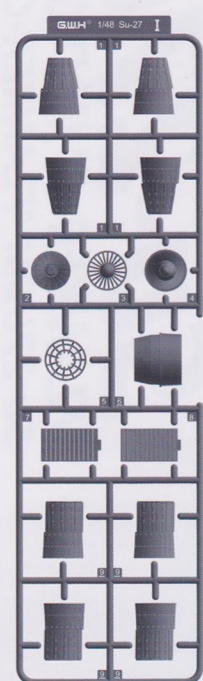

Q Part x 2

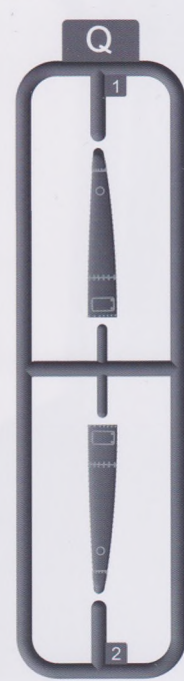

P Part x 2

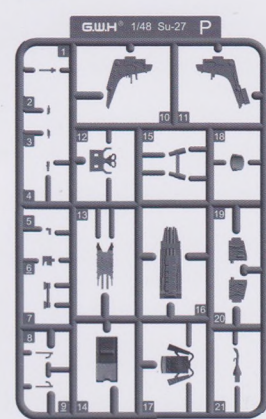

O Part x 1

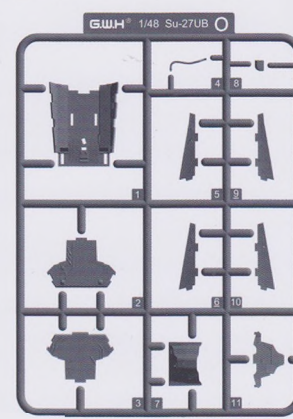

K Part x 1

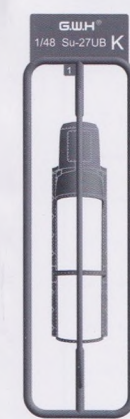

J Part x 1

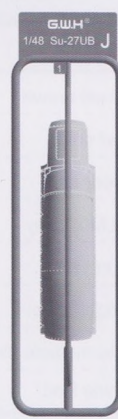

L Parts x 1

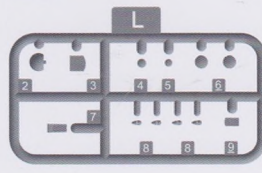

M Parts x 1



L-1 Parts x 1



Decal A

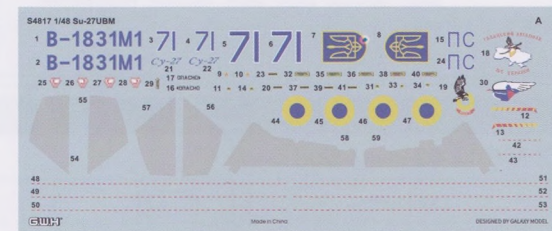

Decal D



Decal B

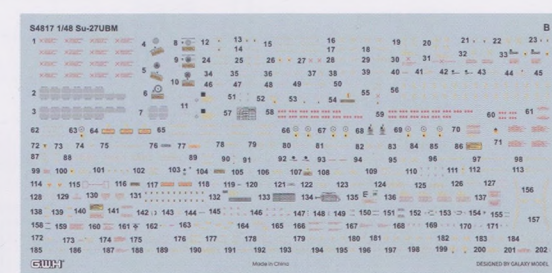

Decal E

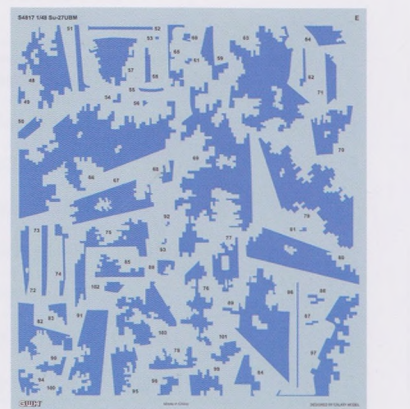

Decal C

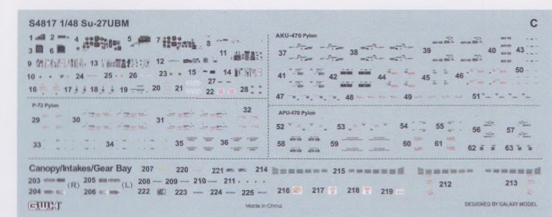

Film

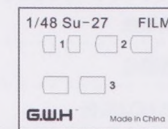

PE 1



PE 2

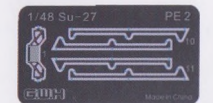

阴影零件不使用
DO NOT USE THE
SHADOW PARTS

1

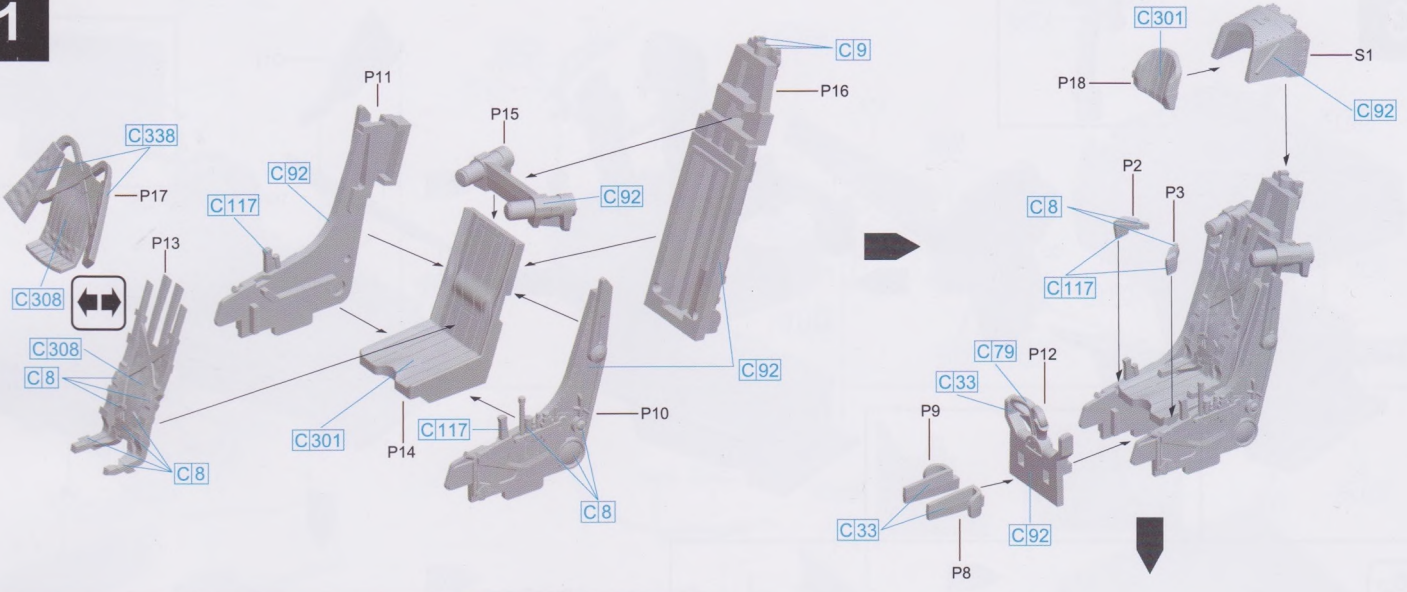

K-36DM Ejection Seat
K-36DM弹射座椅



x2

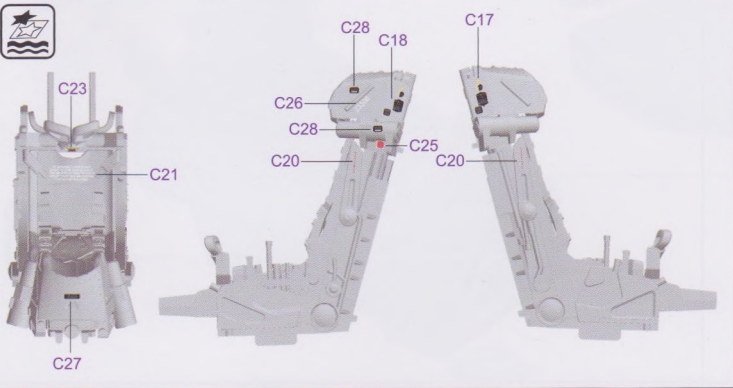

2

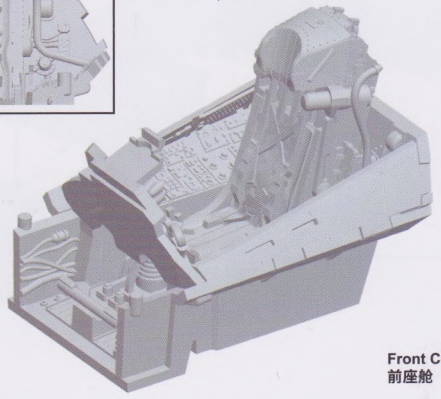
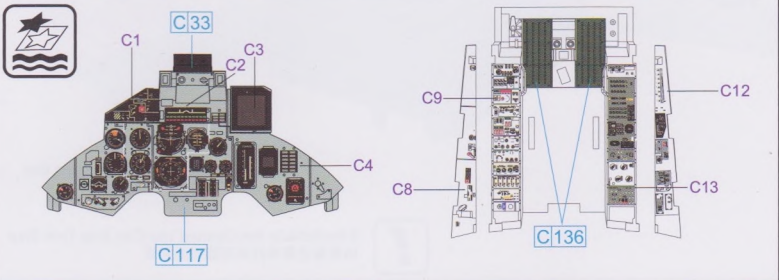
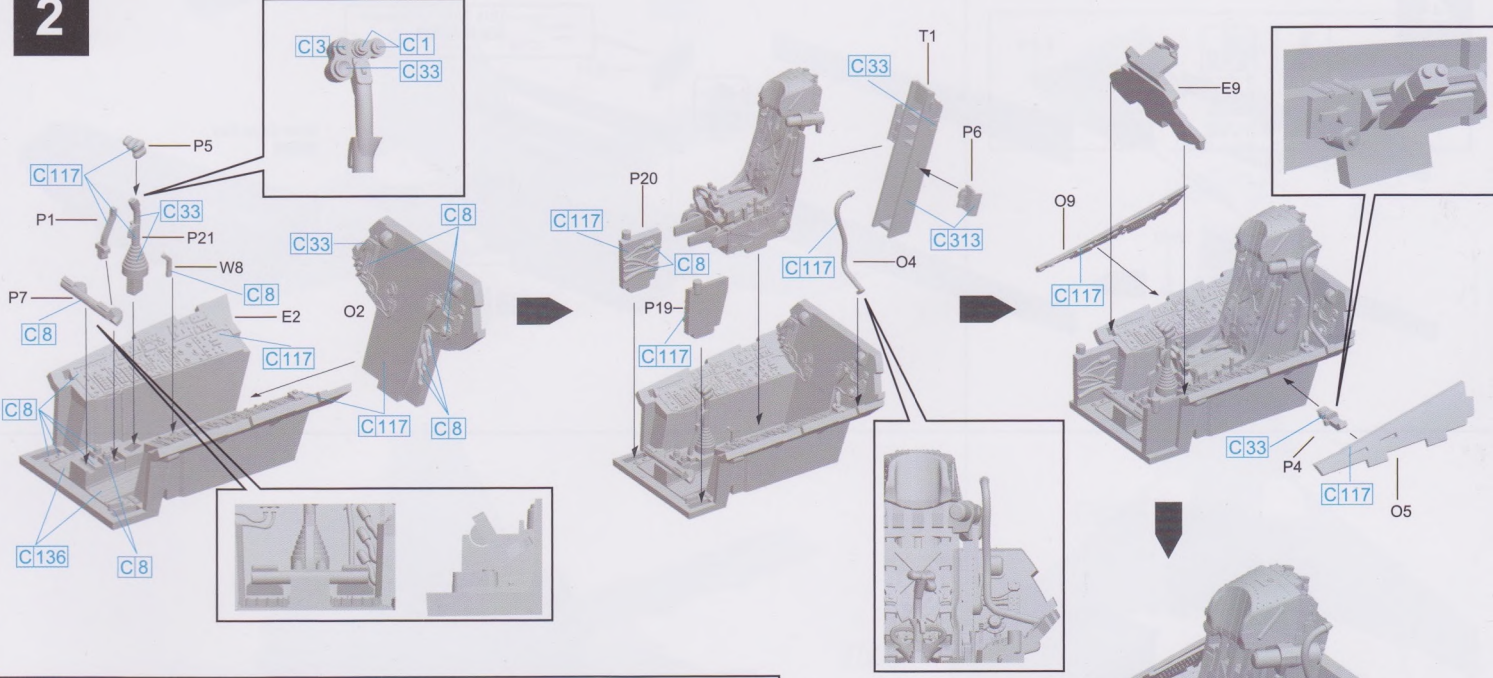

Front Cockpit
前座舱

3

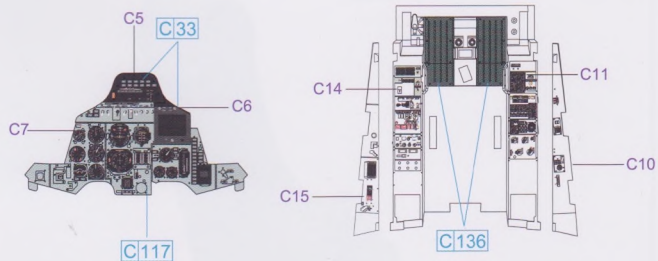
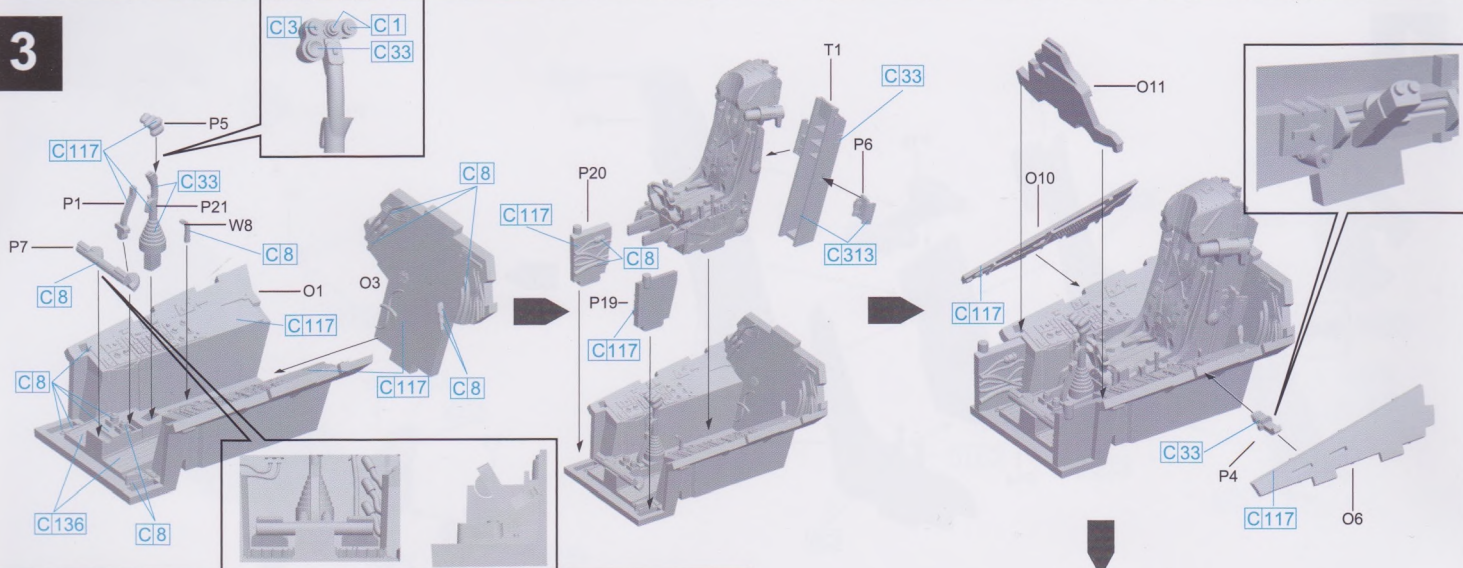

Rear Cockpit
后座舱

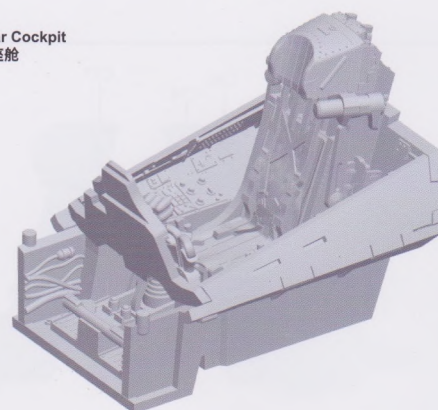

4

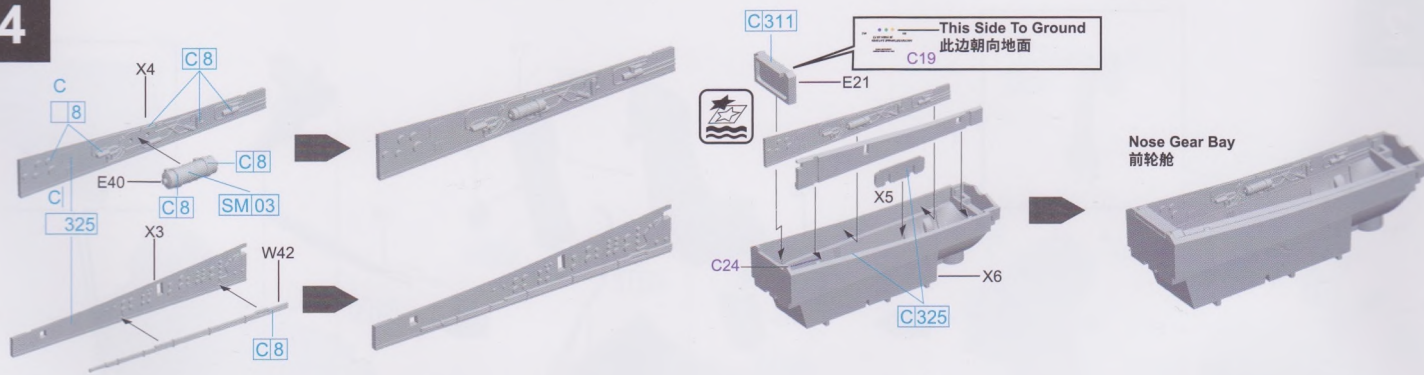

Nose Gear Bay
前轮舱

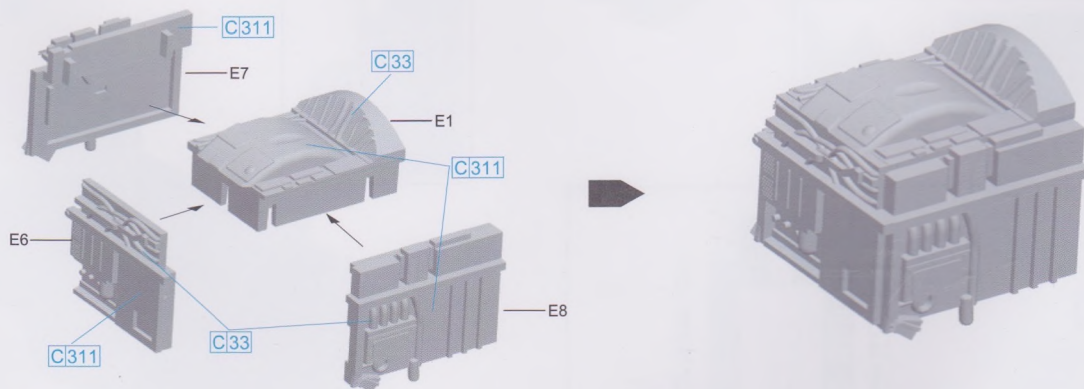

N001 Radar Equipment Box
N001 雷达维护设备



If Radome Is Not Opened You Can Skip This Step
如果雷达罩不打开可跳过此步骤

5

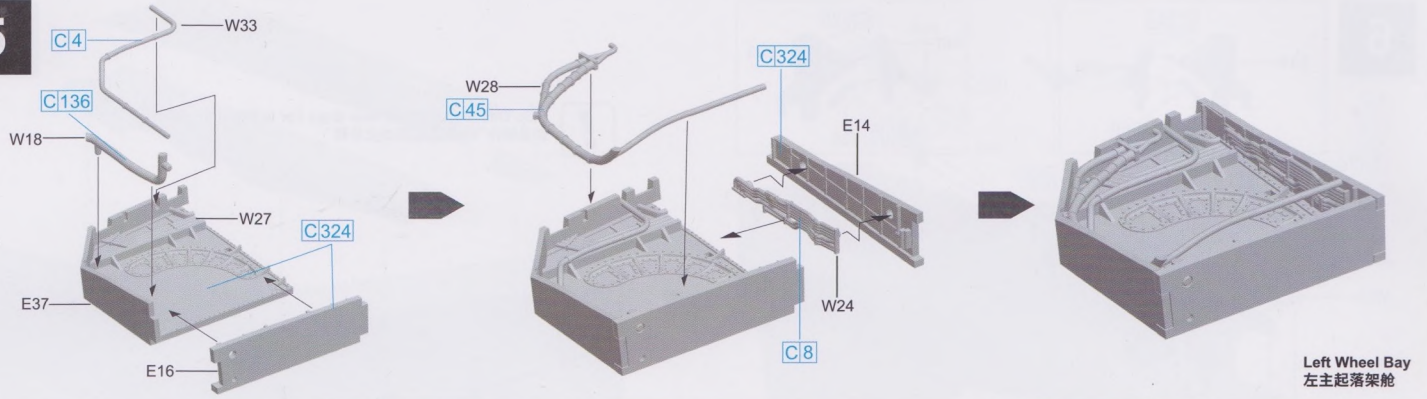

Left Wheel Bay
左主起落架舱

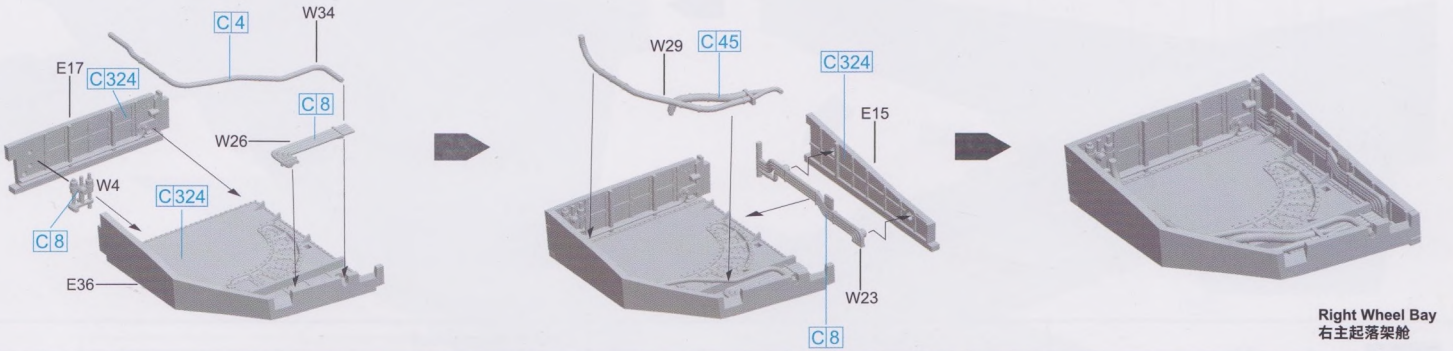

Right Wheel Bay
右主起落架舱

5

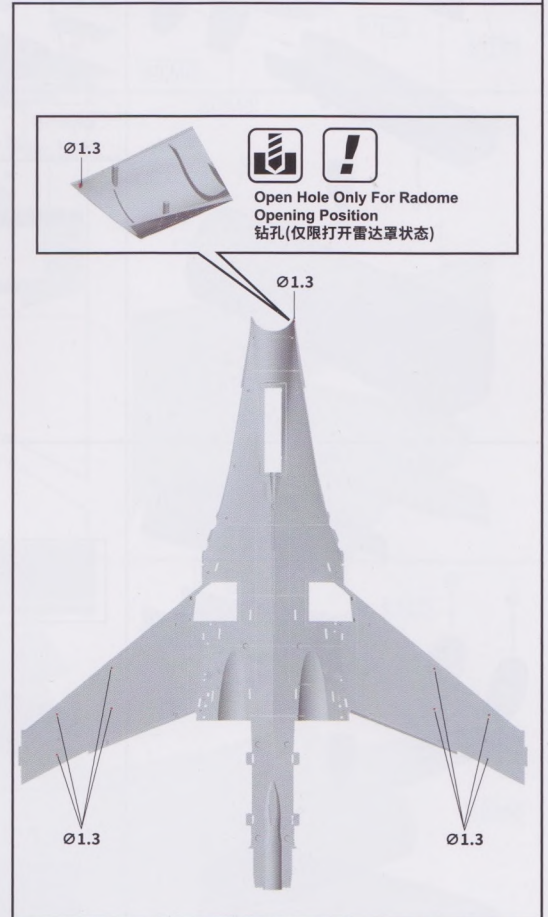
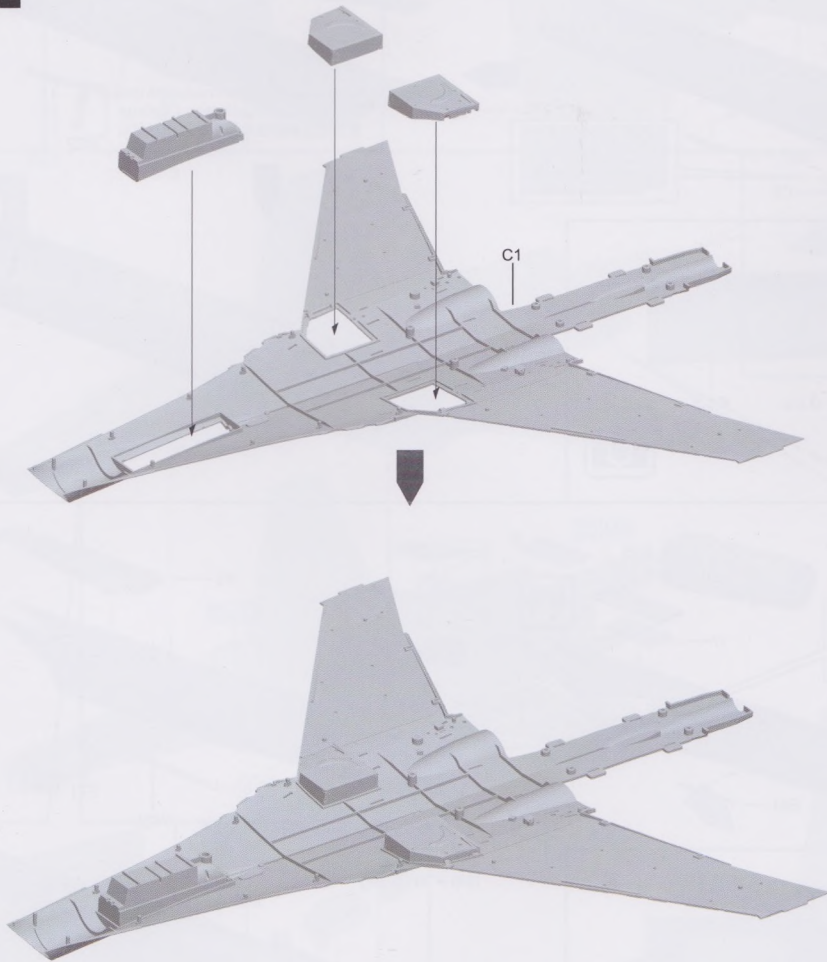

6

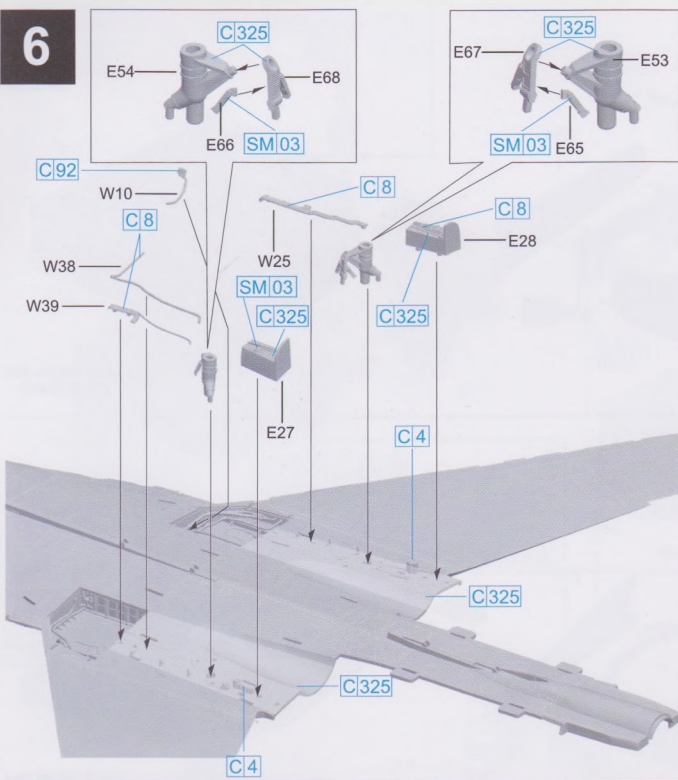

Skip This Step If Close Gear Bays For In Flight Position
如果制作飞行状态则跳过此步骤



7

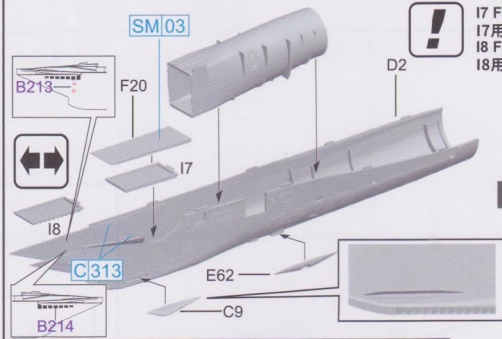
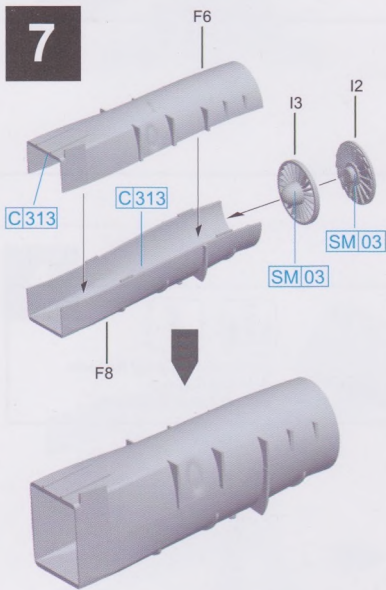

! 17 For Parking Position
17用于驻机状态
18 For Inflight Position
18用于飞行状态

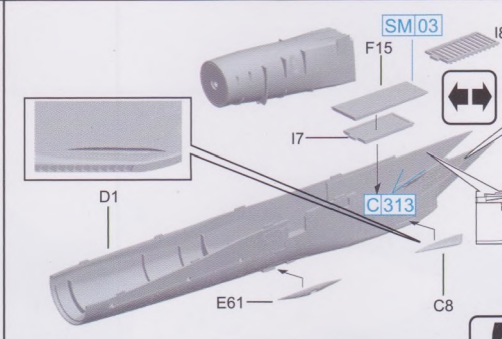
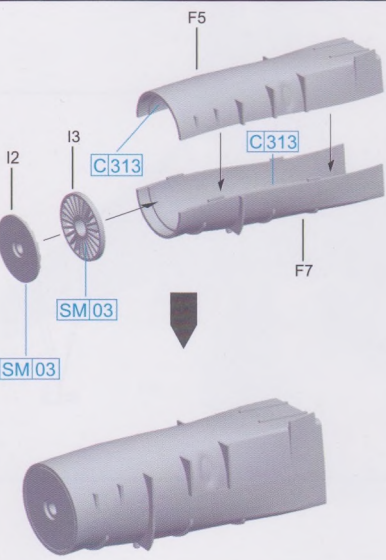
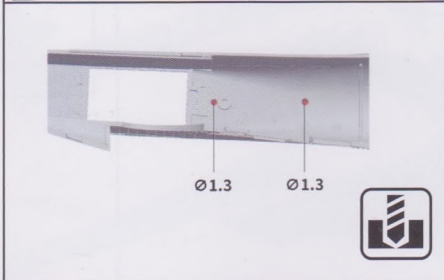
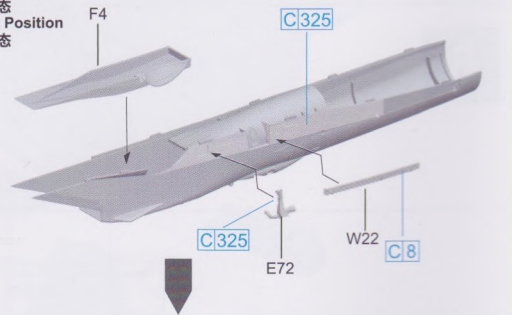

! 17 For Parking Position
17用于驻机状态
18 For Inflight Position
18用于飞行状态

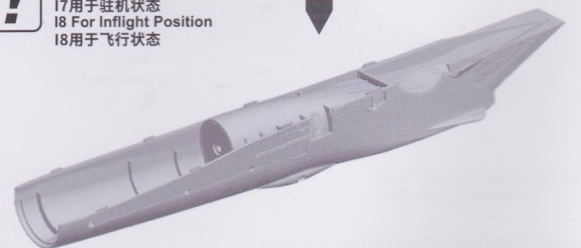
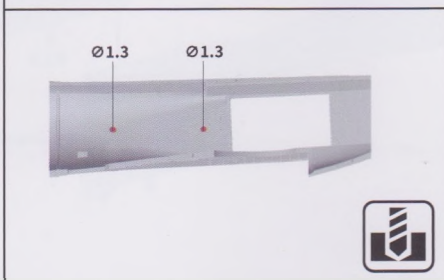
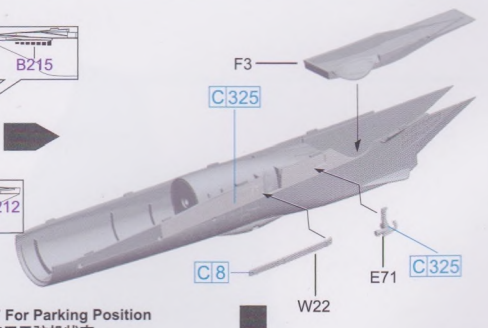

8

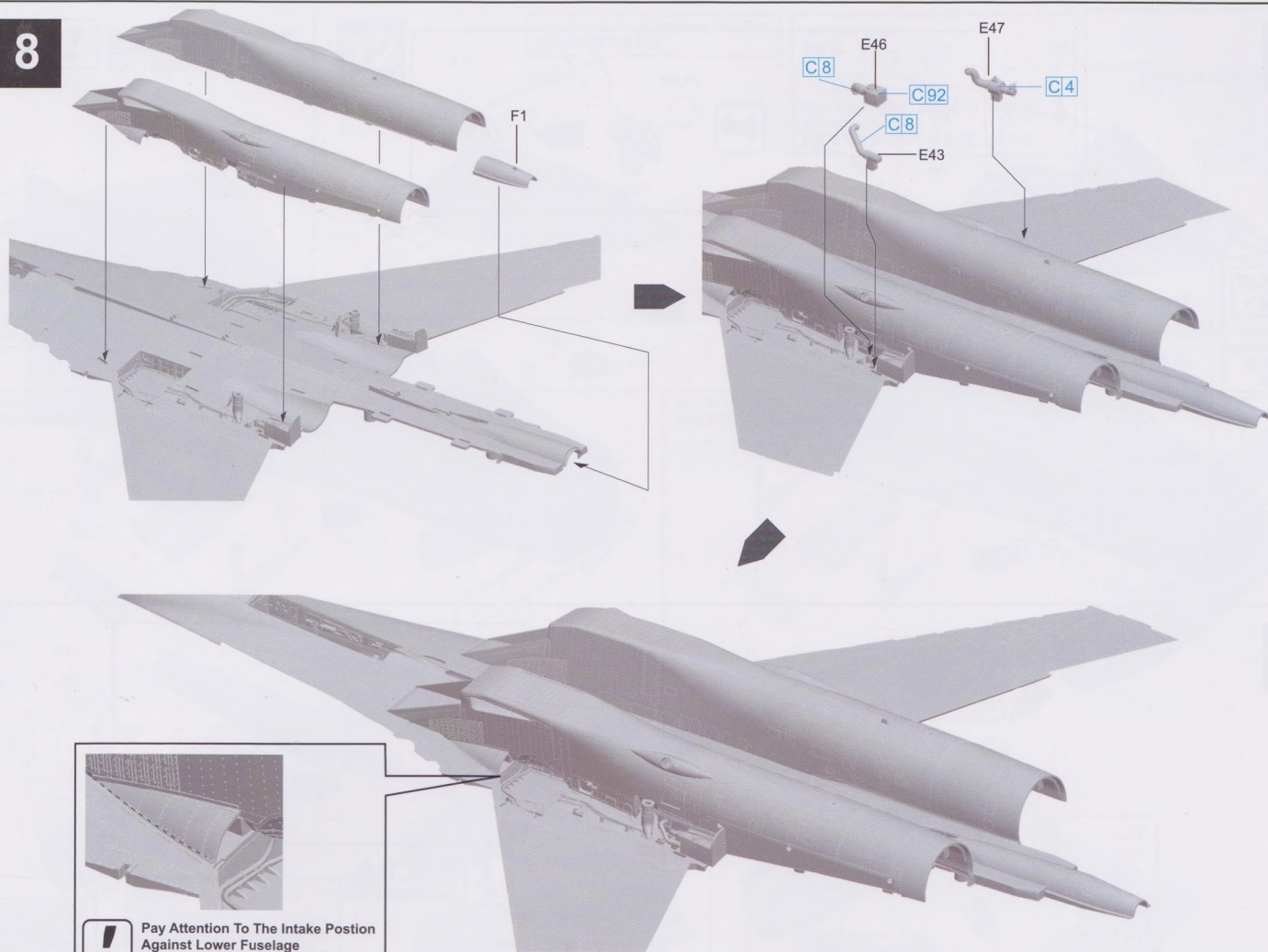

! Pay Attention To The Intake Position Against Lower Fuselage
注意进气道与下机身的相对配位置

9

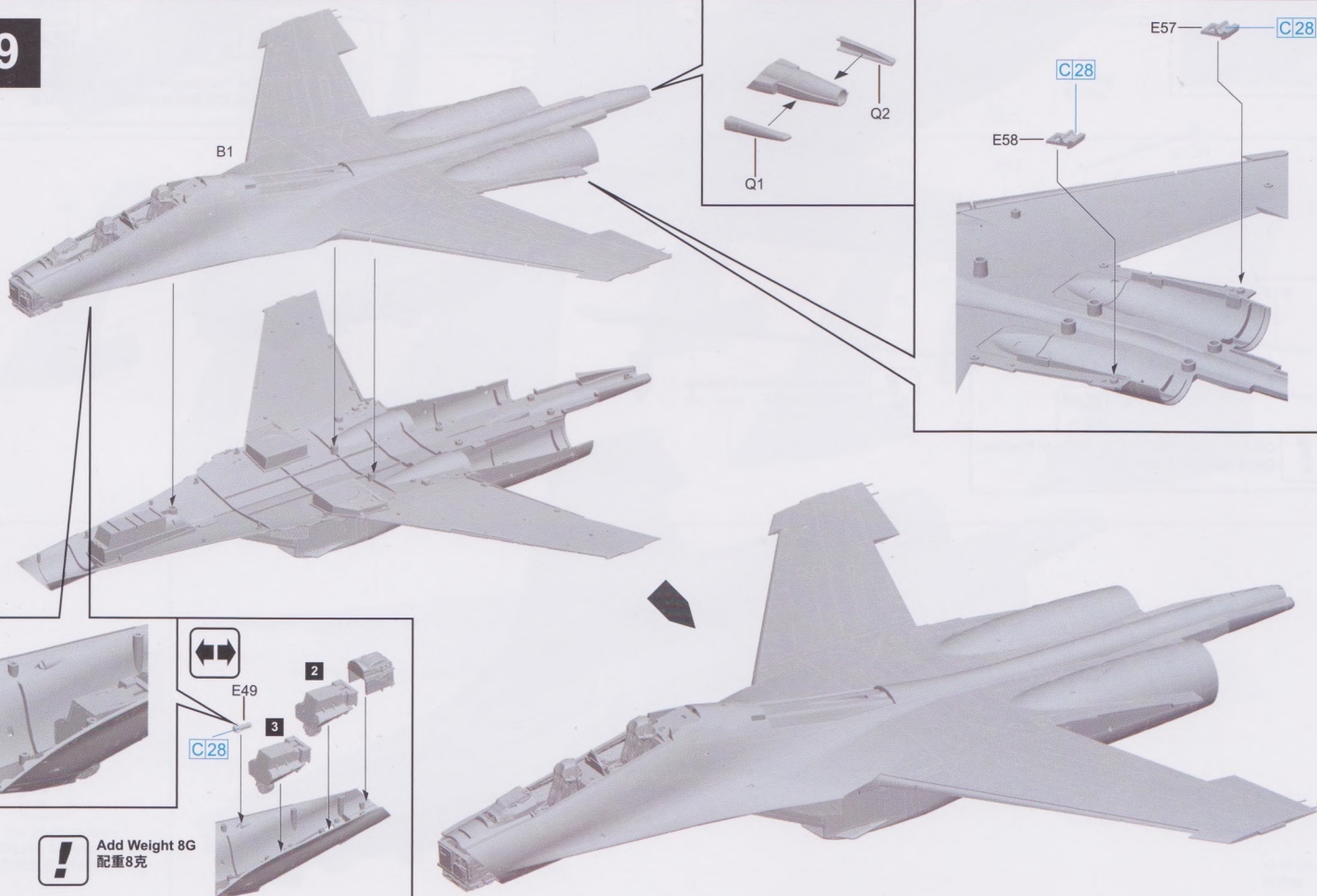

! Add Weight 8G
配重8克

10

! **✂**
Cut The Hinges To Close Radome
 切去定位插栓用于关闭雷达罩

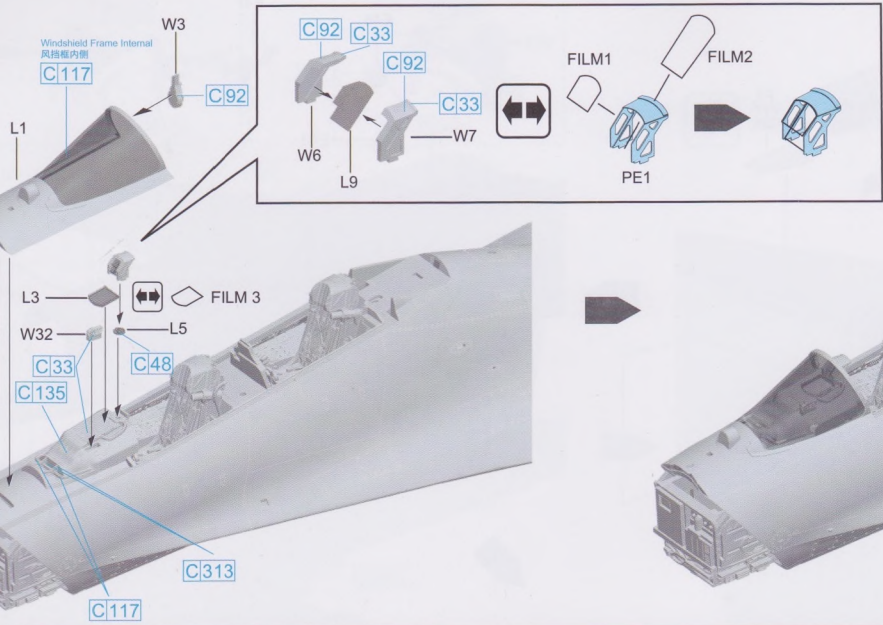

11

! **✂**
Cut The Hinges For Slat Up (Inflight Position)
 切去定位插栓用于收起状态/飞行状态

! **Downwards When Parking**
 驻机状态时朝下

! **Cut The Hinges For Slat Up (Inflight Position)**
 切去定位插栓用于收起状态/飞行状态

! **Downwards When Parking**
 驻机状态时朝下

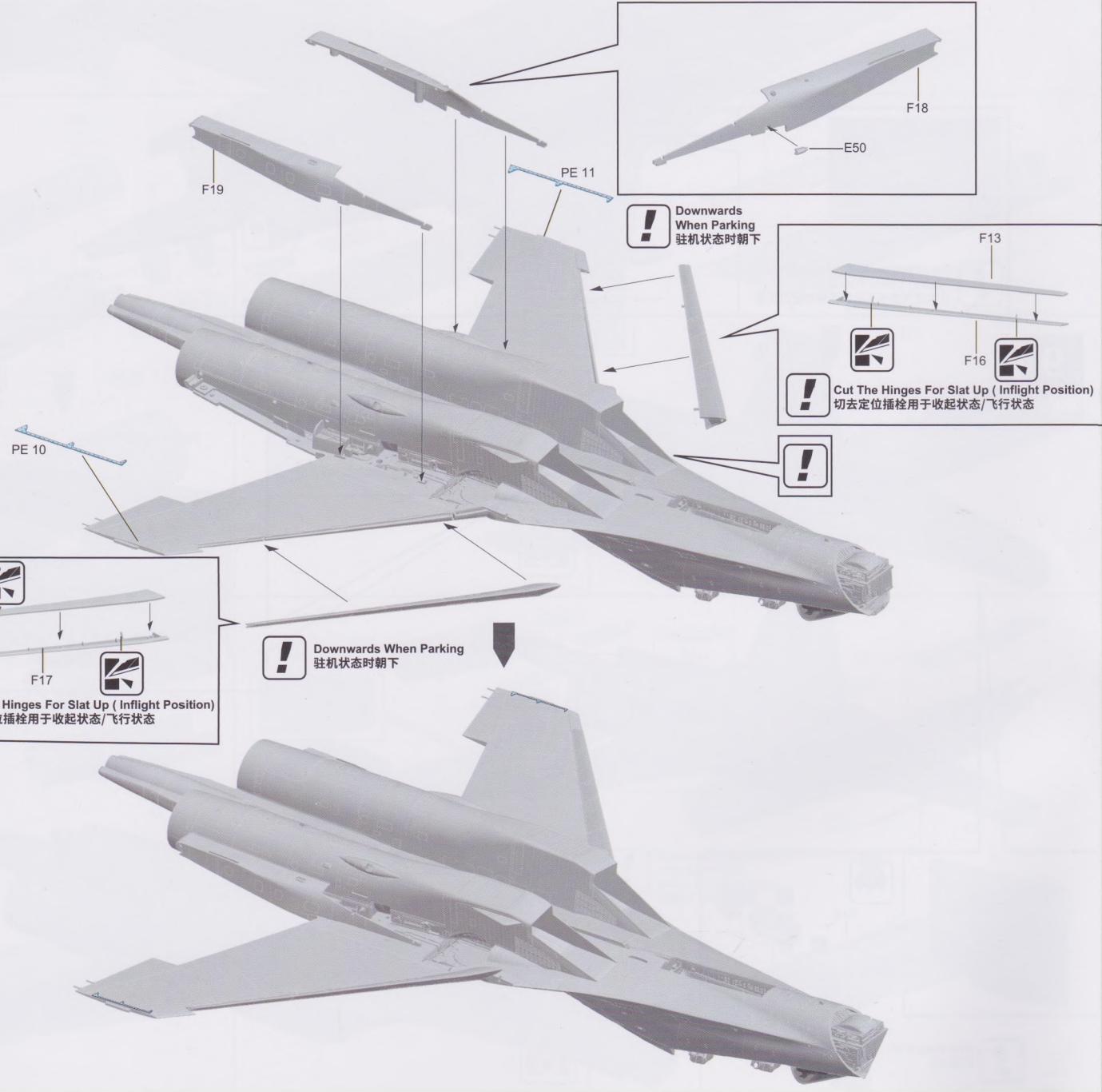



Open Hole Only For Radome Opening Status
 钻孔 (仅限打开雷达罩状态)

12

Only For Radome Opening Position
 仅限打开雷达罩状态

Left Side View
 左侧视

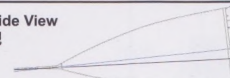

Pitot Tube Has 3 Degree Up Against radome center line
 空速管与雷达罩中心线呈3度上翘夹角

SM08

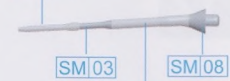

SM03

SM08

Fuselage Camo Color
 机腹迷彩色

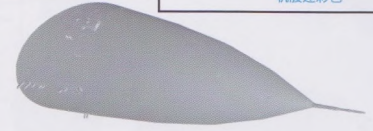
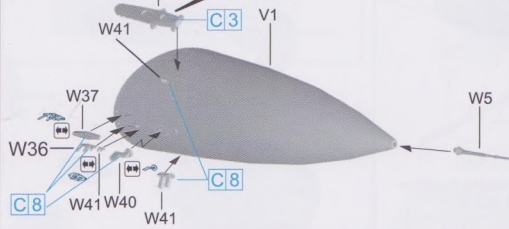

Radome
 雷达罩

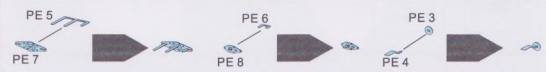

Do not Use G8 G9 Parts If Close Canopy
 如果关闭座舱盖则无需使用G8 G9 零件

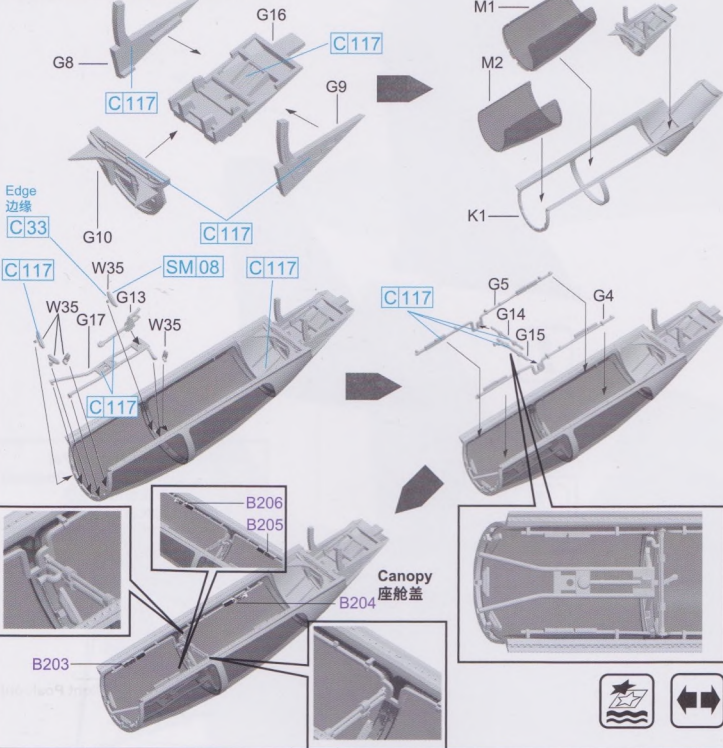

Do not Use G8 G9 Parts If Close Canopy
 如果关闭座舱盖则无需使用G8 G9 零件

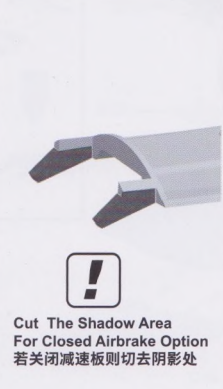
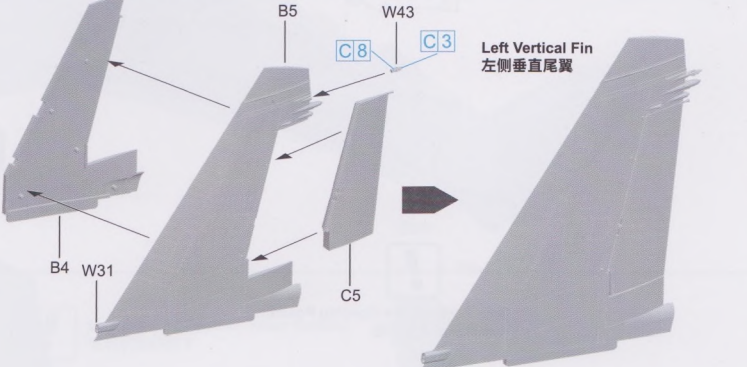
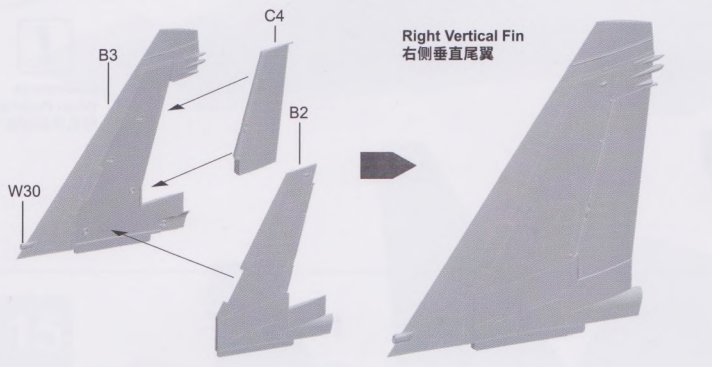
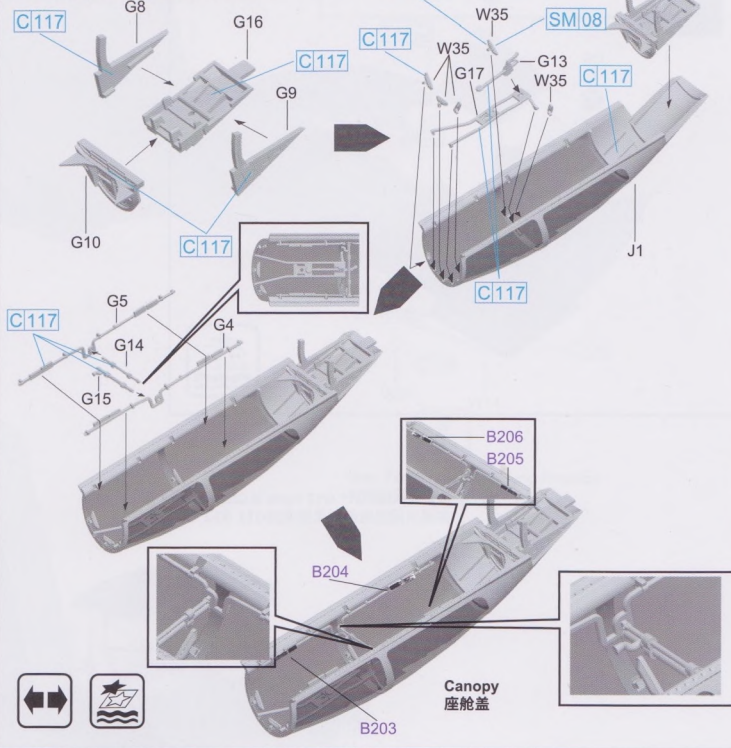

Cut The Shadow Area
 For Closed Airbrake Option
 若关闭减速板则切去阴影处



Airbrake
 减速板

12

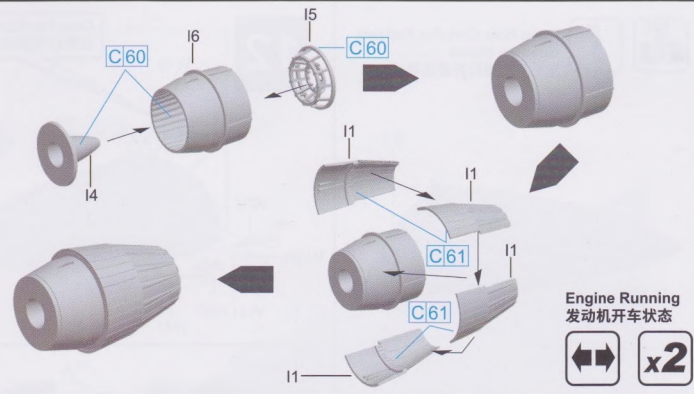
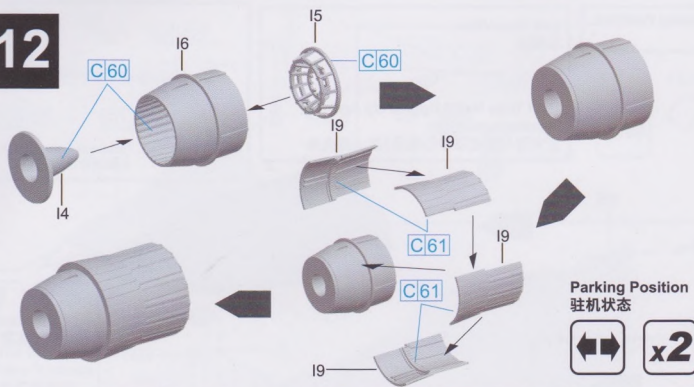

13

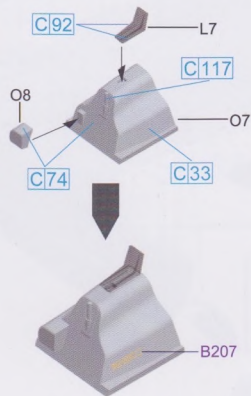

! Do not Use G11 G12 Parts If Close Canopy
如果关闭座舱盖则无需使用G11 G12 零件

! Downwards
When Parking
驻机状态时朝下

! Cut The Hinges For
Slat Up (Inflight Position)
切去定位插栓用于
收起状态/飞行状态

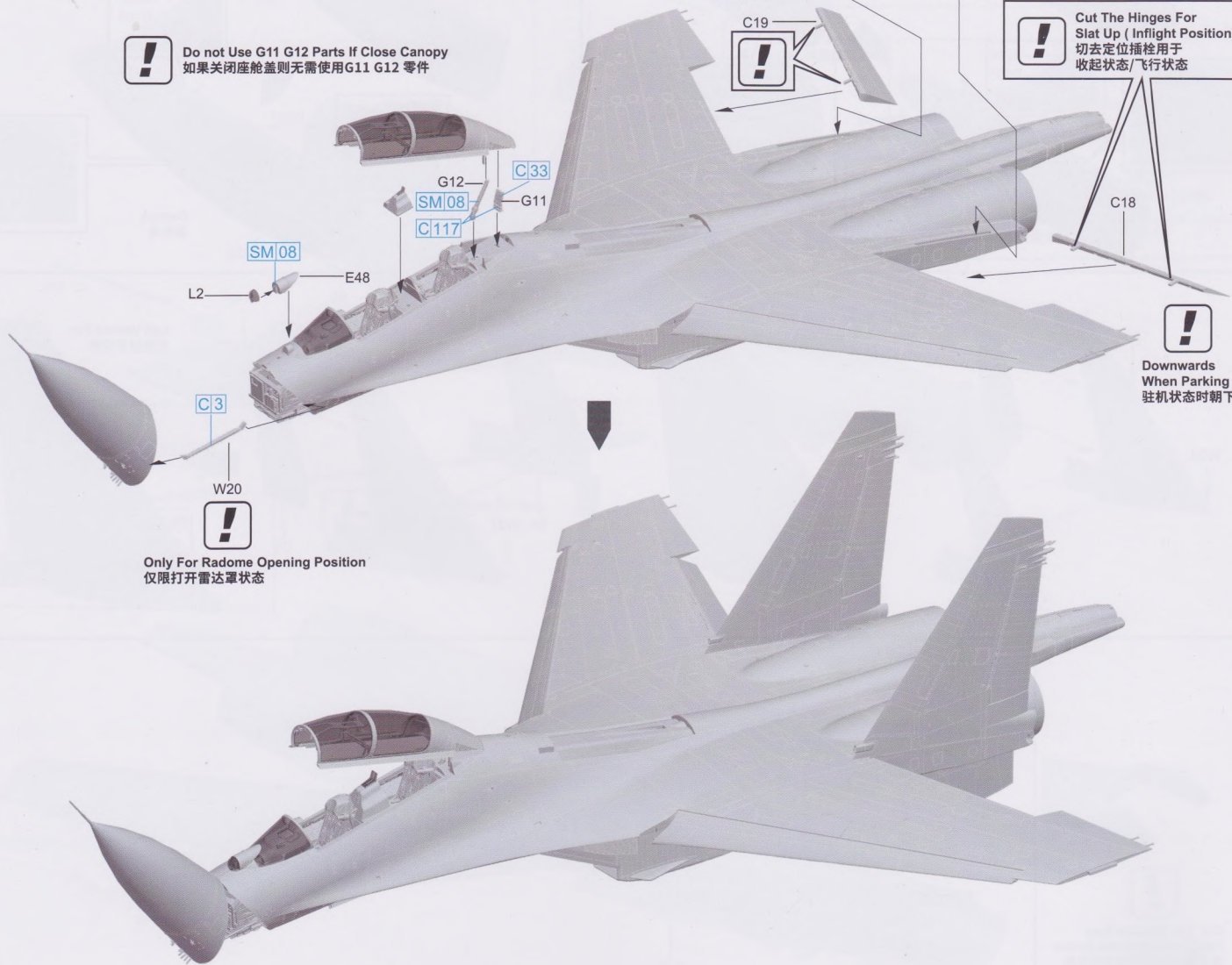

! Only For Radome Opening Position
仅限打开雷达罩状态

! Downwards
When Parking
驻机状态时朝下

14

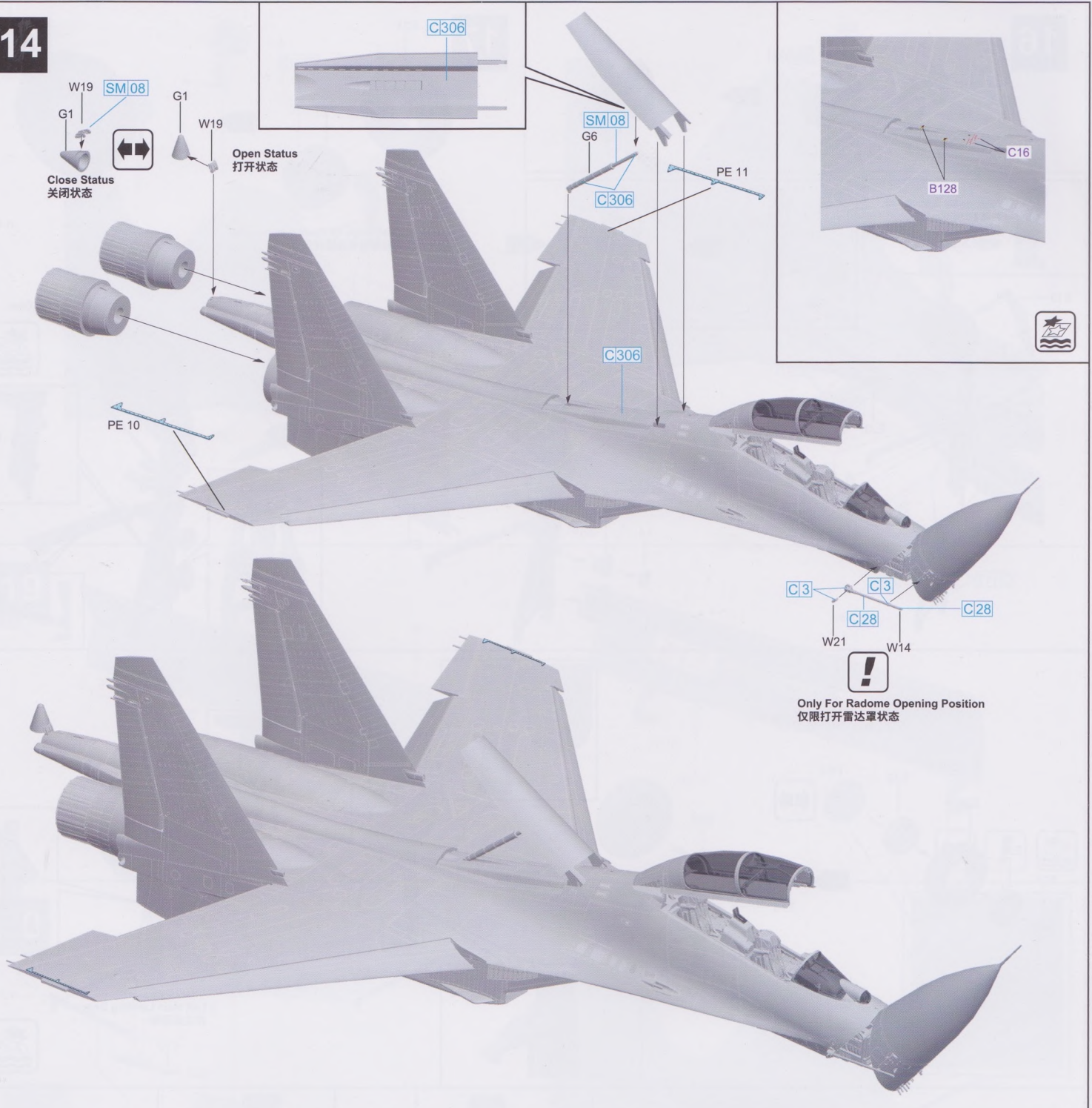

Close Status
关闭状态

Open Status
打开状态

Only For Radome Opening Position
仅限打开雷达罩状态

15

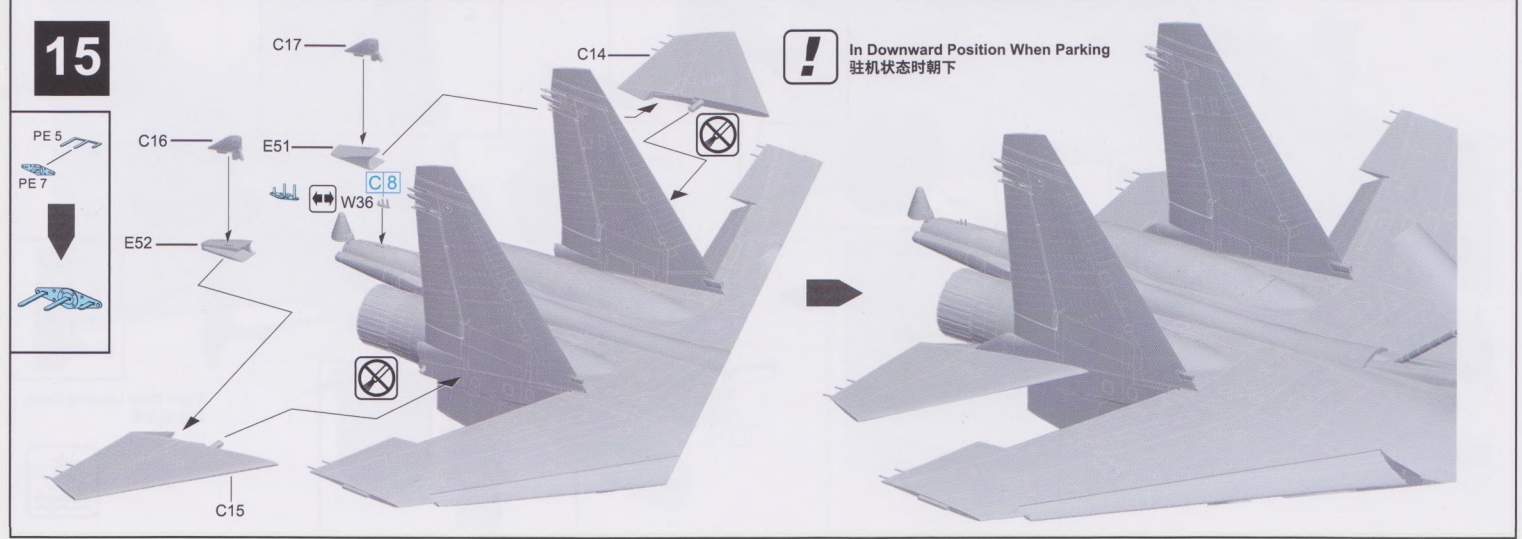

In Downward Position When Parking
驻机状态时朝下

16

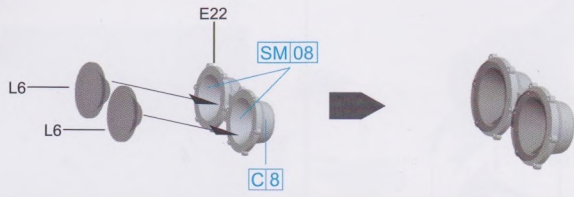

17

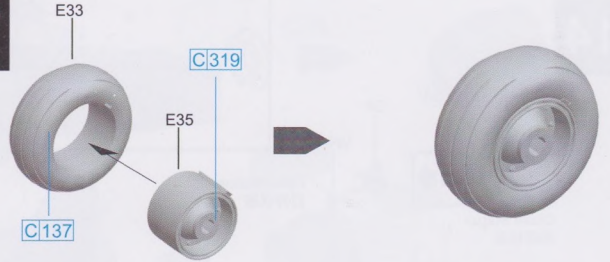

Reduce By 0.5mm For Full Load Status
制作满载状态，液压杆缩短0.5mm



Gently Adjust Angle Of Rods If Necessary
如有需要请轻微调节连接杆角度

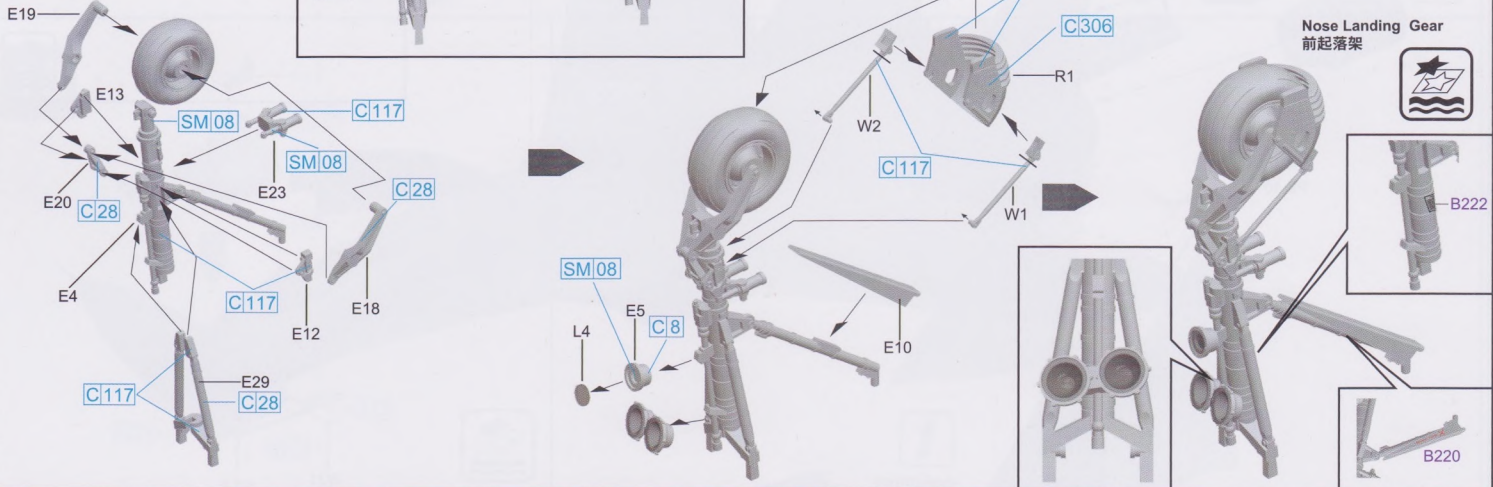

Nose Landing Gear
前起落架



B222

B220

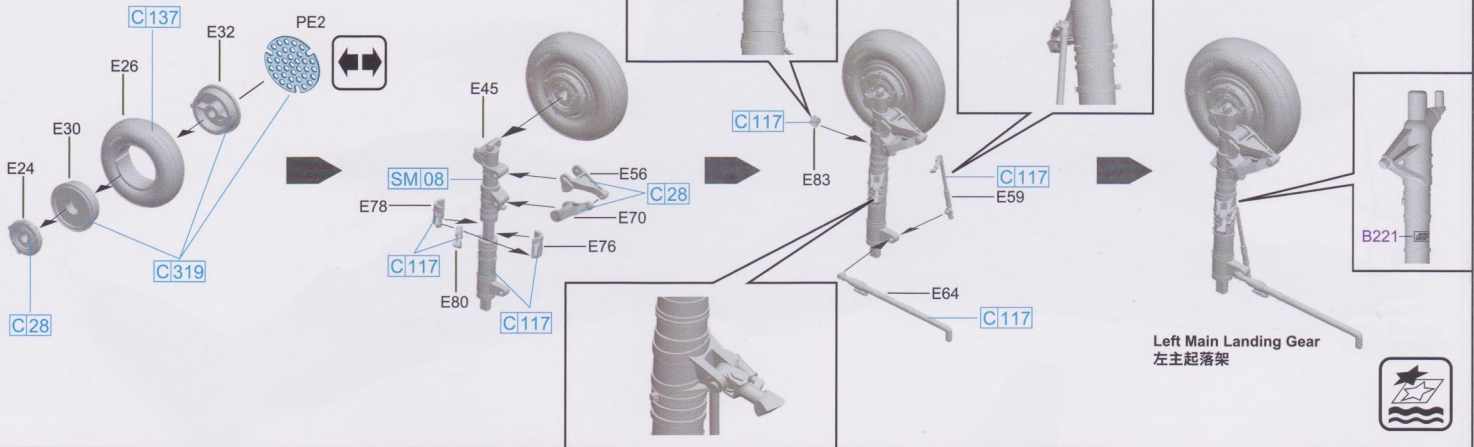

Left Main Landing Gear
左主起落架



B221

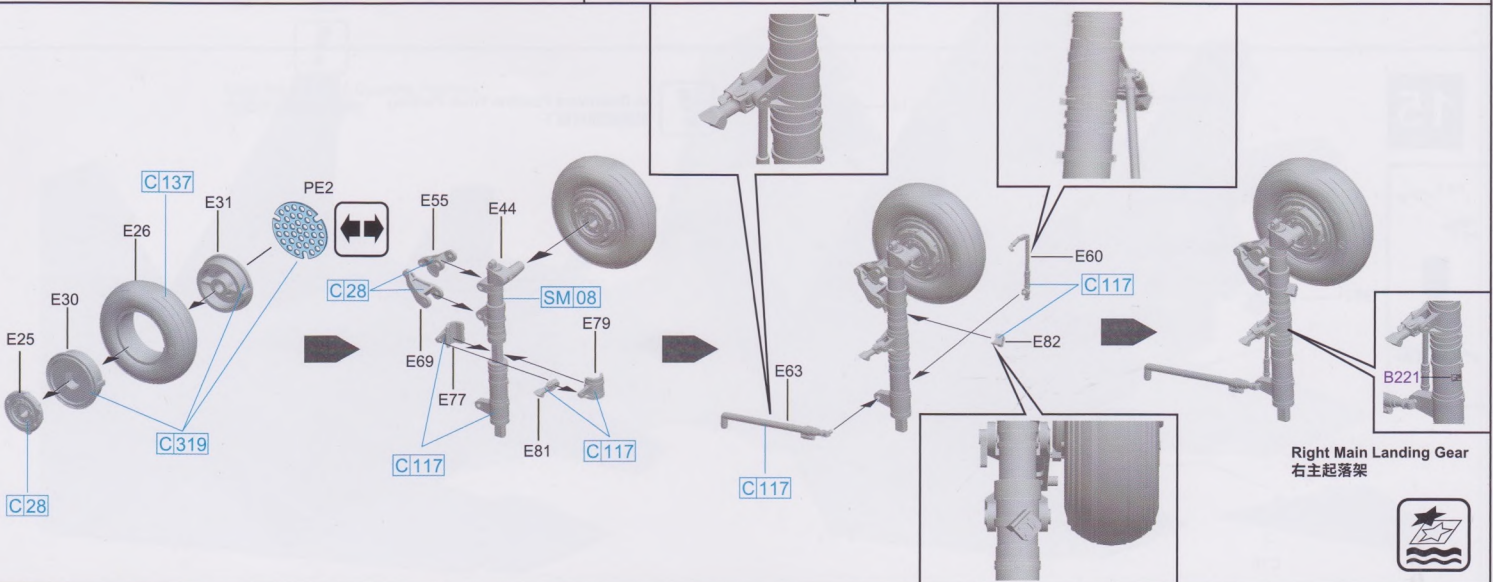

Right Main Landing Gear
右主起落架



B221

18



19

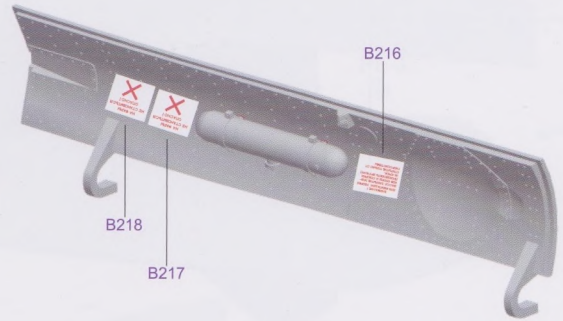
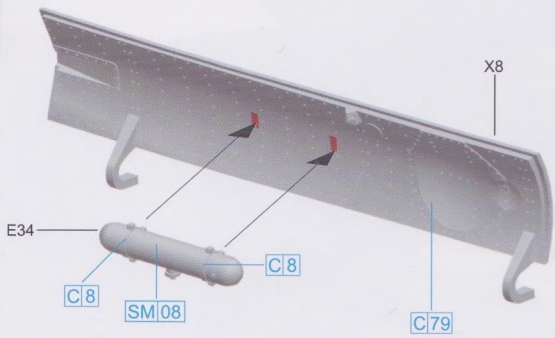

20

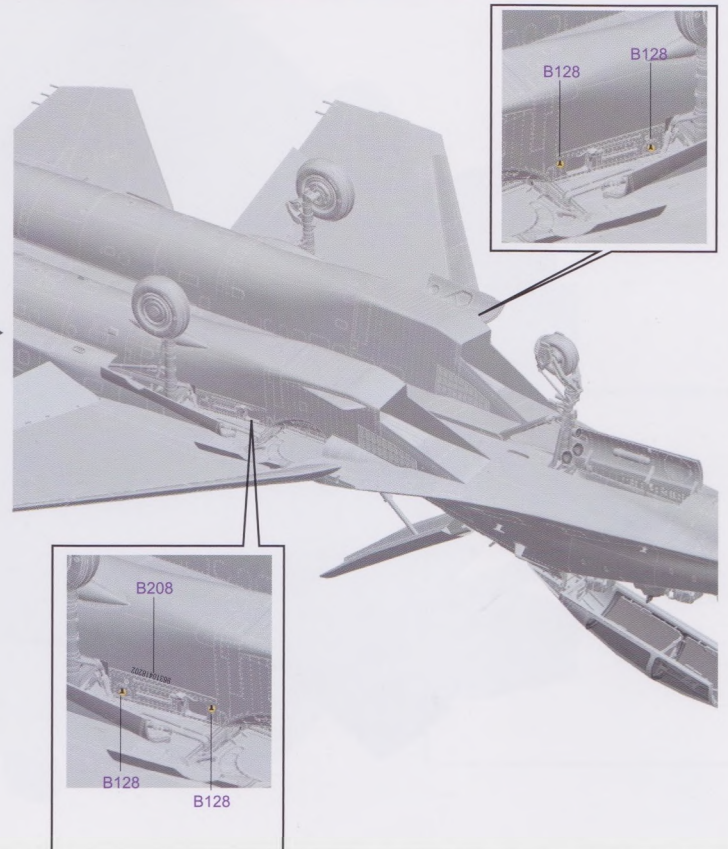
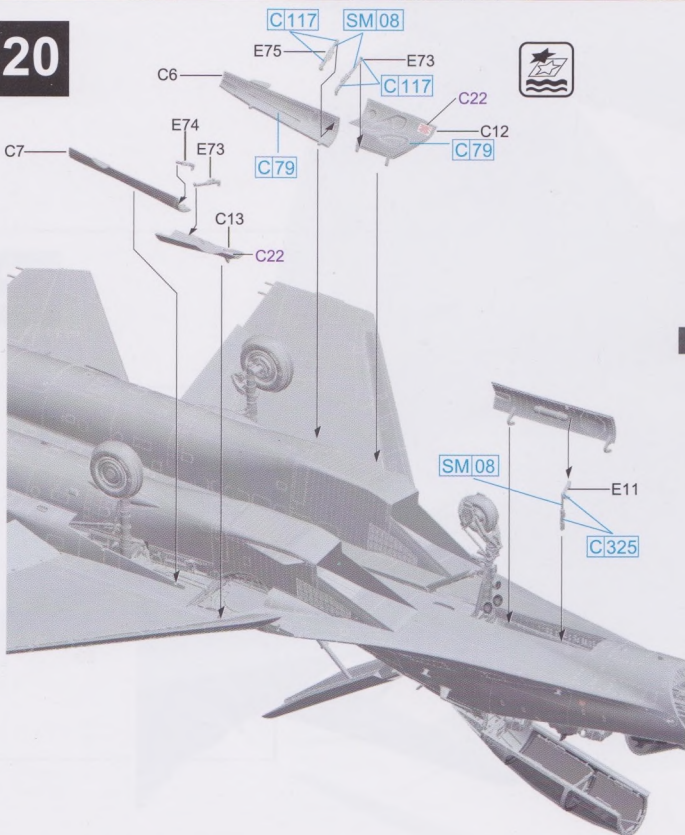

Color For All Hard Points Is Lower Fuselage Camo Color
所有过渡梁均为机身下表面迷彩色

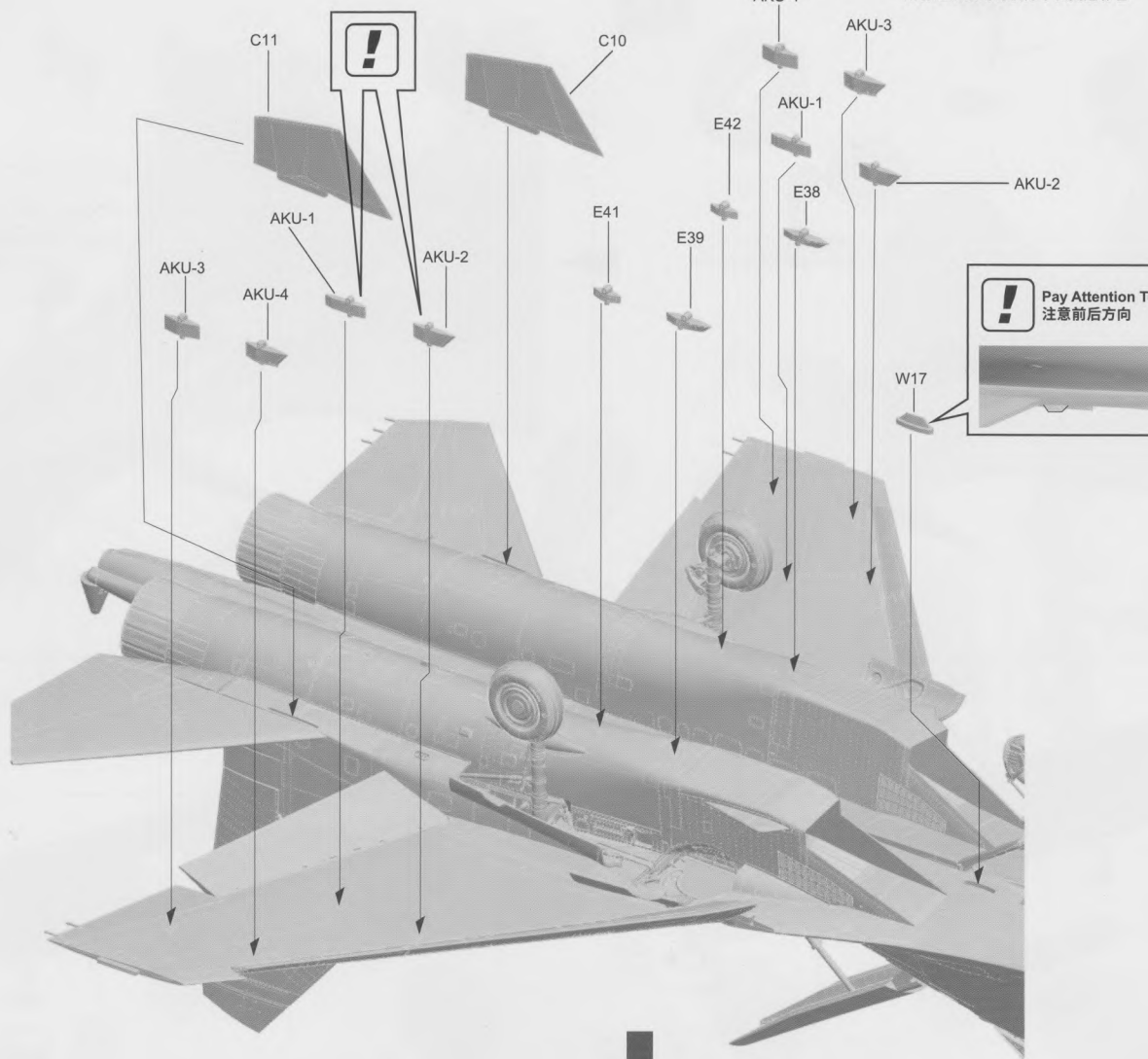

! Pay Attention To Direction
注意前后方向

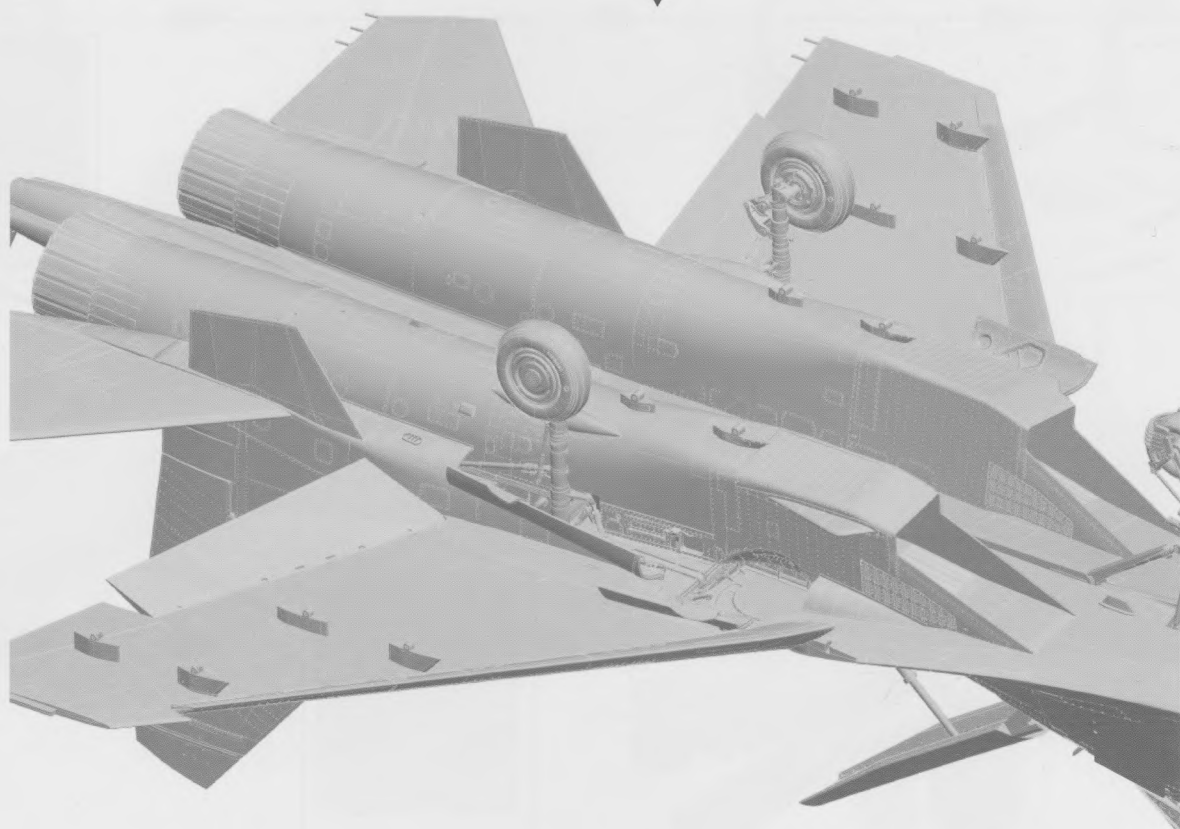

22

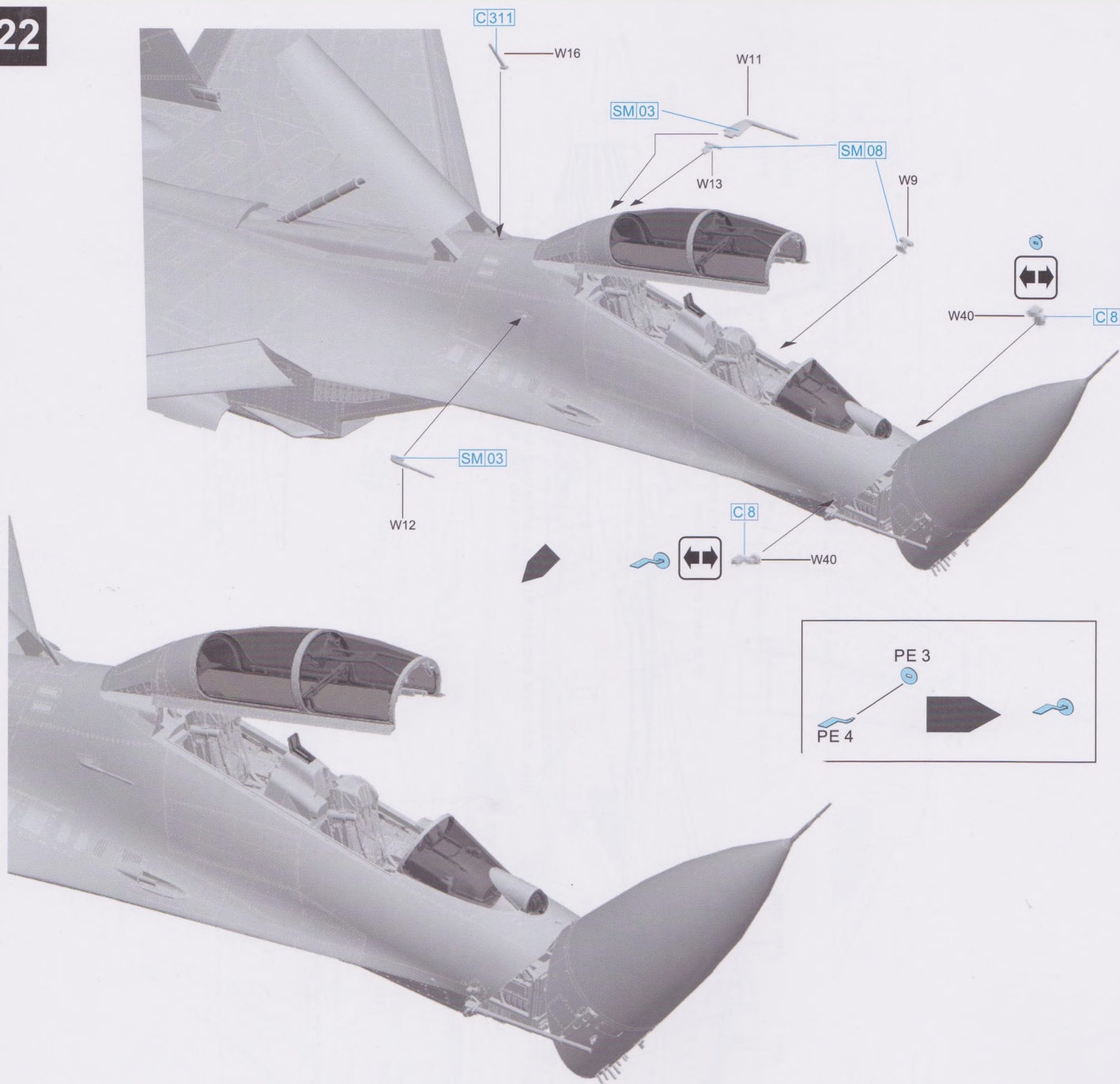

23

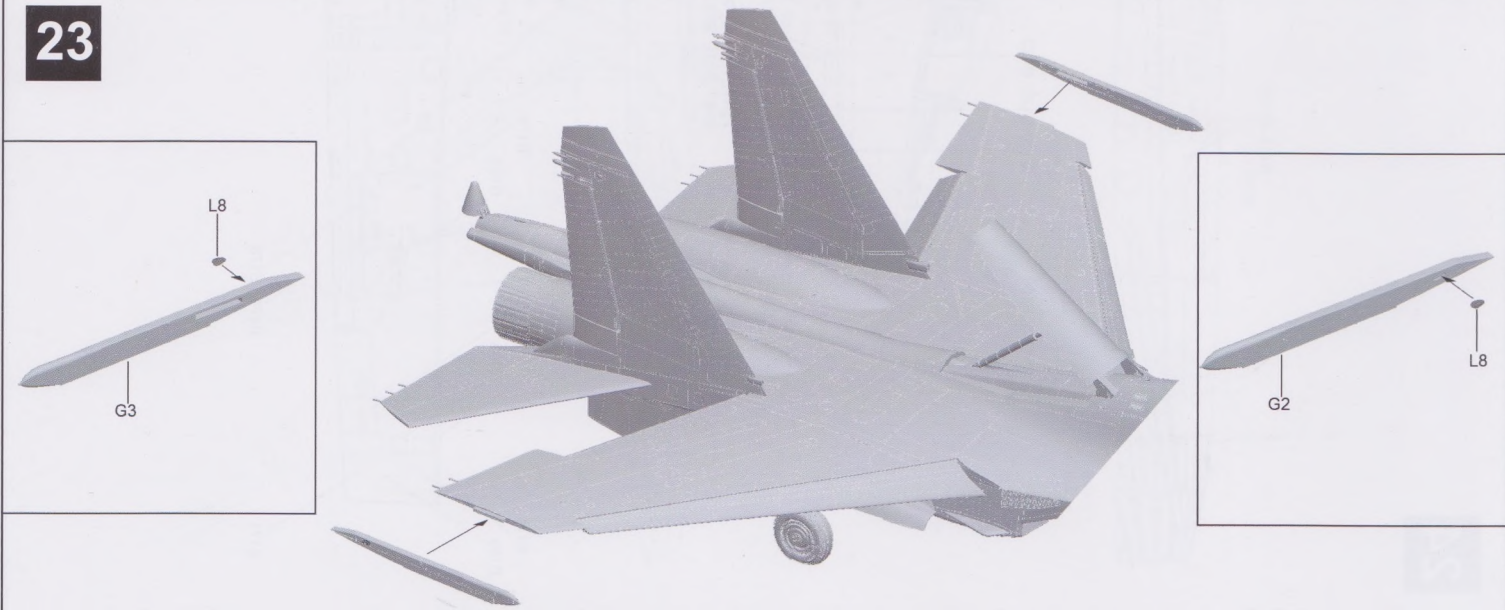

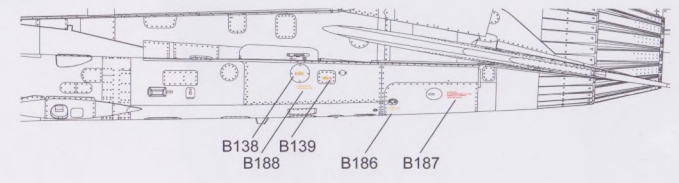
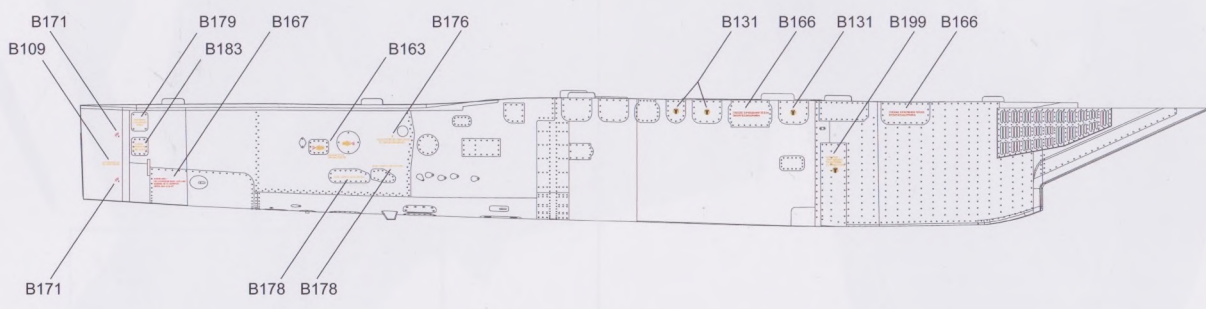
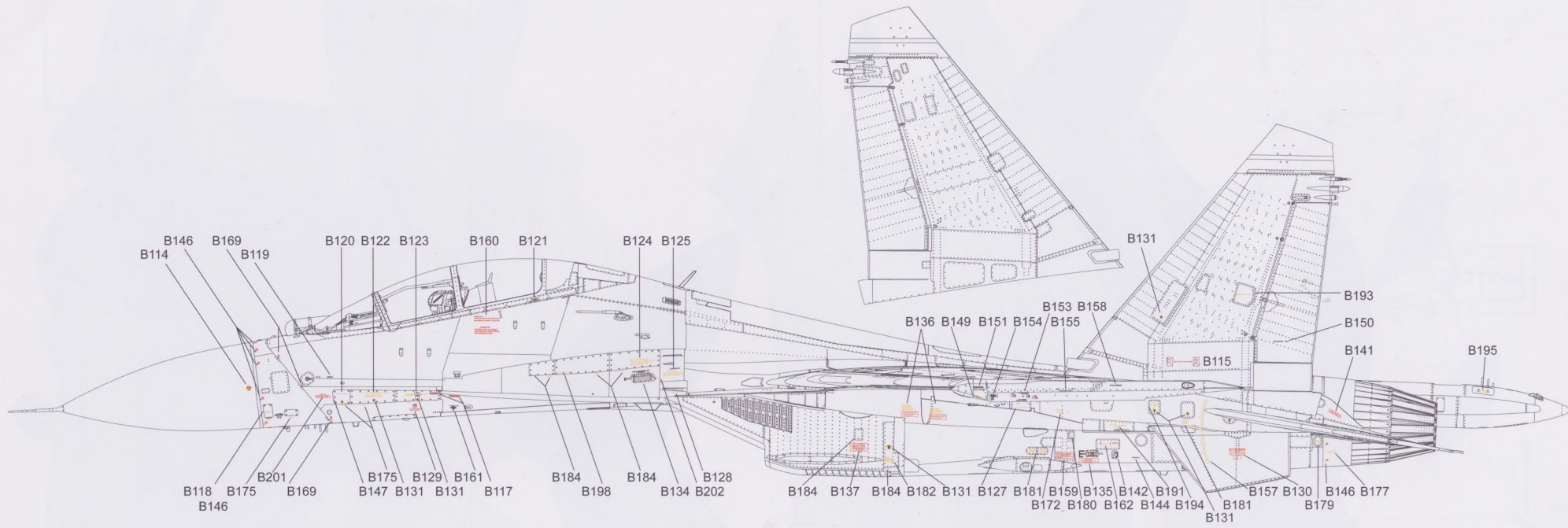

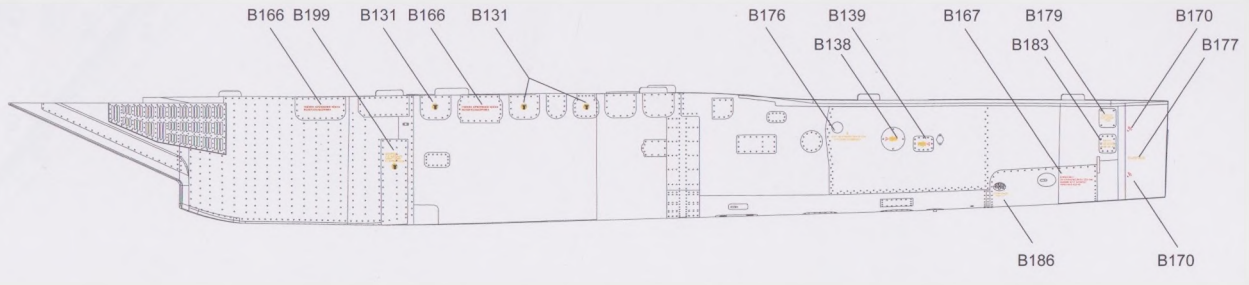
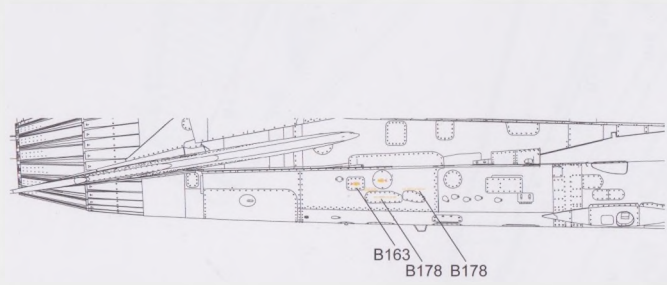
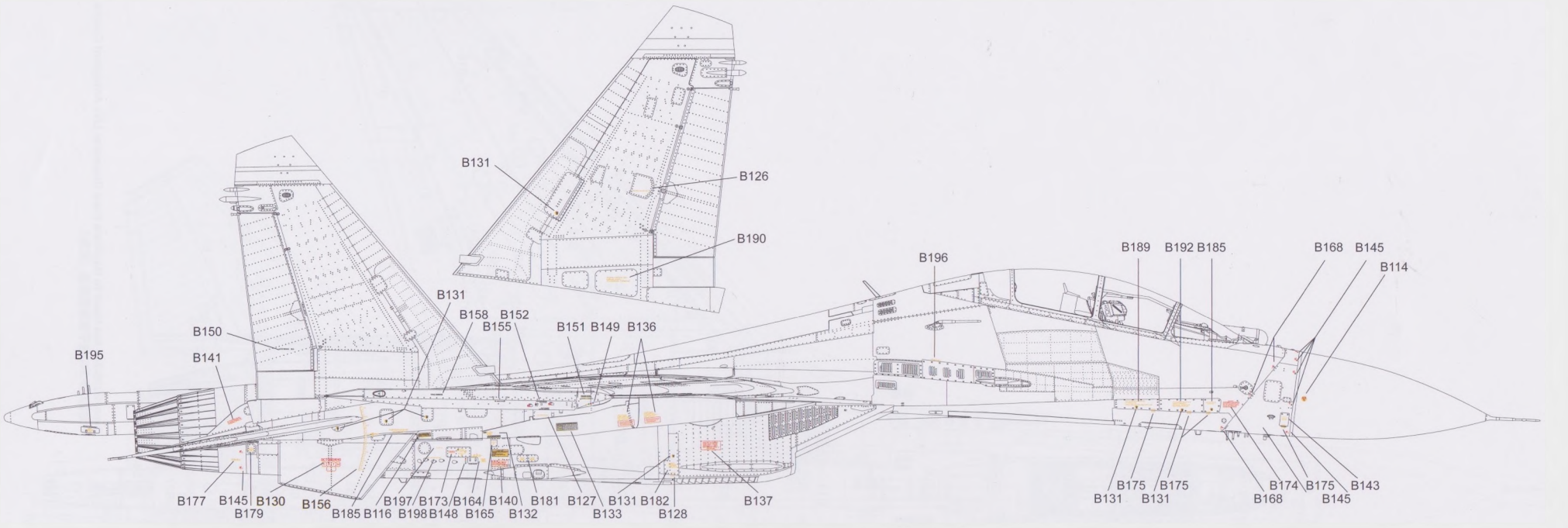

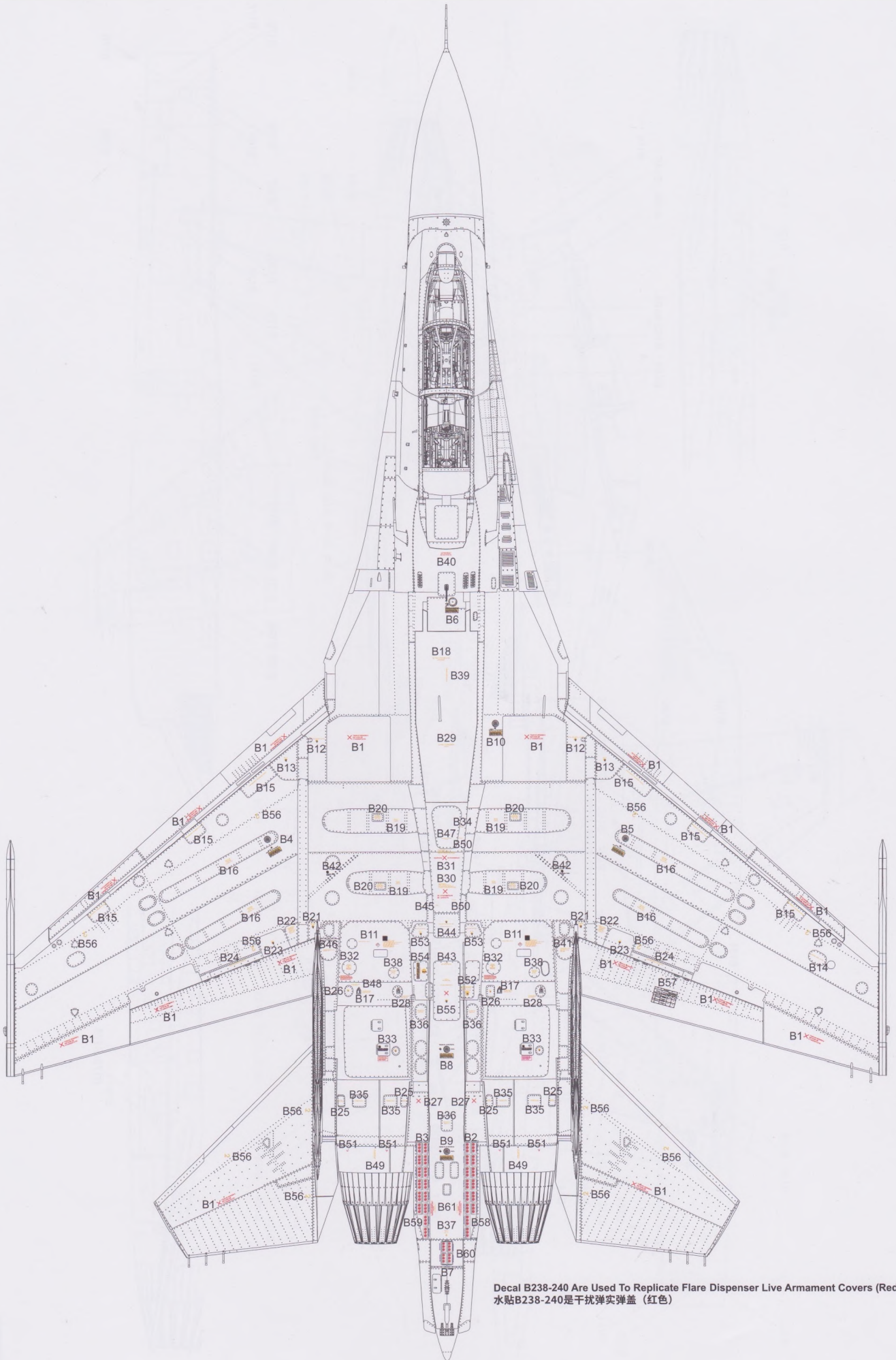

Decal B238-240 Are Used To Replicate Flare Dispenser Live Armament Covers (Red)
 水贴B238-240是干扰弹实弹盖 (红色)



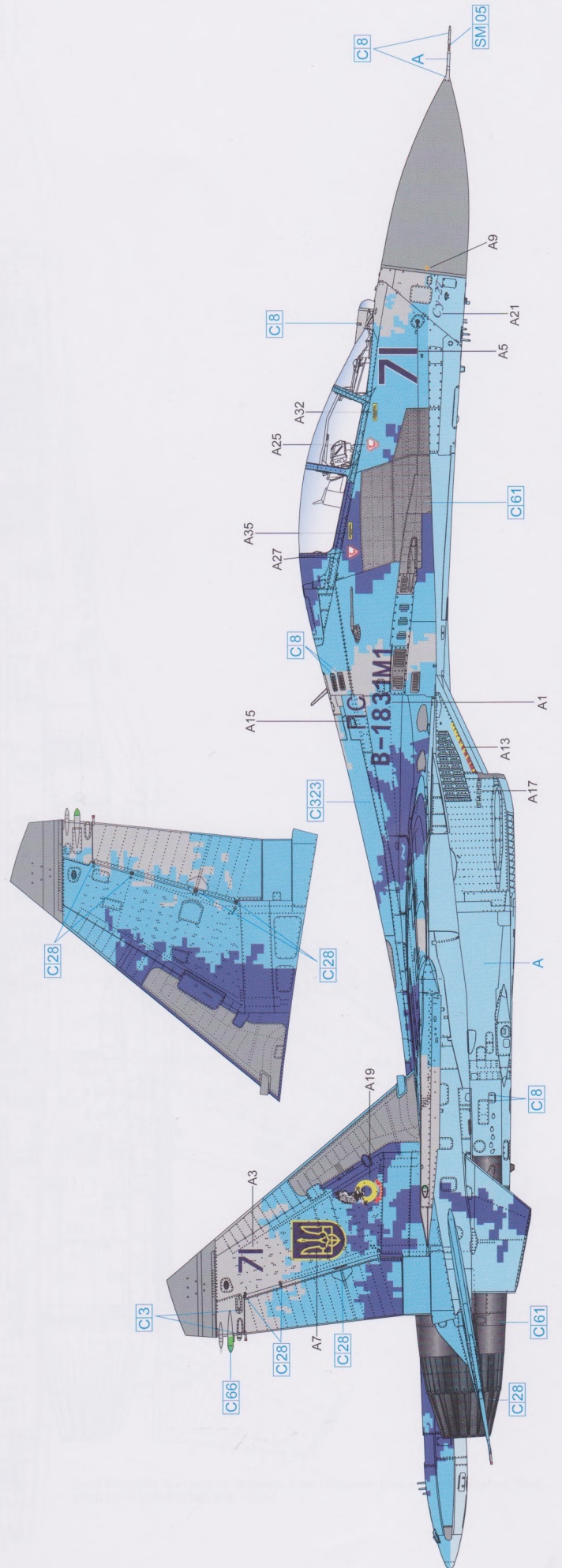
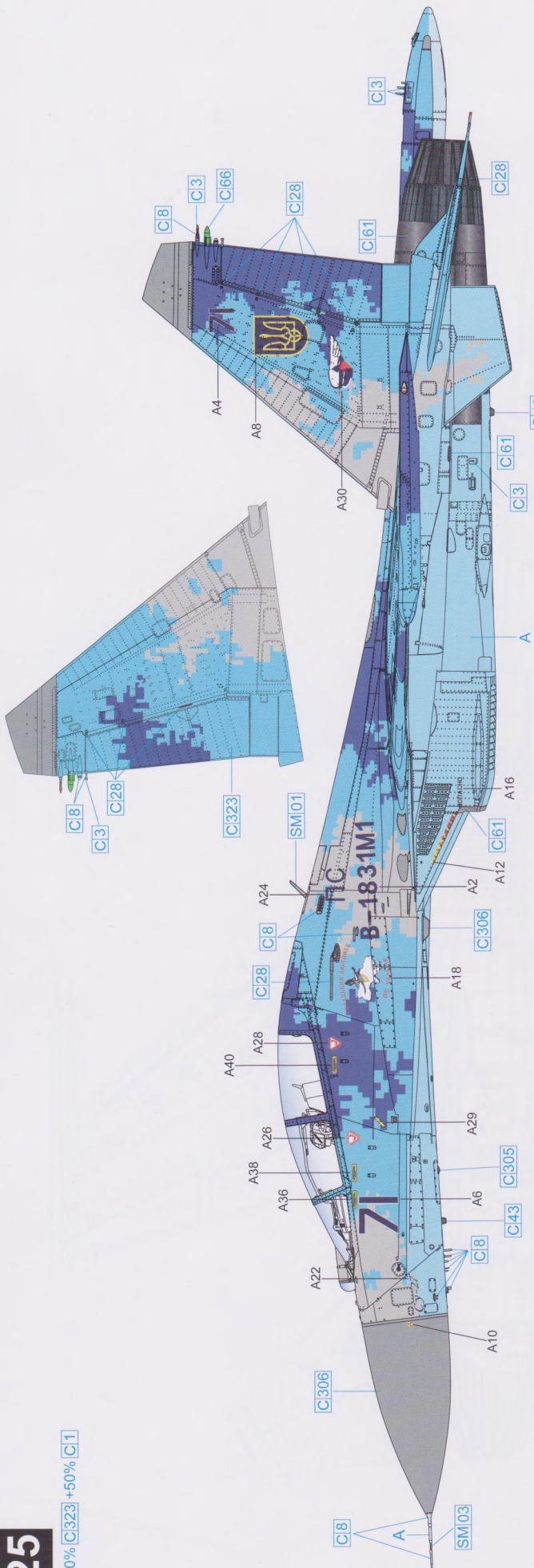



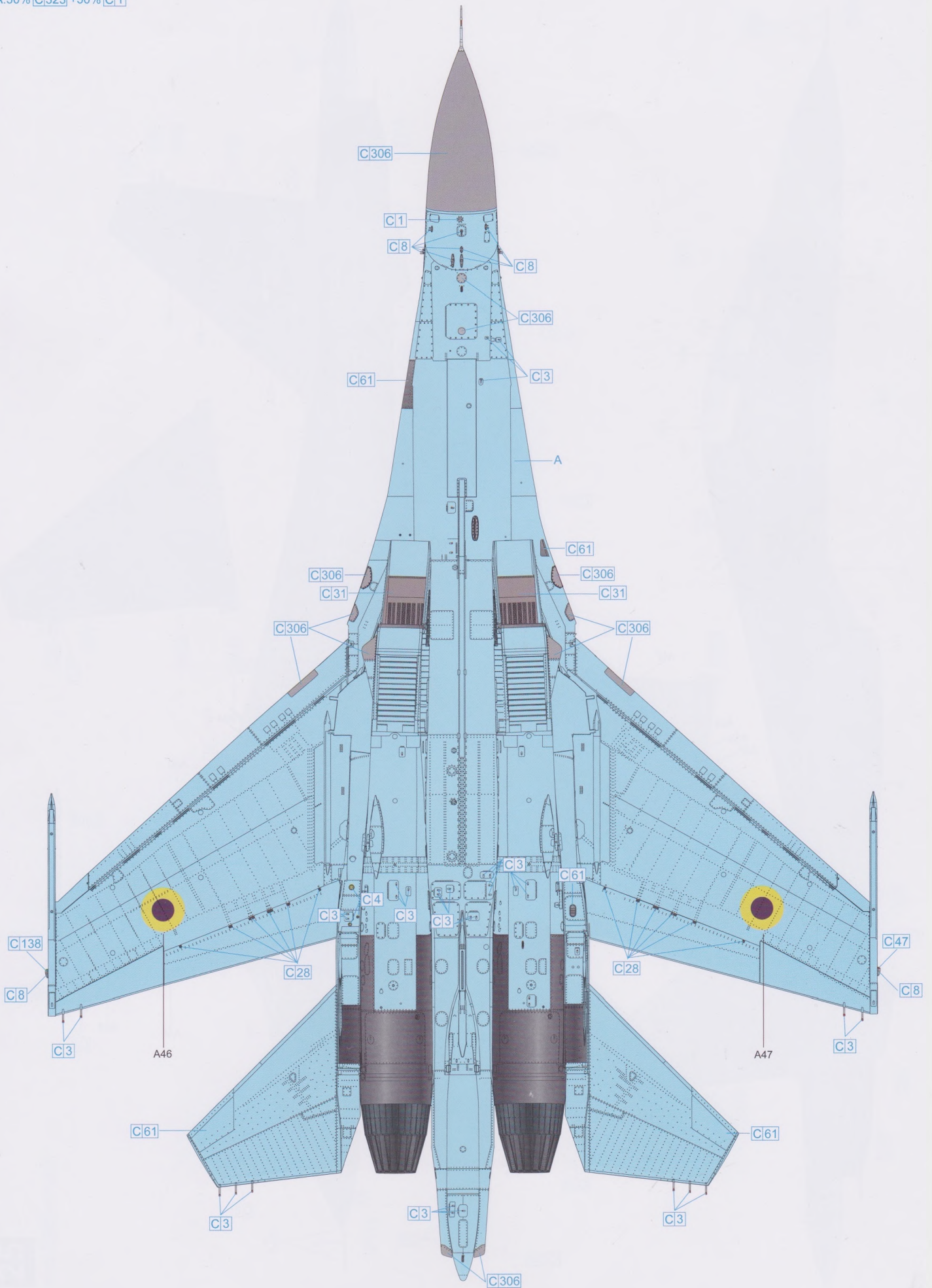

A





A

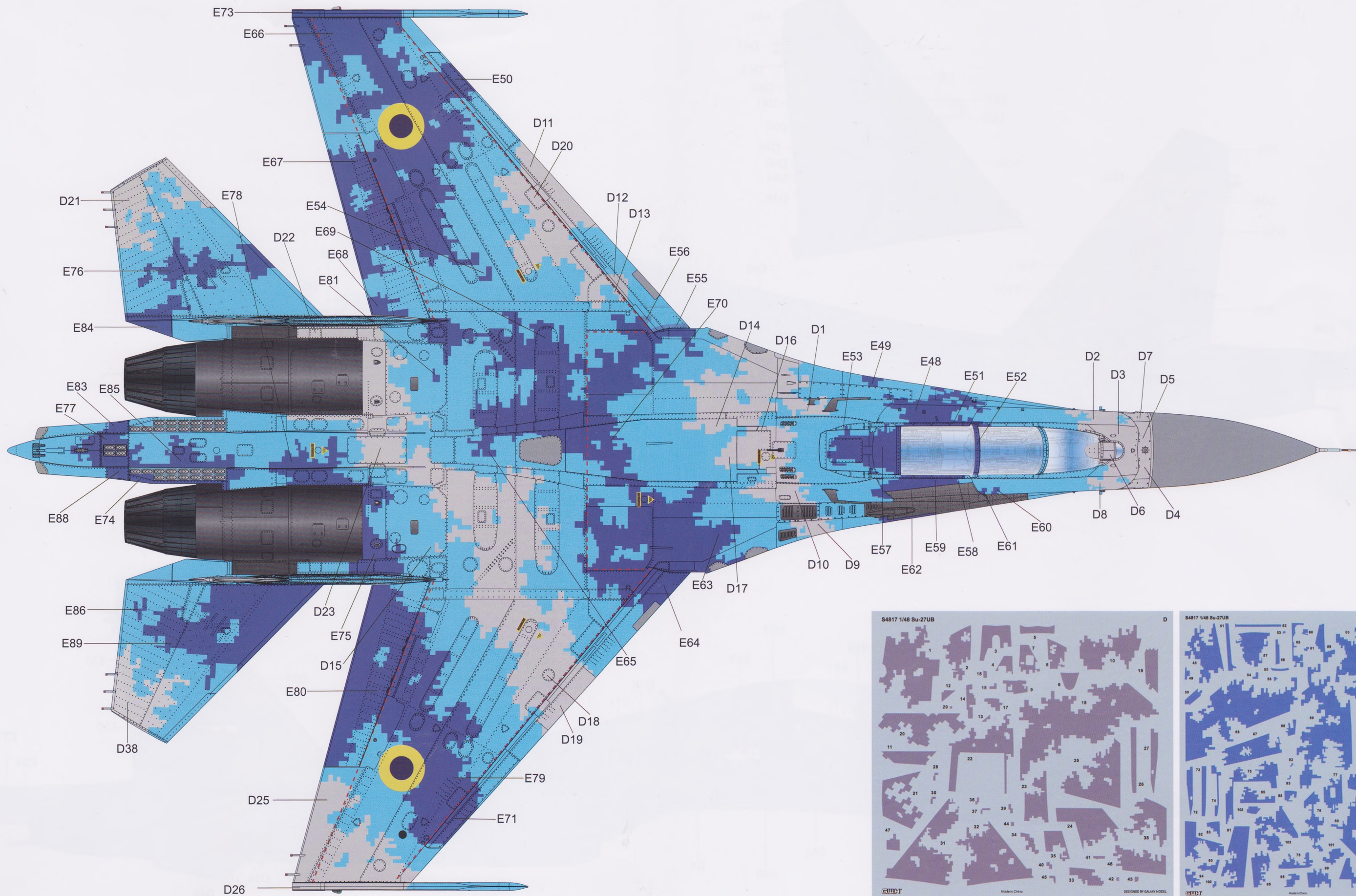

注意事項 CAUTION 組み立てのご注意

- (1) 勿于近火处使用胶水或油漆, 并打开窗户保持空气流通。
- (2) 涂料的号码请参考本栏以下的说明。本品本身不包括胶水和涂料。
- (3) 自板件中取出部件时, 应用模型专用剪, 并用介刀或小锉除去多余胶料。
- (4) 各图形的含义可参考本栏以下说明。

- (1) When you use glue or paint, do not use near a open flame, and use in a well-ventilated room.
- (2) See below for the color list. Glue and paint are not included in the kit.
- (3) When you take parts off the runner frame, use the modeling scissors and trim excess plastic with a cutter or a file.
- (4) See below for the meaning of symbols.

- (1) 接着剤や塗料は火の近くで使わないで下さい、使用の際は換気をよくして下さい。
- (2) 塗料指定のは下記のとおりです、接着剤や塗料は入っていませんので別に求めて下さい。
- (3) 部品のランナーから切り離す時は模型用ハサミ等を使い、余分な部分はカッターやヤスリ等で仕上げて下さい。
- (4) 組立図のサインマークは下の説明を御覧下さい。

图形含义 CAUTION マーク



填平
FILL HOLE
穴を埋めて下さい

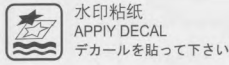

水印粘紙
APPIY DECAL
デカールを貼って下さい

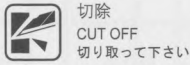

切除
CUT OFF
切り取って下さい



弯折
BEND
折り曲げて下さい

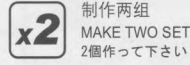

制作两组
MAKE TWO SET
2個作って下さい

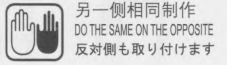

另一側相同制作
DO THE SAME ON THE OPPOSITE
反対側も取り付けます



胶水
CEMENT
接着して下さい

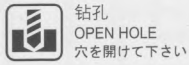

钻孔
OPEN HOLE
穴を開けて下さい

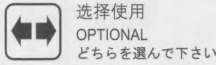

选择使用
OPTIONAL
どちらを選んで下さい

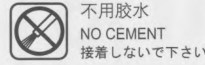

不用胶水
NO CEMENT
接着しないで下さい

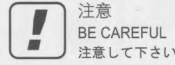

注意
BE CAREFUL
注意して下さい



瞬間胶
INSTANT GLUE FOR METAL
瞬間接着剤 (金属用)

所使用工具 RECOMMENDED TOOLS 専用工具

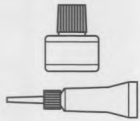

塑胶件用模型胶水
Cement
プラスチック用接着剤

模型用瞬間胶水
Instant Cement
瞬間接着剤

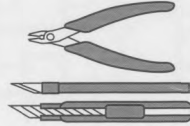

模型用剪钳
Side cutters
模型用ニッパー

模型用刻刀
Modeling knife
模型用ナイフ

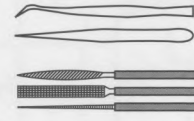

模型用镊子
Tweezers
ピンセット

模型用锉刀
Diamond file
模型用ヤスリ

水贴纸使用说明 DECAL APPLICATION スライドマークの貼り方

- (1) 用模型剪刀或刻刀切下所需的图案部分。
- (2) 将水贴纸浸泡在温水中10秒左右取出放置于戏水的干布上。
- (3) 手拿着水贴纸基的一角, 用模型镊子小心夹住浮起的水贴图案移至模型表面准确位置。
- (4) 用手指适当沾水均匀涂于水贴图案表面, 使其延展移动至精确位置。
- (5) 用柔软吸水的干布将水贴图案中的气泡向一边挤出, 使水贴在模型表面保持平整。

- (1) Cut off decal from sheet.
- (2) Dip the decal in tepid water for about 10 sec. and place on a clean cloth.
- (3) Hold the backing sheet edge and slide decal onto the model.
- (4) Move decal into position by wetting decal with finger.
- (5) Press decal down gently with a soft cloth until excess water and air bubbles are gone.

- (1) 貼りたいマークをハサミで切り抜きます。
- (2) マークをぬるま湯に10秒ほど浸してからタオル等の布の上に置きます。
- (3) 台紙のはしを手で持ち、貼る場所にマークをスライドさせてモデルに移して下さい。
- (4) 指に少し水を付けてマークを濡らしてながら、正しい位置にずらしします。
- (5) 柔らかな布でマークの内側の気泡を押し出しながら、押しつけるようにして水分をとります。

蚀刻片使用说明 PHOTO-ETCHED PARTS エッチングパーツ

- (1) 使用蚀刻片专用剪刀或模型专用刻刀将蚀刻片零件切割下待用。
 - (2) 切割下的零件上有蚀刻片的残留连接点部分, 使用模型专用锉刀细心打模干净。
 - (3) 蚀刻片部分在涂装之前必须使用专用的模型金属底漆打底。
- 注意事项: 蚀刻片很薄外延较为尖锐, 有刮伤手的可能, 在使用之时请务必小心。

- (1) Cut off photo-etched parts using a modeling knife.
 - (2) Carefully remove any excess using a file.
 - (3) Apply metal primer prior to painting.
- Attention, please: Extra care should be taken to avoid personal injury when handling photo-etched parts.

- (1) 切り離す時はカッターナイフを使用してパーツを切り離します。
 - (2) 切り出した時、部品に出張った部品が残っている場合は、ヤスリなどで丁寧に削り落とします。
 - (3) 塗装が必要なパーツは下地にメタルプライマーを吹きつけてから塗装します。
- ご注意: エッチングパーツは大変薄く、手などを切り恐れがあります。取扱いには十分注意して下さい。

涂装色表 PAINT REQUIRED カラー番号リスト

■ [C000] GSI CREOS Mr.COLOR ■ [00-000] ACRYLICOS VALLEJO

[C1]	亮光白	Light white
[C3]	亮光红	Light red
[C4]	亮光黄	Light yellow
[C8]	亮光银	Light silver
[C9]	亮光金	Light gold
[C25]	暗海灰	Dark grey sea
[C28]	黑铁色	Steel
[C33]	哑光黑	Matt black

[C43]	木棕色	Wood brown
[C45]	帆布色	Sail color
[C47]	透明红	Clear red
[C60]	RLM02灰色	RLM02 grey
[C61]	烧铁色	Burnt iron
[C66]	亮绿色	Bright green
[C72]	雾蓝色	Intermediate blue
[C79]	亮红色	Shine Red

[C92]	半光泽黑	Semi-gloss black
[C117]	RLM76浅蓝	RLM76 pale blue
[C135]	俄国绿 (1)	Russian Green(1)
[C136]	俄国绿 (2)	Russian Green(2)
[C137]	消光轮胎黑色	Dull tire black
[C138]	透明绿	Transparent green
[C301]	FS36081深灰色	FS36081 dark grey
[C306]	FS36270灰色	FS36270 gray

[C308]	FS36375浅灰色	FS36375 light grey
[C311]	FS36622灰色	FS36622 gray
[C313]	FS33531沙黄色	FS33531 yellow
[C319]	浅松绿色	Light green
[C323]	亮光浅蓝色	Light blue
[C324]	半光浅灰色	Light grey
[C325]	FS26440灰色	FS26440 gray
[C338]	FS36495浅灰色	FS36495 light grey

[SM03]	超级熟铁色	Super wrought iron
[SM05]	超级钛金属色	Titanium color
[SM08]	特效电镀银色	Special plating silver