

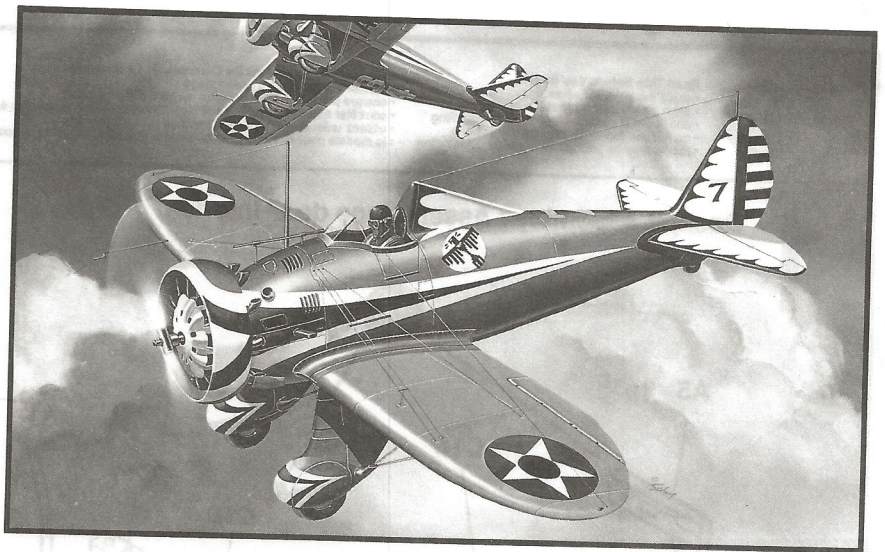

# USAAC "Early" P-26A



## HCI558 • 1:48 • USAAC Peashooter

**Kit features:** detailed cockpit • landing gear • precise moldings • authentic markings.

**Particularités du kit:** • l'intérieur détaillé • train d'atterrissage très détaillé • moulage précis • les marques authentiques.

**Caratteristiche del modello:** • carlinga dettagliata e carrello di atterraggio • dettagli incisi • decals autentici.

**Der Bausatz enthält:** • detailliertes Cockpit und Fahrwerk • fein eingravierte Details • authentische Abziehbilder.

**Características del kit:** • se detallan la cabina del piloto y el aterrizador • marcas auténticas.

COLOR	FLOQUIL CLASSIC**	HUMBROL**	TESTORS MODELMASTER**
FS30118 Brown	303106 US brown drab	HU18 brown	1702 field drab
FS13538 Yellow	303078 yellow	154* yellow	1707 chrome yellow
FS17875 White	303011 white	USN6 white	1745 white

\* = approximate match

\*\*Some paints may not be available in your country. Please check with your local hobby shop for substitute colors.

cyanocrilate glue coller cyanoacrylate Cyanoacrylate kleben incollare cyanoacrylate pegar cyanoacrylate	cut couper schneiden tagliare cortar	bend plier sich biegen piegare doblar	file / sand poncer verspachteln levigare lijar	weight a lester Gewicht zavorra lastre	drill or pierce percer bohren forare agujerear	x2 two deux zwei due dos
painting instructions mode d'emploi Anleitungen der Farben istruzioni per la verniciatura instrucciones sobre la pintura	caution! attention! vorsichten! attenzione! atención	alternative en option Alternativ alternativo alternativa	cement coller kleben incollare pegar	paint peindre bemalen vernicciare pintar	decal decalcomania Abziehbild decalcomania calcomanias	no! no! nein! no! ¡no!



**Read This Before You Begin!**

- study the assembly drawings
- each plastic part is identified by number
- check the fit of each piece before cementing
- do not use too much cement to join parts
- model may be painted to match box illustration

**Lisez Ce Qui Suit Avant De Commencer Le Montage!**

- étudier les schémas d'assemblage
- chaque pièce plastique porte un numéro d'identification
- contrôler que chaque pièce soit bien conforme avant de la coller à sa place
- utilisez uniquement une colle spéciale pour polystyrène
- le modèle peut être peint conformément aux illustrations de la boîte

**Vor Zusammenbau lesen sie bitte!**

- studiere die Bauanleitung
- die Plastikteile sind gekennzeichnet durch ihre Nummern
- vor dem Kleben prüfe ob die Teile zusammenpassen können
- benutze nicht zuviel Klebstoff
- die Bemalung des Modells kann auf dem Becketbild zeigen

# 1 Cockpit Assembly / Assemblage de L' Interieur

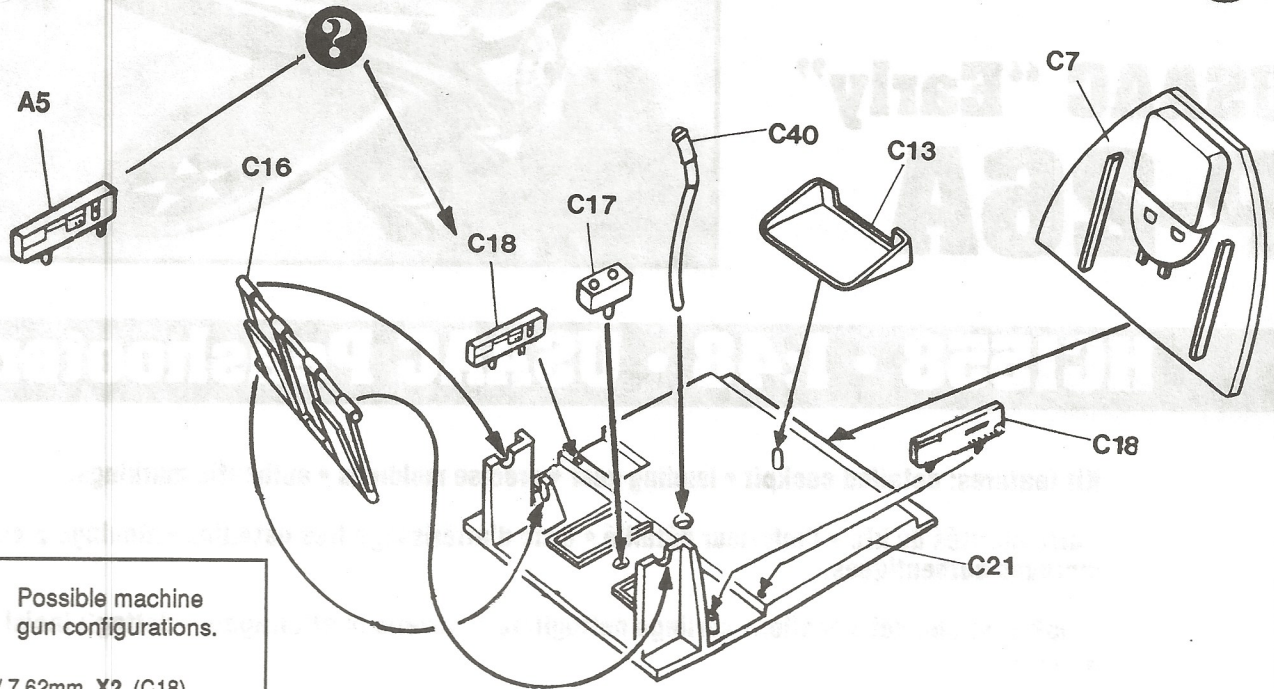

Possible machine gun configurations.

1. 0.30 in./ 7.62mm X2 (C18)
2. 0.30 in./ 7.62mm X1 (C18 - port)  
0.50 in./12.7 mm X1 (A5 - strb'd)

# 2 Fuselage Assembly / Assemblage du Fuselage

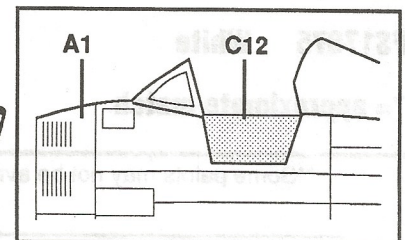
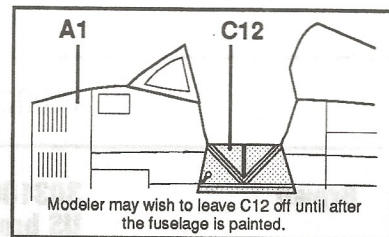
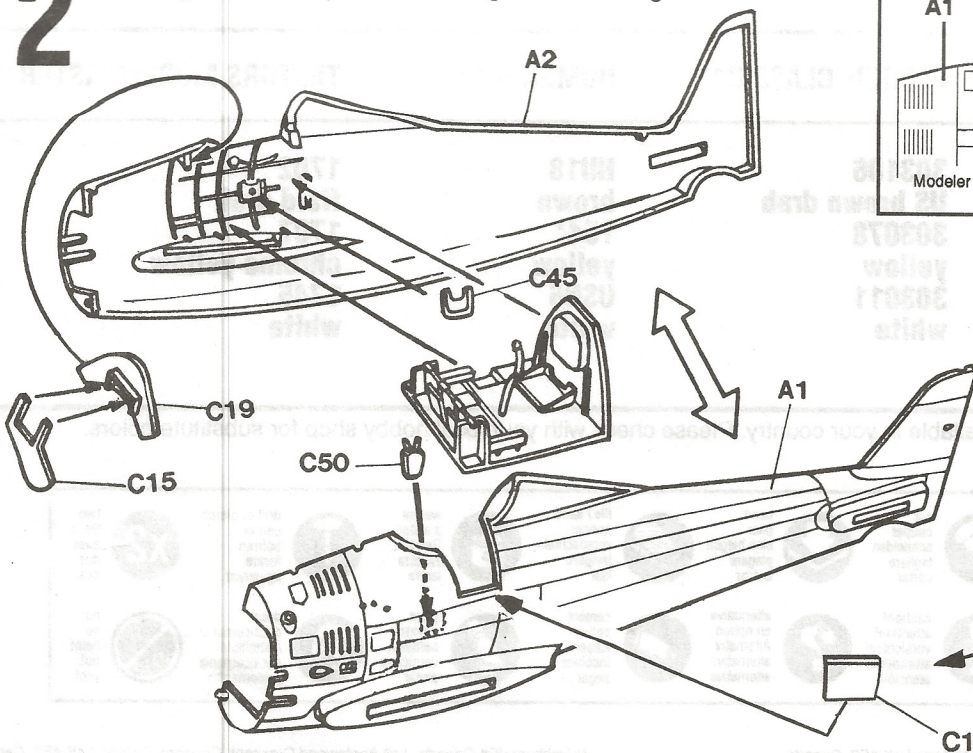

# 3

## Propeller, Wing, Fuselage & Canopy Assembly Assemblage de Hélice, Ailes, Fuselage & Verrière



A15

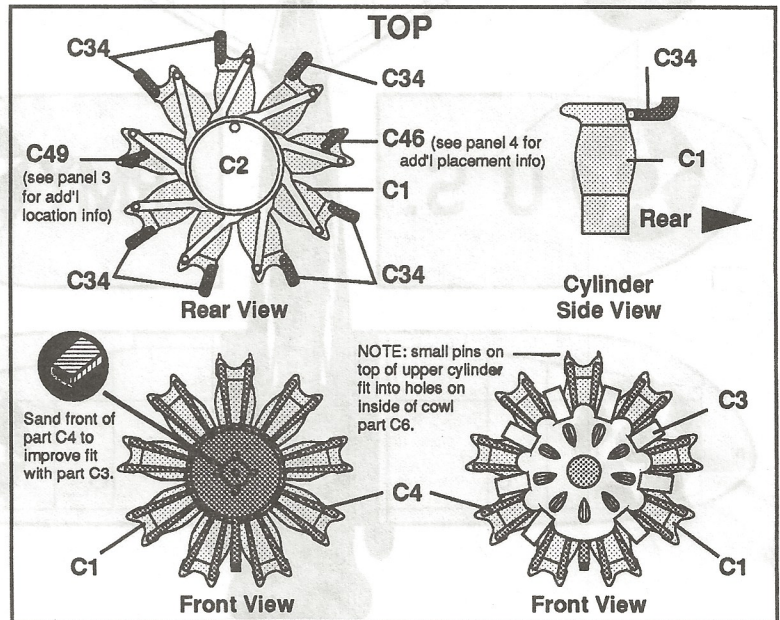
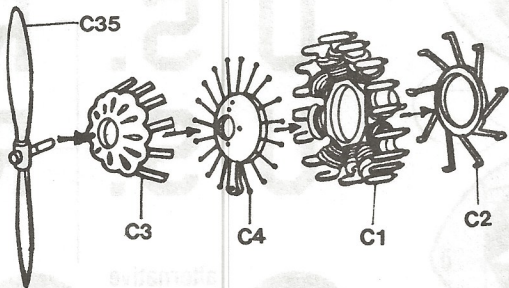
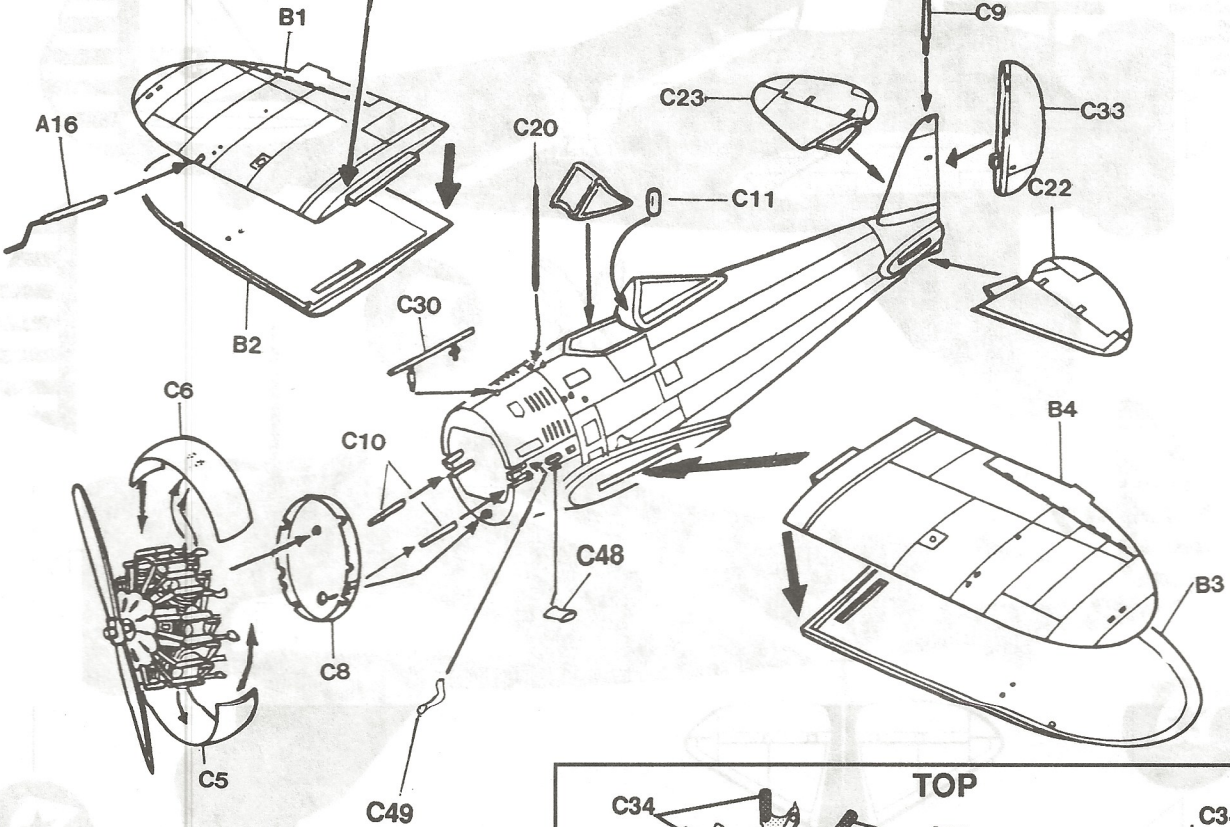
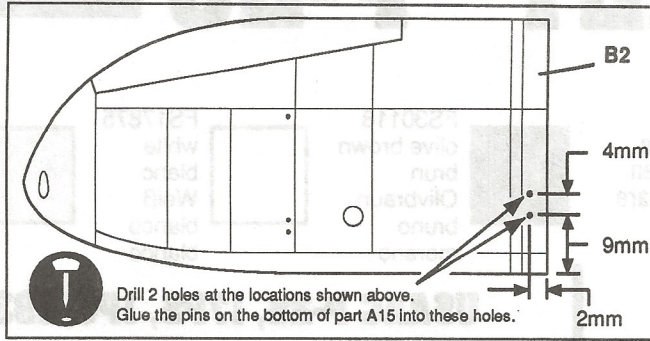

# 4

## Landing Gear, Cover Assembly / Train D' Atterrissage, Covercle Assemblage

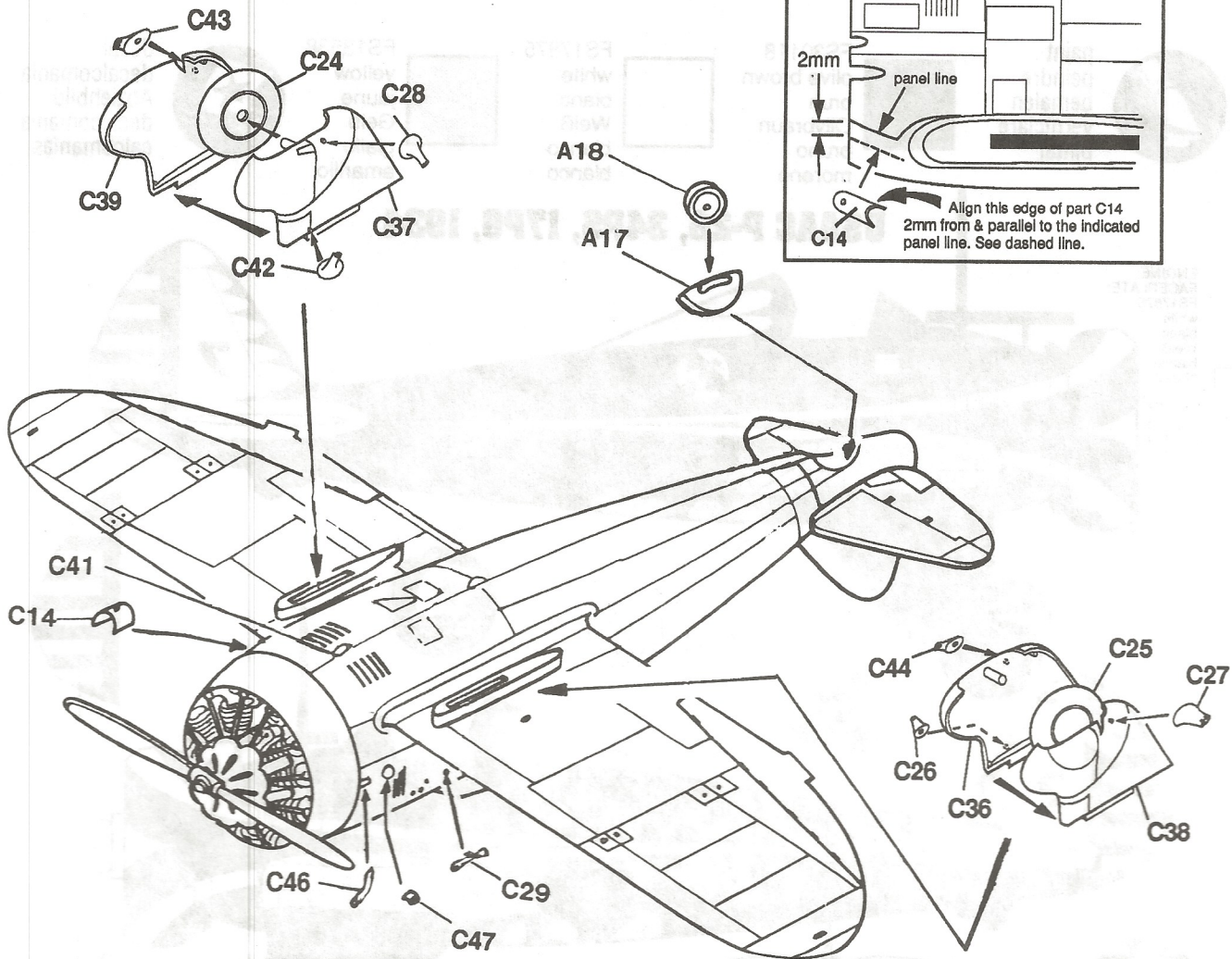
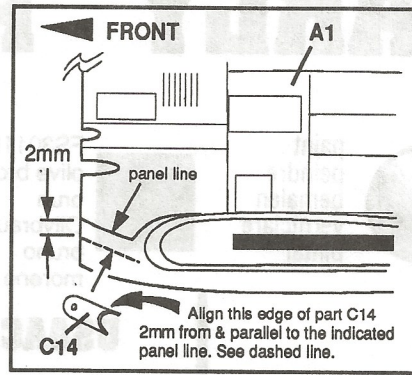

Rigging Diagram-Top View

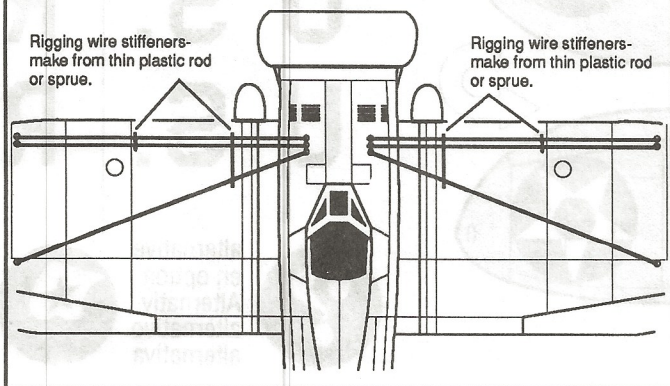

Rigging Diagram - Bottom View

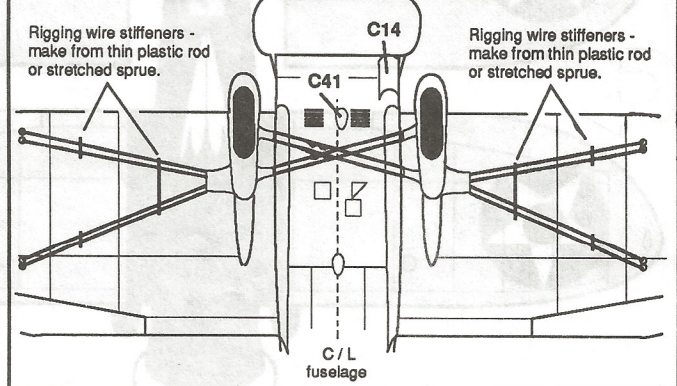

# “EARLY” P-26 Markings • Appliques



paint  
peindre  
bemalen  
verniciare  
pintar



FS30118  
olive brown  
brun  
Olivbraun  
bruno  
moreno

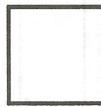

FS17875  
white  
blanc  
Weiß  
bianco  
blanco

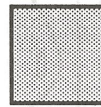

FS13538  
yellow  
jaune  
Gelb  
giallo  
amarillo



decal  
decalcomania  
Abziehbild  
decalcomania  
calcomanías

## USAAC P-26, 17PS, 1PG, 1934

ENGINE  
FACEPLATE:  
FS30118  
olive brown  
brun  
Olivbraun  
bruno  
moreno

