

## NÁVOD / INSTRUCTION Ju 88D-2/4

1/48

### Historie

Vývoj Junkers Ju 88 byl zahájen v roce 1935 podle požadavků Říšského ministerstva letectví. První prototyp Ju 88V-1 vzletl již v roce 1936. Byl navržen jako rychlý taktický bombardér. Vývoj byl poměrně dlouhý, zkušební stroje Ju 88A-0 byly dodány k testovací jednotce Erprobungskommando 88 na jaře 1939. První sériová verze Ju 88A-1 s menším rozpětím byly brzy nahrazeny ve výrobě verzemi s novým křídlem s větším rozpětím Ju 88A-5 a Ju 88A-4. A-4 dostala i výkonnější verzi motorů Jumo 211. Záhy se ukázalo, že konstrukce Ju 88 velmi adaptabilní. Bylo možné ji snadno upravit podle potřeb různým účelům. Podle požadavků Luftwaffe byly vyráběny Ju 88 ve verzích pro bombardování, denní nebo noční stíhání, bitevní a protitankové verze a v neposlední řadě verze pro průzkum. Vhodnost pro průzkumné akce si Luftwaffe ověřila na několika Ju 88A-5(F) a Ju 88D-0 upravených montáží kamer do zadní části pumovnice, přídavných nádrží do její přední části a odstraněním aerodynamických brzd ze spodní části křídla. Na základě verze Ju 88A-4 byly stavěny Ju 88D-1 a tropikalizovaná D-3. Verze Ju 88A-5 se stala základem průzkumných verzí Ju 88D-2 a tropikalizovaných D-4. U průzkumných jednotek většinou nahradily starší Dornier Do 17. Luftwaffe nasadila své průzkumné Ju 88D na východě i západě na všech frontách od polárního kruhu až po písek Afriky. Průzkumné Ju 88D byly dodány i německým spojencům, Maďarsku a Rumunsku. Oba německé satelity je nasadily na východní frontě, po přechodu Rumunska na stranu spojenců byly dokonce nasazeny proti Wehrmachtu. Několik strojů bylo ukořistěno a testováno spojenci. Celkem bylo vyrobeno více než 1450 ks všech verzí Ju 88D.

Rozpětí: 20.08 m, délka: 14.39 m, max. rychlost: 470 km/h , dostup: 8 200m, dolet: 1790 km

### History

The development of the Ju 88 type was commenced as early as in 1935 to requirements of the Reichsluftfahrtministerium (Reich's Ministry of Aviation), the prototype Ju 88V-1 being taken aloft in 1936. From the beginnings, the type was meant to serve as a fast bomber aircraft. The development was rather long, the test machines designated the Ju 88A-0 being delivered to the test unit known as Erprobungskommando 88 in spring 1939. The first production batch of Ju 88A-1 machines featured a shorter span wing while all the later versions were fitted with standard, longer span wings. The A-4 version was also equipped with more powerful Jumo 211 engines. Soon it became clear that the design is rather versatile and could be very easily adapted for various purposes. Several versions were produced, depending on various service requirements, these being the bomber variant, day or night fighter, attack and anti-tank version and at last but not least the reconnaissance type. The suitability of the latter was verified by the Luftwaffe during the trials with several airframes known as the Ju 88A-5(F) and Ju-88D-0 which had the provision to carry photographic cameras in the bomb bay rear section, extra fuel tanks in the front bomb bay and also had their speed brakes removed from beneath the wing. The Ju 88A-5 airframes served as a basis for the dedicated recon versions of Ju 88 D-2 and D-4, the latter being adapted for service under tropical conditions. Both these subvariants served with recon units where they usually replaced the earlier Do-17 type. The Luftwaffe made use of their recon Ju 88Ds both in the east and west on all fronts from the Arctic Circle to the deserts of Africa. The recon Ju 88Ds were also delivered to German allies namely Rumania and Hungary. Both these satellites saw the Ju 88s operated on the Eastern Front, following the Rumania's changeover to the Allies, her Junkers airplanes were also put into action against the Wehrmacht. Handful of Junkers airframes were also captured and test-flown by the Allies.

Span: 20.08 m, Length: 14.39 m, Max. Speed: 470 km/h , Ceiling: 8 200m, Range: 1790 km

## Plastic Parts A

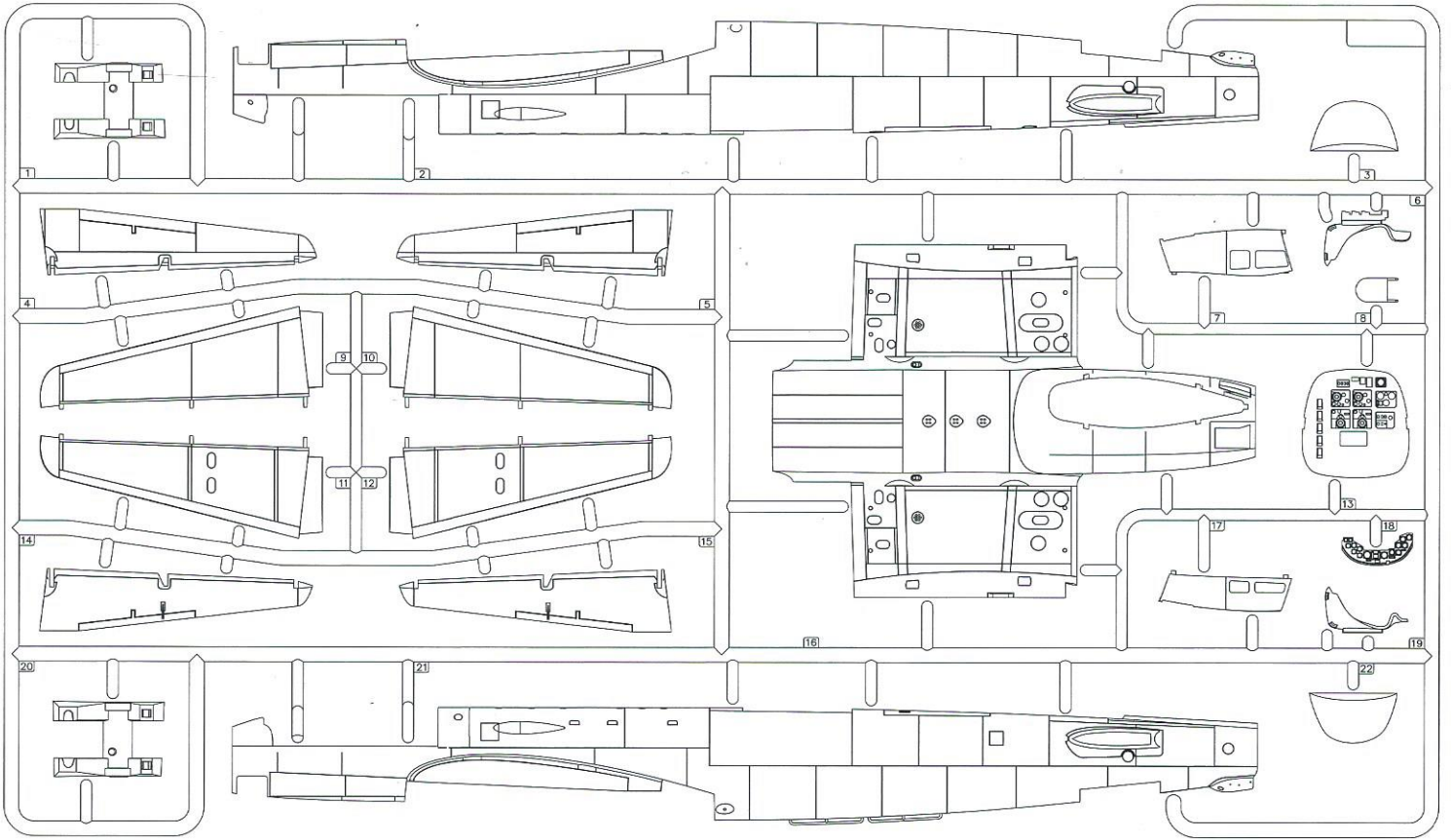

## Plastic Parts B

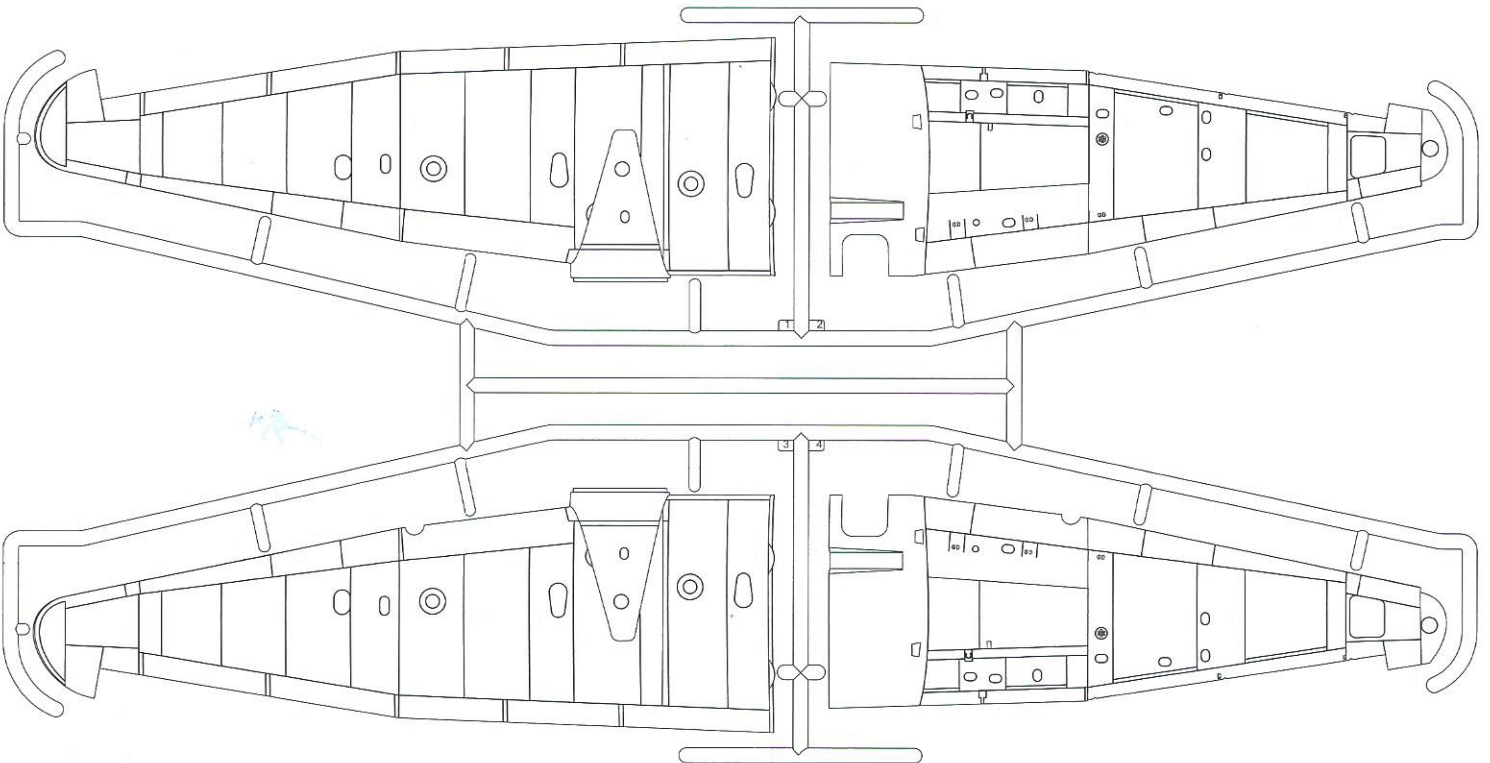

### Plastic Parts C

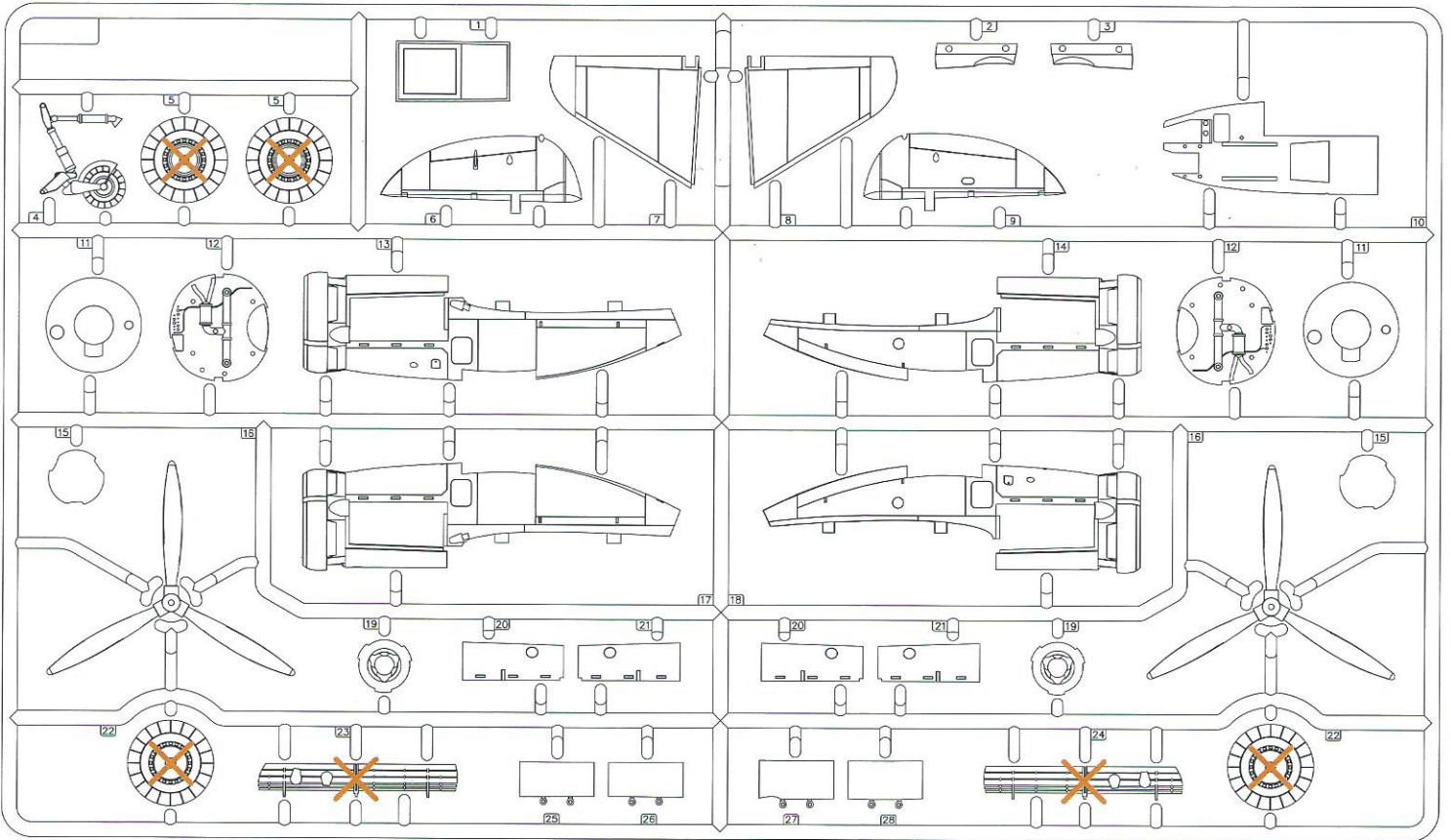

### Plastic Parts D

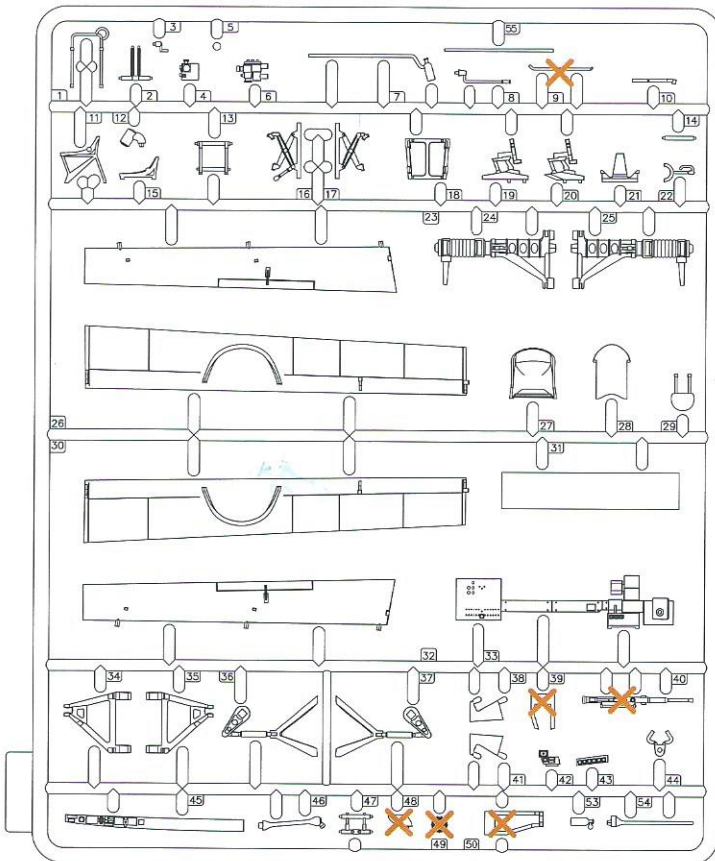

### Plastic Parts E (2x)

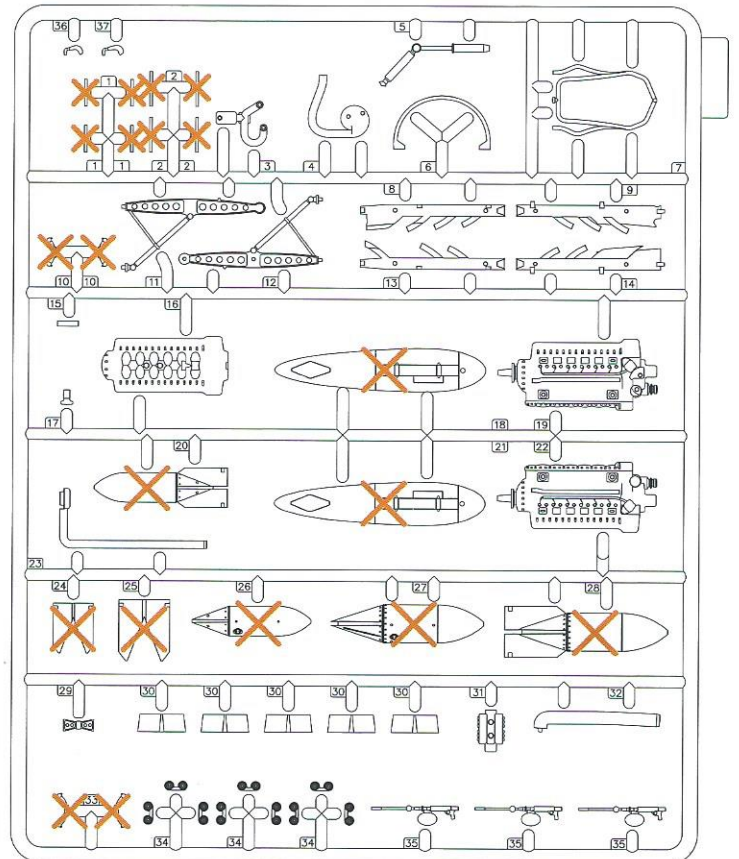

## Clear Parts K

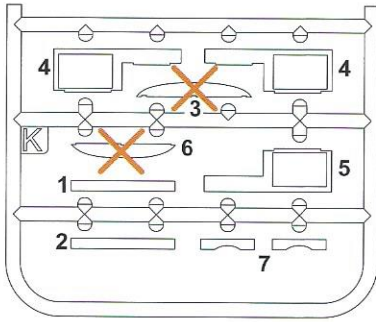

## PUR Parts

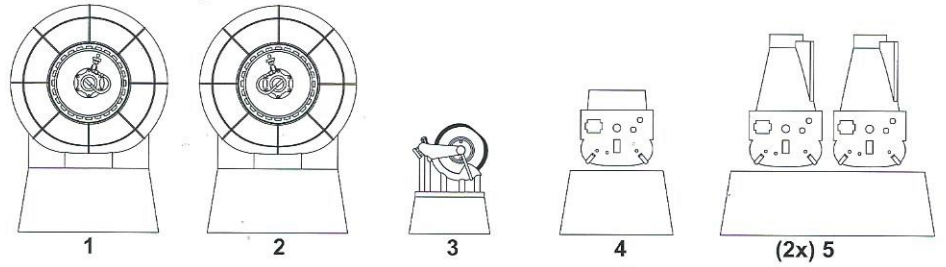

## Clear Parts M

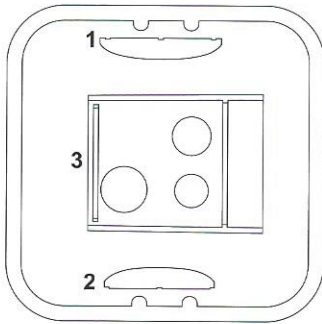

## Clear Parts F

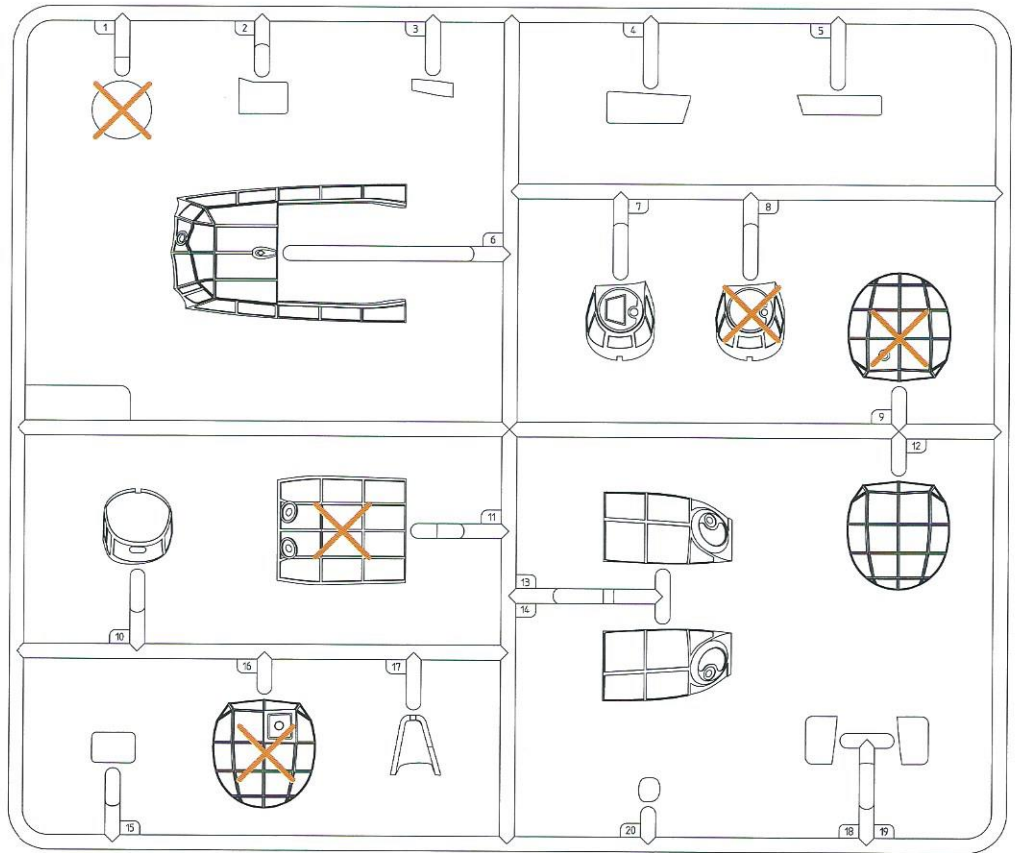

**Tento díl  
nepoužít**



**Do not use  
this part**

### Barvy GUNZE/ GUNZE Colour No.

<b>A</b> Černá/ Black	H12/ C33	<b>G</b> Černošedá/ Black Grey	C116	<b>M</b> Barva kovu/ Steel	H28/ C78
<b>B</b> Barva pneu/ Tire Black	H77/ C137	<b>H</b> Šedá 02/ Grey 02	H70/ C60	<b>N</b> Tmavá šedá/ Dark Grey	H83/ C32
<b>C</b> Špinavá bílá/ Off White	H21/ C69	<b>I</b> Tmavý kov/ Gun Metal	H28/ C78	<b>O</b> Barva kůže/ Leather	H17/ C29
<b>D</b> Černozelená/ Black Green	H65/ C18	<b>J</b> Žlutá/ Yellow	C113	<b>P</b> Olivově zelená/ Olive Green	H420/ C120
<b>E</b> Tmavá zelená/ Dark Green	H64/ C17	<b>K</b> Červená/ Red	H3/ C3	<b>Q</b> Pískově žlutá/ Sand Yellow	H66/ C119
<b>F</b> Světle modrá/ Light Blue	H67/ C115	<b>L</b> Opálený kov/ Burnt Iron	H76/ C61	<b>R</b> Světle modrá/ Light Blue	H418/ C118

### SYMBOLS



MOŽNOST VOLBY  
OPTIONAL  
NACH BELIEBEN  
OPTION



POUŽÍT KYANOAKRYLÁTOVÉ LEPIDLO  
INSTANT CYANOACRYLATE GLUE  
ZYANOAKRYLATKLEBER  
COLLE CYANOACRYLAT



OHNOUT  
BEND  
BIEGEN  
COURBER



ZHOTOVIT NOVÉ  
SCRATCH BUILD  
FERTIGSTELLEN  
ACHEVER



ŘEZAT/VRTAT  
CUT OFF/DRILL  
ENTFERNEN  
DETACHER

GSI **A**  
colours code

NATŘÍT  
COLOUR  
FARBEN  
PEINDRE

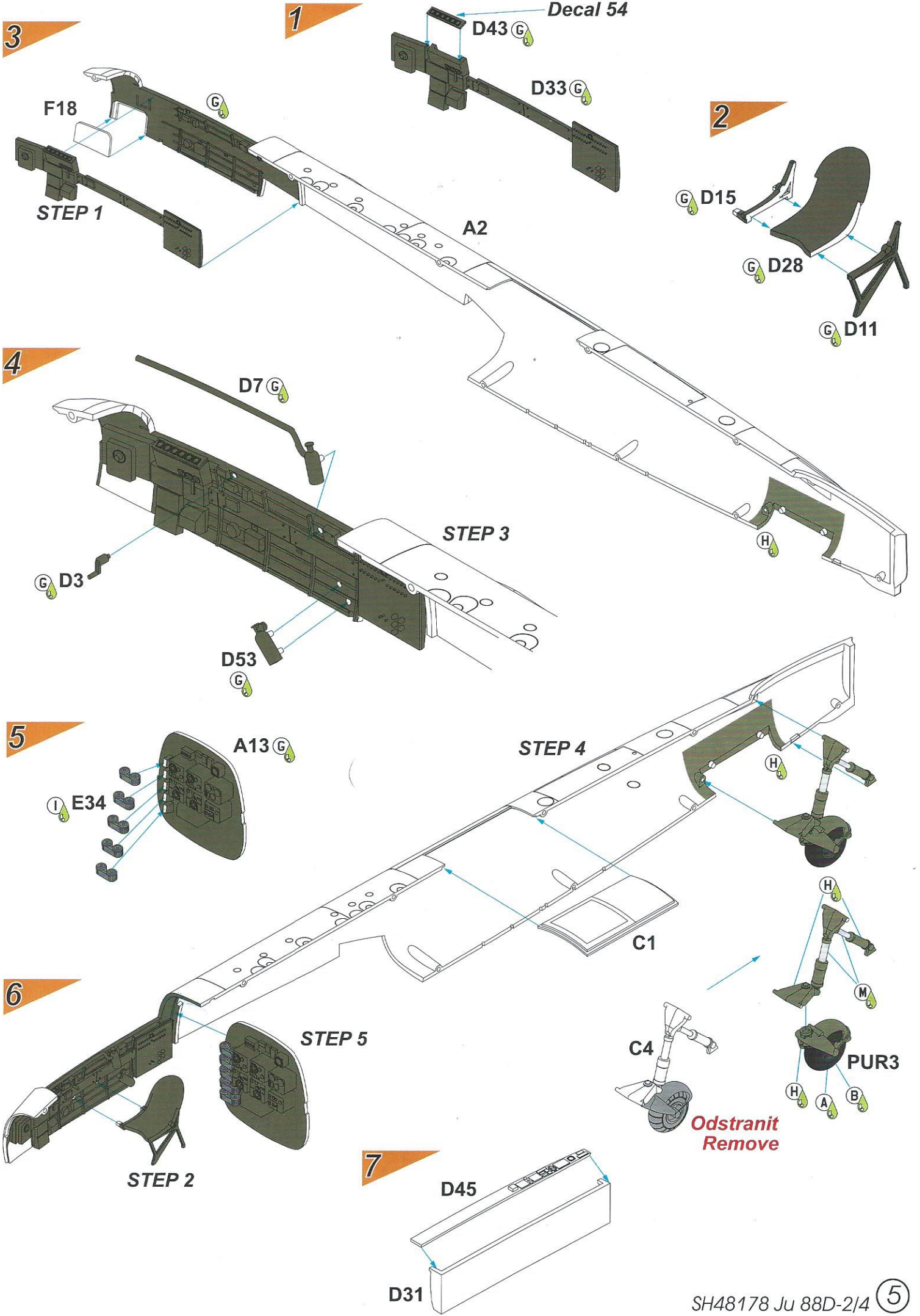

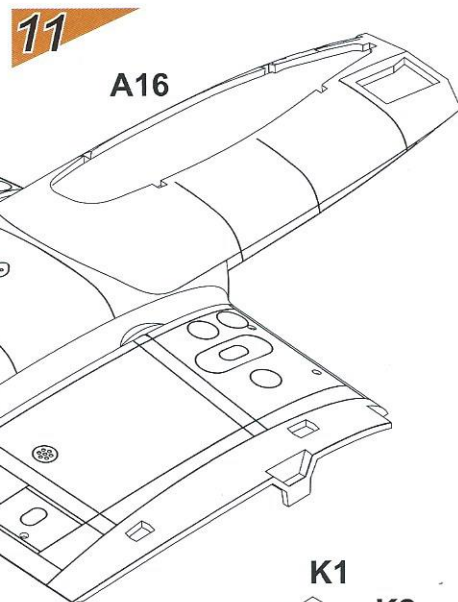
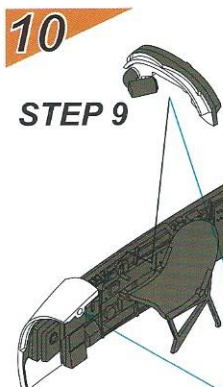
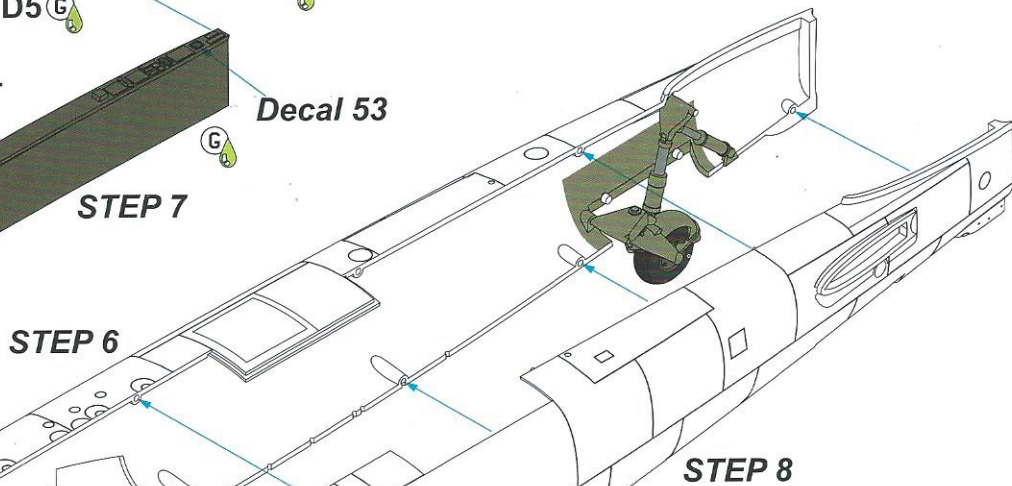
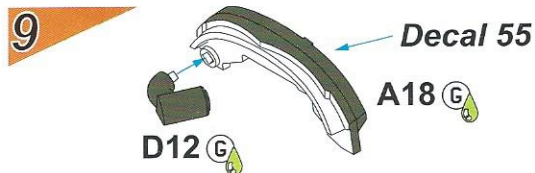
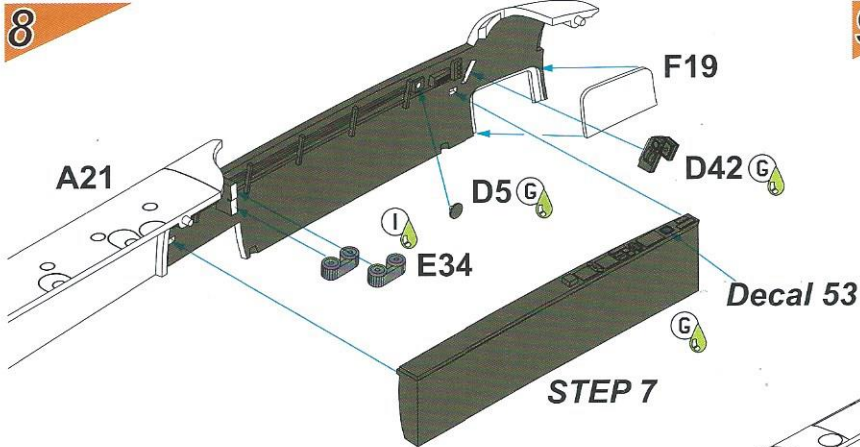

**12**

*Make cut-out slightly smaller then try and fit part M3 carefully.*



*Doporučujeme odříznout méně materiálu a opatrně dopasovat díl M3.*

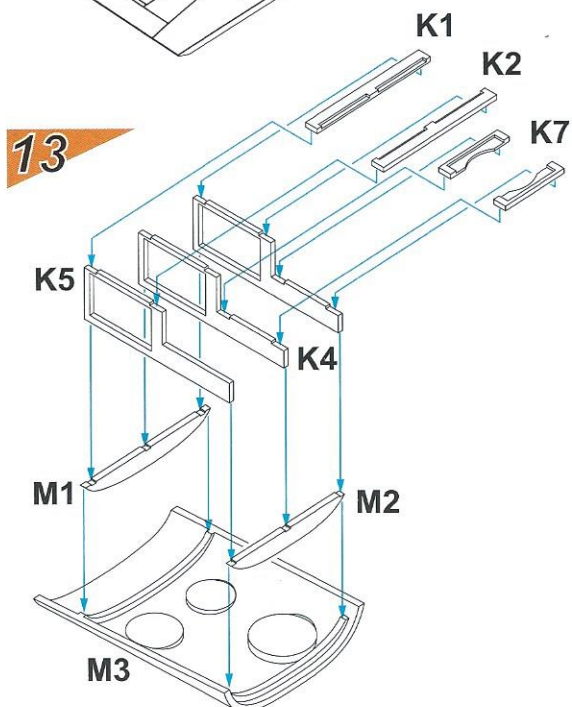
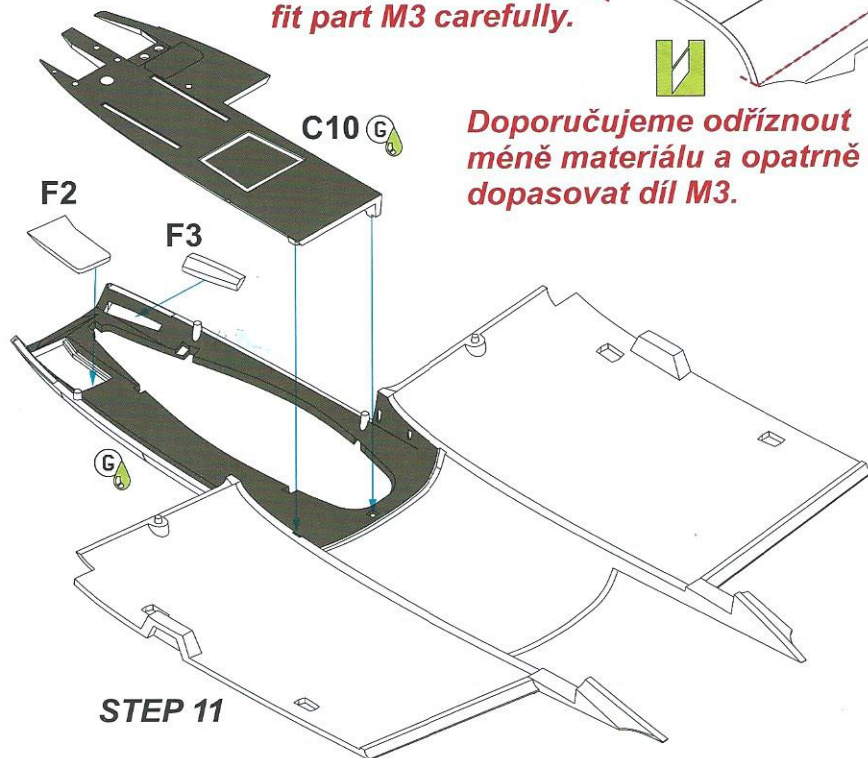

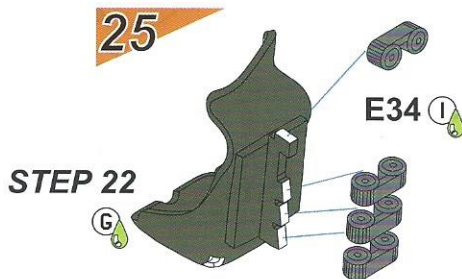
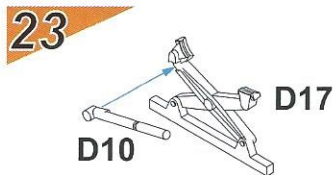
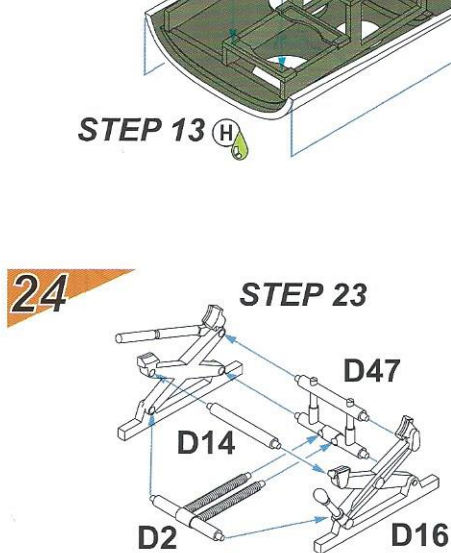
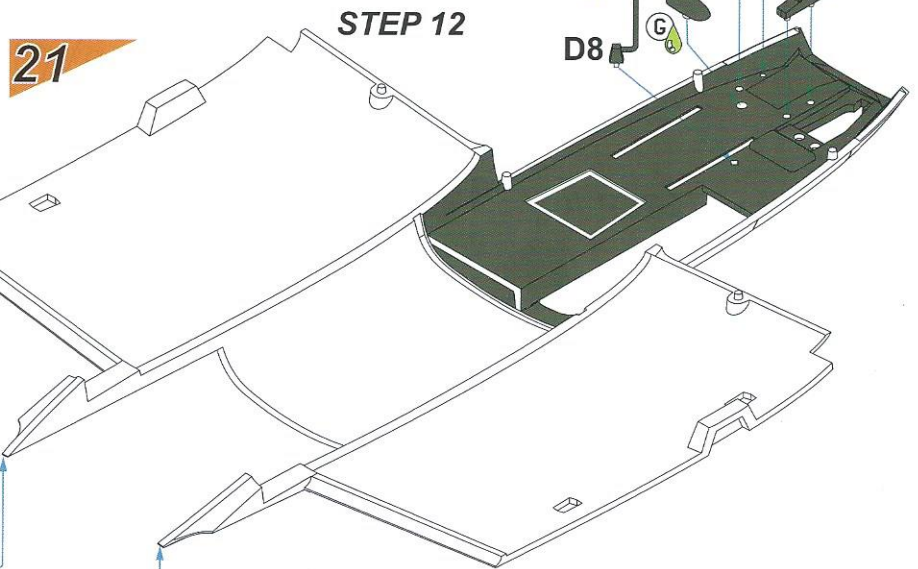
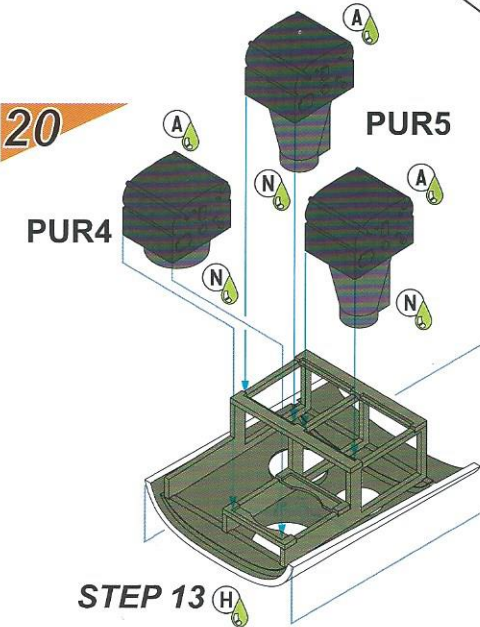
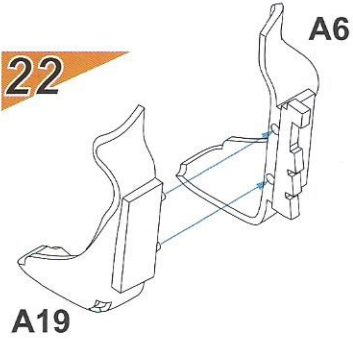
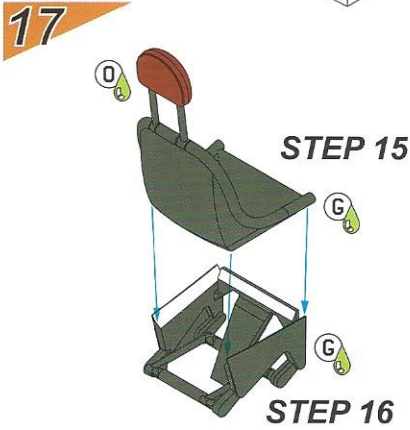
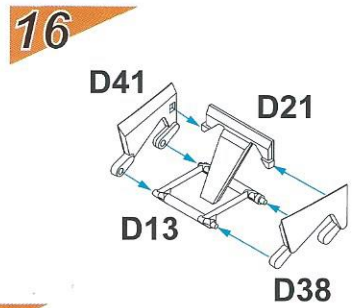
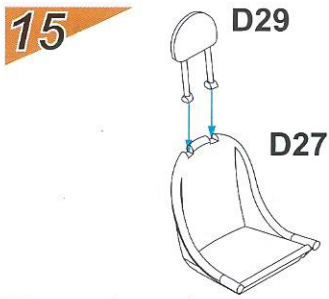
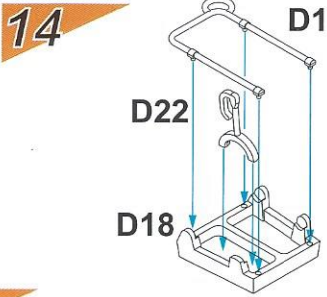

27

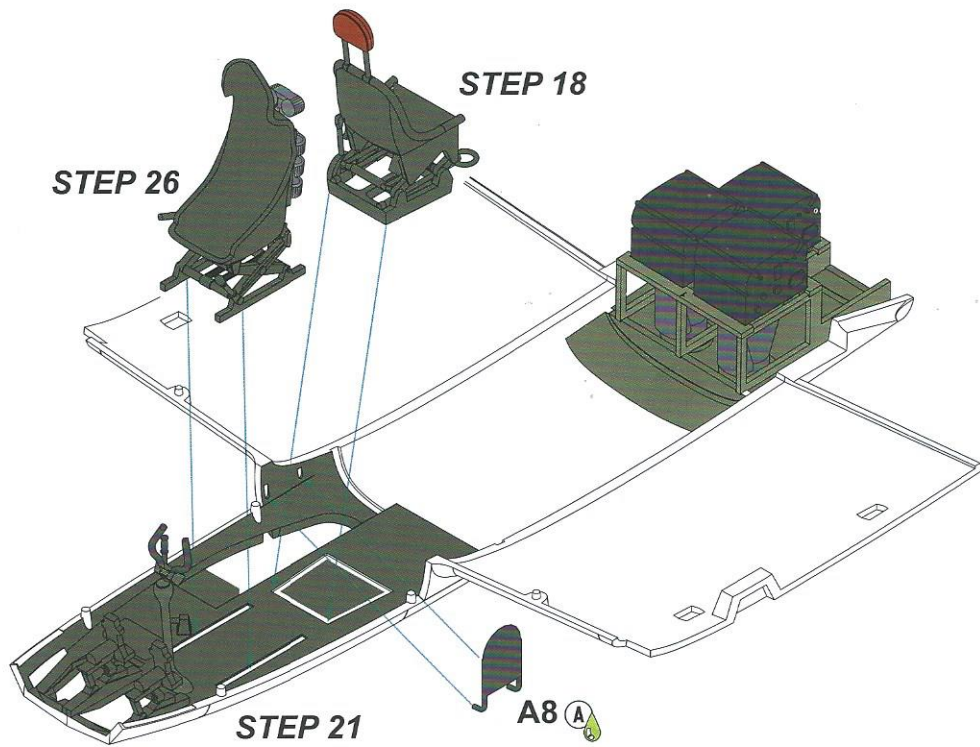

28

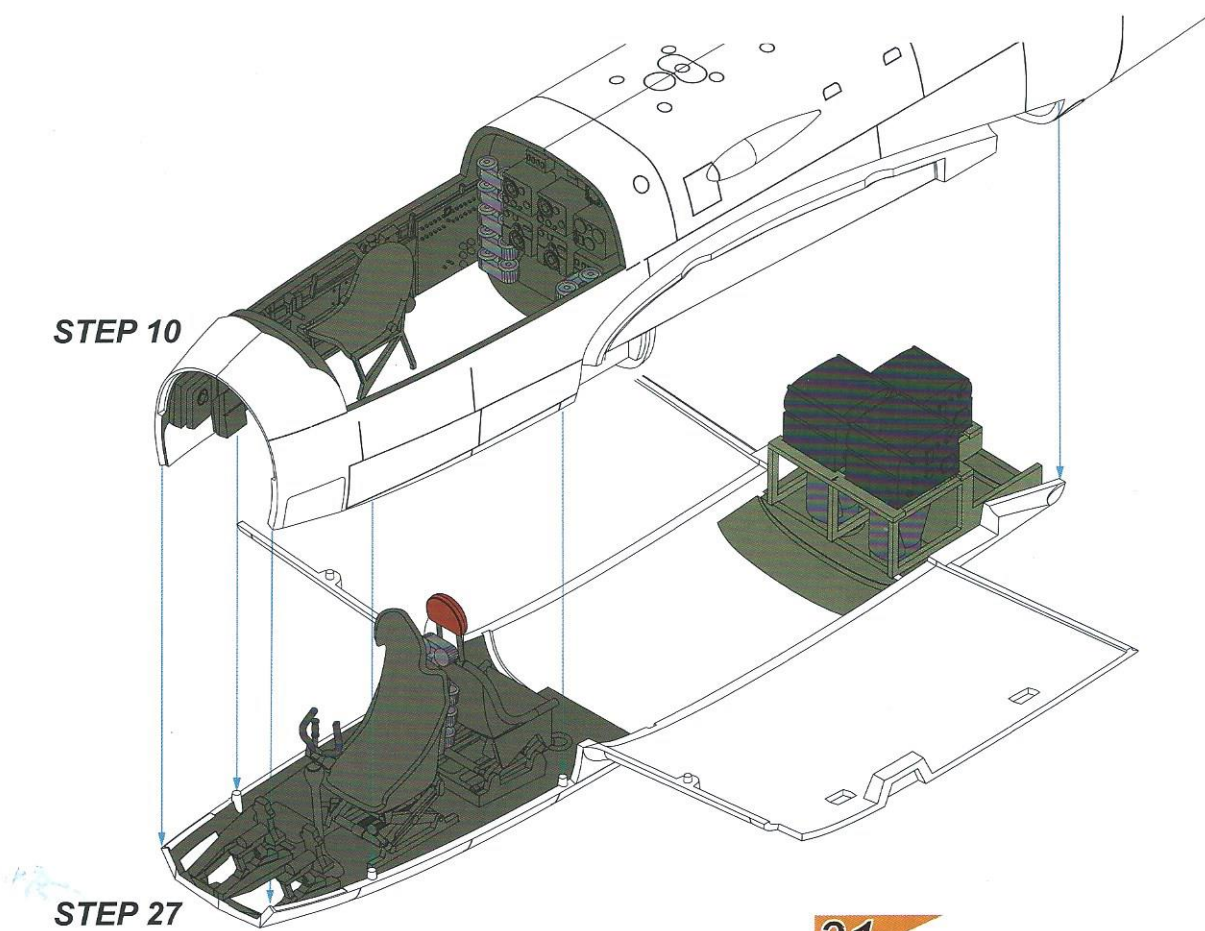

29

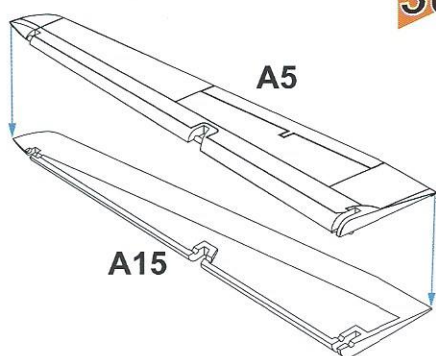

30

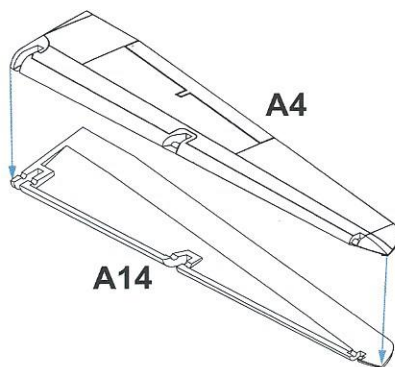

31

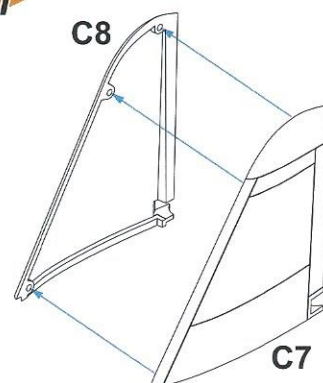



32

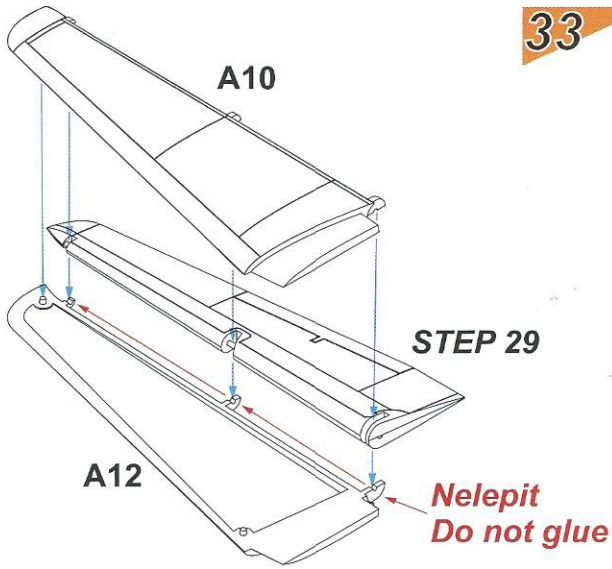

33

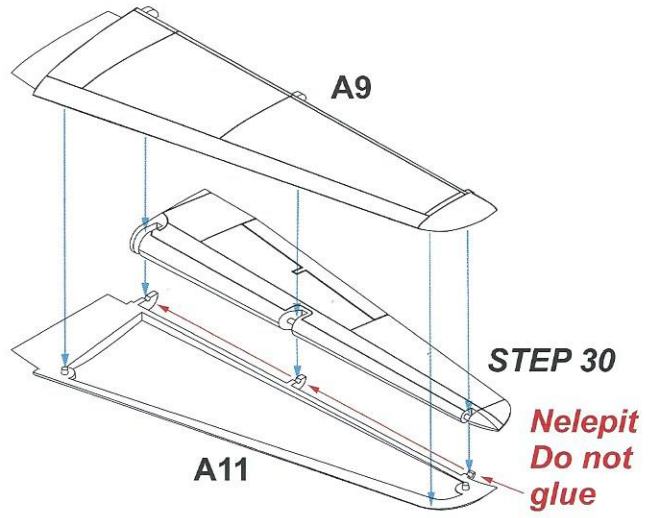

34

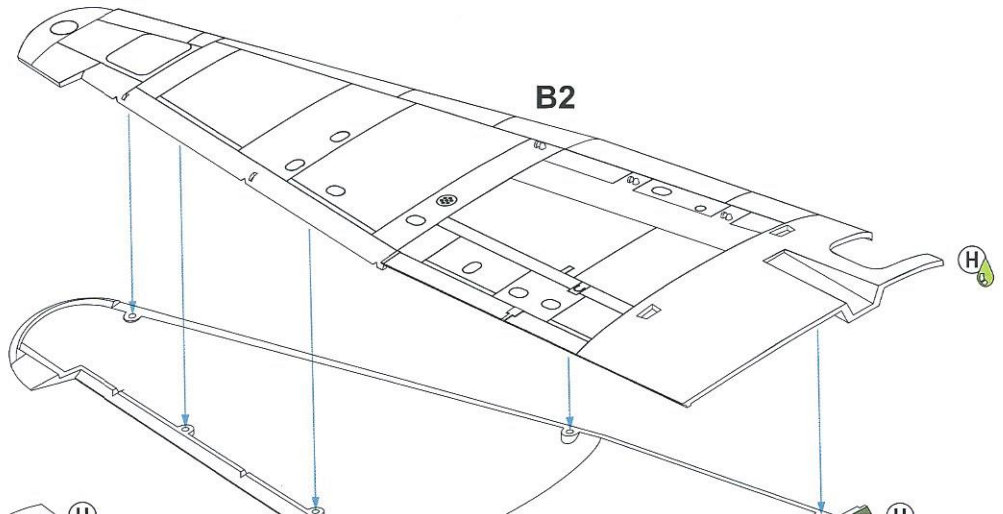

35

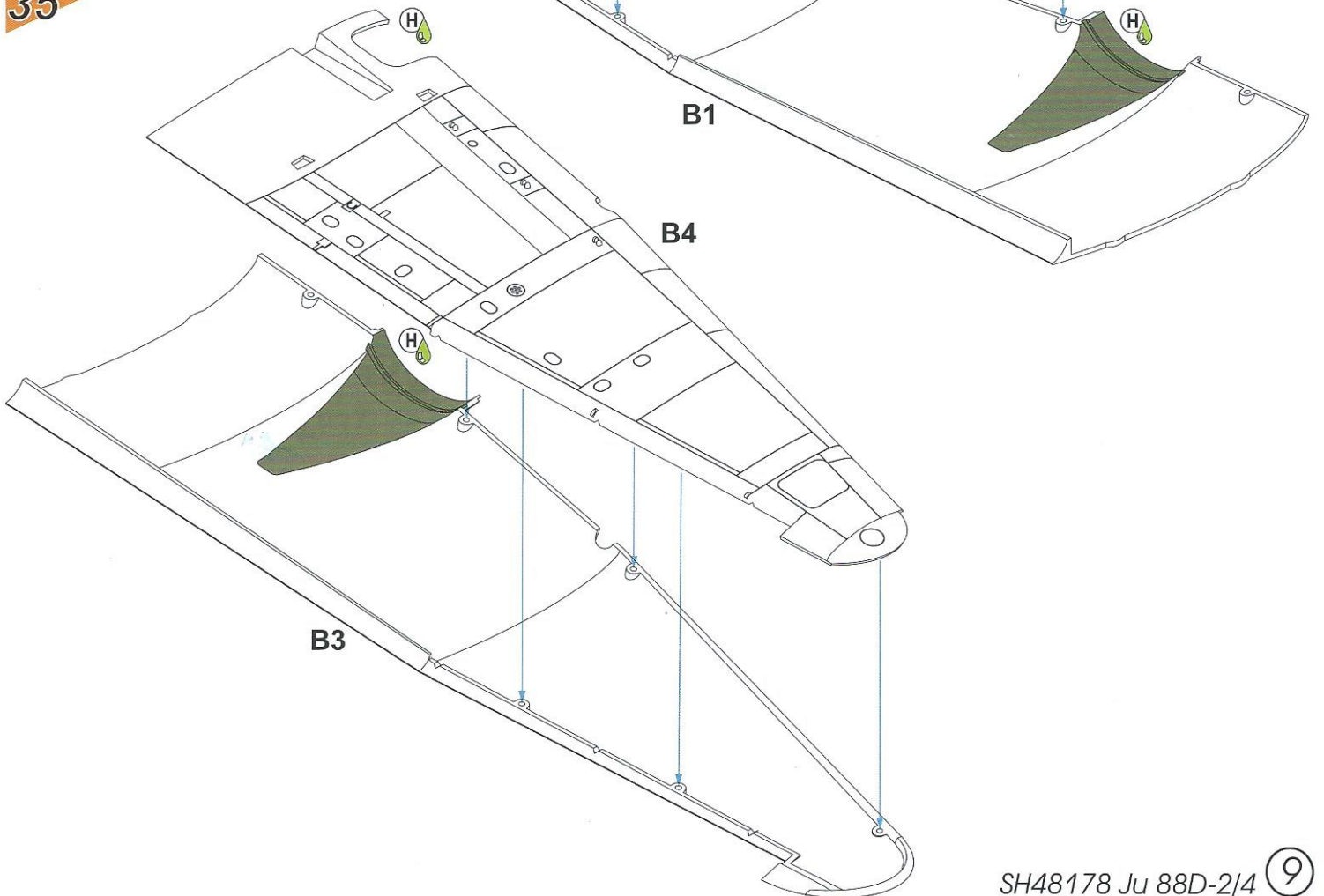

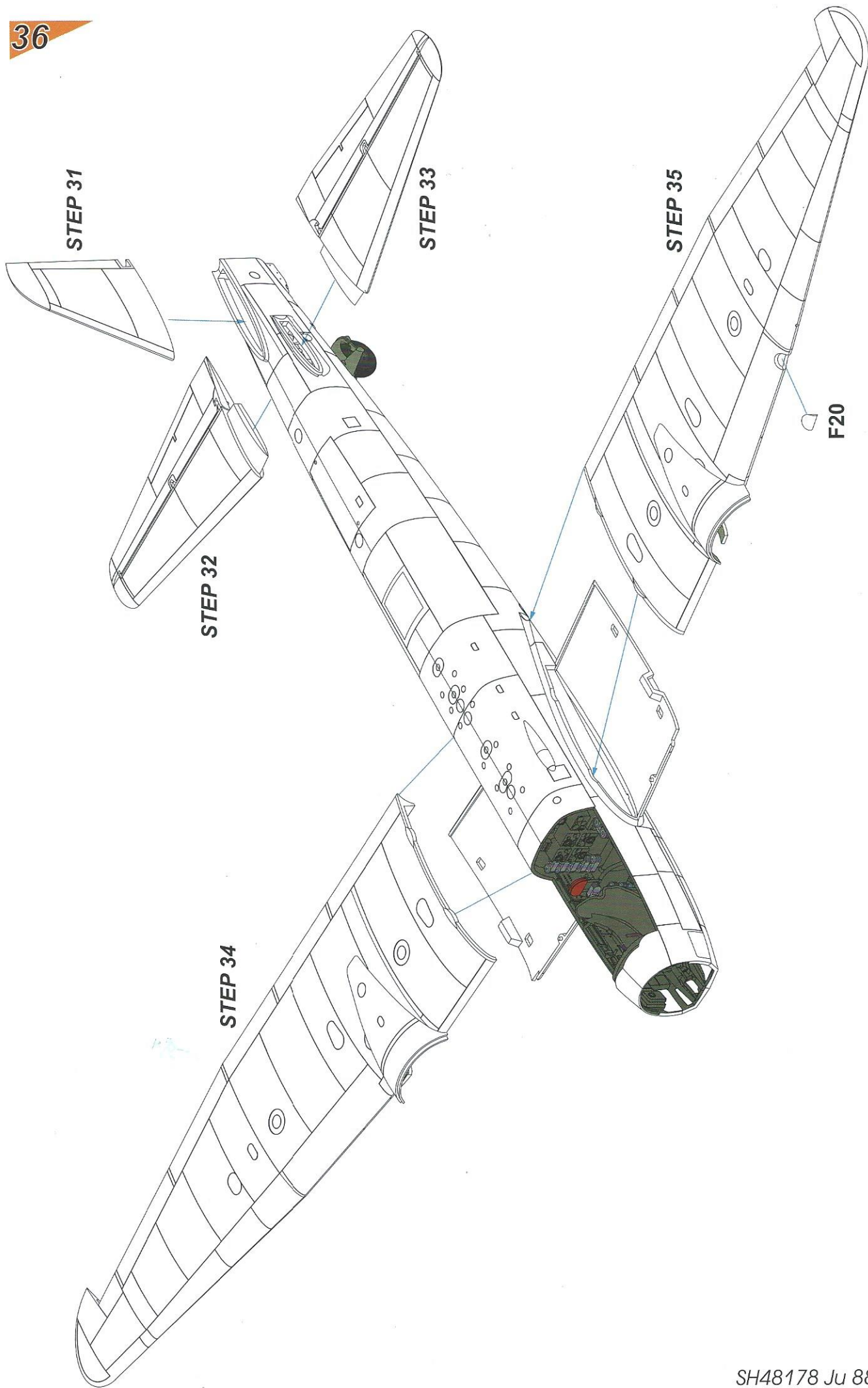

37

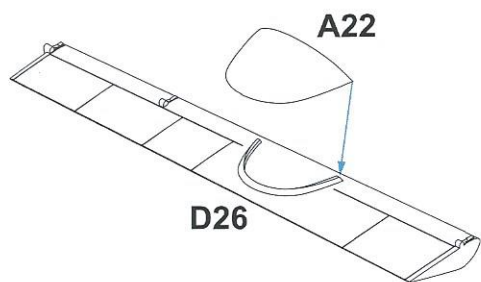

38

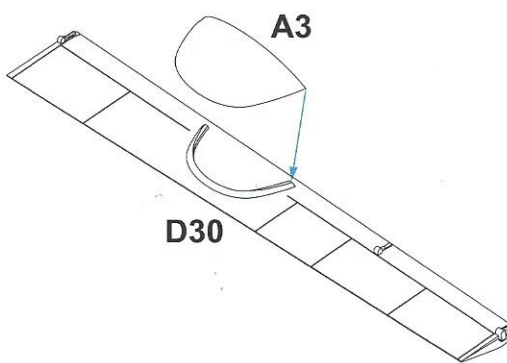

39

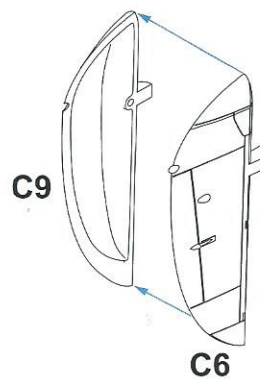

40

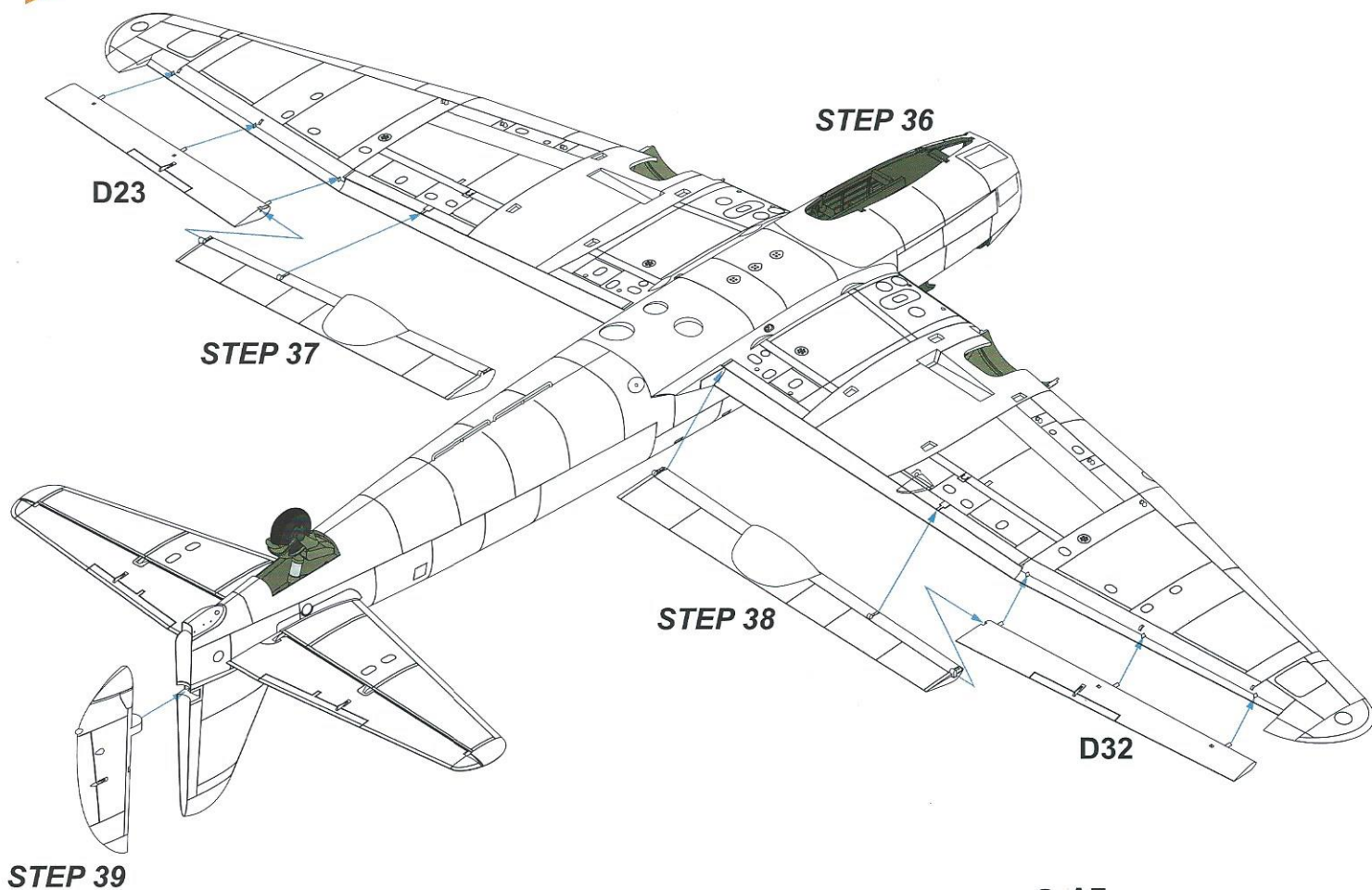

41

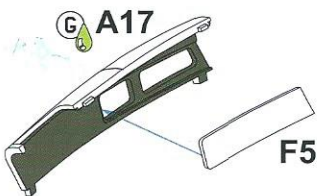

42

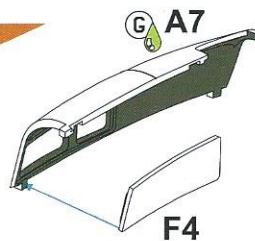

43

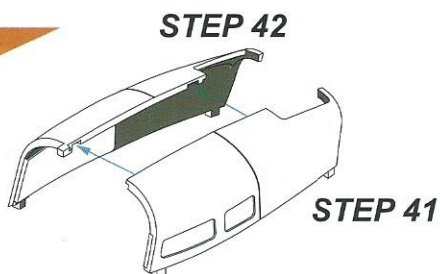

44

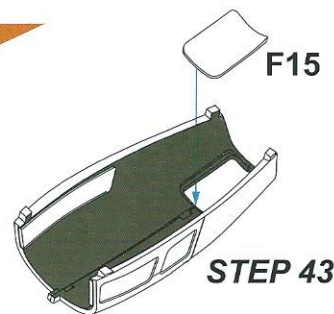

45

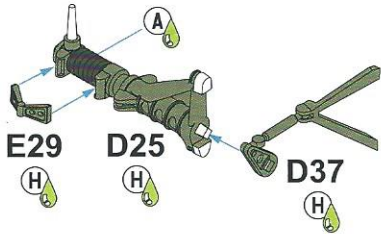

46

STEP 45

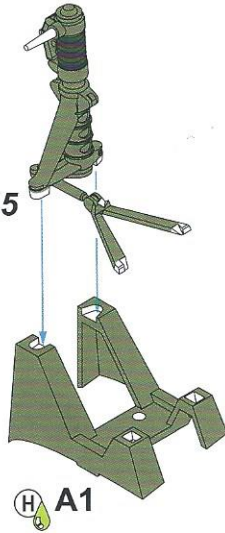

47

STEP 46

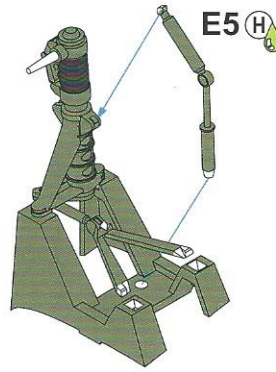

48

STEP 47

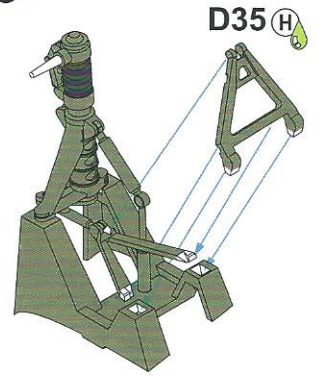

49

STEP 48

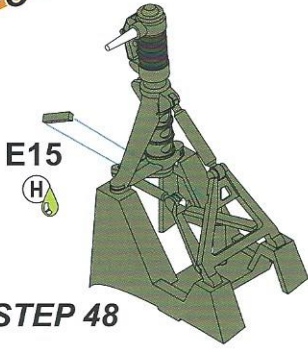

50

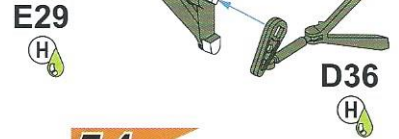

51

STEP 50

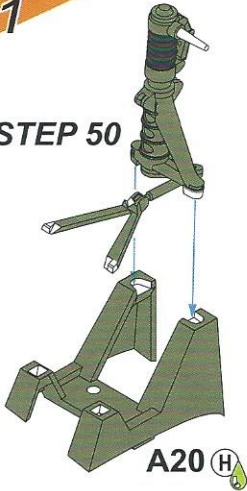

52

STEP 51

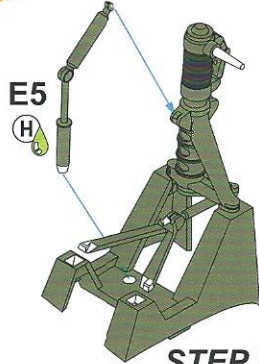

53

STEP 52

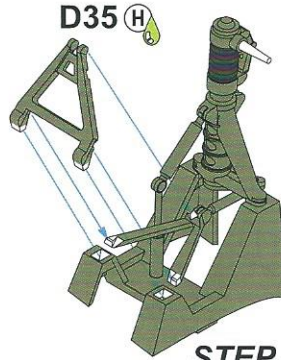

54

STEP 53

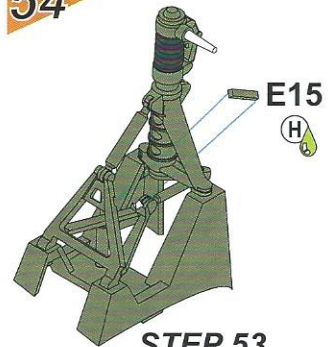

55

STEP 49

STEP 44

STEP 54

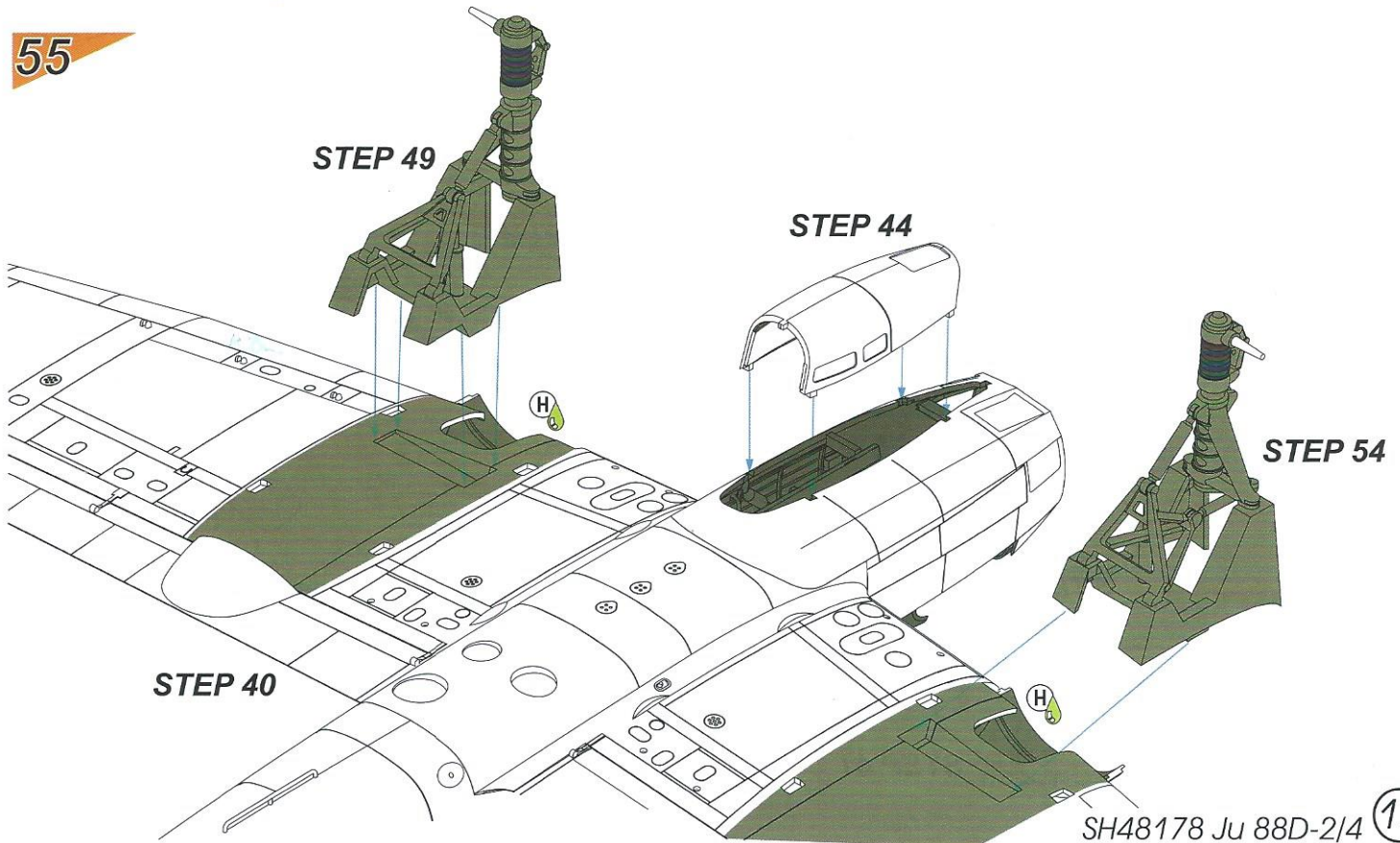

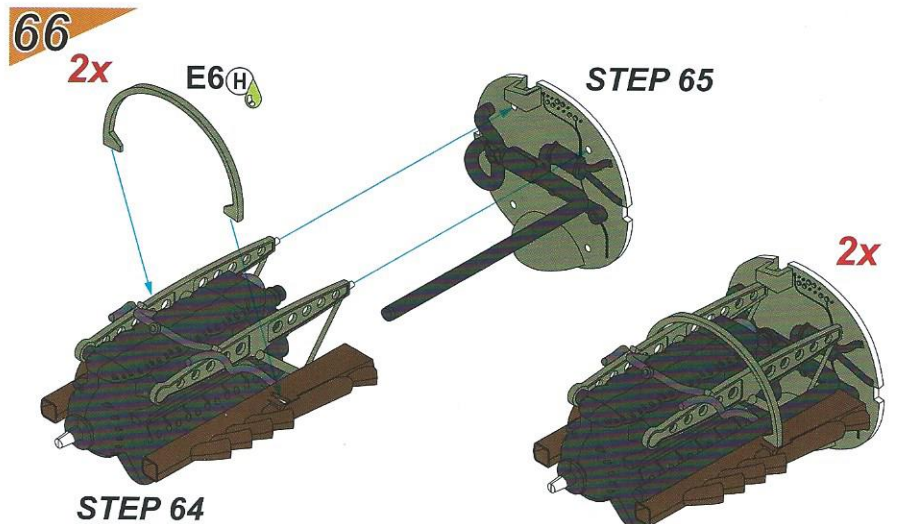
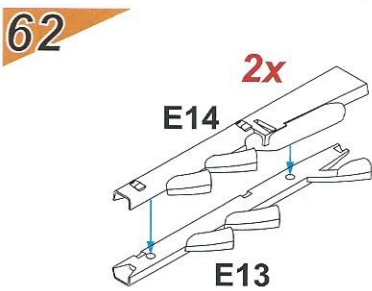
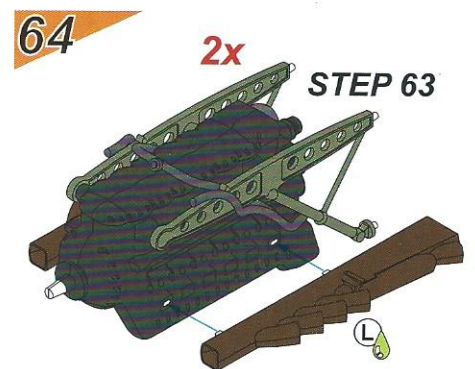
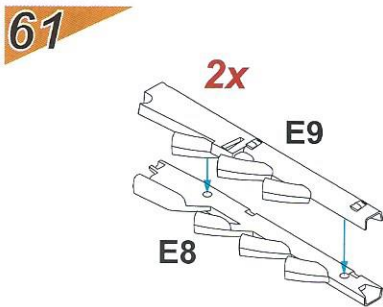
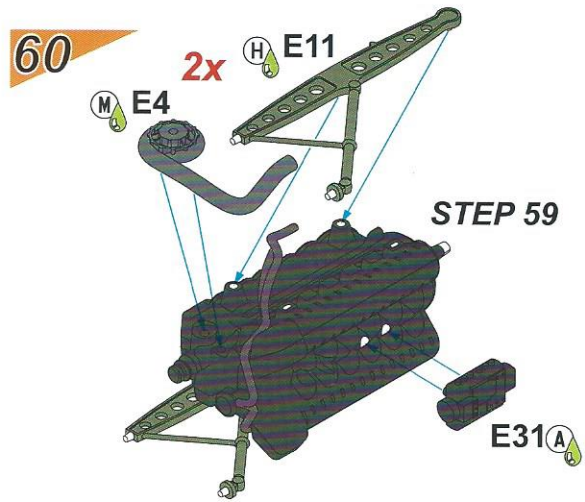
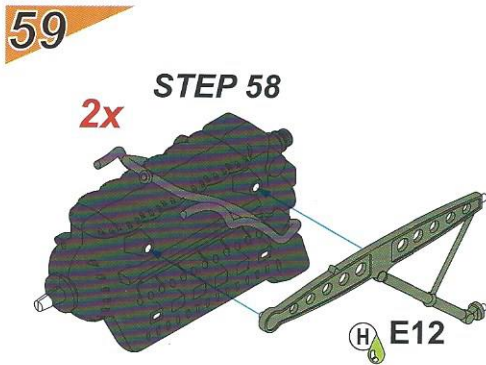
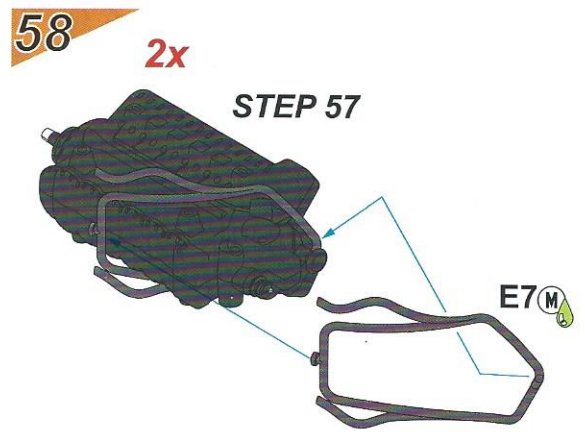
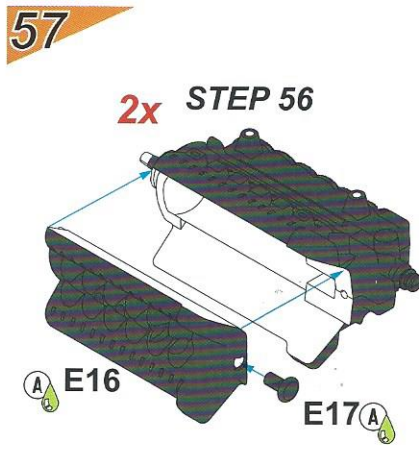
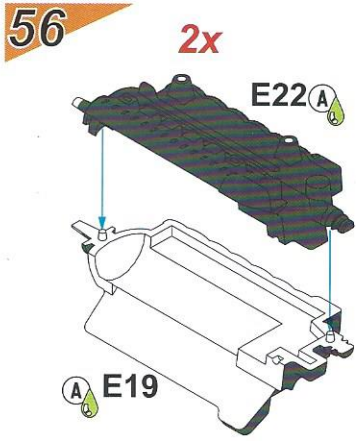

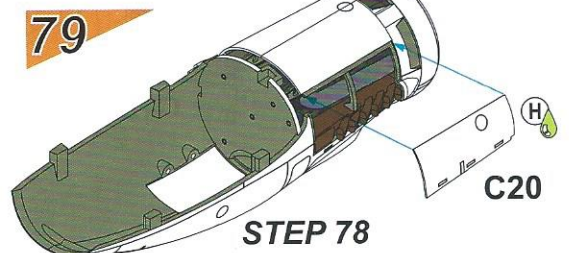
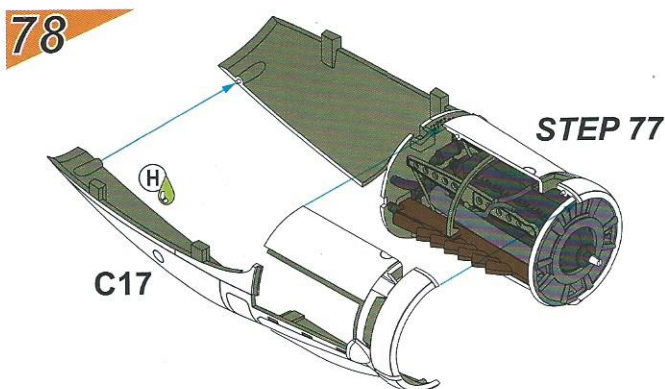
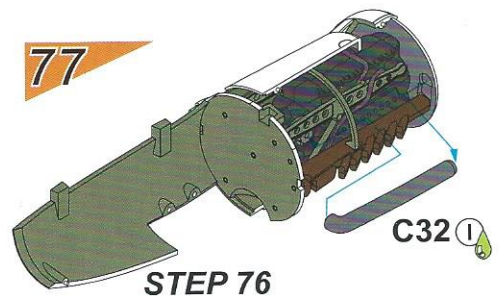
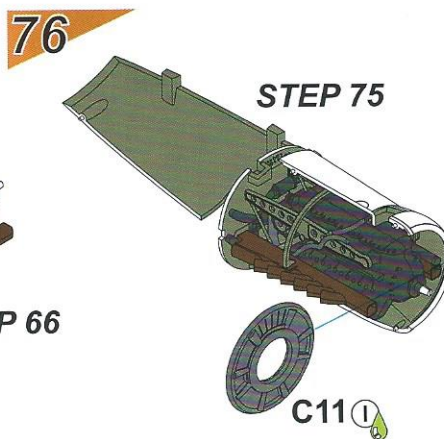
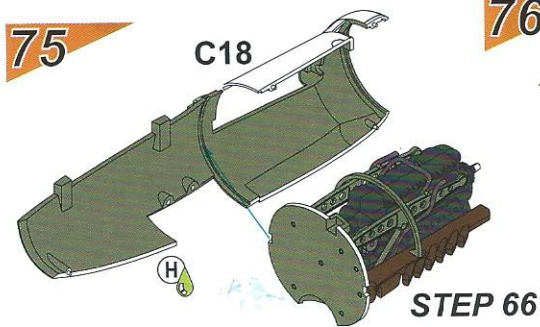
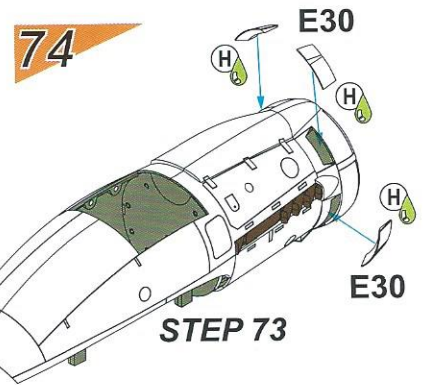
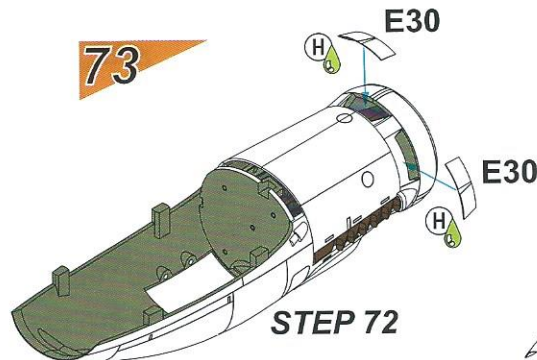
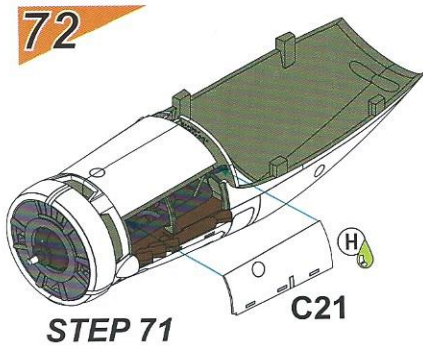
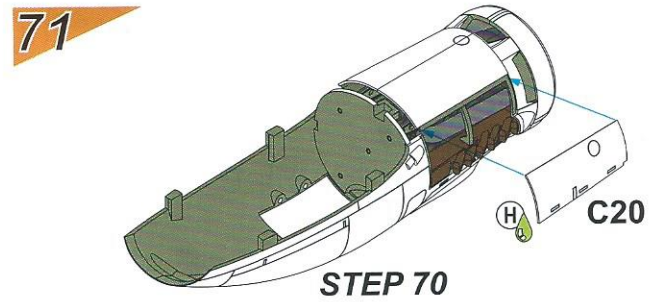
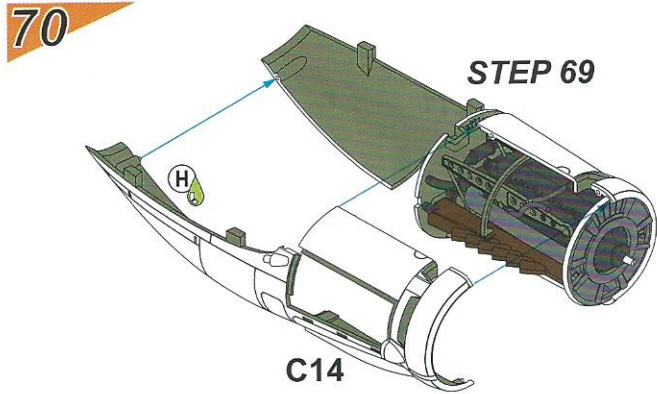
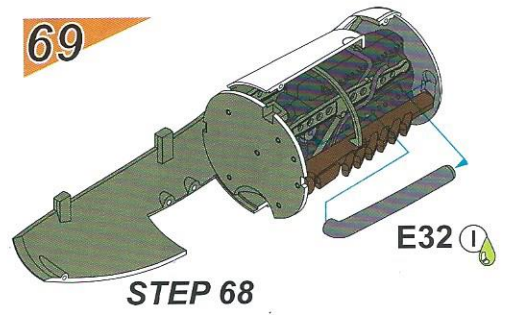
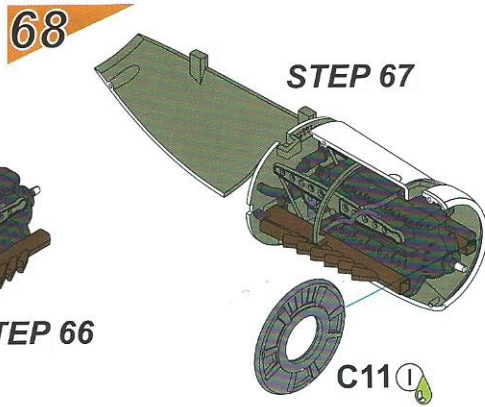
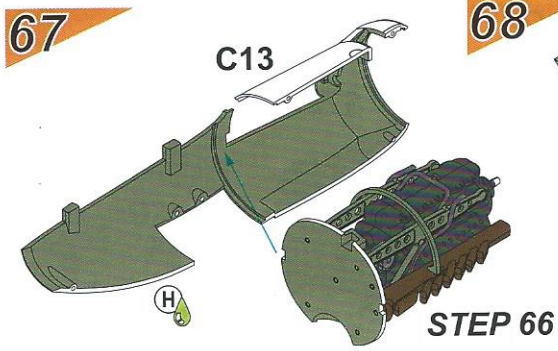

80

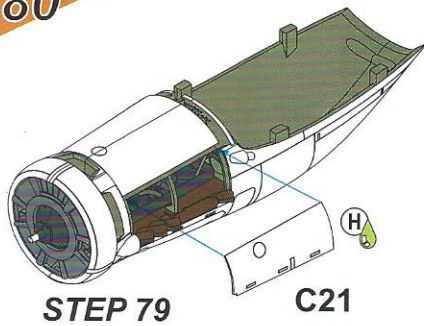

STEP 79

C21

81

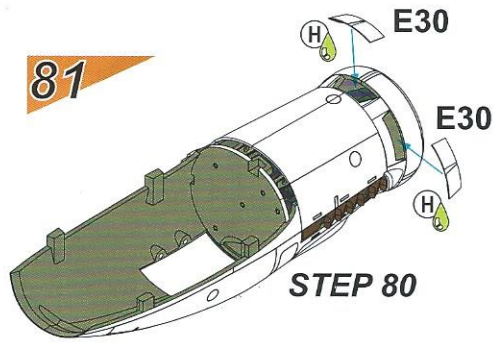

STEP 80

82

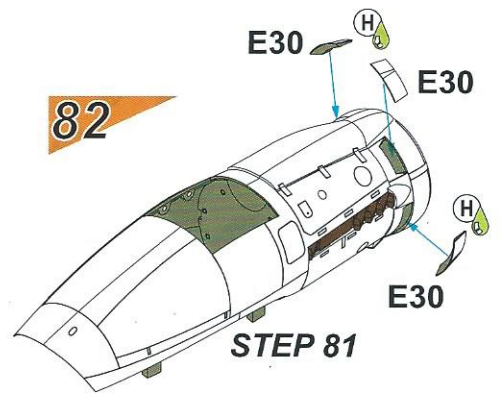

STEP 81

83

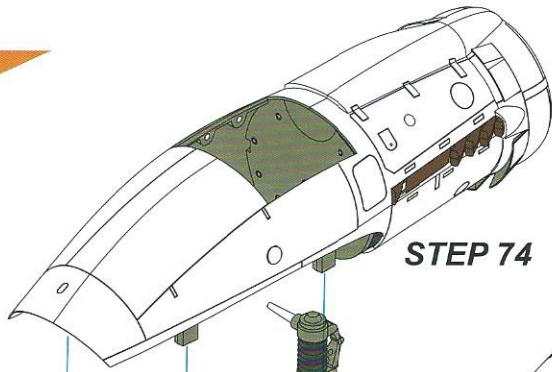

STEP 74

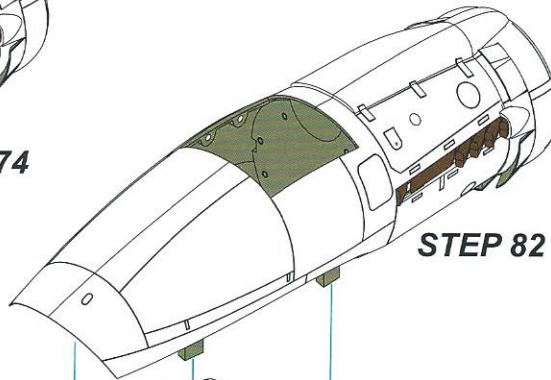

STEP 82

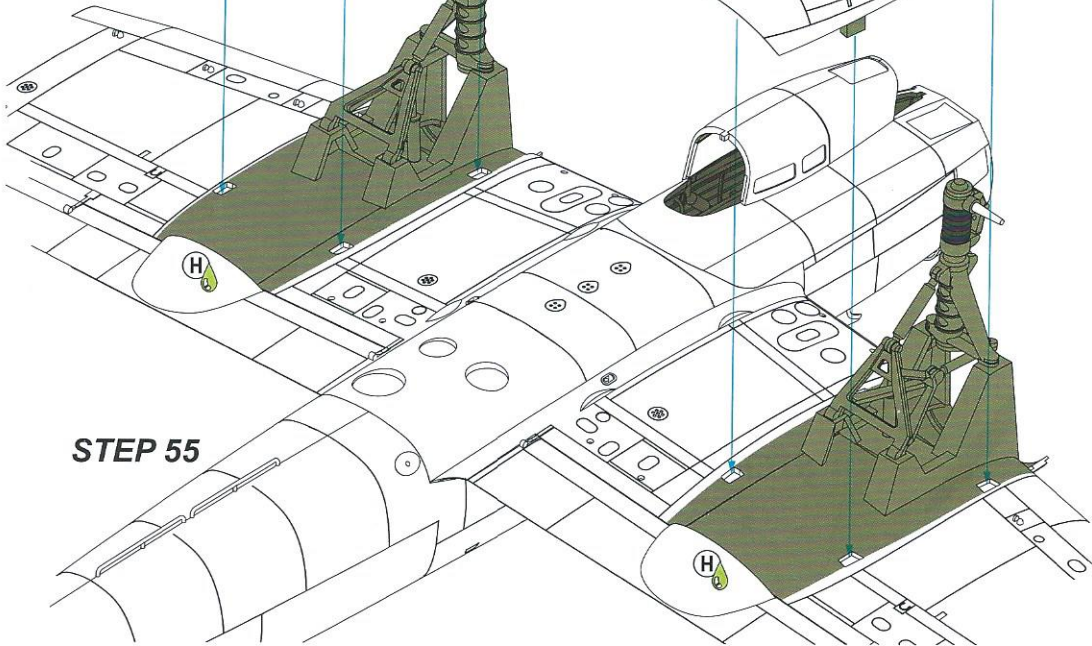

STEP 55

84

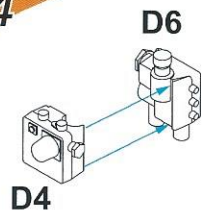

D4

D6

85

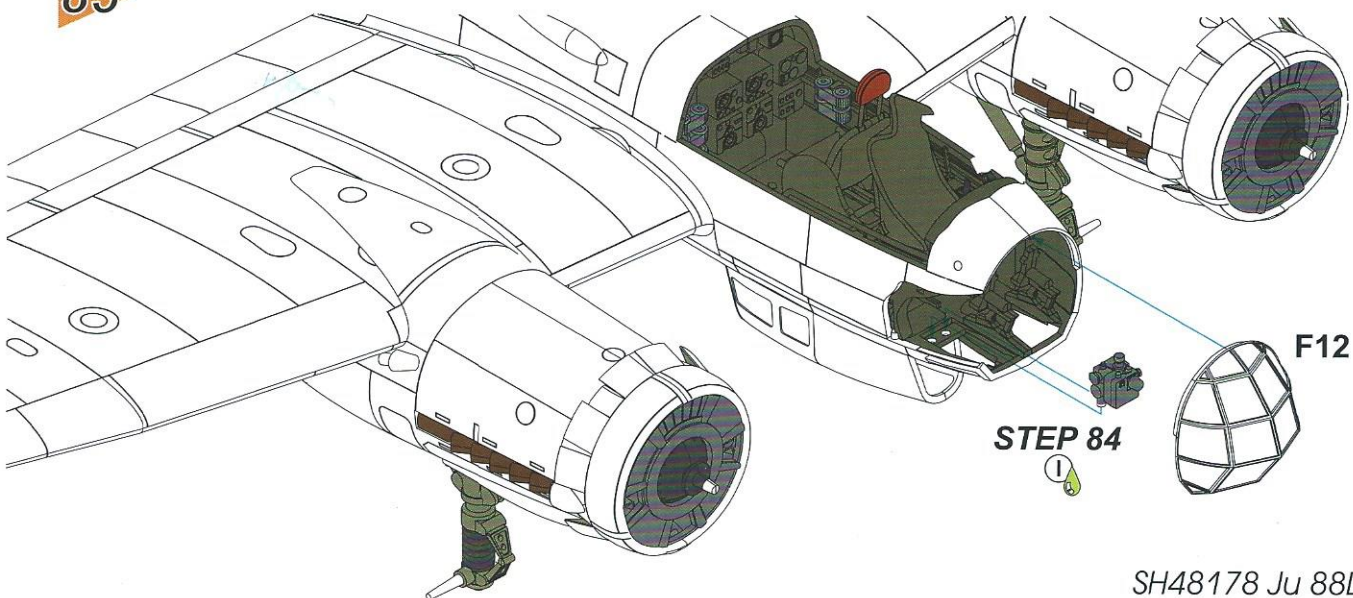

STEP 84

F12

I

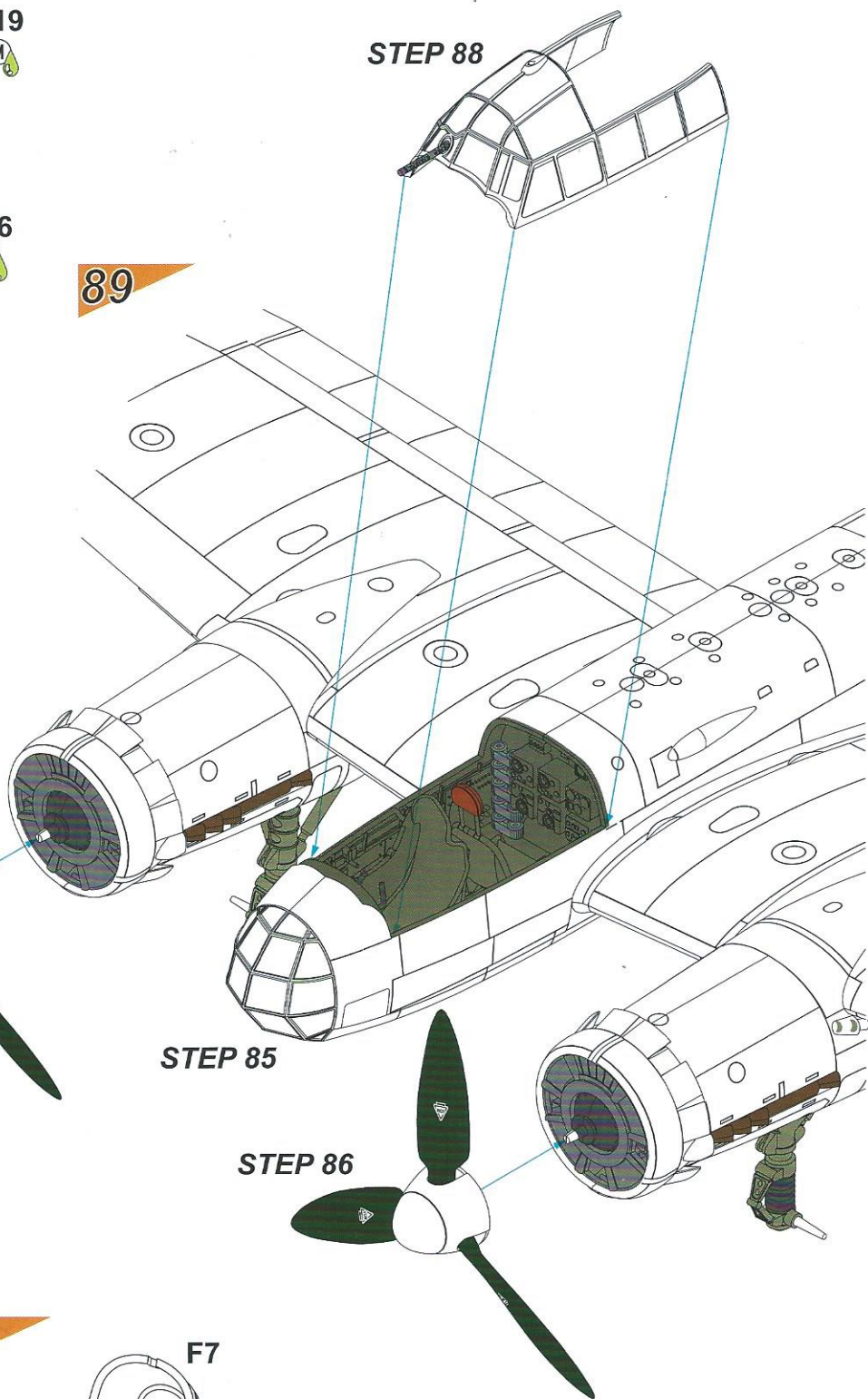
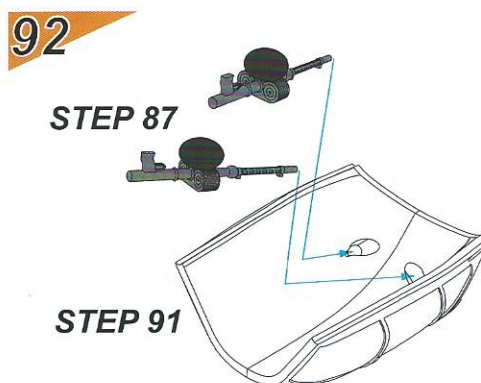
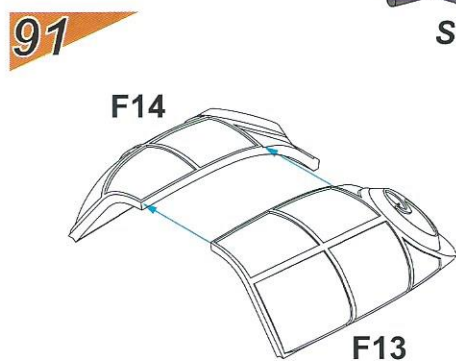
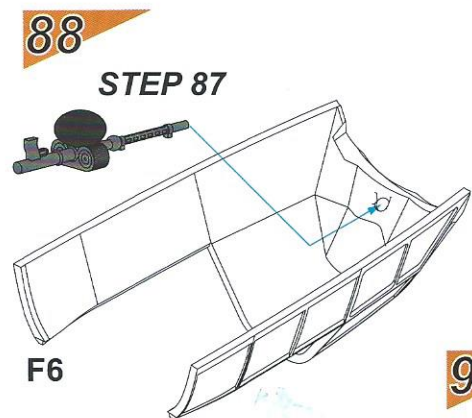
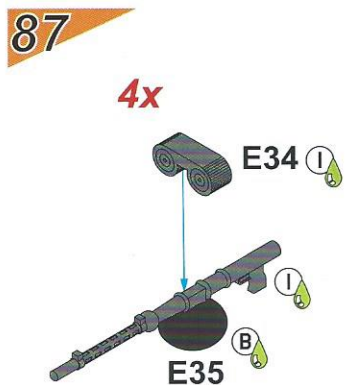
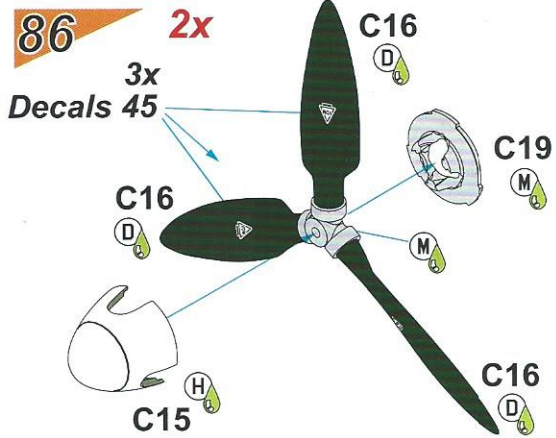



93

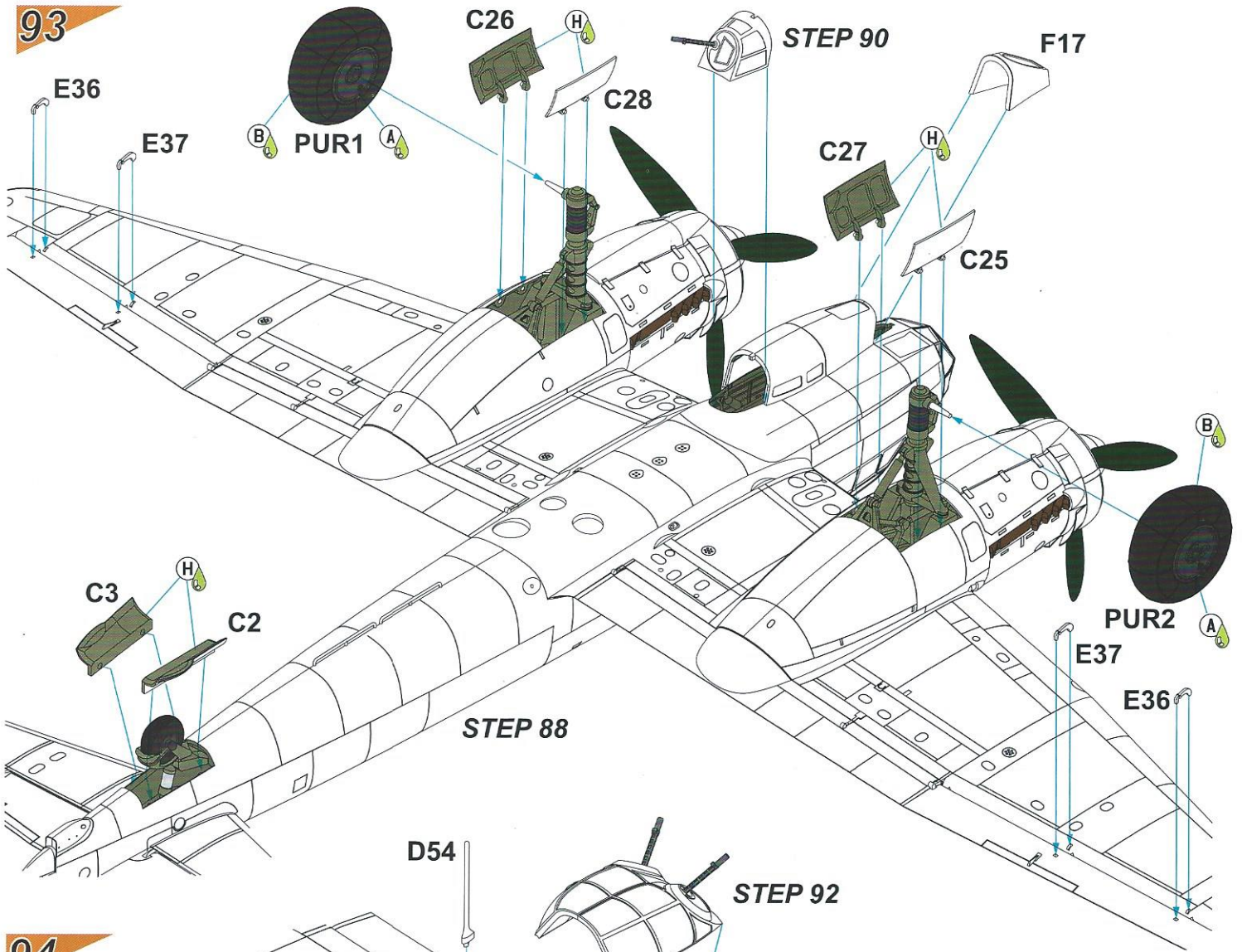

94

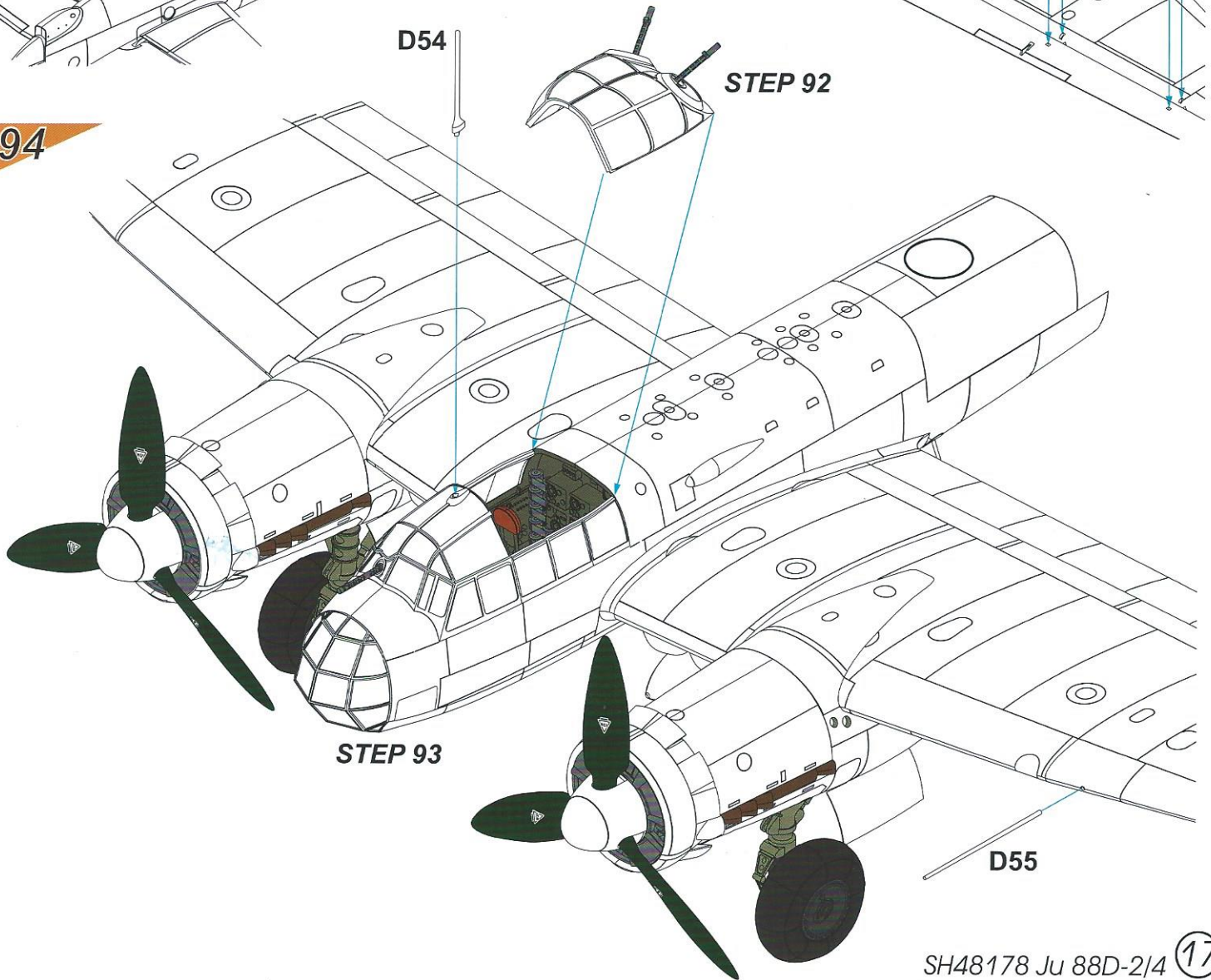

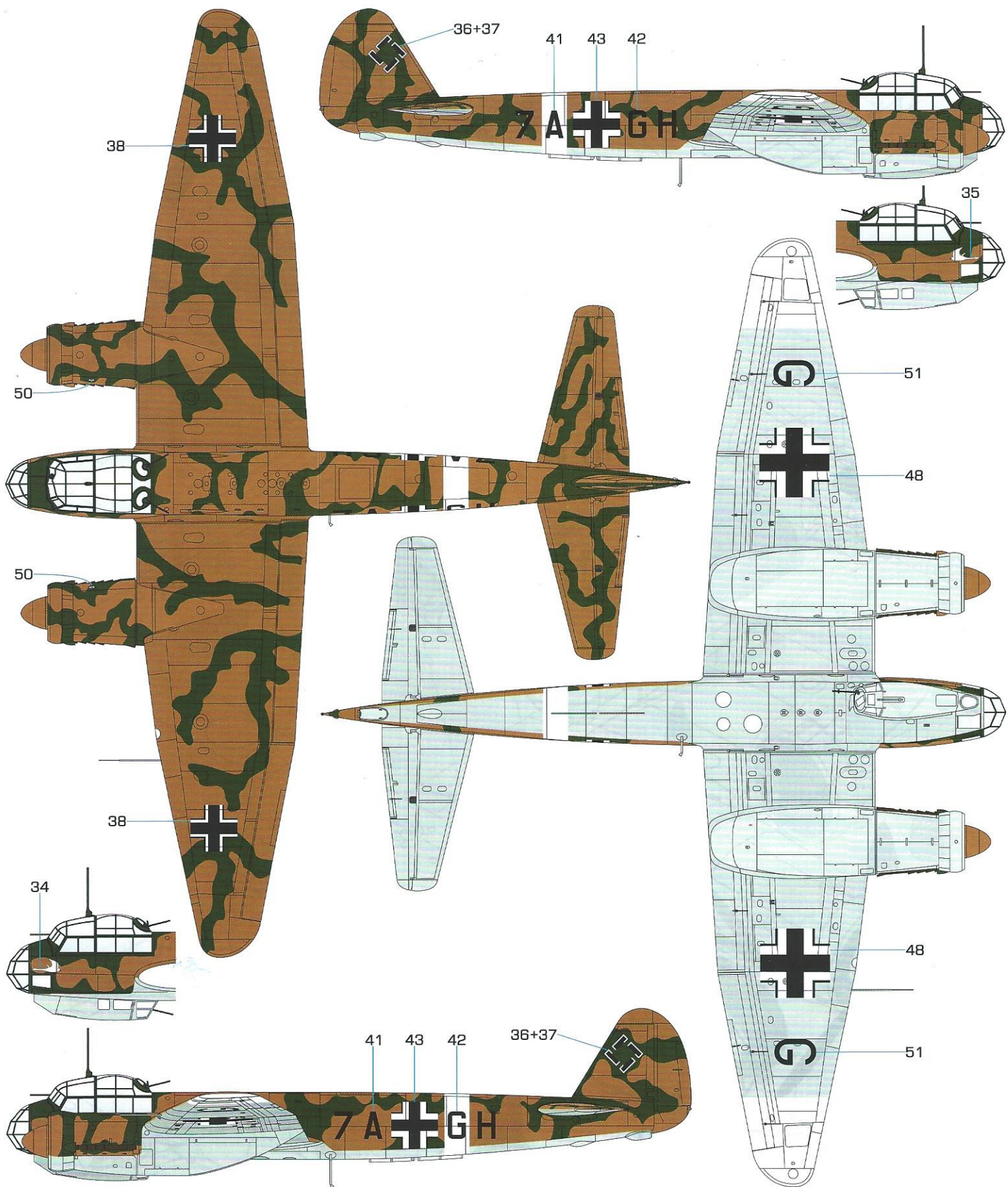

- |  |   |   |   |   |  |   |                                       |   |                                       |   |                         |
|--|---|---|---|---|--|---|---------------------------------------|---|---------------------------------------|---|-------------------------|
|  | Olivově zelená<br>Olive Green<br>RLM 80<br>H420/ C120 |  | Pískově žlutá<br>Sand Yellow<br>RLM 79<br>H66/ C119 |  | Světle modrá<br>Light Blue<br>RLM 78<br>H418/ C118 |  | Opálený kov<br>Burnt Iron<br>H76/ C61 |  | Špinavě bílá<br>White Off<br>H21/ C69 |  | Bílá<br>White<br>H1/ C1 |
|--|---|---|---|---|--|---|---------------------------------------|---|---------------------------------------|---|-------------------------|

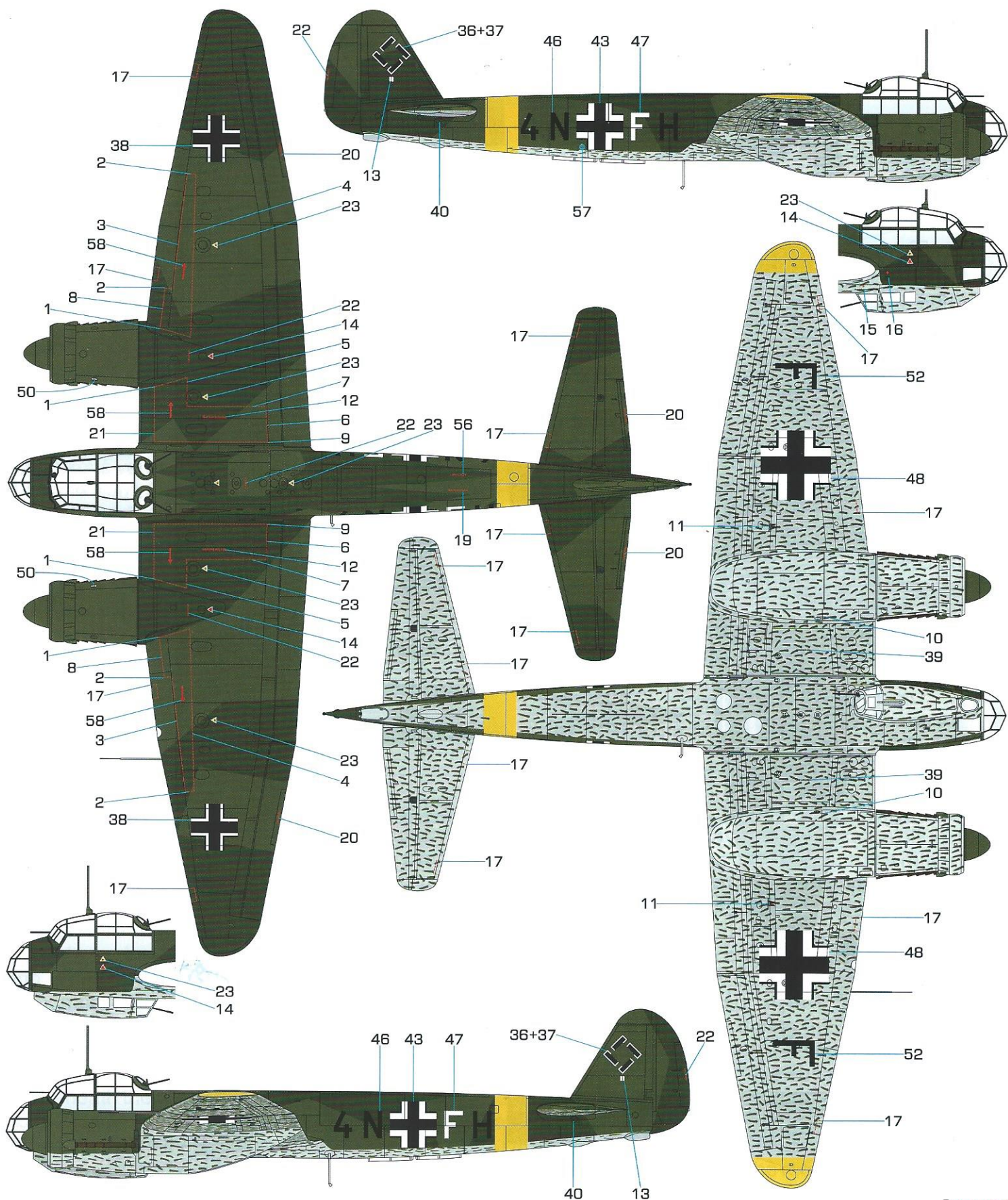

Černozelená  
Black Green  
RLM 70  
H65/ C18

Tmavá zelená  
Dark Green  
RLM 71  
H64/ C17

Světle modrá  
Light Blue  
RLM 65  
H67/ C115

Opálený kov  
Burnt Iron  
H76/ C61

Žlutá  
Yellow  
H413/ C113

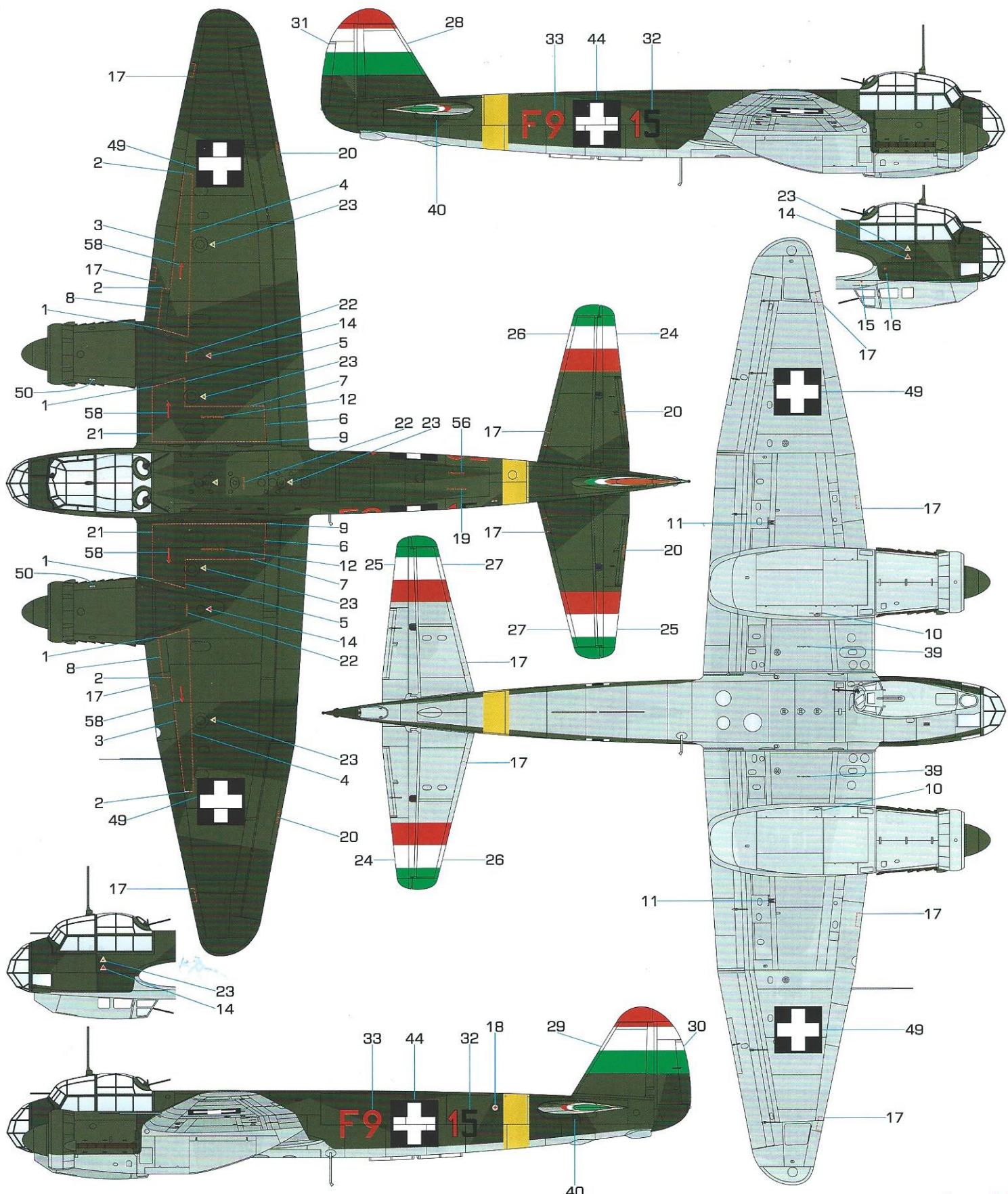

- Černozelená  
Black Green  
RLM 70  
H65/ C18
- Tmavá zelená  
Dark Green  
RLM 71  
H64/ C17
- Světle modrá  
Light Blue  
RLM 65  
H67/ C115
- Opálený kov  
Burnt Iron  
H76/ C61
- Žlutá  
Yellow  
H413/ C113

