

1970 F-100 CUSTOM CAB 4x4



THE FORD PICKUP SERIES



MOEBIUS MODELS

1/25 - SCALE PLASTIC MODEL KIT • SKILL LEVEL 3 • AGES 15 AND UP

IMPORTANT - READ THIS FIRST

Before assembling model, **study pictures carefully**. These instructions include detailed drawings and images of an actual build-up for reference. You can also refer to photos on the packaging. In addition, you will find the following tips helpful:

- This model kit is molded of styrene plastic – **use only styrene-compatible glues or cements**.
- Apply cement to the **inside surfaces only**; avoid getting cement on outer surfaces of model sections.
- **Use cement sparingly** and **avoid getting cement on hands**, so as not to mar or smear plastic surfaces.
- **Do not hurry**; work carefully and patiently.
- Before cementing, **it is advisable to assemble parts dry** (without cement) so that you may familiarize yourself with parts and fit, **noting points where cement is to be applied**.
- For best results assemble model **in the order indicated**.

PAINTING YOUR KIT

- Use paint that is made for use on plastic. If you are unsure, test paint on scrap pieces of sprue before applying it to kit parts.
- This kit is designed to be built in sub-assemblies. We would suggest that it is best to paint each sub-assembly separately before final assembly of the kit.

- In certain cases it may be a good idea to paint some parts during assembly. For example, it will be easiest to paint and decal the assembled dash and the seats before cementing them in place on the floor, which can also be painted before assembly.

DECAL APPLICATION

Decals have been provided to ensure the utmost detail and authenticity. It may also be easiest to **apply decals to sub-assemblies**. Apply decals only after paint is **completely dry**.

1. **Dip the decal in water for 10 seconds**. For best results, mix one drop of common dish washing detergent per cup of lukewarm water.
2. Place the wet decal face up on a paper towel and **wait 30-60 seconds** until the decal is **movable on paper backing**.
3. **Wet the area of the model** where decal will be applied.
4. Hold the decal face up, in position on model and **slide backing away** from under it.
5. Once positioned correctly, **gently smooth out decal** and **absorb excess water** with a paper towel, cotton swab or clean, soft paintbrush.
6. **Let decals dry completely** before applying any sort of dull coat or gloss coat to decal area, if desired.

KEY TO PARTS

① Plastic Part 1 Decal

1 CHASSIS

A Assemble the **Front Axle Top** (#173) and **Front Axle Bottom** (#174); add the **Tie Rod** (#178). Assemble **Rear Axle** (#253, #54 & #58); then assemble **Transfer Case** (#176 & #177). Set these assemblies aside for now.

B Cement **Front Cross Members** (#181) and **Cab Mount/Transfer Case Mount** (#182) to **Frame** (#169) add **Left Rear Springs** (#50) and **Right Rear Springs** (#51).

C Cement **Front Springs** (#175) to **Front Cross Member**, then add **Front Axle Assembly**, followed by **Left Control Arm** (#179) & **Right Control Arm** (#180) finish **Front Suspension Assembly** by cementing **Panhard Bar** (#222) in place from **Left Frame Rail** to right front of **Front Axle**.

D Slip **Front Drive Shaft** (#170) into **Transfer Case Assembly**, then cement **Transfer Case** in place on **Cross Member** (#182). Then cement **Exhaust System** (#139) to **Frame** (#169). Slip **Rear Drive Shaft** (#171) into **Transfer Case** and **Rear Axle Assembly** then cement **Rear Axle** to **Rear Springs** complete **Rear Suspension** by adding **Rear Shock Absorbers** (#52).

1A

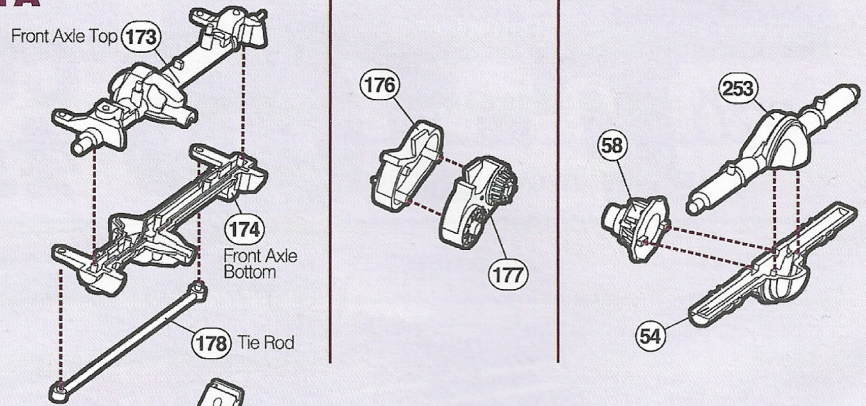

1B

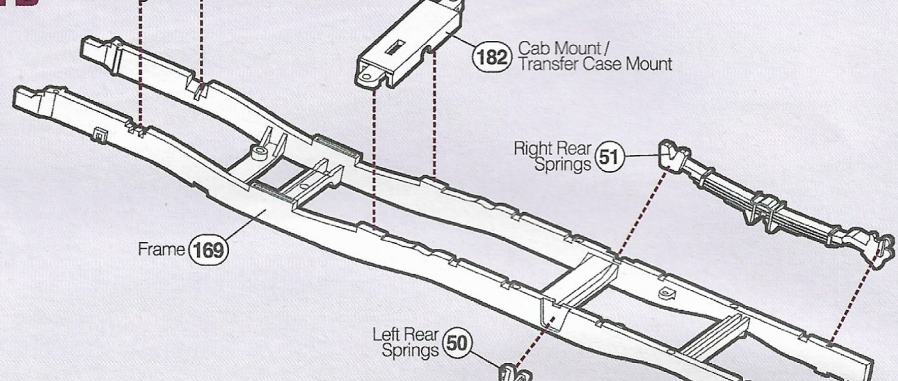

1C

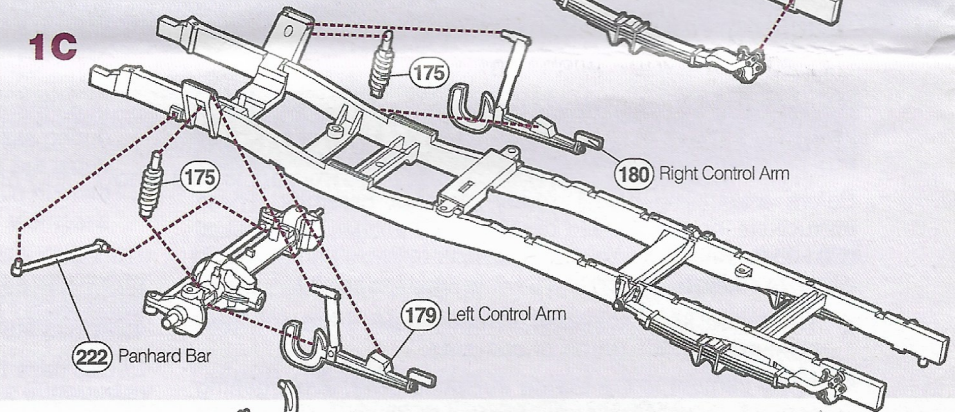

1D

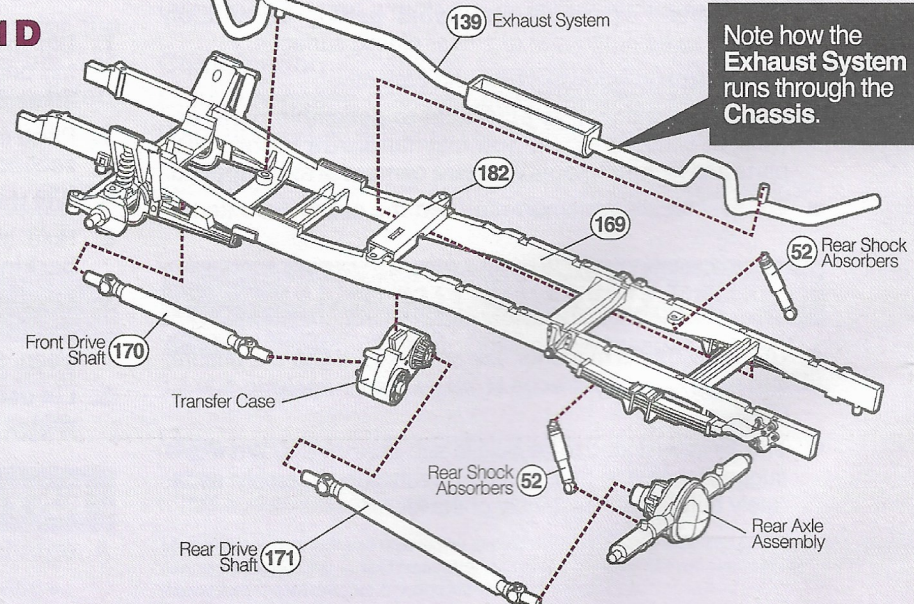

Note how the **Exhaust System** runs through the **Chassis**.

- E** Push **Spare Wheel (#56)** into **Tire (#220)** and cement them to **Spare Tire Carrier (#55)** then cement that assembly to **Frame (#169)**.

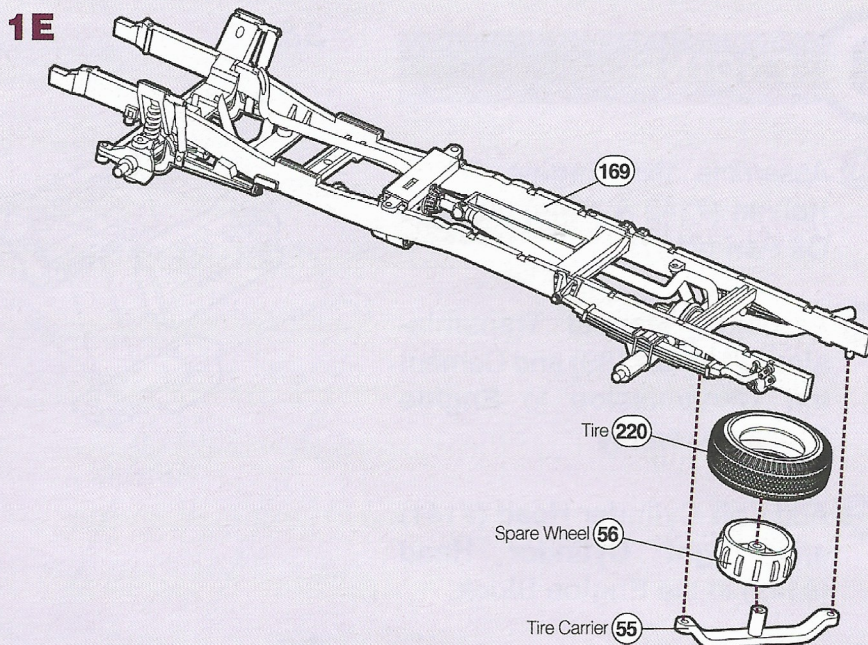

2 WHEELS

- A** Assemble **Front Wheels** by inserting **Front Wheel With Locking Hub (#168)** into **Tire (#220)**. If you wish to use optional hub caps you can add **Front Hub Caps (#102)**. Assemble **Rear Wheels** by inserting **Rear Wheel (#218)** into **Tire (#220)**. If you are using optional hub caps, add **Rear Hub Caps (#110)**.

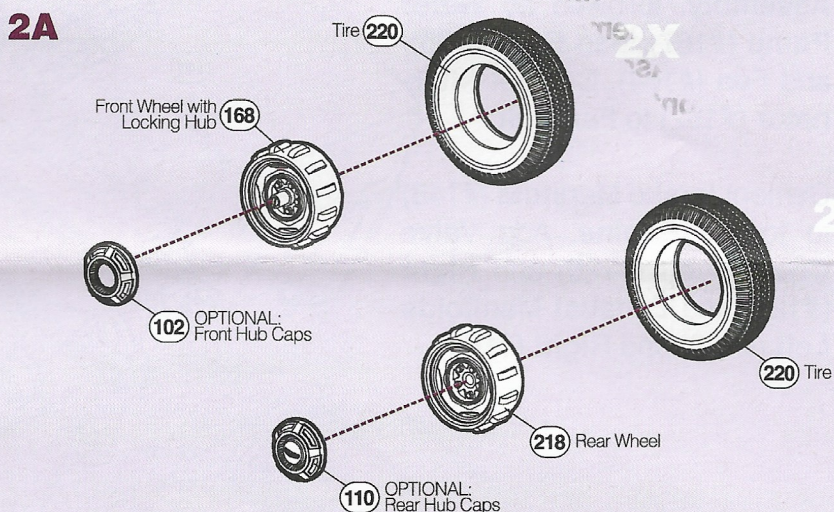

- B** Cement **Brake Backer Plates (#26)** to **Front and Rear Axles** then cement **Front & Rear Wheel Assemblies** to the **Front & Rear Axles**.

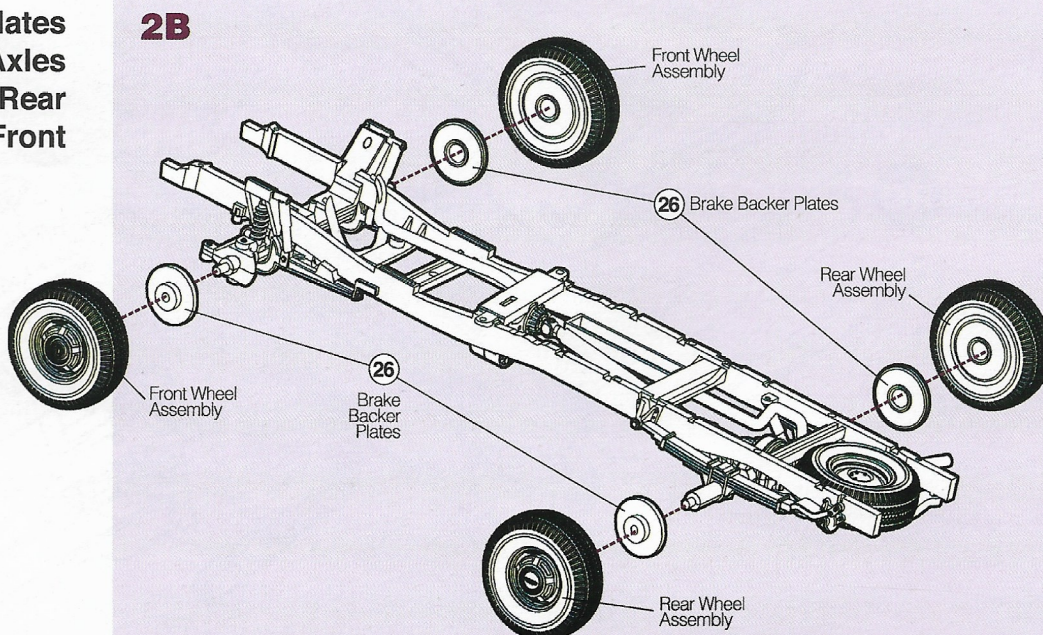

3

ENGINE

- A** Assemble the **Engine Block Halves** (#143 & #144) and add **Oil Pan** (#147).
- B** Assemble **Manual Transmission** (#185 & #189) and **Cement the Transmission to Engine Block Assembly**.
- C** Add **Left Cylinder Head** (#141) and **Right Cylinder Head** (#142) to the **Engine Block**.
- D** **Cement Engine Front Cover** (#153) to front of the **Engine Assembly**, followed by **Water Pump** (#167), **Fan Belt** (#165), and **Fan** (#164). **Cement Alternator** (#152) to **Fan Belt**.
- E** **Cement Intake Manifold** (#148) to top of **Engine**. Add **Valve Covers Left** (#125) and **Right** (#126) and **Exhaust Manifolds Left** (#159) and **Right** (#160).

3A

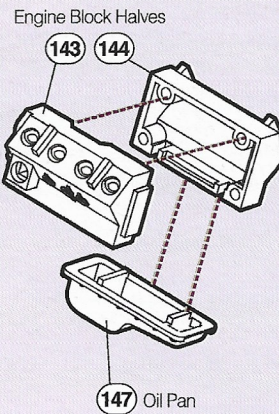

3B

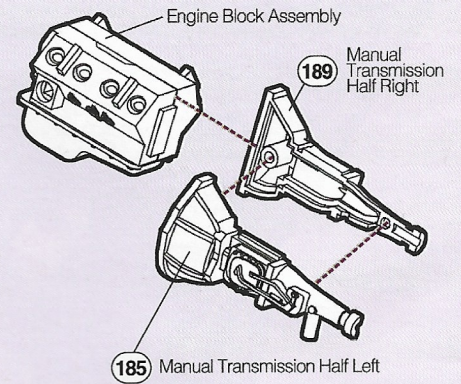

3C

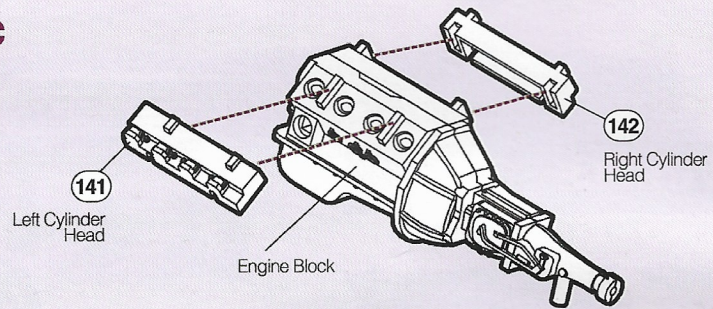

3D

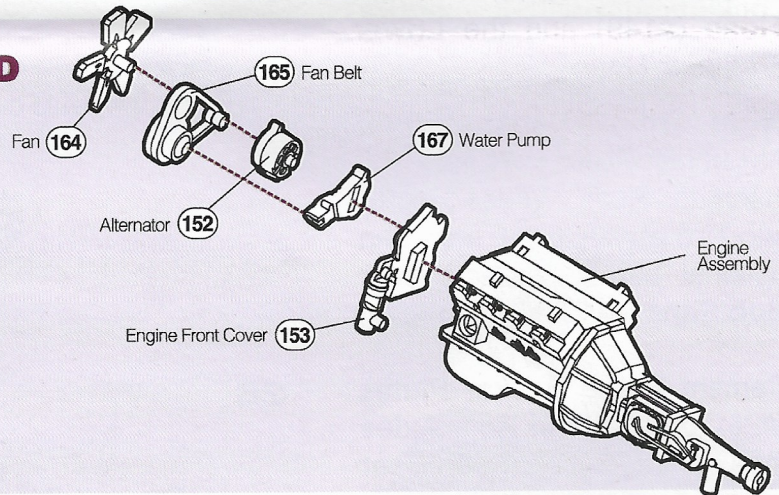

3E

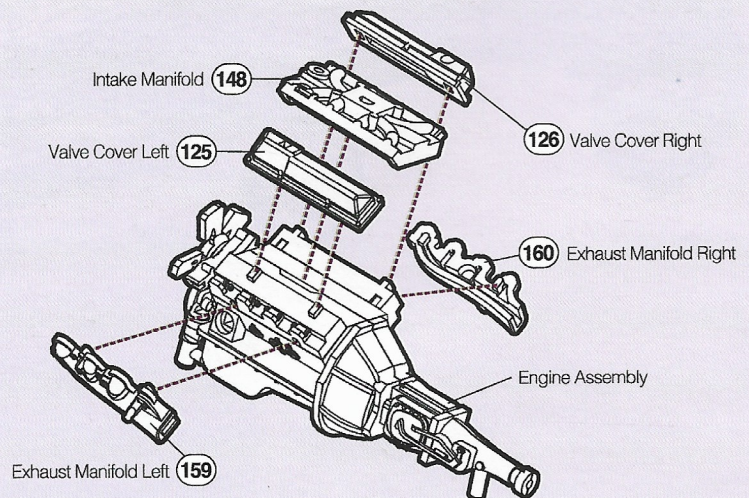

F Cement Distributor (#154), Ignition Coil (#155) and Carburetor (#161) to Intake Manifold.

G Add Oil Breather Cap (#157) plus PVC Valve (#156) to Left Valve Cover; add Cap (#158) to Right Valve Cover.

H Add Oil Filter (#163) to the left side of the Engine; add Starter (#162) to right side.

I Cement Heat Riser (#150) to right side Exhaust Manifold and install Air Cleaner (#140).

J Cement Horns Left (#31) and Right (#32) to Radiator (#62).

K Slip Short Drive Shaft (#172) into the Transfer Case and the Transmission. Next, cement the Engine Assembly into the Chassis. Add Upper Radiator Hose (#149) and the Lower Radiator Hose (#166). Cement Radiator Assembly in place.

3F-G

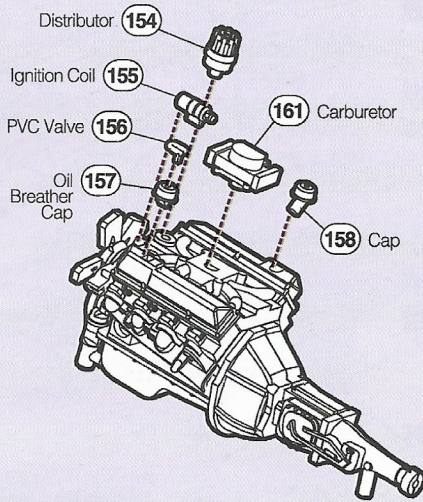

3H-I

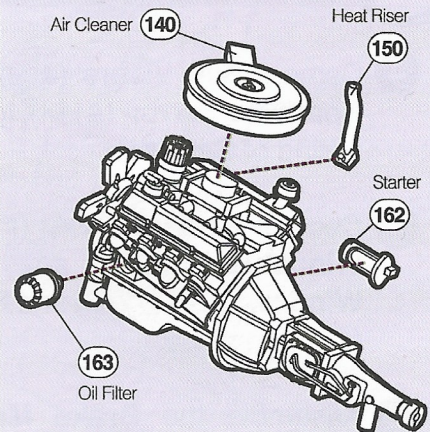

3J

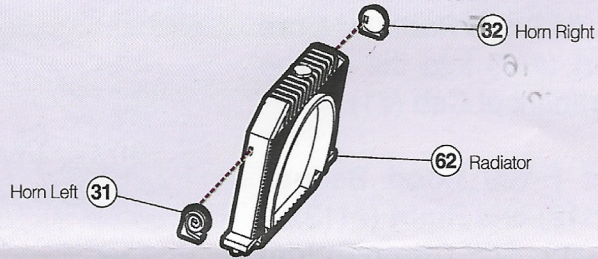

3K

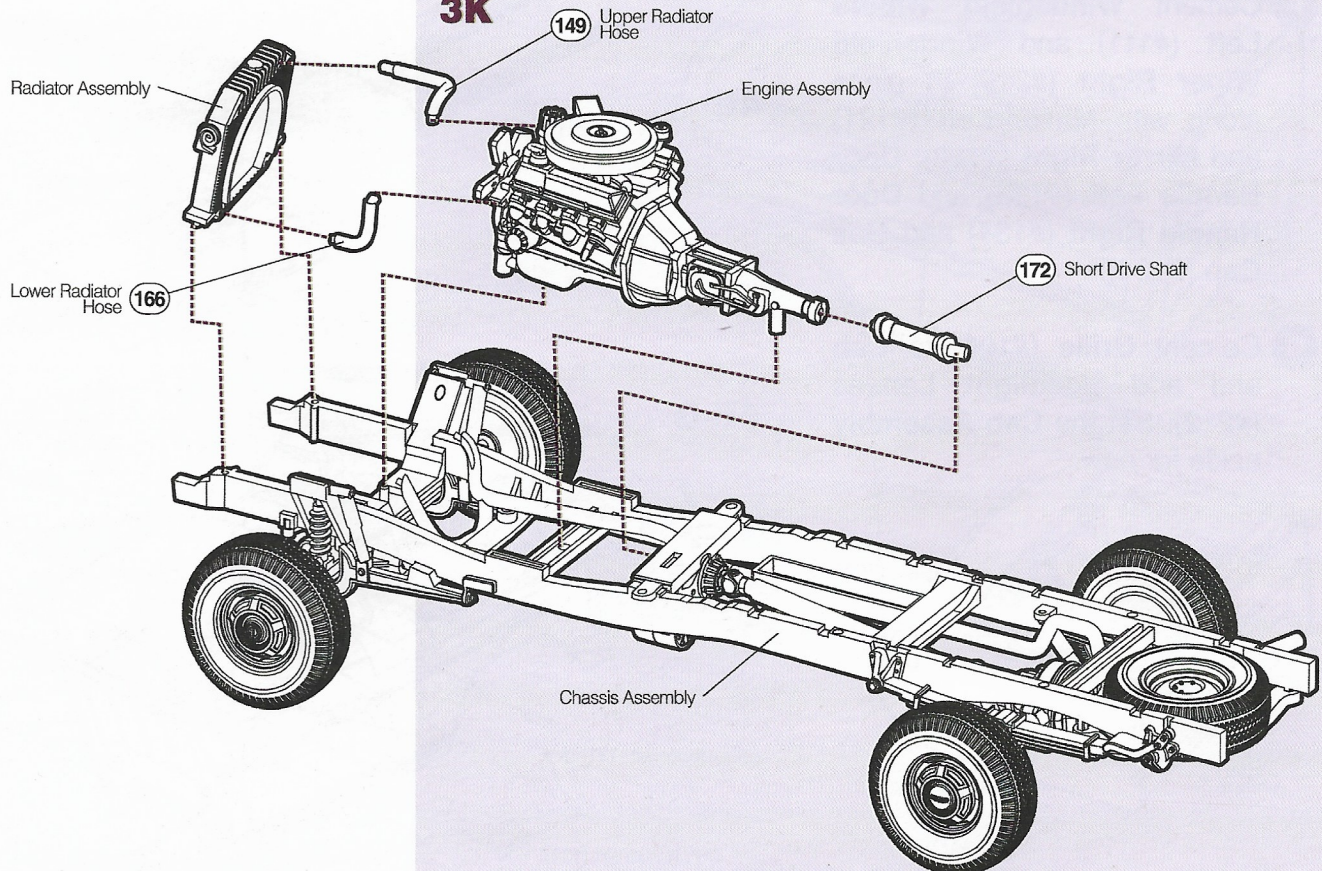

4 CAB

- A** Cement **Sun Visors** (#49) and **Rearview Mirror** (#114) to the ceiling of **Cab** (#1).
- B** Cement **Rear Window** (#209), **Windshield** (#208) and **Vent Windows Left** (#210) and **Right** (#211) in place.
- C** Assemble the **Brake Master Cylinder** (#29 & #30) and install it to the **Firewall** (#44). Cement **Firewall** into **Cab** (#1).
- D** Cement the **Battery** (#27), **Jack** (#40), **Windshield Washer Bottle** (#41) and **Radiator Core Support** (#47) into the engine compartment of **Cab** (#1).
- E** Cement **F-100 Hood Badges Left** (#112) and **Right** (#113) to **Hood** (#2). Add **Chrome Trim Bar** (#48) to front of **Hood**.
- F** Cement **Windshield Wipers Left** (#111) and **Windshield Wiper Right** (#219) in place along with **Mirror Left** (#121) and **Mirror Right** (#122), **Door Handle Left** (#133) and **Door Handle Right** (#134) and **Gas Cap** (#104).
- G** Cement **Grille** (#106) to **Cab** and add **Headlight Lenses** (#212). Set the **Cab Assembly** aside for now.

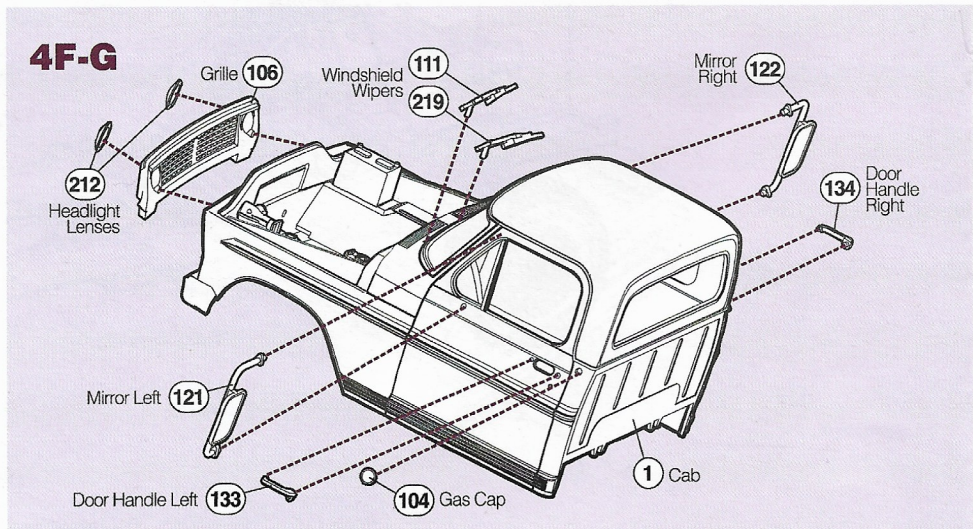
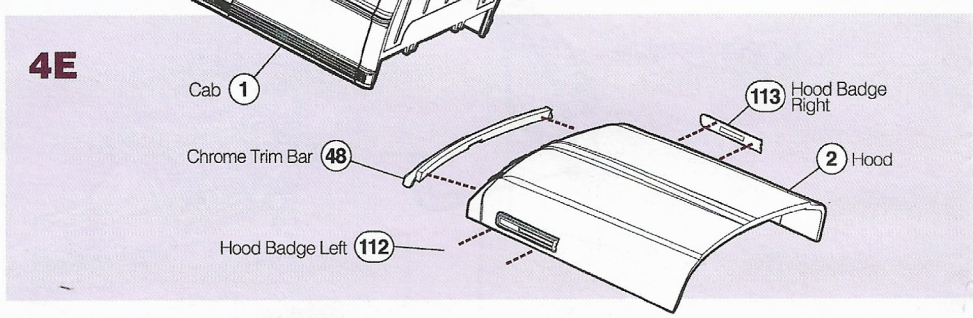
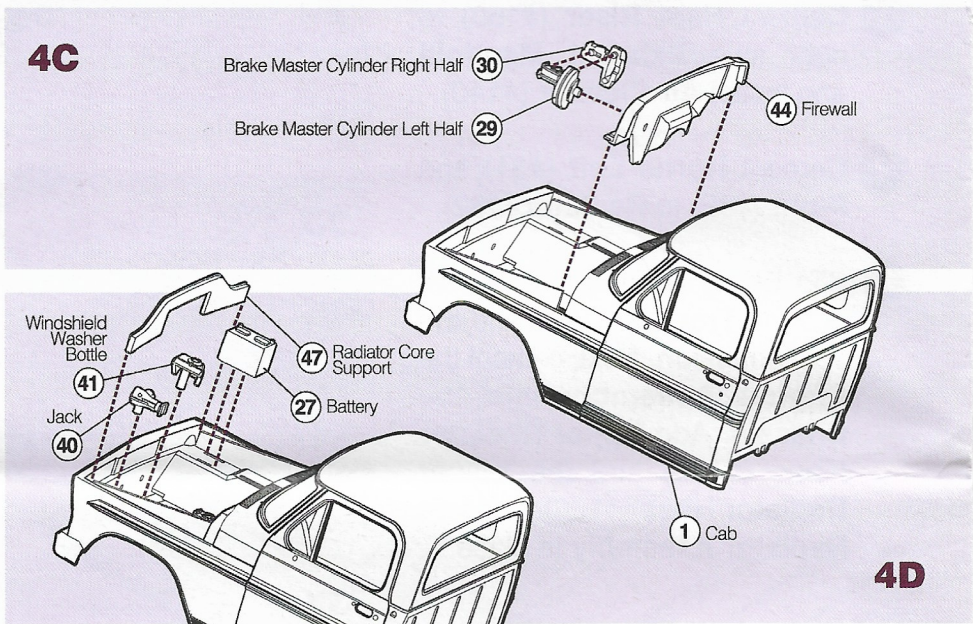
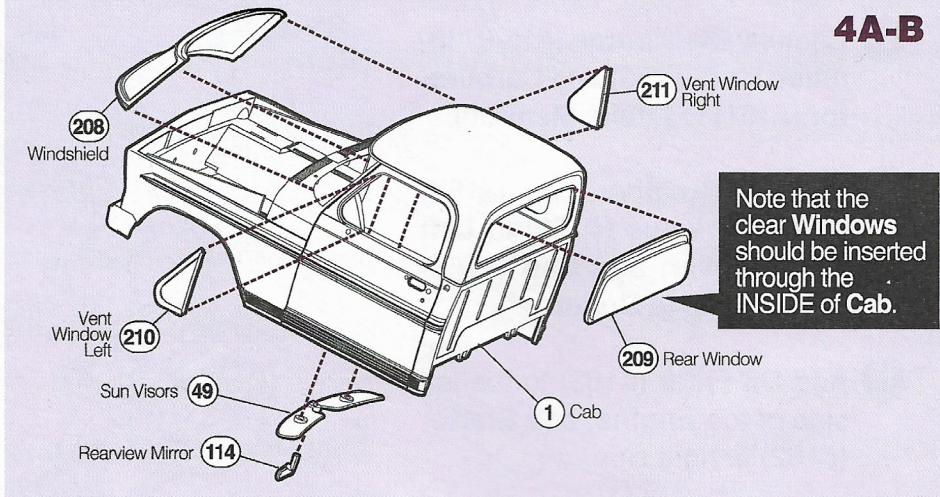

5

INTERIOR

- A** Cement **Seat** (#11) to **Floor** (#4) followed by **Rear Wall** (#3) and **Side Panels Left** (#5) and **Right** (#6). Add **Floor Shift Levers** (#254 & #255).
- B** Cement **Pedal Locator** (#59) to bottom left side of **Dash** (#43). Install the **Pedals** from left to right: **Emergency Brake Pedal** (#37), **Brake** (#36), **Clutch** (#36) and **Accelerator** (#35).
- C** Cement **Steering Wheel** (#61) to the **Steering Column** (#28). Cement the **Steering Column** to **Dash** (#43). Cement **Dash Assembly** into .
- D** Cement **Interior Assembly** into **Cab Assembly** and set the completed **Cab** aside for now.

5A

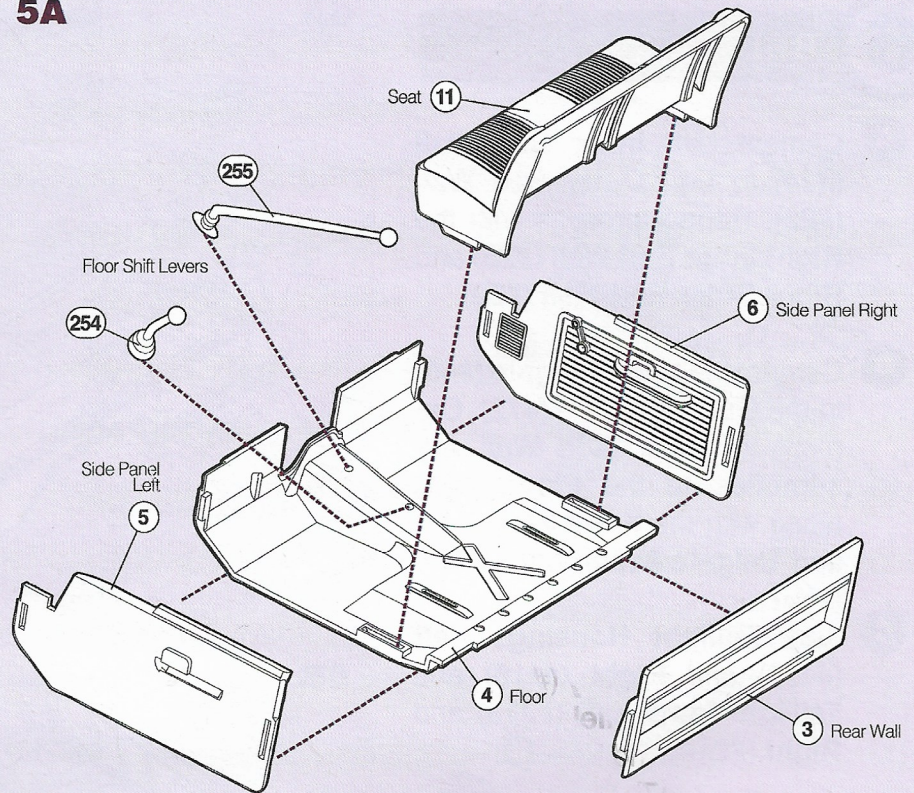

5B-C

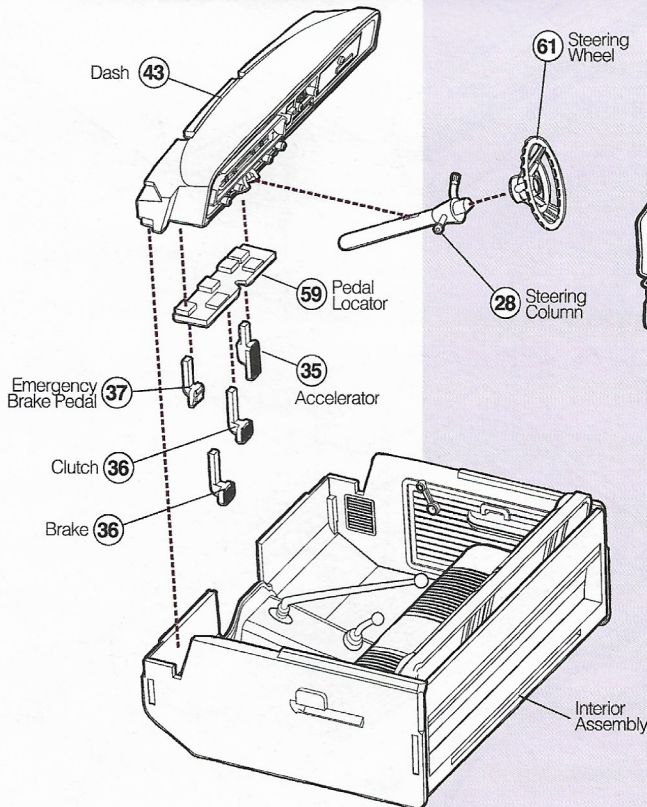

5D

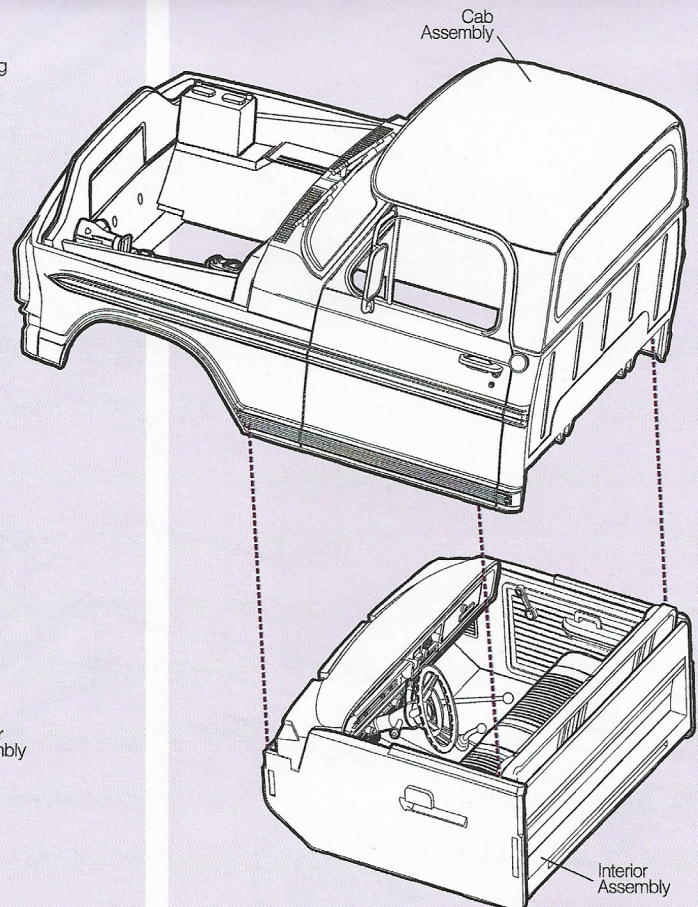

6

BED

- A** Cement **Left Inner Bed Wall (#24)** to **Left Outer Bed Wall (#22)**. Repeat process with the **Right Inner Bed Wall (#25)** and **Right Outer Bed Wall (#23)**.
- B** Cement the **Inner Tailgate (#46)** to the **Outer Tailgate (#72)**. Cement the **Bed Side Wall Assemblies** to the **Floor (#21)** along with the **Front Wall (#45)** and **Tailgate Assembly**.
- C** Add **Taillight Housings Left (#115)** and **Right (#116)** and **Taillight Lens Left (#213)** and **Right (#214)**.

6A

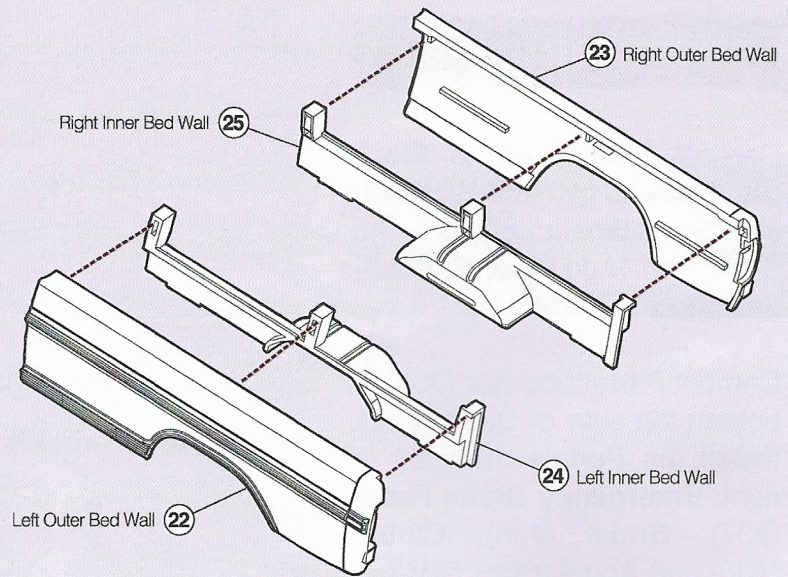

6B

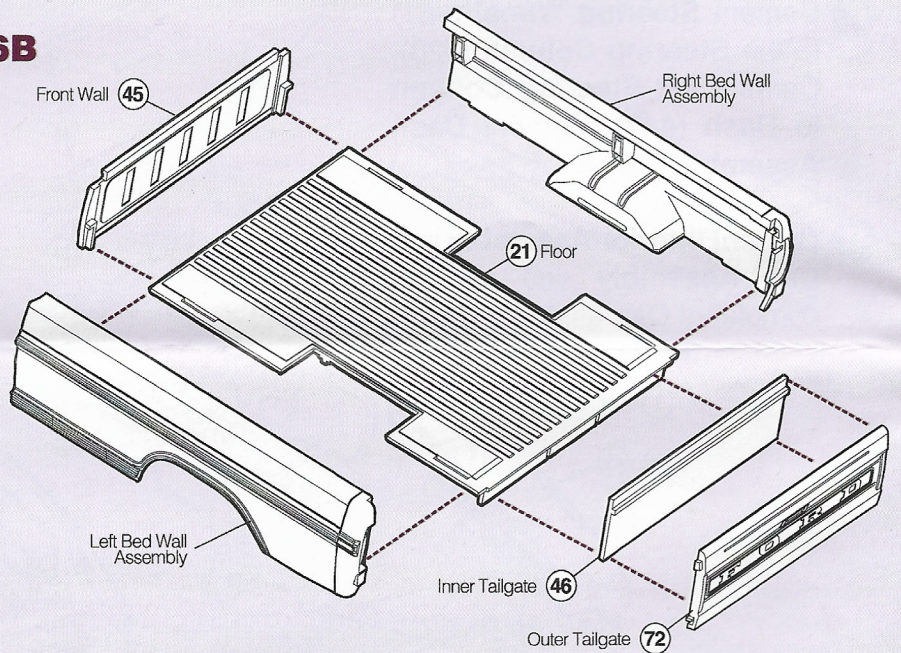

6C

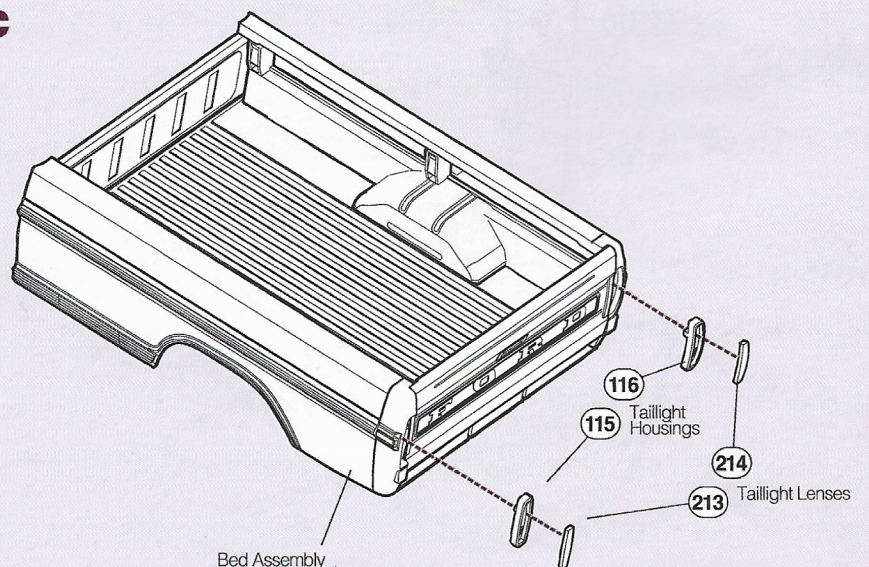

7

FINAL ASSEMBLY

Cement the **Cab Assembly** and the **Bed Assembly** to **Chassis**. Add **Front Bumper (#109)** and **Rear Bumper (#74 OR #110)**. Set **Hood** in place.

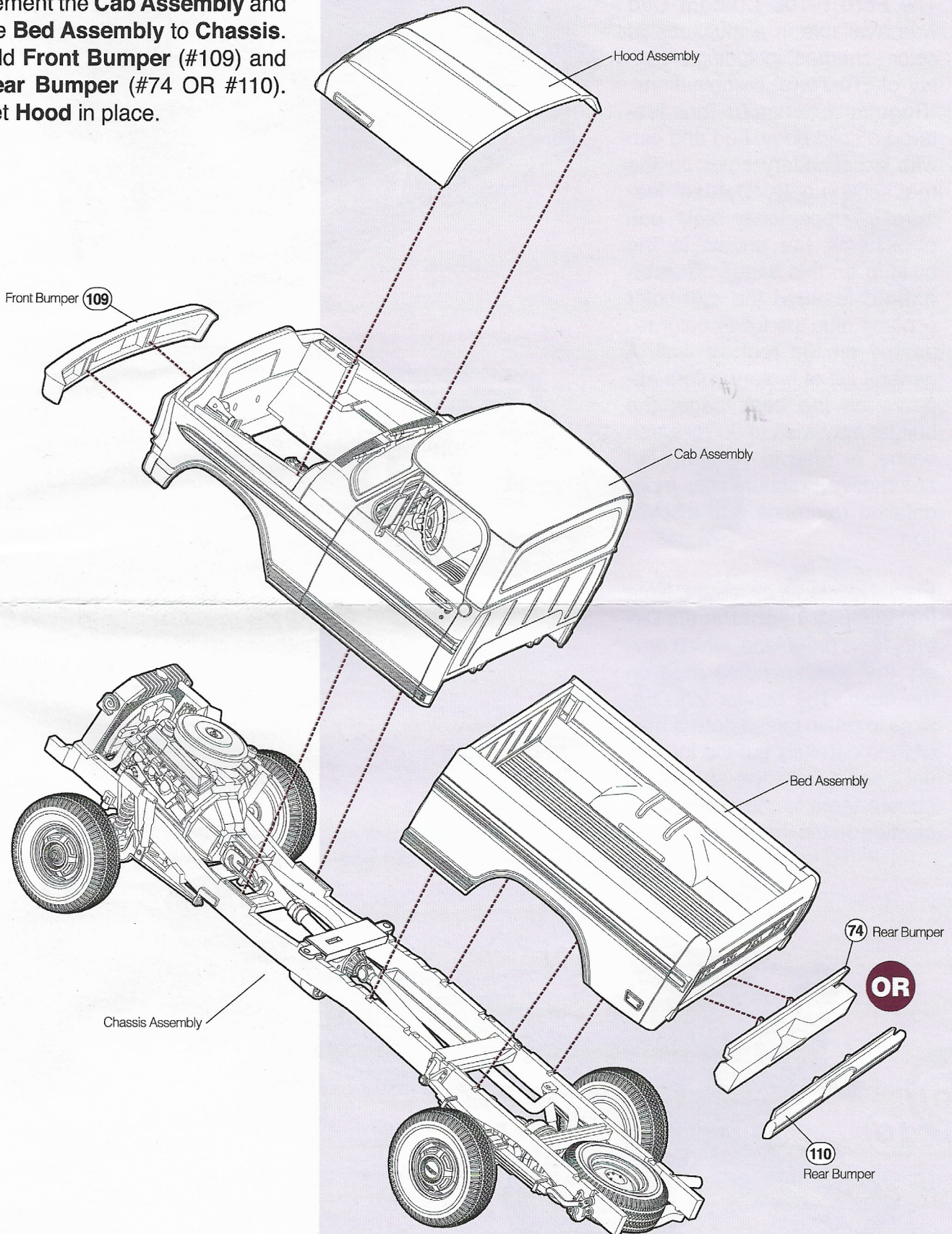



PAINT & DECALS

The **Ford F-100 Custom Cab** was available in a multitude of color schemes, including a variety of “**Tu-Tone**” combinations: “**Regular**” exterior Tu-Tone featured a solid body, bed and cab with a secondary color on the roof section only; “**Deluxe**” featured an upper/lower “split” color scheme (as shown in the buildup on this page); “**Combination**” featured the split color scheme plus the lower color repeated on the roof as well. A general list of factory colors appears on the back page; the builder may wish to do research online, or refer to vintage Ford automotive brochures for more detailed reference and inspiration.

Place decals as indicated. Note that the **Instrument Panels Decal** [18] is one piece, which covers the corresponding area on the dash. The builder who desires to retain raised details may wish to carefully cut the individual panels from the sheet and adhere them to the appropriate cavities on the instrument panel.

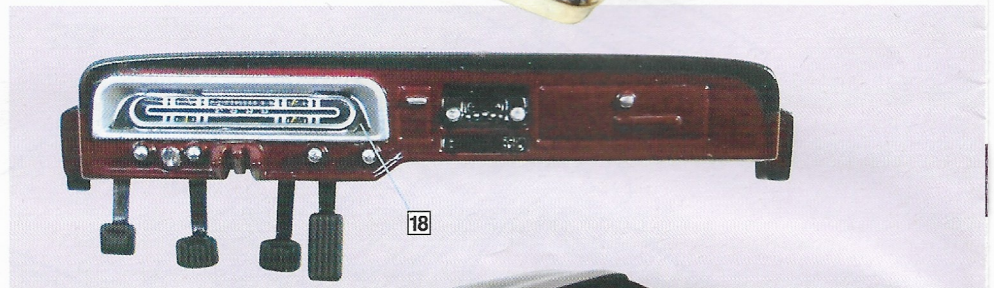

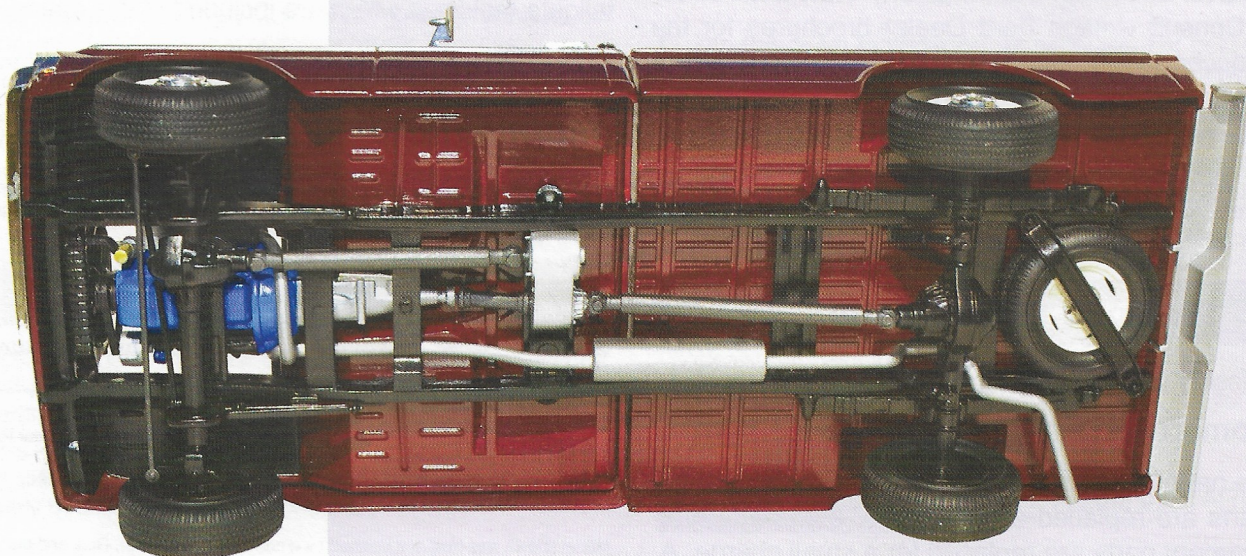



	PAINT COLOR*	CODE
	Raven Black	A
	Royal Maroon	B
	Pure White	C
	Pinto Yellow	D
	Sky View Blue	E
	Mojave Tan	F
	Chrome Yellow	G
	Wimbledon White	M

	PAINT COLOR*	CODE
	Norway Green	N
	Boxwood Green	P
	Yucatan Gold	R
	Candyapple Red	T
	Reef Aqua	Y
	New Lime	2
	Diamond Blue	5
	Harbor Blue	7

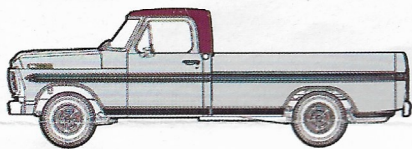
TU-TONE COLOR COMBINATIONS



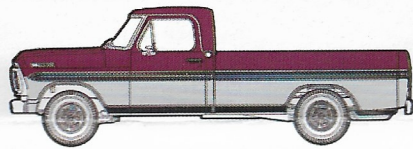

REGULAR TU-TONE

-  First Color Code: **Body**
-  Second Color Code: **Roof**



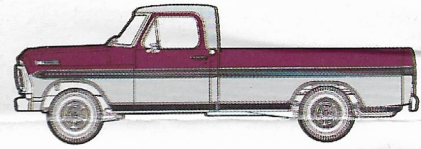

DELUXE TU-TONE

-  First Color Code: **Lower Body**
-  Second Color Code: **Upper Body/Roof**



COMBINATION TU-TONE

-  First Color Code: **Lower Body/Roof**
-  Second Color Code: **Upper Body**

A total of 48 different two-tones for chassis-cabs are available with standard colors (except Chrome Yellow and Pure White). Wimbledon White may be used as an accent color for all colors (except Diamond Blue, Chrome Yellow and Pure White) and Raven Black may be used for all except Diamond, Sky View and Harbor Blue. Consult vintage Ford Dealer brochures for the other accent color combinations to complete the 144 different ways the Styleside models may be painted. Two-tone applications are as follows:

Regular: The accent color is applied to the roof and upper back panel with a belt line molding from door to door around the back of the cab.

Deluxe (Styleside pickups only): The accent color is applied to the area below the body side and lower tailgate moldings which are included in this option.

Combination (Styleside pickups only): Regular and Deluxe two-tone options are combined with the accent color applied as specified above for these two options.

*IMPORTANT: Please note that colors shown are approximations limited by standard printing processes and are for general reference only. For those desiring greater accuracy, you may wish to consult vintage auto paint sources or vintage brochures for more precise color reference. Paint information is taken from the 1970 Ford F-100 Series sales brochure.

MISSING PARTS?

For missing, lost or replacement parts, contact us at:

customerservice@moebiusmodels.com

Please have kit number and part number ready. Missing parts are replaced at no charge. Lost parts and replacement parts are replaced for a small charge. A shipping and handling fee is required in all cases.



www.moebiusmodels.com



Ford Motor Company Trademarks and Trade Dress used under license to Moebius Models. www.FordMotorCompany.com.
©2020 Moebius Models, Upland, California. All rights reserved.
Made and printed in China.

Model shown was built and finished by a professional modeler. Glue and paint required for assembly — sold separately. A special thanks to Steven Goldman for the finished model used for box and instruction sheet photos.