

IM-535022R1

1/350 US Navy DD445 Fletcher Detail up set

Base Kit : Tamiya (ITEM No. : 78012)

1/350 アメリカ海軍 DD445フレッチャー ディテールアップセット

対応艦船 : Tamiya (ITEM No. : 78012)



- Make 2.
2個作ります。
- Make Holes.
指示の穴を開けます。
- Optional
どちらかを選んでください。
- Bending
折り曲げます。
- Cut
切ってください。
- Remove
切り取ります。
- Install on both side
両側(舷)に取り付けます。
- Be Careful
注意してください。

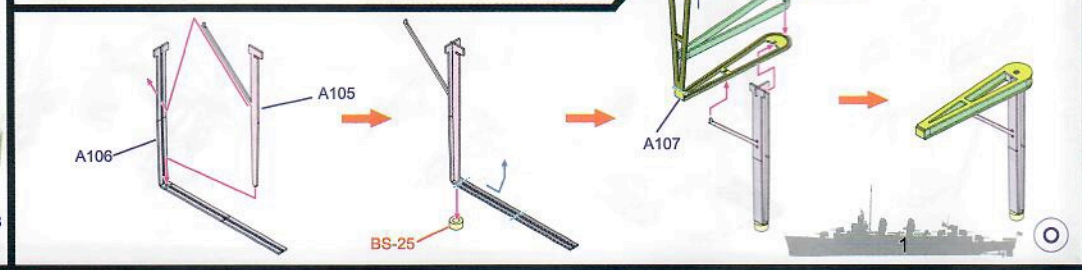
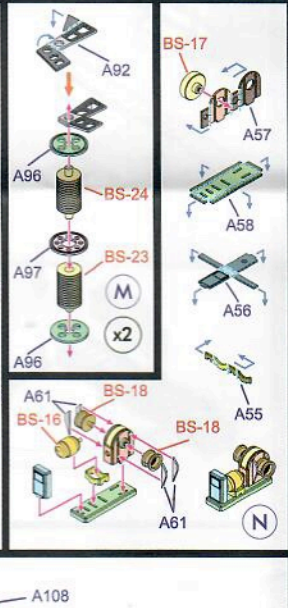
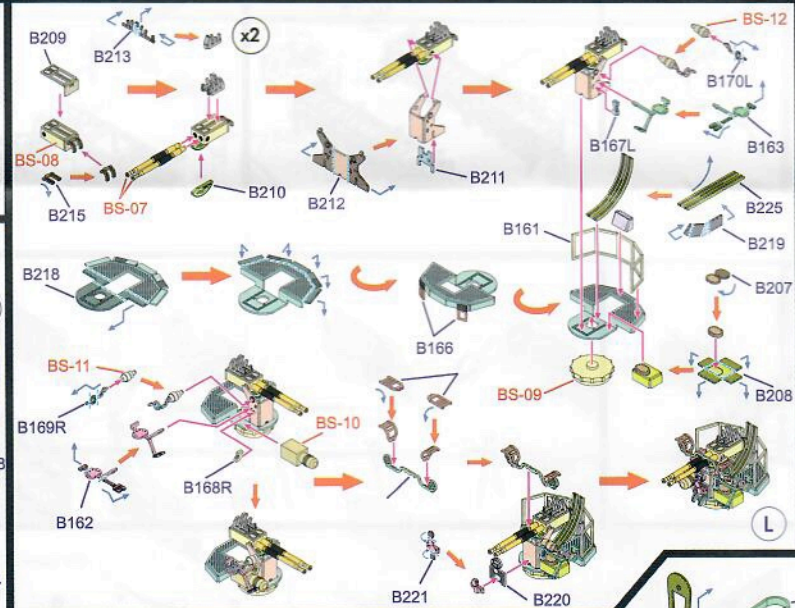
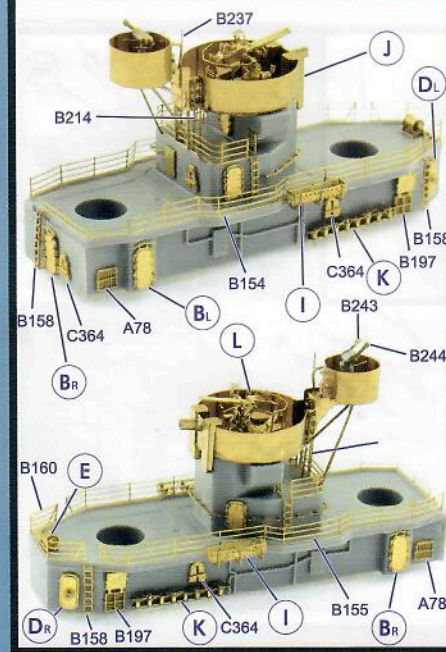
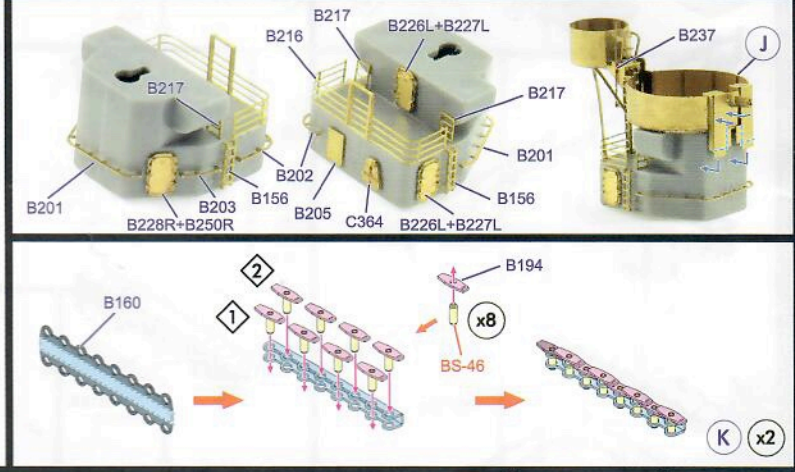
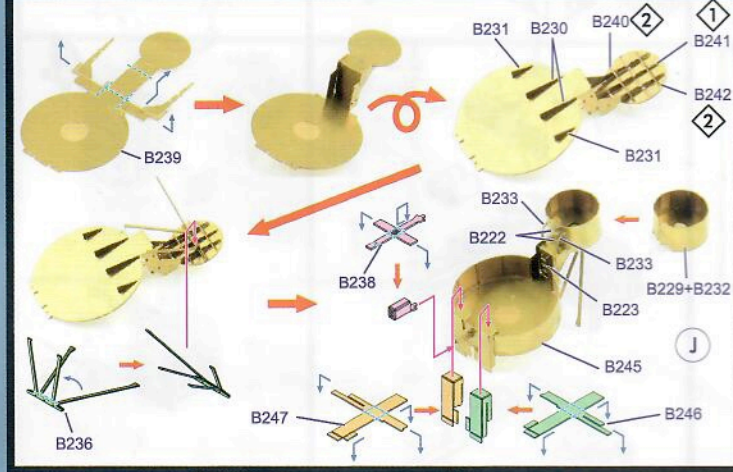
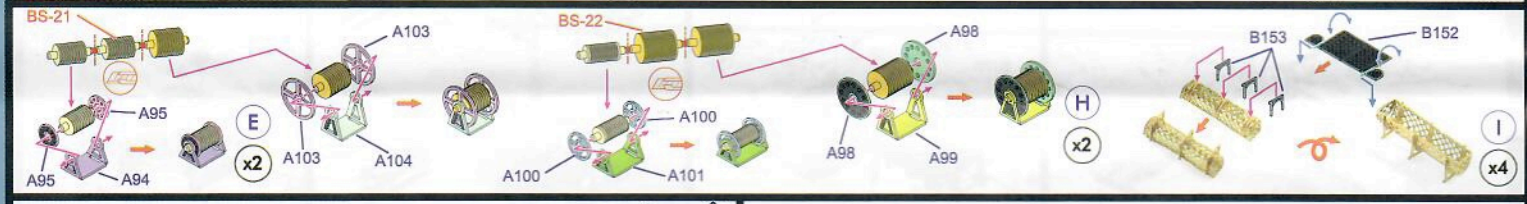
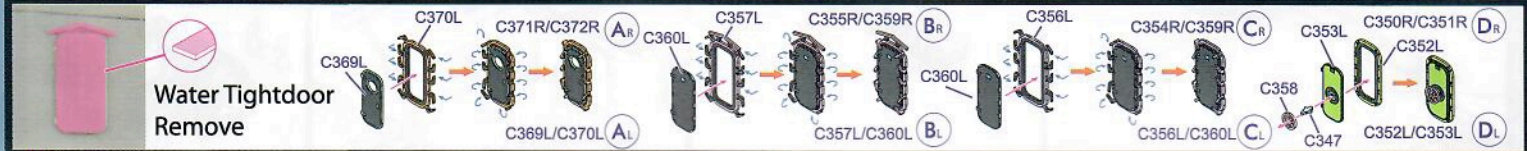

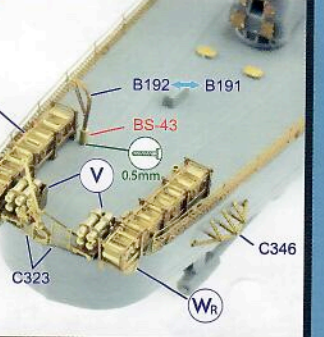
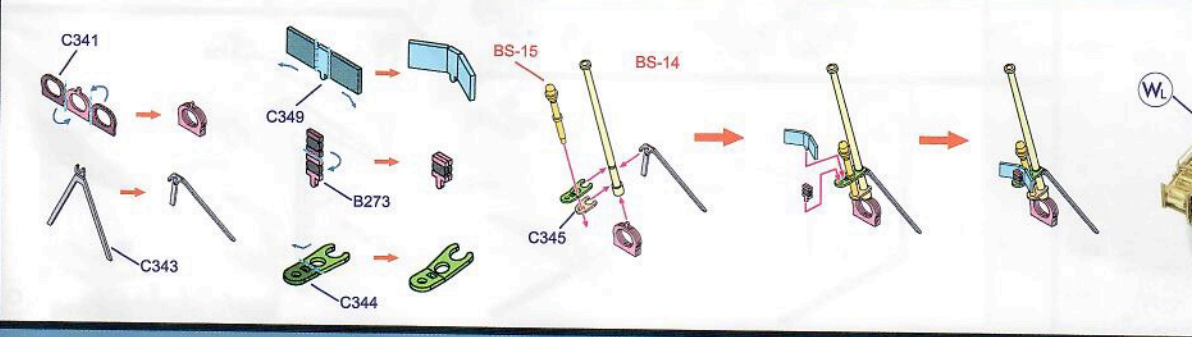
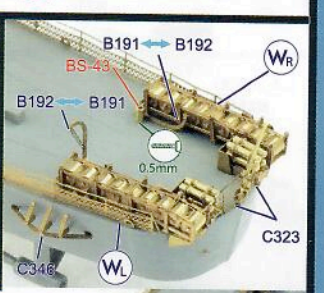
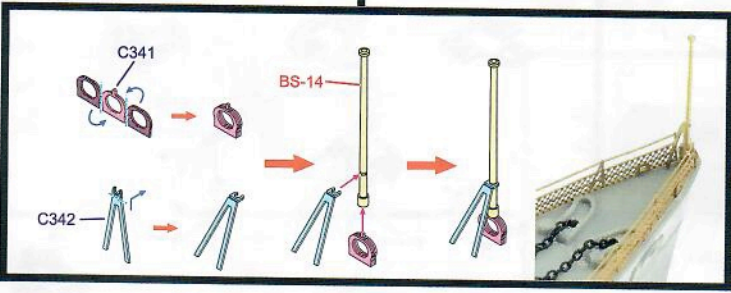
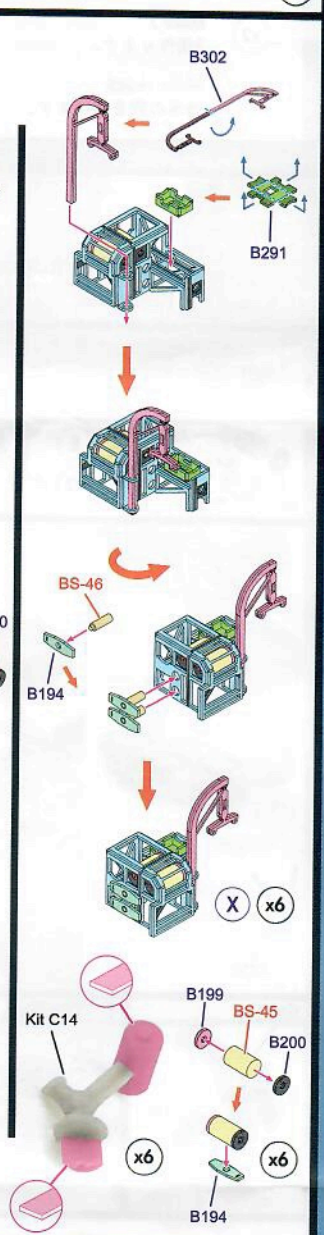
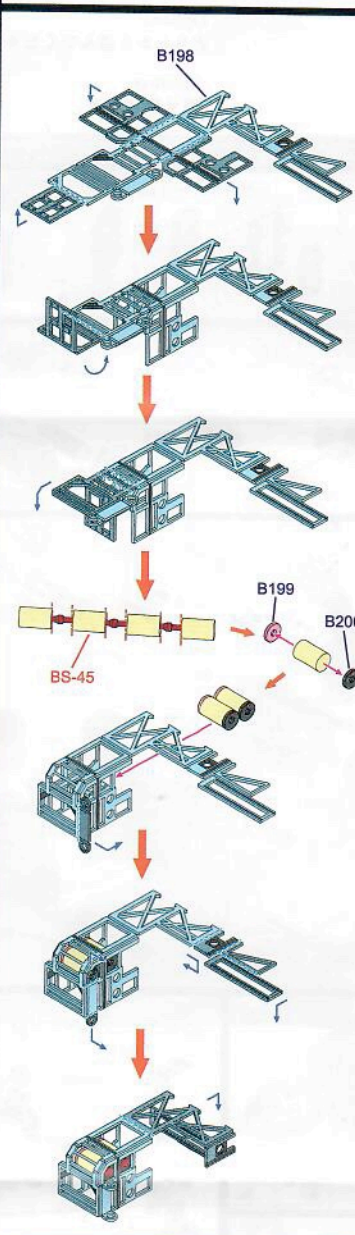
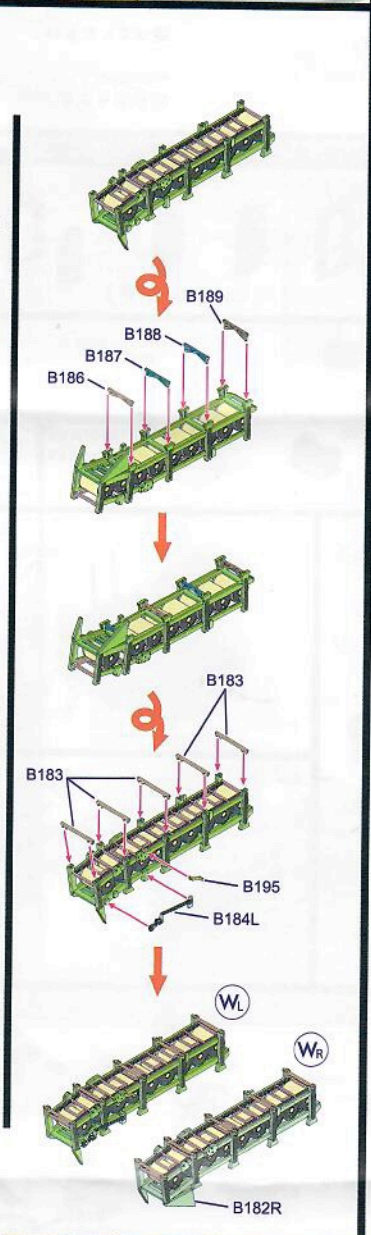
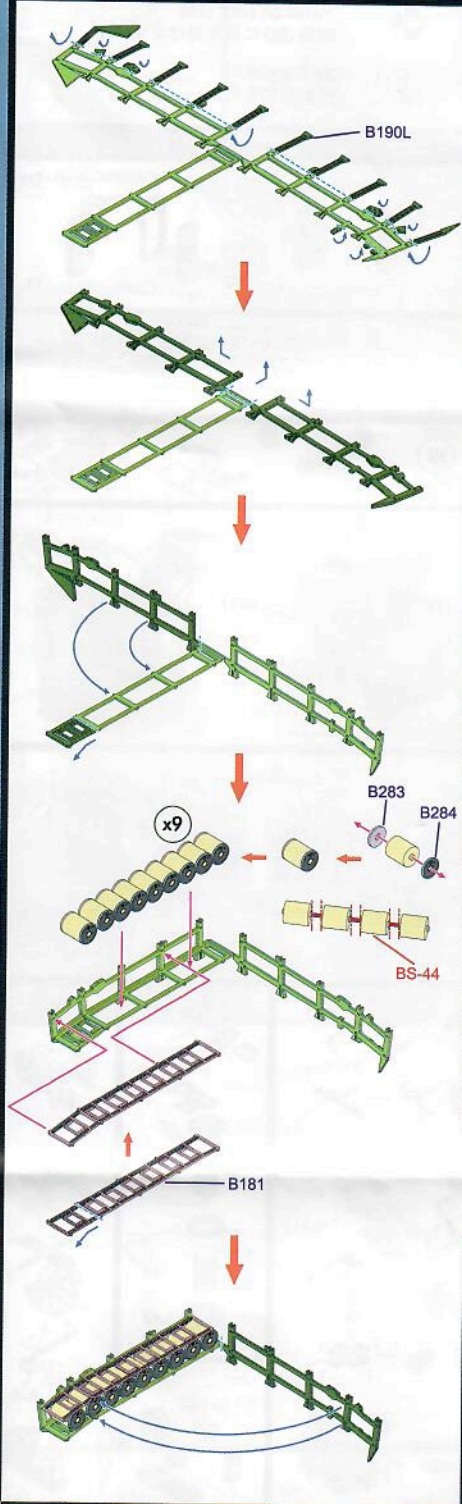
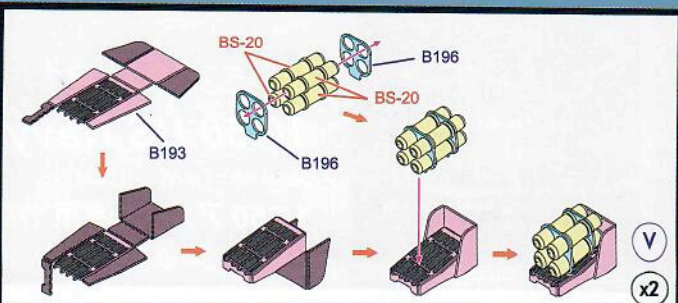
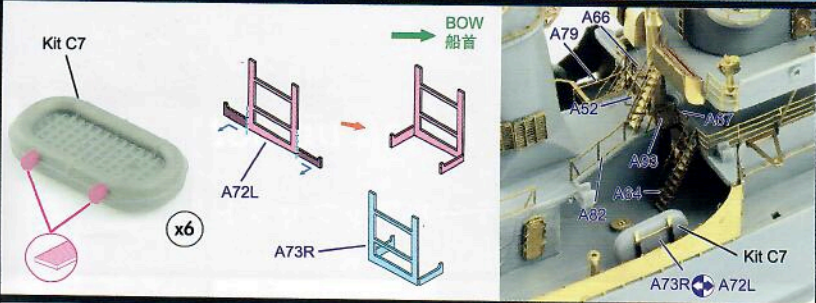

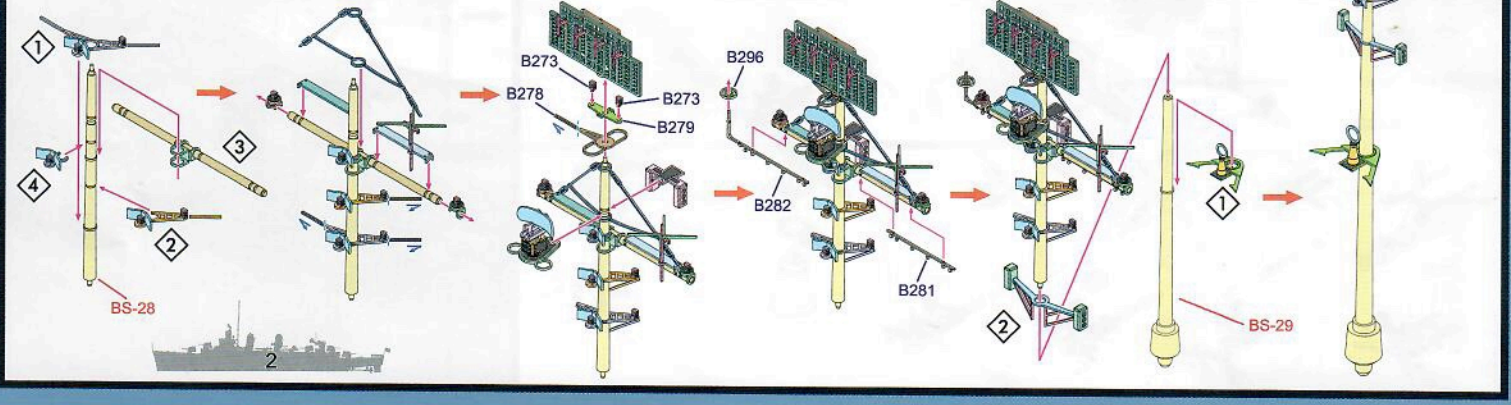
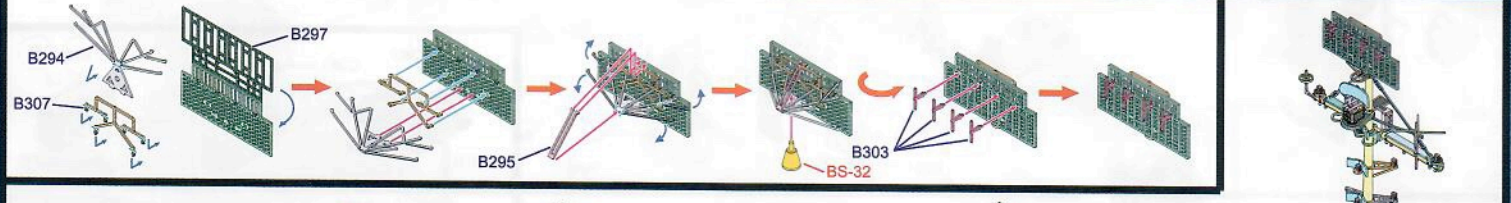
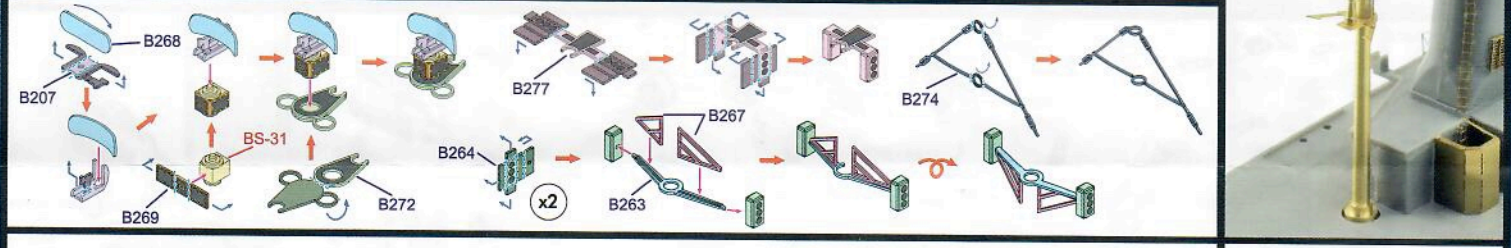
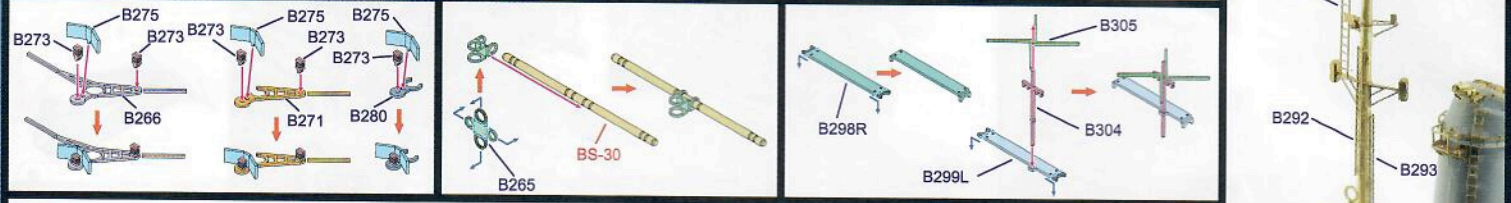
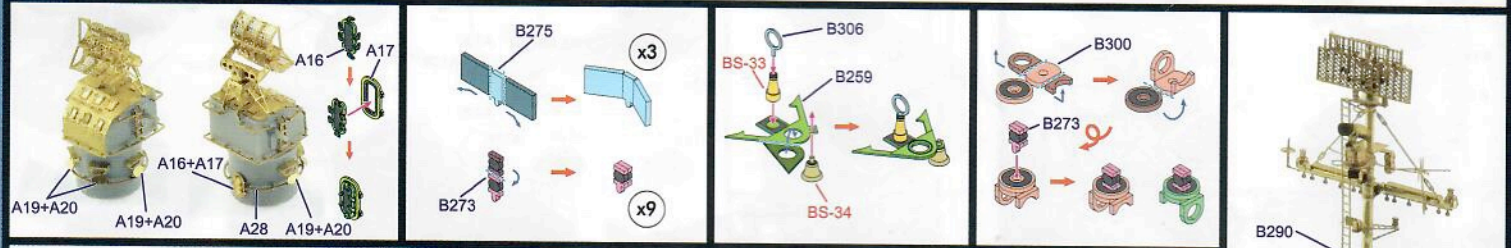
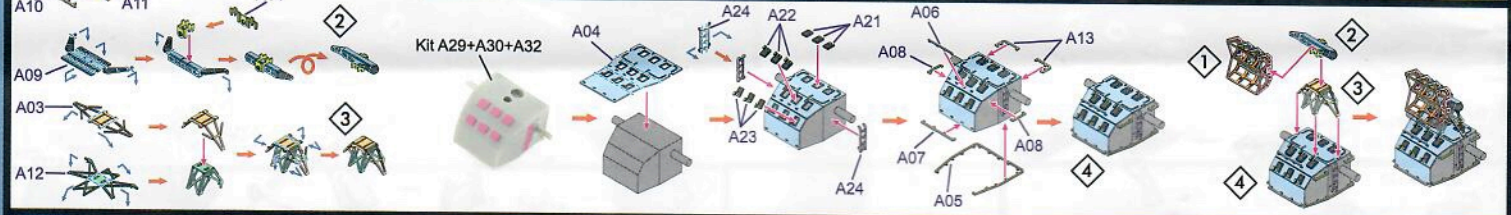
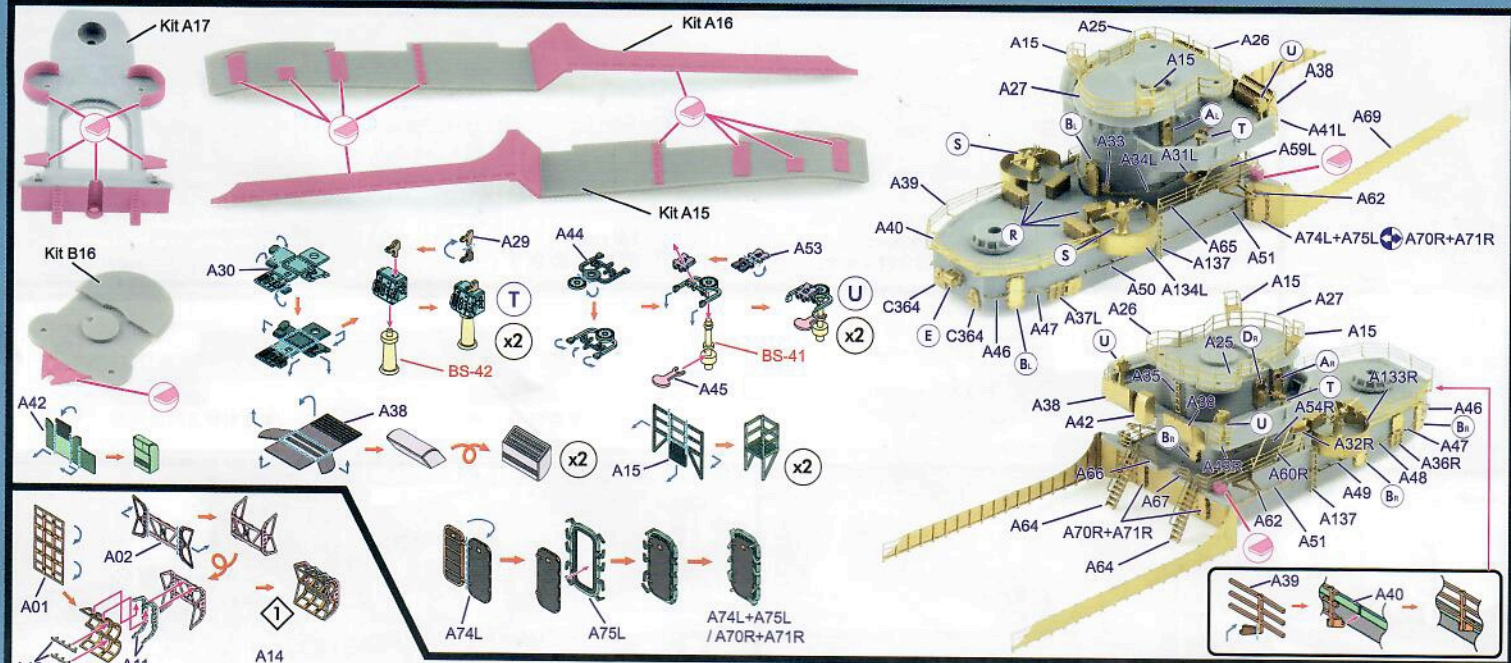

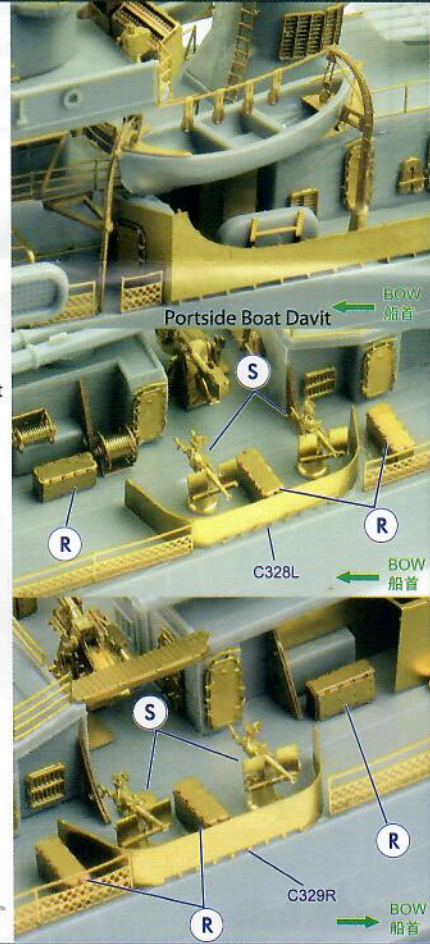
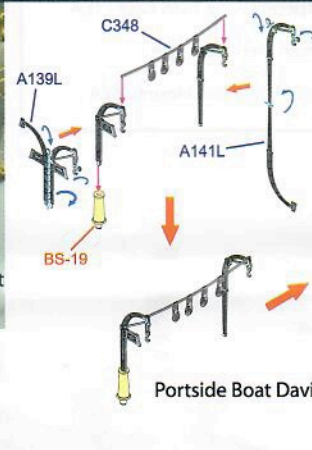
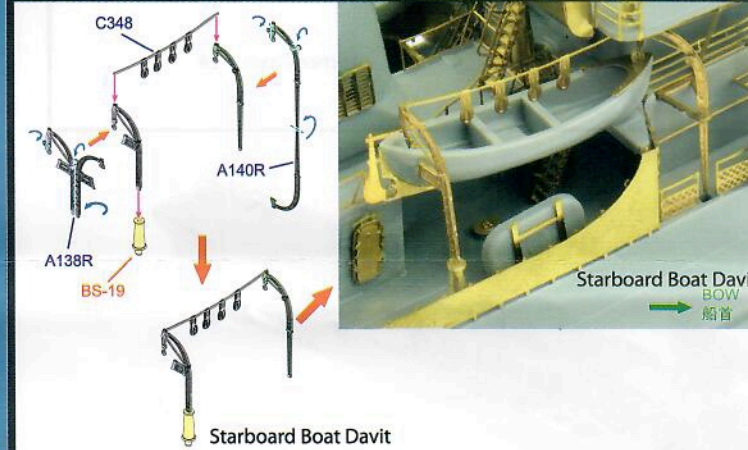
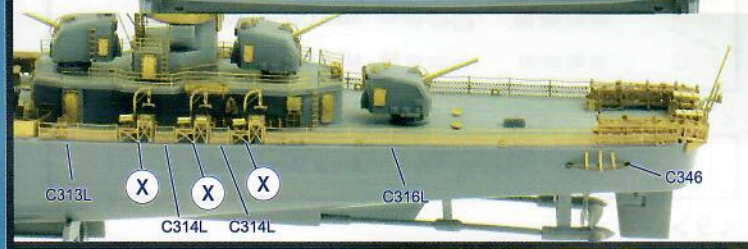
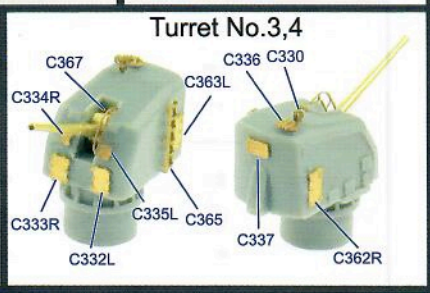
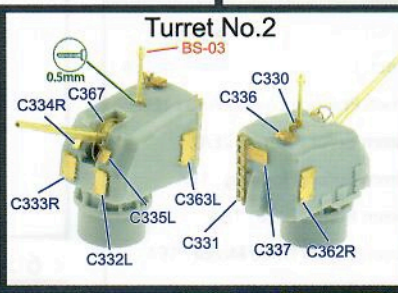
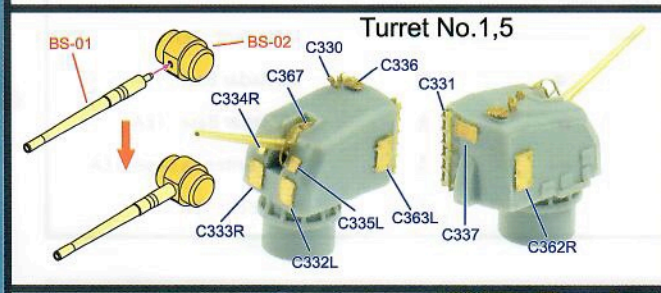
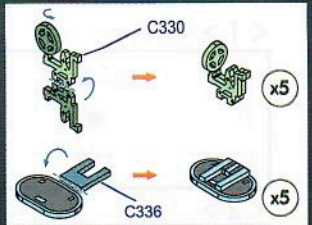
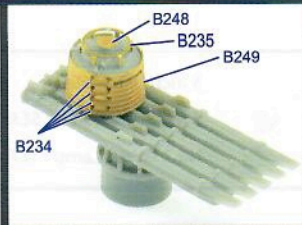
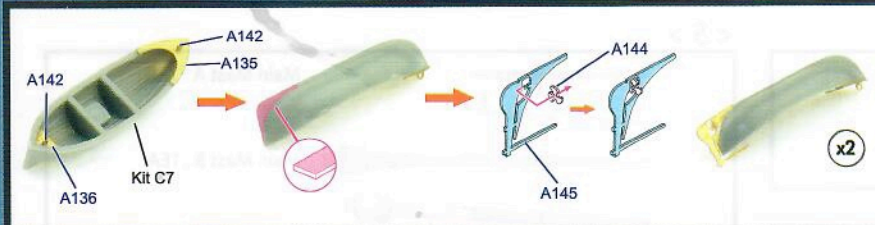







< 1 >

BS-01			5 Inch Barrel : 5EA
BS-02			5 Inch Barrel Axis : 5EA
BS-03			No.2 Turret Lamp : 1EA

< 2 >

BS-04			5 Inch Practice Loader : 1EA
BS-05			5 Inch Practice Loader Motor : 1EA
BS-06			5 Inch Practice Loader Axis : 1EA
BS-07			40mm Bofors Barrel : 2EA
BS-08			40mm Bofors Housing : 1EA
BS-09			40mm Bofors Base : 1EA
BS-10			40mm Bofors Drive Motor : 1EA
BS-11			40mm Bofors Handle - Axis R : 1EA
BS-12			40mm Bofors Handle - Axis L : 1EA















< 3 >

BS-13			Anchor Chain Winch : 1EA
BS-14			Staff : 2EA
BS-15			Jack - Staff Lamp : 1EA
BS-16			Boat Winch Motor : 1EA
BS-17			Boat Winch Part : 1EA
BS-18			Boat Winch Drum : 2EA
BS-19			Boat Davit Base : 2EA
BS-20			Smoke Screen Generator : 8EA

< 4 >

BS-21			Reel E - E - F : 1EA
BS-22			Reel G - H - H : 1EA
BS-23			Reel M - a : 2EA
BS-24			Reel M - b : 1EA
BS-25			Torpedo Crane Turn Base : 1EA
BS-26			20mm Oerlikon : 6EA
BS-27			20mm Oerlikon Mount : 6EA







< 5 >

BS-28			Main Mast A : 1EA
BS-29			Main Mast B : 1EA
BS-30			Main Mast B : 1EA
BS-31			SG Radar Base : 1EA
BS-32			SC Radar Base : 1EA
BS-33			Roof Antenna Base : 1EA
BS-34			Ship Bell : 1EA



< 6 >

BS-35			Flag Staff : 1EA
BS-36			Funnel Mast A : 1EA
BS-37			Funnel Mast A : 2EA
BS-38			Funnel Mast B : 2EA
BS-39			Ship Horn : 1EA
BS-40			Fog Siren : 1EA
BS-41			SLOs Pedestal : 2EA
BS-42			Torpedo Director : 2EA

< 7 >

BS-43			Depth Charge Davit Base : 2EA
BS-44			Mk.3 Depth Charge : 5EA
BS-45			Mk.5 Depth Charge : 7EA

< 8 >

BS-46			Arbor Sleeve : 36EA
-------	-------------------------------------------------------------------------------------	---------------------------------------------------------------------------------------	---------------------

< 9 >

	Anchor Chain : 1EA
-------------------------------------------------------------------------------------	--------------------

INFINI
 INFINI Model
 インフィニモデル



INFINI MODEL
IM-535022R1
US NAVY DD445 Fletcher Detail Up Set
 For 1/350 Scale Tamiya (Item No. 78012)