

**Revell**  
Authentic Kit

## ASSEMBLY INSTRUCTIONS FOR YOUR **DC-8 JET MAINLINER**



### **INTERESTING FACTS ABOUT YOUR UNITED AIR LINES DOUGLAS DC-8**

One of the world's most modern airliners, the United Air Lines Douglas DC-8 adds a new dimension to the already fabulous jet age. Cruising along at speeds of nearly 600 miles per hour, and at altitudes well above most weather disturbances, the DC-8 presents to the airline traveller new comforts and luxuries never before experienced in commercial aviation. Gone is the noise of the old reciprocating engines, and in its place is the soft hum of the powerful jet turbines, barely audible in the large, soundproofed cabins.

Various seating arrangements make it possible for the DC-8 to accommodate between 90 and 150 passengers. It has a wingspan of 139 feet, 9 inches, an overall length of 150 feet, 6 inches, and a cruising range of 4,660 miles. Maximum speed is given as 586 miles per hour, and its cruising speed as 566. These speeds make it possible for a businessman in Los Angeles to board a DC-8 in the morning, fly to New York and put in several hours work, returning to his home the same evening.

Powering the United DC-8 are four Pratt and Whitney JT-3C-6 Turbojet engines, which utilize water injection to boost the power on takeoff. Each engine has its own lubrication system, and a "daisy petal" sound suppressor installed on the tailpipe. Also installed on each engine is a clam shell thrust reverser, used to deflect the engine thrust forward, thereby reducing the landing roll.

United Air Lines DC-8 has been designed with great attention to safety, over two million dollars having been spent in the program. The designs were finalized late in 1955, and the flight tests began in the middle of 1958. The aircraft represents one of the greatest steps forward in commercial aviation and another factor which marks United Air Lines as one of this nation's leading public transportation systems.

### **FOR BEST RESULTS READ THIS FIRST**

1. All parts are numbered for easy identification, or the numbers are engraved on the bar next to the part. Break each part from its bar only when that part is to be used.
2. For the best fit, carefully trim any excess plastic from parts before assembling.
3. Since this kit is molded of Styrene Plastic, use only **REVELL TYPE © CEMENT**. Do not let cement touch your eyes or clothing.
4. Apply cement sparingly. Excess cement may run and damage the details on your model.
5. With **REVELL PAINT SET COLORS**, paint all parts where indicated and allow them to dry before assembling.
6. Directions for applying decals are on the back of the Decal Sheet.
7. **NOW CAREFULLY FOLLOW THESE NUMBERED STEPS FOR EASE IN BUILDING YOUR MODEL.**

# PARTS LIST FOR YOUR DOUGLAS DC-8

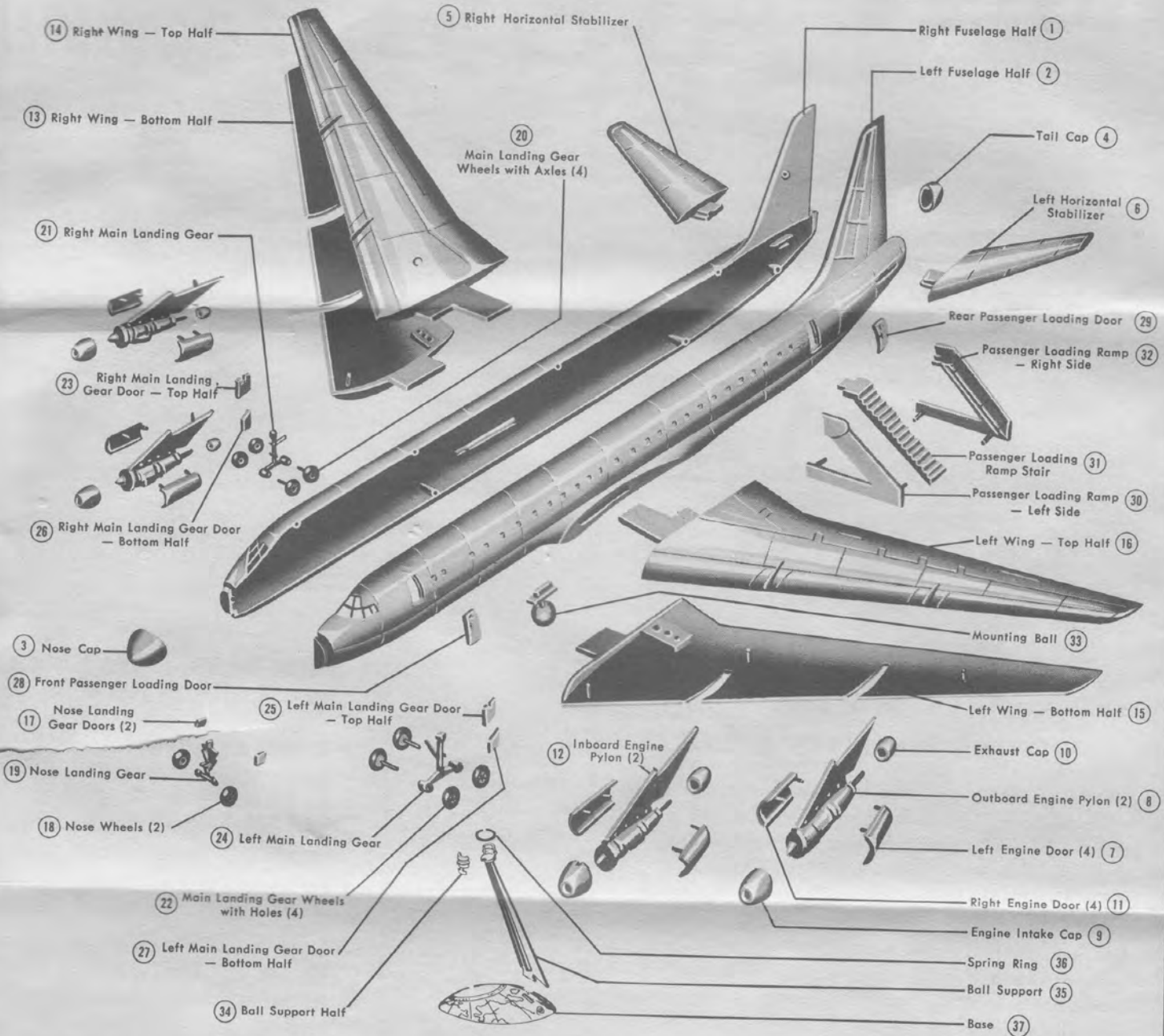

SHOULD ANY PARTS BE MISSING, CIRCLE MISSING PARTS AND SEND IN PARTS LIST AND COUPON TO: DEPT. X, REVELL, INC., 4223 GLENCOE AVENUE, VENICE, CALIFORNIA

PLEASE FILL IN COUPON BELOW IN INK

FROM: **Revell** INC.  
 4223 GLENCOE AVE.  
 VENICE  
 CALIFORNIA

YOUR NAME (Please Print) \_\_\_\_\_  
 STREET ADDRESS \_\_\_\_\_  
 CITY \_\_\_\_\_ ZONE \_\_\_\_\_ STATE \_\_\_\_\_

BEFORE YOU CIRCLE THE NUMBER(S) THAT CORRESPONDS WITH THE NAME OF THE PART (ONLY IF MISSING OR BROKEN) PLEASE FILL IN THE FOLLOWING INFORMATION: (PRINT CLEARLY)

Name of the store where kit was purchased: \_\_\_\_\_  
 Street Address: \_\_\_\_\_  
 City: \_\_\_\_\_ State: \_\_\_\_\_ Date of purchase: \_\_\_\_\_

- PARTS LIST FOR YOUR DC-8**
- |                                |   |  |   |
|--------------------------------|---|--|---|
| 1. Right Fuselage Half         | 11. Right Engine Door (4)                   | 21. Right Main Landing Gear                    | 31. Passenger Loading Ramp Stair        |
| 2. Left Fuselage Half          | 12. Inboard Engine Pylon (2)                | 22. Main Landing Gear Wheels with Holes (4)    | 32. Passenger Loading Ramp - Right Side |
| 3. Nose Cap                    | 13. Right Wing - Bottom Half                | 23. Right Main Landing Gear Door - Top Half    | 33. Mounting Ball                       |
| 4. Tail Cap                    | 14. Right Wing - Top Half                   | 24. Left Main Landing Gear Door - Top Half     | 34. Ball Support Half                   |
| 5. Right Horizontal Stabilizer | 15. Left Wing - Bottom Half                 | 25. Left Main Landing Gear Door - Bottom Half  | 35. Ball Support                        |
| 6. Left Horizontal Stabilizer  | 16. Left Wing - Top Half                    | 26. Right Main Landing Gear Door - Bottom Half | 36. Spring Ring                         |
| 7. Left Engine Door (4)        | 17. Nose Landing Gear Doors (2)             | 27. Left Main Landing Gear Door - Bottom Half  | 37. Base                                |
| 8. Outboard Engine Pylon (2)   | 18. Nose Wheels (2)                         | 28. Front Passenger Loading Door               | 38. Decals                              |
| 9. Engine Intake Cap           | 19. Nose Landing Gear                       | 29. Rear Passenger Loading Door                |   |
| 10. Exhaust Cap                | 20. Main Landing Gear Wheels with Axles (4) | 30. Passenger Loading Ramp - Left Side         |   |

248 CONTENTS - MERCHANDISE. POSTMASTER: This parcel may be opened for postal inspection if necessary. Return postage guaranteed.

**1****PAINT THE DETAILS, AS SHOWN, BEFORE ASSEMBLING.**

- A.** Cement the Right Fuselage Half, Part 1, to the Left Fuselage Half, Part 2.  
**B.** Cement the Nose Cap, Part 3, to the Fuselage Nose. Cement the Tail Cap, Part 4, to the Fuselage Tail. At this point we suggest using rubber bands at the front and rear of Fuselage to hold Fuselage firmly together. When completely dry, remove rubber bands.

REFER TO BOX COVER FOR  
 WHITE PAINTED AREAS AND  
 WHITE DETAIL.

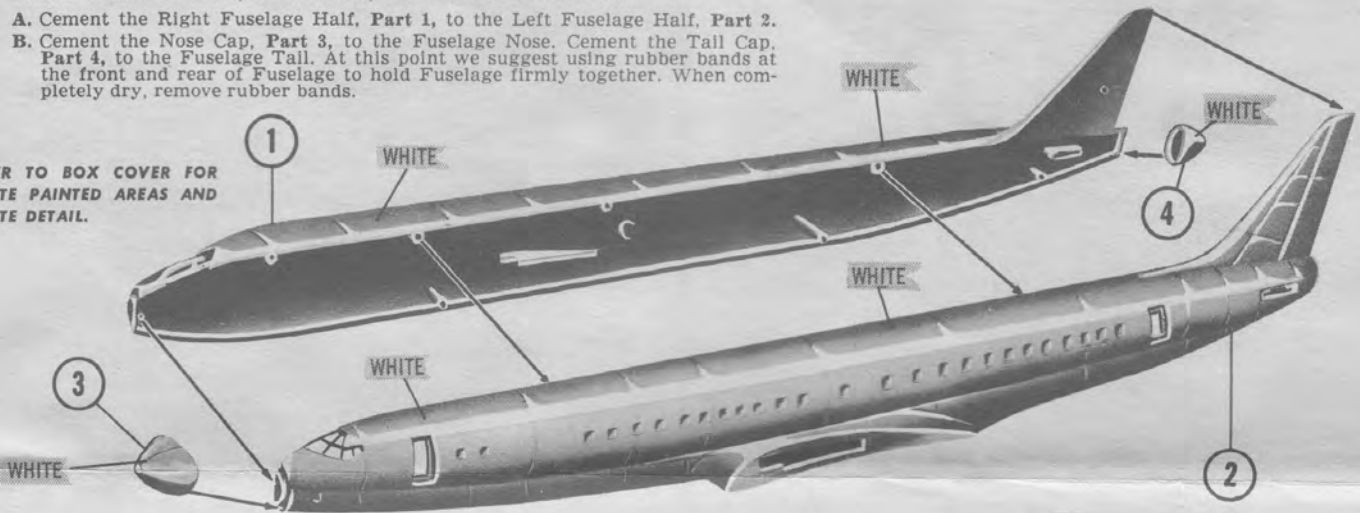
**2****PAINT THE DETAILS, AS SHOWN, BEFORE ASSEMBLING.**

- A.** Cement the Right Horizontal Stabilizer, Part 5, to the Fuselage. Now cement the Left Horizontal Stabilizer, Part 6, to the Fuselage, as shown. Set the Fuselage aside to dry.

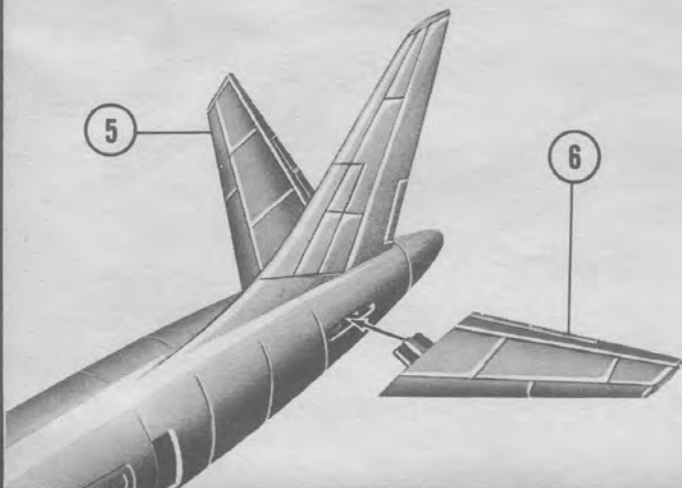
**3****PAINT THE DETAILS, AS SHOWN, BEFORE ASSEMBLING.**

- A.** To assemble the Right Outboard Engine, cement, or place, a Left Engine Door (Part 7) to an Outboard Engine Pylon (Part 8). Cement an Engine Intake Cap (Part 9) and an Exhaust Cap (Part 10) to the Engine as shown.  
**B.** Now cement, or place, a Right Engine Door (Part 11) on the Engine. The Doors may be removed to display the Engine detail.  
**C.** Assemble an Inboard Engine in the same way, using an Inboard Engine Pylon (Part 12). Now assemble the two remaining Engines for the Left Wing, in the same way, and set aside to dry.

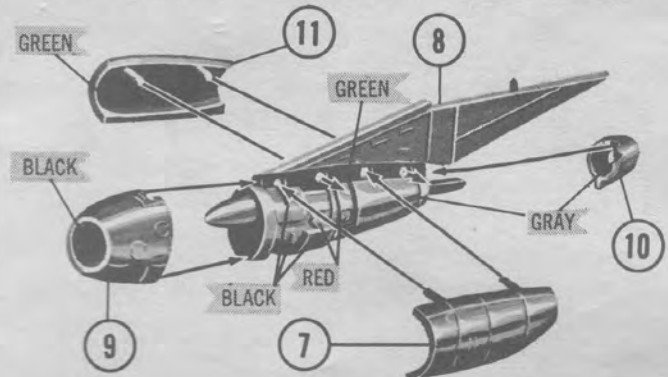
**4****PAINT THE DETAILS, AS SHOWN, BEFORE ASSEMBLING.**

- A.** Cement the Bottom Half of the Right Wing, Part 13, to the Top Half of the Right Wing, Part 14, as shown. Cement an Inboard and an Outboard Engine to the Wing, as shown.  
**B.** Now cement the Bottom Half of the Left Wing, Part 15, to the Top Half of the Left Wing, Part 16. Cement an Inboard and Outboard Engine to this Wing and set aside to dry.

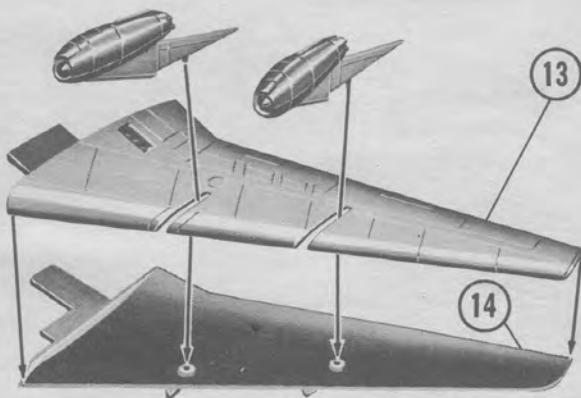
**5****PAINT THE DETAILS, AS SHOWN, BEFORE ASSEMBLING.**

- A.** If you want your model in flight position, cement all Landing Gear Doors closed.  
**B.** If you wish to show your model with Landing Gear down, carefully cement the Nose Landing Gear Doors, Parts 17, to the Fuselage, as shown.  
**C.** Snap, do not cement, the Nose Wheels, Parts 18, to the Nose Landing Gear, Part 19. Cement the Nose Landing Gear to the Fuselage, as shown. Set aside to dry.

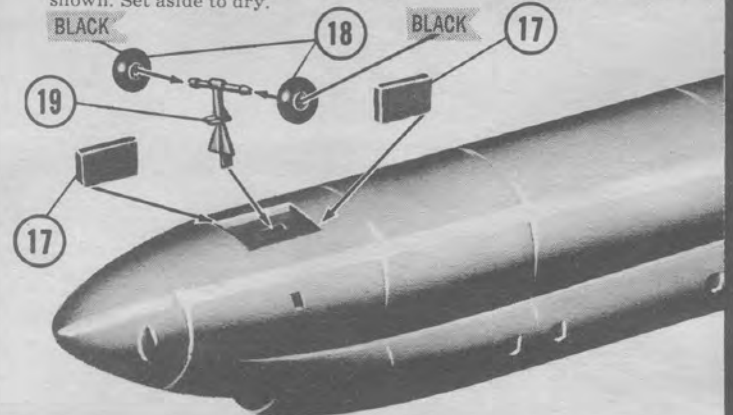



6

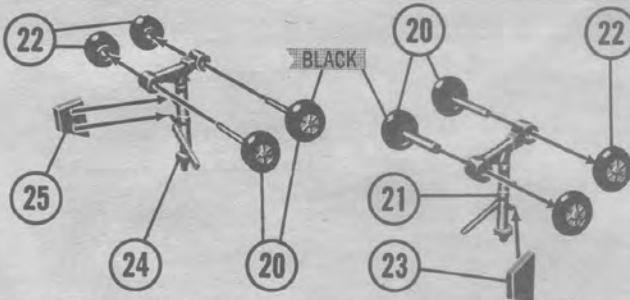

PAINT THE DETAILS, AS SHOWN, BEFORE ASSEMBLING.

- Insert the Axles on two of the Main Landing Gear Wheels With Axles, Parts 20, through the holes in the Right Main Landing Gear, Part 21.
- Carefully apply a drop of cement to the tips of the Axles and cement two of the Main Landing Gear Wheels With Holes, Parts 22, to the Axles. Do not let cement touch the Landing Gear, or the Wheels will not turn freely.
- Cement the Right Main Landing Gear Door Top Half, Part 23, to the Right Main Landing Gear, as shown. Now assemble the remaining Main Landing Gear Wheels, the Left Main Landing Gear, Part 24, and the Left Main Landing Gear Door Top Half, Part 25, in the same way you assembled the Right Landing Gear.

7

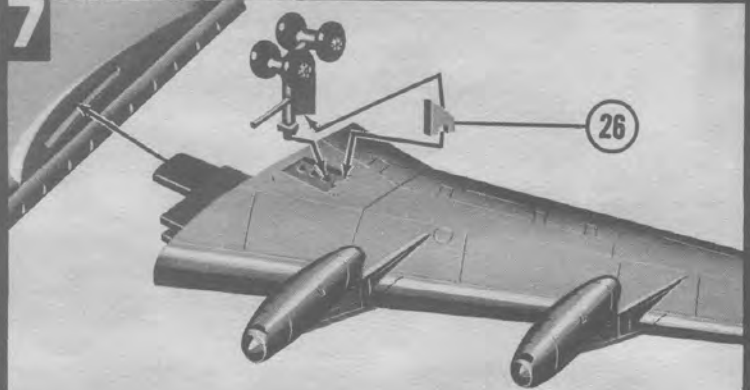

- Cement the Right Main Landing Gear Door Bottom Half, Part 26, to the Right Wing, as shown. Cement the Right Main Landing Gear to the Right Wing.
- Cement the Left Main Landing Gear Door Bottom Half, Part 27, to the Left Wing. Now cement the Left Main Landing Gear to the Left Wing. Finally, cement the Wings to the Fuselage.

8

SEE SEPARATE INSTRUCTION SHEET FOR PLACEMENT OF DECALS.

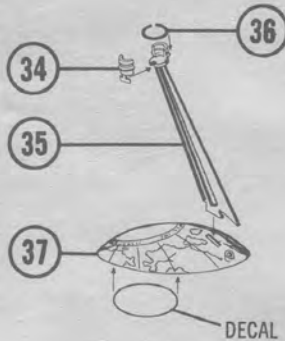

PAINT THE DETAILS AS SHOWN.

- If your model is in flight position, cement the Front Passenger Loading Door, Part 28, and the Rear Passenger Loading Door, Part 29, to the Fuselage in a closed position.
- If your model has the Landing Gear down, the Front Passenger Loading Door may be cemented in either an open or closed position. Cement the Rear Passenger Loading Door to the front edge of the Rear Door Opening in an open position.
- Cement the Passenger Loading Ramp, Left Side, Part 30, to the Passenger Loading Ramp Stair, Part 31. Now cement the Passenger Load-

ing Ramp Right Side, Part 32, to the Passenger Loading Ramp Stair. Now cement the Passenger Loading Ramp into place by inserting the Large Tab on the Ramp Platform into the Rear Door Opening, as shown.

- To display your model on the Swivel Stand, cement the Mounting Ball, Part 33, to the Fuselage. Then snap, do not cement, the Ball Support Half, Part 34, and the Ball Support, Part 35, together. Snap the Spring Ring, Part 36, over the upper groove on the Ball Support. Cement the Ball Support to the Base, Part 37, and apply Stand Decal. Snap the Mounting Ball into the Ball Support. There is a hole in the Base for wall mounting.

**Revell**  
Authentic Kits

H-151 GRUMMAN F9F-8 COUGAR  
Carrier-Based Fighter



H-152 REPUBLIC F84F THUNDERSTREAK  
High-Speed Fighter-Bomber



H-153 NORTHROP SCORPION F-89D INTERCEPTOR  
Rocket Carrying Interceptor



H-154 CHANCE VOUGHT F8U-1 CRUSADER  
Swept-Wing Carrier Plane