

MIRAGE 2000D "KANDAHAR"



83524

F

En service depuis 1993, le Mirage 2000 D est dérivé du Mirage 2000 N. Spécialement optimisé pour les opérations de bombardement conventionnel et l'appui rapproché des troupes au sol, il participe, depuis 1999, à la plupart des engagements français sur les théâtres d'opérations extérieures, dont les opérations de sécurisation de l'Afghanistan.

Son équipage comprend le pilote à l'avant et un officier système d'armes en place arrière. Le cockpit du 2000 D a été complètement refondu pour répondre aux normes HOTAS (Hands on Throttle And Stick - Mains sur Manche et Manette) et met à disposition du NOSA (Navigateur Opérateur du Système d'Armes) l'ensemble des commandes et indicateurs lui permettant de piloter l'avion en cas de défaillance du pilote.

Son système de navigation sécurisé et son radar de suivi de terrain lui permettent de voler à très basse altitude (250 pieds, soit environ 80 m) et à grande vitesse (550 nœuds, soit près de 1000 km/h), en pilotage automatique et conditions de vol sans visibilité. En mission, le pilote s'occupe de la trajectoire, tandis que le NOSA se concentre sur le radar, la localisation de l'objectif et le largage des munitions. Le Mirage 2000D est capable de tirer par tout temps tous les armements en service dans l'Armée de l'Air française, dont ceux à guidage laser, et les nouveaux missiles SCALP-EG et Apache. Il dispose soit d'un pod PDLCT-S (Pod de Désignation Laser à Caméra Thermique Synergie permettant l'acquisition d'objectifs de nuit) soit d'un PDLTV (PDL à télévision), évolution de l'ATLIS du Jaguar, reliés au système de navigation et d'attaque. Le Mirage 2000 D est ravitaillable en vol.

CARACTERISTIQUES

Envergure	: 9,13 m
Longueur	: 14,94 m
Hauteur	: 5,20 m
Masse à vide	: classe des 8 Tonnes
Masse maximale	: 16500 kg
Emport carburant	: 3100 kg en interne
Moteur	: 1 réacteur M53-P2 de 6,5 Tonnes poussée, 9,7 Tonnes avec Post combustion
Plafond opérationnel	: 15 000 mètres
Vitesse maximale	: Mach 1,4
Rayon d'action	: de l'ordre de 1600 km avec réservoirs largables.
Charge externe max	: 6200 kg
Equipements	: Points d'emports extérieurs: 9 au total Radar Antilope 5 modernisé de suivi de terrain. Système de cartographie ICARE GPS intégré 2 centrales à inertie Contre-mesures électroniques intégrées Pod de désignation laser pour tirer des armements guidés laser type AS30 L et BGL
Armement air sol:	: - Bombes: BGL 1000, BAP 100, GBU : 12, 22, 16, 24 et 49, BLU 107 Durandal - Missiles guidés: AS-30 Laser (max 1) Armat, Apache, Scalp-EG - Roquettes
Armement air-air:	: - MAGIC II

GB

In service since 1993, the Mirage 2000D derives from the Mirage 2000N. Specially designed for conventional attack operations and close support for troops on the ground, since 1999 it has taken part in most French military operations abroad including security operations in Afghanistan.

It's equipped with two seats, the pilot being in the front and the weapon systems officer in the rear. The cockpit of the 2000D was completely redesigned to respond to HOTAS standards (Hands On Throttle And Stick) and provides the weapon system officer with the controls and displays needed to fly the aircraft in case the pilot is unable to.

Its secure navigation system and terrain-following radar enable it to fly at very low altitudes (250ft, or about 80m) and at high speed (550 knots, or close to 1000km/h), automatically and in zero visibility. On missions, the pilot focusses on the route, while the weapon systems officer concentrates on the radar, location of the objective and releasing of the munitions.

The Mirage 2000D is capable of firing all arms used in the French Air Force at any time, including laser guided weapons, and the new Storm Shadow and Apache missiles. It is equipped with either optical infra-red PDLCT's for targeting at night, or high-resolution video PDLTV targeting pods, an improvement on the Jaguar's ATLIS, linked to a navigation and attack system. The Mirage 2000D can be refuelled in flight.

CHARACTERISTICS

Wingspan	: 9.13 m
Length	: 14.94 m
Height	: 5.20 m
Empty weight	: 8 Tons
Maximum weight	: 16500 kg
Internal fuel capacity	: 3100 kg
Powerplant	: 1 M53-P2 turbojet - 6.5 tons of thrust, 9.7 tons with reheat.
Service ceiling	: 15,000m
Maximum speed	: Mach 1.4
Range with drop tanks	: around 1600 km.
Maximum external stores	: 6200 kg
Equipment	: External hardpoints: 9 in total Antilope 5 Radar updated with terrain following capability. ICARE mapping system Built-inGPS 2 inertial platforms Integrated electronic countermeasures Laser designation pod the delivery of laser guided weapons such as the AS30 L and LGB
Air-to-ground missiles:	: - Bombs: BGL 1000, BAP 100, GBU: 12, 22, 16, 24 and 49 BLU 107 Durandal - Guided missiles: AS-30 Laser (max 1) Armat, Apache, Storm Shadow - Rockets
Air-to-air missiles	: - MAGIC II

D

Als Nachfolger der Mirage 2000 N ist die Mirage 2000 D seit 1993 in Betrieb. Sie wurde speziell für konventionelle Bombenangriffe und die Luftnahunterstützung der Bodestreitkräfte optimiert. Seit 1999 nimmt sie an den meisten der französischen Auslandseinsätze teil, darunter auch an den Sicherheitseinsätzen in Afghanistan.

Die Besatzung besteht aus dem vorne sitzenden Piloten und einem hinten sitzenden Waffenoffizier. Das Cockpit der 2000 D wurde gemäß den HOTAS-Normen (Hands on Throttle and Stick) komplett überarbeitet und stellt dem NOSA (Navigateur Opérateur du Système d'Armes, Navigateur/Waffenoperateur) alle Kontrollen und Anzeigen zur Verfügung, so dass dieser bei Ausfall des Piloten das Flugzeug steuern kann.

Das Flugzeug verfügt über ein gesichertes Navigationssystem und einen Terrainfolgeradar, mit dessen Hilfe es bei sehr niedrigen Höhen (250 Fuß – ca. 80 m) und großer Geschwindigkeit (550 Knoten – fast 1000 km/h) mit Autopilot und ohne Sicht fliegen kann. Während eines Einsatzes kümmert sich der Pilot um die Flugbahn, während sich der NOSA auf den Radar, die Zieleinstellung und den Abwurf der Munition konzentriert.

Die Mirage 2000 D kann jederzeit alle Waffen der französischen Luftwaffe, darunter lasergesteuerte Waffen, die neuen Missiles SCALP-EG und Apache, abfeuern. Das Flugzeug verfügt entweder über einen PDLCT-S (Pod de Désignation Laser avec Camera Thermique Synergie, Laserzielbeleuchter mit Infrarotkamera) oder über einen PDLTV (PDL mit Fernsicht), die Weiterentwicklung des ATLIS des Jaguars, die mit den Navigations- und Angriffssystemen verbunden ist. Die Mirage 2000 D kann während des Flugs betankt werden.

TECHNISCHE DATEN

Spannweite	: 9,13 m
Länge	: 14,94 m
Höhe	: 5,20 m
Leermasse	: 8 Tonnen-Klasse
Max. Startmasse	: 16500 kg
Interne Kraftstoffkapazität	: 3100 kg
Triebwerk	: 1 Triebwerk M53-P2 mit 6,5 Tonnen Schub, 9,7 Tonnen mit Nachbrenner
Dienstgipfelhöhe	: 15 000 m
Höchstgeschwindigkeit	: Mach 1,4
Aktionsradius mit abwerfbaren Tanks:	in der Größenordnung von 1600 km.
Gesamte Außenlast	: 6200 kg
Ausstattung	: Äußere Flügelstationen: 9 insgesamt Modernisierter Radar Antilope 5 mit Terrainfolgeradar. Kartographiesystem ICARE Integrierter GPS 2 Trägheitsmesssysteme Integrierte elektronische Gegenmaßnahmen Laserzielbeleuchter zum Abfeuern von lasergesteuerten Waffen des Typs AS30 L und BGL
Luft-Boden-Waffen	: - Bomben: BGL 1000, BAP 100 GBU : 12, 22, 16, 24 und 49, BLU 107 Durandal - Ferngesteuerte Missiles: AS-30 Laser (max. 1) Armat, Apache, Scalp-EG - Raketen
Luft-Luft-Waffen	: - MAGIC II

RU

Mirage 2000 D является производным от Mirage 2000 и находится на вооружении с 1993 года. Специально оптимизированный для обычных бомбардировок и непосредственной поддержки сухопутных частей, он, начиная с 1999 года, принимает участие почти во всех зарубежных операциях французских войск, включая операции по обеспечению безопасности в Афганистане.

Его экипаж состоит из пилота (впереди) и офицера по вооружению (на заднем сиденье). Кабина 2000 D полностью переработана в соответствии с нормами HOTAS ("Руки на ручках управления двигателем и самолетом") и предоставляет в распоряжение NOSA ("Штурман и оператор системы вооружения") все органы управления и индикаторы, позволяющие ему вести самолет в случае недееспособности пилота.

Надежная навигационная система и радиолокатор местности позволяют Mirage 2000 D летать на высоте 250 футов (около 80 метров) и с высокой скоростью (550 узлов, или около 1000 км/ч) на автопилоте и при отсутствии видимости. В боевом полете пилот сосредоточен на маршруте, а штурман занимается радаром, локализацией цели и сбрасыванием боеприпасов.

Мираж 2000D способен в любое время нести любое оружие, состоящее на вооружении ВВС Франции, в том числе с лазерным наведением, а также новые ракеты SCALP-EG и Apache. Он оснащен либо контейнерной системой PDLCT-S (лазерная система наведения с термальной камерой Synergie для захвата целей в ночное время), либо PDLTV (PDL с телевидением) – дальнейшее развитие ATLIS Jaguar связанных с системой навигации и нападения. Мираж 2000 D может дозаправляться в полете.

ТЕХНИЧЕСКИЕ ХАРАКТЕРИСТИКИ

Размах крыльев	: 9,13 м
Длина	: 14,94 м
Высота	: 5,20 м
Масса без груза	: класс 8 тонн
Максимальная масса	: 16500 кг
Внутренний запас топлива	: 3100 кг
Двигатель	: 1 реактивный M53-P2 тягой в 6,5 тонн, с дожиганием 9,7 тонн
Рабочий потолок	: 15000 метров
Максимальная скорость	: 1,4 скорости звука
Дальность полета с дополнительными емкостями:	порядка 1600 км.
Максимальная внешняя нагрузка	: 6200 кг
Оборудование	: Точки подвески внешних грузов: 9 всего Радар Antilope 5 модернизированный для слежения за землей. Картографическая система ICARE GPS встроенная 2 инерциальных прибора для навигации Средства электронной защиты встроенные Лазерная система наведения для оружия с лазерным управлением
Вооружение воздух-земля	: типа AS30 L и BGL - Бомбы: BGL 1000 (с лазерным управлением), BAP 100 (бетонобойная), бомбы GBU: 12, 22, 16, 24 и 49, BLU 107 (дюрандаль) - Управляемые ракеты: AS-30 Laser (макс 1) Armat, Apache, Scalp-EG - Ракеты
Вооружение воздух-воздух:	: - MAGIC II

E

El Mirage 2000D, basado en el Mirage 2000N, entró en servicio en 1993. Especialmente optimizado para bombardeos convencionales y para ofrecer apoyo a las tropas de tierra, ha participado desde 1999 en la mayor parte de las operaciones francesas en el exterior entre las que se incluyen las operaciones de seguridad en Afganistán.

Su equipo está formado por un piloto que ocupa el asiento delantero y un oficial de sistema de armas que ocupa el asiento trasero. La cabina del 2000D ha sido completamente rediseñada para responder a las normas HOTAS (del sus siglas en inglés Hands on Throttle And Stick - Manos sobre el acelerador y la palanca) y proporciona al NOSA (Navegador Operador del Sistema de Armas) el conjunto de órdenes e indicadores que permiten al avión seguir volando en caso de fallo del piloto. Su sistema de navegación segura y su radar de seguimiento del terreno le permiten volar a muy baja altitud (250 pies, aproximadamente 80 m) y a gran velocidad (550 nudos, aproximadamente 1000km/h), con piloto automático y en condiciones de vuelo sin visibilidad. Durante una misión, el piloto se ocupa de la trayectoria, mientras que el NOSA se concentra en el radar, la localización del objetivo y el lanzamiento de las municiones.

El Mirage 2000D puede lanzar en todo momento todas las armas en servicio de la Armada Aérea francesa, incluyendo misiles guiados por láser, y los nuevos misiles SCALP-EG y Apache. Posee un módulo espacial PDLCT-S (Módulo espacial láser con cámara térmica de sinergia que permite localizar los objetivos por la noche) un PDLTV (PDL de televisión), evolución del ATLAS de un Jaguar, relacionados con el sistema de navegación y de ataque. El Mirage 2000D puede repostar en vuelo.

CARACTERÍSTICAS

Envergadura : 9,13 m
Longitud : 14,94 m
Altura : 5,20 m
Peso vacío : 8 toneladas
Peso máximo : 16500 kg
Carga de combustible interna : 3100 kg
Motor : 1 reactor M53-P2 de 6,5 toneladas de empuje, 9,7 toneladas con

postquemador
Techo de servicio : 15 000 metros
Velocidad máxima : Mach 1,4

Alcance en combate con tanques de combustible auxiliares: del orden de 1600 km.

Carga externa máxima : 6200 kg

Equipos :

Puntos de carga externos: 9 en total
Radar Antilope 5 modernizado para seguimiento del terreno.
Sistema de cartografía ICARE
GPS integrado
2 centrales de navegación inercial
Contra-medidas electrónicas integradas
Módulo láser para lanzar armas guiadas por láser de tipo AS30 L y BGL

Armamento aire tierra :

- Bombas: BGL 1000, BAP 100, GBU : 12, 22, 16, 24 e 49, BLU 107 Durandal
- Misiles guiados: AS-30 Láser (máx. 1) Armat, Apache, Scalp-EG
- Cohetes

Armamento aire-aire :

- MAGIC II

NL

De Mirage 2000D, in gebruik sedert 1993, is de opvolger van de Mirage 2000 N. Dit vliegtuig, dat specifiek werd geoptimaliseerd voor conventionele bombardementsvluchten en ondersteuning van de grondtroepen, heeft sinds 1999 aan het merendeel van de Franse militaire interventies in het buitenland deelgenomen, waaronder de beveiligingsoperaties in Afghanistan.

De bemanning bestaat uit een piloot vooraan en een bewapeningsofficier achteraan. De cockpit van de 2000 D werd volledig vernieuwd om te voldoen aan de richtlijnen van HOTAS (Hands on Throttle And Stick - Handen op Smooroklep en Hendel) en is ter beschikking gesteld aan de NOSA (Navigateur Opérateur du Système d'Armes - Navigator-bediener van het bewapeningssysteem). Het geheel aan bedieningsknoppen en indicatoren laat de NOSA toe om het vliegtuig te besturen in geval de piloot dit niet langer kan.

Het beveiligd navigatiesysteem en de terrein-volgende radar laten het vliegtuig toe om op zeer lage hoogte (250 voet, circa 80 m), tegen zeer hoge snelheid (550 knopen, circa 1000 km/u), op automatische piloot en in vliegomstandigheden zonder zicht te vliegen. Tijdens de missie bekommert de piloot zich om het traject, terwijl de NOSA zich concentreert op de radar, de lokalisatie van het doel en het afwerpen van munitie.

De Mirage 2000D kan in alle weersomstandigheden alle soorten wapens van de Franse luchtmacht, waaronder raketten met laserbesturing, de nieuwe SCALP-EG en Apache-raketten, afvuren. Het vliegtuig is uitgerust met een PDLCT-S pod (Pod de Désignation Laser à Caméra Thermique Synergie- Een laserdoelwittepuntpod met thermische camera voor het detecteren van doelen in de nacht) en een PDLTV, evolutie van de ATLAS van Jaguar die op het navigatie- en aanvalssysteem is aangesloten. De Mirage 2000 D kan in de lucht worden geravitailleerd.

EIGENSCHAPPEN

Spanwijdte : 9,13 m
Lengte : 14,94 m
Hoogte : 5,20 m
Tara gewicht : 8 ton klasse
Maximum gewicht : 16.500 kg
Interne brandstofcapaciteit : 3100 kg
Motor : 1 M53-P2 reactor van 6,5 ton, 9,7 ton met naverbranding

Praktisch plafond : 15.000 meter
Maximum snelheid : 1,4 mach
Actieradius met scheidbare reservoirs voor circa 1600 km.

Max. externe lading : 6200 kg

Uitrusting :

Externe laadpunten: 9 in totaal
Gemoderniseerde, terrein-volgende radar Antilope 5.

ICARE cartografiesysteem

Geïntegreerde GPS

2 traagheidscentrales

Geïntegreerde, elektronische afweermiddelen

Laserdoelwittepuntpod met lasergeleide bewapening van het AS30 L en

BGL type af te vuren

Lucht-grond bewapening :

- Bomben: BGL 1000, BAP 100, GBU : 12, 22, 16, 24 e 49, BLU 107 Durandal

- Geleide raketten: AS-30 Laser (max. 1) Armat, Apache, Scalp-EG

- Raketbommen

Lucht-lucht bewapening :

- MAGIC II

P

Em serviço desde 1993, o Mirage 2000 D deriva do Mirage 2000 N. Especialmente optimizado para operações de bombardeamento convencional e apoio aproximado das tropas no solo, ele participa, desde 1999, na maioria das operações francesas em teatros de operações exteriores, incluindo operações de segurança no Afeganistão.

A sua equipa inclui o piloto à frente e um oficial do sistema de armamento atrás. O cockpit do 2000 D foi completamente transformado para responder às normas HOTAS ((Hands on Throttle And Stick - Mãos na válvula e no comando)) e coloca à disposição do NOSA (Navegador Operador do Sistema de Armamento) todos os comandos e indicadores que lhe permitem controlar o avião no caso de desfalhecimento do piloto.

O seu sistema de navegação seguro e o seu radar de seguimento de terreno permitem-lhe voar a uma altitude muito baixa (250 pés, ou seja, cerca de 80 m) e a grande velocidade (550 nós, ou seja, perto de 1000 km/h), em piloto automático e condições de voo sem visibilidade. Em missão, o piloto trata da trajectória, enquanto que o NOSA se concentra no radar, na localização do objectivo e no lançamento das munições.

O Mirage 2000D é capaz de disparar todo o armamento em serviço da Força Aérea francesa, incluindo os com orientação a laser e os novos misseis SCALP-EG e Apache. Dispõe de um pod PDLCT-S (Pod de Designação Laser com Câmara Térmica Sinérgica que permite obter objectos durante a noite) e um PDLTV (PDL com televisão), evolução do ATLAS do Jaguar, ligados ao sistema de navegação e de ataque. O Mirage 2000 D pode ser abastecido durante o voo.

CARACTERÍSTICAS:

Envergadura : 9,13 m
Comprimento : 14,94 m
Altura : 5,20 m
Peso sem carga : Classe das 8 toneladas
Peso máximo : 16.500 kg
Capacidade interna de combustível : 3.100 kg
Motor : 1 reactor M53-P2 de 6,5 toneladas de impulsão, 9,7 toneladas

com posto de combustão
Limite operacional : 15.000 metros

Velocidade máxima : Mach 1,4

Raio de acção com reservatórios largáveis: Na ordem dos 1600 km.

Carga externa máxima : 6.200 kg

Equipamentos :

Pontos de transporte externos : 9 no total
Radar Antilope 5 modernizado com seguimento do terreno.
Sistema de cartografia ICARE
GPS integrado
2 centrais de inércia
Contra-medidas electrónicas integradas
Pod de designação laser para lançar armamento guiado a laser do tipo AS30 L e BGL

Armamento terra-ar :

- Bombas: BGL 1000, BAP 100, GBU : 12, 22, 16, 24 e 49, BLU 107 Durandal
- Misseis guiados: AS-30 Laser (máx 1) Armat, Apache, Scalp-EG
- Rockets

Armamento ar-ar :

- MAGIC II

I

In servizio dal 1993, il Mirage 2000 D deriva dal Mirage 2000 N. Appositamente ottimizzato per le operazioni di bombardamento convenzionale e l'appoggio ravvicinato di truppe a terra, dal 1999 partecipa alla maggior parte delle missioni francesi all'estero, tra cui le operazioni di sicurezza in Afghanistan.

L'equipaggio include il pilota davanti e un ufficiale esperto di sistemi di armi seduto dietro. L'abitacolo del 2000 D è stato completamente rimodellato per rispondere alle norme HOTAS (Hands on Throttle And Stick - Mani sulla Manetta e sulla Cloche) e mette a disposizione del NOSA (Navigatore Operatore del Sistema d'Armi) tutti i comandi e gli indicatori che gli permettono di pilotare l'aereo in caso di mancamento del pilota.

Il sistema di navigazione sicuro e il radar di ricognizione a terra gli permettono di volare a bassissima quota (250 piedi, circa 80 m) e ad altissima velocità (550 nodi, circa 1000 km/h), con pilota automatico e senza visibilità. In missione, il pilota si occupa della traiettoria, mentre il NOSA si concentra sul radar, la localizzazione dell'obiettivo e lo sganciamento delle munizioni.

Il Mirage 2000D è in grado di sparare in qualsiasi momento tutte le armi in dotazione all'Aeronautica francese, tra cui quelle a guida laser, i nuovi missili SCALP-EG e l'Apache. È dotato di un pod PDLCT-S (Pod di Designazione Laser a Camera Termica Sinergica che permette l'identificazione degli obiettivi di notte) o di un PDLTV (PDL televisivo), evoluzione dell'ATLAS del Jaguar, collegati al sistema di navigazione e di attacco. Il Mirage 2000 D si può rifornire in volo.

CARATTERISTICHE

Apertura alare : 9,13 m
Lunghezza : 14,94 m
Altezza : 5,20 m
Massa a vuoto : classe 8 tonnellate
Massa massima : 16.500 kg
Carico carburante all'interno : 3.100 kg
Motore : 1 reattore M53-P2 da 6,5 Tonnellate spinte, 9,7 Tonnellate con

Post combustione
Altitudine massima di volo : 15.000 metri

Velocità massima : Mach 1,4

Raggio d'azione con serbatoi sganciabili: 1.600 km

Carico esterno max : 6.200 kg

Attrezzature :

Punti di carico esterni: 9 in totale
Radar Antilope 5 modernizzato con ricognizione a terra.

Sistema di cartografia ICARO

GPS integrato

2 centrali a inerzia

Contromisure elettroniche integrate

Pod di designazione laser per lancio di missili laser-guidati di tipo

AS30 L e BGL

Armamento aria terra :

- Bombe: BGL 1000, BAP 100, GBU : 12, 22, 16, 24 e 49, BLU 107 Durandal
- Missili guidati: AS-30 Laser (max 1) Armat, Apache, Scalp-EG
- Razzi

Armamento aria-aria :

- MAGIC II

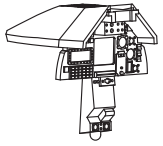

R01



R02

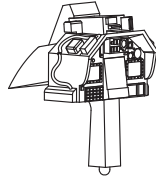

R03



R04



R05



R06

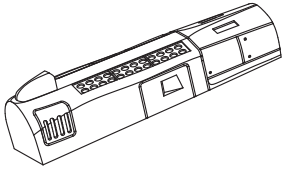

R07

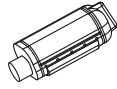

R08

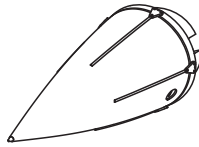

R09

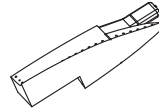

R10

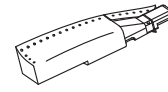

R11

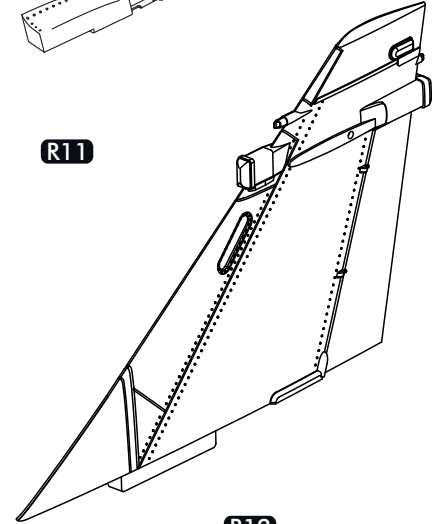

R12

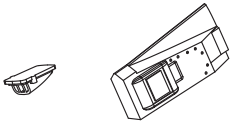

x2 R13

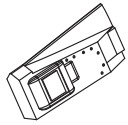

x2 R14



R15

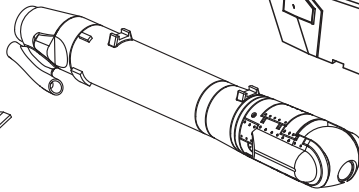

R16

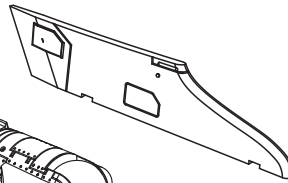

R17

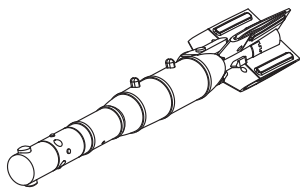

x2 R18



x2 R19



x2 R20



x8 R21

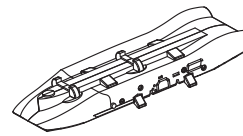

R22

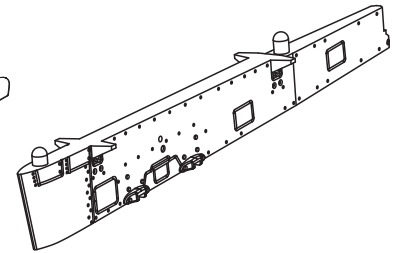

R23

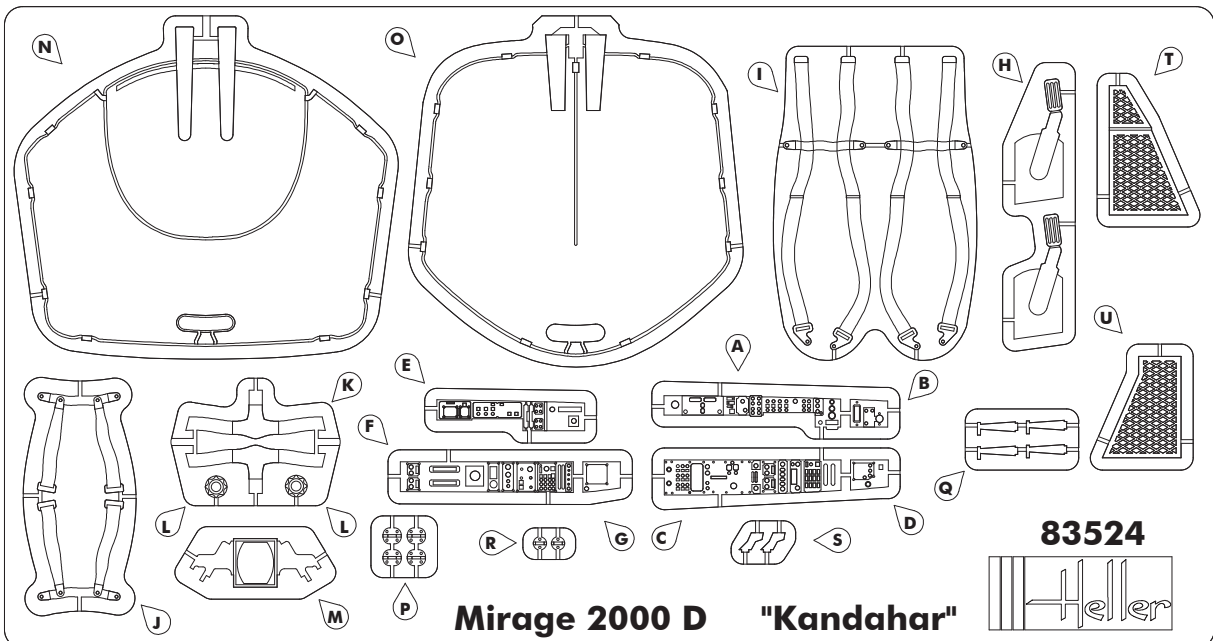

11
Argent
Silver
Silber
FS 17178

24
Jaune mat
Matt yellow
Matt Gelb

30
Vert foncé mat
Matt dark green
Matt Dunkelgrün

33
Noir mat
Matt black
Matt Schwarz

34
Blanc mat
Matt white
Mattweiss
FS 37875

56
Aluminium
Aluminium
Aluminium

85
Noir satiné
Satin black
Seidenmatt-Schwarz
FS 27038

87
Gris acier mat
Matt steel grey
Matt Stahlgrau

93
Jaune désert mat
Matt desert yellow
Matt-Wüstensand

102
Vert armée mat
Matt army green
Matt Armeegrün
FS 34096

116
Vert foncé mat
Matt dark green
Matt Dunkelgrün
FS 34079

129
Gris mouette satiné
Satin gull grey
Satin Möwengrau
FS 36440

140
Gris mouette mat
Matt gull grey
Matt Möwengrau
FS 36231

160
Brun-rouge
Red brown
Tarnbraun

196
Gris clair
Light Grey
Hellgrau

1322
Orange transparent
Clear orange
Durchsichtiges Orange

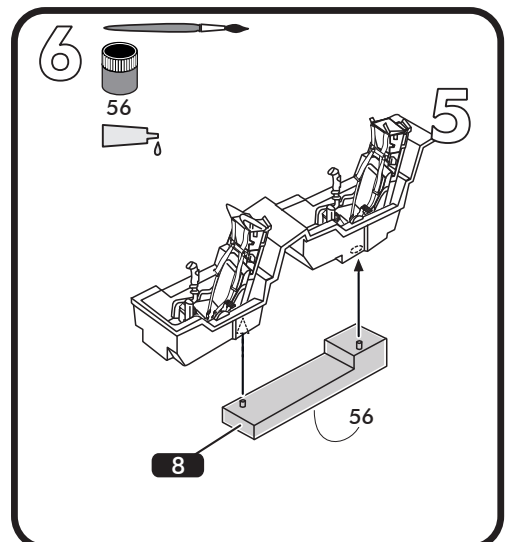
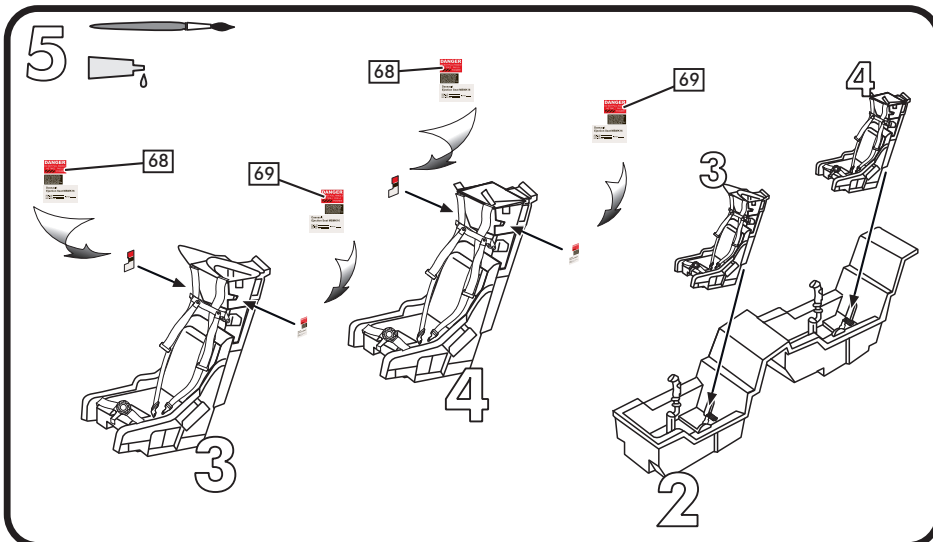
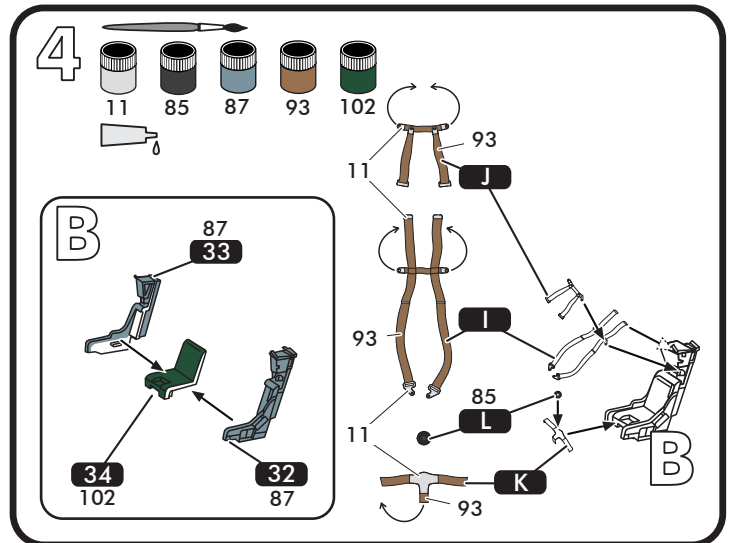
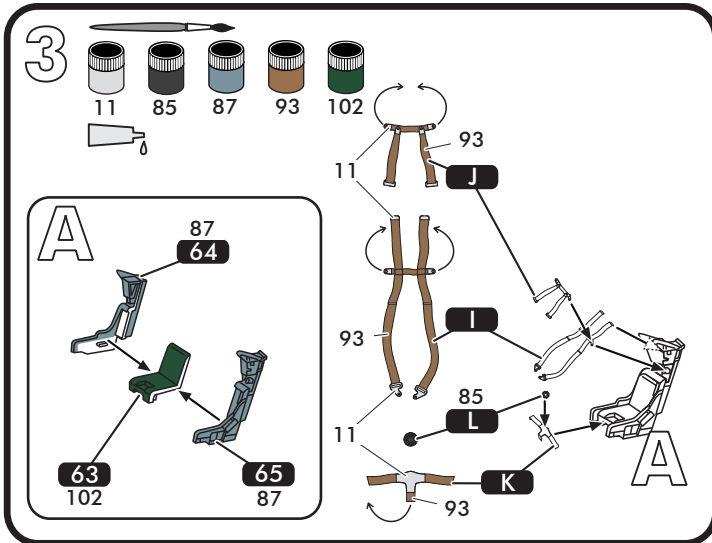
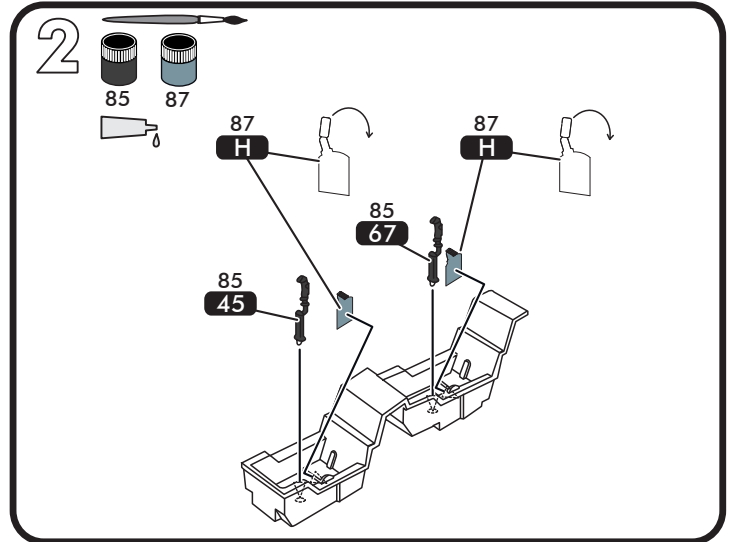
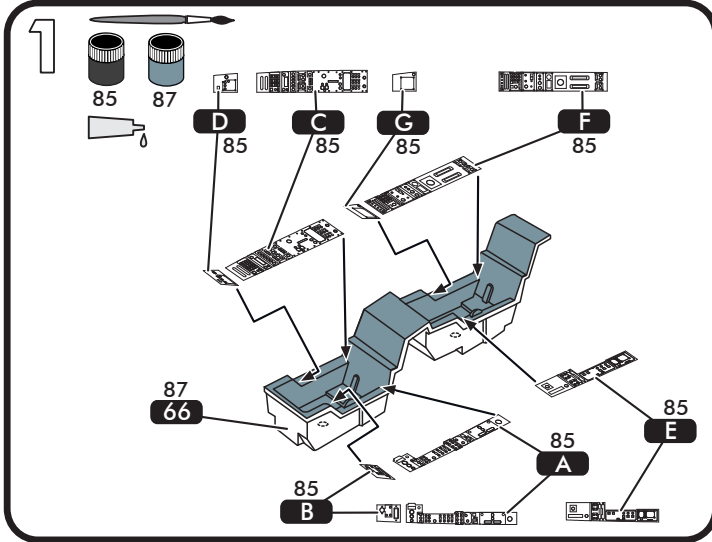

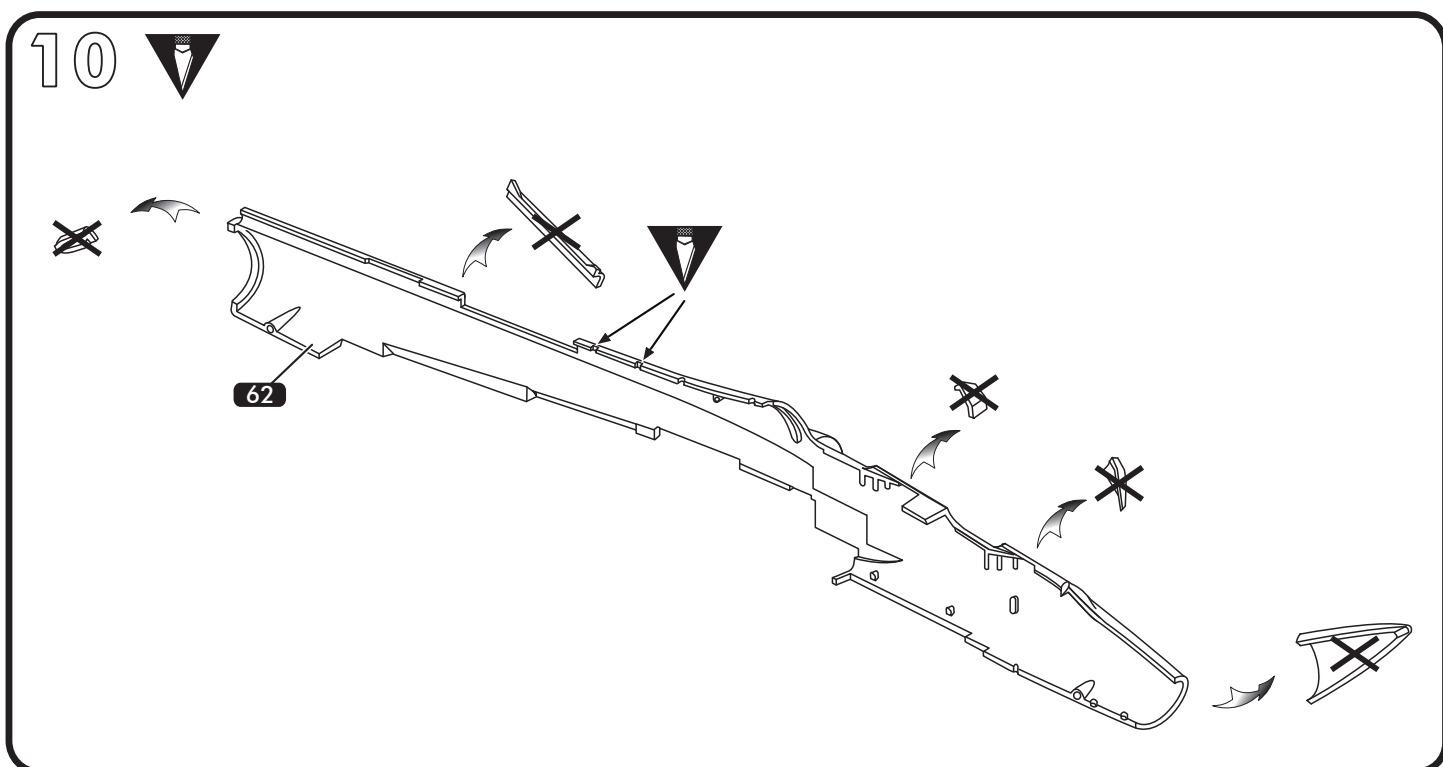
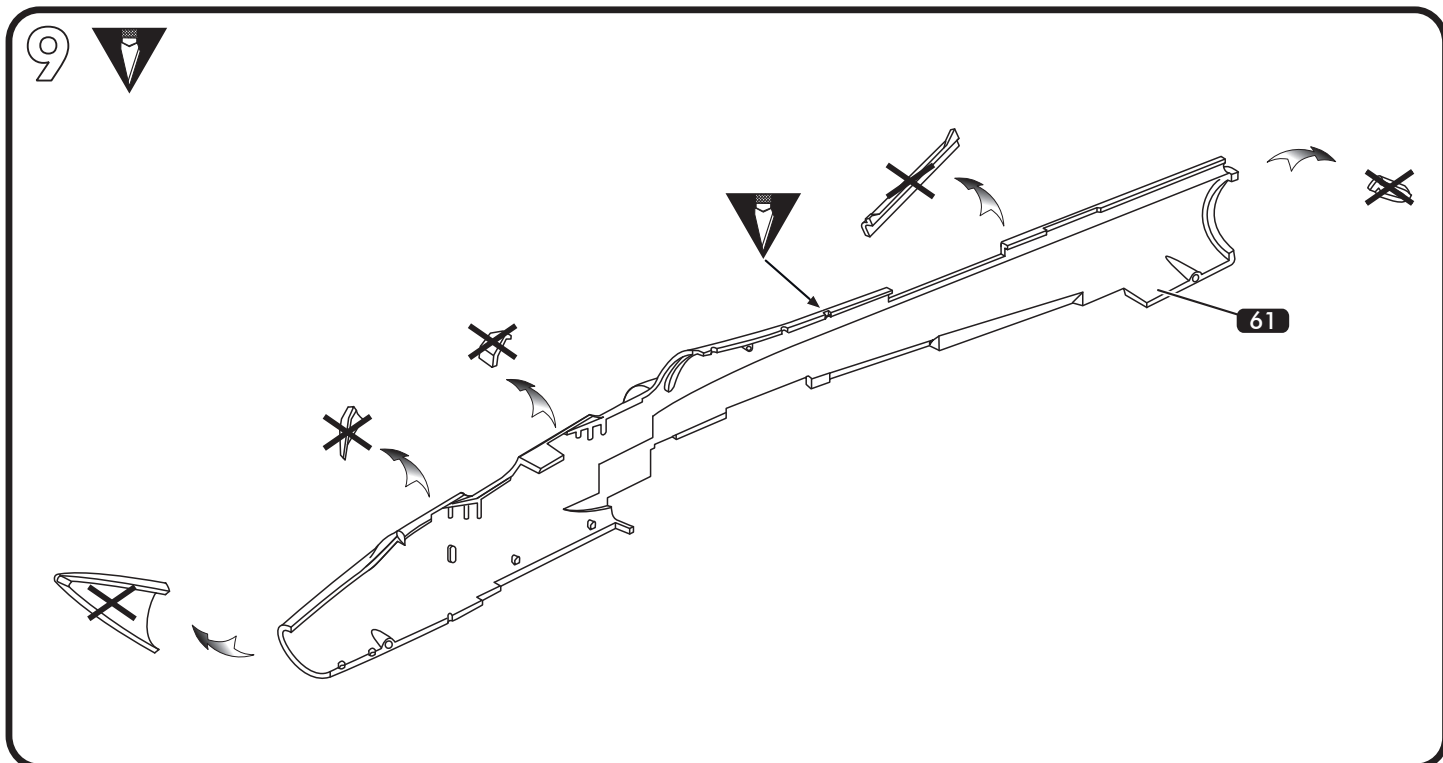
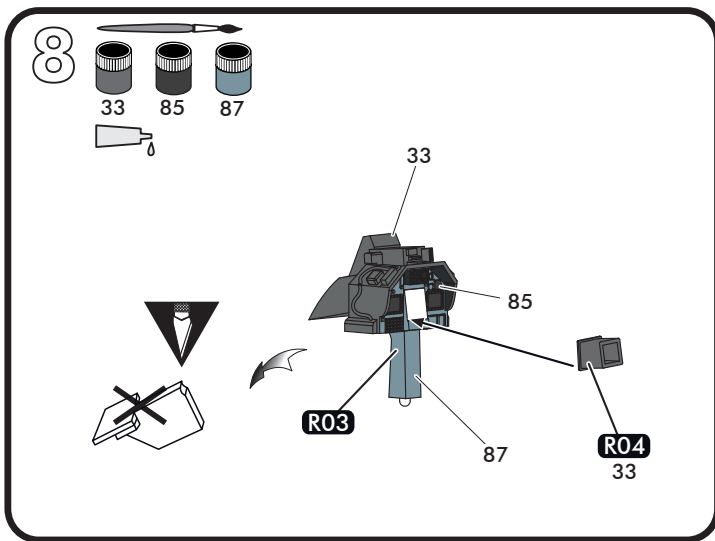
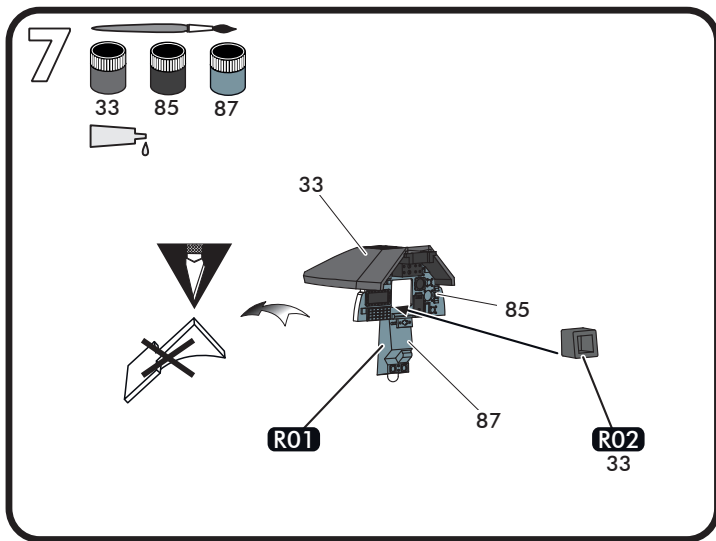

11

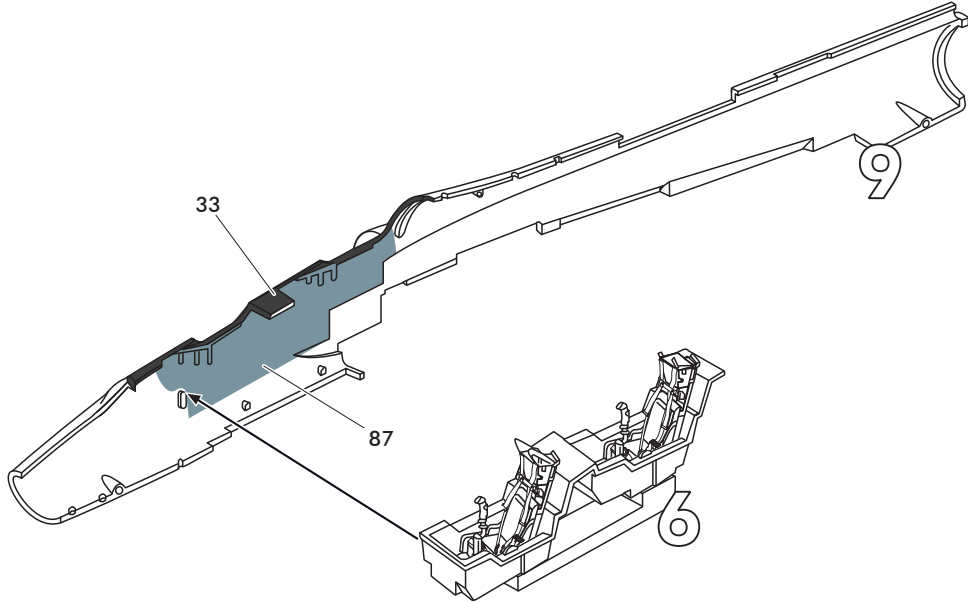
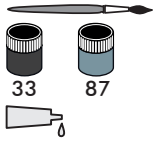

12

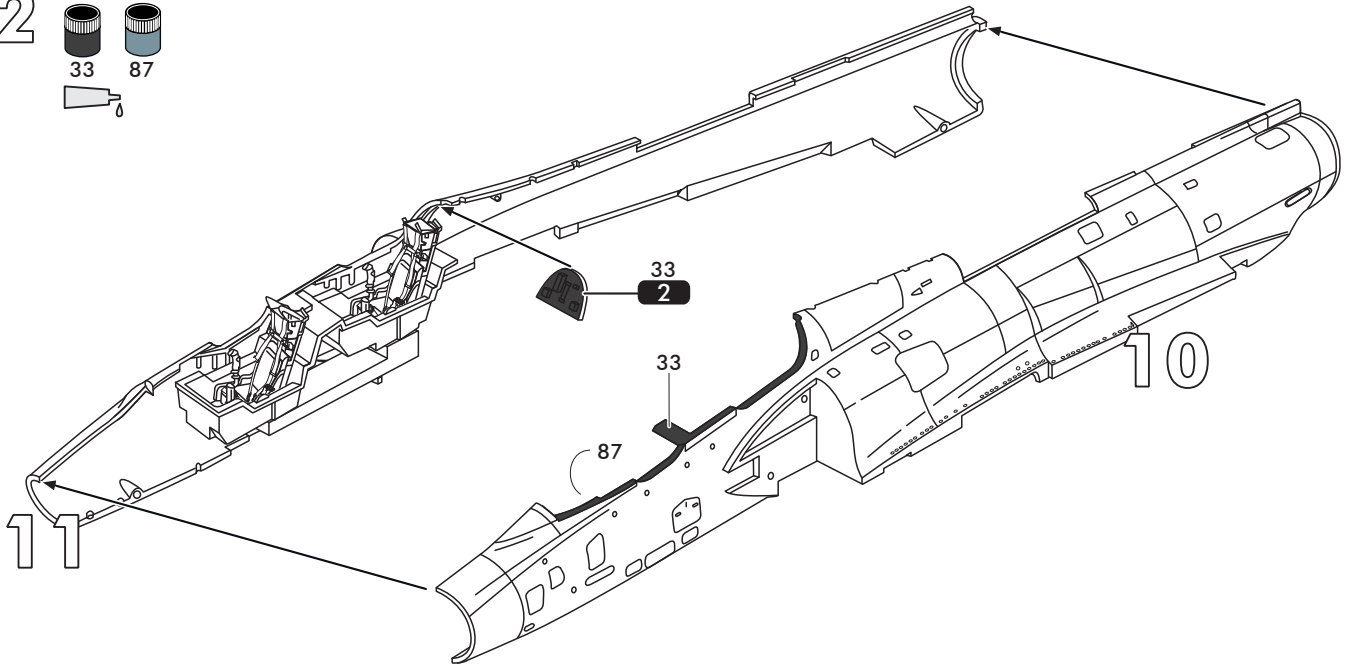
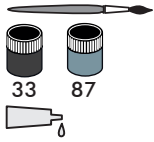

13

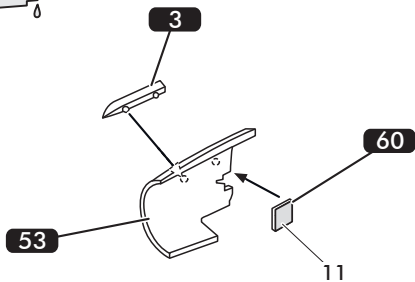
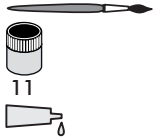

14

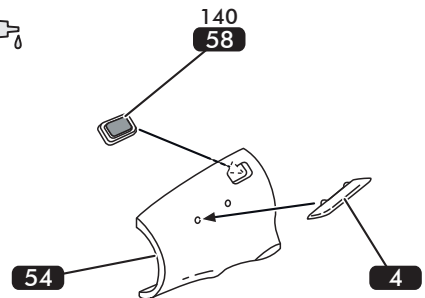
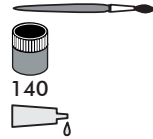

15

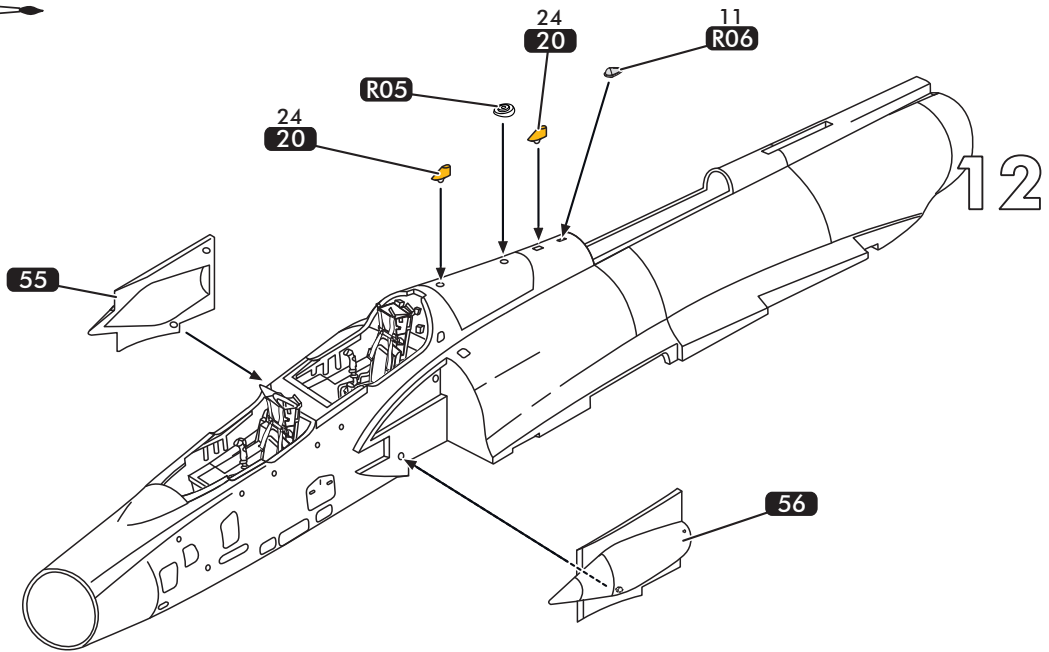
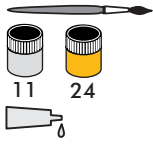

16

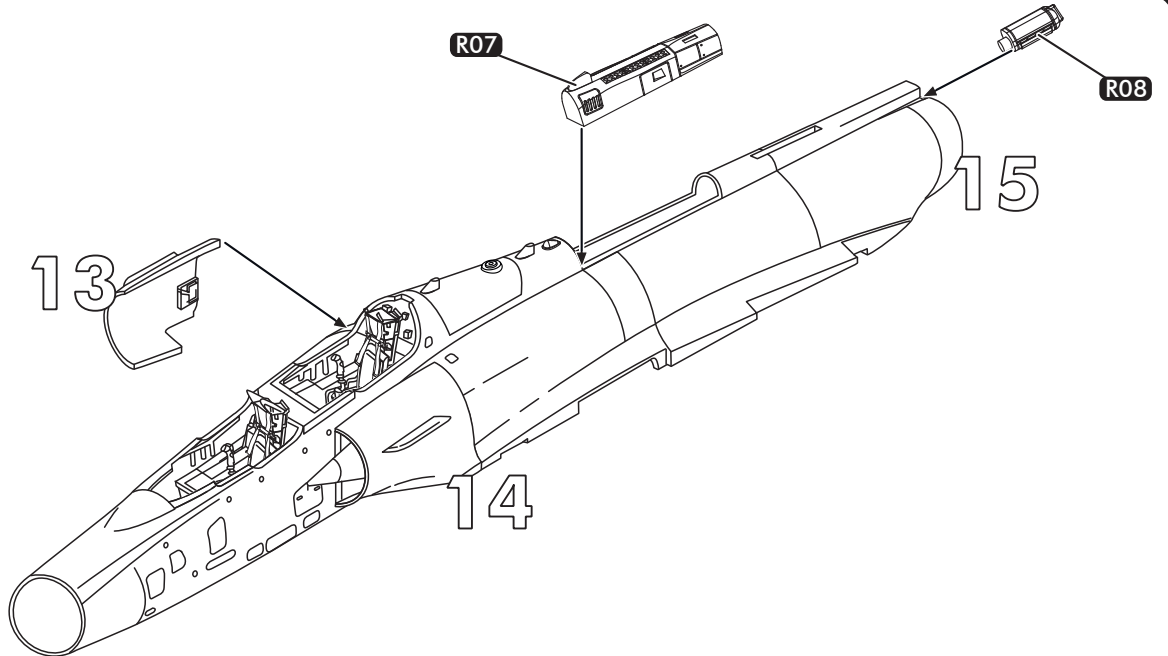

17

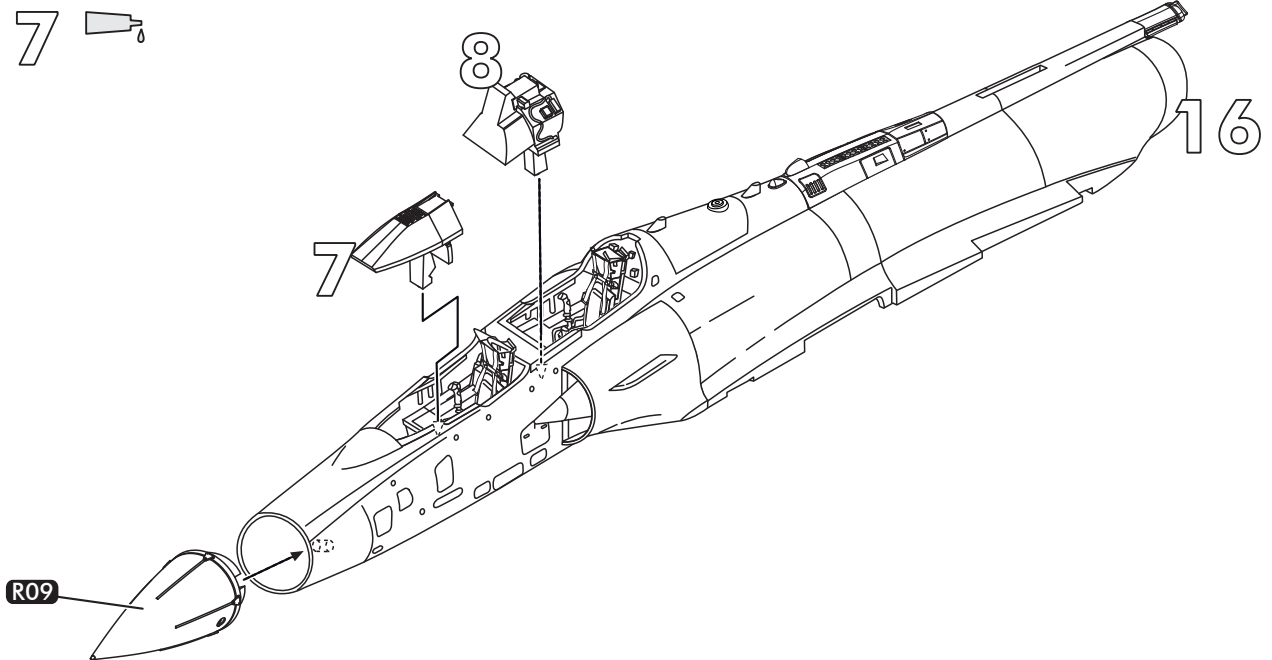

18

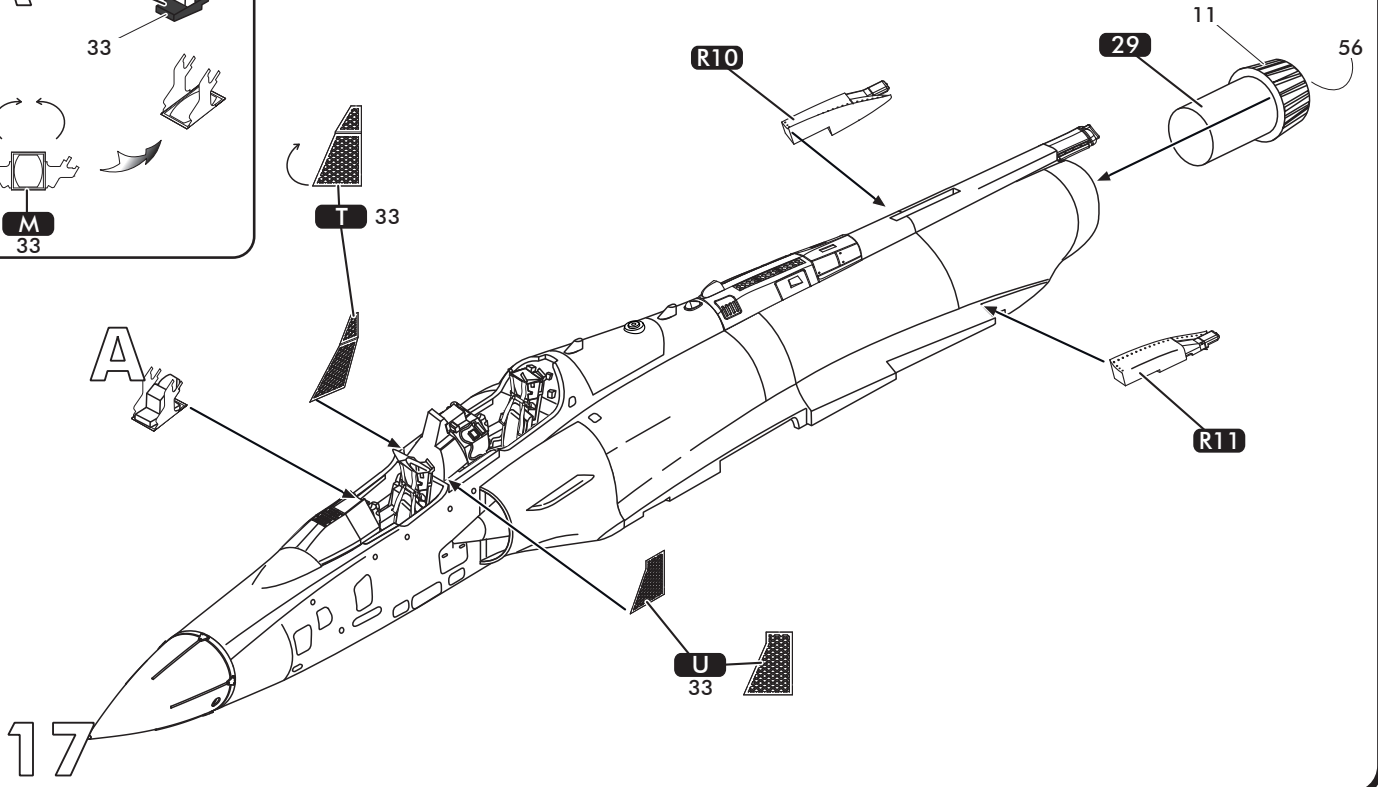
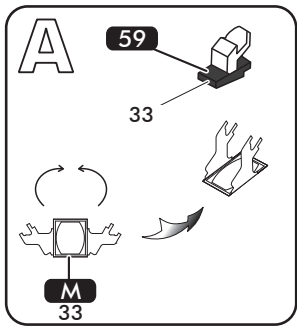
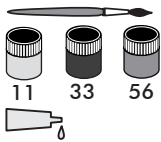

19

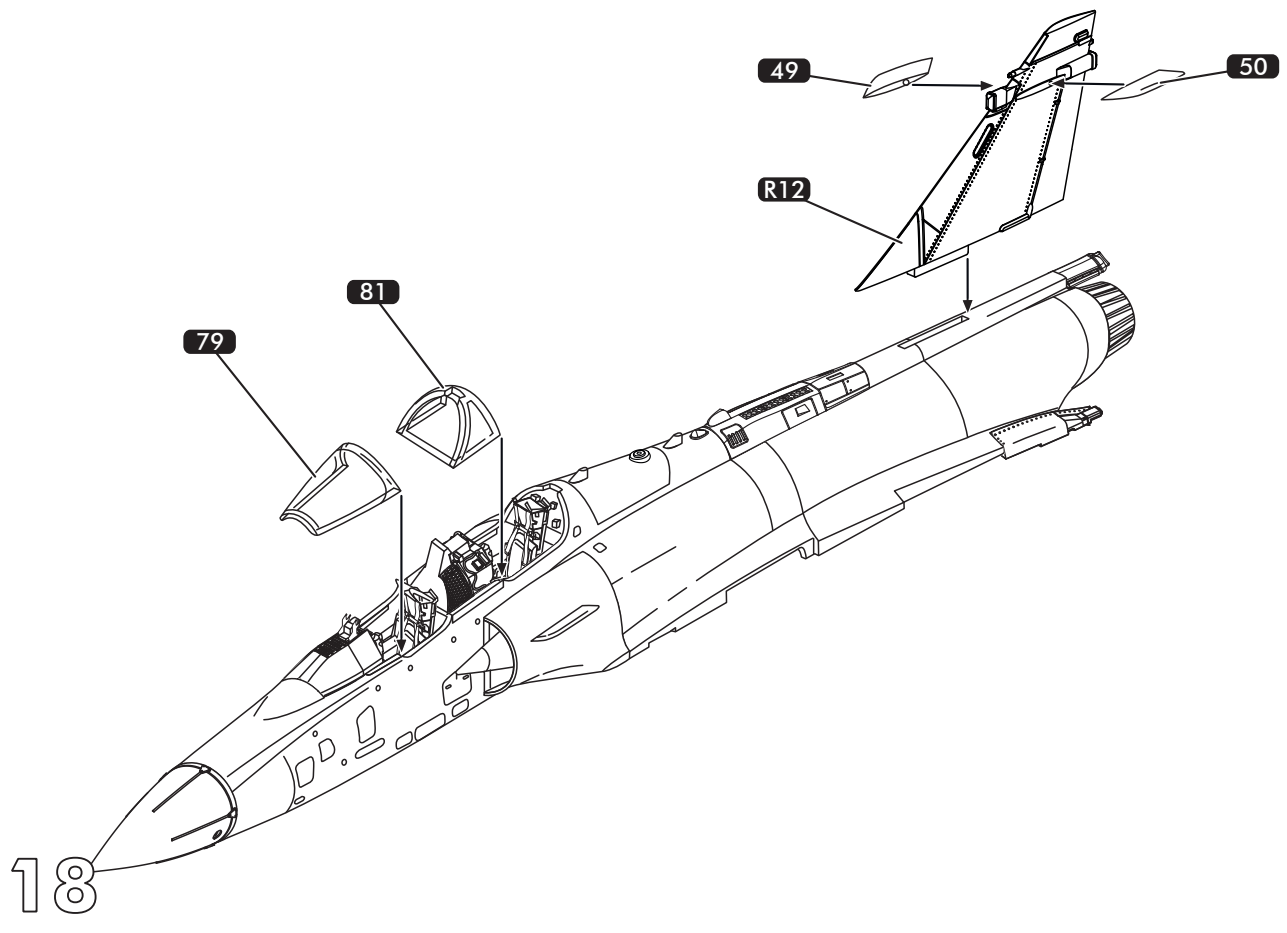

20

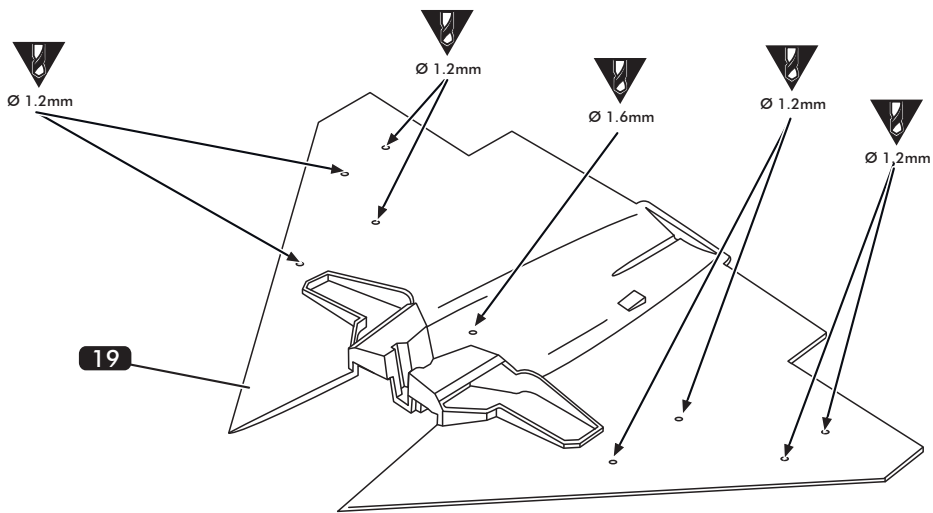

21

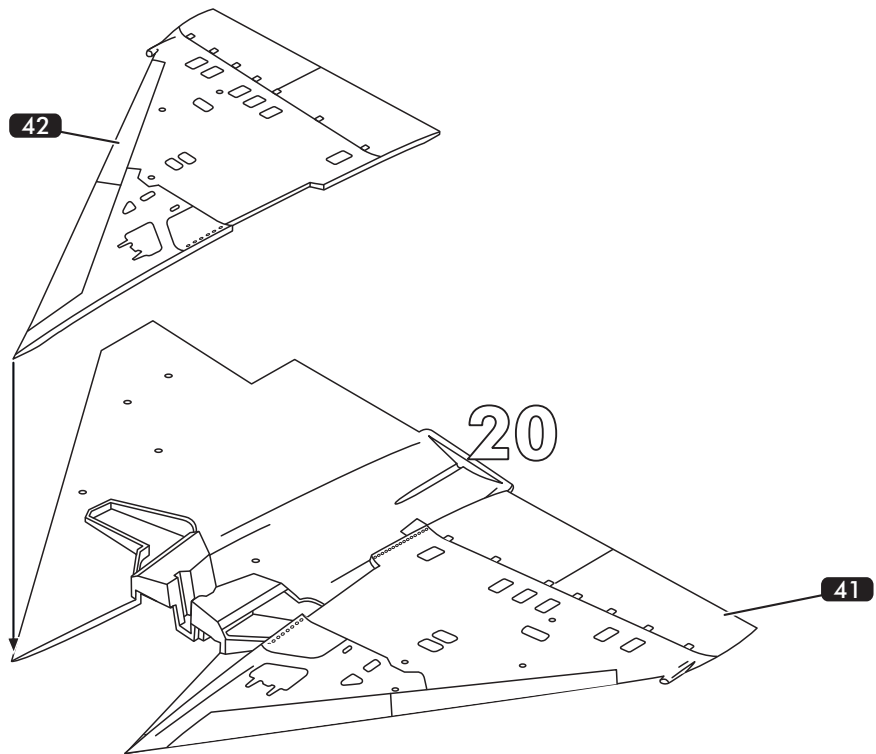

22

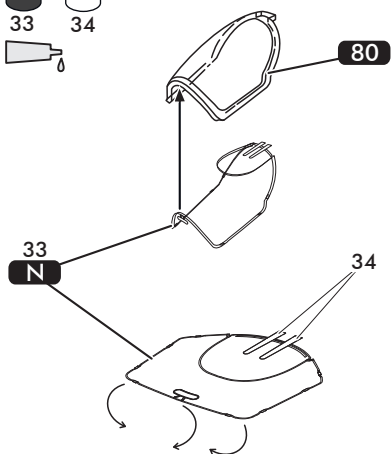
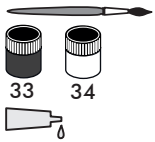

23

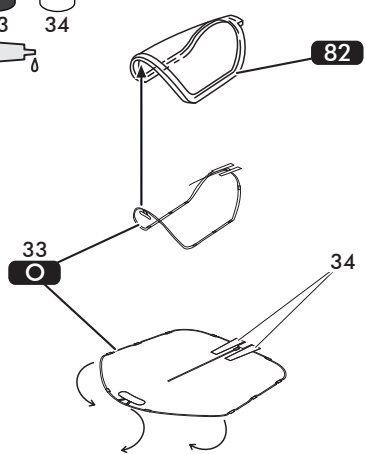
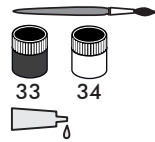

24



19



Ø 1.6mm

70

21

25

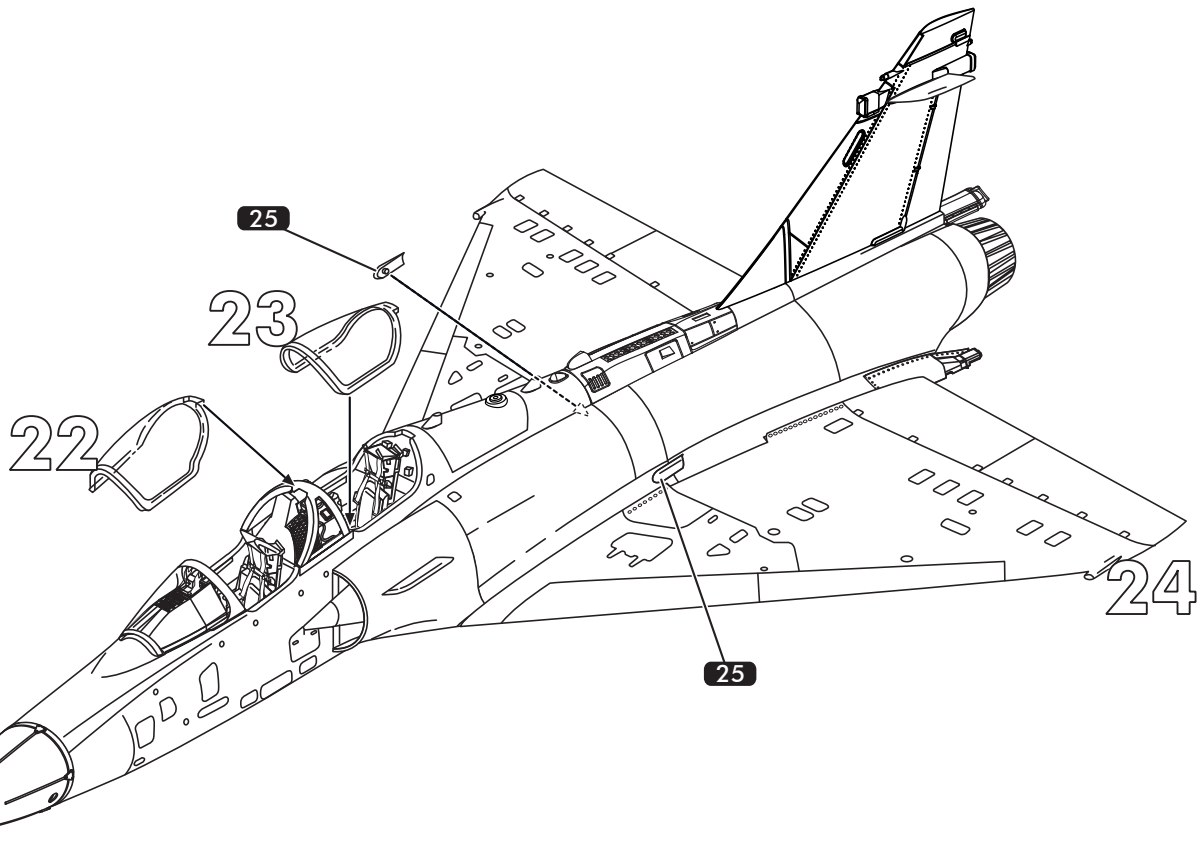

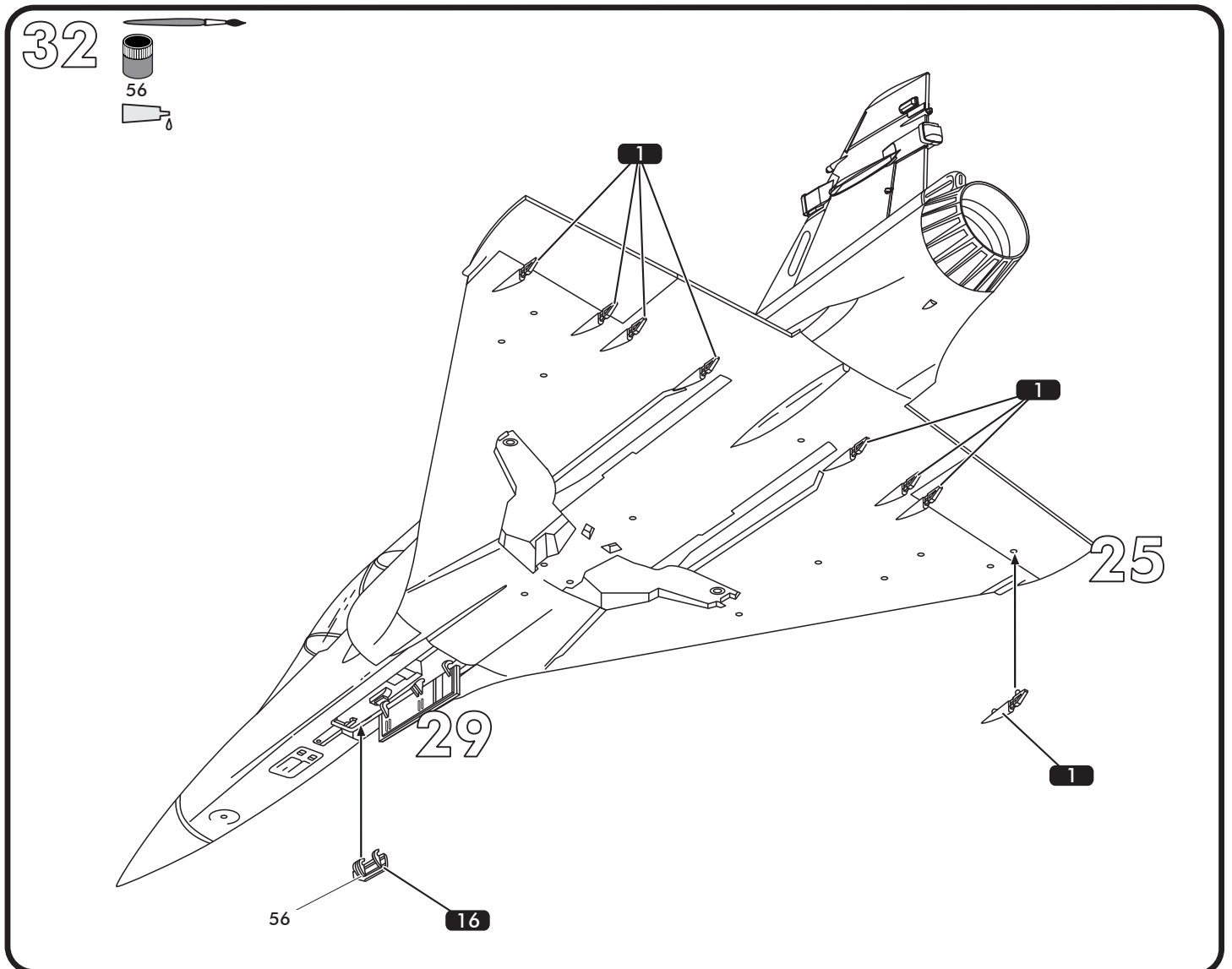
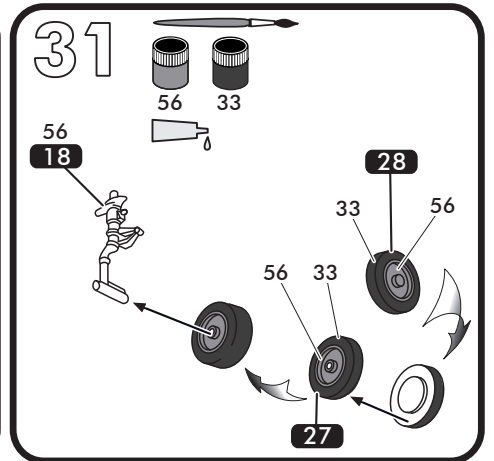
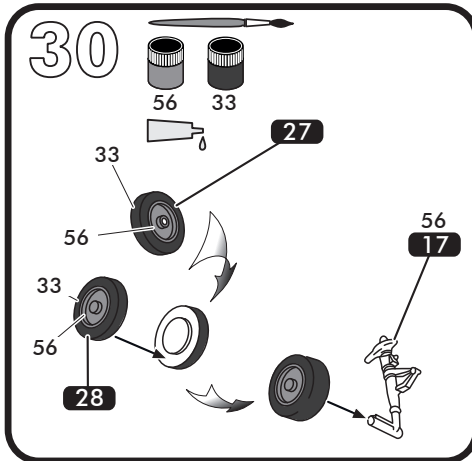
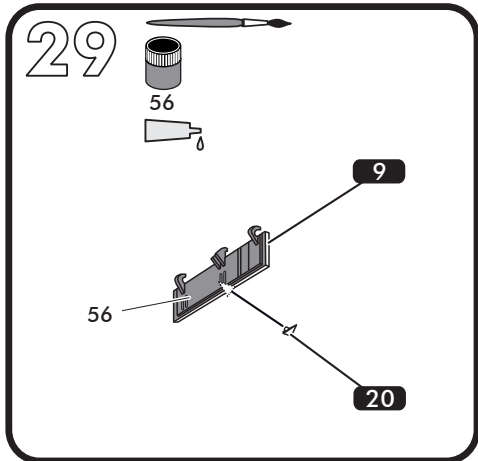
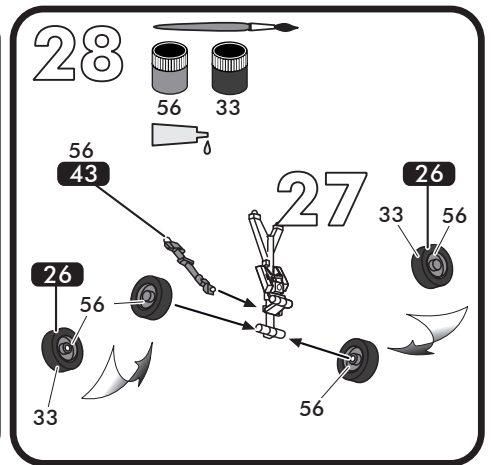
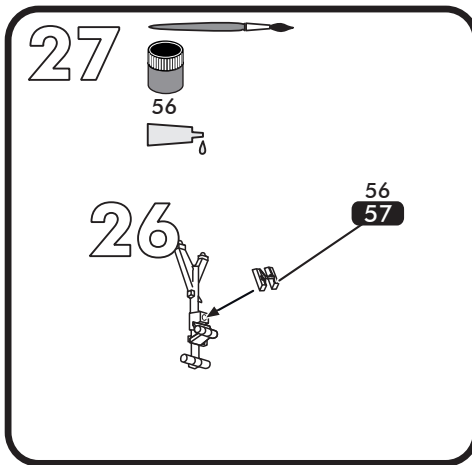
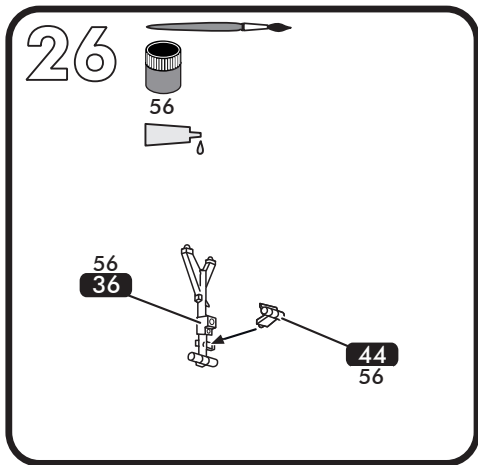

33

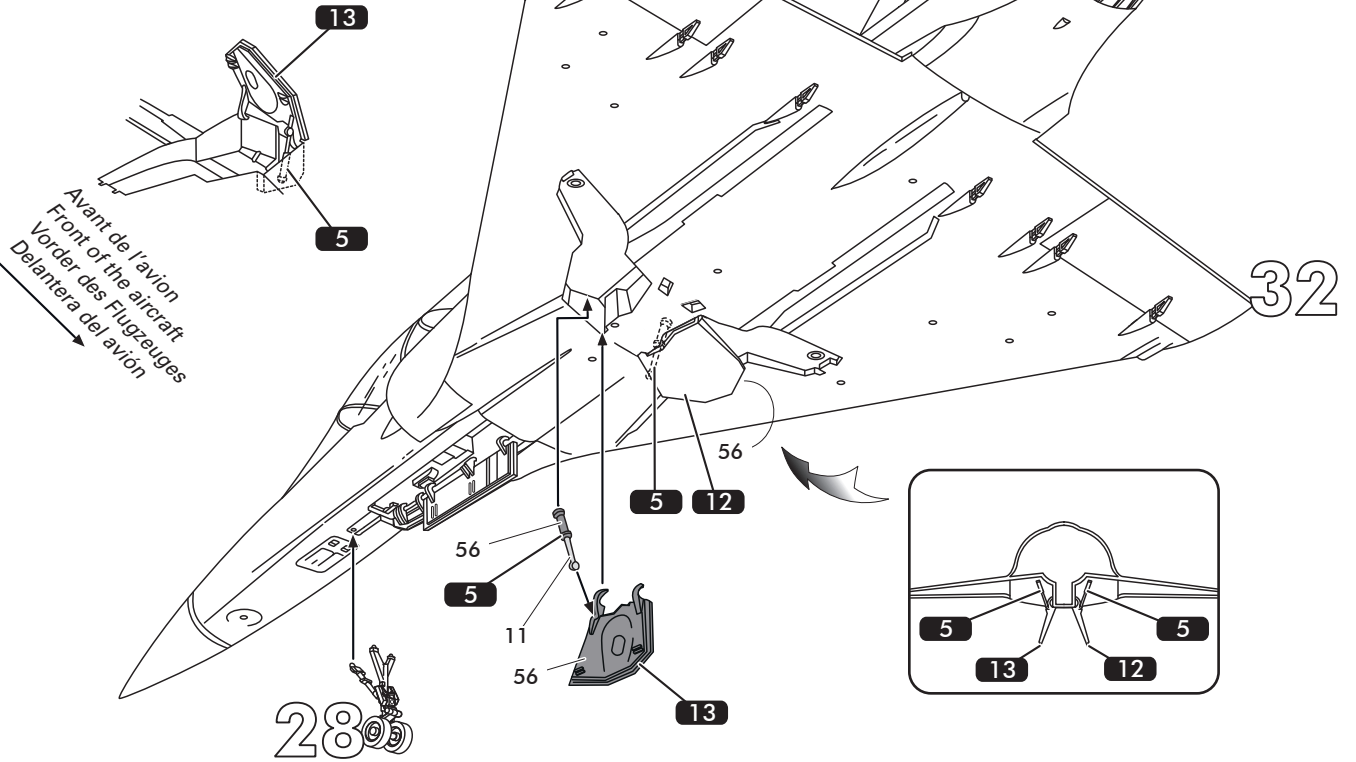
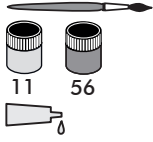



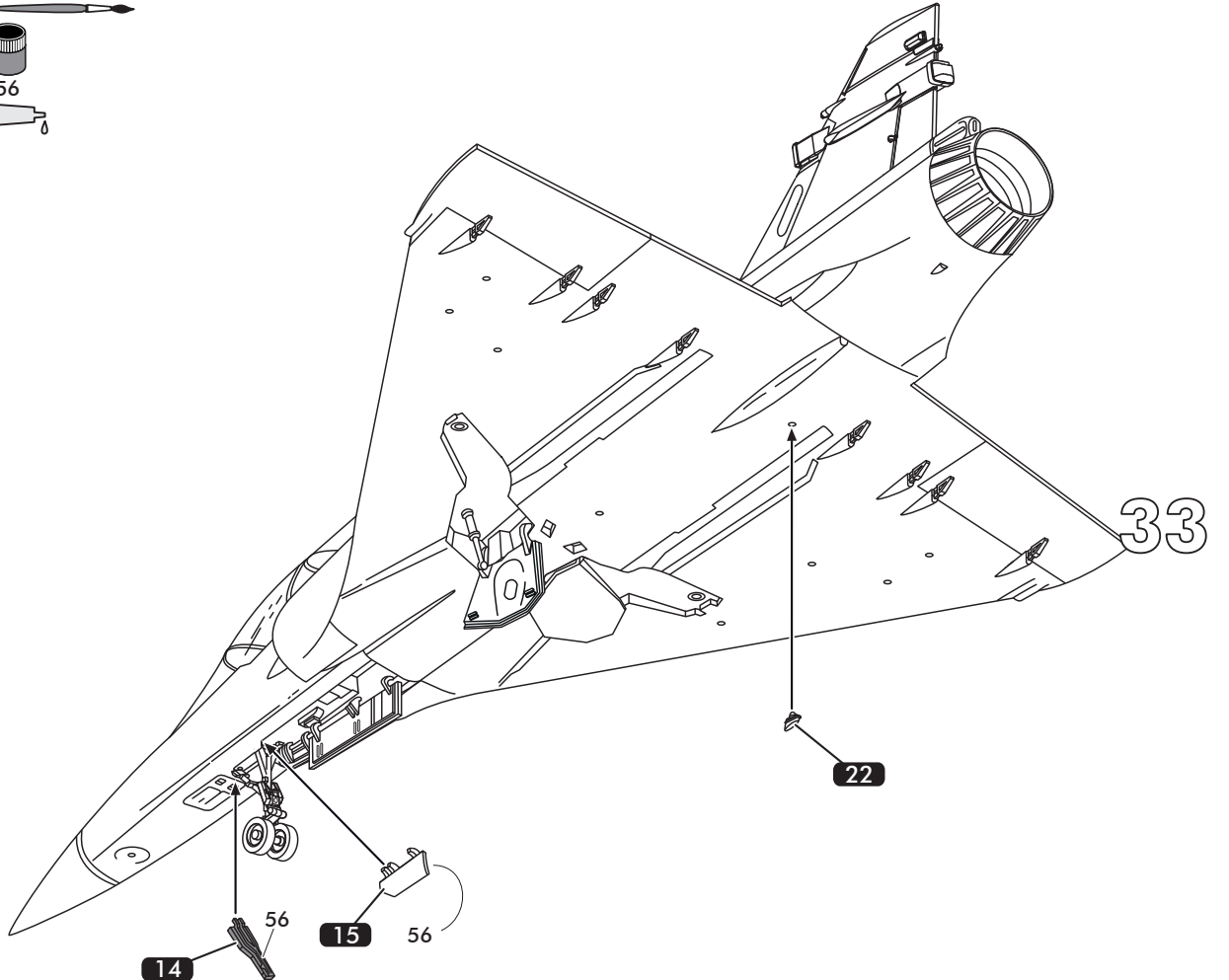
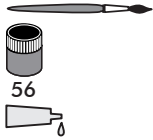

34

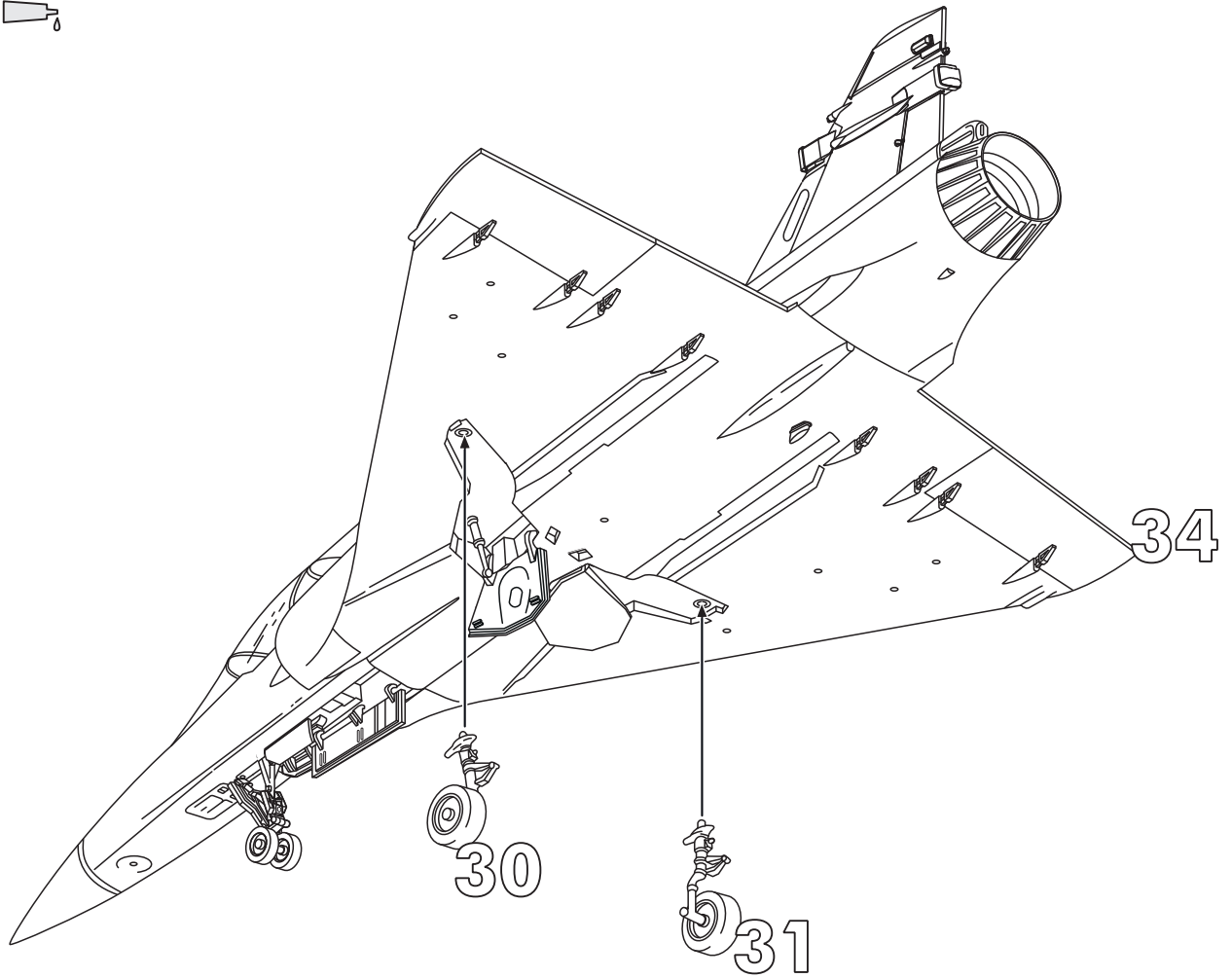

35 



36 
 11  56

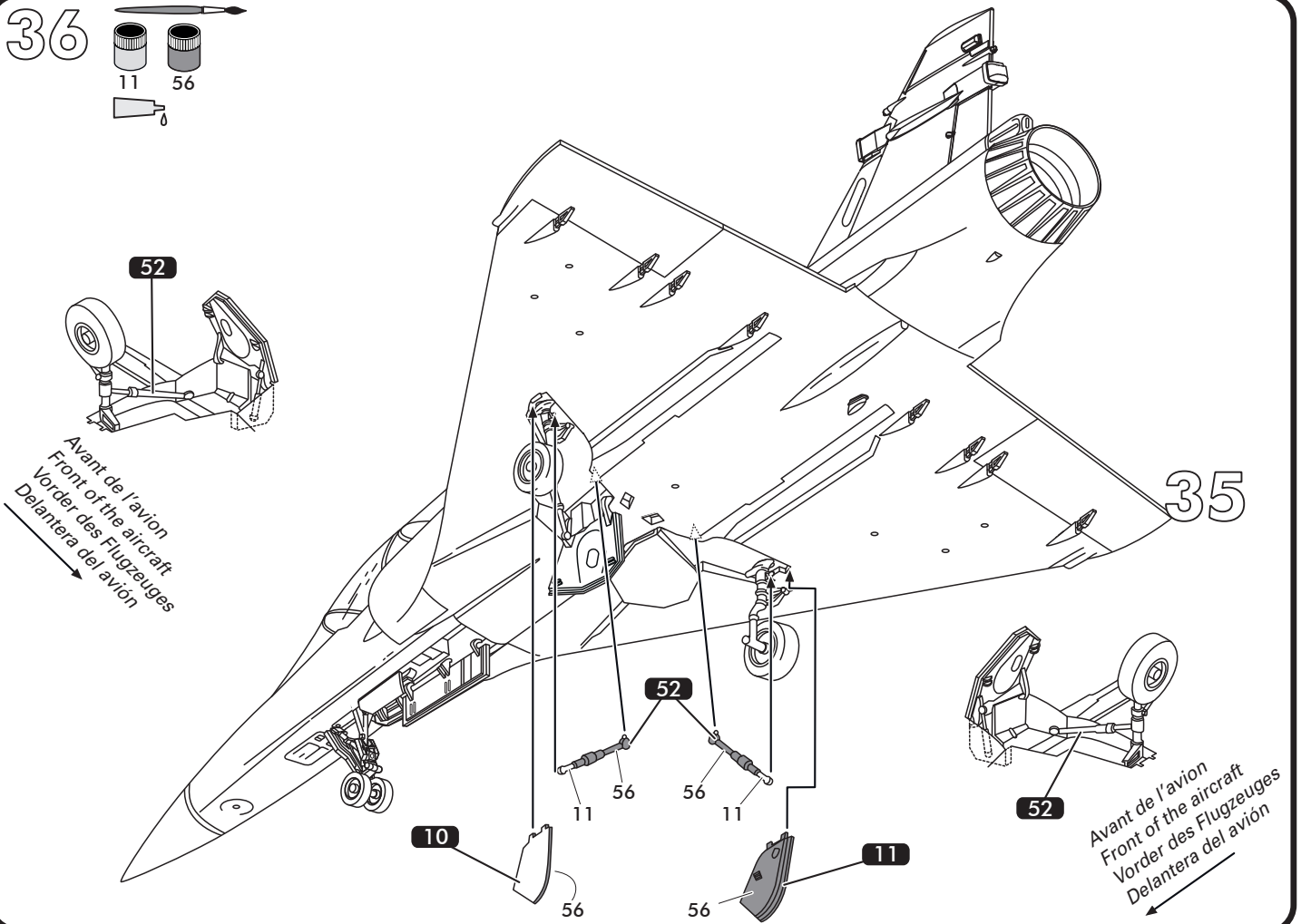

37 

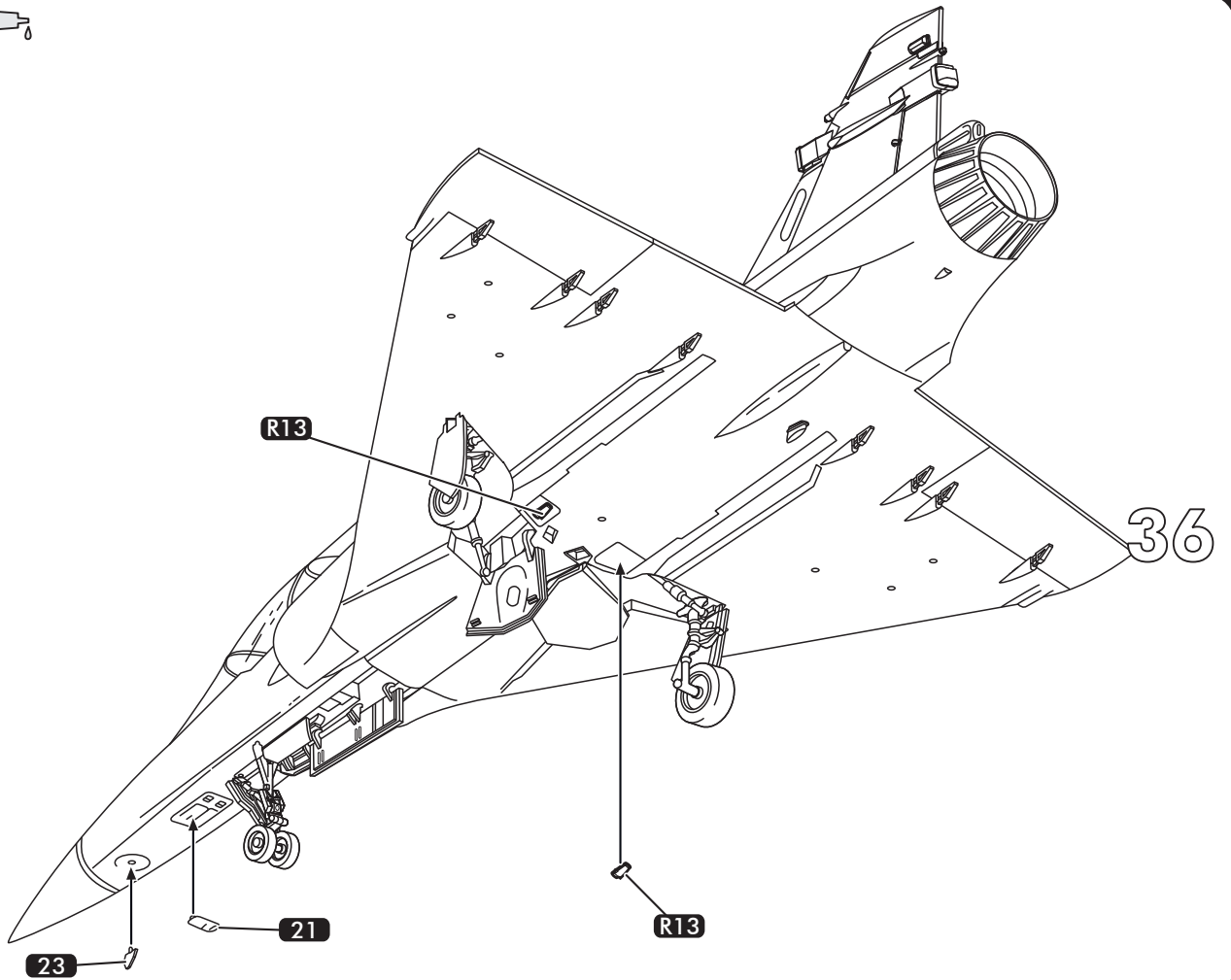



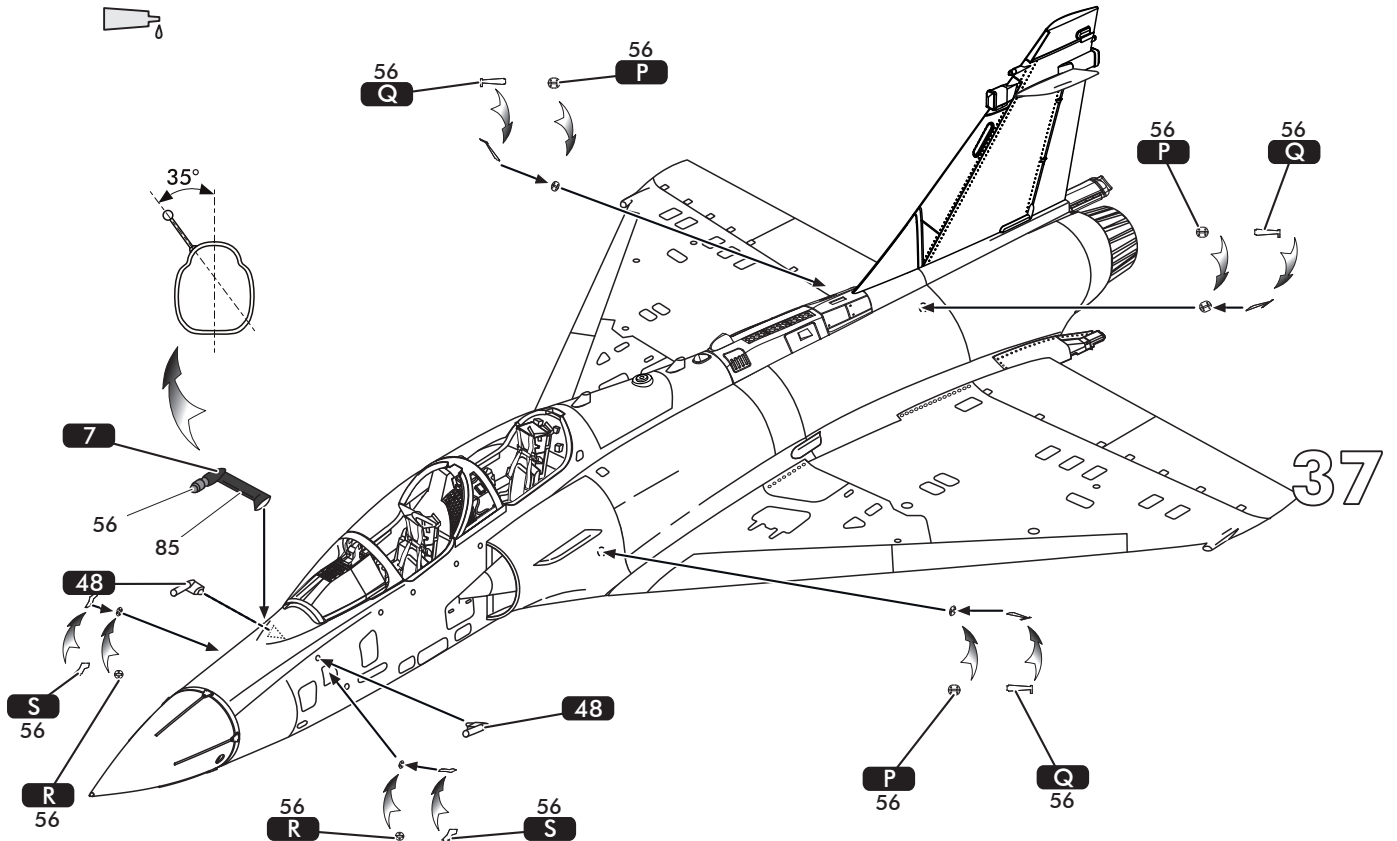
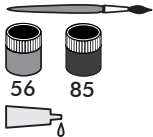

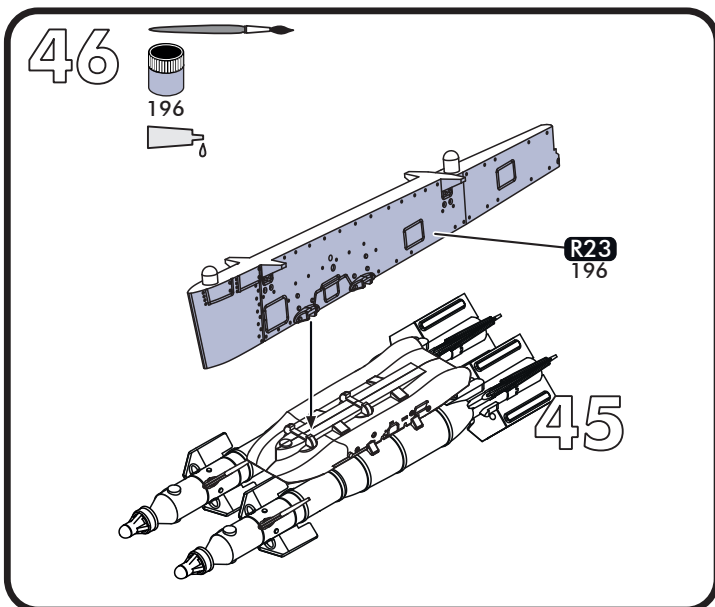
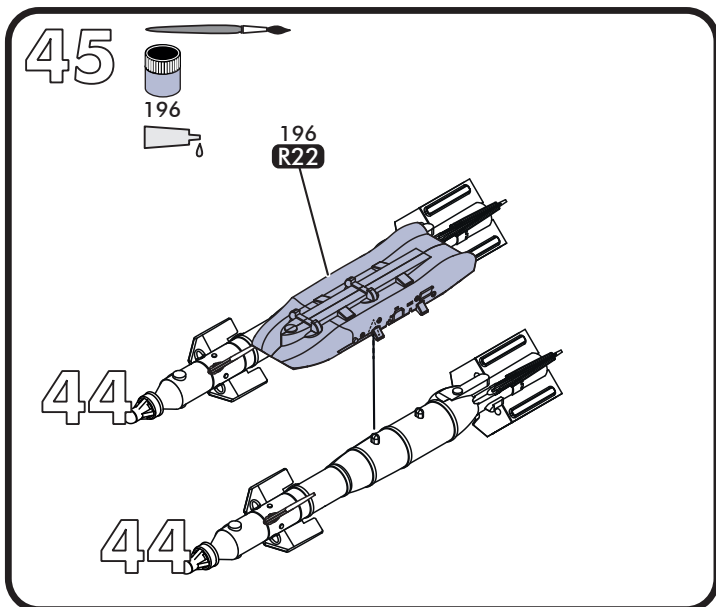
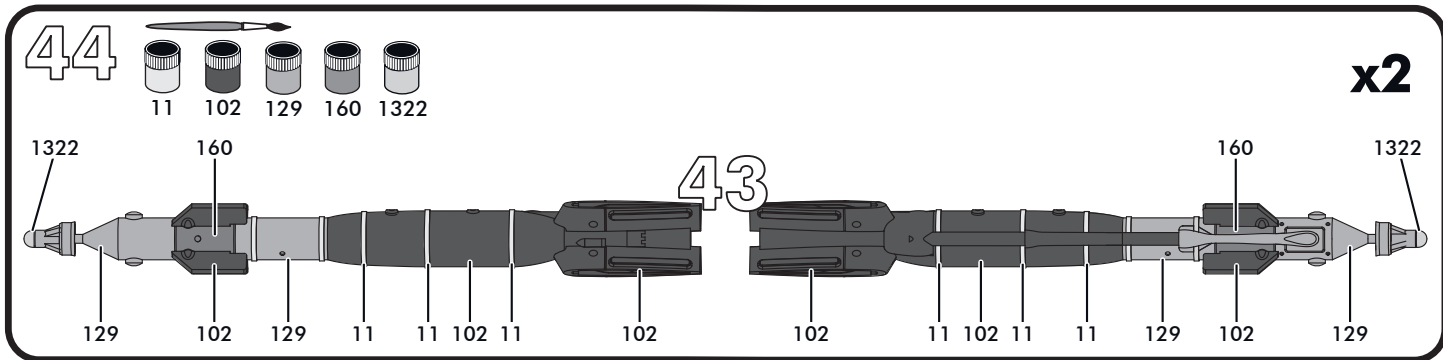
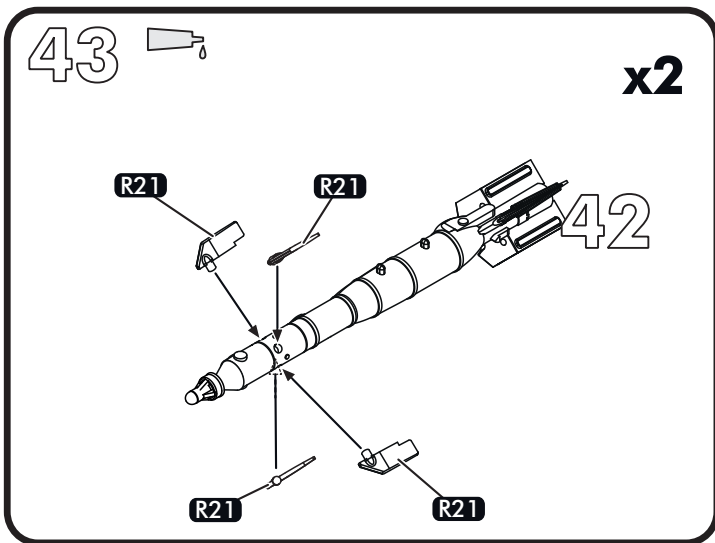
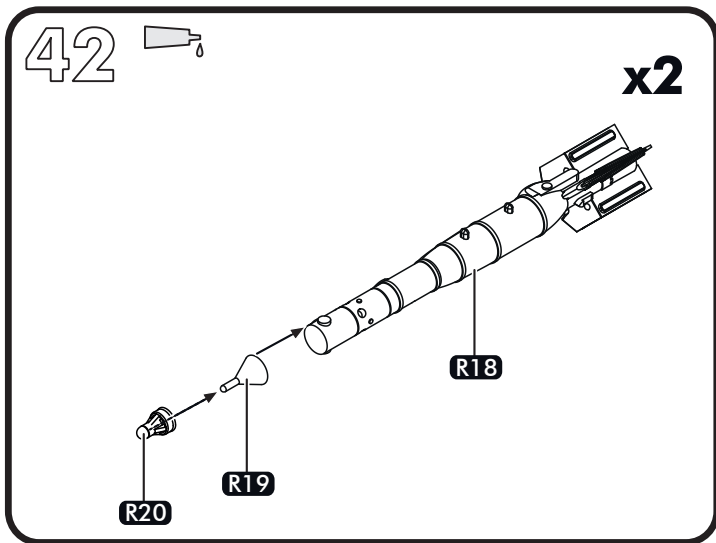
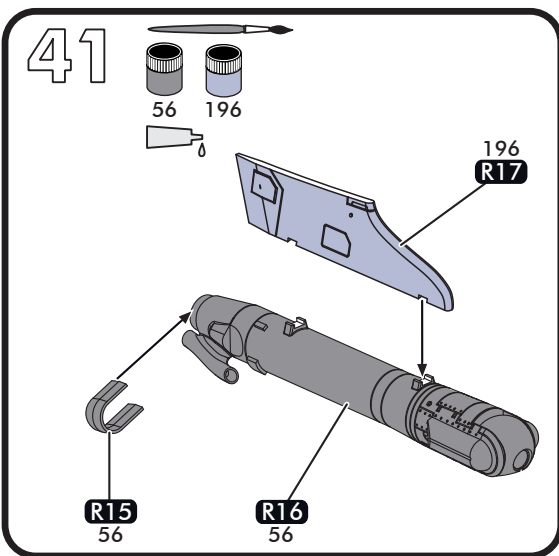
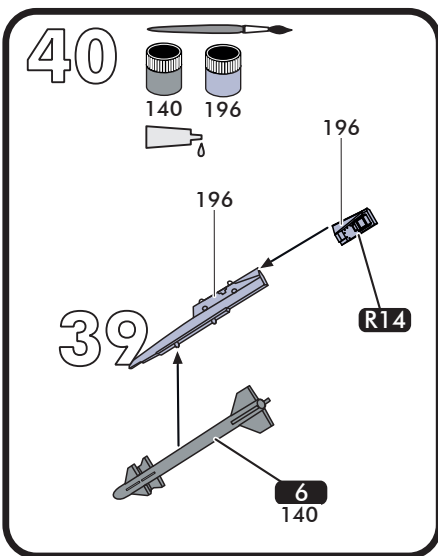
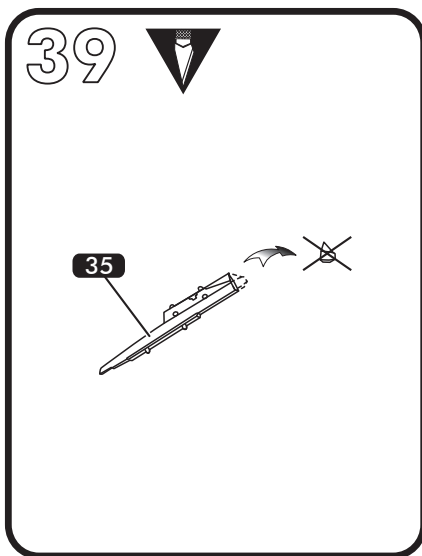
38



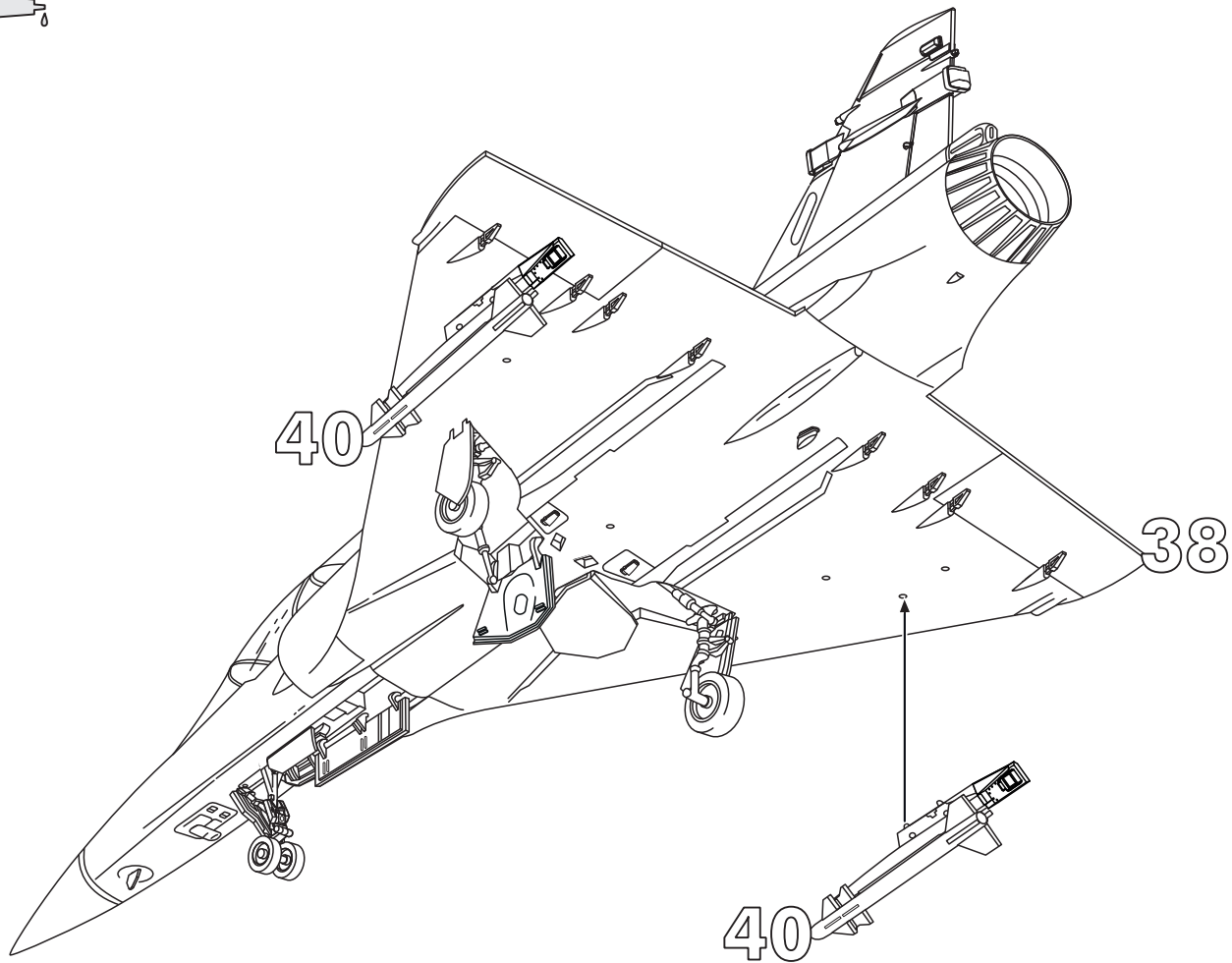

47 



48 
 
 116 140

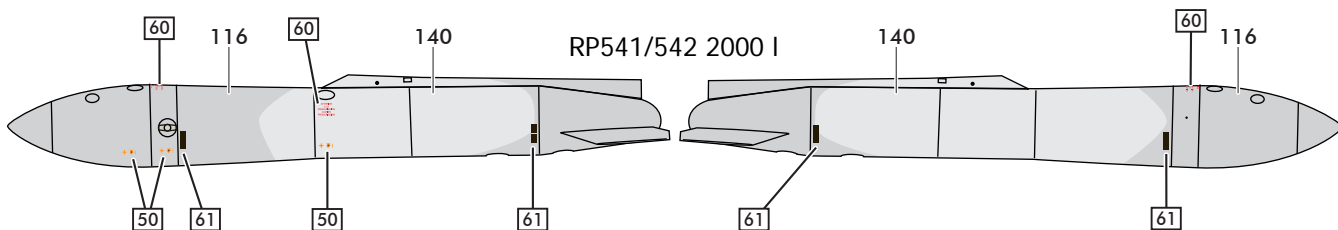
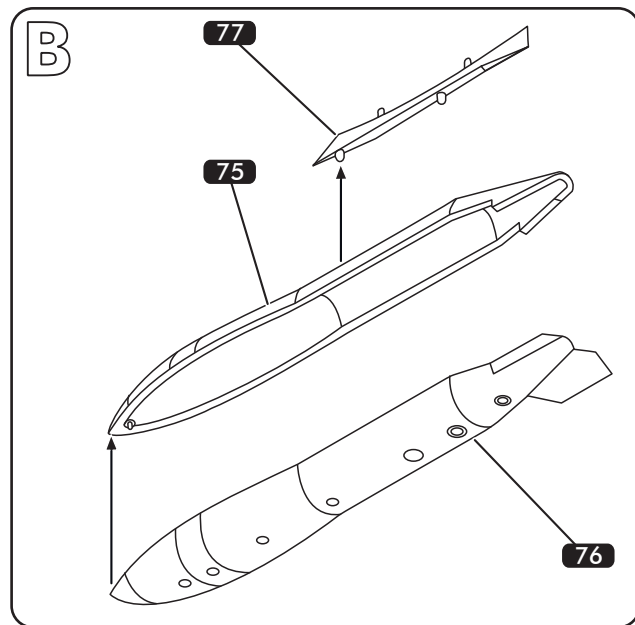
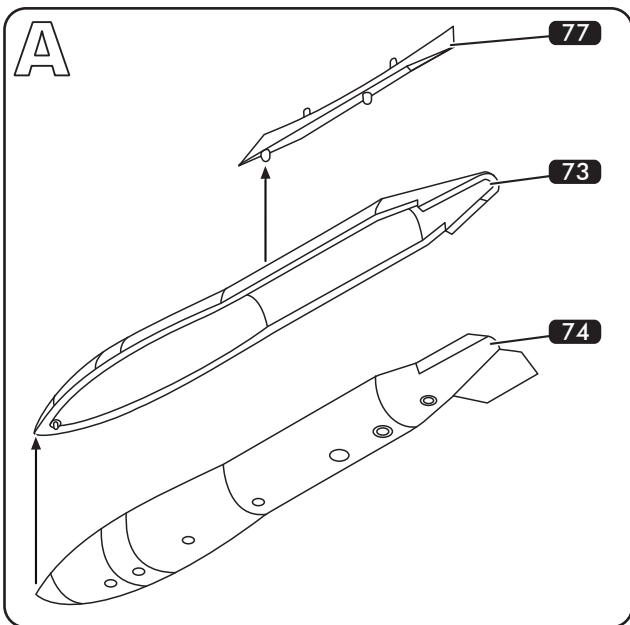

49 

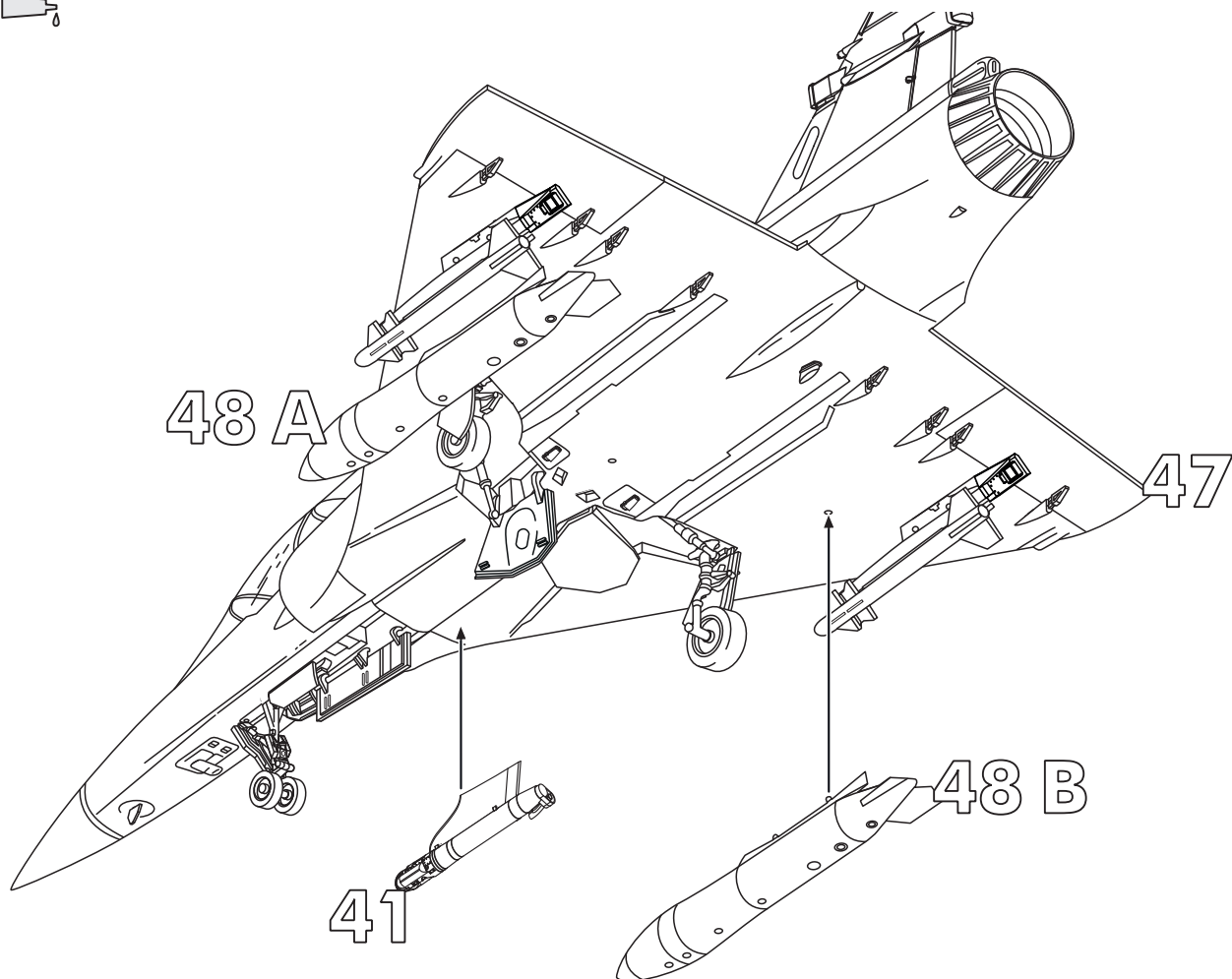

50 

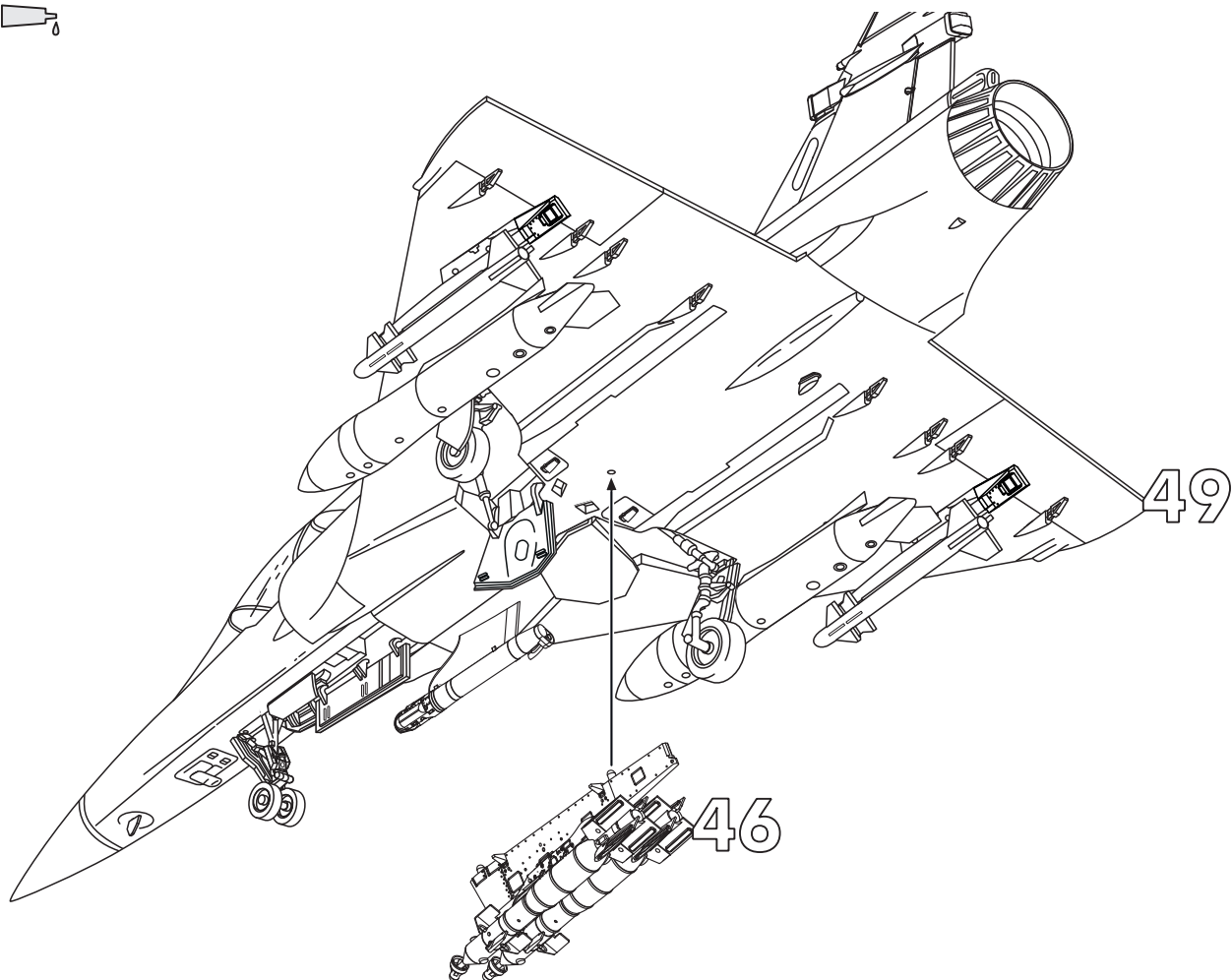

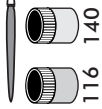

DASSAULT AVIATION MIRAGE 2000D

n°666, 3-IQ / n° de série 540, SPA 62, EC 01-003 "Navarre", au-dessus de l'Afghanistan, décembre 2008.

- * Couper à la longueur convenable
- * May require cutting to length
- * Auf die angemessene Länge kürzen
- * Cortar a la longitud adecuada

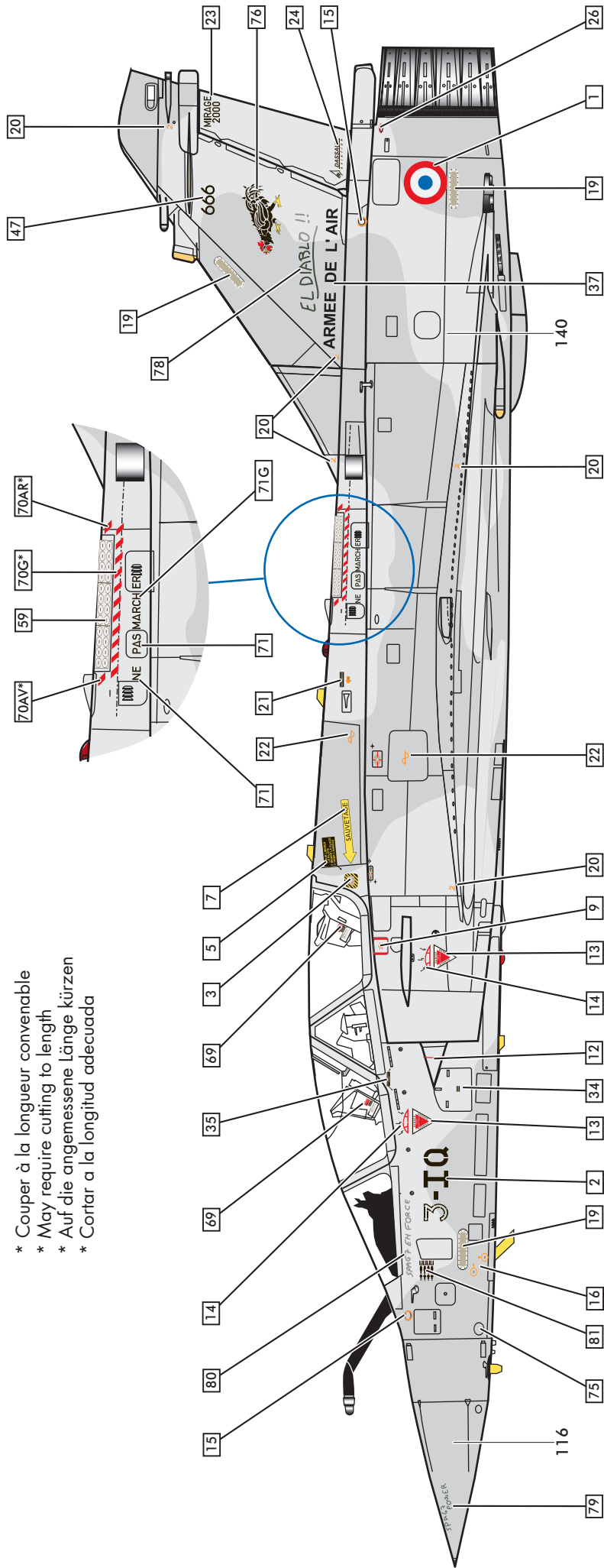

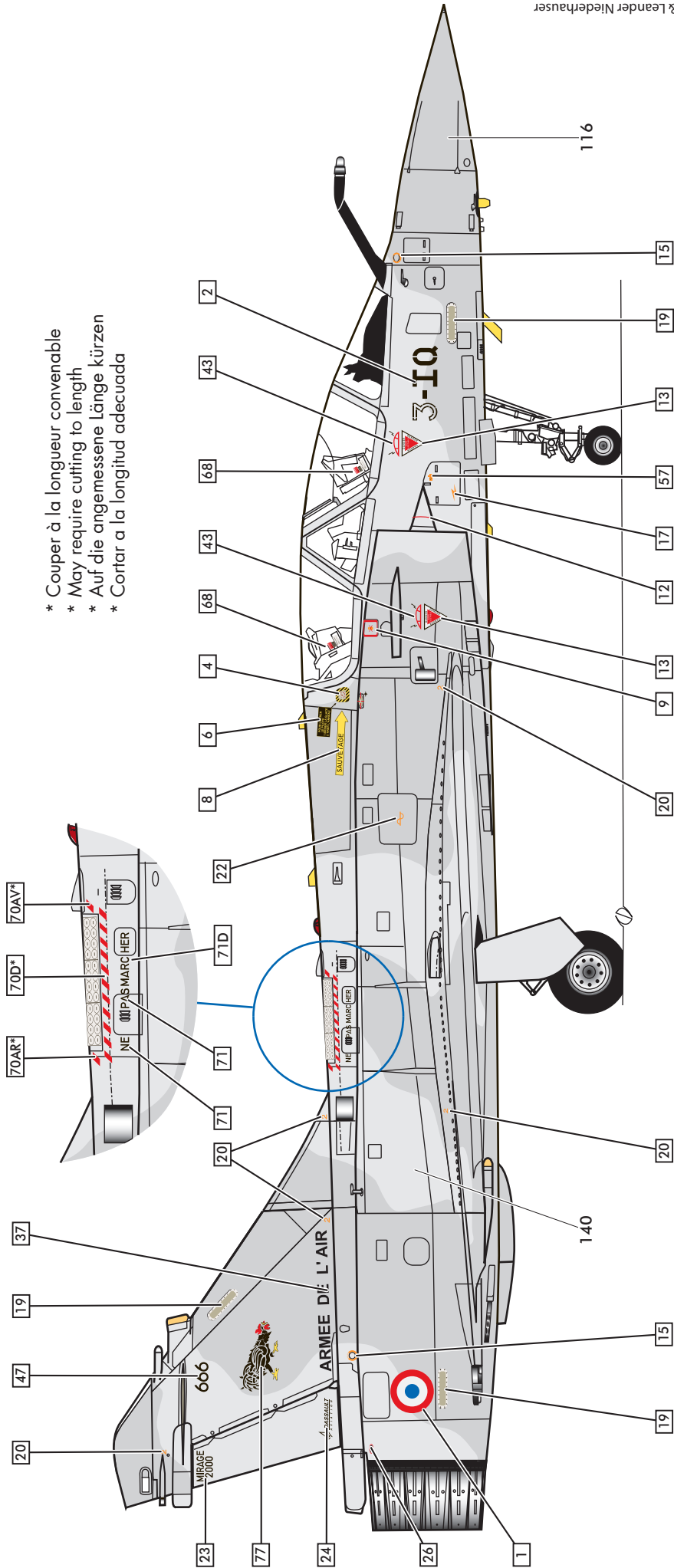
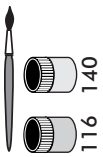

- * Couper à la longueur convenable
- * May require cutting to length
- * Auf die angemessene Länge kürzen
- * Cortar a la longitud adecuada

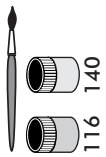

53

* Couper à la longueur convenable
 * May require cutting to length
 * Auf die angemessene Länge kürzen
 * Cortar a la longitud adecuada

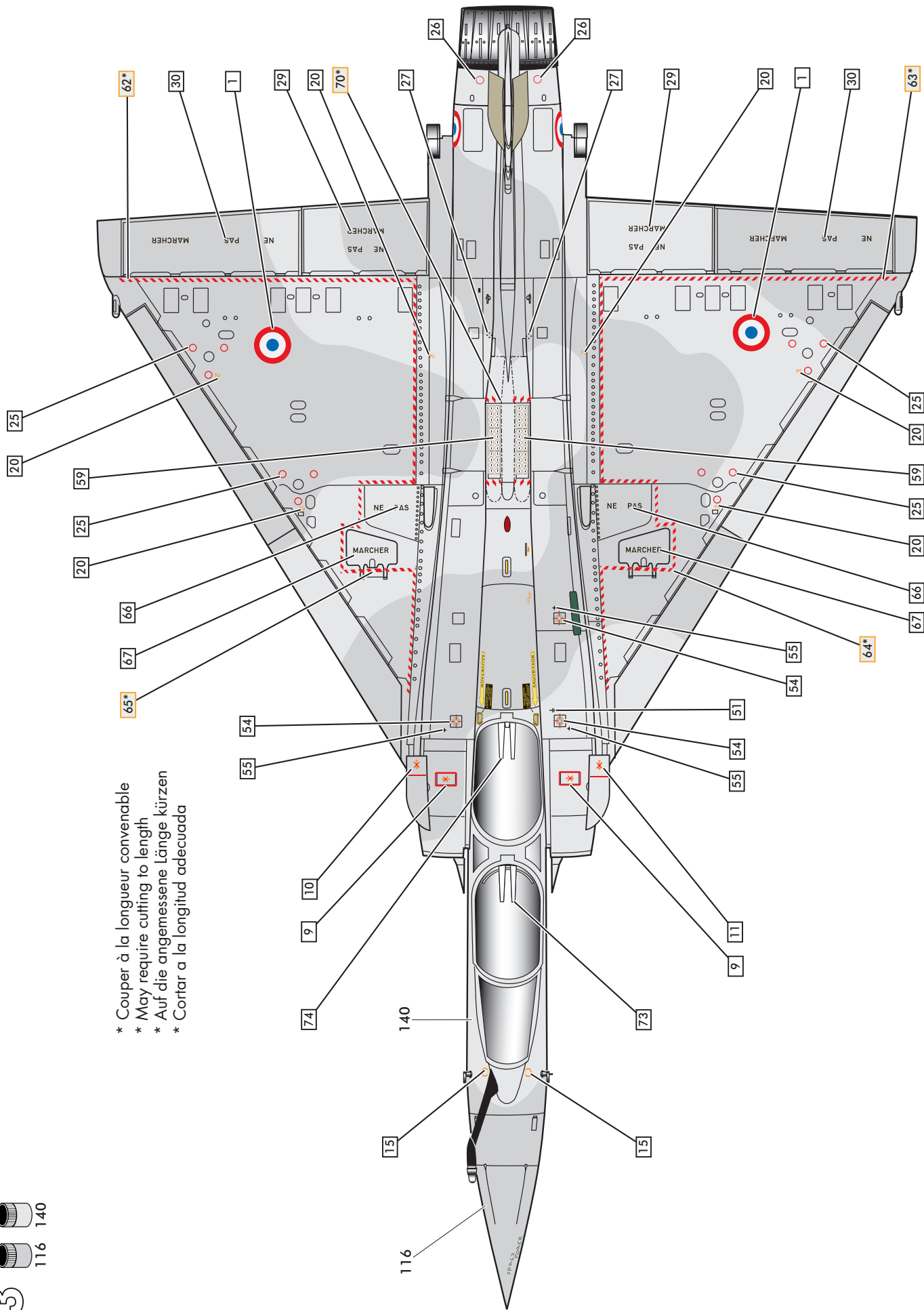

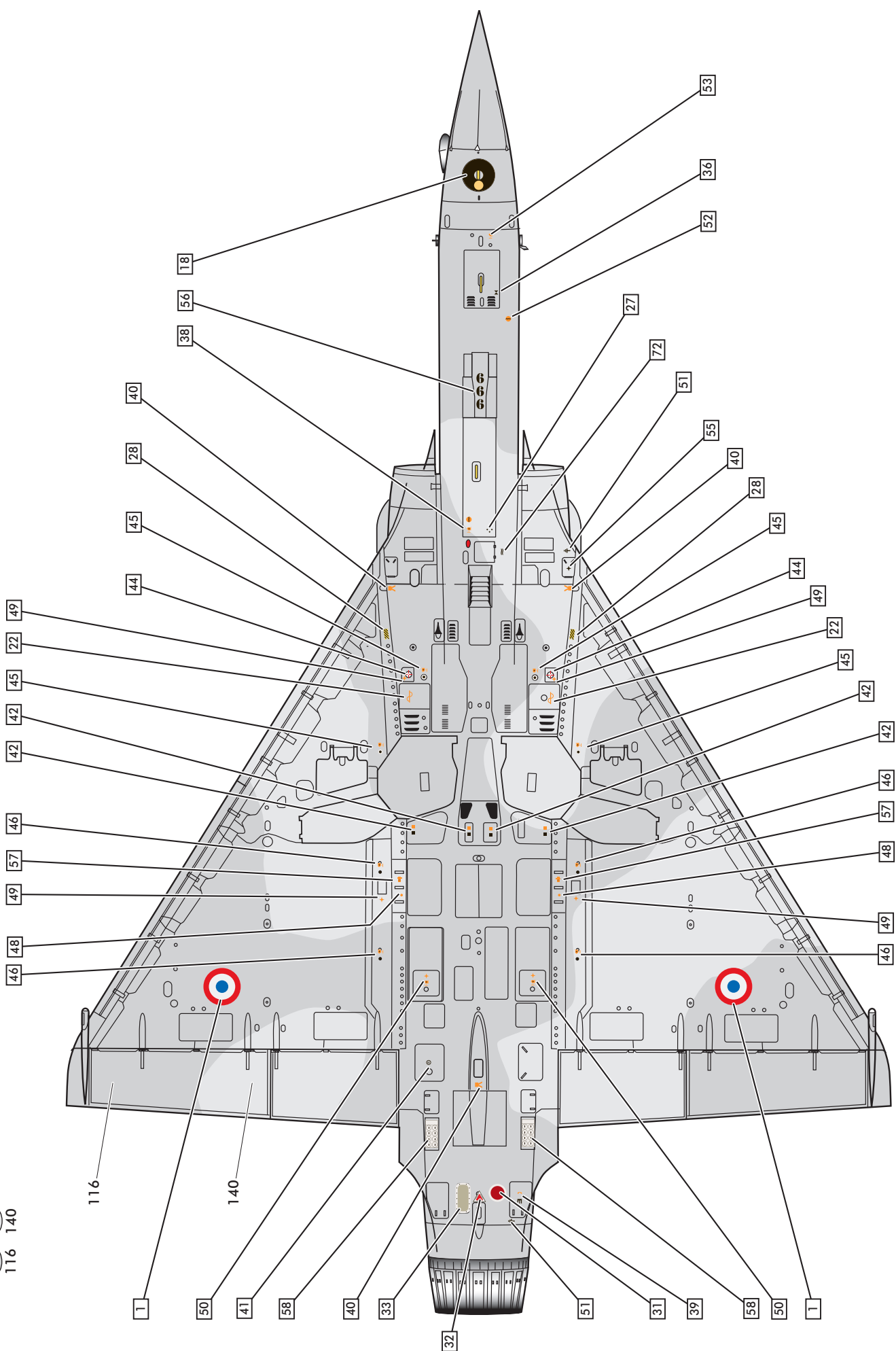
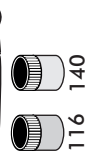

SERVICE CONSOMMATEURS 



+33 (0)2 33 67 72 64



+33 (0)2 33 67 72 71

www.heller.fr

HELLER JOUSTRA SA

Chemin de la Porte

61160 - TRUN

FRANCE



Fabriqué en France