

# 1/350 IJN Battleship Yamato Advanced Version

## CNC Scribed Brass Part:

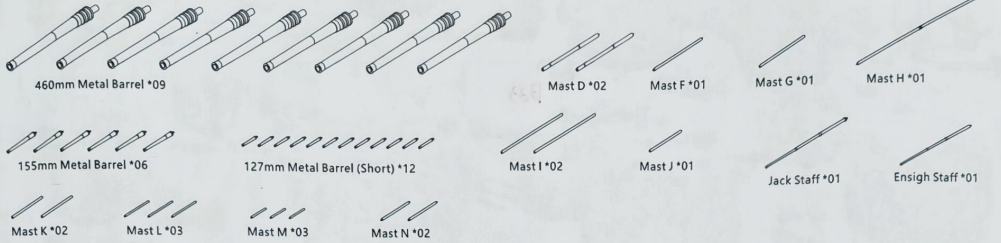

## Resin Part :

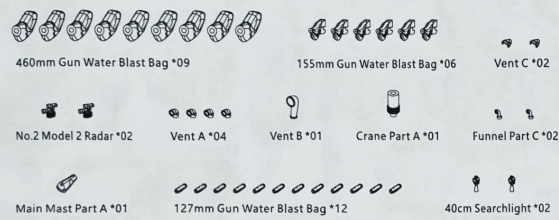

## Wooden Deck:

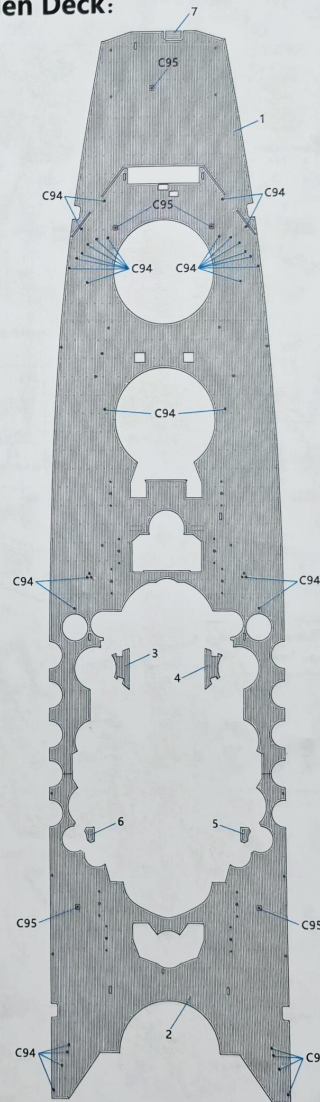

## Photo Etching: A, B, C, D, E (Total : 5 Sheets)

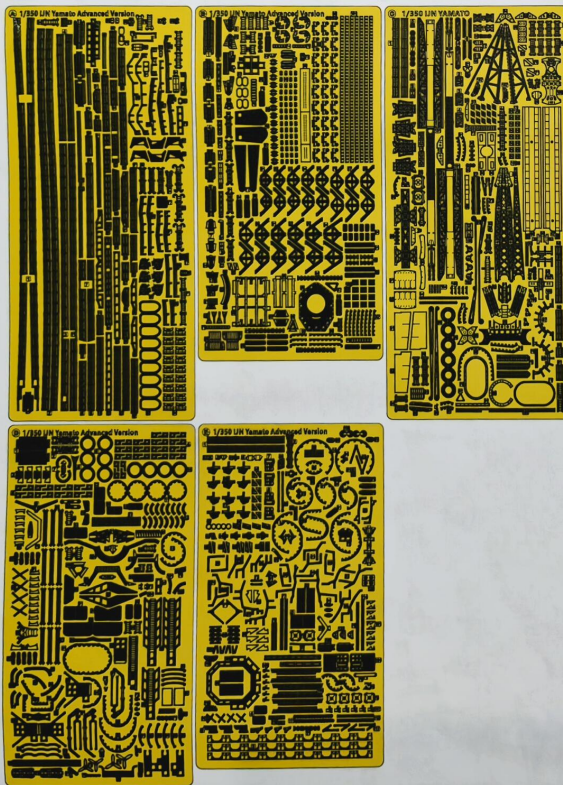

- Install 组装
- Remove 去除
- Bend 弯曲
- Make Hole 钻孔
- Optional parts 选装零件
- Same Another Side 对侧相同
- Up Fold 向上折
- Down Fold 向下折

155mm Metal Barrel

155mm Gun Water Blast Bag

127mm Metal Barrel

127mm DP Gun

127mm Gun Water Blast Bag

127mm Metal Barrel (Short)

Mast L

Kit IT10

C96

B96

B97

E109

Kit D35

Kit D28

Ø=0.4mm

A74

A70

B51

A65

B34

B35

B50

B36

B34

A71

B32

B33

D60

D4

Kit D11

D88

Type A 25mm MG Turret

D5

Kit D10

Type C 25mm MG Turret

Life Buoy

C102

Kit IE7

Life Buoy

No.1 155mm Gun Turrets

A20

D13

B63

D13

C83

B63

Life Buoy

No.4 155mm Gun Turrets

Kit IH3

Ø=0.5mm

127mm Metal Barrel

Kit IH8

Kit IH5

E18

E19

E17

E16

Type 89 127mm AA Gun

Kit D34

Ø=0.4mm

B42

B45

B39

B38

A53

B40

B43

B44

B43

B31

E11

A53

A57

A56

A53

A62

A66

A68

A69

A67

A63

B30

B37

E10

E9

460mm Metal Barrel

A55

A54

A54

460mm Metal Barrel

A55

A54

A54

460mm Gun Water Blast Bag

No.1 45-caliber Triple 460mm Gun Turret

25mm MG Triple Mounts

Kit IE4

B52

B102

E3

B99

B98

Kit IE6

Kit IE3

Kit IE5

Kit IE2

Kit IE1

No.2 & No.3 45-caliber Triple 460mm Gun Turret

A60

E10

E9

A63

A61

B30

A59

A58

25mm MG Triple Mounts

Type 94 AA Gun Director A

Type 94 AA Gun Director B

Type 95 AA Gun Fire Control

Type 85 AA Gun Fire Control

Type 96 Twin 13mm Machine Gun

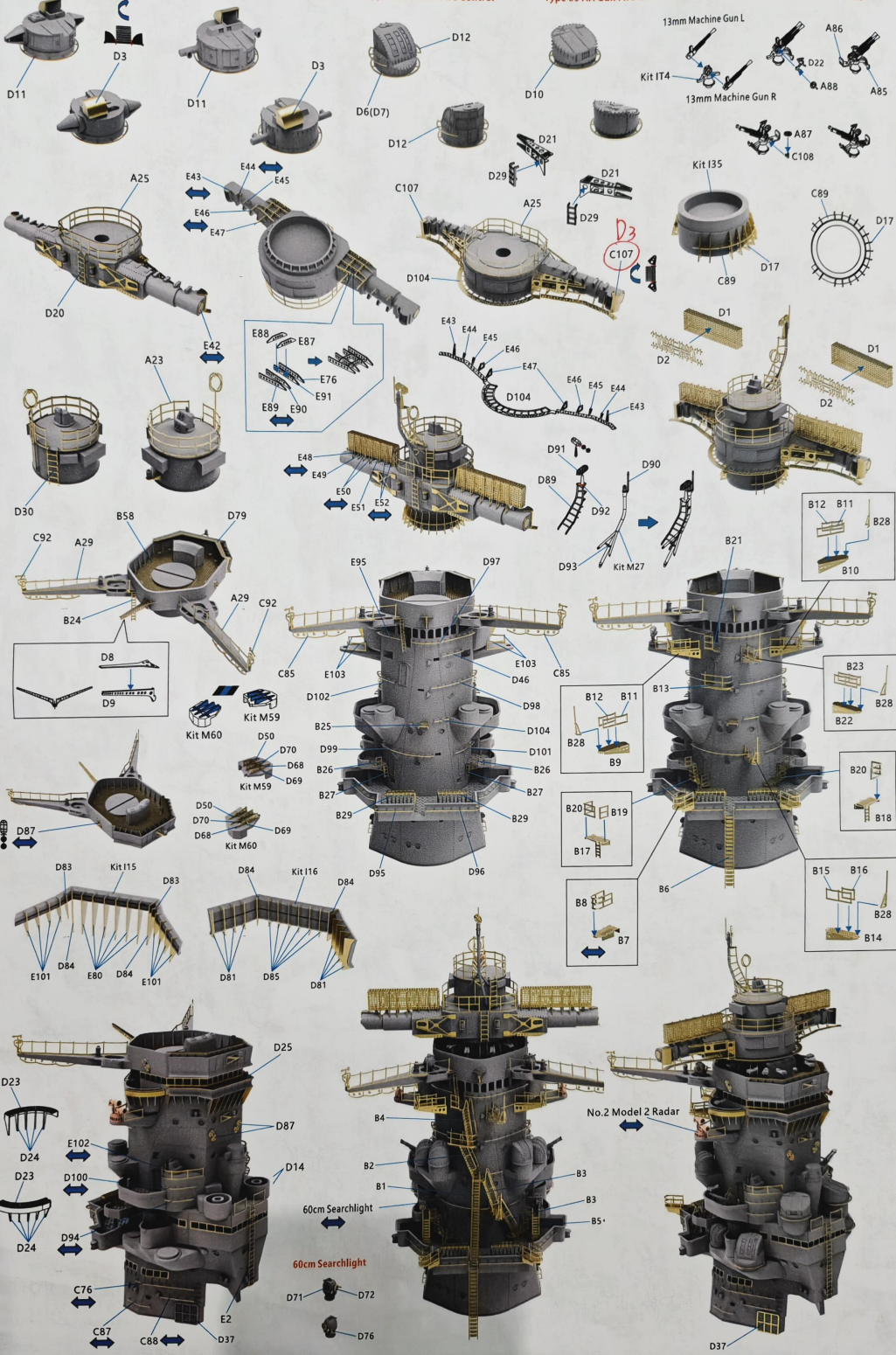

60cm Searchlight

60cm Searchlight

No. 2 Model 2 Radar

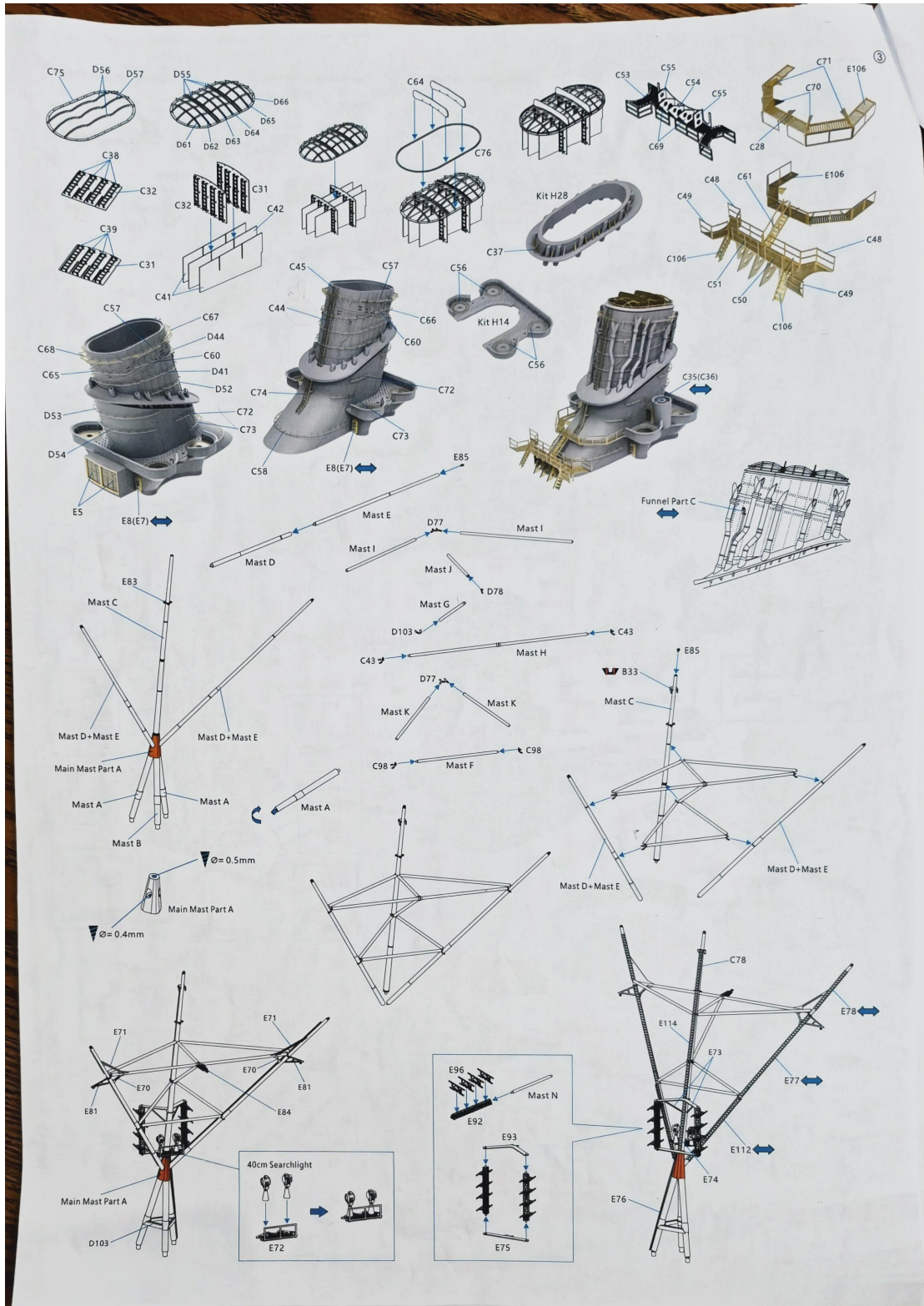

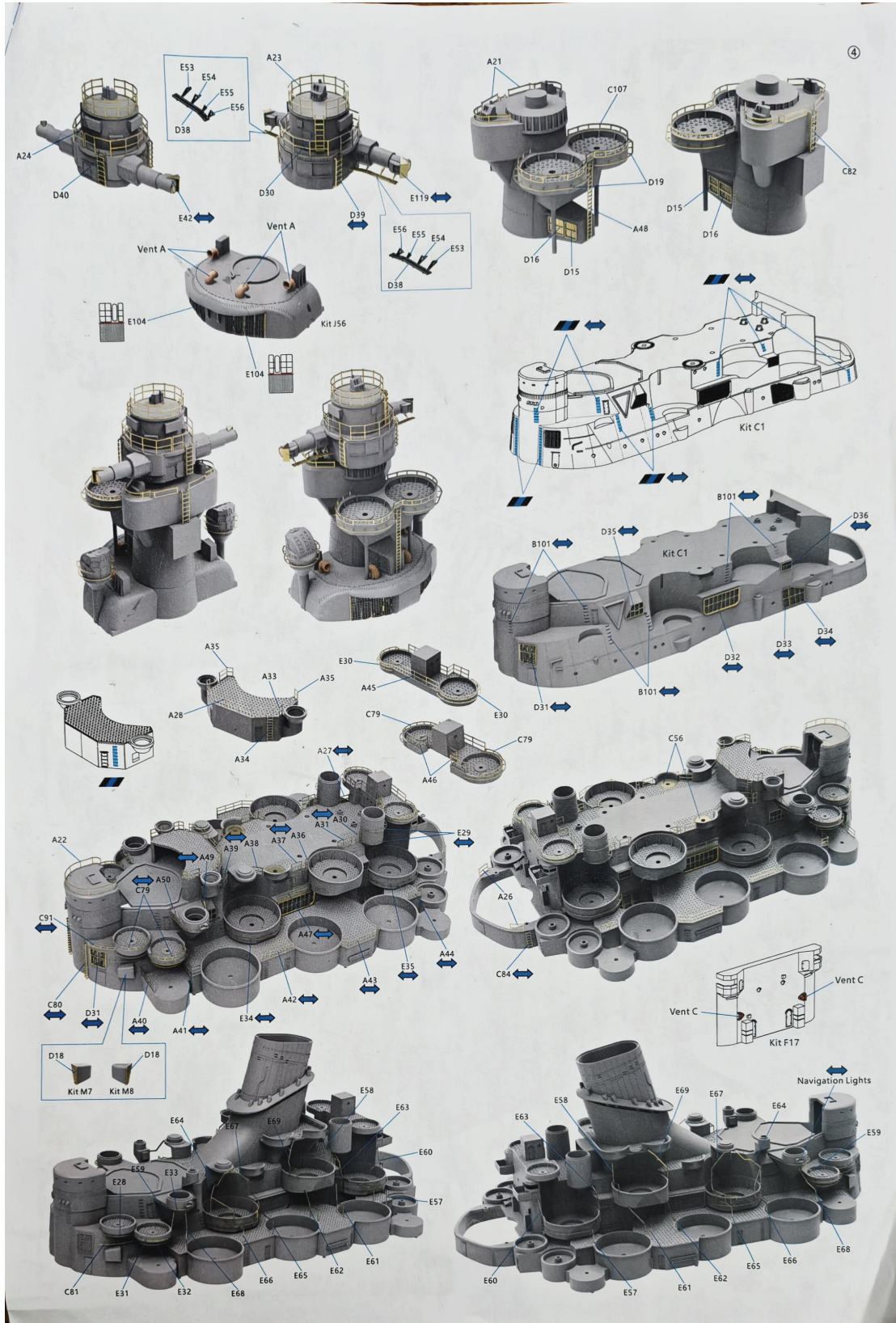

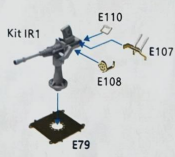
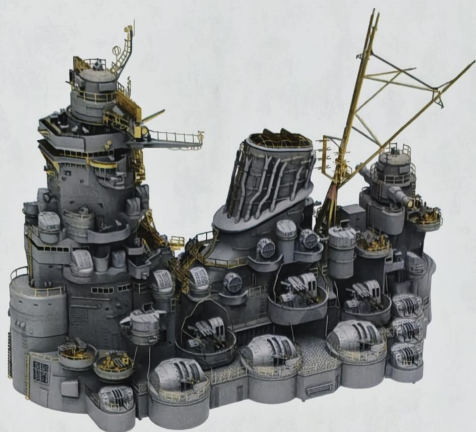

25mm MG Single Mount

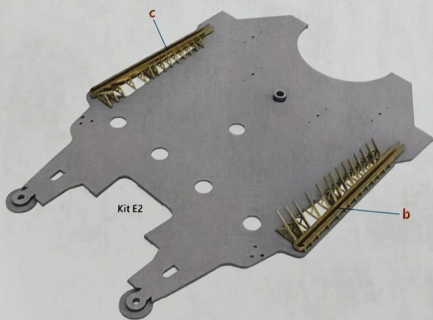
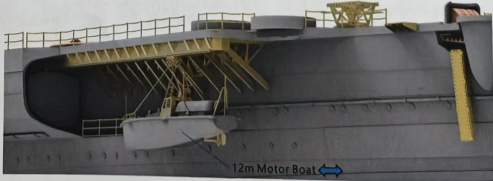
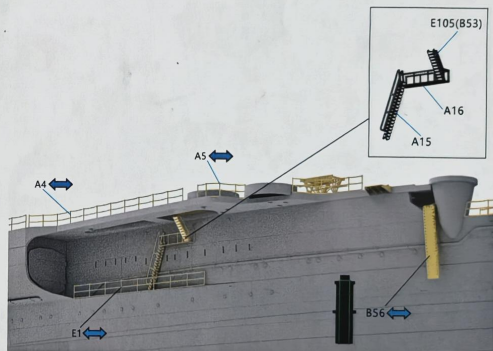
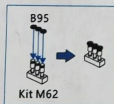
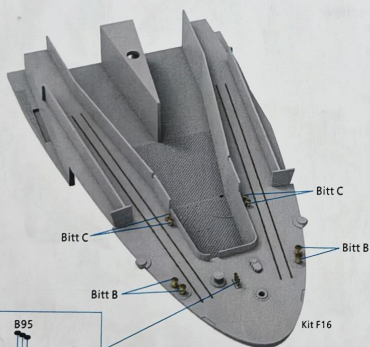
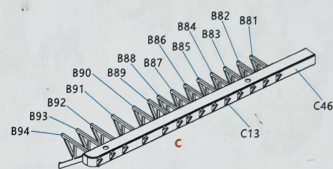
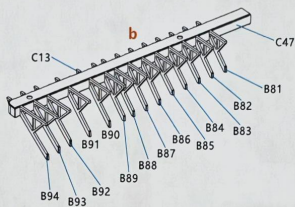

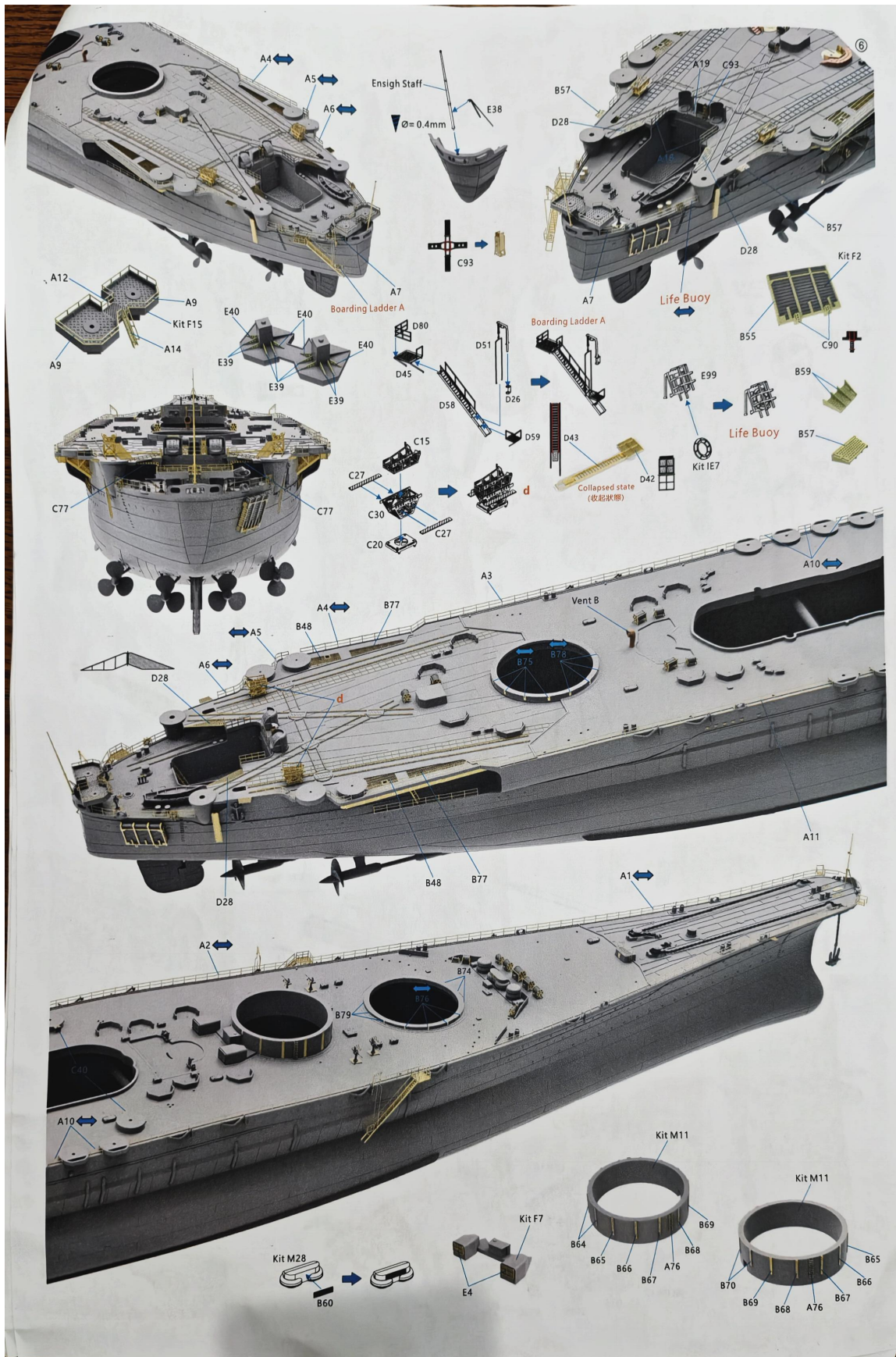

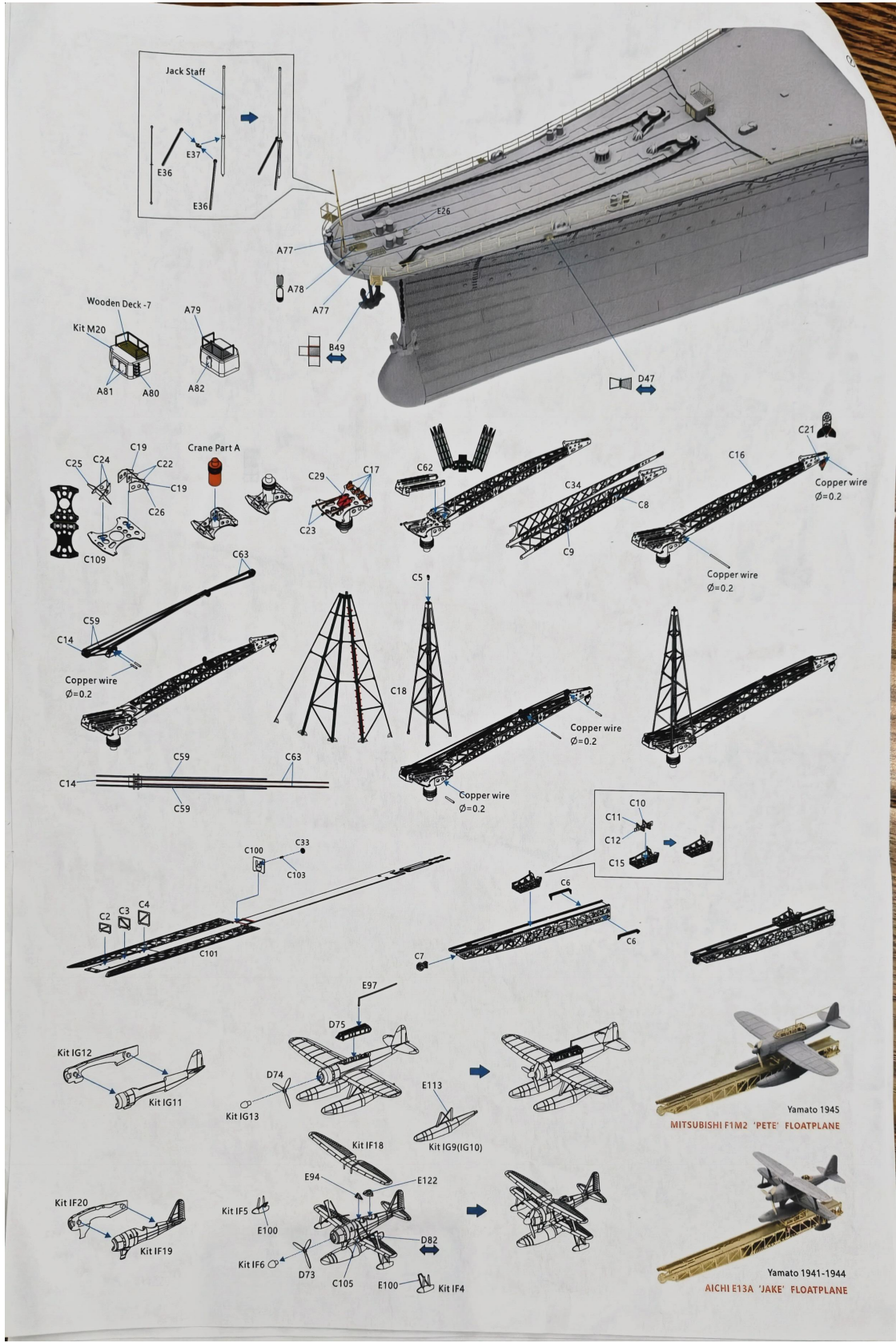



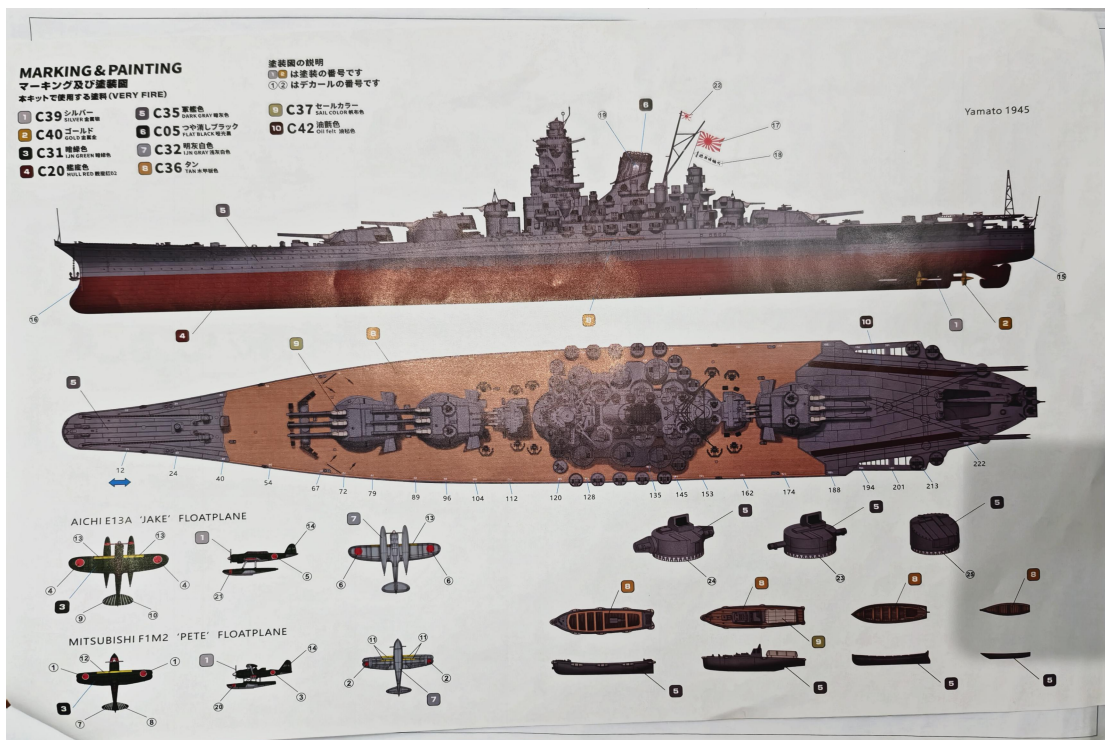
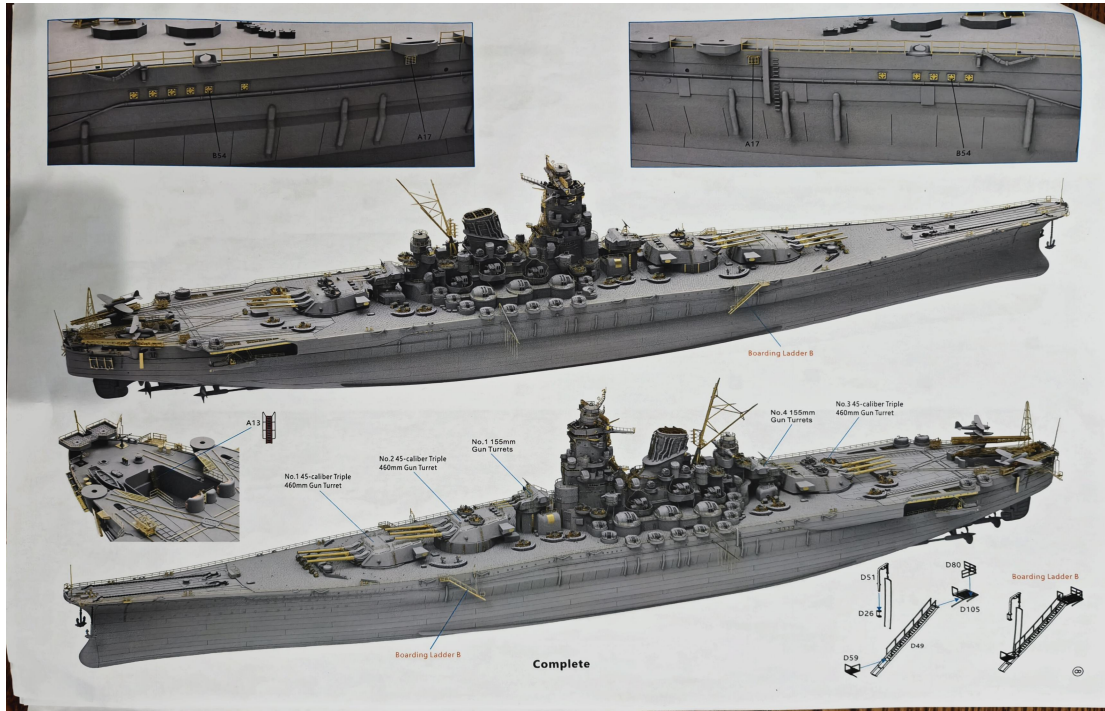

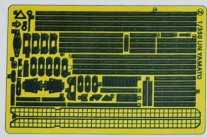
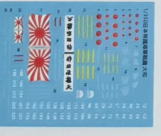
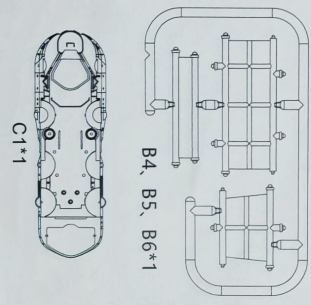
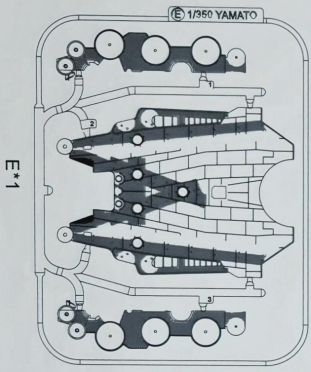
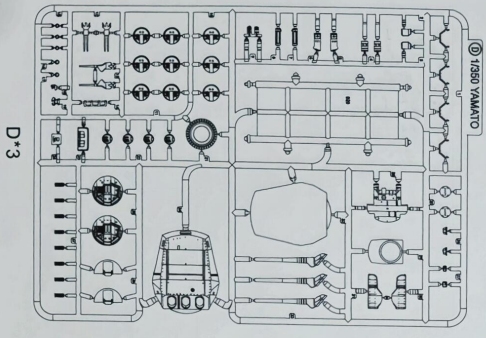
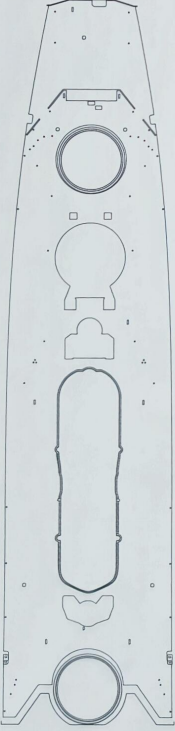
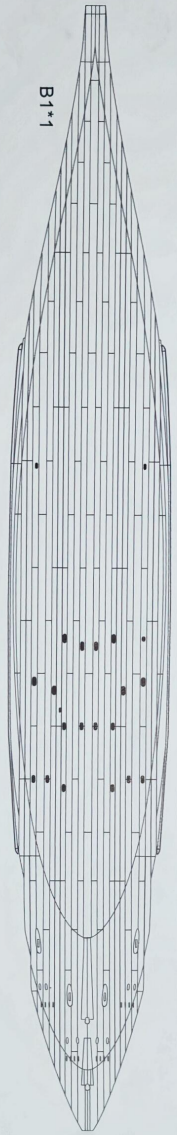
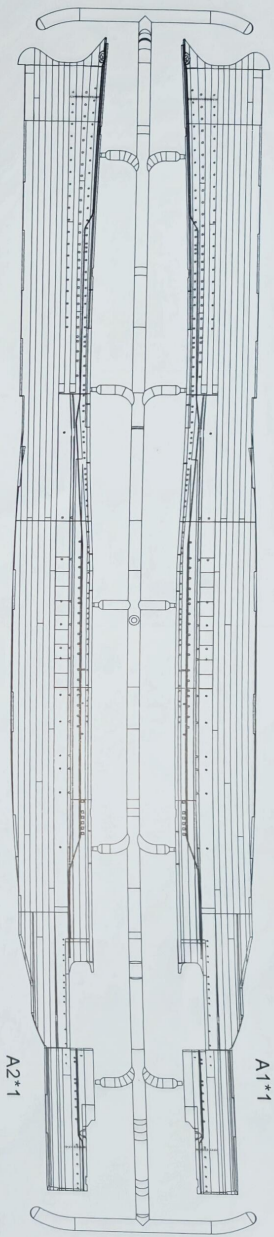

Chain\*1

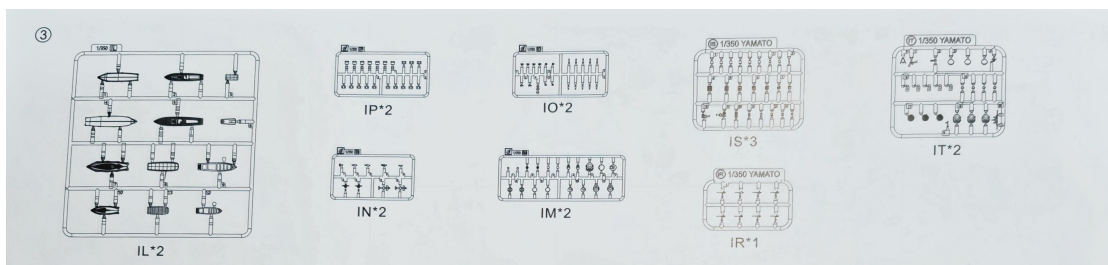
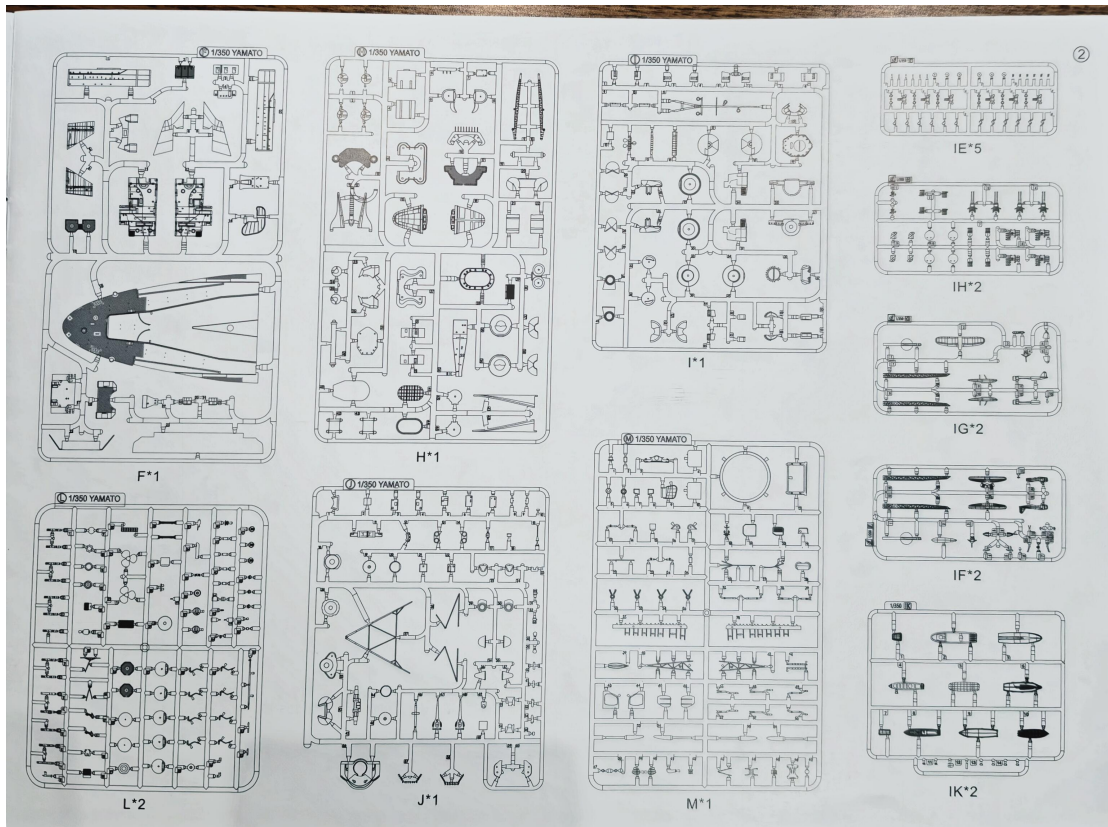

- Install 组装
- Make Hole 钻孔
- Same Another Side 对侧相同
- Bend 弯曲
- Up Fold 向上折
- Down Fold 向下折
- Remove 去除
- Optional parts 选装零件

