



FORD SIERRA COSWORTH 4X4 RALLY DE MONTE CARLO 1991
(PORTUGUESE)

A Ford lançou o Ford Sierra Cosworth 4x4 em 1990 produzindo 9250 unidades.

O Rally de Monte Carlo de 1991 marcou a estreia do Ford Sierra Cosworth 4x4 no Campeonato do Mundo de Rallys.

Quando a Ford contratou um jovem e rápido piloto francês chamado François Delecour, não imaginava que ele obtivesse 11 vitórias em especiais e fosse para a derradeira noite do rally na frente do consagrado Carlos Sainz. O mundo ficava a conhecer o Ford Sierra Cosworth 4x4 com a famosa decoração da Q8 Oils.

Só que, no último troço, o Turini, a suspensão traseira do Sierra 4X4 cede e o francês chora no fim do troço, perdendo a vitória, mas conseguindo ainda terminar no último lugar do Podio. O Francês ficou mundialmente famoso bem como a sua Co-piloto Anne-Chantal Pauwels.

Faziam parte da Equipa Ford o Italiano Alex Fiorio acompanhado de Luigi Pirollo, que terminou o Rally em 10º. E Malcolm Wilson, hoje Patrão da equipa M-Sport, acompanhado de Nicky Grist que terminaram o Rally em 7º.

Durante a Sua Carreira no Campeonato do Mundo o Sierra conseguiu 14 podios no WRC, 1 vitoria no Tour de Corse de 1988 e um Vice Campeonato de Marcas em 1988 e 3º lugar no Campeonato de Marcas de 1992. No entanto conseguiu mais de 40 titulos de campeão nacional de rallys, correndo ao longo da sua carreira nas mãos de diversos pilotos Mundialmente famosos, e com isso tornando-se um dos modelos mais iconicos do Mundial de Rallys.

CUIDADO

Não é adequado para crianças menores de 14 anos.

Conter peças pequenas.

Um adulto supervisor deve ler as instruções se uma criança montar o modelo.

A montagem deste kit precisa de ferramentas.

Cuidados extras devem ser tomados para evitar lesões.

FORD SIERRA COSWORTH 4X4 RALLY DE MONTE CARLO 1991
(ENGLISH)

Ford launched the Ford Sierra Cosworth 4x4 in 1990 producing 9250 units.

The 1991 Monte Carlo Rally marked the debut of the Ford Sierra Cosworth 4x4 in the World Rally Championship.

When Ford hired a young and fast French driver named François Delecour, they did not imagine that he would get 11 special victories and go to the last night of the rally in front of the renowned Carlos Sainz. The world was getting to know the Ford Sierra Cosworth 4x4 with the famous Q8 Oils livery.

However, in the last stage, the Turini, the rear suspension of the Sierra 4X4 gives way and the Frenchman cries at the end of the stage, losing the victory, but still managing to finish in the last place of the Podio. The Frenchman became world famous as well as his co-pilot Anne-Chantal Pauwels.

The Italian Alex Fiorio was part of the Ford Team, accompanied by Luigi Pirollo, who finished the Rally in 10th. And Malcolm Wilson, today boss of the M-Sport team, accompanied by Nicky Grist who finished the Rally in 7th.

During his career in the World Championship, Sierra achieved 14 podiums in the WRC, 1 victory in the Tour de Corse of 1988 and a Vice Championship of in 1988 and 3rd place in the Championship of 1992. However, he managed to win more than 40 national rally championship titles, running throughout his career in the hands of several world famous drivers, and with that becoming one of the most iconic models of the World Rally Championship.

CAUTION

Not suitable for children under 14 years.

Contain Small parts.

A supervising adult should read the instructions if a child assembles the model.

Assembling this kit need tools.

Extra care should be taken to avoid injury.

Ford Sierra Cosworth 4x4 Gr.A 1991

Read before assembly

- Not suitable for children under 14 years .
- Contains small parts .
- A supervising adult should read the instructions if a child assembles the model .
- Carefully study the instructions and perform a test fit before final assembly .
- Do not use cement or paints in enclosed areas or near sources of flames .

Paints required

Tamiya (TS-X-XF-LP):

FSC - Firescale	TS17 Gloss aluminium	X11 Chrome Silver	X31 Titanium gold
ZP - Zero Paint	TS26 White	X14 Sky blue	X32 Titanium silver
FSC243 / ZP1182 Beige	TS30 Silver Leaf	X18 Semi-gloss black	XF1 Flat black
FSC242 / ZP1182 Blue	TS71 Smoke	X19 Smoke	XF7 Flat red
FSC246 / TS26 White	TS100 Semi-gloss bright gun metal	X21 Flat base	XF16 Flat aluminium
FSC241 Signal Blue	X2 White	X23 Clear blue	XF56 Metallic grey
	X6 Orange	X26 Clear orange	XF59 Desert yellow
	X7 Red	X27 Clear Red	XF93 Light brown
	X8 Lemon yellow		LP39 Ivory gloss

Tools needed for assembly :

- Tweezers • Nippers • Drills • Files • Modeler's knife • Scissors
- Paper finishing abrasive • Masking tape • Plastic cement • Decal softener

How to apply decals :

- 1) Cut out the decal into the desired shape and clip the decal in water/hot water over 10 seconds.
- 2) Pull the decals sheet and put it on a sponge sheet or tissue paper to absorb extra water.
- 3) Hold the edge of decal sheet and slide it gently on the desired position.
- 4) Apply a little water to your fingertips and adjust the decals with a little shift.
- 5) Press out the extra water and air bubbles with a soft cloth or a cotton bud.
- 6) Be careful not to touch the decal until it is dry completely .

*1 Use a steamed towel or a decal softener to smooth the surface.

*2 Test before using clear coating.

Icon Definition



Don't glue



Drill hole .mm Diameter



Make 2 pieces



Choice



Decal



Stencil + And / Or



Cut with scissors



Same for other side



Place on decal

Chassis assembly

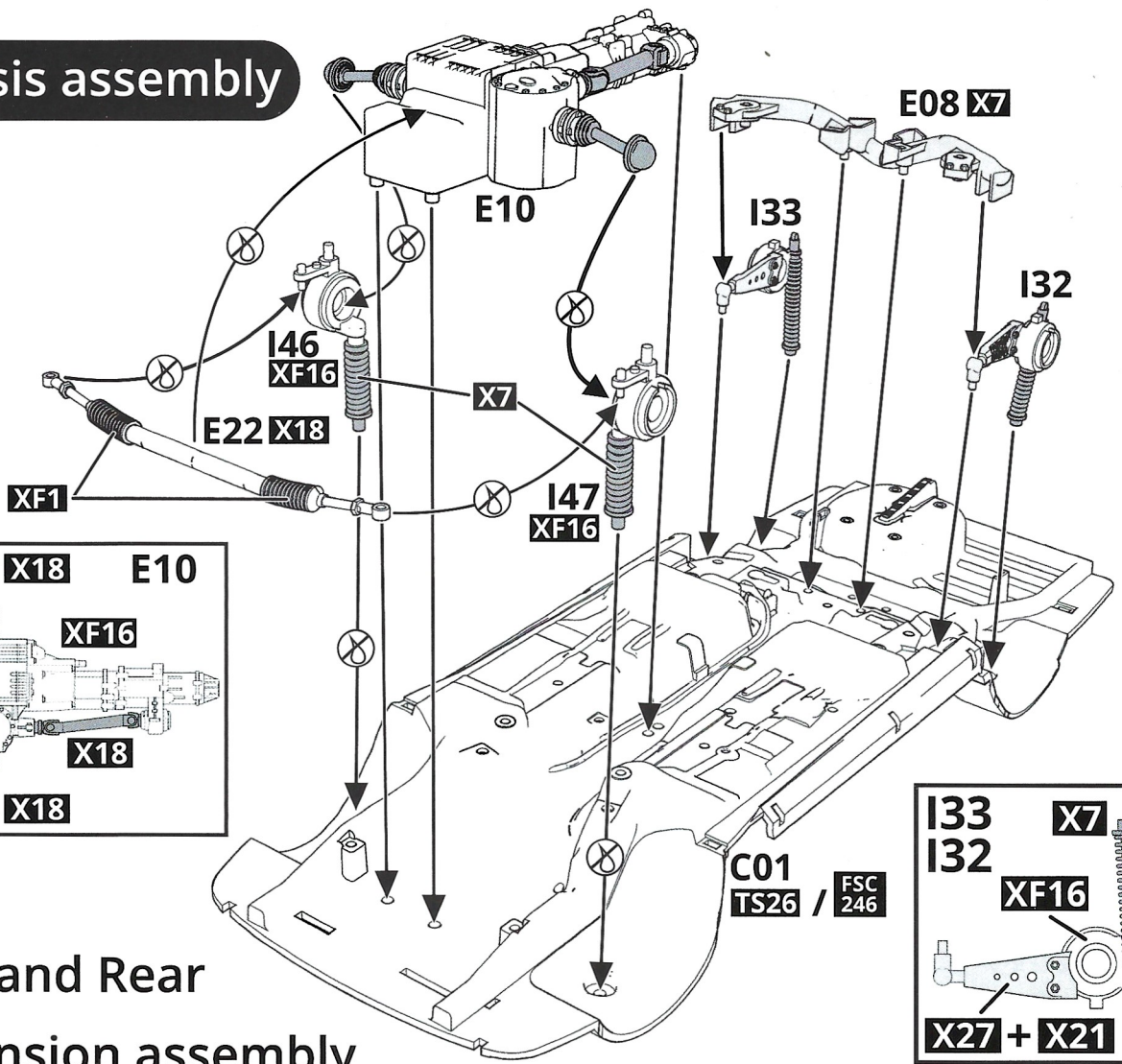

Front and Rear suspension assembly

Underside assembly

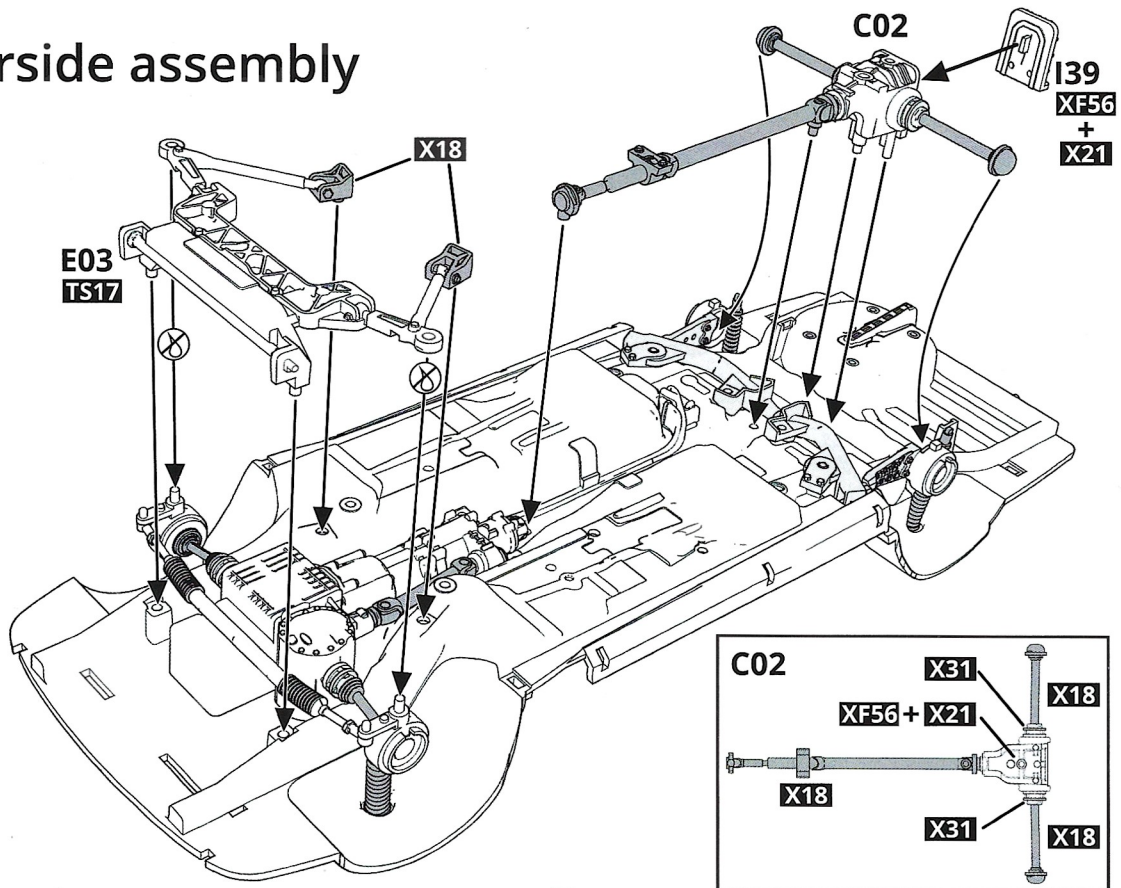

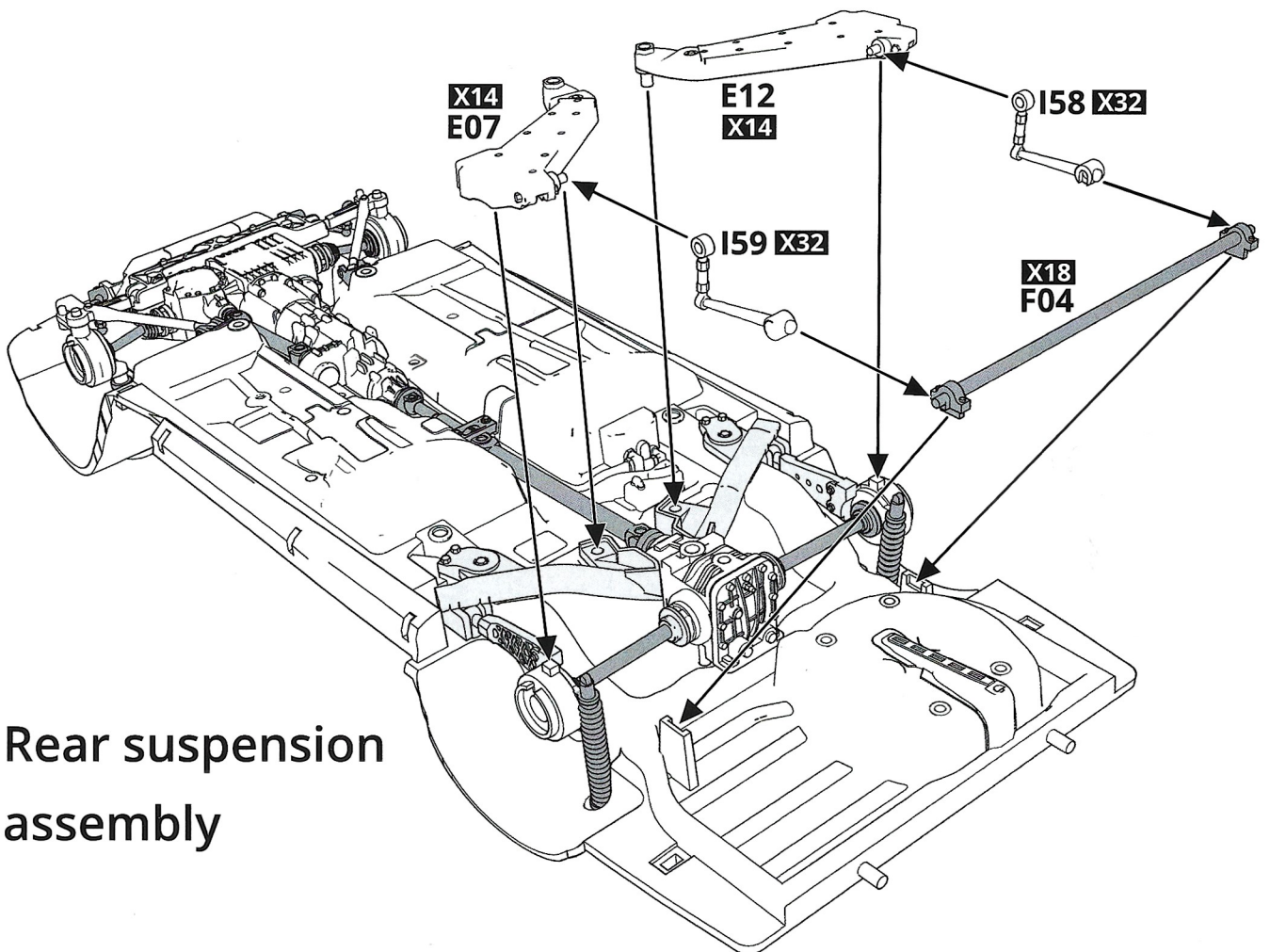
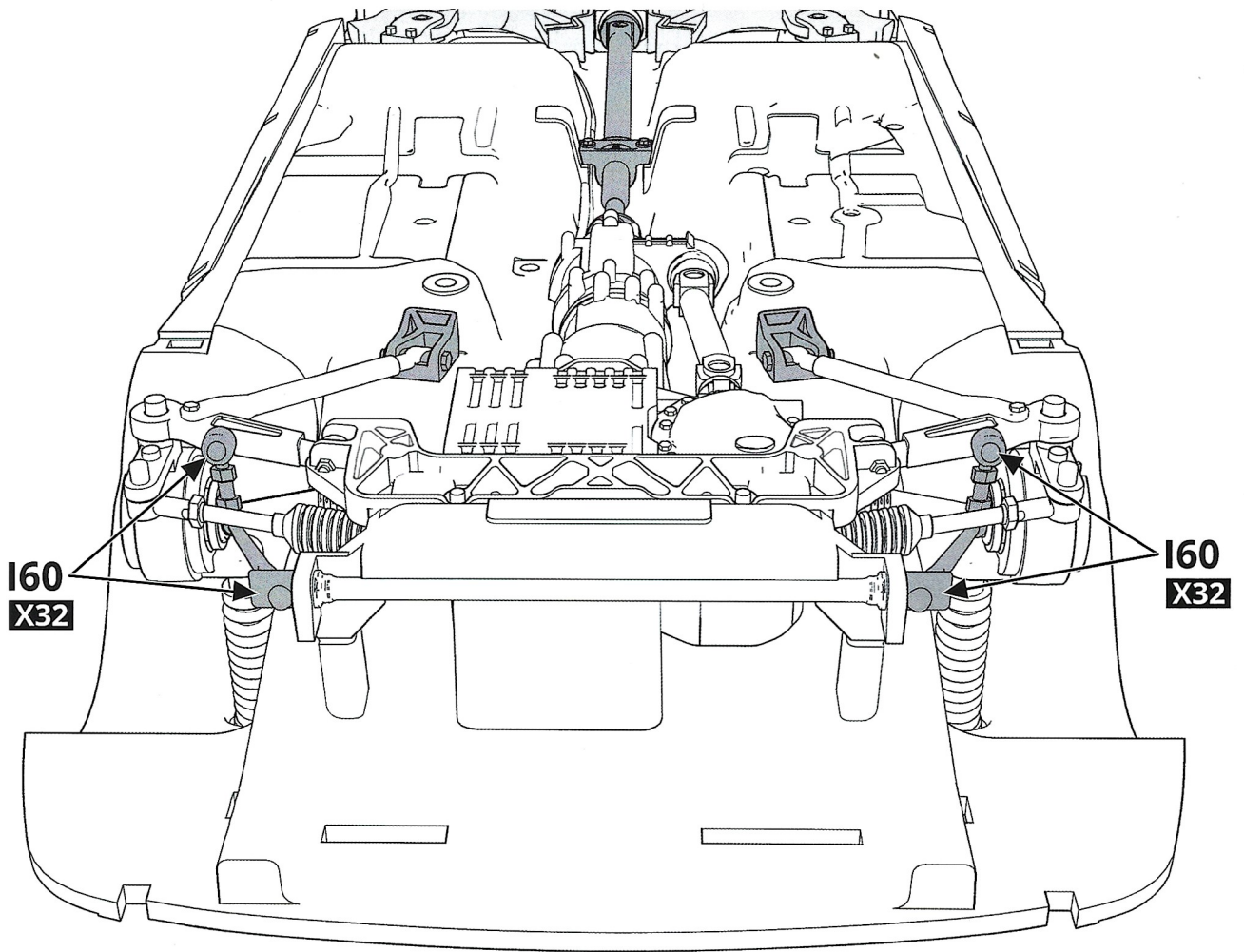

Brake disks assembly

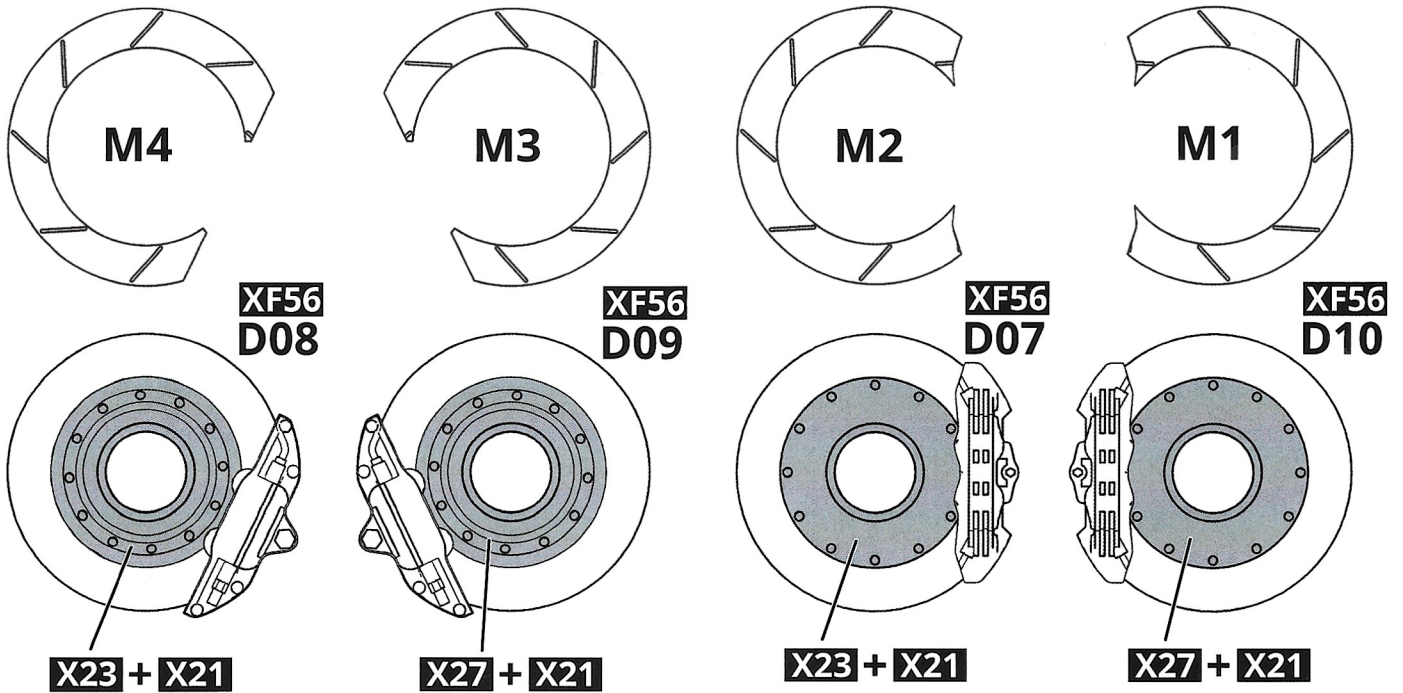

Brake disks attachment

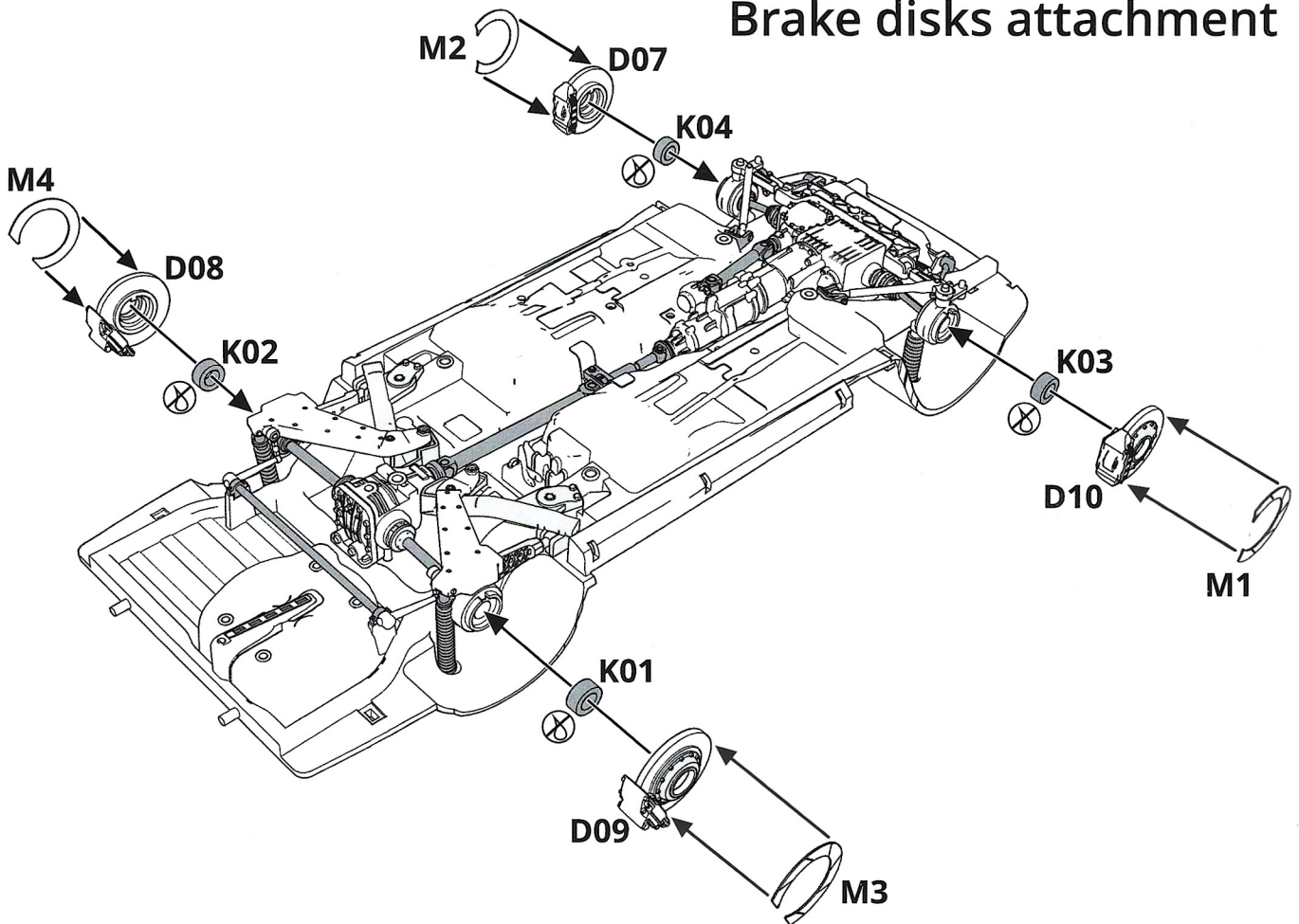

Tires assembly

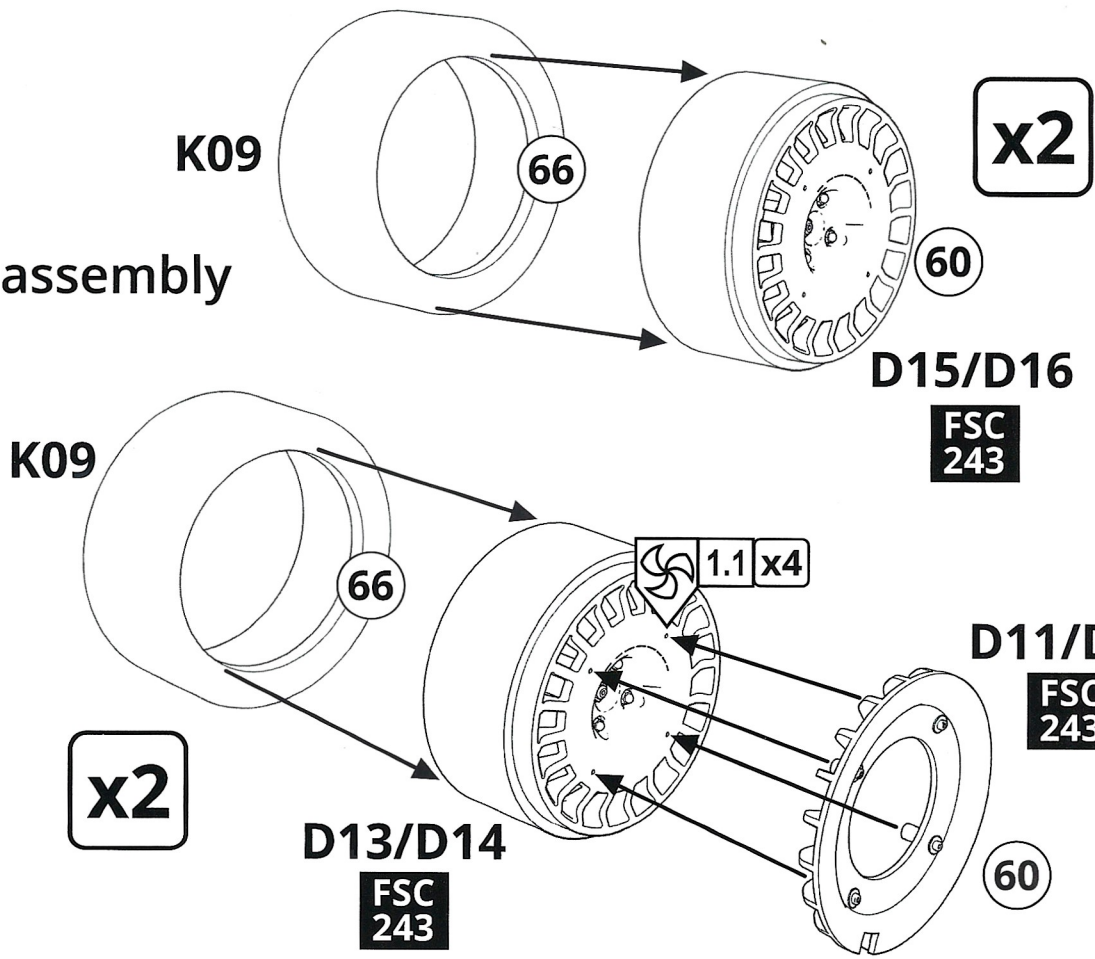

Attaching Wheels

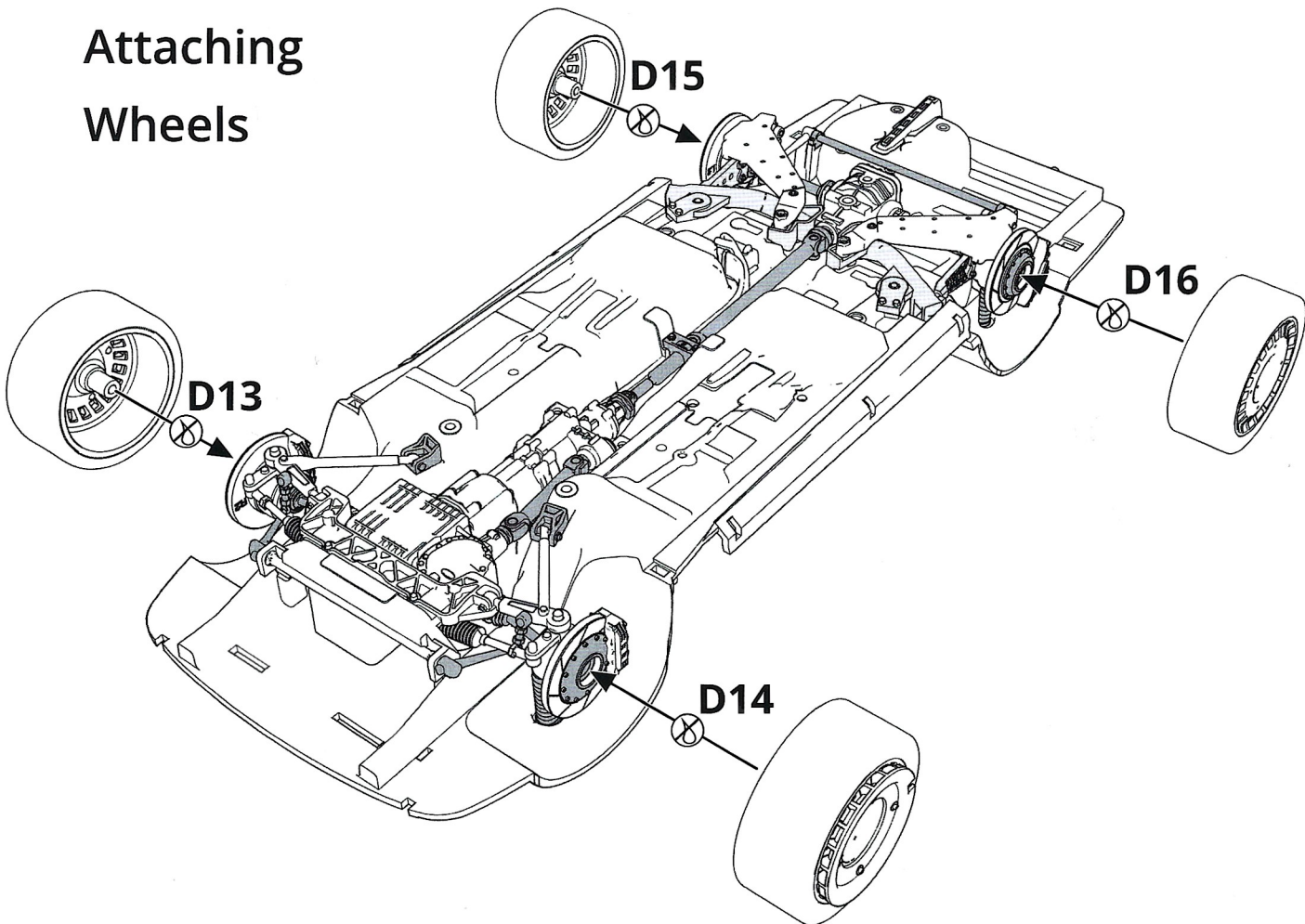

Interior assembly

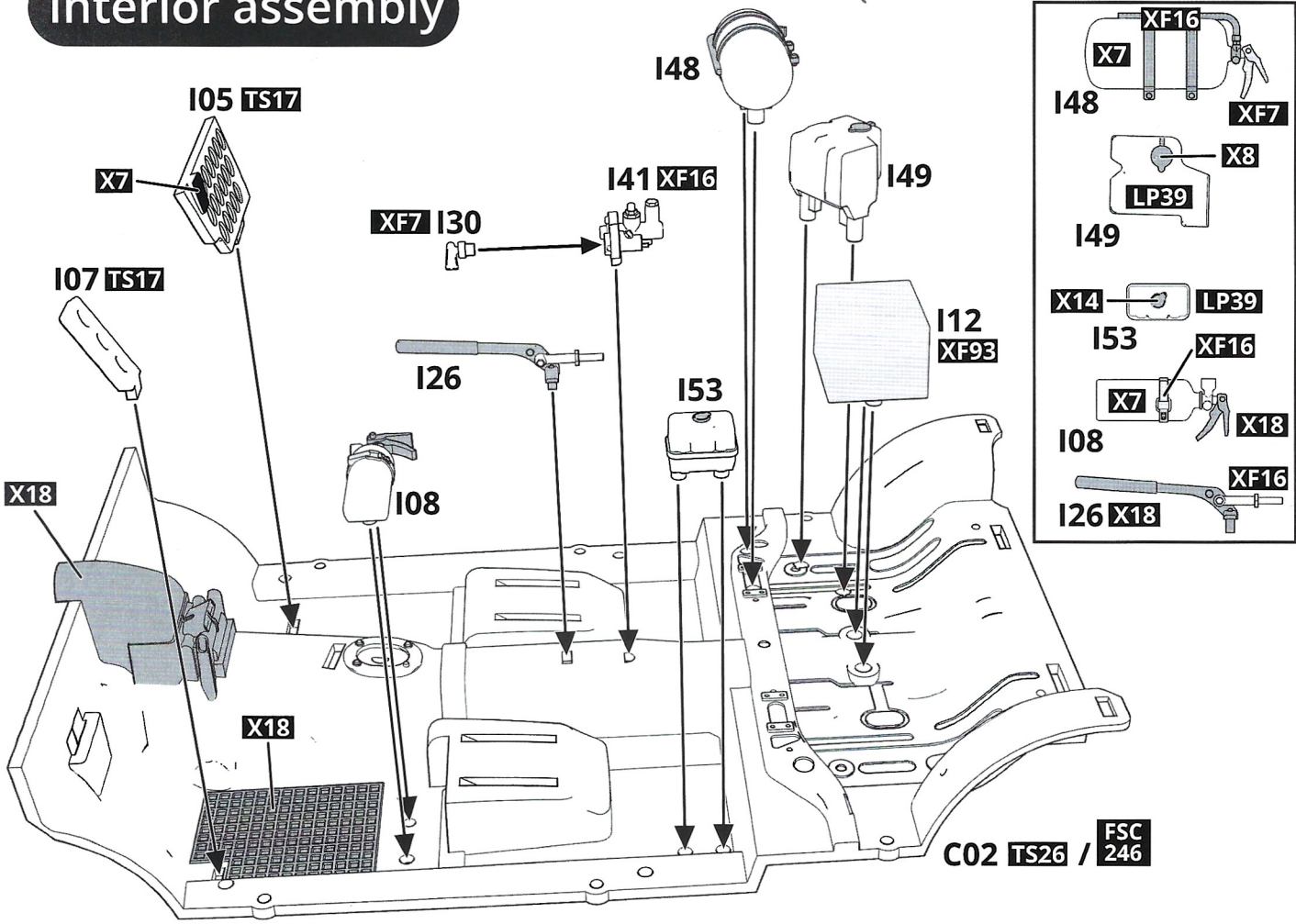

Roll Bar and Rear Panel Assembly

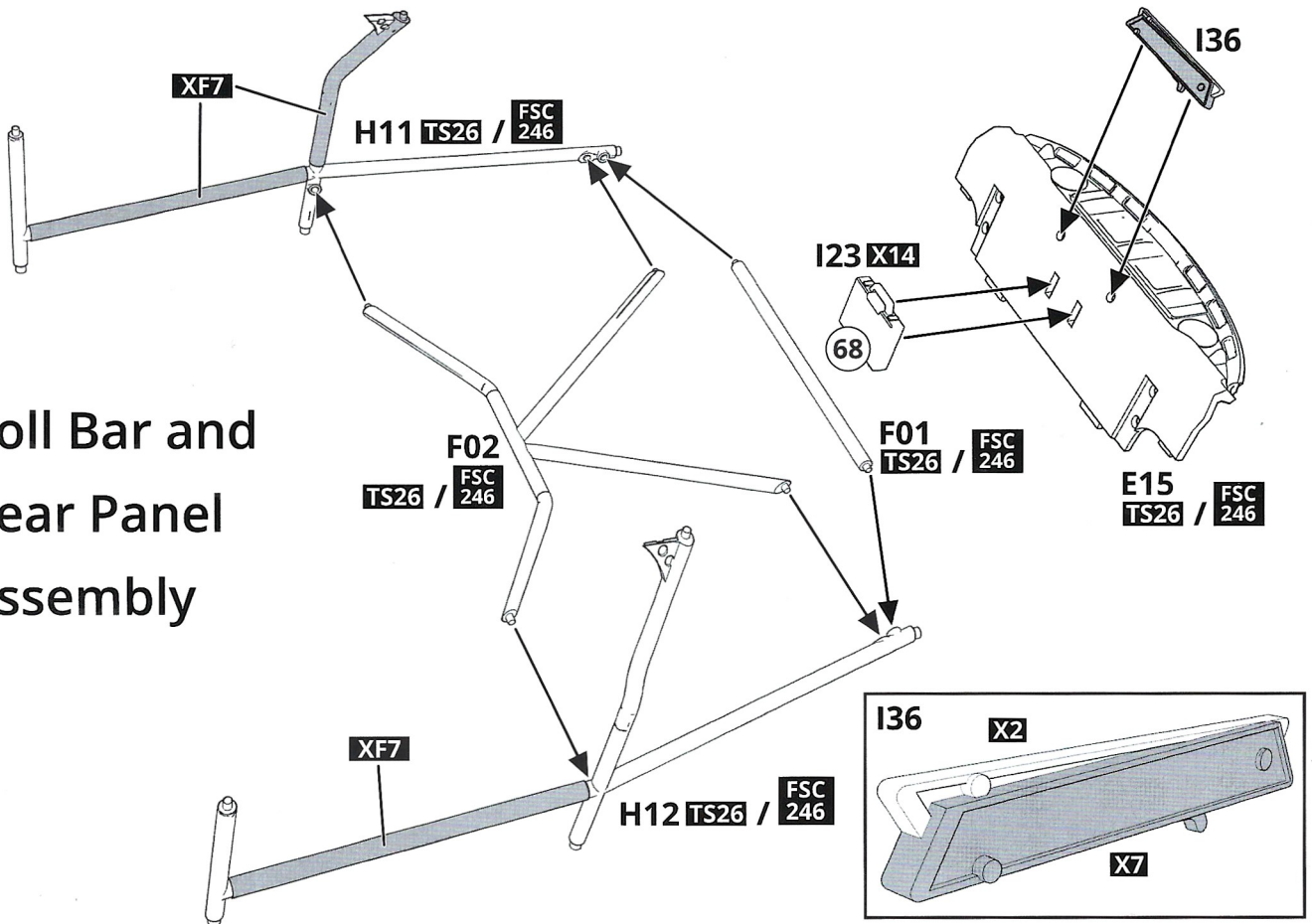

Attaching Roll Bar

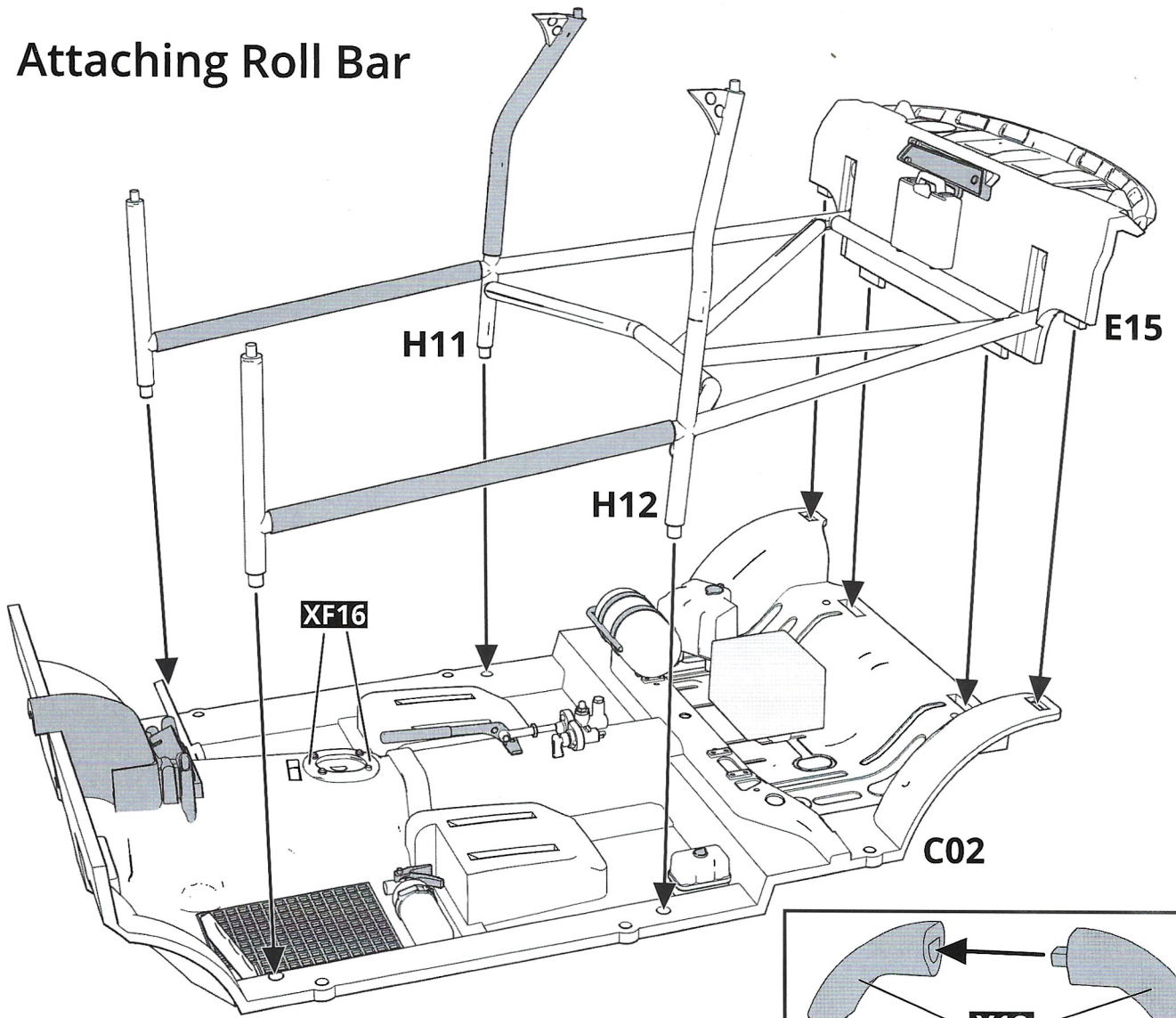

Seats assembly

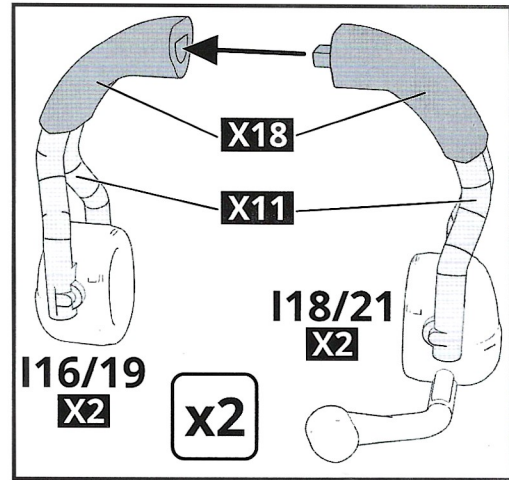
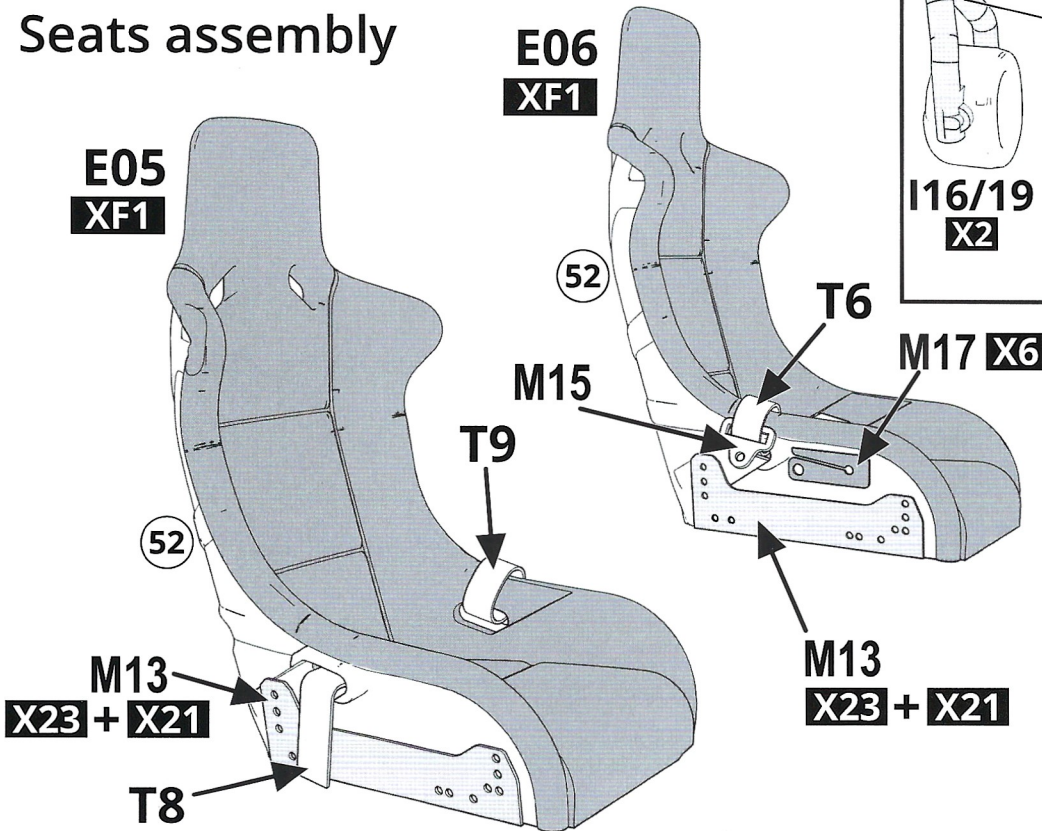

Headset assembly

Seats assembly

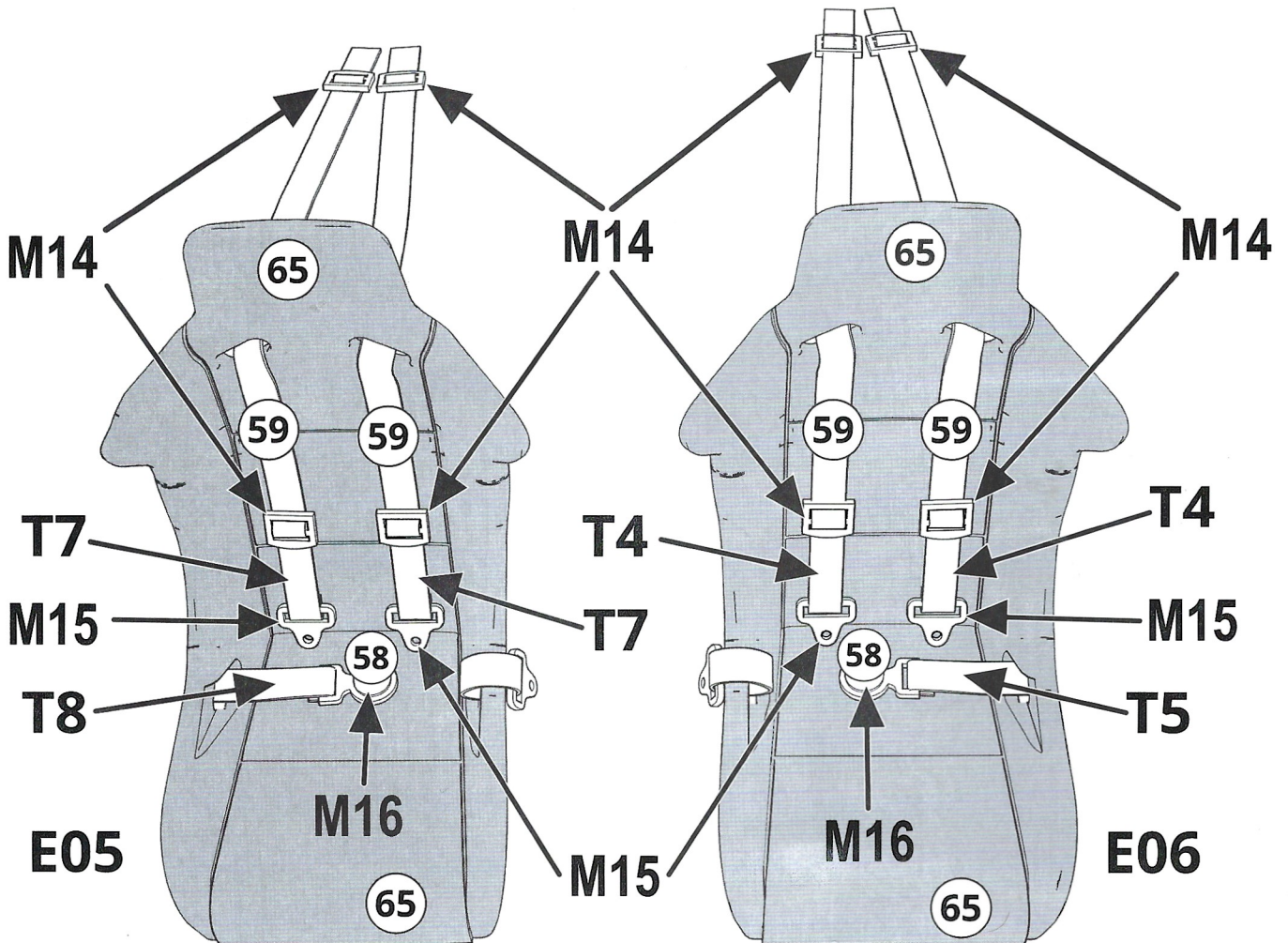
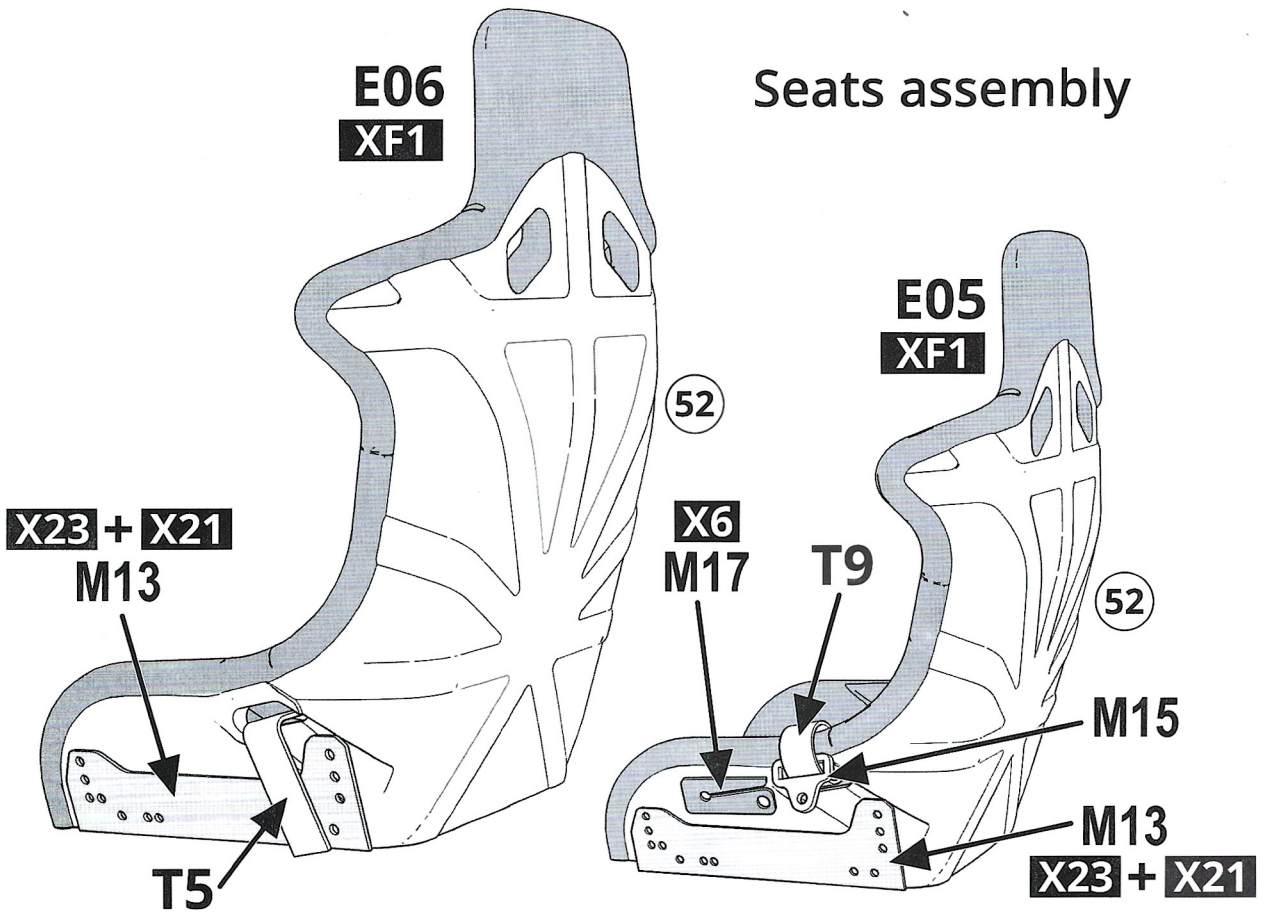

Attaching seats

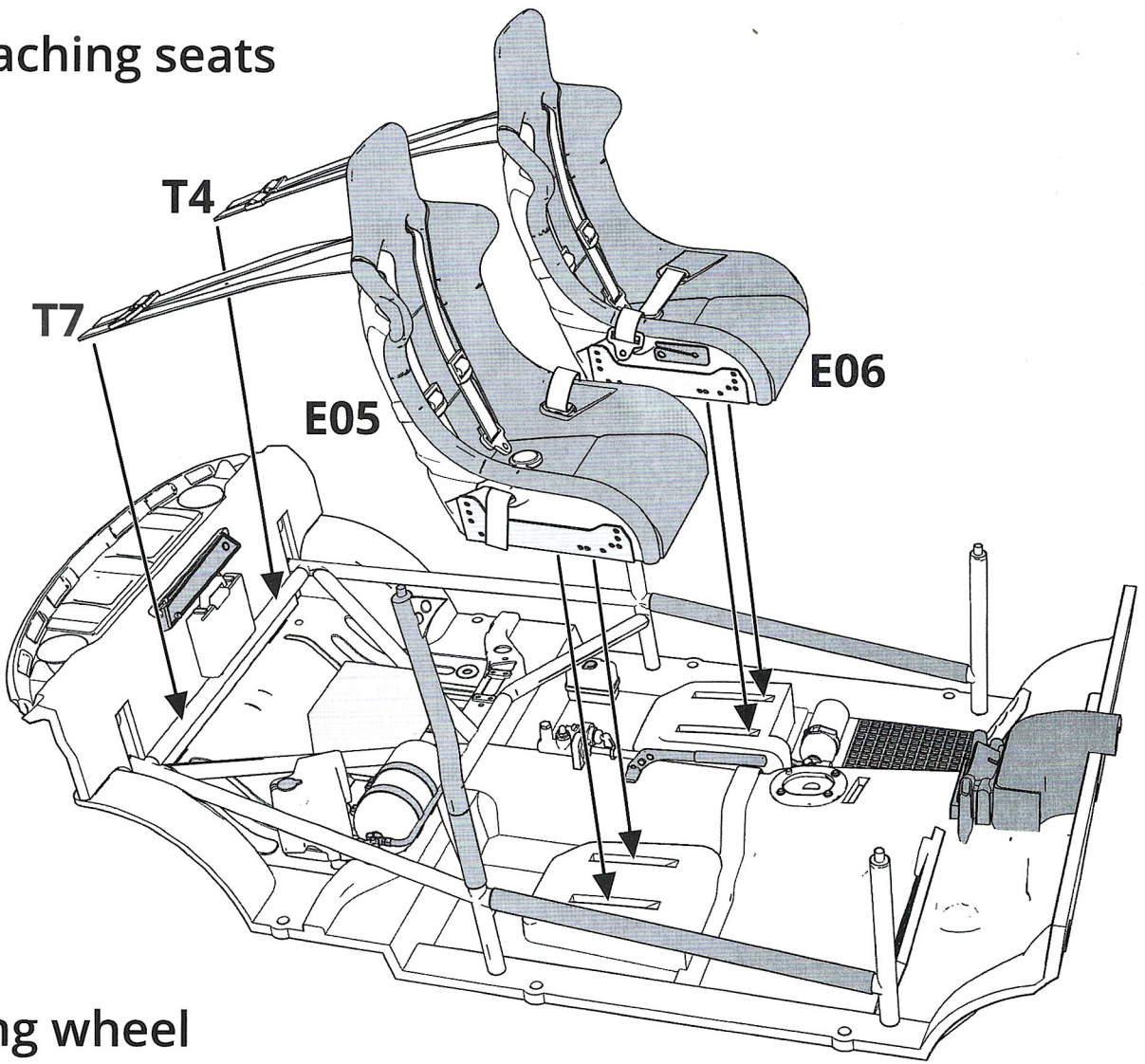

Steering wheel and Dashboard paint scheme

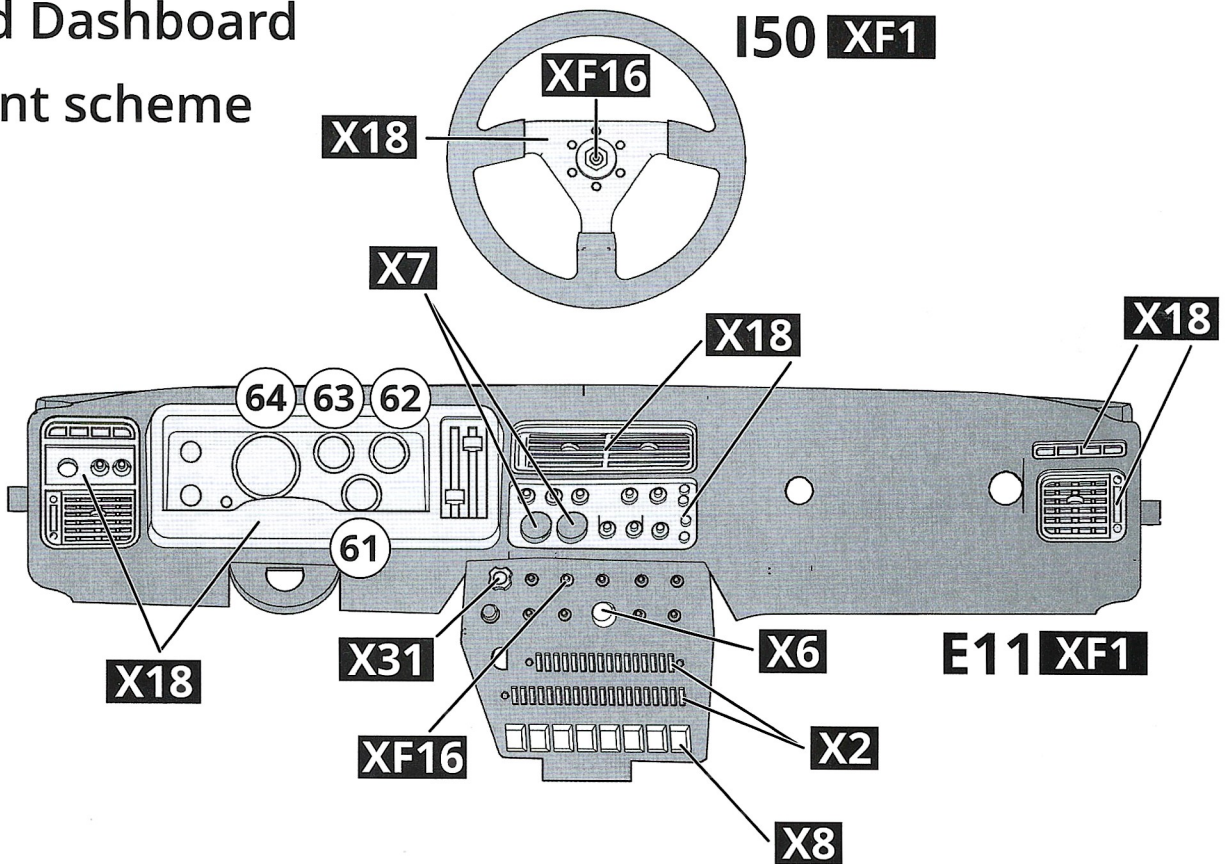

Dashboard assembly

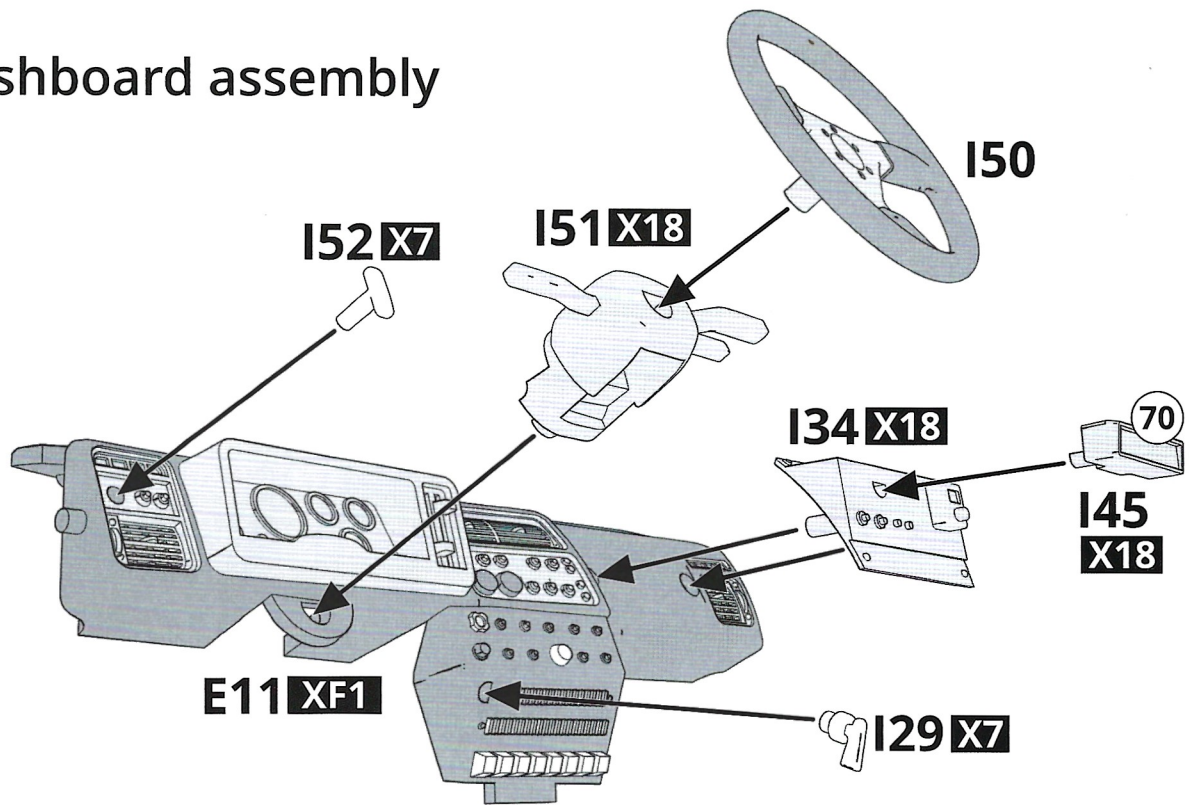

Attaching Top Roll Bar and Dashboard

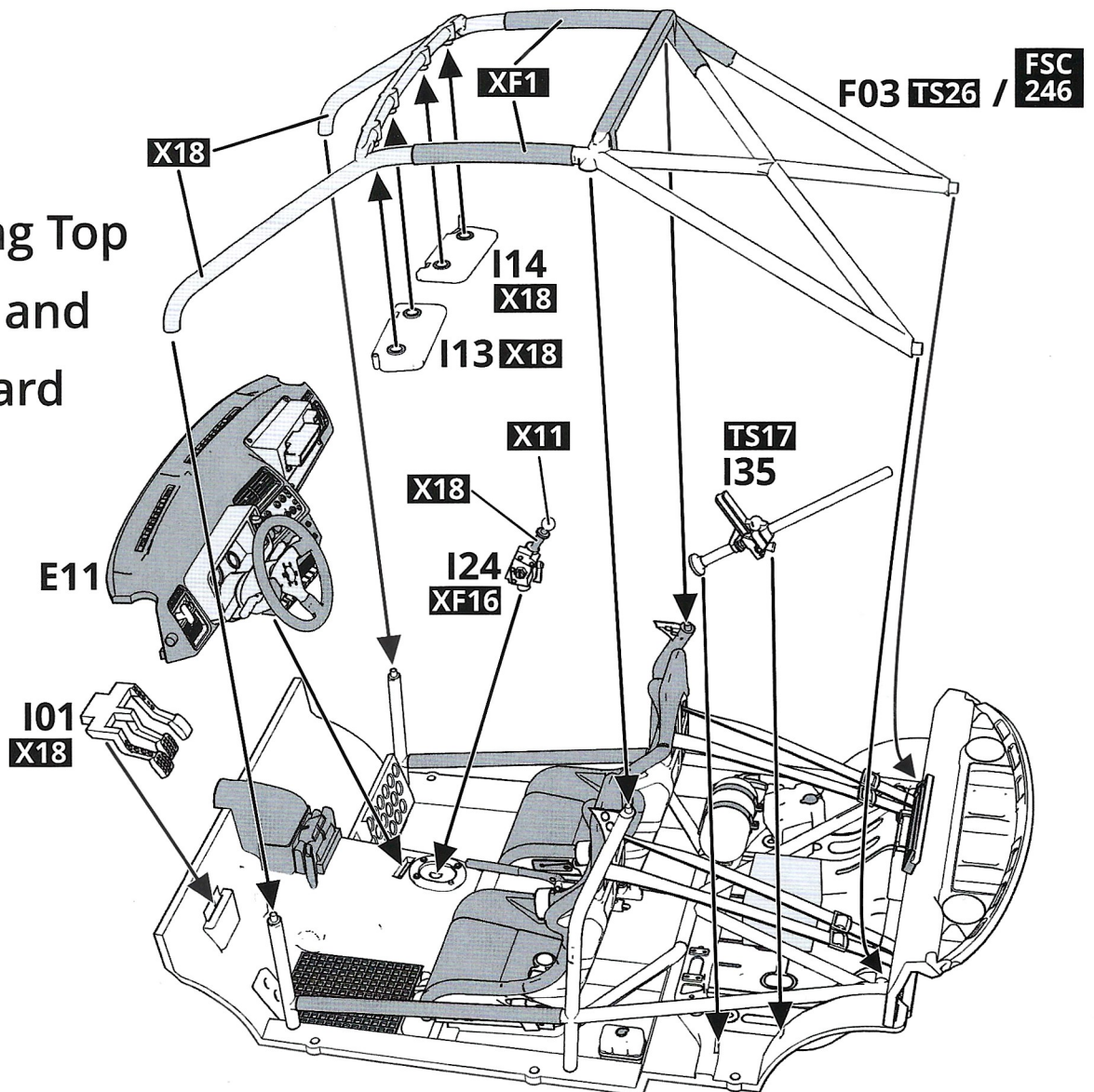

Attaching Side Panels

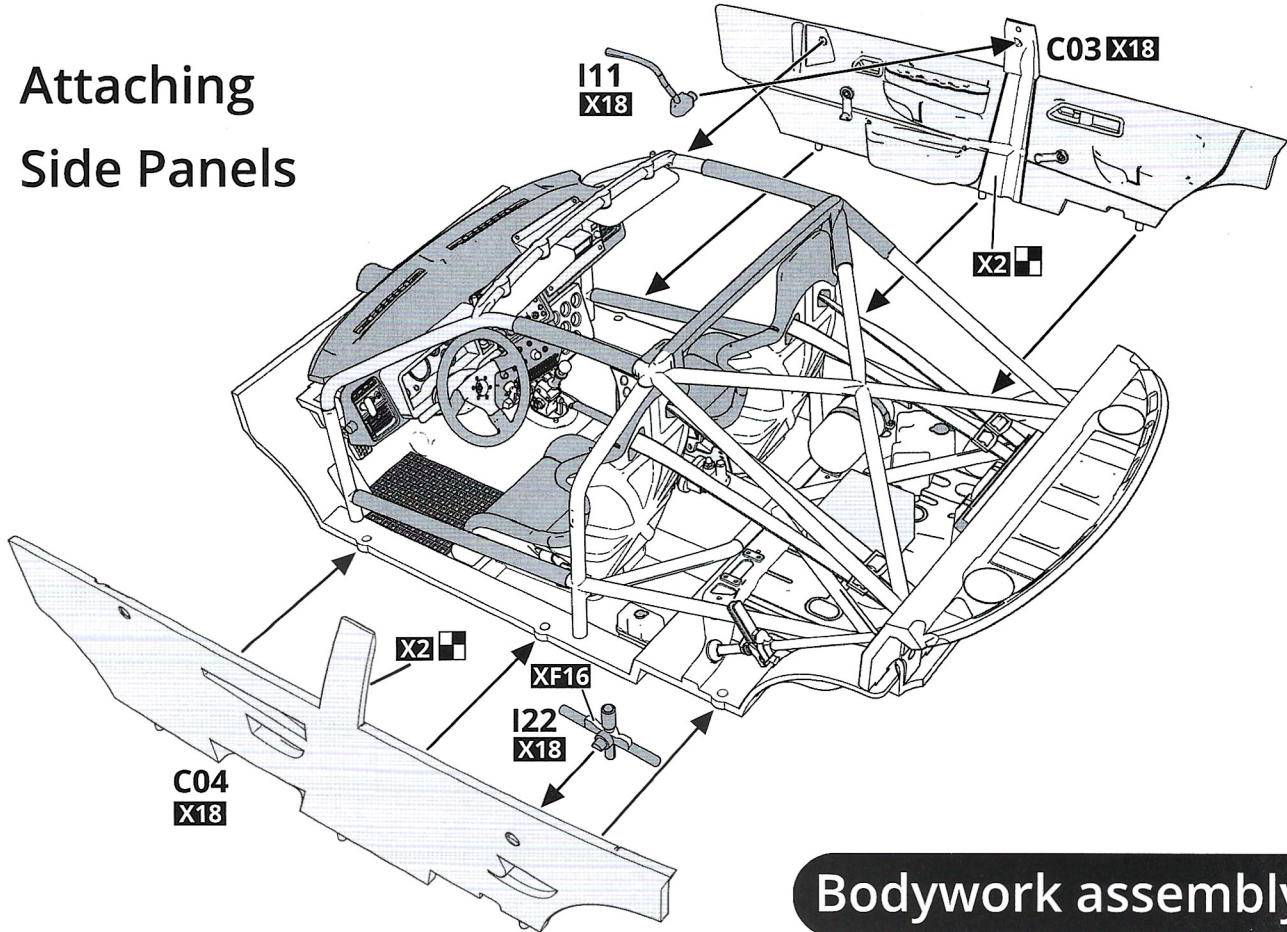

Bodywork assembly

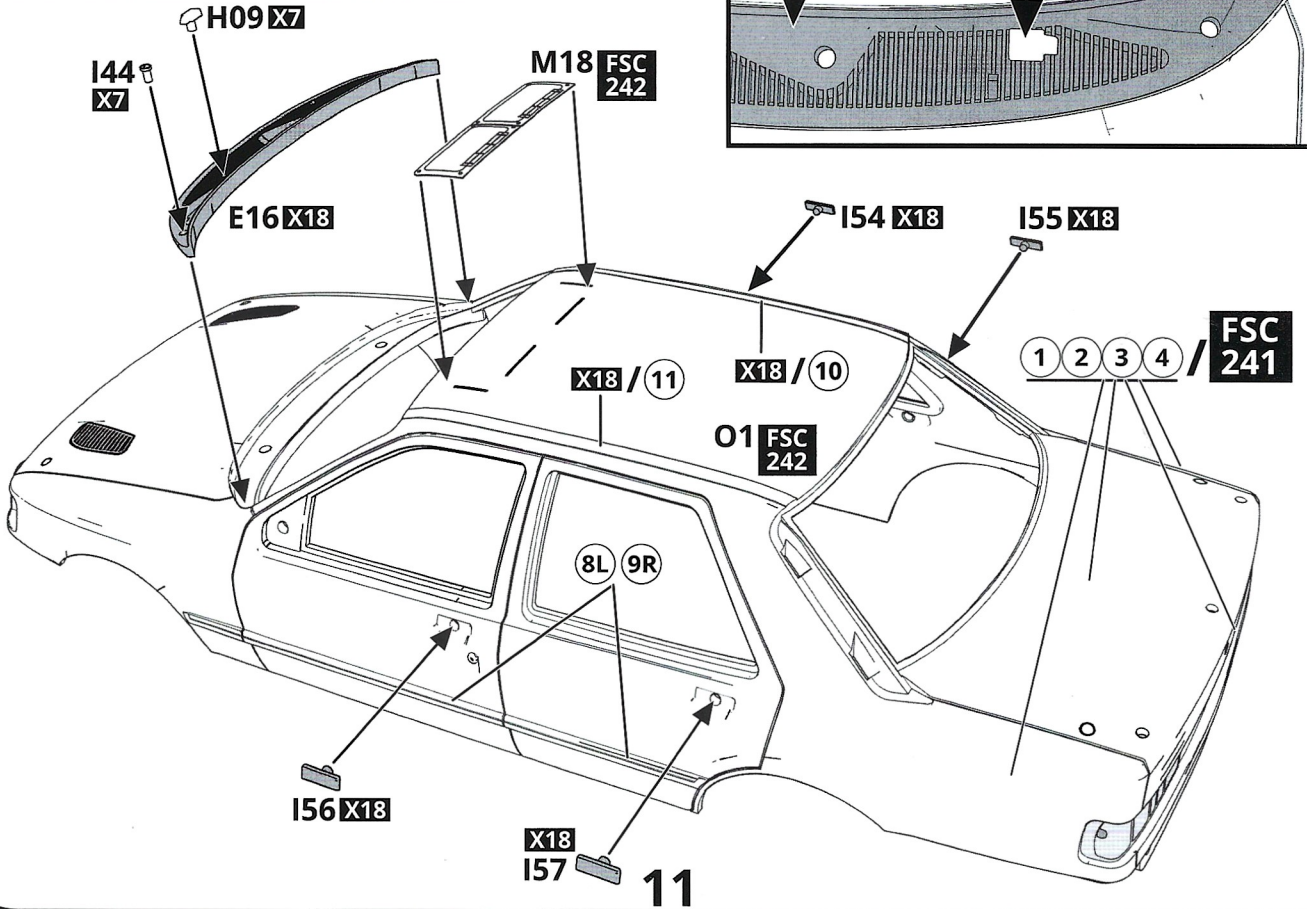
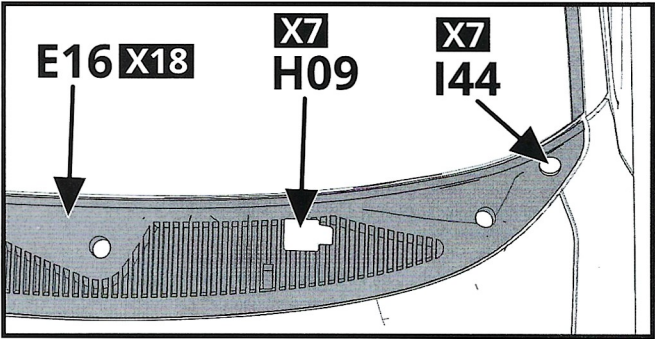
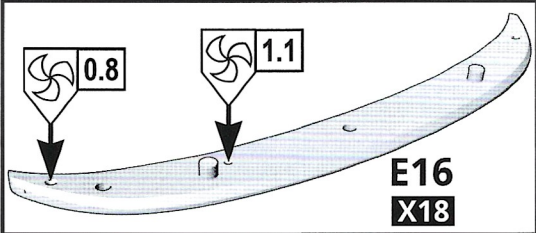

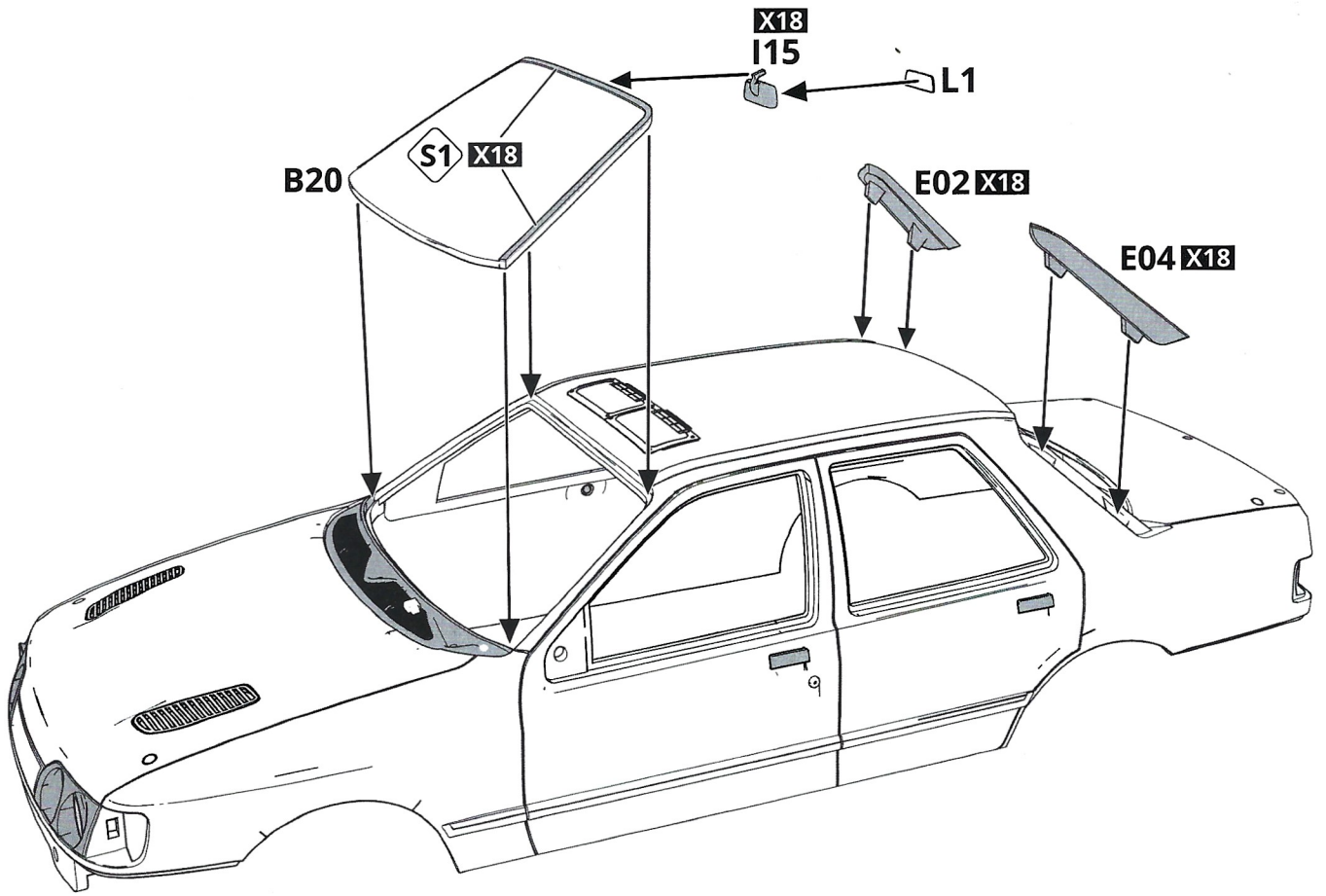

Attaching windows

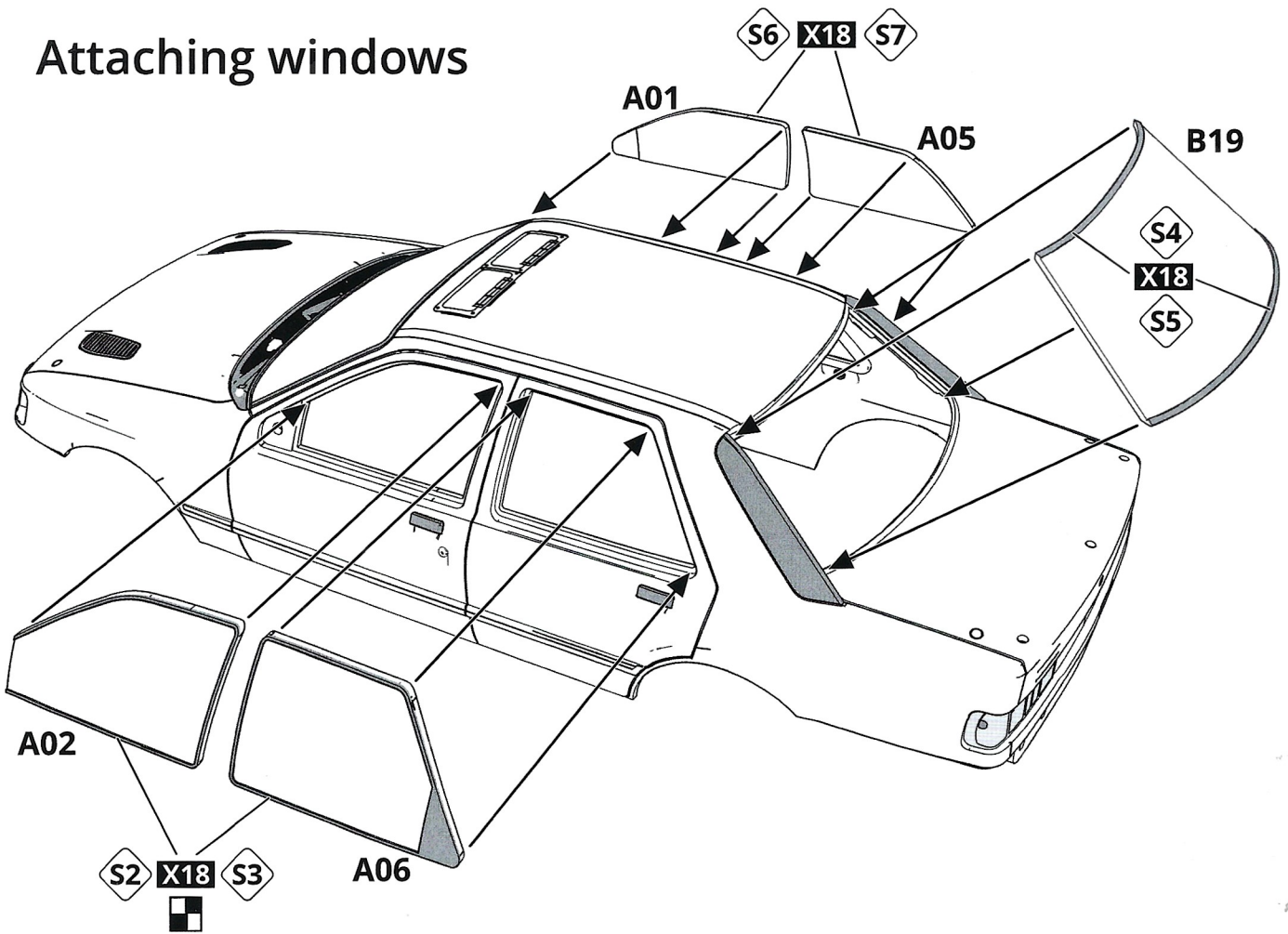

Front light assembly

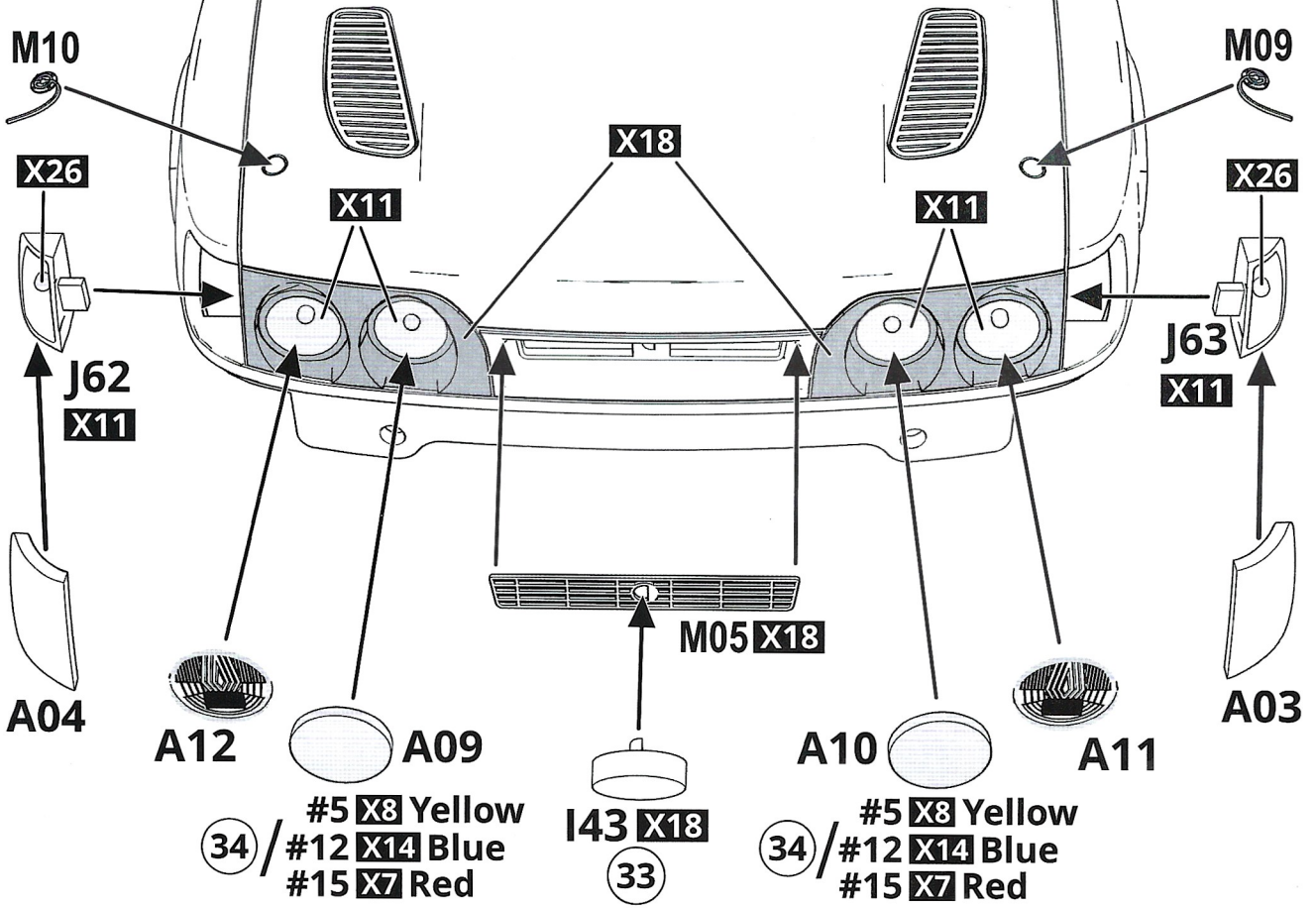

Making holes for Top Antenna and Trunk lock

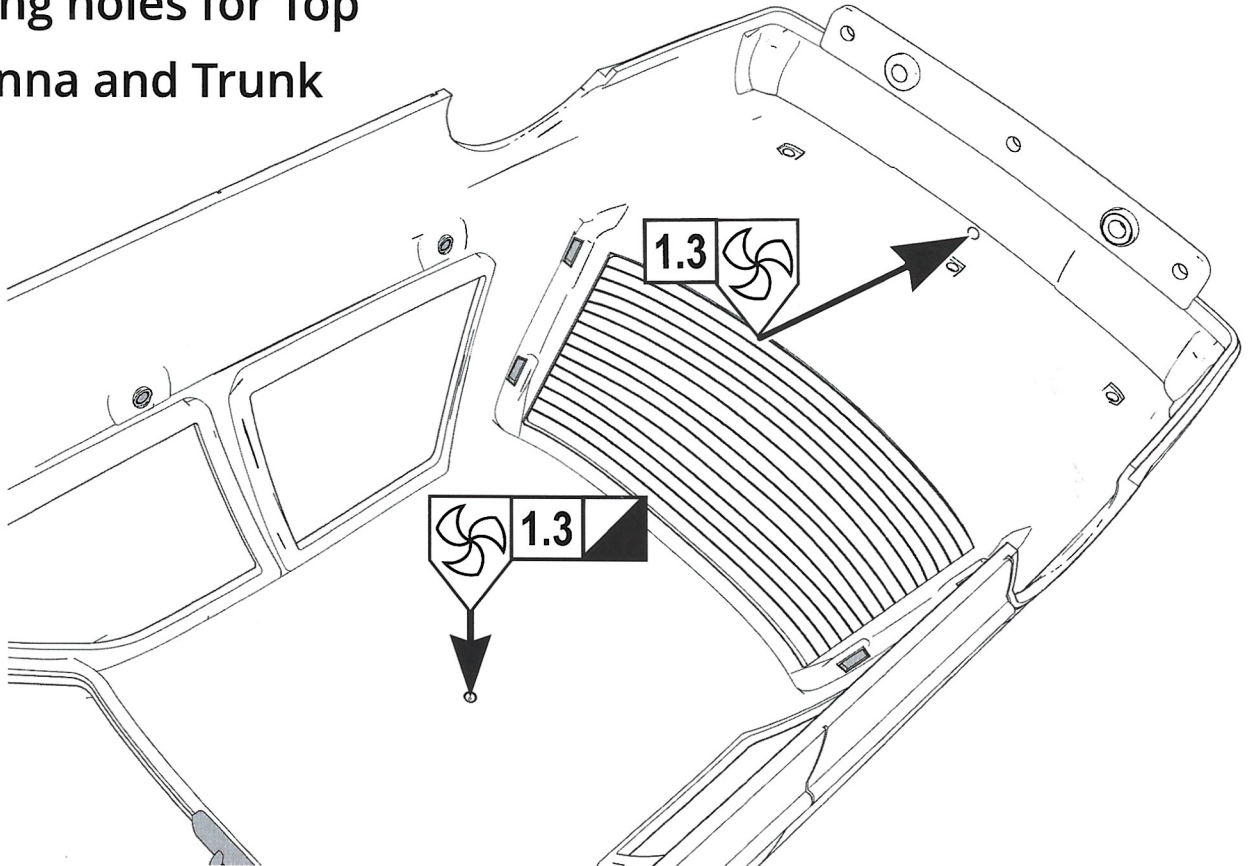

Tail lights assembly

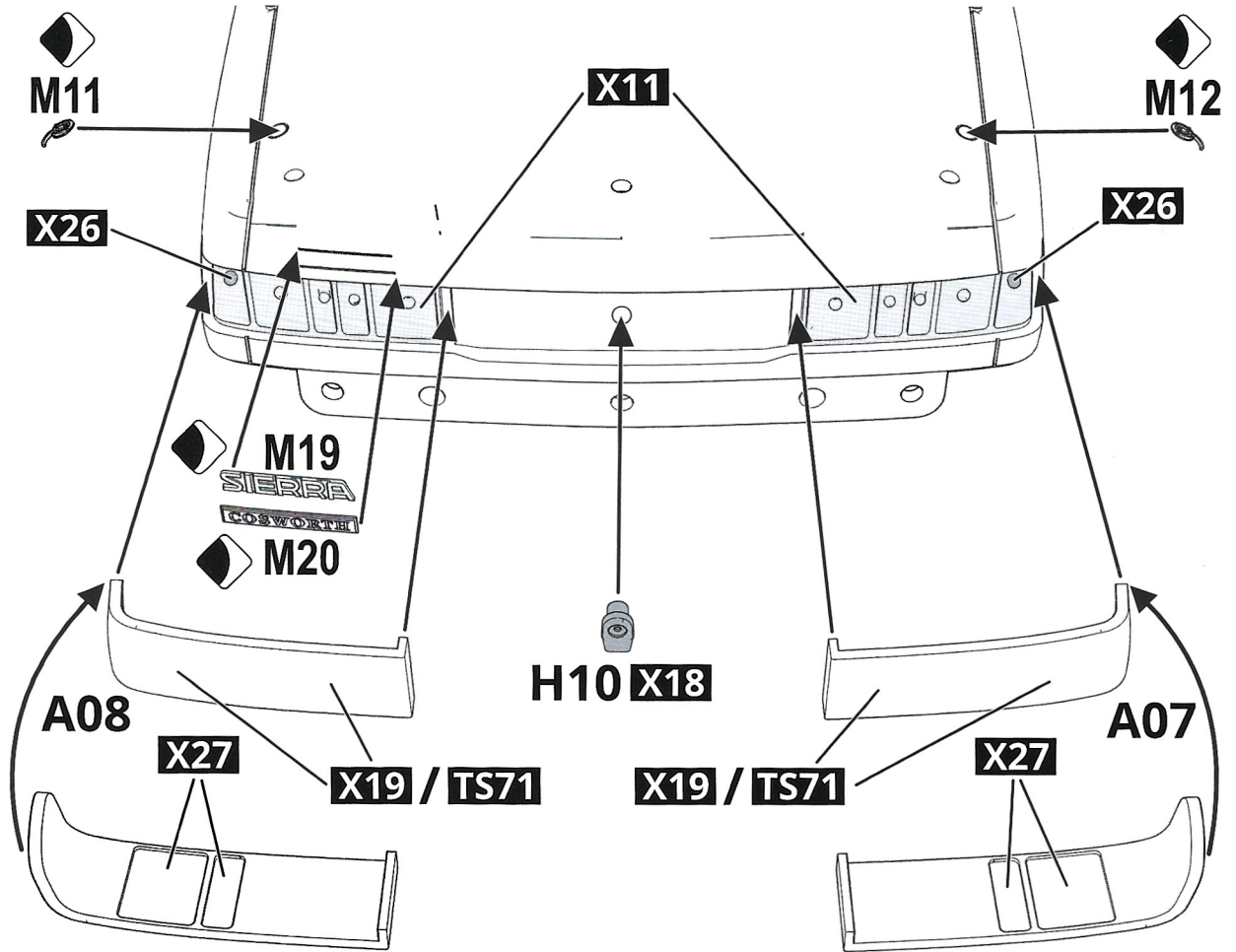
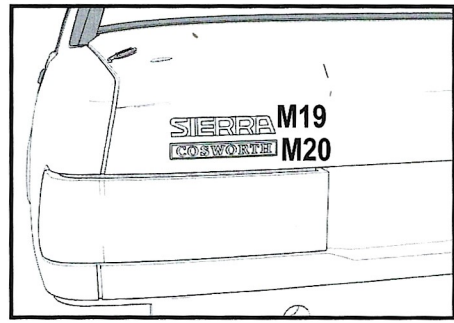

Making holes for optional Headlights

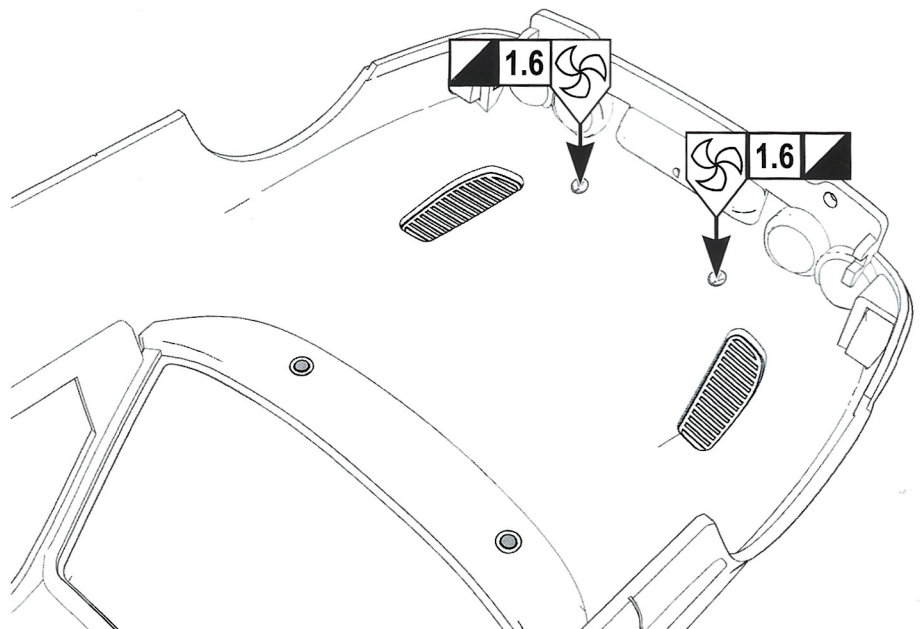

General assembly

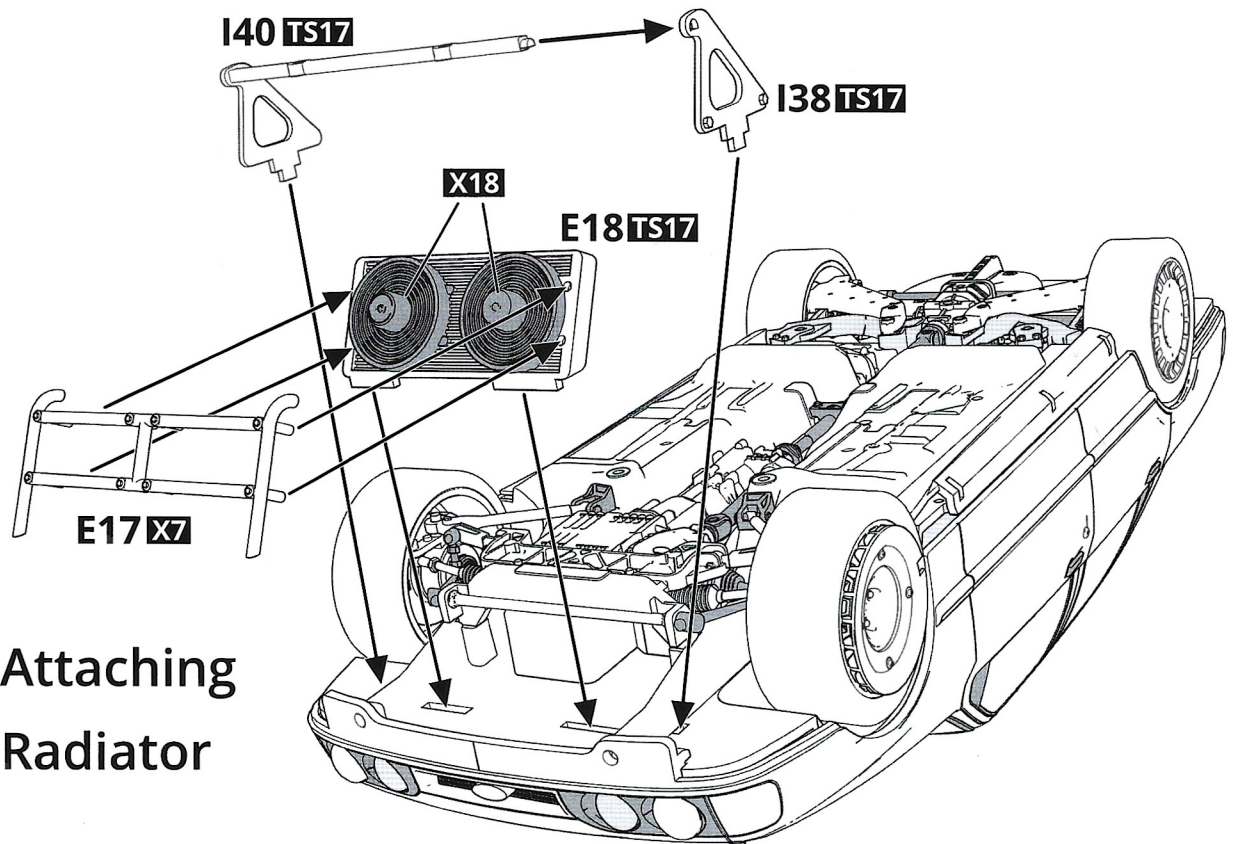
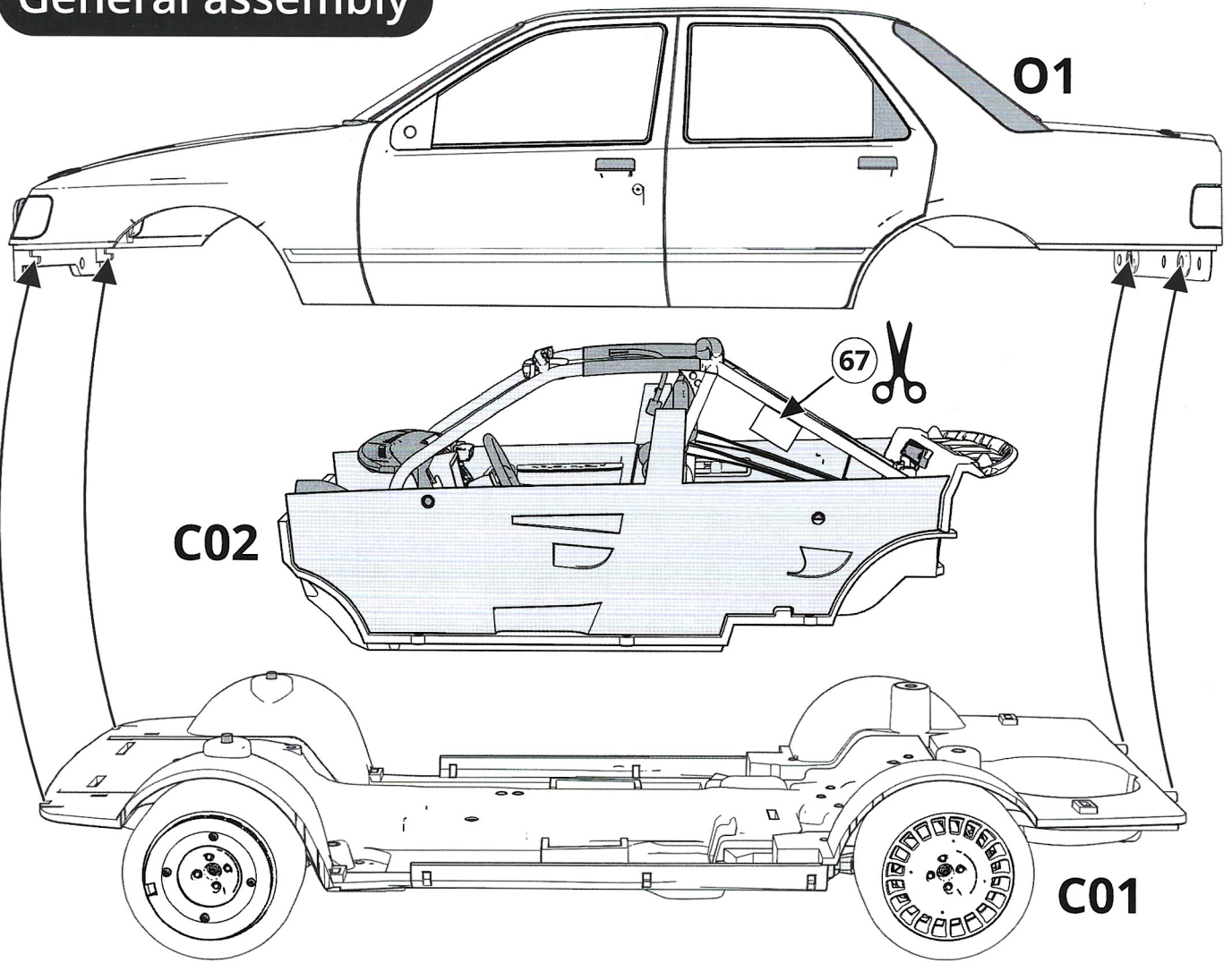

Front Bumper assembly

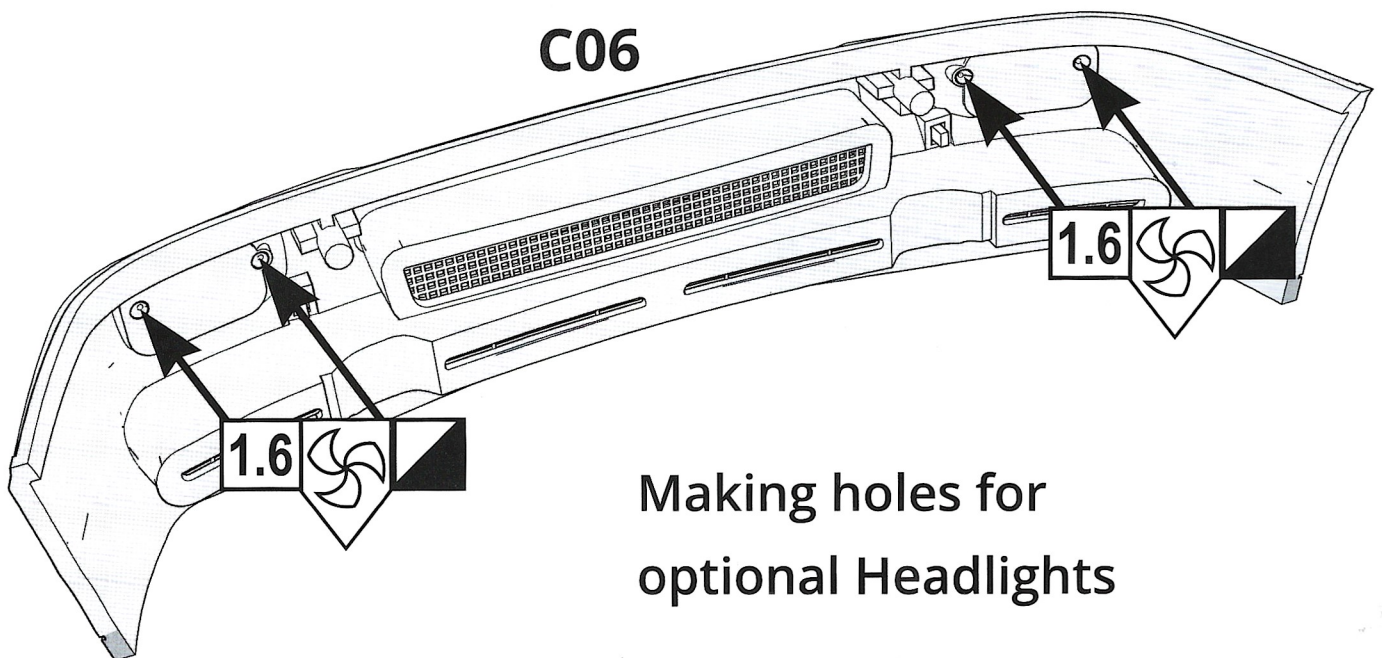
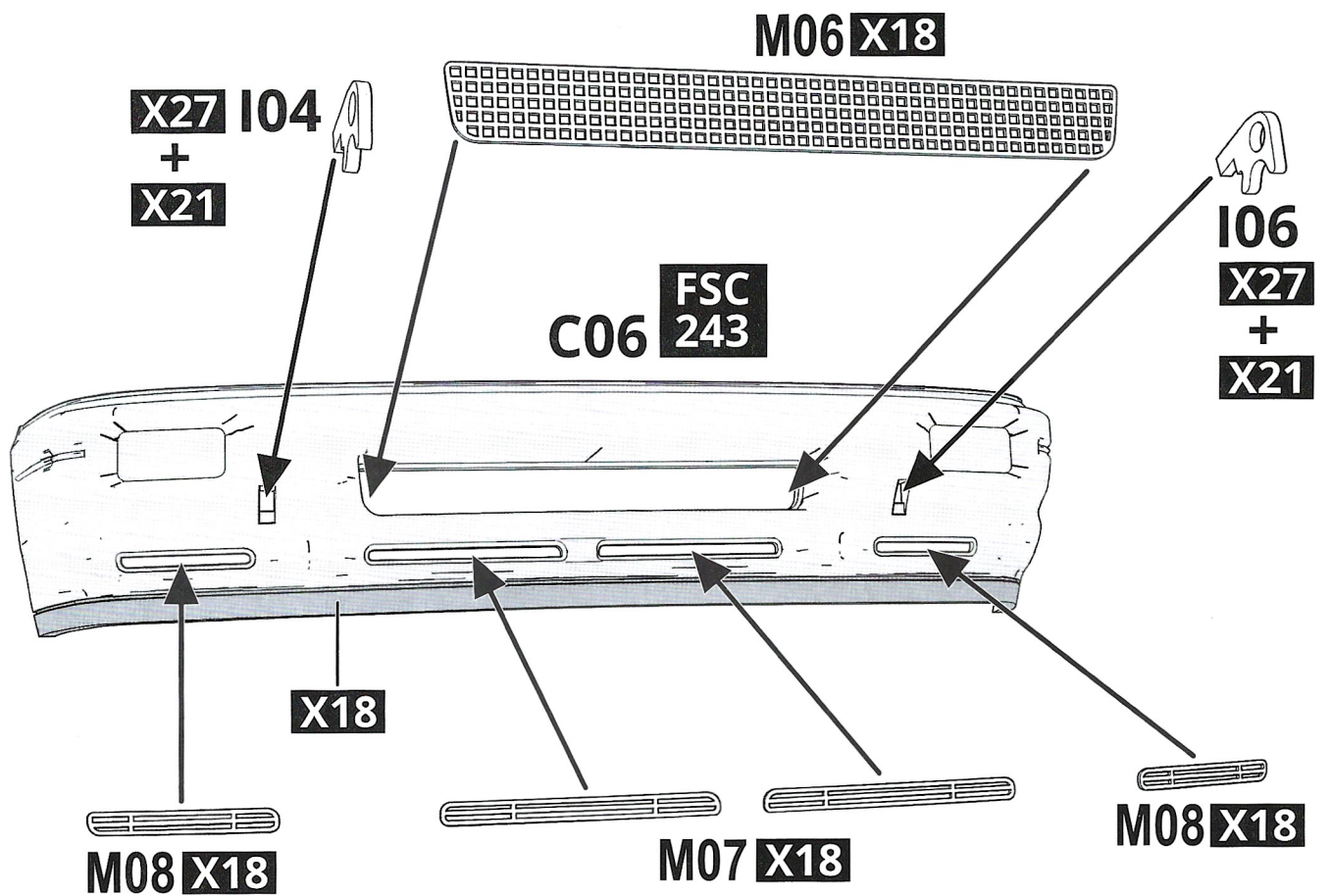

Making holes for optional Headlights

Attaching Front and Rear bumpers

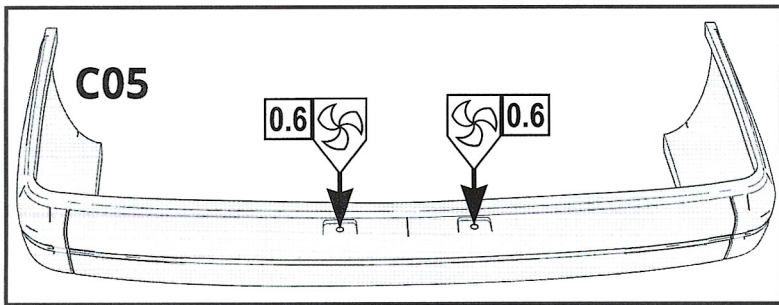
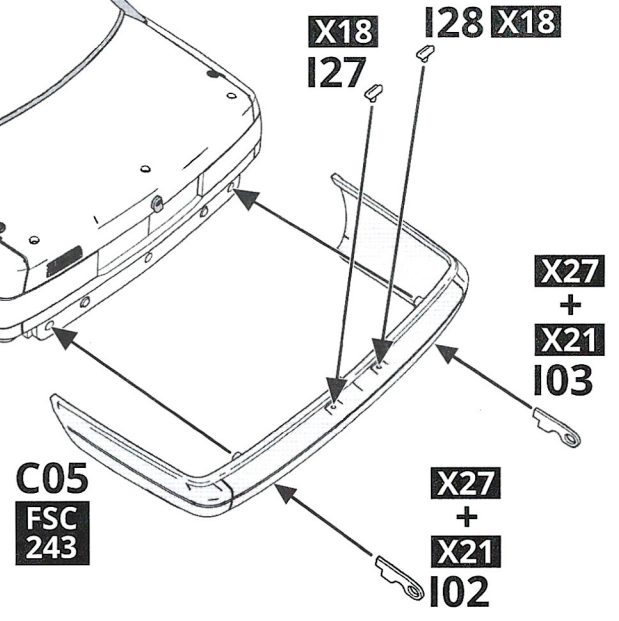
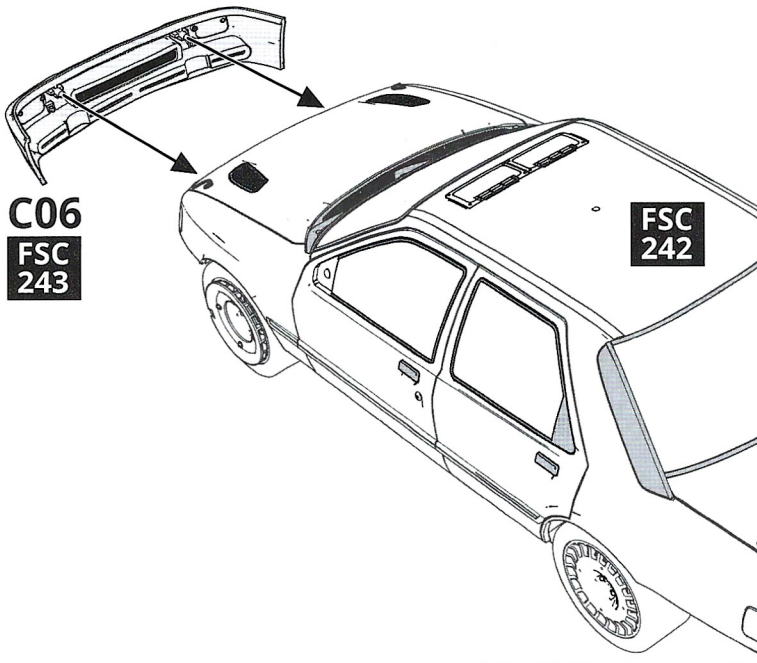

Underside assembly

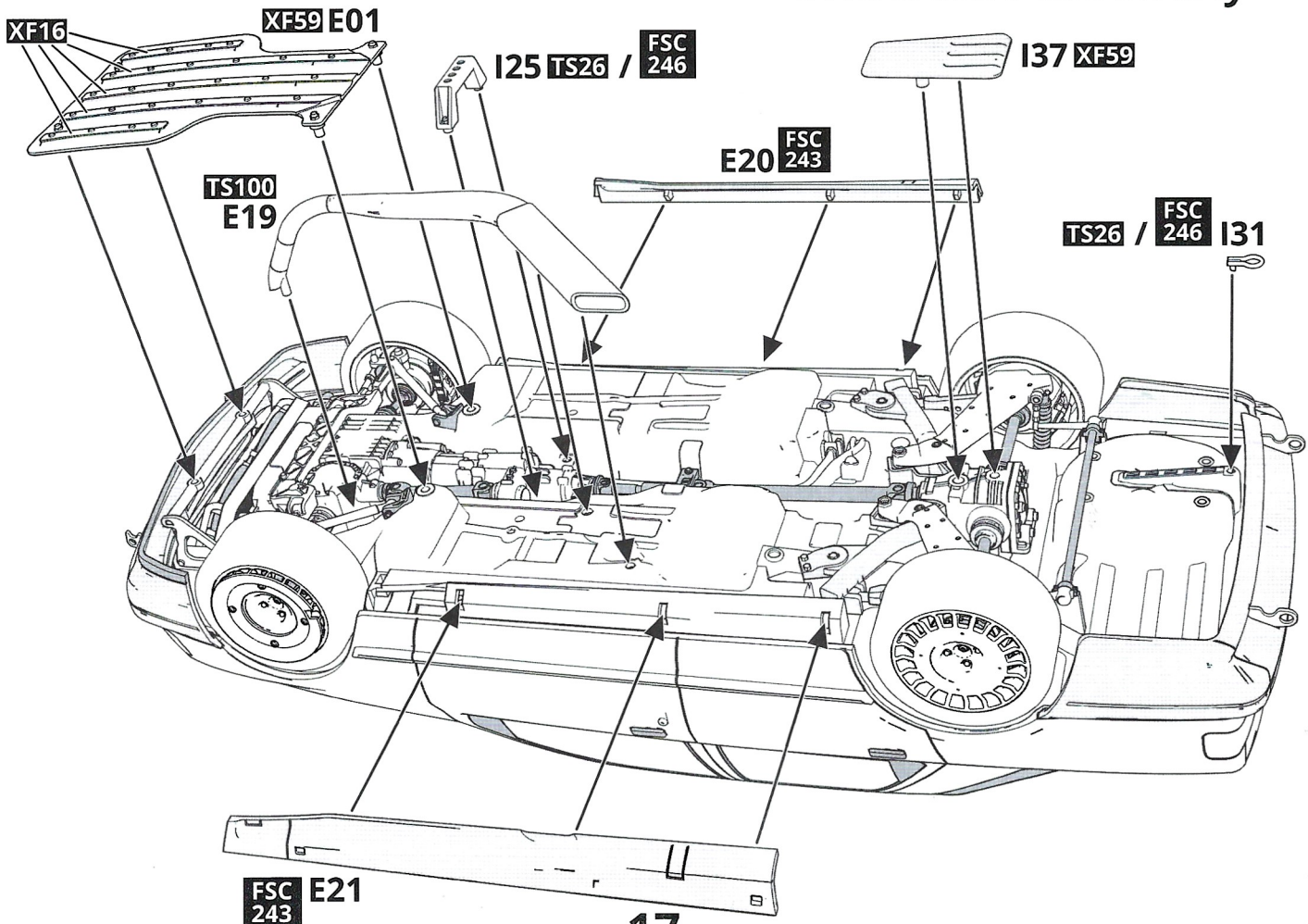

Front Bumper Extra lights assembly

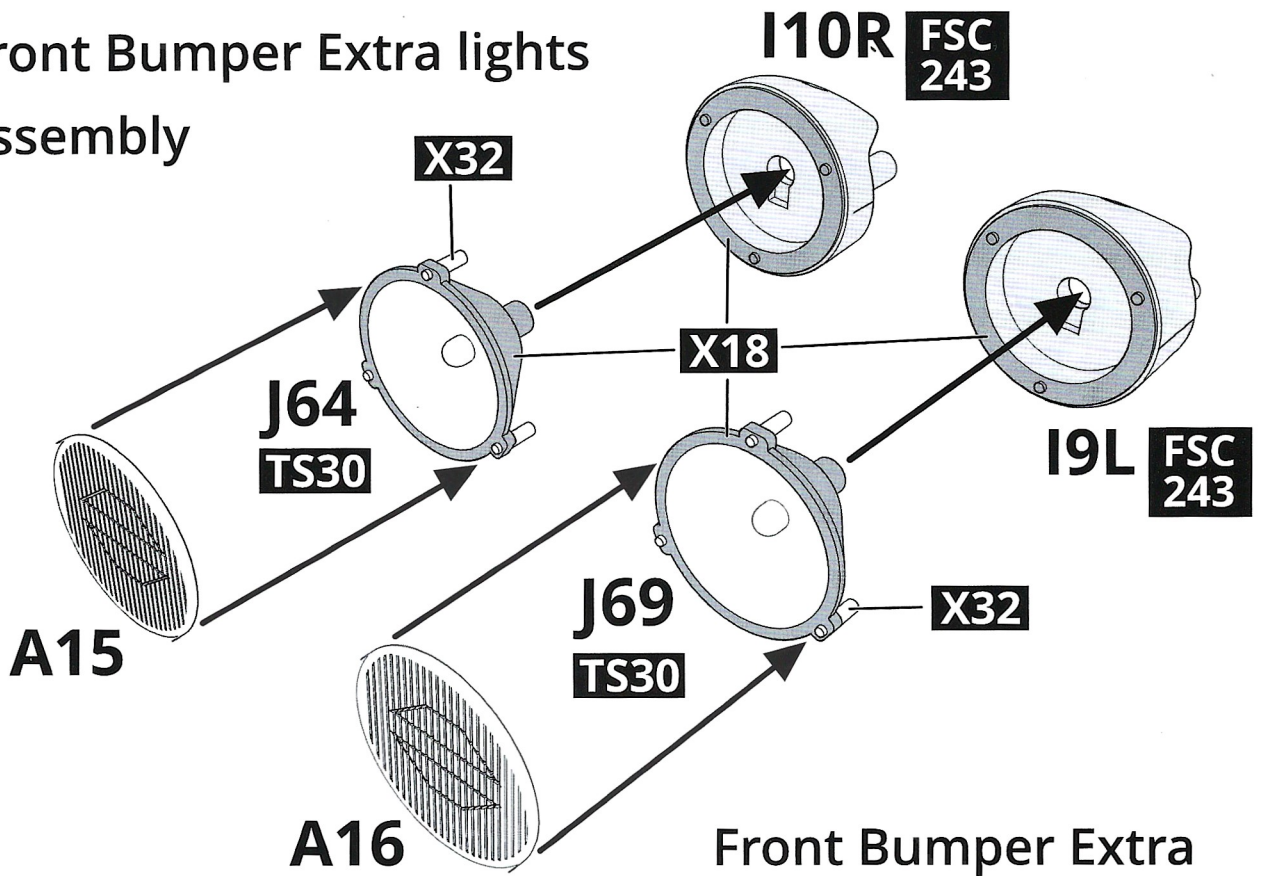

Front Bumper Extra lights attachment

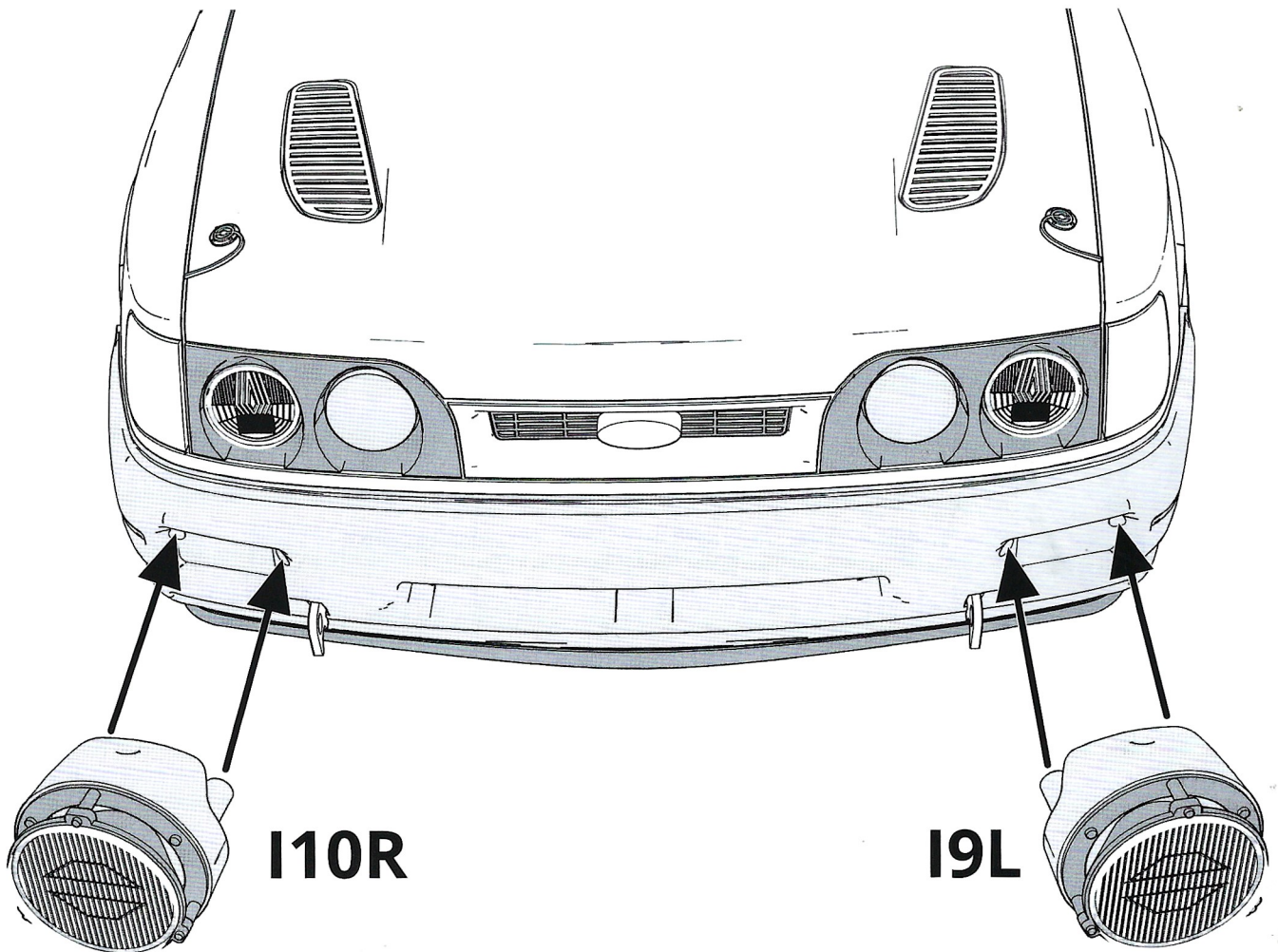

Front Extra Headlights assembly

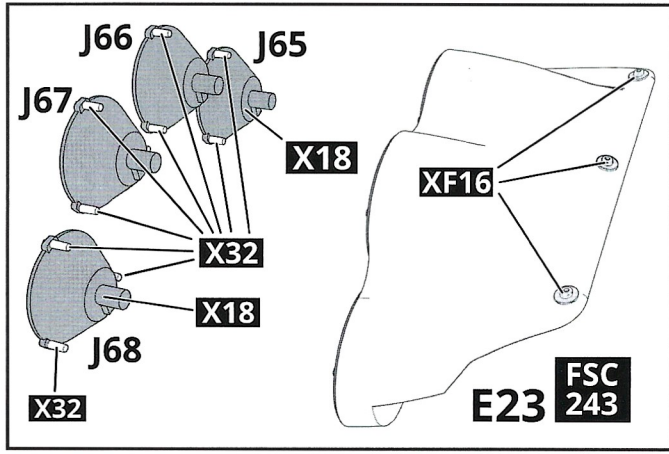
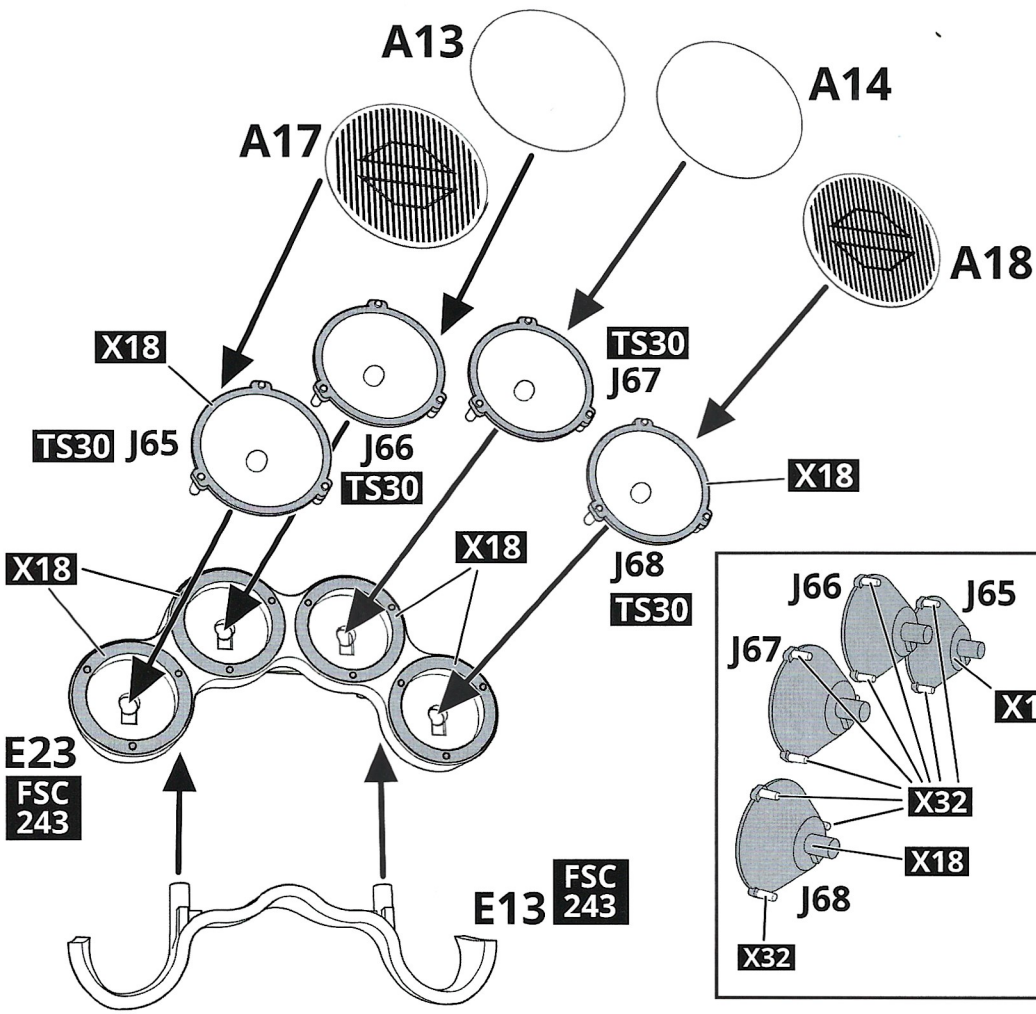

Front Extra Headlights attachment

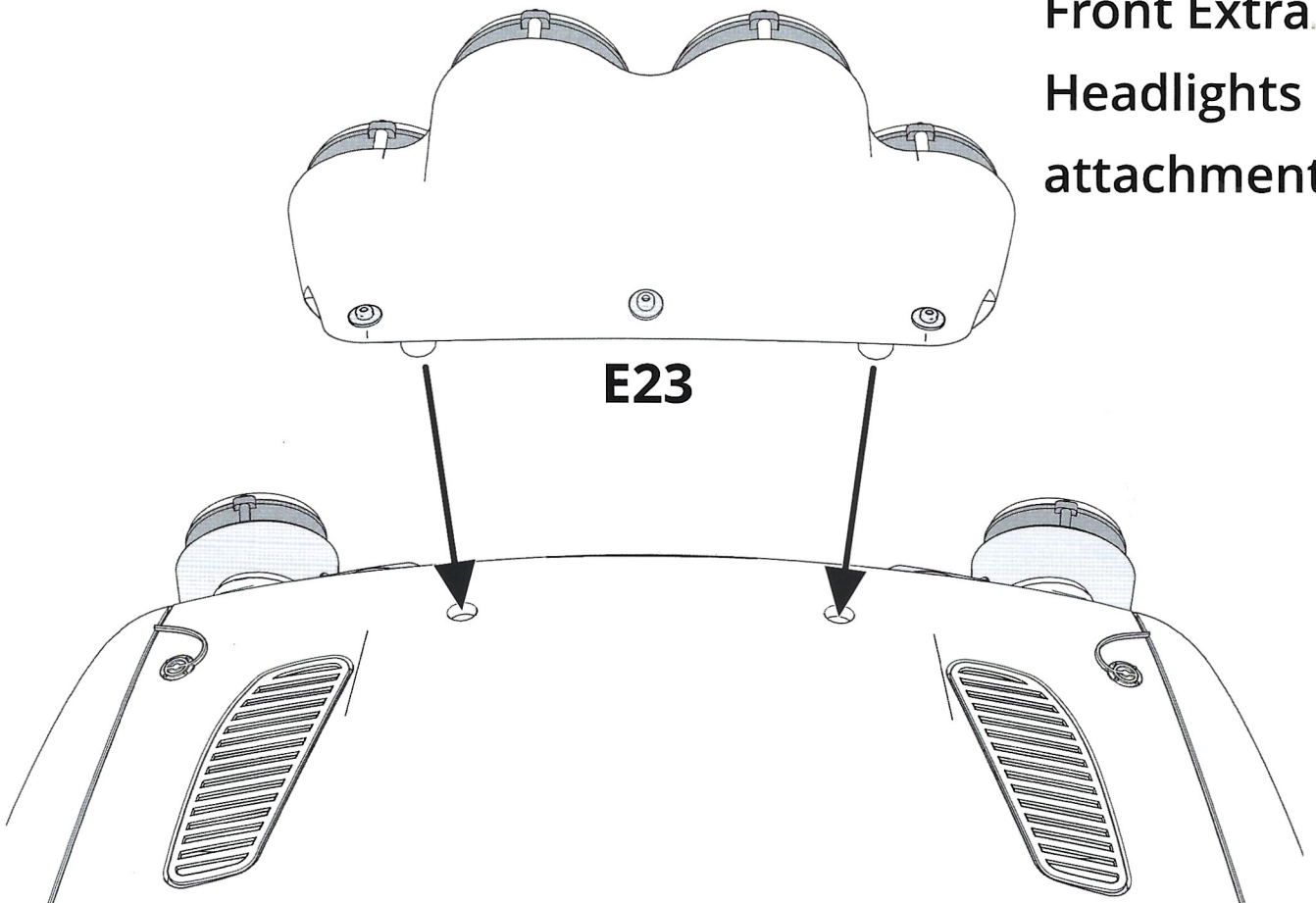

Front Extra Headlights alignment

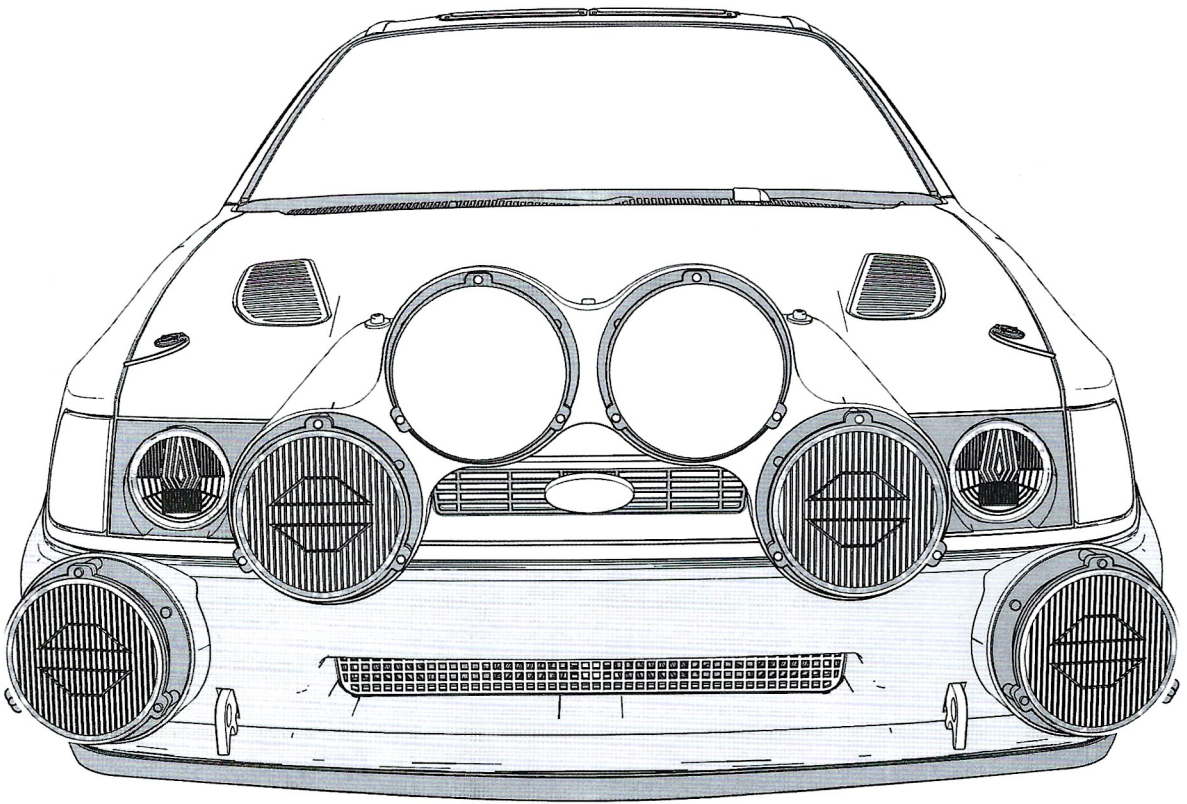

Wipers , Side mirror ,
Spoiler and Antenna
attachment

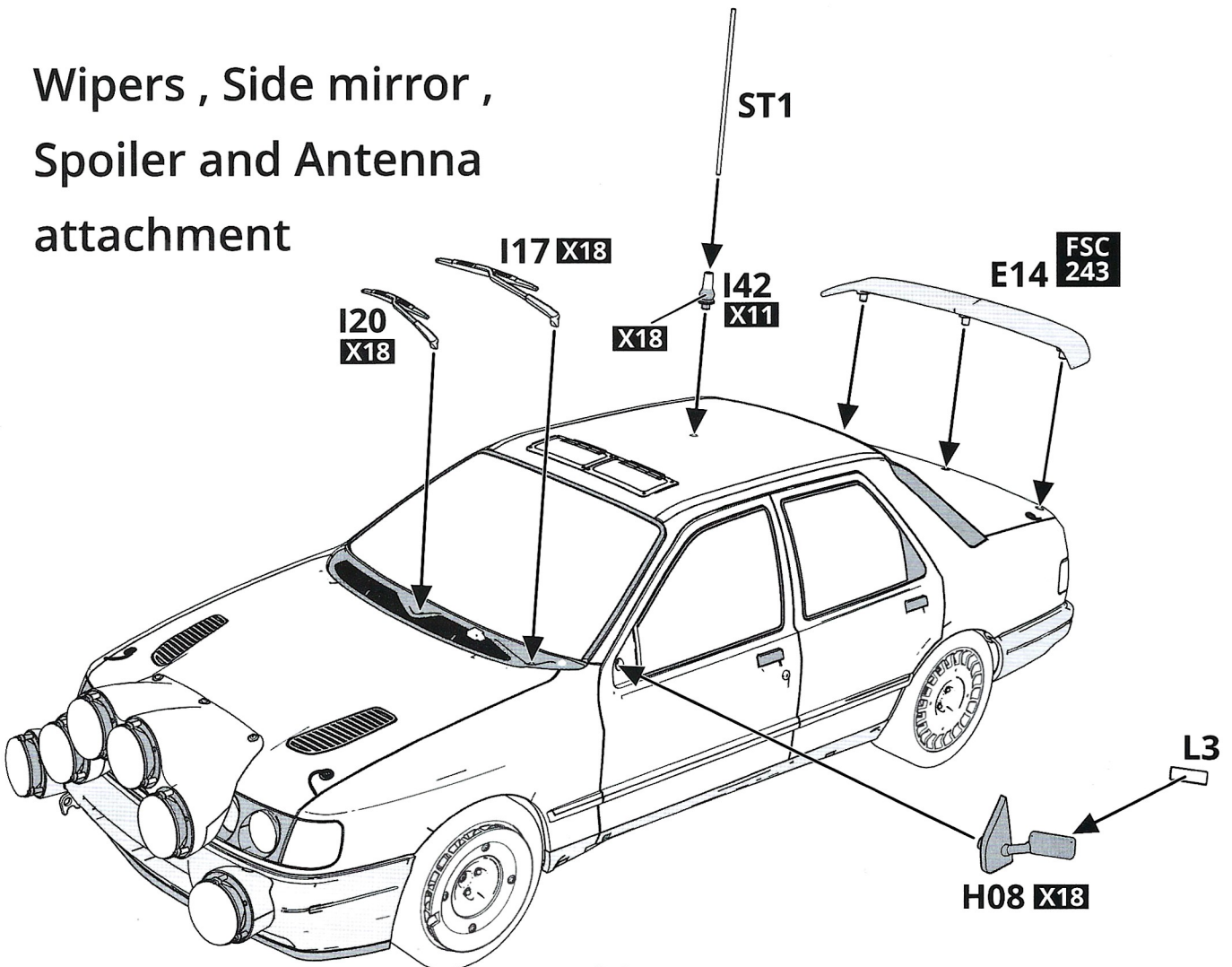

Completed

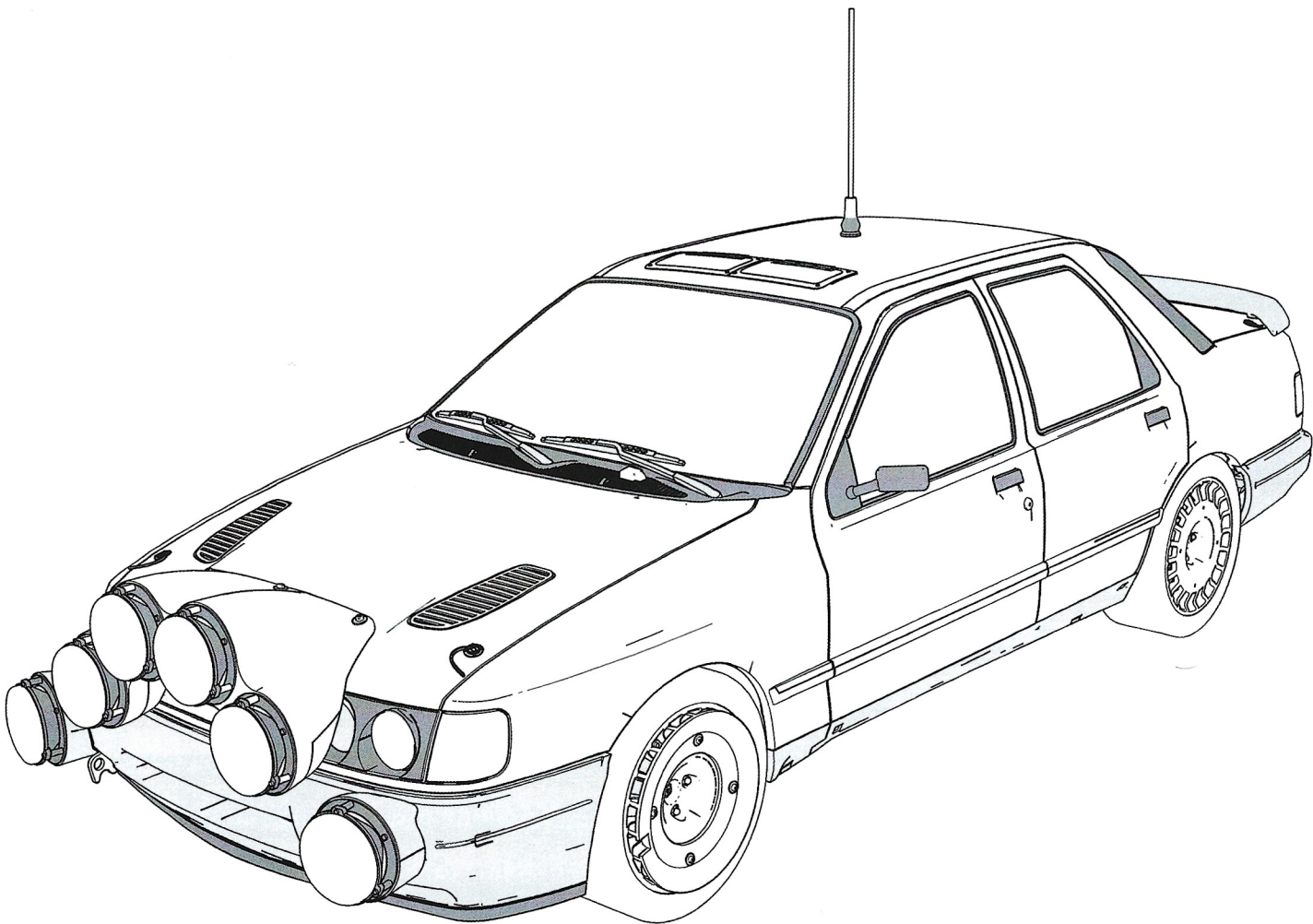

Parts

Do not use dark shaded parts

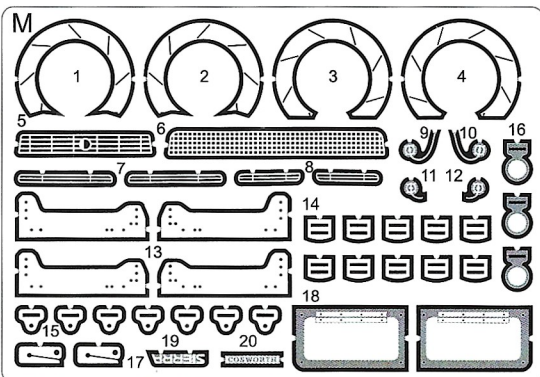
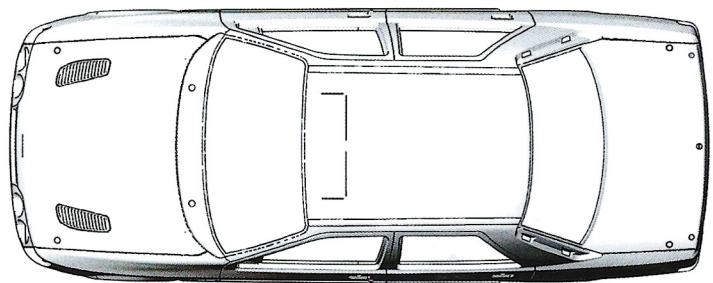
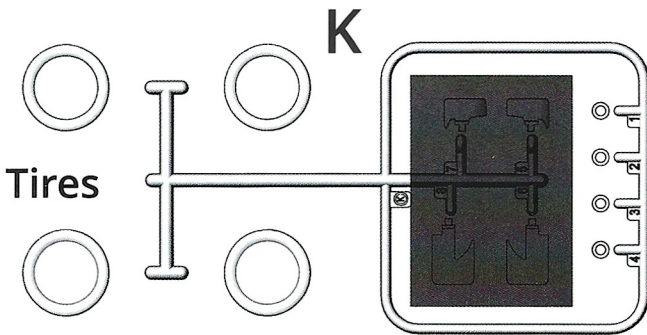
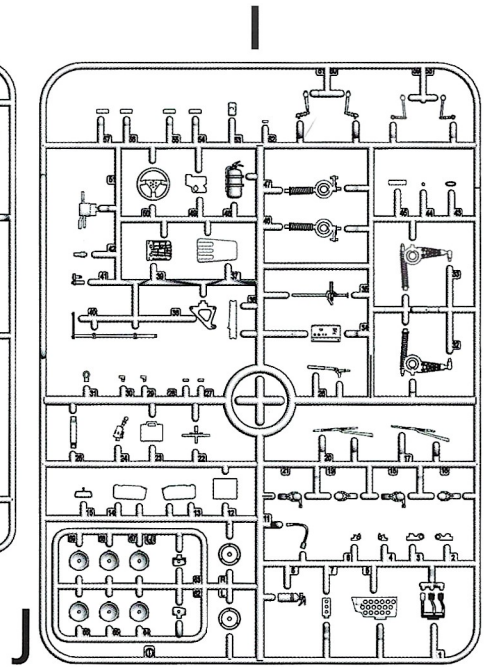
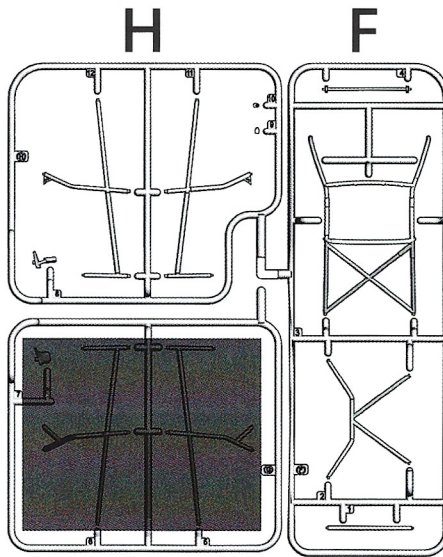
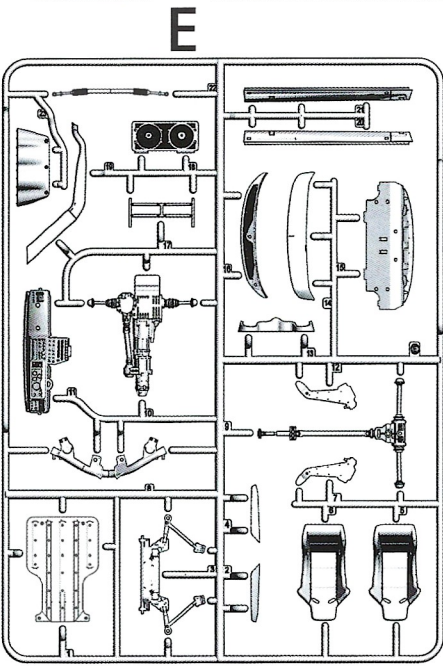
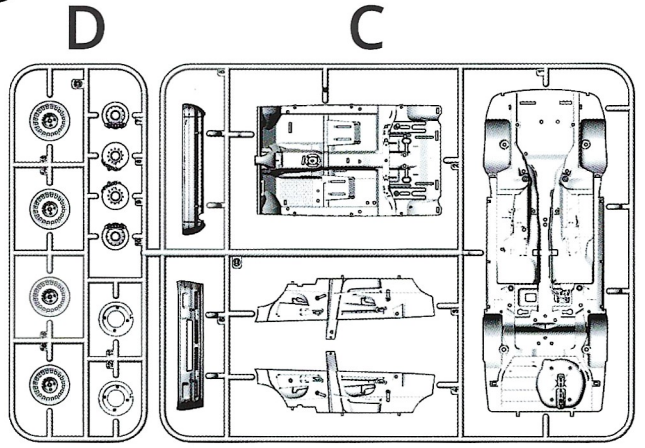
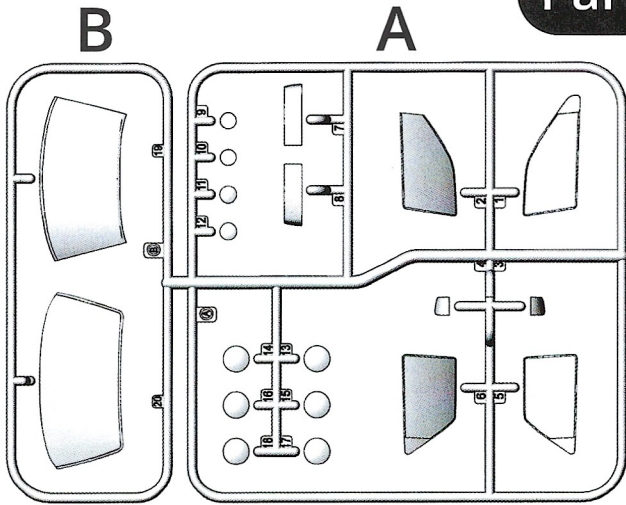

Labels

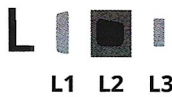

T Belts

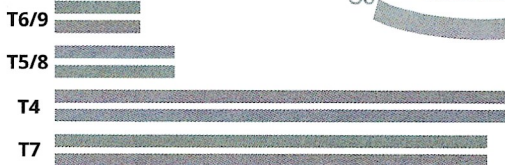

O Body

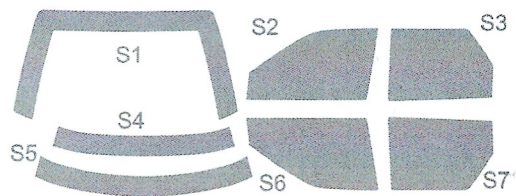

S Stencils

ST Antenna

Photo Etching M

91 RALLYE MONTE-CARLO

#12 François Delecour - Anne-Chantal Pauwels - 3rd

#15 Malcolm Wilson - Nicky Grist - 7th

#5 Alessandro Fiorio - Luigi Pirollo - 10th

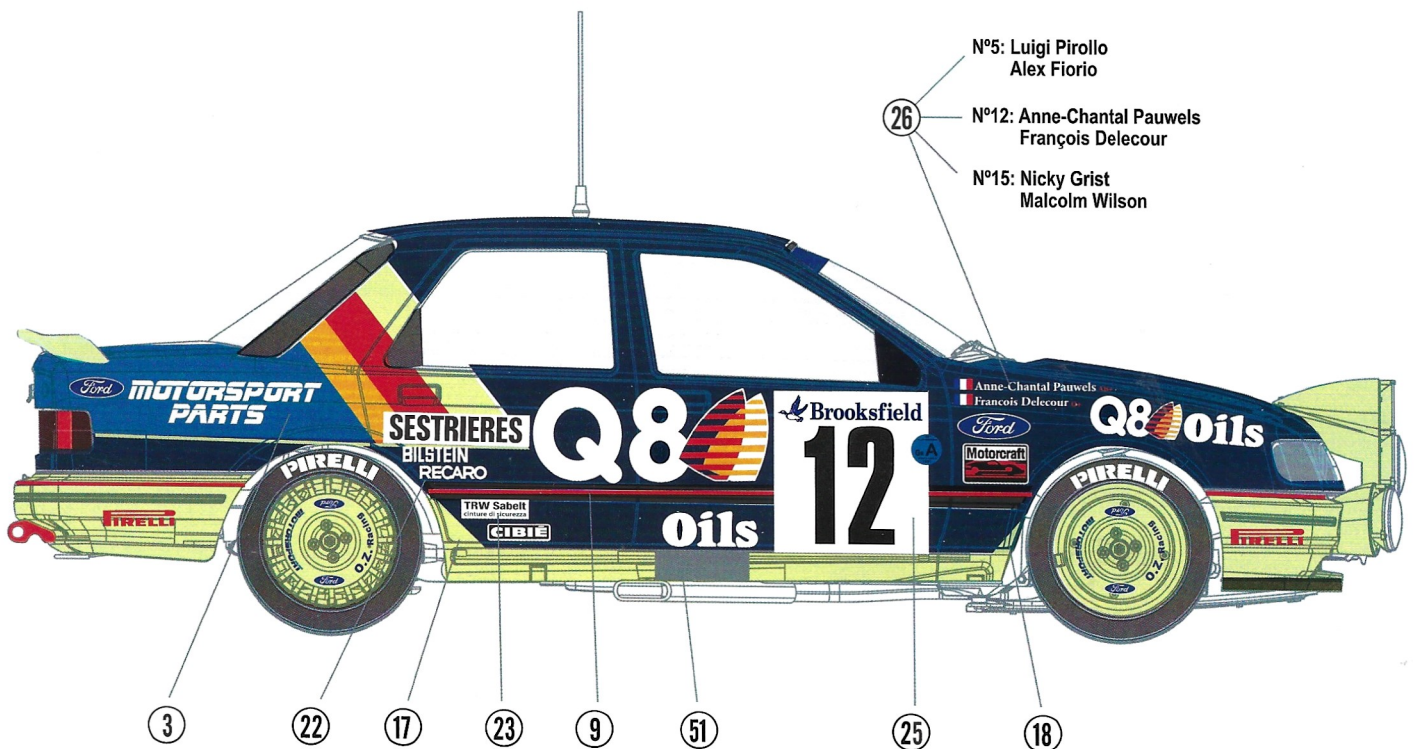
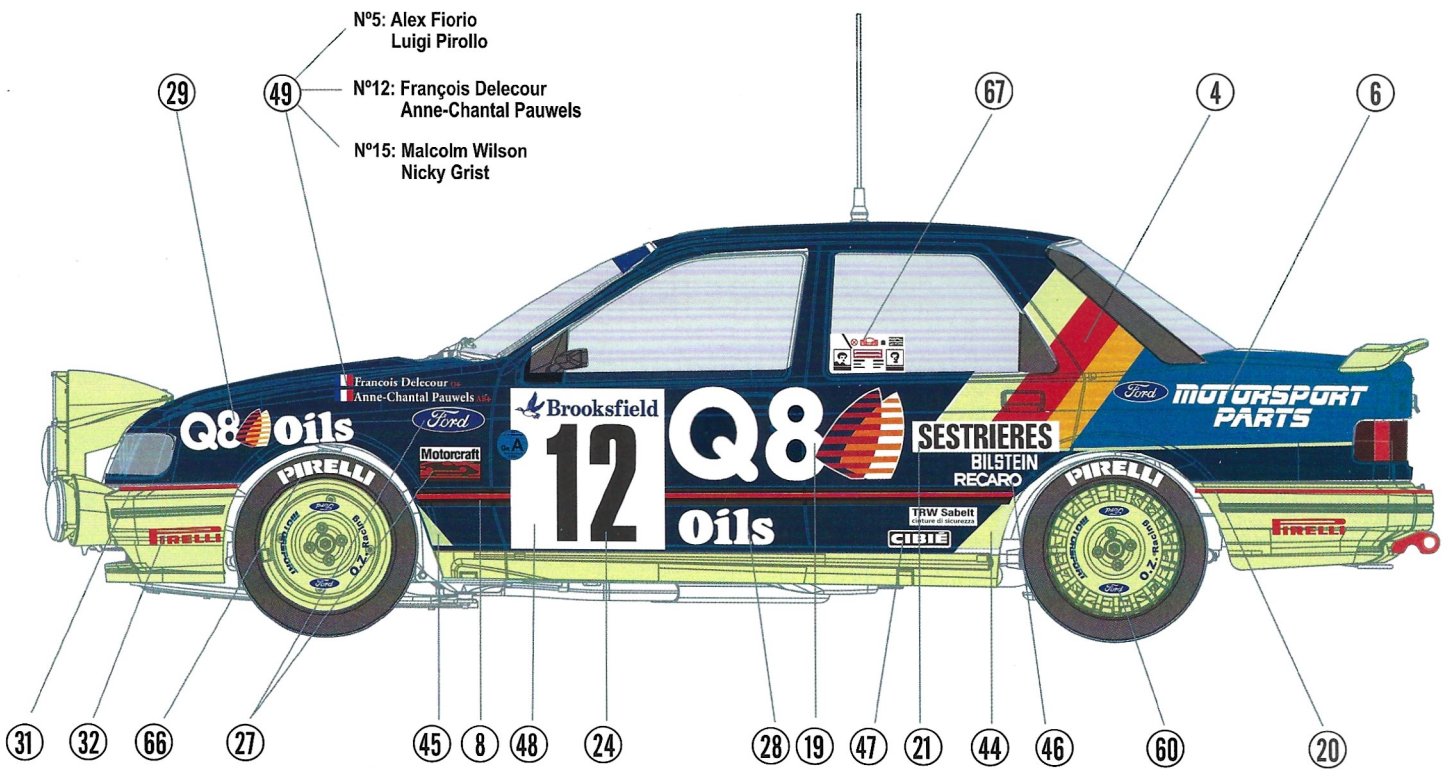

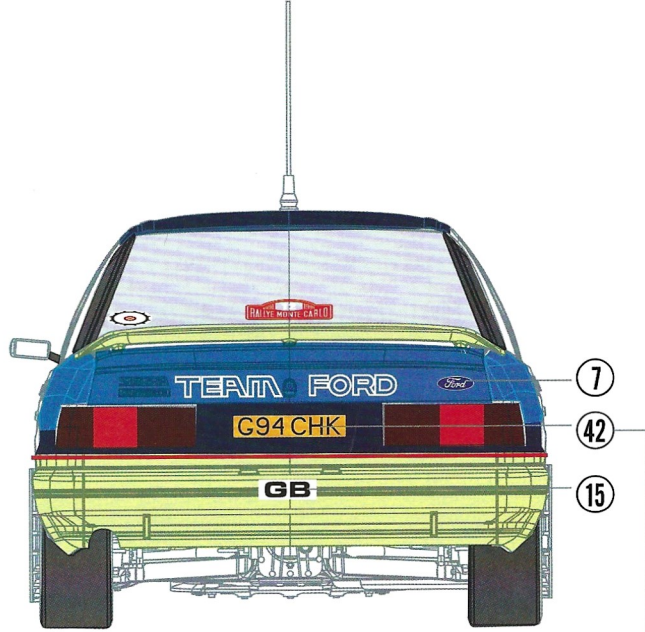
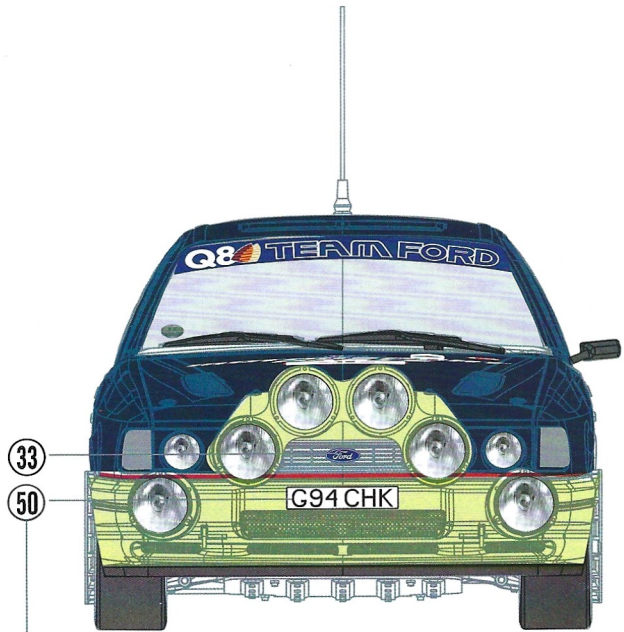
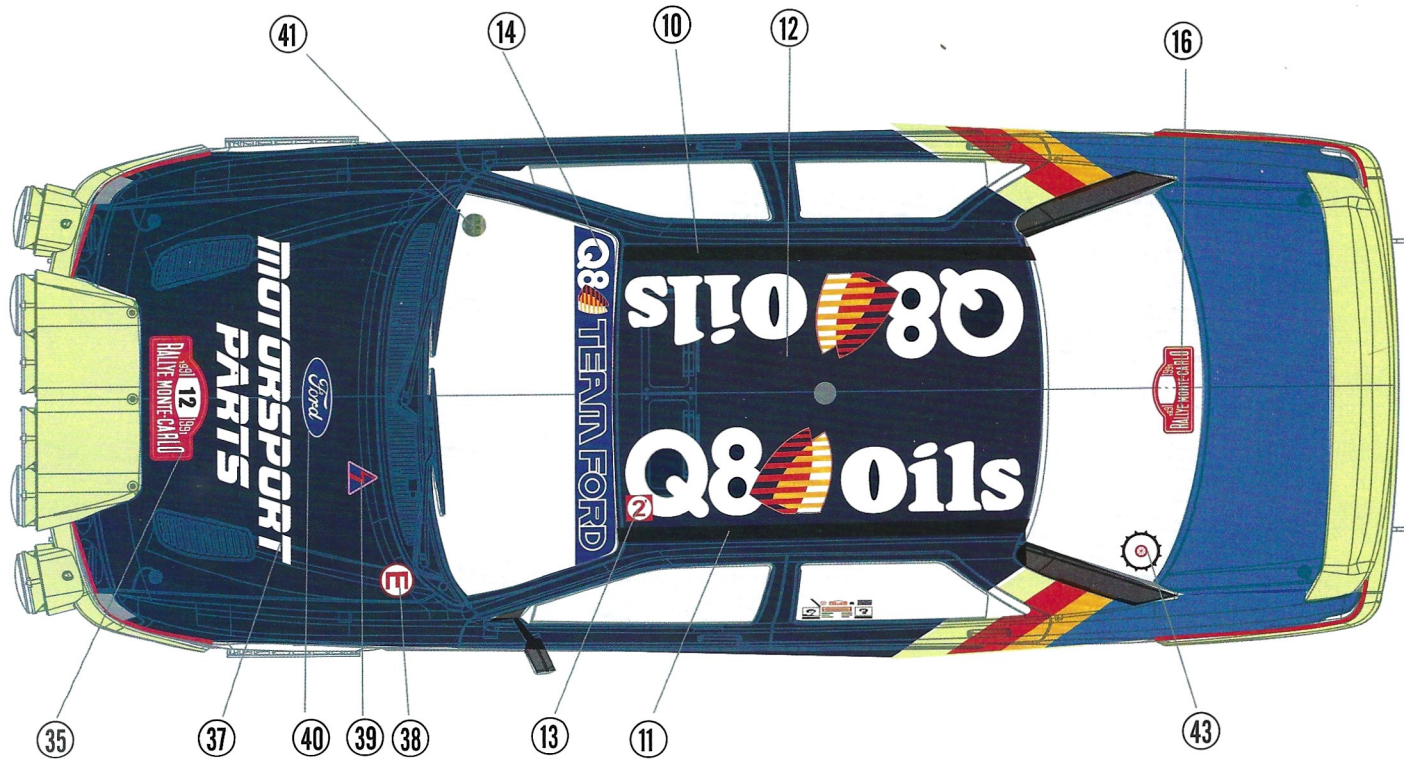

- N°5: G93CHK
- N°12: G94CHK
- N°15: H319MTV

- N°5: G93CHK
- N°12: G94CHK
- N°15: H319MTV



- N°5: Yellow
- N°12: Blue
- N°15: Red