

USAF C-130H



The C-130 has been serving the United States Air Force since the late 1950's. The C-130H represents one of the most common variations of the C-130 and was operated by every branch of the U.S. military services.

The new Minicraft C-130H represents a United States Air Force and Air National Guard C-130H widely used in both domestic service and with reserve units serving overseas. This kit features accurate 1/144 scale with opening rear cargo door, finely recessed panel lines and new markings representing a United States Air Force and Air National Guard.

The following markings are included in this kit:
U.S. Air Force Reserve, 911 AW, Sept 2010
Illinois Air National Guard, 182 AW, April 2008

Minicraft Models, 1501 Commerce Drive, Elgin IL 60123 USA
www.minicraftmodels.com

'A' FUSELAGE PARTS SPRUES

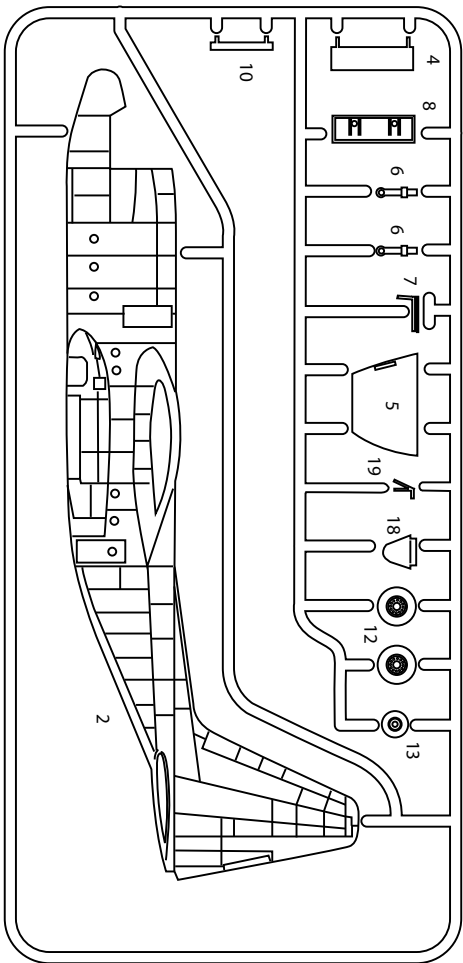
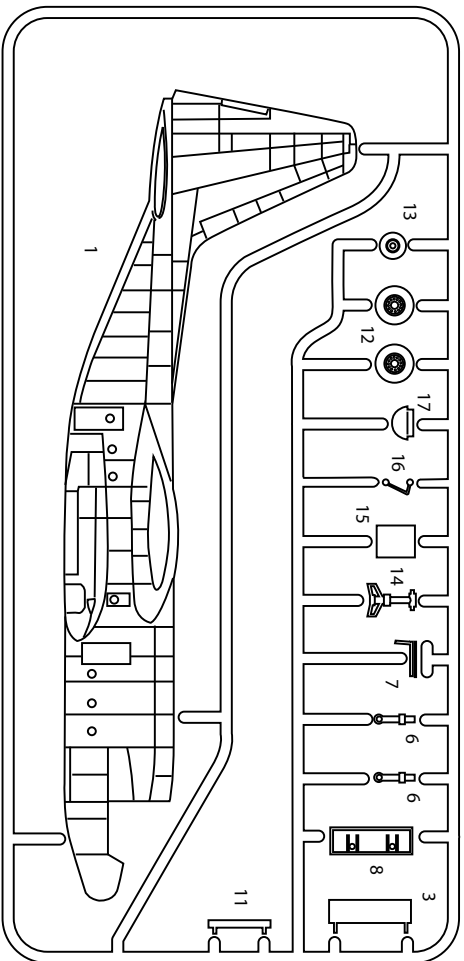

'B' WING / ENGINE / TANK PARTS SPRUE

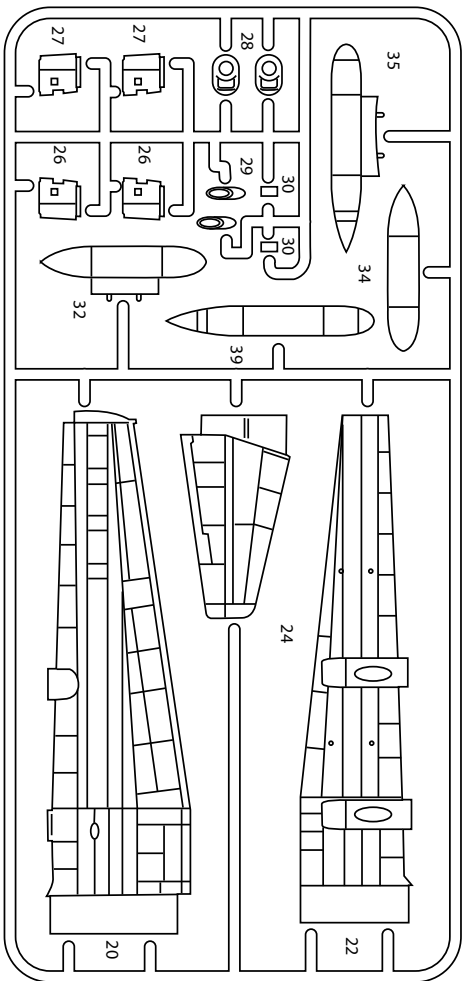
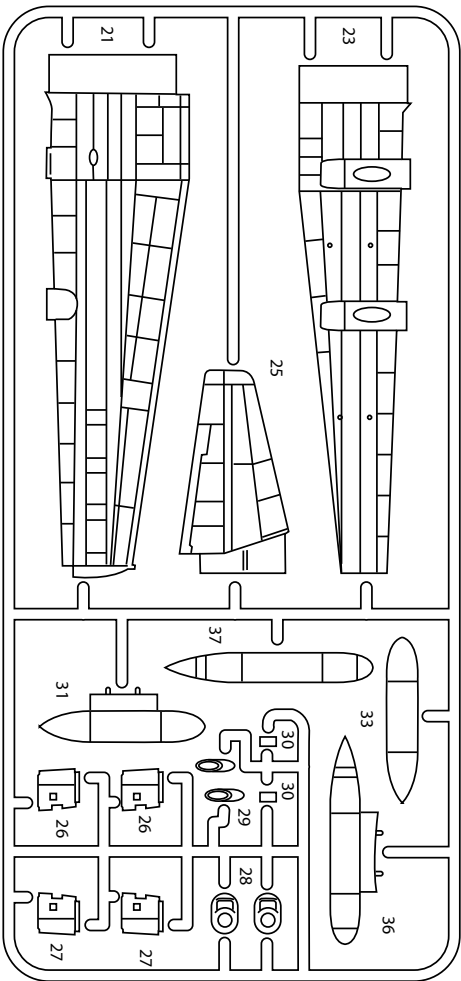

INTERIOR PARTS SPRUE

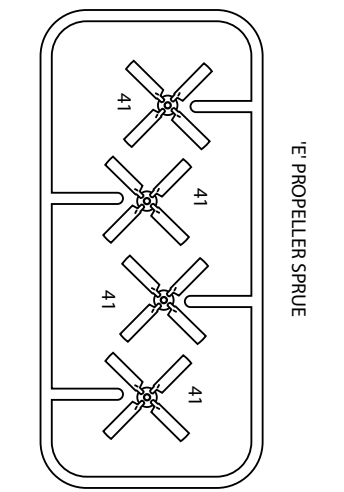

'E' PROPELLER SPRUE

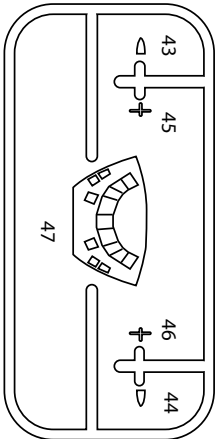

'C' CLEAR PARTS SPRUE

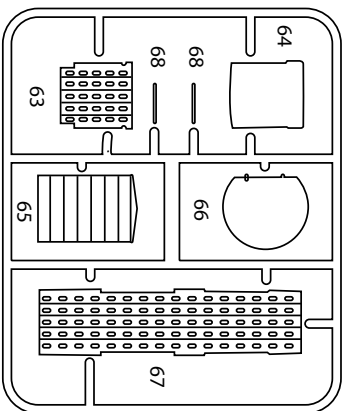

INTERIOR PARTS SPRUE

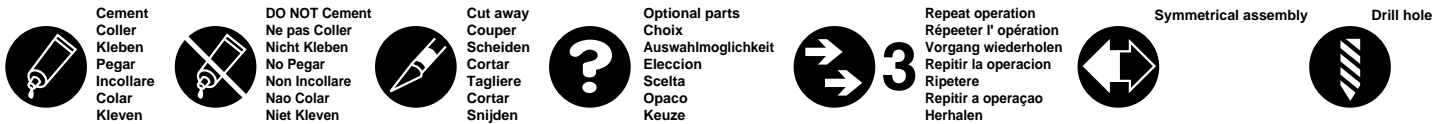

1 WHEEL WELLS

2 • Left (Port) Fuselage / fuselage gauche / linker rumpf
 1 • Right (Starboard) Fuselage / fuselage droite / richtiger rumpf
 5/8 • Wheel well / pousser bien / drehen sie gut



All Parts

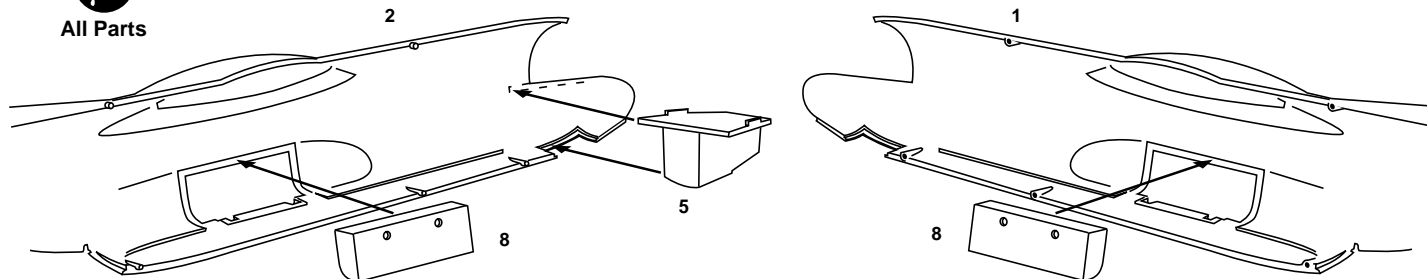

• Cockpit area **FLAT BLACK** or **LIGHT GRAY**

2 INTERIOR ASSEMBLY

66/67 • Interior parts / L'interieur separe / inneres trennt



All Parts

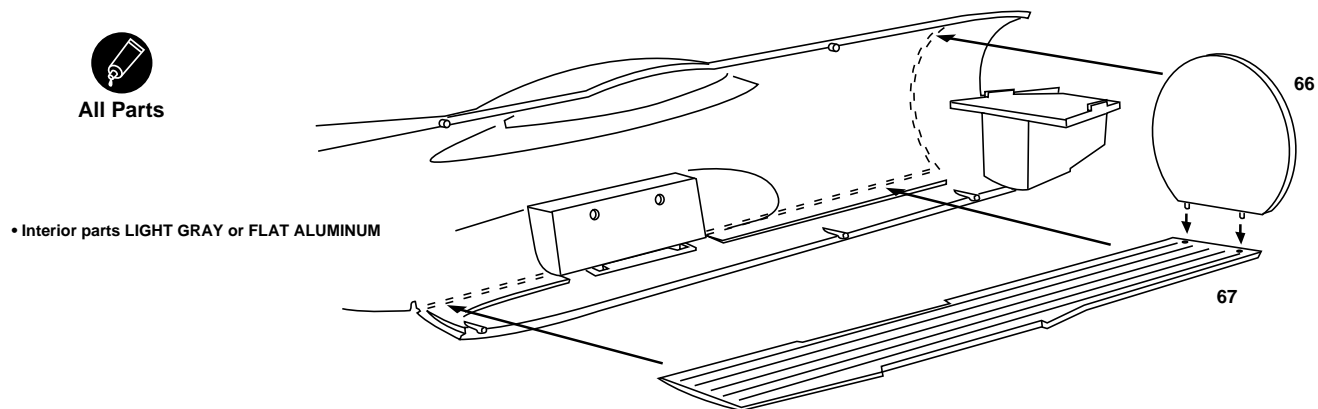

• Interior parts **LIGHT GRAY** or **FLAT ALUMINUM**

3 FUSELAGE ASSEMBLY



All Parts

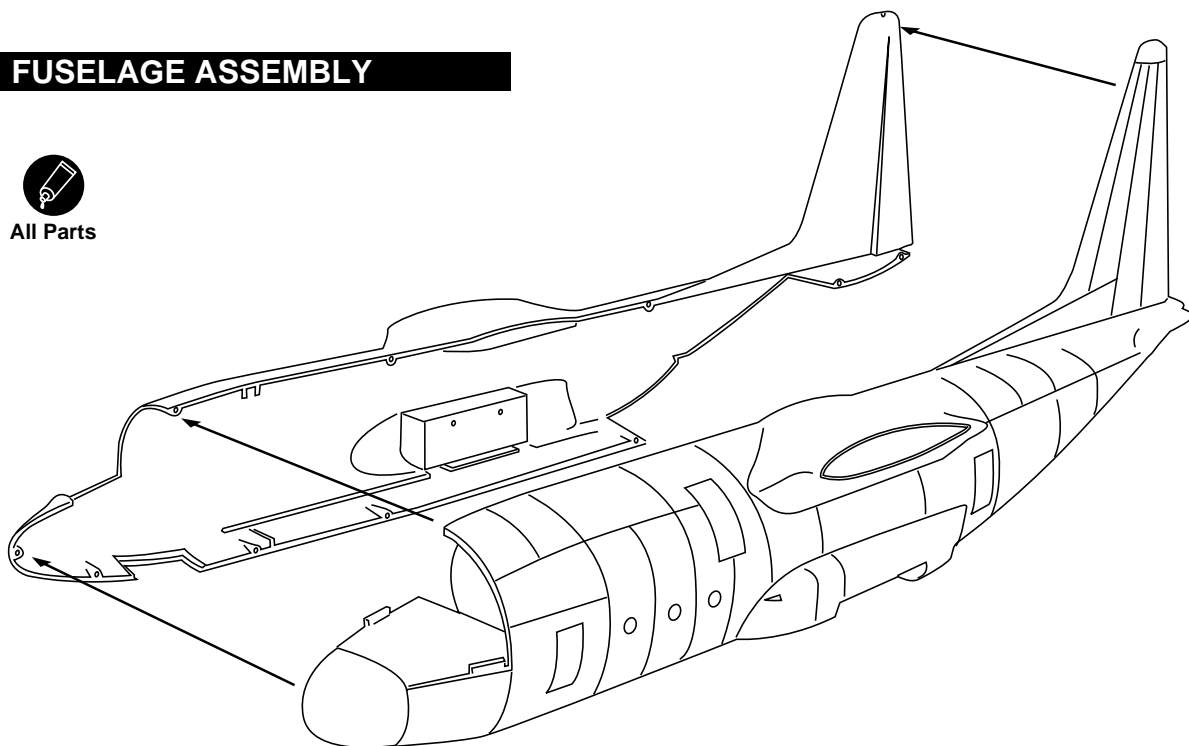

4 NACELLE ASSEMBLY

26/27/28 • Engine Nacelles / nacelles / behelteren
30 • Flap / rabat / klappe

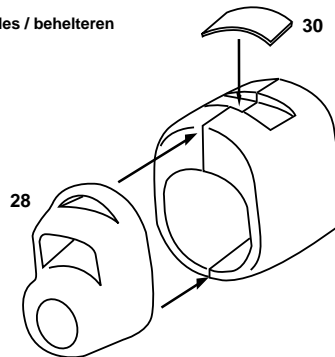
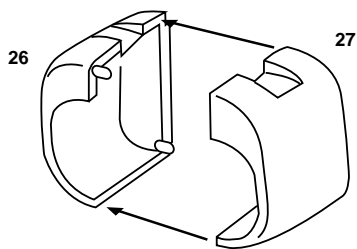

NOTE - Parts are shown upside down for clarity.

5 WING / EXHAUST ASSEMBLY

21 • Left (Port) Upper Wing / superieur aile gauche / linker oberen flügel
23 • Left (Port) Lower Wing / bas aile gauche / linker läßt flügel
29 • Exhaust / eschappement / auspumpen

20 • Right (Starboard) Upper Wing / superieur aile droit / richter oberen flügel
22 • Right (Starboard) Lower Wing / bas aile droit / richter läßt flügel
29 • Exhaust / eschappement / auspumpen

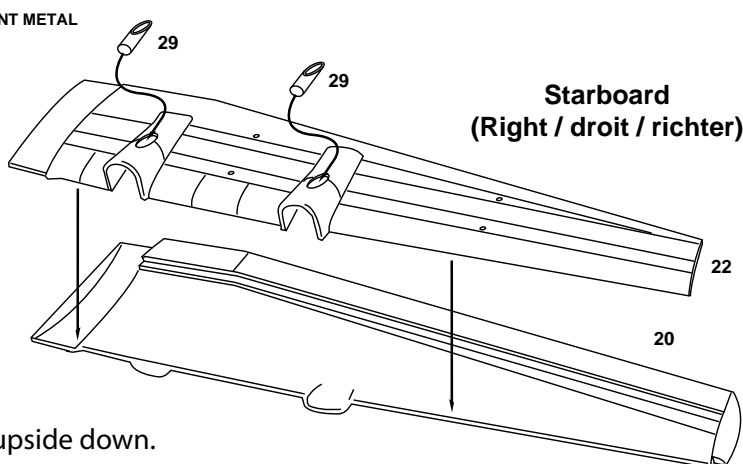
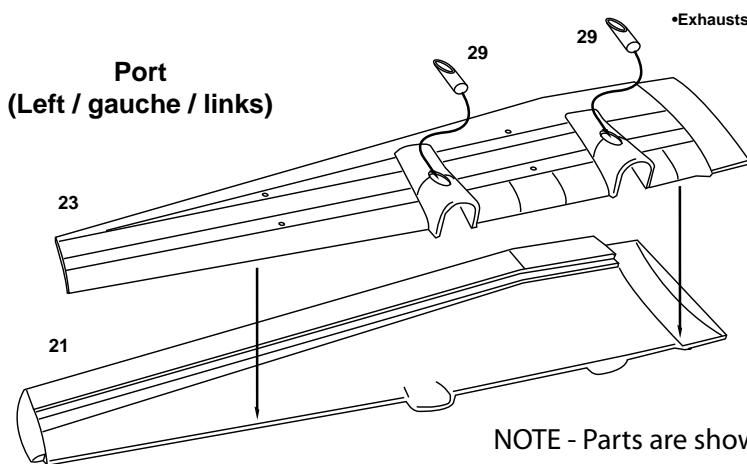

NOTE - Parts are shown upside down.

6 MAIN ASSEMBLY

Some parts not shown for clarity

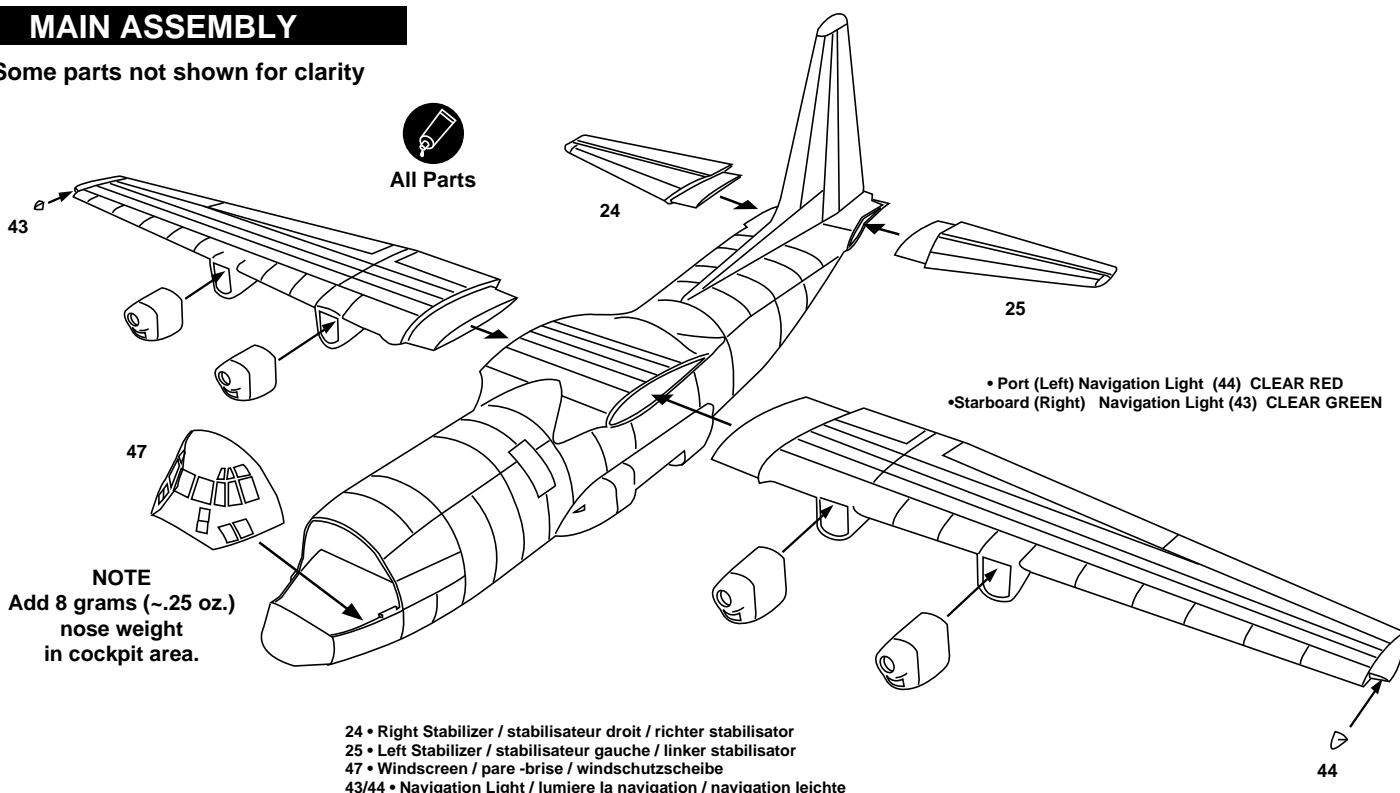

NOTE
Add 8 grams (~.25 oz.)
nose weight
in cockpit area.

24 • Right Stabilizer / stabilisateur droit / richter stabilisator
25 • Left Stabilizer / stabilisateur gauche / linker stabilisator
47 • Windscreen / pare-brise / windschutzscheibe
43/44 • Navigation Light / lumiere la navigation / navigation leuchte

7 BEAVER TAIL

17/18 • Tail / queue / schwanz



All Parts

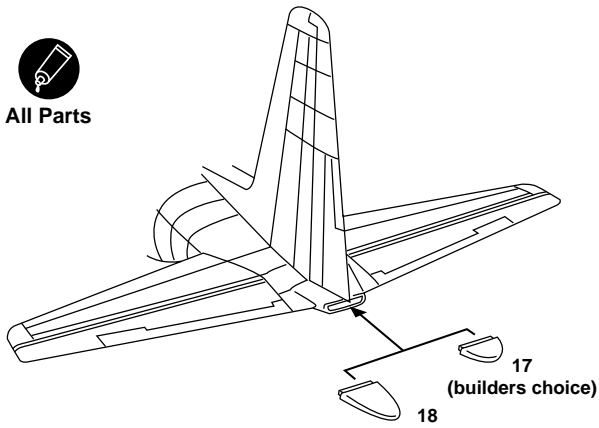

8 LANDING LIGHTS

45 • Landing light / l'atterrissage allume /
landung anzünden

RIGHT / DROITE / RICHTIGER
Main gear door Part 4

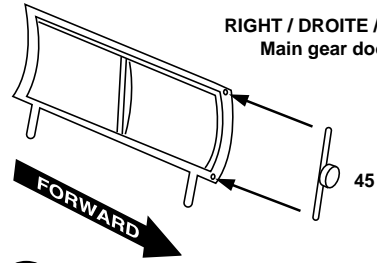

LEFT / GAUCHE / LINKER
Main gear door Part 3

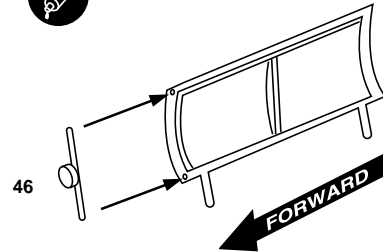

9 MAIN LANDING GEAR

6 • Right (Starboard) Main Gear Strut / entretoise principal droit / richter hauptlandung strut
12 • Mainwheel / roue principale / hauptrad
4/10 • Right (Starboard) Main Gear Door / trappe de train / richter gang türen

RIGHT / DROITE / RICHTIGER
MAIN LANDING GEAR

6 • Left (Port) Main Gear Strut / entretoise principal gauche / linker hauptlandung strut
12 • Mainwheel / roue principale / hauptrad
3/11 • Left (Port) Main Gear Door / trappe de train / linker gang türen

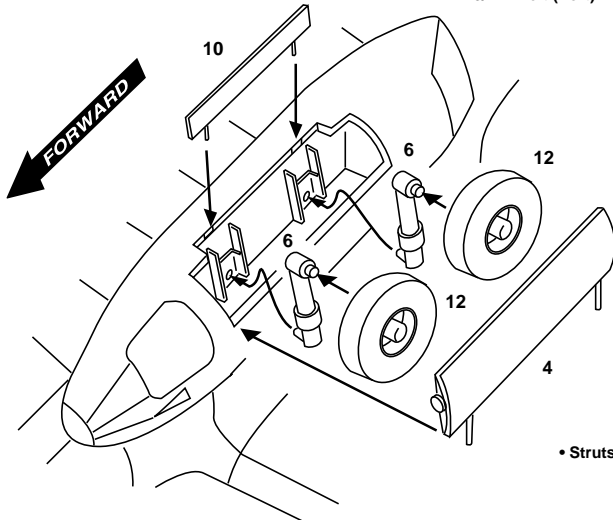

All Parts

• Struts / Hubs / Interiors ALUMINUM
• Tires FLAT BLACK

LEFT / GAUCHE / LINKER
MAIN LANDING GEAR

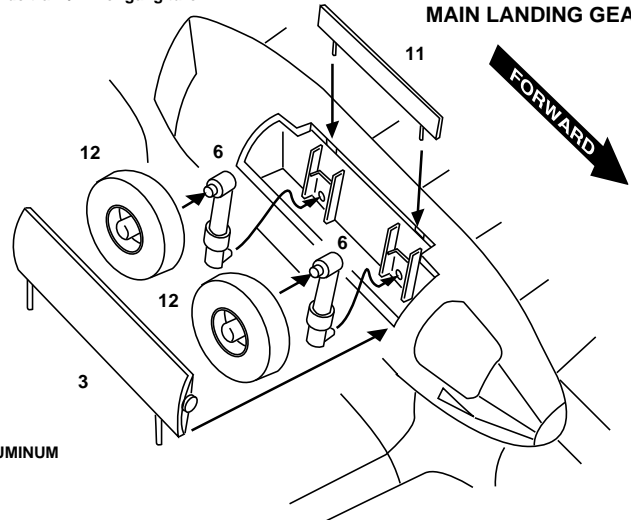

10 NOSE LANDING GEAR

14 • Nose gear strut / train d'atterrissage avant / nase gang strut
13 • Nosewheel / roulette de nez / nase rad
7/15 • Nose gear doors / trappe de train / nase gang tür
16 • Scissors / ciseaux / schere
19 • Strut / entretoise / strut



All Parts

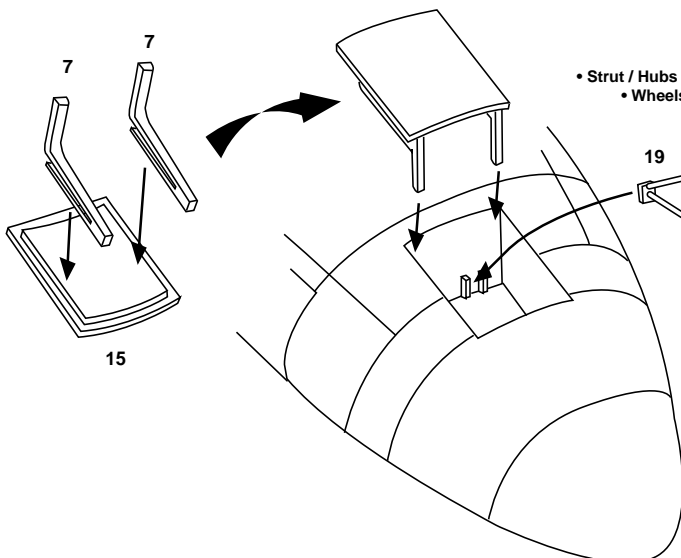

• Strut / Hubs / Interior ALUMINUM
• Wheels FLAT BLACK

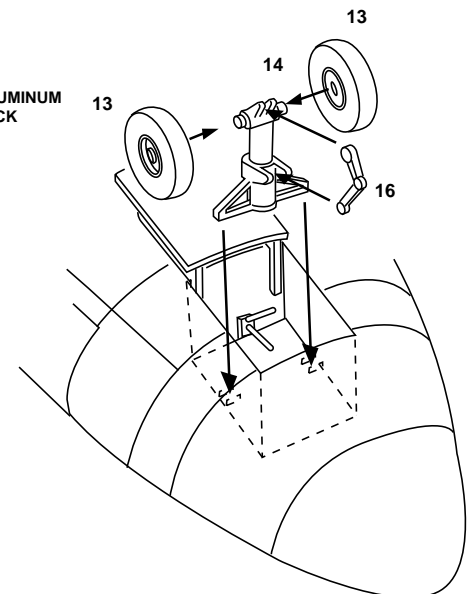

11 CARGO HATCH

63/64/65 • Cargo hatch / couvée de cargaison / frachthalbtür
68 • Strut / entretoise / strut

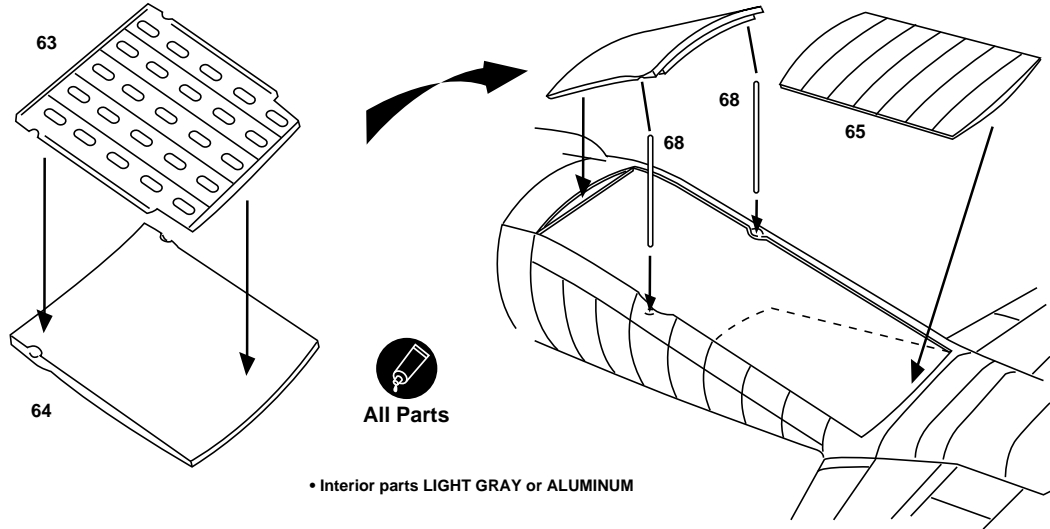

12 EXTERNAL FUEL TANKS

31/32/33/34/35/36/37/39 Fuel tank / alimenter le reservoir / tank

LEFT / GAUCHE / LINKER
WING

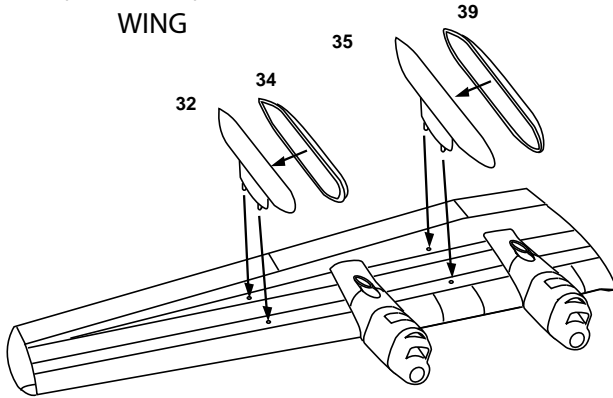

RIGHT / DROITE / RICHTIGER
WING

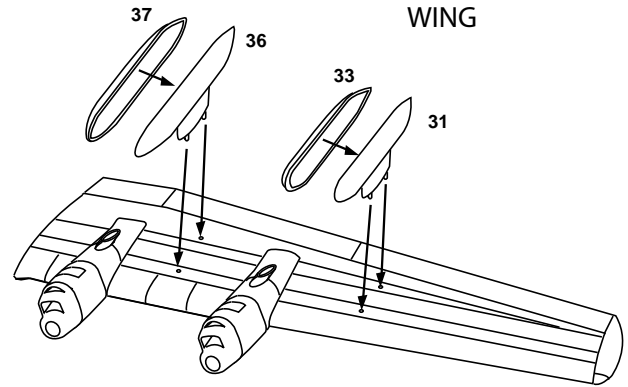

NOTE - Parts are shown upside down.

13 PROPELLERS

41 • Propeller / helice / propeller

4

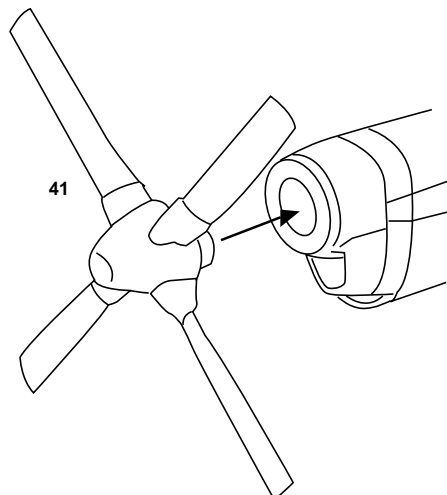

All Parts

U.S. Air Force Reserve, 911 AW, Sept 2010

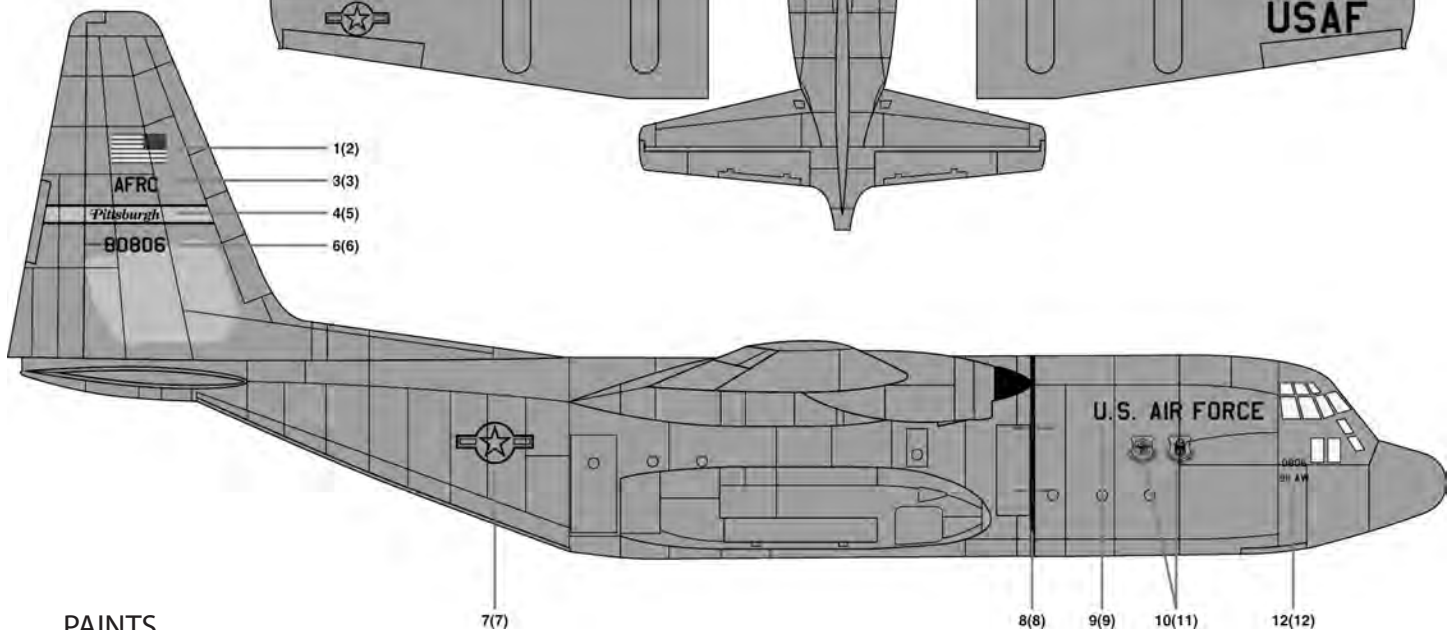
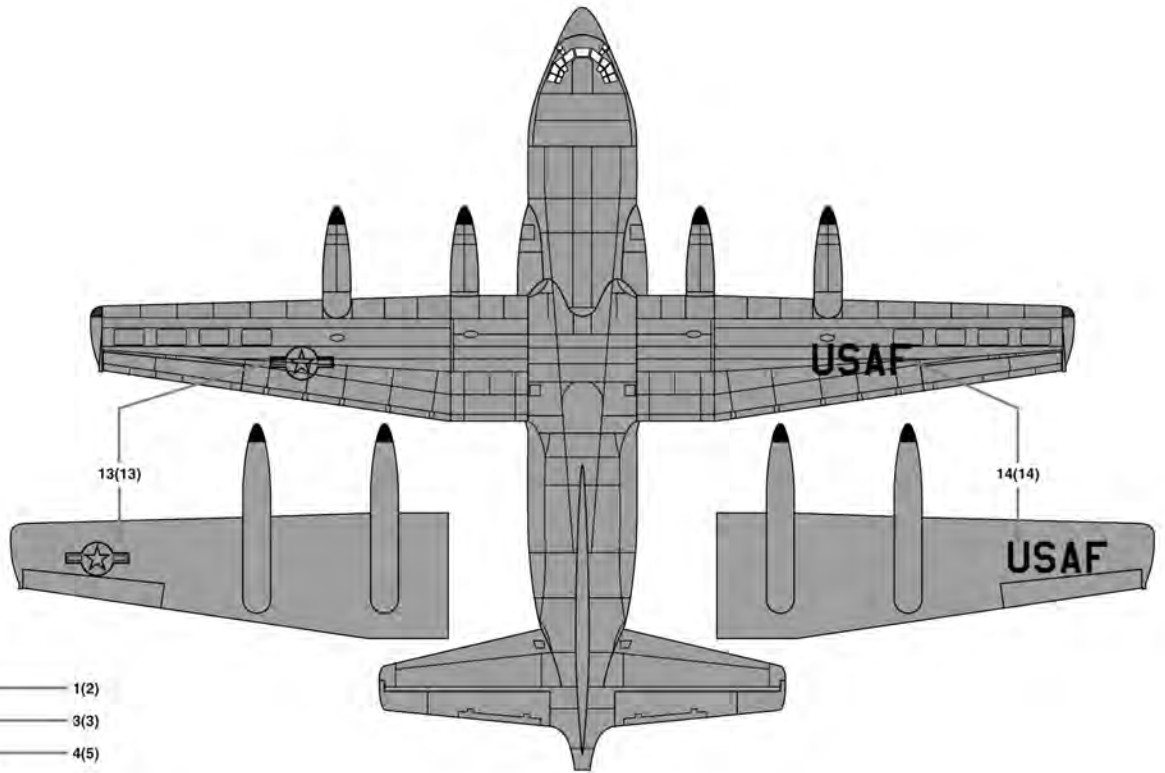
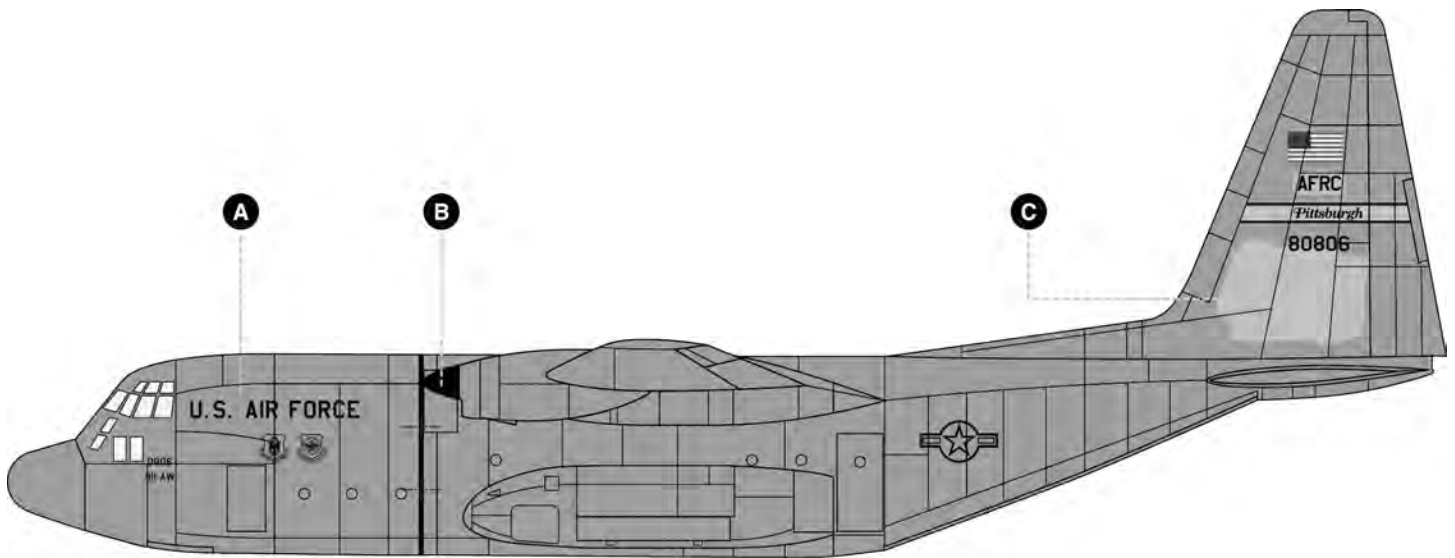

PAINTS

A FS36173 Air Mobility Command Gray (ModelMaster 2035, Acryl 4754)

B Black (ModelMaster 1749, Acryl 4768)

C FS36270 Neutral Gray (ModelMaster 1725, Acryl 4757)

Illinois Air National Guard, 182 AW, April 2008

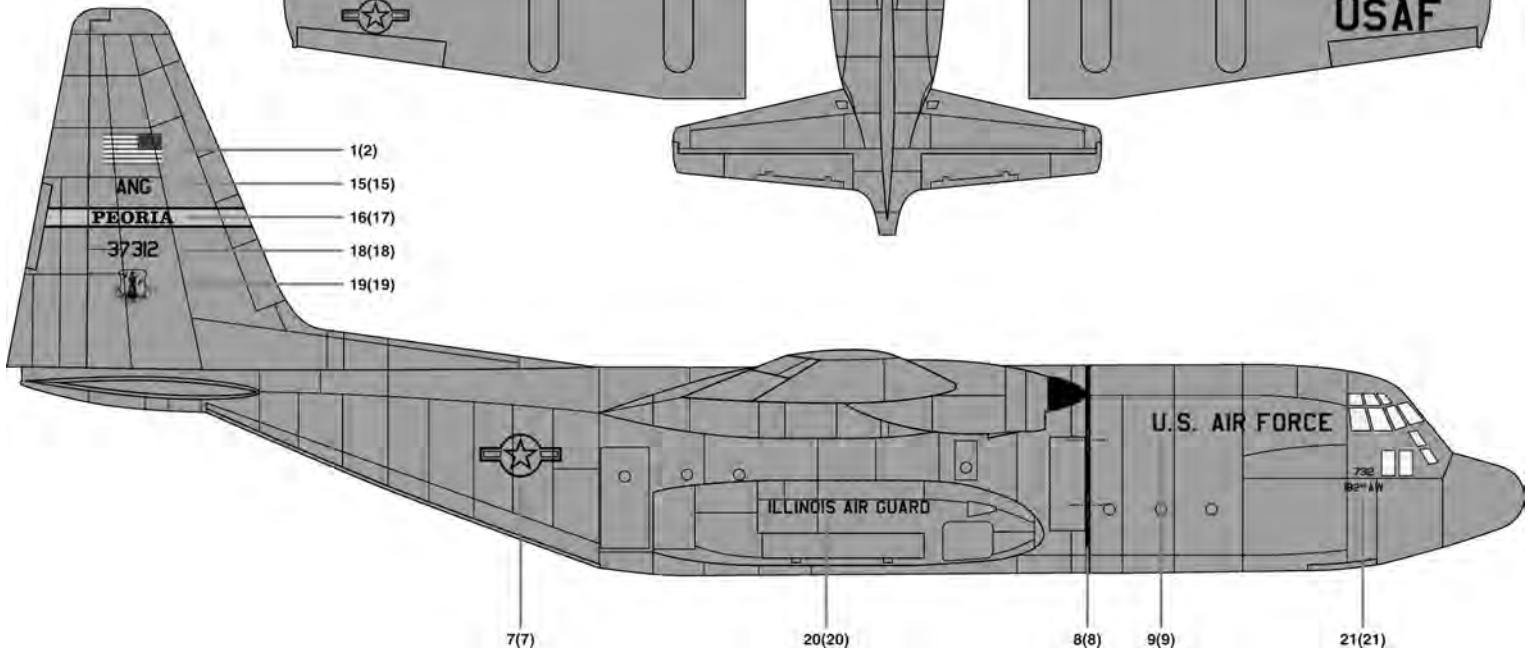
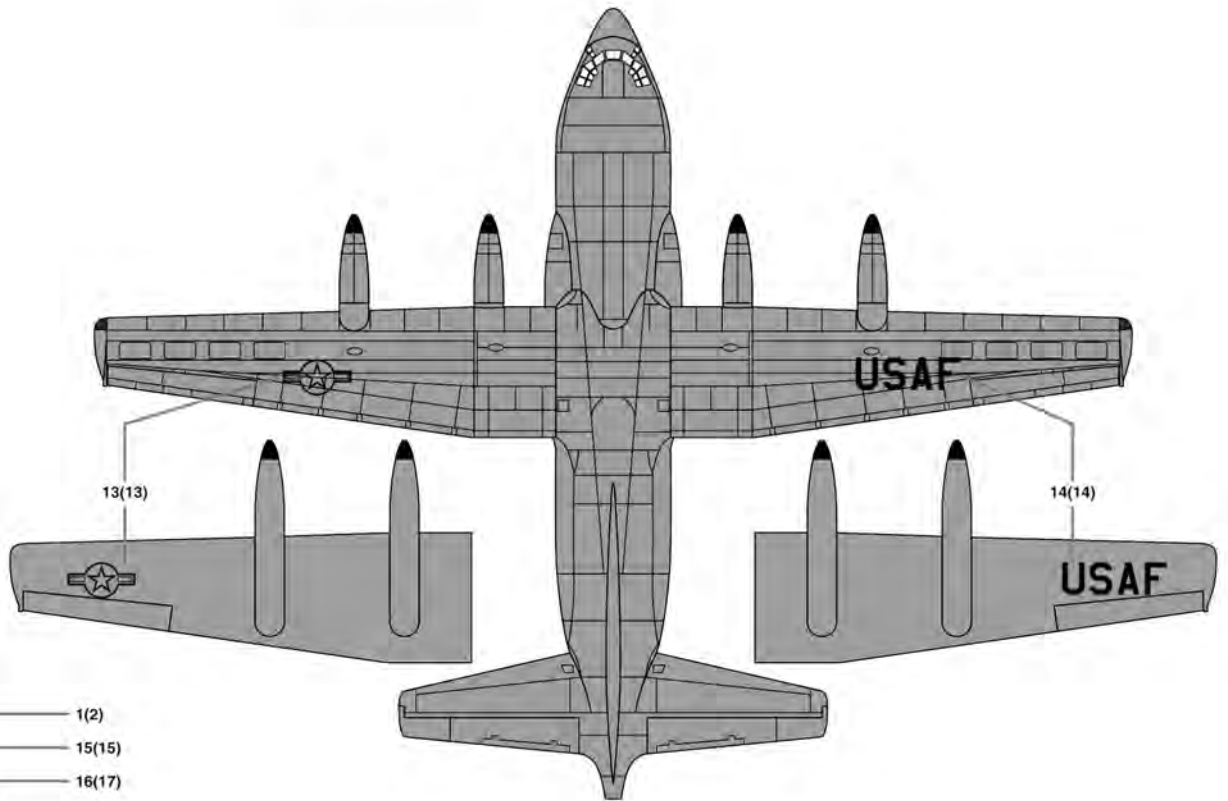
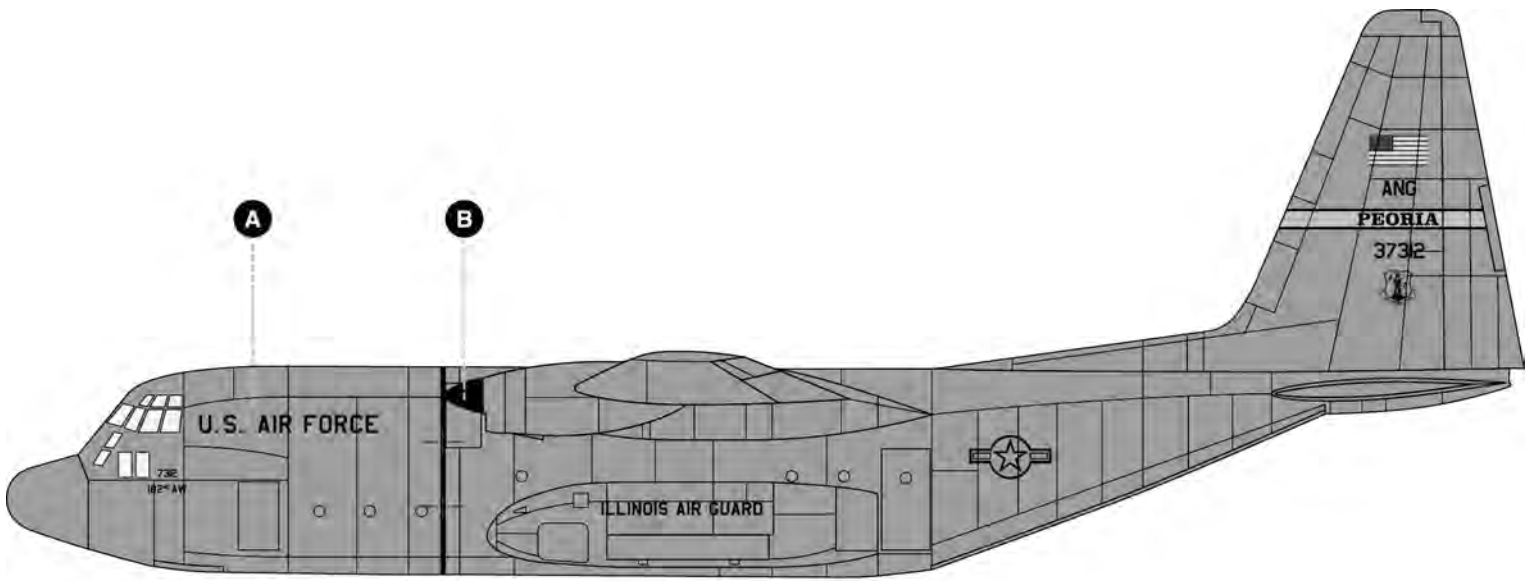

Your Minicraft model includes high-quality waterslide decals. These decals adhere best to a glossy surface; and it is recommended that you apply a clear gloss coat over your painted model.

Use a sharp scissors or knife to cut individual decals from the carrier sheet. Do not cut into the clear film surrounding the individual decals.

* It is recommended that you apply one decal at a time.

* Place the decal section in warm water, when first inserted in the water your decal will curl, after approximately ten seconds the decal will uncurl. Remove from water and lay on a paper towel. After approximately 10 - 20 seconds the decal will slide freely from the backing paper. Use a small brush to help slide the decal from the backing paper and into position on the model. Carefully blot excess water from the decal, using care not to move the decal or tear it.

* If you choose to use a setting solution, apply a thin coat over the decal following the manufacturer's instruction.

* Allow the decal to dry overnight. Wash any adhesive residue off the model with a small amount of clean water and dry thoroughly.

* Apply clear gloss, matte or flat coat to seal decals following the instructions from the manufacturer.



Legends in the making™

Visit our Website-
www.minicraftmodels.com

Minicraft Models
1501 Commerce Drive
Elgin, IL 60123

Phone: 847-429-9676