

63516 STURMGESCHUTZ IIIC/D INTERIOR

1/35 SCALE

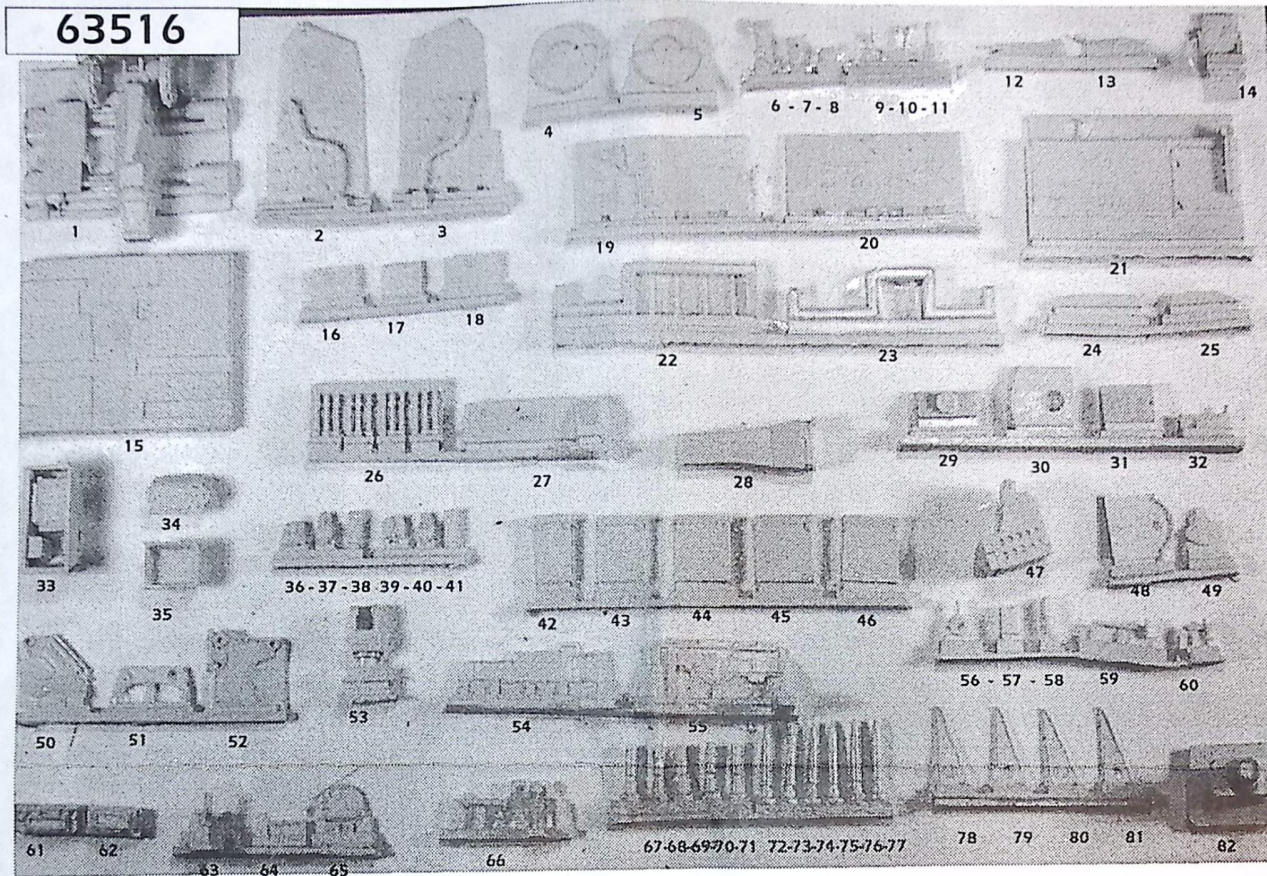

PARTS LIST

- | | | |
|--------------------------------------|-------------------------------------|---|
| 1. DRIVER'S FLOOR ASSEMBLY | 30. LOWER GUN MOUNT BASE PLATE | 59. TRAVERSE HANDLE |
| 2. LEFT HULL SIDE | 31. TRANSMISSION OIL PAN (NOT USED) | 60. TRAVERSING & SIGHT MOUNT |
| 3. RIGHT HULL SIDE | 32. COMMANDERS SEAT MOUNTING ARM | 61. DRIVERS VISION BLOCK - FRONT |
| 4. RIGHT BRAKE DRUM | 33. LEFT RADIO COMPARTMENT | 62. DRIVERS VISION BLOCK - LEFT |
| 5. LEFT BRAKE DRUM | 34. RADIO | 63. GUNNERS SEAT BACK |
| 6. LEFT AXLE | 35. SPENT SHELL BASKET | 64. GUNNERS SEAT MOUNT |
| 7. RIGHT AXLE | 36. BINOCULARS | 65. GUNNERS SEAT |
| 8. COMMANDER'S SEAT MOUNTING BRACKET | 37. WATER BOTTLE | 66. SIGHT |
| 9. RIGHT FOOT PEDAL | 38. GAS MASK | 67. EMPTY SHELLS (OPTIONAL) |
| 10. LEFT FOOT PEDAL | 39. BINOCULARS | 68. EMPTY SHELLS (OPTIONAL) |
| 11. CENTER FOOT PEDAL | 40. WATER BOTTLE | 69. EMPTY SHELLS (OPTIONAL) |
| 12. LEFT BRAKE HANDLE | 41. GAS MASK | 70. EMPTY SHELLS (OPTIONAL) |
| 13. RIGHT BRAKE HANDLE | 42. NARROW AMMO BOX | 71. EMPTY SHELLS (OPTIONAL) |
| 14. DRIVER'S SEAT | 43. MEDIUM AMMO BOX | 72. SPARE ROUNDS (OPTIONAL) |
| 15. FIGHTING COMPARTMENT FLOOR | 44. WIDE AMMO BOX | 73. SPARE ROUNDS (OPTIONAL) |
| 16. STORAGE BOX (OPTIONAL) | 45. WIDE AMMO BOX | 74. SPARE ROUNDS (OPTIONAL) |
| 17. LOADERS SEAT | 46. WIDE AMMO BOX | 75. SPARE ROUNDS (OPTIONAL) |
| 18. STORAGE BOX (OPTIONAL) | 47. AMMO BOX RACK | 76. SPARE ROUNDS (OPTIONAL) |
| 19. LEFT WALL | 48. UPPER GUN MOUNT BASE PLATE | 77. SPARE ROUNDS (OPTIONAL) |
| 20. RIGHT WALL | 49. COMMANDERS SEAT | 78. BRACE FOR FIGHTING COMPARTMENT WALL |
| 21. FIREWALL | 50. RIGHT UPPER GUN MOUNT | 79. BRACE FOR FIGHTING COMPARTMENT WALL |
| 22. FRONT GUN MOUNT | 51. UPPER GUN MOUNT FRONT BRACE | 80. BRACE FOR FIGHTING COMPARTMENT WALL |
| 23. REAR GUN MOUNT | 52. LEFT UPPER GUN MOUNT | 81. BRACE FOR FIGHTING COMPARTMENT WALL |
| 24. GUN PLATFORM RIGHT REAR BRACE | 53. GUN BREECH | 82. 7.5cm StuK 37 |
| 25. GUN PLATFORM LEFT REAR BRACE | 54. LEFT DEFLECTOR | |
| 26. GRENADE RACK/UPPER FIREWALL BOX | 55. RIGHT DEFLECTOR | |
| 27. LOWER FIREWALL BOX | 56. BREECH BLOCK GEAR | |
| 28. DRIVESHAFT COVER | 57. BREECH BLOCK | |
| 29. GUN ELEVATION MOUNT | 58. UPPER GUN MOUNT LOCATING PEG | |

MASTER PATTERN BY
CHRIS MROSKO
BEN JAKOBSEN
JOHNSON WANG

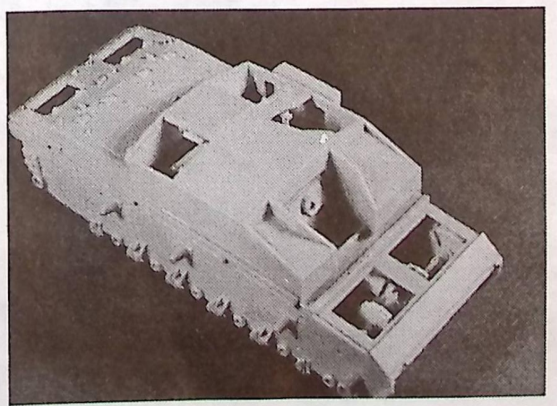
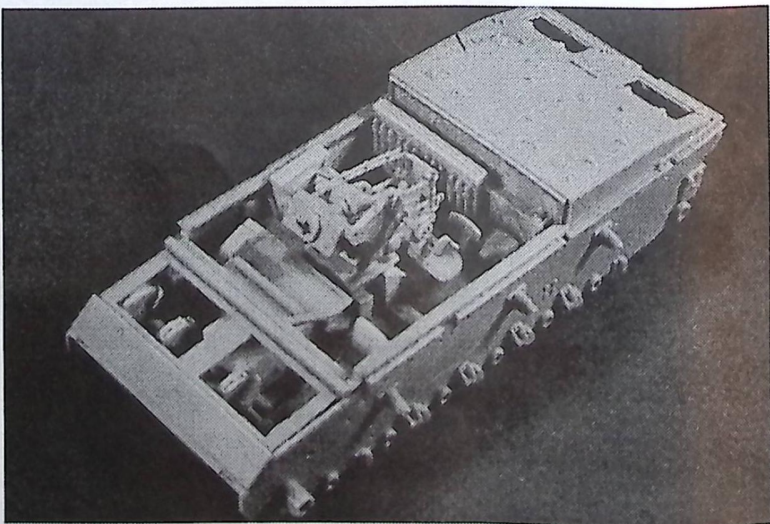
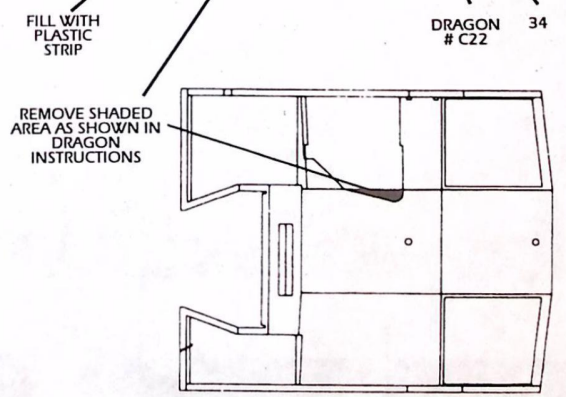
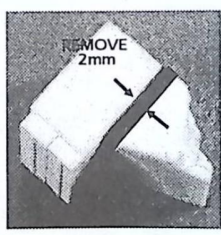
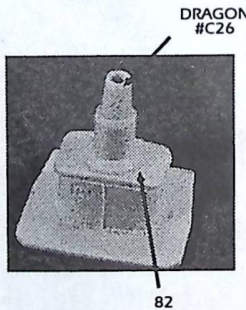
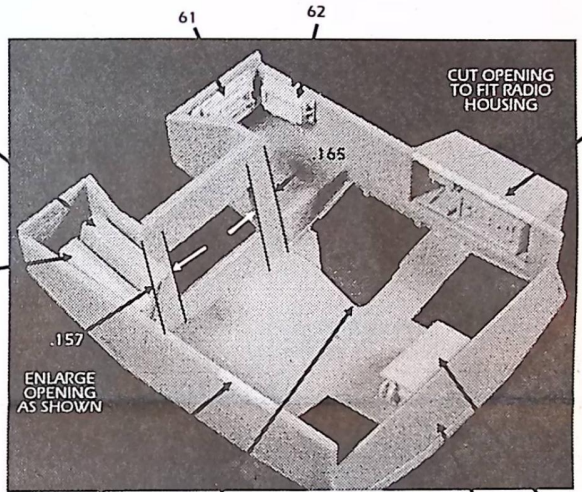
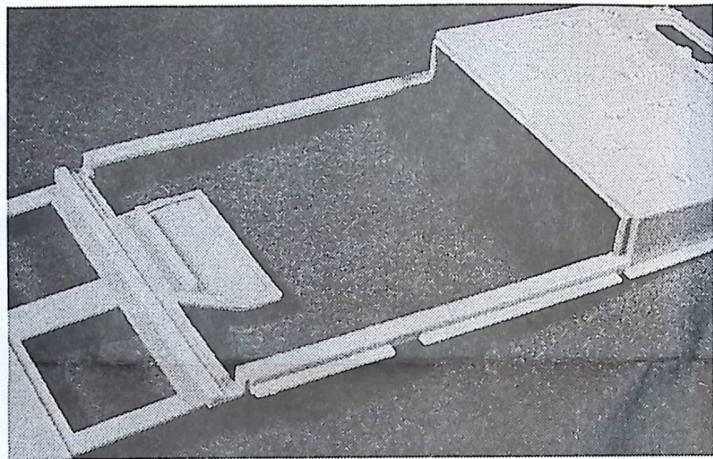
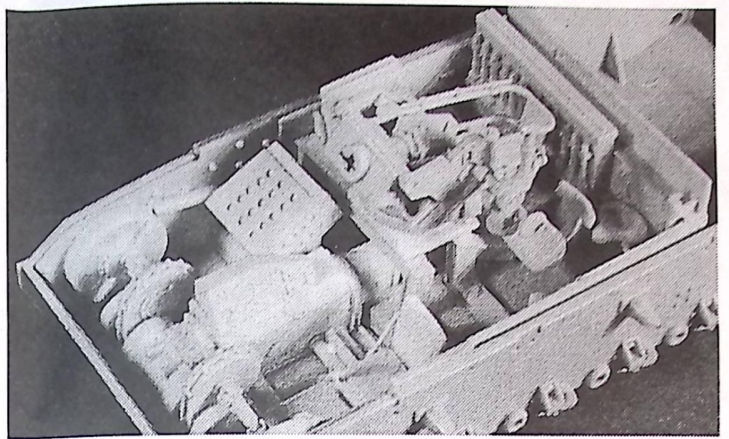
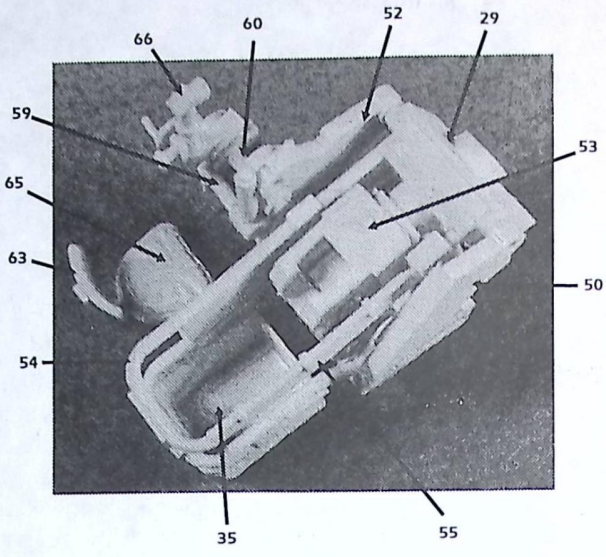

GENERAL INSTRUCTIONS

Read through the instructions and check to be sure all the parts are there. Resin parts usually have a "sprue" or runner that needs to be removed. In most cases, it can be easily snapped off. Slight scoring with a hobby knife along the parting line will help. A razor saw may be necessary for some of the larger sprues. Sometimes a pair of flush cutting nippers is useful for this job but care must be used here to avoid damaging the parts. It is always better to remove too little than too much! Final trimming can be done with a hobby knife, small files and sandpaper. Where a flat mating surface is desired, it's a good idea to tape a piece of 240 or 360 grit sandpaper to flat surface and draw the part carefully along the sandpaper in one direction only. Frequently inspect the part to check progress.

Cyanoacrylate "super glues" are ideal for assembling resin kits. Be sure to wash all parts in soapy water or alcohol to remove any mold residue before assembly or painting. Occasionally you may find some warp on resin parts. This problem can be remedied by immersing in hot water and bending to the proper shape. Handle the hot parts carefully! The shape can be locked in by immediately plunging the part in cold water.

The upper hull deck (part #A1) from the Dragon kit (6033) needs to be modified as shown. You can also use the superstructure (part #C23) as a guide in cutting the necessary sections. Use caution here, as there is just a very thin section left along each side! The left side of the superstructure will also need to be modified to fit the radio housing by cutting away a rectangle.

