

Plastic model

scale : 1/72

The Yokosuka D4Y *Suisei* (Allied name "Judy"). Navy Carrier Dive bomber was operated by the Imperial Japanese Navy. The D4Y was one of the fastest dive-bombers of the war and only the delays in its development hindered its service while its predecessor, the slower fixed-gear Aichi D3A remained in service much longer than intended. Despite limited use, the speed and the range of the D4Y was nevertheless valuable, and the type was used with success as reconnaissance aircraft as well as for *kamikaze* missions. The D4Y was faster than the A6M Zero and some were employed as D4Y2-S night fighters against Boeing B-29 Superfortress bombers late in the war. The night fighter conversions were made at the 11th Naval Aviation Arsenal at Hiro. Each D4Y2-S had bomb equipment removed and a 20 mm Type 99 cannon with its barrel slanted up and forwards (similar to the German *Schräge Musik*) installed in the rear cockpit. Additionally some examples also carried two or four 10 cm air-to-air rockets under the wings. However, the lack of radar for night interceptions, low climb rate and the B-29's high ceiling limited the D4Y2-S effectiveness as a night fighter. Little is known of their operations.

Plastic parts

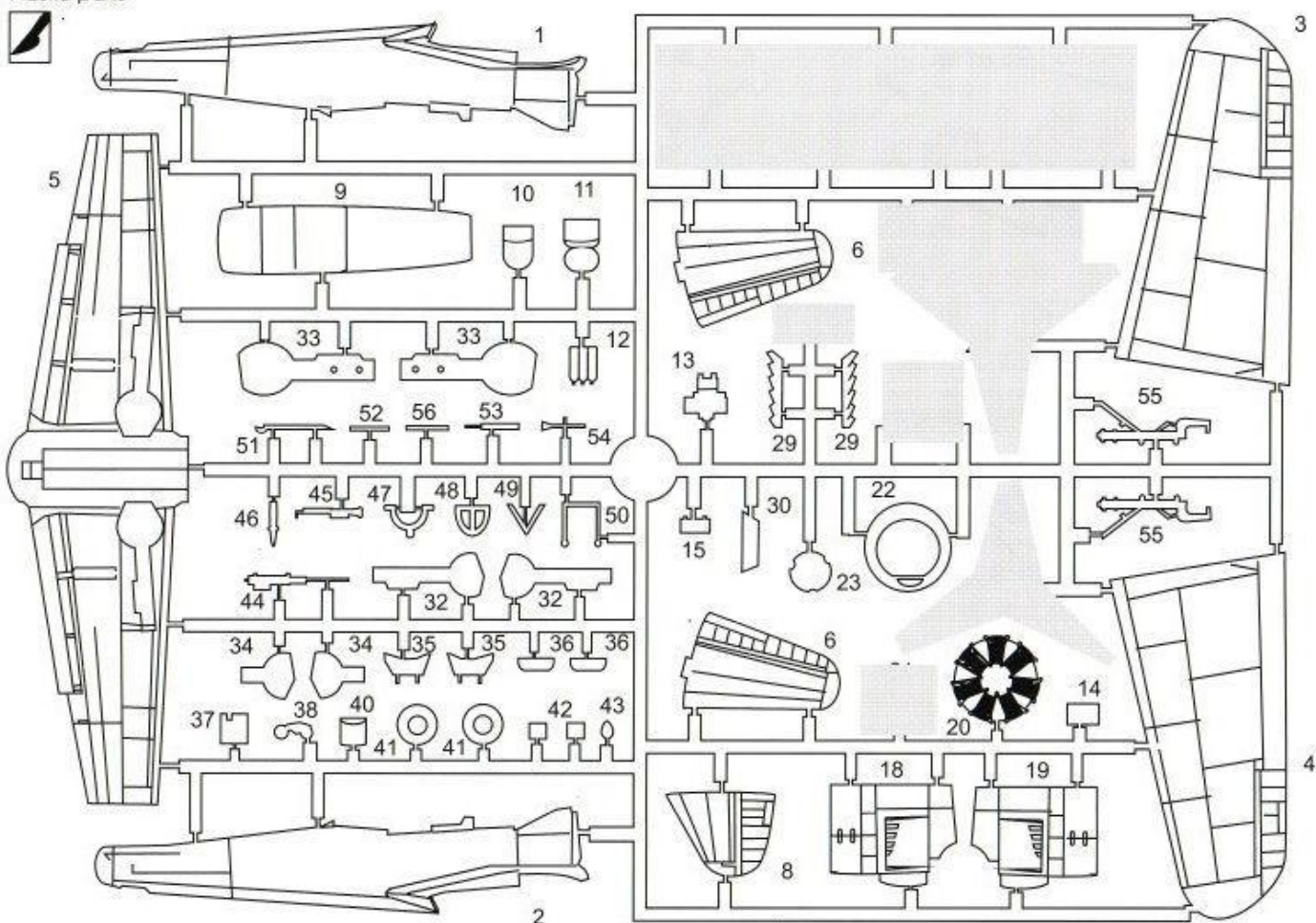

Transparent part

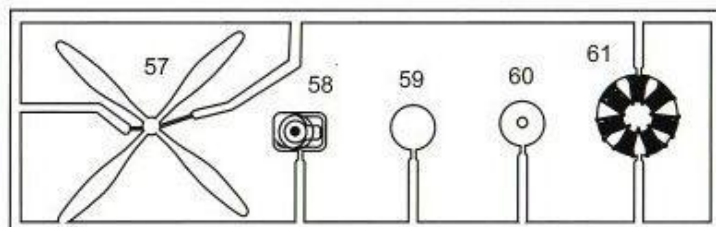
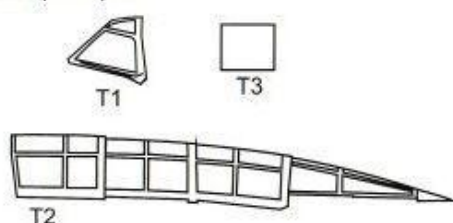

	Colour name	Number		Colour name	Number
A	Black		F	Tyre Black	
B	White		G	Yellow	
C	IJN Interior Green		H	Brown	
D	Light grey		I	IJN Dark Brown	
E	Aluminum		J	IJN Interior Blue	

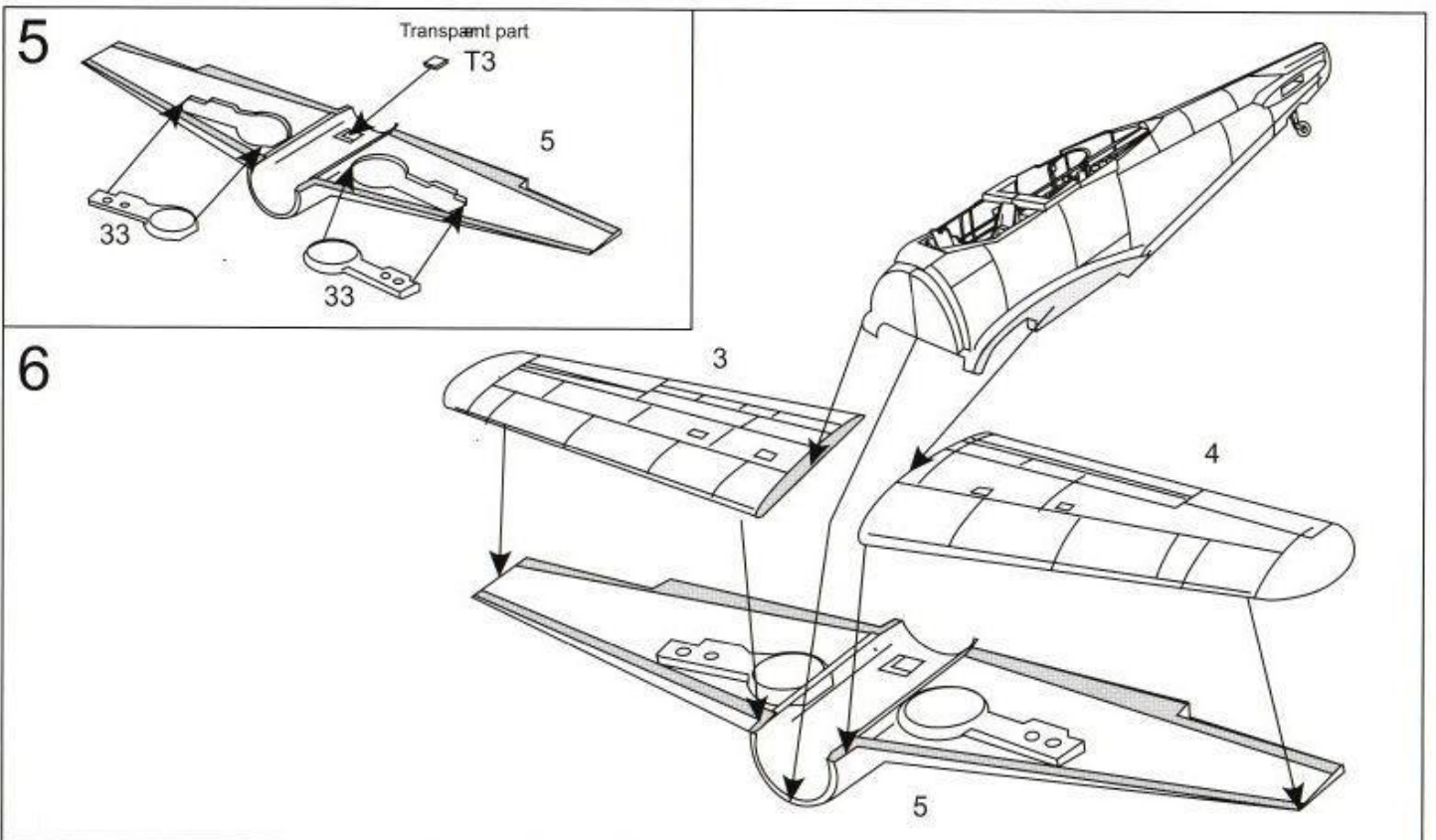
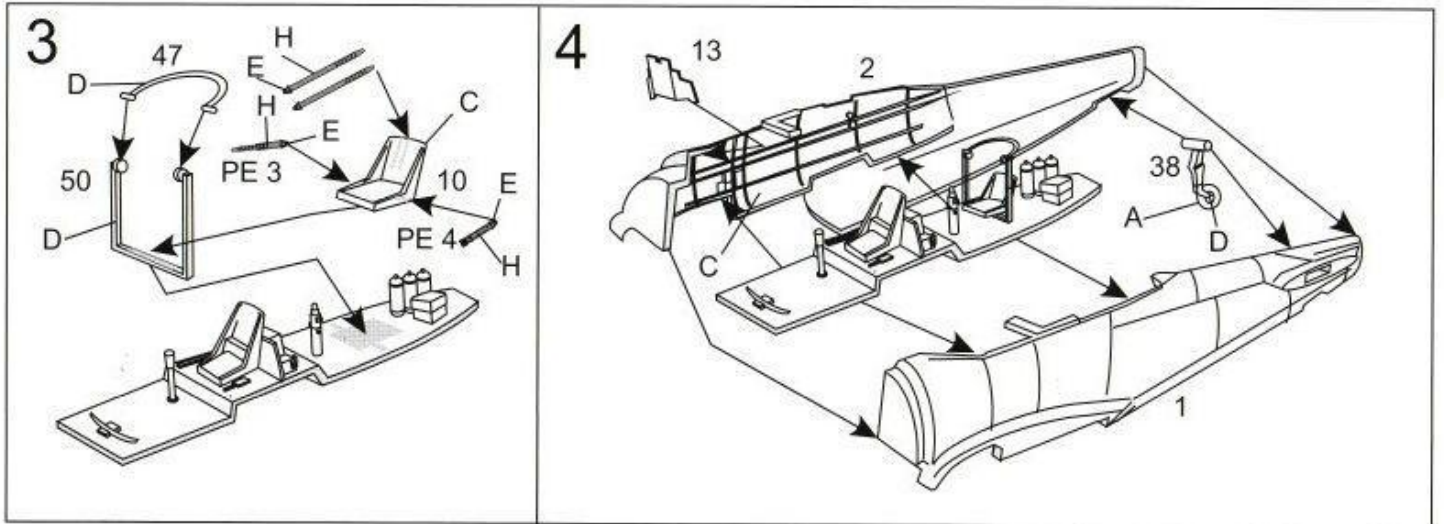
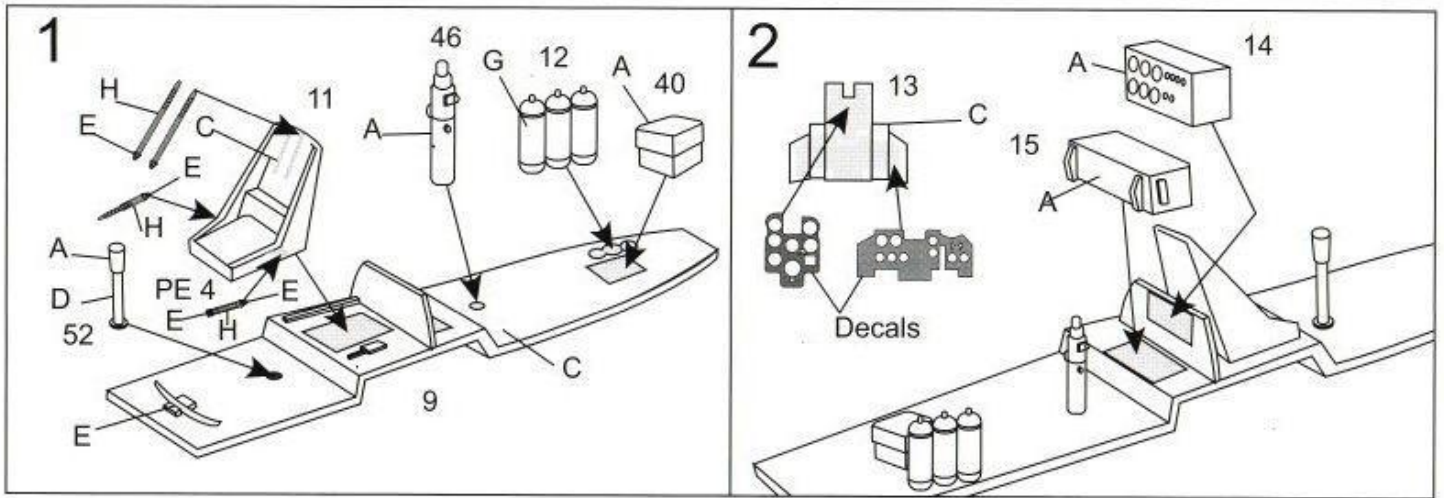

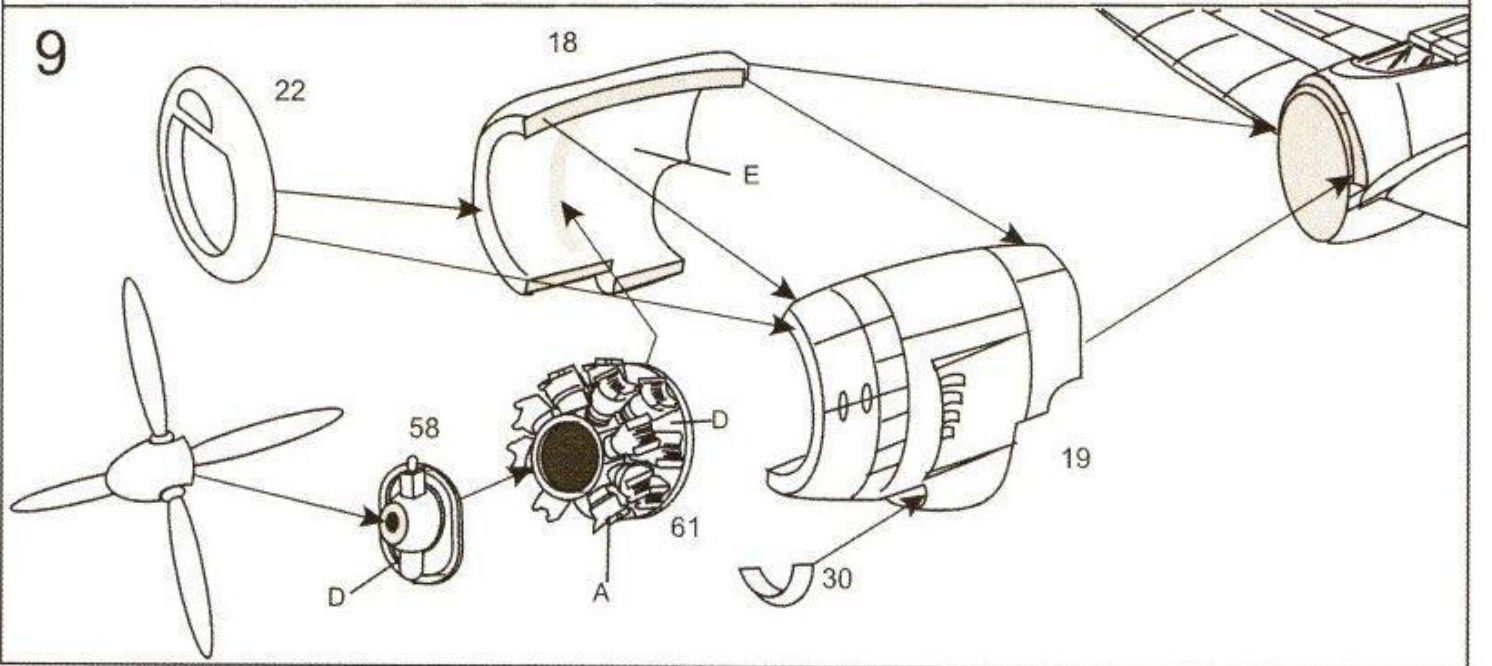
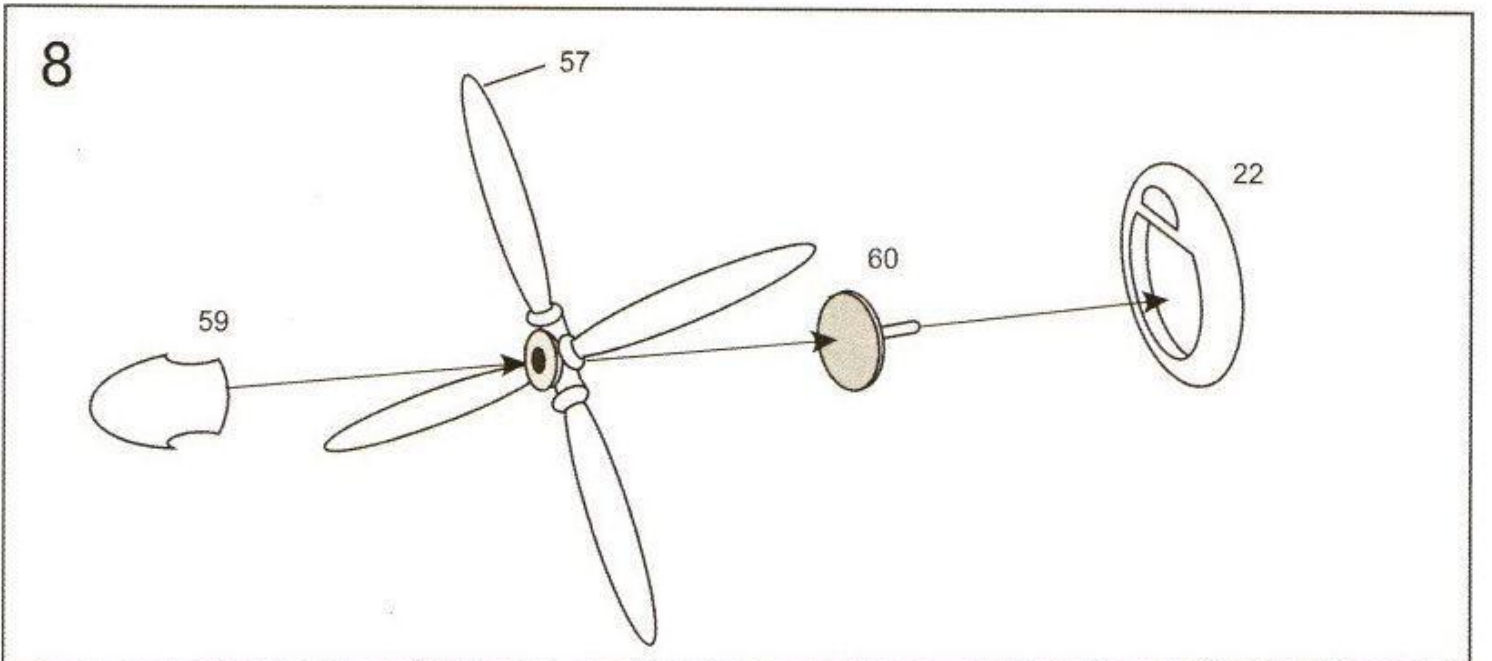
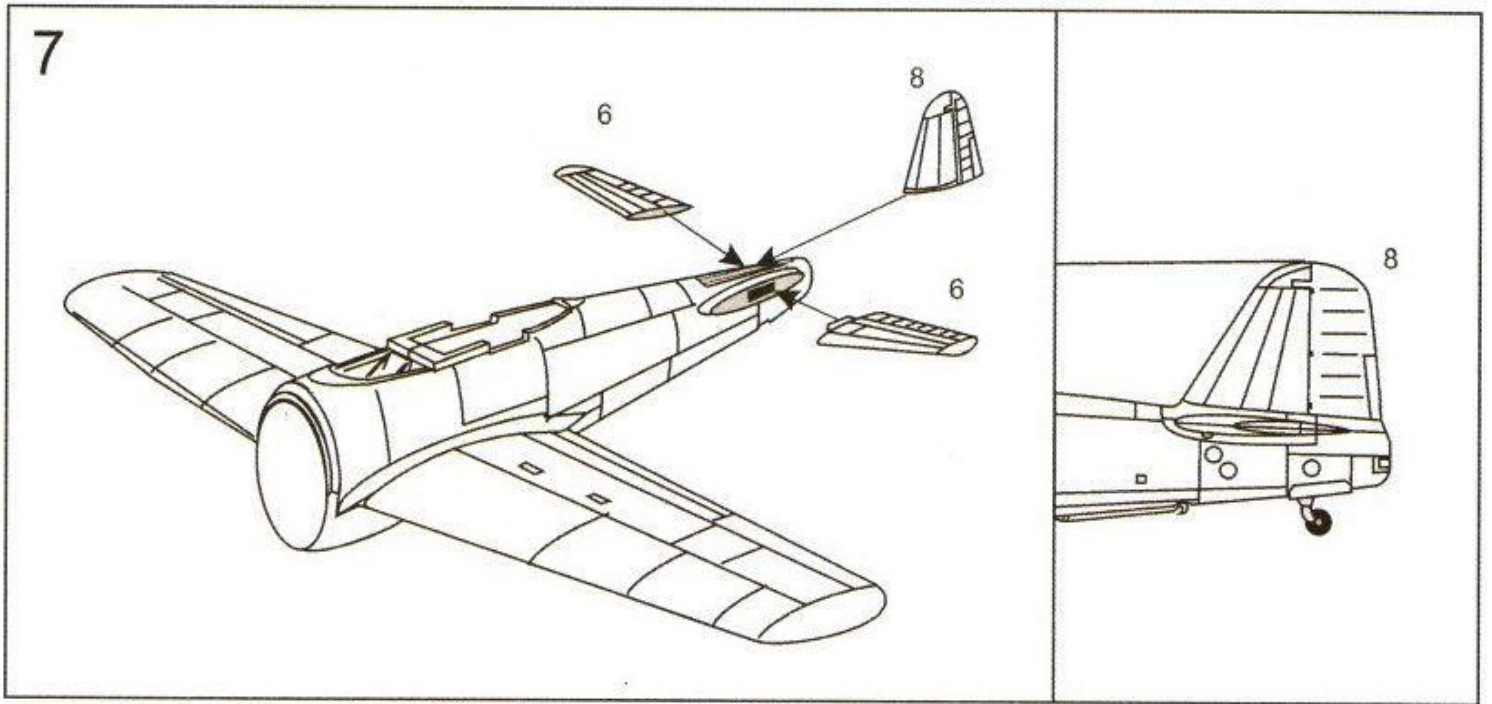

10

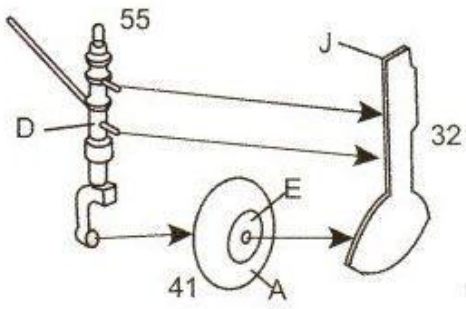

11

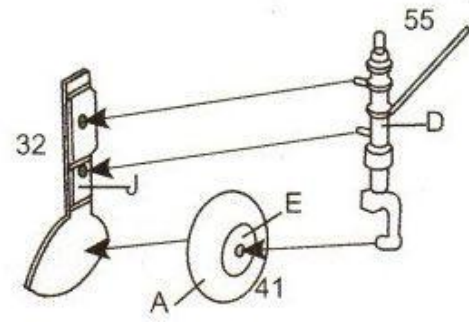

12

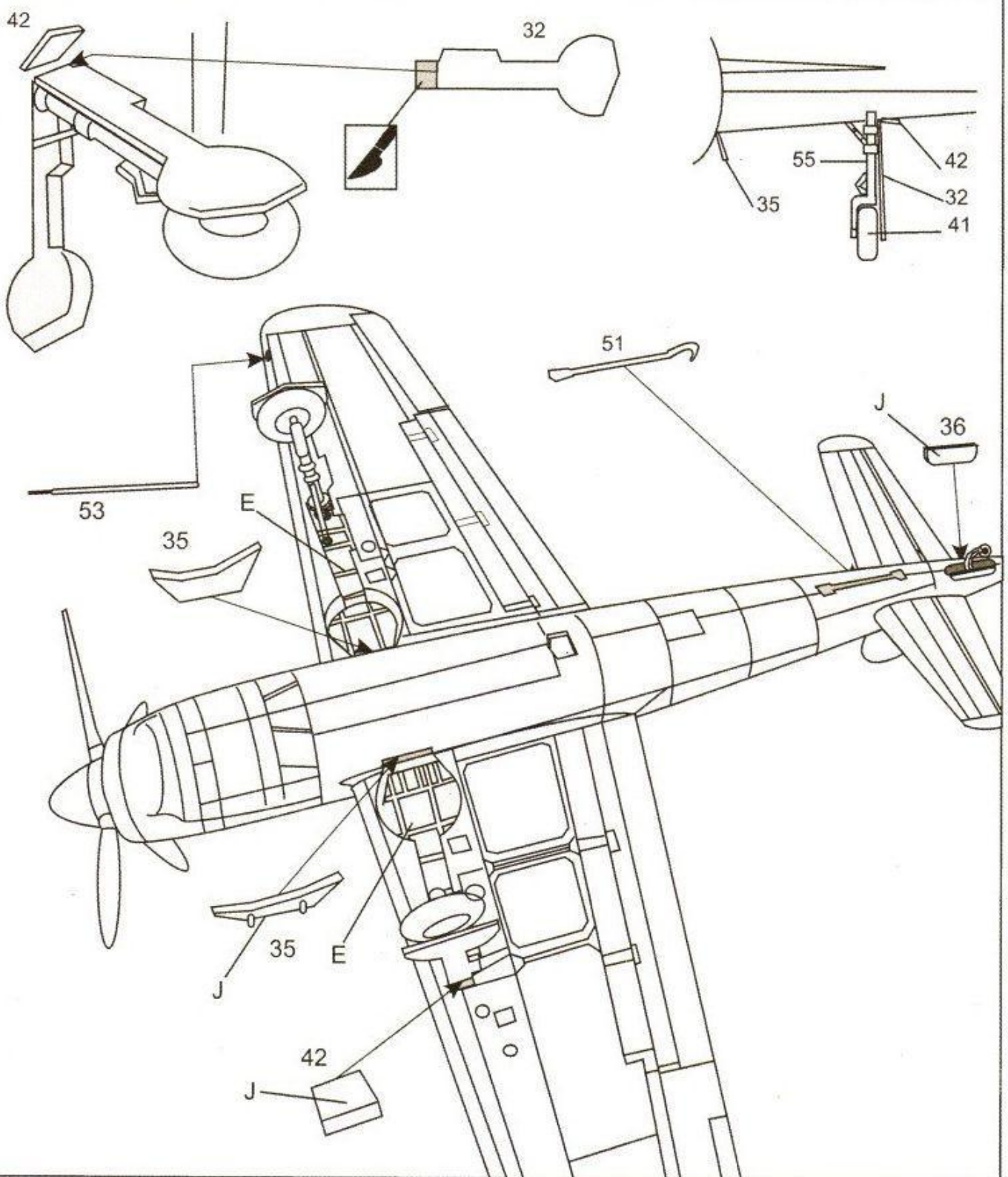

13

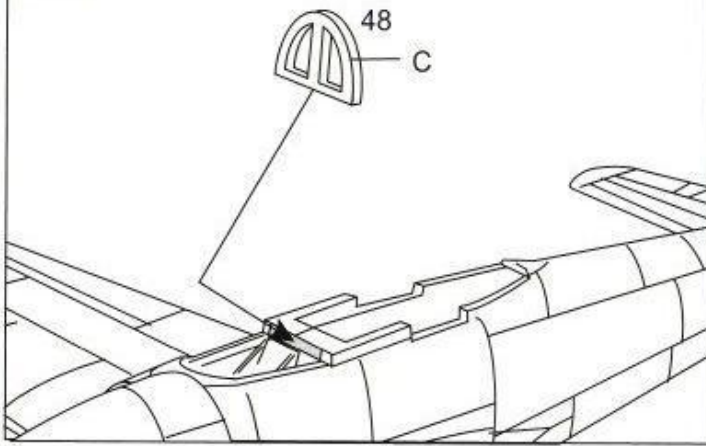

14

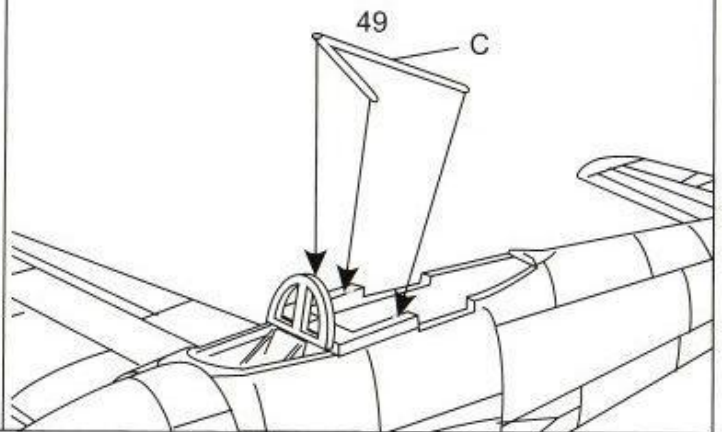

15 Night fighter

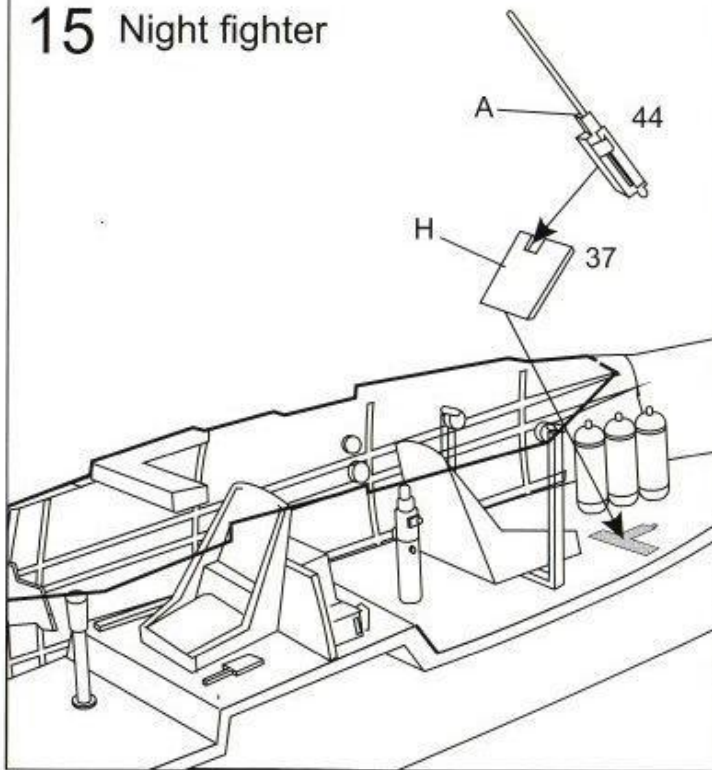

16 Dive bomber

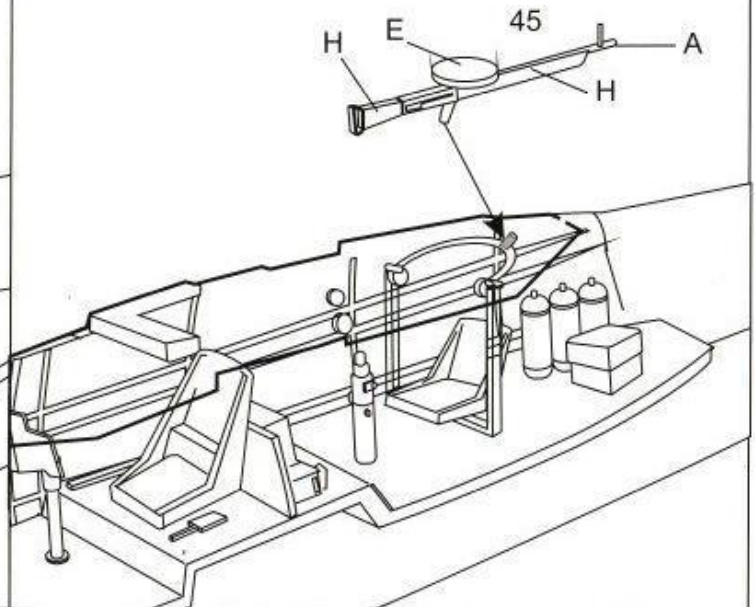

17 Night fighter

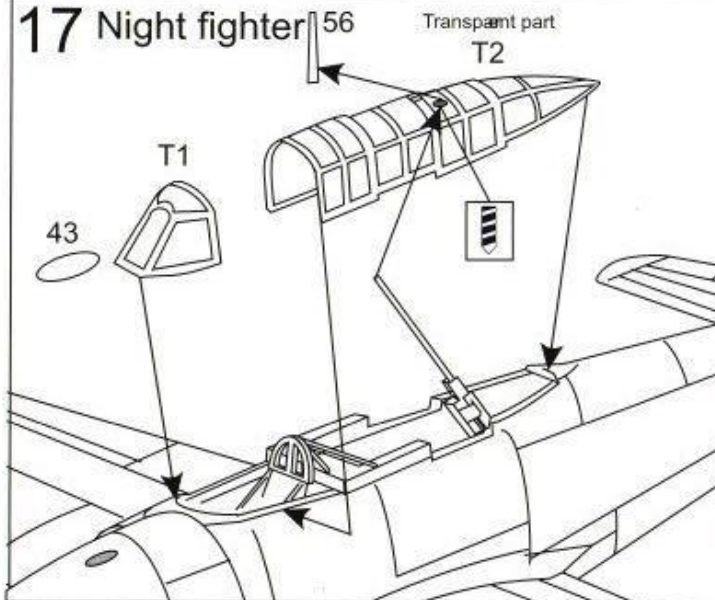

18 Dive bomber

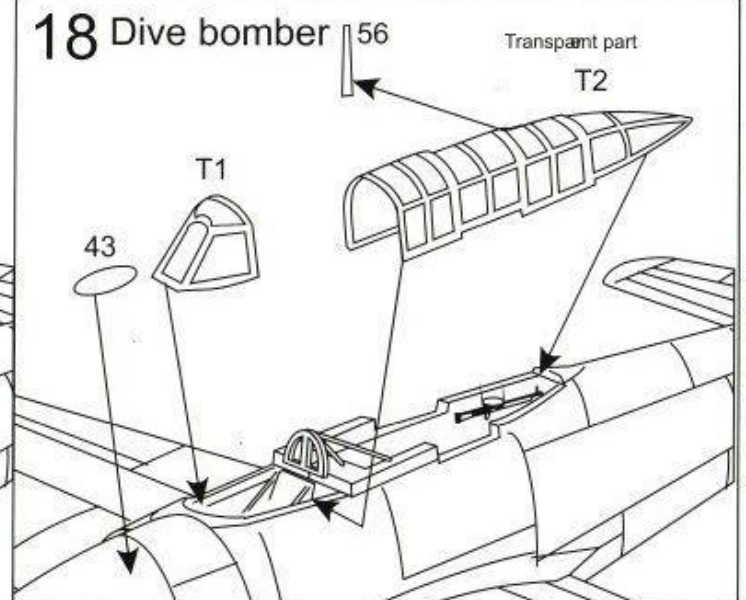

Kugisho D4Y5

