

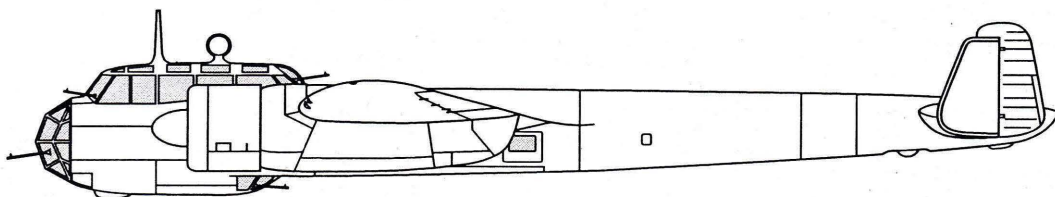

Classic Airframes



Do-17Z

Designed to meet a request by Deutsche Lufthansa for a small, high-speed mail and passenger plane, the prototype Do-17 took to the air in October 1934. Although possessing excellent speed and handling, the design proved impractical due to the cramped fuselage. After three prototypes were built, the transport development was abandoned. However, the aircraft's performance suggested to the RLM that the Do-17 design would make an excellent high-speed bomber. More prototypes were ordered, and the V4 was the first to be equipped with the type's characteristic twin tails. The first operational models, the Jumo powered E-1 bomber and F-1 reconnaissance versions equipped the first Do-17 Squadrons by mid-1937. A number of Do-17s were sent to Spain for evaluation, and proved to outpace most Republican interceptors, reinforcing the RLM's belief in the small bomber platform. Because the Do-17 design proved flexible and amenable to various powerplant installations, constant improvements were incorporated in subsequent versions, leading to the Bramo 323 powered Do-17Z. The Do-17Z played a major role in the Battle of Britain, but losses were heavy. Despite this, the type was used extensively in the Balkans and on the Russian front. A small number of Do-17Z aircraft were modified for use as nightfighters. Approximately 522 Z series aircraft were produced in 1939-40.

Do-17Z Specifications

Powerplant:	2x 940hp Bramo 323 engines	Armament:	5 machine guns 2,205 lb. bombload
Wing Span:	59' .33"		
Length:	51' 9.67"		
Maximum Speed:	~255 mph		

This model kit is intended for *experienced* modelers. The nature of low-pressure molded kits such as this require additional time and effort to clean up and fit the parts, as well as experience with the various media utilized to provide the most accurate effect on the finished model. Use CyA ('super') glue to assemble Resin parts.

Classic Airframes, Inc.
P.O. Box 577580 Chicago, IL 60657-7580 USA

Assembly Instruction Symbols



MULTIPLE ASSEMBLIES



BEND



OPTIONAL



DRILL



CUT



SYMMETRICAL ASSEMBLIES

Paint Reference Guide

A

RLM 02 Green-grey -FS 36135

C

Burnt Metal

E

Aluminum

B

RLM 66 Black-grey -FS 36081

D

RLM 70 Black-green -FS 34050

F

Gunmetal

Parts

PLASTIC PARTS

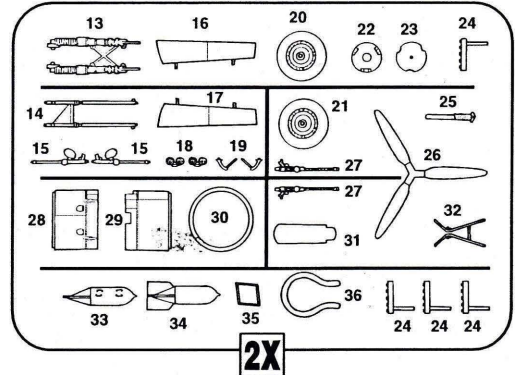
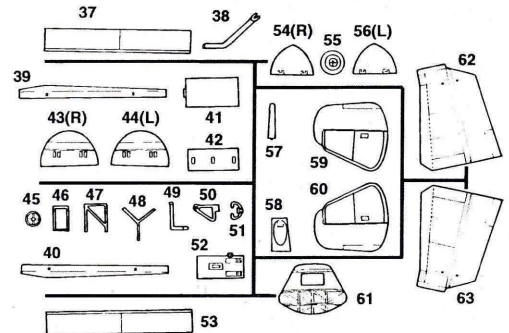
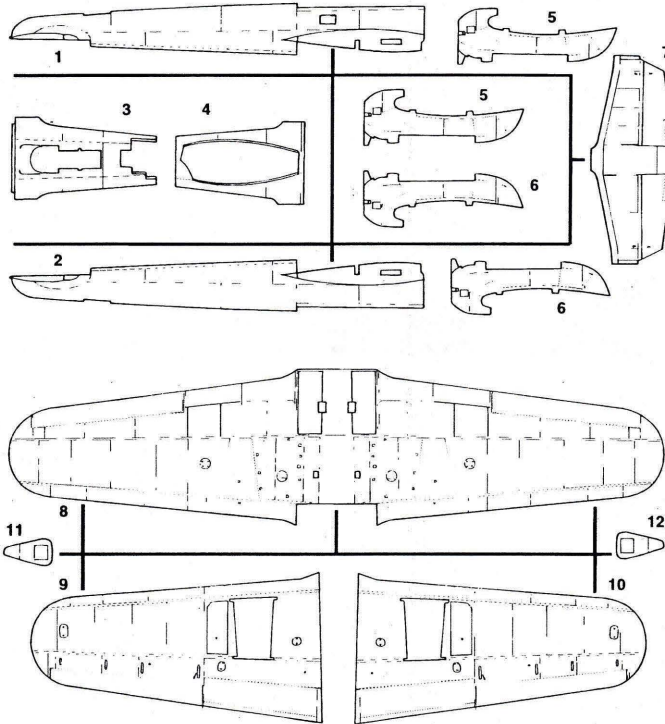

RESIN PARTS

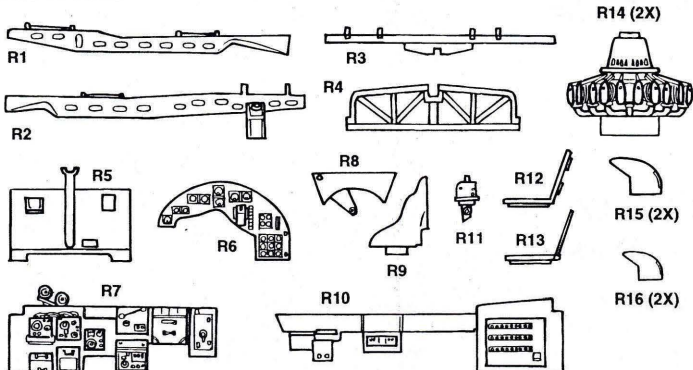

CLEAR PARTS (C)

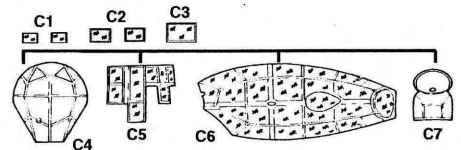

1

A All interior parts

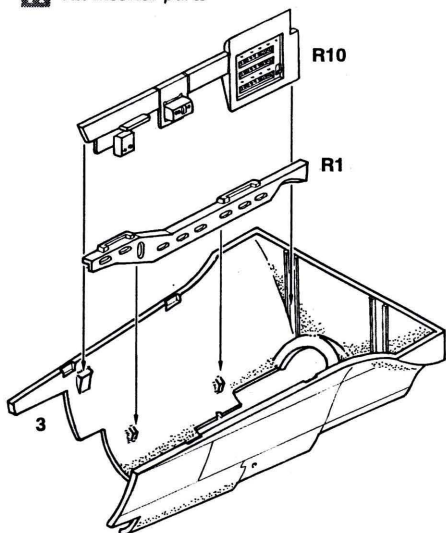

Panel R10 is Satin Black with Silver details

2

A All interior parts

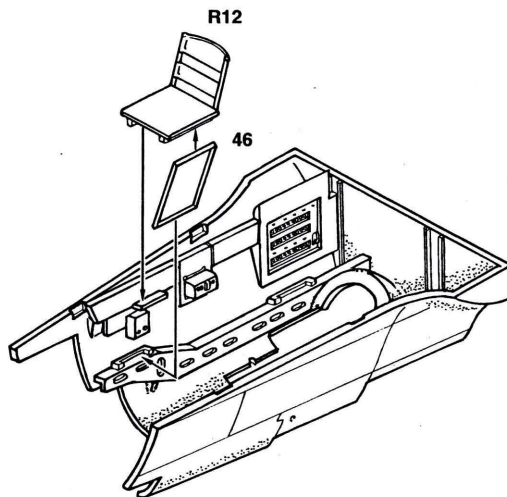

3

A All interior parts

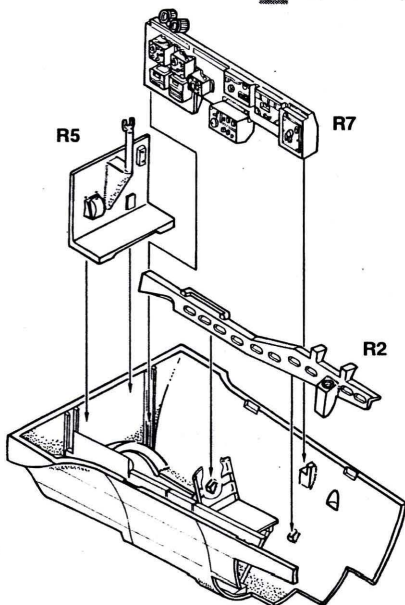

Panel R7 is Satin Black with Silver details

4

A All interior parts

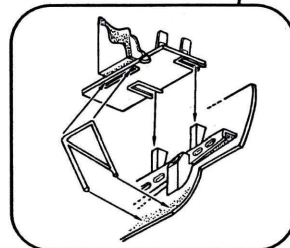
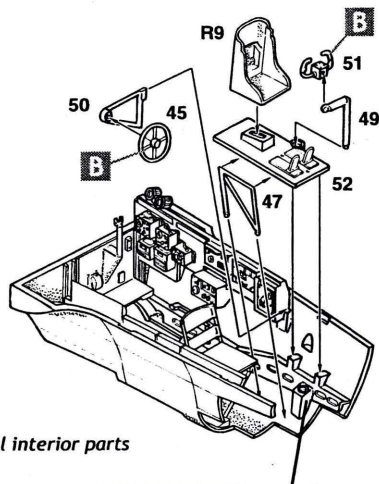

NOTE - Be sure to dry-fit and check alignment of all parts during assembly

5

A All interior parts

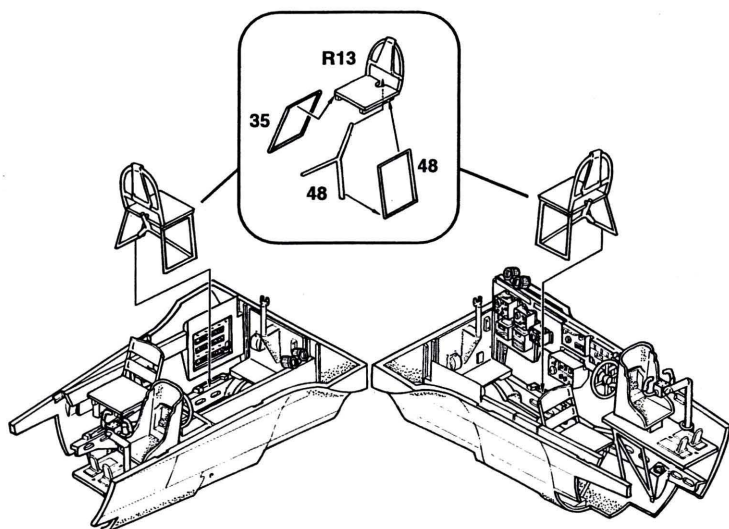

6

A Interior

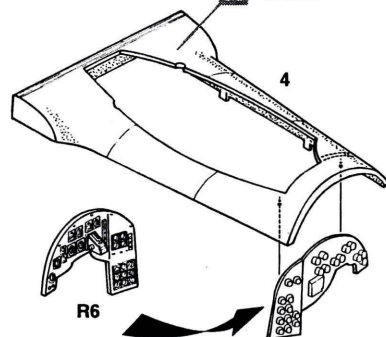

Panel R6 is Satin Black with White and Silver details

NOTE - Be sure to dry-fit and check alignment of all parts during assembly

7

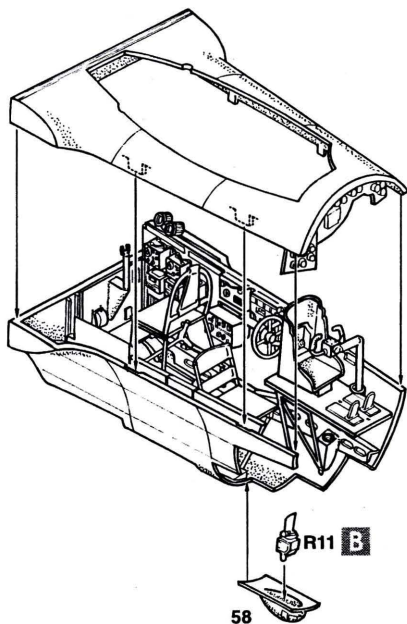

8

A All interior parts and surfaces

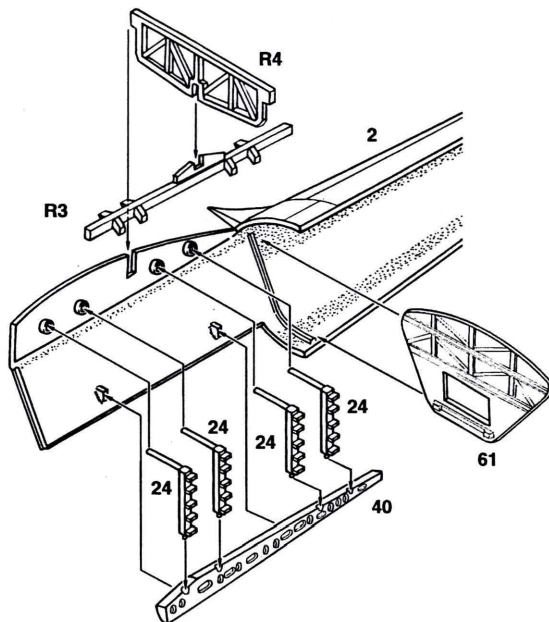

9

A All interior parts and surfaces

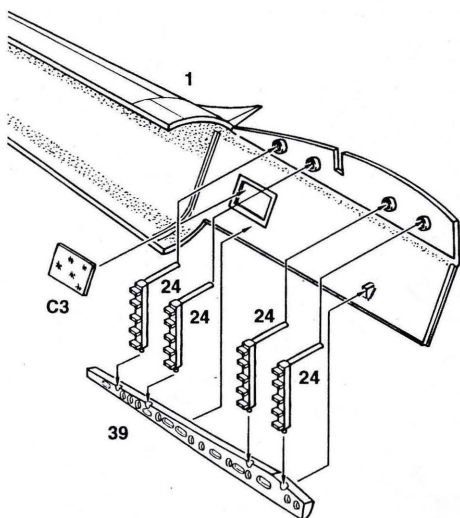

10

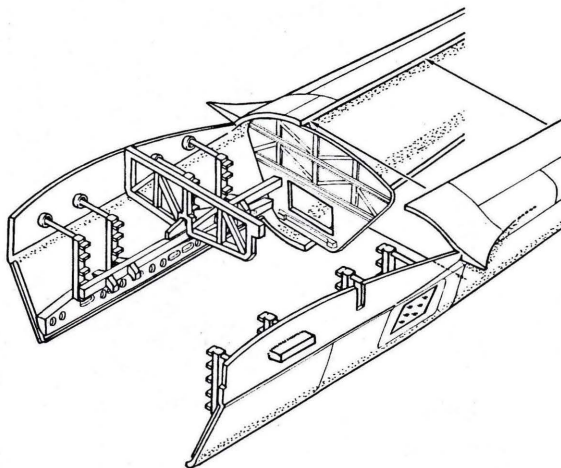

NOTE - Be sure to dry-fit and check alignment of all parts during assembly

11

NOTE - Parts shown upside down

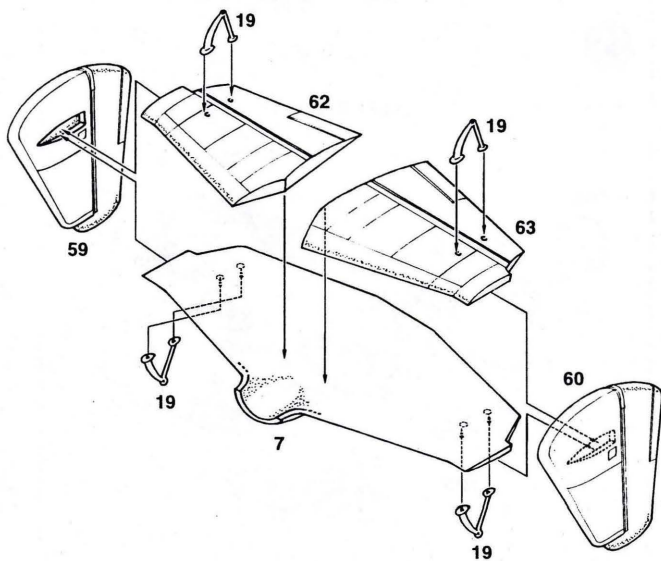

12

NOTE - Parts shown upside down

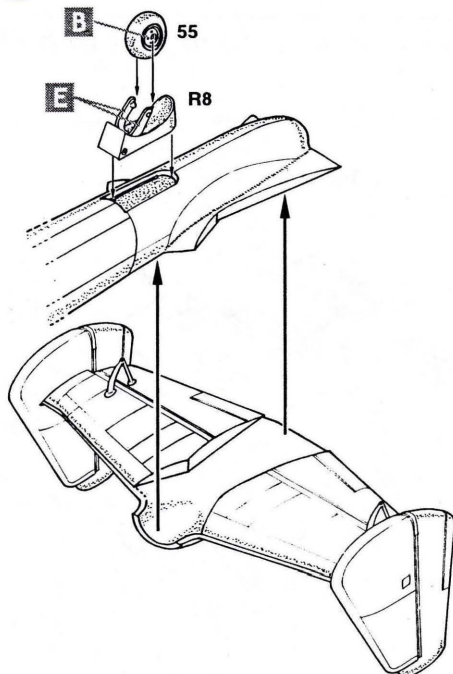

13

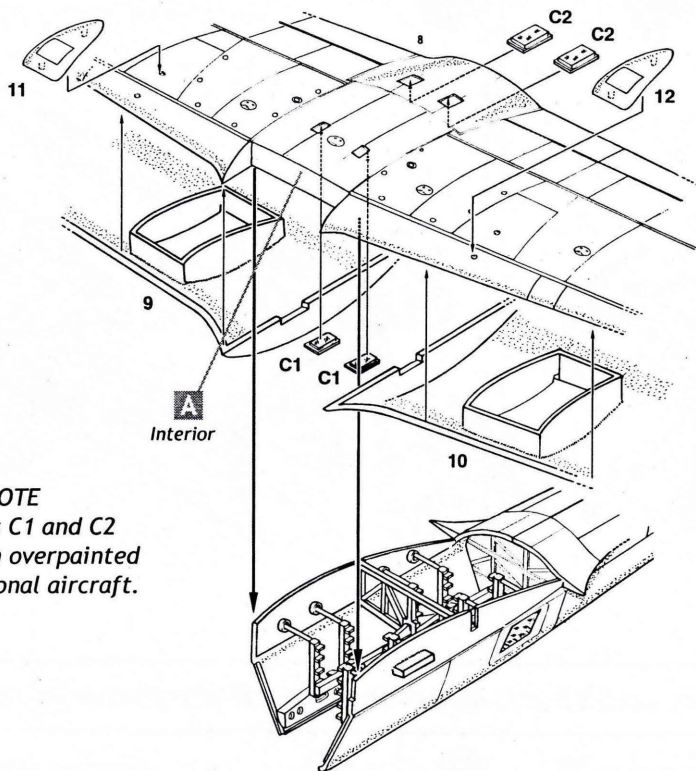

NOTE
Windows C1 and C2
were often overpainted
on operational aircraft.

NOTE - Be sure to dry-fit and check alignment of all parts during assembly

14

RIGHT Engine

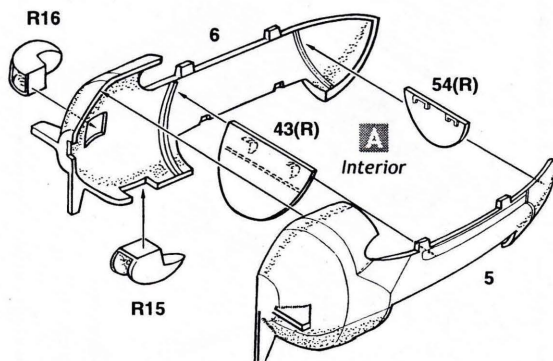

15

LEFT Engine

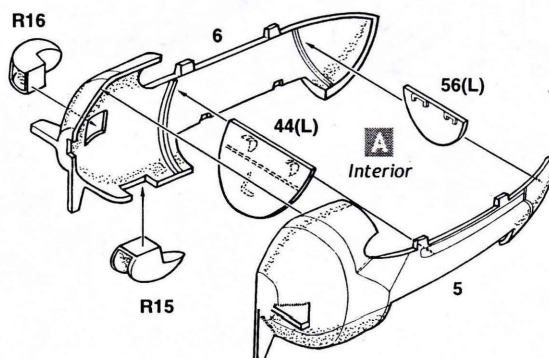

16

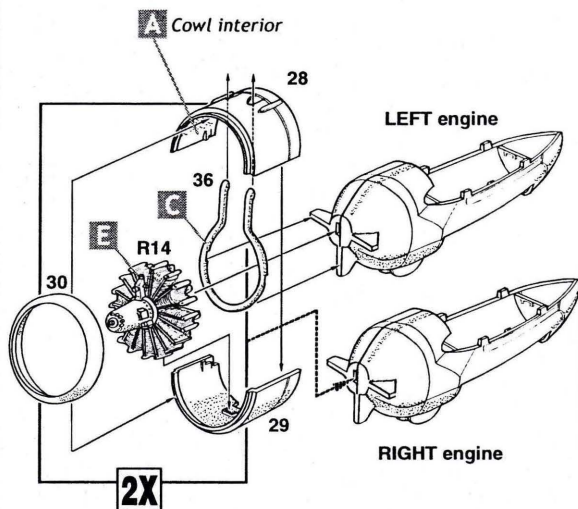

17

NOTE - Parts shown upside down

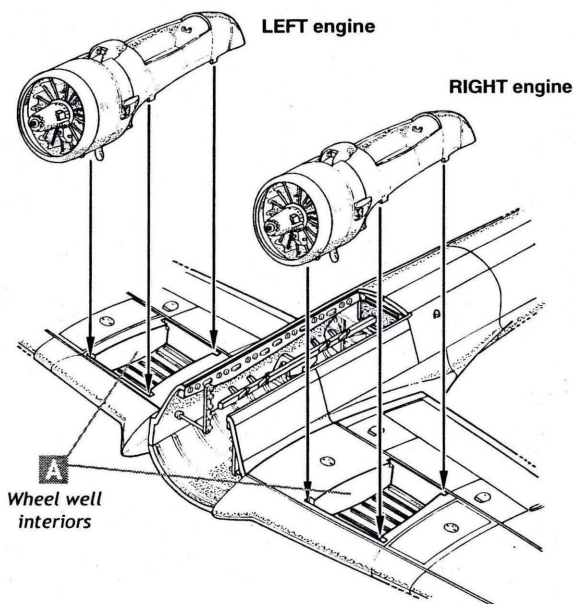

NOTE - Be sure to dry-fit and check alignment of all parts during assembly

18

2X

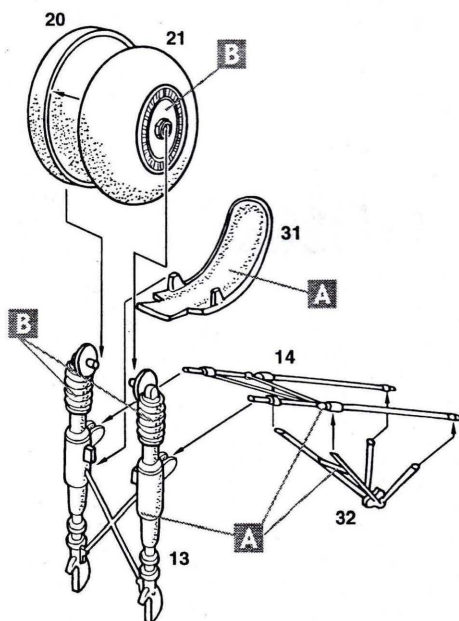

19

A

Door interiors

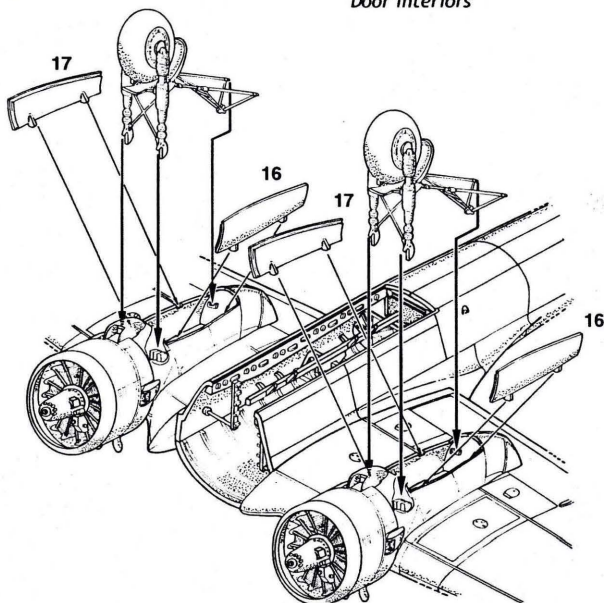

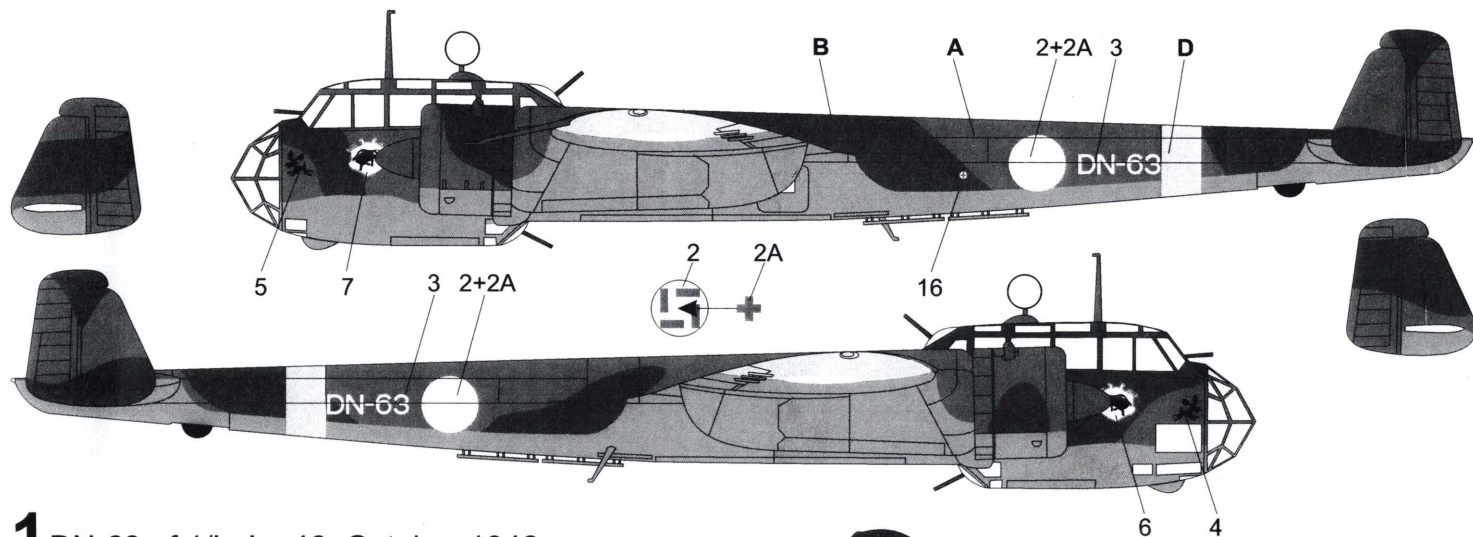

1 DN-63 of 1/LeLv 46, October 1942

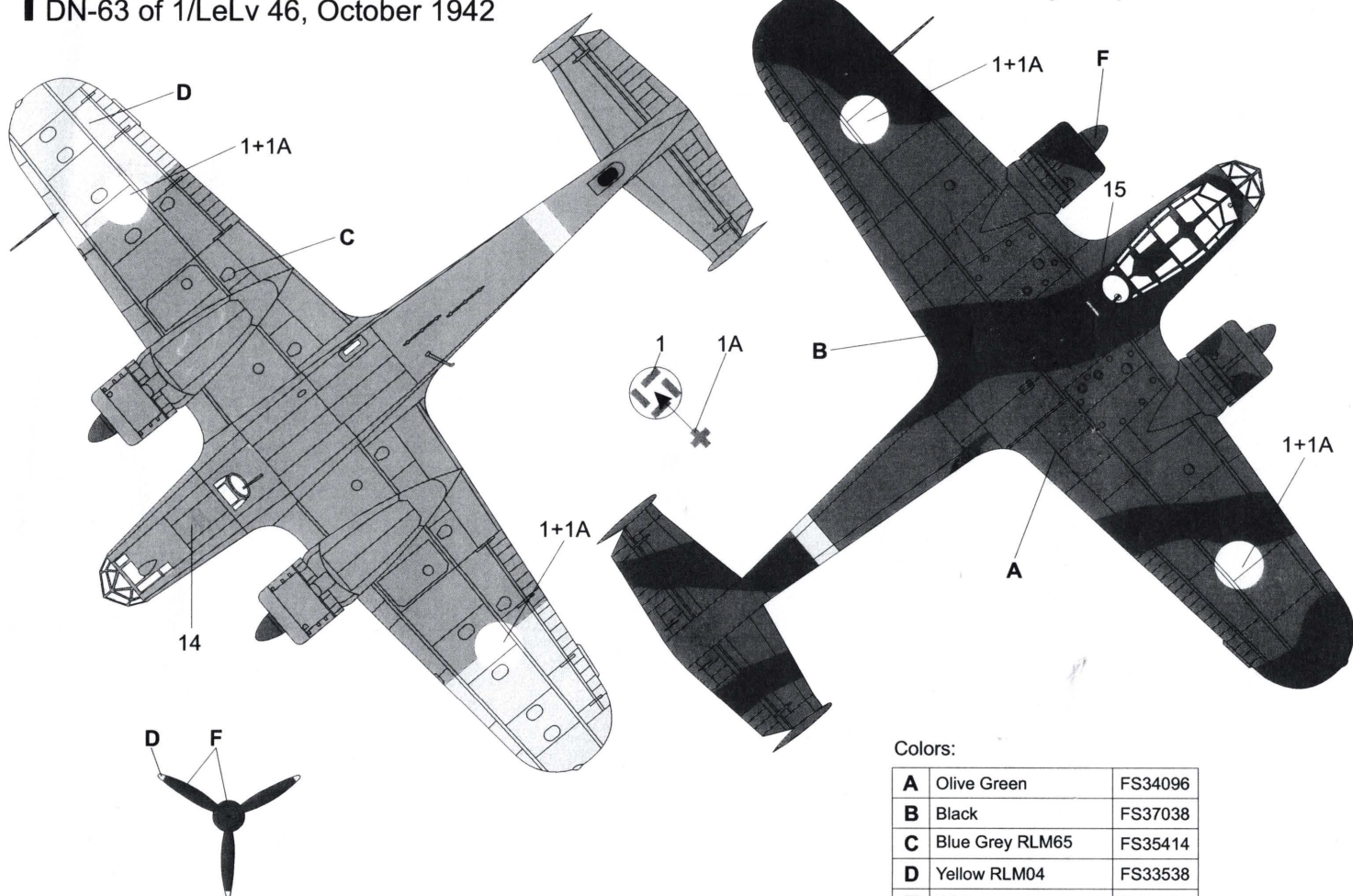

Colors:

A	Olive Green	FS34096
B	Black	FS37038
C	Blue Grey RLM65	FS35414
D	Yellow RLM04	FS33538
E	White	FS37886
F	Black Green RLM70	FS34050

2 DN-53 of 3/LeLv 46, February 1942

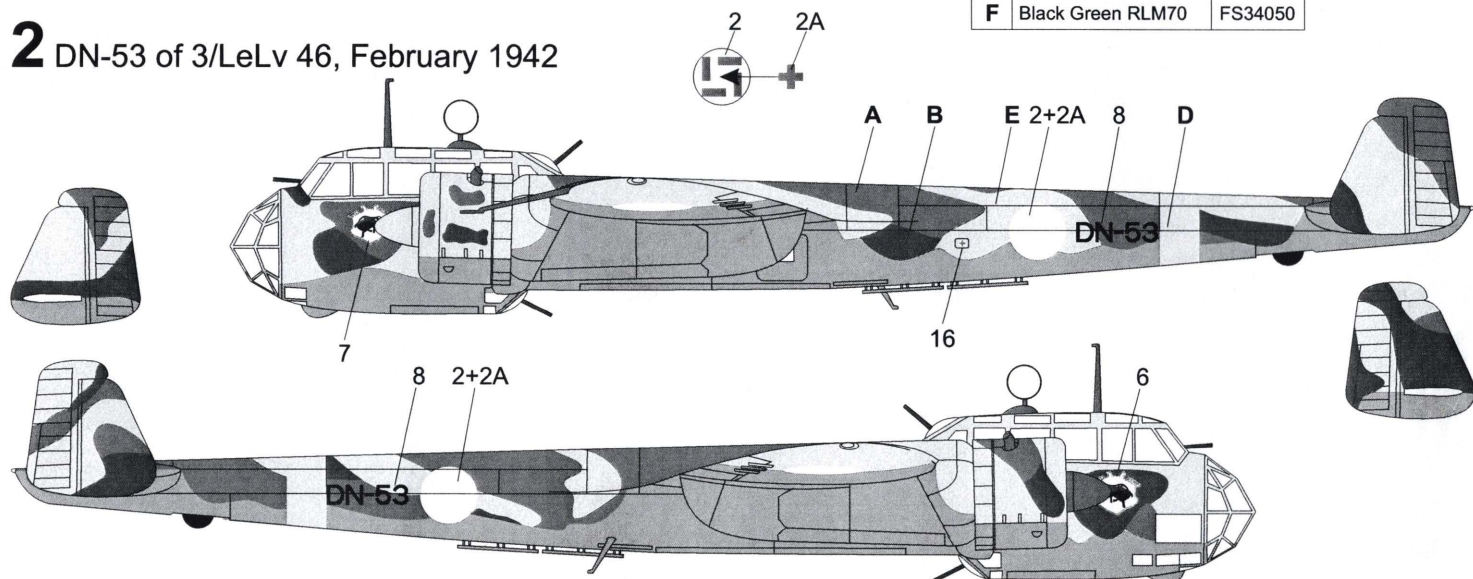

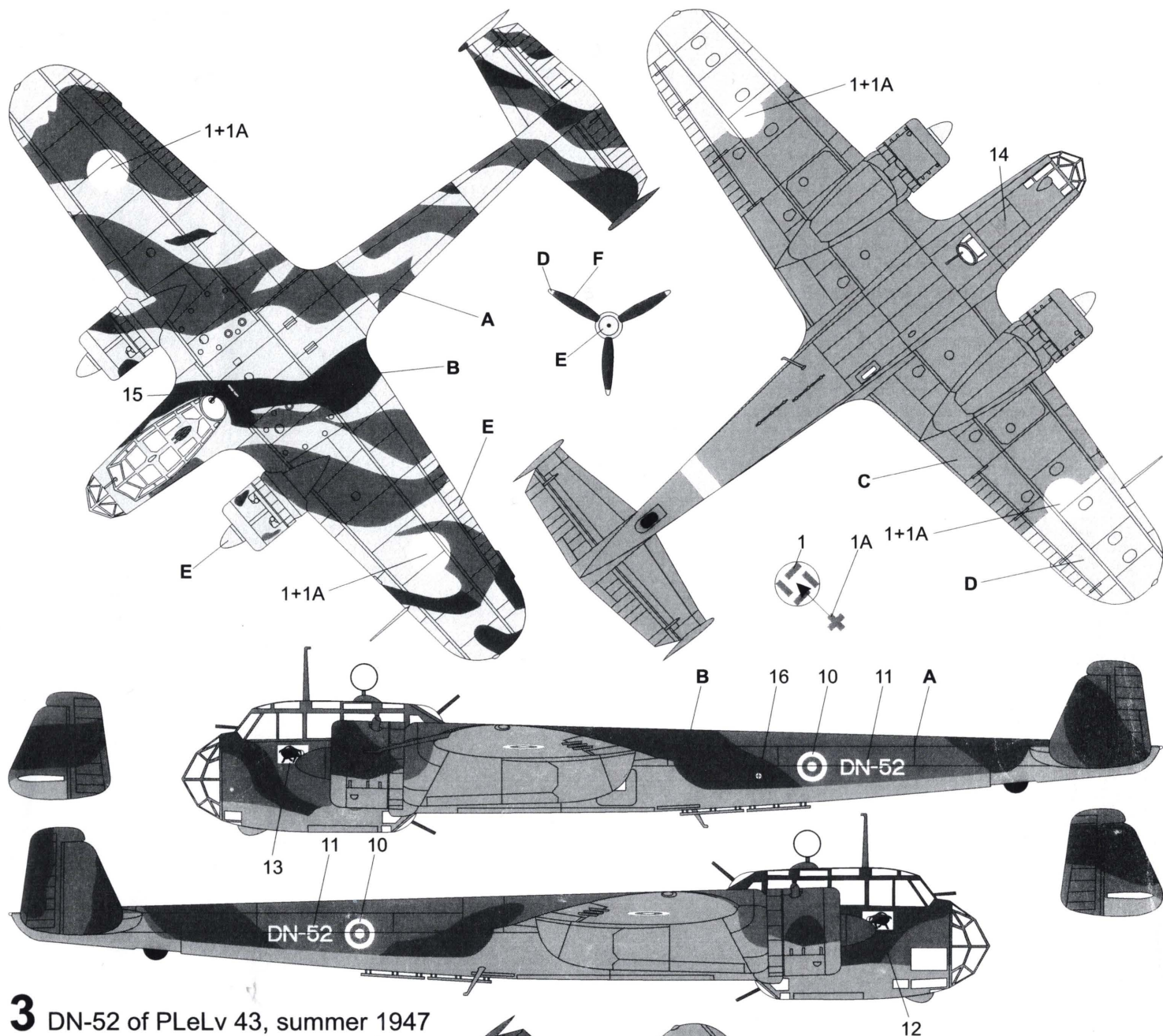

3 DN-52 of PLeLv 43, summer 1947

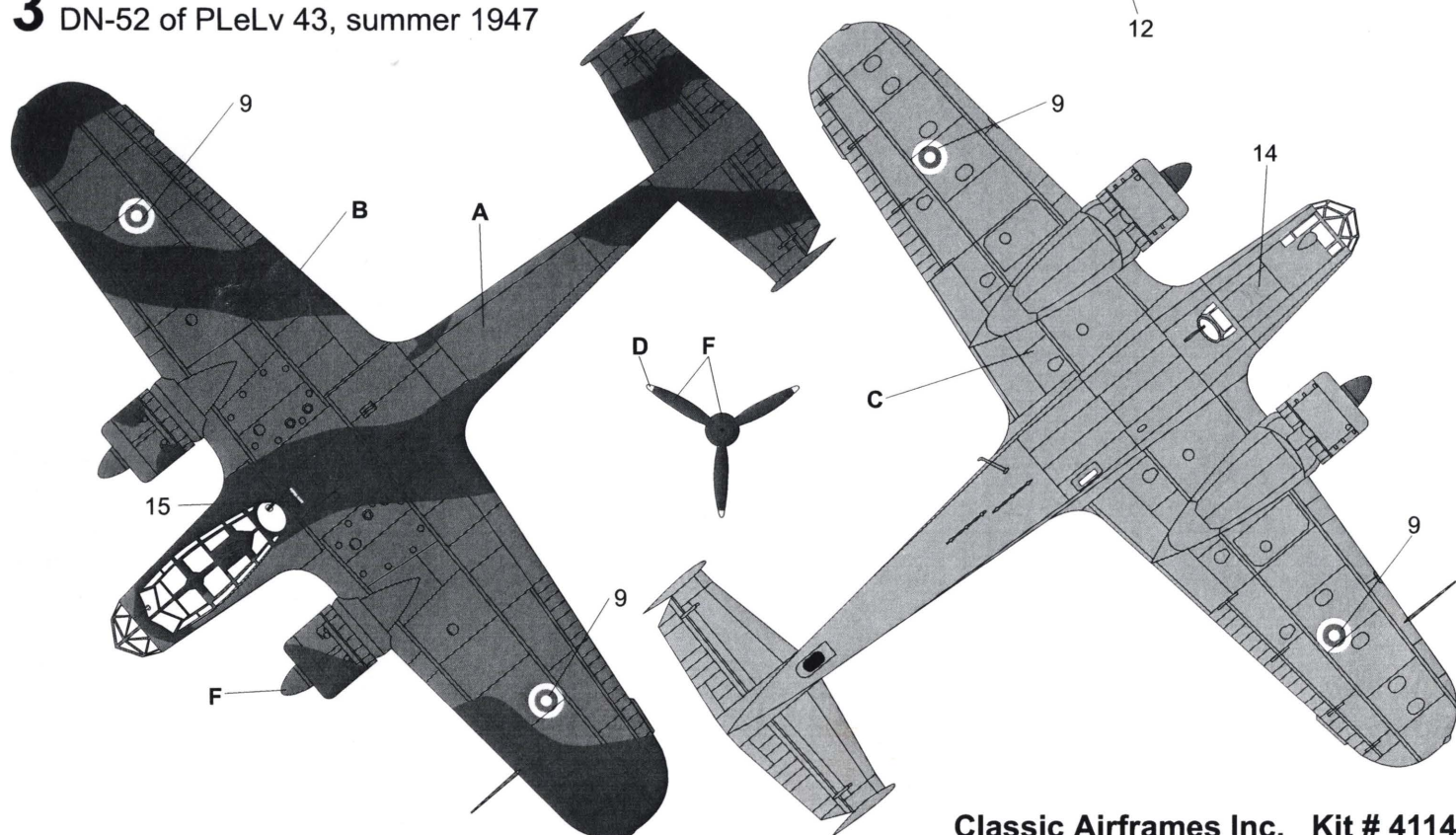

SUOMEN ILMAVOIMIEN HISTORIA ②

Dornier Do 17 Z Junkers Ju 88 A-4

Kalevi Keskinen
Kari Stenman

Lois Quagana

Hobby-Kustannus Oy



THE BEST SOURCE FOR FINNISH Dornier Do 17 Zs

Size B5 (250-175 mm) with 112 pages

53 pages for the Do 17 containing:

- 82 photos with many close-ups
- 4 color profiles by John Weal
- original factory cut-away drawing
- individual aircraft histories
- LeLv 46 operational history
- English summary and photo captions



DN-53



DN-52



HISTORY OF THE FINNISH AIR FORCE

SIH 1A: Brewster Model 239 part 1	ISBN 952-99432-3-7
SIH 1B: Brewster Model 239 part 2	ISBN 952-99432-4-5
SIH 2: Dornier Do 17 Z & Junkers Ju 88 A.....	ISBN 952-5334-01-5
SIH 3A: Fokker D.XXI (Mercury)	ISBN 952-5334-02-3
SIH 3B: Fokker D.XXI (Twin Wasp).....	ISBN 952-5334-03-1
SIH 4: Morane-Saulnier M.S. 406	ISBN 952-98751-8-2
SIH 5: Curtiss Hawk 75A & P-40M.....	ISBN 952-98571-9-0
SIH 6A: Messerschmitt Bf 109 G-2.....	ISBN 952-5334-04-X
SIH 6B: Messerschmitt Bf 109 G-6.....	ISBN 952-5334-05-8
SIH 7: Russian Fighters	ISBN 952-99432-5-3
SIH 8: Fiat G.50 & C.R. 714	ISBN 952-99432-0-2
SIH 9: Russian Bombers.....	ISBN 952-99432-7-X
SIH 10: Bristol Blenheim.....	ISBN 952-99432-1-0
SIH 17: LeR 2	ISBN 951-98751-0-7
SIH 18: LeR 3	ISBN 951-98751-1-5
SIH 19: LeR 4	ISBN 951-98751-2-3
SIH 20: LeR 1	ISBN 951-98751-3-1
SIH 21: Flying Knights (Decorated Airmen).....	ISBN 951-78951-4-X
SIH 22: Trainers.....	ISBN 951-98751-5-8
SIH 23: Warpaint	ISBN 951-98751-6-6
SIH 24: LeR 5	ISBN 952-98751-7-4
SIH 25: Hawker Hurricane & Gloster Gladiator	ISBN 952-99432-6-1
SIH 26: Aerial Victories part 1.....	ISBN 952-99432-8-8
SIH 27: Aerial Victories part 2.....	ISBN 952-99432-9-6
SIV I: Finnish Air Force 1918-27	ISBN 952-99432-2-9
SIV II: Finnish Air Force 1928-40.....	ISBN 952-99743-0-2
SIV III: Finnish Air Force 1941.....	ISBN 952-99743-1-3

Kari Stenman Publishing
Maininkitie 14 A
FIN-02320 Espoo

www.kolumbus.fi/kari.stenman
kari.stenman@kolumbus.fi
Tel/fax +358 9 809 2187



1



2



1



1A



2



2A



1A



DN-63

3

DN-53

8

DN-63

DN-53



9



10



11



12



13



11

DN-52

DN-52



4



5



6



7



14
VARO
POTKUREITA
KULJE
TAKAKAUITTA

15

ASTU TÄNNE

16

+

Classic Airframes Inc. Kit # 4114

Printed by
TECHMOD