

# M36 JACKSON Tank Destroyer

In the early days of WW II, the Germans converted obsolete tanks into tank destroyers. With newly added guns that are of larger caliber, such modification had adequately compensated the fighting strength of the German Army. Being inspired by such developments, the US Army had consequentially redefined their requirement on offensive/defensive ratios of fighting vehicles, and started the development of their own tank destroyers.

By 1943, the M10 tank destroyer, which was converted from M4A2, made its combat debut in the North African Theater. Unlike its German counterparts, M10 sacrificed proper armor protection to give way to a 360-degree pivoting turret. On the other hand, a 76mm cannon was adopted, which was more powerful than the armament of many of its contemporary tanks. Infantry support was defined as the main role of these tank destroyers, and M10 was proved to be very competent in the battle of Tunisia.

However, after the allied invasion of Europe and their encounter with newer, heavily-armed German tanks, the 76mm gun of the M10 found itself no longer sufficient to deal with these new opponents, forcing the US Army officials to look into the possibility of upgrading the fire power of the M10. Consequentially, the 90mm cannon was adapted, some modification in the internal space also took place in order to accommodate new ammunitions. In the newly designed turret, a basket structure was partially accommodated, in order to improve the efficiency of the aimer. Space in the turret's extruding back was also ingeniously designed to make more room for ammunition storage. Consequentially, the counter-weight armor on the back of the original M10 turret was deleted, in order to decrease the weight of the new vehicle.

Production of this new tank destroyer, which was designated M36, started on April 1944. M36s were pressed into tank destroyer battalions, and began to see action in the Normandy Invasion soon after its debut. Being a highly successful vehicle, the demand for the M36 was so great that its pace of production was never able to fulfill. This had led to the solution of mounting the M36's 90mm gun turret onto the M4A3 hull, which was designated the M36B1. Despite the height of this hybrid was higher than the M36, the M36B1 also proved to be a successful vehicle.

On January 1945, the M36s from 776th Tank Destroyer Battalion knocked out a German Jagdtiger, which was the first Jagdtiger being destroyed on the West Front. A newer version that was designed with an attempt to reduce ground pressure, designated the M36B2, was later introduced in April 1945. The M36B2 made its appearance too late for WWII, therefore had not been able to see extensive action until the conflict in Korea and Indo-China broke out. It also saw action as late as 1999 in the war in Kosovo.

第二次大戦の初期からドイツ軍は、旧式化した戦車を駆逐戦車として改造して使用した。新たな大口径砲を搭載したこれらの車輛は、ドイツ軍にとって有効な戦力となっていた。こういった開発に刺激され、アメリカ陸軍は、戦闘車輛についての攻撃／防御の割合の必要条件を見直し、独自の駆逐戦車の開発を開始した。

1943年までに、M4A2シャーマン戦車から改造されたM10駆逐戦車が北アフリカ戦線に投入された。M10は、ドイツ軍の駆逐戦車と異なり、完全な防御装甲を持たない代わりに、360度旋回可能な砲塔を有していた。また、装備した76mm砲は、当時の多くの戦車よりも強力なものだった。駆逐戦車は、歩兵支援が主な任務と定義され、M10は、チュニジアの戦闘において、その有効性を実証したのである。

しかし、連合軍がヨーロッパに侵攻し、ドイツ軍の重装甲の新型戦車と交戦すると、M10の76mm砲は威力不足であることが明らかとなり、アメリカ陸軍は、M10の砲威力の増強について調査、90mm砲の搭載が検討されたが、砲塔内部のスペースは大型化した砲弾の収容に不十分であり、そのため、新たに砲塔が設計されることとなる。大きく張り出した砲塔後部は、砲弾収納のスペースを確保するための巧みな設計であった。M10で砲塔後部に搭載されたカウンターウェイトは不要となり、車重軽減のため撤去された。

新型駆逐戦車は、M36として、1944年4月に生産が開始される。M36は、駆逐戦車大隊に配備され、ノルマンディ上陸作戦後すぐに戦線に投入された。前線での評価は高く 生産量は需要を満たすことはできなかった。そのため、M36の砲塔をM4A3の車体に搭載したタイプが、M36B1として採用された。M36B1は、M36よりも車高が高くなったものの、優秀な車輛であることに変わりはないのである。

1945年1月、第776駆逐戦車大隊のM36が、ドイツ軍のヤクトタイガーを撃破した。これは西部戦線で初めて撃破されたヤクトタイガーであった。接地圧を軽減した新型が、M36B2として1945年4月に採用された。M36B2は、第二次大戦には間に合わなかったが、朝鮮戦争、インドシナ戦争において、広範囲に使用され、また、1999年のコソボ1999年のコソボでの戦いでも使用されたのである。

在二戰初期,德國將漸形落伍的戰車之戰鬥室加以修改,使之成為能夠安裝更大口徑火炮的戰車驅逐車,適時的填補了戰力上的空隙,這樣的利用方式給與美國陸軍很大的啟發,美國人重新修訂了防禦力與攻擊力的配比開發屬於自己的戰車驅逐車。

1943年時由M4A2戰車為雛型所開發的M10戰車驅逐車正式於北非登場,與德國設計哲學不同的,M10削弱了裝甲的保護,而選擇了全周迴轉的砲塔,與德國相同的,它們都擁有比當時戰車更有威力的76mm主砲,美國將這樣的戰車驅逐車主要安排做為提供步兵火力支援的任務,突尼西亞的實戰也證實了它的實用價值。

但隨著戰事的進入歐洲,M10擁有的火力面對德國陸續登場的重型戰車漸漸顯得力不從心,新的發展是將90mm口徑火炮導入,並稍稍修改車身內的配置以適應新的彈藥,此外,又設計了新的砲塔,新砲塔內含有部份的吊籃結構,以增加瞄準手的工作效率,並有效的利用砲塔後方空間儲存彈藥,因此而捨棄了M10砲塔的配重裝甲,使得全車的重量得以下降。

新的戰車驅逐車於1944年4月開始生產並賦與M36的制式編號,編入驅逐戰車營隨後並參與了諾曼地登陸的作戰,由於M36的成功及戰場上需求的殷切,部分M36砲塔被直接搭載於M4A3戰車上成為M36B1,雖然車身高度增加,但卻仍不失為理想的應急裝備。

1945年1月德軍在西線第一輛被摧毀的獵虎式(Jagdtiger)戰車驅逐車便是由美國776驅逐戰車營的M36所造成,1945年4月為減少接地壓力的M36B2登場,不過隨著戰事進入尾聲,M36B2直到韓戰及法國的印度支那半島戰爭才又有了新的舞台,直到1999年南斯拉夫科索伏內戰依然可見到M36B2的身影。

### Illustration:圖示說明



Agglutinate  
用膠黏合



No Agglutinate  
不用黏合



Make 2 Sets  
二組製作



Cut Off  
切除



Optional  
選擇使用



Apply Decal  
貼上貼紙



Be Careful  
注意



Open Hole  
鑽孔加工

### Method For Applying Decals:

### 水貼紙使用說明:

1. Clean Model Surface With Wet Cloth.
2. Cut Out Of Decal Sheet And Dip Them In Water For 15 Seconds.
3. Place it on proper position on model.
4. Slide off base paper leaving decals On Model With Wet Finger Tip.
5. Move Decals To Exact Position, Push Out Excess Water Under Decal With Soft Cotton Cloth.
6. When Decals Get Dry Then Complete.

- 1.將模型表面擦乾淨
- 2.將貼紙剪下泡入清水中約15秒
- 3.將泡濕之貼紙取出置於欲貼處旁
- 4.用指尖輕推貼紙表面使其滑出底紙
- 5.將貼紙調整至適當位置並輕擦拭水份
- 6.待其自然乾燥後即完成

### Color list: 塗料表

Color	Brand	Gunze Sangyo			Humbrol	Revell	Life Color
		Hobby Color	Mr.Color	Mr.Color Spray			
Olive drab(2)	橄欖綠	H-78	C-38	J-38	66	46	UA106
Khaki green	卡其綠	H-80	C-54				
Steel	黑鐵	H-18	C-28	J-28	53	91	LC76
Tire black	輪胎黑	H-77	C-137		85	302	LC02
Flat black	消光黑	H-12	C-33	J-33	33	08	LC02
Flat white	消光白	H-11	C-62	J-62	34	05	LC01
Red	紅	H-3	C-3	J-3	19	31	LC56
Bright blue	寶藍	H-15	C-65	J-65	14	51	LC60
Red brown	紅褐	H-47	C-41	J-44	160	383	
Silver	銀	H-8	C-8	J-8	11	90	LC74
Tan	皮革	H-27	C-44	J-44	118		
Brass	黃銅	H-9	C-9	J-9	54	92	LC75

1

Interior  
車身内部

Radio  
無線電

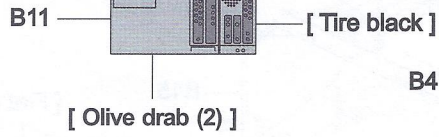

Radio's Seat  
無線電手席

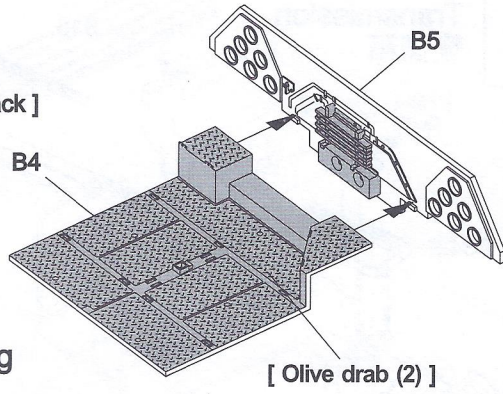
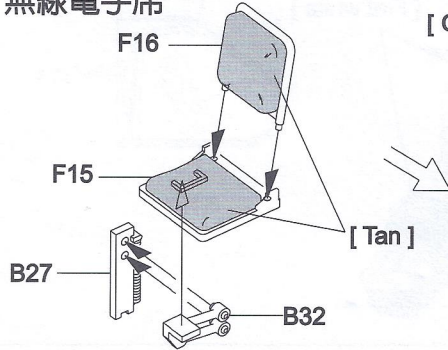

Interior painting  
内部塗装  
[ Flat White ]

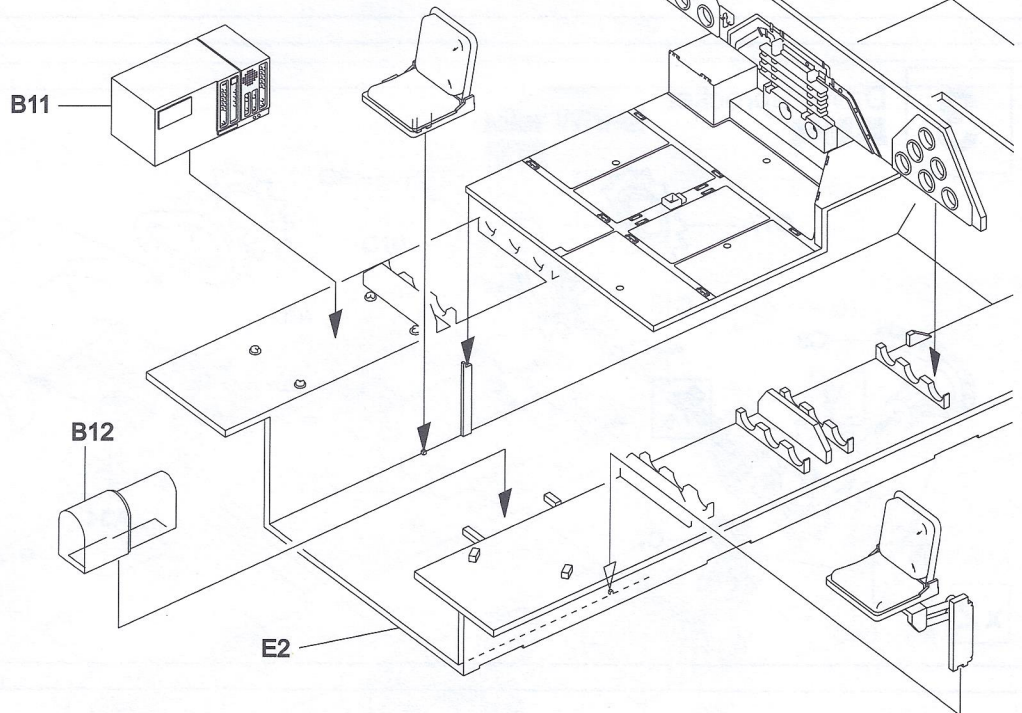

Driver's Seat  
駕駛席

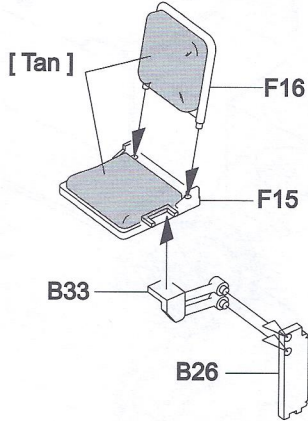

Instrument panel  
儀錶板

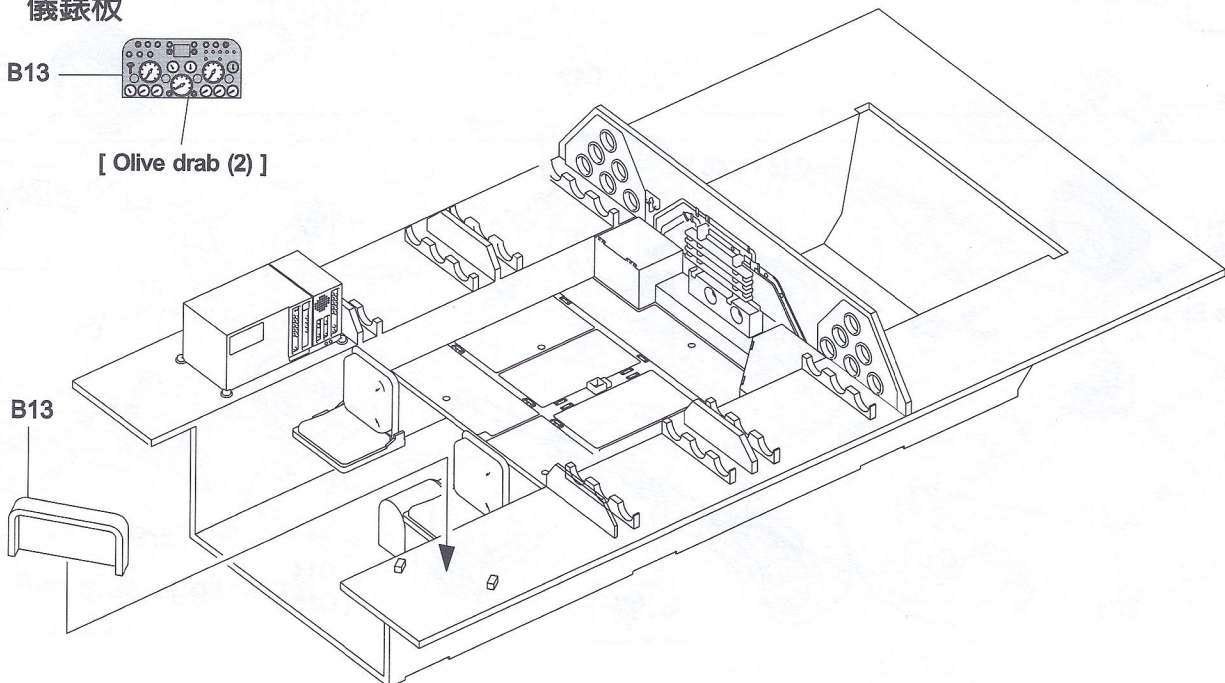
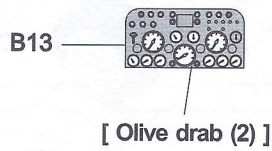

# 2

## Transmission 變速箱

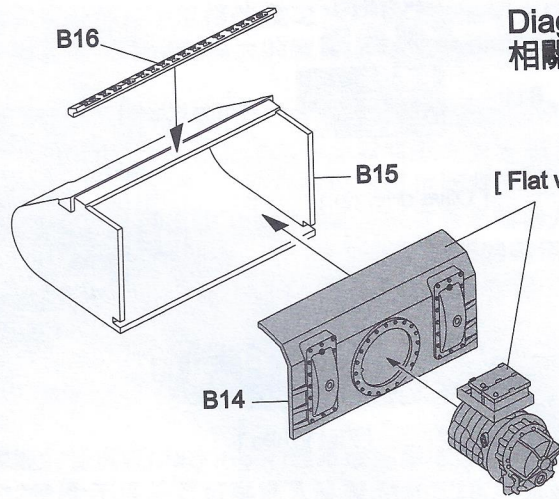
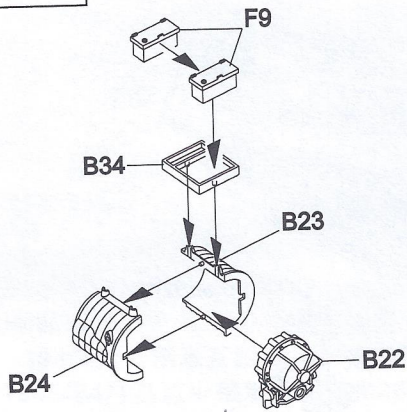

## Diagram of relative location 相關位置參考圖

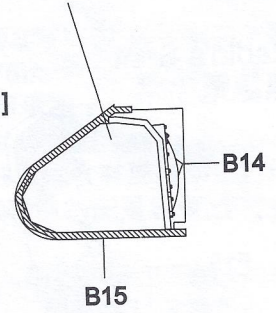

# 3

## Driver Sprocket 驅動輪

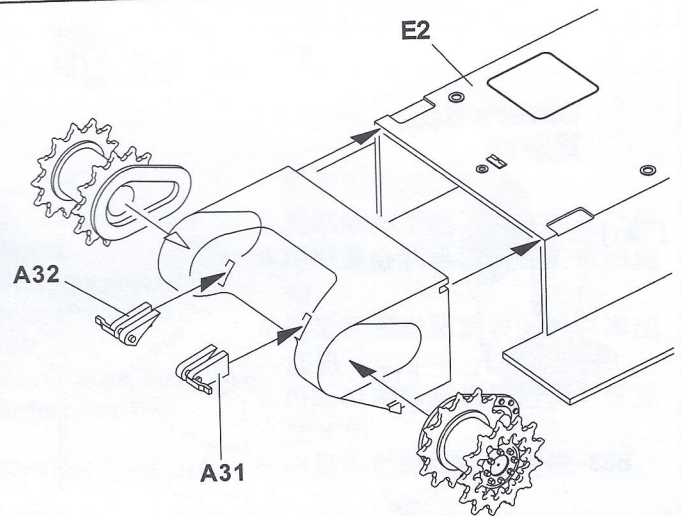
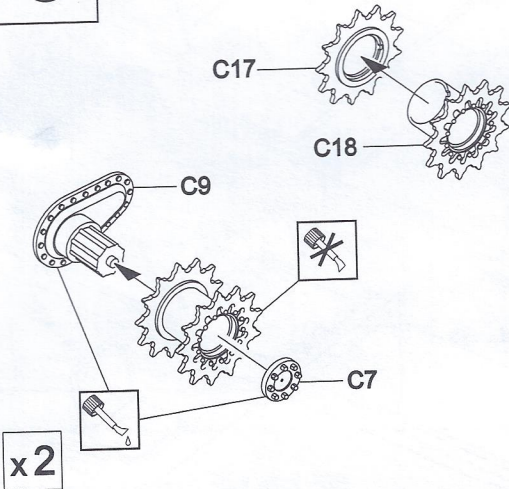

# 4

## Suspension System 懸吊

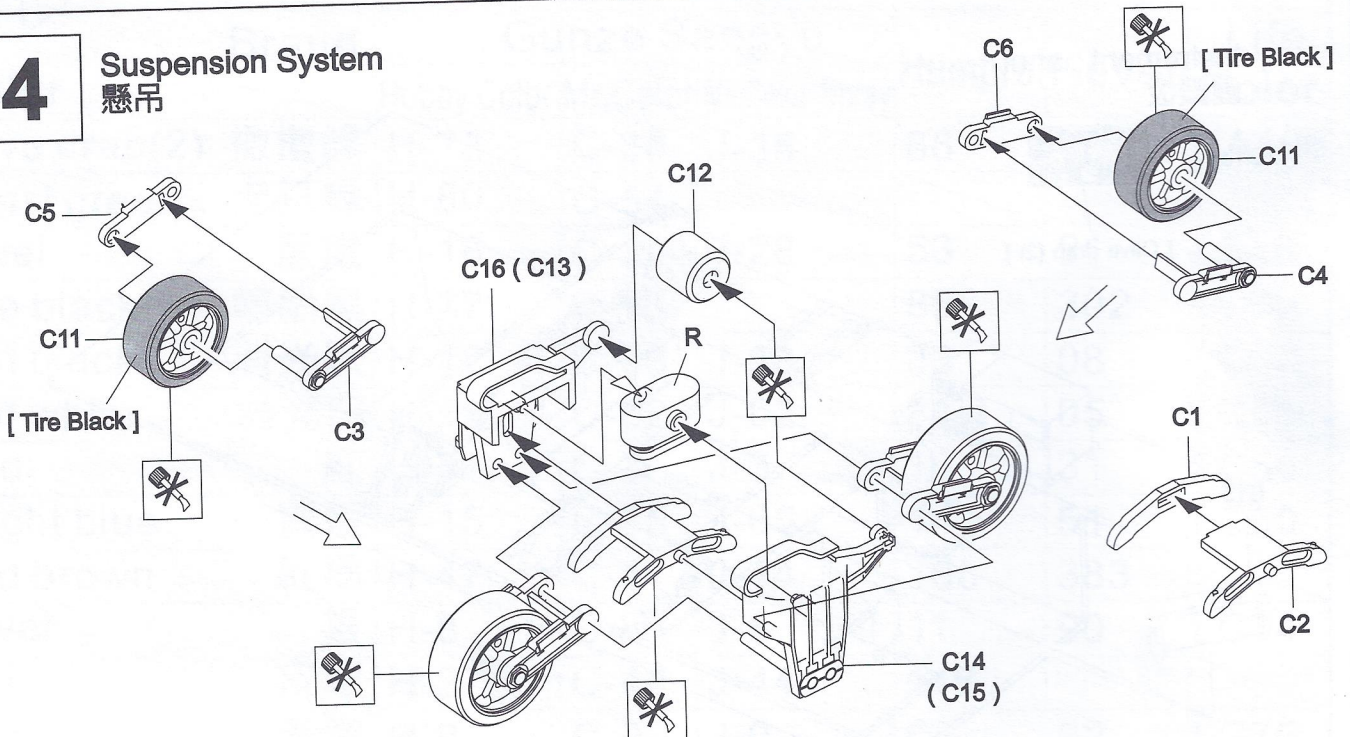

5

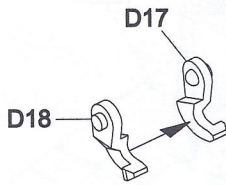

×2

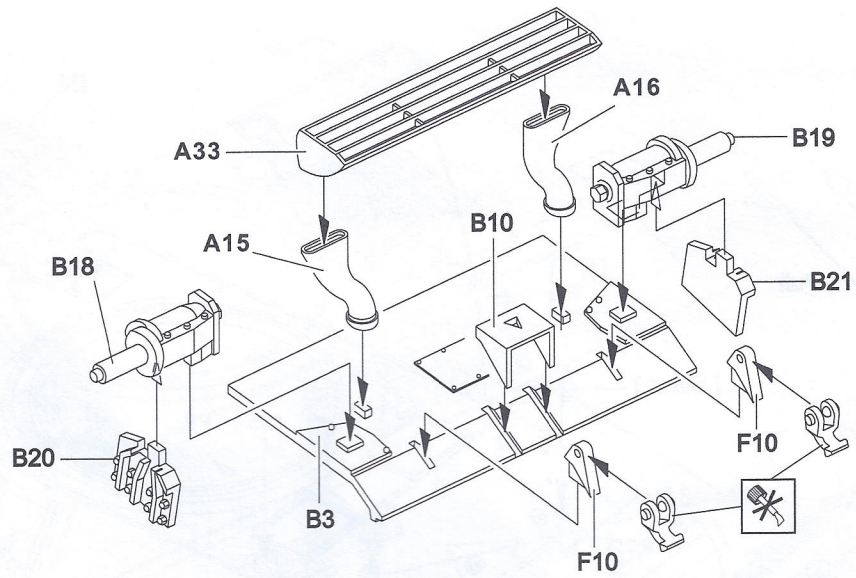

6

Idler Wheel  
惰輪

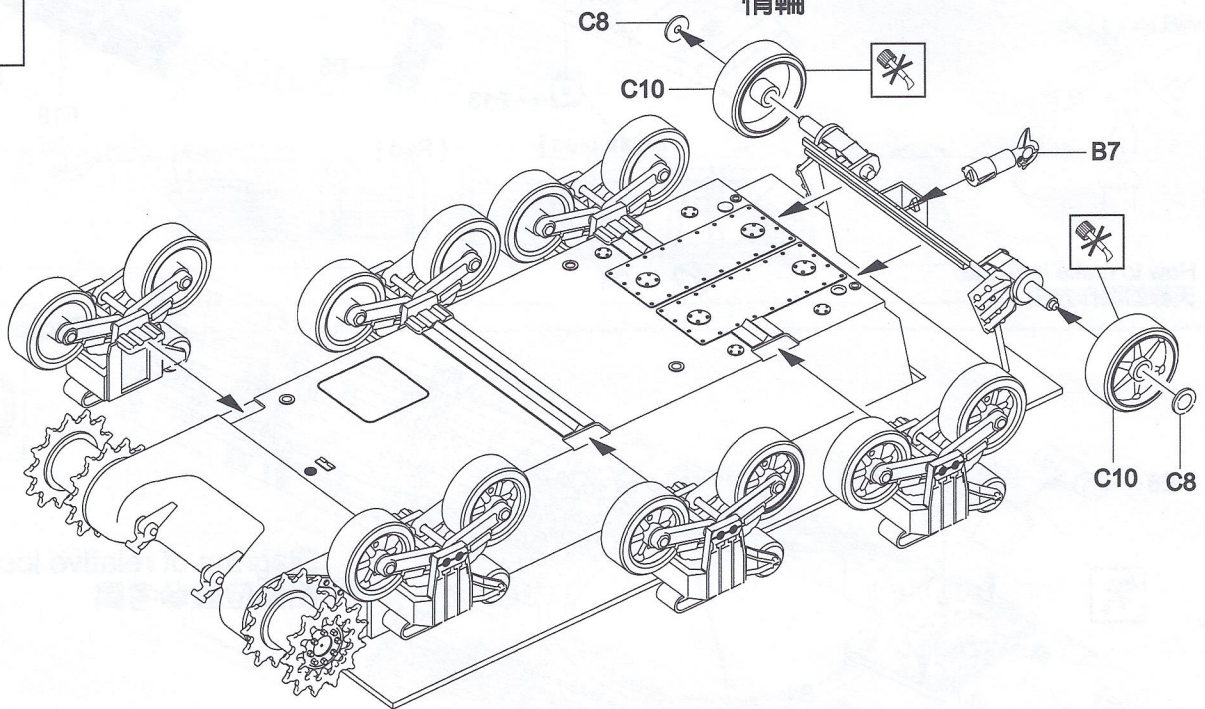

7

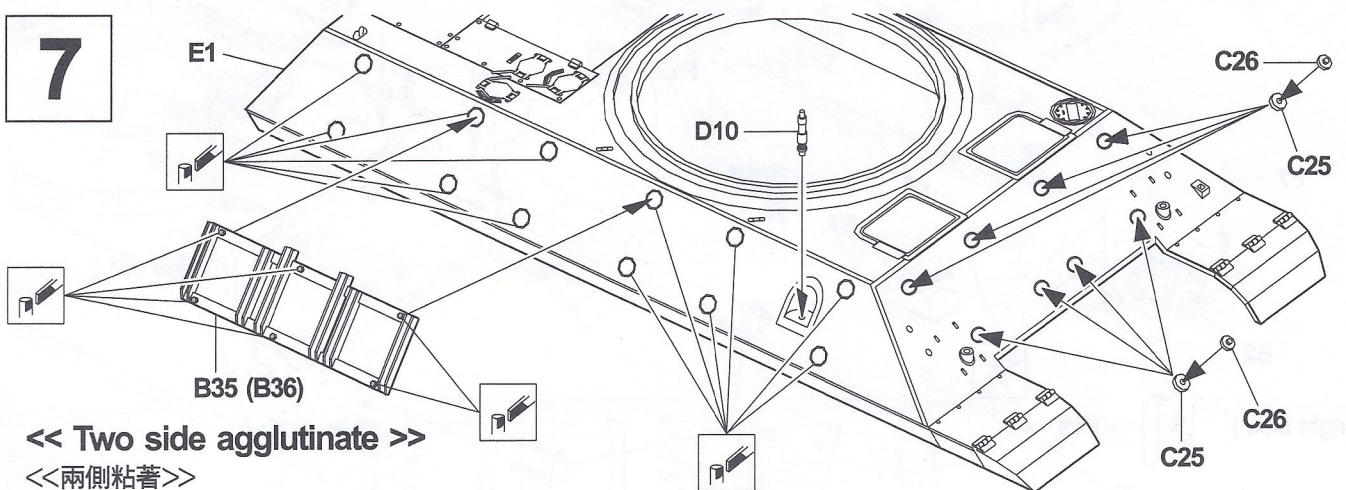

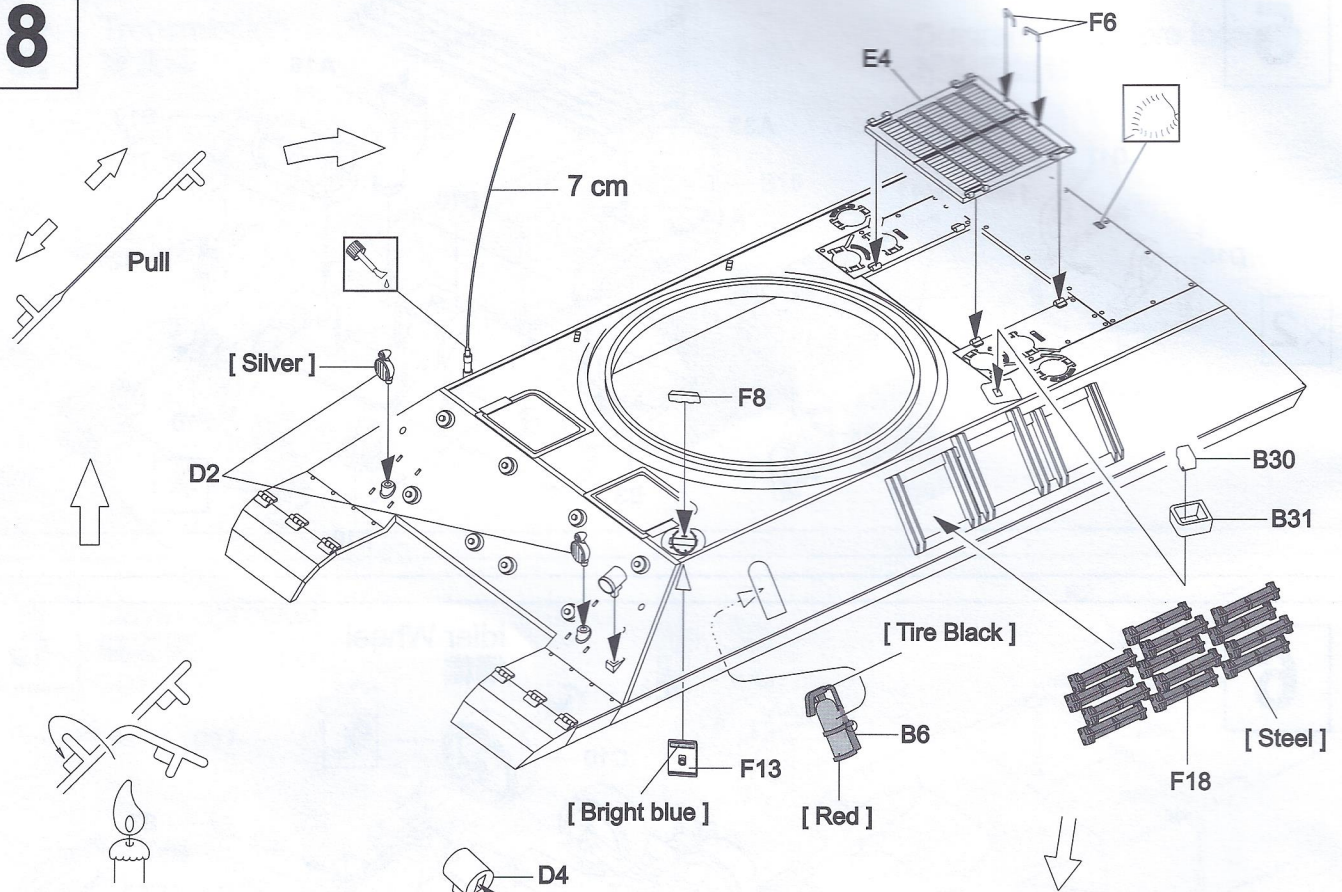

How to make antenna:  
天線的製作方法

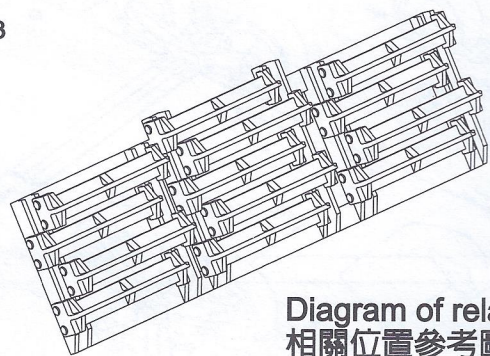

Grouser

Diagram of relative location  
相關位置參考圖

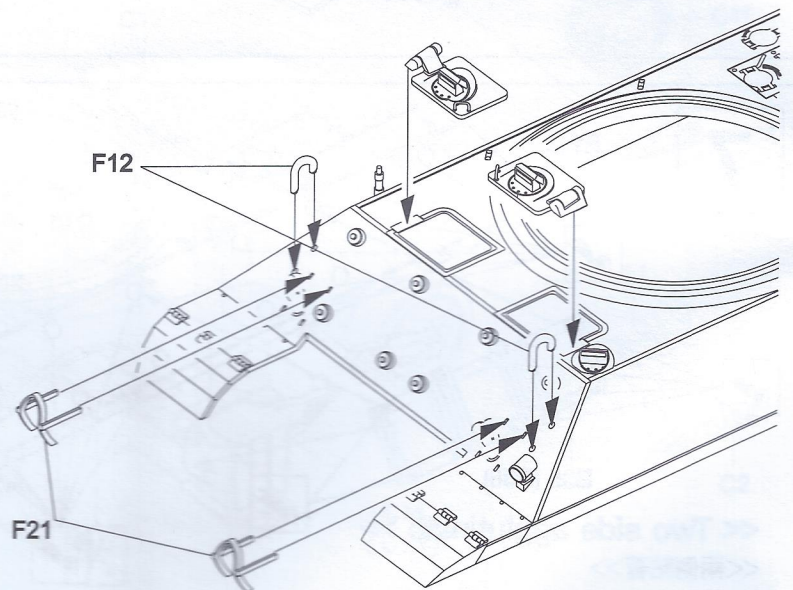
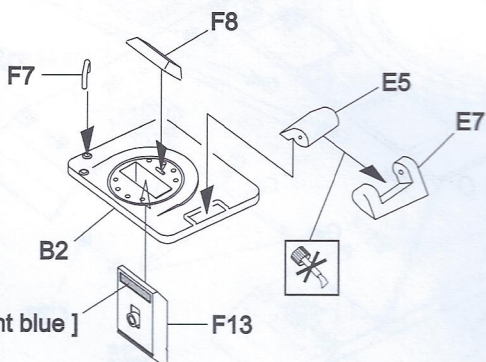
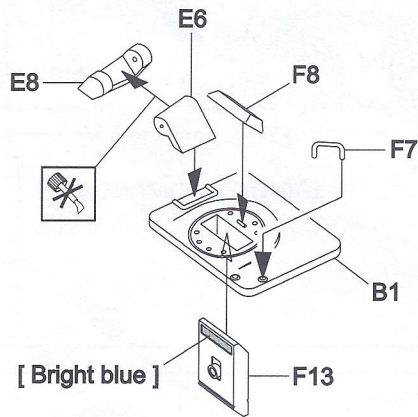

9

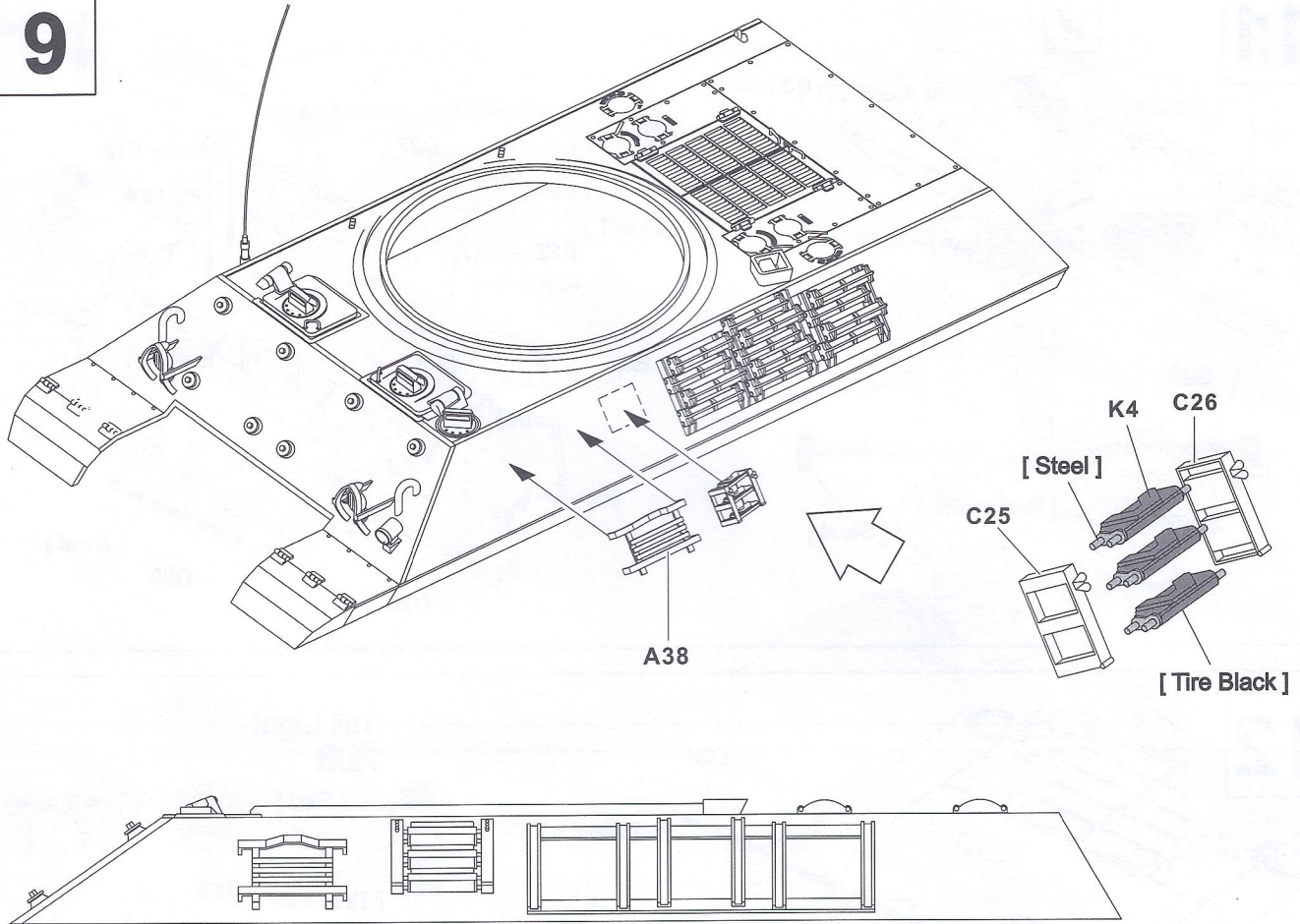

10

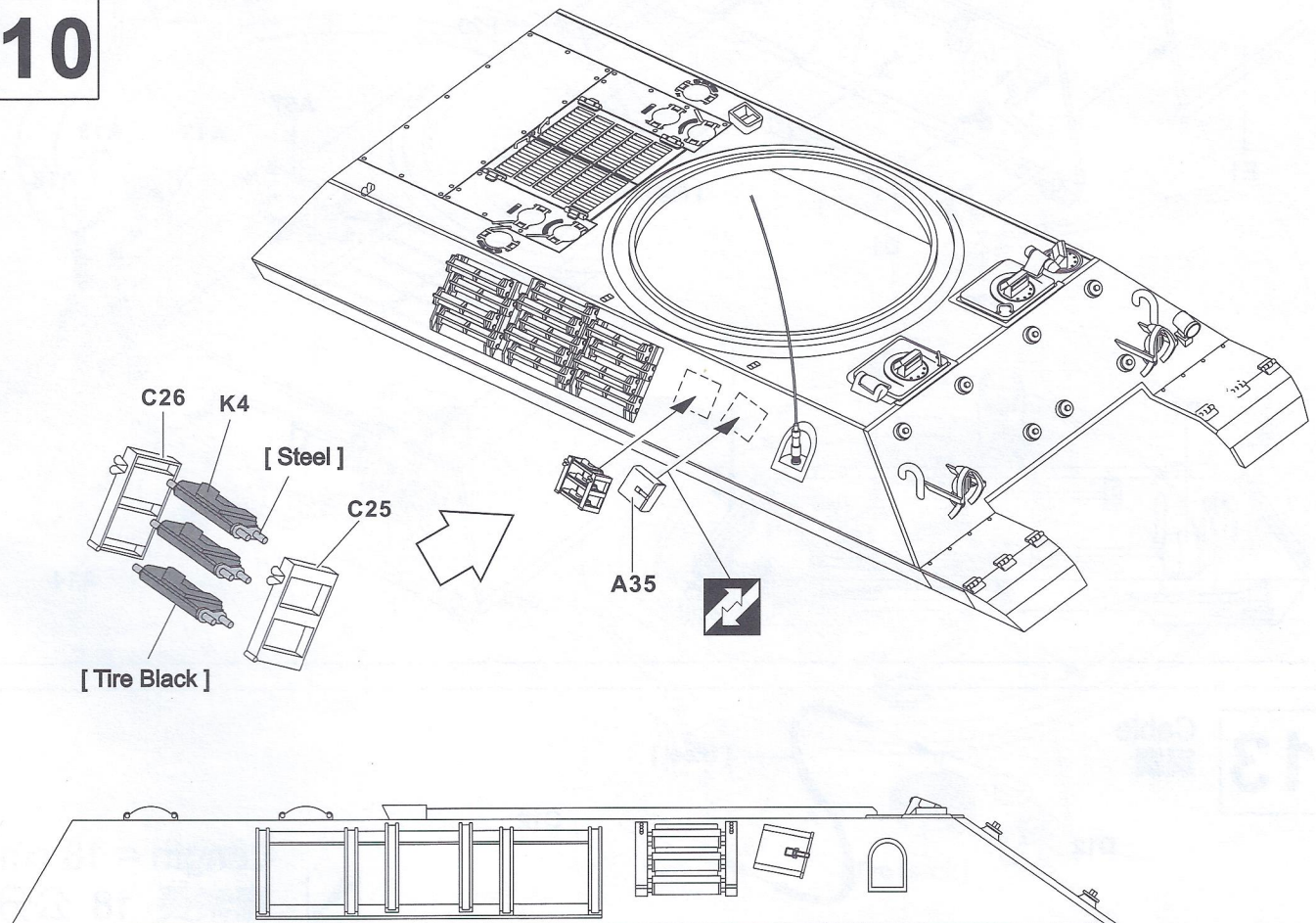

11

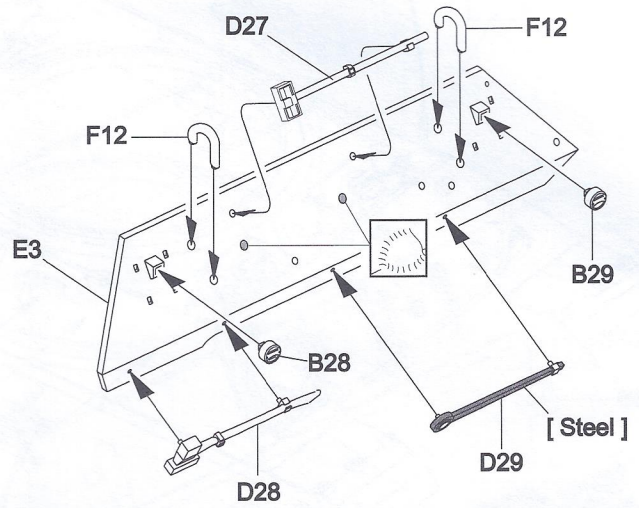
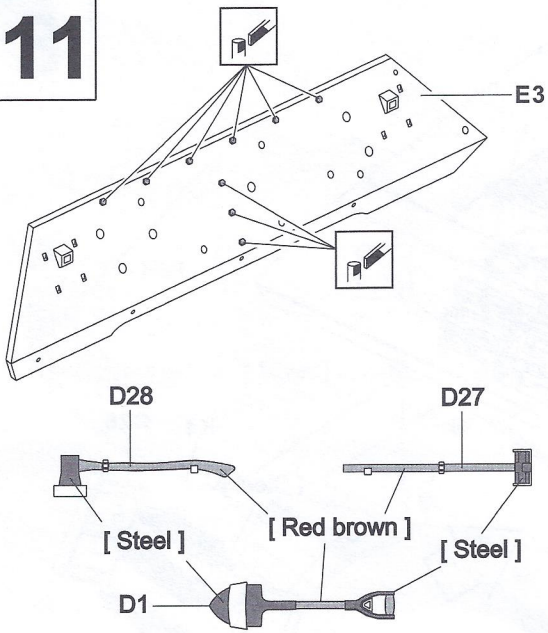

12

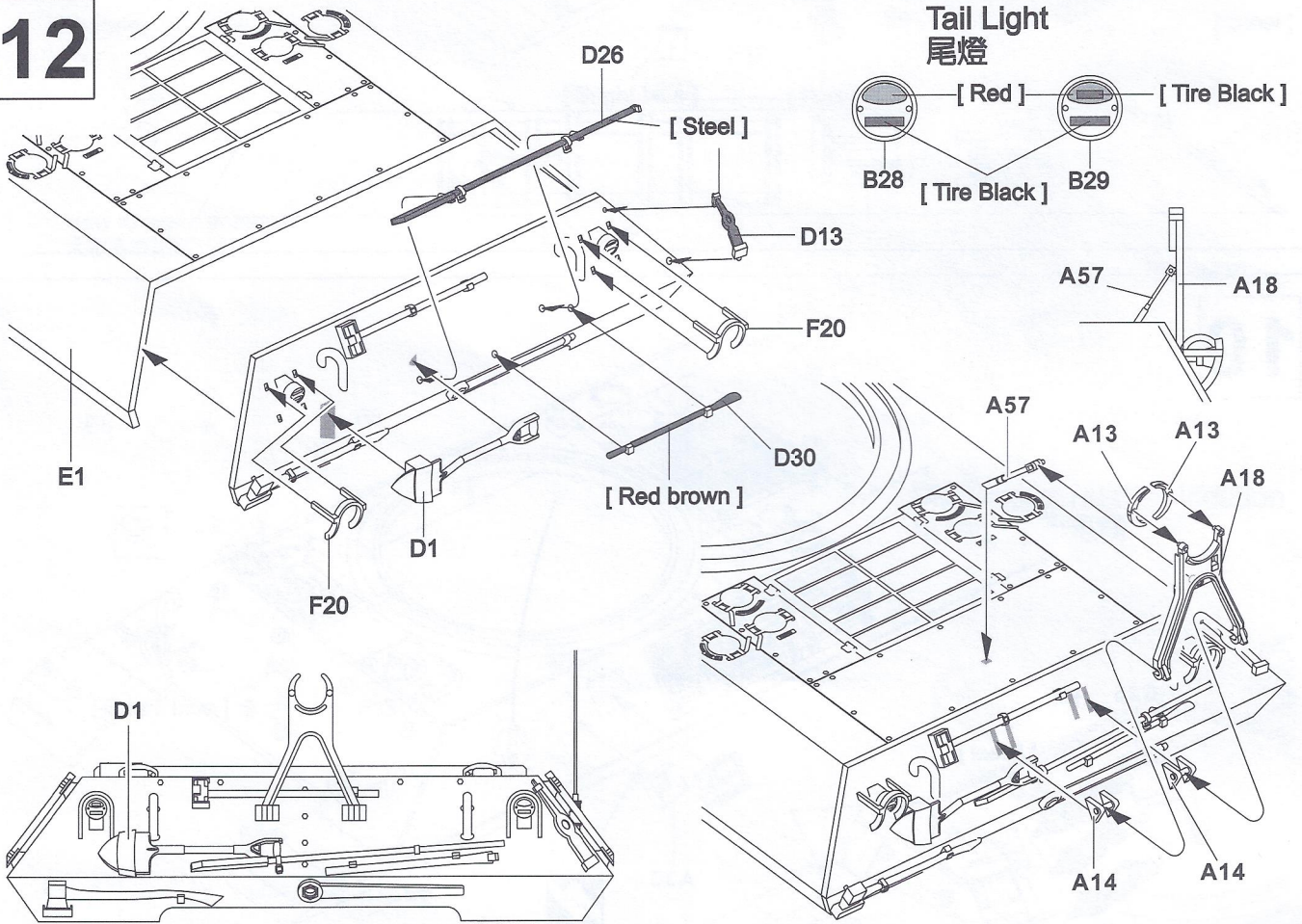

13

Cable 鋼纜

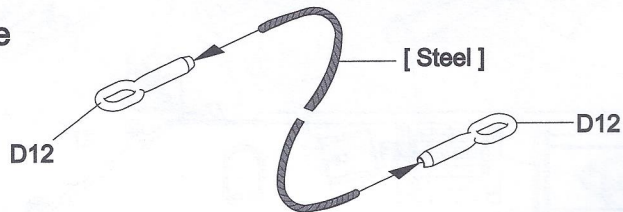

Length = 18 cm  
繩索長 18 公分



# 14

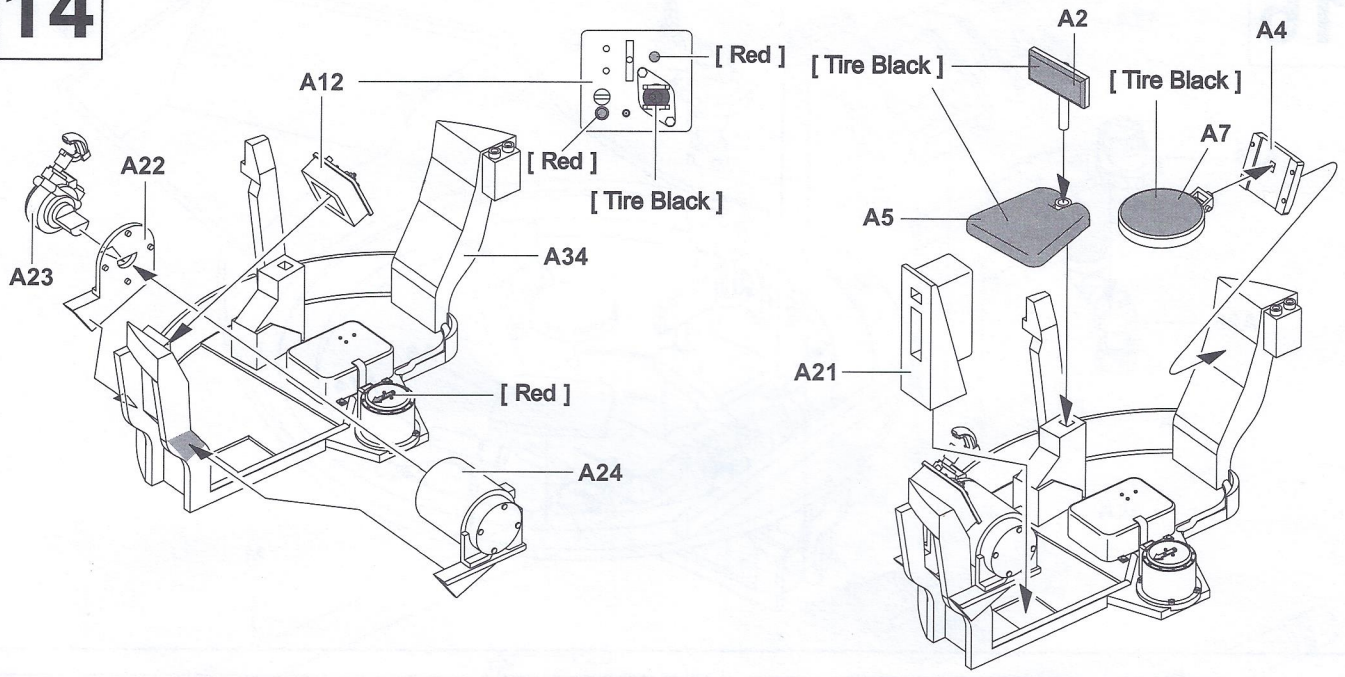

# 15

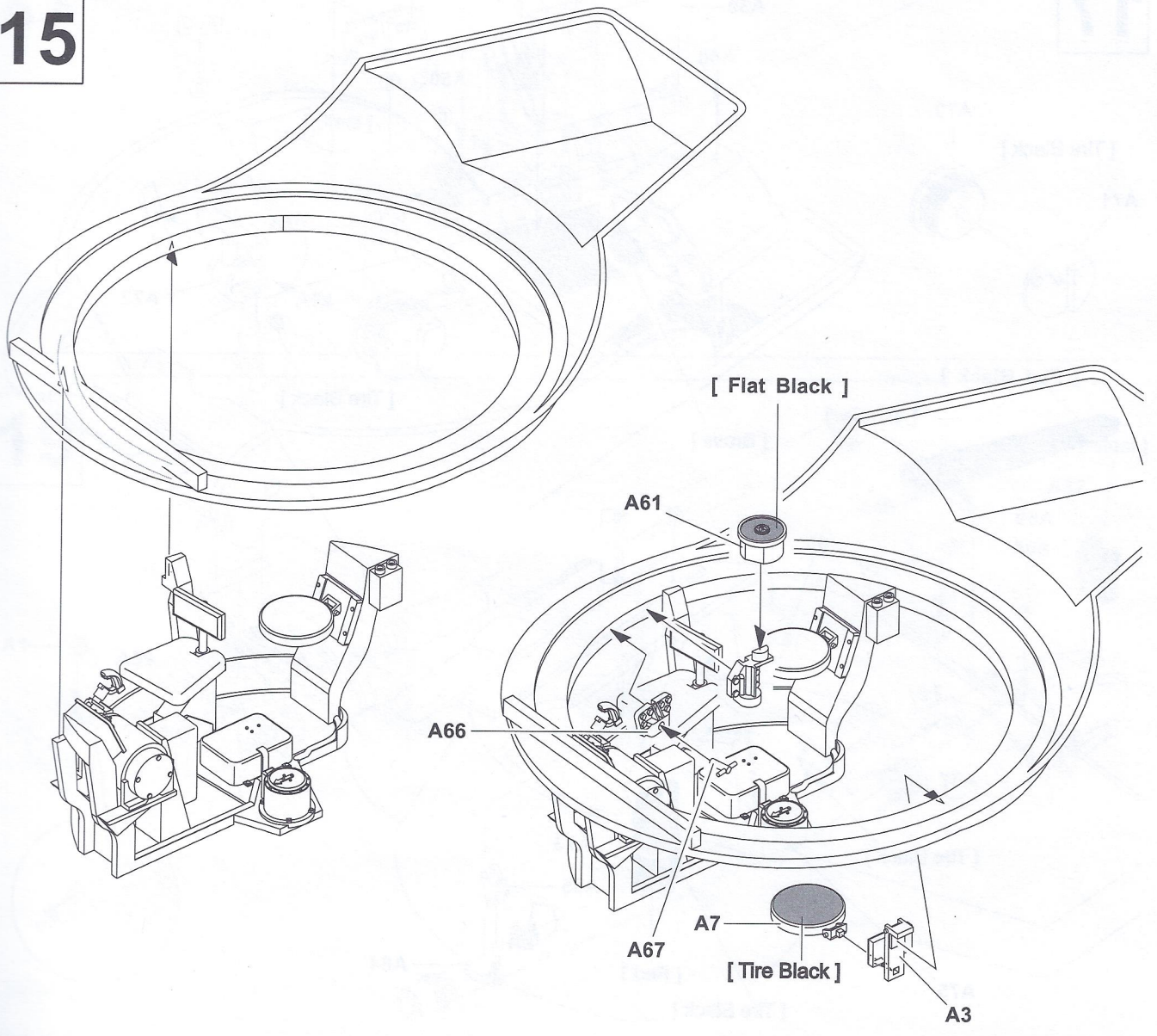

# 16

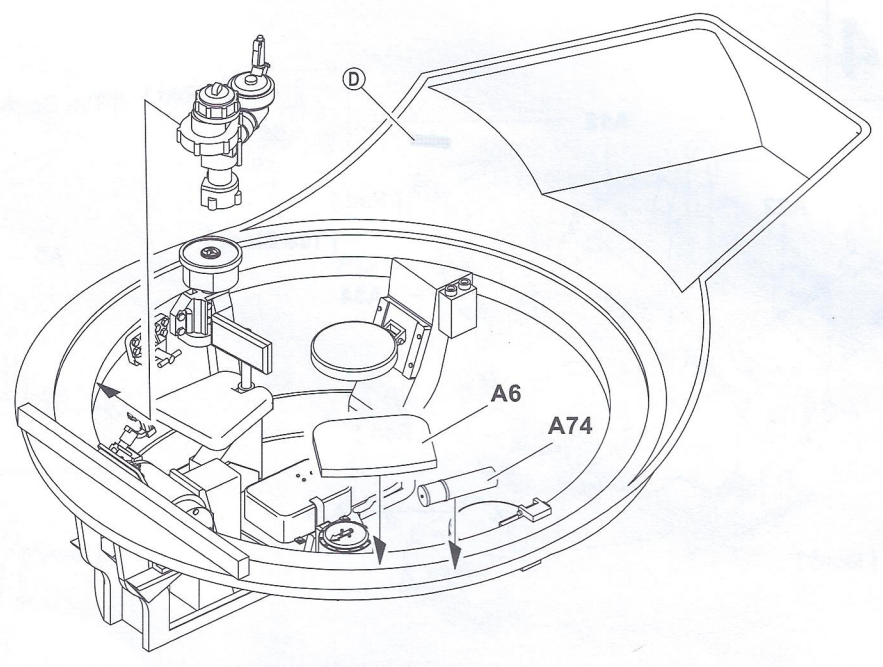
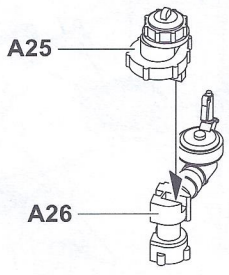

# 17

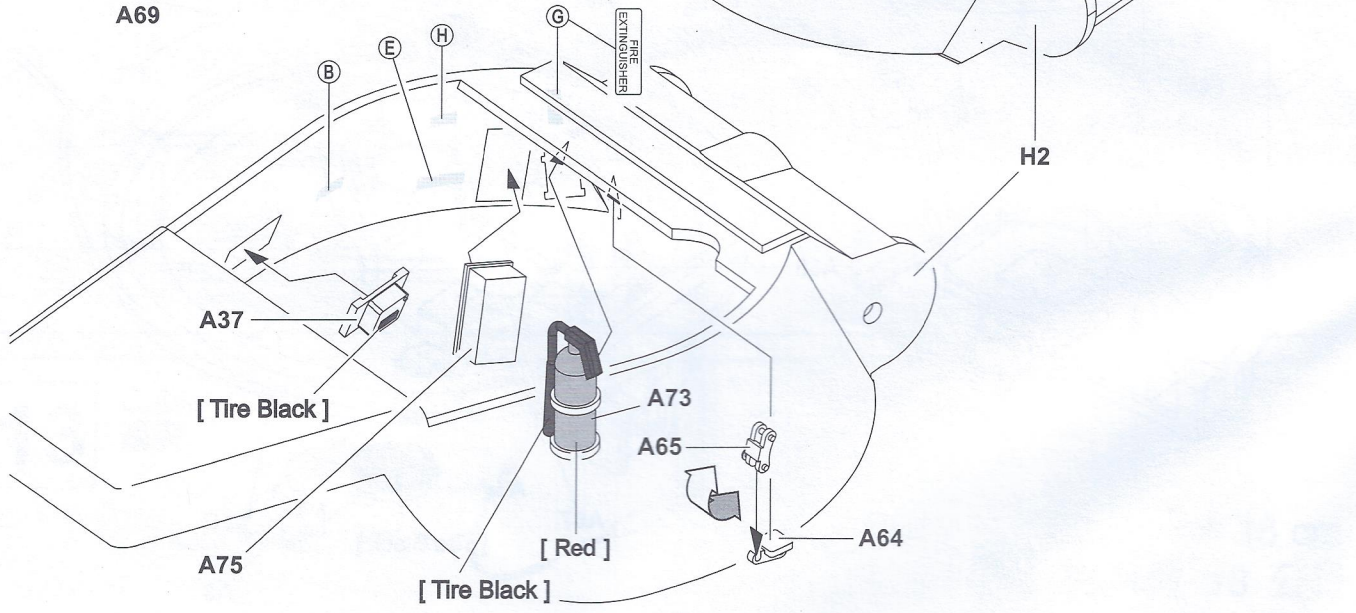
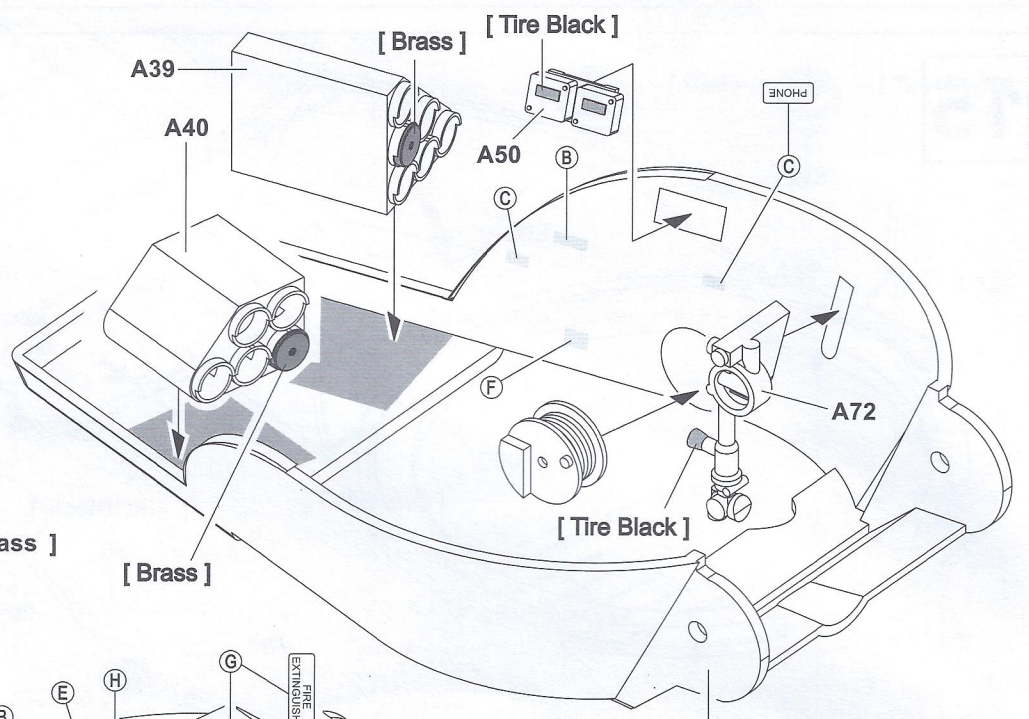
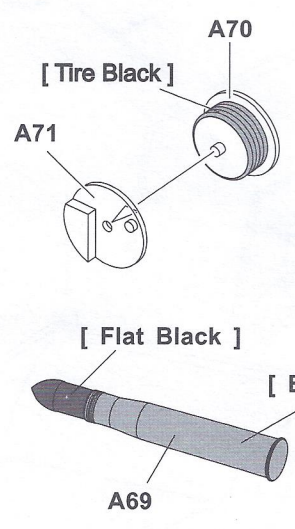

18

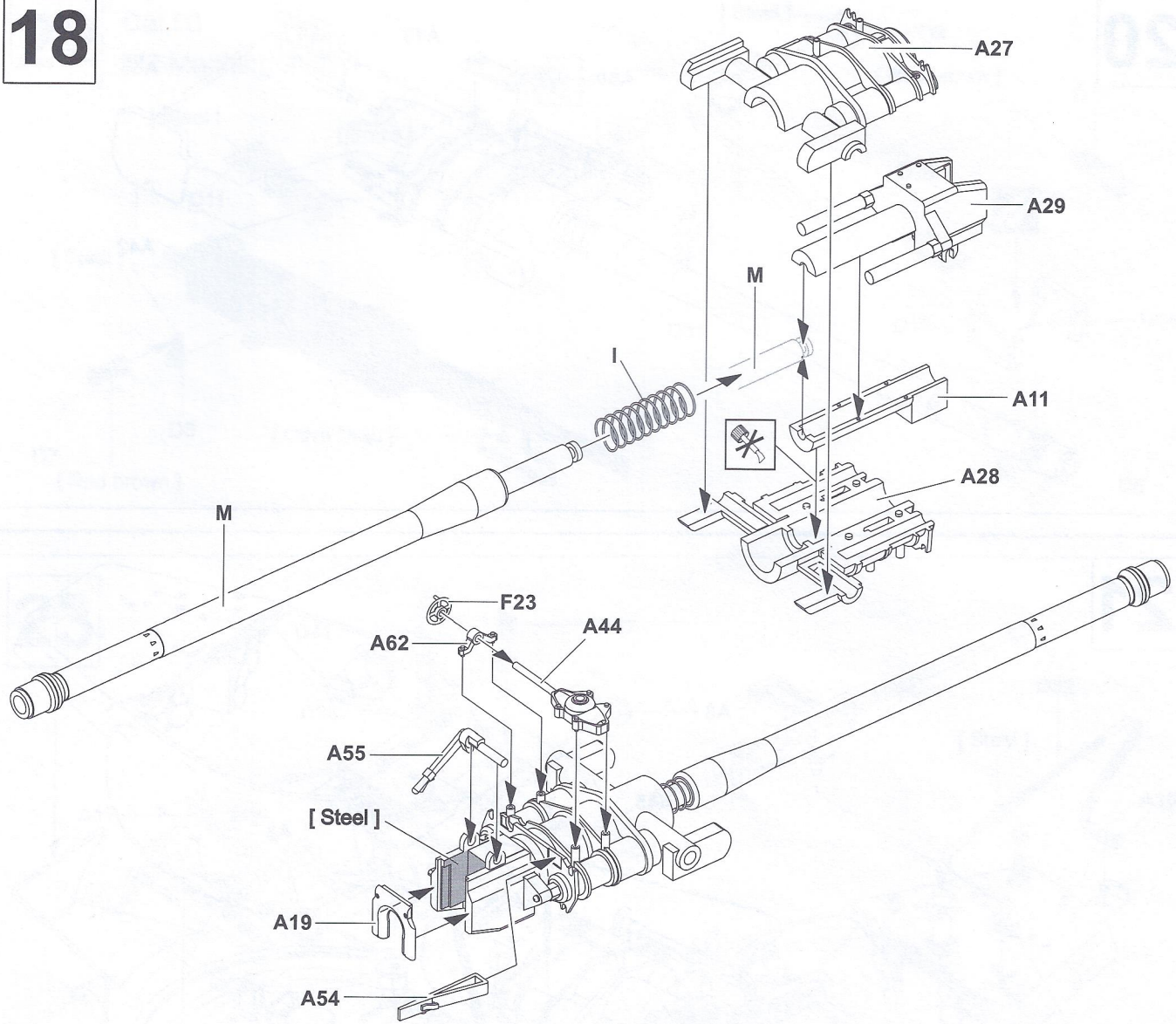

19

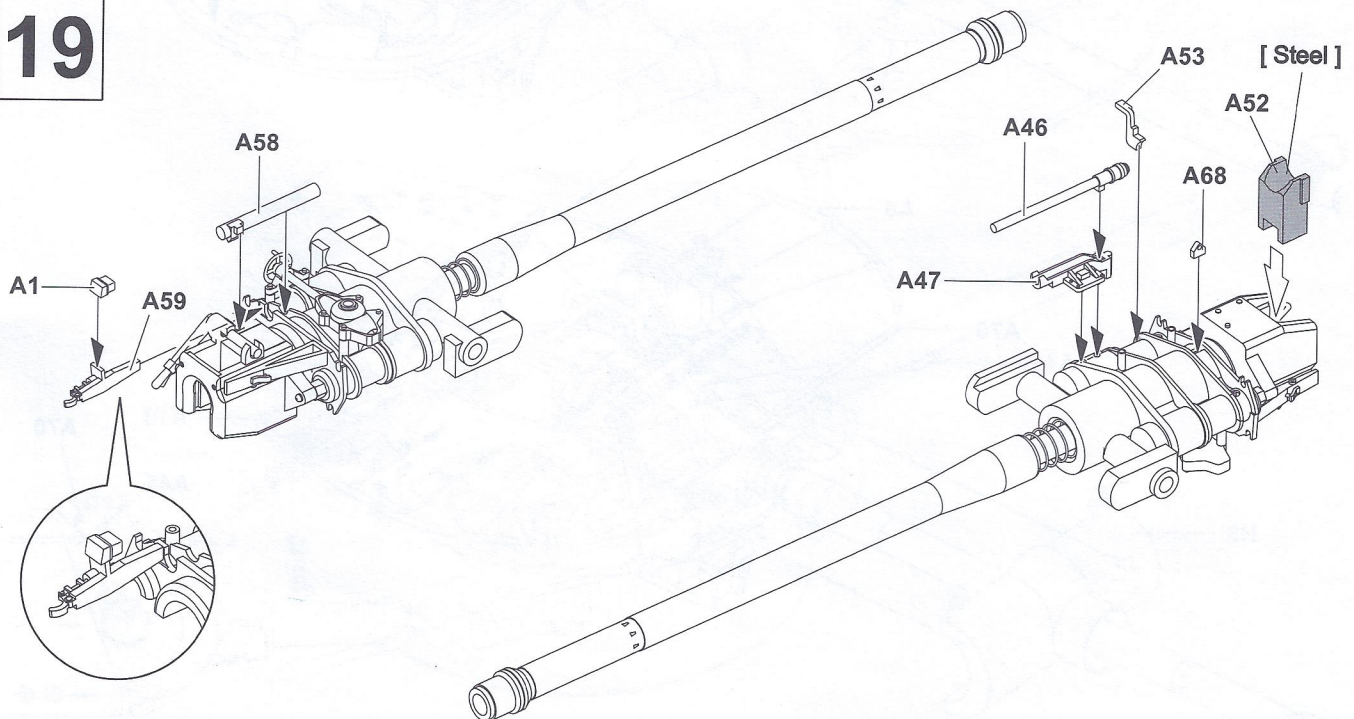

20

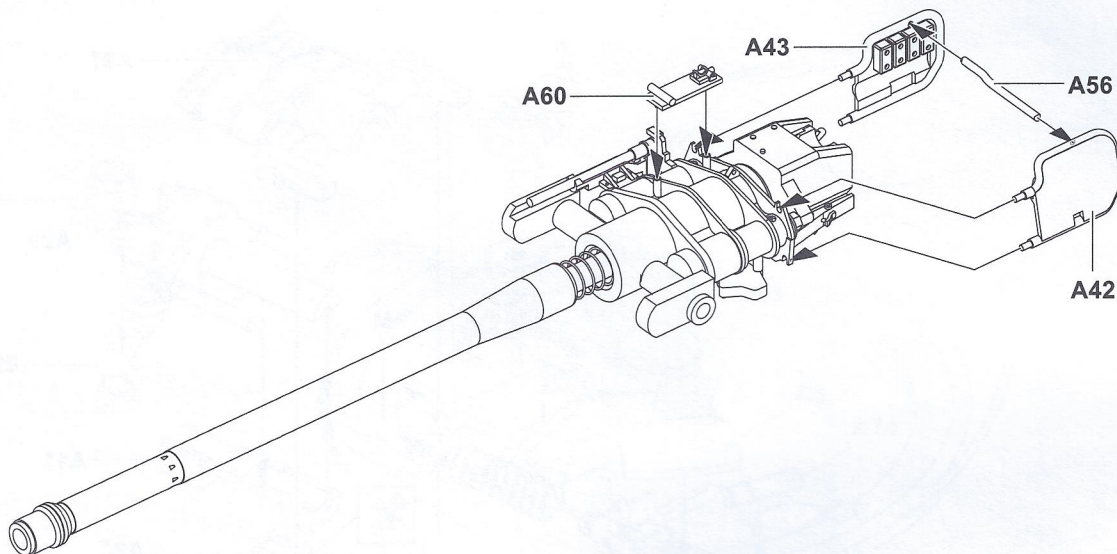

21

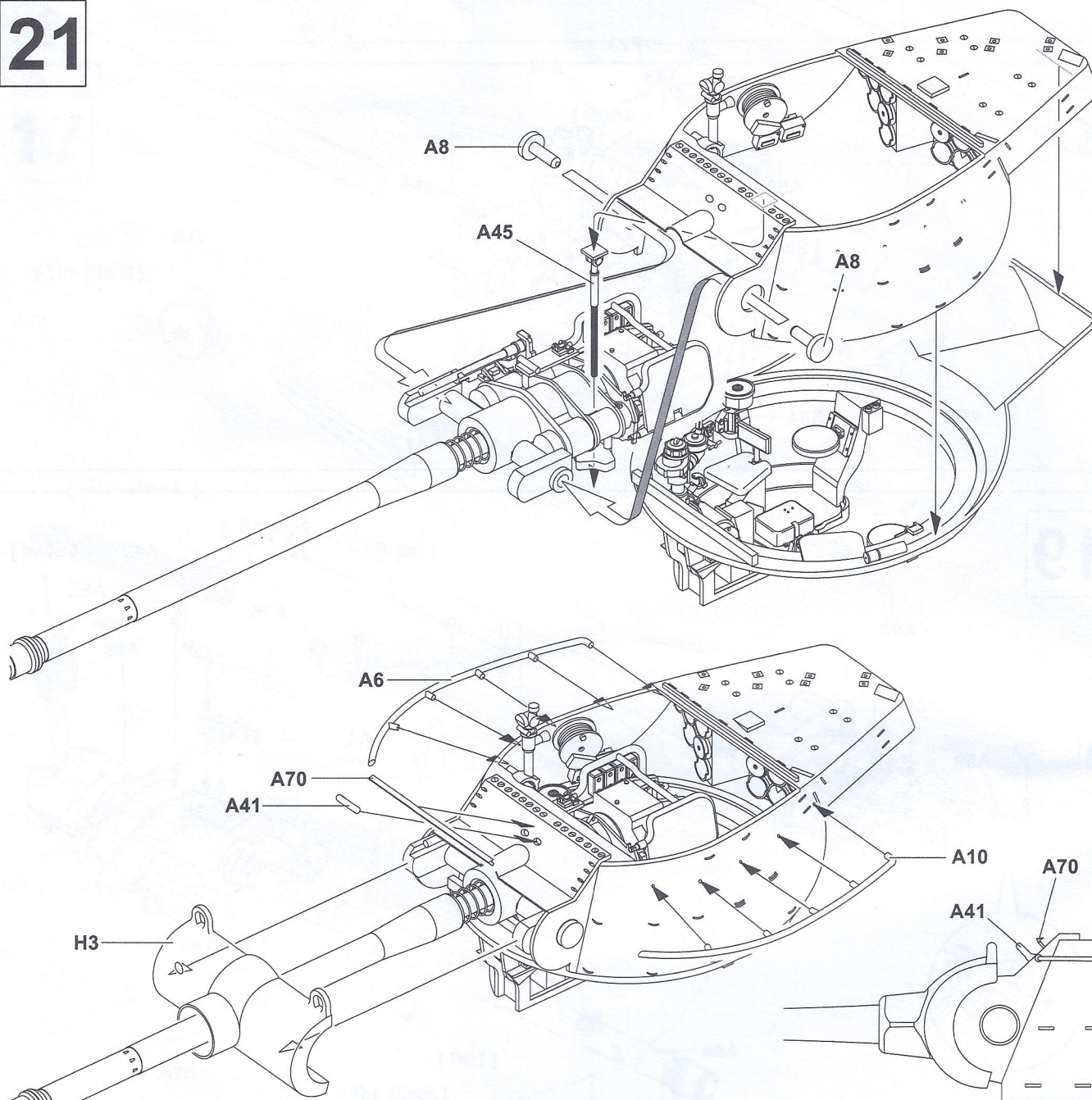

# 22

## Cal.50 M2 Maching Gun

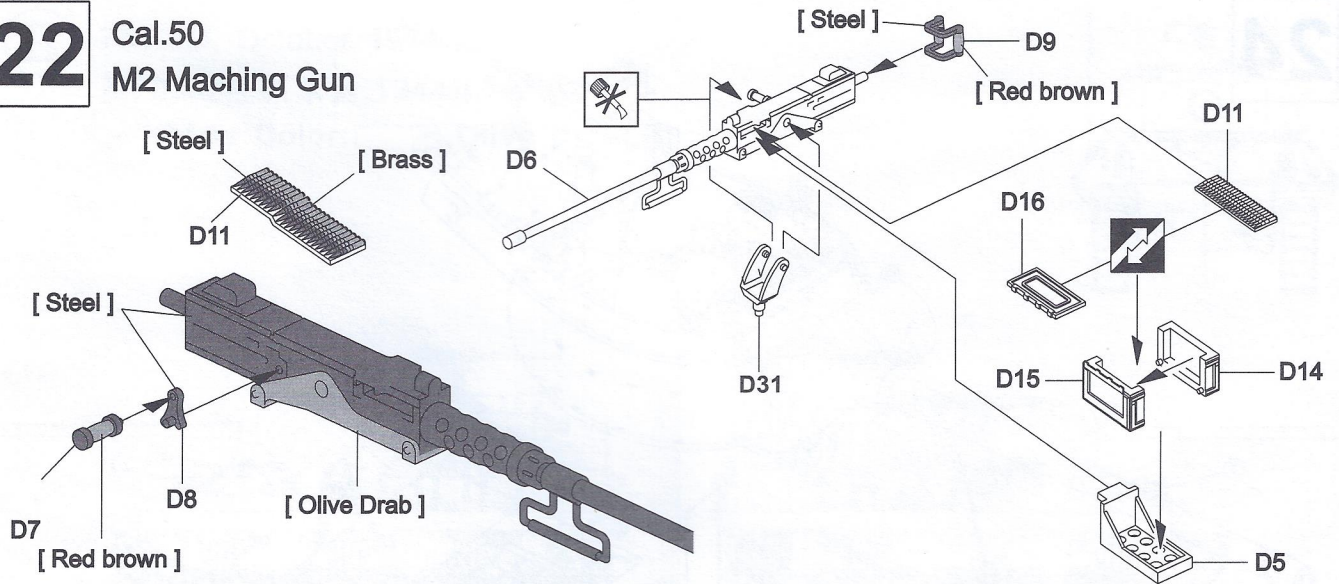

# 23

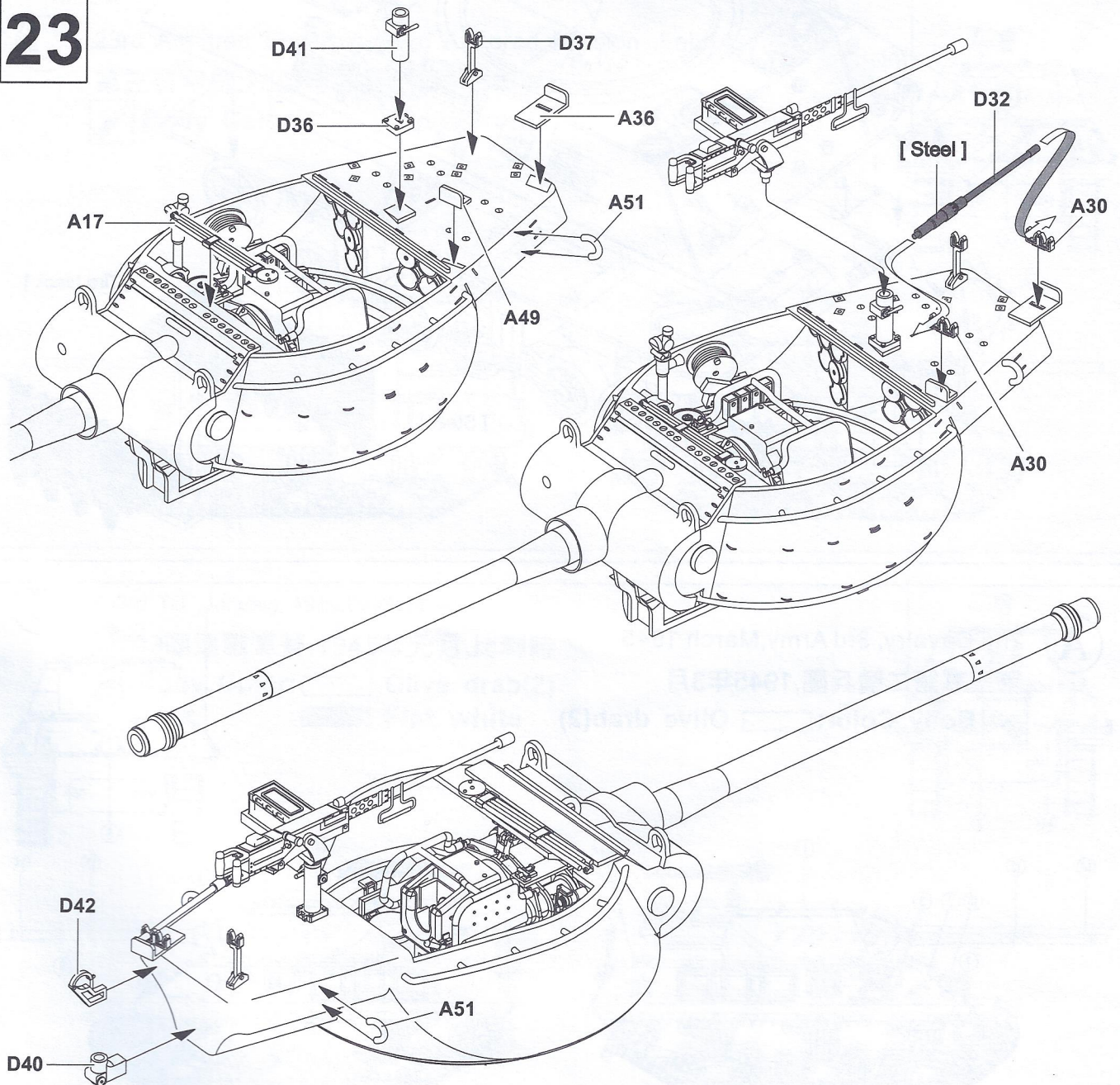

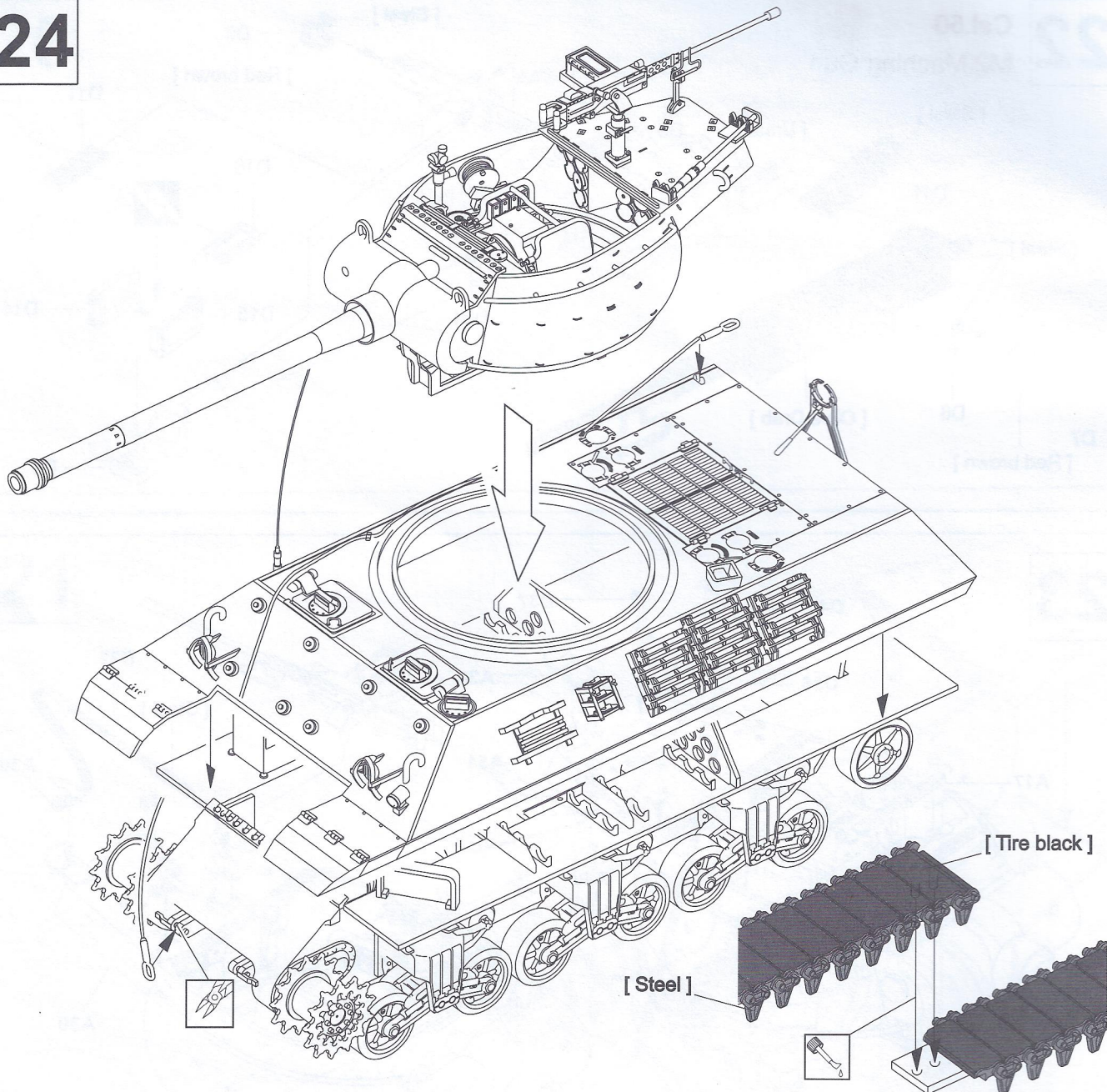

A

2nd Cavalry, 3rd Army, March 1945

第三軍第二騎兵團, 1945年3月



Body Color:  Olive drab(2)

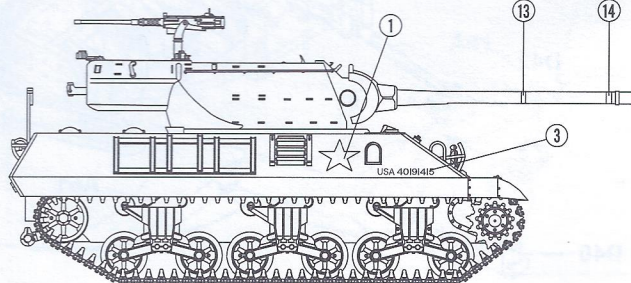
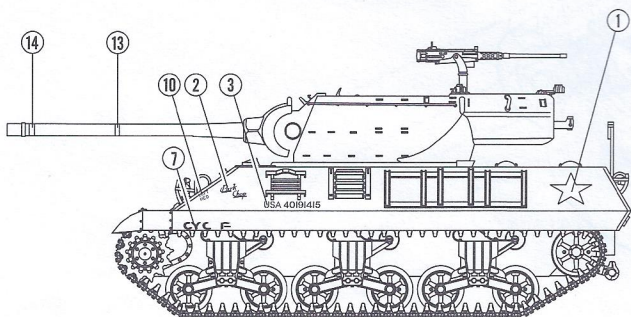
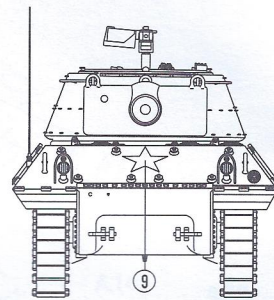

**B** 703 TD, October 1944  
 第703驅逐戰車營, 1944年10月  
 Body Color:  Olive drab(2)

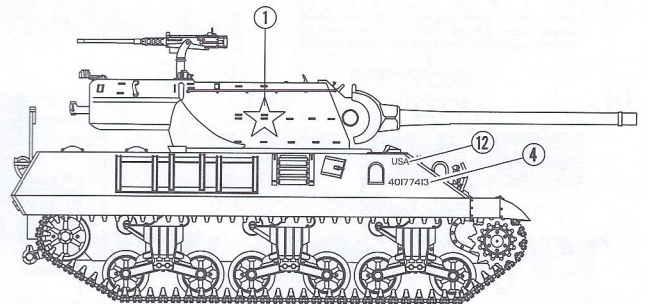
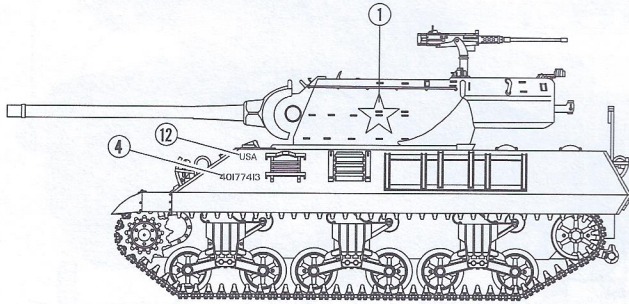
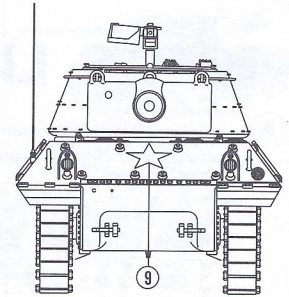

**C** 23rd Armored Engineers, 3rd Armored Division, February 1945  
 第三裝甲師, 23裝甲工兵營, 1945年2月  
 Body Color:  Olive drab(2)

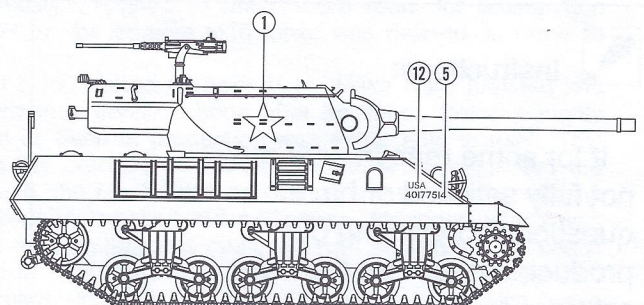
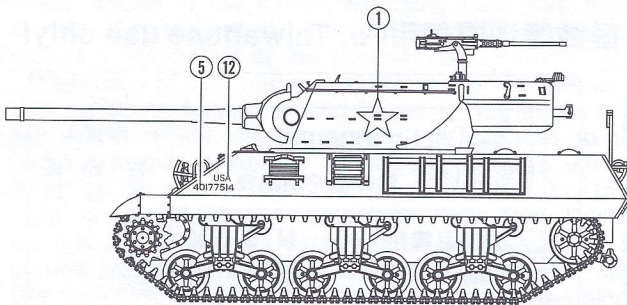
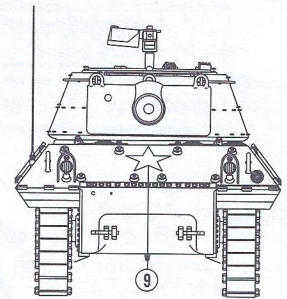

**D** 703rd TD, January 1945, Belgium  
 第703驅逐戰車營, 1945年元月, 比利時  
 Body Color:  Olive drab(2)  
 Flat white

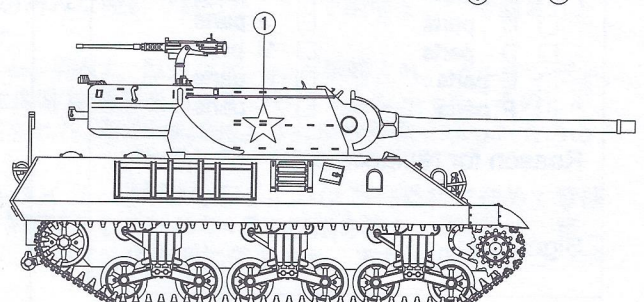
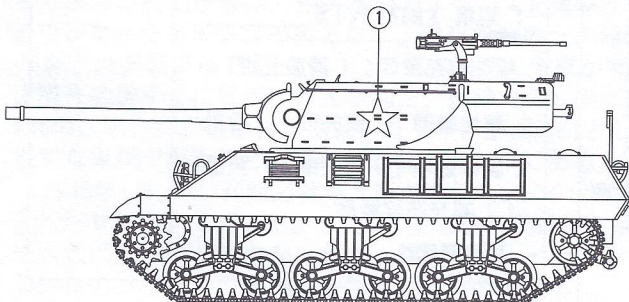
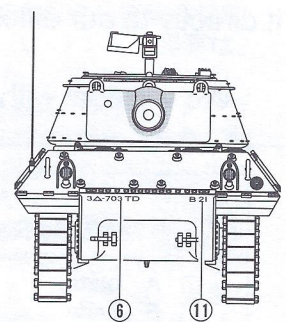

# PARTS LIST 零件表

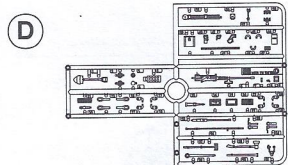
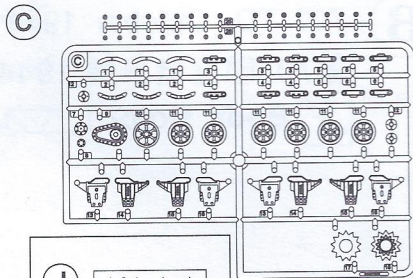
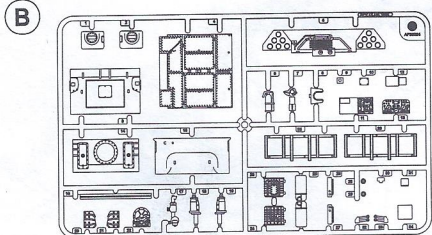
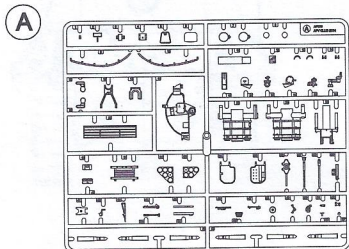

M

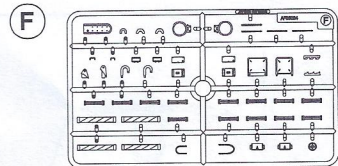
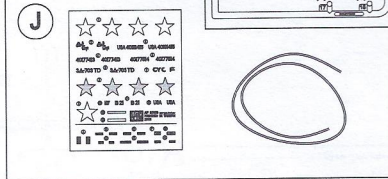
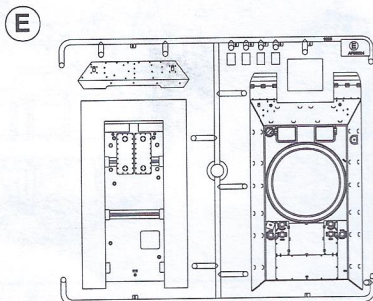

I

R

H

T

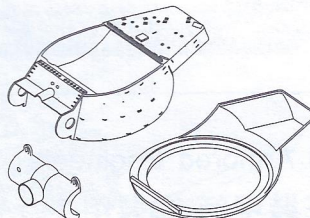

Parts :	A	1	D	1	H	1	M	1
	B	1	E	1	I	1	R	1
	C	2	F	2	J	1	T	2



## Instructions:

If for some reason, you are not fully satisfied or have questions concerning our product; Please use the form provide, and send it to our nearest representative or mail it directly to our office.

We will deal with that A.S.A.P.



### AF35058 Parts Replacement Form

- |                                  |                                  |
|----------------------------------|----------------------------------|
| <input type="checkbox"/> A parts | <input type="checkbox"/> H parts |
| <input type="checkbox"/> B parts | <input type="checkbox"/> I parts |
| <input type="checkbox"/> C parts | <input type="checkbox"/> J parts |
| <input type="checkbox"/> D parts | <input type="checkbox"/> M parts |
| <input type="checkbox"/> E parts | <input type="checkbox"/> R parts |
| <input type="checkbox"/> F parts | <input type="checkbox"/> T parts |

Reason for replacement:  Missing  broken

Signature: \_\_\_\_\_

限台灣地區使用 For Taiwanese use only!

總代理：戰鷹企業 客服部收 本公司將盡速為您處理  
請將本表與該部品相同金額之郵政匯票一同寄至



### AF35058 零件補充申請表

- |                                |          |
|--------------------------------|----------|
| <input type="checkbox"/> A部品零件 | NT\$ 300 |
| <input type="checkbox"/> B部品零件 | NT\$ 150 |
| <input type="checkbox"/> C部品零件 | NT\$ 250 |
| <input type="checkbox"/> D部品零件 | NT\$ 160 |
| <input type="checkbox"/> E部品零件 | NT\$ 280 |
| <input type="checkbox"/> F部品零件 | NT\$ 160 |
| <input type="checkbox"/> H部品零件 | NT\$ 280 |
| <input type="checkbox"/> I部品零件 | NT\$ 30  |
| <input type="checkbox"/> J部品零件 | NT\$ 160 |
| <input type="checkbox"/> M部品零件 | NT\$ 160 |
| <input type="checkbox"/> R部品零件 | NT\$ 30  |
| <input type="checkbox"/> T部品零件 | NT\$ 160 |
| + 郵寄費                          | NT\$ 60  |

(請填) 總計 NT\$ \_\_\_\_\_

零件補充原因: (請於  打✓)

- 原包裝即  遺失或  毀損
- 製作途中  遺失或  毀損
- 補充多餘零件
- 其他原因 \_\_\_\_\_

申請人  
姓名 地址 電話  
: : :