


Light Tank M-24 'Chaffee' (British Army)


英军 M-24 “霞飞” 轻型坦克

1/35 SCALE



The US Army entered WWII with the M3 Stuart Light Tank, which worked well, but was tall and noisy. Not ideal features of a reconnaissance vehicle and not rectified in the later M5 series. A new Light Tank was specified in 1943 using the M5 powertrain, but with a sleek new hull and turret. This was to emerge as the Light Tank M24. The noisy VVSS was replaced with a new torsion bar suspension, and weight was kept to 20 tons. Firepower was greatly increased by mounting a light weight 75mm gun using the same ammunition as the M4 Sherman. The M24 was well received by its crews, but it arrived too late to see much action, the first tanks arriving in Europe by November 1944. A few were passed on to the British and Free French before the war ended. Armour was up to 25mm thick and the road speed up to 56km/h, maximum road range was 161 kilometers. A total of 4,731 M24's were built by the end of WWII. The chassis was used for a whole range of Self-Propelled Guns and weapon carriers. 

Short Story by Phil Greenwood

Bei Kriegseintritt hatte die US Army den leichten Panzer M3 Stuart (37mm Geschütz) im Arsenal. Das Fahrzeug war zuverlässig, aber laut und eng. Letzteres war nicht unbedingt vorteilhaft für einen Spähpanzer und konnte auch durch die folgenden M5 Typen nicht behoben werden. 1943 wurde ein neuer leichter Panzer geplant, welcher den M5 Antrieb beibehalten sollte. Das Ergebnis war der leichte Panzer M24. Er war bis zu 25mm gepanzert und max. 56 km/h schnell bei einer Reichweite von 161 km. Die laute VVSS Federung ersetzte man durch eine Drehstabfederung, das Gewicht blieb unter 20 Tonnen. Die Feuerkraft stieg immens, die Bewaffnung bestand nun aus einer 75mm Kanone, welche M4 Sherman Munition verschießen konnte. Der M24 wurde von der Truppe sehr begrüßt, kam aber zu spät für größere Kampfeinsätze. Denn die ersten Lieferungen erreichten Europa im November 1944. Einige übergab man den britischen und freien französischen Einheiten bis Kriegsende. Die Produktion belief sich auf 4731 Stück. Das Chassis war auch die Basis einiger Selbstfahrlafetten und Versuchsfahrzeuge. 

© Translation Michael Knoblich Academy Europe


美军在二次大战初期投入之 M3 “斯图尔特” 轻型坦克虽然操作良好，但可惜是车身高及噪音太大，这种种不利于作为侦察用途的因素在其后所改良之 M5 系列仍没被矫正过来。但一辆全新外形之轻型坦克在 1943 年却被设计出来，其仍使用 M5 原来之动力系统但是有一个全新的车身和炮塔。由于 M24 主要设计目的是作为轻型坦克。设计师把 M5 原有极易产生噪音的 VVSS 悬挂系统替换为新的扭力悬挂系统，并且将其重量保持为 20 吨。火力方面装上一门轻量化之 75mm 火炮，使其同样可使用和 M4 谢尔曼一样的弹药。M24 深受其乘员组所欢迎，但它在大战的后期才登场显得有点太迟了，在战争结束前之 1944 年 11 月，第一辆 “霞飞” 坦克才送抵欧洲战场。当时有少量之 M24 “霞飞” 被移交给了英军和自由法军部队使用。M24 装甲约为 25 毫米厚，路上最高时速为 56 公里，最大行走半径是 161 公里。M24 从二战后期开始生产，总共有 4,731 台被生产了出来。其后其底盘更被设计作为各式各样的自走炮和装载武器车辆使用。 

ILLUSTRATION 图示说明:

CORRECT METHOD FOR APPLYING DECALS : HINWEISE ZUM ANBRINGEN DER DECALS 正确贴水贴纸的方法:

1. Clean model parts surface with wet cloth. Entsprechende Stellen am Modell feucht reinigen.
将需要贴水贴纸之部位表面擦干净。
2. Cut out the decal parts and dip them in cold water for 15 ~20 seconds. Decal ausschneiden und für 15-20 Sek. ins Wasser legen.
将所需之贴纸剪下泡在清水里约15至20秒。
3. Place it on correct position of the model kit. Decal an der richtigen Stelle auflegen.
将湿透之贴纸取出置放于正确之位置旁。
4. Slide off the decal from the base paper on to the model kit surface with a cotton stick. Decal mit Wattestäbchen festhalten und Papier darunter wegziehen.
用棉花棒轻推贴纸表面使其从底纸滑出至模型表面之正确位置。
5. When decal get dry then complete. Decal mit Papiertuch andrücken und trocknen.
待其自然干透后即完成。

ICON INSTRUCTION: 图标说明:



Open Hole
Loch bohren
钻孔



Remove
Abtrennen
切除



2 Sets needed
Vorgang wiederholen
同样的制作二组



Bend
Biegen
曲折



Optional
Auswahl
可以选择采用



Apply Decal
Decal anbringen
贴水贴纸



Instant Glue For Metal
Sekundenkleber verwenden
瞬间接着剂,金属用



Fill Hole
Verspachteln
把孔填平



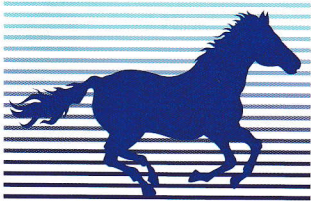
Do not cement
Nicht kleben
不用粘合

COLOR SUGGESTION: FARBTABELLE: 涂装指引:

Color	涂料表	MR. Hobby	Hobby Color	Humbrol	Tamiya
Steel	Stahl 黑铁色	H-18	C-28	53	/
Flat black	消光黑	H-12	C-33	33	XF-1
Silver	Silber 银色	H-8	J-8	11	X-11
Wood brown	Holzbraun 木棕色	H-37	C-48	/	/
Clear red	Klar-rot 透明红	/	/	/	XF-65
Olive drab	Oliv draun 橄榄褐	H-78	C-38	66	XF-62
Tyre black	Reifenschwarz 轮胎黑	H-77	C-137	85	/
Semi-gloss black	Schwarz Seidenmatt 半光黑色	/	C-82	/	/
Olive drab	Oliv draun 橄榄绿	H-78	C-38	66	XF-62
Flesh	肌肤色	H-44	C-51	61	XF-15
Red brown	Rotbraun 红褐色	H-47	C-41	160	XF-64
Red brown	Rotbraun 红棕色	/	/	/	XF-64

READ BEFORE ASSEMBLING: VOR ZUSAMMENBAU LESEN: 组装必读:

- Carefully Study instruction before assembling. Anleitung studieren und verständlich machen. 组装前请阅读清楚制作指引。
- Keep plastic model glue and tools away from children. Kleber, Farben, Werkzeuge und Plastiktüten von Kindern fernhalten. 胶水、油漆及工具勿让小孩接触。
- Do not use cement or paint near open flame or sparks. Kleber/Farbe nicht in Nähe von offenen Flammen. 胶水及油漆勿接触火种。
- Do not work in closed room. Nur in ausreichend belüfteten Räumen arbeiten. 勿在密封地方制作模型。



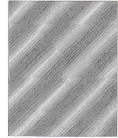
BRONCO

Bronco Models

Copyright © 2012

Made in China

中国制造



No use parts
不要部件

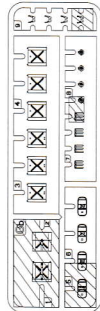
(K) × 2



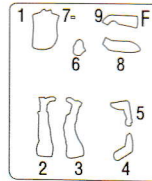
(I) × 2



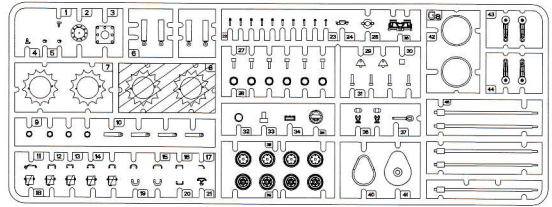
(Gb) × 2



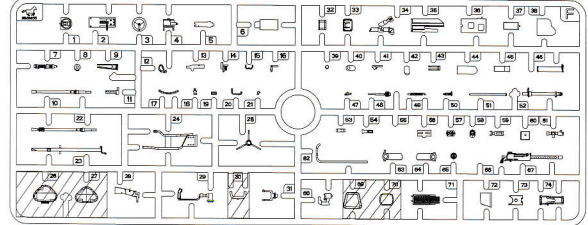
(F) × 1



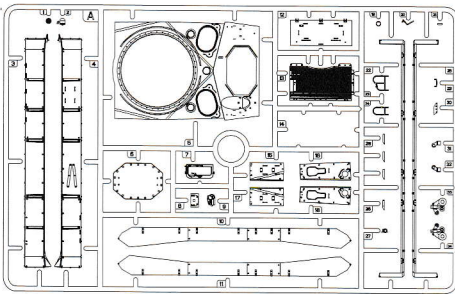
(Ga) × 2



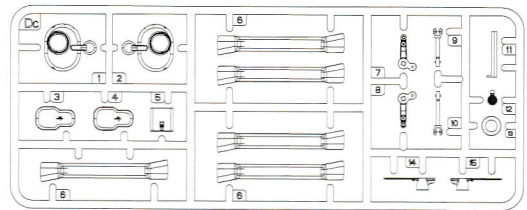
(F) × 1



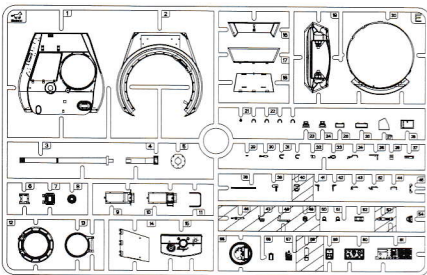
(A) × 1



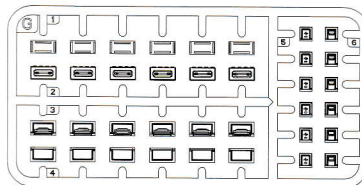
(Dc) × 1



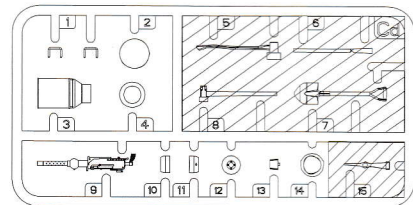
(E) × 1



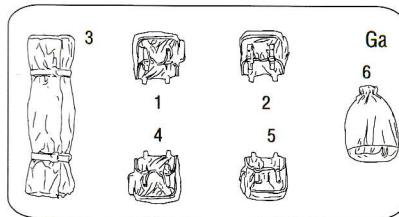
(G) × 1



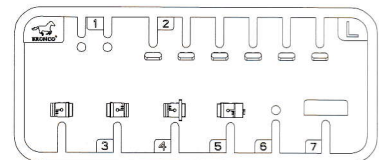
(Cd) × 1



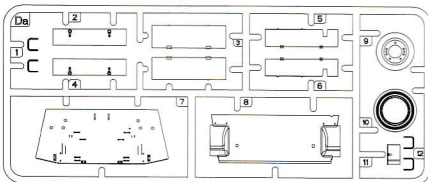
× 1



(L) × 1

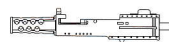


(Da) × 1

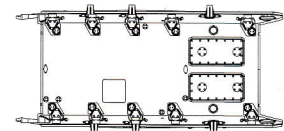


Plastic Spring
塑胶弹簧

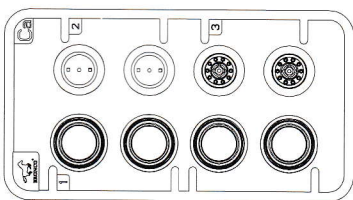
(W) × 1



(M) × 1



(Ca) × 5

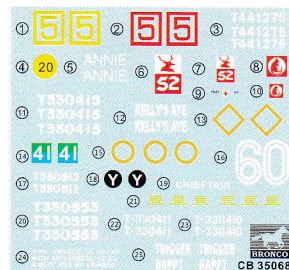


String
绳子

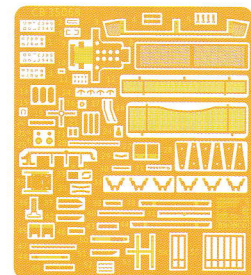


× 1

DECAL × 1



(P) × 1



(N) × 14



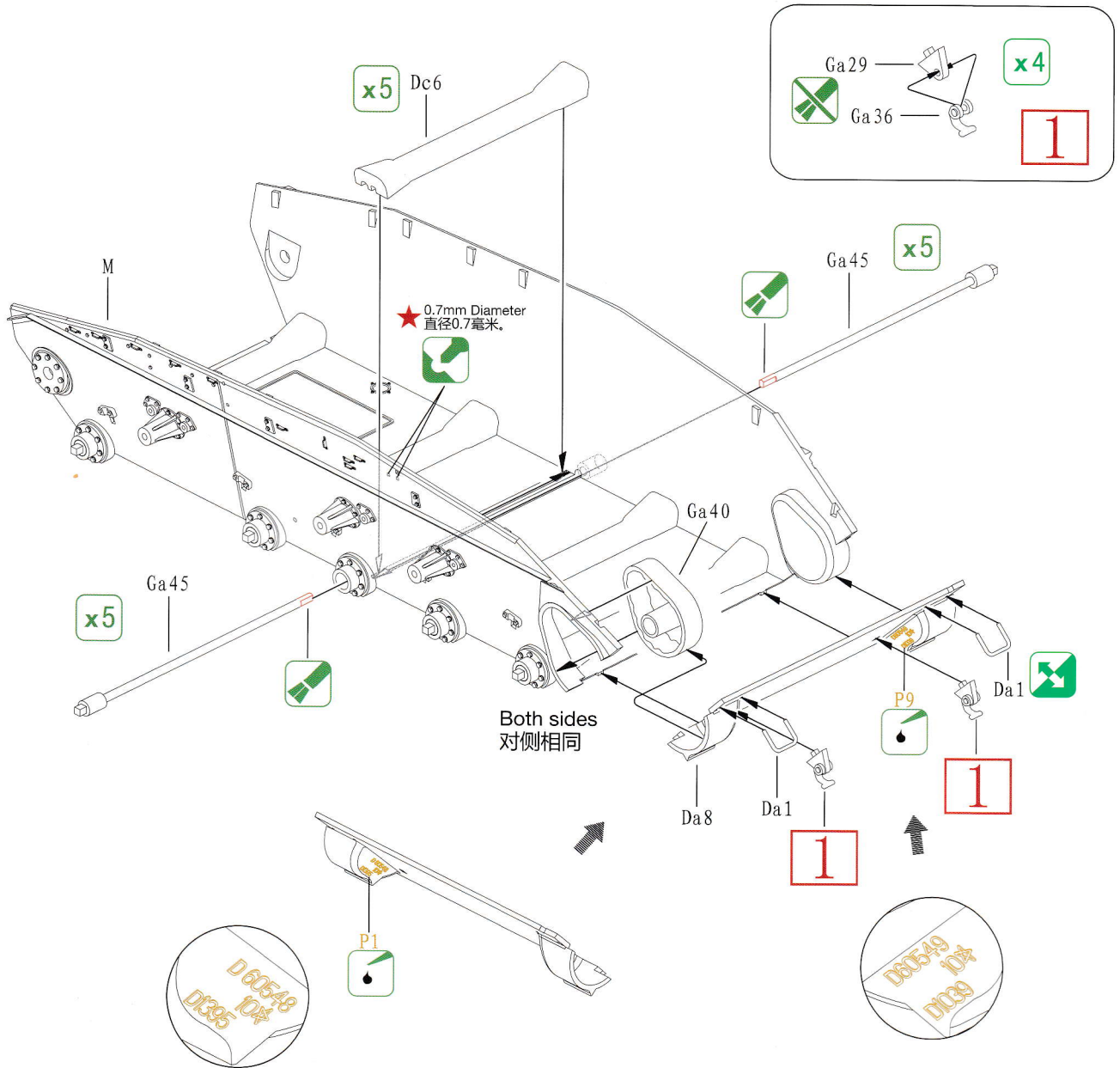
CB35068

ILLUSTRATION 图示说明:

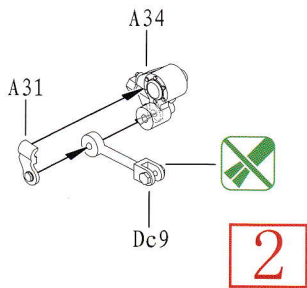
1

Caution:

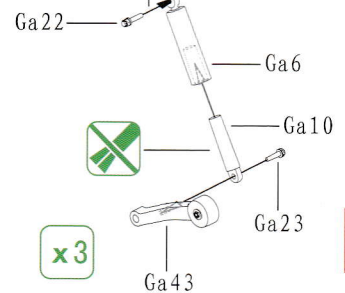
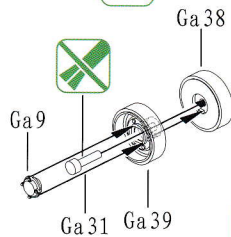
This kit contents a lot of small accurate parts, please carefully to read before to assembly.
此套件包含不少精细零件, 请在制作前先翻阅说明书了解清楚



2

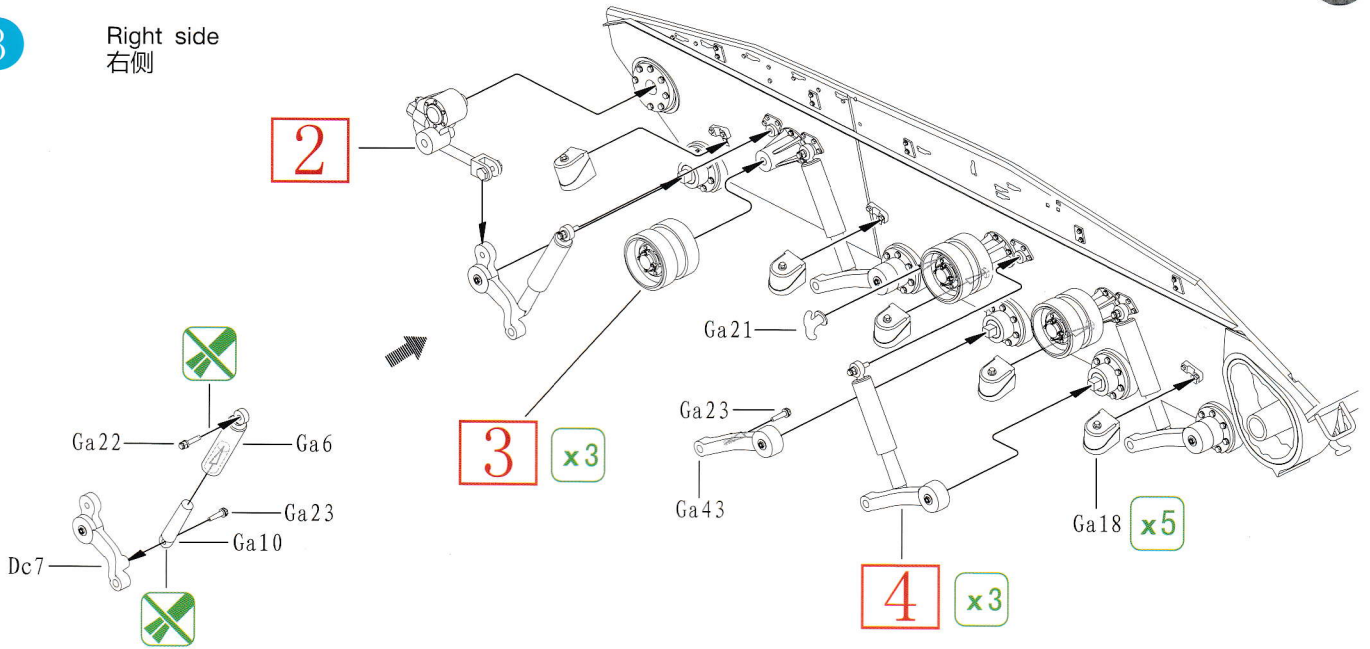


x6



x3

3 Right side
右侧



4



5 Left side
左侧

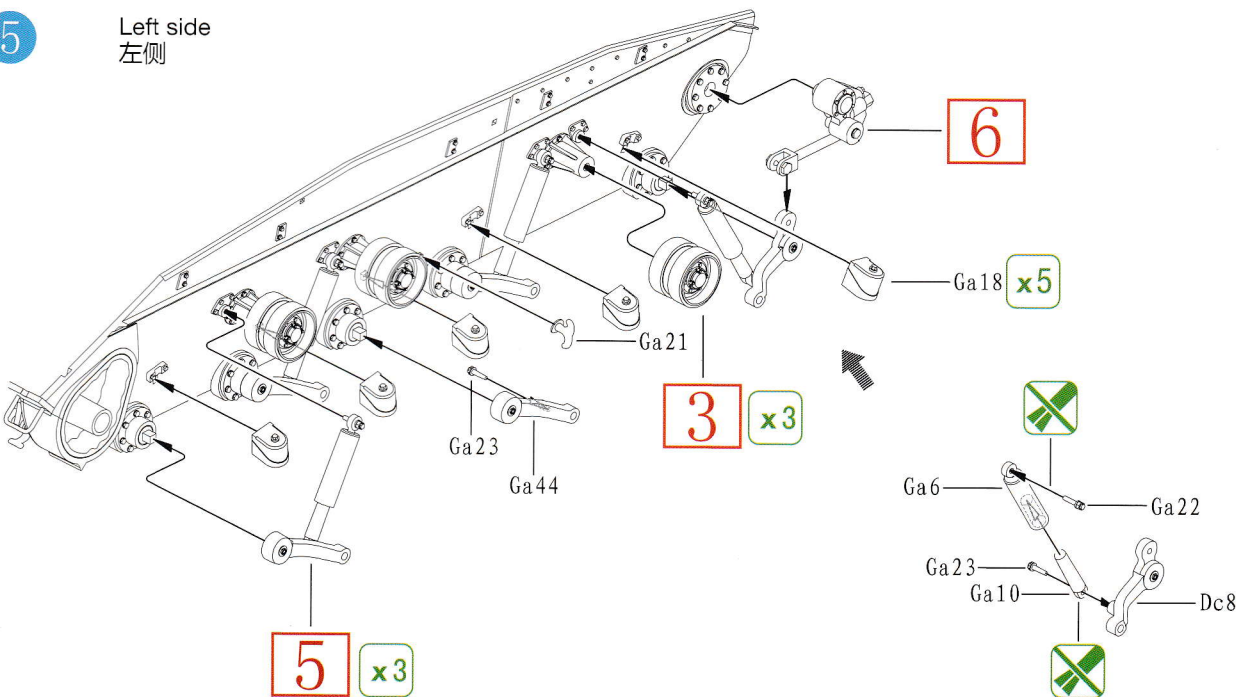
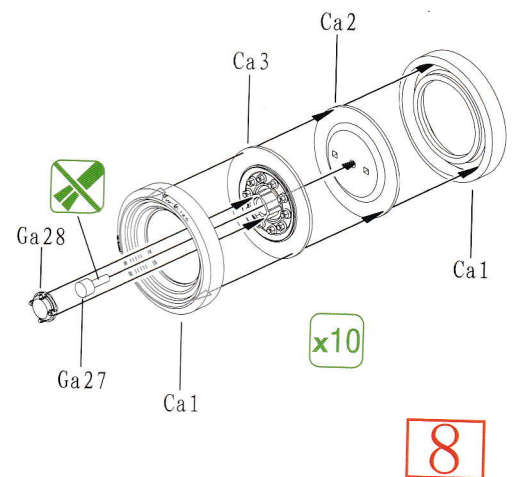
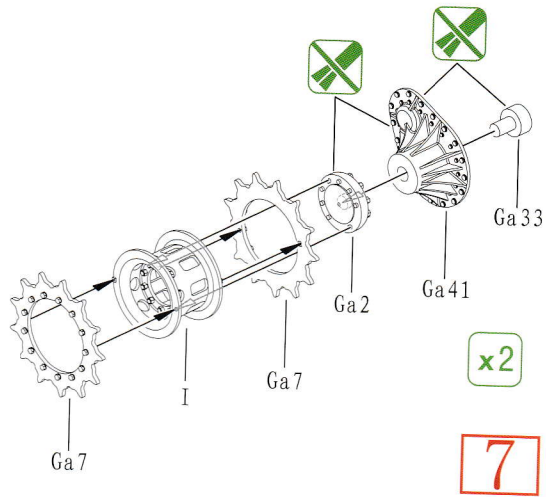


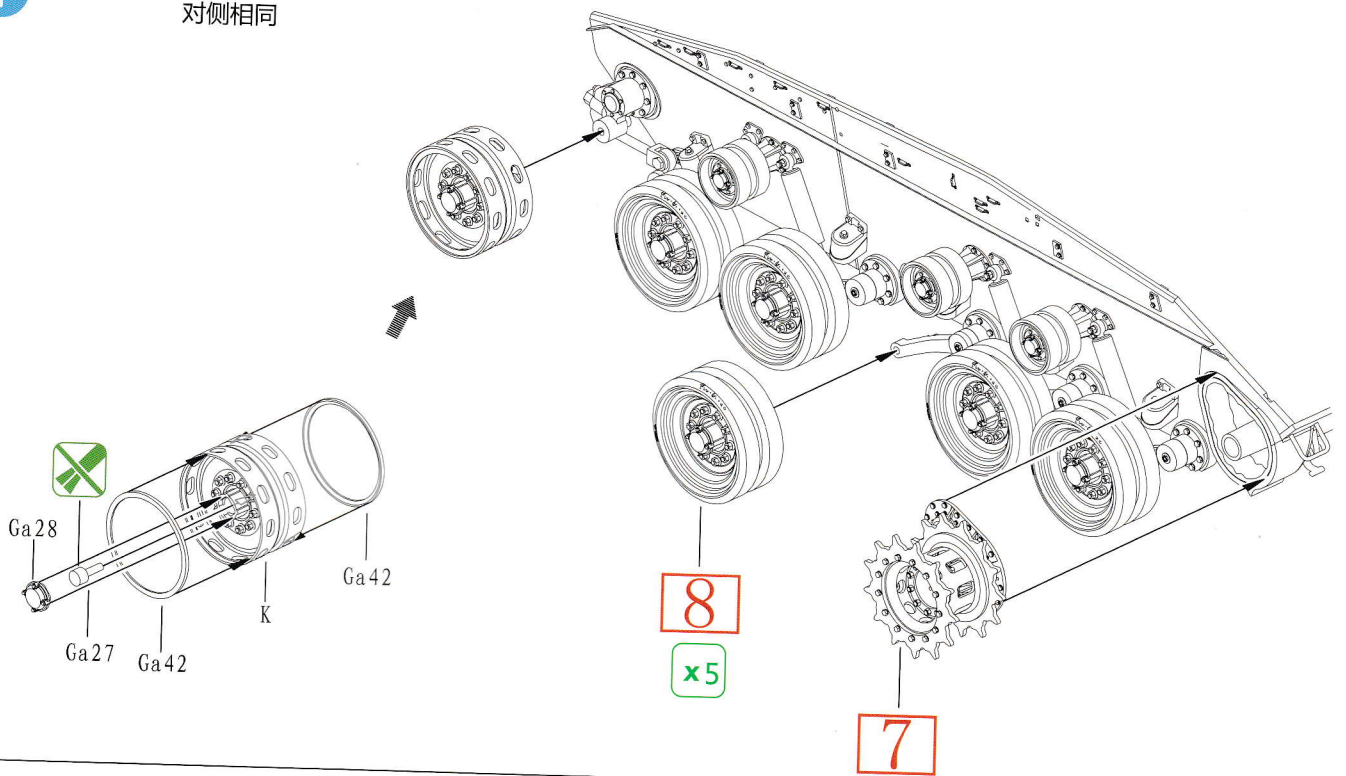
ILLUSTRATION 图示说明:

6

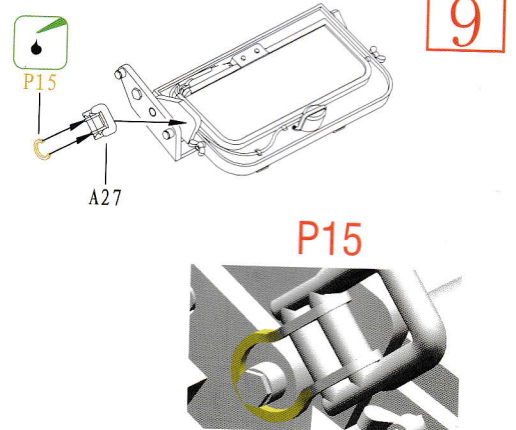
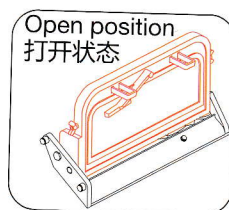
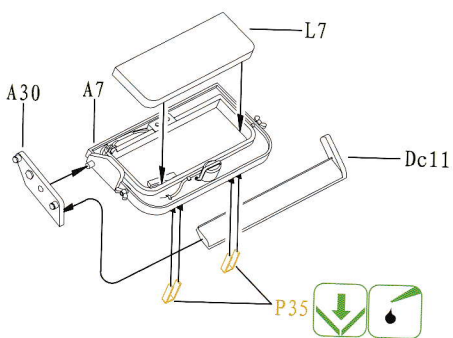


7

Both sides
对侧相同

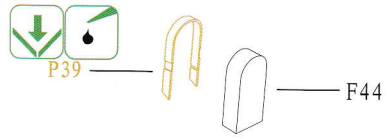
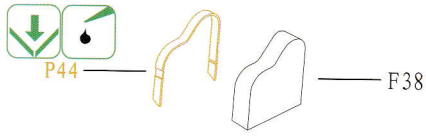


8

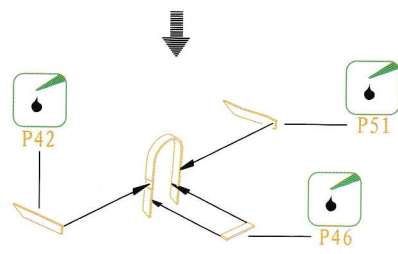
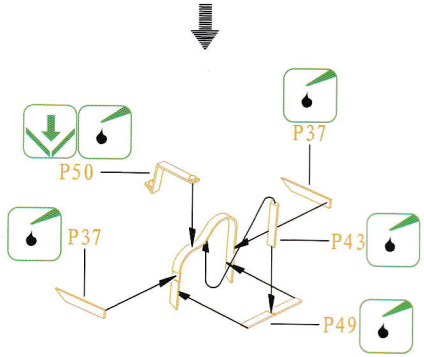


9

Option parts 选装零件



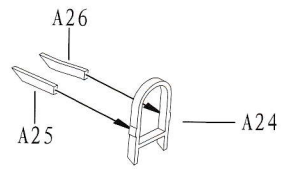
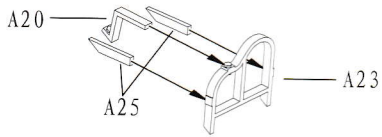
PE parts
蚀刻零件



10

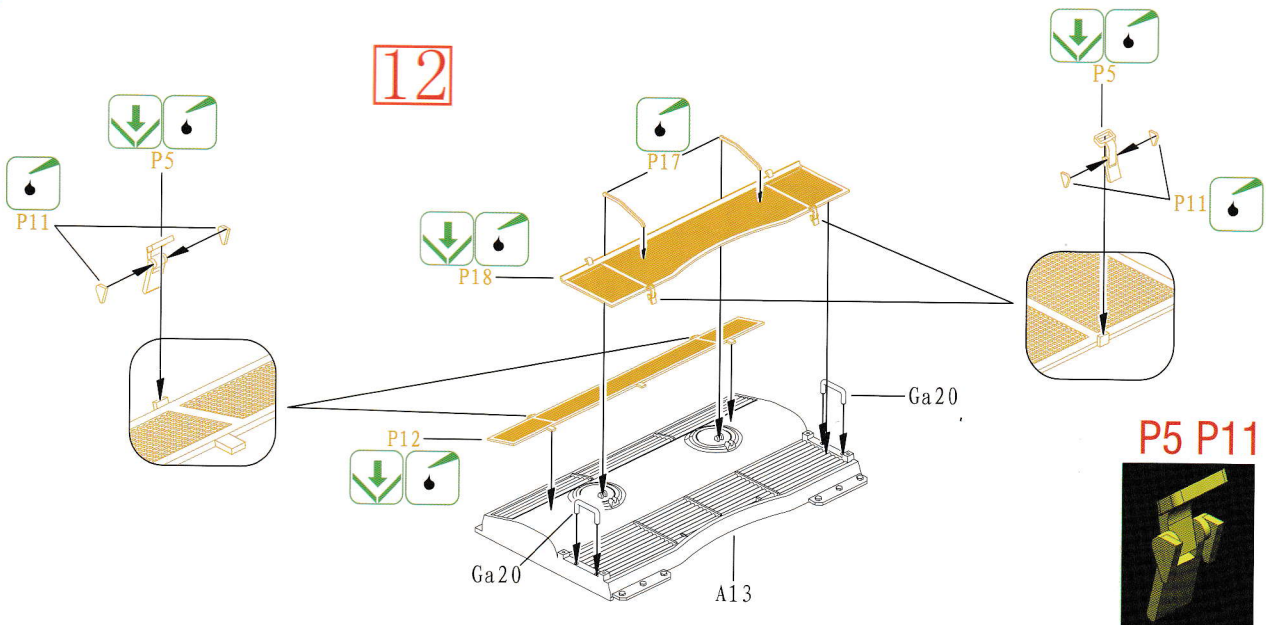
11

Plastic parts
塑胶零件



10

12

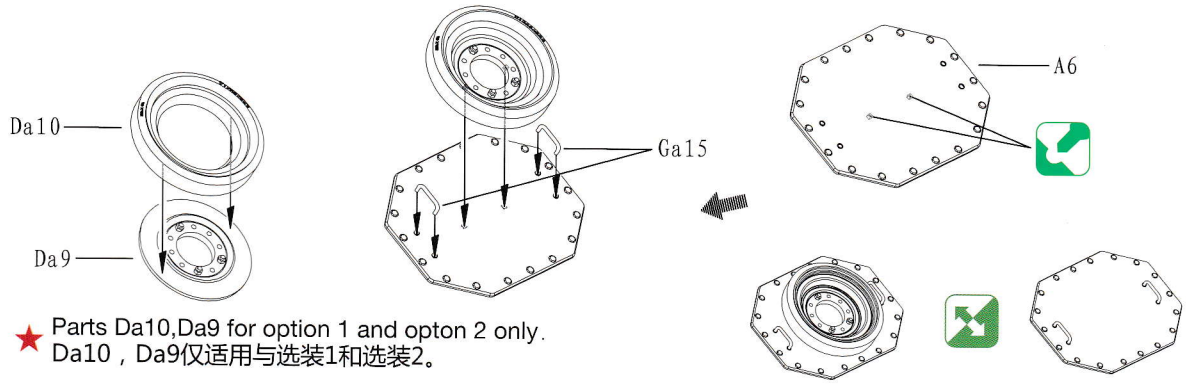


P5 P11

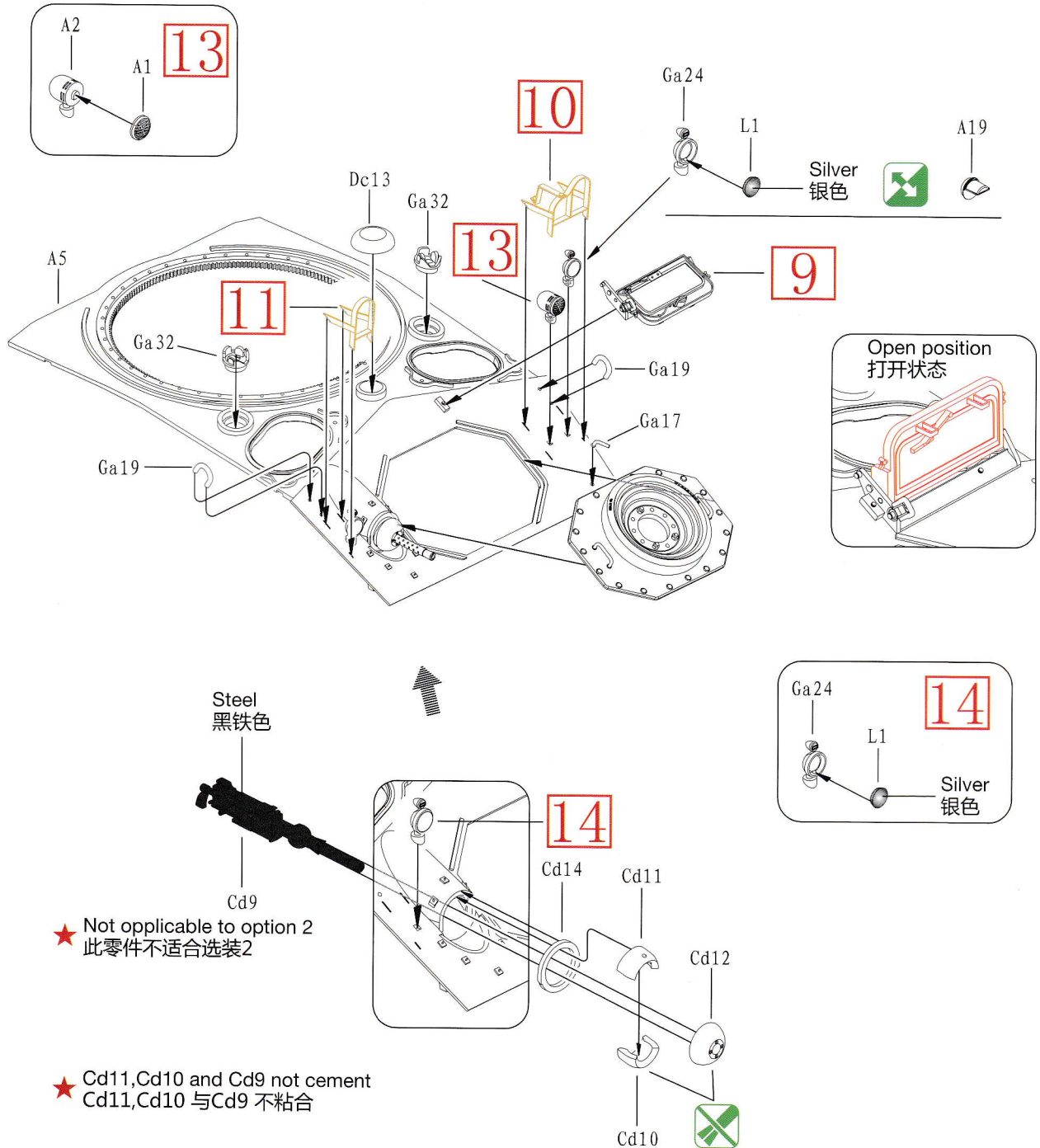


ILLUSTRATION 图示说明:

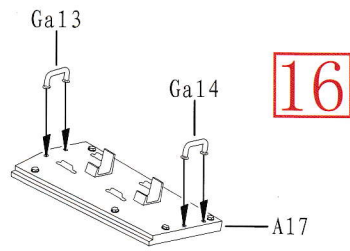
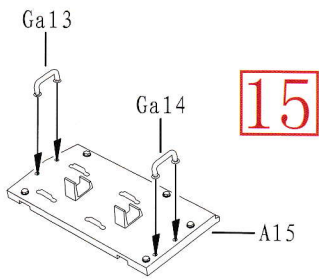
11



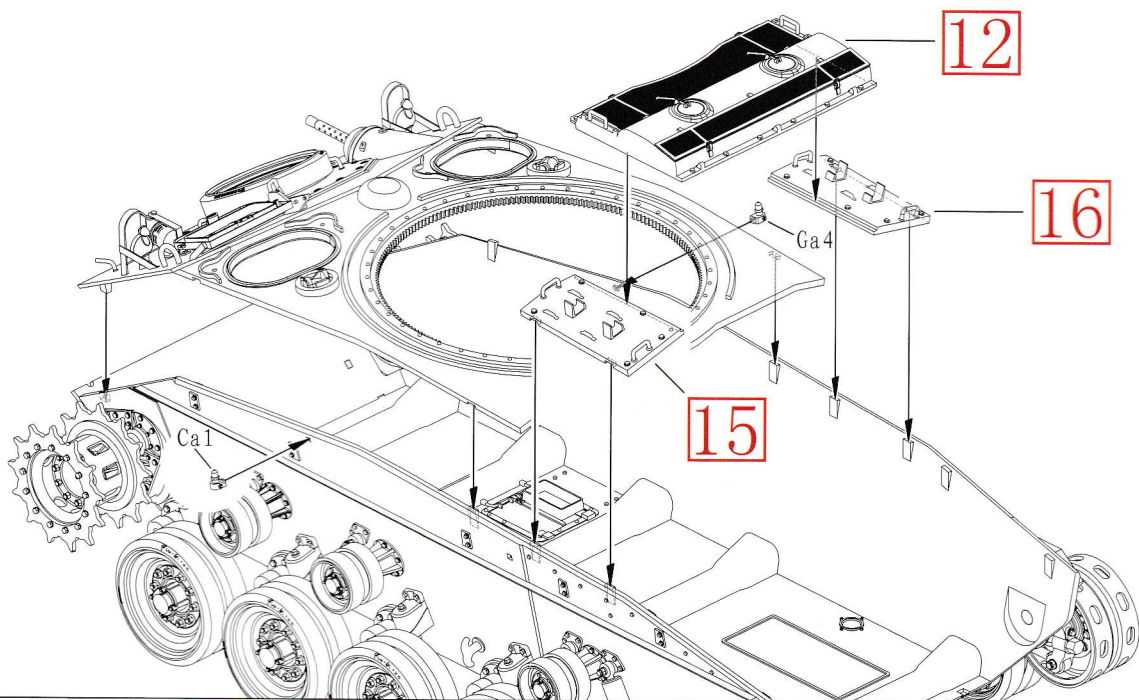
12



13



14



15

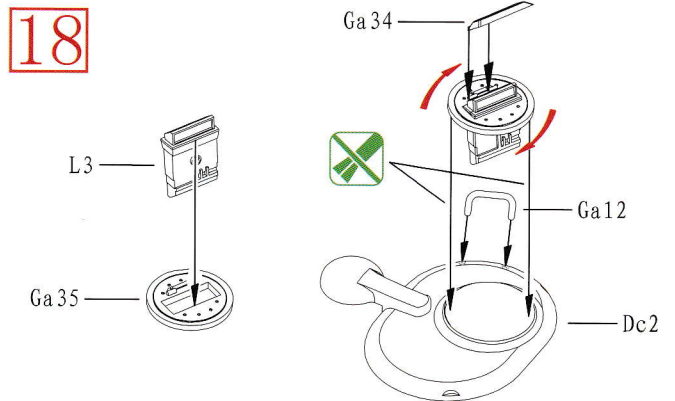
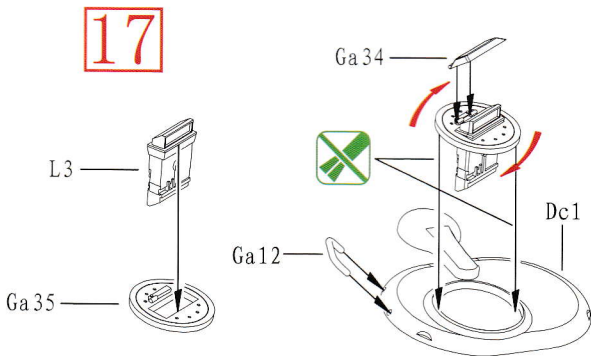
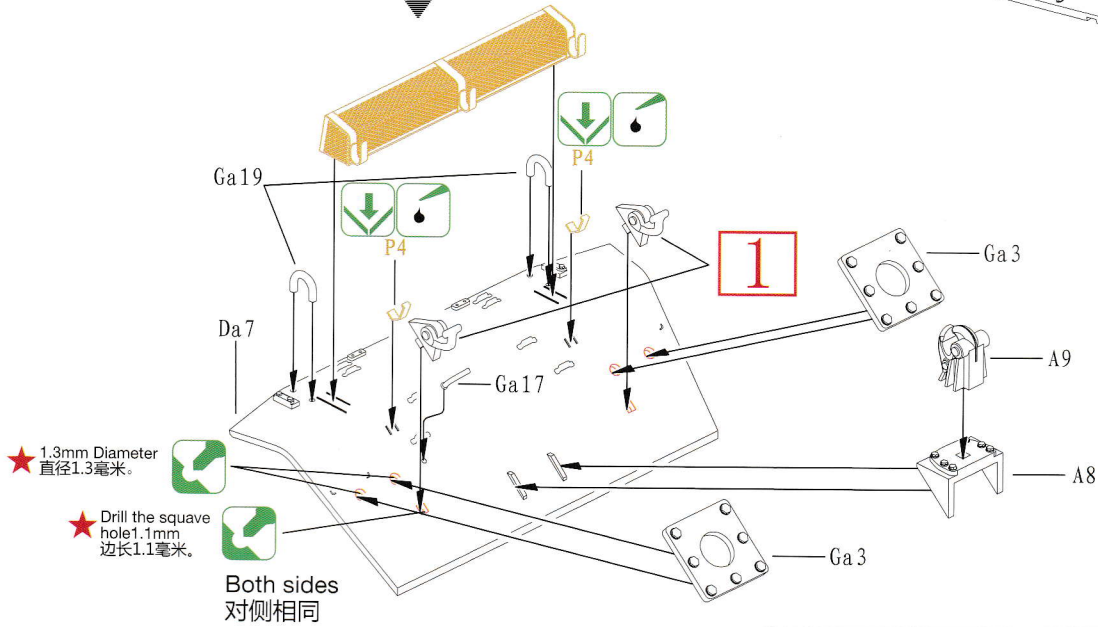
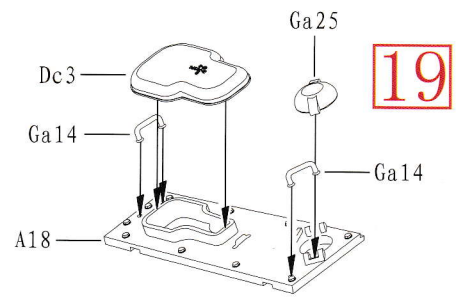
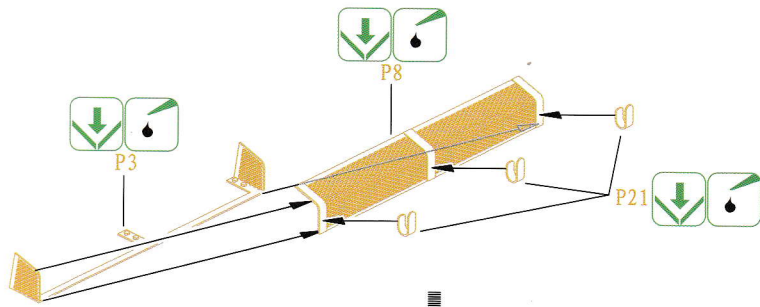


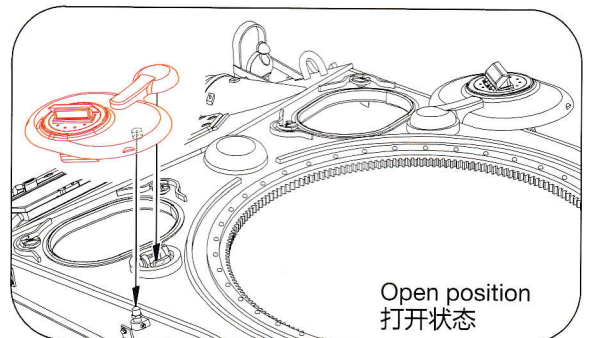
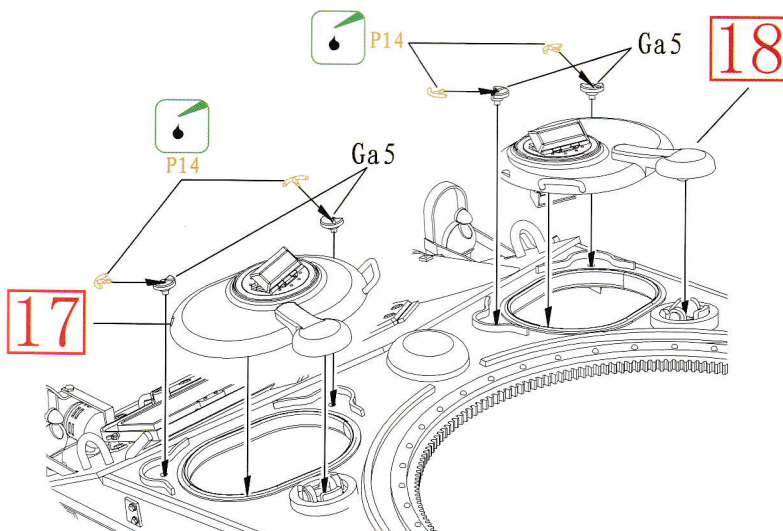
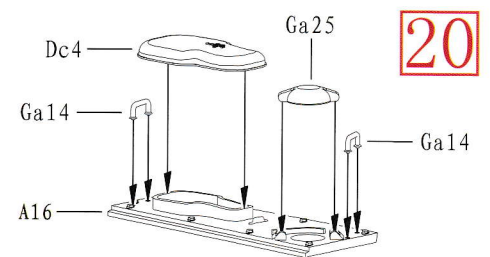
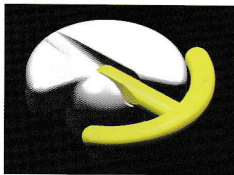
ILLUSTRATION 图示说明:

16

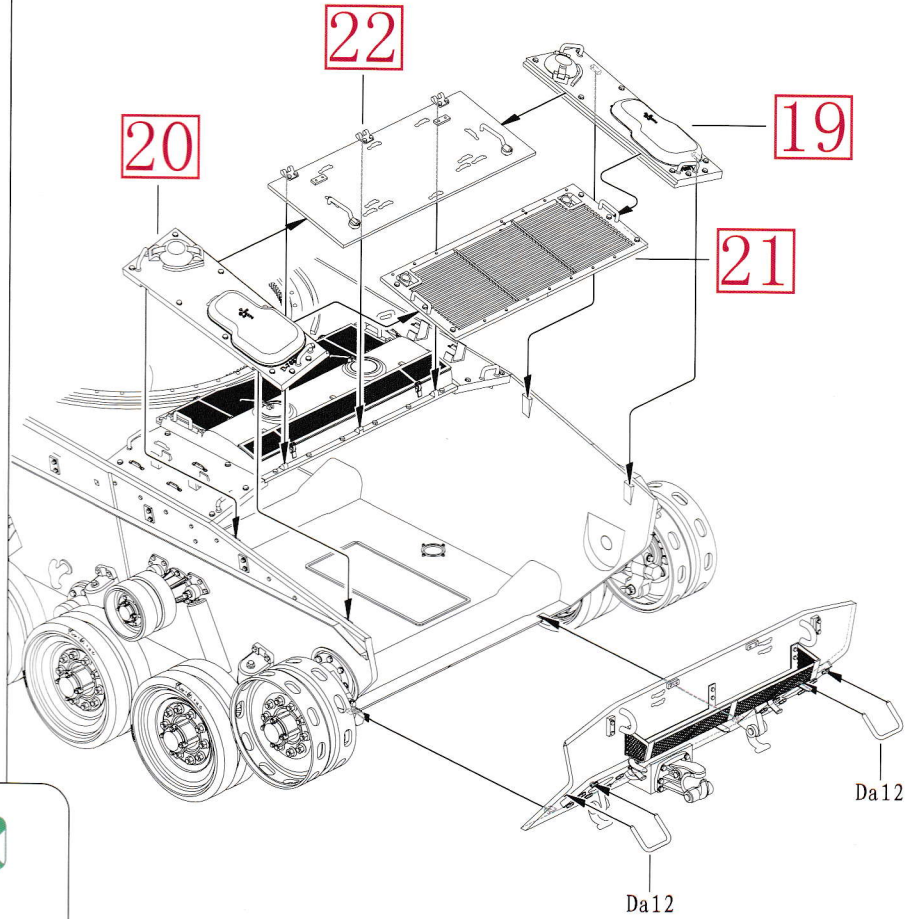
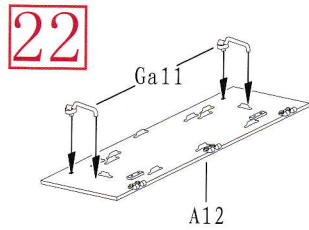
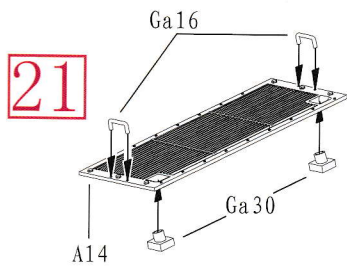


17

P14

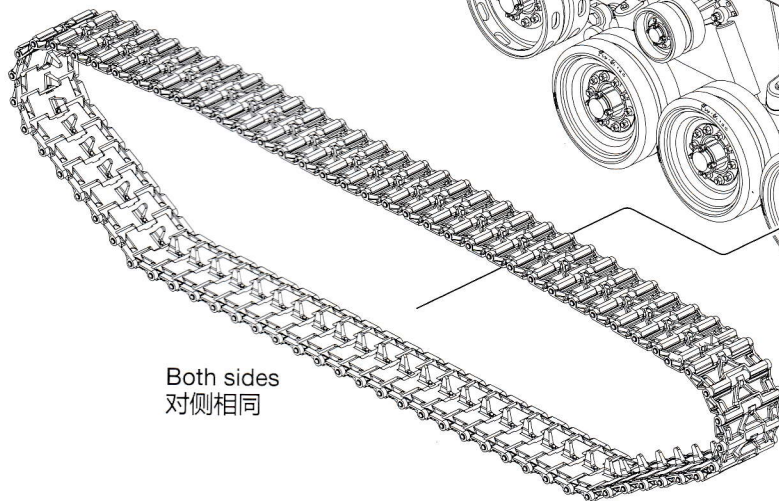


18



★ Caution: Each set x72-73 pc
注意：每组需要72-73枚

19



Both sides
对侧相同

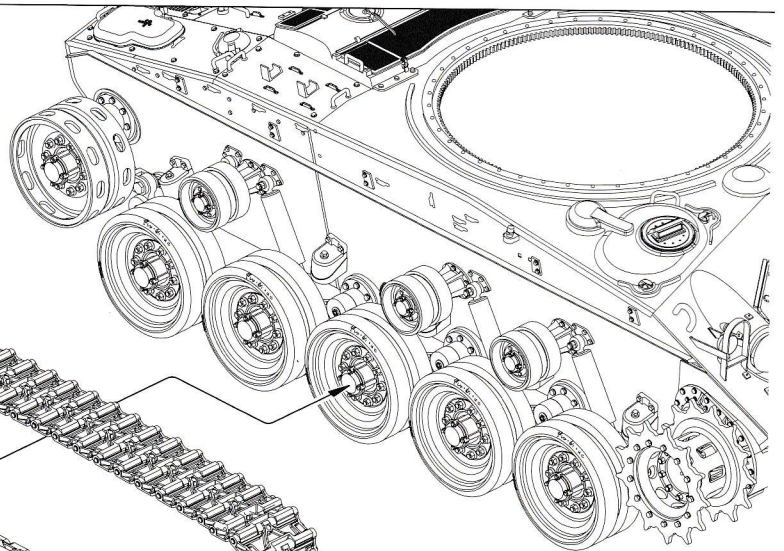
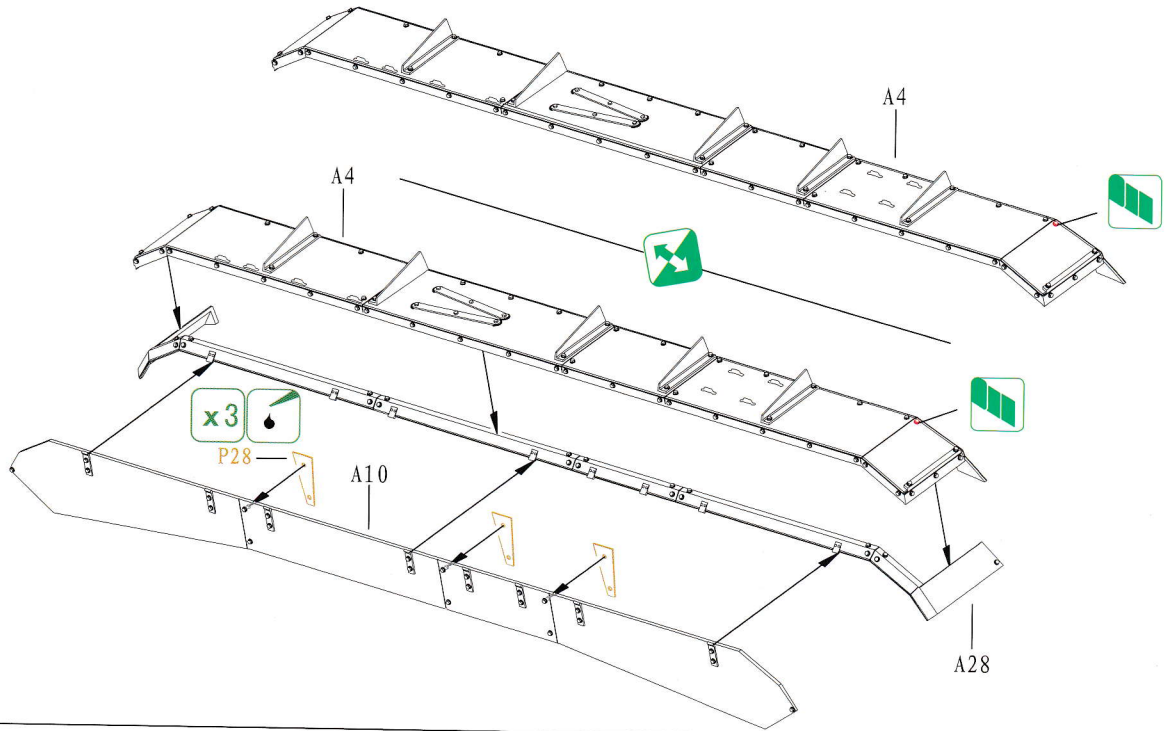
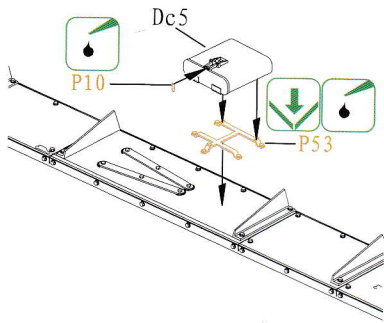


ILLUSTRATION 图示说明:

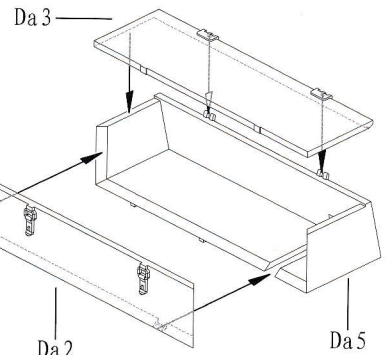
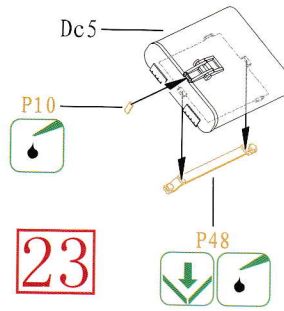
20



★ Option 4 only.
此套件仅适用于选装4。



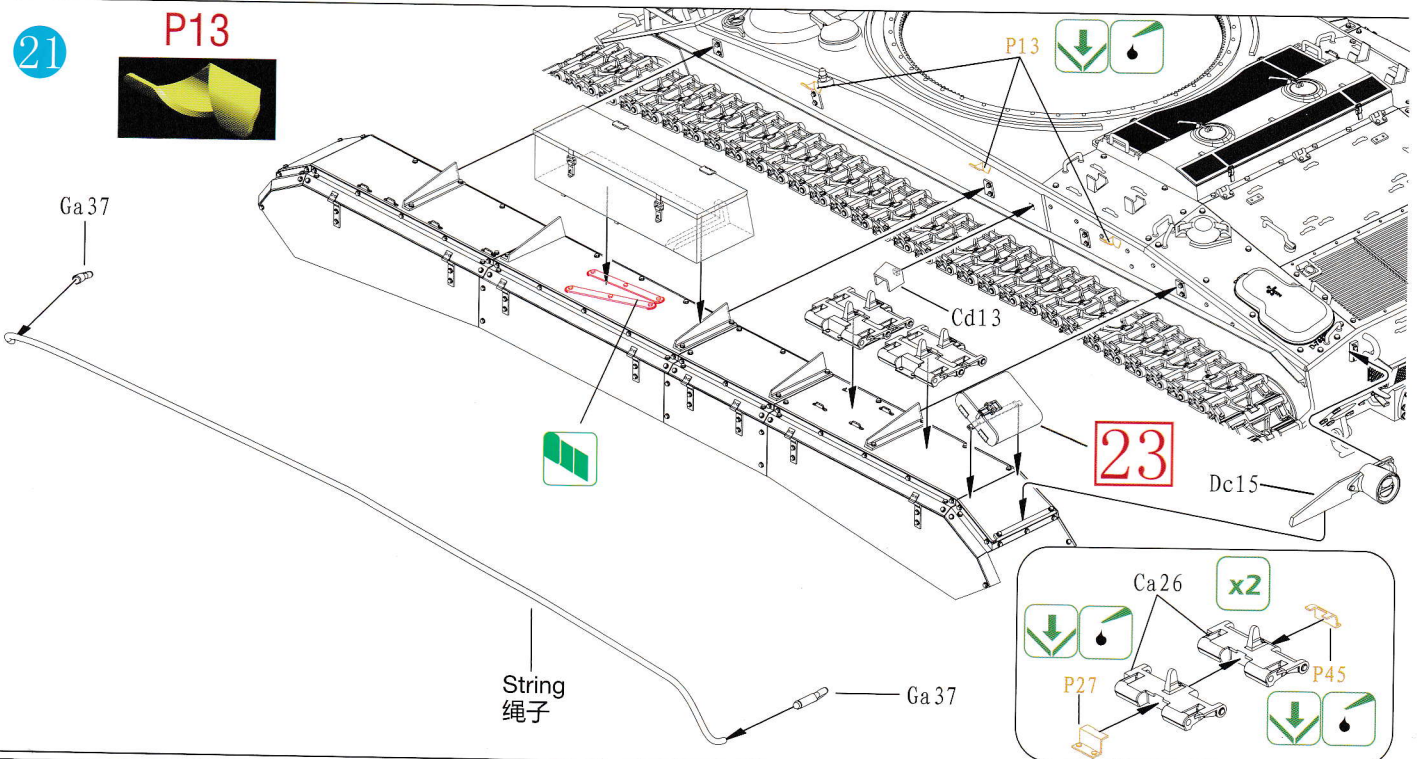
★ Not suitable for option 4.
此套件不适用于选装4。



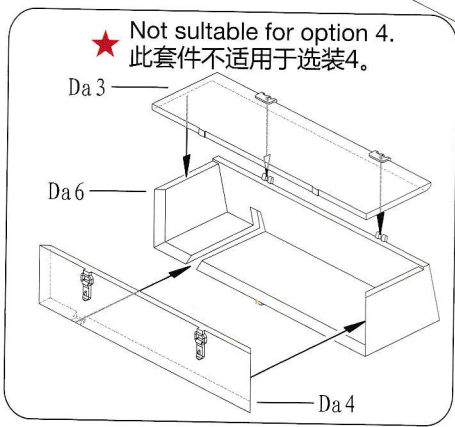
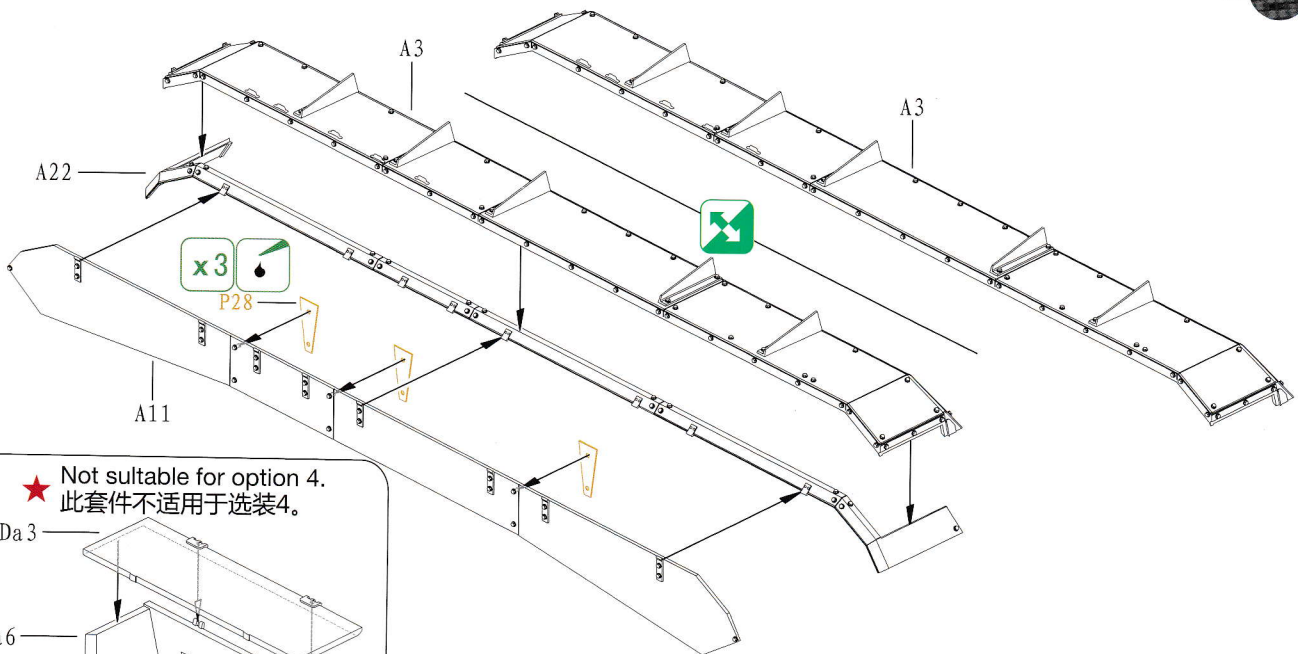
★ Not suitable for option 4.
此套件不适用与选装4。

21

P13

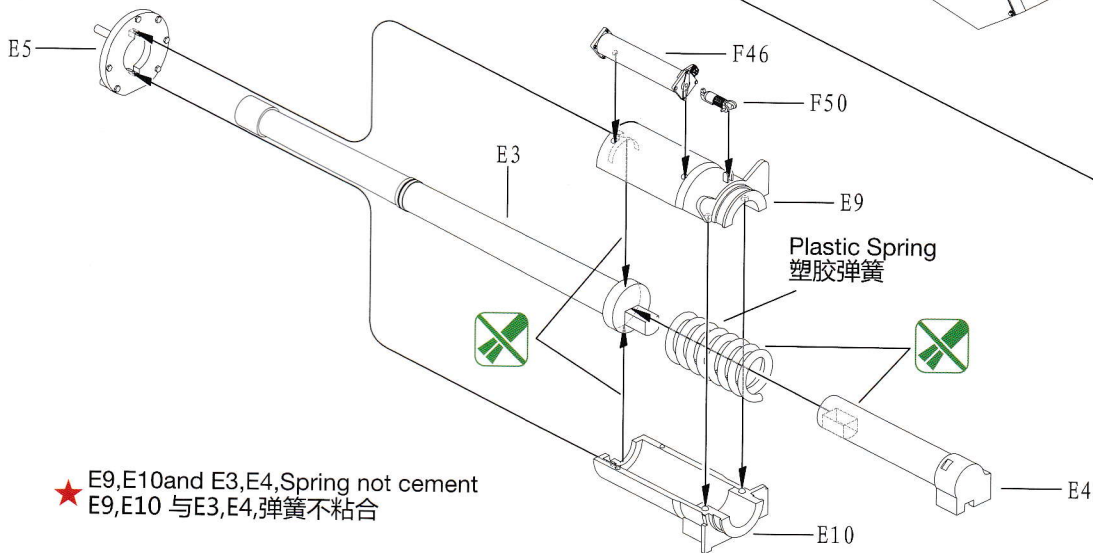
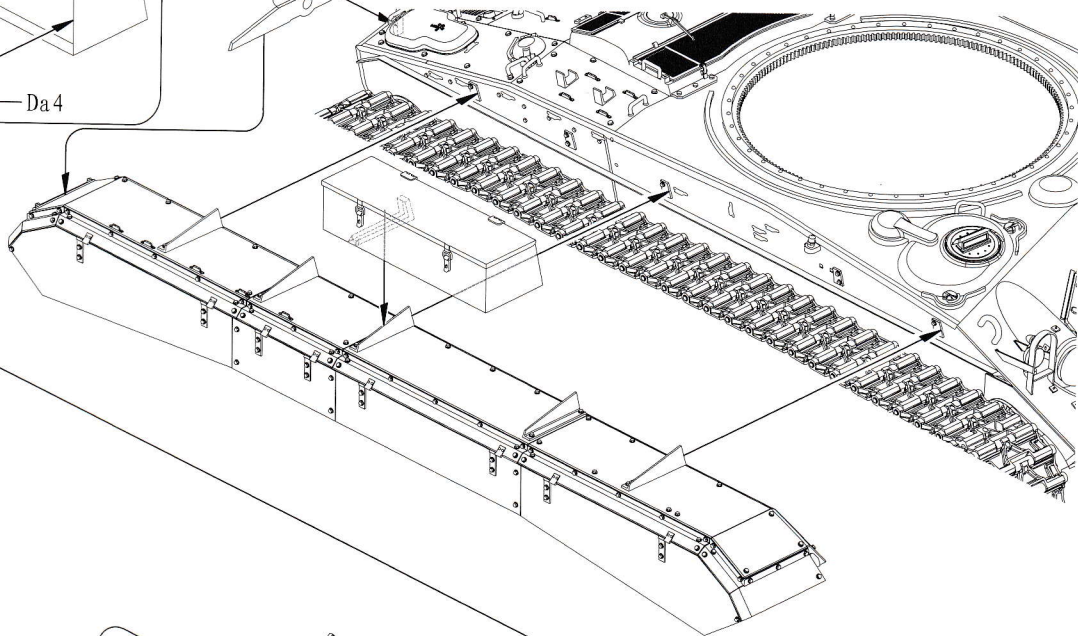


22



Dc14

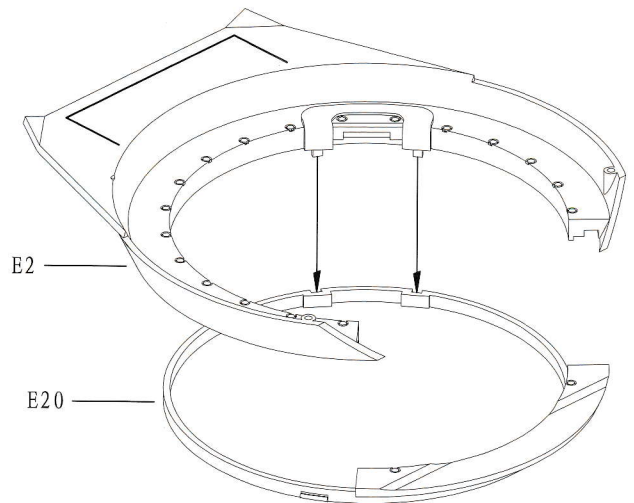
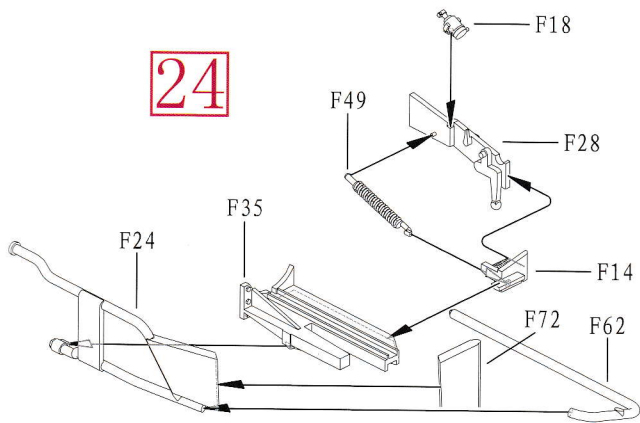
23



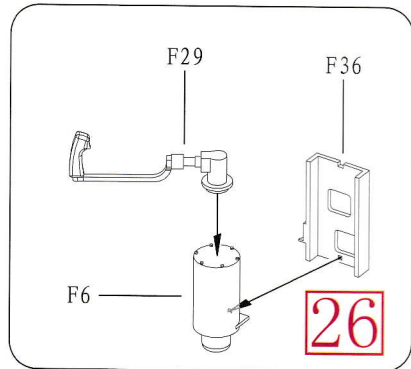
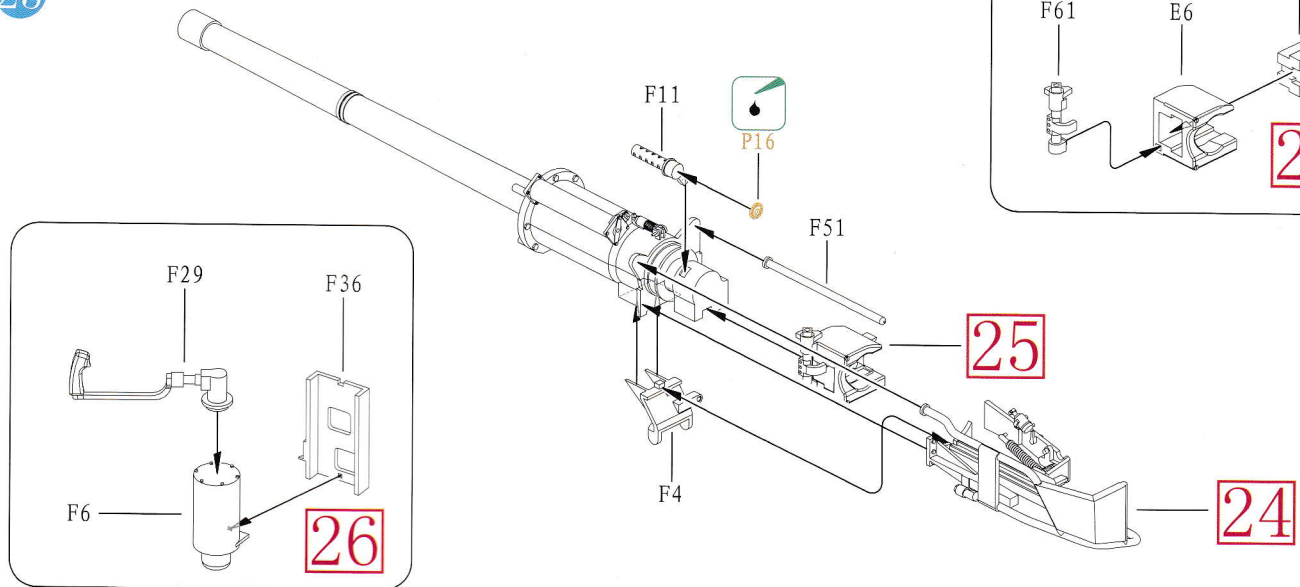
★ E9,E10and E3,E4, Spring not cement
E9,E10 与E3,E4,弹簧不粘合

ILLUSTRATION 图示说明:

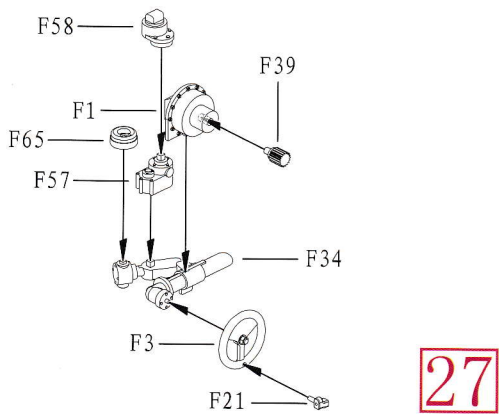
24



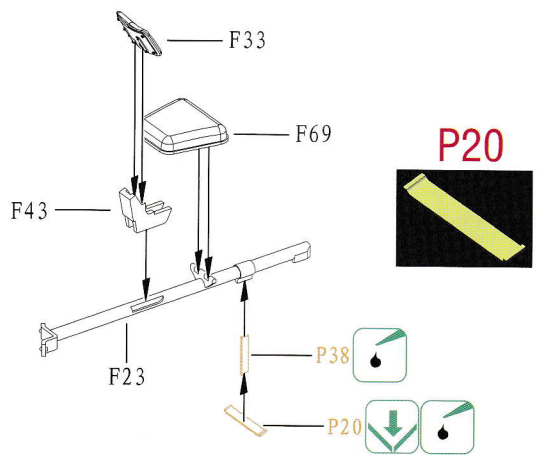
25



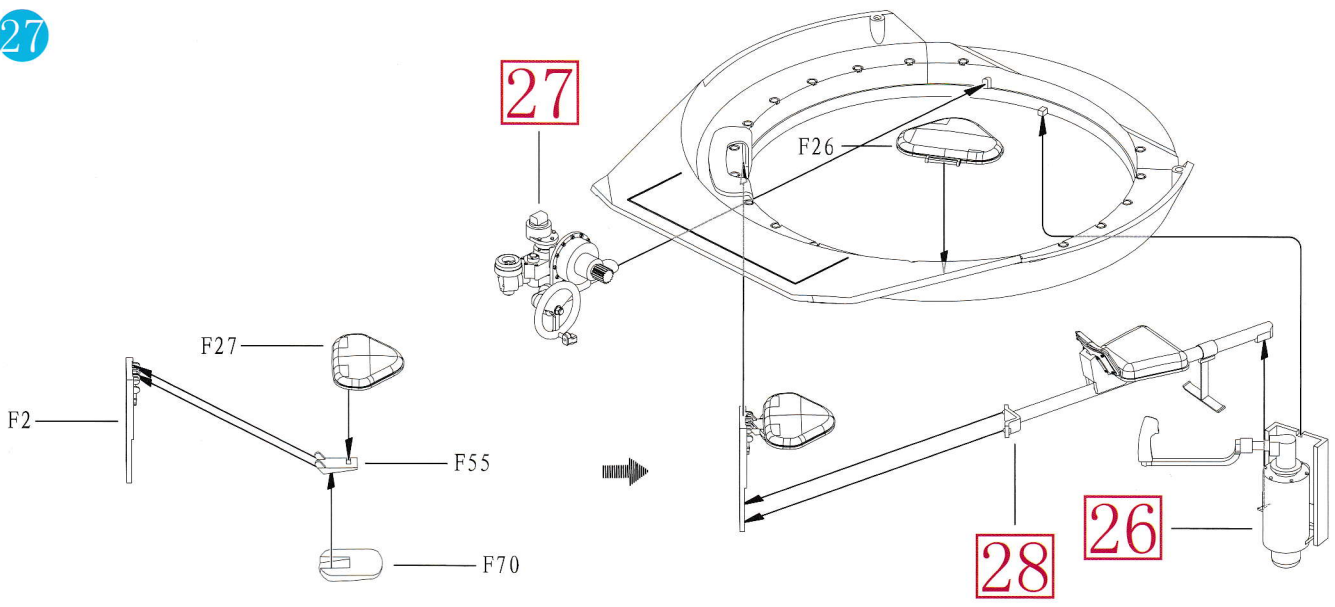
26



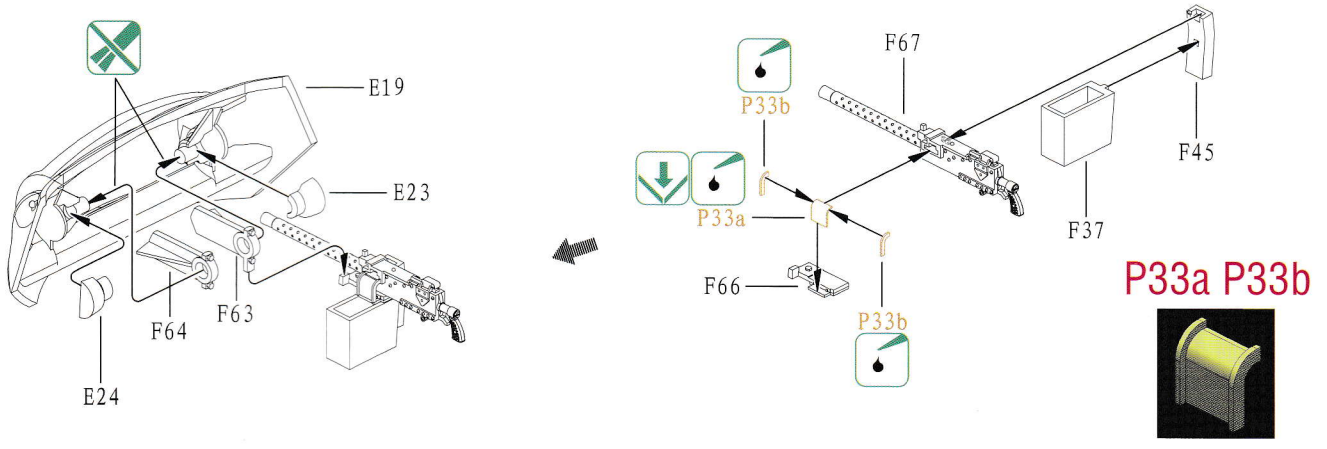
28



27



28



29

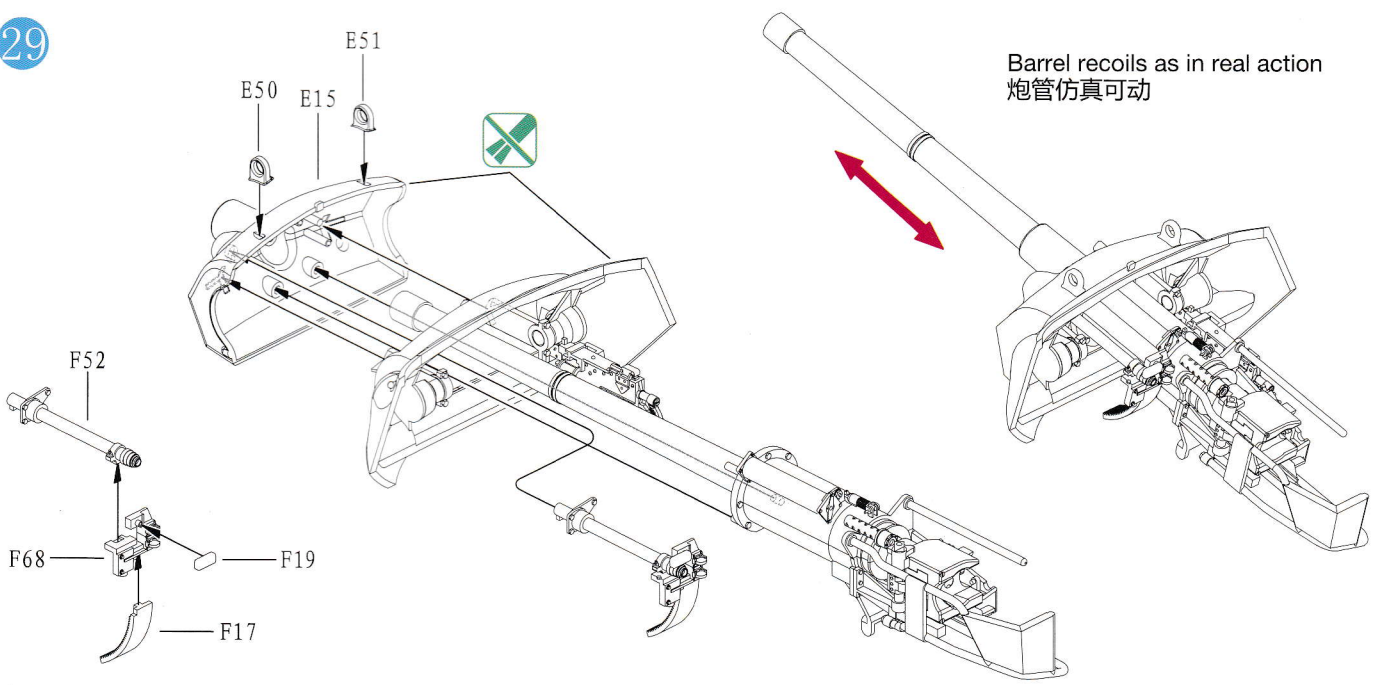
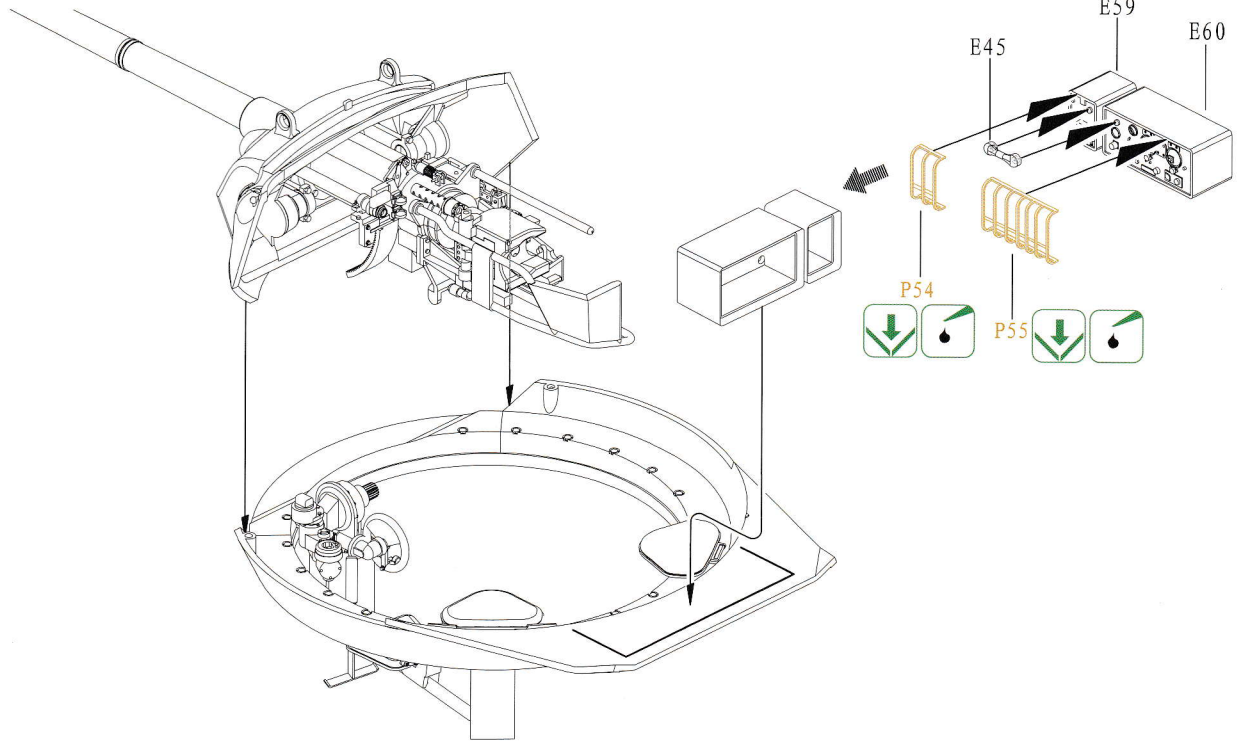
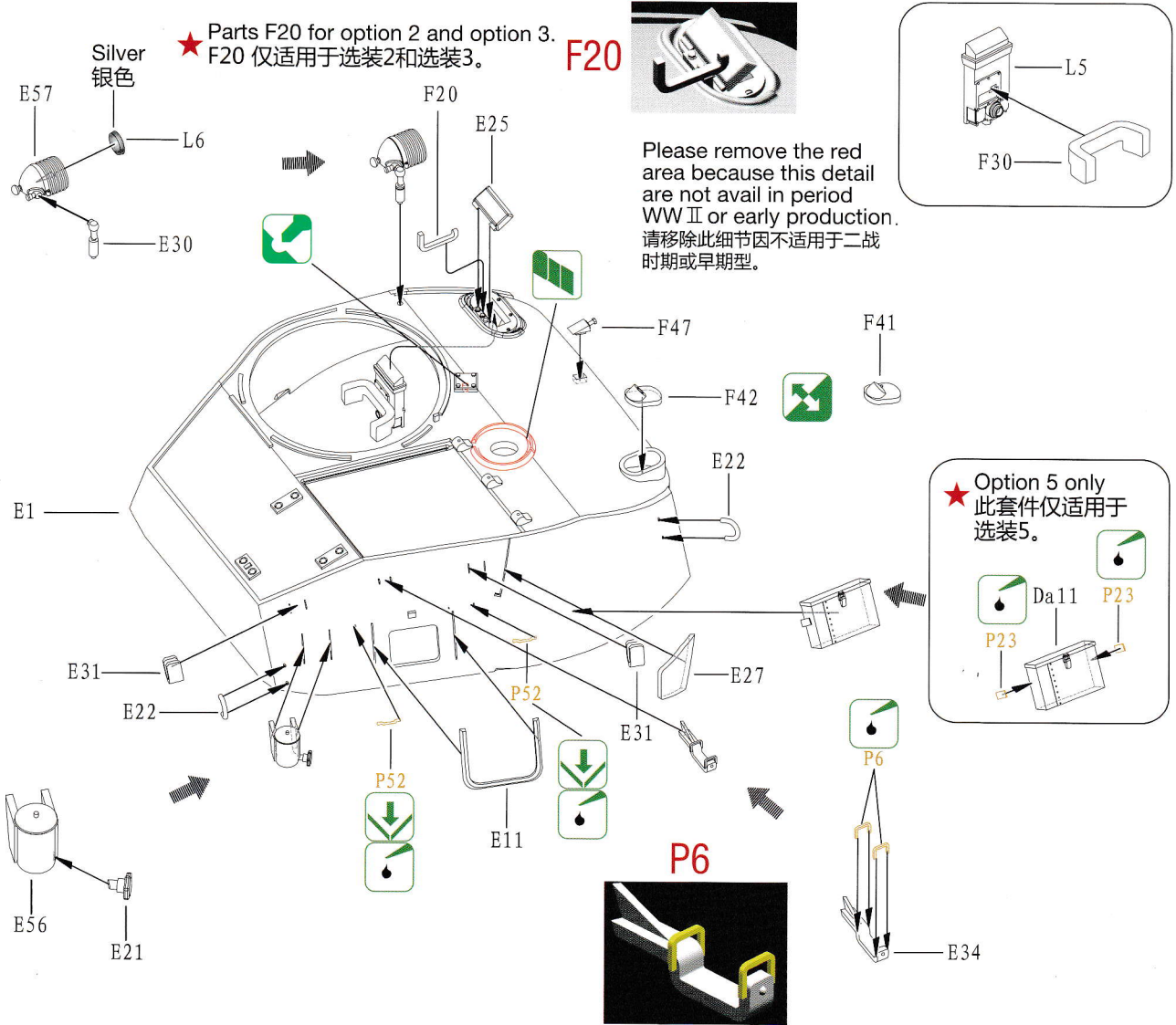


ILLUSTRATION 图示说明:

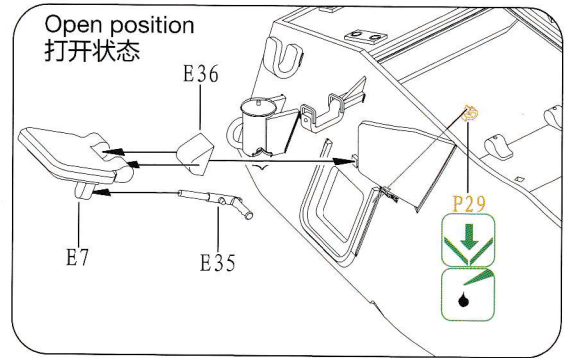
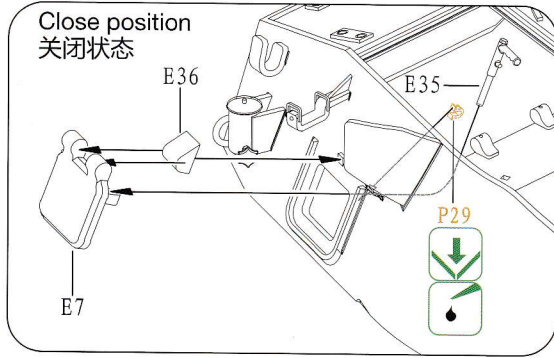
30



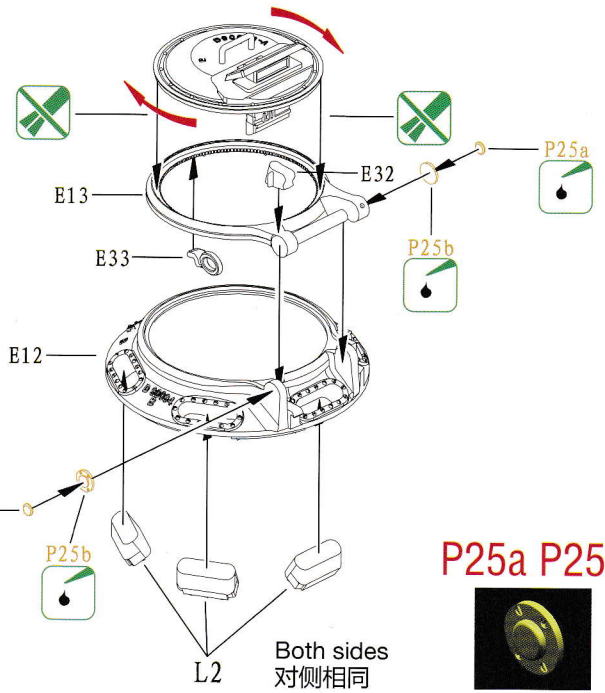
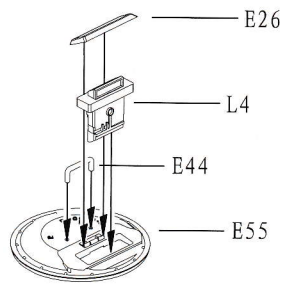
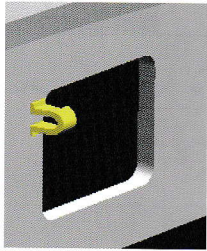
31



32

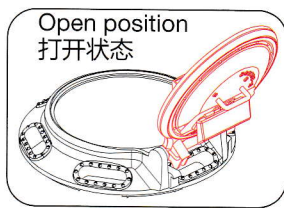


P29

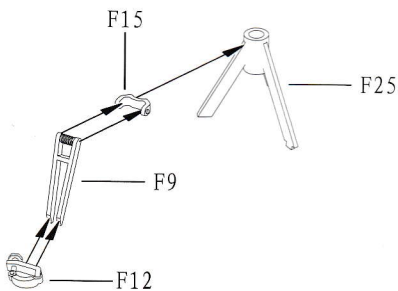


P25a P25b

33



34



P36

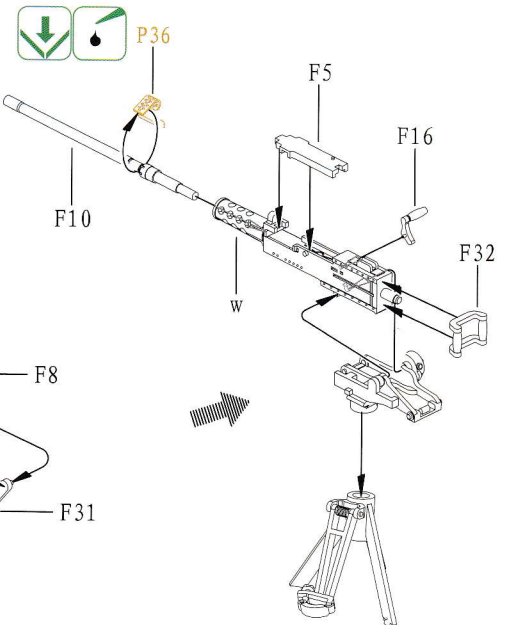
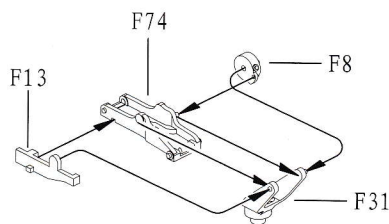
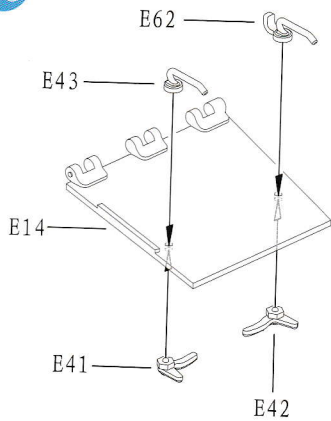
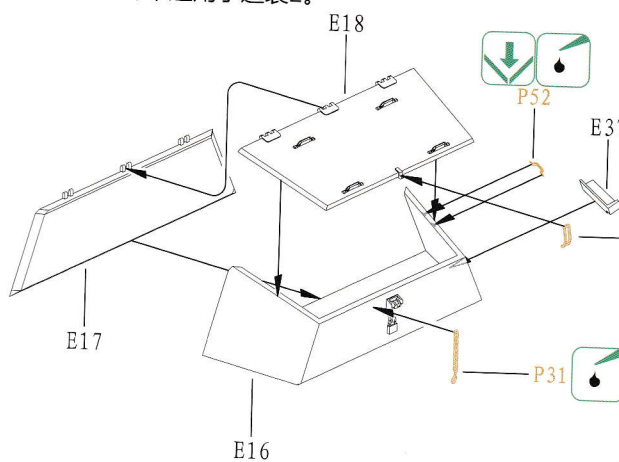


ILLUSTRATION 图示说明:

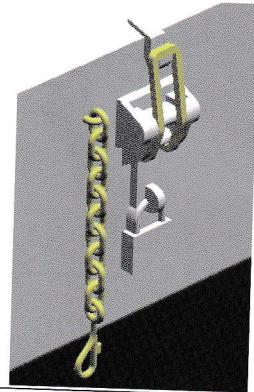
35



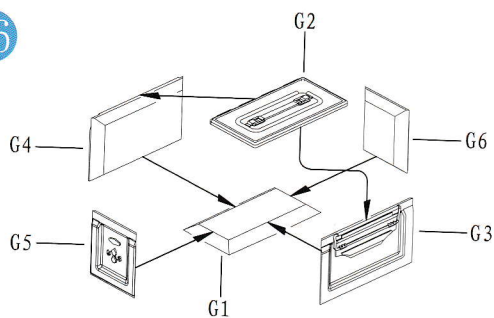
★ Not suitable for option 2.
此套件不适用于选装2。



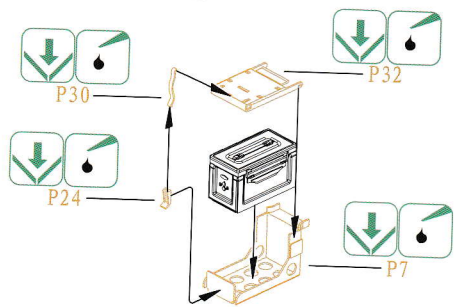
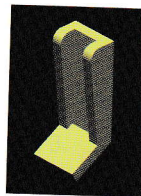
P2 P31



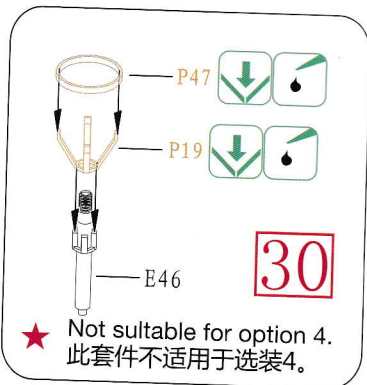
36



P24

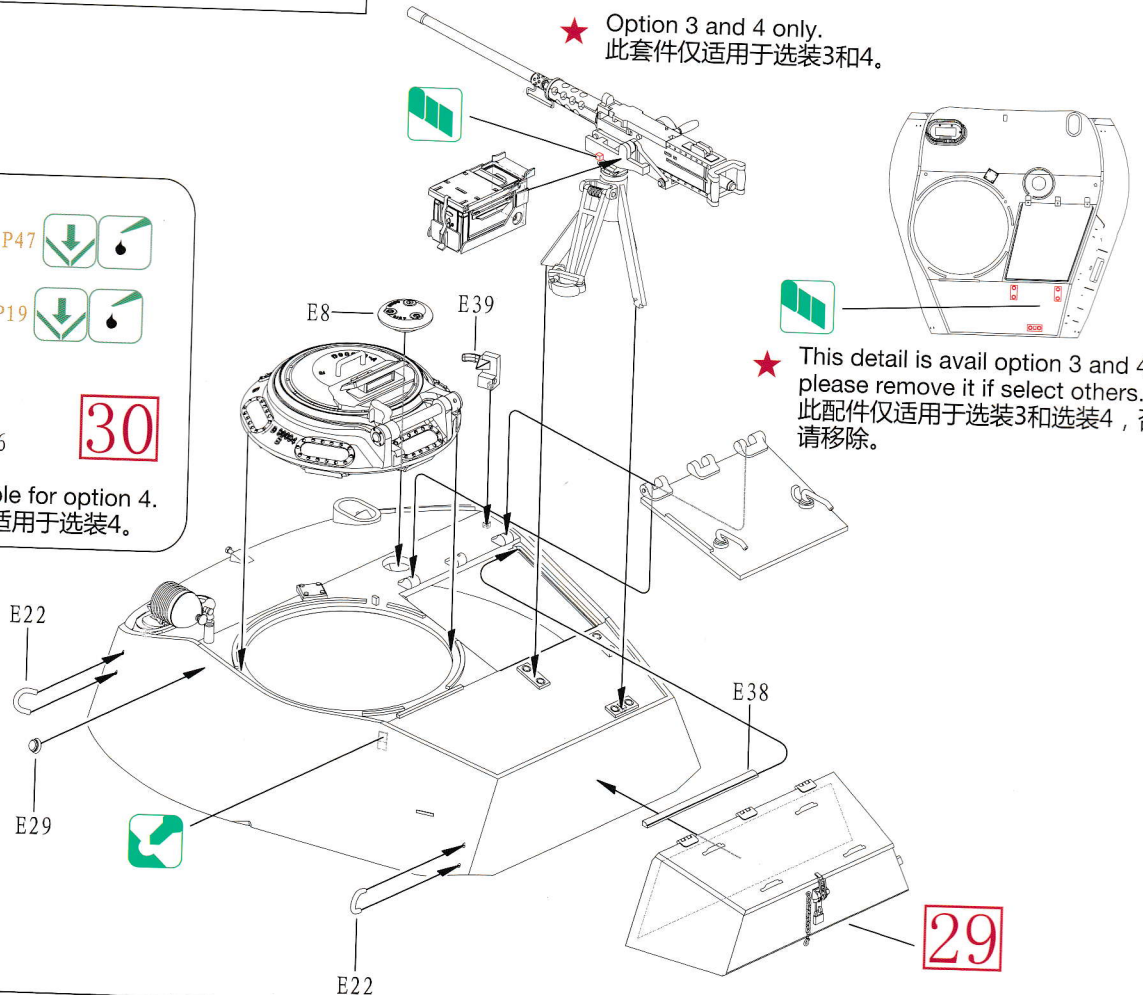


37



★ Not suitable for option 4.
此套件不适用于选装4。

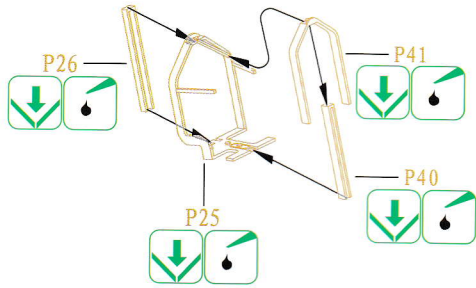
★ Option 3 and 4 only.
此套件仅适用于选装3和4。



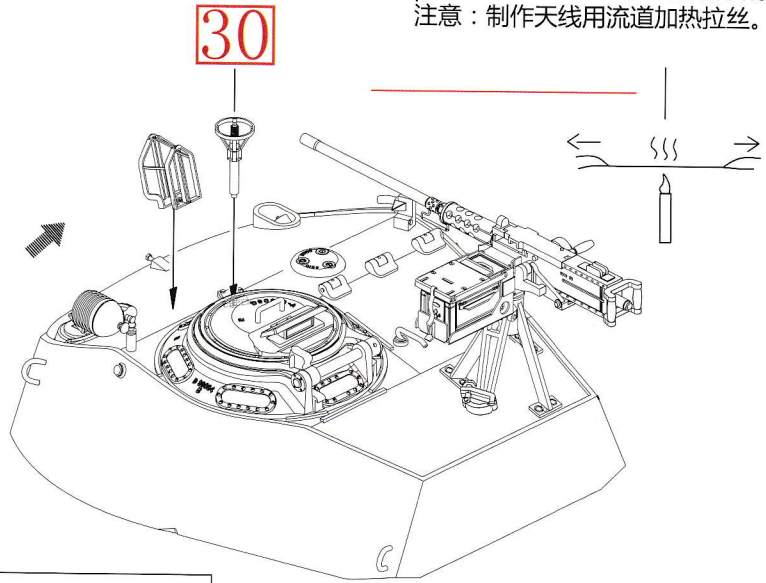
★ This detail is avail option 3 and 4 only
please remove it if select others.
此配件仅适用于选装3和选装4, 否则
请移除。

38

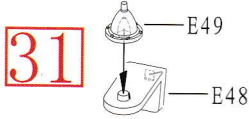
★ Option1、3 and 5 only.
此套件仅适用于选装1、3、5。



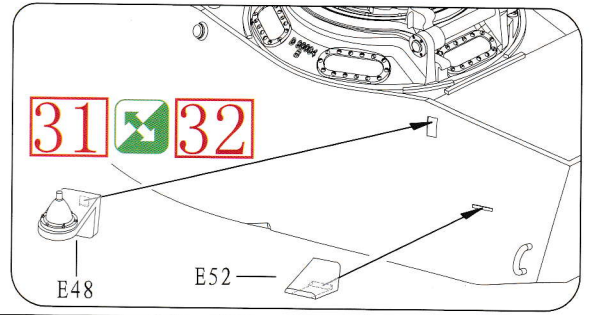
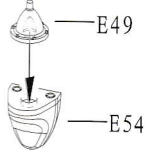
★ Caution: Make the antenna from the plastic frame channel with the heat of fire.
注意：制作天线用流道加热拉丝。



★ Option 3 only.
此套件仅适用于选装3。



★ Option1、2、4 and 5 only.
此套件仅适用于选装1、2、4、5。



39

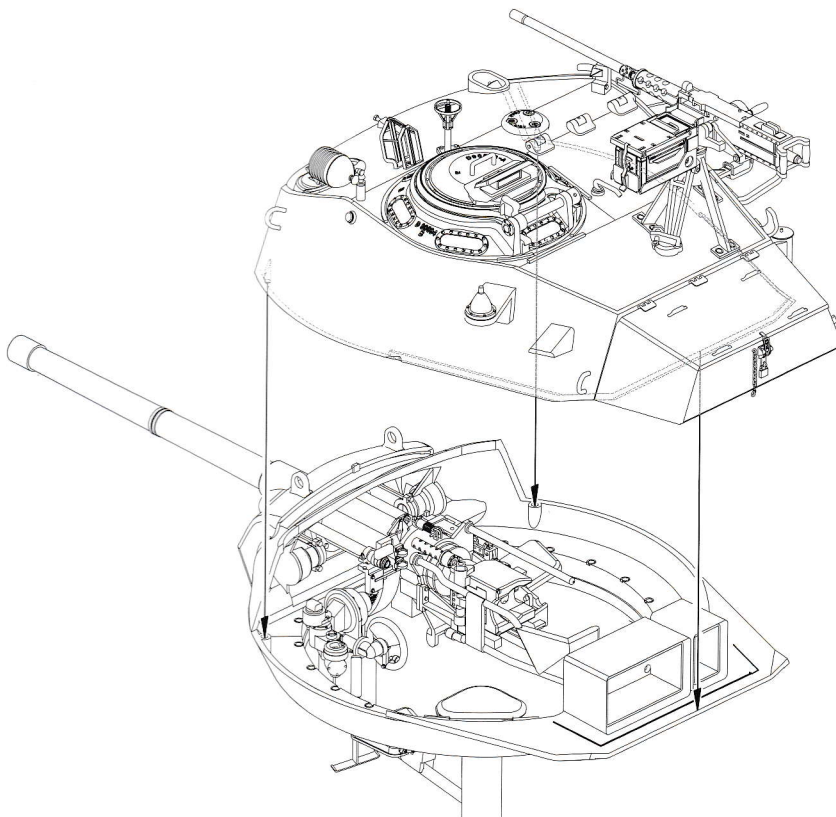
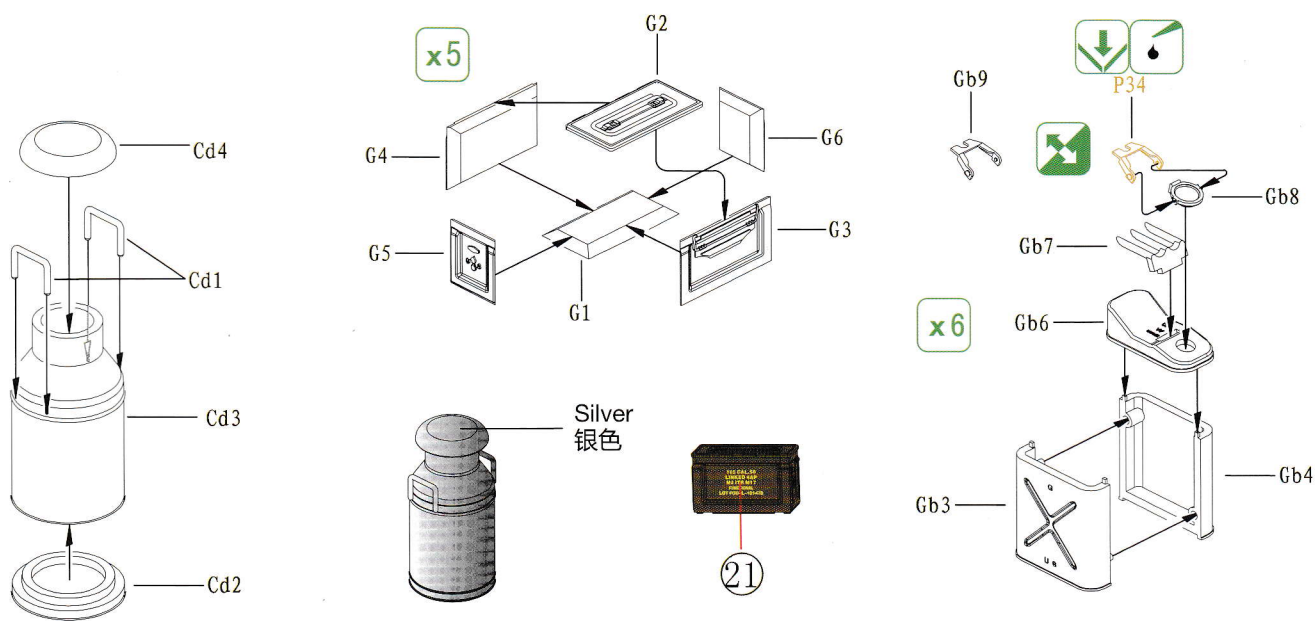


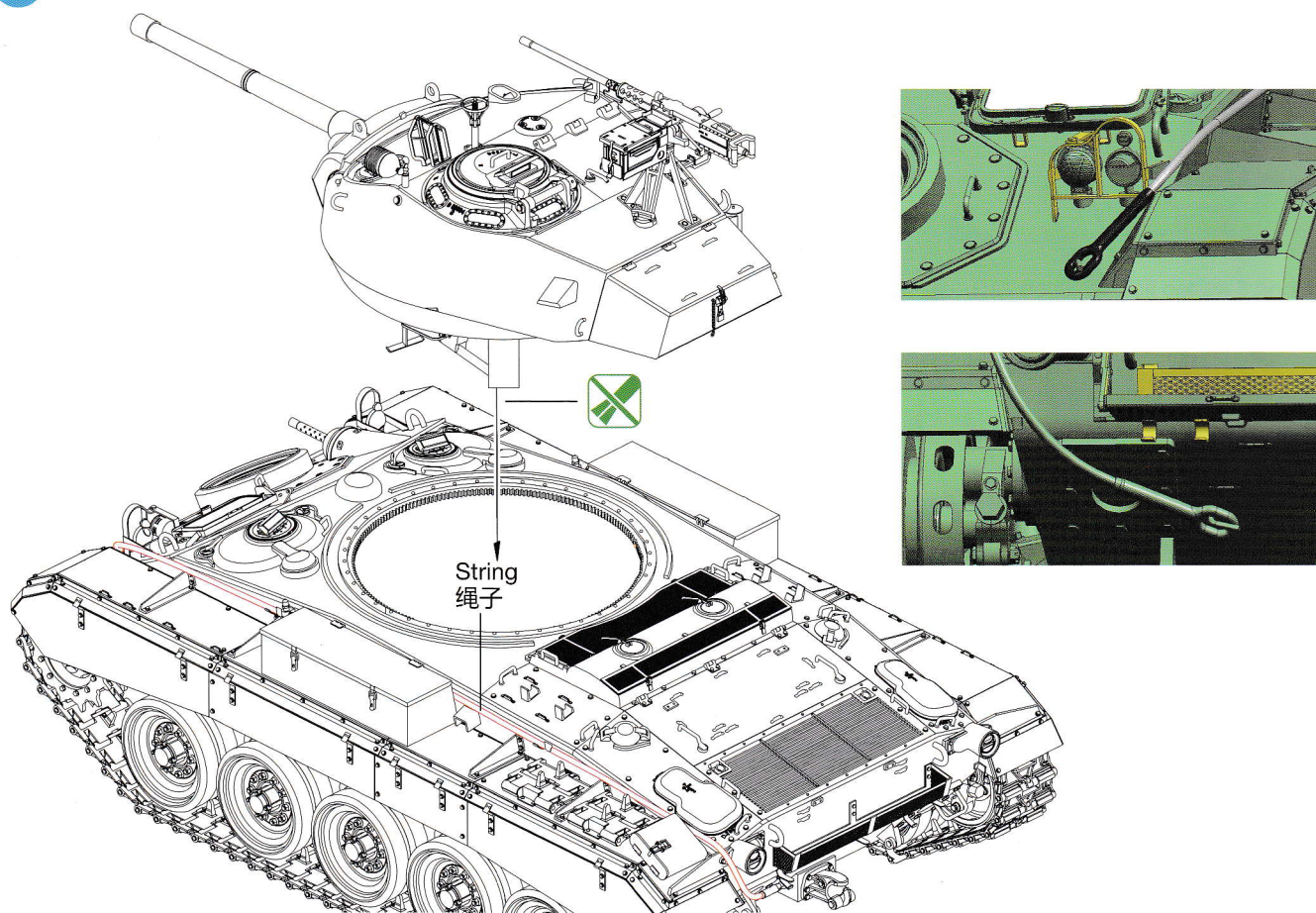
ILLUSTRATION 图示说明:

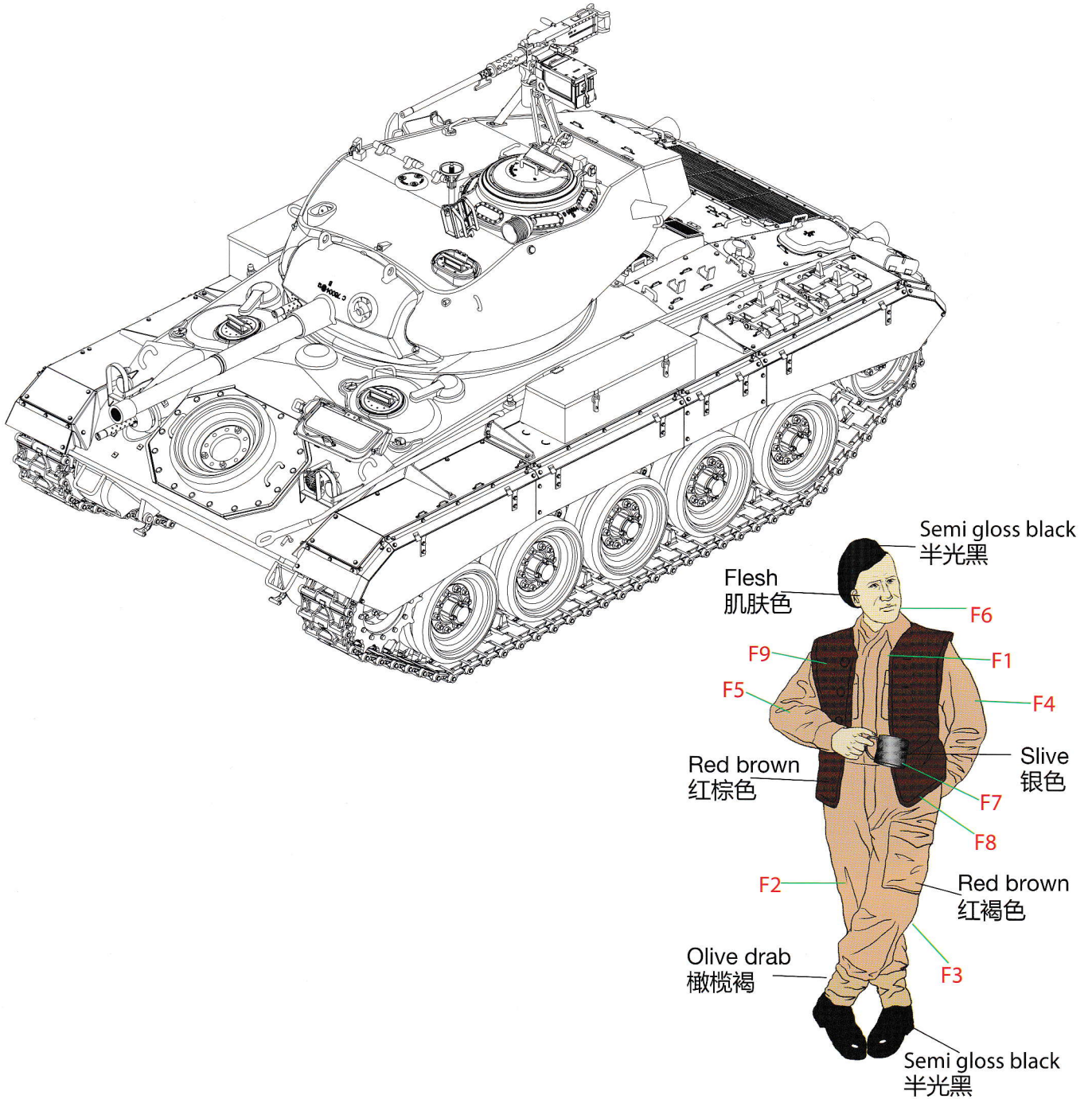
40

★ Bonus: Caisson, Milk bucket, Oil bucket
 附送：弹药箱,牛奶桶,油桶



41



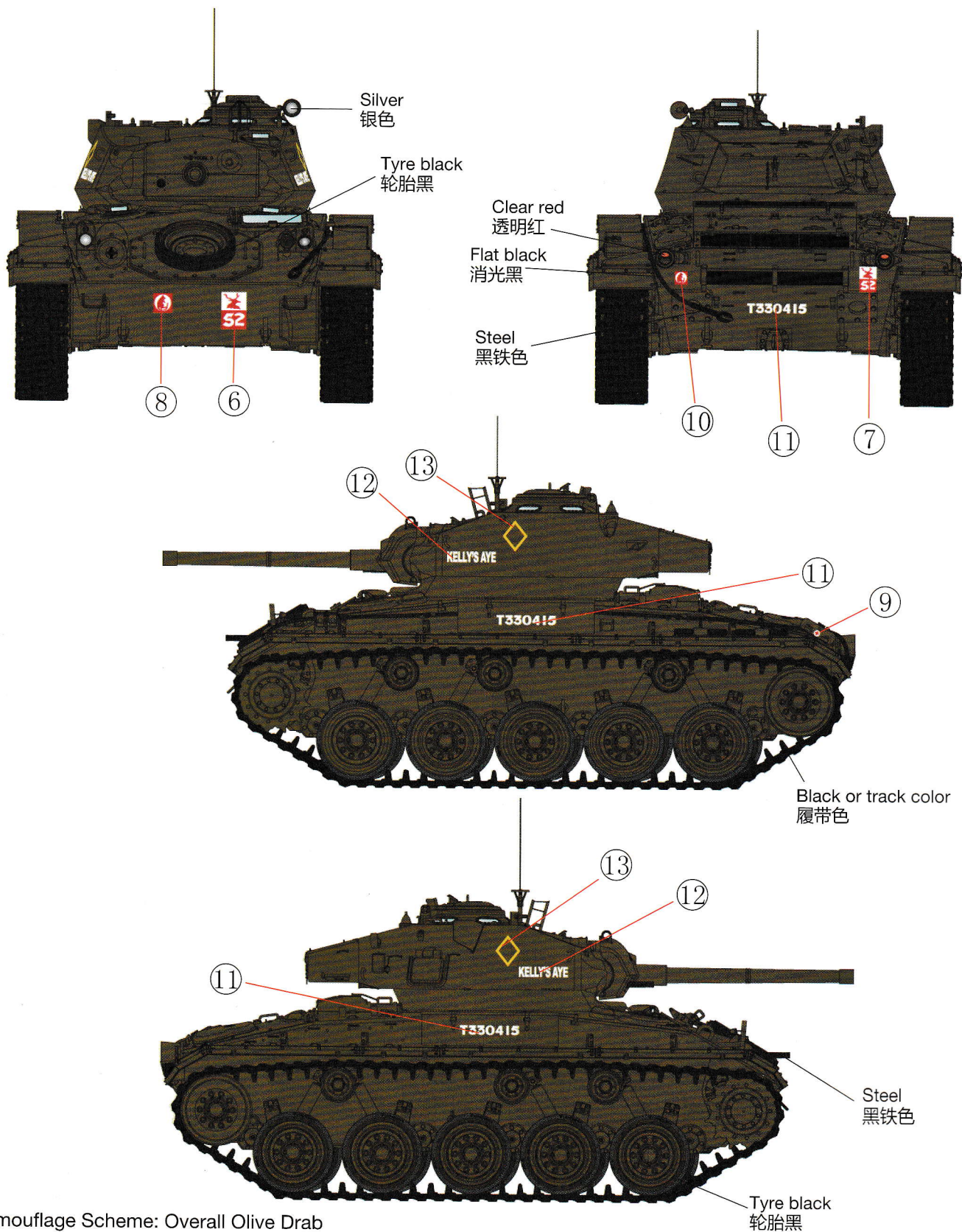


★ This is a precision molded plastic kit with exceptionally fine detail. It will require a little more care during assembly, but you feel the end result is well worth the effort.
本套件设计精密,零件繁多可能让你在制作过程中有所不便,但完成后会让你产生无穷之成功快感。

Happy modelling!
祝愿制作愉快!

DECAL & COLOUR GUIDE 水贴及涂色指示:

★ Option 1:
 HQ Troop, 5th Royal Tank Regiment, 22nd Armoured Brigade Of The 7th Armoured Division Germany 1945.
 1945年在德国境内之第7装甲师, 第22装甲旅第5皇家坦克团属下车辆。

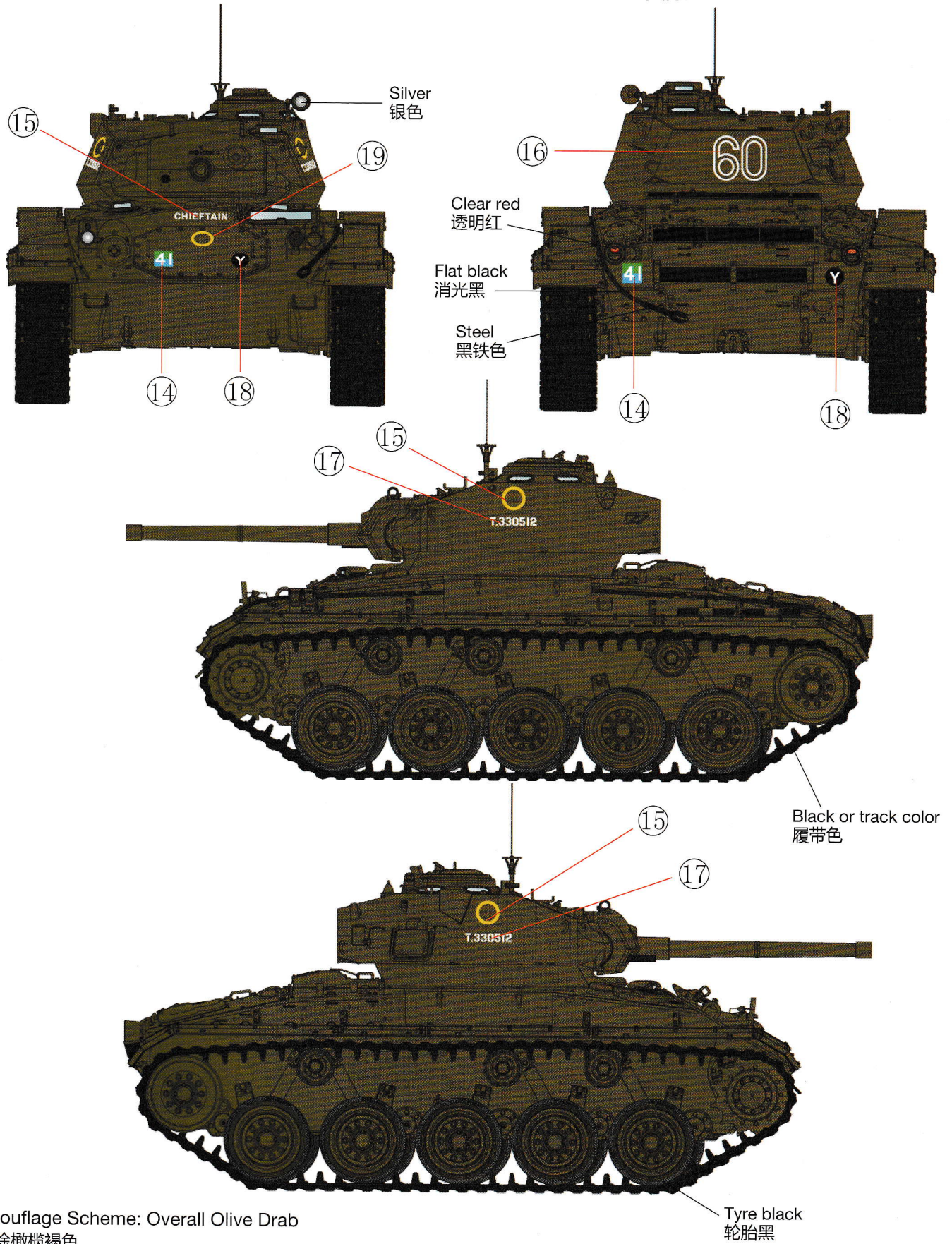


Camouflage Scheme: Overall Olive Drab
 全车涂橄榄褐色

DECAL & COLOUR GUIDE 水贴及涂色指示:

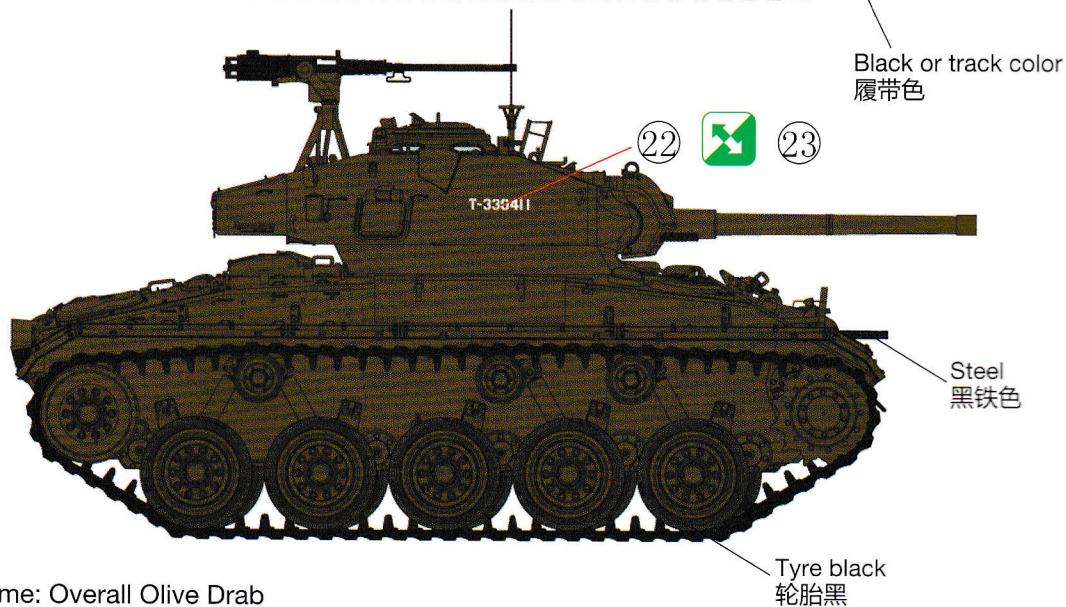
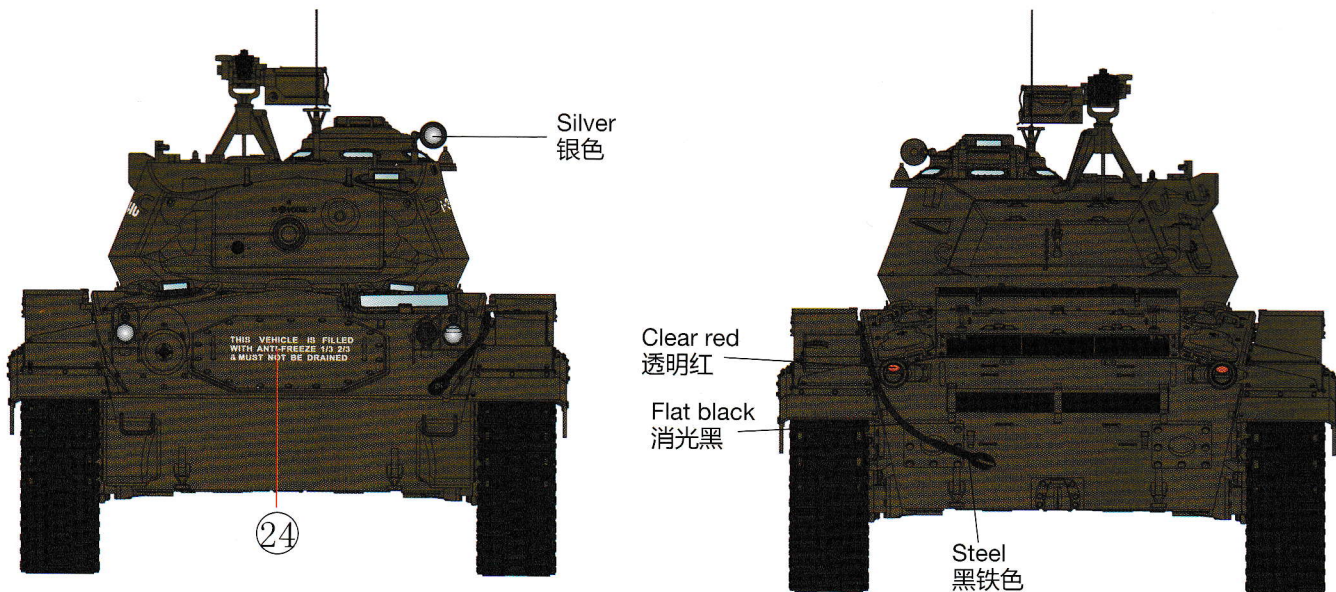
★ Option 2:

C Squadron, Reconnaissance Regiment, 5th Infantry Division, British Army, 1946.
 1946年驻在德国之英国陆军第5步兵师侦察团C连队属下车辆。



DECAL & COLOUR GUIDE 水贴及涂色指示:

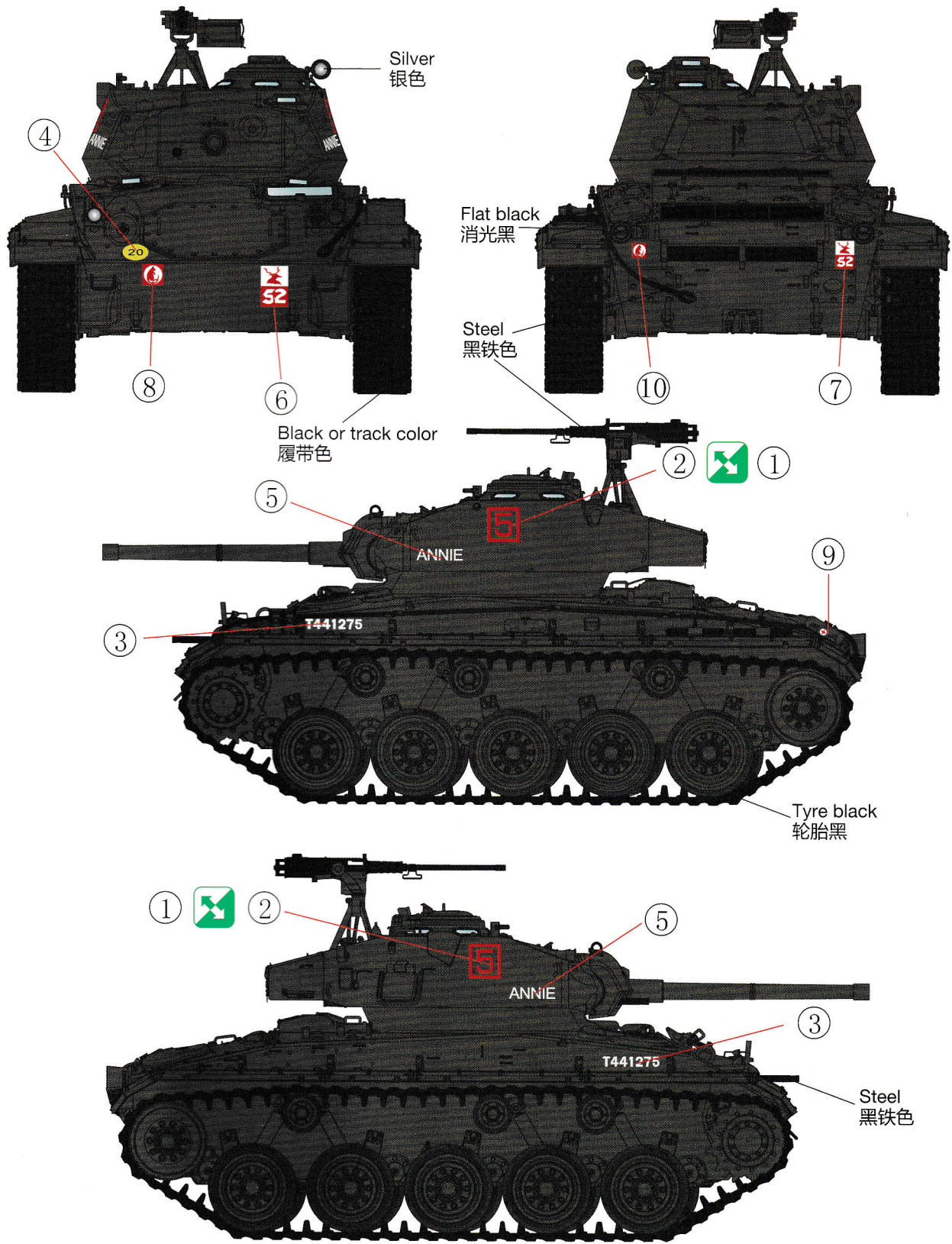
★ Option 3:
Newly Delivered tank For Experiment Purpose England, Winter 1944.
1944年底刚抵达英伦作测试用之M-24。



Camouflage Scheme: Overall Olive Drab
全车涂橄榄褐色

DECAL & COLOUR GUIDE 水贴及涂色指示:

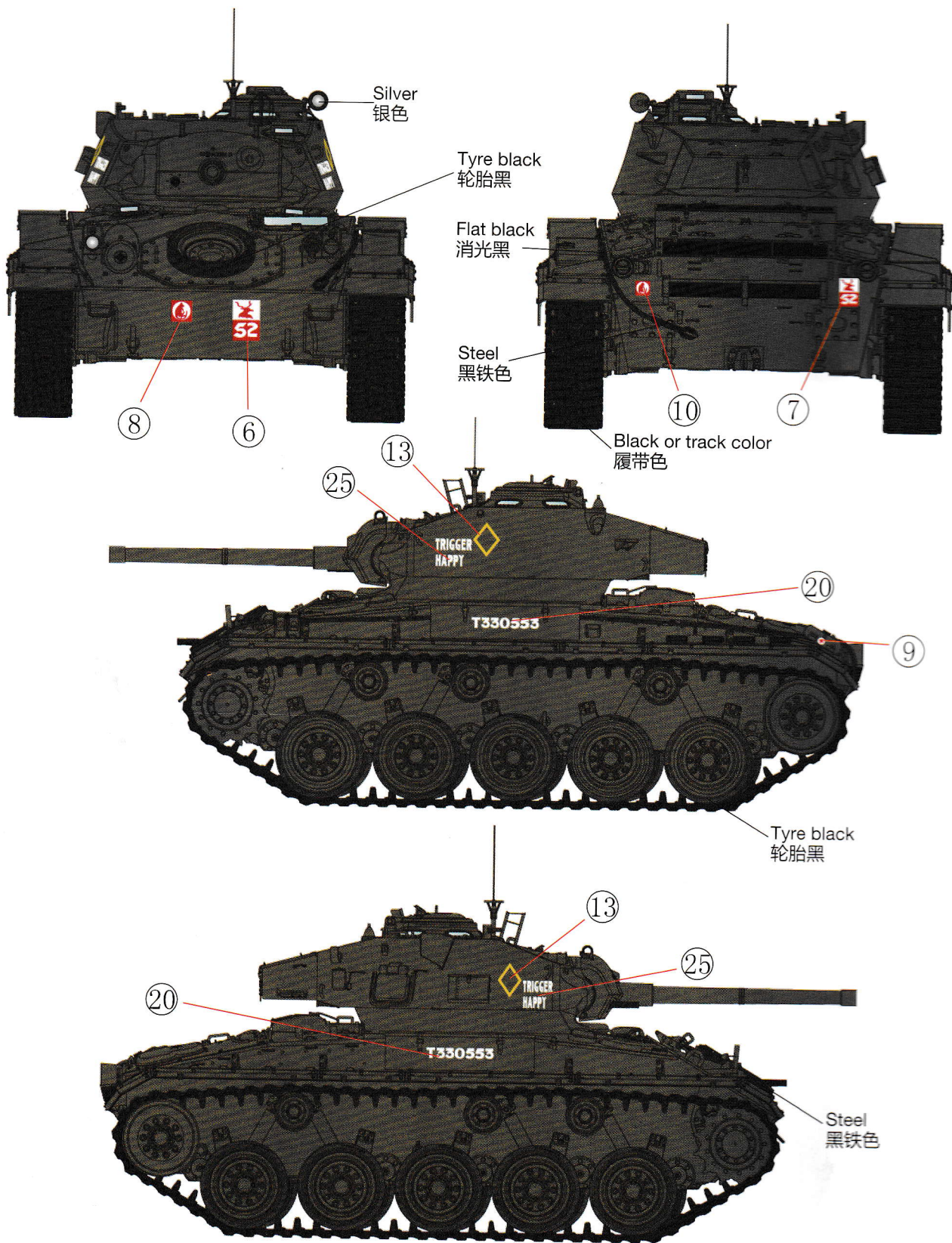
★ Option4:
 3rd Royal Tank Regiment, 22nd Armoured Brigade, 7th Armoured Division, 1944-1945.
 1944-1945年之英军第7装甲师, 第22装甲旅, 第3皇家坦克团属下车辆。



Camouflage Scheme: Overall Olive Drab
 全车涂橄榄绿色

DECAL & COLOUR GUIDE 水贴及涂色指示:

★ Option5:
 1st Royal Tank Regiment, 22nd Armoured Brigade, 7th Armoured Division, 1945.
 1945年之英军第7装甲师，第22装甲旅，第一皇家坦克团属下车辆。



Camouflage Scheme: Overall Olive Drab
 全车涂橄榄绿色

Special thanks to
Mr. Frantisek Koran (WWP)
Mr. Phil Greenwood
for their info assistance

SPECIAL REFERENCE BOOK INTRODUCTION
特别相关资料书介绍

