

# Panzerkampfwagen I Ausf. F (VK18.01)

德军1号轻坦克 F型 (VK18.01) 1/35 SCALE

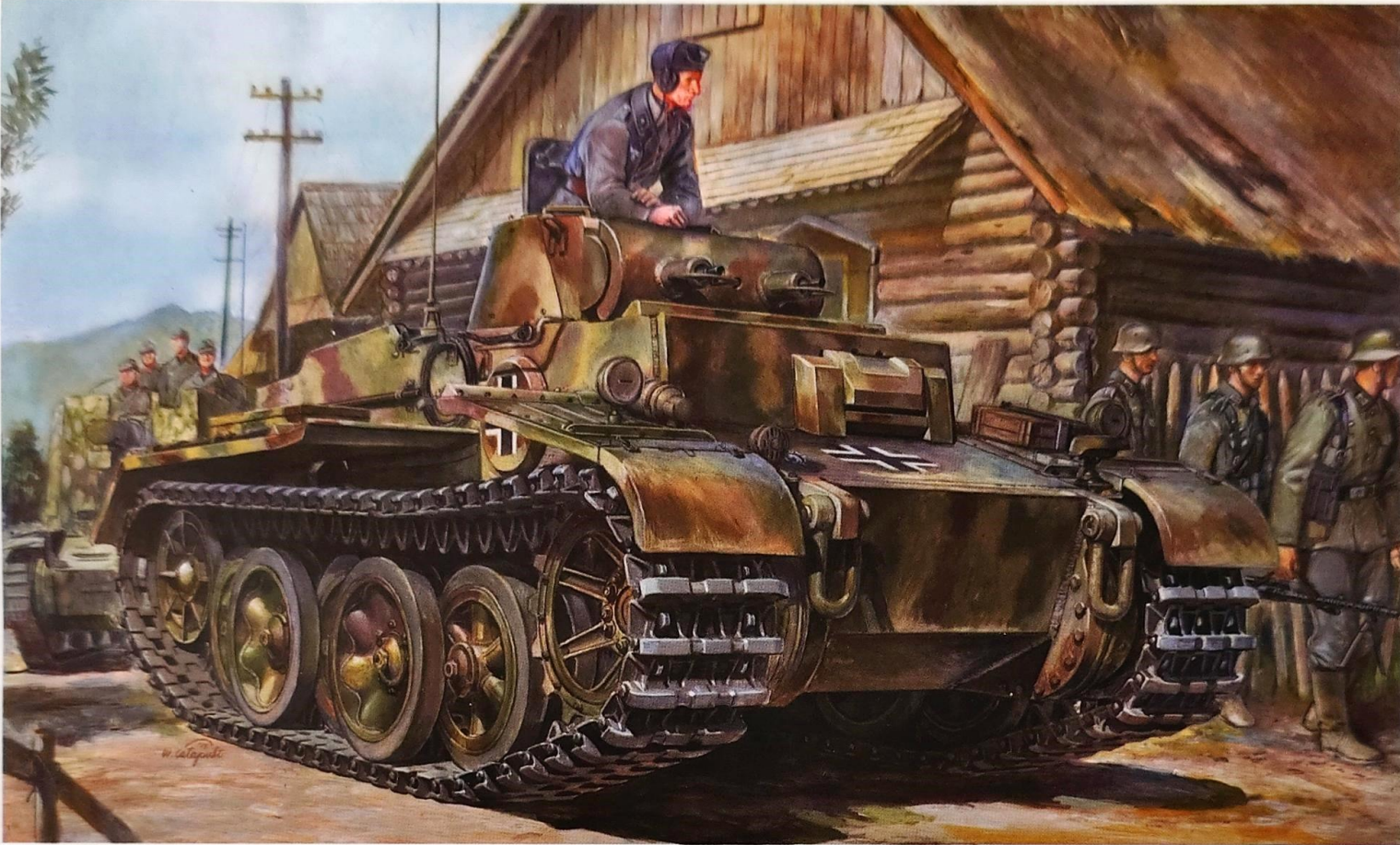

The Panzerkampfwagen I was a light tank developed in Germany during the 1930's. It was designed primarily for reconnaissance and was armed only with light machine guns. It was mass produced by several German manufacturers and was exported to several friendly nations prior to WWII. The Panzerkampfwagen I Ausf F was the last of the series and was built as an infantry support tank with armor increased to a maximum of 80mm. This increased the weight from 5.5 tons to over 20 tons resulting in entirely new suspension, tracks and drive train. Powered by a 150 bhp Maybach Otto engine, the Ausf F attained a maximum road speed of only 24km/h. As with earlier models it was armed with 2 x 7.92mm MG-34 machine guns. The first production order was for 30 tanks, which was completed in 1940, a second order for 100 tanks was canceled. Eight tanks were issued to the 1st Panzer Division in 1943, and used in the battle for Kursk. But the remainder were passed to various training establishments. The design was limited by its small size and 2-man crew, driver and commander/gunner, also by its limited tactical mobility.



Short story by Phil Greenwood

Der Panzerkampfwagen I war ein in den 1930ern in Deutschland entwickelter leichter Panzer. Mit seinen zwei MGs war er in erster Linie zur Aufklärung gedacht. Die Massenherstellung erfolgte in mehreren Werken. Vor Kriegsausbruch lieferte man das Fahrzeug auch an einige befreundete Länder. Die Ausführung F war die letzte der Reihe, konzipiert als Infanteriepanzer mit einer maximalen Panzerung von 80mm. Dadurch erhöhte sich das Gewicht von 5,5 auf über 20 Tonnen, was komplett neue Komponenten bezüglich Aufhängung, Ketten und Antriebsstrang erforderte. Mit dem 150 PS Maybach Ottomotor erreichte die Ausführung F eine Höchstgeschwindigkeit von nur 24 km/h. Sie war wie die Vorläufer mit zwei 7,92mm MG 34 bewaffnet. Die Erstorder bestand aus 30 Stück, welche bis 1940 geliefert wurden. Eine weitere Bestellung über weitere 100 wurde gestrichen. Acht Panzer gingen 1943 an die 1. Panzer Division und in die Schlacht von Kursk. Die übrigen verteilte man an verschiedene Fahrschulen. Die Entwicklung war aufgrund der Größe und der zweiköpfigen Besatzung zu begrenzt, um den gestiegenen taktischen Anforderungen gerecht zu werden.



© Translation Michael Knoblich ACADEMY EUROPE

1号坦克是在 20 世纪 30 年代期间德国所研发的一种轻型坦克系列。由于它主要用于侦察所以只配备机枪。它被几家德国制造商大量生产及出口到在第二次世界大战前的几个友好国家。1号 F 坦克是系列中的最后一款，被修改作为步兵支援坦克，该车装甲增加到最大 80 毫米，由于重量从 5.5 吨增加了到 20 吨以上所以必须使用全新的悬架、履带和传动系统。动力由 150 pbh 迈巴赫奥托发动机提供，F 型坦克仅得 24 km/h 的最高车速。由于是早期型号，它只被装上 2 挺 7.92 毫米 MG 34 机枪。第一轮生产的订单只有 30 辆而完成于 1940 年。但第二轮 100 辆坦克的订单却被取消。在 1943 年有八辆该坦克被发配给第 1 装甲师在库尔斯克战役中所用。但剩下的则被转移给各个培训单位。其设计由于过于狭小车内只能容纳两名车员，其必须分担驾驶、指挥及作射手的工作，因此战术运用及机动性受到局限。



# ILLUSTRATION 图示说明:

## CORRECT METHOD FOR APPLYING DECALS : HINWEISE ZUM ANBRINGEN DER DECALS : 正确使用水贴纸的方法:

1. Clean model parts surface with wet cloth. Entsprechende Stellen am Modell feucht reinigen.  
将需要贴水贴纸之部位表面擦干净。
2. Cut out the decal parts and dip them in cold water for 15 ~20 seconds. Decal ausschneiden und für 15-20 Sek. ins Wasser legen.  
将所需之贴纸剪下泡在清水里约15至20秒。
3. Place it on correct position of the model kit. Decal an der richtigen Stelle auflegen.  
将湿透之贴纸取出置放于正确之位置旁。
4. Slide off the decal from the base paper on to the model kit surface with a cotton stick. Decal mit Wattestäbchen festhalten und Papier darunter wegziehen.  
用棉花棒轻推贴纸表面使其从底纸滑出至模型表面之正确位置。
5. When decal get dry then complete. Decal mit Papiertuch andrücken und trocknen.  
待其自然干透后即完成。

## ICON INSTRUCTION: 图标说明:



Open Hole  
Loch bohren  
钻孔



Remove  
Abtrennen  
切除



2 Sets needed  
Vorgang wiederholen  
同样的制作二组



Bend  
Biegen  
曲折



Optional  
Auswahl  
可以选择采用



Apply Decal  
Decal anbringen  
贴上水贴纸



Instant Glue For Metal  
Sekundenkleber verwenden  
瞬间接着剂,金属用



Fill Hole  
Verspachteln  
把孔填平



Do not cement  
Nicht kleben  
不用粘合

Color 涂料表	MR. Hobby	Hobby Color	Humbrol	Tamiya
German gray Deutsches Grau 德国灰	H-32	C-40	92	XF-63
Sand 沙黄色	H-78	C-38	66	XF-62
Dark green Dunkelgrün 暗绿色	H-36	C-17	30	XF-61
Red brown Rotbraun 红棕色	H-47	C-41	/	XF-64
Clear red Klar-Rot 透明红	/	/	/	X-27
Clear blue 透明蓝	/	/	/	X-23
Tyre black Reifenschwarz 轮胎黑	H-77	C-137	85	/

## READ BEFORE ASSEMBLING: VOR ZUSAMMENBAU LESEN: 组装必读:

- Carefully Study instruction before assembling. Anleitung studieren und verständlich machen. 组装前请阅读清楚制作指引。
- Keep plastic model glue and tools away from children. Kleber, Farben, Werkzeuge und Plastiktüten von Kindern fernhalten. 胶水,油漆及工具勿让小孩接触。
- Do not use cement or paint near open flame or sparks. Kleber/Farbe nicht in Nähe von offenen Flammen. 胶水及油漆勿接触火种。
- Do not work in closed room. Nur in ausreichend belüfteten Räumen arbeiten. 勿在密封地方制作模型。

PARTS LIST 零件展示表:



**BRONCO**  
Bronco Models

Copyright © 2013  
Made in China  
中国制造



No use parts  
不要部件

ⓑ × 1

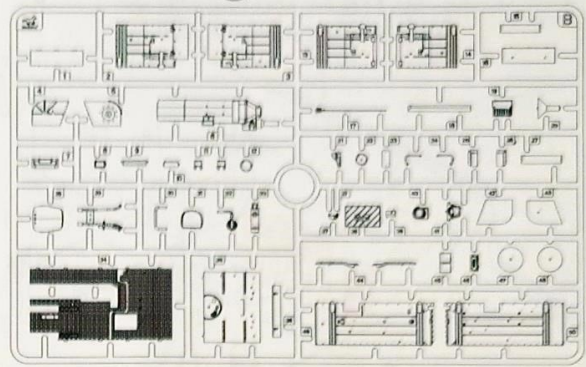

Ⓐ × 1

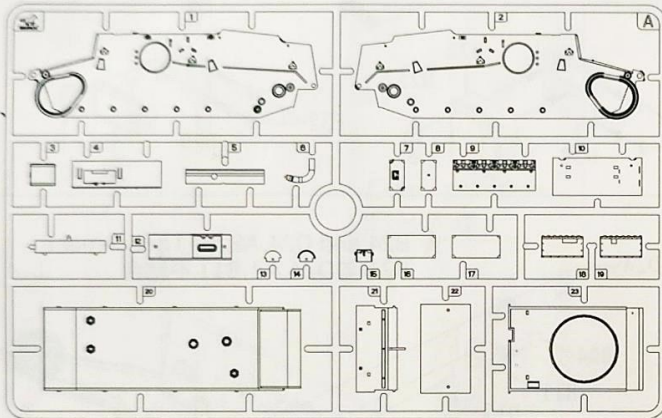

ⓒ × 1

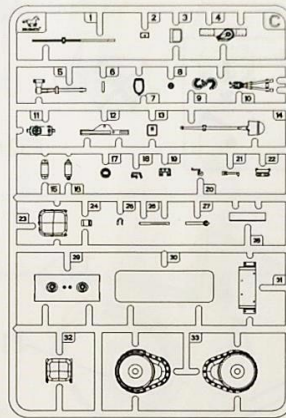

Ⓕ × 2

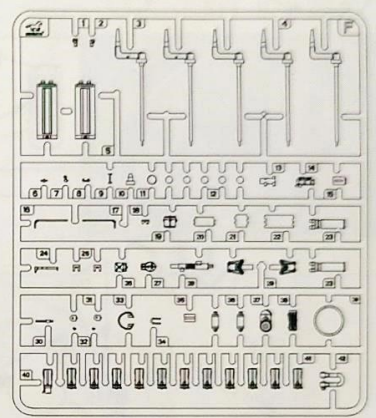

Ⓓ × 1

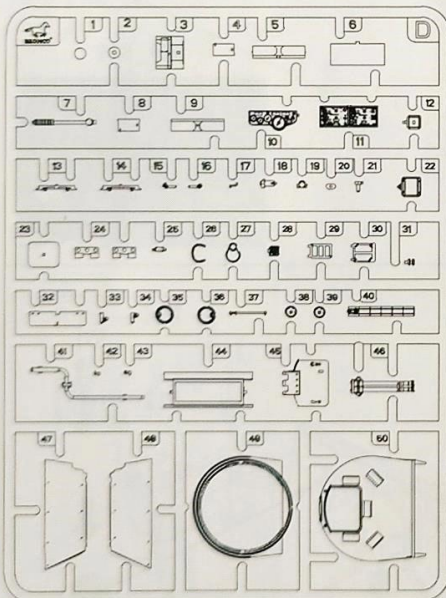

Ⓔ × 2

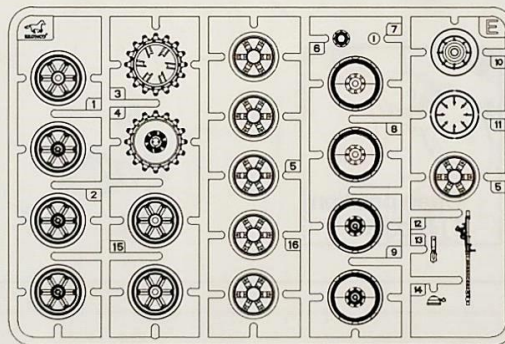

Ⓟ × 1

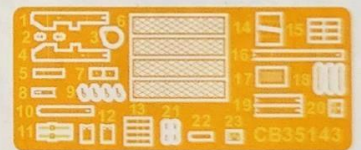

DECAL × 1

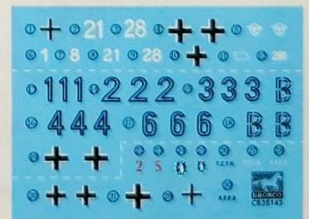

Ⓖ × 8

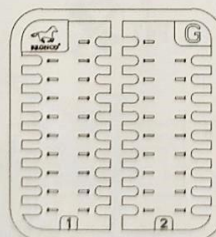

Ⓗ × 1

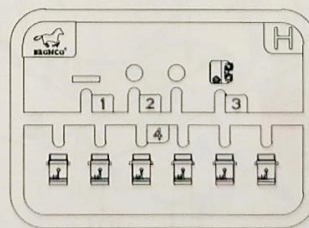

Ⓩ × 12



CB35143

# ILLUSTRATION 图示说明:

1

A

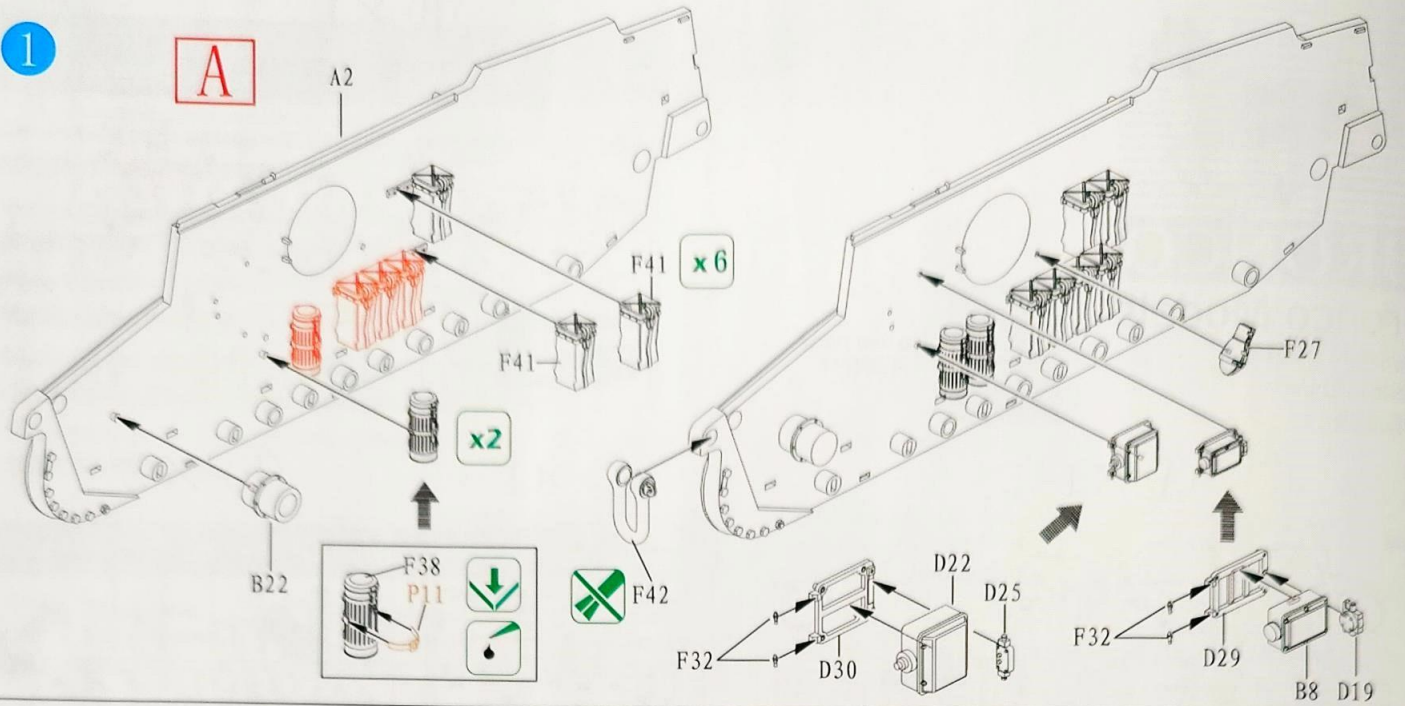

★ B24 and D24, A2, B11 not cement  
B24 与 D24, A2, B11 不粘合

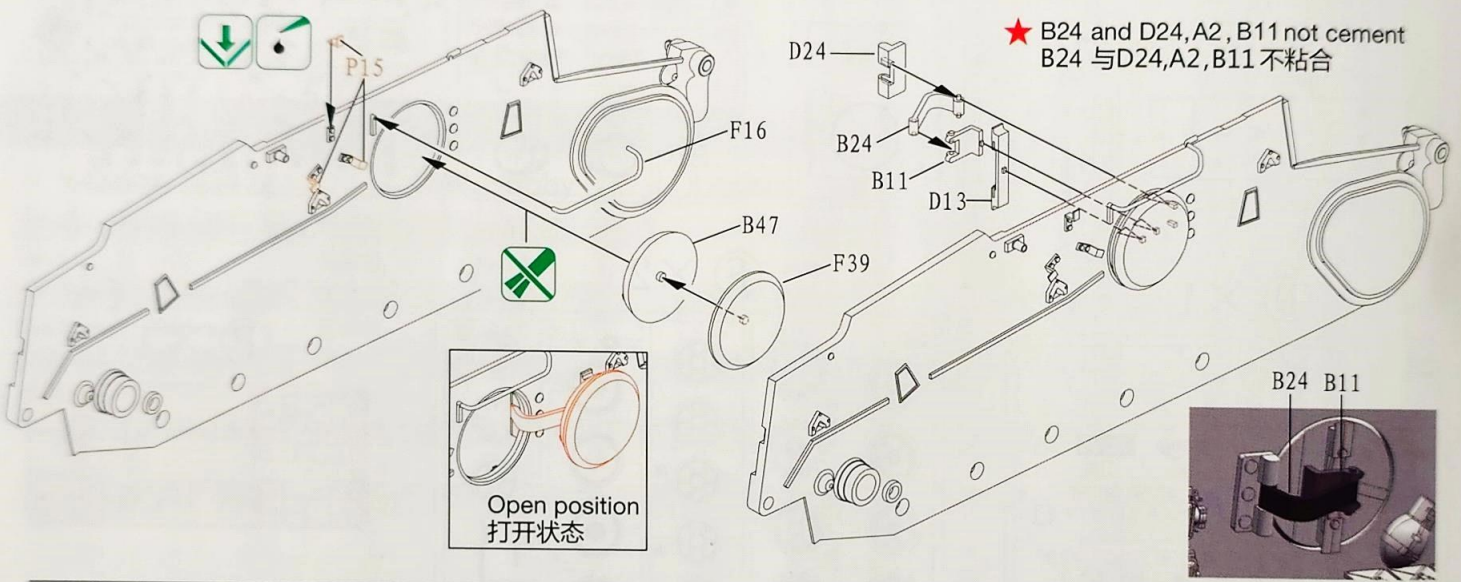

2

B

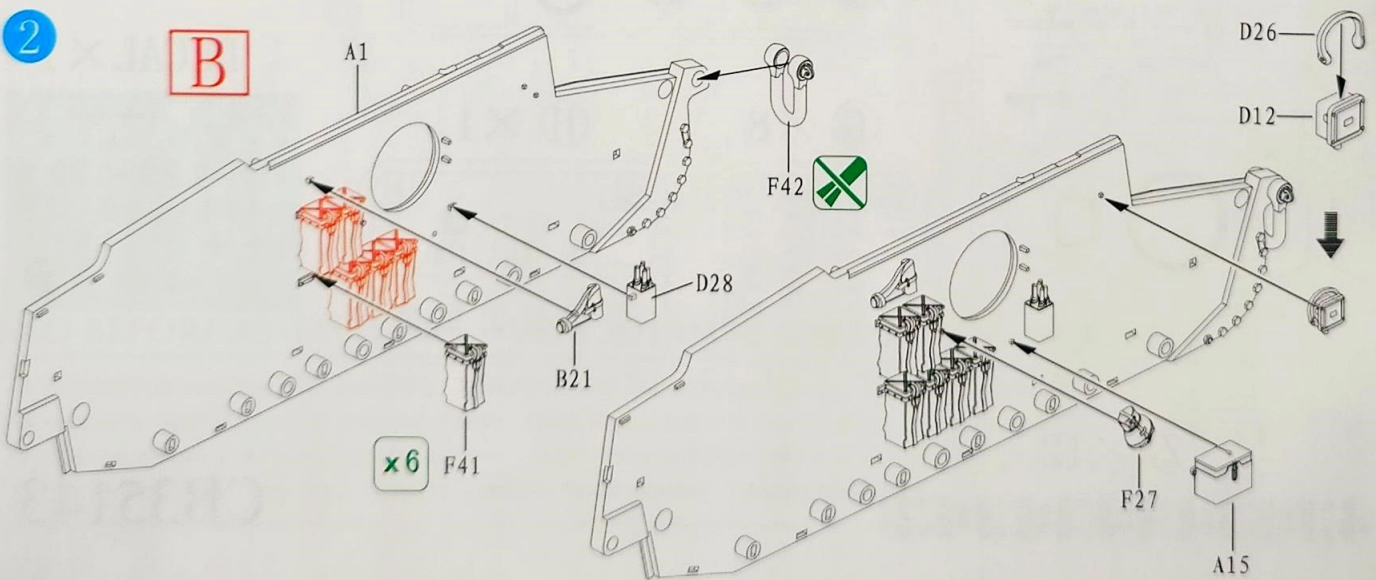

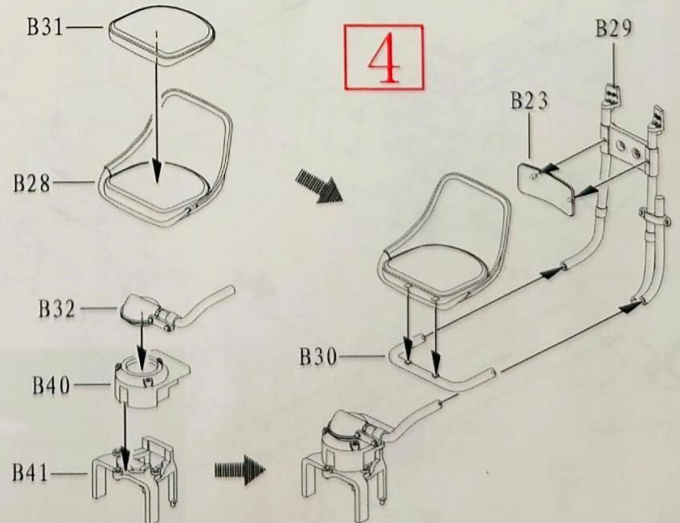
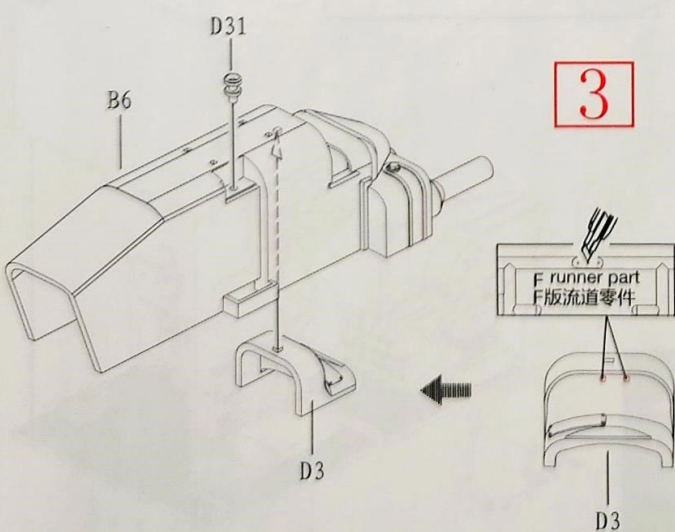
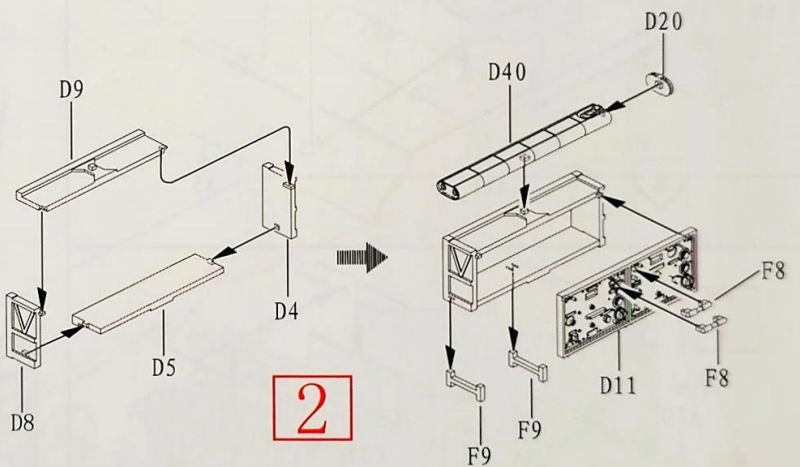
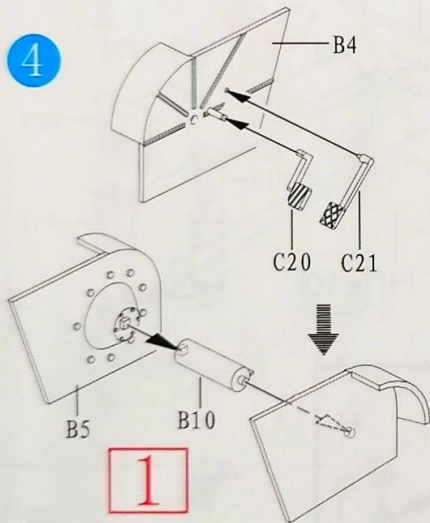
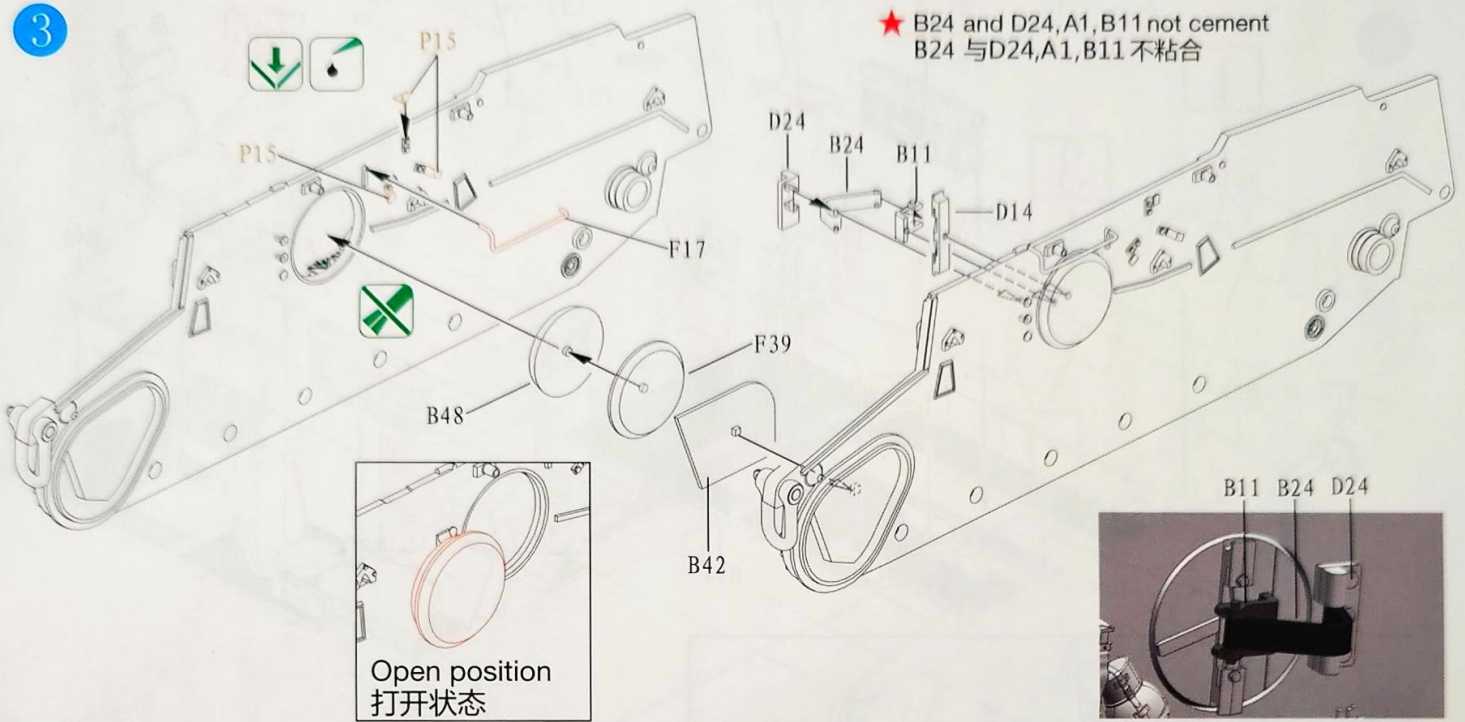

# ILLUSTRATION 图示说明:

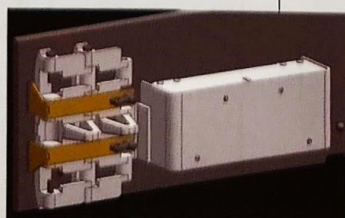
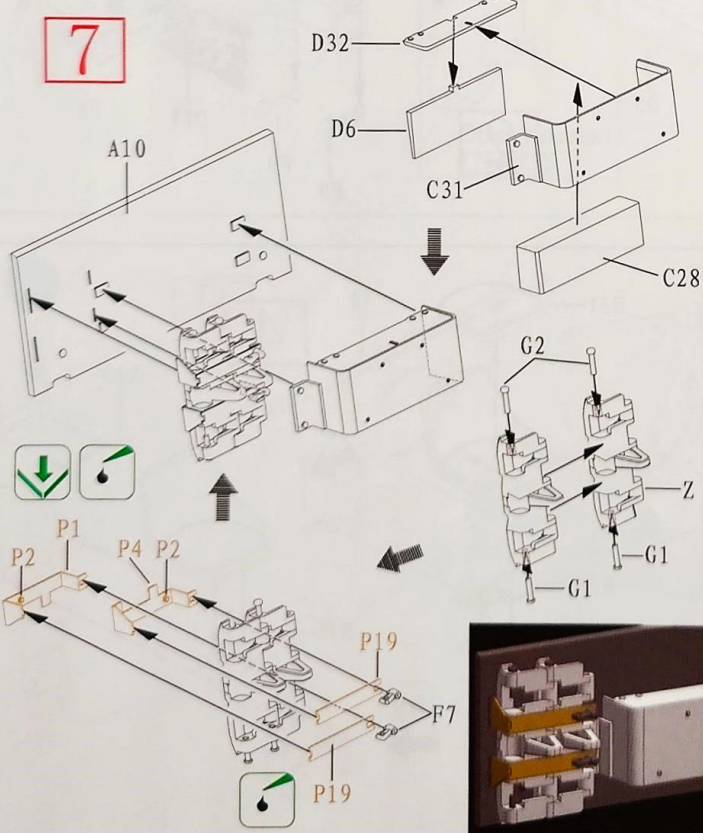
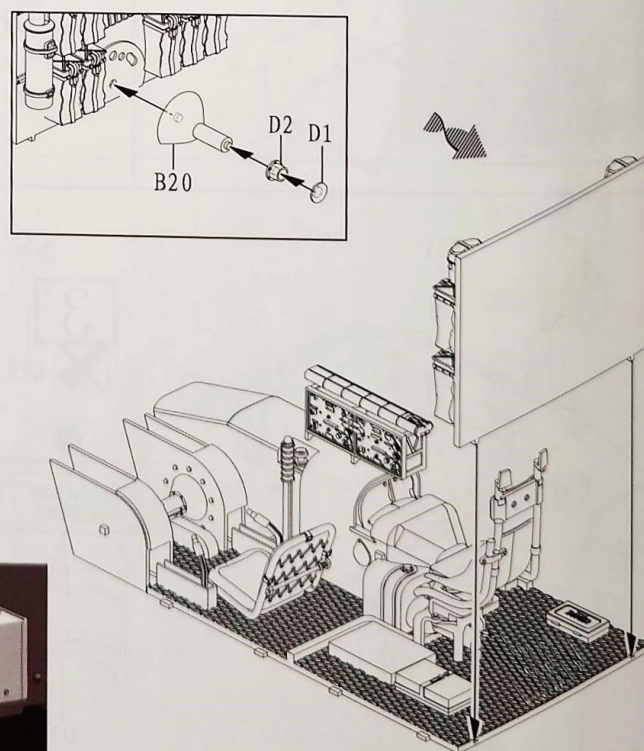
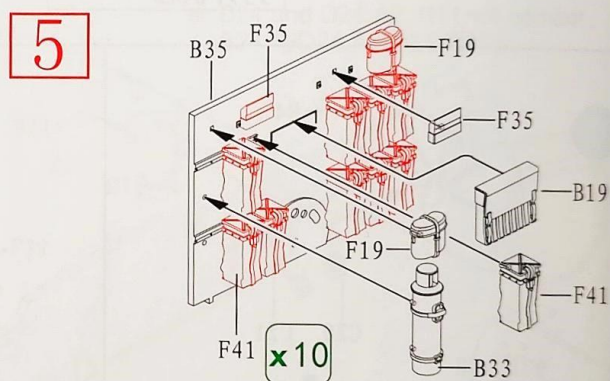
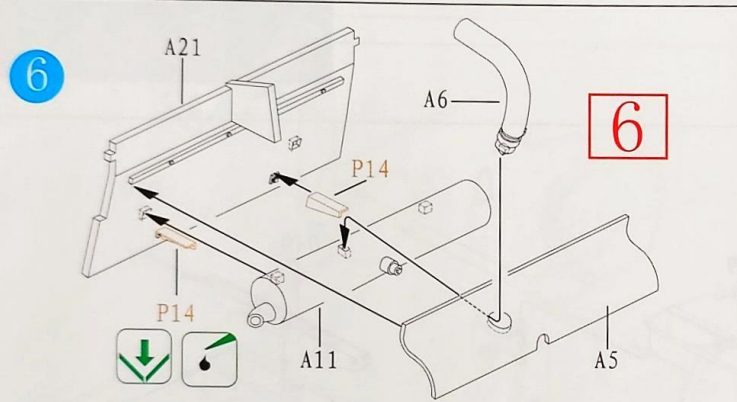
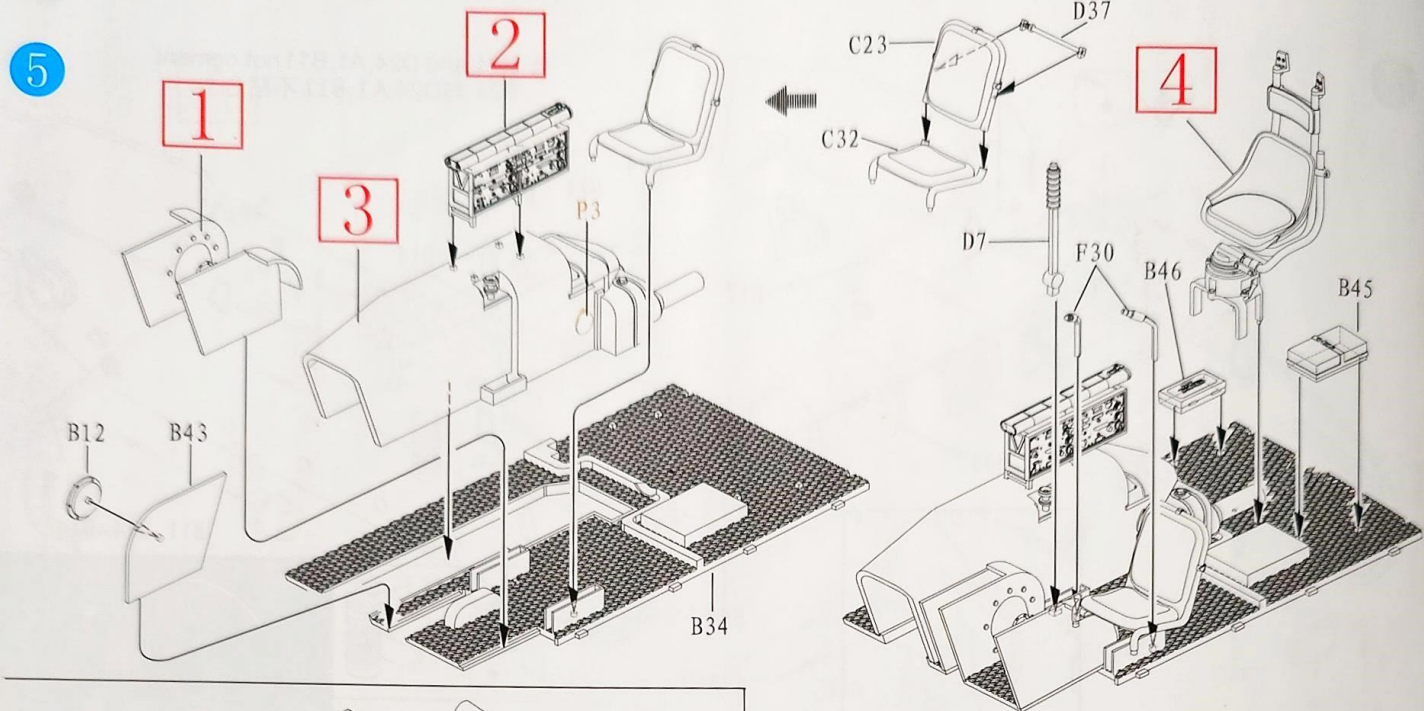

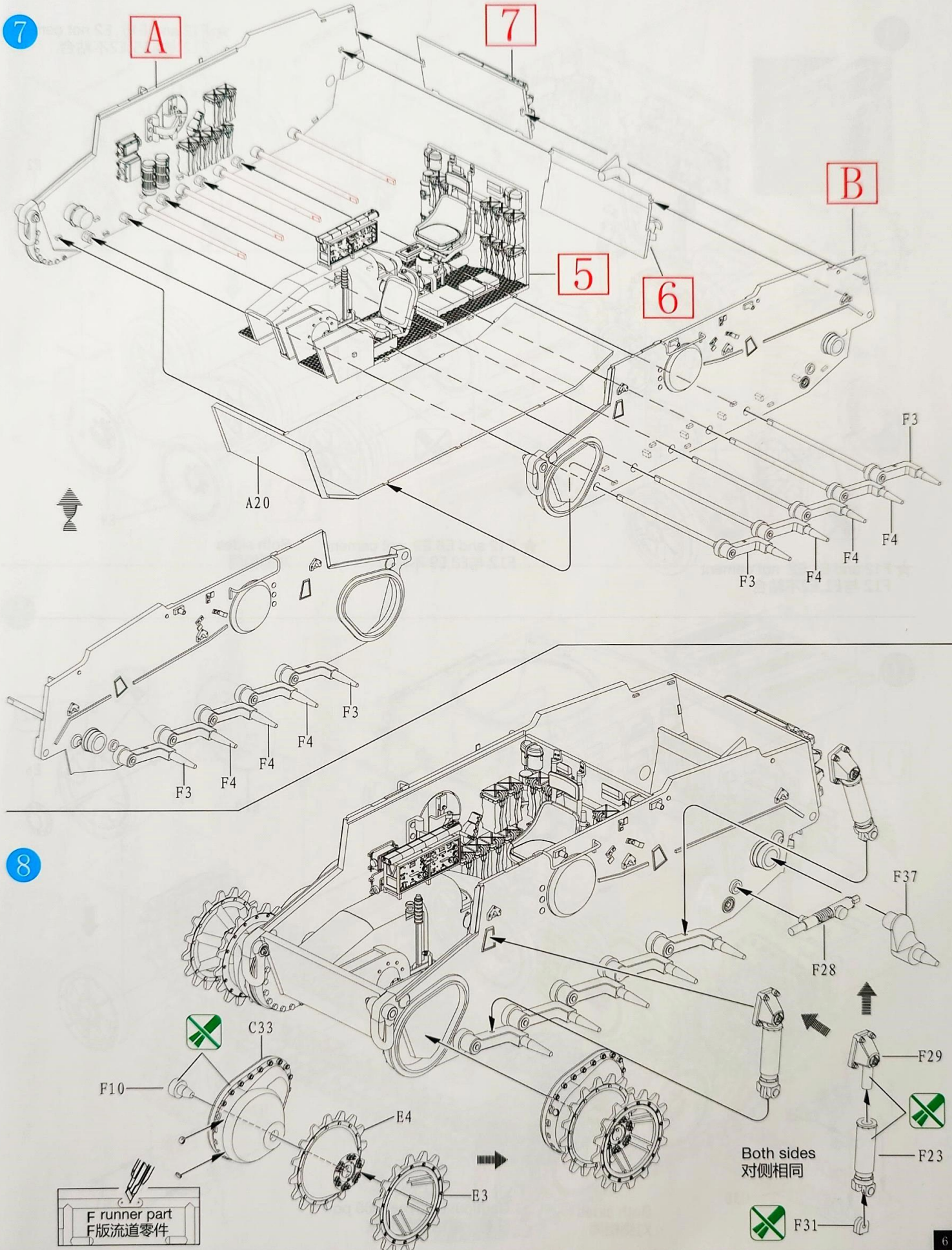
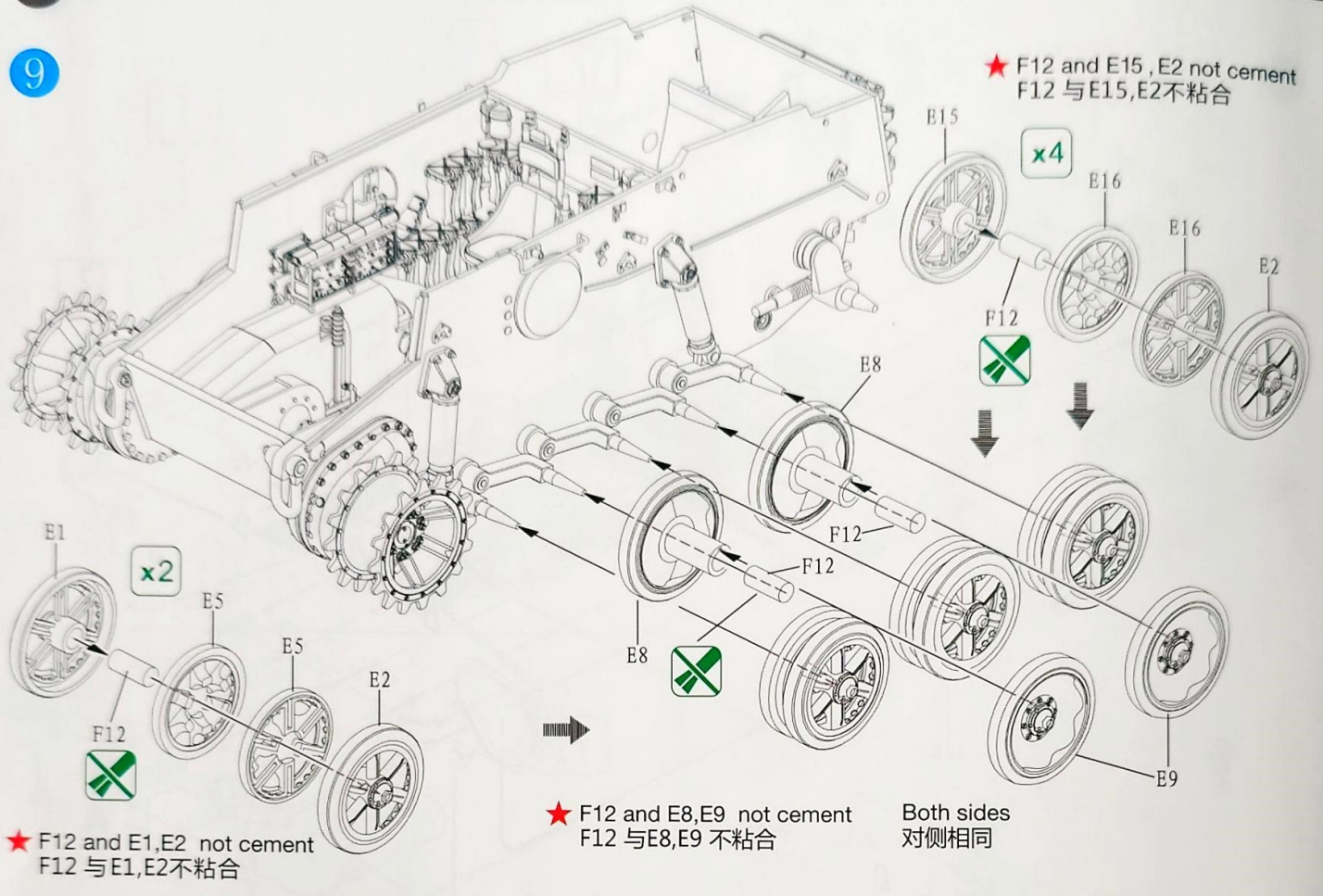
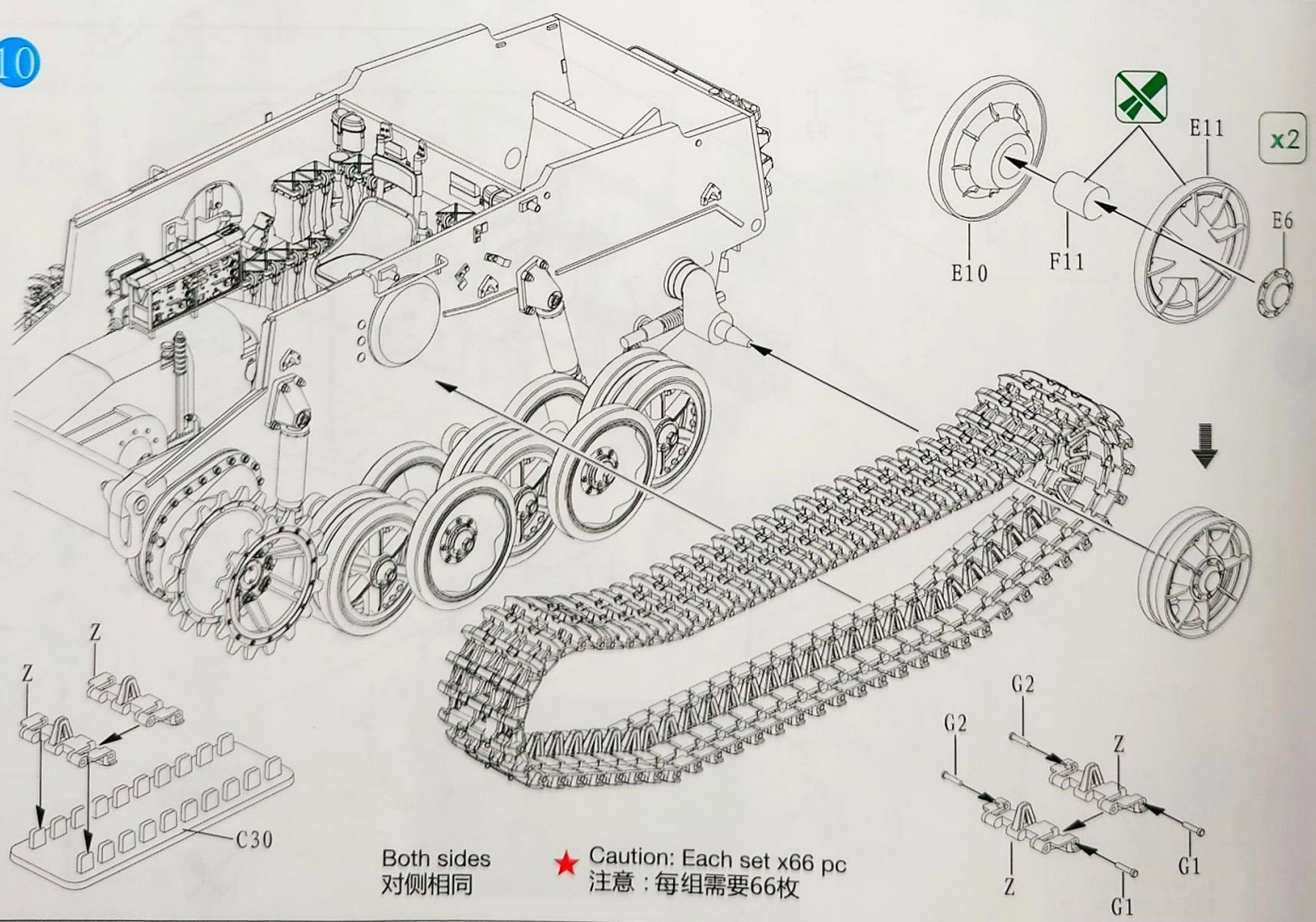

ILLUSTRATION 图示说明:

9



10





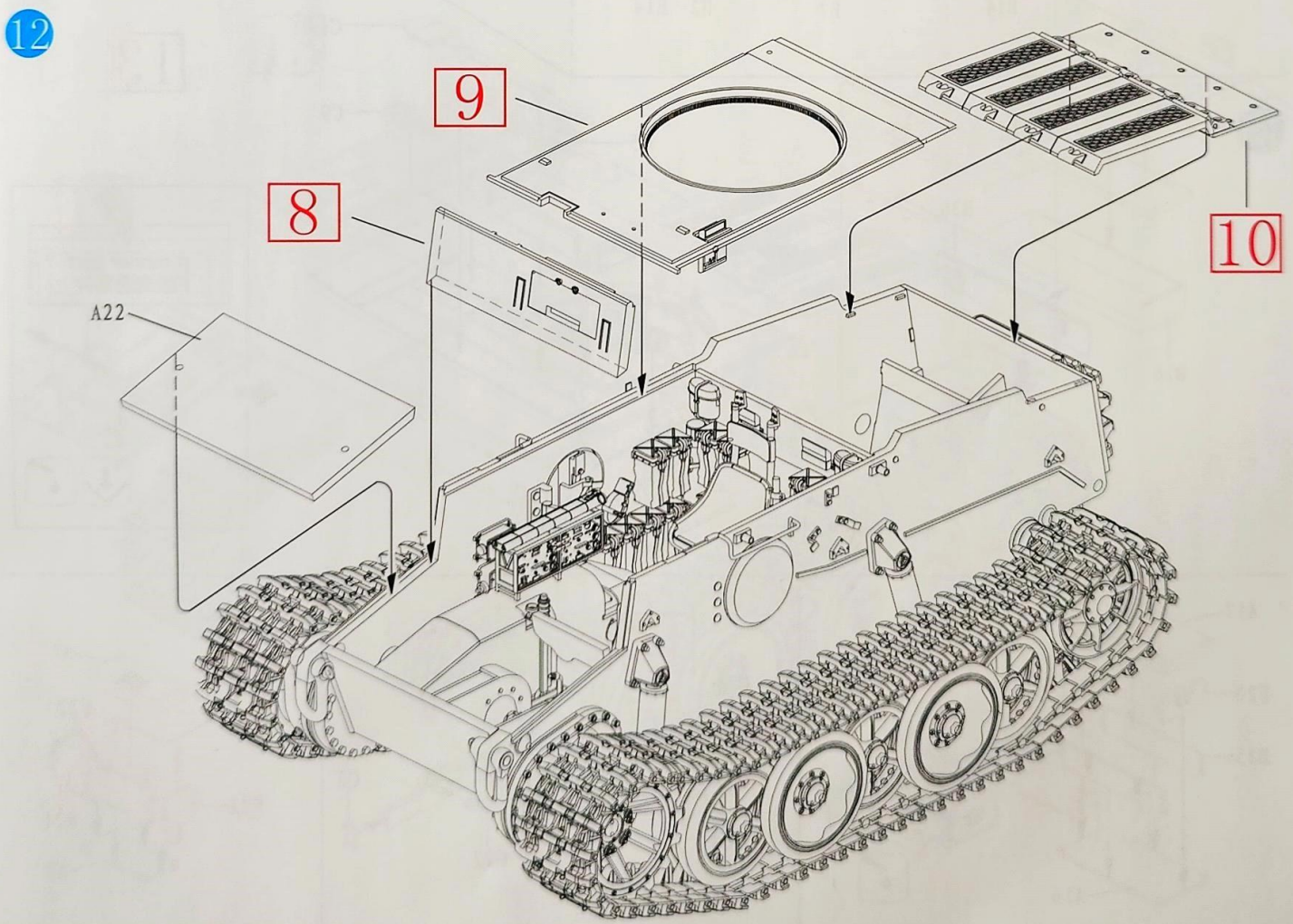
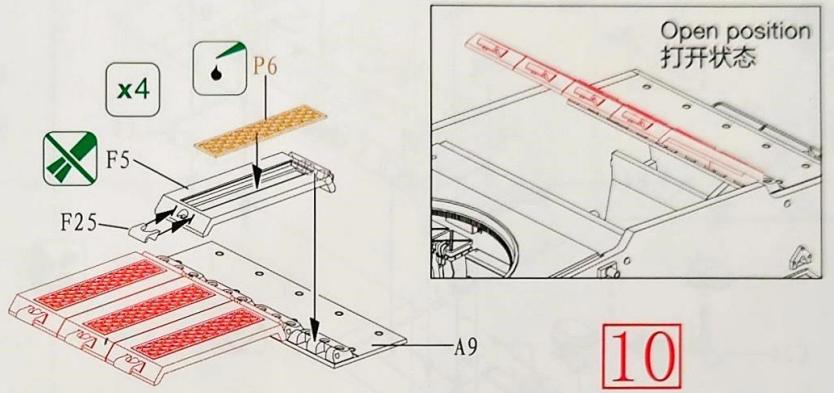
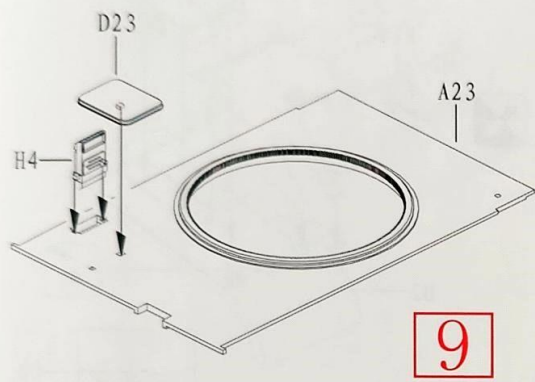
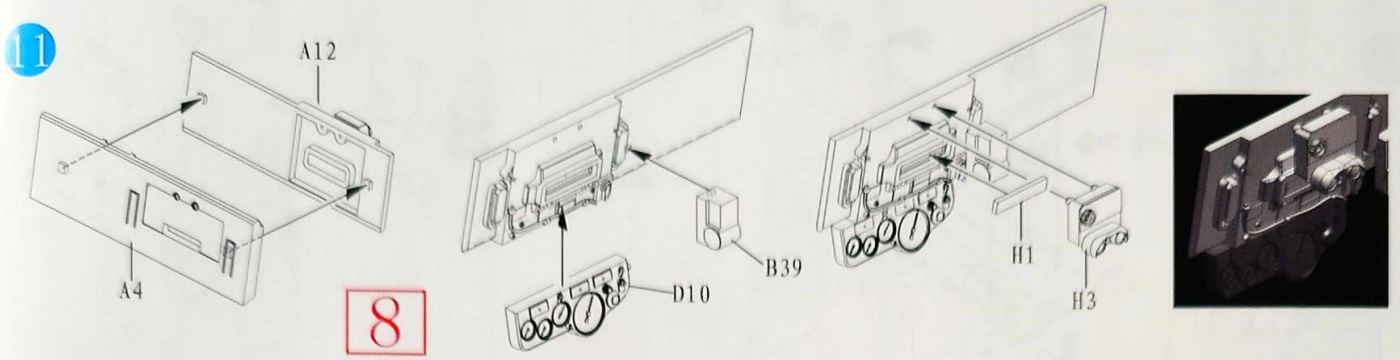

# ILLUSTRATION 图示说明:

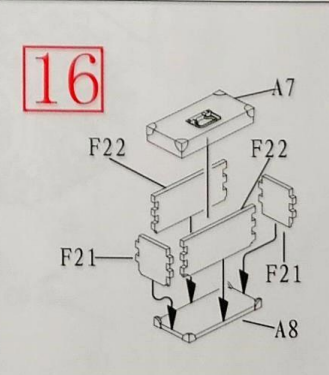
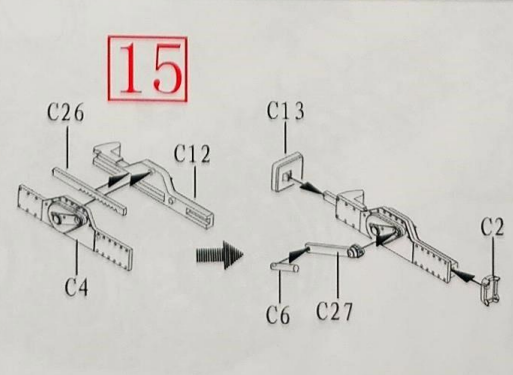
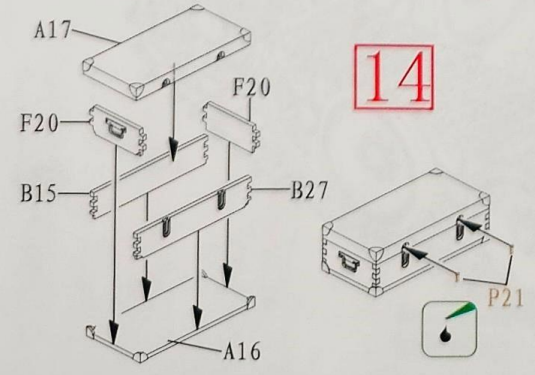
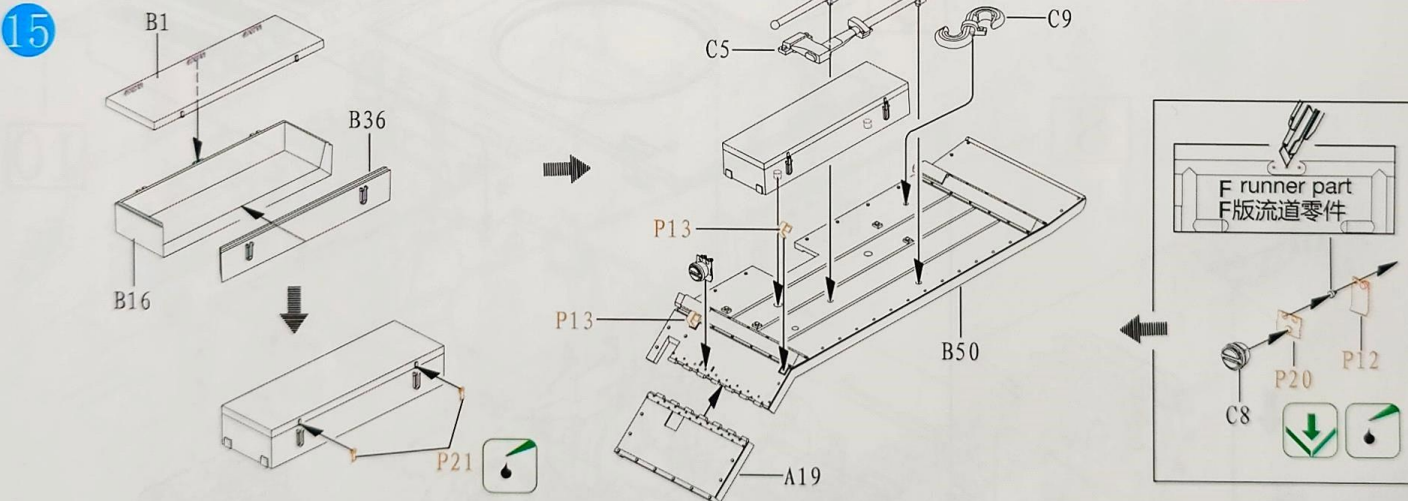
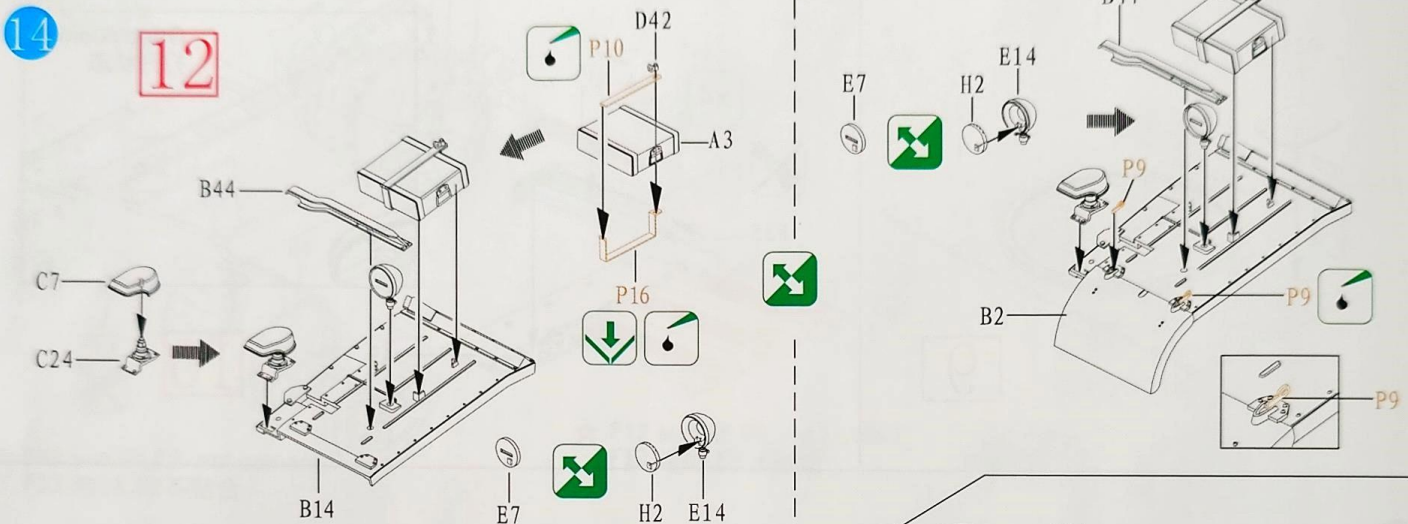
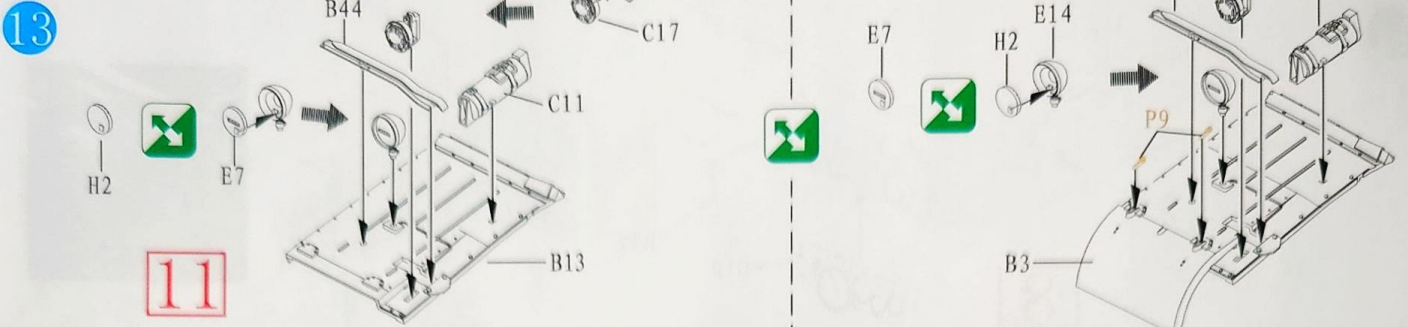
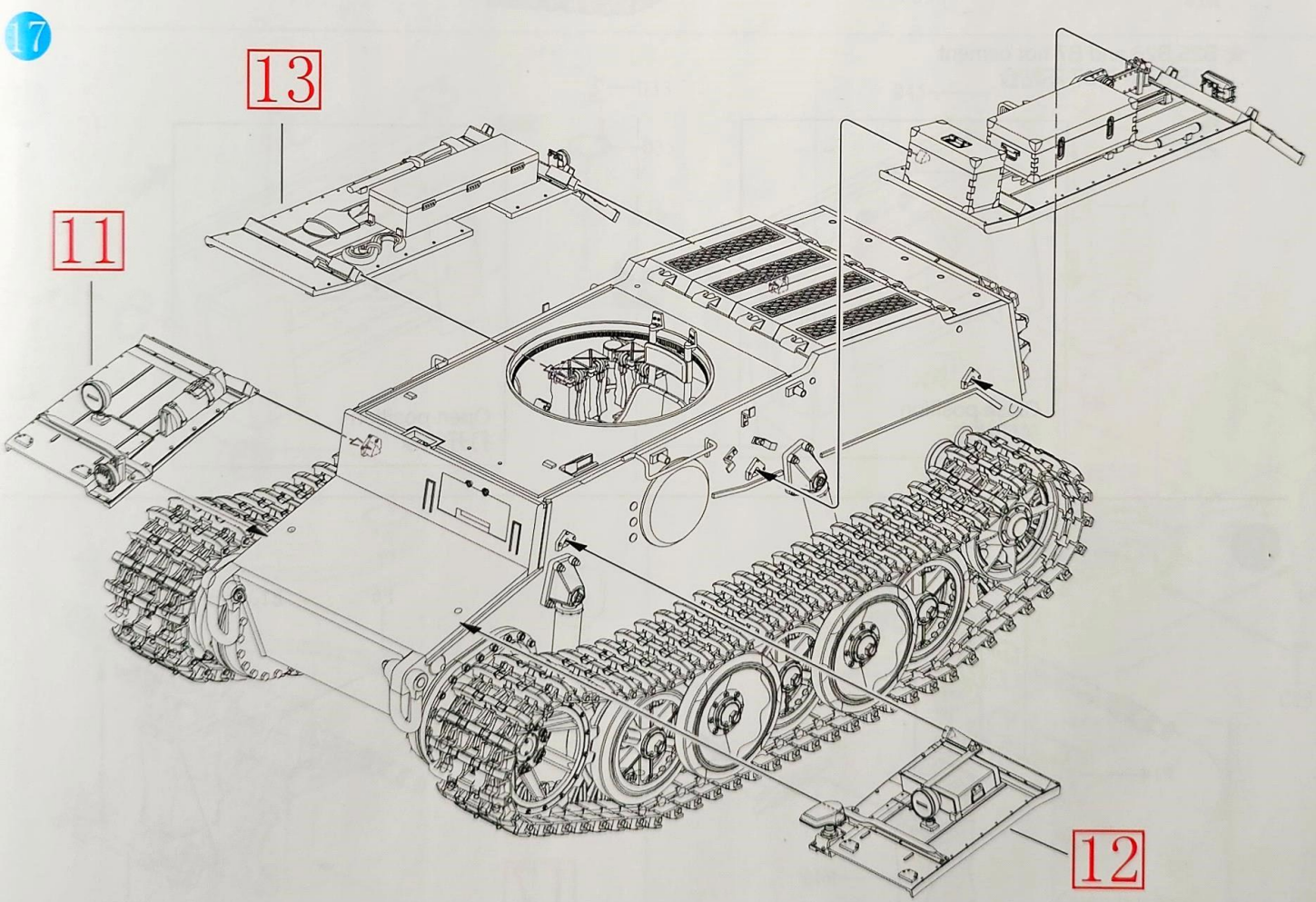
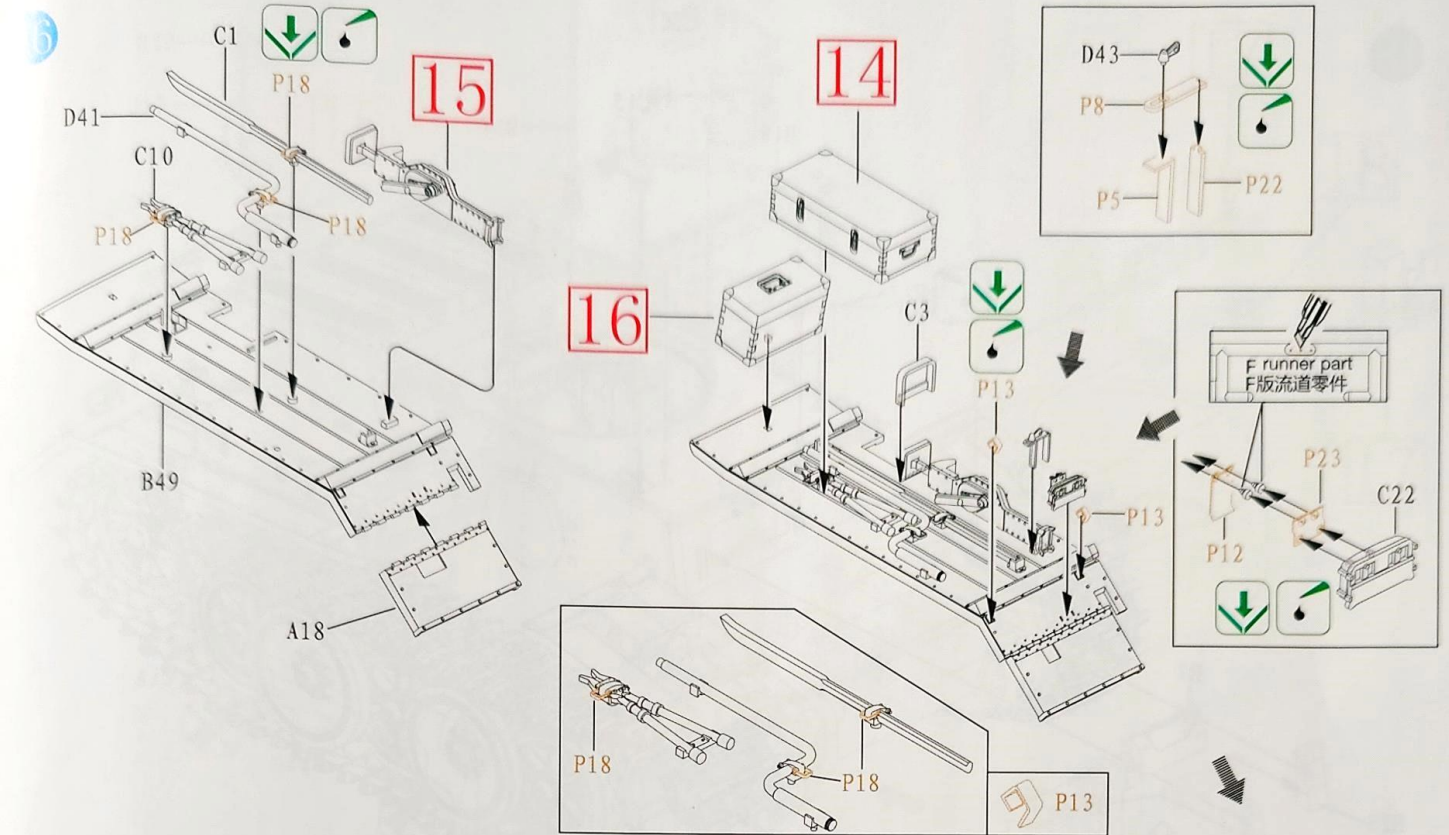
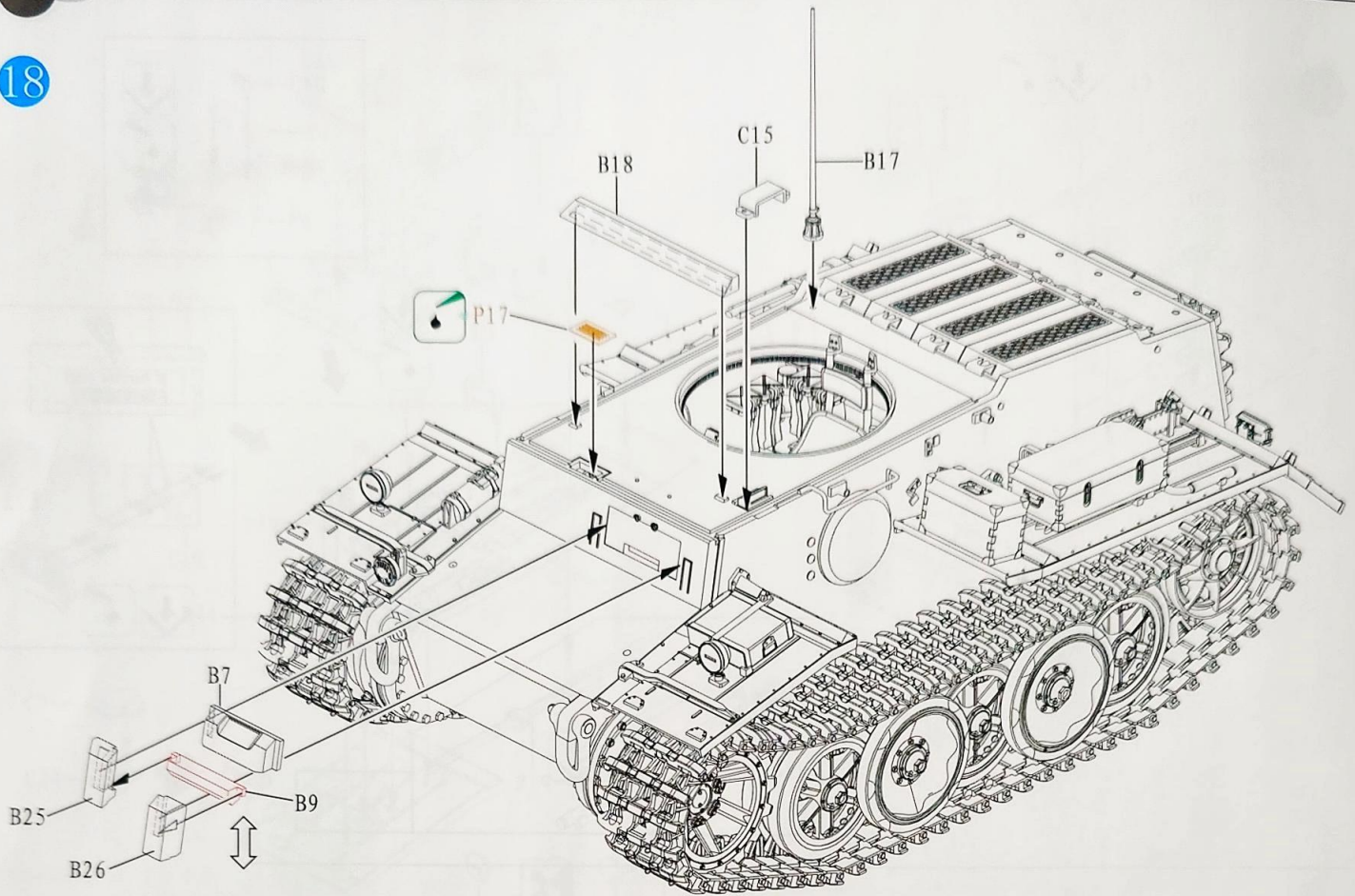

ILLUSTRATION 图示说明:



18



★ B25, B26 and B7 not cement  
B25, B26 与 B7 不粘合

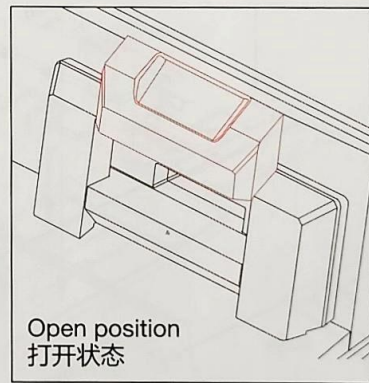
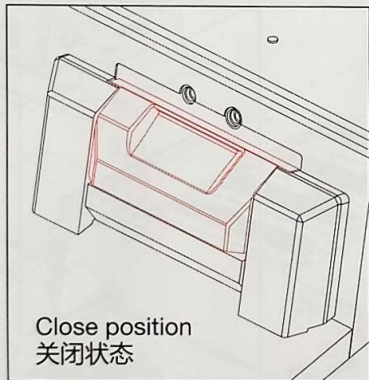

19

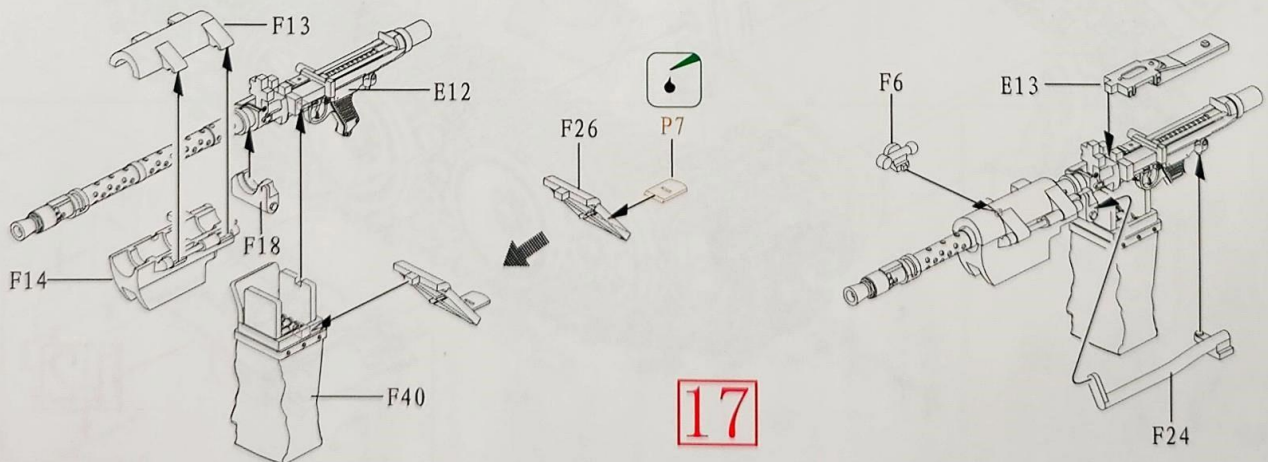

17

ILLUSTRATION 图示说明:

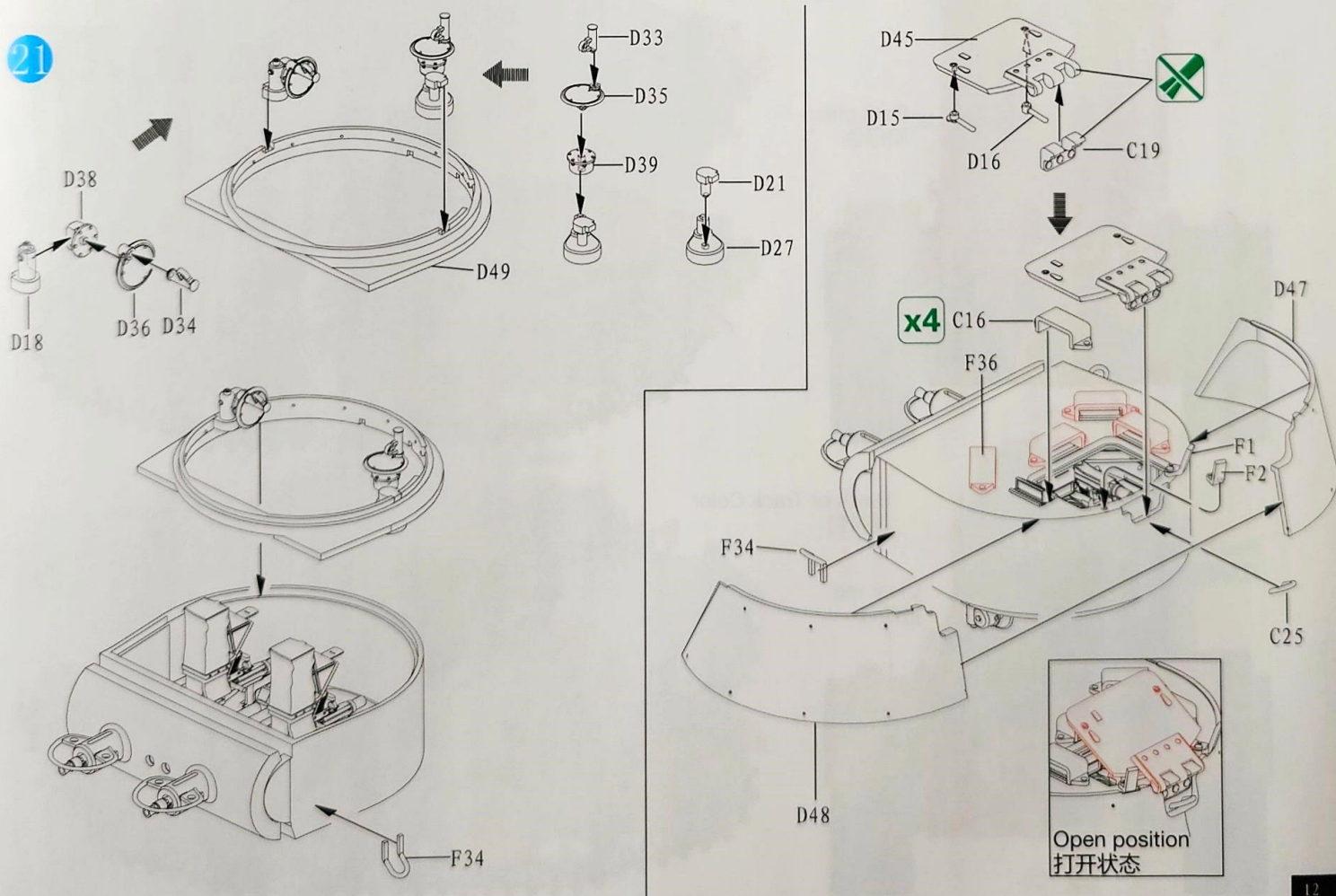
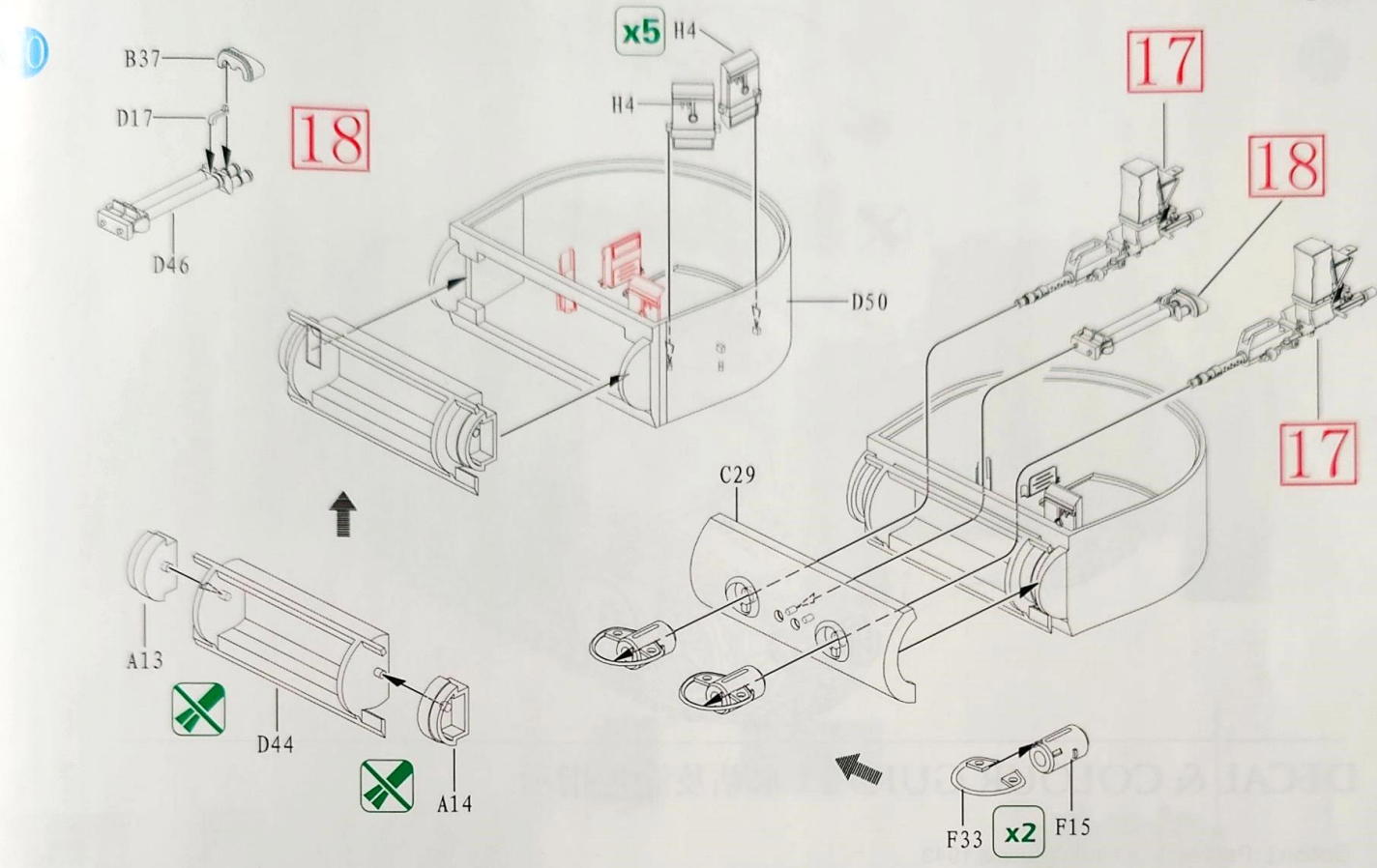
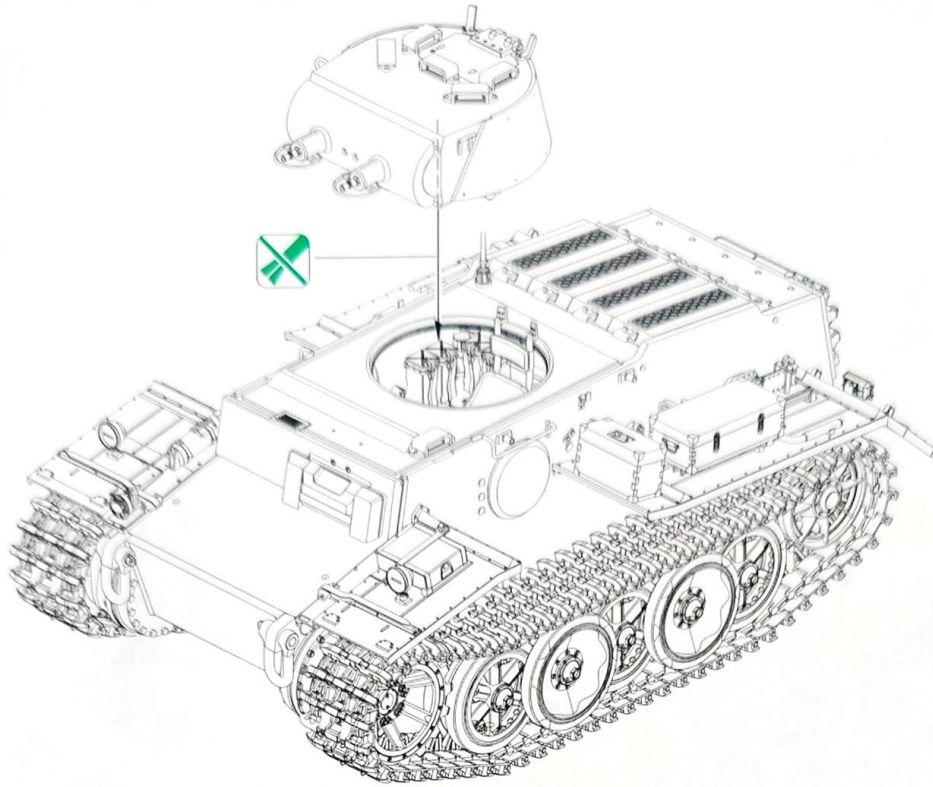

ILLUSTRATION 图示说明:

22



DECAL & COLOUR GUIDE 水贴及涂色指示:

Option 1: Panzer Regiment 1, Russia 1943  
1943年在俄罗斯作战之德军第一装甲团属下车辆

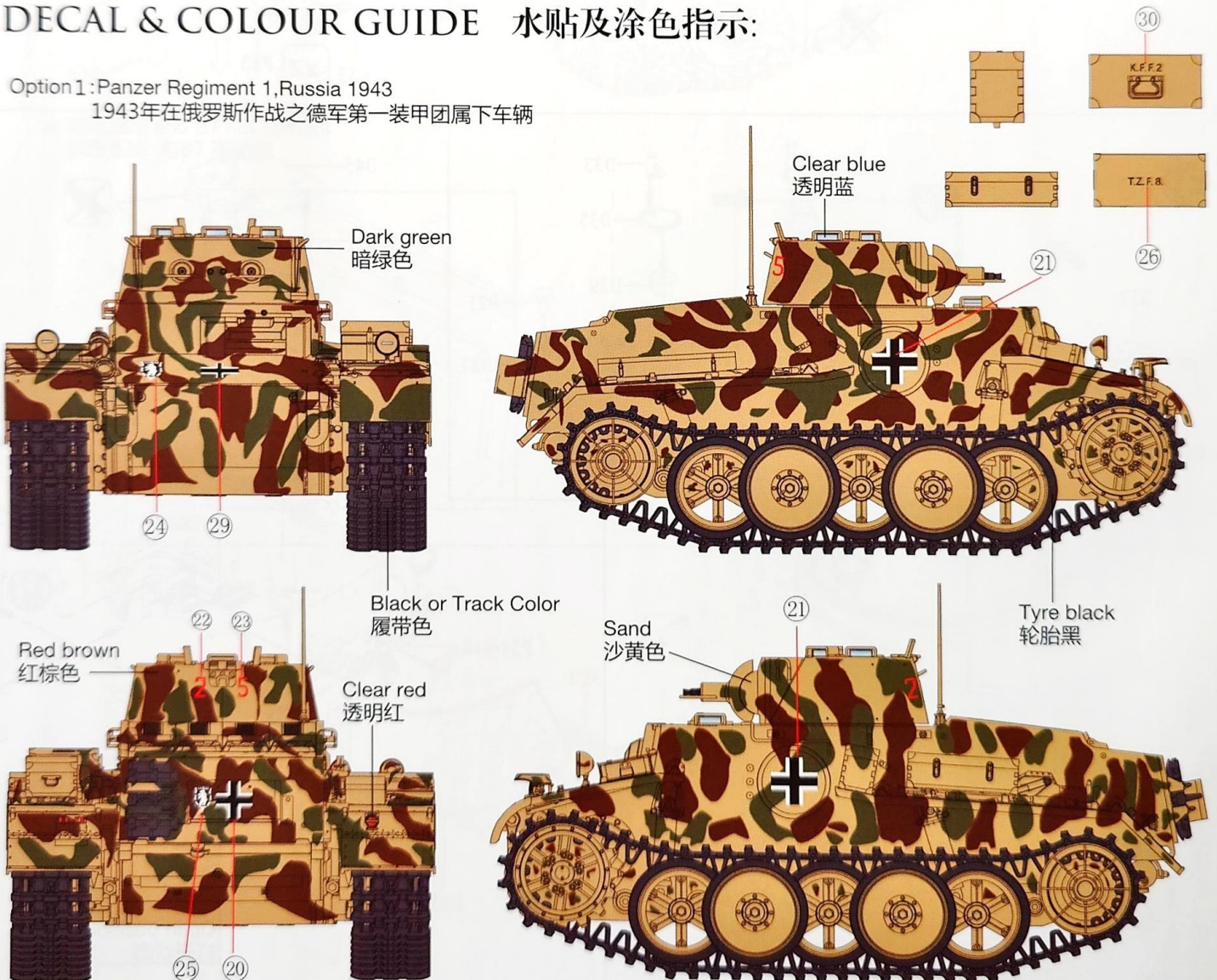

# DECAL & COLOUR GUIDE 水贴及涂色指示:

Option 2: Polizei-Panzer-Kompanie (neu) .Eastern Front, Spring 1944  
 1944年春天在东部战线作战之德军第二警察装甲连属下车辆

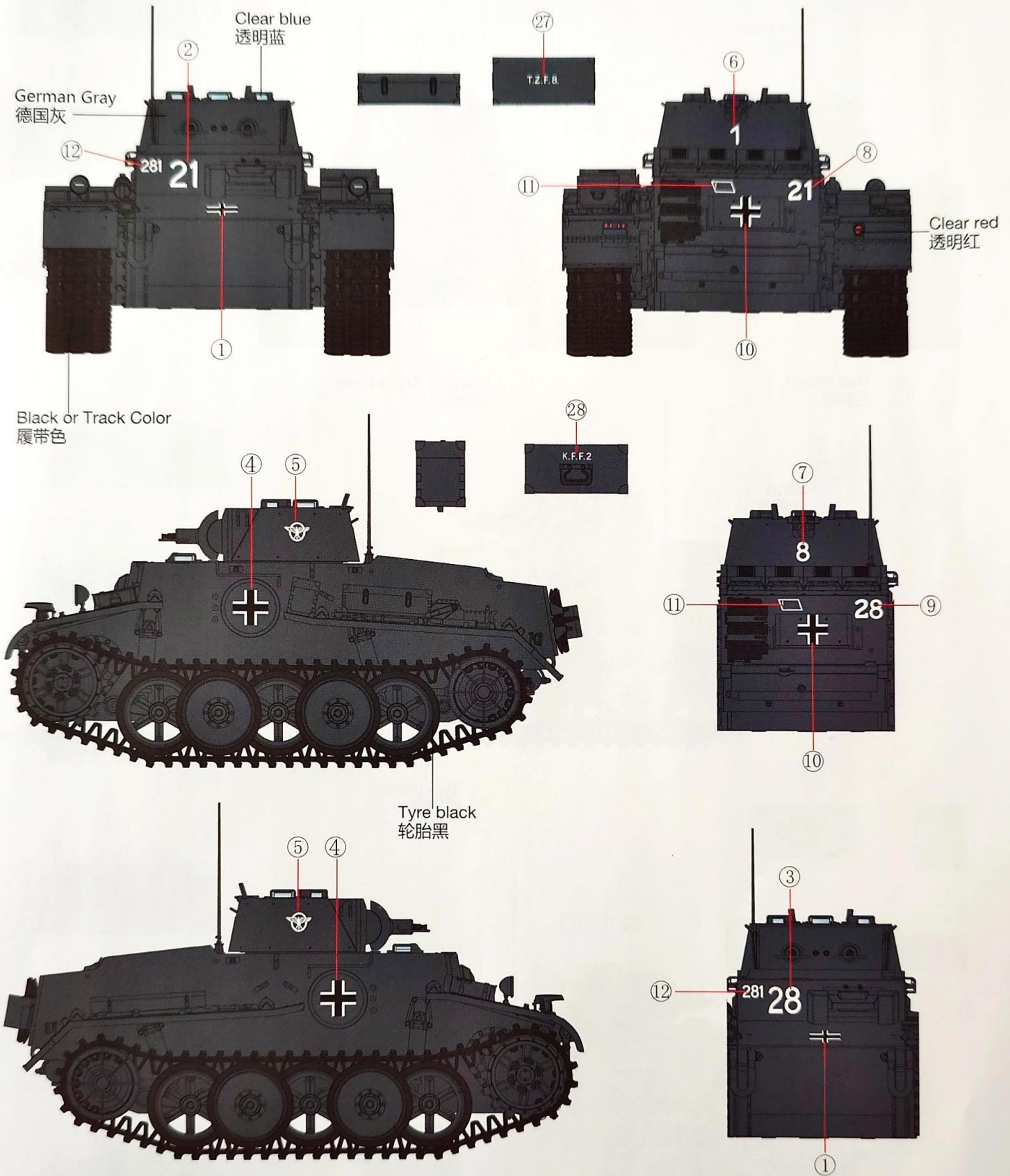

Canmouflage Scheme :German Gray  
全车涂德国灰

# DECAL & COLOUR GUIDE 水贴及涂色指示:

Option 3: Panzer-Abteilung z.b.V.66 Russia Fall 1942  
 1942年在俄罗斯作战之德军第66特殊装甲营属下车辆

