

# A-1E SKYRAIDER

## 1/72 Cockpit Detail set

CC 72005

General instructions: All of your new resin parts should be washed in warm water and a de-greasing detergent like Formula 409 or Fantastic. This will remove the mold release agent from the parts and allow your paint to stick properly. Remove parts from the sprues with a hobby knife or razor saw then lightly sand any remaining sprue. Do not breathe resin dust- use a dustmask. Use CA type (Superglue) to attach resin parts.

This cockpit set reproduces a typical early A-1E as used in

Viet Nam. Extensive photographs were taken of the A-1E Skyraider on display at the U.S. Air Force Museum in Dayton, Ohio.

Your new Cockpit is a direct replacement for all the kit supplied components.

1. Remove edge extensions from both fuselage sides.
2. Cut away the kit instrument panel coming. A new resin one is supplied. Do not remove any of the actual fuselage.

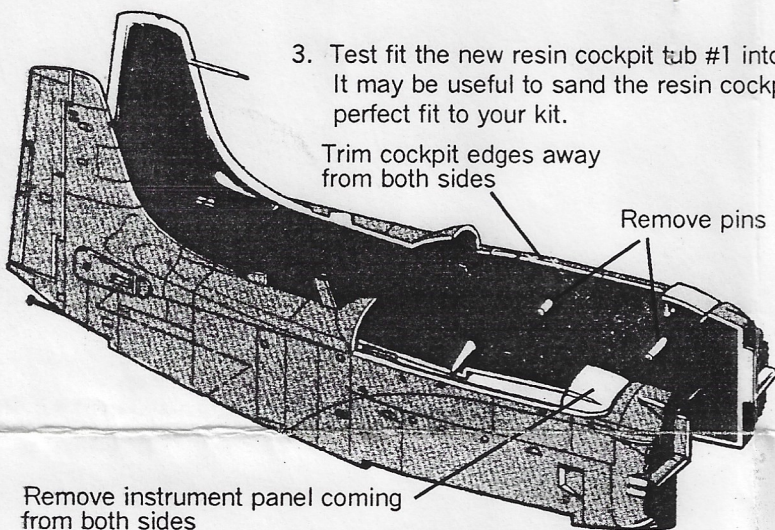

3. Test fit the new resin cockpit tub #1 into the fuselage. It may be useful to sand the resin cockpit tub walls for a more perfect fit to your kit.

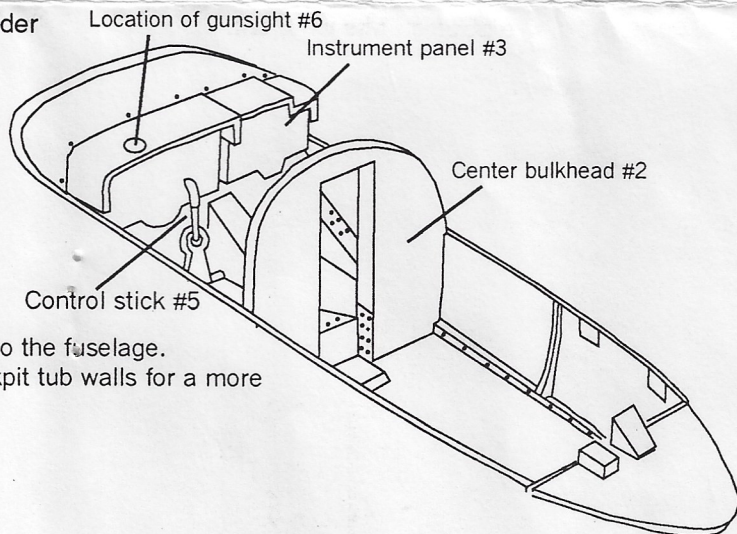

4. To finish cockpit assembly - install cockpit/cabin bulkhead #2 into slot in tub (detail faces forward). Install control sticks #5 in line with link rod on floor. Install seats #4. Install instrument panel and coming to fuselage insuring that the canopy will still fit in place. glue gunsight #6 to top of instrument panel in location shown.

**Colors**

Light Gray: Floor, seat frames, center bulkhead

Silver Gray: Seat belts, rear bulkhead padding

Dark Green: lower padding on pilots sidewalls

Flat Black: Control stick grips, Instrument panels and gauge bezels, top surfaces of side consoles, entire center console, gunsight, canopy framing, rudder pedals, canvas instrument panel coming cover. circuit breakers on center bulkhead, upper padded edge of pilots side walls

Medium Green: rear compartment wall padding, upper pilots seat cushions and bottom seat cushions on some aircraft

Yellow: bottom seat cushions (on USAF Museum aircraft)

Masters by: Alex Bernardo

Thanks to: Byron Hukee, Ed Barthelmes, and Daniel W. Rees

© 1998



3313 Pathway Court, Falls Church, Va. 22042  
Phone/Fax (703) 204-9412