

CAUTION
These resin casted accessories can only be glued using cyanoacrylate glues. These glues are not without danger, so be careful when using them. Work in a well ventilated area only and avoid inhaling the fumes for they can be harmful.

RECOMMENDED KIT

Italeri's Crusader II Kit N° 219.

The best way of removing the carrier on the resin-casted parts is by means of a razor saw (X-Acto). Sand smooth afterwards. Use waterproof sandpaper to avoid excessive spreading of resin dust.

We advise you to wash your hands thoroughly upon working with resin casted items.

Glue gun barrel in any desired position

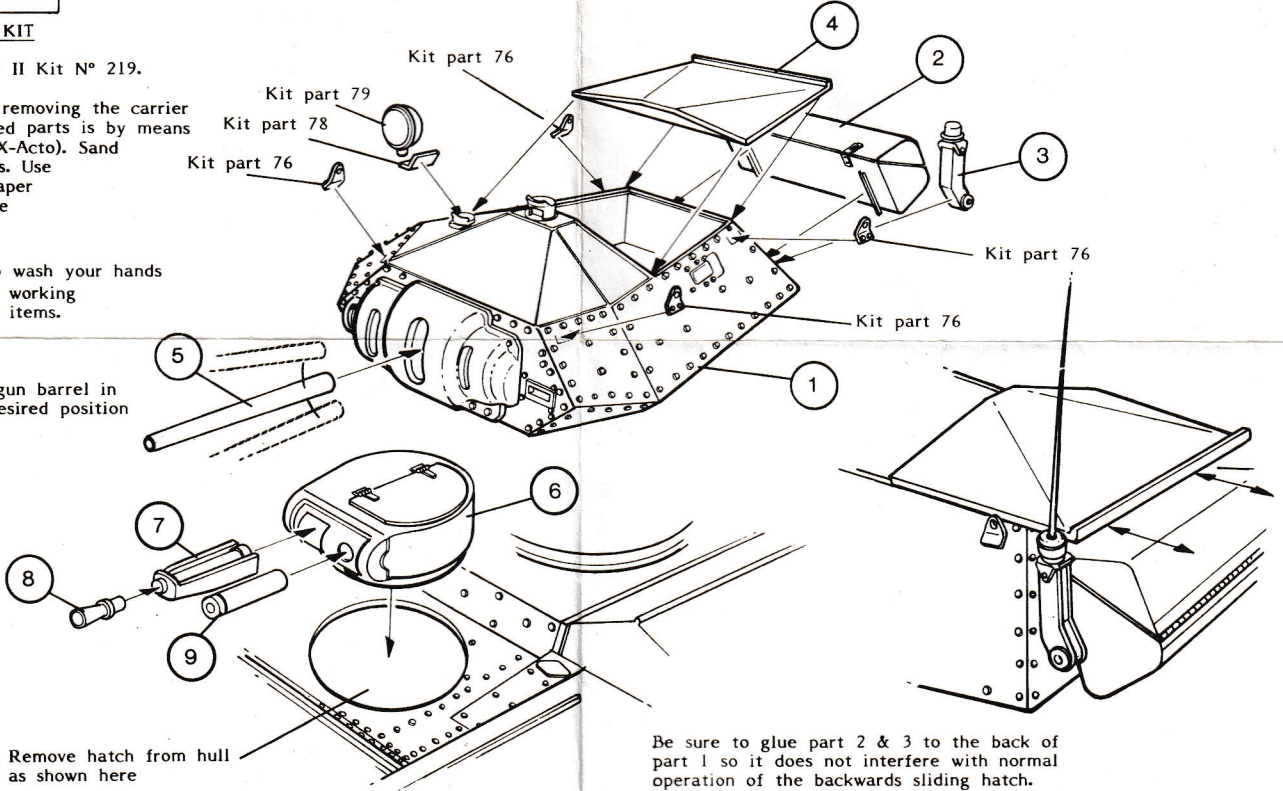

Remove hatch from hull as shown here

Be sure to glue part 2 & 3 to the back of part 1 so it does not interfere with normal operation of the backwards sliding hatch. Glue the hatch in any desired position. Insert antenna from stretched sprue (not included)