

- Modo esatto di applicare le decalcomanie
- Correct Method for Applying Decals
- Comment appliquer les décalcomanies correctement
- Das korrekte Aufbringen der Abziehbilder

# AERMACCHI MB-339 A-PAN



MODELLO IN  
SCALA RIDOTTA  
MODELE  
REDUIT

MODEL  
KIT  
MODELL IN  
VERDL. MASSTAB

## 1/72

CAT. N. 10-014  
MADE IN ITALY

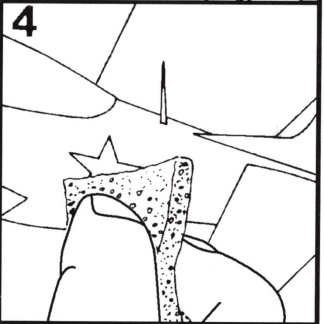
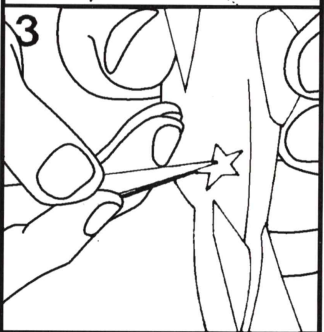
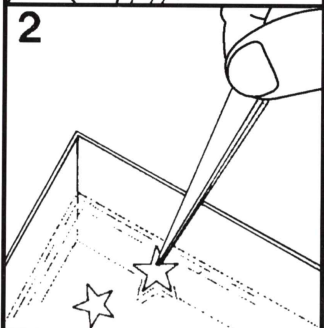
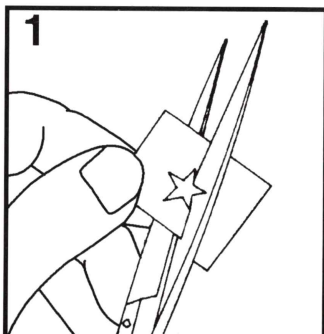

**DESCRIZIONE** - L'AERMACCHI intraprese lo studio dell'MB 339 nel 1972. Questa macchina conservò tutti i pregi di fondo e le migliori introdotte nelle versioni più avanzate dell'MB 326, mentre presentava una nuova sezione di prua con posti di pilotaggio molto scalati, con vantaggi aerodinamici e migliore visibilità per il secondo pilota. Il primo volo ebbe luogo nel 1976. L'MB 339 è stato ordinato da: Aeronautica Militare Italiana, Argentina, Perù.

L'MB 339 è in dotazione alla pattuglia acrobatica nazionale (PAN) dal 1982. Biposto metallico, con motore "VIPER", ala medio bassa, con bordo d'attacco a leggera freccia. Allievo ed istruttore siedono in tandem sotto un lungo tettuccio completamente trasparente.

**Caratteristiche principali** - Apertura alare: 10,86 m - Lunghezza: 10,97 m - Altezza: 3,58 m - Velocità massima: 883 Km/h - Autonomia: 1750 Km.

**HISTORY** - The AERMACCHI company starting the study of MB 339 in 1972 year. This machine maintain all the good qualities and the improvements introduced in the advanced versions of MB 326 but with a new section of nose with a new seats disposal for increase the visibility for the second pilot and aerodynamics. The first flying was in 1976. The MB 339 has been delivered at: Italian Air force, Argentina, Perù.

The MB 339 is in service in the aerobatic italian team PAN from 1982. Twin-seat, with "Viper" engine, middle-low wing and leading-edge with light arrow. Pupil and instructor are locate in tandem under a long transparent canopy.

**Technical datas** - Span 10,86 m - Lenght 10,97 m - Height 3,58 m - Max. speed 883 Km/h - Tactical radius 1.750 Km.

**DESCRIPTION** - AERMACCHI entreprit l'étude du MB 339 en 1972. Cet avion conservait toutes les caractéristiques de base et les améliorations introduites dans la version plus avancée du MB 326, bien qu'il presenta une nouvelle section de l'avant avec un poste de pilotage aux sièges très décalés offrant une meilleure aérodynamique et une meilleure visibilité pour le second pilote. Le 1<sup>er</sup> vol a eut lieu en 1976. Le MB 339 fut commandé par les forces aeriennes d'Italie, d'Argentine et du Perou.

Le MB 339 equipe la Patrouille Acrobatique Nationale (PAN) depuis 1982. Bi-place métallique à moteur "Viper", aile mediane à bord d'attaque en légère flèche, ève et instructeur sont assis en tandem sous un long cockpit complètement transparent.

**Données technique** - Envergure 10,86 m - Longueur 10,97 m - Hauteur 3,58 m - Vitesse maximum 883 Km/h. Autonomie 1.750 Km.

**BESCHREIBUNG** - AERMACCHI nahm die Studien zur Entwicklung der MB 339 im Jahre 1972 auf. Diese Maschine weist alle positiven Grundeigenschaften auf, sowie auch die Verbesserungen der neueren Typen MB 326. Der Bug wurde verändert und weist einen neuen Schnitt mit gestaffelten Pilotensitzen auf, die sich durch ihre Aerodynamik und eine bessere Sicht für den Kopiloten auszeichnen. 1976 fand der erste Flug statt. Die MB 339 wurde von folgenden Kunden geordert: Italienische Luftwaffe, Argentinien, Peru.

Die MB 339 wird seit 1982 von der "PAN", der Italienischen Kunstflug-Staffel, eingesetzt. Es handelt sich um eine Zweimann-Maschine aus Metall, mit einem "VIPER"-Motor und mitteltiefen Pfeilflügeln mit schwacher positiver Pfeilung. Schüler und Fluglehrer sitzen hintereinander unter einer langen, vollkommen durchsichtigen Kanzelhaube.

**Haupteigenschaften** - Spannweite: 10,86 m - Länge: 10,97 m - Höhe: 3,58 m - Höchstgeschwindigkeit: 883 Km - Reichweite: 1750 Km.

AERMACCHI, MB-339A-PAN  
 313° Grupo Addestramento Acrobatico,  
 Pattuglia Acrobatica Nazionale "Frecce Tricolori",  
 AMI, Italian Air Force

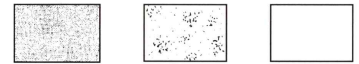
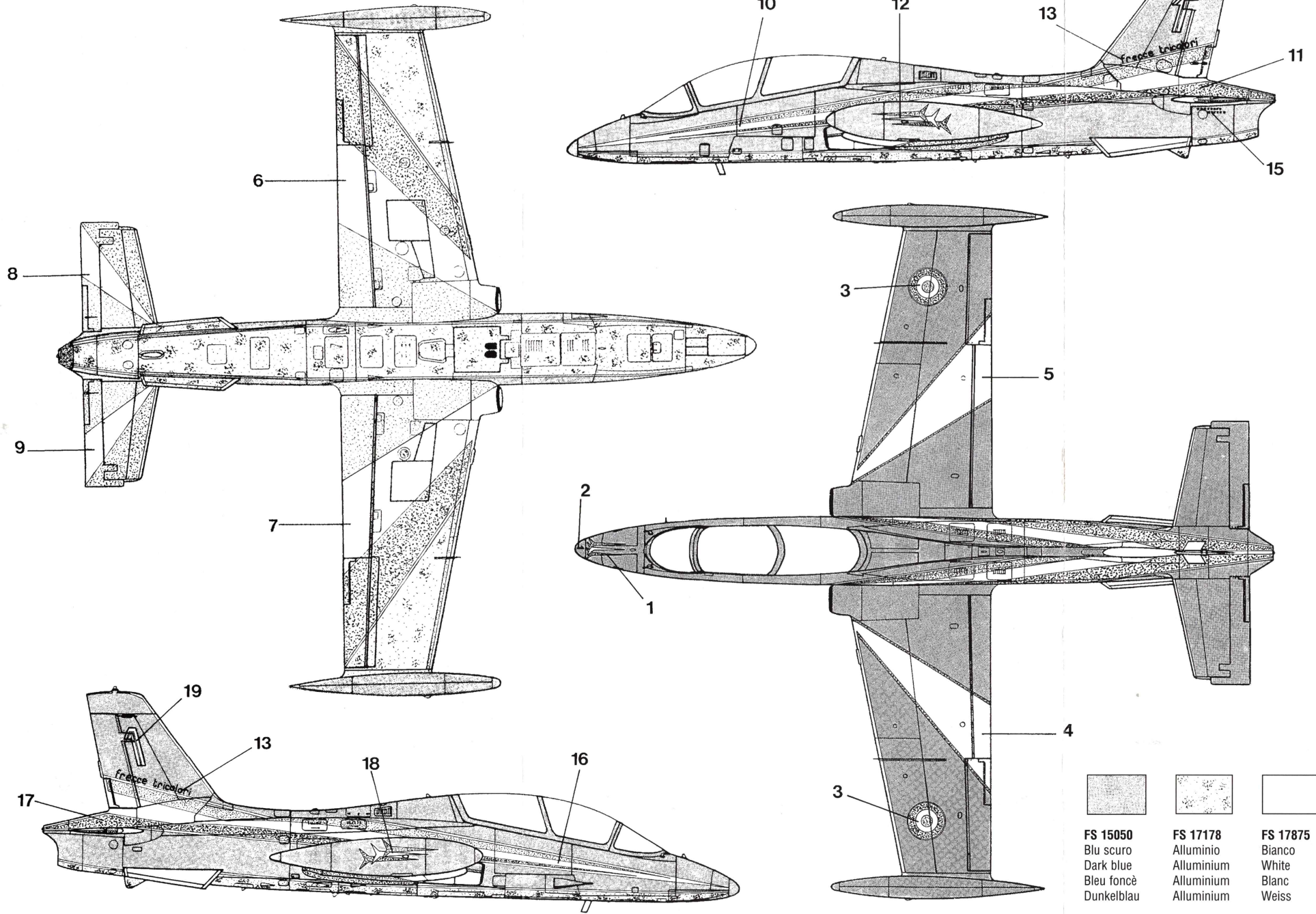

<b>FS 15050</b> Blu scuro Dark blue Bleu foncé Dunkelblau	<b>FS 17178</b> Alluminio Alluminium Alluminium Alluminium	<b>FS 17875</b> Bianco White Blanc Weiss
---	--	--

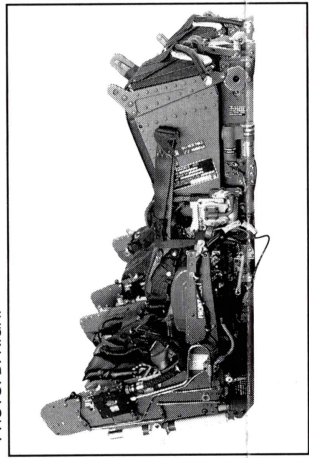
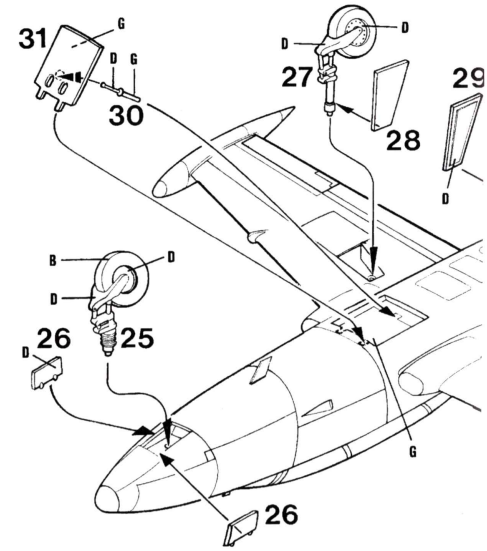
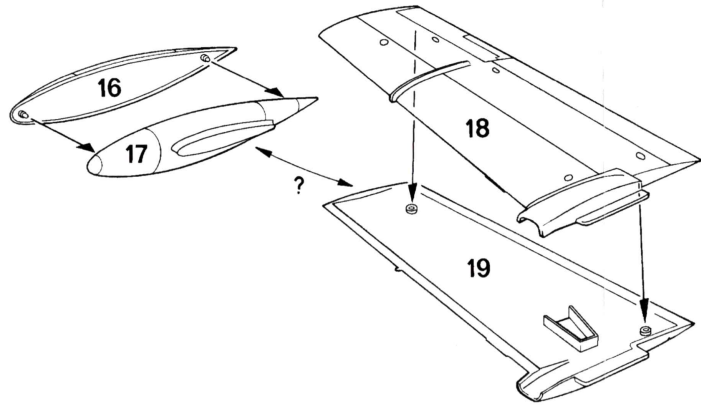
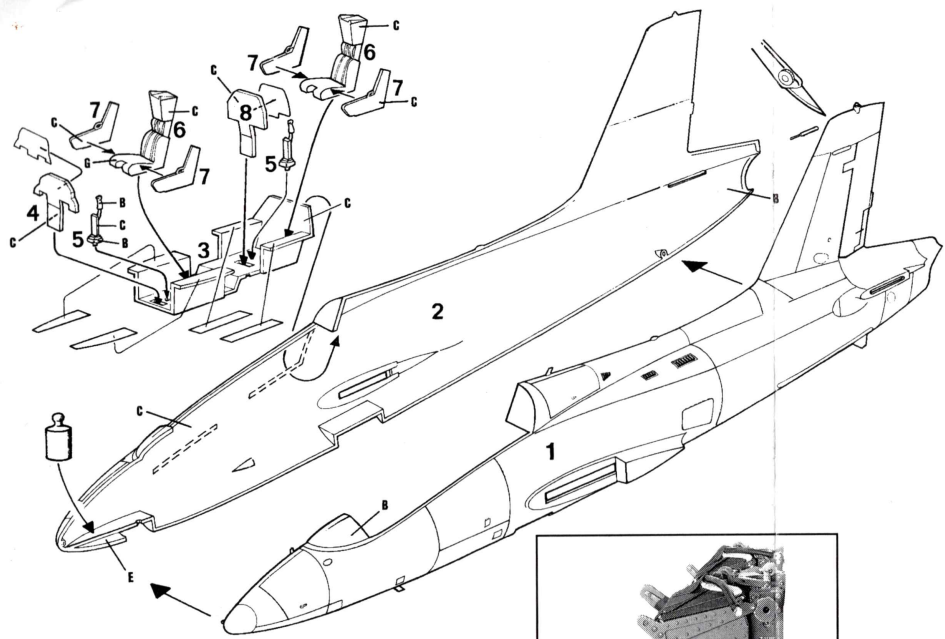

PHOTO: D. RIGHI

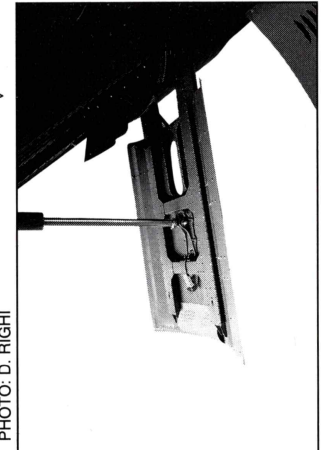
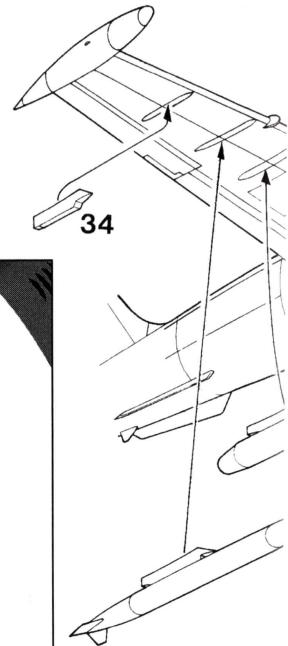
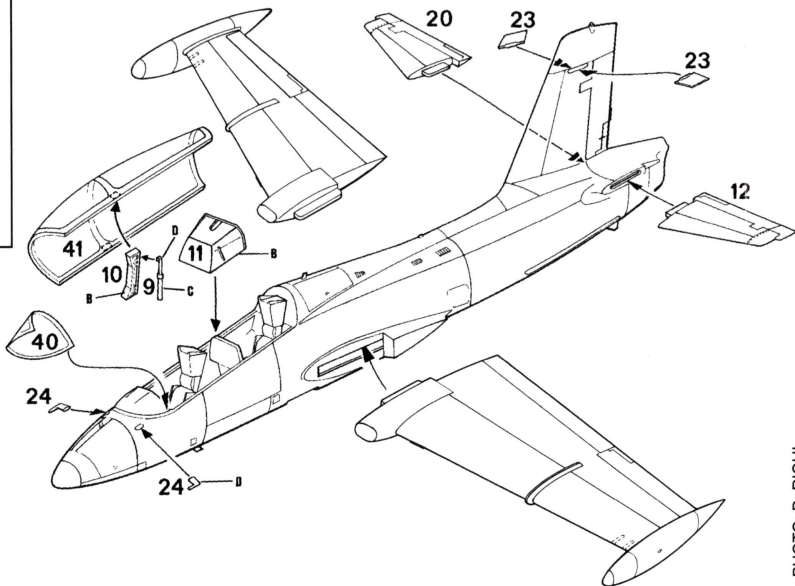
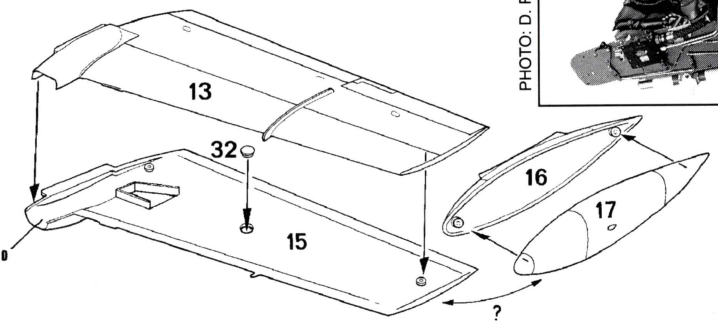

PHOTO: D. RIGHI

ISTRUZIONI PER LA COLORAZIONE  
 PAINT INSTRUCTIONS  
 INSTRUCTIONS POUR LA PEINTURE  
 BEMALUNGS ANWEISUNGEN

**A** F.S. 33538 Giallo / Yellow / Jaune / Gelb  
**B** F.S. 37038 Nero / Black / Noir / Schwarz  
**C** F.S. 36231 Grigio / Grey / Gris / Mittelgrau  
**D** F.S. 37178 Alluminio / Aluminium / Aluminium / Aluminium

**E** F.S. 34151 Verde interni chiaro / Green zinc chromate / Vert Zinc Chromate / Zinkgrün  
**F** F.S. 30118 Marrone / Brown / Brun / Braun  
**G** F.S. 34079 Verde Scuro / Dark Green / Vert Foncè / Dunkelgrün

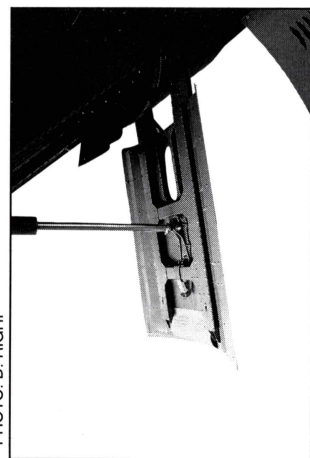
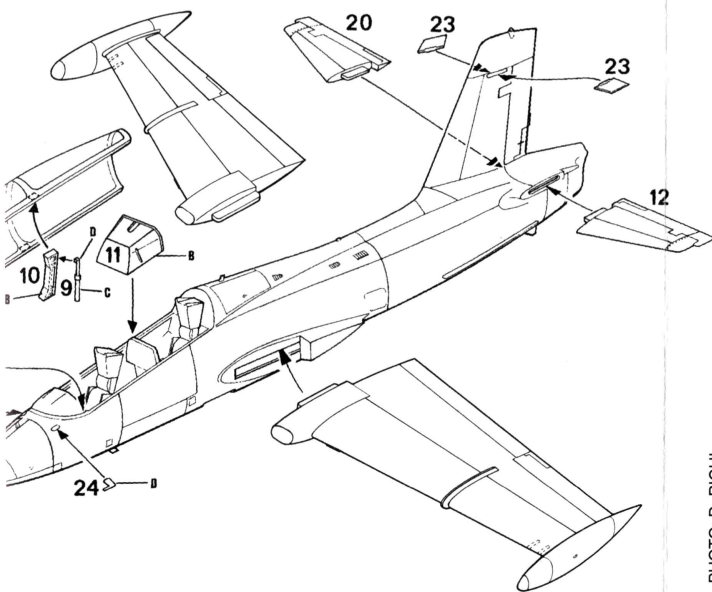
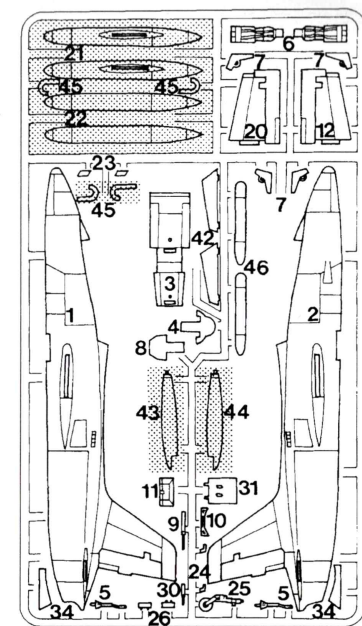
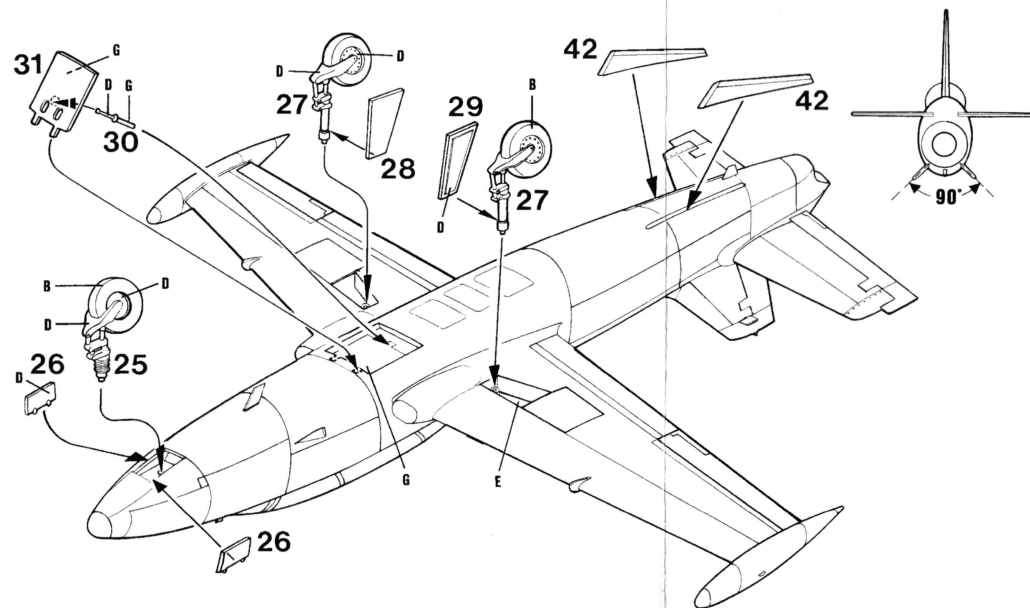
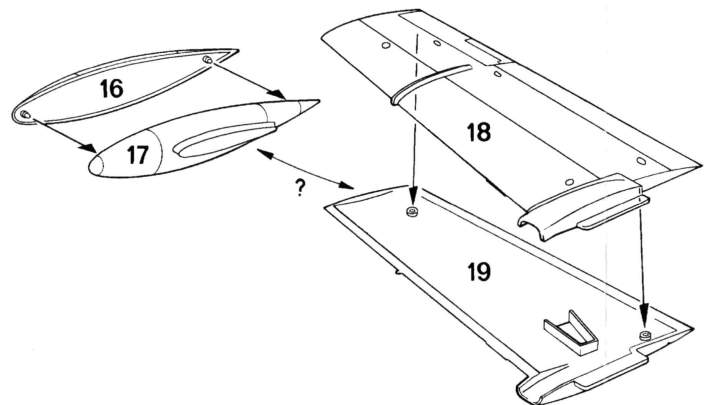
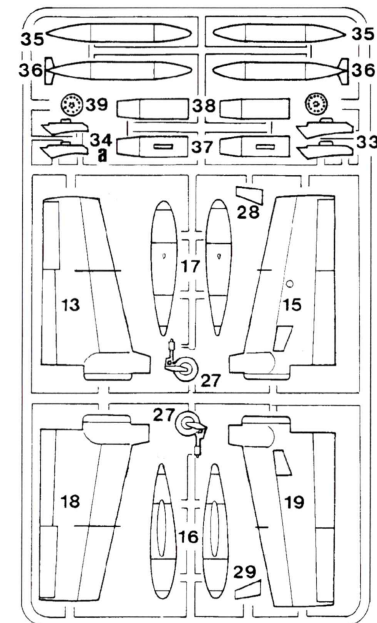
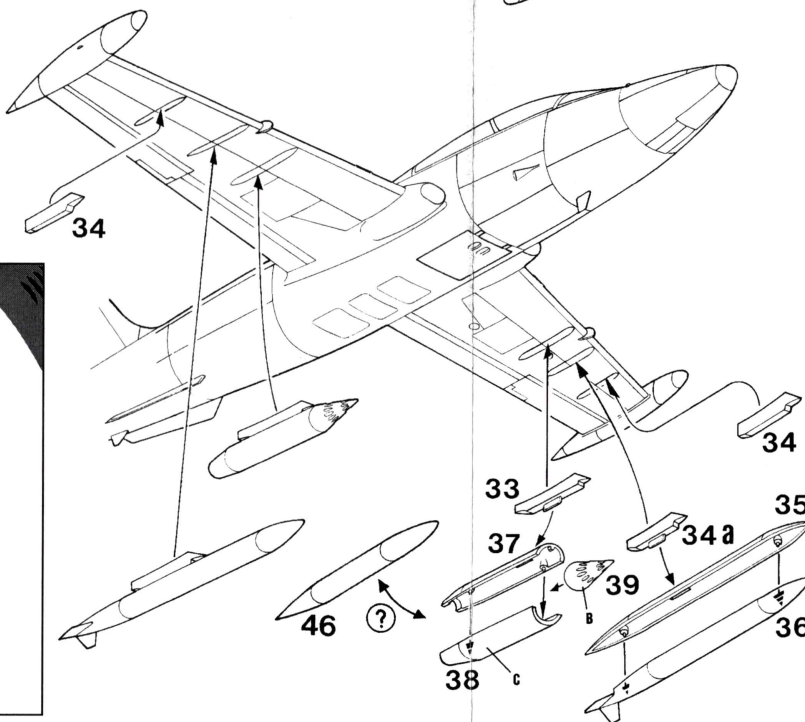
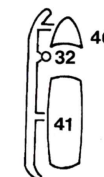

PHOTO: D. RIGHI



ow / Jaune / Gelb  
 < / Noir / Schwarz  
 y / Gris / Mittelgrau  
 Aluminium / Aluminium / Aluminium

E F.S. 34151 Verde interni chiaro / Green zinc chromate / Vert Zinc Chromate / Zinkgrün  
 F F.S. 30118 Marrone / Brown / Brun / Braun  
 G F.S. 34079 Verde Scuro / Dark Green / Vert Foncé / Dunkelgrün



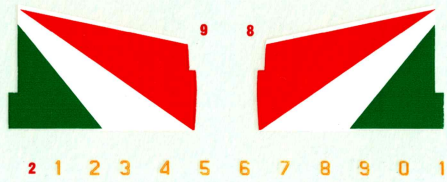
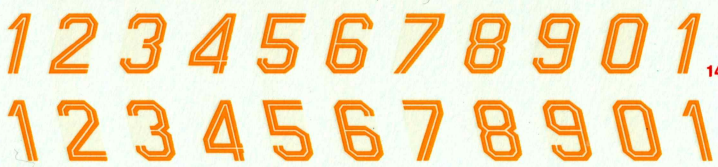
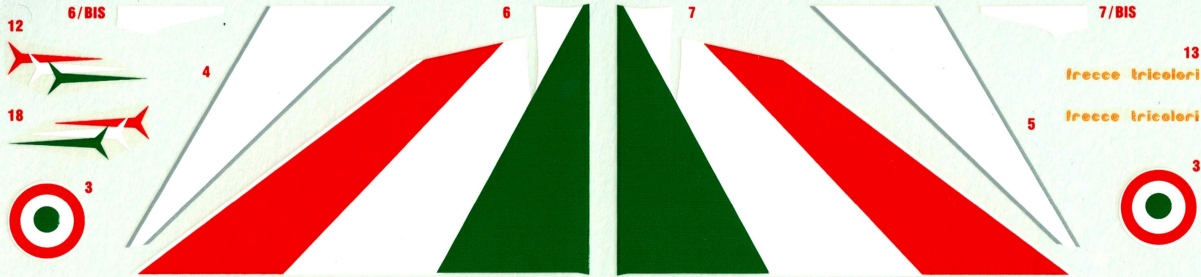

ART. 014

AERMACCHI MB-339 A PAN

