

WERKSTATTKRAFTWAGEN TYP-03-30

35359



GENERAL INSTRUCTION

SCALE
1:35

- HIGHLY DETAILED MODEL
- PHOTO-ETCHED PARTS INCLUDED
- CLEAR PLASTIC PARTS INCLUDED
- DECAL SHEET INCLUDED
- FULLY DETAILED ENGINE COMPARTMENT AND CHASSIS
- REPAIRING EQUIPMENT & TOOLS ARE INCLUDED
- ONE FIGURE INCLUDED

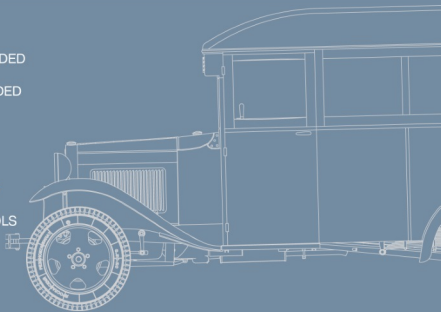

ATTENTION

Ne pas utiliser de colle ou de peinture à proximité d'une flamme nue, et aérer la pièce de temps en temps.
 Pour retirer les pièces hors du cadre, utiliser des ciseaux spéciaux pour piquer le plastique en excès avec un cutter ou une lime.
 Vor la fin de cette colonne pour la signification des symboles.
 Après l'assemblage peut rester des pièces inutilisées.

ZUR BEACHTUNG

Mischer und Farbe nicht nahe von offenem Feuer verwenden und das Fenster von Zeit zu Zeit zu Belüftung öffnen.
 Zum Abschneiden der Teile vom Verbundstück eine Modellereschere verwenden und die überstehenden Plastikteile mit einem Messer oder einer Feile beseitigen.
 Die Bedeutung der Symbole finden Sie unten in dieser Spalte.
 Nach dem Zusammenbau des Modells, können einzelne Teile übrig bleiben

УВАГА

При использовании клея и красок все работы проводить подальше от открытого огня и периодически проветривать помещение.
 Детали адсорбировать аэликлей ножом обоим из них другим инструментом. Зачистить избыток клея при помощи модellersкого инструмента. Зачистить избыток пластика при помощи ножа или наждачной бумаги. Выброски модели промазать согласно 3 символу. Для зручності побудови кожного деталі позначено номером.
 После окончания сборки каждая деталь обозначена номером. После сборки набора могут остаться неиспользованные детали.

ATTENZIONE

Non usare colla o vernice vicino a fiamme esposte, e aprire le finestre di tanto in tanto per cambiare l'aria. Quando si staccano parti del modello, usare forbici da modellismo e eliminare la plastica in eccesso con un coltello o una lima. Vedere in fondo a questa colonna per il signifi. Dopo l'assemblaggio possono rimanere parti inutilizzate.

ВНИМАНИЕ

При использовании клея и красок все работы проводить в проветриваемом помещении вдали от источников огня.
 Детали отделять от литников ножом или другим режущим инструментом. Зачистить избыток и места среза при помощи ножа или наждачной бумаги. Сброску моделей промазывать согласно значению символа.
 Для удобства сборки каждая деталь обозначена номером. После сборки набора могут остаться неиспользованные детали.

CAUTION

When you use glue or paint, do not use near open flame, and use in well ventilated room. When you take parts off from the runner frame, use modeling scissors or cutter.
 See the bottom of this column for the meaning of symbols.
 Extra details can remain after assembling of the kit.



MMÉ 2x8
 2 TIELE FORTSETZEN
 EFFETUEZ 2 PIECES
 FARE due PIEZZE
 TEE 2x8
 ГОДИТЬСЯ ДВА РАЗА
 КОРЬКА КОРЬКА



DO NOT CEMENT
 NICHT ABLÄSEN
 NE PAS COLLER
 NON INCOLLARE
 ELIMINA
 LIMMA
 НЕ ИСПОЛЬЗОВАТЬ КЛЕЙ
 НЕ КЛЕЙТЕ



OPTIONAL
 NACH BELIEBEN
 FACULTATIF
 FACOLTATIVO
 VALINKAVALIKANNEN
 VALIKO
 ВАРЬАНТИ
 ВАРИАНТИ



OPEN HOLE
 ÖFFNEN
 FAIRE UN TROU
 FORARE/PIRETTA
 AUSA REKA
 OLMANNA
 СДЕЛАТЬ ОТВЕРСТИЕ
 ЗРОБИТИ ОТВЕР



REMOVE
 ENTRENIEN
 RETIRER
 BENAHME
 POSTA
 AUSGASSEN
 ÖTRESÄTTA
 ВІВІДАТИ



BEND
 BIEGE
 PLEIER
 SE VOUS PLIAT
 PEGARE
 TAITA
 BOCCA
 ВІГНУТИ
 ВІГНУТИ

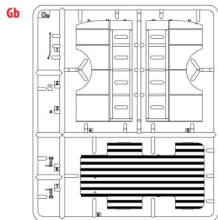
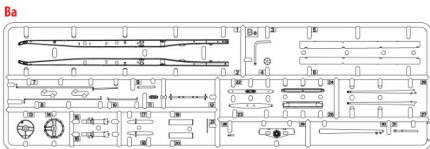
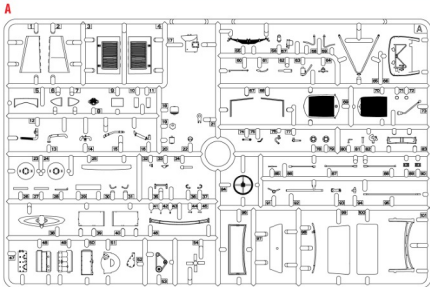
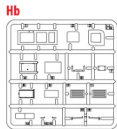
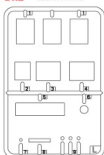

SCRATCHBUILD
 AM BESTEN ZU MACHEN
 FAIRE LE PLUS
 BENOITI
 TATA
 COBI
 DING BILLY
 OBIETAT SAMOMU
 ZROBITI SAMOMU

PARTS**Lx2 CLEAR PARTS****COLOR CHART**

Nº	Color	Vallejo	Mr. Color	AK RC	Mission Models	AMMO MIG	Tamiya	Color name
01		71.017	C-511	RC-073	MMP-031	A.MIG-0019	XF-62	480 Russian Green
02		71.062	C-090	RC-020	MMM-008	A.MIG-0194	XF-16	Aluminium
03		71.057	C-033	RC-001	MMP-047	A.MIG-0046	XF-01	Black
04		70.984	C-131	AK-709	MMW-001	A.MIG-0041	XF-10	Rust
05		71.818	C-029	RC-067	MMP-012	A.MIG-0913	XF-64	Red Braun
06		70.965	C-005	RC-036	MMP-065	A.MIG-0086	XF-08	Blue
07		71.007	C-038	RC-023	MMP-025	A.MIG-0081	XF-62	Olive Green
08		70.884	C-060	RC-052	MMP-072	A.MIG-0075	XF-55	Light Grey
09		71.072	C-028	AK-476	MMM-002	A.MIG-0191	XF-56	Steel
10		71.003	C-003	RC-006	MMP-003	A.MIG-0049	XF-07	Red
11		71.056	C-040	RC-057	MMP-014	A.MIG-0008	XF-63	Dunkelgrau
12		71.073	C-078	RC-015	MMM-001	A.MIG-0045	XF-84	Gun Metal
13		71.072	C-028	AK-476	MMM-002	A.MIG-0191	XF-56	Steel
14		70.976	C-043	RC-030	MMP-076	A.MIG-0037	XF-79	Wood
15		71.251	C-137	RC-022	MMP-040	A.MIG-0033	XF-85	Tire Black
16		71.025	C-039	RC-062	MMP-011	A.MIG-0010	XF-60	Dunkelgelb
17		70.815	051	RC-014	MMP-070	A.MIG-0116	XF-15	Skin Tone
18		71.244	C-119	RC-088	MMP-039	A.MIG-0027	XF-59	Sand Beige
19		70.920	C-052	RC-048	MMP-046	A.MMO-F512	XF-65	Grey Green

C x8

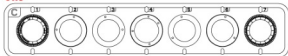

H

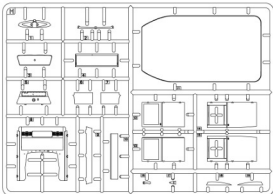

Ca



Cb x2



Cc x2



Ce x2



De

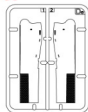

La

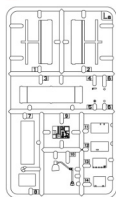

Ke

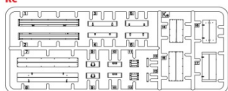

Kb



Be

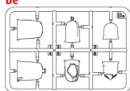

Bf x2



Bg

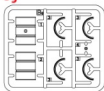

Bh x4



Bj



Cd

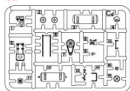

Ce

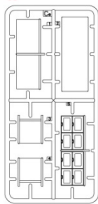

D

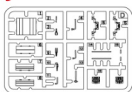

Cf

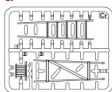

Cg

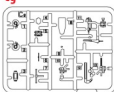

Db

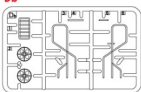

Dc

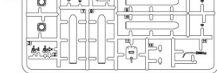

Eg



K x2



Kc



Kd



Ja x2



Jb x2



A Figure



PE

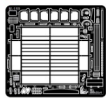

Decal Sheet



Ed



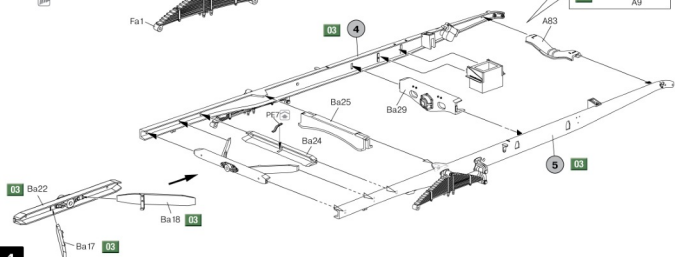
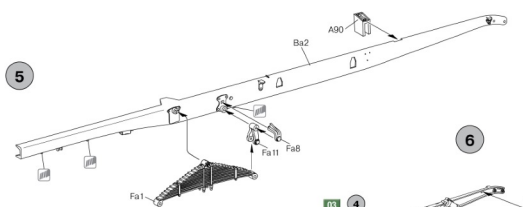
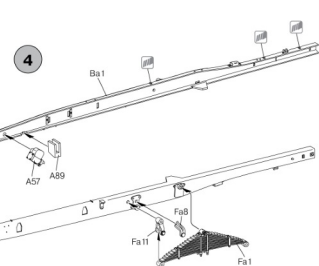
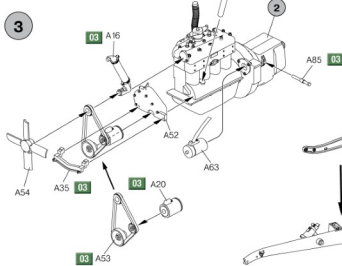
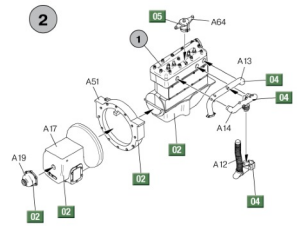
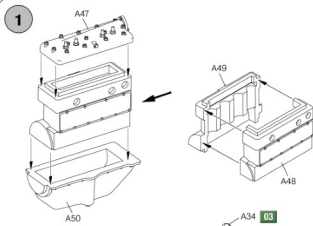

7 x8

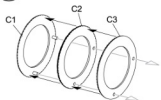

8 x8

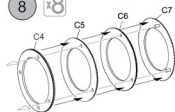

10

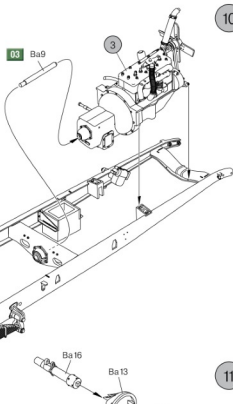

9 x2

Ce1

8

15

7

15

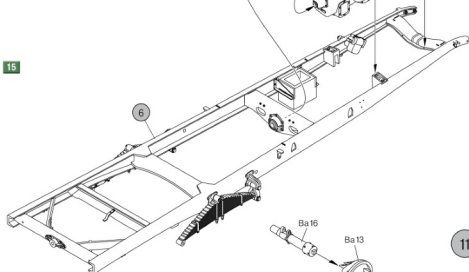
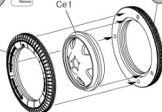

12

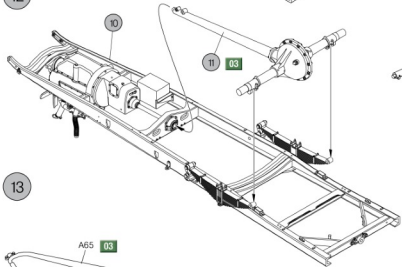

11

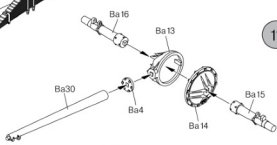

13

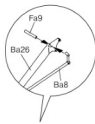
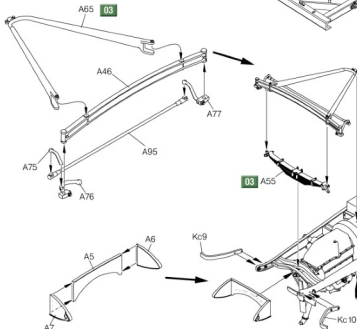

PE 10

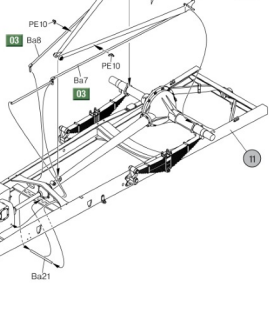

14

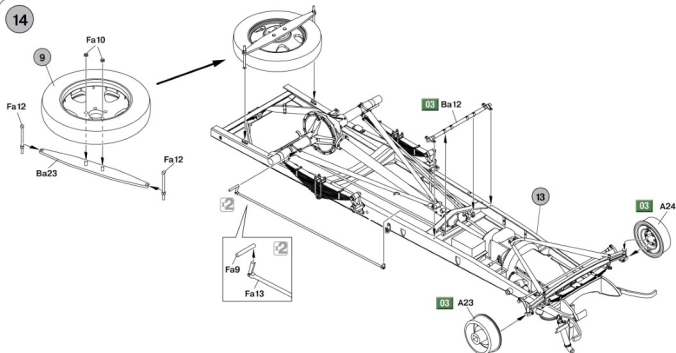

15 x4

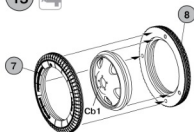

16 x2

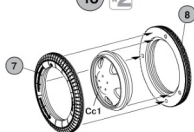

x2 17

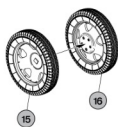

18

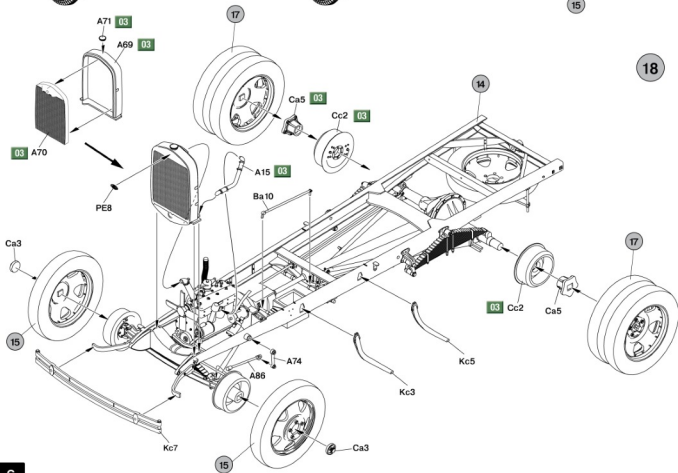

19

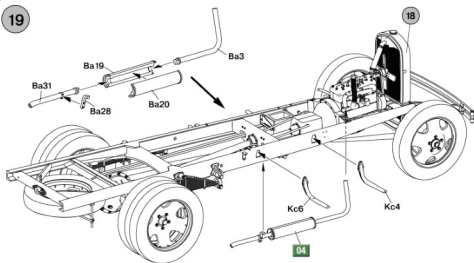

20

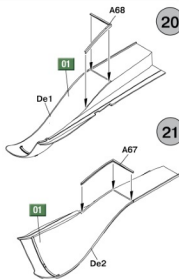

21

22

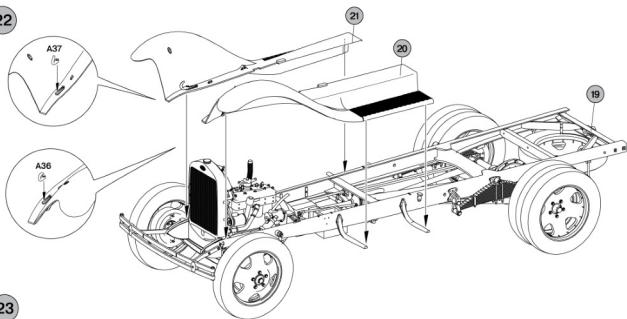

23

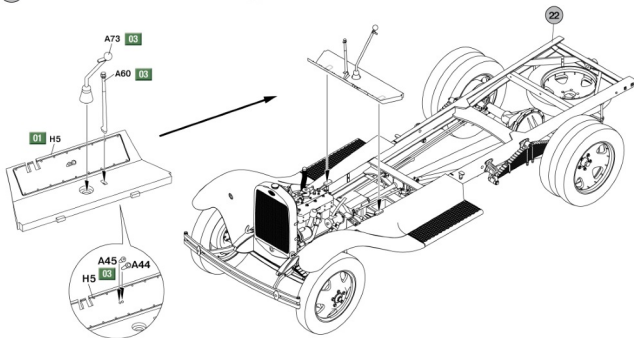

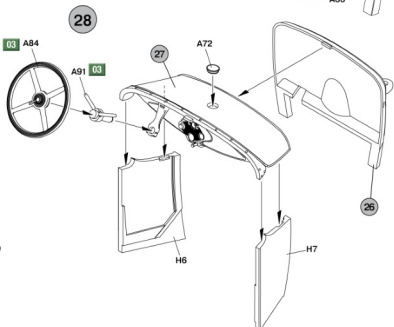
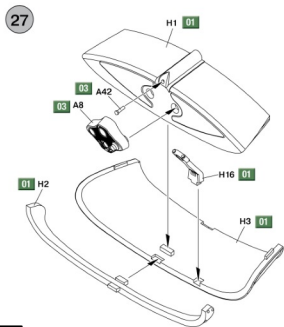
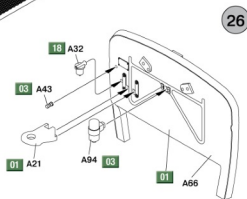
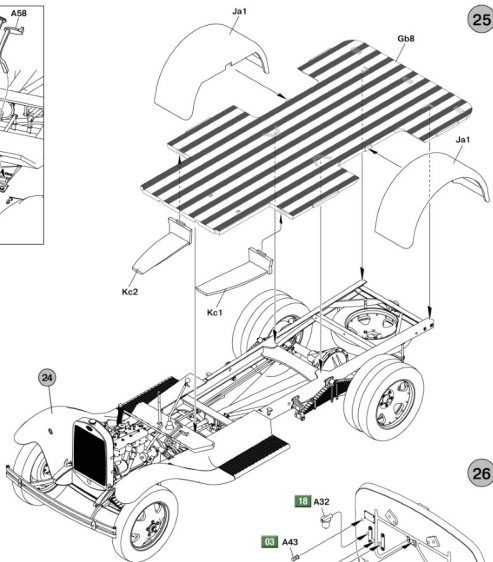
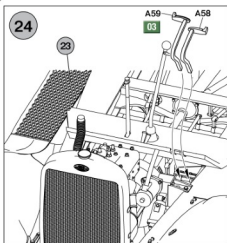

29

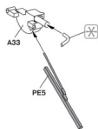

31

30

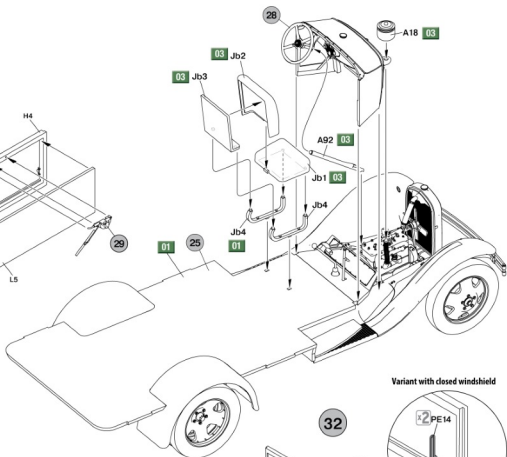
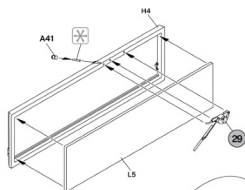

Variant with closed windshield

32

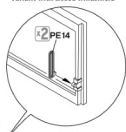

Variant with open windshield

33

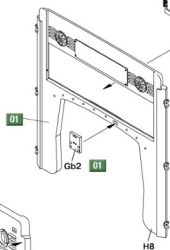
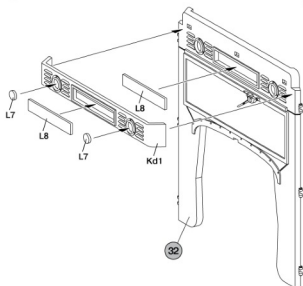

Variant with open windshield

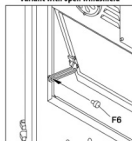

Variant with closed windshield

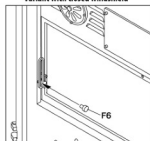

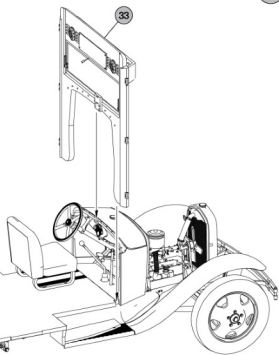
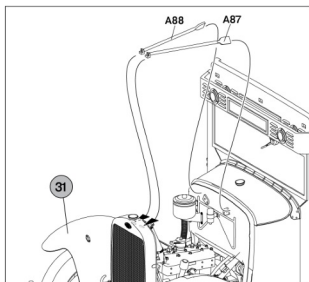

The parts Jb7, Jb6
use only for
open back doors

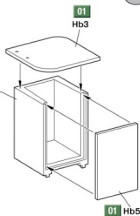
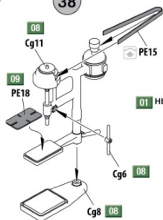
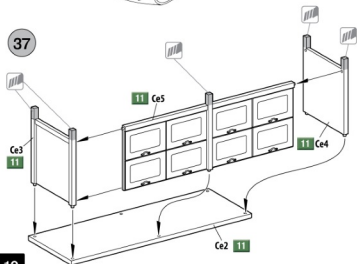
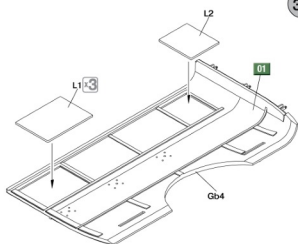
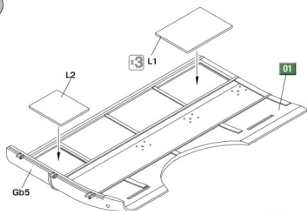
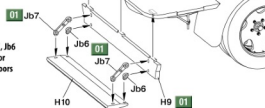

40

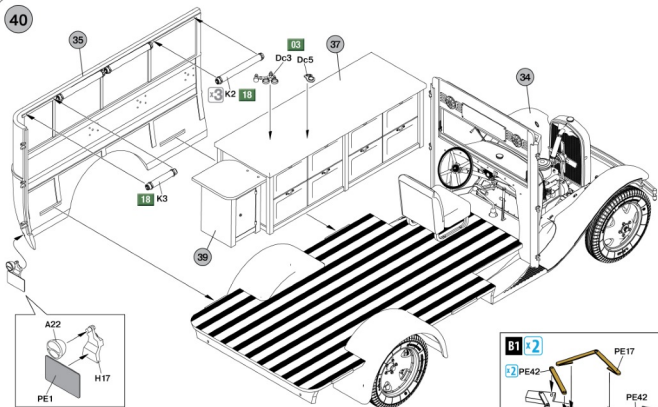

41

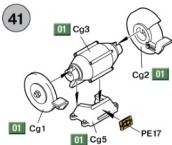

43

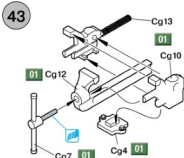

44

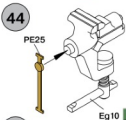

45

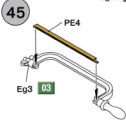

46

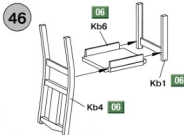

47

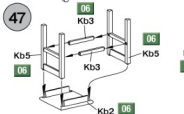

Closed Toolbox A

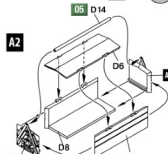

42

B Open Toolbox

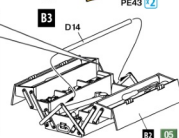
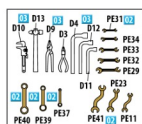
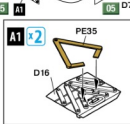
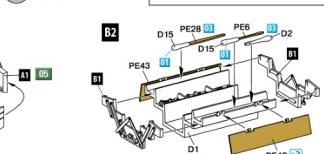

48

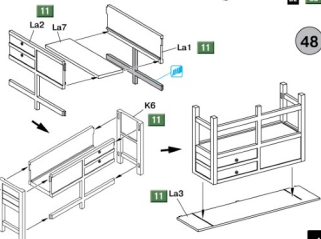

49

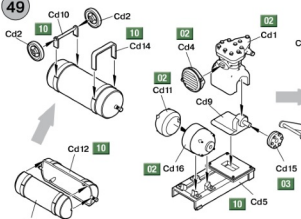

50

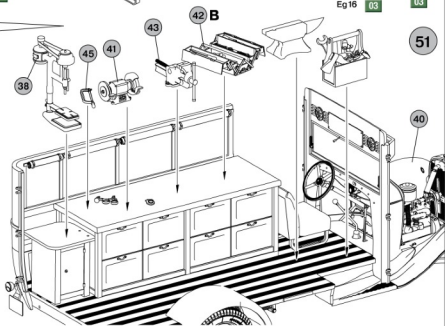
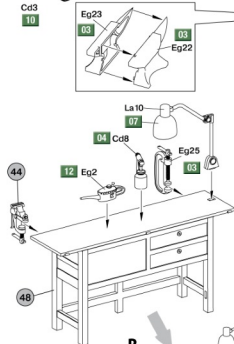
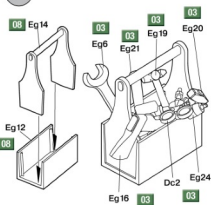

52

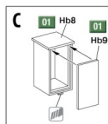
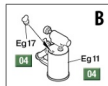
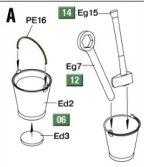
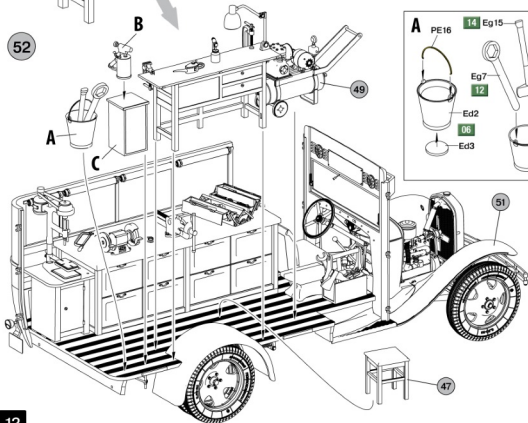

53

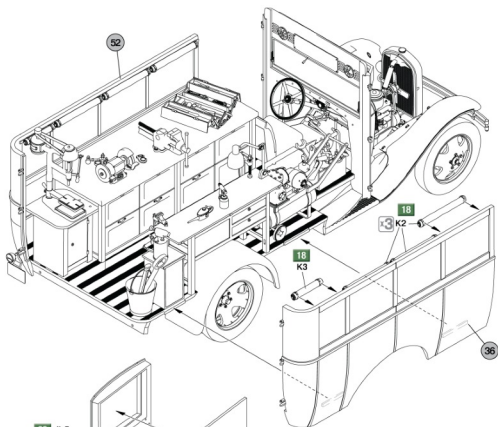

54

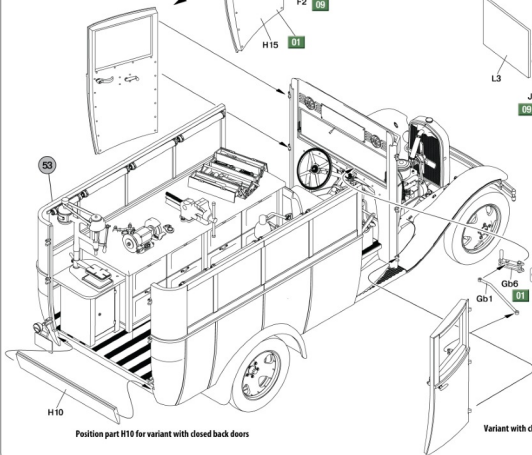
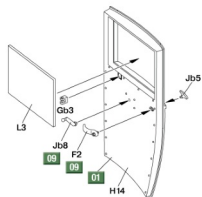
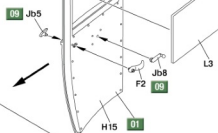

Variant with opened door

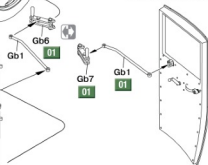

Variant with closed door

Position part H10 for variant with closed back doors

55

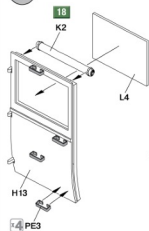

56

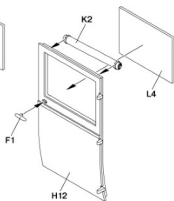

57

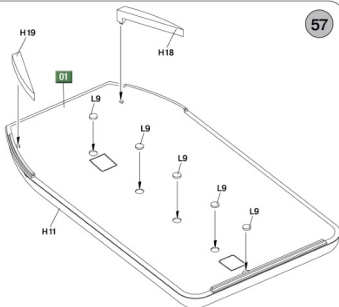

58

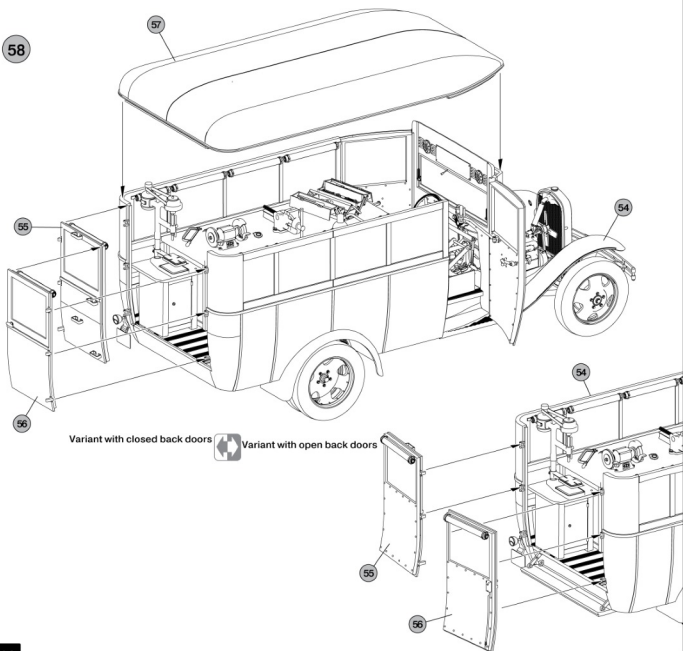

59

for variant with closed cover



for variant with open cover

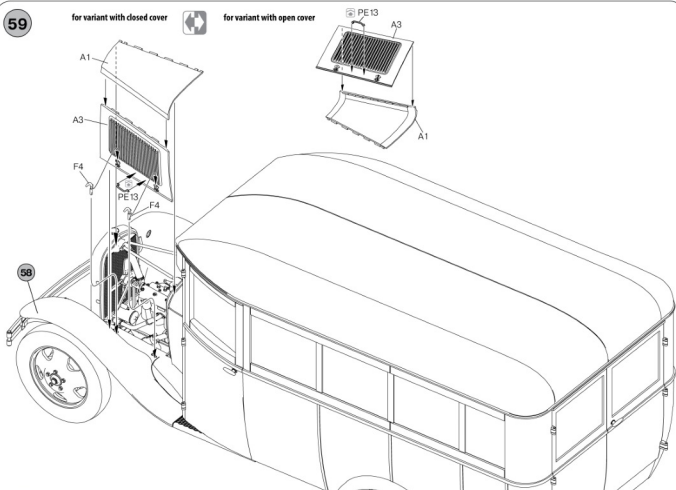

60

for variant with open cover



for variant with closed cover

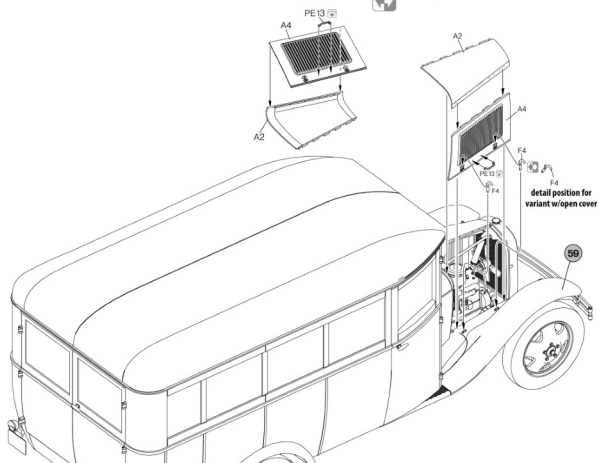

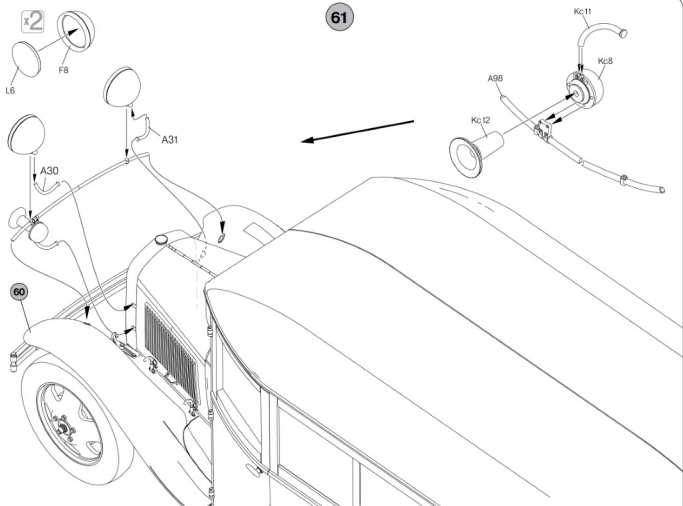

62

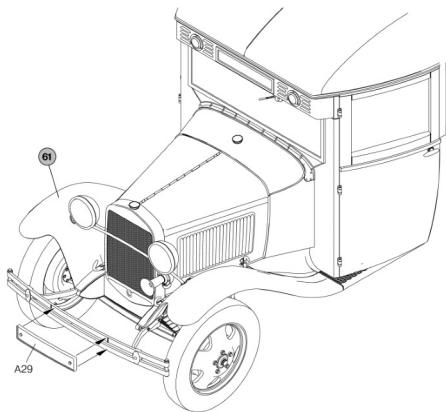

63

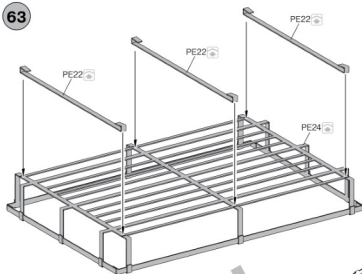

64

