

# M 1B HELLCAT

The parts included in this kit are to be assembled in conjunction with the APV Kit no. 6168. For best results in the assembling of photo-etched and resin parts use cyanoacrylate glue. Always remember to use cyanoacrylate glue in a well ventilated area. Before assembling be sure to remove all the parts to be substituted with photo-etched and resin parts. It is advisable before assembling to study well the instructions which accompany this MICRODETAILS SET plus any other sufficient documentation. It is advise to heat the metal parts before gluing; once the metal's hot it will be easier to bend.

For to details at the best the kit, you can add the resin Mullers (RM no. 346) and the Stowage set (RM no. 338).

- BE CAREFUL
- REPEAT SAME OPERATION FOR THE OTHER SIDE
- OPTIONAL
- FILE HOLE
- PK PLASTIC KIT PART
- ADD NUT
- TO FOLD
- TO BEND
- ADD PART CARD WITH SOFT WIRE
- RESIN PART
- MAKE 2 PIECES
- ADD ROD
- DO NOT CEMENT
- OPEN HOLE

## 1 50 CAL AMMO BOXES

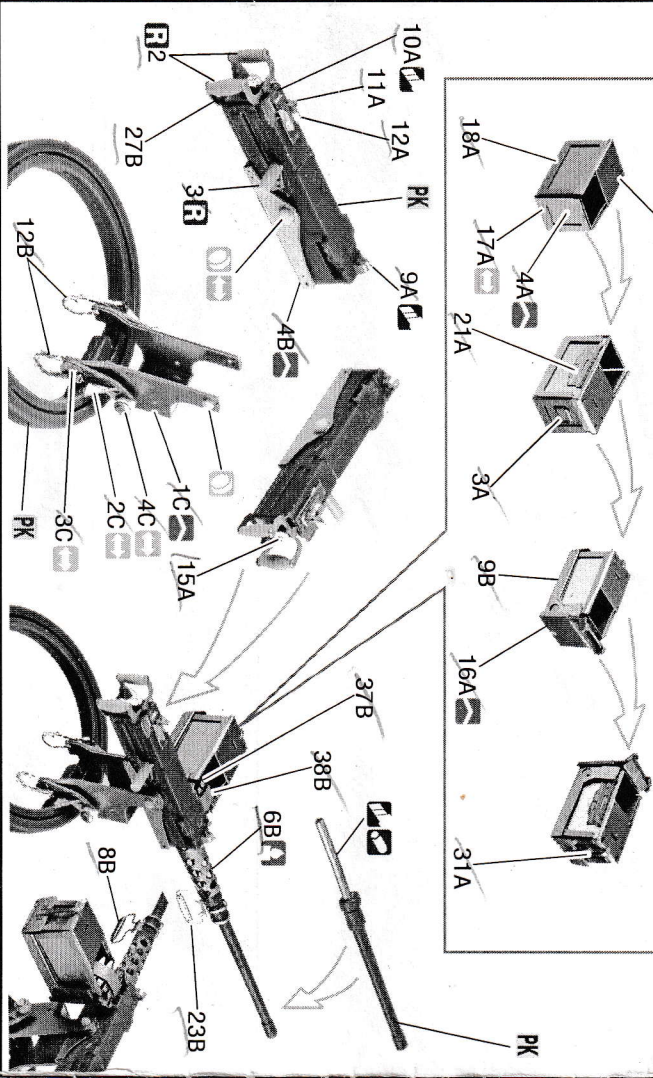

## 2

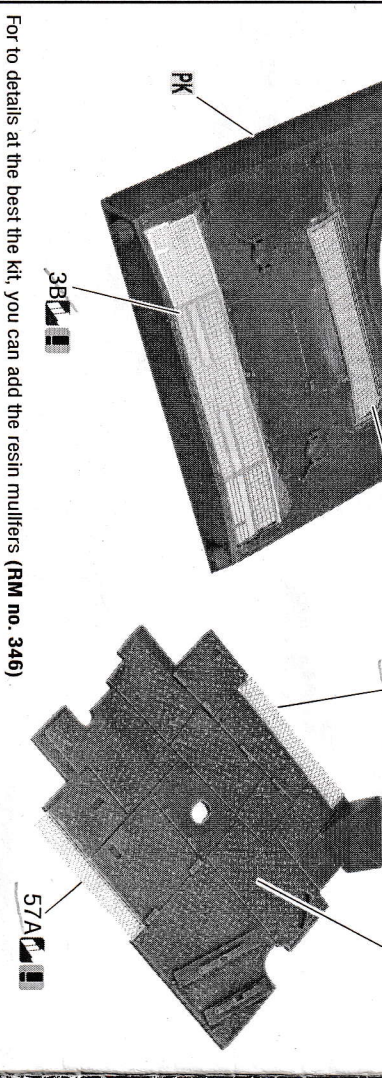

For to details at the best the kit, you can add the resin mullers (RM no. 346)

## 3

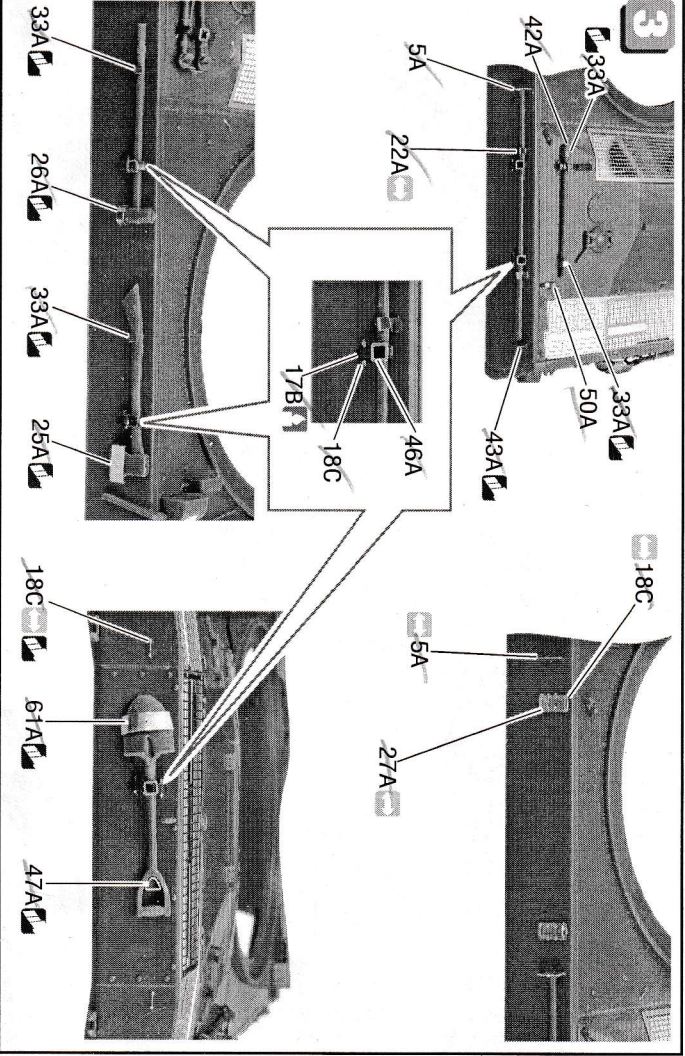

## 4

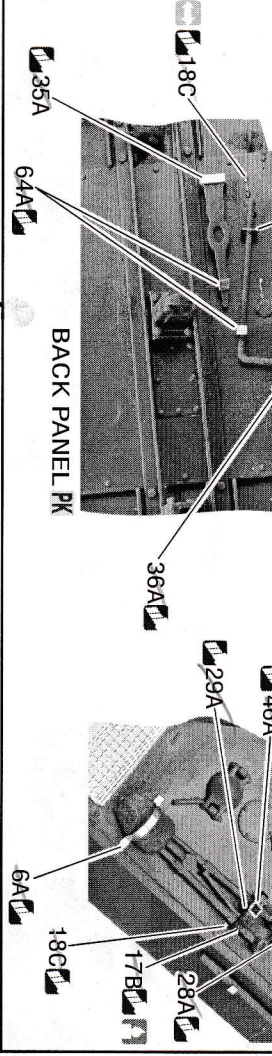

## 5

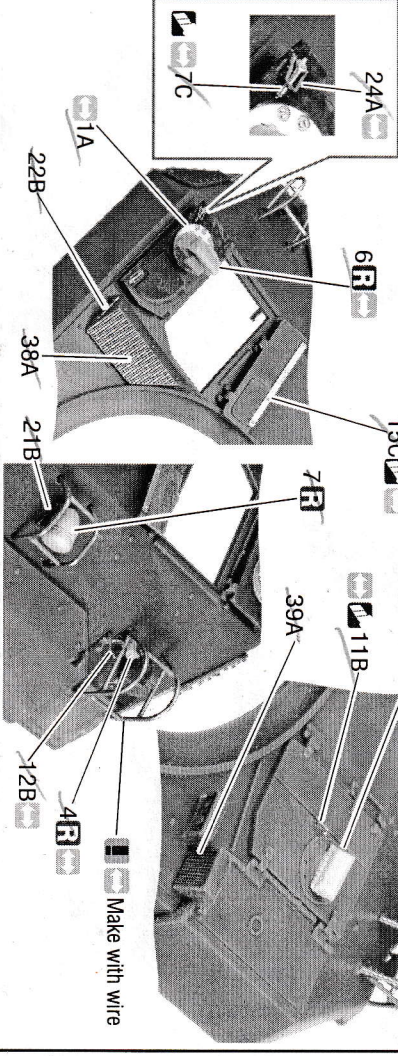

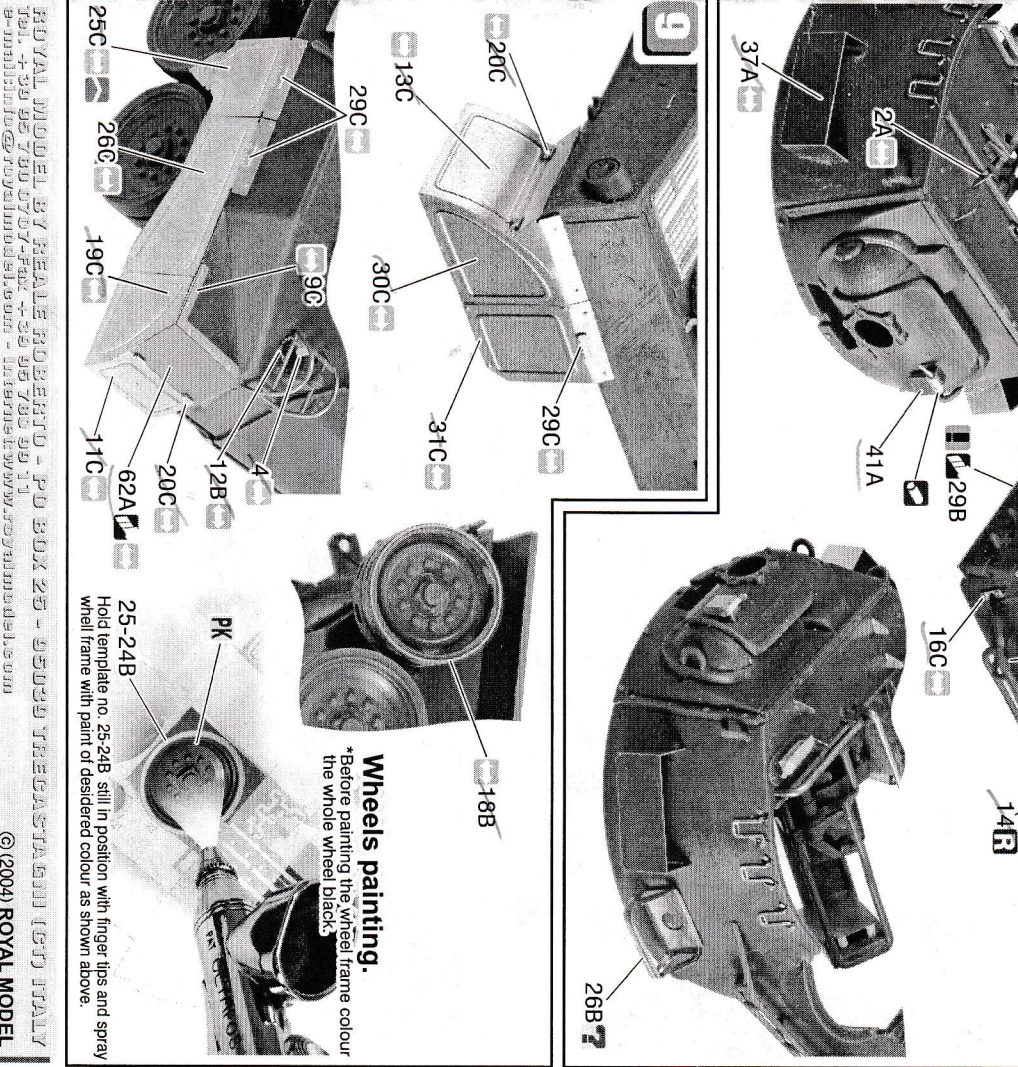
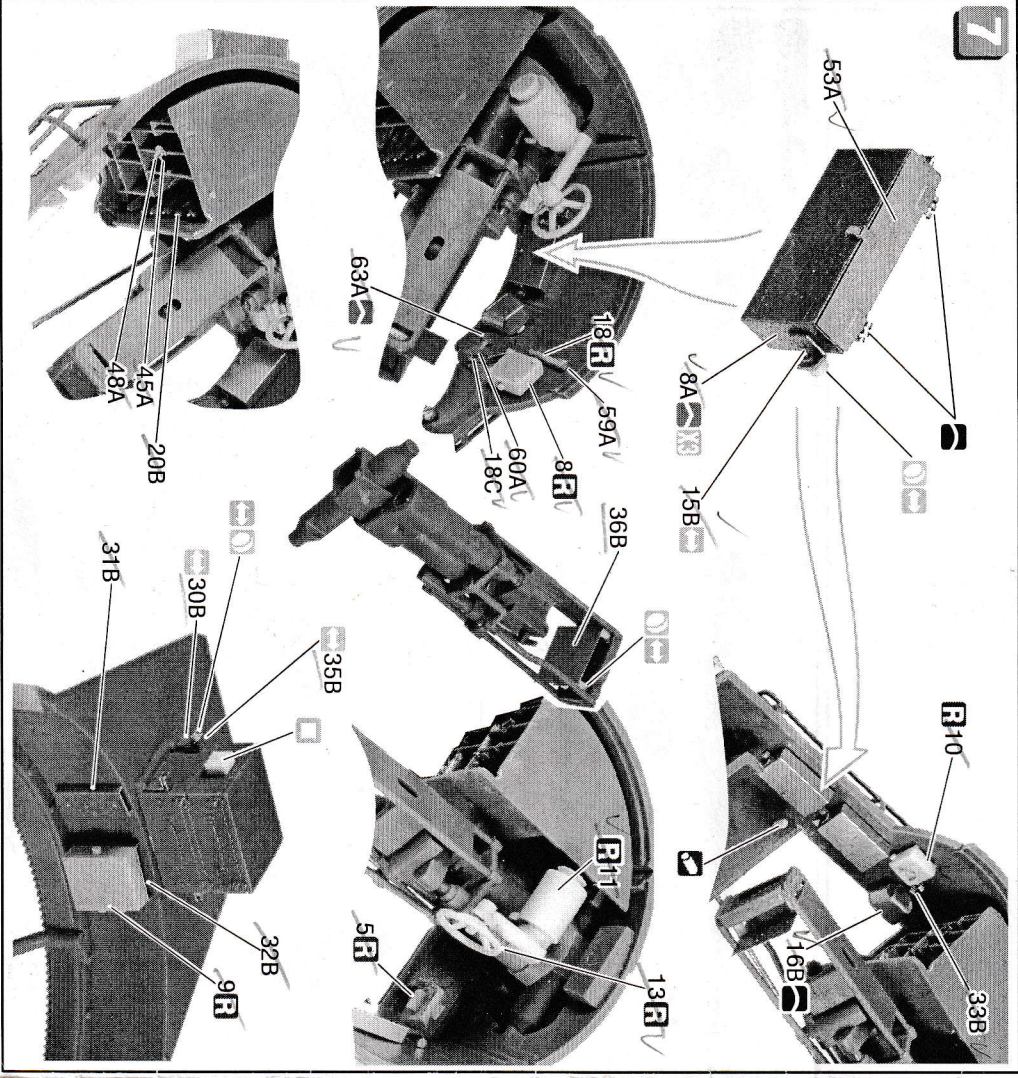
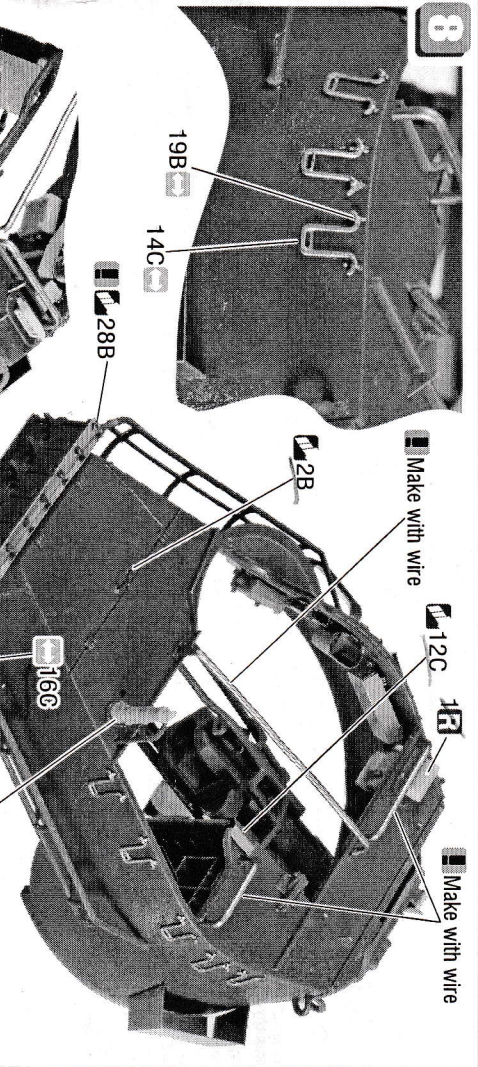
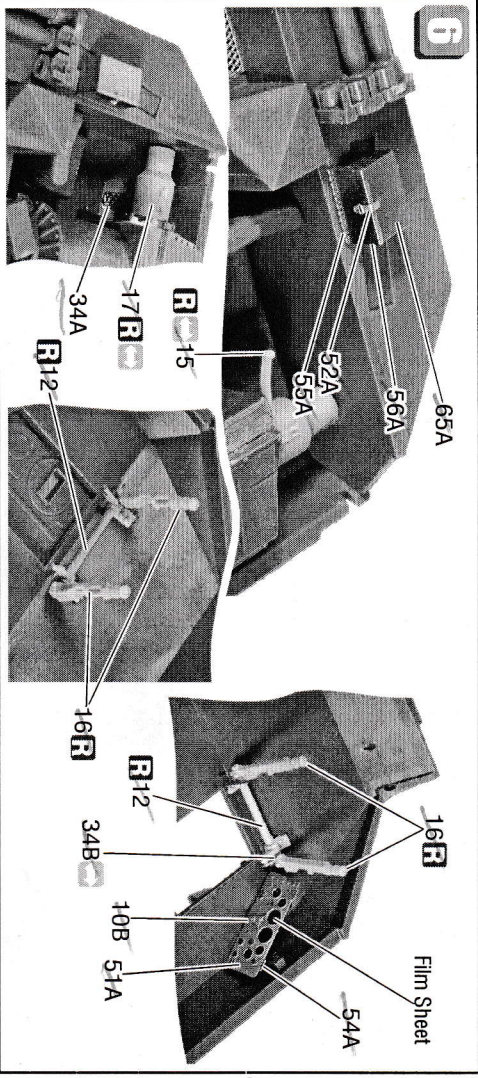

**Wheels painting.**  
 \*Before painting the wheel frame colour the whole wheel black.

Hold template no. 25-24B still in position with finger tips and spray wheel frame with paint of desired colour as shown above.