

Sikorsky MH-60G PAVE HAWK

Copyright 2001 Model Rectifier Corporation
Made in Korea by Academy Plastic Model Co.,Ltd.

#2201/FA203

KIT #200414

1/35th Scale

The Sikorsky MH-60G PAVE HAWK is the U.S. Air Force special operation forces (SOF) and search and rescue (SAR) version of the UH-60L BLACK HAWK helicopter. This version has been modified with the following special equipment :

- Retractable In-flight Refuelling Probe. This enables the PAVE HAWK to have virtually unlimited range, or time on station, by refuelling in-flight from a KC-130 tanker aircraft.
- Weather Radar. This equipment provides partial all weather operation. It will also pick up ships at sea.
- Folding Stabilator. The all-moving stabilator on the tail of this aircraft allows the MH-60G to be quickly folded for air transport, anywhere in the world. On landing, the aircraft can be ready to fly within two hours.
- Internal Auxiliary Fuel Tanks. With these tanks installed and without in-flight refuelling the PAVE HAWK can remain airborne for 4.5 hours.
- External Rescue Hoist. With a 200-foot(60m)length of cable this hoist can lift 600 pounds(270kg).

These additions to the standard BLACK HAWK allow the MH-60G to perform rescues from 17,000-ft(5200m)up the slope of Mt. McKinley in Alaska, USA, to 600 miles off the coast in the teeth of hurricanes, or typhoons. For SOF missions an armament package can be installed, with 7.62 mm Mini guns(Gatting guns) in the Gunner's windows and a .50 caliber(12.7mm)M2 machine gun in each cargo door, for a total of four machine guns. With all this equipment the PAVE HAWK can carry a SOF team for deep insertion behind enemy lines as it did in Desert Storm. Your MH-60G Model can be assembled as a SAR helicopter(Unarmed), Combat SAR(Window mounted Mini guns or M2 machine guns), or SOF operations(window Mini guns and door mounted M2 machine guns).



(USAF Photo)

Reference photos can be found on the U.S. Air Force web site : www.af.mil/photos/

Specifications

Rotor Span.....53.7 feet (16.4m)
Height.....16.8 feet (5.1m)
Maximum Weight.....20,250 lbs (9185.4 kg)
Armament.....Two 7.62 mm Mini guns,

Length.....64.8 feet (19.8m)
Empty Weight.....10,649 lbs (4830.4 kg)
Power Plant....Two 1940 shp T700-GE-701C turbo shaft engines
.....Two .50 (12.7mm) M2 machine guns

Performance

Maximum Speed.....182 mph(292.9km/h)
Range.....373 miles (600.3km)

Service Ceiling19,300 feet (5882.6m)
Crew.....Three



シコルスキーMH-60Gペーブ・ホークは、UH-60Lブラック・ホークより発展した米空軍の特殊作戦部隊 (SOF) 及び捜索救難 (SAR) 用機である。以下がMH60Gペーブ・ホークの特殊装備です。

- 引き込み式の空中給油装置。KC-130型給油機からの空中給油により、この給油装置でMH60Gペーブ・ホークがほぼ無制限の航続距離もしくは現場の滞空時間を持つことを可能とする。
- 気象レーダー。気象レーダーはほぼ全天候飛行を可能にし、同様に海上にある船舶を探知できる。
- 折り畳み式水平安定板。ヘリコプターの尾部にある全可動式の安定板は、MH-60Gペーブ・ホークを世界中のどこへでも空輸するため簡単に折りたたむ。着陸後、2時間以内に同ヘリコプターの飛行準備を完了出来る。
- 内部補助燃料タンク。この補助燃料タンクの装備により、空中給油なしでも、MH-60Gペーブホーク・ヘリコプターは4時間も滞空できる。
- 外部救難吊り上げ装置。200フィート (60メートル) 長のケーブルを持つ同装置は、600ポンド (270キログラム) を吊りあげることができる。

UH60Lにこれらの装備を追加することで、MH-60Gペーブ・ホークが、米国アラスカにあるマッキンレー山の1万7000フィート (5200メートル) もの高さの峰から、距岸600マイル沖のハリケーンや台風の真っ只中に至る救難の遂行を可能ならしめてくれる。特殊作戦部隊の任務には、銃座用手窓に装備する口径7.62ミリのミニガン (ガトリング銃) およびカーゴ・ドアの双方に装備する50口径 (12.7ミリ) のM2型機関銃の合計4挺の機関銃を装備できる。MH-60Gペーブ・ホークは、これらの装備とともに特殊作戦1チームを、デザート・ストーム作戦で実施したように敵軍の背後深く送り込むことができる。

MRCの1/35MH-60Gキットは、捜索救難ヘリコプター (非武装)、戦闘捜索救難ヘリコプター (窓に装備されたミニガンもしくはM2型機関銃)、もしくは特殊作戦ヘリコプター (ミニガンを窓に、M2型機関銃をドアに装備) のいずれにも組み立てられます。

参考写真は、米空軍のウェブ・サイト、www.af.mil/photos/で見られます。

諸元 ローター直径.....16.4m (53.7フィート)
 全高.....5.1m (16.8フィート)
 最大離昇重量.....9185.4kg(20,250ポンド)
 武装.....12.7mm 50口径M2 機関銃 X2

全長.....19.8m(64.8フィート)
自重.....4830.4kg(10,649ポンド)
エンジン.....T700-GE-701Cターボシャフト 推力1940shp2基
武装.....7.62mm ガトリング銃 X2

性能 最大速度.....292.9km/h(182mph)
 航続距離.....600.3km (373マイル)

巡航高度5882.6m(19,300フィート)
乗員.....3名

シコルスキー MH-60G フェイブホークは UH-60L ブラックホークから派生、開発된 미 공군의 특수작전부대(SOF) 및 수색구조(SAR)임무용 헬리콥터이다. 페이브호크는 그 운용성상 다음과 같은 다양한 특수 장비 들을 갖추고 있다.

- 공중급유장치의 장착: 이 장비를 통해 KC-130급유기로부터 공중급유를 받을 수 있게 되면서 페이브호크는 거의 무제한에 가까운 항속거리와 체공시간을 얻게 되었다.
- 기상(氣象)레이더: 기상레이더의 도입으로 거의 전천후에 가까운 비행능력을 얻게 되었으며, 동시에 해상에 있는 선박을 탐지해내는 능력도 지니게 되었다.
- 접고 될 수 있는 수평꼬리날개: 페이브호크의 전가동식(全可動式) 수평꼬리날개는 필요에 따라 간단히 접고 펼 수 있는 구조로 되어있어 수송기에 의한 신속 공수전 개시에 유리하다. 또한 착륙 후 2시간이내에 비행 가능한 상태로 준비하는 것이 가능하다.
- 동체 내부의 보조 연료탱크 증설: 이 추가연료탱크 덕분에 페이브호크는 별도의 공중급유 없이도 4시간 반 정도의 체공이 가능해졌다.
- 외부장착식 견인장비의 채택: 길이 200피트(약 60m)의 케이블을 갖춘 이 장치는 대략 600파운드(약 270kg)정도의 무게를 끌어올릴 수 있다.

표준형의 UH-60L 블랙호크에 위와 같은 장비들을 추가, 개조하여 만들어진 MH-60G 페이브호크는, 높은 산악지대의 험준한 능선에서부터 거대한 태풍이나 허리케인의 한복판에 이르러까지 어떠한 악조건 하에도 구조임무를 수행할 수 있는 뛰어난 능력을 발휘한다. 또한 특수작전 임무 시엔 필요에 따라 구경 7.62mm의 미니건(소형 개틀링포) 2정 및 구경 12.7mm의 M2형 중기관총 2정의 무장 패키지를 장비할 수도 있다. 이와 같은 장비를 모두 장비한 페이브호크는 '사막의 폭풍작전' 당시 실증해 보았던 것처럼, 특수작전 1개 팀을 신속 은밀하게 적진 후방 깊숙히 침투하는 임무의 수행이 가능하다.

※ 본 MH-60G의 조립키는 수색구조형(비무장), 전투/수색구조형(창문에 미니건 또는 M2중기관총 장비), 혹은 특수작전형(창문에 미니 건을, 동체 도어에 M2중기관총을 장비)중 어떤 형식이라도 만들 수 있도록 되어 있습니다. 관련 자료를 참고하시거나 각자의 취향에 맞춰 선택 조립하십시오. (참고로, 자료사진은 미 공군의 웹 사이트, www.af.mil/photos/ 에서 보실 수 있습니다.)

〈제원〉 로터직경.....16.4m(53.7피트) 길이.....19.8m(64.8피트) 높 이.....5.1m(16.8피트)
 자체중량.....4830.4kg(10,649파운드) 최대이륙중량.....9,185.4kg(20,250파운드) 엔 진.....T700-GE-701C 터보샤프트엔진(추력1,940축마력2기)
 무 장.....12.7mm 50구경 M2중기관총2정, 7.62mm 미니건(소형개틀링포)2정

〈성능〉 최대속도.....시속 292.9km(시속182마일) 순항고도.....5,882.6m(19,300피트) 항속거리.....600.3km(373마일) 승무원.....3명

Step#1- Main Rotor Assembly 메인로터의 조립

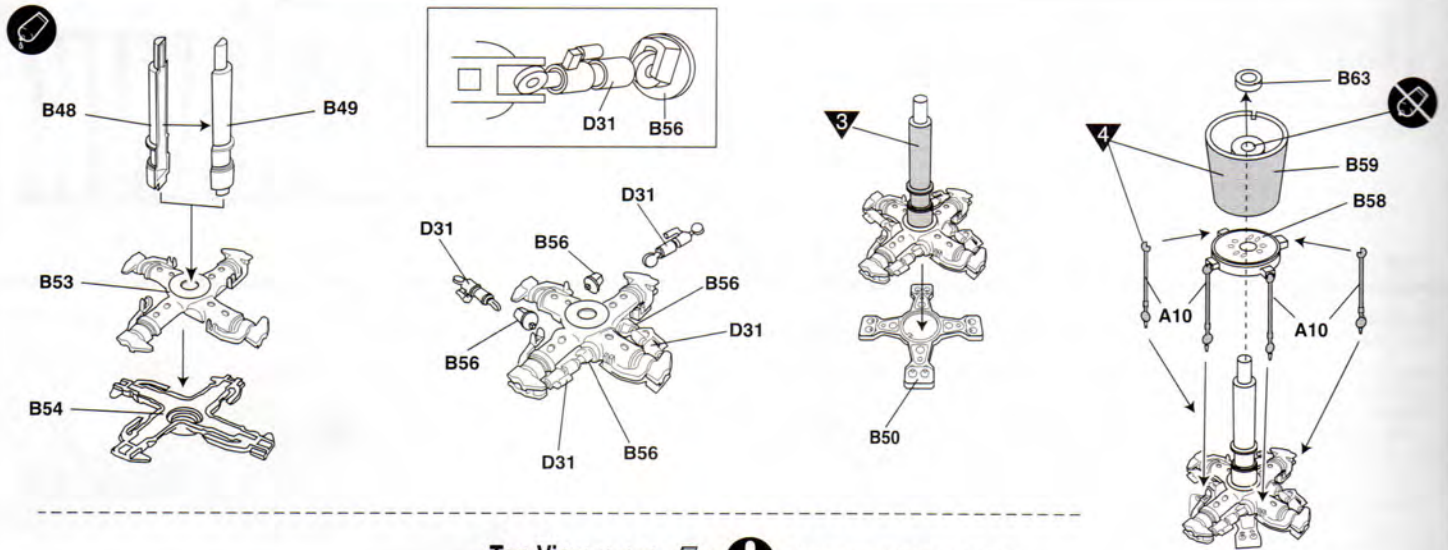

<Top View 상면도>

! *Note rotor rotation direction. 그림의 방향처럼 조립한다.

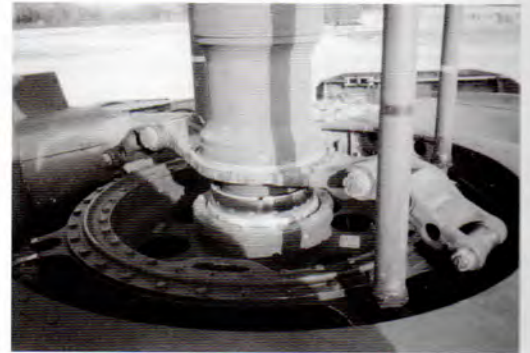
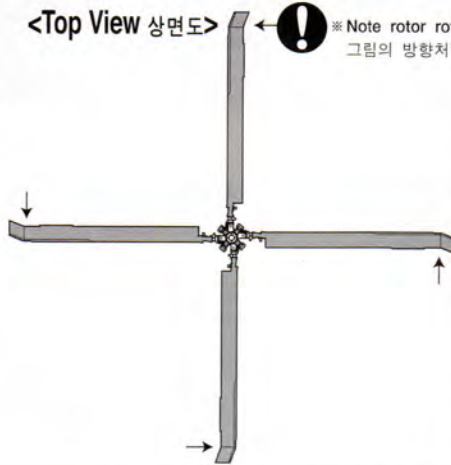
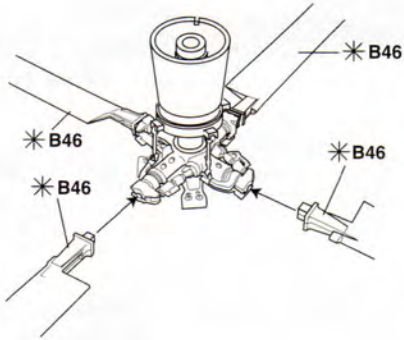

*•Painting Guide/색칠가이드

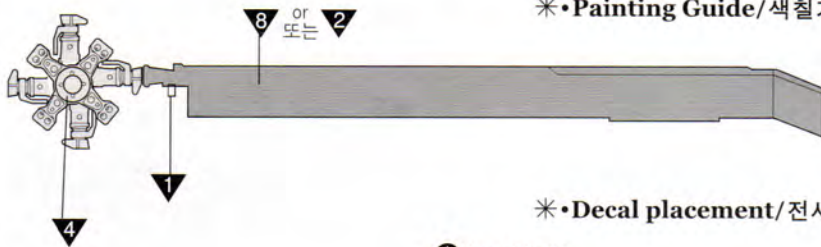

*•Decal placement/전사지위치

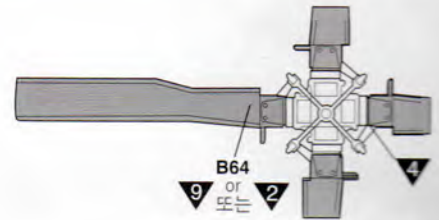
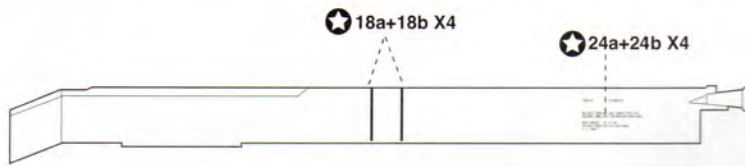

Step#2-Tail Rotor Assembly 테일로터의 조립

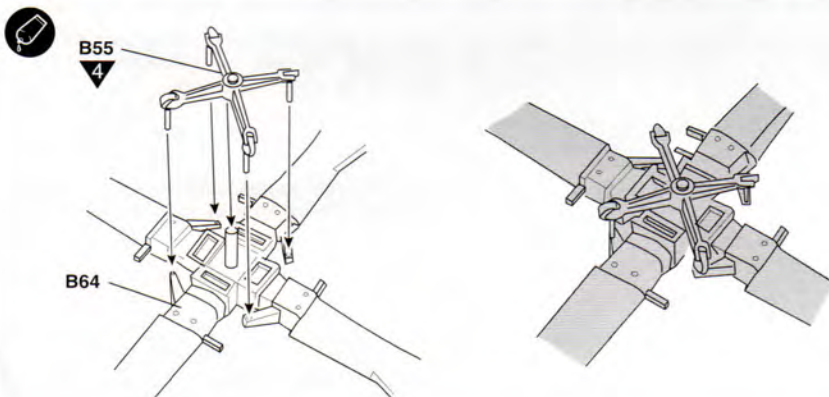

Step#3

Engine Compartment/Ceiling/Turnbuckle Assembly

엔진수납부/내부천장/좌석고정대의 조립

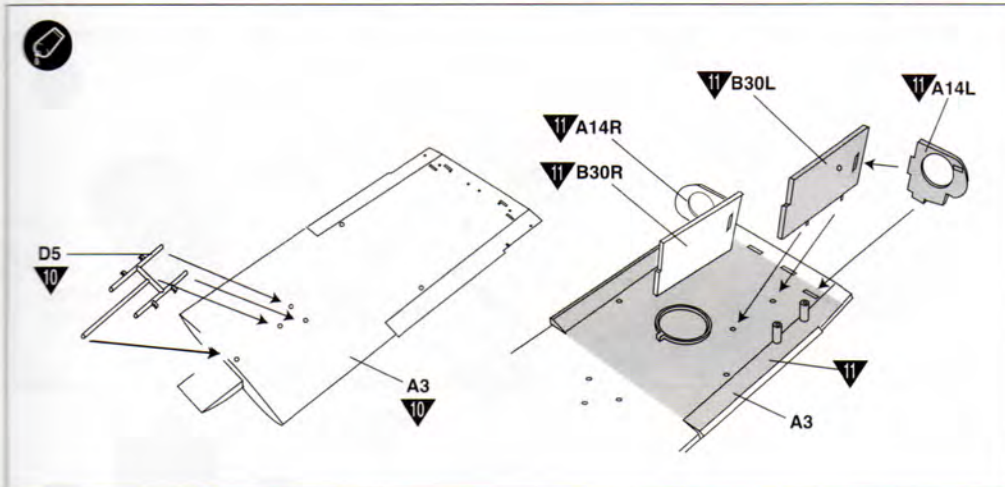

Step#4- Seat Assembly 좌석의 조립

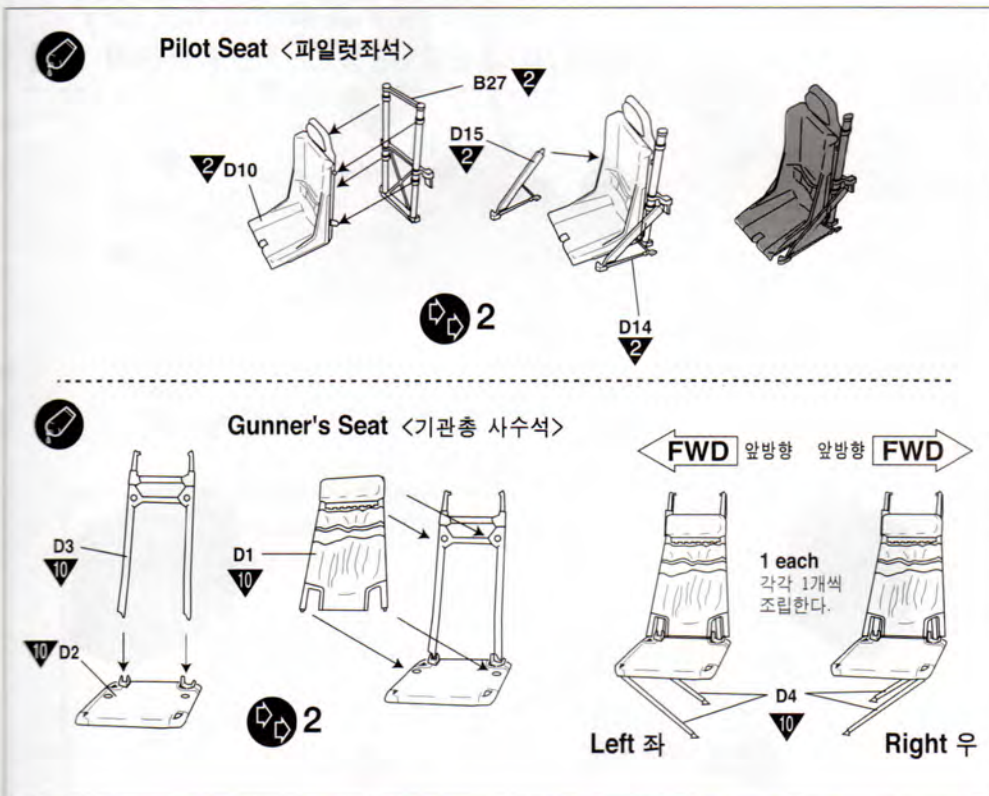

* • Painting Guide/ Decal Placement
색칠가이드/전사지위치

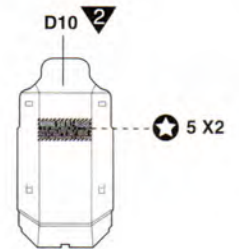

Step#5

Instrument Panel Assembly 계기판의 조립

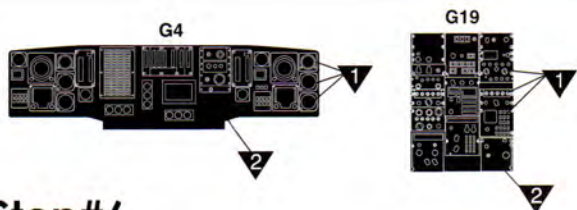
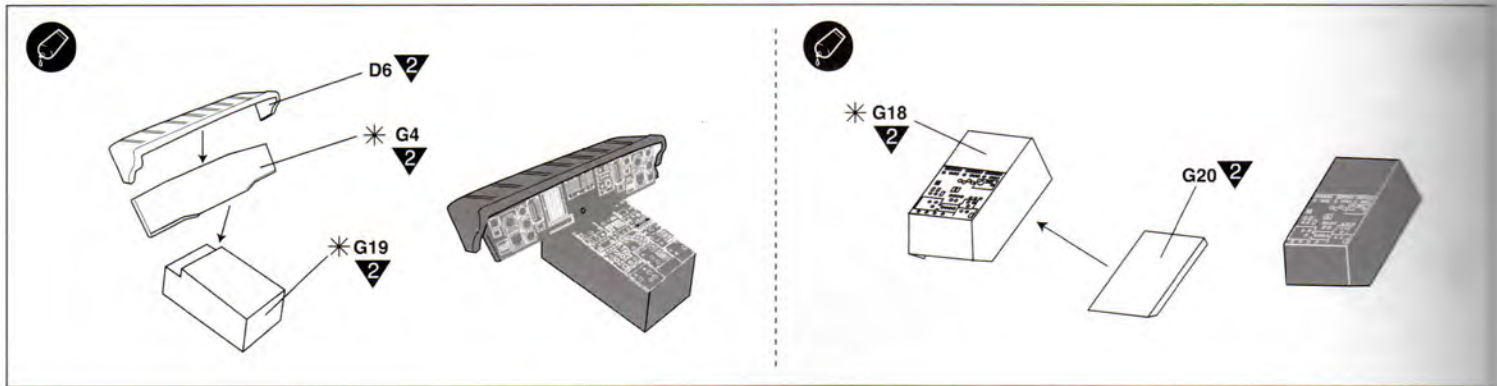

* • Painting Guide/색칠가이드

Flat Black FS 37038/ White FS 17925 details
기본색: 무광검정색/계기류: 유광흰색

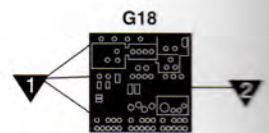

Step#6

Minigun/M-2 Machinegun/Magazine/Auxiliary fuel-Tank-Assembly

미니건/M2기관총/탄통/보조연료탱크의 조립

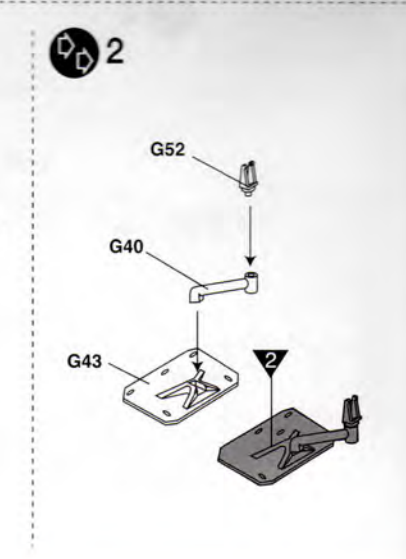
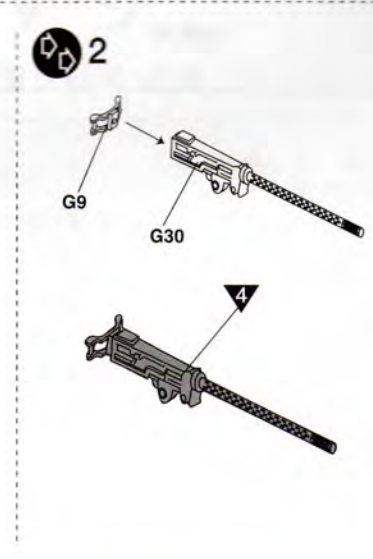
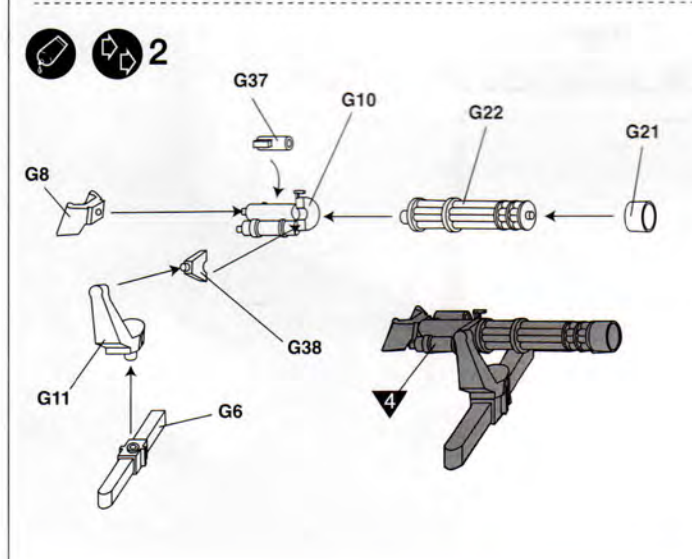
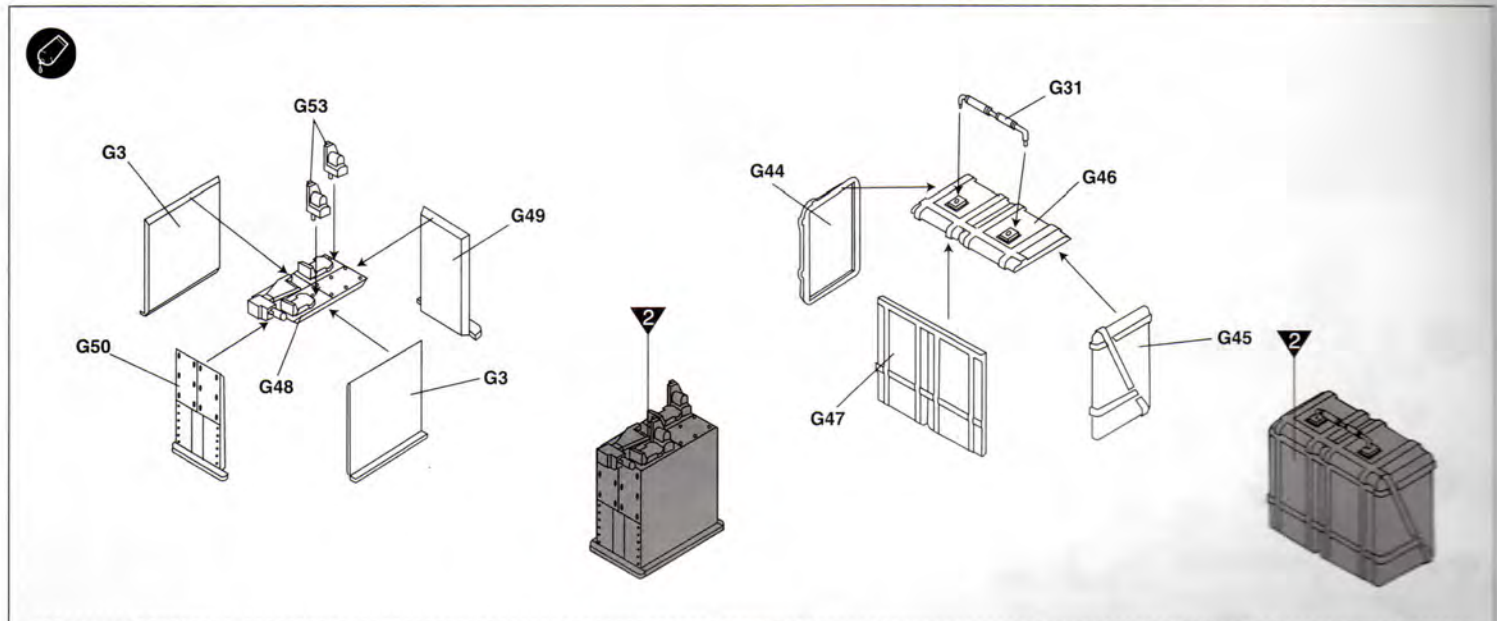

Step #7 Cockpit/Cabin Assembly

조종석/승무원실의 조립

* •Painting Guide/색칠가이드

Overhead consoles 상면계기판(A3)

Flat Black FS 37038/ White FS 17925 details

기본색: 무광검정색/계기류: 유광흰색

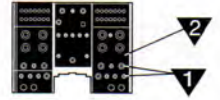

Dotted lines are Part D5 Turnbuckles.
점선으로 표시된 부분은 좌석고정대(D5)를 나타냄.

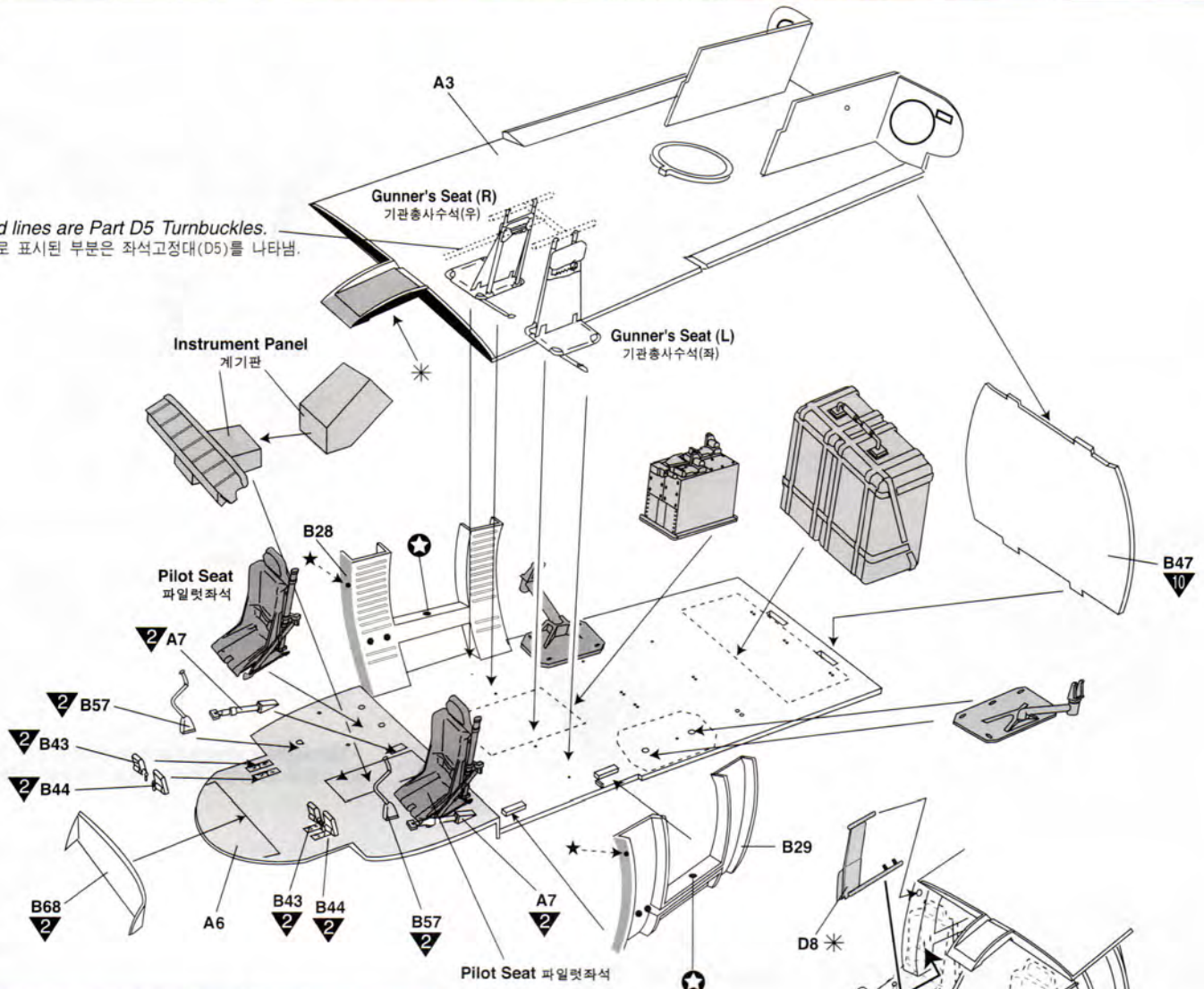

* •Painting Guide/ Decal Placement 색칠가이드/전사지위치

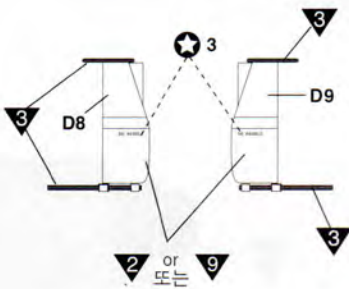

•Painting Guide/색칠가이드

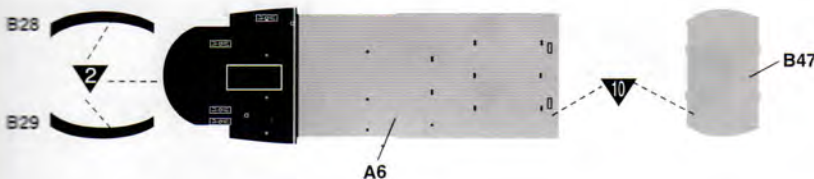

<Top View 뒷모습>

★ •Decal Placement/전사지위치

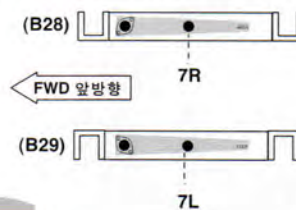

<Front View 앞모습>

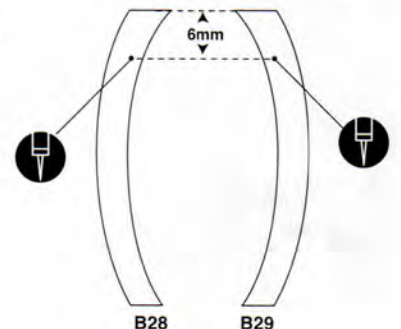

★ Drill hole for Armor Protector.

(Refer to Parts D8 and D9)

그림과 같이 B-28, B-29 부속의 측면에 D8, D9 부속을 끼우기 위한 구멍을 뚫어준다.

Step #8

Engine/Engine Compartment Assembly 엔진 및 엔진수납부의 조립

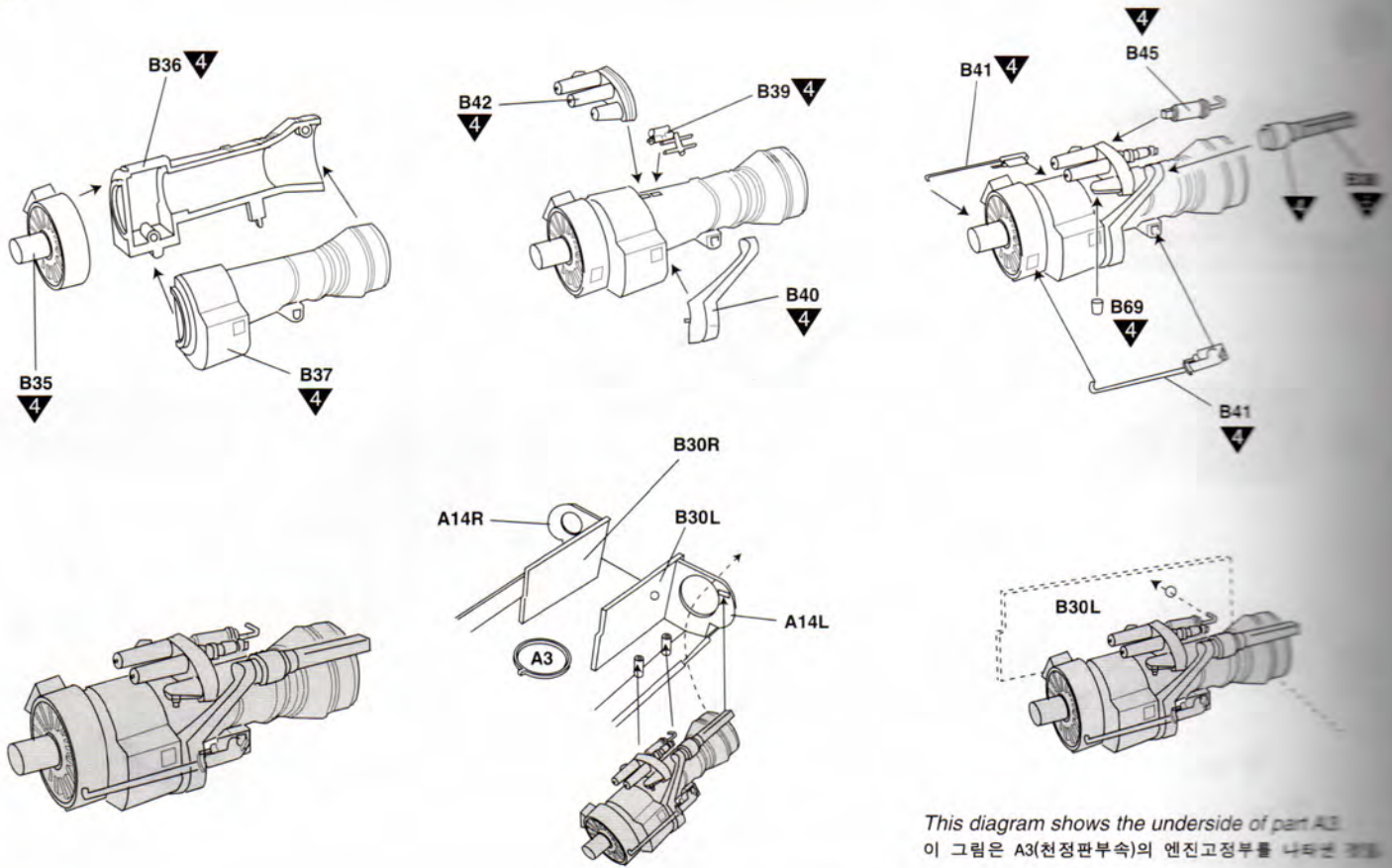

Step#9

Tail Wheel Assembly 꼬리바퀴의 조립

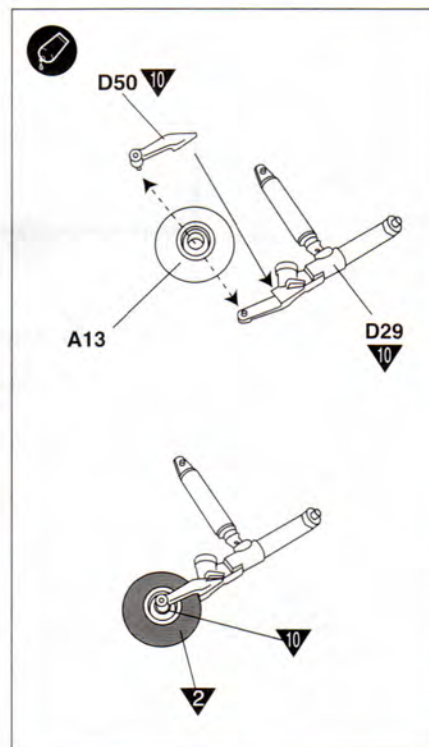
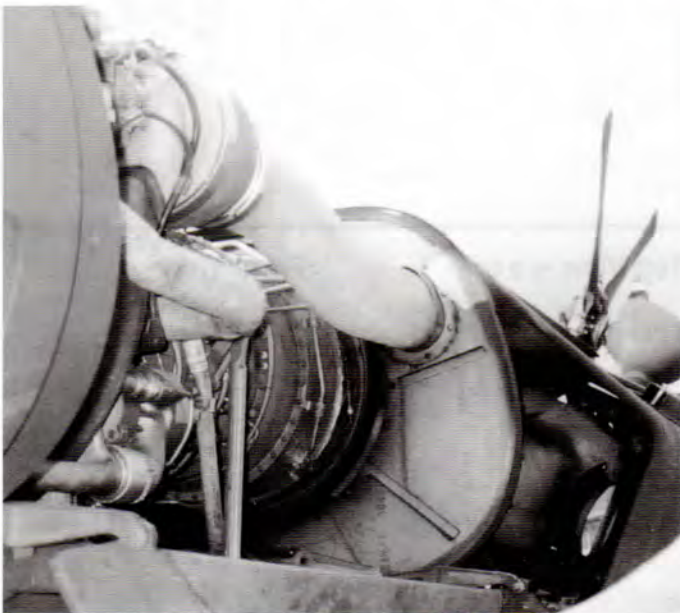

Step#10 Fuselage Assembly

동체의 조립

* • Painting Guide/색칠가이드

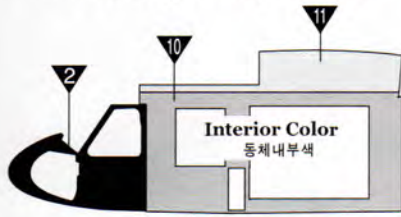

• Decal Placement/전사지위치

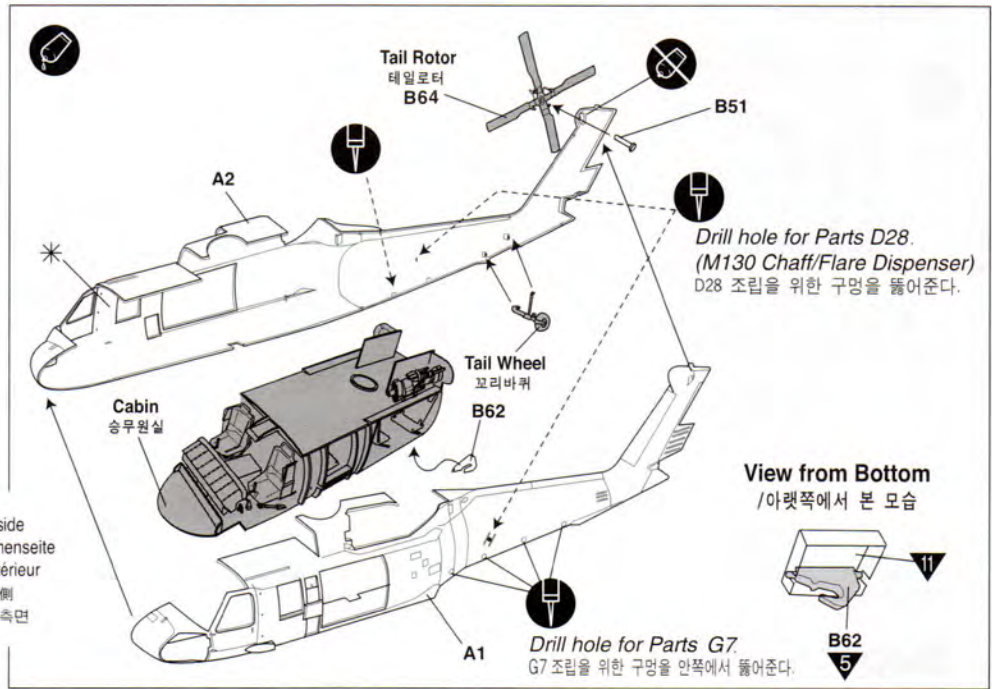
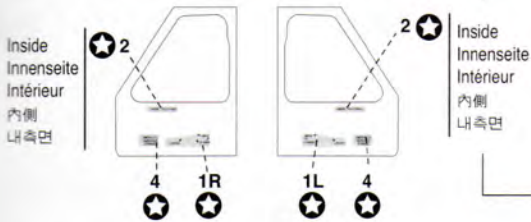

Step#11- Air Intake Assembly(I) 공기흡입구의 조립(I)

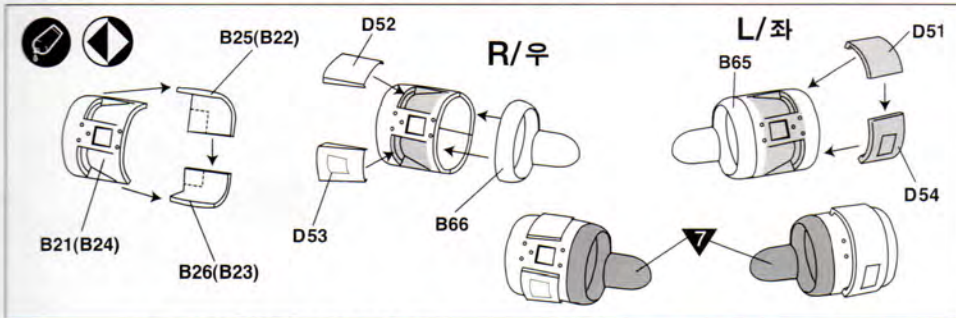

• Left/좌: B21, B25, B26, B66, D52, D53
(Right/우: B24, B22, B23, B65, D51, D54)



Step#12 HIRSS Assembly(I) HIRSS의 조립(I)

HIRSS; Hover Infrared Suppressor System
※ 잔류 적외선억제장치

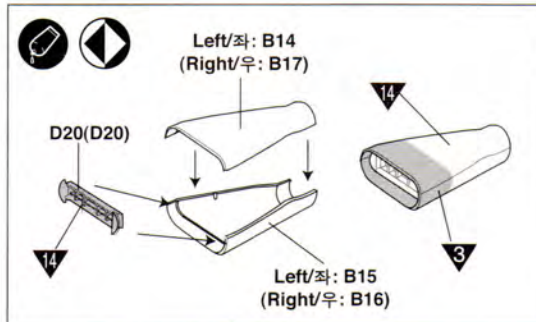

Step #13- Landing Gear Assembly 랜딩기어의 조립

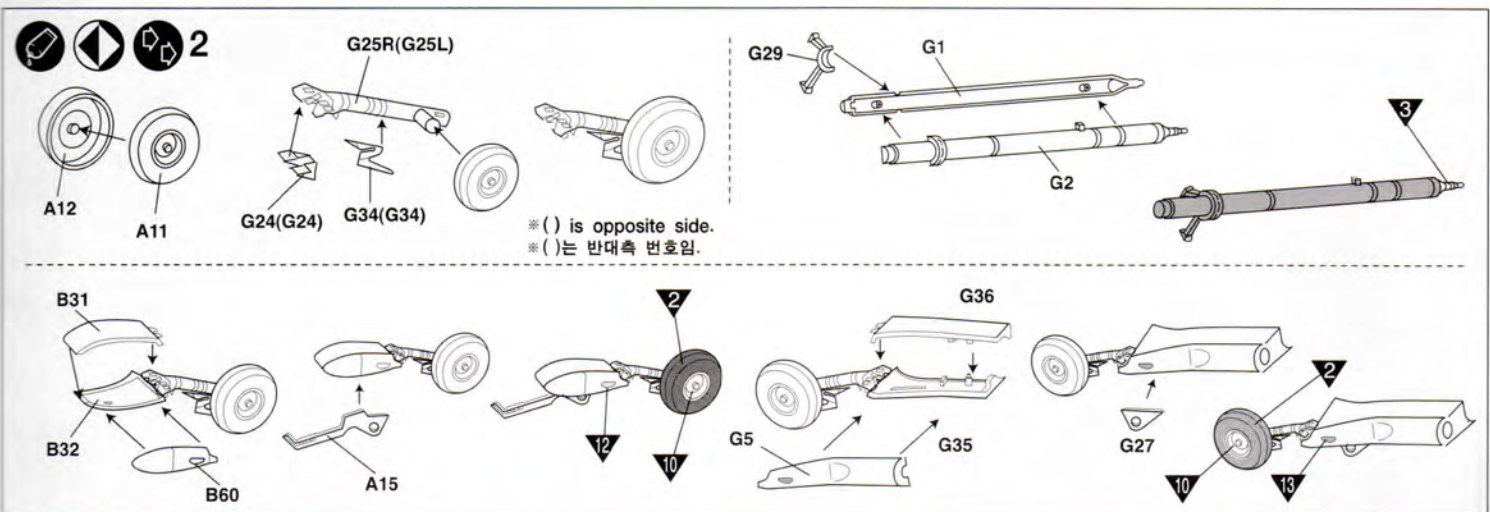

Step#14- HIRSS Assembly(II) HIRSS의 조립(II)

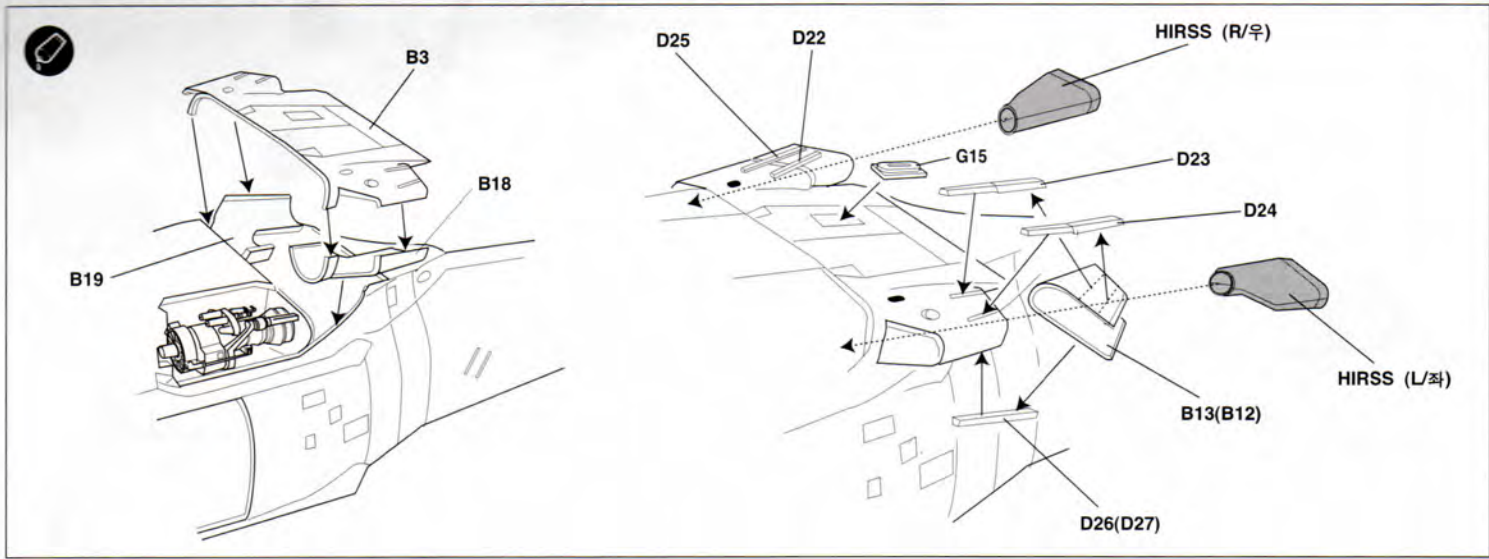

Step#15 Door/Wiper Assembly

문과 와이퍼의 조립

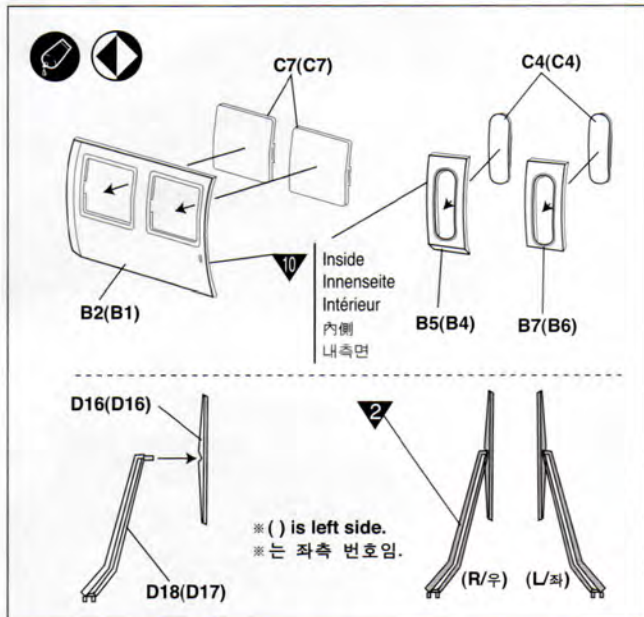

Step#16 Air Intake Assembly(II)

공기흡입구의 조립(II)

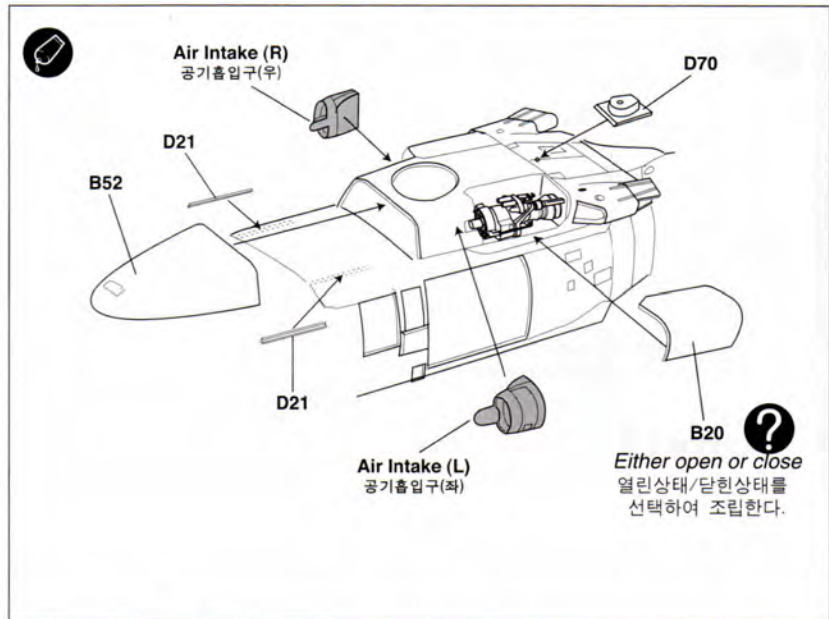

• Painting Guide/ Decal Placement

색칠가이드/전사지위치

(R/우)

(L/좌)

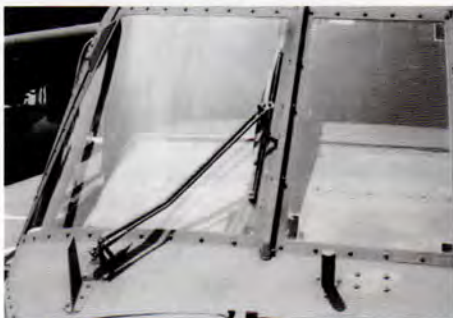
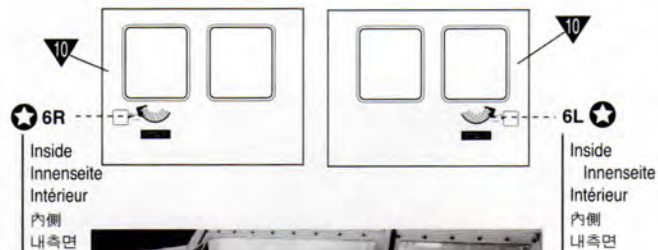

Step#17 IRCM/Hoist/Radome/Satcom Assembly

IRCM/견인장치/레이돔/위성통신안테나의 조립

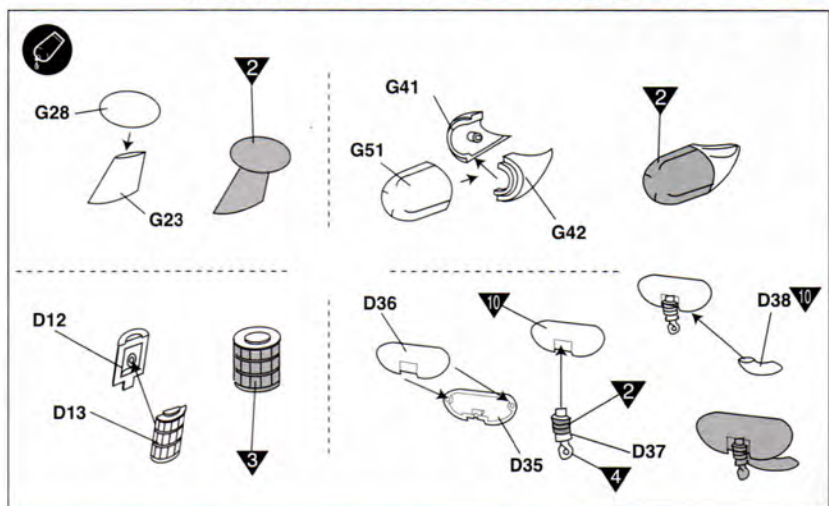

Step#18- Window/Door Assembly 창문/탑승문의 장착

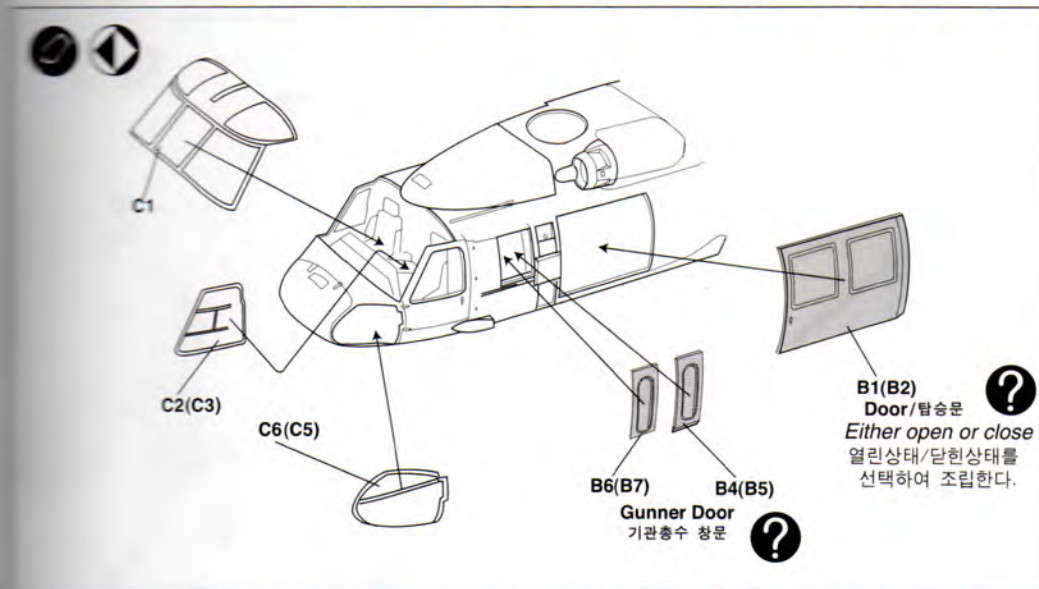

Side View 옆모습

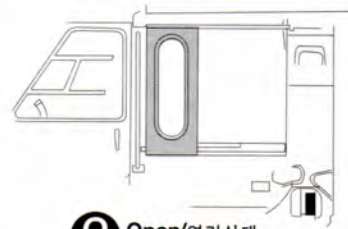
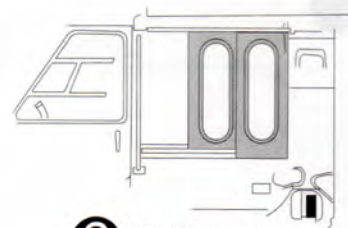

Step#19- Adding Fuselage Details 동체부속의 조립

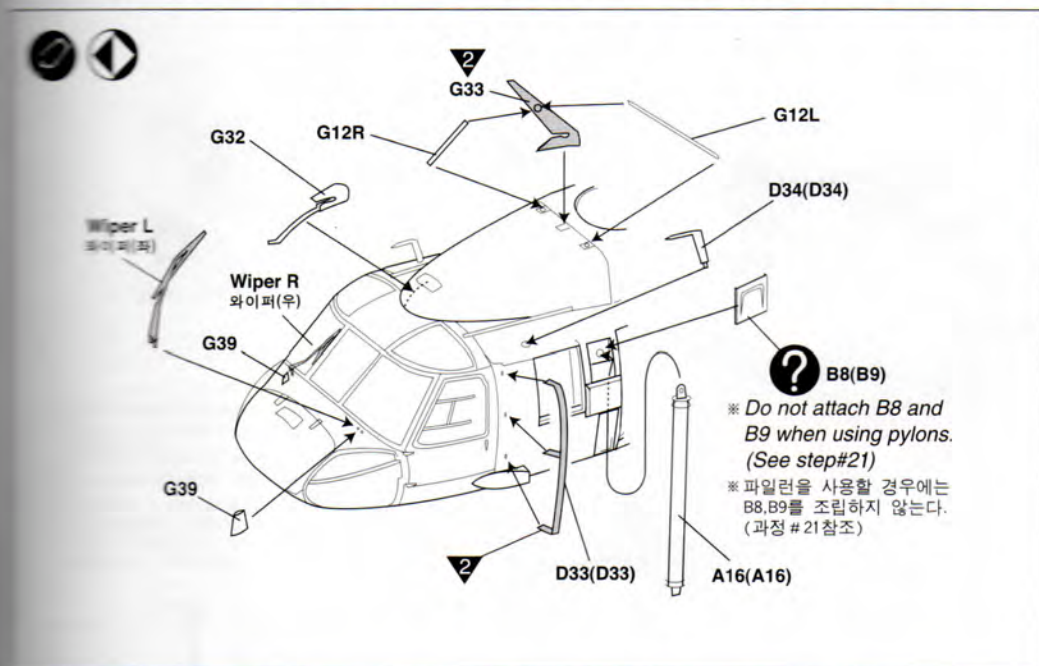

Step#20- Adding Tail Details 꼬리부속의 조립

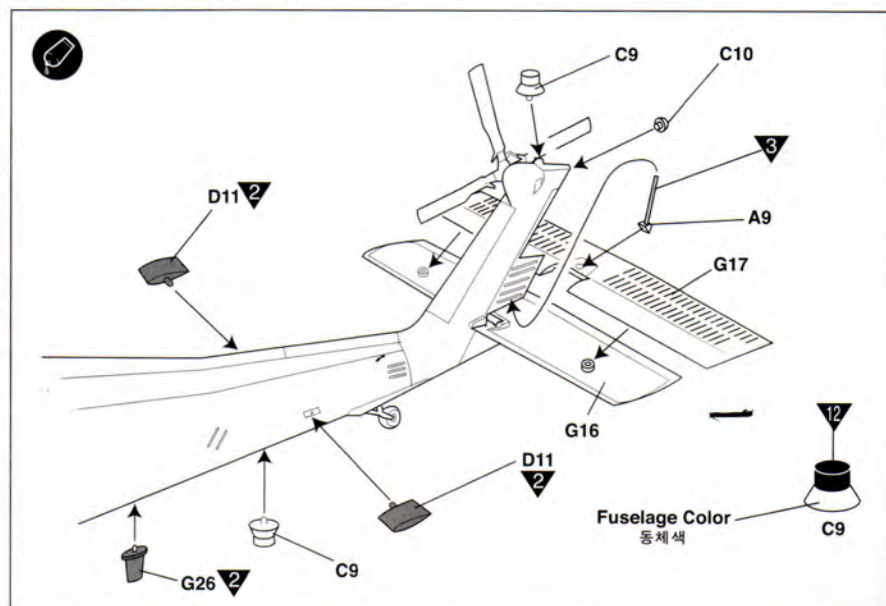

Step#21- Adding the Main Rotor 메인로터 및 장비류의 장착

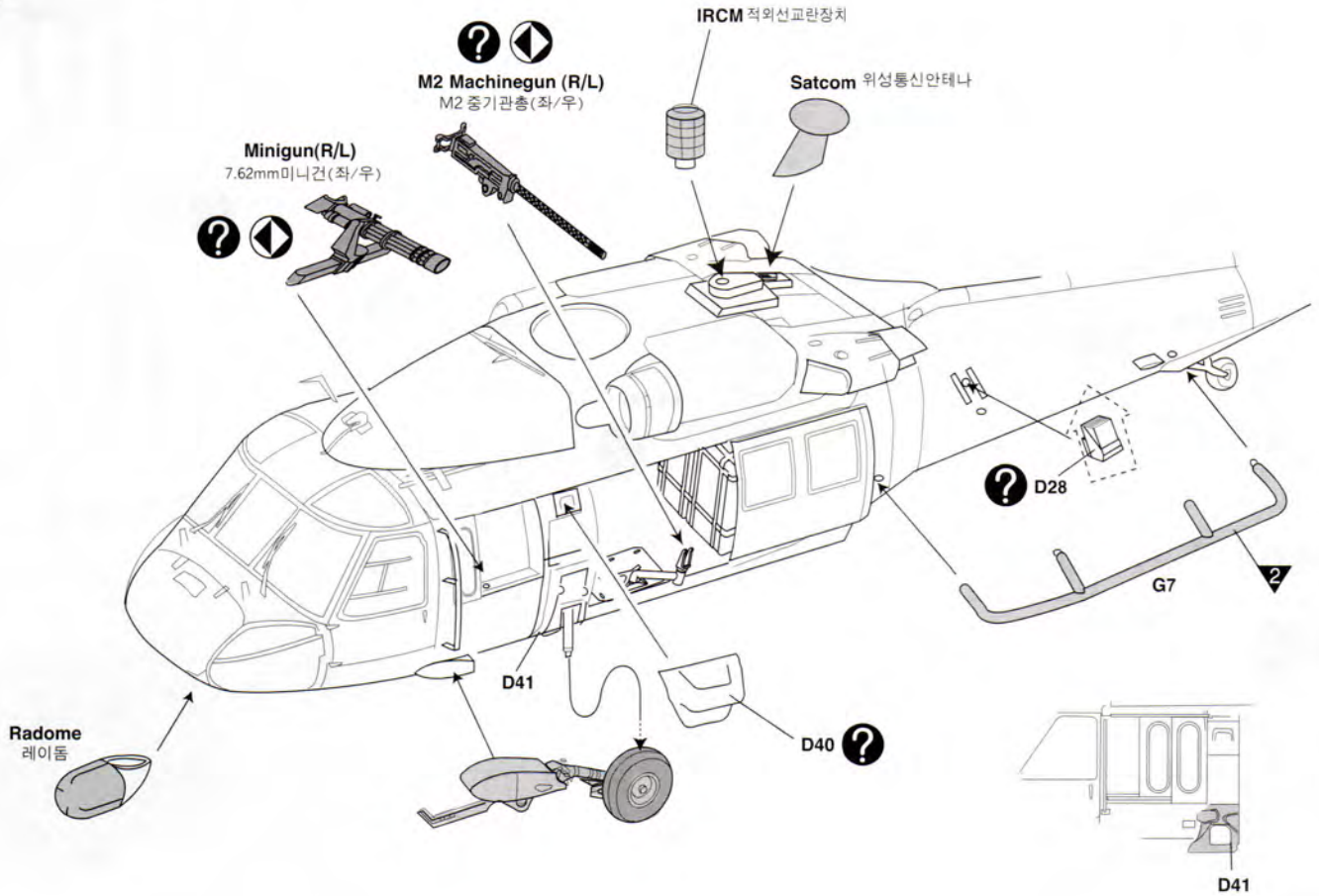

Note the right dispenser (D28) is mounted in downward direction and the left dispenser is mounted in upward direction.
그림과 같이 동체우측의 채프발사기(D28)는 아래쪽으로, 좌측의 발사기는 뒷쪽을 향하도록 장착한다.

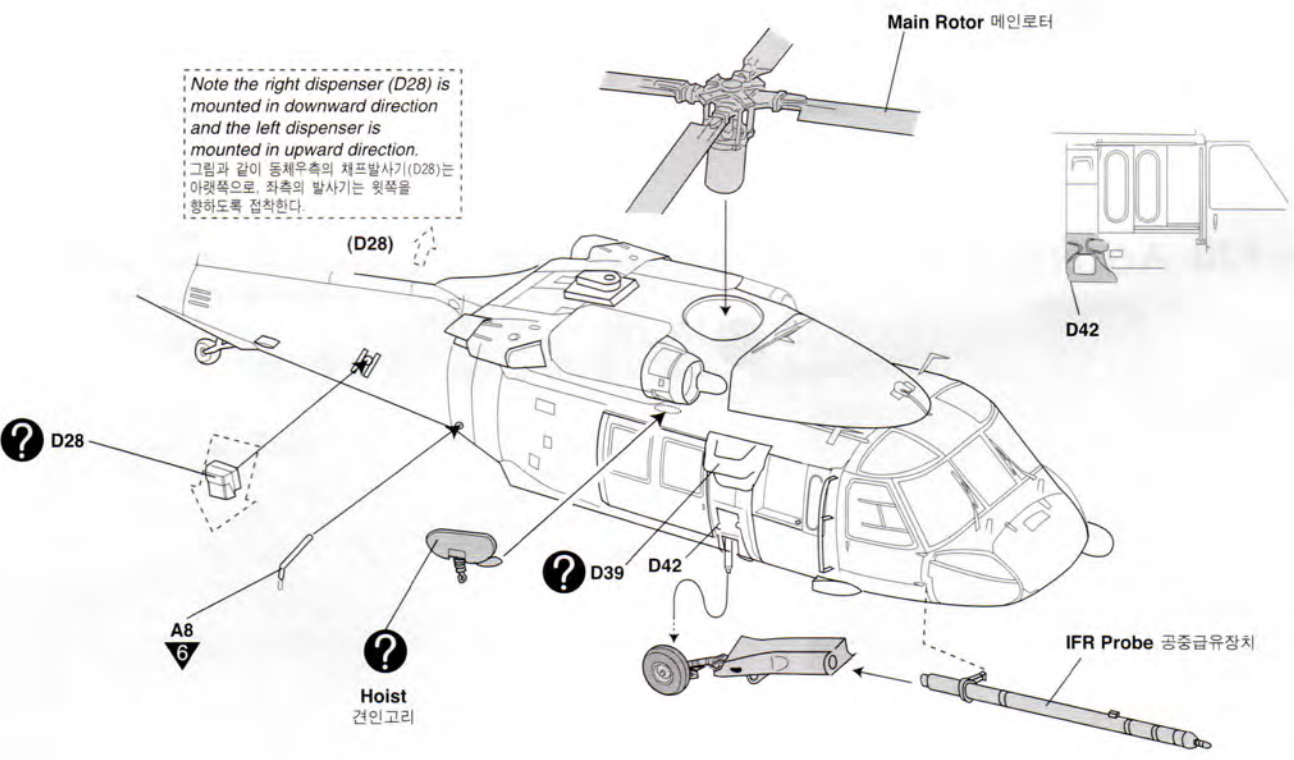

Step#22- Internal Rescue Hoist Assembly 내장형 구조건인장치의 조립

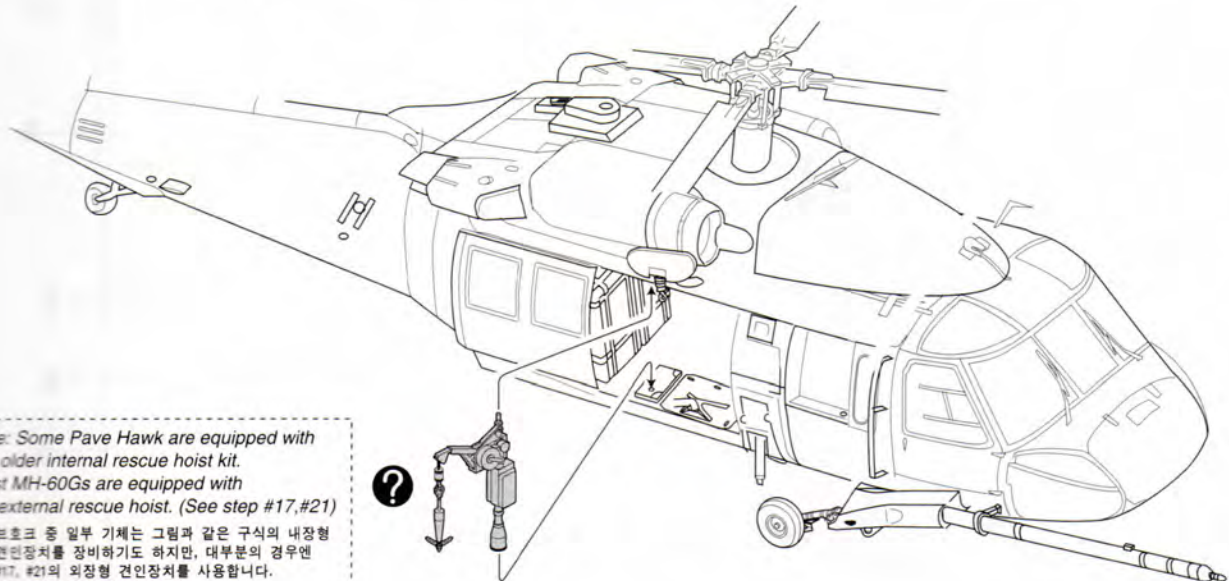
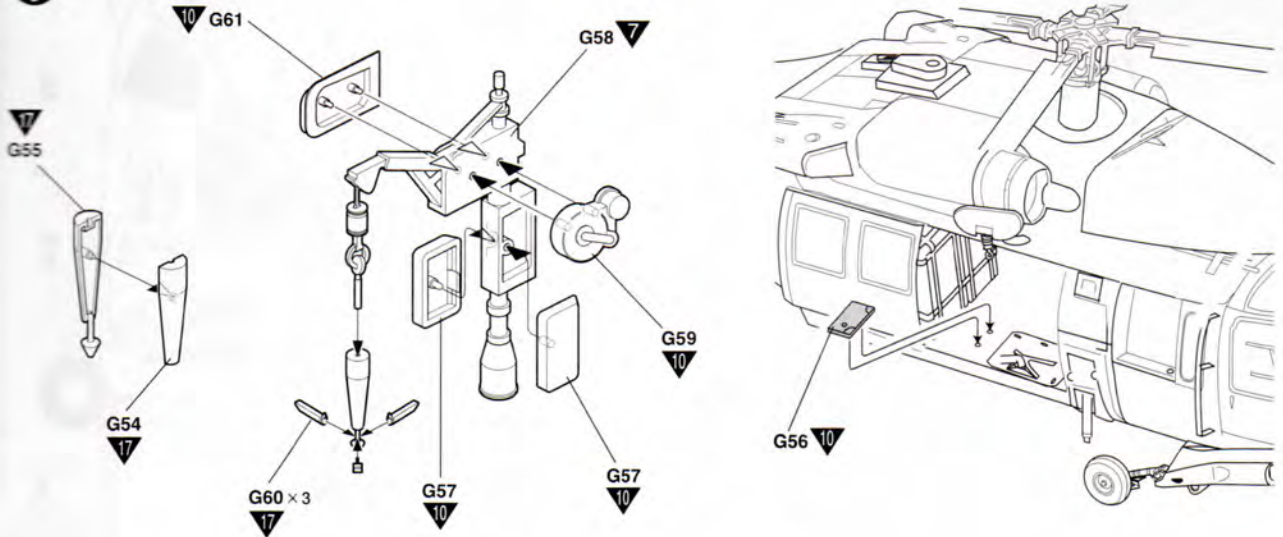

Note: Some Pave Hawk are equipped with this older internal rescue hoist kit. Most MH-60Gs are equipped with the external rescue hoist. (See step #17,#21)
 페이브호크 중 일부 기체는 그림과 같은 구식의 내장형 구조건인장치를 장비하기도 하지만, 대부분의 경우엔 표정#17, #21의 외장형 건인장치를 사용합니다. (해당에 따라 선택 조립하십시오.)

1	WHITE FS 17925	WEISS	BLANC	ホワイト	유광흰색
2	FLAT BLACK FS 37038	MATTSCHWARZ	NOIR MAT	つや消しブラック	무광검정색
3	SILVER	SILBER	ARGENT	シルバー	은색
4	GUN METAL	METALL-GRAU	GRIS ACIER	ガンメタル	건메탈
5	GOLD	GOLD	OR	ゴールド	금색
6	METALLIC GRAY	GRAUMETALLIC	GRIS MÉTAL	メタリックグレイ	흑철색
7	SEMI GLOSS BLACK FS 27038	SEIDENGLANZ SCHWARZ	NOIR SATINÉ	セミグロスブラック	반광검정색
8	DARK GRAY FS 36118	DUNKEL GRAU	GRIS FONCÉ	ダークグレイ	다크그레이
9	OLIVE DRAB FS 34087	BRAUN OLIV	BRUN OLIVE	オリブドラブ	국방색
10	DARK GULL GRAY FS 36231	DUNKEL-MÖWENGRAU	GRIS MOUETTE FONCÉ	ダークガルグレイ	다크 걸그레이
11	YELLOW ZINC CHROMATE FS 33481	GRÜN GELB	VERT JAUNE	イエローグリーン	옐로우그린
12	CLEAR RED	ROT, REIN	ROUGE CLAIR	クリアーレッド	클리어 레드
13	CLEAR BLUE	BLAU, REIN	BLEU CLAIR	クリアーブルー	클리어 블루
14	METALLIC SILVER (= 40%+ 60%)	SILBER METALLIC	ARGENT METALLIQUE	メタリックシルバー	메탈릭실버
15	MIDIUM GREEN FS 34102	MITTEL GRÜN	VERT MOYEN	ミディアムグリーン	미디엄그린
16	DARK GREEN FS 34092	DUNKEL GRÜN	VERT FORCÉ	ダークグリーン	다크그린(유토피안그린)
17	YELLOW	GELB	JAUNE	イエロー	유광노랑색

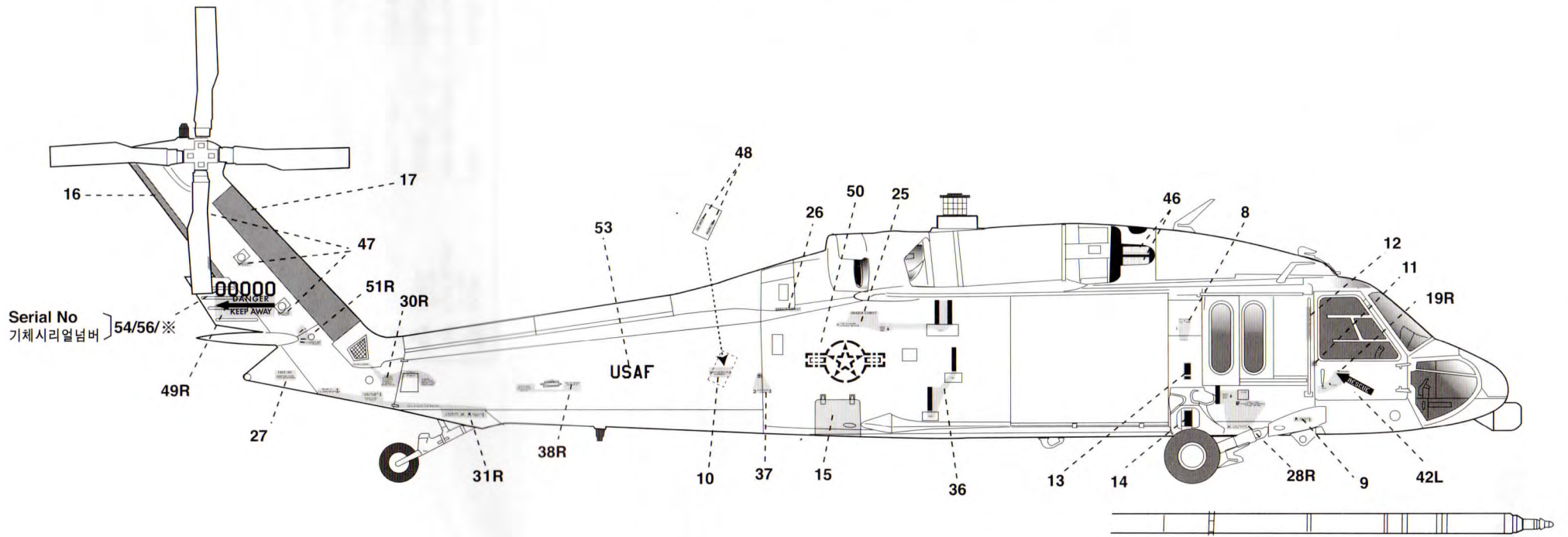
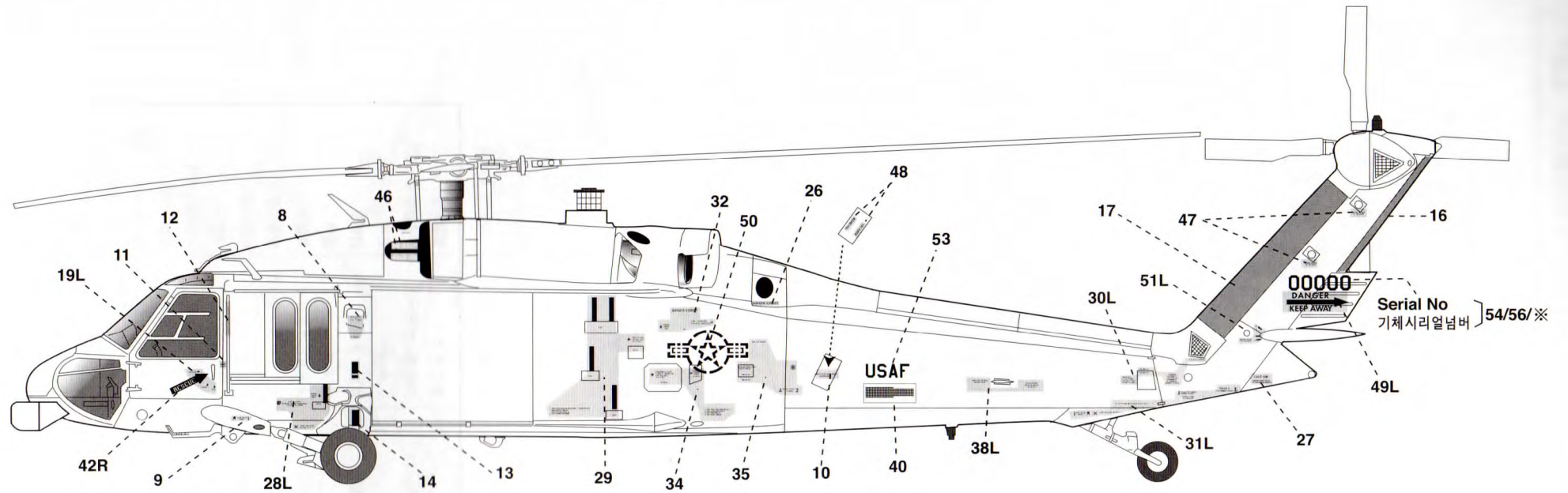

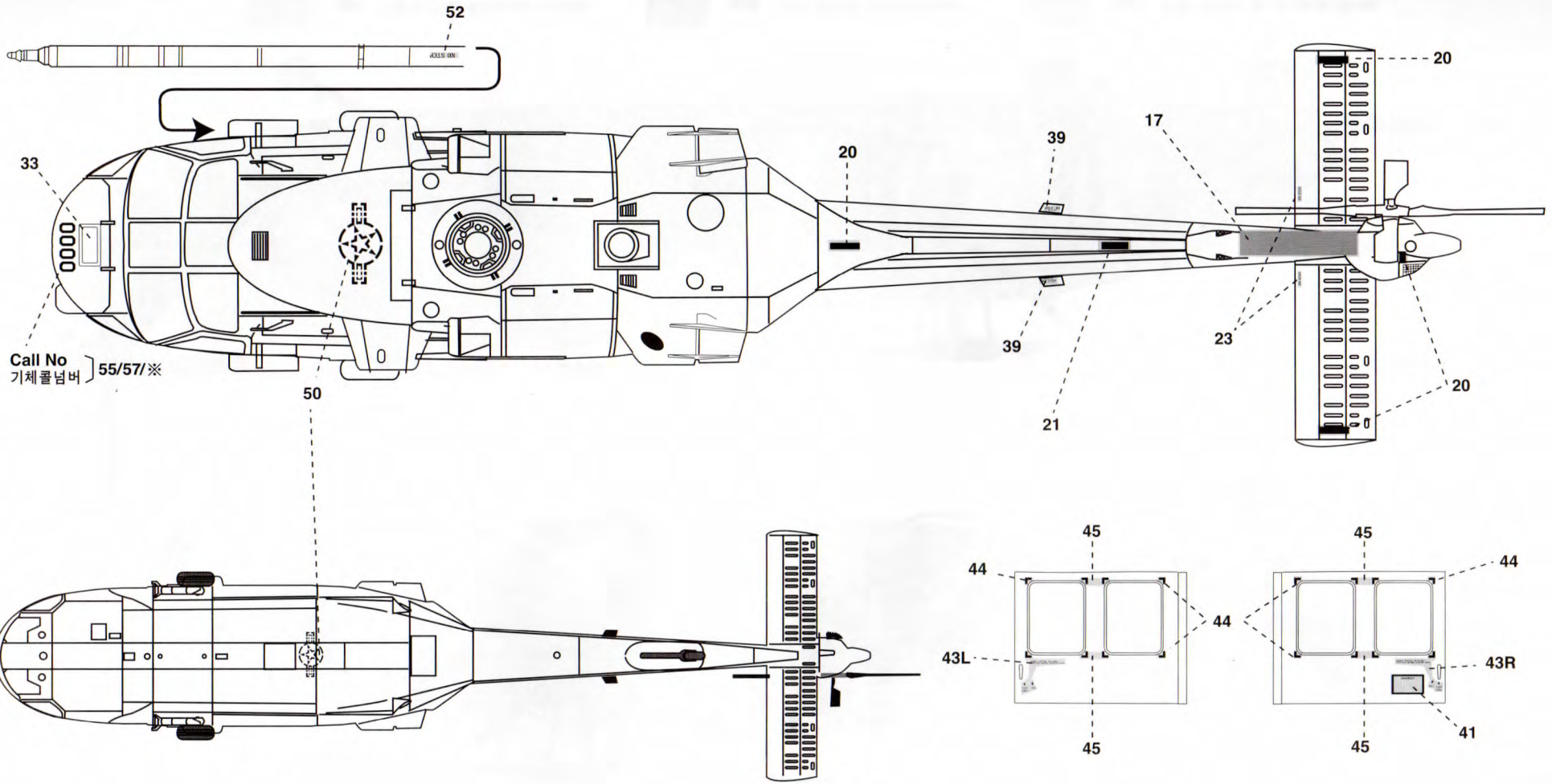

Call No
기체콜넘버 } 55/57 ※

점착한다.
Cement parts
Coller
Kleben
Pegar
Incollare
Collar
Kleben

점착하지 않는다.
DO NOT cement
Ne pas coller
Nicht kleben
No pegar
Non incollare
Nao colar
Niet kleven

3 수만큼 조립한다.
Repeat operation
Répéter l'opération
Vorgang wiederholen
Repitir la operación
Répeter
Repitir a operação
Herhalen

★ 전사지를 붙인다.
Decals
Dcalcomanies
Abziehbild

9 무게추를 넣는다.
Add weight
Lester
Gewicht

구멍이나 홈을 메워준다.
Use filler
Mastiquer
Schleifen

잘라낸다.
Cut away
Couper
Schneiden
Cortar
Tagliare
Cortar
Snijden

? 선택한다.
Optional parts
Choix
Auswahlmöglichkeit
Eleccion
Scelta
Opcao
Keuze

반대쪽도 조립한다.
Repeat for opposite side
Répétition de la page
Wiederholung für gegenüberliegende Seite

□ 구멍을 뚫어준다.
Make hole
Faire un trou
Öffnen

! 주의한다.
Be careful
Faire attention
Hier Vorsicht

색칠 및 전사지 붙이기 번호
Painting scheme number
Numeros de la liste de pe-ñures
Lackierschemanummer

Exterior Finishes Applicable to United States Air Force MH-60G

미공군 소속 MH-60G 페이브호크의 외부 위장무늬 패턴

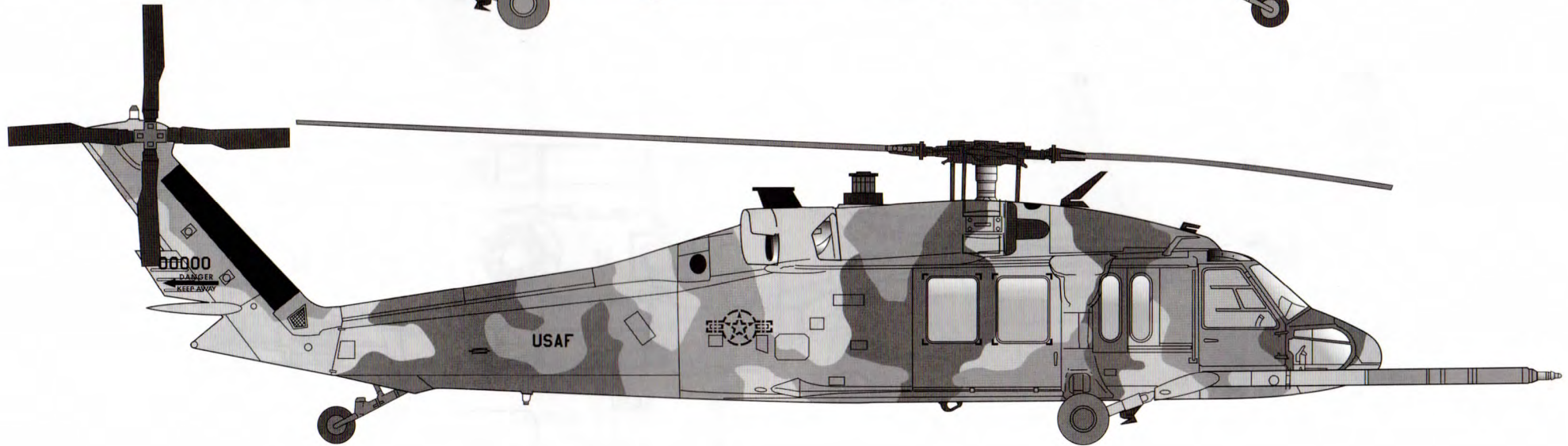
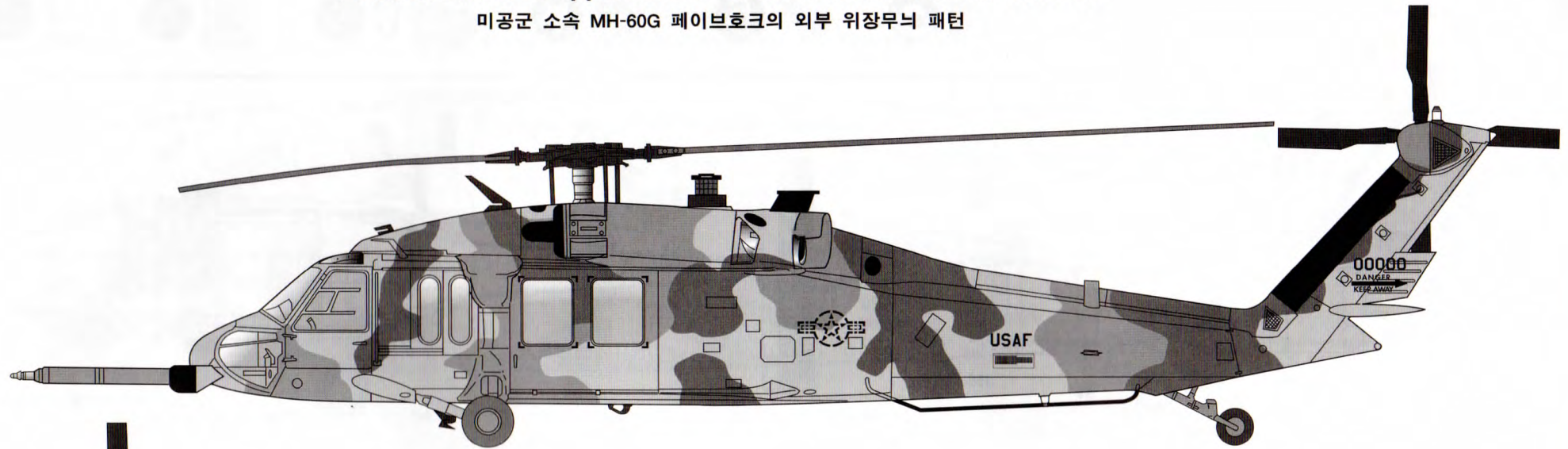

15 FS 34102 Midium Green
미디엄그린

16 FS 34092 Dark Green
다크그린

10 FS 36231 Dark Gull Gray
다크걸그레이

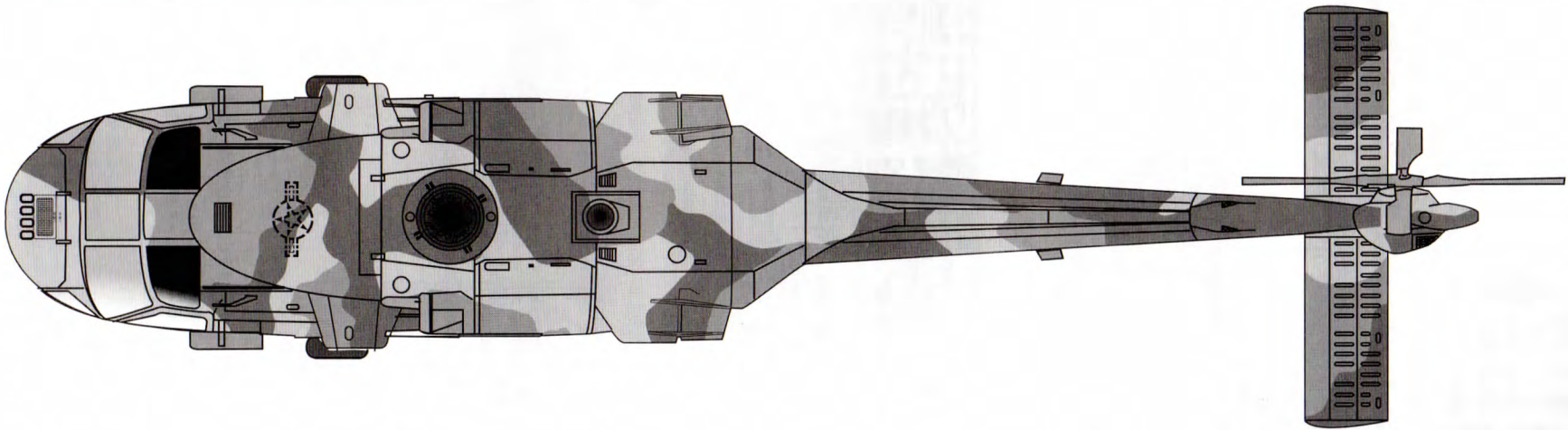
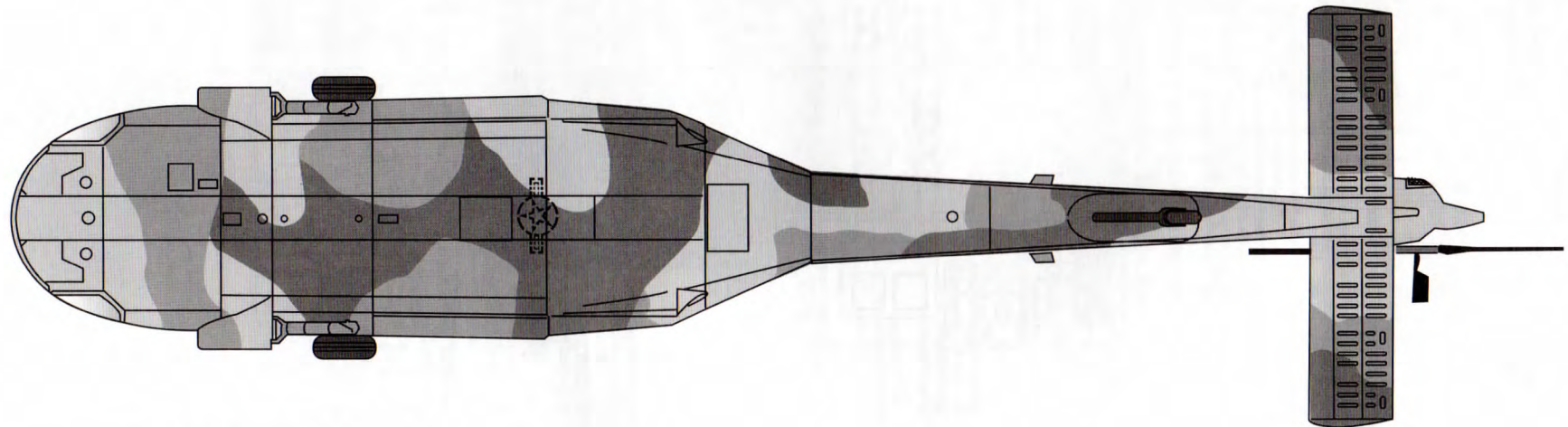

15 FS 34102 Midium Green
미디엄그린

16 FS 34092 Dark Green
다크그린

10 FS 36231 Dark Gull Gray
다크걸그레이

PARTS LOCATING DIAGRAM



"Realism in the right scale"

ACADEMY

HOBBY MODEL KITS

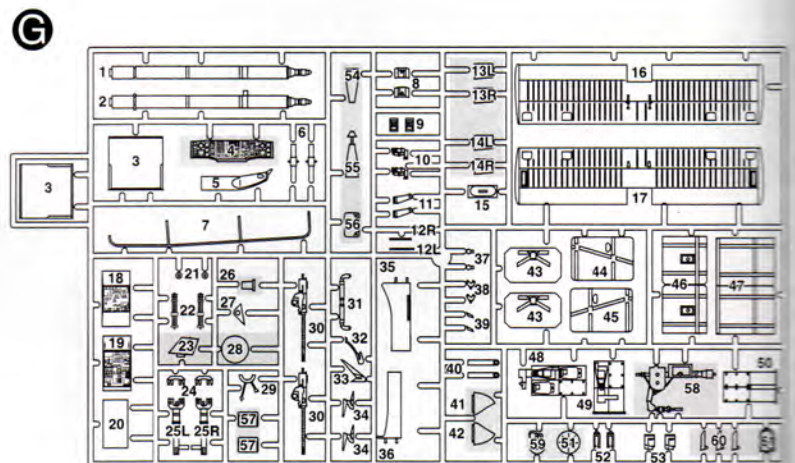
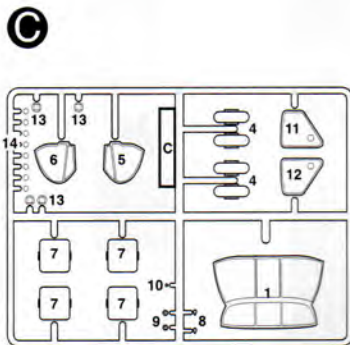
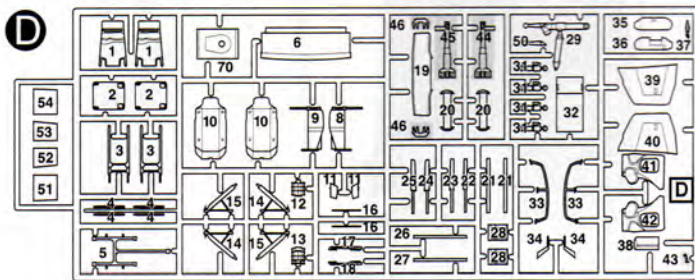
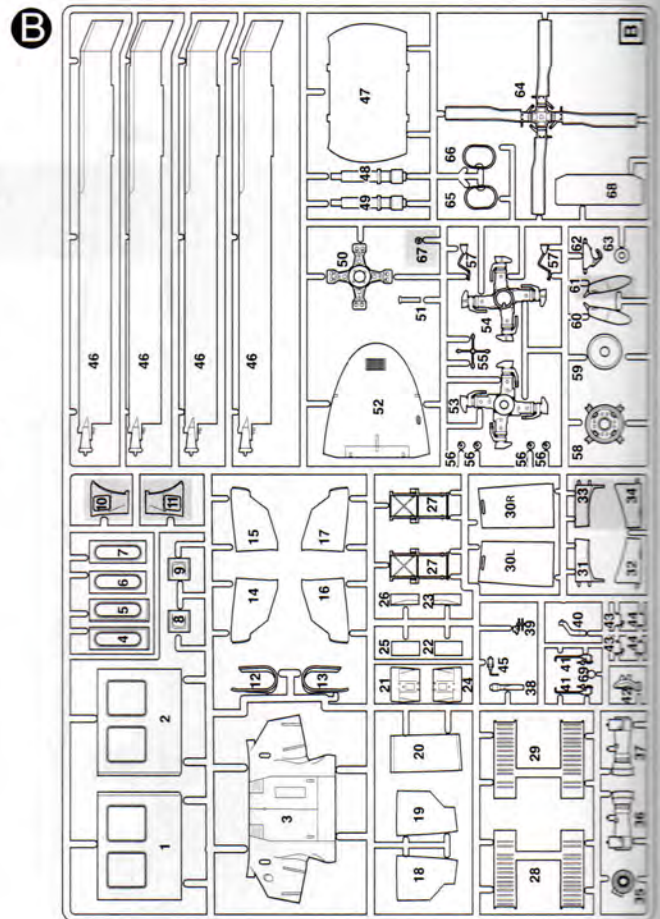
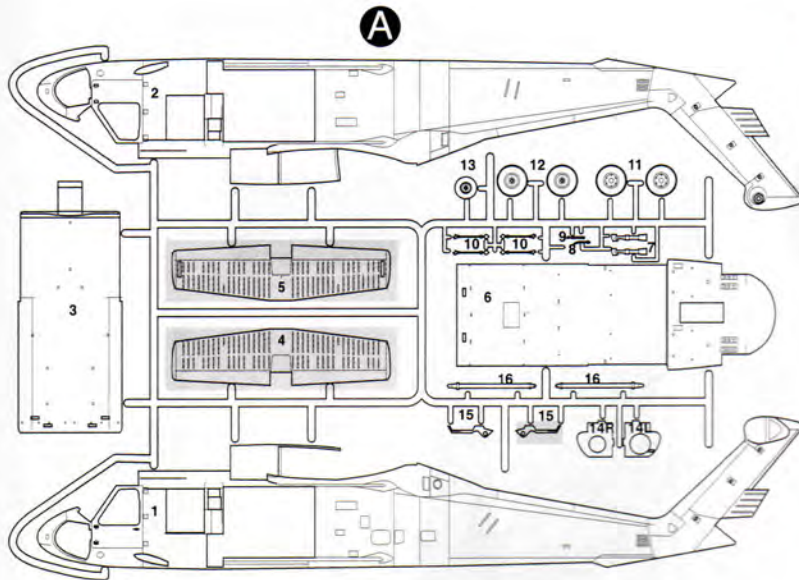

- Unused parts : A4, A5, A15×1, B10, B11, B33, B34, B61, B67, C8, D43,
- Nicht verwenden D44, D45, D46, G13L, G13R, G14L, G14R, C13, C14
- Pièces non utilisées
- 不要部品
- 불필요 부품

- 직매점 겸 A/S센터 : 삼선교: 742-9293, 방배동: 552-9293, 양재동: 575-9997, 용산: 796-1214, 아셈하비센터: 6002-6293, 구로하비나라: 853-9293
- A/S센터 : 본사: 908-7000(교환 147), 동대문: 745-9293, 천호동: 473-9293
- 총판점 겸 A/S센터 : 노원아카데미: 907-0940, 양천아카데미: 691-7108, 강북아카데미: 762-0980, 강남아카데미: 485-8884, 경기아카데미: (031)458-5591, 서면아카데미: (051)816-9773, 대구아카데미: (053)744-9293
- 유통사업부 : 아카데미피옌디: 586-9293
- 홈페이지 : <http://www.academy.co.kr>
- ♣ 고객센터문의 : 080-969-7000

ACADEMY ACADAMY PLASTIC MODEL CO., LTD.
273-64, Suyu-dong, Kangbuk-gu, Seoul, Korea
TEL: 82-2-908-7000 FAX: 82-2-997-3003