

# B-24D Ploesti Raider



The B-24 Liberator was used in every theatre of operation in World War II and produced in greater quantities than any other aircraft in history. The B-24 evolved through its service life beginning as a heavy bomber and was the longest-range heavy bomber in United States Army Air Force inventory.

This model kit represents the early B-24D variant as used during the allied air attack on Axis oil refineries in Ploesti Rumania. On August 1, 1943, 177 Ninth Air Force B-24s dropped 311 tons of bombs from low level on the oil refineries at Ploesti, Romania, during Operation Tidal Wave.

The United States Army Air Force introduced the concept of daylight strategic bombing early in World War II. The strategy was designed to destroy enemy armament production and raw materials needed to conduct modern warfare like ammunition, gasoline and lubrication oil. The oil refineries in Ploesti Rumania were recognized to be a key Axis oil production facility. Several raids were conducted and German and Rumanian forces took significant defensive measures to protect this vital facility. The Ploesti raid of August 1 1943 was one of the largest and most costly raids conducted in early WWII. Results were mixed and costs were high but the raid did reduce refining capacity of this key facility. Later raids were conducted which in time seriously crippled Axis oil production and significantly contributed to the defeat of Axis forces in Europe.

Three decal options are offered in this kit representing 3 different B-24D aircraft that participated in the raid of August 1, 1943. Each had unique paint and markings typical of the early B-24D used in the Mediterranean Theatre of operation in World War II.

This Minicraft kit offers markings for the following aircraft:

B-24D "Suzy Q", 67th BS, 44th BG

B-24D "Timba-a-ah!", 506th BS, 44th BG

B-24D "Kate Smith" 343rd BS, 98th BG

Minicraft Models, 1501 Commerce Drive, Elgin IL 60123 USA

[www.minicraftmodels.com](http://www.minicraftmodels.com)

# PARTS LOCATING DIAGRAM

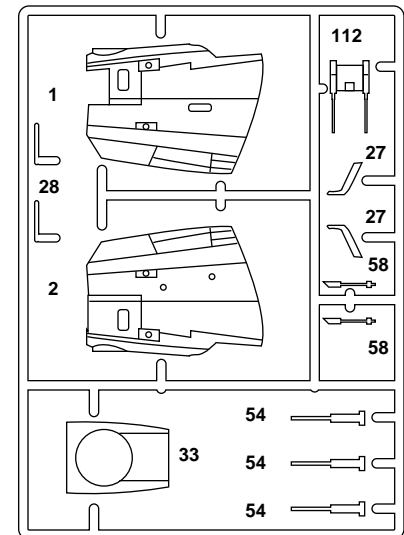
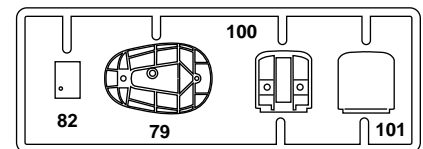
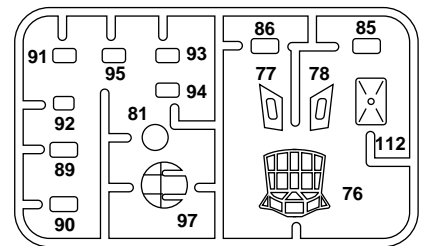
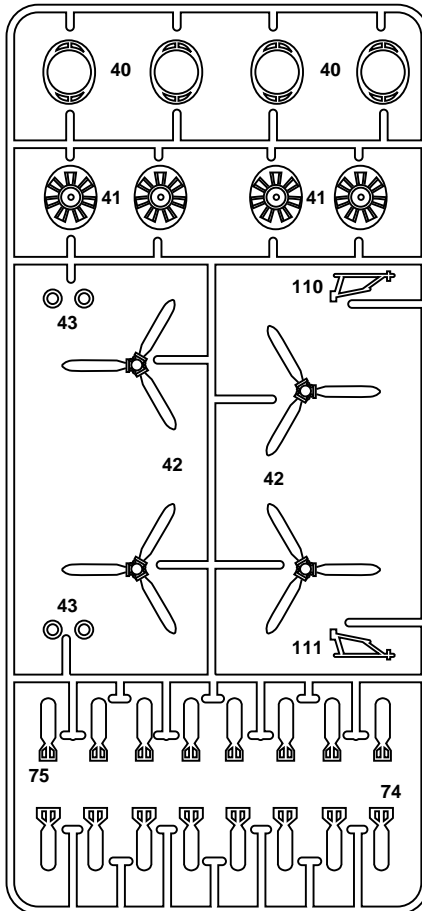
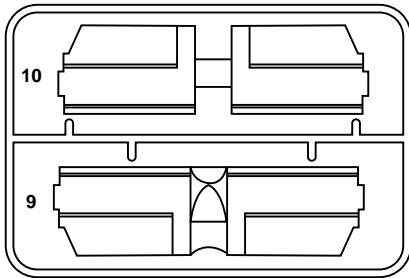
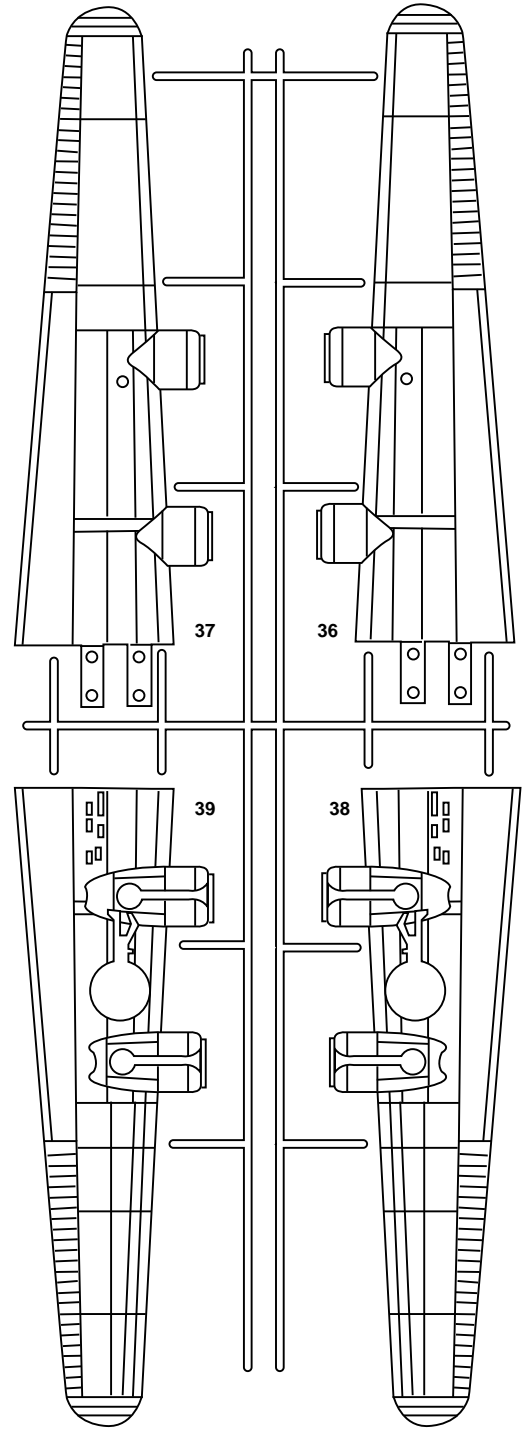
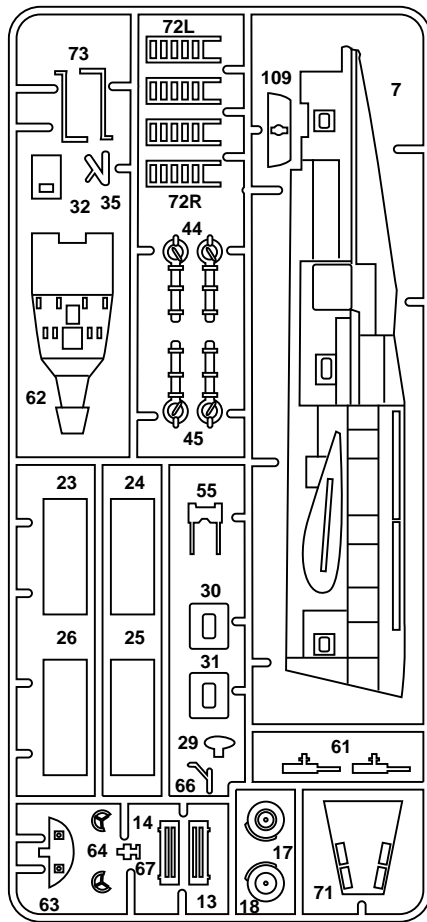
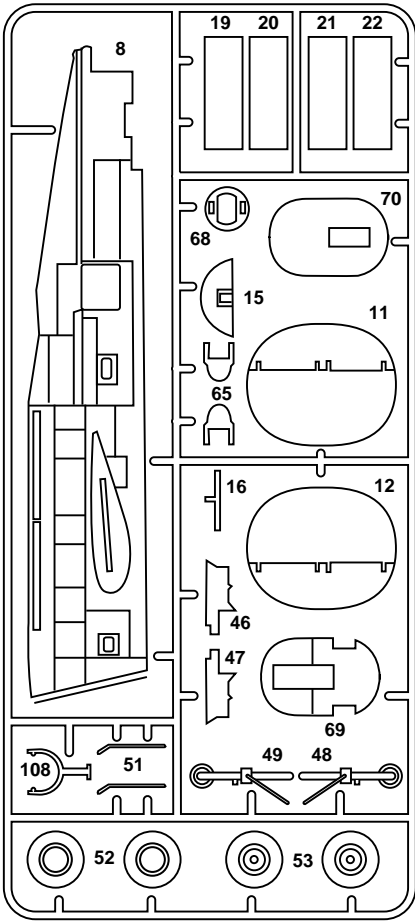

## 9 FORWARD FUSELAGE ASSEMBLY

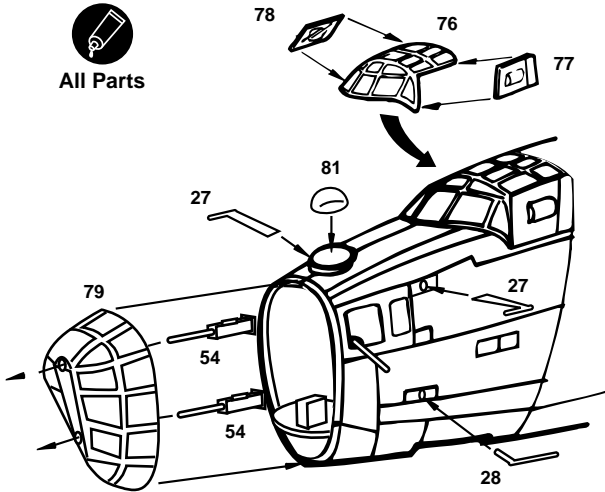

¥ Guns FLAT BLACK / GUNMETAL

## 10 BOMB BAY DOORS

DOORS OPEN



DOORS CLOSED

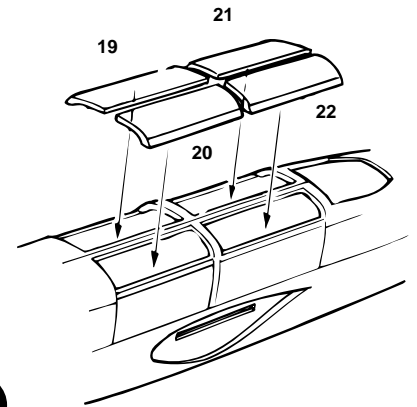
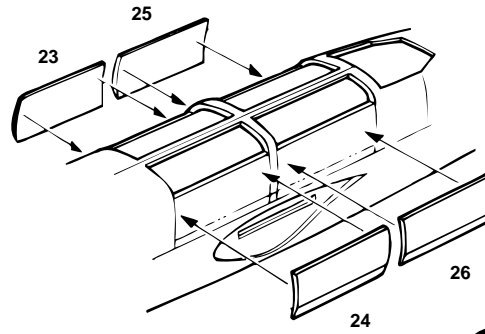

All Parts

## 11 UNDERSIDE FAIRING

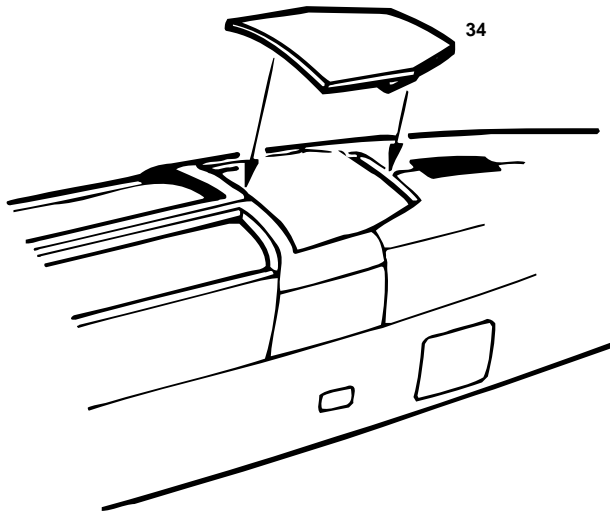

## 12 TAILSKID AND HATCH

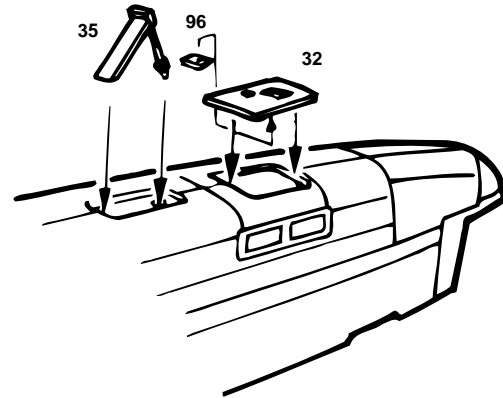

## 13 TAIL TURRET INSTALLATION

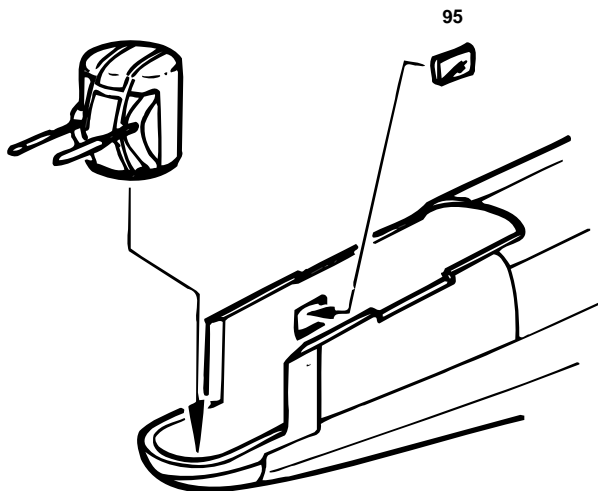

## 14 ENGINE ASSEMBLY

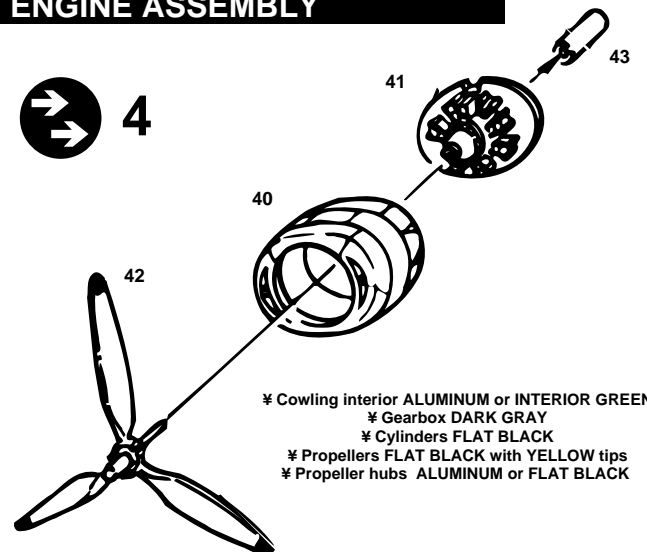

¥ Cowling interior ALUMINUM or INTERIOR GREEN  
 ¥ Gearbox DARK GRAY  
 ¥ Cylinders FLAT BLACK  
 ¥ Propellers FLAT BLACK with YELLOW tips  
 ¥ Propeller hubs ALUMINUM or FLAT BLACK

## 7 COCKPIT INSTALLATION



All Parts

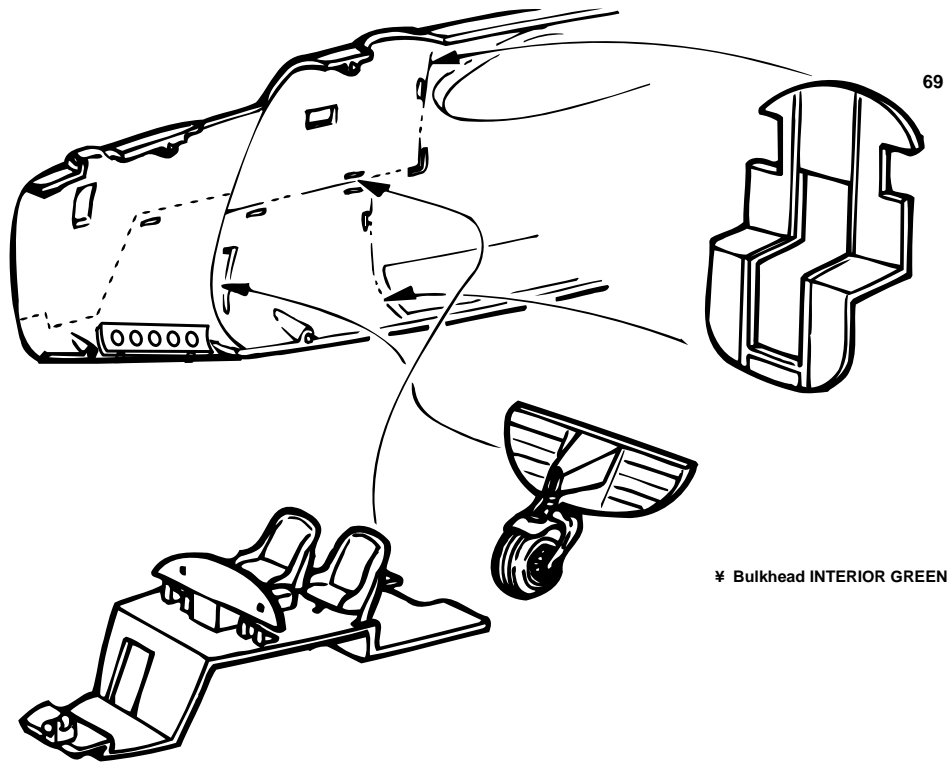

## 8 MAIN FUSELAGE ASSEMBLY



All parts except where noted

¥ Upper turret interior INTERIOR GREEN  
¥ Guns FLAT BLACK

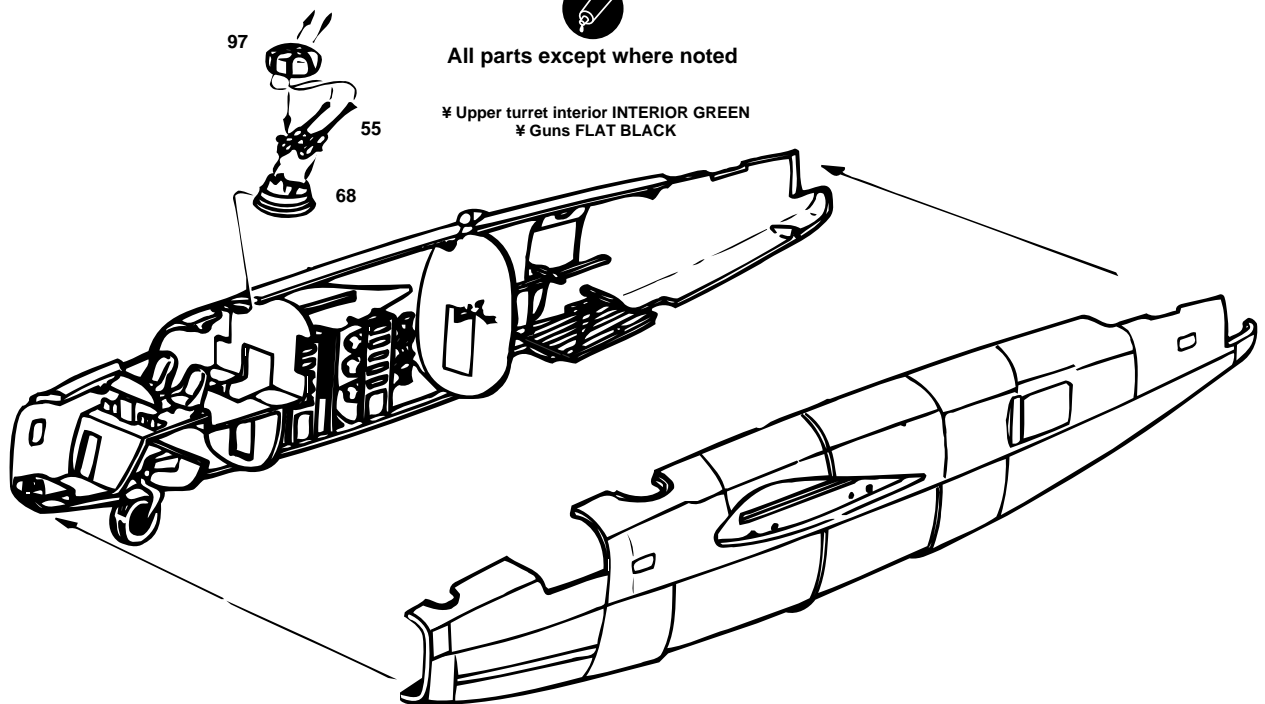

# 4 INTERIOR ASSEMBLY LEFT

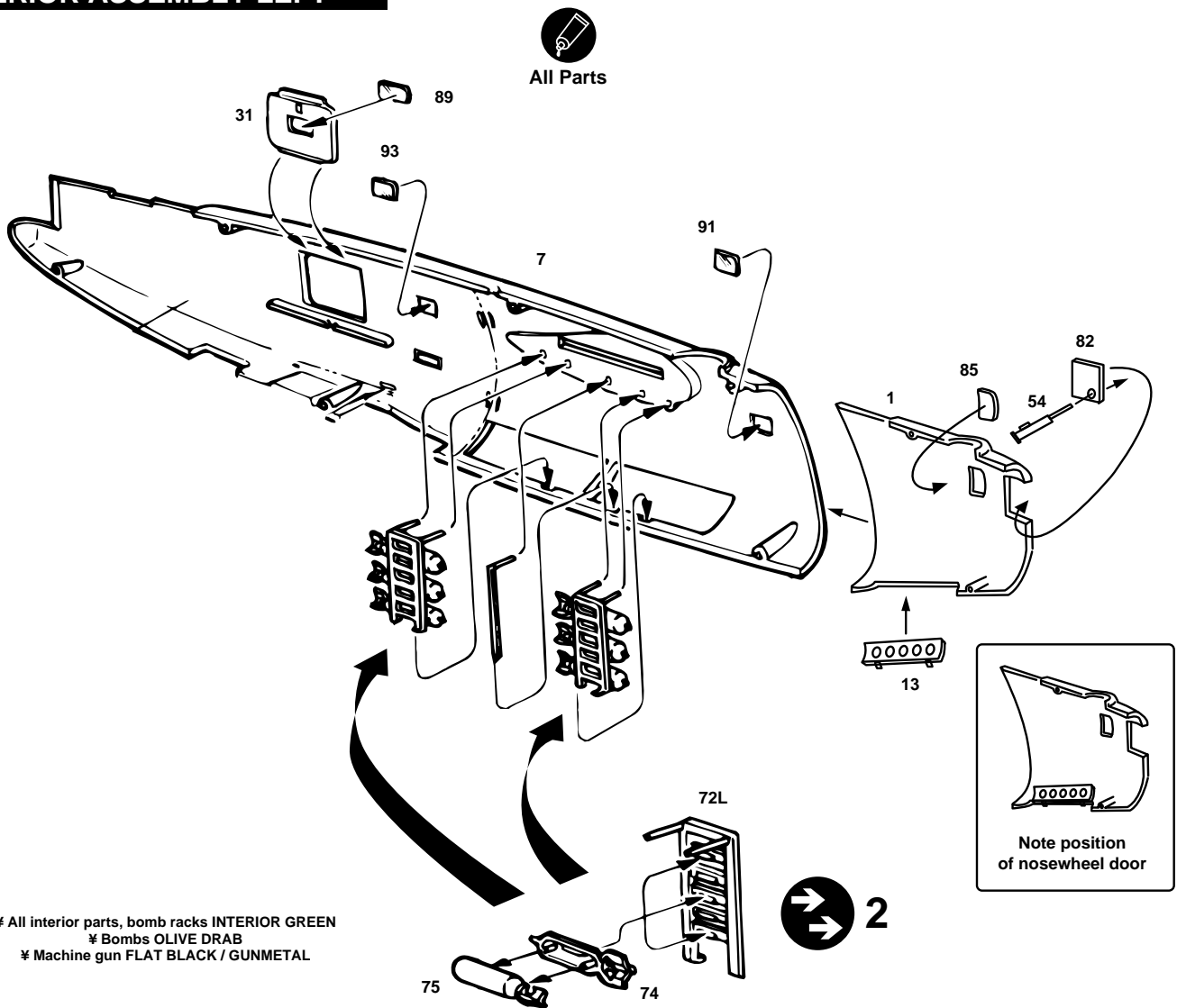

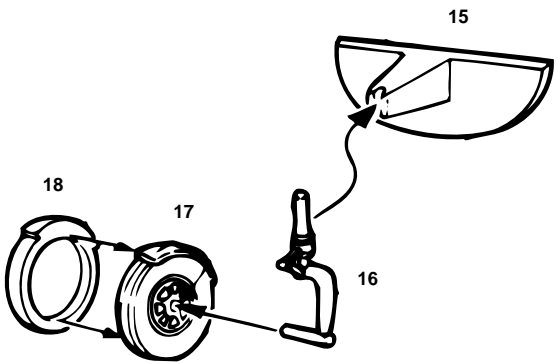

# 5 NOSEWHEEL ASSEMBLY



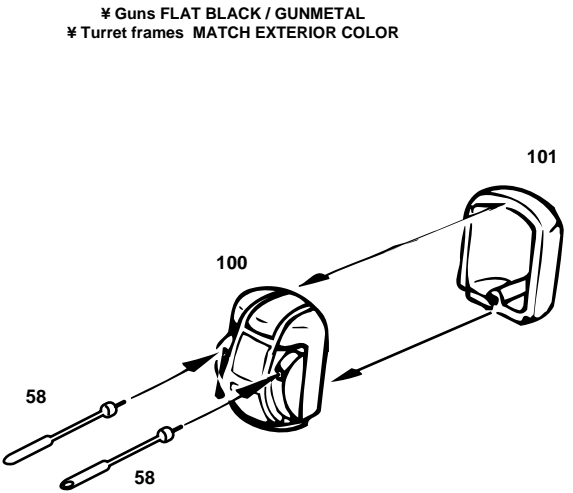

† Bulkhead INTERIOR GREEN  
 † Strut, mudguard and wheel hubs ALUMINUM  
 † Tire FLAT BLACK-GRAY

# 6 TAIL TURRET





- 

Cement  
Coller  
Kleben  
Pegar  
Incollare  
Colar  
Kleven
- 

**DO NOT Cement**  
Ne pas Coller  
Nicht Kleben  
No Pegar  
Non Incollare  
Nao Colar  
Niet Kleven
- 

Cut away  
Couper  
Scheiden  
Cortar  
Tagliere  
Cortar  
Snijden
- 

Optional parts  
Choix  
Auswahlmöglichkeit  
Eleccion  
Scelta  
Opaco  
Keuze
- 

**3**  
Repeat operation  
RŽpeeter l' opŽration  
Vorgang wiederholen  
Repitir la operacion  
Ripetere  
Repitir a opera'ao  
Herhalen
- 

Symmetrical assembly
- 

Drill hole

## 1 WAIST GUNS

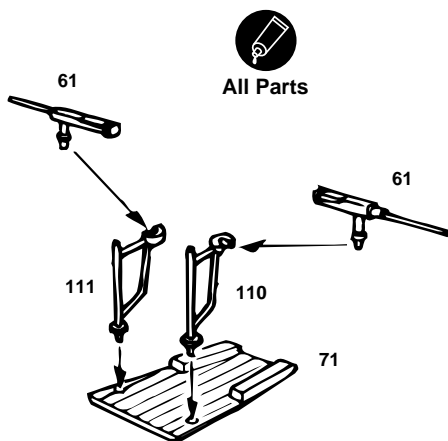

 All Parts

⌘ Floor WOOD TAN  
⌘ Gun mounts INTERIOR GREEN  
⌘ Guns FLAT BLACK / GUNMETAL

## 2 FLIGHT DECK

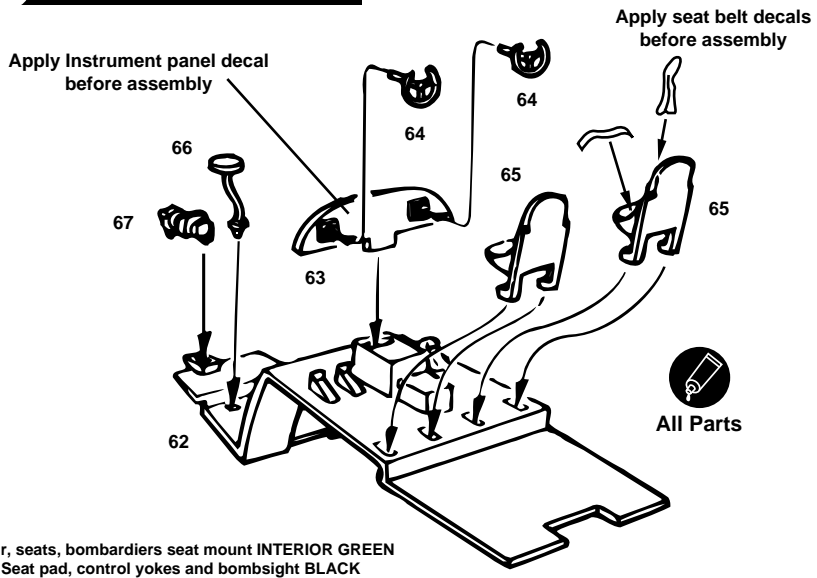

Apply Instrument panel decal before assembly

Apply seat belt decals before assembly

 All Parts

⌘ Floor, seats, bombardiers seat mount INTERIOR GREEN  
⌘ Seat pad, control yokes and bombsight BLACK

## 3 INTERIOR ASSEMBLY RIGHT

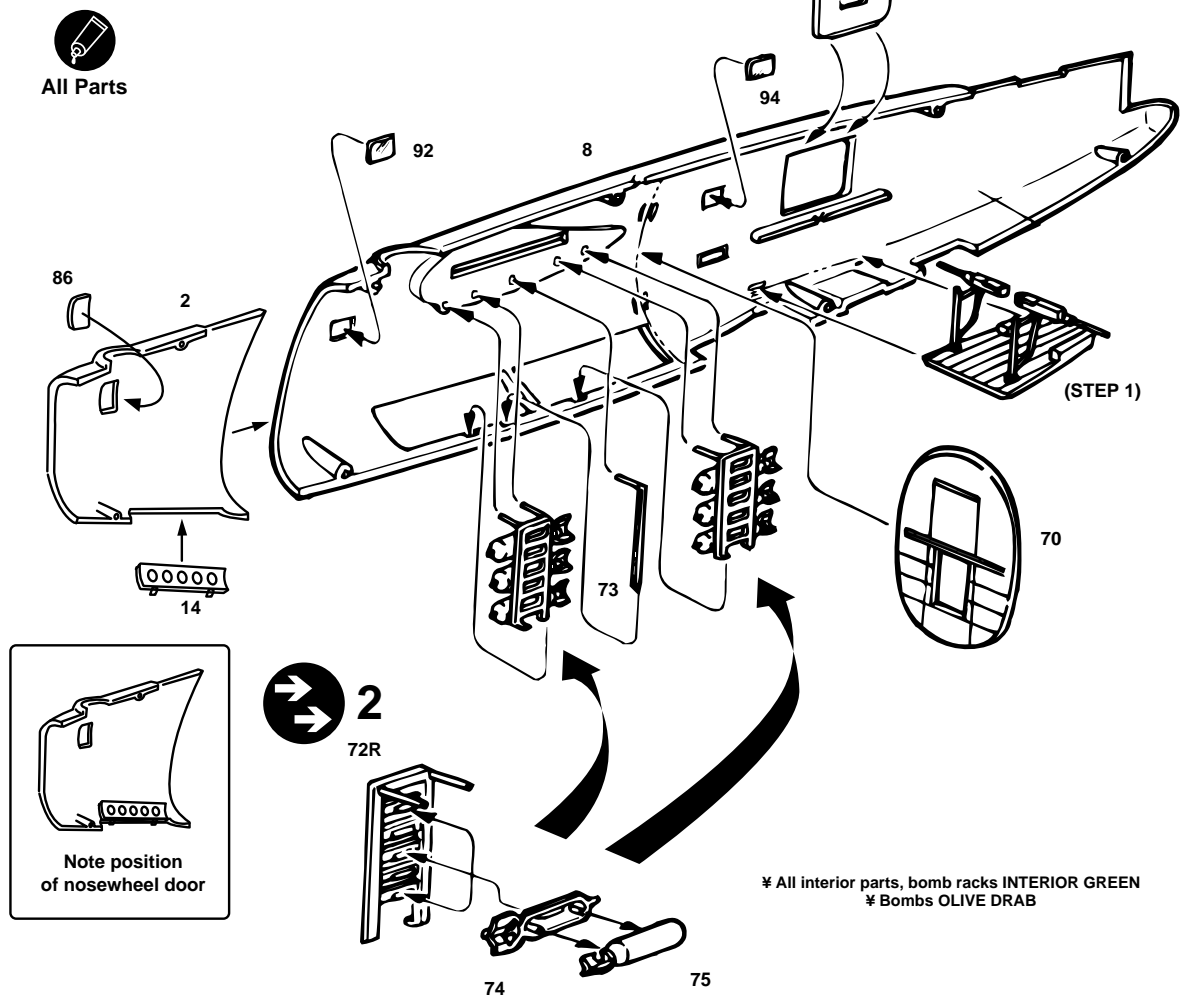

 All Parts

  
Note position of nosewheel door

 **2**  
72R

⌘ All interior parts, bomb racks INTERIOR GREEN  
⌘ Bombs OLIVE DRAB

(STEP 1)



# PAINT & DECAL GUIDE

## B-24D "Timba-a-ah!", 506th BS, 44th BG

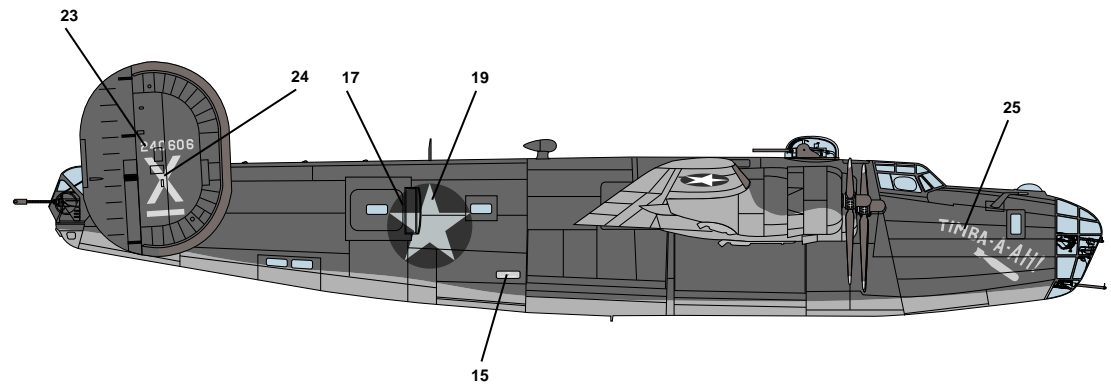
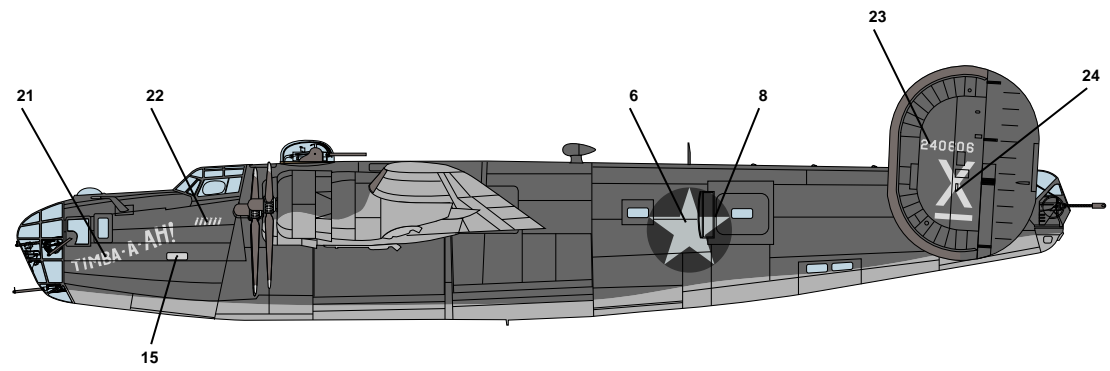
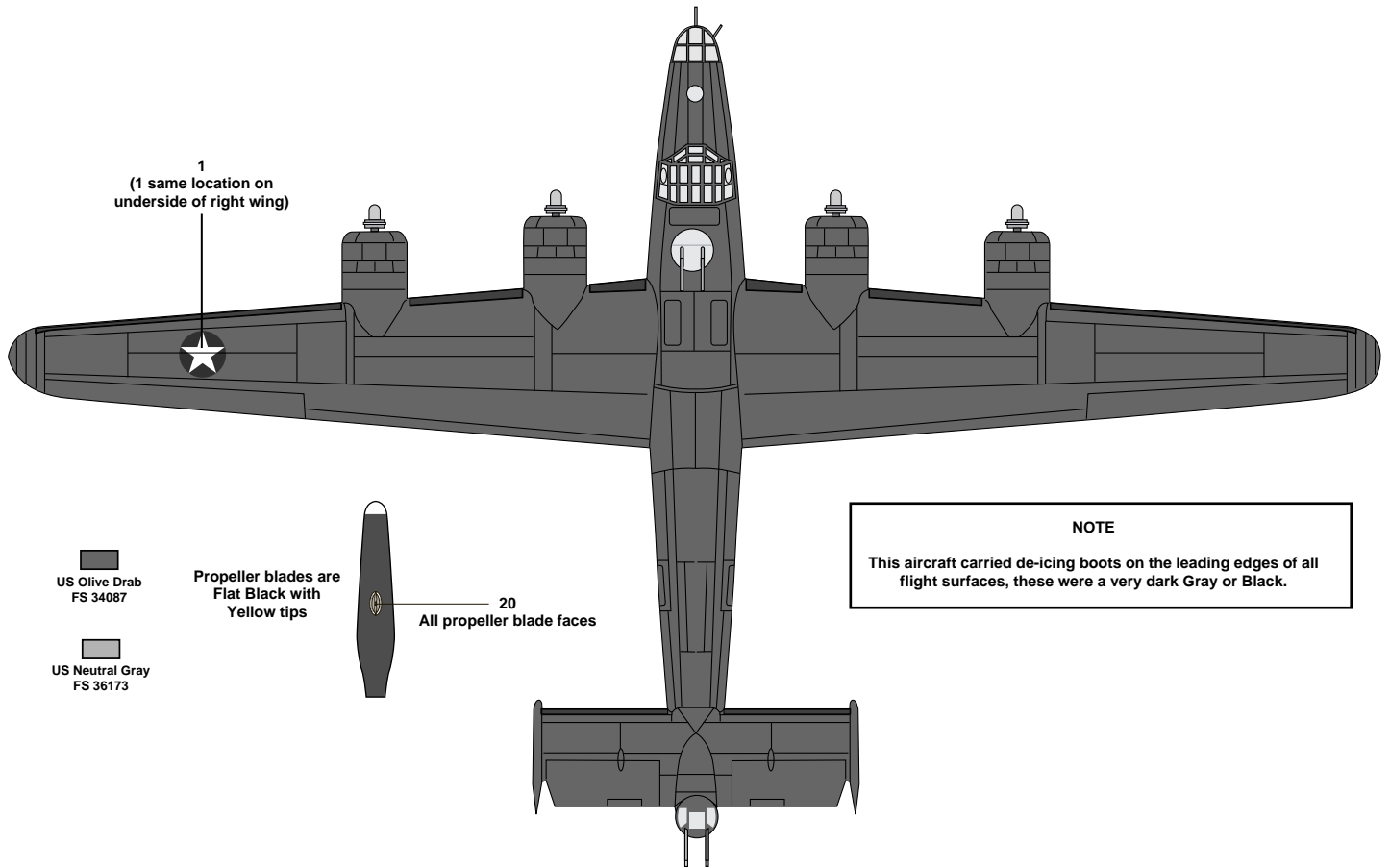



# PAINT & DECAL GUIDE

## B-24D "Suzy Q", 67th BS, 44th BG

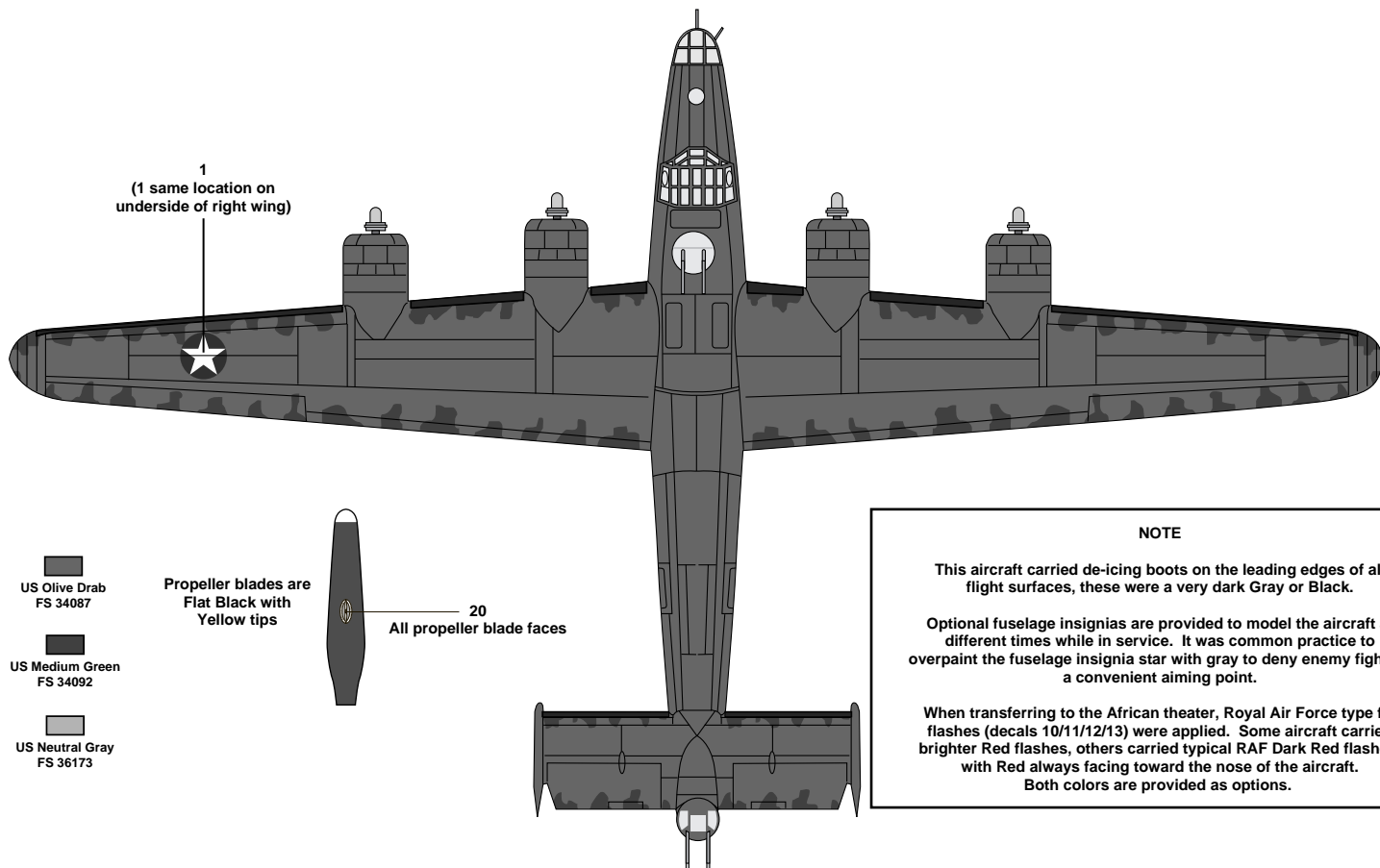

**NOTE**

This aircraft carried de-icing boots on the leading edges of all flight surfaces, these were a very dark Gray or Black.

Optional fuselage insignias are provided to model the aircraft at different times while in service. It was common practice to overpaint the fuselage insignia star with gray to deny enemy fighters a convenient aiming point.

When transferring to the African theater, Royal Air Force type fin flashes (decal 10/11/12/13) were applied. Some aircraft carried brighter Red flashes, others carried typical RAF Dark Red flashes, with Red always facing toward the nose of the aircraft. Both colors are provided as options.

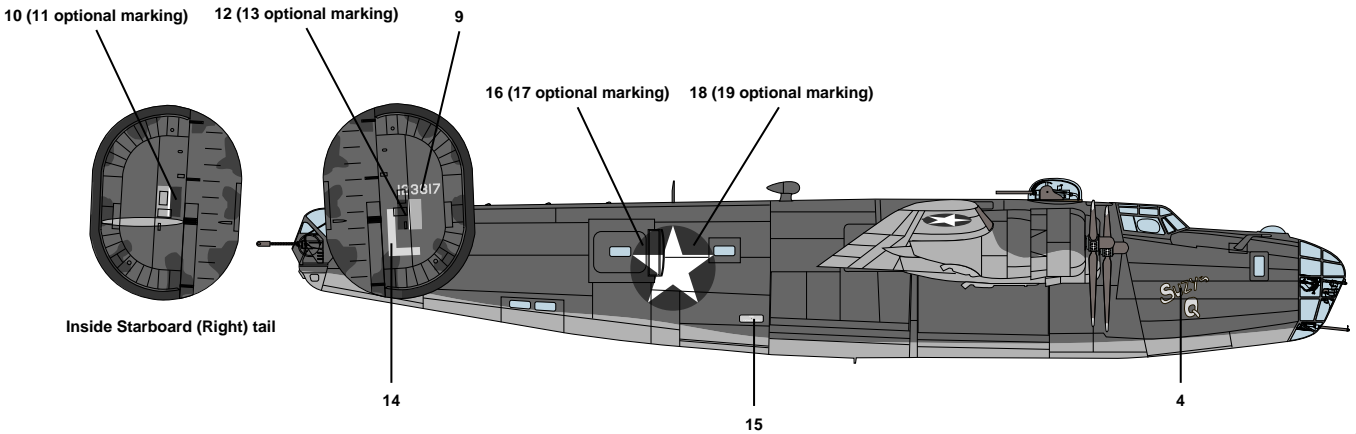
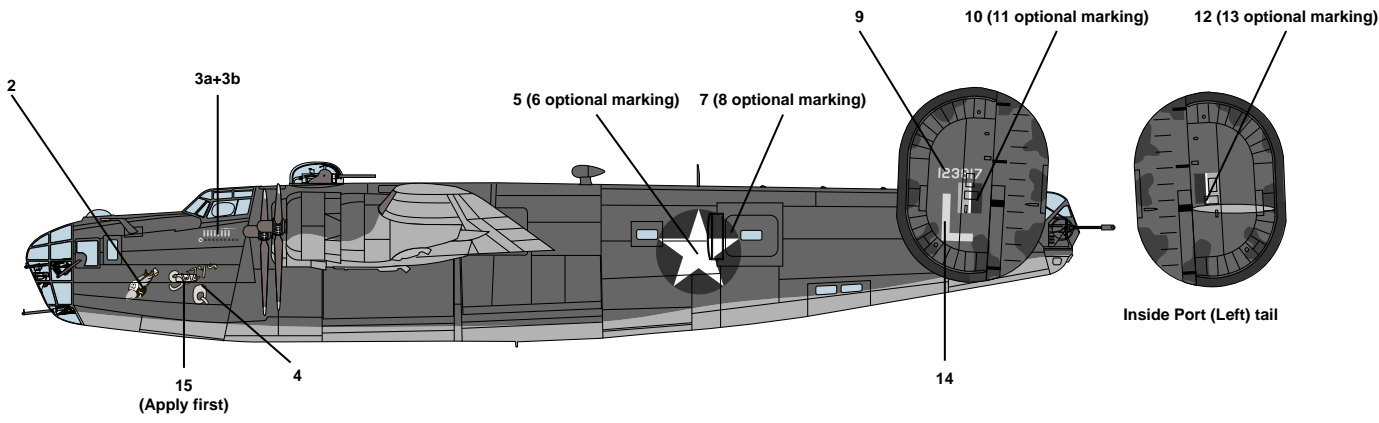

# PAINT & DECAL GUIDE

## B-24D "Kate Smith" 343rd BS, 98th BG

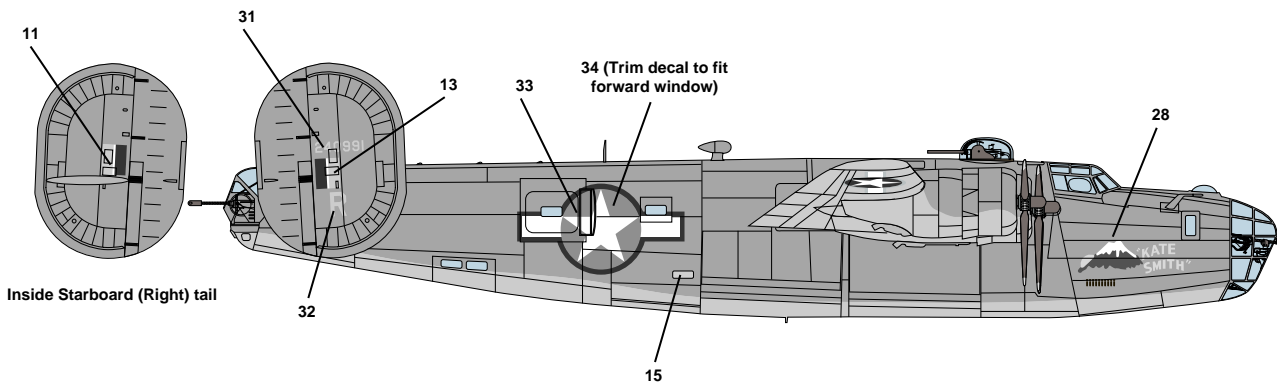
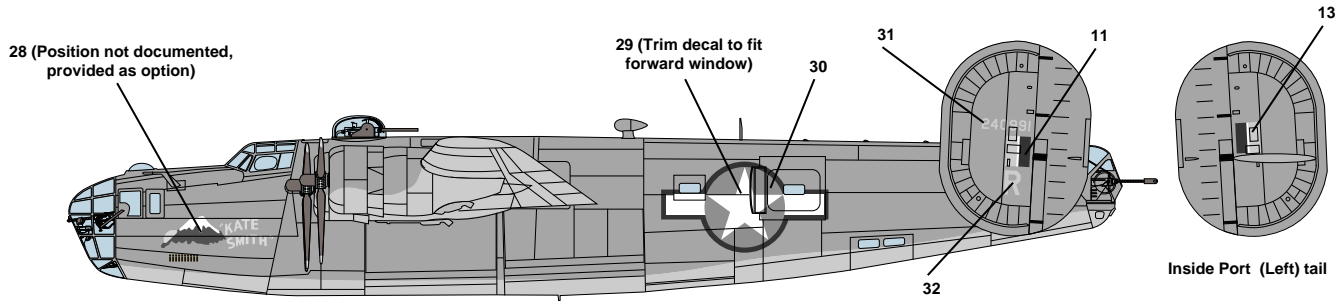
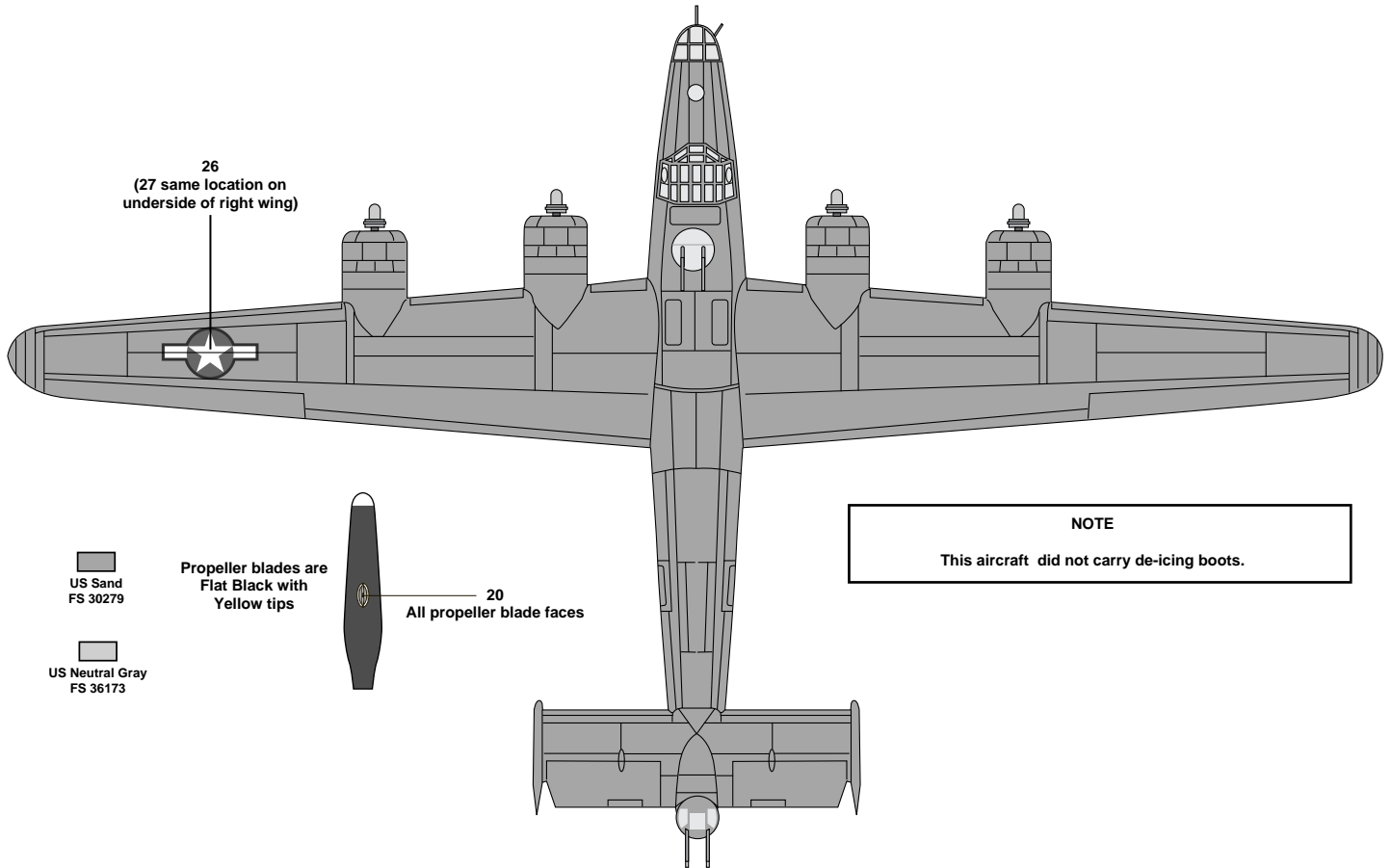

Your Minicraft model includes high-quality waterslide decals. These decals adhere best to a glossy surface; and it is recommended that you apply a clear gloss coat over your painted model.

Use a sharp scissors or knife to cut individual decals from the carrier sheet. Do not cut into the clear film surrounding the individual decals.

\* It is recommended that you apply one decal at a time.

\* Place the decal section in warm water, when first inserted in the water your decal will curl, after approximately ten seconds the decal will uncurl. Remove from water and lay on a paper towel. After approximately 10 - 20 seconds the decal will slide freely from the backing paper. Use a small brush to help slide the decal from the backing paper and into position on the model. Carefully blot excess water from the decal, using care not to move the decal or tear it.

\* If you choose to use a setting solution, apply a thin coat over the decal following the manufacturer's instruction.

\* Allow the decal to dry overnight. Wash any adhesive residue off the model with a small amount of clean water and dry thoroughly.

\* Apply clear gloss, matte or flat coat to seal decals following the instructions from the manufacturer.



*Legends in the making™*

Visit our Website-  
[www.minicraftmodels.com](http://www.minicraftmodels.com)

Minicraft Models  
1501 Commerce Drive  
Elgin, IL 60123

Phone: 847-429-9676